



# *Government Gazette*

OF THE STATE OF  
NEW SOUTH WALES

**Number 20**  
**Friday, 17 February 2012**

Published under authority by Government Advertising

## LEGISLATION

### **Online notification of the making of statutory instruments**

Week beginning 6 February 2012

THE following instruments were officially notified on the NSW legislation website ([www.legislation.nsw.gov.au](http://www.legislation.nsw.gov.au)) on the dates indicated:

#### **Regulations and other statutory instruments**

Electronic Transactions (ECM Courts) Amendment (Local Court) Order 2012 (2012-35) — published LW 10 February 2012

Mining Amendment (Fees) Regulation 2011 (2012-36) — published LW 10 February 2012

Trustee Amendment (Prescribed Insurers) Regulation 2012 (2012-37) — published LW 10 February 2012

Victims Support and Rehabilitation Regulation 2012 (2012-38) — published LW 10 February 2012

**OFFICIAL NOTICES****Appointments****BOARD OF VOCATIONAL EDUCATION AND  
TRAINING ACT 1994**

## Notification of Appointments to the Board

I, ADRIAN PICCOLI, M.P., Minister for Education, pursuant to Cabinet approval and Part 2 of the Board of Vocational Education and Training Act 1994, appoint the following people:

Mr Bert EVANS, AO  
Mr Kevin POWER, AM  
Ms Leslie LOBLE  
Mr Bill WOOLDRIDGE  
Ms Linda SIMON  
Mr Ben BARDON  
Ms Natalie WALKER

as Members of the Board of Vocational Education and Training for the period commencing on 1 January 2012 and ending on 30 June 2012.

ADRIAN PICCOLI, M.P.,  
Minister for Education

**EDUCATION ACT 1990**Notification of an Appointment to the  
Board of Studies

I, ADRIAN PICCOLI, M.P., Minister for Education, in pursuance of Schedule 1, Clause 8 of the Education Act 1990, appoint Professor Jo-Anne REID as a member of the Board of Studies, being a nominee provided under section 100(3)(a), for a term commencing on and from 31 January 2012 until 30 January 2015.

ADRIAN PICCOLI, M.P.,  
Minister for Education

## Roads and Maritime Services

### ROAD TRANSPORT (GENERAL) ACT 2005

Notice under the Road Transport (Mass, Loading and Access) Regulation 2005

I, Peter Duncan, Chief Executive, Roads and Maritime Services, pursuant to Clause 25 of the Road Transport (Mass, Loading and Access) Regulation 2005, hereby amend the 4.6 Metre High Vehicle Notice 2008, as published in *NSW Government Gazette* No. 185 on 21 December 2007 at pages 10618 to 10674, as set out in the Schedule of this Notice.

PETER DUNCAN,  
Chief Executive,  
Roads and Maritime Services

#### SCHEDULE

**1. Citation**

This Notice may be cited as the Roads and Maritime Services 4.6 Metre High Vehicle Notice 2008 (Amendment) Notice No. 1/2012.

**2. Commencement**

This Notice takes effect on and from the date of publication in the *NSW Government Gazette*.

**3. Effect**

This Notice remains in force up to and including 31 December 2012 unless it is repealed earlier.

**4. Amendment**

Insert the following routes into the table at Appendix 2, under the heading Part 1 – 4.6 Metre High Vehicle routes within Sydney Region.

<i>Road No.</i>	<i>State Route</i>	<i>Starting Point</i>	<i>Finishing Point</i>	<i>Conditions</i>
516	Chifley Road (Bells Line of Road)	Boundary of Lithgow City Council and Blue Mountains City Council	Darling Causeway (MR184), Bell	

## ROAD TRANSPORT (GENERAL) ACT 2005

Notice under the Road Transport (Mass, Loading and Access) Regulation 2005

I, Peter Duncan, Chief Executive, Roads and Maritime Services, pursuant to Clause 25 of the Road Transport (Mass, Loading and Access) Regulation 2005, hereby amend the 4.6 Metre High Vehicle Notice 2008, as published in *NSW Government Gazette* No. 185 on 21 December 2007 at pages 10618 to 10674, as set out in the Schedule of this Notice.

PETER DUNCAN,  
Chief Executive,  
Roads and Maritime Services

## SCHEDULE

**1 Citation**

This Notice may be cited as the Roads and Maritime Services 4.6 Metre High Vehicle Notice 2008 (Amendment) Notice No. 2/2012.

**2 Commencement**

This Notice takes effect on and from the date of publication in the *NSW Government Gazette*.

**3 Effect**

This Notice remains in force up to and including 31 December 2012 unless it is repealed earlier.

**4 Amendment**

Delete the following routes from the table at Appendix 2, under the heading Part 1 – 4.6 Metre High Vehicle routes within Sydney Region.

<i>Road No.</i>	<i>State Routes</i>	<i>Starting Point</i>	<i>Finishing Point</i>	<i>Conditions</i>
M2	M2 Motorway	Epping Road, North Ryde	Abbott Road, Seven Hills	

Insert the following routes into the table at Appendix 2, under the heading Part 1 – 4.6 Metre High Vehicle routes within Sydney Region.

<i>Road No.</i>	<i>State Routes</i>	<i>Starting Point</i>	<i>Finishing Point</i>	<i>Conditions</i>
M2 (6002)	Hills Motorway including on and off ramps at the following locations: Delhi Road, Ryde Road, Beecroft Road, Pennant Hills Road, Windsor Road, Abbot Road.	Delhi Road (MR191), North Ryde	Westlink M7 (6009)	
191	Delhi Road (MR191), North Ryde	Epping Road (MR373), North Ryde	M2 Motorway off ramp	

**ROAD TRANSPORT (GENERAL) ACT 2005**

Notice under the Road Transport (Mass, Loading and Access) Regulation 2005

I, Peter Duncan, Chief Executive, Roads and Maritime Services, pursuant to Clause 25 of the Road Transport (Mass, Loading and Access) Regulation 2005, hereby amend the 4.6 Metre High Vehicle Notice 2008, as published in *NSW Government Gazette* No. 185 on 21 December 2007 at pages 10618 to 10674, as set out in the Schedule of this Notice.

PETER DUNCAN,  
Chief Executive,  
Roads and Maritime Services

---

**SCHEDULE**
**1. Citation**

This Notice may be cited as the Roads and Maritime Services 4.6 Metre High Vehicle Notice 2008 (Amendment) Notice No. 3/2012.

**2. Commencement**

This Notice takes effect on and from the date of publication in the *NSW Government Gazette*.

**3. Effect**

This Notice remains in force up to and including 31 December 2012 unless it is repealed earlier.

**4. Amendment**

Delete the following route from the table at Appendix 2, under the heading Part 3 – 4.6 metre high vehicle routes in Shire and Council areas (excluding the Sydney Region) Wollongong City Council.

<i>Routes</i>	<i>Starting Point</i>	<i>Finishing Point</i>
Coal Terminal Road, Port Kembla	Port Kembla Road	Loop road around Coal Loader Terminal
Tom Thumb Road, Port Kembla	Springhill Road (MR581)	Coal Terminal Road
Teal Road, Port Kembla	Tom Thumb Road	Grain Handling Terminal
Farrer Road	Tom Thumb Road, Coniston	Grain Handling Terminal, Conison

Insert the following routes into the table at Appendix 2, under the heading Part 3 – 4.6 metre high vehicle routes in Shire and Council areas (excluding the Sydney Region) Port Kembla Ports Corporation.

<i>Routes</i>	<i>Starting Point</i>	<i>Finishing Point</i>
Coal Loader Road, Port Kembla North	Port Kembla Road (MR671), Coniston	Tom Thumb Road, Port Kembla North
Coal Terminal Road, Port Kembla North	Port Kembla Road (MR671), Coniston	Loop road around Coal Loader Terminal
Farrer Road, Port Kembla North	Tom Thumb Road, Port Kembla North	Grain handling terminal, Port Kembla North
Morton Way, Port Kembla North	Tom Thumb Road, Port Kembla North	Grain handling terminal, Port Kembla North
Tom Thumb Road, Port Kembla North	Springhill Road (MR581), Coniston	Coal Terminal Road, Port Kembla North
Unnamed Road (Wileys Road), Port Kembla North	Tom Thumb Road, Port Kembla North	End of road (approx 500m)
Unnamed Road (Berth 103), Port Kembla North	Tom Thumb Road, Port Kembla North	End of road (approx 200m)
Yampi Way, Port Kembla North	Tom Thumb Road, Port Kembla North	Entrance to car handling terminal, Port Kembla North

**ROAD TRANSPORT (GENERAL) ACT 2005**

Notice under the Road Transport (Mass, Loading and Access) Regulation 2005

I, Peter Duncan, Chief Executive, Roads and Maritime Services, pursuant to Clause 58 of the Road Transport (Mass, Loading and Access) Regulation 2005, hereby amend the 19 metre B-Double Mass Limit Notice 2010, as published in *NSW Government Gazette* No. 111 on 3 September 2010 at pages 4336 to 4353, as set out in the Schedule of this Notice.

PETER DUNCAN,  
Chief Executive,  
Roads and Maritime Services

---

**SCHEDULE**
**1. Citation**

This Notice may be cited as the Roads and Maritime Services 19 metre B-Double Mass Limit (Amendment) Notice No. 1/2012.

**2. Commencement**

This Notice takes effect on and from the date of publication in the *NSW Government Gazette*.

**3. Effect**

This Notice remains in force up to and including 1 September 2015 unless it is repealed earlier.

**4. Amendment**

Insert the following routes into the table at Appendix 1, under the heading Southern Region.

<i>Type</i>	<i>Road No.</i>	<i>Road Name</i>	<i>Starting Point</i>	<i>Finishing Point</i>	<i>Conditions</i>
19	1	Princes Highway, Wollongong	F6 Southern Freeway, Figtree	Service Station, corner of Crown Street and Staff Street, Wollongong	No travel permitted 6:00-10:00am and 3:00-6:00pm

**ROAD TRANSPORT (GENERAL) ACT 2005**

Notice under the Road Transport (Mass, Loading and Access) Regulation 2005

I, Peter Duncan, Chief Executive, Roads and Maritime Services, pursuant to Clause 20 of the Road Transport (Mass, Loading and Access) Regulation 2005, hereby amend the Class 2 B-Double Notice 2010, as published in the *NSW Government Gazette* No. 108 on 27 August 2010 at pages 4033 to 4284, as set out in the Schedule of this Notice.

PETER DUNCAN,  
Chief Executive,  
Roads and Maritime Services

**SCHEDULE****1. Citation**

This Notice may be cited as the Roads and Maritime Services Class 2 B-Double (Amendment) Notice No. 1/2012.

**2. Commencement**

This Notice takes effect on and from the date of publication in the *NSW Government Gazette*.

**3. Effect**

This Notice remains in force up to and including 1 September 2015 unless it is repealed earlier.

**4. Amendment**

Delete the following routes from the table at Appendix 1, under the heading Part 6 – Southern Region Private Roads.

<i>Type</i>	<i>Road Name</i>	<i>Starting Point</i>	<i>Finishing Point</i>
25	Coal Loader Road, Port Kembla North	MR671 Port Kembla Road	Tom Thumb Road
25	Coal Terminal Road, Port Kembla North	MR671 Port Kembla Road	Loop Road around Coal Loader Terminal
25	Farrer Road, Port Kembla North	Tom Thumb Road	Grain Handling Terminal
25	Teal Road, Port Kembla North	Tom Thumb Road	Grain Handling Terminal
25	Tom Thumb Road, Port Kembla North	MR581 Springhill Road	Coal Loader Road

Insert the following routes into the table at Appendix 1, under the heading Part 6 – Southern Region Port Kembla Ports Corporation

<i>Type</i>	<i>Road Name</i>	<i>Starting Point</i>	<i>Finishing Point</i>
25	Coal Loader Road, Port Kembla North	Port Kembla Road (MR671)	Tom Thumb Road
25	Coal Terminal Road, Port Kembla North	Port Kembla Road (MR671)	Loop Road around Coal Loader Terminal, Port Kembla North
25	Farrer Road, Port Kembla North	Tom Thumb Road	Grain Handling Terminal, Port Kembla North
25	Morton Way, Port Kembla North	Tom Thumb Road	Grain handling terminal, Port Kembla North
25	Tom Thumb Road, Port Kembla North	Springhill Road (MR581)	Coal Loader Road, Port Kembla North
25	Unnamed Road (Berth 103), Port Kembla North	Tom Thumb Road	End of road, approx 200m
25	Unnamed Road (Wileys Road), Port Kembla North	Tom Thumb Road	End of road, approx 500m
25	Yampi Way, Port Kembla North	Tom Thumb Road	Entrance to car handling terminal, Port Kembla North

**ROAD TRANSPORT (GENERAL) ACT 2005**

Notice under the Road Transport (Mass, Loading and Access) Regulation 2005

I, Peter Duncan, Chief Executive, Roads and Maritime Services, pursuant to Clause 20 of the Road Transport (Mass, Loading and Access) Regulation 2005, hereby amend the Class 2 B-Double Notice 2010, as published in the *NSW Government Gazette* No. 108 on 27 August 2010 at pages 4033 to 4284, as set out in the Schedule of this Notice.

PETER DUNCAN,  
Chief Executive,  
Roads and Maritime Services

---

SCHEDULE

**1. Citation**

This Notice may be cited as the Roads and Maritime Services Class 2 B-Double (Amendment) Notice No. 2/2012.

**2. Commencement**

This Notice takes effect on and from the date of publication in the *NSW Government Gazette*.

**3. Effect**

This Notice remains in force up to and including 1 September 2015 unless it is repealed earlier.

**4. Amendment**

Insert the following routes into the table at Appendix 1, under the heading Part 1 – Sydney Region

<i>Type</i>	<i>Road No.</i>	<i>Road Name</i>	<i>Starting Point</i>	<i>Finishing Point</i>
25	191	Delhi Road (MR191), North Ryde	Epping Road (MR373), North Ryde	M2 Motorway on and off ramps



**ROADS TRANSPORT (GENERAL) ACT 2005**

Notice under Clause 20 of the Road Transport (Mass, Loading and Access) Regulation 2005

BATHURST REGIONAL COUNCIL, in pursuance of Division 4 of Part 2 of the Road Transport (Mass, Loading and Access) Regulation 2005, by this Notice, specify the routes and areas on or in which B-Doubles may be used subject to any requirements or conditions set out in the Schedule.

Dated: 1 February 2012.

Mr DAVID JOHN SHERLEY,  
General Manager,  
Bathurst Regional Council  
(by delegation from the Minister for Roads)

**SCHEDULE****1. Citation**

This Notice may be cited as the Bathurst Regional Council B-Doubles Notice No. 2/ 2012.

**2. Commencement**

This Notice takes effect on the date of Gazettal.

**3. Effect**

This Notice remains in force until 30 September 2015 unless it is amended or repealed earlier.

**4. Application**

This Notice applies to those 25 metre B-Double vehicles which comply with Schedule 1 of the Road Transport (Mass, Loading and Access) Regulation 2005 and Schedule 2 of the Road Transport (Vehicle Registration) Regulation 2007.

**5. Routes**

B-Double routes within the Bathurst Regional Council.

<i>Type</i>	<i>Road No.</i>	<i>Road Name</i>	<i>Starting Point</i>	<i>Finishing Point</i>
25.	000.	Delaware Crescent, Bathurst.	Intersection with Mid Western Highway.	Entrance to 4b Delaware Crescent.

**ROAD TRANSPORT (GENERAL) ACT 2005**

Notice under the Road Transport (Mass, Loading and Access) Regulation 2005

BATHURST REGIONAL COUNCIL, in pursuance of the Road Transport (Mass, Loading, Access) Regulation 2005, makes the amendment in the Schedule to the routes and areas previously specified on or in which B-Doubles may be used.

Dated: 1 February 2012.

Mr DAVID JOHN SHERLEY,  
General Manager,  
Bathurst Regional Council  
(by delegation from the Minister for Roads)

**SCHEDULE****1. Citation**

This Notice may be cited as the Bathurst Regional Council B-Double Repeal Notice No. 1/2012.

**2. Commencement**

This Notice takes effect on the date of gazettal.

**3. Amendment**

The Class 2 General B-Double Notice 2010 – Appendix 1 is amended by omitting the following from that Notice:

<i>Type</i>	<i>Road No.</i>	<i>Road Name</i>	<i>Starting Point</i>	<i>Finishing Point</i>
25.	000.	Delaware Crescent, Bathurst.	Intersection with Mid Western Highway.	End of Delaware Crescent (no through road).

**ROAD TRANSPORT (GENERAL) ACT 2005**

Class 3 26-metre B-Double Exemption (Amendment) Notice 2012

I, Peter Duncan, Chief Executive of Roads & Maritime Services pursuant to Clause 25 of the Road Transport (Mass, Loading and Access) Regulation 2005, hereby amend the Class 3 26-metre B-Double Exemption Notice 2010 as published in the NSW Government Gazette on 24 September 2010 in Government Gazette No. 117 at pages 4841 to 4843 as set out in the Schedule of this Notice.

PETER DUNCAN,  
Chief Executive  
Roads and Maritime Service

**SCHEDULE**

The *Class 3 26-metre B-Double Notice 2010* published on 24 September 2010 in Government Gazette No. 117 at pages 4841 to 4843 is amended by this exemption as follows:

**[1] Delete after 4.3:**

4.3.1 The prime mover must comply with Regulation No. 29 made under the UN ECE Agreement (UN ECE R29) for cabin strength.

**[2] Insert after 4.3**

4.3.1 The prime mover, if manufactured after 31 December 2005, must comply with Regulation No. 29 made under the UN ECE Agreement (UN ECE R29) for cabin strength.

**ROADS TRANSPORT (GENERAL) ACT 2005**

## Class 3 Semi-Trailer Exemption Notice 2012

I, Peter Duncan, Chief Executive of the Roads and Maritime Services, pursuant to Clause 25 of the Road Transport (Mass, Loading and Access) Regulation 2005 (the Regulation), do, by this Notice exempt the vehicles described in Part 2 of the Schedule of this Notice from Clause 8 (1) of Schedule 1 to the Regulation and Clause 73(1)(b) of Schedule 2 to the Road Transport (Vehicle Registration) Regulation 2007, as provided in the Schedule of this Notice.

PETER DUNCAN,  
Chief Executive  
Roads and Maritime Services

---

 SCHEDULE

## PART 1 — PRELIMINARY

**1.1 Citation**

This Notice may be cited as the Class 3 Semi-Trailer Exemption Notice 2012.

**1.2 Commencement**

This Notice takes effect on and from publication in the New South Wales Government Gazette.

**1.3 Effect**

This Notice remains in force until 1 December 2016 unless repealed earlier.

**1.4 Repeal**

This Notice repeals and replaces the Class 3 Semi-Trailer Exemption Notice 2008 published in New South Wales Government Gazette Number 185 on 21 December 2007 at pages 10605 to 10606.

**1.5 Interpretation**

1.5.1 Unless stated otherwise in this Notice, words and expressions used in this Notice have the same meaning as those defined in the Road Transport (General) Act 2005.

1.5.2 "Identification Plate" has the same meaning as defined in the Motor Vehicle Standards Act 1989 (Commonwealth).

1.5.3 Notes, diagrams and tables in this Notice do not form part of the Notice.

## PART 2 — APPLICATION

**2.1 Application**

2.1.1 Subject to Clauses 3.3 and 3.4, this Notice applies to a semi-trailer (including a pole-type trailer) used in prime mover semi-trailer combination that does not exceed the dimension limits set out in Table 1 of this Notice.

2.1.2 This Notice does not apply to a semi-trailer used as part of a B-Double or Road Train combination.

## PART 3 — OPERATION AND TRAVEL REQUIREMENTS

**3.1 Documentation**

3.1.1 A copy of this Notice must be carried in the driving compartment whenever the vehicle is operating under this Notice and must be produced when the driver is requested to do so by a police officer or an authorised officer.

3.1.2 Where a compliance certificate is required under Clause 3.2 (a) or 3.2(b) of this Notice, the certificate must be carried in the vehicle at all times.

**3.2 Compliance plate denoting overdimension**

A semi-trailer to which this Notice applies must be

(a) fitted with an identification plate denoting that the trailer is overdimension, or

(b) must have an

(i) engineering certificate issued by an engineering signatory under the Roads and Maritime Services Engineering Certification Scheme, or

(ii) compliance certificate issued by a licenced certifier under the Roads and Maritime Services Vehicle Safety Compliance Certification Scheme,

that shows the semi-trailer has been modified to comply with the applicable Australian Design Rules at the time of certification and fits the dimensions outlined in Table 1.

**3.3 Livestock trailers and crates**

A semi-trailer or crate for transporting livestock, may operate under this Notice subject to the following conditions:

(a) must only use a single deck trailer when transporting cattle.

(b) must not use a trailer with more than two decks when transporting sheep, pigs or goats.

(c) the lower deck must be fully loaded before the upper deck is used, and

- (d) must not be a trailer specifically designed for transporting horses, and
- (e) the distance from the lowest deck to the top of the trailer must not exceed 2.1 metres.

Note: Clause 73(4) of Schedule 2 to the Road Transport (Vehicle Registration) Regulation 2007 states that a trailer built to carry cattle, sheep, pigs or horses on 2 or more partly or completely overlapping decks must not have over 12.5 metres of its length available for the carriage of animals .

#### PART 4 — DIMENSION LIMITS

4.1 A semi-trailer to which this Notice applies must not exceed the dimension limits set out in **Table 1**.

TABLE 1 MAXIMUM DIMENSIONS						
L	R	S	T	W	X	ROH
14.63	1.9	9.5	13.2	2.5	19.0	3.7m

DIAGRAM 1

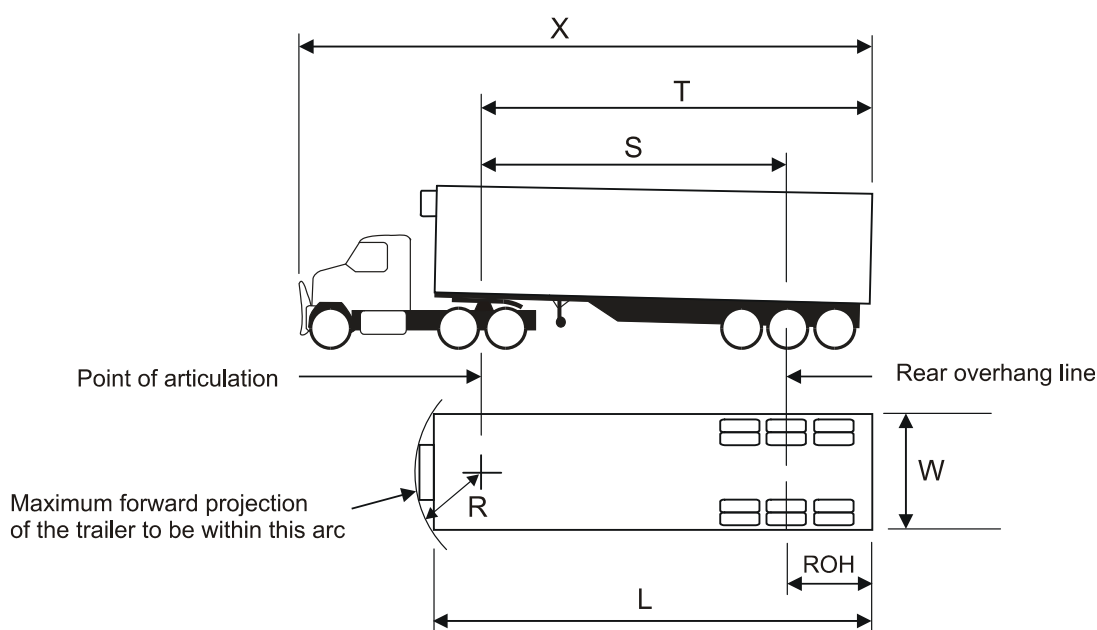

#### 4.2 Car Carriers

4.2.1 Dimension X in Table 1 does not apply to a vehicle designed to carry vehicles on more than one deck, subject to the following conditions:

- (a) the load must not project more than 1.2 metres in front of the vehicle,
- (b) the distance measured at right angles between the rear overhang line of a trailer and the rear of the rearmost vehicle on the trailer must not exceed 4.9 m.
- (c) where the vehicle is not designed to carry a car over the driving compartment, the vehicle and its load must not exceed 20.2 metres in length.
- (d) where the vehicle is designed to carry a car over the driving compartment, the vehicle and its load must not exceed 21.4 metres in length.

4.2.2 A car carrier, including its load, which exceeds 19 metres in length must only operate on route set out in the Class 2 Car Carrier Notice 2010 as published in the NSW Government Gazette on 24 December 2010 and is available on the Roads and Maritime Services website.

**ROADS ACT 1993**

Order - Sections 46, 49, 54 and 67

Wollongong City Council area

Dedication of Land as Public Road and Declaration as a Controlled Access Road of part of Memorial Drive at Woonona

I, the Minister for Roads and Ports, pursuant to Sections 46, 49, 54 and 67 of the Roads Act, 1993, by this order -

1. dedicate as public road the land described in Schedules 1 and 2 under;
2. declare to be a main road the said public road described in Schedule 2 and the public road described in Schedule 3 under;
3. declare to be a controlled access road the said main road described in Schedules 2 and 3;
4. declare that access to the said controlled access road is restricted; and
5. specify in Schedule 4 under, the points along the controlled access road at which access may be gained to or from other public roads.

**HON DUNCAN GAY MLC  
MINISTER FOR ROADS AND PORTS**

---

**SCHEDULE 1**

ALL those pieces or parcels of land situated in the Wollongong City Council area, Parish of Woonona and County of Camden, shown as:

Lot 30 Section D Deposited Plan 977908; and

Lots 39 to 48 Deposited Plan 1158886.

The above Lots comprise the whole of the land in the correspondingly numbered certificates of title and are all shown in RMS Plan 0626 497 AC 4004.

---

**SCHEDULE 2**

ALL those pieces or parcels of land situated in the Wollongong City Council area, Parish of Woonona and County of Camden shown as:

Lot 1 Deposited Plan 1017567;

Lot 1 Deposited Plan 742635;

Lot 100 Deposited Plan 882107;

Lot 1 Deposited Plan 999603;

Lots 28 and 29 Deposited Plan 1137958;

Lots 1 and 2 Deposited Plan 199909;

Lot 1 Deposited Plan 193919;

Lot 2 Deposited Plan 1004446;

Lots 3, 4, 5 and 22 Deposited Plan 13769;

Lot 20 Deposited Plan 6454;

Lots 11, 12 and 13 Deposited Plan 1141154;

Lots 26 and 28 Section D Deposited Plan 977908;

Lots 43, 44 and 45 Section B Deposited Plan 977908; and

Lots 19 to 31 inclusive Deposited Plan 1158886.

The above Lots are all shown in RMS Plan 0626 497 AC 4004.

---

**SCHEDULE 3**

ALL those pieces or parcels of public road situated in the Wollongong City Council area, Parish of Woonona and County of Camden shown as:

Lots 32 to 38 inclusive Deposited Plan 1158886.

The above Lots are all shown in RMS Plan 0626 497 AC 4004.

---

**SCHEDULE 4**

Between the points A and B;

Between the points B and C;

between the points D and E; and

between the points E and F; all shown in RMS Plan 0626 497 AC 4004.

(RMS Papers: F8/497.11328)

**ROADS ACT 1993****LAND ACQUISITION (JUST TERMS  
COMPENSATION) ACT 1991**

Notice of Compulsory Acquisition of Land at South  
Kempsey in the Kempsey Shire Council area

Roads and Maritime Services by its delegate declares,  
with the approval of Her Excellency the Governor, that  
the land described in the schedule below is acquired by  
compulsory process under the provisions of the Land  
Acquisition (Just Terms Compensation) Act 1991 for  
the purposes of the Roads Act 1993.

T D Craig  
Manager, Compulsory Acquisition & Road Dedication  
Roads and Maritime Services

**SCHEDULE**

ALL that piece or parcel of public road situated in the  
Kempsey Shire Council area, Parish of Beranghi and  
County of Macquarie, shown as Lot 100 Deposited Plan  
1172316.

The land is said to be in the possession of Kempsey  
Shire Council.

(RMS Papers: SF2011/2207; RO 10/235.1641)

**ROADS ACT 1993**

Notice of Dedication of Land as Public Road at Peak  
Hill in the Parkes Shire Council area

Roads and Maritime Services, by its delegate dedicates  
the land described in the schedule below as public road  
under section 10 of the Roads Act 1993.

T D Craig  
Manager, Compulsory Acquisition & Road Dedication  
Roads and Maritime Services

**SCHEDULE**

ALL those pieces or parcels of land situated in the  
Parkes Shire Council area, Parish of Mingelo and  
County of Narromine, shown as Lots 3 and 4 Deposited  
Plan 1163024.

(RMS Papers: 17/353.1125; RO SF2012/000582/1)

## Department of Trade and Investment, Regional Infrastructure and Services

### COAL INNOVATION ADMINISTRATION ACT 2008

Appointment of members to the Coal Innovation NSW

I, CHRIS HARTCHER, MP, Minister for Resources and Energy, pursuant to sections 10(1) of the Coal Innovation Administration Act 2008 ("the Act"), hereby appoint the following new members (as below) as members of Coal Innovation NSW, including the Chairperson, for a period of 2 years from the date of appointment up to 31 December 2013.

*Appointment of New Independent Chair*

1. Dr Neil Shepherd

*Appointment of New Members*

1. Mr Brad Mullard
2. Prof Mary O'Kane
3. Dr Nicole Williams
4. Mr Michael Buffier
5. Prof Diane Wiley
6. Prof Michael Dureau
7. Prof Jim Galvin

Dated this 15th day of February 2012.

CHRIS HARTCHER, M.P.,  
Minister for Resources and Energy

### MINERAL RESOURCES

NOTICE is given that the following applications have been received:

#### EXPLORATION LICENCE APPLICATIONS

(T12-1026)

No. 4482, GOLD AND COPPER RESOURCES PTY LIMITED (ACN 124 534 863), area of 199 units, for Group 1, dated 8 February 2012. (Orange Mining Division).

(T12-1027)

No. 4483, SIBELCO AUSTRALIA LIMITED (ACN 000 971 844), area of 3 units, for Group 2, dated 14 February 2012. (Orange Mining Division).

CHRIS HARTCHER, M.P.,  
Minister for Resources and Energy

NOTICE is given that the following applications have been received:

#### REQUEST FOR CANCELLATION OF AUTHORITY

(07-1234)

Exploration Licence No. 7541, AUSTRALIA ORIENTAL MINERALS NL (ACN 010 126 708), County of Gough, area of 13 units. Application for Cancellation was received on 9 February 2012.

(T11-0076)

Exploration Licence No. 7733, PLATSEARCH NL (ACN 003 254 395), County of Yancowinna, area of 20 Units.

Application for Cancellation was received on 9 February 2012.

CHRIS HARTCHER, M.P.,  
Minister for Resources and Energy

NOTICE is given that the following application has been granted:

#### EXPLORATION LICENCE APPLICATION

(T11-0144)

No. 4260, now Exploration Licence No. 7876, SUMITOMO METAL MINING OCEANIA PTY LTD (ACN 059 761 125), Counties of Canbelego and Cowper, Map Sheet (8135, 8136), area of 112 units, for Group 1, dated 21 December 2011, for a term until 21 December 2013.

CHRIS HARTCHER, M.P.,  
Minister for Resources and Energy

NOTICE is given that the following application has been withdrawn:

#### EXPLORATION LICENCE APPLICATION

(T11-0265)

No. 4357, PINNACLE GOLD PTY LTD (ACN 151 778 424), County of Darling and County of Nandewar, Map Sheet (8936). Withdrawal took effect on 3 February 2012.

CHRIS HARTCHER, M.P.,  
Minister for Resources and Energy

NOTICE is given that the following applications for renewal have been received:

(T01-0164)

Exploration Licence No. 5922, TEMPLAR RESOURCES PTY LTD (ACN 085 644 944), area of 179 units. Application for renewal received 8 February 2012.

(07-0284)

Exploration Licence No. 7081, FORGE MINERALS PTY LTD (ACN 121 258 713), area of 15 units. Application for renewal received 10 February 2012.

(T09-0167)

Exploration Licence No. 7461, PEEL MINING LIMITED (ACN 119 343 734), area of 27 units. Application for renewal received 9 February 2012.

(T98-0153)

Consolidated Mining Lease No. 7 (Act 1992), PEAK GOLD MINES PTY LTD (ACN 001 533 777), area of 1185.5 hectares. Application for renewal received 13 February 2012.

CHRIS HARTCHER, M.P.,  
Minister for Resources and Energy

**RENEWAL OF CERTAIN AUTHORITIES**

NOTICE is given that the following authorities have been renewed:

(07-5411)

Exploration Licence No. 3326, HILLGROVE MINES PTY LTD (ACN 102 660 506), County of Sandon, Map Sheet (9236), area of 8 units, for a further term until 22 August 2013. Renewal effective on and from 6 February 2012.

(11-3912)

Exploration Licence No. 5879, PERILYA BROKEN HILL LIMITED (ACN 099 761 289), County of Yancowinna, Map Sheet (7234), area of 5 units, for a further term until 31 October 2013. Renewal effective on and from 6 February 2012.

(05-0169)

Exploration Licence No. 6447, PERILYA BROKEN HILL LIMITED (ACN 099 761 289), County of Yancowinna, Map Sheet (7133, 7134), area of 8 units, for a further term until 31 October 2013. Renewal effective on and from 6 February 2012.

(07-0148)

Exploration Licence No. 6813, PLATSEARCH NL (ACN 003 254 395), County of Dudley, Map Sheet (9336), area of 15 units, for a further term until 20 June 2013. Renewal effective on and from 6 February 2012.

(07-0308)

Exploration Licence No. 6922, COMMISSIONERS GOLD LIMITED (ACN 115 845 942), County of King, Map Sheet (8728), area of 21 units, for a further term until 24 October 2013. Renewal effective on and from 6 February 2012.

(12-0253)

Exploration Licence No. 7279, ABX2 PTY LTD (ACN 139 791 478), County of Camden, Map Sheet (8928), area of 7 units, for a further term until 30 January 2013. Renewal effective on and from 17 January 2012.

CHRIS HARTCHER, M.P.,  
Minister for Resources and Energy

**REFUSAL OF APPLICATION FOR RENEWAL**

NOTICE is given that the application for renewal in respect of the following authority has been refused:

(T08-0029)

Exploration Licence No. 7192, QUIDONG MINERALS PTY LTD (ACN 121 671 323), County of Wellesley, Map Sheet (8624, 8723, 8724), area of 33 units. The authority ceased to have effect on 7 February 2012.

CHRIS HARTCHER, M.P.,  
Minister for Resources and Energy

**CANCELLATION OF AUTHORITY AT REQUEST OF HOLDER**

NOTICE is given that the following authority has been cancelled:

(T10-0206)

Exploration Licence No. 7682, PLATSEARCH NL (ACN 003 254 395), County of Kennedy and County of Narromine, Map Sheet (8532), area of 39 units. Cancellation took effect on 3 February 2012.

CHRIS HARTCHER, M.P.,  
Minister for Resources and Energy

**TRANSFERS**

(11-5413)

Exploration Licence No. 6620, formerly held by CARBINE TUNGSTEN LIMITED (ACN 115 009 106) has been transferred to GOSSAN HILL GOLD LIMITED (ACN 147 329 833). The transfer was registered on 6 February 2012.

(11-5413)

Exploration Licence No. 6648, formerly held by ICON RESOURCES LTD (ACN 115 009 106) has been transferred to GOSSAN HILL GOLD LIMITED (ACN 147 329 833). The transfer was registered on 6 February 2012.

(T07-0472)

Exploration Licence No. 7119, formerly held by GREYSTOKE MINES PTY LTD (ACN 125 517 259) has been transferred to STANDARD IRON PTY LTD (ACN 131 971 438). The transfer was registered on 13 February 2012.

(11-5413)

Exploration Licence No. 7725, formerly held by CARBINE TUNGSTEN LIMITED (ACN 115 009 106) has been transferred to GOSSAN HILL GOLD LIMITED (ACN 147 329 833). The transfer was registered on 6 February 2012.

(11-5413)

Exploration Licence No. 7726, formerly held by CARBINE TUNGSTEN LIMITED (ACN 115 009 106) has been transferred to GOSSAN HILL GOLD LIMITED (ACN 147 329 833). The transfer was registered on 6 February 2012.

CHRIS HARTCHER, M.P.,  
Minister for Resources and Energy



## PRIMARY INDUSTRIES

**FISHERIES MANAGEMENT ACT 1994****FISHERIES MANAGEMENT (AQUACULTURE)  
REGULATION 2007**

## Section 177(1) – Notice of Aquaculture Lease Cancellation

OL59/281 within the estuary of Brisbane Water, having an area of 1.3046 hectares formerly leased by Frank VAN EDEN.

OL67/394 within the estuary of the Macleay River, having an area of 0.9020 hectares formerly leased by Craig Anthony DOYLE and Gary John SOARES.

OL82/074 within the estuary of the Macleay River, having an area of 0.1812 hectares formerly leased by Craig Anthony DOYLE and Gary John SOARES.

OL85/103 within the estuary of the Macleay River, having an area of 1.8108 hectares formerly leased by Craig Anthony DOYLE and Gary John SOARES.

OL86/252 within the estuary of the Macleay River, having an area of 1.5478 hectares formerly leased by Craig Anthony DOYLE and Gary John SOARES.

BILL TALBOT,  
Director,  
Aquaculture, Conservation and Marine Parks,  
Fisheries Division,  
NSW Department of Primary Industries

**FISHERIES MANAGEMENT ACT 1994****FISHERIES MANAGEMENT (AQUACULTURE)  
REGULATION 2007**

## Clause 39 (4) – Notice of Aquaculture Lease Renewal

THE Minister has renewed the following Class 1 Aquaculture Leases:

OL69/566 within the estuary of the Manning River, having an area of 0.6084 hectares to John William STONE and Doris Merle STONE of Coopernook, for a term of 15 years expiring on 31 December 2026.

OL88/033 within the estuary of the Manning River, having an area of 0.1742 hectares to John William STONE and Doris Merle STONE of Coopernook, for a term of 15 years expiring on 21 February 2027.

OL84/048 within the estuary of the Clyde River, having an area of 1.8503 hectares to Roderick James TERRY of Batemans Bay NSW, for a term of 15 years expiring on 22 September 2026.

BILL TALBOT,  
Director,  
Aquaculture, Conservation and Marine Parks,  
Fisheries Division,  
NSW Department of Primary Industries

**FISHERIES MANAGEMENT ACT 1994**

## Sections 8 &amp; 9 Notification – Urgent Fishing Closure

Ocean Waters north of Iluka (Shark Bay)  
and off Evans Head

I, GEOFF ALLAN, Executive Director, Fisheries NSW, with the delegated authority of the Minister for Primary Industries and the Director General of the Department of Trade and Investment, Regional Infrastructure and Services pursuant to sections 227 and 228 of the Fisheries Management Act 1994 (“the Act”), do by this notification pursuant to section 8 of the Act, prohibit the taking of all species of fish, by the method of otter trawl net (prawns) by all endorsement holders in the Ocean Trawl Fishery, in the waters described in Column 1 of the Schedule to this notification for the period commencing on the date of this notification and expiring on the date specified in Column 2 of that Schedule, unless under the direct supervision of an employee of the Department of Primary Industries or otherwise with the consent of the Executive Director, Fisheries NSW for the purpose of undertaking trials to determine the abundance and/or size of fish (including prawns) and informing any decision to amend or revoke this fishing closure.

## SCHEDULE

<i>Column 1 Waters</i>	<i>Column 2 Period</i>
<p><i>Ocean waters adjacent to Evans Head</i></p> <p>The whole of the waters within an area bounded by a line commencing at 29°08.300'S, 153°27.450'E (the eastern extremity of Snapper Rock) then drawn north north east to 29°03.480'S, 153°27.752'E (the '10 fathom snag'), then north north east to 29°00.000'S, 153°29.650'E (along the southern end of the Ballina Juvenile King Prawn Closure as set out in Schedule 2 to clause 8 of the Appendix to the <i>Fisheries Management (Ocean Trawl Share Management Plan) Regulation 2006</i>), then due west along latitude 29°00.000'S to the mean high water mark on Patches Beach), then generally south along the mean high water mark (and across the entrance to the Evans River) to the point of commencement (references to directions are indicative only).</p>	<p><i>Ocean waters adjacent to Evans Head:</i> until 25 February 2012 (11 days).</p>

<p><i>Ocean waters north of Iluka (Shark Bay)</i></p> <p>The whole of the waters within an area bounded by a line commencing at 29°21.534'S, 153°21.766'E (the eastern extremity of Poverty Bay Rocks, near Iluka) then drawn north north east to 29°15.000'S, 153°23.390E (the South West corner of the Evens Head Juvenile King Prawn Closure as set out in Schedule 2 to clause 8 of the Appendix to the <i>Fisheries Management (Ocean Trawl Share Management Plan) Regulation 2006</i>), then due west along latitude 29°15.000'S to the mean high waters mark on the beach near Black Rock, then generally south along the mean high water mark to the point of commencement (references directions are indicative only).</p>	<p><i>Ocean waters north of Iluka (Shark Bay)</i> until such time as this notification expires, is revoked or amended (following trawl trials).</p>
---	---

In this Schedule, latitude and longitude coordinates are in WGS84 datum.

In this fishing closure, Ocean Trawl Fishery means the share management fishery of that name, as described in Schedule 1 to the Act.

The provisions of this fishing closure in respect of endorsement holders in the Ocean Trawl Fishery have effect despite any provisions in the Fisheries Management (Ocean Trawl Share Management Plan) Regulation 2006.

This fishing closure is effective from the date of this notification until 1 July 2012 unless sooner amended or revoked.

Dated this 14th day of February 2012.

DR GEOFF ALLAN,  
Executive Director, Fisheries NSW  
Department of Primary Industries  
(an office within the Department of Trade and  
Investment, Regional Infrastructure and Services)

#### FISHERIES MANAGEMENT ACT 1994

Sections 8 & 9 Notification – Urgent Fishing Closure

Ocean Waters Adjacent to the Richmond, Clarence,  
Bellinger, Nambucca,

Macleay and Hastings Rivers

I, GEOFF ALLAN, Executive Director, Fisheries NSW, with the delegated authority of the Minister for Primary Industries and the Director General of the Department of Trade and Investment, Regional Infrastructure and Services pursuant to sections 227 and 228 of the Fisheries Management Act 1994 ("the Act"), do by this notification pursuant to section 8 of the Act, prohibit the taking of all species of fish, by the method of otter trawl net (prawns), otter trawl net (fish) and danish seine trawl net (fish) by all endorsement holders in the Ocean Trawl Fishery, in the waters described in Column 1 of the Schedule to this notification for the period

commencing on the date of this notification and expiring on the date specified in Column 2 of that Schedule, unless under the direct supervision of an employee of the Department of Primary Industries or otherwise with the consent of the Executive Director, Fisheries NSW for the purpose of undertaking trials to determine the abundance and/or size of fish (including prawns) and informing any decision to amend or revoke this fishing closure.

#### SCHEDULE

<i>Column 1 Waters</i>	<i>Column 2 Period</i>
<p><i>Ocean waters adjacent to the Richmond River</i></p> <p>The whole of the waters adjacent to the Richmond River bounded by a line commencing at the eastern extremity of the southern breakwater and heading generally south along the mean high water mark to 28°53.906'S, 153°33.706'E (adjacent to Keith Hall Lane), then south east to 28°54.028'S, 153°34.573'E (the western boundary of the Ocean Trawl Refuge Area), then generally north along the western boundary of the Ocean Trawl Refuge Area to a point 28°50.589'S, 153°37.011'E, then west to the eastern extremity of Flat Rock at 28°50.587'S, 153°36.521'E, then generally south along the mean high water mark to the eastern extremity of the northern breakwater and back to the point of commencement.</p>	<p><i>Ocean waters adjacent to the Richmond River:</i> until 25 February 2012 (2 weeks).</p>
<p><i>Ocean waters adjacent to the Clarence River</i></p> <p>The whole of the waters within an area bounded by a line drawn due east from the eastern most extremity of Second Bluff (Iluka) to the western boundary of the Angourie Point Juvenile King Prawn Closure set out in Schedule 2 to clause 8 of the Appendix to the <i>Fisheries Management (Ocean Trawl Share Management Plan) Regulation 2006</i>, then generally south along the western boundary of the Angourie Point Juvenile King Prawn Closure to its junction with the mean high water mark on Angourie Point, then generally north along the mean high water mark (and across the entrance of the Clarence River) to the point of commencement.</p>	<p><i>Ocean waters adjacent to the Clarence River:</i> until 25 February 2012 (2 weeks).</p>

<p><i>Ocean waters adjacent to the Nambucca River</i></p> <p>The whole of the waters within the area bounded by a line commencing at 30°37.121'S and 153°00.640'E (the mean high water mark approximately 2 nautical miles north of the Nambucca River entrance) and heading due east approximately 2 nautical miles to 30°37.121'S and 153°02.997'E, then due south approximately 4 nautical miles to 30°41.215'S and 153°02.997'E, then due west to 30°41.215'S and 153°59.706'E (the mean high water mark on Forster Beach), then generally north along the mean high water mark (and across the entrance to the Nambucca River) to the point of commencement.</p>	<p><i>Ocean waters adjacent to the Nambucca River:</i> until 18 February 2012 (1 week).</p>
<p><i>Ocean waters adjacent to the Macleay River</i></p> <p>The whole of the waters within the area bounded by a line commencing at 30°47.800'S and 153°00.146'E (the southern most point of Grassy Head) and heading due east to 30°47.800'S and 153°03.600'E, then south to 30°52.647'S and 153°04.034'E (the mean high water mark on Laggars Point), then generally north along the mean high water mark (and across the entrance to the Macleay River) to the point of commencement.</p>	<p><i>Ocean waters adjacent to the Macleay River:</i> until 18 February 2012 (1 week).</p>
<p><i>Ocean waters adjacent to the Hastings River</i></p> <p>The whole of the waters within the area bounded by a line commencing at 31°23.611'S and 152°55.188'E (the mean high water mark approximately 2 nautical miles north of the southern Hastings River breakwall) and heading due east approximately 2 nautical miles to 31°23.611'S and 152°57.511'E, then due south approximately 4 nautical miles to 31°27.615'S and 152°57.511'E, then due west to 31°27.615'S and 152°56.124'E (the mean high water mark on Lighthouse Beach), then generally north along the mean high water mark (and across the entrance to the Hastings River) to the point of commencement</p>	<p><i>Ocean waters adjacent to the Hastings River:</i> until 25 February 2012 (2 weeks).</p>

In this Schedule, latitude and longitude coordinates are in WGS84 datum.

In this fishing closure, Ocean Trawl Fishery means the share management fishery of that name, as described in Schedule 1 to the Act.

The provisions of this fishing closure in respect of endorsement holders in the Ocean Trawl Fishery have effect despite any provisions in the Fisheries Management (Ocean Trawl Share Management Plan) Regulation 2006.

This fishing closure is effective from the date of this notification until 25 February 2012 unless sooner amended or revoked.

Dated this 10th day of February 2012.

DR GEOFF ALLAN,  
Executive Director, Fisheries NSW  
Department of Primary Industries  
(an office within the Department of Trade and  
Investment, Regional Infrastructure and Services)

## LANDS

**ARMIDALE CROWN LANDS OFFICE**  
**108 Faulkner Street (PO Box 199A), Armidale NSW 2350**  
**Phone: (02) 6770 3100 Fax (02) 6772 8782**

**NOTIFICATION OF CLOSING OF A ROAD**

IN pursuance of the provisions of the Roads Act 1993, the road hereunder described is closed and the lands comprised therein cease to be public road and the rights of passage and access that previously existed in relation to the road is extinguished. Upon closing, title to the land, comprising the former public road, vests in the body specified in the Schedule hereunder.

KATRINA HODGKINSON, M.P.,  
 Minister for Primary Industries

## Description

*Parish – Armidale; County – Sandon;*  
*Land District – Armidale; L.G.A. – Armidale Dumaresq*

Road Closed: Lots 1-2, DP 1169605.

File No.: AE06 H 432.

## Schedule

On closing, the land within Lots 1-2, DP 1169605 remains vested in the State of New South Wales as Crown Land.

## Description

*Parish – Stag; County – Murchison*  
*Land District – Inverell; L.G.A. – Inverell*

Road Closed: Lot 1, DP 1169609.

File No.: AE06 H 99.

## Schedule

On closing, the land within Lot 1, DP 1169609 remains vested in the State of New South Wales as Crown Land.

## Description

*Parish – Weean; County – Arrawatta;*  
*Land District – Inverell; L.G.A. – Inverell*

Road Closed: Lot 1, DP 1169603.

File No.: AE06 H 405.

## Schedule

On closing, the land within Lot 1, DP 1169603 remains vested in the State of New South Wales as Crown Land.

## Description

*Parish – Urotah; County – Sandon;*  
*Land District – Armidale; L.G.A. – Armidale Dumaresq*

Road Closed: Lot 1, DP 1168711 (subject to easement/right of carriageway created by Deposited Plan DP 1168711).

File No.: 09/07080.

## Schedule

On closing, the land within Lot 1, DP 1168711 remains vested in the State of New South Wales as Crown Land.

## Description

*Parish – Tent Hill; County – Gough;*  
*Land District – Glen Innes;*  
*L.G.A. – Glen Innes Severn Shire*

Road Closed: Lots 1-2, DP 1140312.

File No.: AE06 H 107.

## Schedule

On closing, the land within Lots 1-2, DP 1140312 remains vested in the State of New South Wales as Crown Land.

## Description

*Parish – Ryanda; County – Clarke;*  
*Land District – Armidale; L.G.A. – Guyra*

Road Closed: Lots 7-8, DP 1159722 (subject to easement/right of carriageway created by Deposited Plan 1159722).

File No.: 10/04347.

## Schedule

On closing, the land within Lots 7-8, DP 1159722 remains vested in the State of New South Wales as Crown Land.

## Description

*Parish – Tenterfield; County – Clive;*  
*Land District – Tenterfield; L.G.A. – Tenterfield*

Road Closed: Lot 1, DP 1169606.

File No.: 08/11466.

## Schedule

On closing, the land within Lot 1, DP 1169606 remains vested in the State of New South Wales as Crown Land.

**DUBBO CROWN LANDS OFFICE**  
**45 Wingewarra Street (PO Box 1840), Dubbo NSW 2830**  
**Phone: (02) 6883 5421      Fax: (02) 6884 2067**

**REVOCATION OF A RESERVATION OF CROWN  
 LAND**

PURSUANT to section 90 of the Crown Lands Act 1989, the reservation of Crown Land specified in Column 1 of the Schedule hereunder, is revoked to the extent opposite in Column 2 of the Schedule.

SCHEDULE

<i>Column 1</i>	<i>Column 2</i>
Land District: Wellington.	The whole of Lot 124 in
Shire: Wellington.	DP 756896 of 4047 square
Parish: Mumbil.	metres.
County: Wellington.	
Reserve No.: 756906.	
Purpose: Future public requirements.	
Date of Notification: 29 June 2007.	

**NOTIFICATION OF CLOSING OF A ROAD**

IN pursuance of the provisions of the Roads Act 1993, the road hereunder described is closed and the lands comprised therein cease to be public road and the rights of passage and access that previously existed in relation to the road is extinguished. Upon closing, title to the land, comprising the former public road, vests in the body specified in the Schedule hereunder.

KATRINA HODGKINSON, M.P.,  
 Minister for Primary Industries

Description

*Parish – Guntawang; County – Phillip;  
 Land District – Mudgee; L.G.A. – Mid-Western*

Road Closed: Lot 1, DP 1169712.

File No.: 11/03393.

Schedule

On closing, the land within Lot 1, DP 1169712 remains vested in the State of New South Wales as Crown Land.

Description

*Parish – Mulyan; County – Wellington;  
 Land District – Orange; L.G.A. – Cabonne*

Road Closed: Lot 1, DP 1170772.

File No.: 11/11186.

Schedule

On closing, the land within Lot 1, DP 1170772 remains vested in the State of New South Wales as Crown Land.

**GOULBURN OFFICE**  
**159 Auburn Street (PO Box 748), Goulburn NSW 2580**  
**Phone: (02) 4824 3700 Fax: (02) 4822 4287**

**REVOCATION OF APPOINTMENT OF RESERVE TRUST**

PURSUANT to section 92(3)(c) of the Crown Lands Act 1989, the appointment of the reserve trust specified in Column 1 of the Schedule hereunder, as trustee of the reserve(s), or part(s) of the reserve(s), specified opposite thereto in Column 2 of the Schedule, is revoked.

KATRINA HODGKINSON, M.P.,  
Minister for Primary Industries

SCHEDULE

<i>Column 1</i>	<i>Column 2</i>
Young Shire Council Crown Reserves Reserve Trust.	Reserve No.: 9405. Public Purpose: Public health and recreation. Notified: 27 July 1889. File No.: GB87 R 33.

**APPOINTMENT OF RESERVE TRUST AS TRUSTEE OF A RESERVE**

PURSUANT to section 92(1) of the Crown Lands Act 1989, the reserve trust specified in Column 1 of the Schedule hereunder, is appointed as trustee of the reserve specified opposite thereto in Column 2 of the Schedule.

KATRINA HODGKINSON, M.P.,  
Minister for Primary Industries

SCHEDULE

<i>Column 1</i>	<i>Column 2</i>
Harden Shire Council Crown Reserves Reserve Trust.	Reserve No.: 9405. Public Purpose: Public health and recreation. Notified: 27 July 1889. File No.: GB87 R 33.

**ROADS ACT 1993**

**ORDER**

Transfer of Crown Road to a Council

IN pursuance of the provisions of section 151 of the Act, the Crown roads specified in Schedule 1 are transferred to the roads authority specified in Schedule 2 hereunder, as from the date of publication of this notice and as from that date the roads specified in Schedule 1 ceases to be Crown roads.

KATRINA HODGKINSON, M.P.,  
Minister for Primary Industries

SCHEDULE 1

*Town – Crookwell; Parishes – Kiamma and Crookwell;*  
*Counties – Georgiana and King;*  
*Land District – Crookwell; L.G.A. – Upper Lachlan Shire*

Description: Crown roads being North Street, Broderick Street, Park Street, part Woodward Lane, part McIntosh Road, part Prell Street and part McDonald Street, shown red in diagrams below.



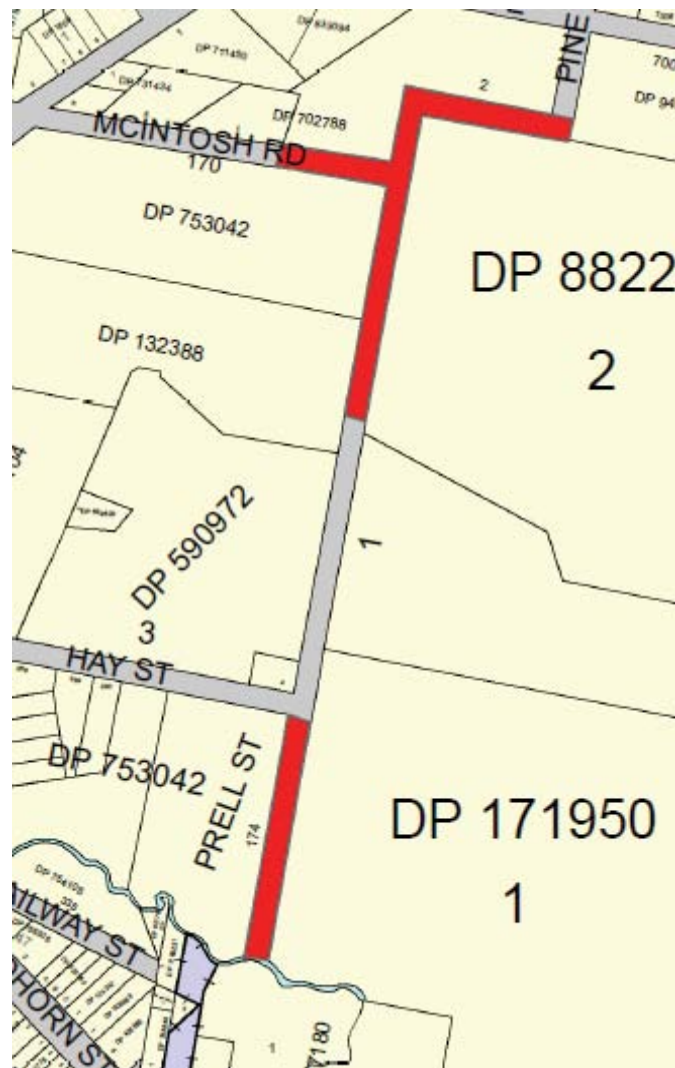

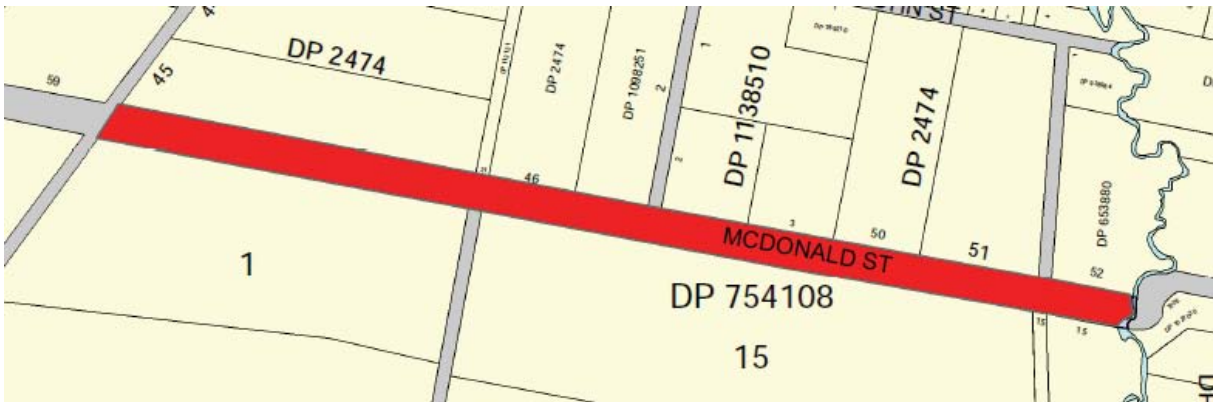

SCHEDULE 2

Roads Authority: Upper Lachlan Shire Council.

Reference: 11/13809.LB.

SCHEDULE 1

*Parishes – Wowagin and Guineacor;  
 Counties – Georgiana and Argyle;  
 Land District – Crookwell; L.G.A. – Upper Lachlan Shire*

Description: Crown roads being part Mount Rae Road and part Spicers Lane, shown red in diagrams below.

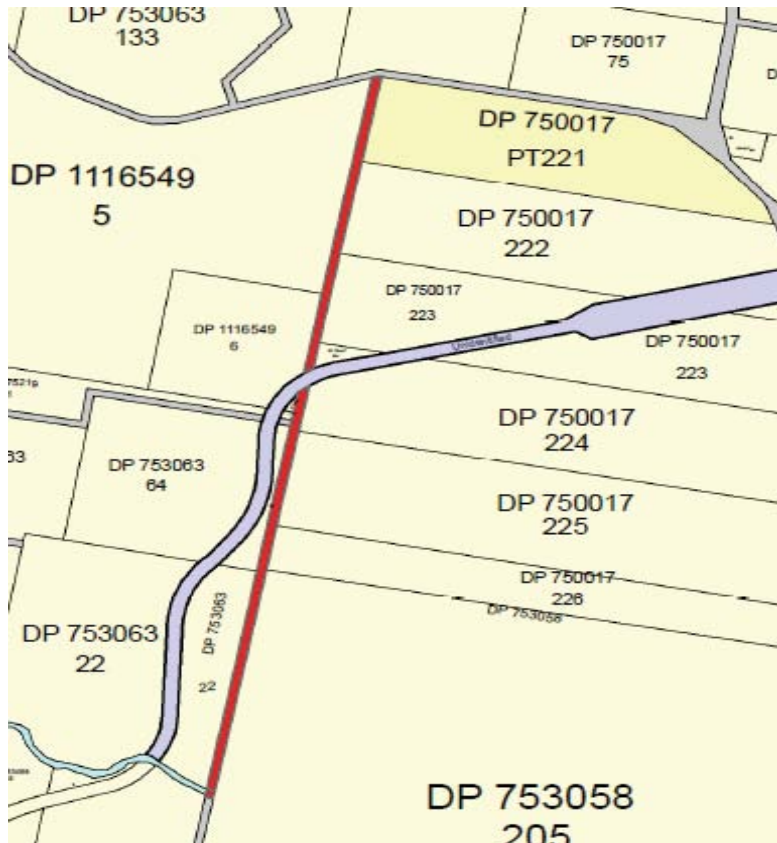





SCHEDULE 2

Roads Authority: Upper Lachlan Shire Council.

Reference: 11/13809.LB.

SCHEDULE 1

*Town – Collector; Parishes – Collector; County – Argyle;  
Land District – Gunning; L.G.A. – Upper Lachlan Shire*

Description: Crown roads being laneways through sections 10 and 13, DP 758263, shown red in diagram below.

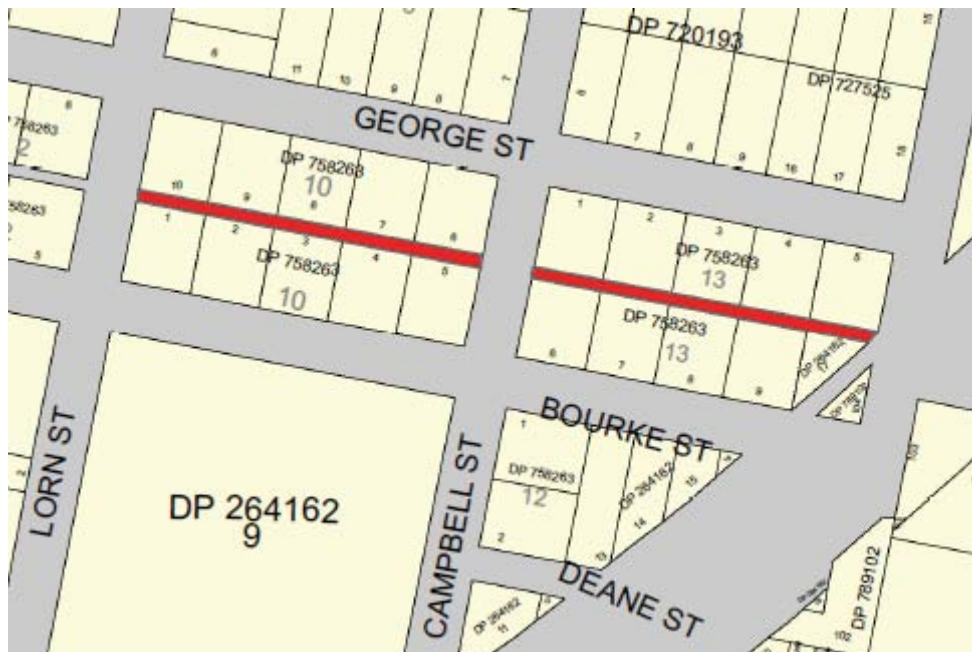

SCHEDULE 2

Roads Authority: Upper Lachlan Shire Council.

Reference: 11/13809.LB.

SCHEDULE 1

Towns – Harden and Murrumburrah;  
Parishes – Murrinboola and Cunnigar;  
County – Harden; Land District – Young;  
L.G.A. – Harden Shire Council

Description: Crown roads and laneways within Harden and Murrumburrah being Clarence Street, Clarke Lane, Clarke Street, Allsop Street, North Street, Short Street, Whitton Lane, Allman Street, Allan Street, Swift Lane, Binalong Lane and parts of Currawong Road, Vernon Street, Bathurst Street, Holman Road, Cemetery Road, Araluen Road, Scott Street, Swift Street, Station Street, Stair Street, Lucan Street, Derby Street, Woolrych Street, Iris Street, Queen Street, Aurville Road, Cattleyards Road, Gloaming Road, Boorowa Street, Jellambi Road, Lyons Street, West Street, Neill Street and East Street, shown red in diagrams below.

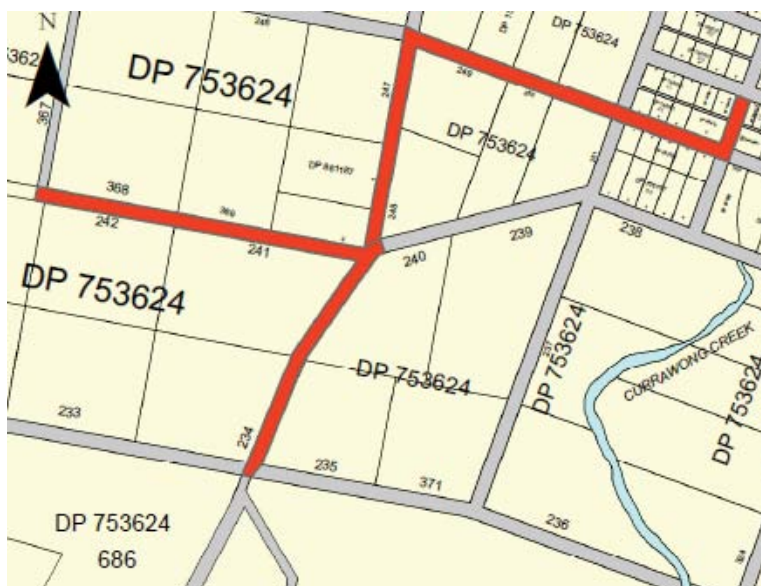

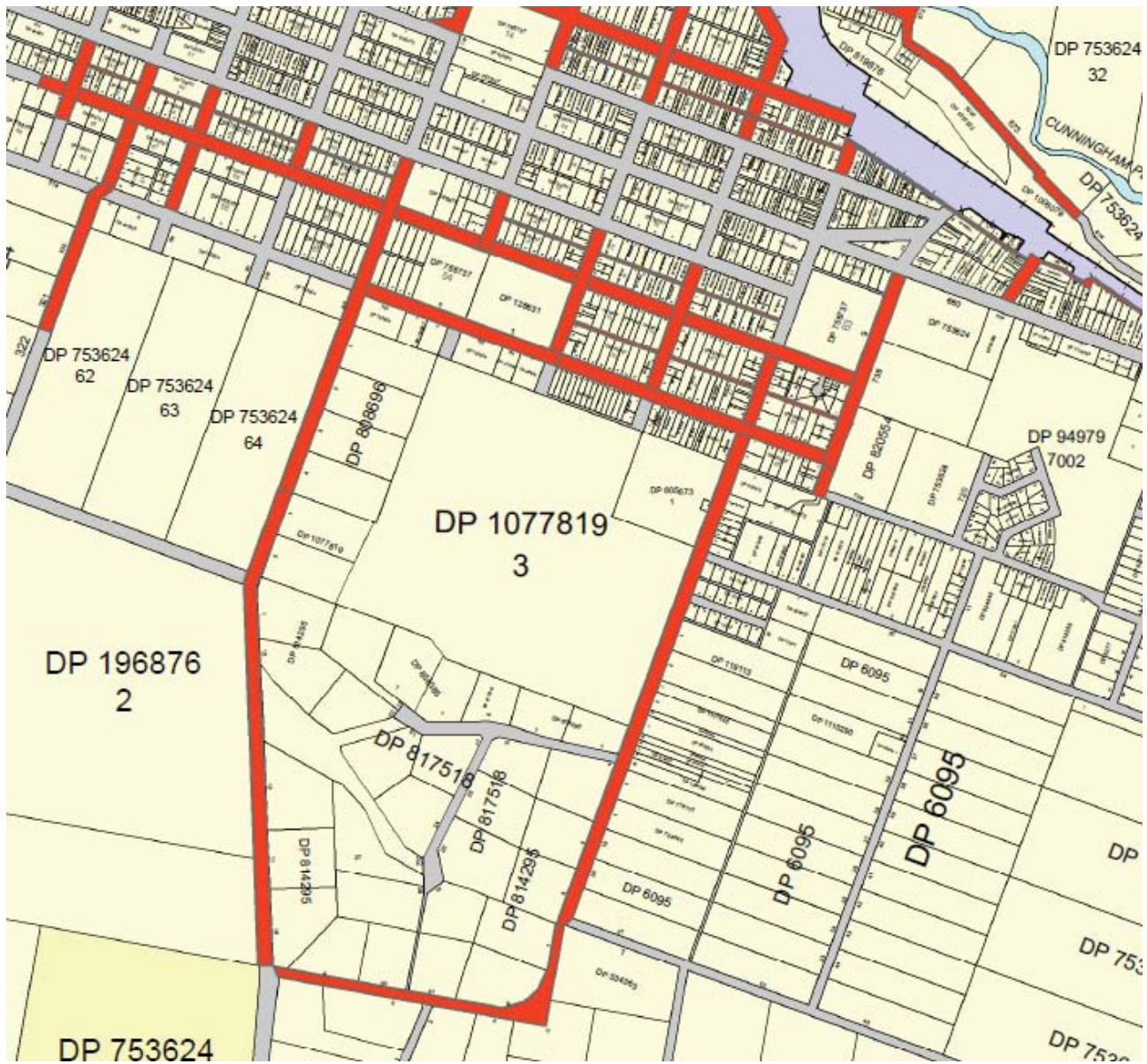

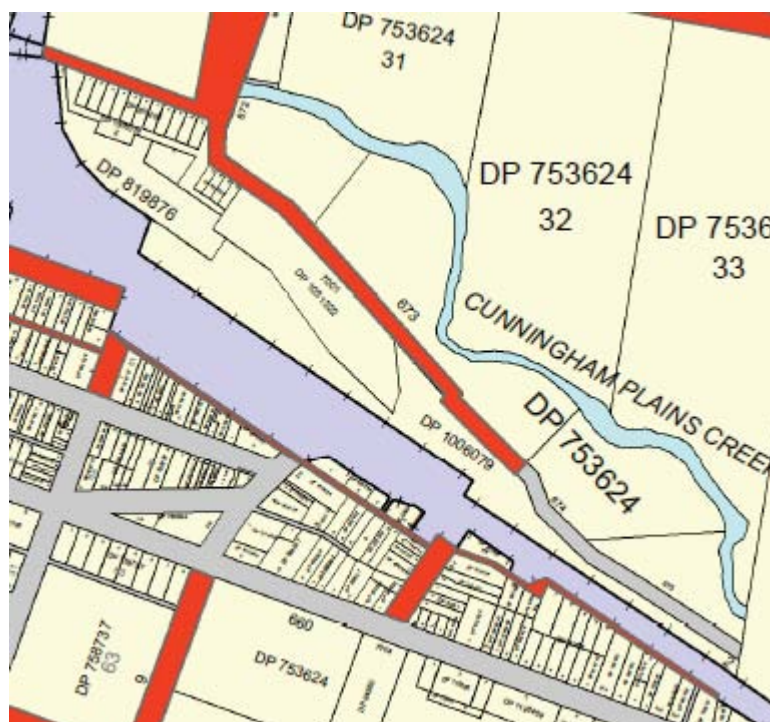
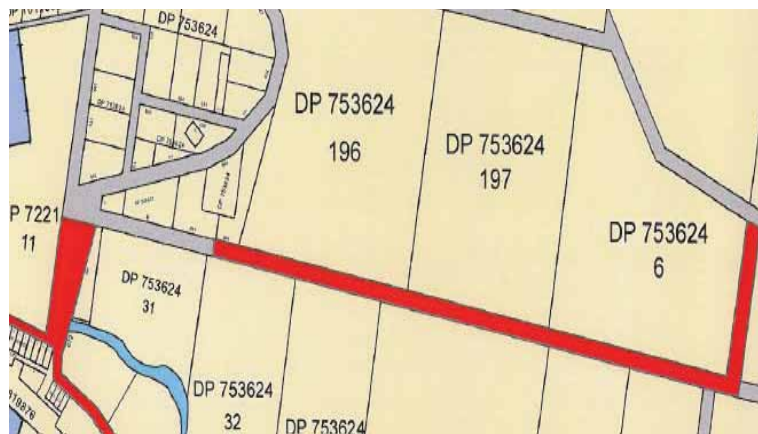
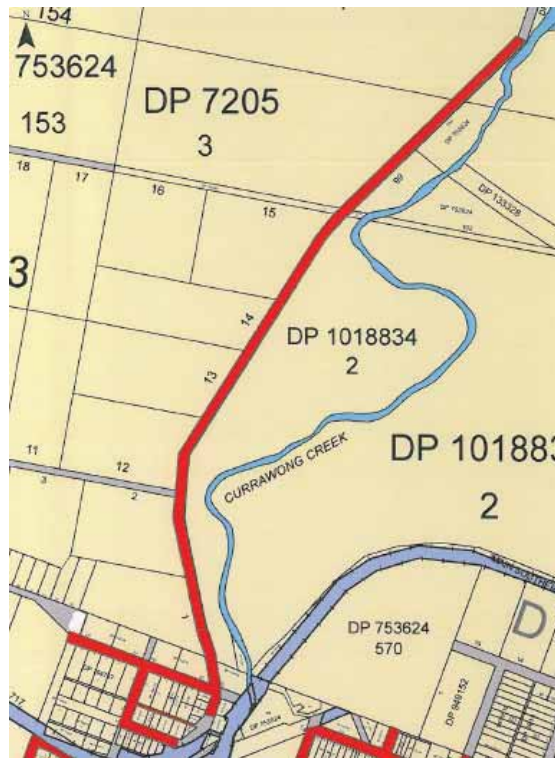

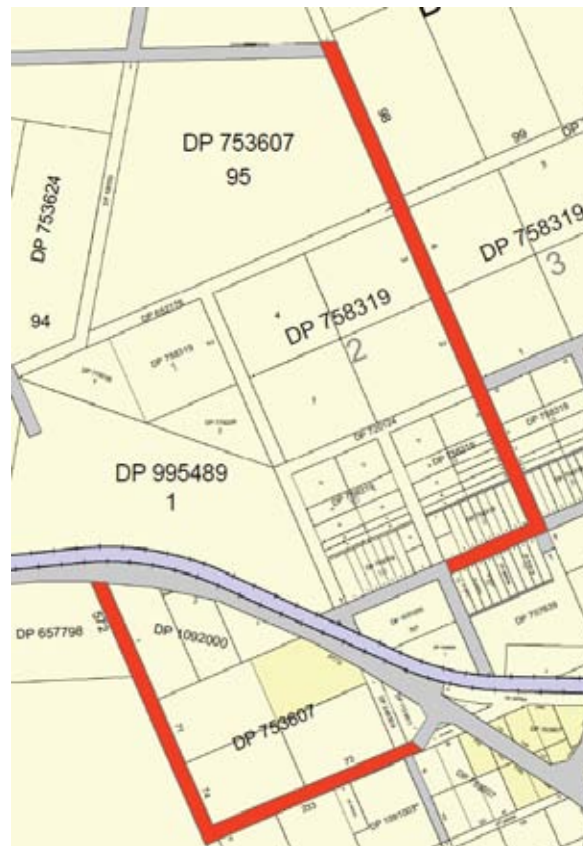

\_\_\_\_\_  
SCHEDULE 2

Roads Authority: Harden Shire Council.

Reference: 11/01107.LB.

**GRAFTON OFFICE**  
**76 Victoria Street (PO Box 272), Grafton NSW 2460**  
**Phone: (02) 6640 3400 Fax: (02) 6642 5375**

**NOTIFICATION OF CLOSING OF A ROAD**

IN pursuance of the provisions of the Roads Act 1993, the road hereunder described is closed and the lands comprised therein cease to be public road and the rights of passage and access that previously existed in relation to the road is extinguished. Upon closing, title to the land, comprising the former public road, vests in the body specified in the Schedule hereunder.

KATRINA HODGKINSON, M.P.,  
 Minister for Primary Industries

Description

*Parish – Toothill; County – Fitzroy;*  
*Land District – Grafton; L.G.A. – Clarence Valley*

Road Closed: Lot 1, DP 1170145.

File No.: 07/2162.

Schedule

On closing, the land within Lot 1, DP 1170145 remains vested in the State of New South Wales as Crown Land.

Description

*Parish – South Casino; County – Richmond;*  
*Land District – Casino; L.G.A. – Richmond Valley*

Road Closed: Lot 3, DP 1169598.

File No.: 07/2151.

Schedule

On closing, the land within Lot 3, DP 1169598 remains vested in the State of New South Wales as Crown Land.

Description

*Parish – Darke; County – Richmond;*  
*Land District – Casino; L.G.A. – Richmond Valley*

Road Closed: Lot 1, DP 1169601.

File No.: 07/1626.

Schedule

On closing, the land within Lot 1, DP 1169601 remains vested in the State of New South Wales as Crown Land.

Description

*Parish – Woodford; County – Clarence;*  
*Land District – Grafton; L.G.A. – Clarence Valley*

Road Closed: Lot 2, DP 1169621.

File No.: GF05 H 911.

Schedule

On closing, the land within Lot 2, DP 1169621 remains vested in the State of New South Wales as Crown Land.

Description

*Parish – Belmore; County – Raleigh;*  
*Land District – Bellingen; L.G.A. – Bellingen*

Road Closed: Lot 1, DP 1169522.

File No.: GF07 H 68.

Schedule

On closing, the land within Lot 1, DP 1169522 remains vested in the State of New South Wales as Crown Land.

Description

*Parish – Leigh; County – Fitzroy;*  
*Land District – Bellingen; L.G.A. – Bellingen*

Road Closed: Lot 1, DP 1169596.

File No.: 07/2863.

Schedule

On closing, the land within Lot 1, DP 1169596 remains vested in the State of New South Wales as Crown Land.

**MAITLAND OFFICE**  
**Corner Newcastle Road and Banks Street (PO Box 6), East Maitland NSW 2323**  
**Phone: (02) 4937 9300 Fax: (02) 4934 2252**

**NOTIFICATION OF CLOSING OF PUBLIC ROAD**

IN pursuance of the provisions of the Roads Act 1993, the road hereunder described is closed and the land comprised therein ceases to be a public road and the rights of passage and access that previously existed in relation to the road are extinguished. On road closing, title to the land comprising the former public road vests in the body specified in the Schedule hereunder.

KATRINA HODGKINSON, M.P.,  
 Minister for Primary Industries

DESCRIPTION

*Parish – Rothbury; County – Northumberland;  
 Land District – Cessnock; L.G.A. – Cessnock*

Road Closed: Lot 10, DP 1170236 (not being land under the Real Property Act).

File No.: 10/06063.

Schedule

On closing, the land within Lot 10, DP 1170236 becomes vested in the State of New South Wales as Crown Land.

**ROADS ACT 1993**

ORDER

Transfer of a Crown Road to a Council

IN pursuance of the provisions of section 151, Roads Act 1993, the Crown road specified in Schedule 1 is transferred to the Roads Authority specified in Schedule 2 hereunder, as from the date of publication of this notice and as from that date, the road specified in Schedule 1 ceases to be a Crown road.

KATRINA HODGKINSON, M.P.,  
 Minister for Primary Industries

SCHEDULE 1

*Parish – Tomaree; County – Gloucester;  
 Land District – Newcastle;  
 Local Government Area – Port Stephens*

THE section of Crown public road being part of Trotter Road (the section of Crown public road named Trotter Road from the prolongation of the western boundary of Lot 2 in DP 954600 to the intersection of Nelson Bay Road), at Bobs Farm as shown by solid red colour on the diagram hereunder.

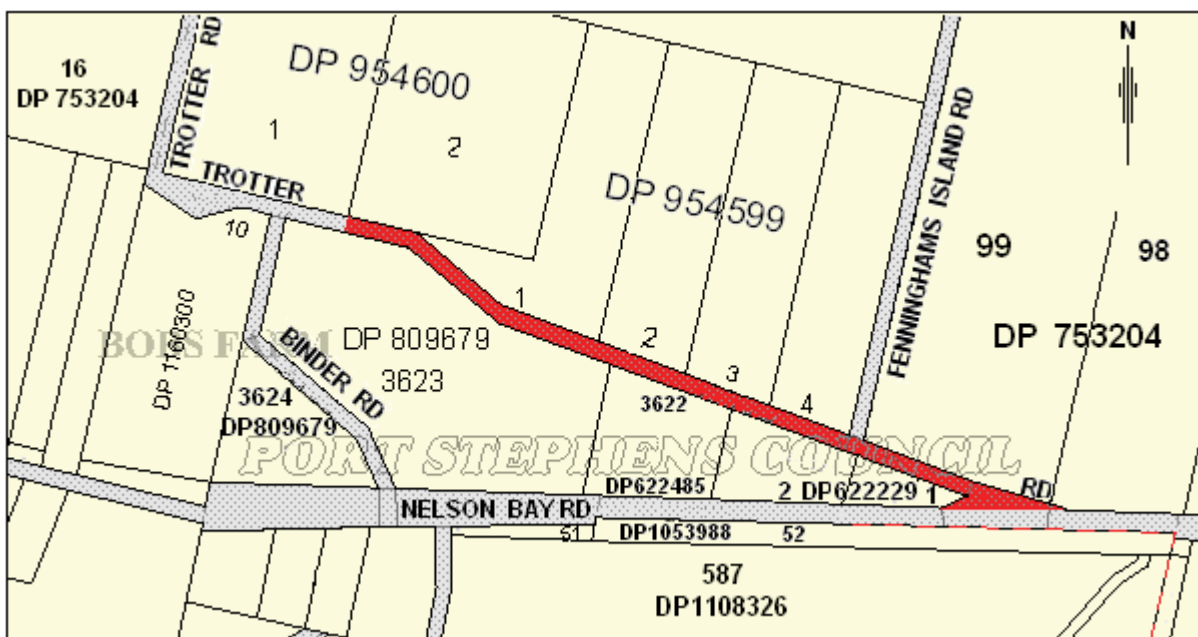

SCHEDULE 2

Roads Authority: Port Stephens Council.

Council's Reference: A 2004-0237.

Crown Lands File Reference: 12/00832.

ERRATUM

IN the notice which appeared in the *New South Wales Government Gazette* No. 122, of the 9 December 2011, Folio 7113, under the heading "Transfer of Crown Road to a Council" in relation to File No. 11/12936, the notification description should have read "Crown public road north of Lot 602, DP 728967 and Crown public road north of pathway on the western boundary of Lot 602, DP 728967 at Norville", as shown on diagram hereunder and not as notified.

KATRINA HODGKINSON, M.P.,  
Minister for Primary Industries

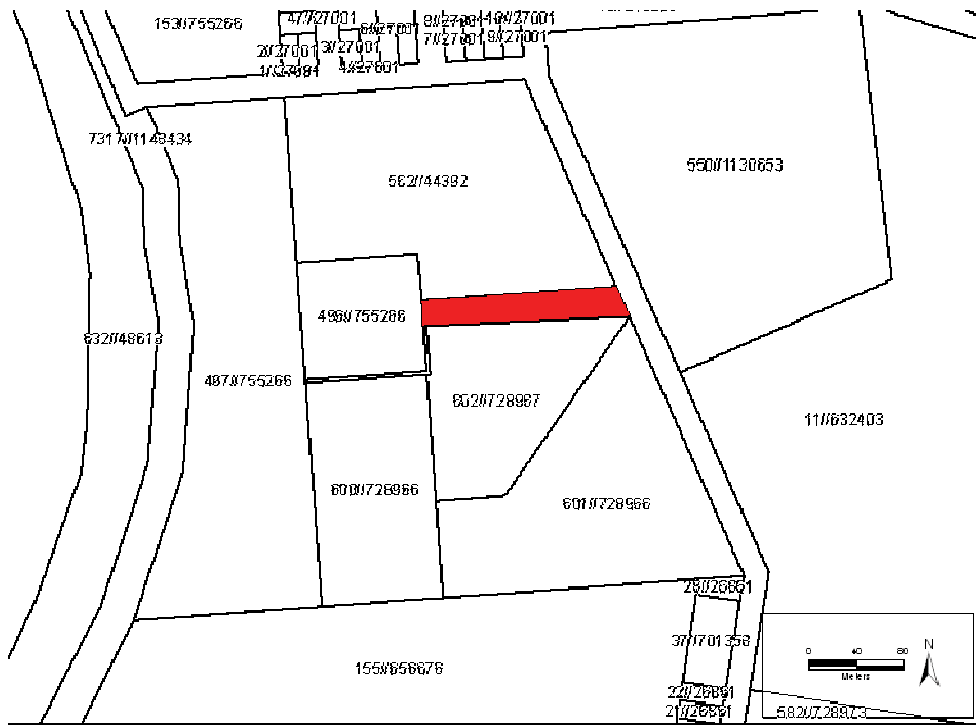



**MOREE OFFICE**  
**Frome Street (PO Box 388), Moree NSW 2400**  
**Phone: (02) 6752 5055 Fax: (02) 6752 1707**

**APPOINTMENT OF ADMINISTRATOR TO  
 MANAGE A RESERVE TRUST**

PURSUANT to section 117, Crown Lands Act 1989, the person specified in Column 1 of the Schedule hereunder, is appointed as administrator for the term also specified, of the reserve trust specified opposite thereto in Column 2, which is trustee of the reserve referred to in Column 3 of the Schedule.

KATRINA HODGKINSON, M.P.,  
 Minister for Primary Industries

SCHEDULE

<i>Column 1</i>	<i>Column 2</i>	<i>Column 3</i>
Terence John BONE.	Moree Showground Trust.	Reserve No.: 160035. Public Purpose: Showground. Notified: 6 April 1990. Dedication No.: 560029. Public Purpose: Showground. Notified: 14 January 1891. File No.: ME79 R 10.

Term of Office

For a term commencing 5 February 2012 and expiring  
 4 August 2012.

**NEWCASTLE OFFICE**  
**437 Hunter Street, Newcastle NSW 2300 (PO Box 2185, Dangar NSW 2309)**  
**Phone: (02) 4925 4104 Fax: (02) 4925 3517**

**NOTIFICATION OF CLOSING OF PUBLIC ROAD**

IN pursuance of the provisions of the Roads Act 1993, the road hereunder described is closed and the land comprised therein ceases to be a public road and the rights of passage and access that previously existed in relation to the road are extinguished. On road closing, title to the land comprising the former public road vests in the body specified in the Schedule hereunder.

KATRINA HODGKINSON, M.P.,  
Minister for Primary Industries

Description

*Parish – Tomaree; County: – Gloucester;*  
*Land District – Newcastle; L.G.A. – Port Stephens*

Road Closed: Lots 1 and 2, DP 1171865 subject to Easement to drain water and Easement for electricity and other purposes created in Deposited Plan 1171865 (not being land under the Real Property Act).

File No.: 08/0654.

Schedule

On closing, the land within Lots 1 and 2, DP 1171865 remains vested in the State of New South Wales as Crown Land.

**SYDNEY METROPOLITAN OFFICE**  
**Level 12, Macquarie Tower, 10 Valentine Avenue, Parramatta 2150**  
**(PO Box 3935, Parramatta NSW 2124)**  
**Phone: (02) 8836 5300      Fax: (02) 8836 5365**

**NOTIFICATION OF CLOSING OF ROAD**

IN pursuance of the provisions of the Roads Act 1993, the roads hereunder described are closed and the land comprised therein ceases to be public roads and the rights of passage and access that previously existed in relation to the roads are extinguished. Upon closing, title to the land comprising the former public road vests in the body specified in the Schedule hereunder.

KATRINA HODGKINSON, M.P.,  
Minister for Primary Industries

Description

*Parish – St James;*  
*County – Cumberland;*  
*Land District – Metropolitan;*  
*Local Government Area – Sydney*

Road Closed: Lot 1 DP 1169310 at Circular Quay East.

File No: MN02H265.

Schedule

On closing, the title for the land in Lot 1 DP 1169310 remains vested in The Council of the City of Sydney as operational land.

Description

*Parish – Rooty Hill;*  
*County – Cumberland;*  
*Land District – Penrith;*  
*Local Government Area. – Blacktown*

Road Closed: Lot 100, DP 1170520, At Oakhurst.

File No.: 09/03377.

Schedule

On closing, title for the land in lot 100, DP 1170520, remains vested in Blacktown City Council as operational.

The road is closed subject to the easement for underground cables 1 wide, the easement to drain water 2 wide, as shown in DP 1170520.

**TAMWORTH OFFICE**  
**25-27 Fitzroy Street (PO Box 535), Tamworth NSW 2340**  
**Phone: (02) 6764 5100 Fax: (02) 6766 3805**

**ESTABLISHMENT OF RESERVE TRUST**

PURSUANT to section 92(1) of the Crown Lands Act 1989, the reserve trust specified in Column 1 of the Schedule hereunder is established under the name stated in that Column and is appointed as trustee of the reserve specified opposite thereto in Column 2 of the Schedule.

KATRINA HODGKINSON,  
Minister for Primary Industries

SCHEDULE

<i>Column 1</i>	<i>Column 2</i>
Kings Plains Rural Fire Service Reserve Trust	Reserve No. 1034128 Public Purpose: rural services Notified: This Day File Reference: 12/00950

**APPOINTMENT OF ADMINISTRATOR TO MANAGE A RESERVE TRUST**

PURSUANT to Section 117, Crown Lands Act, 1989, the person specified in Column 1 of the Schedule hereunder is appointed as administrator for the term also specified in Column 1, of the reserve trust specified opposite thereto in Column 2, which is trustee of the reserve referred to in Column 3 of the Schedule.

KATRINA HODGKINSON,  
Minister for Primary Industries

SCHEDULE

<i>Column 1</i>	<i>Column 2</i>	<i>Column 3</i>
Kevin Patrick Reserve Trust	Kings Plains Rural Fire Service	Reserve No. 1034128 Public Purpose: rural services Notified: This Day File Reference: 12/00950

For a term commencing 17 February 2012 and expiring 17 August 2012.

**RESERVATION OF CROWN LAND**

PURSUANT to section 87 of the Crown Lands Act 1989, the Crown land specified in Column 1 of the schedule hereunder is reserved as specified opposite thereto in Column 2 of the Schedule.

Note: This reservation does not revoke Reserve 50240 for Travelling Stock or any current reserves within the subject area.  
Location of Reserve 1034128 shown by hatching on diagram hereunder

KATRINA HODGKINSON,  
Minister for Primary Industries

SCHEDULE

<i>Column 1</i>	<i>Column 2</i>
Land District: Inverell Local Government Area: Inverell Shire Council Locality: Kings Plains Lot PT 7305, D.P. No. 1150055 Parish Buckley, County Arrawatta Area: About 625m <sup>2</sup> File Reference: 12/00950	Reserve No. 1034128 Public Purpose: rural services

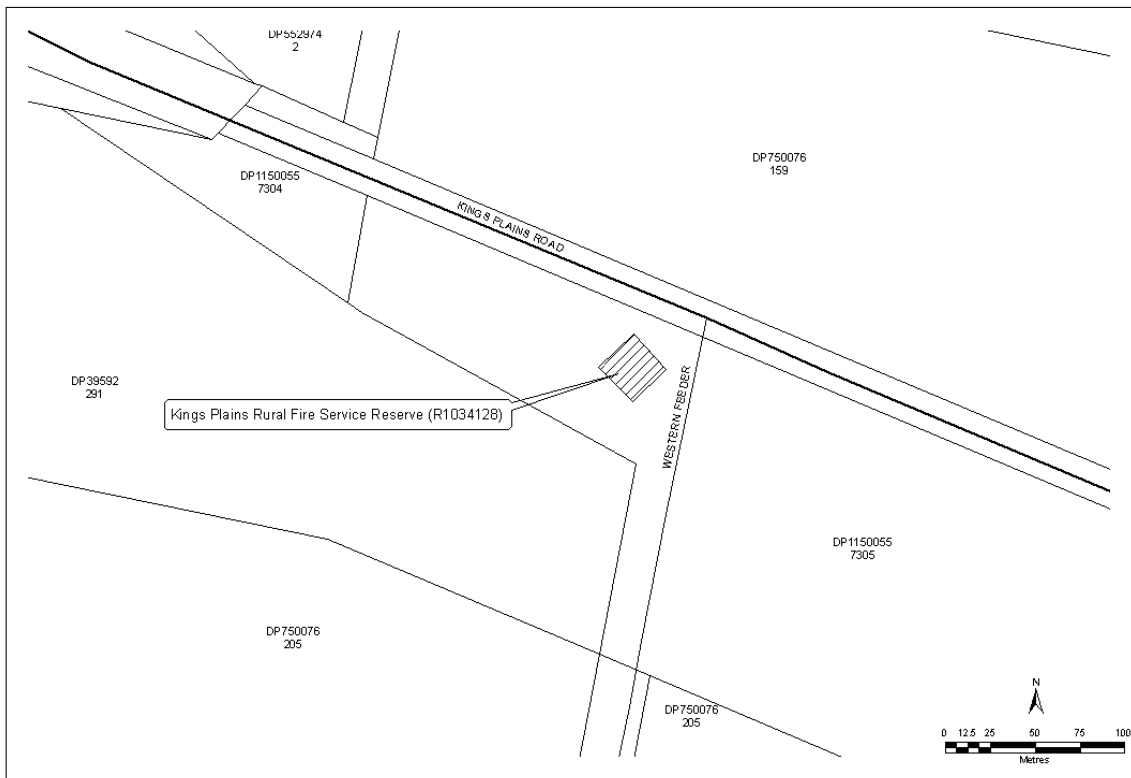

Note: This reservation does not revoke reserve 50240 for Travelling Stock or any other current reserves within the subject area. Location of Reserve 1034128 shown by hatching on diagram hereunder

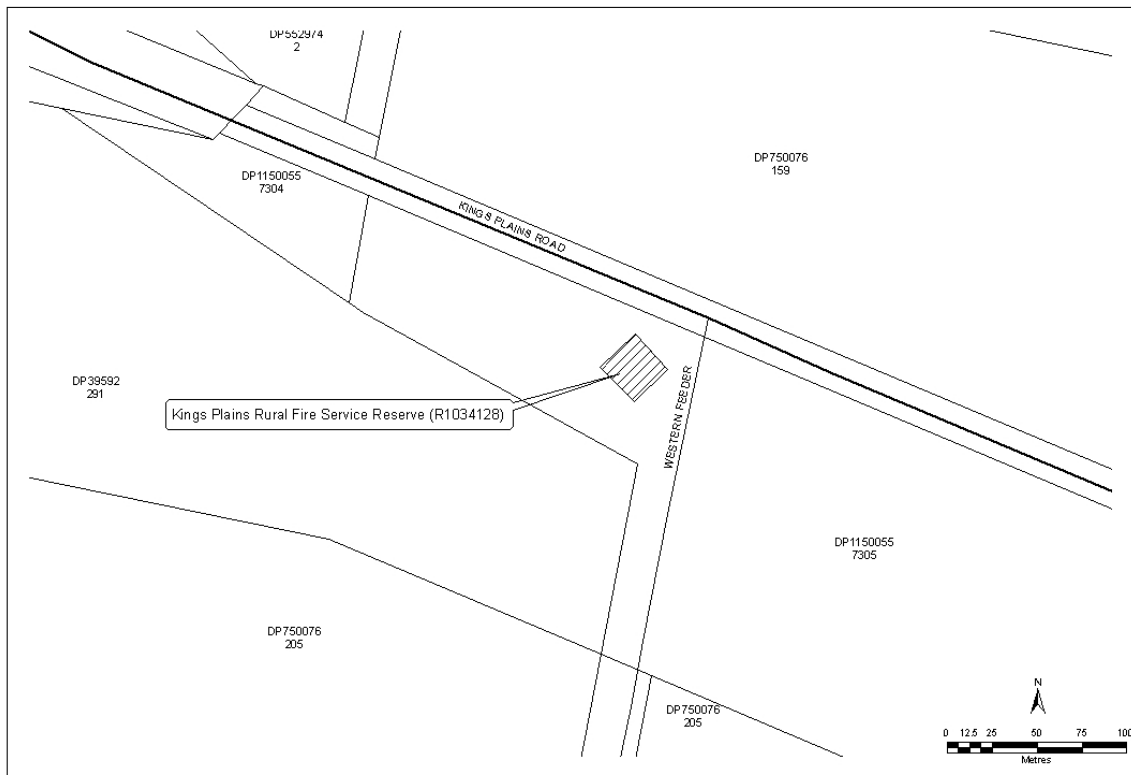

**Order Withdrawing Control of a Reserve from a Livestock Health and Pest Authority**

By this my Order pursuant to section 86(1) of the Rural Lands Protection Act 1998, I hereby withdrawn the care, control and management of part the travelling stock reserve specified in Schedule 1 hereunder from the Livestock Health & Pest Authority specified in Schedule 2 (File No. 12/ 00950)

KATRINA HODGKINSON,  
Minister for Primary Industries

SCHEDULE 1

Part of Reserve 50240 for travelling stock, being part of Lot 7305 DP 1150055 as shown by hatching on diagram below.

SCHEDULE 2

New England Livestock Health & Pest Authority.

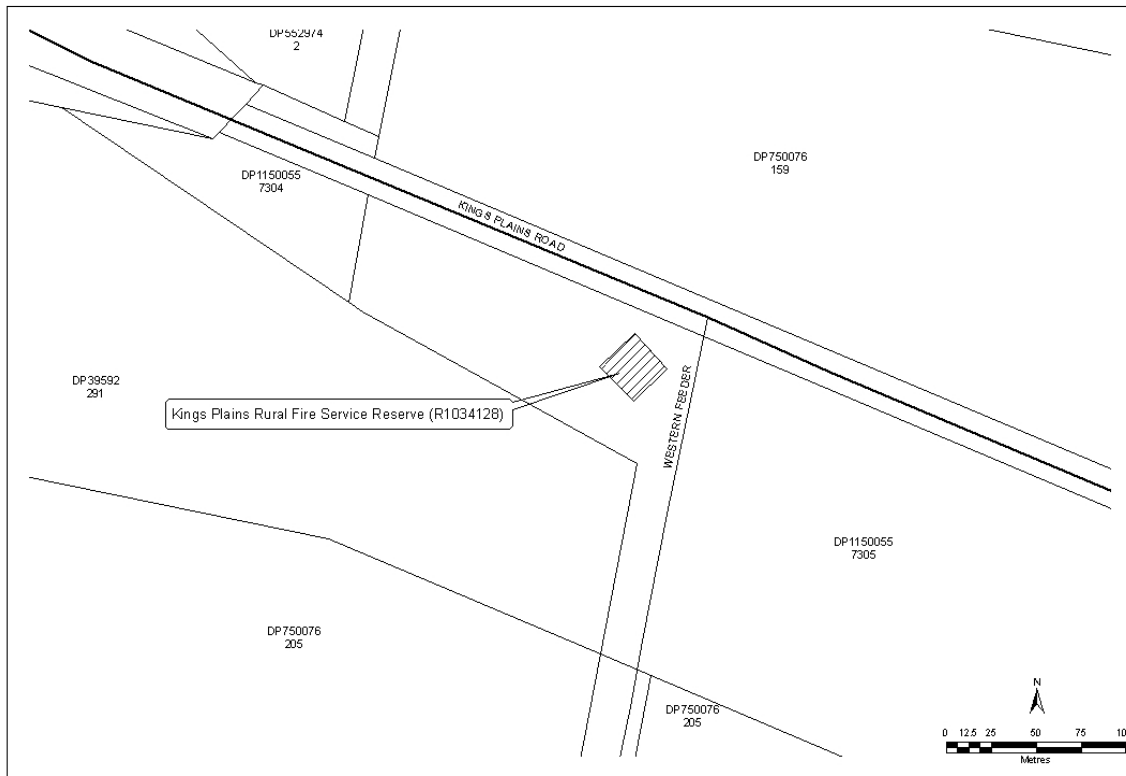

**TAREE OFFICE**  
**98 Victoria Street (PO Box 440), Taree NSW 2430**  
**Phone: (02) 6591 3500      Fax: (02) 6552 2816**

**NOTIFICATION OF CLOSING OF A ROAD**

IN pursuance of the provisions of the Roads Act 1993, the road hereunder described is closed and the lands comprised therein cease to be public road and the rights of passage and access that previously existed in relation to the road is extinguished. Upon closing, title to the land, comprising the former public road, vests in the body specified in the Schedule hereunder.

KATRINA HODGKINSON, M.P.,  
 Minister for Primary Industries

Description

*Parish – Kullatine; County – Dudley;*  
*Land District – Kempsey; L.G.A. – Kempsey*

Road Closed: Lot 1, DP 1169664 (subject to easement/  
 right of carriageway created by Deposited Plan 1169664).

File No.: TE06 H 126.

Schedule

On closing, the land within Lot 1, DP 1169664 remains  
 vested in the State of New South Wales as Crown Land.

Description

*Parish – Coorobongatti; County – Dudley;*  
*Land District – Kempsey; L.G.A. – Kempsey*

Road Closed: Lots 1-2, DP 1169616.

File No.: 07/4264.

Schedule

On closing, the land within Lots 1-2, DP 1169616 remains  
 vested in the State of New South Wales as Crown Land.

Description

*Parish – Cowangara; County – Macquarie;*  
*Land District – Port Macquarie;*  
*L.G.A. – Port Macquarie-Hastings*

Road Closed: Lot 1, DP 1169680.

File No.: 07/5507.

Schedule

On closing, the land within Lot 1, DP 1169680 remains  
 vested in the State of New South Wales as Crown Land.

**WESTERN REGION OFFICE**  
**45 Wingewarra Street (PO Box 1840), Dubbo NSW 2830**  
**Phone: (02) 6883 5400 Fax: (02) 6884 2067**

**GRANTING OF A WESTERN LANDS LEASE**

IT is hereby notified that under the provisions of section 28A of the Western Lands Act 1901, the Western Lands Leases of the lands specified in the following Schedule have been granted to the undermentioned persons.

The leases are subject to the provisions of the Western Lands Act 1901 and the Regulations thereunder.

The land is to be used only for the purpose of Residence.

Initial rent will be \$100.00 per annum and re-assessed thereafter annually on 1st April of each year.

The Conditions and Reservations annexed to such leases are those Conditions published in the *New South Wales Government Gazette* of 20 March 2009, Folios 1416-1418.

All amounts due and payable to the Crown *must* be paid to the Department of Primary Industries, Crown Lands by the due date.

KATRINA HODGKINSON, M.P.,  
Minister for Primary Industries

SCHEDULE

*Administrative District – Walgett North; Shire – Walgett; Parish – Wallangulla/Mebea; County – Finch*

WLL No.	Name of Lessee	File No.	Folio Identifier	Area (m <sup>2</sup> )	Term of Lease	
					From	To
WLL 16301	James LAKEY	09/00906	324/1076808	2530	3 February 2012	2 February 2032



**WATER****WATER ACT 1912**

AN application for a licence under section 10 of Part 2 of the Water Act 1912, being within a proclaimed (declared) local area under section 5(4) of the said Act, has been received as follows:

Trevor Gary LAVERTY for a pump, on Deep Creek, on Lot 50, DP 753025, Parish Cuddyong, County Georgiana, water supply for irrigation purposes (2hectares) (new licence – entitlement obtained by way of permanent transfer). (Reference: 70SL091151). (GA1826443).

Any inquiries should be directed to (02) 6850 2807.

Written objections, from any local occupier or statutory authority, specifying grounds and how their interests are affected, must be lodged with the NSW Office of Water, PO Box 291, Forbes NSW 2871, within 28 days of this publication.

LYN GORHAM,  
Licensing Manager

## Other Notices

### ASSOCIATIONS INCORPORATION ACT 2009

Cancellation of Incorporation Pursuant to Section 72

TAKE notice that the incorporation of the following associations is cancelled by this notice pursuant to section 72 of the Associations Incorporation Act 2009.

Cancellation is effective as at the date of gazettal.

Wollongong City Employment Training Inc – Y2045641

The Circles of Light Association Inc – Inc3419507

New Destiny Leadership College Incorporated – Inc9878933

Bay Adventure Kayakers Incorporated – Inc9889894

Shoalhaven Folk and Bushdancing Club Incorporated – Inc9882097

Shalom Healing Home Incorporated – Inc9879819

Western Plains Housing Scheme Incorporated – Y0165444

Rotary Club of Canowindra Incorporated – Y1188911

Macquarie Citrus Growers Incorporated – Inc9880460

Dated 10th day of February 2012.

ROBYNE LUNNEY,  
Manager, Case Management,  
Registry of Co-operatives and Associations,  
NSW Fair Trading,  
Department of Finance and Services

### ASSOCIATIONS INCORPORATION ACT 2009

Cancellation of incorporation pursuant to section 72

TAKE NOTICE that the incorporation of the following associations is cancelled by this notice pursuant to section 72 of the Associations Incorporation Act, 2009.

Cancellation is effective as at the date of gazettal.

German Pinscher Club of Nsw Incorporated – Inc9882538

Macarthur Diversity Services Incorporated – Y1744027

Bellingen Shire Meals on Wheels Incorporated – Y1127448

Inswim Swimming Club Incorporated – Y2887040

Kyogle Community Technology Incorporated – Inc9886103

The Peel Landcare-Rivercare Group Incorporated – Y2240107

Hagia Gaia Incorporated – Y2635615

Glastonbell Inc. – Y1347724

Chelsea United Junior Rugby League Football

Club Incorporated – Inc9884963

Lindfield Junior Rugby Foundation Incorporated – Inc9877370

Purple Tie Incorporated – Inc9889243

Dated 15th day of February 2012.

ROBYNE LUNNEY,  
Manager, Case Management  
Registry of Co-operatives & Associations  
NSW Fair Trading  
Department of Finance & Services

### ASSOCIATIONS INCORPORATION ACT 2009

Cancellation of Incorporation pursuant to Section 76

TAKE notice that the incorporation of the following associations are cancelled by this notice pursuant to section 76 of the Associations Incorporation Act 2009.

Adamstown Rosebud Junior Cricket Club Incorporated – Y2606036

Association of Healthcarers Information & Training Incorporated – Inc9888538

Australian Academy Karate Taekwondo Association Incorporated – Inc9888425

Berkeley Vale Out of School Hours Activity Centre Incorporated – Y1280342

Burren Flower Show Guild Incorporated – Y2081000

Criminal Defence Lawyers' Association Incorporated – Inc9876971

Crookwell Pre-School Kindergarten Inc – Y0254348

Eden Valley Landcare Group Incorporated – Inc9877435

Epping Rainbow Club Incorporated – Y3038042

Iranian Democratic Unity Incorporated – Inc9886435

Marom Creek Landcare Incorporated – Inc9879854

Muru Nanga Mai Management Inc – Inc9887290

Noggabri Landcare Group Incorporated – Y2866737

Northern Suburbs Netball Club (Illawarra) Incorporated – Y1952901

NSW Avocado Growers Association Inc – Y0365434

NSW Past & Present Boxers Association Incorporated – Inc9886696

NSW Search and Rescue Dogs Incorporated – Y2961404

Old Bar Tavern Fishing and Recreation Club Incorporated – Y2620046

Palace Hotel Social Club Inc – Y1520204

Peakhurst Youth Club Incorporated – Y1863213

Poetry Australia Foundation Incorporated – Inc9876098

Pretty Pine Pony Club Inc – Y1593020

Problo Performance Incorporated – Inc9886854

Rattling Tongues Theatre Incorporated – Y2213943

Restorative Association for Ethical Practitioners & Advocates in a Retributive Justice System Incorporated – Inc9892664

Rotary Club of Silverwater Homebush Bay Incorporated – Y1464622

Shree Satchidanand Satsangh Ramayan Bhajan Kirtan Faag Mandali Incorporated – Inc9876343

Singleton Softball Association Inc – Y0436732

Sporting Peru Social and Cultural Club Incorporated – Inc9875614

Stokers Siding - Dunbible Memorial Hall Incorporated – Y1976342

Talbingo Service Station Rescue Assoc Inc – Inc9879540

The Borenore Community Sports and Social Club Incorporated – Y2888331

The Islamic Mehdavia Community of Australia Incorporated – Inc9889953

The Rehabilitation Research Foundation Inc – Y0029306  
 The Shiloh Project Incorporated – Inc9890439  
 West Dubbo Aboriginal Womens Consultative Group  
 Incorporated – Inc9884498  
 Cancellation is effective as at the date of gazettal.

Dated this 14th day of February 2012.

ROBYNE LUNNEY,  
 Delegate of the Commissioner,  
 NSW Fair Trading,  
 Department of Finance & Services

---

#### ASSOCIATIONS INCORPORATION ACT 2009

Reinstatement of cancelled association pursuant to  
 section 84

TAKE NOTICE that the incorporation of AUSTRALIAN  
 TIBETAN BUDDHIST CENTRE INCORPORATED -  
 INC9876628 –cancelled on 18 September 2009 is reinstated  
 pursuant to section 84 of the Associations Incorporation Act  
 2009.

Dated this 15th day of February 2012.

ROBYNE LUNNEY,  
 Manager, Case Management  
 Registry of Co-operatives & Associations  
 NSW Fair Trading  
 Department of Finance & Services

---

#### ASSOCIATIONS INCORPORATION ACT 2009

Reinstatement of cancelled association pursuant to  
 section 84

TAKE NOTICE that the incorporation of BRUNSWICK  
 HEADS JUNIOR SOCCER CLUB INC - Y1065345  
 –cancelled on 3 October 2008 is reinstated pursuant to section  
 84 of the Associations Incorporation Act 2009.

Dated this 15th day of February 2012.

ROBYNE LUNNEY,  
 Manager, Case Management  
 Registry of Co-operatives & Associations  
 NSW Fair Trading  
 Department of Finance & Services

---

#### CHILDREN (PROTECTION AND PARENTAL RESPONSIBILITY) ACT 1997

##### Order

I, the Honourable Greg Smith, Attorney General of the State  
 of New South Wales, in pursuance of section 14 (2) of the  
 Children (Protection and Parental Responsibility) Act 1997,  
 do, by this my Order, declare the following area to be an  
 operational area for the purposes of Division 2 of Part 3 of  
 that Act:

The Local Government Area of Orange.

This Order takes effect on 1 February 2012 and the  
 declaration of the operational area remains in force until 30  
 June 2015.

Signed at Sydney, this 1st day of February 2012.

GREG SMITH,  
 Attorney General

#### DISTRICT COURT OF NEW SOUTH WALES

##### Direction

PURSUANT to section 173 of the District Court Act  
 1973, I direct that the District Court shall sit in its criminal  
 jurisdiction at the place and time shown as follows:

Albury		10.00am 4 June 2012 (3 weeks)
Tamworth	10.00am	30 April 2012 (2 weeks) Sittings Cancelled
Tamworth	10.00am	4 June 2012 (3 weeks) Sittings Cancelled

Dated this 15th day of February 2012.

R. O. BLANCH,  
 Chief Judge

---

#### GEOGRAPHICAL NAMES ACT 1966

##### Erratum

IN the notice referring to the determination of suburb names  
 and boundaries in the Pittwater Local Government Area,  
 Folio 74, 20 January 2012, the name Ku-Ring-Gai Chase  
 was spelt incorrectly. The correct spelling for this suburb is  
 Ku-ring-gai Chase. This notice corrects that error.

K. RICHARDS,  
 A/Secretary

Geographical Names Board,  
 PO Box 143, Bathurst NSW 2795.

---

#### GEOGRAPHICAL NAMES ACT 1966

##### Notice of discontinuance of a Geographical Name

PURSUANT to the provisions of Section 14 of the  
 Geographical Names Act, 1966, the Geographical Names  
 Board hereby notifies that it has this day discontinued the  
 name 'Bega West Public School' which was assigned with  
 the designation of 'School', Folio 1094, on the 02 June, 1989.

KEVIN RICHARDS,  
 Acting Secretary

Geographical Names Board  
 PO Box 143, Bathurst NSW 2795

---

#### GEOGRAPHICAL NAMES ACT 1966

##### Notice of discontinuance of a Geographical Name

PURSUANT to the provisions of Section 14 of the Geo-  
 graphical Names Act, 1966, the Geographical Names Board  
 hereby notifies that it has this day discontinued the name  
 'Bega Public School' which was assigned with the designa-  
 tion of 'School', Folio 8589, on the 30 November 1973.

KEVIN RICHARDS,  
 Acting Secretary

Geographical Names Board  
 PO Box 143, Bathurst NSW 2795

**HERITAGE ACT 1977**

Direction pursuant to Section 34(1)(a)  
to List an Item on the State Heritage Register

Bomaderry Aboriginal Children's Home  
59 Beinda Street, Bomaderry

SHR No. 1874

IN pursuance of section 34(1)(a) of the Heritage Act 1977, I, the Minister for Heritage, having considered a recommendation of the Heritage Council of New South Wales, direct the Council to list the item of environmental heritage specified in Schedule "A" on the State Heritage Register. This listing shall apply to the curtilage or site of the item, being the land described in Schedule "B". The listing is subject to the standard exemptions from approval under Section 57(2) of the Heritage Act 1977.

Dated: Sydney, 21st day of December 2011.

The Hon. ROBYN PARKER, M.P.,  
Minister for Heritage

**SCHEDULE "A"**

The item known as Bomaderry Aboriginal Children's Home, situated on the land described in Schedule "B".

**SCHEDULE "B"**

All those pieces or parcels of land known as Lot 4, section 29, DP 2886; Lot 5, section 29, DP 2886 and Lot 6, section 29, DP 2886, in Parish of Bunberra, County of Camden, shown on the plan catalogued HC 2502 in the office of the Heritage Council of New South Wales.

**HERITAGE ACT 1977**

Direction pursuant to Section 34(1)(a)  
to List an Item on the State Heritage Register

Cootamundra Aboriginal Girls' Training Home  
39 Rinkin Street, Cootamundra

SHR No. 1873

IN pursuance of section 34(1)(a) of the Heritage Act 1977, I, the Minister for Heritage, having considered a recommendation of the Heritage Council of New South Wales, direct the Council to list the item of environmental heritage specified in Schedule "A" on the State Heritage Register. This listing shall apply to the curtilage or site of the item, being the land described in Schedule "B". The listing is subject to the standard exemptions from approval under section 57(2) of the Heritage Act 1977.

Dated: Sydney, 19th day of December 2011.

The Hon. ROBYN PARKER, M.P.,  
Minister for Heritage

**SCHEDULE "A"**

The item known as Cootamundra Aboriginal Girls' Training Home, situated on the land described in Schedule "B".

**SCHEDULE "B"**

All those pieces or parcels of land known as Lot 230, DP 753601; Lot 351, DP 753601; Lot 502, DP 753601 and Lot 544, DP 753601, in Parish of Cootamundra, County of Harden, shown on the plan catalogued HC 2501 in the office of the Heritage Council of New South Wales.

**HERITAGE ACT 1977**

Direction pursuant to Section 34(1)(a)  
to List an Item on the State Heritage Register

Kinchela Aboriginal Boys' Training Home  
2054 South West Rocks Road, Kinchela

SHR No. 1875

IN pursuance of section 34(1)(a) of the Heritage Act 1977, I, the Minister for Heritage, having considered a recommendation of the Heritage Council of New South Wales, direct the Council to list the item of environmental heritage specified in Schedule "A" on the State Heritage Register. This listing shall apply to the curtilage or site of the item, being the land described in Schedule "B". The listing is subject to the standard exemptions from approval under section 57(2) of the Heritage Act 1977.

Dated: Sydney, 19th day of December 2011.

The Hon. ROBYN PARKER, M.P.,  
Minister for Heritage

**SCHEDULE "A"**

The item known as Kinchela Aboriginal Boys' Training Home, situated on the land described in Schedule "B".

**SCHEDULE "B"**

All those pieces or parcels of land known as Lot 362, DP 754396; Lot 363, DP 754396 and part of unmade road Herborn Street, in Parish of Arakoon, County of Macquarie, shown on the plan catalogued HC 2503 in the office of the Heritage Council of New South Wales.

**HERITAGE ACT 1977****Erratum**

THE notice published in the *New South Wales Government Gazette* No. 18 of 10 February 2012, relating to Colebee-Nurragingy Land Grant should have read:

SHR No. 1877.

**NOTICE OF CLOSURE OF RAILWAY PEDESTRIAN LEVEL CROSSINGS**

TRANSPORT CONSTRUCTION AUTHORITY, on behalf of Rail Corporation New South Wales as the rail infrastructure owner of the following railway level crossings:

1. QUAKERS HILL PEDESTRIAN LEVEL CROSSING.  
Location: Railway Road, Quakers Hill, NSW (North of Quakers Hill Station); and
2. SCHOFIELDS PEDESTRIAN LEVEL CROSSING.  
Location: Railway Terrace, Schofields, NSW (North of Old Schofields Station),

confirms the closure of the above level crossings in July 2011, as described in the Quakers Hill to Vineyard Duplication - Environmental Assessment dated April 2009, which was placed on public exhibition between 29 April 2009 and 1 June 2009.

All rights, easements and privileges in relation to the Quakers Hill and Schofields pedestrian level crossings are now extinguished.

Two accessible public pedestrian footbridges have been installed in lieu of the closed Quakers Hill and Schofields pedestrian level crossings.

Dated this 7th day February 2012.

CHRISTOPHER DECCAN LOCK,  
Chief Executive

---

### LORD HOWE ISLAND REGULATION 2004

2012 Lord Howe Island Board Election

PURSUANT to Clause 52 (b) of the Lord Howe Island Regulation 2004, I, Mario Saliba declare the following persons duly elected to the Lord Howe Island Board, following the declaration of the poll on Friday, 10 February 2012:

RIDDLE, Judy  
CROMBIE, Gary  
MAKIITI, Lisa  
NICHOLS, Barney

MARIO SALIBA,  
Returning Officer,  
NSW Electoral Commission

---

Office of the Minister for Police  
Sydney NSW  
10 February 2012

### MURDER

ONE HUNDRED THOUSAND DOLLARS (\$100,000)  
REWARD

ON the 6th October 2009, the body of Mr. Pardeep KUMAR, aged 33 years, was located at Old Euston Road, Monak. Mr. KUMAR died as a result of a severe laceration to his throat which severed the carotid artery.

Notice is hereby given that a reward of up to one hundred thousand dollars (\$100,000) will be paid by the Government of New South Wales for information leading to the arrest and conviction of the person or persons responsible for the death of Pardeep KUMAR.

The allocation of this reward will be at the sole discretion of the Commissioner of Police.

The urgent assistance and co-operation of the public is especially sought in the matter. Any information, which will be treated as confidential, may be given at any time of the day or night at any Police Station or by telephone –

Police Headquarters telephone (02) 9281 0000  
or Crime Stoppers on 1800 333 000

The Hon. MICHAEL GALLACHER, M.L.C.,  
Minister for Police and Emergency Services  
Minister for the Hunter

Office of the Minister for Police  
Sydney NSW  
10 February 2012

### MURDER

ONE HUNDRED THOUSAND DOLLARS (\$100,000)  
REWARD

ON the 12th July 1974, Elaine Beverley KING, aged 45 years, was found deceased in a hotel room of the Burlington Hotel, Hay Street, Sydney. A Coronial inquiry found that the deceased died as a result of manual and ligature strangulation by a person or persons unknown.

Notice is hereby given that a reward of up to one hundred thousand dollars (\$100,000) will be paid by the Government of New South Wales for information leading to the arrest and conviction of the person or persons responsible for the death of Elaine Beverley KING.

The allocation of this reward will be at the sole discretion of the Commissioner of Police.

The urgent assistance and co-operation of the public is especially sought in the matter. Any information, which will be treated as confidential, may be given at any time of the day or night any Police Station or by telephone –

Police Headquarters telephone (02) 9281 0000  
or Crime Stoppers on 1800 333 000

The Hon. MICHAEL GALLACHER, M.L.C.,  
Minister for Police and Emergency Services  
Minister for the Hunter

---

### RURAL FIRES ACT 1997

Local Bush Fire Danger Period Variation

PURSUANT to section 82 of the Rural Fires Act 1997, as amended, the Commissioner of the NSW Rural Fire Service, following consultation with the local stakeholders, declares the following Local Bush Fire Danger Period Variation:

Area of Variation:

Clarence Valley FCC Incorporating:  
Clarence Valley Council

The Local Bush Fire Danger period has been revoked for the period 20 February until 31 March 2012.

During this period permits pursuant to section 87 of the Rural Fires Act 1997, as amended, will not be required for the lighting of fire for the purposes of land clearance or fire breaks.

ROB ROGERS, AFSM,  
Deputy Commissioner,  
Director Operational Services  
(Delegate)

---

### RURAL FIRES ACT 1997

Local Bush Fire Danger Period Variation

PURSUANT to section 82 of the Rural Fires Act 1997, as amended, the Commissioner of the NSW Rural Fire Service, following consultation with the local stakeholders, declares the following Local Bush Fire Danger Period Variation:

Area of Variation:

Far North Coast Team Incorporating:

Ballina Shire Council  
Byron Shire Council  
Tweed Shire Council

The Local Bush Fire Danger period has been revoked for the period 20 February until 31 March 2012.

During this period permits pursuant to section 87 of the Rural Fires Act 1997, as amended, will not be required for the lighting of fire for the purposes of land clearance or fire breaks.

ROB ROGERS, AFSM,  
Deputy Commissioner,  
Director Operational Services  
(Delegate)

### RURAL FIRES ACT 1997

#### Local Bush Fire Danger Period Variation

PURSUANT to section 82 of the Rural Fires Act 1997, as amended, the Commissioner of the NSW Rural Fire Service, following consultation with the local stakeholders, declares the following Local Bush Fire Danger Period Variation:

Area of Variation:

Northern Rivers Team Incorporating:

Kyogle Council  
Lismore City Council  
Richmond Valley Council

The Local Bush Fire Danger period has been revoked for the period 20 February until 31 March 2012.

During this period permits pursuant to section 87 of the Rural Fires Act 1997, as amended, will not be required for the lighting of fire for the purposes of land clearance or fire breaks.

ROB ROGERS, AFSM,  
Deputy Commissioner,  
Director Operational Services  
(Delegate)

### RURAL FIRES ACT 1997

#### Local Bush Fire Danger Period Variation

PURSUANT to section 82 of the Rural Fires Act 1997, as amended, the Commissioner of the NSW Rural Fire Service, following consultation with the local stakeholders, declares the following Local Bush Fire Danger Period Variation:

Area of Variation:

Mid North Coast Team Incorporating:

Bellingen Shire Council  
Coffs Harbour City Council

The Local Bush Fire Danger period has been revoked for the period 20 February until 31 March 2012.

During this period permits pursuant to section 87 of the Rural Fires Act 1997, as amended, will not be required for the lighting of fire for the purposes of land clearance or fire breaks.

ROB ROGERS, AFSM,  
Deputy Commissioner,  
Director Operational Services  
(Delegate)

### RURAL FIRES ACT 1997

#### Local Bush Fire Danger Period Variation

PURSUANT to section 82 of the Rural Fires Act 1997, as amended, the Commissioner of the NSW Rural Fire Service, following consultation with the local stakeholders, declares the following Local Bush Fire Danger Period Variation:

Area of Variation:

Northern Tablelands Team Incorporating:

Glen Innes Severn Council  
Inverell Shire Council  
Tenterfield Shire Council

The Local Bush Fire Danger period has been revoked for the period 20 February until 31 March 2012.

During this period permits pursuant to section 87 of the Rural Fires Act 1997, as amended, will not be required for the lighting of fire for the purposes of land clearance or fire breaks.

ROB ROGERS, AFSM,  
Deputy Commissioner,  
Director Operational Services  
(Delegate)

### RURAL FIRES ACT 1997

#### Local Bush Fire Danger Period Variation

PURSUANT to section 82 of the Rural Fires Act 1997, as amended, the Commissioner of the NSW Rural Fire Service, following consultation with the local stakeholders, declares the following Local Bush Fire Danger Period Variation:

Area of Variation:

Lower North Coast Team Incorporating:

Kempsey Shire Council  
Nambucca Shire Council

The Local Bush Fire Danger period has been revoked for the period 20 February until 31 March 2012.

During this period permits pursuant to section 87 of the Rural Fires Act 1997, as amended, will not be required for the lighting of fire for the purposes of land clearance or fire breaks.

ROB ROGERS, AFSM,  
Deputy Commissioner,  
Director Operational Services  
(Delegate)

### SPORTING INJURIES INSURANCE ACT 1978

#### Order of Declaration under Section 5

IN pursuance of section 5 of the Sporting Injuries Insurance Act 1978, I declare by this order the AM BODYWORKS / BALMAIN PCYC BOXING GYM to be a sporting organisation, for the purposes of the provisions of the Act, in respect of the activity of Boxing (Amateur).

Dated: 7 February 2012.

GENIERE APLIN,  
Acting Chair,  
Sporting Injuries Committee

**SPORTING INJURIES INSURANCE ACT 1978**

## Order of Declaration under Section 5

IN pursuance of section 5 of the Sporting Injuries Insurance Act 1978, I declare by this order the OATLEY RSL FISHING CLUB to be a sporting organisation, for the purposes of the provisions of the Act, in respect of the activity of Fishing.

Dated: 3 February 2012.

GENIERE APLIN,  
Acting Chair,  
Sporting Injuries Committee

**SUPREME COURT PRACTICE NOTE SC Eq 9**

Supreme Court Equity Division – Arbitration List

**Commencement**

1. This Practice Note was issued on 13 February 2012 and commences on 20 February 2012.
2. This Practice Note supersedes Practice Note No SC Eq 9 issued on 15 December 2009.
3. Under the provisions of the International Arbitration Act 1974 (Cth) (“IA Act”) this Court is taken to have been specified in article 6 of the UNCITRAL Model Law on International Commercial Arbitration to perform the functions referred to in that article if the place of arbitration is or is to be in New South Wales.
4. Under s 2 of the Commercial Arbitration Act 2010 (NSW) (“CA Act”) “the Court” in that Act means, subject to s 6(2) of that Act, this Court. That Act confers jurisdiction on this Court in relation to proceedings under it.

**Definitions**

5. In this Practice Note

**List** means the Arbitration List

**List Judge** means a judge of the Court assigned by the (Chief Justice, Chief Judge in Equity) to administer the List.

**Arbitration Proceedings** mean and include

- (a) Proceedings arising under or relating to the construction or effect or operation of the IA Act, CA Act or the Commercial Arbitration Act 1984 (NSW) or any equivalent legislation of any State, Territory or foreign country;
- (b) Proceedings arising under or relating to or concerning the construction or effect or operation of the UNCITRAL Model Law on International Commercial Arbitration or any international instrument concerning arbitration or alternative dispute resolution;
- (c) Proceedings concerning the construction of an arbitration agreement;
- (d) Application for stay of proceedings arising out of an arbitration agreement or proceedings relating to the dispute in question;
- (e) Proceedings relating to the conduct of an arbitration including applications for any interim measures whether under the IA Act or otherwise;
- (f) Proceedings relating to any challenge to or setting aside of an arbitral award;

- (g) Proceedings relating to the enforcement of an arbitral award or interim measures or an award under the Convention on the Settlement of Investment Disputes between States and Nationals of other States.

**Introduction**

6. This Practice Note is designed to facilitate the prompt resolution of disputes arising in the context of arbitral proceedings in which the Court has jurisdiction whether by virtue of the CA Act, the provision of an arbitration agreement or otherwise.
7. The objective of this Practice Note’s provisions are to provide parties with a quick and effective mechanism for resolving disputes in relation to arbitration agreements or which may arise in the context or out of arbitral proceedings.
8. The nature of the issues involved, generally speaking, should make substantive interlocutory steps unnecessary. In particular the List will not be appropriate for matters which, for example, involve significant pre-trial discovery or other interlocutory steps. In particular, such steps will only be ordered if the Court considers it is necessary for the just and quick disposal of the proceedings, the onus being on the party seeking such steps to justify their necessity. If such steps are found to be necessary then consideration will be given by the Court as to whether it is appropriate the matter remain in the List.
9. The judge administering the List will be Hammerschlag J. It is anticipated that the List will be called over at 9.30 am on the second Tuesday of every month or such earlier time as the nature of the case requires.

**Entry into the List**

10. A matter in the List shall be commenced in the general form of summons proscribed under the Uniform Civil Procedure Rules 2005 but shall be endorsed with a note “The proceedings have been entered into the Arbitration List established pursuant to Practice Note SC Eq 9. The provisions of the Practice Note shall apply to the proceedings.
11. There is to be filed with the summons
  - (a) A statement of the nature of the dispute;
  - (b) A succinct statement of the issues of fact the plaintiff contends will arise;
  - (c) A succinct statement of the issues of law the plaintiff contends will arise;
  - (d) A statement setting out the interlocutory steps the plaintiff considers necessary to prepare the matter for hearing.
12. Within 14 days of service of the summons a defendant shall file and serve an Arbitration List Response setting out to the extent if any it does not agree with the plaintiff’s formulation:
  - (a) The nature of the dispute.
  - (b) A succinct statement of the additional issues of fact the defendant contends will arise.
  - (c) A succinct statement of any additional issues of law the defendant contends will arise.
  - (d) A statement setting out any additional or different interlocutory steps the defendant considers necessary to prepare the matter for hearing, and

- (e) A statement whether the defendant contends that it will be more appropriate that the proceedings be dealt with in;
  - (i) The Commercial List;
  - (ii) The Technology and Construction List; or
  - (iii) Any other list.
- 13. On the return date of the summons the following matters to the extent practicable shall be dealt with
  - (a) Whether having regard to the extent of the factual matters involved in the proceedings it is more appropriate that the proceedings be dealt with in
    - (i) The Commercial List;
    - (ii) The Technology and Construction List;
    - (iii) Any other list.
  - (b) In the event it is determined that the matters remain in the Arbitration List the following matters will be dealt with
    - (i) Directions as to the steps necessary to bring the matter to a hearing;
    - (ii) Fixing the hearing date.
- 14. Any urgent interim or interlocutory application is to be brought before the Arbitration List Judge by contacting his or her Associate or in lieu thereof the Registrar in Equity in the same manner as any urgent matter before the Duty Judge.

Dated: 13 February 2012.

T. F. BATHURST,  
Chief Justice of New South Wales

#### **Related Information**

International Arbitration Act 1974 (Cth)  
Commercial Arbitration Act 2010 (NSW)  
Commercial Arbitration Act 1984 (NSW)  
Civil Procedure Act 2005  
Uniform Civil Procedure Rules 2005  
UNCITRAL Model Law on International Commercial Arbitration

#### **Amendment History**

20 February 2012: This Practice Note replaces the previous version of SC Eq 9 that was issued on 15 December 2009.



**WORKERS COMPENSATION**

under the Workers Compensation Act 1987

## ERRATUM

THE following three Workers Compensation Orders:

Surgeon Fees Order;  
Medical Practitioner Fees Order; and  
Orthopaedic Surgeon Fees Order

published in the gazette of the 3rd February 2012, No. 12 contained errors. These notices are now republished in full.

---

**WORKERS COMPENSATION (SURGEON FEES) ORDER 2012**

under the

Workers Compensation Act 1987

I, **JULIE NEWMAN**, Acting Chief Executive Officer of the WorkCover Authority of New South Wales, make the following Order pursuant to section 61 (2) of the *Workers Compensation Act 1987*.

Dated this twenty fourth day of January 2012.

JULIE NEWMAN  
Acting Chief Executive Officer  
WorkCover Authority

---

**EXPLANATORY NOTE**

Treatment by a medical practitioner who is a surgeon is a medical or related treatment covered under the *Workers Compensation Act 1987*. This Order sets the maximum fees for which an employer is liable under the Act for treatment by a surgeon of an injured worker's work-related injury.

(Note: Treatment by an orthopaedic surgeon is covered by the *Workers Compensation (Orthopaedic Surgeon Fees) Order 2012*. However, maximum fees under this Order may apply to procedures carried out by an orthopaedic surgeon which are covered by the *Workers Compensation (Orthopaedic Surgeon Fees) Order 2012*).

The effect of the Order is to prevent a surgeon from recovering from the injured worker or employer any extra charge for treatments covered by the Order.

The Order adopts the items listed as Surgical Procedures in the *List of Medical Services and Fees* published by the Australian Medical Association (AMA).

To bill an AMA item number a surgeon must be confident they have fulfilled the service requirements as specified in the item descriptor. Where a comprehensive item number is used, separate items should not be claimed for any of the individual items included in the comprehensive service.

Where only one service is rendered, only one item should be billed. Where more than one service is rendered on one occasion of service, the appropriate item for each discrete service may be billed, provided that each item fully meets the item descriptor. Where an operation comprises a combination of procedures, which are commonly performed together, and for which there is an AMA item that specifically describes the combination of procedures, then only that item should be billed. The invoice should cover the total episode of treatment.

All surgical invoices must be accompanied by a detailed operation report clearly outlining the mechanism of injury, intra-operative findings and the procedures performed.

The incorrect use of AMA items can result in penalties, including the medical provider being asked to repay monies to WorkCover that the provider has incorrectly received.

**Workers Compensation (Surgeon Fees) Order 2012****1. Name of Order**

This Order is the *Workers Compensation (Surgeon Fees) Order 2012*.

**2. Commencement**

This Order commences on 1 January 2012.

**3. Definitions**

In this Order (including Schedules A, B and C):

*the Act* means the *Workers Compensation Act 1987*.

**Aftercare visits** has the same meaning as in the AMA List and is covered by the surgical procedure fee during the first six weeks following the date of surgery or until wound healing has occurred. However unrelated visits or incidental reasons for visits that are not regarded as routine aftercare should be explained with accounts rendered. The consulting surgeon will issue a “certificate” detailing the worker’s fitness for work and anticipated aftercare, on discharge from hospital or after the first post injury consultation.

**After hours consultations** means call-outs to a public or private hospital or a private home for urgent cases before 8.00am or after 6:00pm. This fee is not to be utilised where a consultation is conducted for non-urgent cases outside of these hours.

**Assistant at operation** means a medical practitioner but only where an assistant’s fee is allowed for in the Commonwealth Medicare Benefits Schedule, or where indicated in the WorkCover schedule or approved in advance by the insurer.

In accordance with NSW health policy (File No. C17061), assistant fees cannot be charged for WorkCover cases performed in a public hospital when the assistant is a registrar. If the registrar is on rotation to an approved private hospital training rotation, the relevant assistant fee may be charged. Payment of these fees is to be directed into a hospital or departmental trust fund account and the invoice should include details of this account. Workcover reserves the right to conduct an audit of assistant fee payments to ensure their proper distribution into the named trust fund.

**AMA list** means the document entitled *List of Medical Services and Fees* published by the Australian Medical Association and dated 1 November 2011.

**Extended initial consultation** means a consultation involving significant multiple trauma or complex “red flag” spinal conditions (systemic pathology, carcinoma, infection, fracture or nerve impingement) involving a lengthy consultation and extensive physical examination.

**GST** means the goods and services tax payable under the GST Law; and

**GST Law** has the same meaning as in the *A New Tax System (Goods and Services Tax) Act 1999* of the Commonwealth.

**Initial consultation and report** covers the first consultation and the report to the referring General Practitioner and insurer.

The report will contain:

- the patient’s diagnosis and present condition;
- the patient’s likely fitness for pre-injury work or for alternate duties;
- the need for treatment or additional rehabilitation; and
- collateral conditions that are likely to impact on the management of the worker’s condition (in accordance with privacy considerations).

Receipt of this information and “certificates” post treatment will provide sufficient information for insurers, employers and rehabilitation providers to develop management plans.

Instrument fee covers procedures where the surgeon supplies all the equipment or a substantial number of specialised instruments in exceptional circumstances and must be justified. This fee does not apply for all operations or if only incidental instruments (non critical) are supplied by the surgeon. Routine items such as loupes are not included.

**Medical practitioner** means a person registered under the *Health Practitioner Regulation National Law (NSW) No 86a* in the medical profession.

**Multiple operations or injuries** refers to situations that require two or more operations or for the treatment of two or more injuries carried out at the same time. The fee for the main procedure or injury is to be paid in full as per Schedule A and 75% of the charge specified in Schedule A for each additional item number or injury is payable, unless specifically listed in the Schedule as a multiple procedure item.

**Opinion on file request** includes retrieval of a file from whatever source, reading time, and reporting where a request for such an opinion has been made in writing to the surgeon and in accordance with privacy principles. Fees for this service will not be pre-paid in whole or part.

**Revision surgery** refers to a procedure carried out to correct earlier surgery. Only where the revision surgery is performed by a surgeon other than the original surgeon, shall it attract a fee of 50% of the amount for the principal procedure in the initial surgery, in addition to the fee payable for the new procedure, except where the new procedure is specified as a revision procedure in the AMA list.

Surgical procedures are those listed in the AMA list but do not include the cost of bandages, dressings, plaster of Paris bandages, splints, metallic fixation agents, and prosthetic implants which may be charged in addition to the fee set out in the Schedule A, if purchased by the surgeon. The fee for surgical procedures includes aftercare visits.

**Subsequent consultation** is a consultation not included in the normal aftercare that applies following surgery. The cost of the latter is included in the fee for the surgical procedure.

**Surgeon** means a medical practitioner who is currently a Fellow of the Australasian College of Surgeons. It includes a surgeon who is a staff member at a public hospital providing services at the hospital and a surgeon who is recognised by Medicare Australia as a Specialist Surgeon.

#### 4. Application of Order

This Order applies to treatment provided on or after the commencement date of this Order, whether it relates to an injury received before, on or after that date.

**5. Maximum fees for treatment by surgeon**

- (1) The maximum fee amount for which an employer is liable under the Act for treatment of an injured worker by a surgeon, being treatment of a type specified in Column 1 of Schedule A to this Order, is the corresponding amount specified in Column 3 of that Schedule.
- (2) A fee charged by a surgeon for a patient's treatment (including the management of fractures and other conditions) will be in addition to the fee in Schedule A for the original examination and report.

**6. Billing items for hand surgery (Schedule B)**

Schedule B provides mandatory guidelines that must be followed for billing items used in hand and wrist surgery only. Table 1 details items that are not applicable to hand surgery procedures.

Table 2 details items with restricted application for hand surgery and where clinical justification is required that they are reasonably necessary given the circumstances of the case.

**7. Billing items for shoulder and elbow surgery (Schedule C)**

Schedule C provides mandatory guidelines that must be followed for billing items used in shoulder and elbow surgery only.

Any item number where the term "flag" is used in the "Clinical Indication" column highlights a potential exception that will require further justification. Should a surgeon seek an exception to the mandatory guidelines the surgeon must provide a written explanation to support the request. Further expert medical opinion may be sought by WorkCover to assist with approving surgery requests or invoices.

**8. GST**

An amount fixed by this Order is exclusive of GST. An amount fixed by this Order may be increased by the amount of any GST payable in respect of the service to which the cost relates, and the cost so increased is taken to be the amount fixed by this Order. This clause does not permit a medical practitioner to charge or recover more than the amount of GST payable in respect of the service to which the cost relates.

---

SCHEDULE A – MAXIMUM FEES FOR SURGEON

<i>Item</i>	<i>Column 1 Type of service</i>	<i>Column 2 AMA Item(s)</i>	<i>Column 3 Maximum amount</i>
<u>Consultations</u>			
1.	Initial consultation and report	AC500 (MBS 104) AC600 (MBS 6007)	\$280.30
2.	Extended initial consultation and report	AC500 (MBS104) AC600 (MBS 6007)	\$386.10
3.	Subsequent consultation and report	AC510 (MBS 105) AC610 (MBS 6009)	\$193.10
4.	After hours consultation		\$162.00 in addition to consultation fee
<u>Procedures</u>			
5.	Surgical procedures	EA015 (MBS 30001) to MY115 (MBS 50130)	150% of AMA Schedule
6.	Instrument fee	WCO003	\$193.10
7.	Assistant at operation	MZ900	\$323.80 or 20% of the fee for surgi- cal procedures where the assistant fee applies, whichever is greater
8.	Multiple operations or injuries		Primary item number is to be paid in full, and additional item numbers at 75% of scheduled fee
9.	Aftercare visits		As per AMA Schedule
<u>Insurer/lawyer requests</u>			
10.	Opinion on file request		\$193.10
11.	Telephone requests		\$37.40 per 3-5 minute phone call

12. Lost reports and reprints \$130.80 per report
13. Treating specialist reports (where additional information that is not related to the routine injury management of the patient, is requested by either party to a potential or current dispute). Please refer to the *Workplace Injury Management and Workers Compensation (Medical Examinations and Reports) Order 2012 Schedule 2*
14. Fees for providing copies of clinical notes and records Please refer to the *Workers Compensation (Medical Practitioners Fees) Order 2012 – Section 5(5)*

SCHEDULE B – Billing items Used in Hand Surgery

Table 1 : Item numbers and descriptors no longer applicable to hand surgery procedures

<i>CMBS item code</i>	<i>AMA item code</i>	<i>Descriptor</i>	<i>Reason for decline</i>
Nil	CV233  CV082	INJECTION OF AN ANAESTHETIC AGENT, ulnar, radial or median nerve of main trunk, one or more of, not being associated with a brachial plexus block  MINOR NERVE BLOCK (specify type) to provide post operative pain relief (this does not include subcutaneous infiltration)	The MBS does not allow a claim for nerve blocks performed as a method of postoperative analgesia. Infiltration is included in both the anaesthetic schedule AND in the surgical item number fee if performed by the surgeon. This item can only be used in circumstances where a formal nerve block is performed by the surgeon as the only form of anaesthesia and no charge is raised for another anaesthetic service.
45051	MG540	CONTOUR RECONSTRUCTION for pathological deformity, insertion of foreign implant (non biological but excluding injection of liquid or semisolid material) by open operation	This relates to the insertion of foreign implant for pathological deformity by an open operation i.e. facial reconstruction and was not intended for usage in hand surgery.
45445	MH480	FREE GRAFTING (split skin) as inlay graft to 1 defect including elective dissection using a mould (including insertion of and removal of mould)	The appropriate item number is MH490./45448,
47954	MR170	TENDON, repair of, not being a service to which another item in this Group applies	This item is from the orthopaedic group of item numbers. There already exist appropriate item numbers in the hand surgery section.
47966	MR210	TENDON OR LIGAMENT TRANSFER, not being a service to which another item in this Group applies	This item is from the orthopaedic group of item numbers. There already exist appropriate item numbers in the hand surgery section.
47969	MR220	TENOSYNOVECTOMY, not being a service to which another item in this Group applies	This item is from the orthopaedic group of item numbers. There already exist appropriate item numbers in the hand surgery section.
47972	MR230	TENDON SHEATH, open operation for tenovaginitis, not being a service to which another item in this Group applies	This item is from the orthopaedic group of item numbers. There already exist appropriate item numbers in the hand surgery section.
48403	MS015	PHALANX OR METATARSAL, osteotomy or osteectomy of, with internal fixation	This item is from the orthopaedic group of item numbers and relates to foot surgery only. There already exist appropriate item numbers in the hand surgery section.

<i>CMBS item code</i>	<i>AMA item code</i>	<i>Descriptor</i>	<i>Reason for decline</i>
50103	MY015	JOINT, arthrotomy of, not being a service to which another item in this Group applies	This item is from the orthopaedic group of item numbers. There already exist appropriate item numbers in the hand surgery section.
50104	MY025	JOINT, synovectomy of, not being a service to which another item in this Group applies	This item is from the orthopaedic group of item numbers. There already exist appropriate item numbers in the hand surgery section.
50109	MY045	JOINT, arthrodesis of, not being a service to which another item in this Group applies	This item is from the orthopaedic group of item numbers. There already exist appropriate item numbers in the hand surgery section.
50127	MY105	JOINT OR JOINTS, arthroplasty of, by any technique not being a service to which another item applies	This item is from the orthopaedic group of item numbers. There already exist appropriate item numbers in the hand surgery section.
60506	OF820	FLUOROSCOPY using a mobile image intensifier, in conjunction with a surgical procedure lasting less than 1 hour, not being a service to which another item in this table applies (R)	This item cannot be claimed for use of image intensification when operated by the surgeon in the absence of a radiographer.
60509	OF824	FLUOROSCOPY using a mobile image intensifier, in conjunction with a surgical procedure lasting 1 hour or more, not being a service associated with a service to which another item in this table applies (R)	This item cannot be claimed for use of image intensification when operated by the surgeon in the absence of a radiographer.
	900001	Workcover certificate	This is for general practitioners and not treating specialists.

Table 2 : Item numbers with restricted application for hand surgery – clinical justification required

<i>CMBS item code</i>	<i>AMA item code</i>	<i>Descriptor</i>	<i>Clinical indication</i>
105	AC510	Each attendance SUBSEQUENT to the first in a single course of treatment	Follow up consultations will not be paid within the 6 week period following a procedure as this is included in normal aftercare.
30023	EA075	WOUND OF SOFT TISSUE, traumatic, deep or extensively contaminated, debridement of, under general anaesthesia or regional or field nerve block, including suturing of that wound when performed (Assist.)	This item applies to heavily contaminated wounds and removal of devitalized tissue in deep wounds. The majority of clean lacerations in acute hand injuries will attract item number EA095/30029.  Debridements are also not applicable when removing percutaneous wire fixation.  There will be a limit of one debridement per digit.
30029	EA095	SKIN AND SUBCUTANEOUS TISSUE OR MUCOUS MEMBRANE, REPAIR OF WOUND OF, other than wound closure at time of surgery, not on face or neck, small (NOT MORE THAN 7CM IN LENGTH), involving deeper tissue, not being a service to which another item in Group 3.4 applies.	This item is for use in wound suture when no other vital tissue is involved. It cannot be used in conjunction with EA075/30023 for the same wound/zone of injury, nor when repair of a deeper structure is also performed and claimed for.

<i>CMBS item code</i>	<i>AMA item code</i>	<i>Descriptor</i>	<i>Clinical indication</i>
30223	EA755	LARGE HAEMATOMA, LARGE ABSCESS, CARBUNCLE, CELLULITIS OR SIMILAR LESION, requiring admission to hospital or day-hospital facility, INCISION WITH DRAINAGE OF (excluding aftercare)	This item cannot be used in conjunction with EA075/30023 for the same wound/zone of injury.
30238	EA825	FASCIA, DEEP, repair of, FOR HERNIATED MUSCLE	This item is rarely indicated and cannot be used in conjunction with: EA075/30023 MR240/47975 MR250/47978 MR260/47981
33815 33818	ET560/ ET570	MAJOR ARTERY OR VEIN OF EXTREMITY, repair of wound of, with restoration of continuity, by lateral suture / MAJOR ARTERY OR VEIN OF EXTREMITY, repair of wound of, with restoration of continuity, by direct anastomosis	This item is applicable for repair of radial, ulnar or brachial arteries proximal to wrist crease.
39312	LN 740	NEUROLYSIS, internal (interfascicular) neurolysis of using microsurgical techniques	This item is never indicated in acute trauma. It is rarely indicated in elective surgery and is reserved for use in revision nerve decompression surgery. This item is not to be used in conjunction with MU400: Wrist carpal tunnel release (division of transverse carpal ligament), by open procedure.
39315	LN750	NERVE TRUNK, nerve graft to, (cable graft) including harvesting of nerve graft using microsurgical techniques	This item can only be charged once per named nerve trunk, regardless of the number and distal distribution of individual cables.  This item cannot be used in conjunction with LN790, LN800 or LN810
39318	LN760	CUTANEOUS NERVE (including digital nerve), nerve graft to, using microsurgical techniques	This item cannot be used in conjunction with LN790, LN800 or LN810. This item cannot be used for prosthetic neural tubes or wraps. In this setting, LN 700 or LN710 are applicable.
39324	LN790/800	NEURECTOMY, NEUROTOMY or removal of tumour from superficial peripheral nerve, by open operation	This item cannot be used in conjunction with LN810..
39330	LN810	NEUROLYSIS by open operation without transposition, not being a service associated with a service to which Item LN740 applies	This item is not for the identification of nerves during surgical exposure. It is not to be used in combination with LN700.  This item is not to be used in conjunction with MU400: Wrist carpal tunnel release (division of transverse carpal ligament) by open procedure. However, LN810 and MU400 can be used together for combined open carpal tunnel release and cubital tunnel release surgery.  This item is not to be used in conjunction with ML235 Tendon sheath of hand/wrist open operation for stenosing tenovaginitis.

<i>CMBS item code</i>	<i>AMA item code</i>	<i>Descriptor</i>	<i>Clinical indication</i>
45203	MH115	SINGLE STAGE LOCAL FLAP, where indicated to repair 1 defect, complicated or large, and excluding flap for male pattern baldness and excluding H-flap or double advancement flap	This item is rarely indicated in the hand and wrist as a large defect will not be readily amenable to a local flap reconstruction. It is not to be used for suturing of traumatic skin flaps.
45206	MH125	SINGLE STAGE LOCAL FLAP where indicated to repair 1 defect, on eyelid, nose, lip, ear, neck, hand, thumb, finger or genitals, excluding H-flap or double advancement flap	This item can only be used once for a z-plasty.
45500	MJ025	MICROVASCULAR REPAIR using microsurgical techniques, with restoration of continuity of artery or vein of distal extremity or digit	This item relates to microvascular repair of an artery or vein. This item will not be paid for repair of dorsal veins with volar skin intact, branches of digital arteries, branches of radial/ulnar vessels and venae comitantes of major arteries.  Microvascular repairs distal to the metacarpophalangeal joint will also require clinical documentation of appropriate surgical technique utilising an operating microscope.
45501/45502	MJ030/ MJ035	MICROVASCULAR ANASTOMOSIS of artery using microsurgical techniques, for re-implantation of limb or digit/ MICROVASCULAR ANASTOMOSIS of vein using microsurgical techniques, for re-implantation of limb or digit	These items specifically relate to replantation of limb and digit i.e: the amputated portion must be completely detached.
45503	MJ045	MICRO-ARTERIAL or MICRO-VEINOUS graft using microsurgical techniques	This item includes the remuneration for harvesting the graft and performing any microvascular anastomoses to the graft.
45515	MJ075	SCAR, other than on face or neck, NOT MORE THAN 7 CMS IN LENGTH, revision of, as an independent procedure, where undertaken in the operating theatre of a hospital or approved day hospital facility, or where performed by a specialist in the practice of his or her specialty	This item cannot be used in conjunction with other items e.g. nerve repair, tendon repair, flap repair (i.e. intended to be an independent procedure).
45563	MJ245	NEUROVASCULAR ISLAND FLAP, including direct repair of secondary cutaneous defect if performed, excluding flap for male pattern baldness	This item is for a true island flap, elevated on a neurovascular pedicle for an existing traumatic defect. This item is not to be claimed for VY advancement flaps where MH125/45206 is applicable.
46325	ML105	CARPAL BONE replacement or resection arthroplasty using adjacent tendon or other soft tissue including associated tendon transfer or realignment when performed	This item is primarily intended for use in reconstruction for basal thumb arthritis. It is not approved for excision of the pisiform.
46327	ML115	INTER-PHALANGEAL JOINT or METACARPOPHALANGEAL JOINT, arthrotomy of	This item is not to be used in addition to EA075/30023 when arthrotomy is performed to facilitate joint lavage within an open wound.
46330	ML125	INTER-PHALANGEAL JOINT or METACARPOPHALANGEAL JOINT, ligamentous or capsular repair with or without arthrotomy	This item is only permitted for repair of named ligaments where preoperative or intraoperative findings document significant joint instability.

<i>CMBS item code</i>	<i>AMA item code</i>	<i>Descriptor</i>	<i>Clinical indication</i>
46333	ML135	INTER-PHALANGEAL JOINT or METACARPOPHALANGEAL JOINT, ligamentous repair of using free tissue graft or implant	This item is only permitted for repair of named ligaments using free grafts or alloplast where preoperative or intraoperative findings document significant joint instability. This item cannot be used for reattachment of ligament using a bone anchor. ML125/46330 is the approved number.
46336	ML145	INTER-PHALANGEAL JOINT or METACARPOPHALANGEAL JOINT, synovectomy, capsulectomy or debridement of, not being a service associated with any other procedure related to that joint	This item cannot be claimed in conjunction with any other item or procedure related to the joint. This item cannot be used in conjunction with EA075/30023 .
46339	ML155	EXTENSOR tendons or FLEXOR tendons of hand or wrist synovectomy of	This item is <u>not</u> indicated for use with surgery for de Quervain's tenovaginitis (ML235/46363) and is rarely indicated in routine carpal tunnel surgery.
46396	ML345	PHALANX or METACARPAL of the hand, osteotomy or osteectomy of	This item is applicable for removing excess bone formation in an intact bone. This is no longer to be applied to removal of loose pieces of bone in trauma or bone shortening for terminalisation or replantation. This is part of the debridement and is included in EA075/30023 if applicable.
46414	ML405	ARTIFICIAL TENDON PROSTHESIS, INSERTION OF in preparation for tendon grafting	Tenolysis (ML545, ML535 : 46450, 46453) or tenotomy (MR20047963) of the tendon to be grafted cannot be billed with this item
46438	ML485	MALLET FINGER, closed pin fixation of	This item is not to be used in conjunction with MP005/47300
46450/46453	ML535/ ML545	EXTENSOR TENDON, TENOLYSIS OF, following tendon injury, repair or graft FLEXOR TENDON, TENOLYSIS OF, following tendon injury, repair or graft	These items are applicable for freeing tendons from scar following previous surgery or trauma. They are not indicated in an acute hand injury. ML545 cannot be claimed in conjunction with release of trigger finger.
46504	ML765	NEUROVASCULAR ISLAND FLAP, for pulp innervation	These items are only to be used for a heterodigital neurovascular island flap used to resurface pulp loss (e.g. Littler flap, first dorsal metacarpal artery or Kite flap).
46513/46516	ML795/ ML805	Digital nail of finger or thumb removal of	This item should not be used in association with nailbed repair (ML665/46486 or ML675/46489)
46516	ML805	DIGITAL NAIL OF FINGER OR THUMB, removal of in the operating theatre of a hospital or approved day hospital facility	This item is not to be used in association with primary or secondary nail bed repair (ML665/46486, ML675/46489)
46522	ML825	FLEXOR TENDON SHEATH OF FINGER OR THUMB - open operation and drainage for infection	This item is applicable only for drainage of suppurative flexor tenosynovitis It does not apply to washout of flexor sheath in acute injury.
47306	MP025	Distal PHALANX of FINGER or THUMB treatment of by open reduction	This item is not appropriate to be used in conjunction with ML665/46486 where a distal tuft fracture is manipulated into position.



CMBS item code	AMA item code	Descriptor	Clinical indication
47920	MR088	BONE GROWTH STIMULATOR, insertion of	This is only indicated where a mechanical bone growth stimulator has been inserted. It is not for the insertion of OP1 or other bone morphogenic proteins in the setting of hand surgery
47921	MR090	ORTHOPAEDIC PIN OR WIRE, insertion of, as an independent procedure	This item cannot be claimed when the k-wire has been used as part of fracture fixation.
47927	MR110	BURIED WIRE, PIN OR SCREW, 1 or more of, which were inserted for internal fixation purposes, removal of, in the operating theatre of a hospital or approved day hospital facility - per bone	This item applies for removal of buried k-wire. Where a k-wire or wires cross more than 2 bones, only 1 item number is claimable.
48239/ 47306	MR630/ MR640	BONE GRAFT (with or without internal fixation), not being a service to which another item in this Group applies	These items cannot be claimed in conjunction with fracture fixation numbers or the following item numbers : ML005, ML015, ML355, ML365, ML375, MR560-MR620.
48400	MS005	PHALANX, METATARSAL, ACCESSORY BONE OR SESAMOID BONE, osteotomy or osteectomy of, excluding services to which Item MX660 or MX670 applies	This item is only applicable to sesamoidectomy.
48406	MS025	FIBULA, RADIUS, ULNA, CLAVICLE, SCAPULA (other than acromion), RIB, TARSUS OR CARPUS, osteotomy or osteectomy of	This item <u>is</u> the appropriate number for excision of the pisiform. This item is <u>not</u> appropriate for simple removal of bone prominence, osteophytes or small quantities of excess bone.
49212	MU470	WRIST, arthrotomy of	This item is not to be used in conjunction with excision of primary or recurrent wrist ganglia. (ML725/46500,ML755/46503/)
50106	MY035	JOINT, stabilisation of, involving 1 or more of: repair of capsule, repair of ligament or internal fixation, not being a service to which another item in this Group applies	This item is applicable for stabilization of CMC joints only.

#### Additional assistance:

1. Where questions arise in individual clinical situations supply of additional information will be considered to assist in determinations.
2. In an open fracture wound that requires debridement, a 50% loading for open fracture fixation can be applied. Debridement item 30023/EA075 is not to be used when applying this loading
3. After hours loading for cases only applies when a surgeon is called back to perform a procedure(s) in isolation rather than for cases scheduled after 6.00 pm on a weekday or a routine weekend operating list.

#### Requirements for claims for payment

All claims for payment will need to be accompanied by the following

1. Detailed operation record including a description of the initial injury, structures that were repaired including the anatomic location and technique of repair.
2. Usage of any of the restricted item numbers (Table 2) should be accompanied by clinical justification in order to process the claim.
3. For any proposed surgery – a list of proposed applicable item numbers will need to be provided prior to approval being given.
4. WorkCover reserves the right to insist on independent clinical assessment prior to the payment of invoices and approvals for surgical procedures.

## SCHEDULE C

## Billing Items Used In Shoulder And Elbow Surgery

The Order adopts the *WorkCover Qld Shoulder and Elbow Surgery Guidelines* with minor modifications. These are outlined below and their use is mandatory when billing for shoulder and elbow surgery.

<i>AMA/CMBS item code</i>	<i>Descriptor</i>	<i>Clinical indication</i>
<b>BONE GRAFTS</b>		
MR550/48215	Humerus, bone graft to, with internal fixation	
MR640/48242	Bone graft, with internal fixation	Not being a service to which another item in this group applies
MS005/48400	Phalanx, metatarsal, accessory bone or sesamoid bone, osteotomy or osteectomy of, excluding services to which item MX660 or MX670 applies, any of items MX660, MX670, MR130 or MR140 apply	
MS025/48406	Fibula, radius, ulna, clavicle, scapula (other than acromion), rib, tarsus or carpus, osteotomy or osteectomy of	Excluding services to which items MR130/47933 or MR140/47936 apply Not to be used in combination with MT770/48951 <b>Flag if this item is used in combination with any other shoulder item codes (MT600/48900 to MT800/48960)</b>
MS035/48409	Fibula, radius, ulna, clavicle, scapula (other than acromion), rib, tarsus or carpus, osteotomy or osteectomy of, with internal fixation,	Excluding services to which items MR130/47933 or MR140/47936 apply Not to be used in combination with MT770/48951 <b>Flag if this item is used in combination with any other shoulder items (MT600/48900 to MT800/48960)</b>
MS045/48412	HUMERUS, osteotomy or osteectomy of, excluding services to which items MR130 or MR140 apply	<b>Flag if this item is used for tennis elbow surgery</b>
<b>SHOULDERS</b>		
MT600/48900	Excision or coraco-acromial ligament or removal of calcium deposit from cuff or both	Open operation not arthroscopic Use of this item rarely seen in WorkCover NSW claims <b>Flag if this item is used twice or more</b>
MT610/48903	Decompression of subacromial space by acromioplasty	Open operation, also known as open acromioplasty or subacromial decompression (SAD)
MT620/48906	Repair of rotator cuff, including excision of coraco-acromial ligament	Known as open cuff repair without acromioplasty Not to be used in combination with MT600/48900. If MS025 is performed it cannot be used with MT770
MT630/48909	Repair of rotator cuff, including decompression of subacromial space by acromioplasty	Known as open rotator cuff repair with acromioplasty with excision of AC joint Not being a service to which item MT610/48903 applies <b>Flag if this item is used with MX670/49851</b>

<i>AMA/CMBS item code</i>	<i>Descriptor</i>	<i>Clinical indication</i>
MT640/48912	Shoulder arthrotomy	Use of this item rarely seen in WorkCover NSW claims <b>Flag if this item is used in combination with any other item code for shoulder surgery</b>
MT650/48915	Hemi-arthroplasty	Use of this item rarely seen in WorkCover NSW claims Maybe appropriate for shoulder fractures only
MT660/48918	Total replacement arthroplasty including rotator cuff repair	Use of this item rarely seen in WorkCover NSW claims
MT670/48921	Revision of total replacement arthroplasty	Use of this item rarely seen in WorkCover NSW claims
MT680/48924	Revision of total replacement arthroplasty with bone graft to scapula or humerus	Use of this item rarely seen in WorkCover NSW claims
MT690/48927	Removal of shoulder prosthesis	Use of this item rarely seen in WorkCover NSW claims
MT700/48930	Stabilisation for recurrent anterior/posterior dislocation	Known as open shoulder stabilisation (including repair of labrum) If recurrent, treatment option: highly recommend looking in claimant's history to determine if surgery is to treat the aggravation or pre-existing condition
MT710/48933	Stabilisation for multidirectional dislocation	Mostly used for open procedures
MT720/48936	Synovectomy as an independent procedure	Use of this item rarely seen in WorkCover NSW claims <b>Flag if this item is used in combination with any other item code</b>
MT730/48939	Arthrodesis with synovectomy	Use of this item rarely seen in WorkCover NSW claims <b>Flag if this item is used once or more</b>
MT740/48942	Arthrodesis with synovectomy, removal of prosthesis and bone grafting	Use of this item rarely seen in WorkCover NSW claims <b>Flag if this item is used once or more</b>
MT750/48945	Diagnostic arthroscopy	Not to be used with any <b>arthroscopic</b> procedure of the shoulder region May be used with open surgery i.e. MT630/48909, MT620/48906, MT710/48933
MT760/48948	Arthroscopic surgery, with one or more: removal loose bodies, decompression of calcium deposits, debridement labrum/synovium/rotator cuff, chondroplasty	Not to be used with any other <b>arthroscopic</b> procedure of the shoulder region Preparatory for an open procedure Appropriate with MT620/48906 and MT630/48909, May be used with MT700/48930 and MT710/48933
MT770/48951	Arthroscopic division of the coraco-acromial ligament including acromioplasty	Not to be used with any other <b>arthroscopic</b> procedure of the shoulder region Not to be used in combination with EA365/30111 or MT780/48954

<i>AMA/CMBS item code</i>	<i>Descriptor</i>	<i>Clinical indication</i>
MT780/48954	Arthroscopic total synovectomy including release of contracture (shoulder)	Known as frozen shoulder release; stand alone item code Not to be used with any other <b>arthroscopic</b> procedure of the shoulder region Not to be used in combination with MT770/48951 <b>Flag if this item is used with any other item number for shoulder surgery</b>
MT790/48957	Arthroscopic stabilisation for recurrent instability including labral tear or reattachment	Not to be used with any other <b>arthroscopic</b> procedure of the shoulder region If recurrent treatment option, highly recommend looking in claimant's history to determine if surgery is to treat the aggravation or pre-existing condition <b>Flag if this item number used with any other item number for shoulder surgery</b>
MT800/48960	Reconstruction or repair of, including rotator cuff by arthroscopic, arthroscopic assisted or mini open means; arthroscopic acromioplasty; or resection of acromioclavicular joint by separate approach	Not to be used with any procedure of the shoulder region Not to be used in combination with any other item number for shoulder surgery May be used with 18256 Not to be used with <b>EA365/30111</b> <b>Flag if this item number is used in combination with MT770/48951 or MT790/48957</b>
<b>ELBOW</b>		
MU035/49100	Arthrotomy with removal one or more lavage, removal of loose body or division of contracture	Not to be used for tennis elbow surgery
MU045/49103	Ligamentous stabilisation	Not to be used in conjunction with LN810/39330 Acceptable to use LN810/39330 if the ulnar nerve requires mobilisation or decompression at the time of stabilisation (operation notes should reflect this). Transposition LN770/39321 is commonly used. Ulnar nerve transposition can occur frequently in large elbow operations. It may be necessary to perform neurolysis of more than one nerve such as radial and ulnar, if there was significant previous injury or previous surgery
MU055/49106	Arthrodesis with synovectomy	Use of this item rarely seen in WorkCover NSW claims <b>Flag if this item code is used</b>
MU065/49109	Total synovectomy	Known as <b>common contracture release</b> Use of this item rarely seen in WorkCover NSW claims May be appropriate with oosteotomy ie. MS045/48412 or MS025/ 48406 <b>Flag if used</b>

<i>AMA/CMBS item code</i>	<i>Descriptor</i>	<i>Clinical indication</i>
MU075/49112	Silastic replacement of radial head	Seen with fractures and dislocations May be associated with other item numbers i.e. MU045/49103 or MU075/49112 Not to be used in combination with MU065/49109 <b>Flag if used</b>
MU085/49115	Total joint replacement	Use of this item rarely seen in WorkCover NSW claims <b>Flag if used</b>
MU086/49116	Total replacement arthroplasty, revision including removal of prosthesis	Use of this item rarely seen in WorkCover NSW claims <b>Flag if used</b>
MU087/49117	Total replacement arthroplasty, revision procedure with bone grafting or removal or prosthesis	Use of this item rarely seen in WorkCover NSW claims <b>Flag if used</b>
MU095/49118	Diagnostic arthroscopy	Not to be used with any other <b>arthroscopic</b> procedure of the elbow region Appropriate for use with open elbow surgery
MU105/49121	Arthroscopic surgery of elbow	Involving any one or more of: drilling of defect, removal of loose body, release of contracture or adhesions, chondroplasty, or osteoplasty (not a service associated with any other <b>arthroscopic</b> procedure of the elbow joint)
<b>OTHER</b>		
EA365/30111	Bursa (large) including olecranon, calcaneum or patella, excision of	May be used in combination with olecranon bursa <b>Flag if used in combination with any shoulder surgery</b> Not to be used in combination with MT800/48960
LN810/39330	Neurolysis by open operation without transposition	Not being a service associated with a service to which item LN740/39312 applies Can be used in combination with elbow surgery Not to be used in combination with MT760/48948 <b>Flag if used in combination with any item codes for shoulder surgery</b>
<b>LIMB LENGTHENING AND DEFORMITY CORRECTION</b>		
MZ330/50405	Elbow, flexorplasty, or tendon transfer to restore elbow function	May be seen in distal biceps reconstruction Use of this item rarely seen in WorkCover NSW claims – set of item numbers address congenital conditions <b>Flag if used</b>
<b>OTHER JOINTS</b>		
MY035/50106	Joint, stabilisation of, involving one or more of: repair of capsule, repair of ligament or internal fixation	Not being a service to which another item in this Group applies Appropriate to be used with MT610/48903 and MR210/47966

<i>AMA/CMBS item code</i>	<i>Descriptor</i>	<i>Clinical indication</i>
MY055/50112	Cicatricial flexion or extension contraction of joint, correction of, involving tissues deeper than skin and subcutaneous tissue, not being a service to which another item in this group applies	<p>Not to be used with any other <b>arthroscopic</b> procedure of the shoulder region</p> <p>Not to be used in combination with item code MT780/48954</p> <p><b>Flag if used in combination with any item code for elbow and shoulder surgery</b></p> <p>Implies a release for stiffness after injury or surgery. May occur with other numbers in relation to a large release of the stiff elbow. Three to five item numbers should be in association with an operation that took two to three hours and is usually a revision situation or after serious trauma. The complexity should be reflected in the history of injury, number of prior operations, duration of surgery, complexity of the operation note.</p>
MY065/50115	Joint or joints, manipulation of, performed in the operating theatre of a hospital	<p>Not to be used for an 'examination' of a joint under general anaesthetic prior to an operation, where the general anaesthetic is for the operation itself</p> <p>Not being a service associated with a service to which another item in this group applies</p> <p><b>Flag if this item code is used two or more times</b></p>
MY105/50127	Joint or joints, arthroplasty of, by any technique	<p>Not being a service to which another item applies</p> <p>Not to be used in combination with any item code for shoulder, elbow or sternoclavicular surgery</p>
<b>GENERAL</b>		
MP455/47429	Humerus, proximal, treatment of fracture of, by open reduction	
MP465/47432	Humerus, proximal, treatment of intra-articular fracture of, by open reduction	
MP485/47438	Humerus, proximal, treatment of fracture of, and associated dislocation of shoulder, by open reduction	
MP495/47441	Humerus, proximal, treatment of intra-articular fracture of, and associated dislocation of shoulder, by open reduction	
MR020/47903	Epicondylitis, open operation for	<p>Tennis elbow</p> <p>Not to be used in combination with MS045/48412</p> <p><b>Flag if used</b></p>
MR110/47927	Buried wire, pin or screw, one or more of, which were inserted for internal fixation purposes, removal of, in the operating theatre of a hospital	Per bone
MR120/47930	Plate, rod or nail and associated wires, pins or screws, one or more of, all of which were inserted for internal fixation purposes, removal of	Not being a service associated with a service to which item MR100/47924 or MR110/47927 applies - per bone

<i>AMA/CMBS item code</i>	<i>Descriptor</i>	<i>Clinical indication</i>
MR170/47954	Tendon, repair of, as an independent procedure	Can be used in treating biceps tenodesis <b>Flag if used with any other item code</b>
MR190/47960	Tenotomy, subcutaneous	Not being a service to which another item in this group applies
MR200/47963	Tenotomy, open, with or without tenoplasty	Not being a service to which another item in this group applies Could be used in combination with MT770/48951 or MT800/48960
MR210/47966	Tendon or ligament, transfer,	As an independent procedure Could be used in combination with MT770/48951 or MT800/48960
MR220/47969	Tenosynovectomy	Not being a service to which another item in this group applies Should not be used for tennis elbow or shoulder surgery <b>Flag if used for shoulder or elbow procedures</b>

**WORKERS COMPENSATION (MEDICAL PRACTITIONER FEES)**

## ORDER 2012

under the Workers Compensation Act 1987

I, JULIE NEWMAN, Acting Chief Executive Officer of the WorkCover Authority of New South Wales, make the following Order pursuant to section 61 (2) of the *Workers Compensation Act 1987*.

Dated this twenty fourth day of January 2012.

JULIE NEWMAN,  
Acting Chief Executive Officer  
WorkCover Authority

## EXPLANATORY NOTE

Treatment by a Medical Practitioner is one of the categories of medical or related treatment covered under the *Workers Compensation Act 1987*. This Order sets the maximum fees for which an employer is liable under the Act for treatment by a Medical Practitioner of an injured worker's work-related injury.

The effect of the Order is to prevent a Medical Practitioner from recovering from the injured worker or employer any extra charge for treatments covered by the Order.

The Order does not apply to services provided by a Specialist Surgeon.

The Order adopts the *List of Medical Services and Fees* published by the Australian Medical Association (AMA). To bill an AMA item, a Medical Practitioner must be confident they have fulfilled the service requirements as specified in the item descriptor. Where a comprehensive item is used, separate items cannot be claimed for any of the individual items included in the comprehensive service.

The incorrect use of AMA items can result in penalties, including the medical provider being asked to repay monies to WorkCover that the provider has incorrectly received.

Workers Compensation (Medical Practitioner Fees) Order 2012

**1. Name of Order**

This Order is the Workers Compensation (Medical Practitioner Fees) Order 2012

**2. Commencement**

This Order commences on 1 January 2012.

**3. Definitions**

In this Order:

*the Act* means the *Workers Compensation Act 1987*.

*After hours services* applies in an emergency where the clinic is not normally open at that time, and urgent treatment is provided. This fee is not to be utilised in the situation where a consultation is conducted within the advertised hours of a clinic.

*AMA List* means the document entitled *List of Medical Services and Fees* published by the Australian Medical Association and dated 1 November 2011.

*Assistant at Operation* means a Medical Practitioner, but only where an assistant's fee is allowed for in the Commonwealth Medical Benefits Schedule, or where indicated in the WorkCover Order or approved in advance by the insurer. An assistant fee may only be applicable for surgical procedures EA010 to MY115.

In accordance with NSW health policy (File No. C17061), assistant fees cannot be charged for WorkCover cases performed in a public hospital when the assistant is a Registrar. If the Registrar is on rotation to an approved private hospital training rotation, the relevant assistant fee may be charged. Payment of these fees is to be directed into a hospital or departmental trust fund account and the invoice should include details of this account. Workcover reserves the right to conduct an audit of assistant fee payments to ensure their proper distribution into the named trust fund.

*GST* means the goods and services tax payable under the GST Law; and

*GST Law* has the same meaning as in the *A New Tax System (Goods and Services Tax) Act 1999 (Cth)*.

*Medical Practitioner* means a person registered under the *Health Practitioner Regulation National Law (NSW) No 86a* in the medical profession who is not a Specialist Surgeon.

*Specialist Surgeon* means a Medical Practitioner who holds a fellowship of the Royal Australian College of Surgeons.

**4. Application of Order**

This Order applies to treatment provided on or after the commencement date of this Order, whether it relates to an injury received before, on or after that date.



**5. Maximum fees for Medical Practitioners**

- (1) This clause applies to medical and related treatment provided by a Medical Practitioner in respect of which a fee is specified in the AMA List, except:
  - (a) Medical services identified in the AMA List by AMA numbers AC500, AC510, AC520, AC530, AC600 and AC610 (Professional Attendances by a Specialist), if these medical services are provided by a Specialist Surgeon;
  - (b) Medical services identified in the AMA List by AMA Numbers EA010 to MZ705 (Surgical Operations) if these medical services are provided by a Specialist Surgeon;
  - (c) Medical services identified in the AMA List by AMA Number MZ900 (Assistant Surgeon's fee);
  - (d) Medical services identified in the AMA List by AMA numbers OP200, OP210 and OP220 (magnetic resonance imaging – MRI).
- (2) The maximum amount payable for magnetic resonance imaging (MRI) is \$700 for a single region or two contiguous regions, and \$1050 for more than two contiguous regions.
- (3) The maximum amount payable for a medical certificate is \$20.00.
- (4) The maximum hourly rate payable to a General Practitioner is \$242.90. The maximum hourly rate payable to a Specialist is \$336.30. The hourly rate may cover, for example, case conferences, visits to worksites and additional reports requested from treating doctors. These should be billed under the WorkCover payment classification code WCO002.
- (5) The maximum fee for providing copies of medical records (including Specialist's notes and reports) is \$30 (for 33 pages or less) and an additional \$1.00 per page if more than 33 pages.
- (6) Subject to subclauses (1), (2), (3), (4), (5), and clause 7 (Nil fee for certain medical services), the maximum amount for which an employer is liable under the Act for any claim for medical or related treatment to which this clause applies is the fee listed, in respect of the medical or related treatment concerned, in the AMA List.

**6. Specialist consultations**

The initial Specialist consultation fee includes the first consultation and report to the referring General Practitioner copied to the insurer.

The report will contain:

- (a) The patient's diagnosis and present condition;
- (b) The patient's likely fitness for pre-injury work or alternate duties;
- (c) The need for treatment or additional rehabilitation; and
- (d) Collateral conditions that are likely to impact on the management of the worker's condition (in accordance with privacy considerations).

Additional reports requested that do not relate to the routine management of a worker's injury and are not required as part of a dispute or potential dispute should be billed under WCO002 and at a rate of \$336.30/hour (plus GST) for Specialists. If the report is requested as part of a current or potential dispute, then the Workplace Injury Management and Workers Compensation (Medical Examination and Reports) Order 2012 applies.

**7. Nil fee for certain medical services**

The AMA List includes items that are not relevant to medical services provided to injured workers. As such, the fee set for the following items is nil:

- (a) General Practitioner - Urgent attendances after hours items (Medical services identified in the AMA List by AMA number AA007)
- (b) All time based General Practitioner fees items (Medical services identified in the AMA List by AMA numbers AA190 – AA320)
- (c) Enhanced primary care items (Medical services identified in the AMA List by AMA numbers AA501 – AA850)
- (d) Telehealth items (Medical services identified in the AMA List by AMA numbers AP050 – AP105).

**8. Goods and Services Tax**

An amount fixed by this Order is exclusive of GST. An amount fixed by this Order may be increased by the amount of any GST payable in respect of the service to which the cost relates, and the cost so increased is taken to be the amount fixed by this Order. This clause does not permit a Medical Practitioner to charge or recover more than the amount of GST payable in respect of the service to which the cost relates.

**WORKERS COMPENSATION ORTHOPAEDIC SURGEON FEES) ORDER 2012**

under the

Workers Compensation Act 1987

I, **JULIE NEWMAN**, Acting Chief Executive Officer of the WorkCover Authority of New South Wales, make the following Order pursuant to section 61 (2) of the *Workers Compensation Act 1987*.

Dated this twenty fourth day of January 2012.

JULIE NEWMAN,  
Acting Chief Executive Officer  
WorkCover Authority

**Explanatory Note**

Treatment by a medical practitioner who is an orthopaedic surgeon is a medical or related treatment covered under the *Workers Compensation Act 1987*. This Order sets the maximum fees for which an employer is liable under the Act for treatment by an orthopaedic surgeon of an injured worker's work-related injury.

The effect of the Order is to prevent an orthopaedic surgeon from recovering from the injured worker or employer any extra charge for treatments covered by the Order.

The Order adopts the items listed as Orthopaedic Procedures in the *List of Medical Services and Fees* published by the Australian Medical Association (AMA).

To bill an AMA item number a surgeon must be confident they have fulfilled the service requirements as specified in the item descriptor. Where a comprehensive item number is used, separate items should not be claimed for any of the individual items included in the comprehensive service.

Where only one service is rendered, only one item should be billed. Where more than one service is rendered on one occasion of service, the appropriate item for each discrete service may be billed, provided that each item fully meets the item descriptor. Where an operation comprises a combination of procedures which are commonly performed together and for which there is an AMA item that specifically describes the combination of procedures then only that item should be billed. The invoice should cover the total episode of treatment.

All surgical invoices must be accompanied by a detailed operation report clearly outlining the mechanism of injury, intra-operative findings and the procedures performed.

The incorrect use of AMA items can result in penalties, including the medical provider being asked to repay monies to WorkCover that the provider has incorrectly received.

**Workers Compensation (Orthopaedic Surgeon Fees) Order 2012****1. Name of Order**

This Order is the *Workers Compensation (Orthopaedic Surgeon Fees) Order 2012*.

**2. Commencement**

This Order commences on 1 January 2012.

**3. Definitions**

In this Order (including Schedule A):

*the Act* means the *Workers Compensation Act 1987*.

*Aftercare visits* has the same meaning as in the AMA List and is covered by the surgical procedure fee during the first six weeks following the date of surgery or until wound healing has occurred. However, unrelated visits or incidental reasons for visits that are not regarded as routine aftercare should be explained with accounts rendered. The consulting surgeon will issue a "certificate" detailing the worker's fitness for work and anticipated after-care on discharge from hospital or after the first post injury consultation.

*After hours consultations* means call-outs to a public or private hospital or a private home for urgent cases before 8.00am or after 6:00pm. This fee is not to be utilised where a consultation is conducted for non-urgent cases outside of these hours.

*Assistant at operation* means a medical practitioner, but only where an assistant's fee is allowed for in the Commonwealth Medicare Benefits Schedule, or where indicated in the WorkCover schedule or approved in advance by the insurer. An assistant fee may only be applicable for surgical procedures EA010 to MY115.

In accordance with NSW health policy (File No. C17061), assistant fees cannot be charged for WorkCover cases performed in a public hospital when the assistant is a registrar. If the registrar is on rotation to an approved private hospital training rotation, the relevant assistant fee may be charged. Payment of these fees is to be directed into a hospital or departmental trust fund account and the invoice should include details of this account. Workcover reserves the right to conduct an audit of assistant fee payments to ensure their proper distribution into the named trust fund.

*AMA list* means the document entitled *List of Medical Services and Fees* published by the Australian Medical Association and dated 1 November 2011.

**Extended initial consultation** means a consultation involving significant multiple trauma or complex “red flag” spinal conditions (systemic pathology, carcinoma, infection, fracture or nerve impingement) involving a lengthy consultation and extensive physical examination.

**GST** means the goods and services tax payable under the GST Law; and

**GST Law** has the same meaning as in the *A New Tax System (Goods and Services Tax) Act 1999* of the Commonwealth.

**Initial consultation and report** covers the first consultation and the report to the referring General Practitioner and insurer.

The report will contain:

- the patient’s diagnosis and present condition;
- the patient’s likely fitness for pre-injury work or for alternate duties;
- the need for treatment or additional rehabilitation; and
- collateral conditions that are likely to impact on the management of the worker’s condition (in accordance with privacy considerations).

Receipt of this information and “certificates” post treatment will provide sufficient information for insurers, employers and rehabilitation providers to develop management plans.

Instrument fee covers procedures where the surgeon supplies all the equipment or a substantial number of specialised instruments in exceptional circumstances and must be justified. This fee does not apply for all operations or if only incidental instruments (non critical) are supplied by the surgeon. Routine items such as loupes are not included.

**Medical practitioner** means a person registered under the *Health Practitioner Regulation National Law (NSW) No 86a* in the medical profession.

**Multiple operations or injuries** refers to situations that require two or more operations or for the treatment of two or more injuries carried out at the same time. The fee for the main procedure or injury is to be paid in full as per Schedule A and 75% of the charge specified in Schedule A for each additional item number or injury is payable, unless specifically listed in the Schedule as a multiple procedure item.

**Opinion on file request** includes retrieval of a file from whatever source, reading time, and reporting where a request for such an opinion has been made in writing to the orthopaedic surgeon and in accordance with privacy principles. Fees for this service will not be pre-paid in whole or part.

Orthopaedic procedures are those listed in the AMA list but do not include the cost of bandages, dressings, plaster of Paris bandages, splints, metallic fixation agents, and prosthetic implants which may be charged in addition to the fee set out in the Schedule A, if purchased by the surgeon. The fee for orthopaedic procedures includes aftercare visits.

**Orthopaedic surgeon** means a medical practitioner who is currently a Fellow of the Australian Orthopaedic Association or who is recognised by Medicare Australia as a specialist in orthopaedic surgery. It includes an orthopaedic surgeon who is a staff member at a public hospital providing services at the hospital.

**Revision surgery** refers to a procedure carried out to correct earlier surgery. Only where the revision surgery is performed by a surgeon other than the original surgeon, shall it attract a fee of 50% of the amount for the principal procedure in the initial surgery, in addition to the fee payable for the new procedure, except where the new procedure is specified as a revision procedure in the AMA list.

**Subsequent consultation** is a consultation not included in the normal aftercare that applies following surgery. The cost of the latter is included in the fee for the orthopaedic procedure.

#### 4. Application of Order

This Order applies to treatment provided on or after the commencement date of this Order, whether it relates to an injury received before, on or after that date.

#### 5. Maximum fees for treatment by orthopaedic surgeon

- (1) The maximum fee amount for which an employer is liable under the Act for treatment of an injured worker by an orthopaedic surgeon, being treatment of a type specified in Column 1 of Schedule A to this Order, is the corresponding amount specified in Column 3 of that Schedule.
- (2) A fee charged by an orthopaedic surgeon for a patient’s treatment (including the management of fractures and other conditions) will be in addition to the fee in Schedule A for the original examination and report.

#### 6. Billing items for hand surgery (Schedule B)

Schedule B provides mandatory guidelines for billing items used in hand and wrist surgery only.

Table 1 details items that are not applicable to hand surgery procedures.

Table 2 details items with restricted application for hand surgery and where clinical justification is required that they are reasonably necessary given the circumstances of the case.

#### 7. Billing items for shoulder and elbow surgery (Schedule C)

Schedule C provides mandatory guidelines that must be followed for billing items used in shoulder and elbow surgery only.

Any item number where the term “flag” is used in the Clinical Indication column highlights a potential exception that will require further justification. Should a surgeon seek an exception to the guidelines, the surgeon must provide a

written explanation to support the request. Further expert medical opinion may be sought by WorkCover to assist with approving surgery requests or invoices.

## 8. GST

An amount fixed by this Order is exclusive of GST. An amount fixed by this Order may be increased by the amount of any GST payable in respect of the service to which the cost relates, and the cost so increased is taken to be the amount fixed by this Order. This clause does not permit a medical practitioner to charge or recover more than the amount of GST payable in respect of the service to which the cost relates.

### SCHEDULE A - MAXIMUM FEES FOR ORTHOPAEDIC SURGEONS

<i>Item</i>	<i>Column 1 Type of service</i>	<i>Column 2 AMA Item(s)</i>	<i>Column 3 Maximum amount</i>
<u>Consultations</u>			
1.	Initial consultation and report	AC500 (MBS 104)	\$280.30
2.	Extended initial consultation and report	AC500 (MBS104)	\$386.10
3.	Subsequent consultation	AC510 (MBS 105)	\$193.10
4.	After hours consultation		\$162.00 in addition to consultation fee
<u>Procedures</u>			
5.	Orthopaedic procedures	ML005 (MBS 46300) to MY115 (MBS 50130)	150% of AMA Schedule
6.	Instrument fee	WCO003	\$193.10
7.	Assistant at operation	MZ900	\$323.80 or 20% of the fee for surgical procedures where the assistant fee applies, whichever is greater
8.	Multiple operations or injuries		Primary item number is to be paid in full, and additional item numbers at 75% of scheduled fee
9.	Aftercare visits		As per AMA Schedule
<u>Insurer/lawyer requests</u>			
10.	Opinion on file request		\$193.10
11.	Telephone requests		\$37.40 per 3-5 minute phone call
12.	Lost reports and reprints		\$130.80 per report
13.	Treating Specialist Report (where additional information that is not related to the routine injury management of the patient, is requested by either party to a potential or current dispute)		Please refer to the <i>Workplace Injury Management and Workers Compensation (Medical Examinations and Reports) Order 2012 Schedule 2</i>
14.	Fees for providing copies of clinical notes and records		Please refer to the <i>Workers Compensation (Medical Practitioners Fees) Order 2012 – Section 5(5)</i>

## SCHEDULE B – Billing Items used in Hand Surgery

Table 1: Item numbers and descriptors no longer applicable to hand surgery procedures

<i>CMBS item code</i>	<i>AMA item code</i>	<i>Descriptor</i>	<i>Reason for decline</i>
Nil	CV233	INJECTION OF AN ANAESTHETIC AGENT, ulnar, radial or median nerve of main trunk, one or more of, not being associated with a brachial plexus block	The MBS does not allow a claim for nerve blocks performed as a method of postoperative analgesia. Infiltration is included in both the anaesthetic schedule AND in the surgical item number fee if performed by the surgeon. This item can only be used in circumstances where a formal nerve block is performed by the surgeon as the only form of anaesthesia and no charge is raised for another anaesthetic service.
	CV082	MINOR NERVE BLOCK (specify type) to provide post operative pain relief (this does not include subcutaneous infiltration)	
45051	MG540	CONTOUR RECONSTRUCTION for pathological deformity, insertion of foreign implant (non biological but excluding injection of liquid or semisolid material) by open operation	This relates to the insertion of foreign implant for pathological deformity by an open operation i.e. facial reconstruction and was not intended for usage in hand surgery.
45445	MH480	FREE GRAFTING (split skin) as inlay graft to 1 defect including elective dissection using a mould (including insertion of and removal of mould)	The appropriate item number is MH490/45448.
47954	MR170	TENDON, repair of, not being a service to which another item in this Group applies	This item is from the orthopaedic group of item numbers. There already exist appropriate item numbers in the hand surgery section.
47966	MR210	TENDON OR LIGAMENT TRANSFER, not being a service to which another item in this Group applies	This item is from the orthopaedic group of item numbers. There already exist appropriate item numbers in the hand surgery section.
47969	MR220	TENOSYNOVECTOMY, not being a service to which another item in this Group applies	This item is from the orthopaedic group of item numbers. There already exist appropriate item numbers in the hand surgery section.
47972	MR230	TENDON SHEATH, open operation for tenovaginitis, not being a service to which another item in this Group applies	This item is from the orthopaedic group of item numbers. There already exist appropriate item numbers in the hand surgery section.
48403	MS015	PHALANX OR METATARSAL, osteotomy or osteectomy of, with internal fixation	This item is from the orthopaedic group of item numbers and relates to foot surgery only. There already exist appropriate item numbers in the hand surgery section.
50103	MY015	JOINT, arthrotomy of, not being a service to which another item in this Group applies	This item is from the orthopaedic group of item numbers. There already exist appropriate item numbers in the hand surgery section.
50104	MY025	JOINT, synovectomy of, not being a service to which another item in this Group applies	This item is from the orthopaedic group of item numbers. There already exist appropriate item numbers in the hand surgery section.
50109	MY045	JOINT, arthrodesis of, not being a service to which another item in this Group applies	This item is from the orthopaedic group of item numbers. There already exist appropriate item numbers in the hand surgery section.

<i>CMBS item code</i>	<i>AMA item code</i>	<i>Descriptor</i>	<i>Reason for decline</i>
50127	MY105	JOINT OR JOINTS, arthroplasty of, by any technique not being a service to which another item applies	This item is from the orthopaedic group of item numbers. There already exist appropriate item numbers in the hand surgery section.
60506	OF820	FLUOROSCOPY using a mobile image intensifier, in conjunction with a surgical procedure lasting less than 1 hour, not being a service to which another item in this table applies (R)	This item cannot be claimed for use of image intensification when operated by the surgeon in the absence of a radiographer.
60509	OF824	FLUOROSCOPY using a mobile image intensifier, in conjunction with a surgical procedure lasting 1 hour or more, not being a service associated with a service to which another item in this table applies (R)	This item cannot be claimed for use of image intensification when operated by the surgeon in the absence of a radiographer.
	900001	Workcover certificate	This is for general practitioners and not treating specialists.

Table 2: Item numbers with restricted application for hand surgery – clinical justification required

<i>CMBS item code</i>	<i>AMA item code</i>	<i>Descriptor</i>	<i>Clinical indication</i>
105	AC510	Each attendance SUBSEQUENT to the first in a single course of treatment	Follow up consultations will not be paid within the 6 week period following a procedure as this is included in normal aftercare.
30023	EA075	WOUND OF SOFT TISSUE, traumatic, deep or extensively contaminated, debridement of, under general anaesthesia or regional or field nerve block, including suturing of that wound when performed (Assist.)	This item applies to heavily contaminated wounds and removal of devitalized tissue in deep wounds. The majority of clean lacerations in acute hand injuries will attract item number EA095/30029.  Debridements are also not applicable when removing percutaneous wire fixation.  There will be a limit of one debridement per digit.
30029	EA095	SKIN AND SUBCUTANEOUS TISSUE OR MUCOUS MEMBRANE, REPAIR OF WOUND OF, other than wound closure at time of surgery, not on face or neck, small (NOT MORE THAN 7CM IN LENGTH), involving deeper tissue, not being a service to which another item in Group 3.4 applies.	This item is for use in wound suture when no other vital tissue is involved. It cannot be used in conjunction with 30023 (EA075) for the same wound/zone of injury, nor when repair of a deeper structure is also performed and claimed for.
30223	EA755	LARGE HAEMATOMA, LARGE ABSCESS, CARBUNCLE, CELLULITIS OR SIMILAR LESION, requiring admission to hospital or day-hospital facility, INCISION WITH DRAINAGE OF (excluding aftercare)	This item cannot be used in conjunction with 30023 (EA075) for the same wound/zone of injury.
30238	EA825	FASCIA, DEEP, repair of, FOR HERNIATED MUSCLE	This item is rarely indicated and cannot be used in conjunction with: EA075/30023, MR240/47975, MR250/47978, MR260/47981.

<i>CMBS item code</i>	<i>AMA item code</i>	<i>Descriptor</i>	<i>Clinical indication</i>
33815 33818	ET560/ ET570	MAJOR ARTERY OR VEIN OF EXTREMITY, repair of wound of, with restoration of continuity, by lateral suture / MAJOR ARTERY OR VEIN OF EXTREMITY, repair of wound of, with restoration of continuity, by direct anastomosis	This item is applicable for repair of radial, ulnar or brachial arteries proximal to wrist crease.
39312	LN 740	NEUROLYSIS, internal (interfascicular) neurolysis of using microsurgical techniques	This item is never indicated in acute trauma. It is rarely indicated in elective surgery and is reserved for use in revision nerve decompression surgery. This item is not to be used in conjunction with MU400: Wrist carpal tunnel release (division of transverse carpal ligament), by open procedure.
39315	LN750	NERVE TRUNK, nerve graft to, (cable graft) including harvesting of nerve graft using microsurgical techniques	This item can only be charged once per named nerve trunk, regardless of the number and distal distribution of individual cables.  This item cannot be used in conjunction with LN790, LN800 or LN810
39318	LN760	CUTANEOUS NERVE (including digital nerve), nerve graft to, using microsurgical techniques	This item cannot be used in conjunction with LN790, LN800 or LN810. This item cannot be used for prosthetic neural tubes or wraps. In this setting, LN 700 or LN710 are applicable.
39324	LN790/800	NEURECTOMY, NEUROTOMY or removal of tumour from superficial peripheral nerve, by open operation	This item cannot be used in conjunction with LN810.
39330	LN810	NEUROLYSIS by open operation without transposition, not being a service associated with a service to which Item LN740 applies	This item is not for the identification of nerves during surgical exposure. It is not to be used in combination with LN700.  This item is not to be used in conjunction with MU400: Wrist carpal tunnel release (division of transverse carpal ligament) by open procedure. However, LN810 and MU400 can be used together for combined open carpal tunnel release and cubital tunnel release surgery.  This item is not to be used in conjunction with ML235 Tendon sheath of hand/ wrist open operation for stenosing tenovaginitis.
45203	MH115	SINGLE STAGE LOCAL FLAP, where indicated to repair 1 defect, complicated or large, and excluding flap for male pattern baldness and excluding H-flap or double advancement flap	This item is rarely indicated in the hand and wrist as a large defect will not be readily amenable to a local flap reconstruction. It is not to be used for suturing of traumatic skin flaps.
45206	MH125	SINGLE STAGE LOCAL FLAP where indicated to repair 1 defect, on eyelid, nose, lip, ear, neck, hand, thumb, finger or genitals, excluding H-flap or double advancement flap	This item can only be used once for a z-plasty.

<i>CMBS item code</i>	<i>AMA item code</i>	<i>Descriptor</i>	<i>Clinical indication</i>
45500	MJ025	MICROVASCULAR REPAIR using microsurgical techniques, with restoration of continuity of artery or vein of distal extremity or digit	This item relates to microvascular repair of an artery or vein. This item will not be paid for repair of dorsal veins with volar skin intact, branches of digital arteries, branches of radial/ulnar vessels and venae comitantes of major arteries.  Microvascular repairs distal to the metacarpophalangeal joint will also require clinical documentation of appropriate surgical technique utilising an operating microscope.
45501/45502	MJ030/ MJ035	MICROVASCULAR ANASTOMOSIS of artery using microsurgical techniques, for re-implantation of limb or digit/ MICROVASCULAR ANASTOMOSIS of vein using microsurgical techniques, for re-implantation of limb or digit	These items specifically relate to replantation of limb and digit i.e. The amputated portion must be completely detached.
45503	MJ045	MICRO-ARTERIAL or MICRO-VEINOUS graft using microsurgical techniques	This item includes the remuneration for harvesting the graft and performing any microvascular anastomoses to the graft.
45515	MJ075	SCAR, other than on face or neck, NOT MORE THAN 7 CMS IN LENGTH, revision of, as an independent procedure, where undertaken in the operating theatre of a hospital or approved day hospital facility, or where performed by a specialist in the practice of his or her specialty	This item cannot be used in conjunction with other items e.g. nerve repair, tendon repair, flap repair (i.e. intended to be an independent procedure).
45563	MJ245	NEUROVASCULAR ISLAND FLAP, including direct repair of secondary cutaneous defect if performed, excluding flap for male pattern baldness	This item is for a true island flap, elevated on a neurovascular pedicle for an existing traumatic defect. This item is not to be claimed for VY advancement flaps where MH125/45206 is applicable.
46325	ML105	CARPAL BONE replacement or resection arthroplasty using adjacent tendon or other soft tissue including associated tendon transfer or realignment when performed	This item is primarily intended for use in reconstruction for basal thumb arthritis. It is not approved for excision of the pisiform.
46327	ML115	INTER-PHALANGEAL JOINT or METACARPOPHALANGEAL JOINT, arthrotomy of	This item is not to be used in addition to EA075/30023 when arthrotomy is performed to facilitate joint lavage within an open wound.
46330	ML125	INTER-PHALANGEAL JOINT or METACARPOPHALANGEAL JOINT, ligamentous or capsular repair with or without arthrotomy	This item is only permitted for repair of named ligaments where preoperative or intraoperative findings document significant joint instability.
46333	ML135	INTER-PHALANGEAL JOINT or METACARPOPHALANGEAL JOINT, ligamentous repair of using free tissue graft or implant	This item is only permitted for repair of named ligaments using free grafts or alloplast where preoperative or intraoperative findings document significant joint instability. This item cannot be used for reattachment of ligament using a bone anchor. ML125/46330 is the approved number.



<i>CMBS item code</i>	<i>AMA item code</i>	<i>Descriptor</i>	<i>Clinical indication</i>
46336	ML145	INTER-PHALANGEAL JOINT or METACARPOPHALANGEAL JOINT, synovectomy, capsulectomy or debridement of, not being a service associated with any other procedure related to that joint	This item cannot be claimed in conjunction with any other item or procedure related to the joint. This item cannot be used in conjunction with EA075/30023 .
46339	ML155	EXTENSOR tendons or FLEXOR tendons of hand or wrist synovectomy of	This item is <b>not</b> indicated for use with surgery for de Quervain's tenovaginitis ML235/46363 and is rarely indicated in routine carpal tunnel surgery.
46396	ML345	PHALANX or METACARPAL of the hand, osteotomy or osteectomy of	This item is applicable for removing excess bone formation in an <i>intact</i> bone. This is no longer to be applied to removal of loose pieces of bone in trauma or bone shortening for terminalisation or replantation. This is part of the debridement and is included in EA075/30023 if applicable.
46414	ML405	ARTIFICIAL TENDON PROSTHESIS, INSERTION OF in preparation for tendon grafting	Tenolysis (ML545, ML535 : 46450, 46453) or tenotomy (MR20047963) of the tendon to be grafted cannot be billed with this item.
46438	ML485	MALLET FINGER, closed pin fixation of	This item is not to be used in conjunction with MP005/47300
46450/46453	ML535/ ML545	EXTENSOR TENDON, TENOLYSIS OF, following tendon injury, repair or graft FLEXOR TENDON, TENOLYSIS OF, following tendon injury, repair or graft	These items are applicable for freeing tendons from scar following previous surgery or trauma. They are not indicated in an acute hand injury. ML545 cannot be claimed in conjunction with release of trigger finger.
46504	ML765	NEUROVASCULAR ISLAND FLAP, for pulp innervation	These items are only to be used for a heterodigital neurovascular island flap used to resurface pulp loss (e.g. Littler flap, first dorsal metacarpal artery or Kite flap).
46513/46516	ML795/ ML805	Digital nail of finger or thumb removal of	This item should not be used in association with nailbed repair (ML665/46486 or ML675/46489)
46516	ML805	DIGITAL NAIL OF FINGER This item is OR THUMB, removal of in the operating theatre of a hospital or approved day hospital facility	This item is not to be used in association with primary or secondary nail bed repair (ML665/46486, ML675/46489)
46522	ML825	FLEXOR TENDON SHEATH OF FINGER OR THUMB - open operation and drainage for infection	This item is applicable only for drainage of suppurative flexor tenosynovitis It does not apply to washout of flexor sheath in acute injury.
47306	MP025	Distal PHALANX of FINGER or THUMB treatment of by open reduction	This item is not appropriate to be used in conjunction with ML665/46486 where a distal tuft fracture is manipulated into position.
47920	MR088	BONE GROWTH STIMULATOR, insertion of	This is only indicated where a mechanical bone growth stimulator has been inserted. It is not for the insertion of OPI or other bone morphogenic proteins in the setting of hand surgery

CMBS item code	AMA item code	Descriptor	Clinical indication
47921	MR090	ORTHOPAEDIC PIN OR WIRE, insertion of, as an independent procedure	This item cannot be claimed when the k-wire has been used as part of fracture fixation.
47927	MR110	BURIED WIRE, PIN OR SCREW, 1 or more of, which were inserted for internal fixation purposes, removal of, in the operating theatre of a hospital or approved day hospital facility - per bone	This item applies for removal of <i>buried</i> k-wire. Where a k-wire or wires cross more than 2 bones, only 1 item number is claimable.
48239/ 47306	MR630/ MR640	BONE GRAFT (with or without internal fixation), not being a service to which another item in this Group applies	These items cannot be claimed in conjunction with fracture fixation numbers or the following item numbers : ML005, ML015, ML355, ML365, ML375, MR560-MR620.
48400	MS005	PHALANX, METATARSAL, ACCESSORY BONE OR SESAMOID BONE, osteotomy or osteectomy of, excluding services to which Item MX660 or MX670 applies	This item is only applicable to sesamoidectomy.
48406	MS025	FIBULA, RADIUS, ULNA, CLAVICLE, SCAPULA (other than acromion), RIB, TARSUS OR CARPUS, osteotomy or osteectomy of	This item <u>is</u> the appropriate number for excision of the pisiform. This item is <u>not</u> appropriate for simple removal of bone prominence, osteophytes or small quantities of excess bone.
49212	MU470	WRIST, arthrotomy of	This item is not to be used in conjunction with excision of primary or recurrent wrist ganglia. (ML725/46500,ML755/46503)
50106	MY035	JOINT, stabilisation of, involving 1 or more of: repair of capsule, repair of ligament or internal fixation, not being a service to which another item in this Group applies	This item is applicable for stabilization of CMC joints only.

#### Additional assistance:

1. Where questions arise in individual clinical situations supply of additional information will be considered to assist in determinations.
2. In an open fracture wound that requires debridement, a 50% loading for open fracture fixation can be applied. Debridement item 30023/EA075 is not to be used when applying this loading
3. After hours loading for cases only applies when a surgeon is called back to perform a procedure(s) in isolation rather than for cases scheduled after 6.00 pm on a weekday or a routine weekend operating list.

#### Requirements for claims for payment

All claims for payment will need to be accompanied by the following

1. Detailed operation record including a description of the initial injury, structures that were repaired including the anatomic location and technique of repair.
2. Usage of any of the restricted item numbers (Table 2) should be accompanied by clinical justification in order to process the claim.
3. For any proposed surgery – a list of proposed applicable item numbers will need to be provided prior to approval being given.
4. WorkCover reserves the right to insist on independent clinical assessment prior to the payment of invoices and approvals for surgical procedures.

## SCHEDULE C – Billing Items used in Shoulder and Elbow Surgery

The Order adopts the *WorkCover Qld Shoulder and Elbow Surgery Guidelines* with minor modifications. These are outlined below and their use is mandatory when billing for shoulder and elbow surgery.

<i>AMA/CMBS item code</i>	<i>Descriptor</i>	<i>Clinical indication</i>
<b>BONE GRAFTS</b>		
MR550/48215	Humerus, bone graft to, with internal fixation	
MR640/48242	Bone graft, with internal fixation	Not being a service to which another item in this group applies
MS005/48400	Phalanx, metatarsal, accessory bone or sesamoid bone, osteotomy or osteectomy of, excluding services to which item MX660 or MX670 applies, any of items MX660, MX670, MR130 or MR140 apply	
MS025/48406	Fibula, radius, ulna, clavicle, scapula (other than acromion), rib, tarsus or carpus, osteotomy or osteectomy of	Excluding services to which items MR130/47933 or MR140/47936 apply Not to be used in combination with MT770/48951 <b>Flag if this item is used in combination with any other shoulder item codes (MT600/48900 to MT800/48960)</b>
MS035/48409	Fibula, radius, ulna, clavicle, scapula (other than acromion), rib, tarsus or carpus, osteotomy or osteectomy of, with internal fixation,	Excluding services to which items MR130/47933 or MR140/47936 apply Not to be used in combination with MT770/48951 <b>Flag if this item is used in combination with any other shoulder items (MT600/48900 to MT800/48960)</b>
MS045/48412	HUMERUS, osteotomy or osteectomy of, excluding services to which items MR130 or MR140 apply	<b>Flag if this item is used for tennis elbow surgery</b>
<b>SHOULDERS</b>		
MT600/48900	Excision or coraco-acromial ligament or removal of calcium deposit from cuff or both	Open operation not arthroscopic Use of this item rarely seen in WorkCover NSW claims <b>Flag if this item is used twice or more</b>
MT610/48903	Decompression of subacromial space by acromioplasty	Open operation, also known as open acromioplasty or subacromial decompression (SAD)
MT620/48906	Repair of rotator cuff, including excision of coraco-acromial ligament	Known as open cuff repair without acromioplasty Not to be used in combination with MT600/48900. If MS025 is performed it cannot be used with MT770
MT630/48909	Repair of rotator cuff, including decompression of subacromial space by acromioplasty	Known as open rotator cuff repair with acromioplasty with excision of AC joint Not being a service to which item MT610/48903 applies <b>Flag if this item is used with MX670/49851</b>

<i>AMA/CMBS item code</i>	<i>Descriptor</i>	<i>Clinical indication</i>
MT640/48912	Shoulder arthrotomy	Use of this item rarely seen in WorkCover NSW claims <b>Flag if this item is used in combination with any other item code for shoulder surgery</b>
MT650/48915	Hemi-arthroplasty	Use of this item rarely seen in WorkCover NSW claims Maybe appropriate for shoulder fractures only
MT660/48918	Total replacement arthroplasty including rotator cuff repair	Use of this item rarely seen in WorkCover NSW claims
MT670/48921	Revision of total replacement arthroplasty	Use of this item rarely seen in WorkCover NSW claims
MT680/48924	Revision of total replacement arthroplasty with bone graft to scapula or humerus	Use of this item rarely seen in WorkCover NSW claims
MT690/48927	Removal of shoulder prosthesis	Use of this item rarely seen in WorkCover NSW claims
MT700/48930	Stabilisation for recurrent anterior/posterior dislocation	Known as open shoulder stabilisation (including repair of labrum) If recurrent, treatment option: highly recommend looking in claimant's history to determine if surgery is to treat the aggravation or pre-existing condition
MT710/48933	Stabilisation for multidirectional dislocation	Mostly used for open procedures
MT720/48936	Synovectomy as an independent procedure	Use of this item rarely seen in WorkCover NSW claims <b>Flag if this item is used in combination with any other item code</b>
MT730/48939	Arthrodesis with synovectomy	Use of this item rarely seen in WorkCover NSW claims <b>Flag if this item is used once or more</b>
MT740/48942	Arthrodesis with synovectomy, removal of prosthesis and bone grafting	Use of this item rarely seen in WorkCover NSW claims <b>Flag if this item is used once or more</b>
MT750/48945	Diagnostic arthroscopy	Not to be used with any <b>arthroscopic</b> procedure of the shoulder region May be used with open surgery i.e. MT630/48909, MT620/48906, MT710/48933
MT760/48948	Arthroscopic surgery, with one or more: removal loose bodies, decompression of calcium deposits, debridement labrum/synovium/rotator cuff, chondroplasty	Not to be used with any other <b>arthroscopic</b> procedure of the shoulder region Preparatory for an open procedure Appropriate with MT620/48906 and MT630/48909, May be used with MT700/48930 and MT710/48933
MT770/48951	Arthroscopic division of the coraco-acromial ligament including acromioplasty	Not to be used with any other <b>arthroscopic</b> procedure of the shoulder region Not to be used in combination with EA365/30111 or MT780/48954

<i>AMA/CMBS item code</i>	<i>Descriptor</i>	<i>Clinical indication</i>
MT780/48954	Arthroscopic total synovectomy including release of contracture (shoulder)	Known as frozen shoulder release; stand alone item code Not to be used with any other <b>arthroscopic</b> procedure of the shoulder region Not to be used in combination with MT770/48951 <b>Flag if this item is used with any other item number for shoulder surgery</b>
MT790/48957	Arthroscopic stabilisation for recurrent instability including labral tear or reattachment	Not to be used with any other <b>arthroscopic</b> procedure of the shoulder region If recurrent treatment option, highly recommend looking in claimant's history to determine if surgery is to treat the aggravation or pre-existing condition <b>Flag if this item number used with any other item number for shoulder surgery</b>
MT800/48960	Reconstruction or repair of, including rotator cuff by arthroscopic, arthroscopic assisted or mini open means; arthroscopic acromioplasty; or resection of acromioclavicular joint by separate approach	Not to be used with any procedure of the shoulder region Not to be used in combination with any other item number for shoulder surgery May be used with 18256 Not to be used with <b>EA365/30111</b> <b>Flag if this item number is used in combination with MT770/48951 or MT790/48957</b>
<b>ELBOW</b>		
MU035/49100	Arthrotomy with removal one or more lavage, removal of loose body or division of contracture	Not to be used for tennis elbow surgery
MU045/49103	Ligamentous stabilisation	Not to be used in conjunction with LN810/39330 Acceptable to use LN810/39330 if the ulnar nerve requires mobilisation or decompression at the time of stabilisation (operation notes should reflect this). Transposition LN770/39321 is commonly used. Ulnar nerve transposition can occur frequently in large elbow operations. It may be necessary to perform neurolysis of more than one nerve such as radial and ulnar, if there was significant previous injury or previous surgery
MU055/49106	Arthrodesis with synovectomy	Use of this item rarely seen in WorkCover NSW claims <b>Flag if this item code is used</b>
MU065/49109	Total synovectomy	Known as <b>common contracture release</b> Use of this item rarely seen in WorkCover NSW claims May be appropriate with oosteotomy ie. MS045/48412 or MS025/ 48406 <b>Flag if used</b>

<i>AMA/CMBS item code</i>	<i>Descriptor</i>	<i>Clinical indication</i>
MU075/49112	Silastic replacement of radial head	Seen with fractures and dislocations May be associated with other item numbers i.e. MU045/49103 or MU075/49112 Not to be used in combination with MU065/49109 <b>Flag if used</b>
MU085/49115	Total joint replacement	Use of this item rarely seen in WorkCover NSW claims <b>Flag if used</b>
MU086/49116	Total replacement arthroplasty, revision including removal of prosthesis	Use of this item rarely seen in WorkCover NSW claims <b>Flag if used</b>
MU087/49117	Total replacement arthroplasty, revision procedure with bone grafting or removal or prosthesis	Use of this item rarely seen in WorkCover NSW claims <b>Flag if used</b>
MU095/49118	Diagnostic arthroscopy	Not to be used with any other <b>arthroscopic</b> procedure of the elbow region Appropriate for use with open elbow surgery
MU105/49121	Arthroscopic surgery of elbow	Involving any one or more of: drilling of defect, removal of loose body, release of contracture or adhesions, chondroplasty, or osteoplasty (not a service associated with any other <b>arthroscopic</b> procedure of the elbow joint)
<b>OTHER</b>		
EA365/30111	Bursa (large) including olecranon, calcaneum or patella, excision of	May be used in combination with olecranon bursa <b>Flag if used in combination with any shoulder surgery</b> Not to be used in combination with MT800/48960
LN810/39330	Neurolysis by open operation without transposition	Not being a service associated with a service to which item LN740/39312 applies Can be used in combination with elbow surgery Not to be used in combination with MT760/48948 <b>Flag if used in combination with any item codes for shoulder surgery</b>
<b>LIMB LENGTHENING AND DEFORMITY CORRECTION</b>		
MZ330/50405	Elbow, flexorplasty, or tendon transfer to restore elbow function	May be seen in distal biceps reconstruction Use of this item rarely seen in WorkCover NSW claims – set of item numbers address congenital conditions <b>Flag if used</b>
<b>OTHER JOINTS</b>		
MY035/50106	Joint, stabilisation of, involving one or more of: repair of capsule, repair of ligament or internal fixation	Not being a service to which another item in this Group applies Appropriate to be used with MT610/48903 and MR210/47966

<i>AMA/CMBS item code</i>	<i>Descriptor</i>	<i>Clinical indication</i>
MY055/50112	Cicatricial flexion or extension contraction of joint, correction of, involving tissues deeper than skin and subcutaneous tissue, not being a service to which another item in this group applies	Not to be used with any other <b>arthroscopic</b> procedure of the shoulder region Not to be used in combination with item code MT780/48954 <b>Flag if used in combination with any item code for elbow and shoulder surgery</b> Implies a release for stiffness after injury or surgery. May occur with other numbers in relation to a large release of the stiff elbow. Three to five item numbers should be in association with an operation that took two to three hours and is usually a revision situation or after serious trauma. The complexity should be reflected in the history of injury, number of prior operations, duration of surgery, complexity of the operation note.
MY065/50115	Joint or joints, manipulation of, performed in the operating theatre of a hospital	Not to be used for an 'examination' of a joint under general anaesthetic prior to an operation, where the general anaesthetic is for the operation itself Not being a service associated with a service to which another item in this group applies <b>Flag if this item code is used two or more times</b>
MY105/50127	Joint or joints, arthroplasty of, by any technique	Not being a service to which another item applies Not to be used in combination with any item code for shoulder, elbow or sternoclavicular surgery
<b>GENERAL</b>		
MP455/47429	Humerus, proximal, treatment of fracture of, by open reduction	
MP465/47432	Humerus, proximal, treatment of intra-articular fracture of, by open reduction	
MP485/47438	Humerus, proximal, treatment of fracture of, and associated dislocation of shoulder, by open reduction	
MP495/47441	Humerus, proximal, treatment of intra-articular fracture of, and associated dislocation of shoulder, by open reduction	
MR020/47903	Epicondylitis, open operation for	Tennis elbow Not to be used in combination with MS045/48412 <b>Flag if used</b>
MR110/47927	Buried wire, pin or screw, one or more of, which were inserted for internal fixation purposes, removal of, in the operating theatre of a hospital	Per bone
MR120/47930	Plate, rod or nail and associated wires, pins or screws, one or more of, all of which were inserted for internal fixation purposes, removal of	Not being a service associated with a service to which item MR100/47924 or MR110/47927 applies - per bone

<i>AMA/CMBS item code</i>	<i>Descriptor</i>	<i>Clinical indication</i>
MR170/47954	Tendon, repair of, as an independent procedure	Can be used in treating biceps tenodesis <b>Flag if used with any other item code</b>
MR190/47960	Tenotomy, subcutaneous	Not being a service to which another item in this group applies
MR200/47963	Tenotomy, open, with or without tenoplasty	Not being a service to which another item in this group applies Could be used in combination with MT770/48951 or MT800/48960
MR210/47966	Tendon or ligament, transfer,	As an independent procedure Could be used in combination with MT770/48951 or MT800/48960
MR220/47969	Tenosynovectomy	Not being a service to which another item in this group applies Should not be used for tennis elbow or shoulder surgery <b>Flag if used for shoulder or elbow procedures</b>



# PRIVATE ADVERTISEMENTS

## COUNCIL NOTICES

### BATHURST REGIONAL COUNCIL

Roads Act 1993, Section 10

Dedication of Land as Public Road

THE Bathurst Regional Council hereby gives notice that pursuant to section 10 of the Roads Act 1993, the land described in the Schedule below is dedicated to the public as road. D. SHERLEY, General Manager, Bathurst Regional Council, PMB 17, Bathurst NSW 2795.

#### SCHEDULE

Lot 1, DP 48361. [6319]

### BATHURST REGIONAL COUNCIL

Roads Act 1993, Section 10

Dedication of Land as Public Road

THE Bathurst Regional Council hereby gives notice that pursuant to section 10 of the Roads Act 1993, the land described in the Schedule below is dedicated to the public as road. D. SHERLEY, General Manager, Bathurst Regional Council, PMB 17, Bathurst NSW 2795.

#### SCHEDULE

Lot 47, DP 843032 to be known as Bradwardine Road. [6320]

### COFFS HARBOUR CITY COUNCIL

Naming of Roads

NOTICE is hereby given that Coffs Harbour City Council, in pursuance of section 162 of the Roads Act 1993, has renamed roads as follows:

<i>Location</i>	<i>New Name</i>
South Solitary Lane off Island Road, North Sapphire Beach.	Island Lane.

STEVE McGRATH, General Manager, Coffs Harbour City Council, Locked Bag 155, Coffs Harbour NSW 2450.

[6321]

### GOULBURN MULWAREE COUNCIL

Notification of Private Lanes to be Acquired

IN pursuance of the provisions of the Roads Act 1993, the private lanes hereunder described as Lots 1, 2, 3 and 4, DP 1153258 (Victoria Avenue, Goulburn), are to be vested in Goulburn Mulwaree Council as operational land.

In accordance with section 10, Roads Act 1993, the Crown consents to the subject land in Lots 1, 2, 3 and 4, DP 1153258 (Victoria Avenue, Goulburn), being vested in Goulburn Mulwaree Council for the purpose of the Roads Act 1993.

DUNCAN GAY, M.L.C.,  
Minister for Roads and Ports

Description

*Parish – Goulburn; County – Argyle;  
Land District – Goulburn;  
L.G.A. – Goulburn Mulwaree Council*

Lots 1, 2, 3 and 4, DP 1153258 (not being land under the Real Property Act 1900).

[6322]

### OBERON COUNCIL

Roads Act 1993

Land Acquisition (Just Terms Compensation) Act 1991

Notice of Compulsory Acquisition of Land

OBERON COUNCIL declares with the approval of Her Excellency the Governor that the lands described in the Schedule below, excluding any mines or deposits of minerals in the lands, are acquired by compulsory process in accordance with the provisions of the Land Acquisition (Just Terms Compensation) Act 1991, for public road. Dated at Oberon, this 14th day of February 2012. ALAN MCCORMACK, Acting General Manager, Oberon Council, PO Box 84, Oberon NSW 2787.

#### SCHEDULE

Lot 31, DP 1156543. [6323]

### PORT MACQUARIE-HASTINGS COUNCIL

Local Government Act 1993, Section 553

Waste Water Service Extensions

NOTICE is hereby given pursuant to section 553 of the Local Government Act 1993, that Council's sewer mains have been extended to service the land described hereunder:

Lots 1501-1510, DP 1169820, Emerald Drive, Port Macquarie.

Lots 1-38, DP 1158318, Sovereign Hills, Port Macquarie.

Lot 43, DP 1171288, Sovereign Hills, Port Macquarie.

Land that is not connected thereto shall become rateable for wastewater availability charges after sixty (60) days from the date of this notice, or from the date upon which the land is connected to Council's service, whichever is the earlier. T. HAYWOOD, General Manager, Port Macquarie-Hastings Council, PO Box 84, Port Macquarie NSW 2444.

[6324]

### THE HILLS SHIRE COUNCIL

Roads Act 1993, Section 10

NOTICE is hereby given that The Hills Shire Council dedicates the land described in the Schedule below as public road under section 10 of the Roads Act 1993. GENERAL MANAGER, The Hills Shire Council, 129 Showground Road, Castle Hill NSW 2154.

#### SCHEDULE

All that piece or parcel of land known as Lot 11 in DP 1163900 in The Hills Shire Council, Parish of Field of Mars, County of Cumberland and as described in Folio Identifier 11/1163900. [6325]

**WOOLLAHRA MUNICIPAL COUNCIL**

Roads Act 1993

Land Acquisition (Just Terms Compensation) Act 1991

Notice of Compulsory Acquisition of Land

WOOLLAHRA MUNICIPAL COUNCIL declares with the approval of Her Excellency the Governor that the lands described in the Schedule below, excluding any mines or deposits of minerals in the lands, are acquired by compulsory process in accordance with the provisions of the Land Acquisition (Just Terms Compensation) Act 1991, for a public road. Dated at Woollahra, this 9th day of February 2012. GARY JAMES, General Manager, Woollahra Municipal Council, PO Box 61, Double Bay NSW 1360.

**SCHEDULE**

Lots 2, 8 and 9, DP 1156846.

[6326]

**ESTATE NOTICES**

NOTICE of intended distribution. – Estate of ROBERT BRUCE BROWN. – NSW grant made on 12 December 2011. – Any person having any claim including an application or notice of intended application for a family provision order upon the estate of Robert Bruce Brown, late of Peakhurst, in the State of New South Wales, retired train driver, who died on 26 August 2011, must send particulars of the claim to the executors, Rodney Wayne Brown and Pauline Ann Dinning, c.o. Colin J. Duff, 7 Morts Road, Mortdale NSW 2223, not more than 30 days after publication of this notice. After that time the legal personal representative intends to distribute the property in the estate having regard only to the claims affecting the estate of the deceased of which at the time of distribution the legal personal representative has notice. COLIN J. DUFF, Solicitor, 7 Morts Road, Mortdale NSW 2223 (DX11307, Hurstville), tel.: (02) 9570 2022. [6327]

**OTHER NOTICES****ESSENTIAL ENERGY****ELECTRICITY SUPPLY ACT 1995**

Land Acquisition (Just Terms Compensation) Act 1991

Notice of Compulsory Acquisition of Easement for Electricity purposes at Taralga

ESSENTIAL ENERGY declares, with the approval of Her Excellency the Governor, with the advice of the Executive Council, that the Interest in Land described in Schedule 1 to this notice the terms of which are described in Schedule 2 to this notice, are acquired by compulsory process in accordance with the provisions of the Land Acquisition (Just Terms Compensation) Act 1991, for the purposes of the Electricity Supply Act 1995.

Dated at Port Macquarie this 15th day of February 2012

TERRI BENSON,  
Managing Director  
Essential Energy

PO Box 718  
Queanbeyan 2620

**SCHEDULE 1**

Interest in Land

Easement for overhead powerlines 40 wide and variable width affecting Lots 4 and 6 in DP565065, Lot 1 in DP225509, Lot 1 in DP652469 and Lot 4 in DP231734 shown as “Proposed Easement for Overhead Powerlines 40 wide & variable width” on DP1171480

Locality

Big Hill

LGA

Upper Lachlan

Parish

Eden Forest and Kerrawary

County

Argyle

**SCHEDULE 2**

The easement for overhead powerlines listed in Schedule 1 is on the terms set out in Memorandum No. AG733122 registered on the Register held under the Real Property Act 1900 and amended as follows:

1. at the commencement of clause 1.4, insert the words, “having regard to existing access routes as far as practicable and having regard to the farming and/or grazing activities carried out or proposed to be carried out in the area of the proposed access route”;
2. in clause 1.4 after the words “all reasonable times” insert the words “where practicable on reasonable notice”;
3. at the end of clause 1.5 add the words “having regard to the farming and/or grazing activities carried out or proposed to be carried out in the area of the proposed access route”;
4. in clause 2 after the word “minimise” insert the words “inconvenience to the Landowner and/or any occupier and minimise”;
5. in clause 2 after the words “Lot Burdened” insert the words “and any improvements and/or crop or livestock on the Lot Burdened”;
6. at the end of clause 2, insert the words, “and ensure all work is done properly with all reasonable expedition”;
7. in clause 4.1, before the word “Services” insert the word “new”;
8. delete clause 4.5 and insert the following clauses 4.5 and 4.6:
  - “4.5 plant vegetation or plants within the Easement Site other than:
    - 4.5.1 low or horizontal grasses which are not capable of growing more than 3 metres high; or
    - 4.5.2 vegetation or plants as long as none of the vegetation or plants is capable of growing more than 3 metres high,
  - 4.6 plant or allow to grow new or existing crops within the Easement Site other than crops grown in normal agricultural pursuits which are not capable of growing more than 3 metres high,”
9. in the last paragraph of clause 4 of the easement memorandum after the words “may reasonably impose” insert the words “which must not be unreasonably withheld or delayed in respect of the placement of other Services which do not interfere with the rights granted by this easement or the infrastructure located within the Easement Site”;

10. insert the following clause after clause 4 and renumber the following clauses accordingly:

“5 At all times Country Energy will enter the Easement Site at its own risk and will release the Landowner from any liability, loss, damages or costs it incurs arising from it exercising its rights under this easement except to the extent any such liability, loss, damages or costs results from the negligent act or omission of the Landowner, its employees, contractors or agents.”

[6328]

**ESSENTIAL ENERGY**

**ELECTRICITY SUPPLY ACT 1995**

Land Acquisition (Just Terms Compensation) Act 1991

Notice of Compulsory Acquisition of Easement for Electricity purposes at Taralga

ESSENTIAL ENERGY declares, with the approval of Her Excellency the Governor, with the advice of the Executive Council, that the Interest in Land described in Schedule 1 to this notice the terms of which are described in Schedule 2 to this notice, are acquired by compulsory process in accordance with the provisions of the Land Acquisition (Just Terms Compensation) Act 1991, for the purposes of the Electricity Supply Act 1995.

Dated at Port Macquarie this 15th day of February 2012.

TERRI BENSON  
 Managing Director  
 Essential Energy

PO Box 718  
 Queanbeyan 2620

**SCHEDULE 1**

Interest in Land	Easement for overhead powerlines 40 wide and variable width affecting Lot 162 in DP750023 shown as “Proposed Easement for Overhead Powerlines 40 wide & variable width” on DP1171482
Locality	Bannaby
LGA	Upper Lachlan
Parish	Bannaby and Kerrawary
County	Argyle

**SCHEDULE 2**

The easement for overhead powerlines listed in Schedule 1 is on the terms set out in Memorandum No. AG733122 registered on the Register held under the Real Property Act 1900 and amended by deleting clause 4.4 and inserting the following new clause 4.4:

“4.4 plant or allow to grow trees (Exemption – limited to a single continuous distance of 400 metres of the easement, olive trees are permitted to grow but shall be limited to a maximum height of 7 metres above natural ground level; or”.

[6329]

**ESSENTIAL ENERGY**  
**ELECTRICITY SUPPLY ACT 1995**

Land Acquisition (Just Terms Compensation) Act 1991

Notice of Compulsory Acquisition of Easement for Electricity purposes at Taralga

ESSENTIAL ENERGY declares, with the approval of Her Excellency the Governor, with the advice of the Executive Council, that the Interests in Land described in Schedule 1 to this notice the terms of which are described in Schedule 2 to this notice, are acquired by compulsory process in accordance with the provisions of the Land Acquisition (Just Terms Compensation) Act 1991, for the purposes of the Electricity Supply Act 1995.

Dated at Port Macquarie this 15th day of February 2012

Terri Benson  
Managing Director  
Essential Energy

PO Box 718  
Queanbeyan 2620

SCHEDULE 1

No.	Interests in Land	Locality	LGA	Parish	County
1	Easement for overhead powerlines 40 wide and variable affecting Lot 46 in DP750023 shown as " <i>Proposed Easement for Overhead Powerlines 40 wide &amp; variable width</i> " on DP1171480	Big Hill	Upper Lachlan	Eden Forest and Kerrawary	Argyle
2	Easement for overhead powerlines 40 wide and variable width affecting Lots 71 and 193 in DP750001 and Lot 2 in DP750023 shown as " <i>Proposed Easement for Overhead Powerlines 40 wide &amp; variable width</i> " on DP1171481	Bannaby	Upper Lachlan	Bannaby and Kerrawary	Argyle
3	Easement for overhead powerlines 40 wide and variable width affecting Lot 4 in DP717494 and Lot 106 in DP750001 shown as " <i>Proposed Easement for Overhead Powerlines 40 wide &amp; variable width</i> " on DP1171482	Bannaby	Upper Lachlan	Bannaby and Kerrawary	Argyle
4	Easement for overhead powerlines 40 wide and variable width affecting Lot 1 in DP750023 and Lot 109 in DP750023 shown as " <i>Proposed Easement for Overhead Powerlines 40 wide &amp; variable width</i> " on DP1171482	Bannaby	Upper Lachlan	Bannaby and Kerrawary	Argyle
5	Easement for overhead powerlines 40 wide and variable width affecting Lot 132 in DP750001 shown as " <i>Proposed Easement for Overhead Powerlines 40 wide &amp; variable width</i> " on DP1171482	Bannaby	Upper Lachlan	Bannaby and Kerrawary	Argyle
6	Easement for overhead powerlines 40 wide and variable width affecting Lot 111 in DP750023 and 151 in DP750021 shown as " <i>Proposed Easement for Overhead Powerlines 40 wide &amp; variable width</i> " on DP1171482	Bannaby	Upper Lachlan	Bannaby and Kerrawary	Argyle
7	Easement for overhead powerlines 40 wide and variable width affecting Lot 2 in DP1078823 shown as " <i>Proposed Easement for Overhead Powerlines 40 wide &amp; variable width</i> " on DP1171482 excepting the easement for transmission line 60.96 wide created by registered dealing N607432	Bannaby	Upper Lachlan	Bannaby and Kerrawary	Argyle
8	Easement for overhead powerlines 40 wide and variable width affecting Lot 2 in DP1163263 shown as " <i>Proposed Easement for Overhead Powerlines 40 wide &amp; variable width</i> " on DP1171499 excepting the right of carriageway over track in use created by registered dealings AF204248 and AF223178	Bannaby	Upper Lachlan	Bannaby	Argyle
9	Easement for overhead powerlines 40 wide and variable width affecting Lot 11 in DP626118 shown as " <i>Proposed Easement for Overhead Powerlines 40 wide &amp; variable width</i> " on DP1171498	Taralga	Upper Lachlan Shire	Strathaird	Argyle

SCHEDULE 2

The easements for overhead powerlines listed in Schedule 1 are on the terms set out in Memorandum No. AG733122 registered on the Register held under the Real Property Act 1900. [6330]

Authorised to be printed

ISSN 0155-6320

TONY DUCKMANTON, Government Printer.