

Government Gazette

of the State of
New South Wales

Number 48
Friday, 4 May 2018

The New South Wales Government Gazette is the permanent public record of official NSW Government notices. It also contains local council, private and other notices.

From 1 January 2018, each notice in the Government Gazette has a unique identifier that appears in square brackets at the end of the notice and that can be used as a reference for that notice (for example, [n2018-14]).

The Gazette is compiled by the Parliamentary Counsel's Office and published on the NSW legislation website (www.legislation.nsw.gov.au) under the authority of the NSW Government. The website contains a permanent archive of past Gazettes.

To submit a notice for gazettal – see Gazette Information.

GOVERNMENT NOTICES

Appointments

CONSTITUTION ACT 1902

Ministerial arrangements for the Minister for Transport and Infrastructure

Pursuant to section 36 of the *Constitution Act 1902*, His Excellency the Governor, with the advice of the Executive Council, has authorised the Honourable Melinda Pavey MP to act for and on behalf of the Minister for Transport and Infrastructure on and from 6 to 13 May 2018, inclusive.

Dated: 2 May 2018

GLADYS BEREJIKLIAN, MP
Premier

[n2018-1450]

INDUSTRIAL RELATIONS ACT 1996

INDUSTRIAL RELATIONS COMMISSION OF NSW REAPPOINTMENT OF COMMISSIONER

HIS Excellency the Governor, with the advice of the Executive Council, and in pursuance of Section 148 of the *Industrial Relations Act 1996*, approved on 26 April 2018 the reappointment of John Vincent Murphy as a Commissioner of the Industrial Relations Commission of New South Wales, commencing on 27 July 2018 and ending on 26 July 2021.

DOMINIC PERROTTET, MP
Minister for Industrial Relations

[n2018-1451]

Roads and Maritime Notices

MARINE SAFETY ACT 1998

MARINE NOTICE

Section 12(2)

REGULATION OF VESSELS – EXCLUSION ZONE

Revocation and Replacement

This Marine Notice revokes and replaces Notice SO1838, published in Government Gazette No 45 of 20 April 2018

Location

Murray River – 150 metres upstream and downstream of the Barham Bridge, Barham.

Duration

Saturday 30 September 2017 to Friday 29 June 2018 during the following times:

- 7.00am to 6.00pm seven days per week

Detail

Maintenance works will be conducted on the Barham Bridge at the above times.

An **EXCLUSION ZONE** is specified for the duration and will be created in the above location.

The exclusion zone will be marked by the presence of “channel blocked” markers and fixed signage. The markers will comprise three shapes in a vertical line (ball – triangle – ball) by day, and lights in a vertical line (red – green – red) by night.

Unauthorised vessels and persons are strictly prohibited from entering the exclusion zone.

Note: The only navigable channel during the works is the central channel under the Lift Span. Vessel operators are cautioned that the vertical clearance through this span is 5.3m above riverbed – which will be reduced naturally as the prevailing water column rises on any day.

All vessel operators and persons using the waters specified above should keep a proper lookout and exercise extreme caution near the exclusion zone and check vessel heights at a slow speed prior to navigating through the central channel.

Penalties may apply (section 12(5) – *Marine Safety Act 1998*)

For full details visit the Roads and Maritime Services website – www.rms.nsw.gov.au/maritime

Marine Notice: SO1839

Date: 24 April 2018

Christian Cochrane
A/Manager Operations South
Delegate

[n2018-1452]

MARINE SAFETY ACT 1998

MARINE NOTICE

Section 12(2)

REGULATION OF VESSELS – EXCLUSION ZONE & SPECIAL RESTRICTIONS

Location

St Georges Basin, Basin View – within an area bounded by:

- A point 200 metres south of Basin View boat ramp, to
- Tallyan Point, to
- 200 metres west from the western tip of Garden island, to
- Bream Point, to
- Picnic Point.

Duration

8.00am to 5.00pm Saturday – 26 May 2018 and Sunday 27 May 2018.

Detail

Competitive ski racing will be conducted on the waters of St Georges Basin, involving the use of high speed power vessels which will be active in the area on both days during the above times.

There will also be support vessels present to manage the event, persons in the water from time to time, and persons being towed at speed using tow-lines – presenting a significant potential hazard to other waterway users.

An **EXCLUSION ZONE** is specified during the event at the location specified above.

Unauthorised vessels and persons are strictly prohibited from entering the exclusion zone – which will be marked by buoys and patrolled by Roads and Maritime and official control vessels.

Two ‘transit lanes’ will be established along the foreshore of St Georges Basin within which a patrol vessel or a control vessel may, at times during the event, authorise local vessel traffic to pass through and within the confines of the transit lane:

- From the Basin View public boat ramp in a south-easterly direction to Picnic Point, at the entrance to Wandandian Creek.
- From the Basin View public boat ramp in an easterly direction to Tallyan Point.

SPECIAL RESTRICTIONS apply to vessels using the transit lane. Pursuant to section 12(3) of the *Marine Safety Act 1998*, vessels navigating the transit lane must do so at a speed not exceeding 4 knots, must produce no wash, and must comply with any direction given.

All users of St Georges Basin in the vicinity of the event are requested to be aware of the above, keep a proper lookout, keep well clear of competing and support vessels, and exercise extreme caution.

Penalties may apply (section 12(5) – *Marine Safety Act 1998*)

For full details visit the Roads and Maritime Services website – www.rms.nsw.gov.au/maritime

Marine Notice: SO1830

Date: 23 April 2018

Christian Cochrane
A/Manager Operations South
Delegate

[n2018-1453]

TRANSPORT ADMINISTRATION ACT 1988

LAND ACQUISITION (JUST TERMS COMPENSATION) ACT 1991

Notice of Compulsory Acquisition of Land in the Local Government Area of Newcastle

Transport for NSW by its delegate declares, with the approval of His Excellency the Governor, that the land described in the schedule below is acquired by compulsory process under the provisions of the *Land Acquisition (Just Terms Compensation) Act 1991* as authorised by clause 11 of Schedule 1 of the *Transport Administration Act 1988* for the purposes of the *Transport Administration Act 1988*.

Stephen Troughton
Deputy Secretary
Infrastructure and Services
Transport for NSW

SCHEDULE

All that piece of land situated in the Local Government Area of Newcastle, Parish of Newcastle, County of Northumberland, comprising Lot 1 in Deposited Plan 1237349, being part of the land in Certificate of Title 11/1098216, part of the land in Certificate of Title 2/95186 and part of the land in Certificate of Title 5/95186 said to be in the possession of Newcastle City Council.

Transport for NSW Document Number: 5954603_1

[n2018-1454]

Mining and Petroleum Notices

Persuant to section 136 of the *Mining Act 1992* and section 16 of the *Petroleum (Onshore) Act 1991*

NOTICE is given that the following applications have been received:

EXPLORATION LICENCE APPLICATIONS

(T18-1064)

No. 5673, AUSTRALIAN PRECIOUS METALS CORPORATION PTY LTD (ACN 624701131), area of 97 units, for Group 1, dated 26 April, 2018. (Armidale Mining Division).

(T18-1065)

No. 5674, EASTERN COBALT PTY LTD (ACN 625745600), area of 19 units, for Group 1, dated 27 April, 2018. (Sydney Mining Division).

(T18-1066)

No. 5675, EASTERN COBALT PTY LTD (ACN 625745600), area of 33 units, for Group 1, dated 27 April, 2018. (Sydney Mining Division).

(T18-1068)

No. 5676, AUSTRALIAN CONSOLIDATED GOLD HOLDINGS PTY LTD (ACN 619 975 405), area of 81 units, for Group 1, dated 30 April, 2018. (Orange Mining Division).

MINING LEASE APPLICATION

(T18-1063)

No. 29, THE AUSTRAL BRICK CO PTY LTD (ACN 000 005 550), area of about 2.662 hectares, to mine for clay/shale, kaolin and structural clay, dated 20 April, 2018. (Sydney Mining Division).

NOTICE is given that the following application has been withdrawn:

EXPLORATION LICENCE APPLICATION

(T17-1185)

No. 5582, WESTERN WOOD CAPITAL PTY LTD (ACN 616068832), County of Gipps, Map Sheet (8231, 8331). Withdrawal took effect on 26 April, 2018.

NOTICE is given that the following applications for renewal have been received:

(V18-1219)

Exploration Licence No. 7544, MINERALS AUSTRALIA PTY LTD (ACN 124 475 538), area of 5 units. Application for renewal received 24 April, 2018.

(V18-1233)

Exploration Licence No. 8104, ANGEL JADE PTY LTD (ACN 146 720 578), area of 22 units. Application for renewal received 26 April, 2018.

(V18-1216)

Mining Lease No. 259 (Act 1973), CSR BUILDING PRODUCTS LIMITED (ACN 008 631 356), area of 11.1 hectares. Application for renewal received 20 April, 2018.

RENEWAL OF CERTAIN AUTHORITIES

Notice is given that the following authorities have been renewed:

(Z12-2099)

Mineral Claim Converted To Lease No. 13 (Act 1992), STEPHEN ROY HOARE,, Map Sheet (), area of 2500 square metres, for a further term until 30 June, 2023. Renewal effective on and from 17 April, 2018.

(Z12-2100)

Mineral Claim Converted To Lease No. 14 (Act 1992), STEPHEN ROY HOARE,, Map Sheet (), area of 2500 square metres, for a further term until 30 June, 2023. Renewal effective on and from 18 April, 2018.

(T97-1000)

Mineral Claim Converted To Lease No. 293 (Act 1992), RILEY WARD, Parish of Yancowinna, County of Yancowinna, Map Sheet (7234-2-N), area of 2 hectares, for a further term until 30 June, 2023. Renewal effective on and from 18 April, 2018.

The Honourable Don Harwin MLC
Minister for Resources

[n2018-1455]

APPLICATIONS TO TRANSFER RECEIVED

Notice is given that the following applications to transfer have been received:

(V18-1228)

ANGLO AMERICAN EXPLORATION (AUSTRALIA) PTY LTD, (ACN 006 195 982) has applied for approval to transfer Exploration Licence No. 5574 to PROSPECTORE LIMITED, (ACN 619 426 952). Application received 26 April, 2018.

[n2018-1456]

**COAL SERVICES HEALTH MONITORING REQUIREMENTS FOR
COAL MINE WORKERS ORDER No. 43
under the
COAL INDUSTRY ACT 2001**

Coal Services Pty Limited (A.C.N 099 078 234), an approved company under the *Coal Industry Act 2001* (“the Act”), with the approval of the Hon. Don Harwin, MLC, Minister for Resources, and in pursuance of section 13 of the Act, makes the following Order.

Dated this 28th day of March 2018.

Peter Jordan
Chair
Coal Services Pty Limited

Lucy Flemming
Managing Director/CEO
Coal Services Pty Limited

Approved by the Hon. Don Harwin, MLC, Minister for Resources,
on this 23rd day of April 2018.

The Hon. Don Harwin, MLC
Minister for Resources

**COAL SERVICES HEALTH MONITORING REQUIREMENTS FOR
COAL MINE WORKERS ORDER NO. 43
under the
COAL INDUSTRY ACT 2001**

1. Name of Order

This Order is the Coal Services Health Monitoring Requirements for Coal Mine Workers Order No. 43

2. Commencement

This Order commences on 1 July 2018.

3. Revocation

The Coal Services – Health Surveillance Requirements for New South Wales Coal Workers Order No. 41 published in the NSW Government Gazette No. 14 on 11 February 2011 at pages 565 – 567, including any associated schedules made or published on or after that date, is revoked.

4. Interpretation

In this Order:

Annual Calibration Statement means a statement provided every 12 months by a doctor (or the medical practice at which the doctor practices) certifying that the equipment the doctor will use to perform medical assessments in accordance with the requirements of this Order has been properly calibrated and attaches any evidence of such calibration.

approved medical practitioner means a doctor who:

- a) is registered by the Medical Board of Australia to practice medicine in Australia; and
- b) has completed the NSW Coal Industry Medical Induction Program run by Coal Services; and
- c) has provided an Annual Calibration Statement to Coal Services; and
- d) has completed a course in spirometry interpretation included in the 'List of spirometry interpretation training courses' published on the Coal Services website (as may be updated from time to time); and
- e) is listed in the Register of Approved Medical Practitioners published on the Coal Services website, as may be updated from time to time.

approved radiologist means a radiologist listed on the Coal Workers Pneumoconiosis Register published on the Royal Australian and New Zealand College of Radiologists website at <https://www.ranzcr.com/fellows/clinical-radiology/quality-assurance-and-accreditation>, as may be updated from time to time.

coal mine worker means a person who carries out work at a coal mine for a person conducting a business or undertaking. It does not include a person who works in an environment in which they are not exposed to coal dust, unless the person has previously worked in an area of a coal mine in which they were exposed to coal dust.

Coal Services means Coal Services Pty Limited (A.C.N 099 078 234).

Coal Services website means the website maintained by Coal Services at www.coalservices.com.au.

Respiratory fit-testing means a quantitative assessment of the fitting of personal respiratory protective equipment to ensure that it fits closely to a person's face so as to minimise the risk of exposure to airborne contaminants.

person conducting a business or undertaking has the same meaning given to that term under section 5 of the *Work Health and Safety Act 2011*.

registered nurse means a Registered Nurse (Division 1) registered by the Nursing and Midwifery Board of Australia to practice nursing in Australia and who has completed a course in audiometry included in the 'List of audiometry training courses' published on the Coal Services website (as may be updated from time to time).

spirometry means:

- a) testing carried out by an approved medical practitioner or registered nurse who has completed a course in spirometry included in the 'List of spirometry training courses' published on the Coal Services website (as may be updated from time to time); and
- b) interpretation of the results of such testing by an approved medical practitioner.

worker means a person who is about to commence work at a coal mine for a person conducting a business or undertaking, including a person who has previously worked at a coal mine and is about to commence work at a different coal mine.

5. Application of this Order

This Order applies to a person conducting a business or undertaking that employs, contracts or otherwise engages a worker or coal mine worker to carry out work for the business or undertaking at a coal mine.

6. Requirement for Pre-Placement Medical Assessment

- a) A person conducting a business or undertaking must ensure that, before a worker commences work for the business or undertaking:
 - i. the person has caused the worker to undergo (or is satisfied the worker has undergone) a medical assessment in relation to the matters specified in Schedule 1, carried out by an approved medical practitioner within the previous 12 months (a "*Pre-Placement Medical Assessment*"); and
 - ii. a report of that assessment (a "*Pre-Placement Medical Assessment Report*") has been provided to the Senior Medical Officer, Coal Services.
- b) The Pre-Placement Medical Assessment Report must be in the form and contain the information (including

results) required by Coal Services.

- c) The person conducting a business or undertaking who causes a worker to undergo a Pre-Placement Medical Assessment under (a) (i) must provide the following information to the approved medical practitioner:
 - i. the name and address of the person conducting the business or undertaking;
 - ii. the name and date of birth of the worker;
 - iii. whether the person conducting a business or undertaking is a mine operator, a contractor carrying out work at a mine or a labour hire company; and
 - iv. the work that the worker will be carrying out.

7. Requirement for Pre-Placement Chest X-Ray

- a) A person conducting a business or undertaking must ensure that, before a worker commences work for the business or undertaking:
 - i. the person has caused the worker to undergo, or is satisfied the worker has undergone, a chest x-ray (a "*Pre-Placement Chest X-Ray*"); and
 - ii. a report of that x-ray (a "*Pre-Placement Chest X-Ray Report*") has been provided to the Senior Medical Officer, Coal Services.
- b) The Pre-Placement Chest X-Ray must have been done:
 - i. for a worker who has previously carried out work at an underground coal mine – within the previous 3 years or the shorter interval recommended in the worker's last Pre-Placement Medical Assessment Report or Periodic Medical Assessment Report (whichever was completed later);
 - ii. for a worker who has previously carried out work at a surface coal mine and was involved in production, processing or maintenance tasks – within the previous 3 years or the shorter interval recommended in the worker's last Pre-Placement Medical Assessment Report or Periodic Medical Assessment Report (whichever was completed later);
 - iii. for all other workers – within the previous 6 years.
- c) The reference to a time interval in (b) (for example, 3 years, 6 years, or other recommended interval) means by 31 December of that year.
- d) The Pre-Placement Chest X-Ray Report must:
 - i. be in the form and contain the information (including results) required by Coal Services; and
 - ii. have been prepared by an approved radiologist in accordance with the International Labour Organisation (ILO) International Classification of Radiographs of Pneumoconioses.

8. Requirement for Periodic Medical Assessment

- a) A person conducting a business or undertaking must ensure that:
 - i. every 3 years each coal mine worker carrying out work for the business or undertaking undergoes a medical assessment carried out by an approved medical practitioner or a registered nurse supervised by an approved medical practitioner in relation to the matters specified in Schedule 2 (a "*Periodic Medical Assessment*"); and
 - ii. a report of that assessment (a "*Periodic Medical Assessment Report*") is provided to the Senior Medical Officer, Coal Services and to that coal mine worker within 4 weeks of the assessment taking place.
- b) The reference to 3 years in (a) (i) means by 31 December of that year.
- c) The person conducting a business or undertaking who has caused a coal mine worker to undertake a Periodic Medical Assessment must provide the following information to the approved medical practitioner carrying out or supervising the assessment:
 - i. the name and address of the person conducting the business or undertaking;
 - ii. the name and date of birth of the coal mine worker;
 - iii. whether the person conducting a business or undertaking is a mine operator, a contractor carrying out work at a mine or a labour hire company;
 - iv. the work that the coal mine worker is carrying out; and
 - v. how long the coal mine worker has been carrying out that work.
- d) The person conducting a business or undertaking must allow a coal mine worker to undertake a Periodic Medical Assessment during their normal weekly roster (except where this conflicts with a registered enterprise agreement, in which case the terms of the registered enterprise agreement will prevail).
- e) The person conducting a business or undertaking must pay for all costs in relation to the coal mine worker's attendance at any Periodic Medical Assessment.

- f) The Periodic Medical Assessment Report must be in the form and contain the information (including results) required by Coal Services.

9. Requirement for Periodic Chest X-Rays

- a) The person conducting a business or undertaking must ensure that:
 - i. each coal mine worker carrying out work for the business or undertaking undergoes a chest x-ray:
 - I. for an underground coal mine worker – every 3 years or the shorter interval recommended in the worker’s last Pre-Placement Medical Assessment Report or Periodic Medical Assessment Report (whichever was completed later);
 - II. for a surface coal mine worker involved in production, processing or maintenance tasks – every 3 years or the shorter interval recommended in the worker’s last Pre-Placement Medical Assessment Report or Periodic Medical Assessment Report (whichever was completed later);
 - III. for all other coal mine workers – every 6 years;
(a “*Periodic Chest X-Ray*”); and
 - ii. a report of that x-ray (a “*Periodic Chest X-Ray Report*”) is provided to the Senior Medical Officer, Coal Services and to that coal mine worker within 4 weeks of the x-ray taking place.
- b) The reference to a time interval in (a) (i) (for example, 3 years, 6 years, or other recommended interval) means by 31 December of that year.
- c) The Periodic Chest X-Ray Report must:
 - i. be in the form and contain the information (including results) required by Coal Services; and
 - ii. be prepared by an approved radiologist in accordance with the International Labour Organisation (ILO) International Classification of Radiographs of Pneumoconioses.

10. Requirement for Exit Medical Assessment

- a) The person conducting a business or undertaking must ensure that:
 - i. a medical assessment in relation to the matters specified in Schedule 2 (excluding Respiratory fit-testing) is offered to each coal mine worker who is retiring or otherwise ceasing work for the business or undertaking (an “*Exit Medical Assessment*”); and
 - iii. a report of any such assessment (an “*Exit Medical Assessment Report*”) is provided to the Senior Medical Officer, Coal Services and to that coal mine worker within 4 weeks of the assessment taking place.
- b) The Exit Medical Assessment must be carried out by an approved medical practitioner or a registered nurse supervised by an approved medical practitioner.
- c) The person conducting a business or undertaking who has commissioned an Exit Medical Assessment must provide the following information to the approved medical practitioner carrying out or supervising the assessment:
 - i. the name and address of the person conducting the business or undertaking;
 - ii. the name and date of birth of the coal mine worker;
 - iii. whether the person conducting a business or undertaking is a mine operator, a contractor carrying out work at a mine or a labour hire company;
 - iv. the work that the coal mine worker has been carrying out; and
 - v. how long the coal mine worker has been carrying out that work.
- d) The Exit Medical Assessment Report must be in the form and contain the information (including results) required by Coal Services.

11. Requirement to provide list of coal mine workers

- a) The person conducting a business or undertaking must provide a list containing the full name and date of birth of each coal mine worker who has carried out work for the business or undertaking in the previous 12 months, to the Senior Medical Officer, Coal Services, by 31 October each year.

SCHEDULE 1

Pre-Placement Medical Assessment

1. Name and date of birth of the worker.
2. Name and registration number of the approved medical practitioner carrying out the Assessment.
3. Name and address of the person conducting the business or undertaking who requested the Assessment.
4. Date(s) the Assessment was carried out.
5. Detailed work history of the worker.
6. Detailed medical history, including any past or present disease or injury and any use of medication.
7. Spirometry and a review of the respiratory system, including the completion of a standardised respiratory questionnaire based on the MRC (UK) Respiratory Questionnaire 1986.
8. Hearing assessment, including audiometry.
9. Vision assessment, including visual fields and colour vision.
10. Full musculoskeletal assessment that pays particular attention to any previous injury or underlying condition.
11. Cardiovascular assessment.
12. Blood pressure assessment.
13. Urinalysis.
14. Body Mass Index (BMI).
15. Waist/Hip ratio.
16. Clinical examination and general health review, including tobacco smoking history, alcohol consumption and physical activity.
17. Neurological examination with particular attention to sensory or balance disorders, including the Romberg test for balance.
18. Respiratory fit-testing for a worker who will undertake tasks relating to production, processing or maintenance at a coal mine for the first time
19. Review of any previous chest x-rays carried out in relation to the worker.
20. Conclusions and recommendations including:
 - a. any advice that test results indicate that the worker may have contracted a disease, injury or illness as a result of carrying out the work;
 - b. overall fitness of the worker for the proposed position, including any recommendations or work restrictions.

SCHEDULE 2

Periodic Medical Assessment and Exit Medical Assessment

1. Name and date of birth of the coal mine worker.
2. Name and registration number of the approved medical practitioner carrying out the Assessment.
3. Name and address of the person conducting the business or undertaking who requested the Assessment.
4. Date(s) the Assessment was carried out.
5. Detailed work history of the coal mine worker.
6. Detailed medical history that pays particular attention to any disease or injury, both work and non-work related. It must also include a review of any medication usage.
7. Spirometry and a review of the respiratory system, including the completion of a standardised respiratory questionnaire based on the MRC (UK) Respiratory Questionnaire 1986.
8. Hearing assessment, including audiometry.
9. Vision assessment, including visual fields and colour vision.
10. Blood pressure assessment.
11. Urinalysis, cholesterol check (non-fasting), blood sugar level, Body Mass Index (BMI), Waist Hip ratio.
12. The Kessler Psychological Distress Scale (K10): The questionnaire aims to identify workers with significant levels of psychological distress so that they may be appropriately managed with respect to their ongoing health and wellbeing.
13. The Epworth Sleepiness Scale (ESS): This assessment is intended to measure daytime sleepiness and can be helpful in diagnosing sleep disorders.
14. Alcohol Audit: The Alcohol Use Disorders Identification Test (AUDIT) was developed by the World Health Organisation (WHO) as a simple method of screening for excessive alcohol consumption. It provides a framework for intervention to help risk or high-risk drinkers to reduce or cease their alcohol consumption. It also helps to identify alcohol dependence.
15. Cardiovascular Risk Assessment: A rating based on guidelines that have been developed for use by Physicians to assess the risk of cardiovascular disease (CVD) in adults without known CVD. The ranking is based on guidelines produced by the Australian 'National Vascular Disease Prevention Alliance' and the American Heart Association.
16. Hazard exposure questionnaire identifying all potential environmental hazards a coal mine worker may be exposed to and includes information on the use of personal protective equipment.
17. Work related skin disease questionnaire.
18. Musculoskeletal questionnaire.
19. Respiratory fit-testing (excluding Exit Medical Assessment).
20. Review of any previous chest x-rays carried out in relation to the coal mine worker.
21. Conclusions and recommendations including:
 - a. any advice that test results indicate that the coal mine worker may have contracted a disease, injury or illness as a result of carrying out the work;
 - b. any recommendation that the person conducting the business or undertaking take remedial measures, including whether the coal mine worker can continue to carry out the work; and
 - c. whether medical counselling is required for the coal mine worker in relation to the work.

Notes.

1. The Act provides that a person (an individual or a corporation) must not, without reasonable excuse, refuse or fail to comply with this Order – Maximum penalty: 200 penalty units in the case of a corporation or 50 penalty units in the case of an individual.
2. The data obtained from assessments under this Order will be entered by Coal Services into its Health Assessment Database for the purpose of monitoring the health of the New South Wales coal industry. This will enable Coal Services to report on health trends, provide advice to relevant Government agencies, the Minister and to coal mines. In doing so, the provisions of the *Privacy and Personal Information Protection Act 1998* and the *Health Records and Information Privacy Act 2002* will be adhered to.
3. A hazard exposure questionnaire, work related skin disease questionnaire and musculoskeletal questionnaire have been developed by Coal Services for the New South Wales coal industry and are available on request for use in assessments.
4. The legislation referred to in this Order is available from www.legislation.nsw.gov.au. For further information contact Coal Services on (02) 8270 3200.

Primary Industries Notices

GAME AND FERAL ANIMAL CONTROL (SUSPENSION OF GAME HUNTING LICENCE CONDITIONS) ORDER (NO.2) 2018

under the

Game and Feral Animal Control Regulation 2012

I, ANDREW MORIARTY, Director, Game Licensing, with the delegated authority of the Regulatory Authority in pursuance of section 53A of the *Game and Feral Animal Control Act 2012*, and in pursuance of clause 18 of the *Game and Feral Animal Control Regulation 2012*, make the following Order.

Dated this 30th day of April 2018

ANDREW MORIARTY
Director Game Licensing
Department of Primary Industries
(an office within the Department of Industry)

GAME AND FERAL ANIMAL CONTROL (SUSPENSION OF GAME HUNTING LICENCE CONDITIONS) ORDER (NO.2) 2018

under the

Game and Feral Animal Control Regulation 2012

1. Name of Order

This Order is the *Game and Feral Animal Control (Suspension of Game Hunting Licence Conditions) Order (No2) 2018*.

2. Commencement

This Order commences on the date it is published in the NSW Government Gazette.

3. Definitions

In this Order:

game animal has the same meaning as in the Act.

game hunting licence has the same meaning as in the Act.

Regulatory Authority has the same meaning as in the Act.

the Act means the *Game and Feral Animal Control Act 2002*.

the Regulation means the *Game and Feral Animal Control Regulation 2012*.

4. Suspension of certain conditions of game hunting licences

Pursuant to clause 18 of the Regulation, the operation of subclauses 5(1), 6(1), 8(1), 9(1) and 10(1) of Schedule 1 to the Regulation, being prescribed conditions of game hunting licences, are suspended:

- (a) for the period from the commencement of this Order to 4 May 2021 (both dates inclusive);
- (b) in relation to the land specified in Schedule 1, being land that is the subject of a management plan dealing with the management or control of fallow deer (*Dama dama*), red deer (*Cervus elaphus*), Wapiti deer (*Cervus elephus canadensis*), rusa deer (*Cervus timorensis*), sambar deer (*Cervus unicolor*), chital deer (*Axis axis*) and hog deer (*Axis porcinus*) on that land; and
- (c) on the condition that the operation of this suspension is limited to the management or control of fallow deer (*Dama dama*), red deer (*Cervus elaphus*), Wapiti deer (*Cervus elephus canadensis*), rusa deer (*Cervus timorensis*), sambar deer (*Cervus unicolor*), chital deer (*Axis axis*) and hog deer (*Axis porcinus*) on the land specified in Schedule 1.

Schedule 1 Land

(Clause 4(b))

The lands consisting of:

- (a) All private and public land within the Port Macquarie Hastings Local Government Area excluding areas that have been declared for the purposes of hunting under the *Game and Feral Animal Control Act 2002*.

- (b) All private and public land within the Kempsey Local Government Area excluding areas that have been declared for the purposes of hunting under the *Game and Feral Animal Control Act 2002*.
- (c) All private and public land within the Coffs Harbour Local Government Area excluding areas that have been declared for the purposes of hunting under the *Game and Feral Animal Control Act 2002*.
- (d) All private and public land within the Nambucca Local Government Area excluding areas that have been declared for the purposes of hunting under the *Game and Feral Animal Control Act 2002*.

[n2018-1458]

Crown Land Notices

1300 886 235 www.crownland.nsw.gov.au

NOTIFICATION OF CLOSING OF A ROAD

In pursuance of the provisions of the *Roads Act 1993*, the road hereunder described is closed and the lands comprised therein cease to be public road and the rights of passage and access that previously existed in relation to the road is extinguished. Upon closing, title to the land, comprising the former public road, vests in the body specified in the Schedule hereunder.

The Hon Paul Toole, MP
Minister for Lands and Forestry

DESCRIPTION

Parish – Wog Wog; County – St Vincent

Land District – Braidwood; LGA – Queanbeyan-Palerang Regional

Road Closed: Lots 1-3 DP 1238880

File No: 17/09071

SCHEDULE

On closing, the land within Lots 1-3 DP 1238880 remains vested in the State of New South Wales as Crown land.

[n2018-1459]

NOTIFICATION OF CLOSING OF A ROAD

In pursuance of the provisions of the *Roads Act 1993*, the road hereunder described is closed and the lands comprised therein cease to be public road and the rights of passage and access that previously existed in relation to the road is extinguished. Upon closing, title to the land, comprising the former public road, vests in the body specified in the Schedule hereunder.

The Hon Paul Toole, MP
Minister for Lands and Forestry

DESCRIPTION

Parishes – Coolumbooka, Bombala; County – Wellesley

Land District – Bombala; LGA – Snowy Monaro Regional

Road Closed: Lots 1-6 DP 1237206, Lots 7-16 DP 1237207

File No: 16/07259

SCHEDULE

On closing, the land within Lots 1-6 DP 1237206, Lots 7-16 DP 1237207 remains vested in the State of New South Wales as Crown land.

[n2018-1460]

NOTIFICATION OF CLOSING OF A ROAD

In pursuance of the provisions of the *Roads Act 1993*, the road hereunder described is closed and the lands comprised therein cease to be public road and the rights of passage and access that previously existed in relation to the road is extinguished. Upon closing, title to the land, comprising the former public road, vests in the body specified in the Schedule hereunder.

The Hon Paul Toole, MP
Minister for Lands and Forestry

DESCRIPTION

Parish – Mingelo; County – Kennedy

Land District – Nyngan; LGA – Lachlan

Road Closed: Lots 1-2 DP 1239870

File No: 11/03563

SCHEDULE

On closing, the land within Lot 1 DP1239870 becomes vested in the State of New South Wales as Crown Land.

Council's reference: D17/1389

On closing, the land within Lot 2 DP 1239870 remains vested in the State of New South Wales as Crown land.

[n2018-1461]

NOTIFICATION OF CLOSING OF A ROAD

In pursuance of the provisions of the *Roads Act 1993*, the road hereunder described is closed and the lands comprised therein cease to be public road and the rights of passage and access that previously existed in relation to the road is extinguished. Upon closing, title to the land, comprising the former public road, vests in the body specified in the Schedule hereunder.

The Hon Paul Toole, MP
Minister for Lands and Forestry

DESCRIPTION

Parish – Binalong; County – Harden
Land District – Boorowa; LGA – Yass Valley

Road Closed: Lot 1 DP 1241221

File No: 12/04596

SCHEDULE

On closing, the land within Lot 1 DP 1241221 remains vested in the State of New South Wales as Crown land.

[n2018-1462]

NOTIFICATION OF CLOSING OF A ROAD

In pursuance of the provisions of the *Roads Act 1993*, the road hereunder described is closed and the lands comprised therein cease to be public road and the rights of passage and access that previously existed in relation to the road is extinguished. Upon closing, title to the land, comprising the former public road, vests in the body specified in the Schedule hereunder.

The Hon Paul Toole, MP
Minister for Lands and Forestry

DESCRIPTION

Parishes – Scone, Manbus; County – Brisbane
Land District – Scone; LGA – Upper Hunter

Road Closed: Lot 1 DP 1233982

File No: 13/11188 RS

SCHEDULE

On closing, the land within Lot 1 DP 1233982 remains vested in the State of New South Wales as Crown land.

[n2018-1463]



ROADS ACT 1993

ORDER

Transfer of a Crown Road to a Council

IN pursuance of the provisions of Section 151, *Roads Act 1993*, the Crown roads specified in Column 1 will be transferred to the Roads Authority specified in Column 2, hereunder, as from the date of publication of this notice and as from that date, the roads specified in Column 1 cease to be Crown roads.

The Hon Paul Toole, MP
Minister for Lands and Forestry

Column 1	Column 2
 <p>Crown public roads within town of Brunswick Heads, as shown by red colour Parish Brunswick County Rous at Brunswick Heads</p> <p>Council ref: Map 1 Brunswick Heads Lands ref: W596063 – 18/03194</p>	<p>Byron Shire Council</p>
 <p>Crown public road west of Lot 1 DP 858380 and Lot 1 DP 372733 as shown by red colour Parish Brunswick County Rous at Mullumbimby</p> <p>Councils ref: Map 1 Mullumbimby Lands ref: W596063 – 18/03194</p>	<p>Byron Shire Council</p>

NOTIFICATION OF CLOSING OF A ROAD

In pursuance of the provisions of the *Roads Act 1993*, the road hereunder described is closed and the lands comprised therein cease to be public road and the rights of passage and access that previously existed in relation to the road is extinguished. Upon closing, title to the land, comprising the former public road, vests in the body specified in the Schedule hereunder.

The Hon Paul Toole, MP
Minister for Lands and Forestry

DESCRIPTION

*Parishes – Balala, Morse; County – Hardinge
Land District – Armidale; LGA – Uralla*

Road Closed: Lot 2 DP 1233247, Lot 3 DP 1235575

File No: 14/08840

SCHEDULE

On closing, the land within Lot 2 DP 1233247, Lot 3 DP 1235575 remains vested in the State of New South Wales as Crown land.

[n2018-1465]

NOTIFICATION OF CLOSING OF A ROAD

In pursuance of the provisions of the *Roads Act 1993*, the road hereunder described is closed and the lands comprised therein cease to be public road and the rights of passage and access that previously existed in relation to the road is extinguished. Upon closing, title to the land, comprising the former public road, vests in the body specified in the Schedule hereunder.

The Hon Paul Toole, MP
Minister for Lands and Forestry

DESCRIPTION

*Parish – Cumbijowa; County – Forbes
Land District – Forbes; LGA – Forbes*

Road Closed: Lot 1 DP 1236923

File No: 17/05807 RS

SCHEDULE

On closing, the land within Lot 1 DP1236923 becomes vested in the State of New South Wales as Crown Land.

Council's reference: 15/02973

[n2018-1466]

NOTIFICATION OF CLOSING OF A ROAD

In pursuance of the provisions of the *Roads Act 1993*, the road hereunder described is closed and the lands comprised therein cease to be public road and the rights of passage and access that previously existed in relation to the road is extinguished. Upon closing, title to the land, comprising the former public road, vests in the body specified in the Schedule hereunder.

The Hon Paul Toole, MP
Minister for Lands and Forestry

DESCRIPTION

*Parish – Cambewarra; County – Camden
Land District – Nowra; LGA – Shoalhaven*

Road Closed: Lot 1 DP 1238411

File No: 17/06698 RS

SCHEDULE

On closing, the land within Lot 1 DP 1238411 remains vested in the State of New South Wales as Crown land.

[n2018-1467]

NOTIFICATION OF CLOSING OF A ROAD

In pursuance of the provisions of the *Roads Act 1993*, the road hereunder described is closed and the lands comprised therein cease to be public road and the rights of passage and access that previously existed in relation to the road is extinguished. Upon closing, title to the land, comprising the former public road, vests in the body specified in the Schedule hereunder.

The Hon Paul Toole, MP
Minister for Lands and Forestry

DESCRIPTION

Parish – Goodiman; County – Bligh
Land District – Dunedoo; LGA – Mid-Western Regional

Road Closed: Lot 2 DP 1237153

File No: 16/06560

SCHEDULE

On closing, the land within Lot 2 DP 1237153 remains vested in the State of New South Wales as Crown land.

[n2018-1468]

NOTIFICATION OF CLOSING OF A ROAD

In pursuance of the provisions of the *Roads Act 1993*, the road hereunder described is closed and the lands comprised therein cease to be public road and the rights of passage and access that previously existed in relation to the road is extinguished. Upon closing, title to the land, comprising the former public road, vests in the body specified in the Schedule hereunder.

The Hon Paul Toole, MP
Minister for Lands and Forestry

DESCRIPTION

Parish – Broome; County – Urana
Land District – Deniliquin; LGA – Murrumbidgee

Road Closed: Lots 1, 3 DP 1215652

File No: 15/05911

SCHEDULE

On closing, the land within Lots 1, 3 DP 1215652 remains vested in the State of New South Wales as Crown land.

[n2018-1469]

NOTIFICATION OF CLOSING OF A ROAD

In pursuance of the provisions of the *Roads Act 1993*, the road hereunder described is closed and the lands comprised therein cease to be public road and the rights of passage and access that previously existed in relation to the road is extinguished. Upon closing, title to the land, comprising the former public road, vests in the body specified in the Schedule hereunder.

The Hon Paul Toole, MP
Minister for Lands and Forestry

DESCRIPTION

Parish – Rockley; County – Georgiana
Land District – Bathurst; LGA – Bathurst Regional

Road Closed: Lot 1 DP 1229252

File No: 16/09792

SCHEDULE

On closing, the land within Lot 1 DP 1229252 remains vested in the State of New South Wales as Crown land.

[n2018-1470]

NOTIFICATION OF CLOSING OF A ROAD

In pursuance of the provisions of the *Roads Act 1993*, the road hereunder described is closed and the lands comprised therein cease to be public road and the rights of passage and access that previously existed in relation to the road is extinguished. Upon closing, title to the land, comprising the former public road, vests in the body specified in the Schedule hereunder.

The Hon Paul Toole, MP
Minister for Lands and Forestry

DESCRIPTION

Parish – Narooma; County – Dampier
Land District – Moruya; LGA – Eurobodalla

Road Closed: Lot 1 DP 1235983

File No: 16/05272

SCHEDULE

On closing, the land within Lot 1 DP 1235983 remains vested in Eurobodalla Shire Council as operational land for the purposes of the *Local Government Act 1993*.

In accordance with Section 44 of the *Roads Act 1993*, the Crown consents to the land in Lot 1 DP 1235983 being vested in Eurobodalla Shire Council as operational land, to be given by the Council as compensation for other land acquired by the Council for the purpose of the Roads Act.

Council Reference: 07.1502.D

[n2018-1471]

NOTIFICATION OF CLOSING OF A ROAD

In pursuance of the provisions of the *Roads Act 1993*, the road hereunder described is closed and the lands comprised therein cease to be public road and the rights of passage and access that previously existed in relation to the road is extinguished. Upon closing, title to the land, comprising the former public road, vests in the body specified in the Schedule hereunder.

The Hon Paul Toole, MP
Minister for Lands and Forestry

DESCRIPTION

Parish – Pee Dee; County – Dudley
Land District – Kempsey; LGA – Kempsey

Road Closed: Lot 2, 4 & 6 DP 1239099

File No: 17/03074

SCHEDULE

On closing, the land within Lot 2, 4 & 6 DP 1239099 remains vested in Kempsey Shire Council as operational land for the purposes of the *Local Government Act 1993*.

In accordance with Section 44 of the *Roads Act 1993*, the Crown consents to the land in Lot 2, 4 & 6 DP 1239099 being vested in Kempsey Shire Council as operational land, to be given by the Council as compensation for other land acquired by the Council for the purpose of the Roads Act.

Council Reference: F18/1650, D17/19573 IJR/ijr

[n2018-1472]

NOTIFICATION OF CLOSING OF A ROAD

In pursuance of the provisions of the *Roads Act 1993*, the road hereunder described is closed and the lands comprised therein cease to be public road and the rights of passage and access that previously existed in relation to the road is extinguished. Upon closing, title to the land, comprising the former public road, vests in the body specified in the Schedule hereunder.

The Hon Paul Toole, MP
Minister for Lands and Forestry

DESCRIPTION

*Parish – Thurgoona; County – Goulburn
Land District – Albury; LGA – Albury City*

Road Closed: Lot 1, 2 & 3 DP 1219904

File No: 09/01446

SCHEDULE

On closing, the land within Lot 1, 2 & 3 DP 1219904 remains vested in Albury City Council as operational land for the purposes of the *Local Government Act 1993*.

In accordance with Section 44 of the *Roads Act 1993*, the Crown consents to the land in Lot 1, 2 & 3 DP 1219904 being vested in Albury City Council as operational land, to be given by the Council as compensation for other land acquired by the Council for the purpose of the Roads Act.

Council Reference: FIL15/01154

[n2018-1473]

NOTIFICATION OF CLOSING OF A ROAD

In pursuance of the provisions of the *Roads Act 1993*, the road hereunder described is closed and the lands comprised therein cease to be public road and the rights of passage and access that previously existed in relation to the road is extinguished. Upon closing, title to the land, comprising the former public road, vests in the body specified in the Schedule hereunder.

The Hon Paul Toole, MP
Minister for Lands and Forestry

DESCRIPTION

*Parish – Durran Durra; County – St Vincent
Land District – Braidwood; LGA – Queanbeyan-Palerang Regional*

Road Closed: Lots 1-2 DP 1238475

File No: 16/07887

SCHEDULE

On closing, the land within Lots 1-2 DP 1238475 remains vested in the State of New South Wales as Crown land.

[n2018-1474]

NOTIFICATION OF CLOSING OF A ROAD

In pursuance of the provisions of the *Roads Act 1993*, the road hereunder described is closed and the lands comprised therein cease to be public road and the rights of passage and access that previously existed in relation to the road is extinguished. Upon closing, title to the land, comprising the former public road, vests in the body specified in the Schedule hereunder.

The Hon Paul Toole, MP
Minister for Lands and Forestry

DESCRIPTION

*Parish – Botobolar; County – Phillip
Land District – Mudgee; LGA – Mid-Western Regional*

Road Closed: Lot 1 DP 1238658

File No: 15/02052

SCHEDULE

On closing, the land within Lot 1 DP 1238658 remains vested in the State of New South Wales as Crown land.

[n2018-1475]

NOTIFICATION OF CLOSING OF A ROAD

In pursuance of the provisions of the *Roads Act 1993*, the road hereunder described is closed and the lands comprised therein cease to be public road and the rights of passage and access that previously existed in relation to the road is extinguished. Upon closing, title to the land, comprising the former public road, vests in the body specified in the Schedule hereunder.

The Hon Paul Toole, MP
Minister for Lands and Forestry

DESCRIPTION

*Parish – Awaba; County – Northumberland
Land District – Newcastle; LGA – Lake Macquarie*

Road Closed: Lot 1 DP 1237128

File No: 16/04196

SCHEDULE

On closing, the land within Lot 1 DP1237128 becomes vested in the State of New South Wales as Crown Land.

Council's reference: F2010/01005

[n2018-1476]

NOTIFICATION OF CLOSING OF A ROAD

In pursuance of the provisions of the *Roads Act 1993*, the road hereunder described is closed and the lands comprised therein cease to be public road and the rights of passage and access that previously existed in relation to the road is extinguished. Upon closing, title to the land, comprising the former public road, vests in the body specified in the Schedule hereunder.

The Hon Paul Toole, MP
Minister for Lands and Forestry

DESCRIPTION

*Parish – Mudgee; County – Wellington
Land District – Mudgee; LGA – Mid-Western Regional*

Road Closed: Lot 100 DP 1235114

File No: 16/04186

SCHEDULE

On closing, the land within Lot 100 DP 1235114 remains vested in Mid-Western Regional Council as operational land for the purposes of the *Local Government Act 1993*.

Council Reference: ROA 1000007 Perry Street

[n2018-1477]

NOTIFICATION OF CLOSING OF A ROAD

In pursuance of the provisions of the *Roads Act 1993*, the road hereunder described is closed and the lands comprised therein cease to be public road and the rights of passage and access that previously existed in relation to the road is extinguished. Upon closing, title to the land, comprising the former public road, vests in the body specified in the Schedule hereunder.

The Hon Paul Toole, MP
Minister for Lands and Forestry

DESCRIPTION

*Parish – Winduella; County – King
Land District – Crookwell; LGA – Upper Lachlan*

Road Closed: Lot 2 DP 1240669

File No: 17/11370

SCHEDULE

On closing, the land within Lot 2 DP 1240669 remains vested in the State of New South Wales as Crown land.

[n2018-1478]

NOTIFICATION OF CLOSING OF A ROAD

In pursuance of the provisions of the *Roads Act 1993*, the road hereunder described is closed and the lands comprised therein cease to be public road and the rights of passage and access that previously existed in relation to the road is extinguished. Upon closing, title to the land, comprising the former public road, vests in the body specified in the Schedule hereunder.

The Hon Paul Toole, MP
Minister for Lands and Forestry

DESCRIPTION

*Parish – Armidale; County – Sandon
Land District – Armidale; LGA – Armidale Regional*

Road Closed: Lot 3 DP 1241060

File No: 17/10790

SCHEDULE

On closing, the land within Lot 3 DP 1241060 remains vested in the State of New South Wales as Crown land.

[n2018-1479]

NOTIFICATION OF CLOSING OF A ROAD

In pursuance of the provisions of the *Roads Act 1993*, the road hereunder described is closed and the lands comprised therein cease to be public road and the rights of passage and access that previously existed in relation to the road is extinguished. Upon closing, title to the land, comprising the former public road, vests in the body specified in the Schedule hereunder.

The Hon Paul Toole, MP
Minister for Lands and Forestry

DESCRIPTION

*Parish – Gregado; County – Wynyard
Land District – Wagga Wagga; LGA – Wagga Wagga*

Road Closed: Lot 1 DP 1231296

File No: 16/07363

SCHEDULE

On closing, the land within Lot 1 DP 1231296 remains vested in the State of New South Wales as Crown land.

[n2018-1480]

NOTIFICATION OF CLOSING OF A ROAD

In pursuance of the provisions of the *Roads Act 1993*, the road hereunder described is closed and the lands comprised therein cease to be public road and the rights of passage and access that previously existed in relation to the road is extinguished. Upon closing, title to the land, comprising the former public road, vests in the body specified in the Schedule hereunder.

The Hon Paul Toole, MP
Minister for Lands and Forestry

DESCRIPTION

Parish – Colinton; County – Beresford
Land District – Cooma; LGA – Snowy Monaro Regional

Road Closed: Lot 1 DP 1230920

File No: 17/01438

SCHEDULE

On closing, the land within Lot 1 DP 1230920 remains vested in the State of New South Wales as Crown land.

[n2018-1481]

NOTIFICATION OF CLOSING OF A ROAD

In pursuance of the provisions of the *Roads Act 1993*, the road hereunder described is closed and the lands comprised therein cease to be public road and the rights of passage and access that previously existed in relation to the road is extinguished. Upon closing, title to the land, comprising the former public road, vests in the body specified in the Schedule hereunder.

The Hon Paul Toole, MP
Minister for Lands and Forestry

DESCRIPTION

Parish – Holbrook; County – Goulburn
Land District – Albury; LGA – Greater Hume Shire

Road Closed: Lot 1 DP 1238481

File No: 17/02878

SCHEDULE

On closing, the land within Lot 1 DP 1238481 remains vested in the State of New South Wales as Crown land.

[n2018-1482]

NOTIFICATION OF CLOSING OF A ROAD

In pursuance of the provisions of the *Roads Act 1993*, the road hereunder described is closed and the lands comprised therein cease to be public road and the rights of passage and access that previously existed in relation to the road is extinguished. Upon closing, title to the land, comprising the former public road, vests in the body specified in the Schedule hereunder.

The Hon Paul Toole, MP
Minister for Lands and Forestry

DESCRIPTION

Parish – Orange; County – Wellington
Land District – Orange; LGA – Orange

Road Closed: Lot 1 DP 1240987

File No: 11/11936

SCHEDULE

On closing, the land within Lot 1 DP1240987 becomes vested in the State of New South Wales as Crown Land.

Council's reference: 15/05191

[n2018-1483]

NOTIFICATION OF CLOSING OF A ROAD

In pursuance of the provisions of the *Roads Act 1993*, the road hereunder described is closed and the lands comprised therein cease to be public road and the rights of passage and access that previously existed in relation to the road is extinguished. Upon closing, title to the land, comprising the former public road, vests in the body specified in the Schedule hereunder.

The Hon Paul Toole, MP
Minister for Lands and Forestry

DESCRIPTION

Parish – Bethungra; County – Clarendon
Land District – Cootamundra; LGA – Junee

Road Closed: Lot 2 DP 1240823

File No: 16/05452

SCHEDULE

On closing, the land within Lot 2 DP 1240823 remains vested in the State of New South Wales as Crown land.

[n2018-1484]

NOTIFICATION OF CLOSING OF A ROAD

In pursuance of the provisions of the *Roads Act 1993*, the road hereunder described is closed and the lands comprised therein cease to be public road and the rights of passage and access that previously existed in relation to the road is extinguished. Upon closing, title to the land, comprising the former public road, vests in the body specified in the Schedule hereunder.

The Hon Paul Toole, MP
Minister for Lands and Forestry

DESCRIPTION

Parish – Ulungra; County – Gowen
Land District – Dunedoo Central; LGA – Gilgandra

Road Closed: Lot 1 DP 1227224

File No: 09/10371

SCHEDULE

On closing, the land within Lot 1 DP 1227224 remains vested in the State of New South Wales as Crown land.

[n2018-1485]

NOTIFICATION OF CLOSING OF A ROAD

In pursuance of the provisions of the *Roads Act 1993*, the road hereunder described is closed and the lands comprised therein cease to be public road and the rights of passage and access that previously existed in relation to the road is extinguished. Upon closing, title to the land, comprising the former public road, vests in the body specified in the Schedule hereunder.

The Hon Paul Toole, MP
Minister for Lands and Forestry

DESCRIPTION

Parish – Breadalbane; County – Argyle
Land District – Goulburn; LGA – Goulburn Mulwaree

Road Closed: Lot 2 DP 1239908

File No: 17/10911

SCHEDULE

On closing, the land within Lot 2 DP 1239908 remains vested in the State of New South Wales as Crown land.

[n2018-1486]

NOTIFICATION OF CLOSING OF A ROAD

In pursuance of the provisions of the *Roads Act 1993*, the road hereunder described is closed and the lands comprised therein cease to be public road and the rights of passage and access that previously existed in relation to the road is extinguished. Upon closing, title to the land, comprising the former public road, vests in the body specified in the Schedule hereunder.

The Hon Paul Toole, MP
Minister for Lands and Forestry

DESCRIPTION

Parish – Condong; County – Rous
Land District – Murwillumbah; LGA – Tweed

Road Closed: Lot 1 DP 1240727

File No: 17/10784

SCHEDULE

On closing, the land within Lot 1 DP 1240727 remains vested in the State of New South Wales as Crown land.

[n2018-1487]

NOTIFICATION OF CLOSING OF A ROAD

In pursuance of the provisions of the *Roads Act 1993*, the road hereunder described is closed and the lands comprised therein cease to be public road and the rights of passage and access that previously existed in relation to the road is extinguished. Upon closing, title to the land, comprising the former public road, vests in the body specified in the Schedule hereunder.

The Hon Paul Toole, MP
Minister for Lands and Forestry

DESCRIPTION

Parish – Bethungra; County – Clarendon
Land District – Cootamundra; LGA – Junee

Road Closed: Lot 3 DP 1240872

File No: 16/05498

SCHEDULE

On closing, the land within Lot 3 DP 1240872 remains vested in the State of New South Wales as Crown land.

[n2018-1488]

NOTIFICATION OF CLOSING OF A ROAD

In pursuance of the provisions of the *Roads Act 1993*, the road hereunder described is closed and the lands comprised therein cease to be public road and the rights of passage and access that previously existed in relation to the road is extinguished. Upon closing, title to the land, comprising the former public road, vests in the body specified in the Schedule hereunder.

The Hon Paul Toole, MP
Minister for Lands and Forestry

DESCRIPTION

Parish – Toual; County – Murray
Land District – Queanbeyan; LGA – Yass Valley

Road Closed: Lot 3 DP 1241199

File No: 17/11382

SCHEDULE

On closing, the land within Lot 3 DP 1241199 remains vested in the State of New South Wales as Crown land.

[n2018-1489]

NOTIFICATION OF CLOSING OF A ROAD

In pursuance of the provisions of the *Roads Act 1993*, the road hereunder described is closed and the lands comprised therein cease to be public road and the rights of passage and access that previously existed in relation to the road is extinguished. Upon closing, title to the land, comprising the former public road, vests in the body specified in the Schedule hereunder.

The Hon Paul Toole, MP
Minister for Lands and Forestry

DESCRIPTION

Parish – Somers; County – Bathurst
Land District – Blayney; LGA – Blayney

Road Closed: Lot 1 DP 1228769

File No: 08/3055

SCHEDULE

On closing, the land within Lot 1 DP 1228769 remains vested in the State of New South Wales as Crown land.

[n2018-1490]

NOTIFICATION OF CLOSING OF A ROAD

In pursuance of the provisions of the *Roads Act 1993*, the road hereunder described is closed and the lands comprised therein cease to be public road and the rights of passage and access that previously existed in relation to the road is extinguished. Upon closing, title to the land, comprising the former public road, vests in the body specified in the Schedule hereunder.

The Hon Paul Toole, MP
Minister for Lands and Forestry

DESCRIPTION

Parish – Redbank; County – Macquarie
Land District – Port Macquarie; LGA – Port Macquarie-Hastings

Road Closed: Lot 1 DP 1227818

File No: 16/07325

SCHEDULE

On closing, the land within Lot 1 DP 1227818 remains vested in the State of New South Wales as Crown land.

[n2018-1491]

NOTIFICATION OF CLOSING OF A ROAD

In pursuance of the provisions of the *Roads Act 1993*, the road hereunder described is closed and the lands comprised therein cease to be public road and the rights of passage and access that previously existed in relation to the road is extinguished. Upon closing, title to the land, comprising the former public road, vests in the body specified in the Schedule hereunder.

The Hon Paul Toole, MP
Minister for Lands and Forestry

DESCRIPTION*Parish – Bolaira; County – Wallace**Land District – Cooma; LGA – Snowy Monaro Regional*

Road Closed: Lots 2-3 DP 1239783

File No: 17/02943

SCHEDULE

On closing, the land within Lots 2-3 DP 1239783 remains vested in the State of New South Wales as Crown land.

[n2018-1492]

NOTIFICATION OF CLOSING OF A ROAD

IN pursuance of the provisions of the *Roads Act 1993*, the roads described in Column 1 of the Schedule hereunder are closed and the lands comprised therein cease to be public road and the rights of passage and access that previously existed in relation to the roads are extinguished. Upon closing the roads described in Column 1 the lands defined in Column 5 of the Schedule being the re-defined roads will be dedicated as public road.

The Hon. Paul Toole M.P.

Minister for Lands and Forestry

Description*Parishes & Counties – Varies**Land District – Varies**LGA – Wentworth*

Column 1 Western Division Road (WDR) No. & Deposited Plan (DP)	Column 2 Gazetted Public Road	Column 3 Road Name	Column 4 Within Lot/DP	Column 5 Legal Roads Network Deposited Plan (DP) No.
84 (DP97084)	8 August 1980	Tooperoopna Road	5494/768403; 5495/768404	1228796
84 (DP97084)	8 August 1980	Tooperoopna Road	5492/768401	1228796
84 (DP97084)	8 August 1980	Tooperoopna Road	515/761433	1228796
144 (DP97144)	24 June 1983	Anabranh Mail Road	5492/768401	1228796
144 (DP97144)	24 June 1983	Anabranh Mail Road	493/761436	1228796
144 (DP97144)	24 June 1983	Anabranh Mail Road	496/761439	1228796
144 (DP97144)	24 June 1983	Anabranh Mail Road	499/761442	1228796
144 (DP97144)	24 June 1983	Anabranh Mail Road	500/761443	1228796
144 (DP97144)	24 June 1983	Anabranh Mail Road	501/761444	1228796
144 (DP97144)	24 June 1983	Milpara & Anabranh Mail Roads	502/761489	1228796
144 (DP97144)	24 June 1983	Anabranh Mail Road	6707/822031	1228796
144 (DP97144)	24 June 1983	Anabranh Mail Road	497/761440	1228796

Column 1 Western Division Road (WDR) No. & Deposited Plan (DP)	Column 2 Gazetted Public Road	Column 3 Road Name	Column 4 Within Lot/DP	Column 5 Legal Roads Network Deposited Plan (DP) No.
144 (DP97144)	24 June 1983	Anabranh Mail Road	498/761441	1228796
144 (DP97144)	24 June 1983	Anabranh Mail Road	494/761437	1228796
144 (DP97144)	24 June 1983	Milpara Road	1444/763316; 4880/763316	1228796
144 (DP97144)	24 June 1983	Anabranh Mail Road	1912/763768	1228796
144 (DP97144)	24 June 1983	Anabranh Mail Road	1911/763767	1228796
144 (DP97144)	24 June 1983	Anabranh Mail Road	1910/763766	1228796
144 (DP97144)	24 June 1983	Anabranh Mail Road	3248/765453	1228796
144 (DP97144)	24 June 1983	Milpara Road	3290/765546; 3291/765547	1228796

File No.: 15/01008

[n2018-1493]

ADDITION OF LANDS TO A WESTERN LANDS LEASE

IT is hereby notified that in pursuance of Section 35C of the *Western Lands Act 1901*, the land particularised in Column 3, being the road closed in Column 4, has been added to the Western Lands Leases identified in Column 1.

The Hon. Paul Toole M.P.
Minister for Lands and Forestry

Description*Parishes – Varies Counties – Varies**Land District – Varies**LGA – Wentworth*

Column 1 Western Lands Lease No.	Column 2 Folio ID	Column 3 Area Addition (ha)	Column 4 Former WDR No	Column 5 Total Area following Addition (ha)
167	5494/768403; 5495/768404	35	84	4144
287	5492/768401	44	84	4180
287	5492/768401	4	144	4184
2500	493/761436	31	144	4057
2501	496/761439	12	144	4051
2503	500/761443	19	144	4059
2504	501/761444	21	144	4049
2505	502/761489	27	144	4095
2515	498/761441	23	144	4052

Column 1 Western Lands Lease No.	Column 2 Folio ID	Column 3 Area Addition (ha)	Column 4 Former WDR No	Column 5 Total Area following Addition (ha)
2528	494/761437	20	144	4093
3817	1444/763316; 4880/763316	25.4	144	450.8
4067	1912/763768	15	144	2269
4071	1911/763767	20	144	2308
5693	3290/765546; 3291/ 765547	8	144	4779

File No.: 15/01008

[n2018-1494]

WITHDRAWAL OF LANDS FROM WESTERN LANDS LEASES

IT is hereby notified that in pursuance of Section 35Q of the *Western Lands Act 1901*, the land particularised in Column 1 has been withdrawn from the Western Lands Leases identified in Column 2 for the purpose of being dedicated as public road.

The Hon. Paul Toole M.P.
Minister for Lands and Forestry

Description

Parishes – Varies Counties – Varies

Land District – Varies

LGA – Wentworth/Balranald/Central Darling/Carrathool

Column 1 Land Withdrawn from Western Lands Lease (Lot/DP)	Column 2 Western Lands Lease affected by Withdrawal	Column 3 Folio ID affected by Withdrawal	Column 4 Area Withdrawn from Lease (ha)	Column 5 Area of Lease following Withdrawal (ha)
1/1228796	5548	3248/765453	4.248	13069
2/1228796	4073	1910/763766	30.92	2544
3/1228796	4071	1911/763767	19.89	2288
4/1228796	4067	1912/763768	15.69	2253
5/1228796	2500	493/761436	31.43	4026
6/1228796	2528	494/761437	20.79	4072
7/1228796	2513	1/243884; 1/756150; 6707/822031	13.2	4013
8/1228796	2513	1/243884; 1/756150; 6707/822031	7.777	4005
9/1228796	2501	496/761439	21.55	4029
10/1228796	2514	5088/45068; 4170/766736; 497/761440	6.542	4175

Column 1	Column 2	Column 3	Column 4	Column 5
Land Withdrawn from Western Lands Lease (Lot/DP)	Western Lands Lease affected by Withdrawal	Folio ID affected by Withdrawal	Area Withdrawn from Lease (ha)	Area of Lease following Withdrawal (ha)
11/1228796	2514	5088/45068; 4170/766736; 497/761440	10.3	4165
12/1228796	2515	498/761441	18.64	4033
13/1228796	2515	498/761441	3.4	4030
14/1228796	2502	499/761442	18.92	4001
15/1228796	2503	500/761443	18.93	4040
16/1228796	2504	501/761444	21.09	4028
17/1228796	2505	502/761489	20.65	4074
18/1228796	2505	502/761489	2.751	4071
19/1228796	287	5492/768401	14.07	4170
20/1228796	286	5493/768402	35.93	4193
21/1228796	291	5498/768407	25.17	4190
22/1228796	284	5828/768726	2.18	4199
31/1228796	284	5828/768726	1.402	4197
37/1228796	2677	672/761719	1.148	593.8
38/1228796	2505	502/761489	2.692	4069
39/1228796	5693	3290/765546; 3291/765547	5.273	4774
40/1228796	3817	1444/763316; 4880/763316	3.013	447.8
41/1228796	3817	1444/763316; 4880/763316	22.02	425.8
42/1228796	5693	3290/765546; 3291/765547	3.336	4771
43/1228796	287	5492/768401	42.7	4127
44/1228796	167	5494/768403; 5495/768404	23.98	4120
45/1228796	167	5494/768403; 5495/768404	10.73	4109
46/1228796	2509	515/761433	28.1	4050
53/1228796	3825	5203/725295; 5202/725295	0.9379	204.1
65/1228796	1684	5870/768762; 5871/768763	23.42	2725
66/1228796	4592	2413/764376; 3465/765754	30.44	3310
67/1228796	302	5706/768606; 5676/768576; 5677/768577	29.90	5053
68/1228796	1305	5669/768569	7.574	4136

Column 1	Column 2	Column 3	Column 4	Column 5
Land Withdrawn from Western Lands Lease (Lot/DP)	Western Lands Lease affected by Withdrawal	Folio ID affected by Withdrawal	Area Withdrawn from Lease (ha)	Area of Lease following Withdrawal (ha)
69/1228796	7202	5664/768564; 6/754476	11.67	1259
71/1228796	701	4597/768562; 5662/768561; 5663/768563	49.42	9858
72/1228796	8329	3838/766281	35.29	16509
75/1228796	8329	3838/766281	15.18	16494
76/1228796	8243	3839/766282	40.88	15662
77/1228796	2853	932/761989	60.44	7282
78/1228796	3339	931/761988	24.53	6875
79/1228796	3339	931/761988	4.330	6871
81/1228796	1684	5870/768762; 5871/768763	5.074	2720
82/1228796	4592	2413/764376; 3465/765754	17.81	3322
83/1228796	1721	175/760750	41.45	3642
84/1228796	1735	5675/768575	31.93	4091
85/1228796	12973	4940/720965	30.46	4819
86/1228796	4541	2097/764097	12.29	1232
87/1228796	5735	188/764098; 3582/765934; 5666/768566	30.97	5651
88/1228796	6127	3579/765931	58.48	10862
89/1228796	6126	3578/765930	27.99	11657
90/1228796	5984	3493/765785	20.30	11485
91/1228796	5986	3495/765787	47.00	12699
92/1228796	5985	3494/765786	65.03	11782
93/1228796	6471	25/864026; 26/864026; 28/864026	13.13	2464
96/1228796	5552	1/754714; 21/754725; 5654/768553; 5655/768554; 5656/768555; 5657/768556	6.299	11163
98/1228796	4520	1742/764091; 4926/764091; 1236/764157	15.38	880.2
99/1228796	4520	1742/764091; 4926/764091; 1236/764157	8.446	871.8
100/1228796	4587	2407/764370; 3491/765783	39.57	6413

Column 1 Land Withdrawn from Western Lands Lease (Lot/DP)	Column 2 Western Lands Lease affected by Withdrawal	Column 3 Folio ID affected by Withdrawal	Column 4 Area Withdrawn from Lease (ha)	Column 5 Area of Lease following Withdrawal (ha)
101/1228796	4587	2407/764370; 3491/765783	69.37	6344
106/1228796	4587	2407/764370; 3491/765783	76.84	6267
107/1228796	4588	4562/767698; 2409/764372	33.57	4496
108/1228796	4587	2407/764370; 3491/765783	12.41	6255
109/1228796	3481	923/762004	43.76	6393
110/1228796	6124	3576/765928	54.68	12890
111/1228796	6123	3640/766022; 3575/765927	41.53	11380
112/1228796	6123	3640/766022; 3575/765927	36.67	11344

File No.: 15/01008

[n2018-1495]

DEDICATION OF CROWN LAND AS PUBLIC ROAD

IT is hereby notified that in pursuance of Section 12 of the *Roads Act 1993*, the crown land particularised below is, from the date of publication of this notice, dedicated as public road. The public road hereby dedicated is declared not to be crown road within the meaning of the *Roads Act 1993*.

The Hon. Paul Toole M.P.
Minister for Lands and Forestry

Description

Parishes – Varies Counties – Varies

Land District – Varies

LGA – Wentworth/Balranald/Central Darling/Carrathool

Lot/DP	Lot/DP	Lot/DP	Lot/DP
1/1228796	26/1228796	57/1228796	85/1228796
2/1228796	29/1228796	58/1228796	86/1228796
3/1228796	31/1228796	60/1228796	87/1228796
4/1228796	32/1228796	61/1228796	88/1228796
5/1228796	33/1228796	62/1228796	89/1228796
6/1228796	37/1228796	63/1228796	90/1228796
7/1228796	38/1228796	64/1228796	91/1228796
8/1228796	39/1228796	65/1228796	92/1228796
9/1228796	40/1228796	66/1228796	93/1228796
10/1228796	41/1228796	67/1228796	94/1228796
11/1228796	42/1228796	68/1228796	96/1228796
12/1228796	43/1228796	69/1228796	97/1228796
13/1228796	44/1228796	71/1228796	98/1228796

Lot/DP	Lot/DP	Lot/DP	Lot/DP
14/1228796	45/1228796	72/1228796	99/1228796
15/1228796	46/1228796	75/1228796	100/1228796
16/1228796	47/1228796	76/1228796	101/1228796
17/1228796	48/1228796	77/1228796	103/1228796
18/1228796	49/1228796	78/1228796	106/1228796
19/1228796	50/1228796	79/1228796	107/1228796
20/1228796	51/1228796	80/1228796	108/1228796
21/1228796	52/1228796	81/1228796	109/1228796
22/1228796	53/1228796	82/1228796	110/1228796
23/1228796	54/1228796	83/1228796	111/1228796
25/1228796	56/1228796	84/1228796	112/1228796

Note: Affected parts of Crown Reserves 39, 248, 299, 365, 393, 406, 426, 1418, 2734, 2741, 14782, 15689, 24849, 53029, 64542, 65145, 66580, 71704, 78909, 97997, and 1013826 are hereby revoked by this dedication.

File No.: 15/01008

[n2018-1496]

NOTIFICATION OF CLOSING OF A ROAD

In pursuance of the provisions of the *Roads Act 1993*, the road hereunder described is closed and the lands comprised therein cease to be public road and the rights of passage and access that previously existed in relation to the road is extinguished. Upon closing, title to the land, comprising the former public road, vests in the body specified in the Schedule hereunder.

The Hon Paul Toole, MP
Minister for Lands and Forestry

DESCRIPTION

Parish – Mukki; County – Hawes
Land District – Walcha; LGA – Walcha

Road Closed: Lots 1-2 DP 1239821

File No: 17/11269

SCHEDULE

On closing, the land within Lots 1-2 DP 1239821 remains vested in the State of New South Wales as Crown land.

[n2018-1497]

NOTIFICATION OF CLOSING OF A ROAD

In pursuance of the provisions of the *Roads Act 1993*, the road hereunder described is closed and the lands comprised therein cease to be public road and the rights of passage and access that previously existed in relation to the road is extinguished. Upon closing, title to the land, comprising the former public road, vests in the body specified in the Schedule hereunder.

The Hon Paul Toole, MP
Minister for Lands and Forestry

DESCRIPTION

Parishes – Brookong, Cullivel; County – Urana
Land District – Urana; LGA – Lockhart

Road Closed: Lot 1 DP 1239498

File No: 17/10781

SCHEDULE

On closing, the land within Lot 1 DP 1239498 remains vested in the State of New South Wales as Crown land.

[n2018-1498]

NOTIFICATION OF CLOSING OF A ROAD

In pursuance of the provisions of the *Roads Act 1993*, the road hereunder described is closed and the lands comprised therein cease to be public road and the rights of passage and access that previously existed in relation to the road is extinguished. Upon closing, title to the land, comprising the former public road, vests in the body specified in the Schedule hereunder.

The Hon Paul Toole, MP
Minister for Lands and Forestry

DESCRIPTION

*Parishes – Keadool, Matouree; County – Leichhardt
Land District – Coonamble; LGA – Coonamble*

Road Closed: Lot 1 DP 1240729

File No: 17/10110

SCHEDULE

On closing, the land within Lot 1 DP 1240729 remains vested in the State of New South Wales as Crown land.

[n2018-1499]

NOTIFICATION OF CLOSING OF A ROAD

In pursuance of the provisions of the *Roads Act 1993*, the road hereunder described is closed and the lands comprised therein cease to be public road and the rights of passage and access that previously existed in relation to the road is extinguished. Upon closing, title to the land, comprising the former public road, vests in the body specified in the Schedule hereunder.

The Hon Paul Toole, MP
Minister for Lands and Forestry

DESCRIPTION

*Parish – Menadool; County – Courallie
Land District – Moree; LGA – Moree Plains*

Road Closed: Lot 4 DP 1228635

File No: 16/02752

SCHEDULE

On closing, the land within Lot 4 DP 1228635 remains vested in the State of New South Wales as Crown land.

[n2018-1500]

NOTIFICATION OF CLOSING OF A ROAD

In pursuance of the provisions of the *Roads Act 1993*, the road hereunder described is closed and the lands comprised therein cease to be public road and the rights of passage and access that previously existed in relation to the road is extinguished. Upon closing, title to the land, comprising the former public road, vests in the body specified in the Schedule hereunder.

The Hon Paul Toole, MP
Minister for Lands and Forestry

DESCRIPTION

*Parish – Elland; County – Clarence
Land District – Grafton; LGA – Clarence Valley*

Road Closed: Lot 3 DP 1241061

File No: 17/11233

SCHEDULE

On closing, the land within Lot 3 DP 1241061 remains vested in the State of New South Wales as Crown land.

[n2018-1501]

NOTIFICATION OF CLOSING OF A ROAD

In pursuance of the provisions of the *Roads Act 1993*, the road hereunder described is closed and the lands comprised therein cease to be public road and the rights of passage and access that previously existed in relation to the road is extinguished. Upon closing, title to the land, comprising the former public road, vests in the body specified in the Schedule hereunder.

The Hon Paul Toole, MP
Minister for Lands and Forestry

DESCRIPTION

Parish – Rushforth; County – Clarence
Land District – Grafton; LGA – Clarence Valley

Road Closed: Lot 2 DP 1240725

File No: 17/11340

SCHEDULE

On closing, the land within Lot 2 DP 1240725 remains vested in the State of New South Wales as Crown land.

[n2018-1502]

**NOTICE OF PURPOSE OTHER THAN THE DECLARED PURPOSE PURSUANT TO
SECTION 34A(2)(b) OF THE CROWN LANDS ACT 1989**

Pursuant to section 34A(2)(b) of the *Crown Lands Act 1989*, the Crown reserve(s) specified in Column 2 of the Schedule is to be used or occupied under a relevant interest granted for the purpose(s) specified in Column 1 of the Schedule where such use or occupation is other than the declared purpose of the reserve

The Hon Paul Toole, MP
Minister for Lands and Forestry

Schedule

Column 1	Column 2
pipeline	Reserve No. 754572 Public Purpose: future public requirements Notified: 29 June 2007 File Reference: 17/08575

Schedule

Column 1	Column 2
community event	Reserve No. 82780 Public Purpose: future public requirements Notified: 9 September 1960 File Reference: 18/02621 Reserve No. 755692 Public Purpose: future public requirements Notified: 29 June 2007 File Reference: 18/02621

Schedule

Column 1	Column 2
pipeline	Reserve No. 754572 Public Purpose: future public requirements Notified: 29 June 2007 File Reference: 17/08575

Schedule

Column 1	Column 2
road construction	Reserve No. 21939 Public Purpose: travelling stock Notified: 6 January 1895 File Reference: 17/11003 Reserve No. 38823 Public Purpose: preservation and growth of timber Notified: 25 January 1905 File Reference: 17/11003 Reserve No. 40639 Public Purpose: camping, travelling purposes Notified: 4 July 1906 File Reference: 17/11003

Schedule

Column 1	Column 2
sporting event	Reserve No. 64421 Public Purpose: plantation, public recreation Notified: 2 March 1934 File Reference: 18/00619 Reserve No. 70509 Public Purpose: public recreation Notified: 27 February 1942 File Reference: 18/00619 Reserve No. 70540 Public Purpose: public recreation Notified: 10 April 1942 File Reference: 18/00619 Reserve No. 73603 Public Purpose: preservation of native flora, public recreation Notified: 14 July 1950 File Reference: 18/00619 Reserve No. 76303 Public Purpose: water supply Notified: 9 October 1953 File Reference: 18/00619 Reserve No. 78312 Public Purpose: public recreation Notified: 3 February 1956 File Reference: 18/00619 Reserve No. 85986 Public Purpose: public recreation Notified: 7 October 1966 File Reference: 18/00619

Column 1	Column 2
	<p>Reserve No. 86761 Public Purpose: parking, public recreation Notified: 7 June 1968 File Reference: 18/00619</p> <p>Reserve No. 87848 Public Purpose: public recreation Notified: 17 July 1970 File Reference: 18/00619</p> <p>Reserve No. 88536 Public Purpose: public recreation Notified: 19 May 1972 File Reference: 18/00619</p> <p>Reserve No. 88949 Public Purpose: rubbish depot Notified: 13 July 1973 File Reference: 18/00619</p> <p>Reserve No. 90850 Public Purpose: public recreation Notified: 5 August 1977 File Reference: 18/00619</p> <p>Reserve No. 96903 Public Purpose: promotion of the study and the preservation of native flora and fauna Notified: 5 August 1983 File Reference: 18/00619</p> <p>Reserve No. 170078 Public Purpose: camping, public recreation Notified: 6 May 1988 File Reference: 18/00619</p> <p>Reserve No. 170083 Public Purpose: environmental protection Notified: 22 July 1988 File Reference: 18/00619</p> <p>Reserve No. 170127 Public Purpose: after auction purchase Notified: 1 December 1989 File Reference: 18/00619</p> <p>Public Park No. 570011 Public Purpose: public recreation Notified: 25 May 1887 File Reference: 18/00619</p> <p>Dedication No. 570014 Public Purpose: public recreation Notified: 17 December 1937 File Reference: 18/00619</p> <p>Reserve No. 755233 Public Purpose: future public requirements Notified: 29 June 2007 File Reference: 18/00619</p> <p>Reserve No. 755262 Public Purpose: future public requirements Notified: 29 June 2007 File Reference: 18/00619</p>

Column 1	Column 2
	Reserve No. 1011388 Public Purpose: public recreation and coastal environmental protection, tourist facilities and services Notified: 3 March 2006 File Reference: 18/00619 Reserve No. 16839 Public Purpose: travelling stock Notified: 3 December 1892 File Reference: 18/02612

Schedule

Column 1	Column 2
environmental studies	Reserve No. 88002 Public Purpose: public recreation Notified: 13 November 1970 File Reference: 18/01508 Reserve No. 753204 Public Purpose: future public requirements Notified: 29 June 2007 File Reference: 18/01508 Reserve No. 23264 Public Purpose: public recreation Notified: 8 November 1895 File Reference: 18/01516 Reserve No. 23265 Public Purpose: public recreation Notified: 8 November 1895 File Reference: 18/01516 Reserve No. 84263 Public Purpose: public recreation Notified: 5 July 1963 File Reference: 18/01516 Reserve No. 90736 Public Purpose: public recreation Notified: 18 March 1977 File Reference: 18/01516 Reserve No. 752034 Public Purpose: future public requirements Notified: 29 June 2007 File Reference: 18/01516 Reserve No. 1002952 Public Purpose: environmental protection Notified: 18 August 2000 File Reference: 18/01516

Schedule

Column 1	Column 2
car park buffer zone	Reserve No. 755215 Public Purpose: future public requirements Notified: 29 June 2007 File Reference: 17/04714 Reserve No. 755259 Public Purpose: future public requirements Notified: 29 June 2007 File Reference: 17/04714

Schedule

Column 1	Column 2
environmental rehabilitation	Reserve No. 52855 Public Purpose: public recreation Notified: 21 June 1918 File Reference: 18/02435 Reserve No. 751268 Public Purpose: future public requirements Notified: 29 June 2007 File Reference: 18/02435

Schedule

Column 1	Column 2
access pump site pipeline irrigation channel	Reserve No. 54826 Public Purpose: travelling stock Notified: 9 September 1921 File Reference: 17/07026

Schedule

Column 1	Column 2
ramp seawall	Reserve No. 1012048 Public Purpose: access and public requirements, tourism purposes and environmental and heritage conservation Notified: 4 August 2006 File Reference: 18/00184

[n2018-1503]

APPOINTMENT OF TRUST BOARD MEMBERS

Pursuant to section 93 of the *Crown Lands Act 1989*, the persons whose names are specified in Column 1 of the Schedule hereunder are appointed, for the terms of office specified in that Column, as members of the trust board for the reserve trust specified opposite thereto in Column 2, which has been established and appointed as trustee of the reserve referred to opposite thereto in Column 3 of the Schedule.

The Hon Paul Toole, MP
Minister for Lands and Forestry

Schedule

Column 1	Column 2	Column 3
Andrew Ian Price (new member) For a term commencing the date of this notice and expiring 29 November 2022.	Tyalgum Public Recreation and Preservation of Native Flora and Fauna Reserve Trust	Reserve No. 66096 Public Purpose: preservation of native flora and fauna, public recreation Notified: 3 July 1936 Reserve No. 59600 Public Purpose: preservation of native flora, public recreation Notified: 25 March 1927 Reserve No. 95559 Public Purpose: caravan and camping park Notified: 28 August 1981 File Reference: GF81R344-002

[n2018-1504]

APPOINTMENT OF TRUST BOARD MEMBERS

Pursuant to section 93 of the *Crown Lands Act 1989*, the persons whose names are specified in Column 1 of the Schedule hereunder are appointed, for the terms of office specified in that Column, as members of the trust board for the reserve trust specified opposite thereto in Column 2, which has been established and appointed as trustee of the reserve referred to opposite thereto in Column 3 of the Schedule.

The Hon Paul Toole, MP
Minister for Lands and Forestry

Schedule

Column 1	Column 2	Column 3
Ian Kirkland (re-appointment) Keith William Morrow (re-appointment) The person for the time being holding the office of Nominated Representative, Big Scrub Landcare (ex-officio member) Rowan Burnett Trimble (re-appointment) Gregory William Pearson (re-appointment) David Charles Thorpe (new member) Laurence William Hosking (re-appointment) For a term commencing 10 May 2018 and expiring 09 May 2023.	Booyong Public Recreation And Preservation Of Native Flora Reserve Trust	Reserve No. 62153 Public Purpose: preservation of native flora, public recreation Notified: 3 October 1930 File Reference: GF81R372

[n2018-1505]

**DECLARATION OF A PUBLIC PURPOSE PURSUANT TO
SECTION 3 OF THE CROWN LANDS ACT 1989**

Pursuant to Section 3 of the *Crown Lands Act 1989*, "Rail Trail for Recreational Use" is declared to be a public purpose for the purposes of sections of 80 and 87 of the said Act.

The Hon Paul Toole, MP
Minister for Lands and Forestry

[n2018-1506]

DEDICATION OF CROWN LAND

Pursuant to section 80 of the *Crown Lands Act 1989*, the Crown land specified in Column 1 of the schedule hereunder is dedicated as specified opposite thereto in Column 2 of the Schedule.

The Hon Paul Toole, MP
Minister for Lands and Forestry

Schedule

Column 1	Column 2
Land District: Tumbarumba Local Government Area: Snowy Valleys Council Locality: Rosewood to Tumbarumba Parish: Mate and Tumbarumba County: Selwyn	Dedication No: 1039111 Public Purpose: Rail Trail for Recreational Use File Reference: 16/00455

Torrens Title Land

	Lot Number	Section	DP	Folio Identifier/Auto Consol
1	1		DP 1077611	Folio Identifier 1/1077611
2	1		DP 961251	Folio Identifier 1/961251
3	1		DP 1183439	Folio Identifier 1/1183439
4	1		DP 1172079	Folio Identifier 1/1172079
5	1		DP 178576	Folio Identifier 1/178576
6	1		DP 1077604	Folio Identifier 1/1077604
7	3083		DP 1183375	Folio Identifier 3083/ 1183375
8	1		DP 1172190	Folio Identifier 1/1172190
9	3077		DP 1183559	Folio Identifier 3077/ 1183559
10	6		DP 844044	Folio Identifier 6/844044
11	1		DP 1077600	Folio Identifier 1/1077600
12	3073		DP 1183438	Folio Identifier 3073/ 1183438
13	4	3	DP 758887	Folio Identifier 4/3/758887
14	9	1	DP 758887	Folio Identifier 9/1/758887
15	1		DP 1237458	Folio Identifier 1/1237458
16	3085		DP 1183369	Folio Identifier 3085/ 1183369
17	2		DP 562408	Folio Identifier 2/562408
18	1		DP 1172195	Folio Identifier 1/1172195
19	3074		DP 1183601	Folio Identifier 3074/ 1183601

Torrens Title Land				
	Lot Number	Section	DP	Folio Identifier/Auto Consol
20	3084		DP 1183372	Folio Identifier 3084/ 1183372
21	3080		DP 1183390	Folio Identifier 3080/ 1183390
22	5		DP 844044	Folio Identifier 5/844044
23	3086		DP 1183348	Folio Identifier 3086/ 1183348
24	3082		DP 1183377	Folio Identifier 3082/ 1183377
25	1		DP 661892	Folio Identifier 1/661892
26	3076		DP 1183570	Folio Identifier 3076/ 1183570
27	3071		DP 1183395	Folio Identifier 3071/ 1183395
28	7		DP 844044	Folio Identifier 7/844044
29	1		DP 1077607	Folio Identifier 1/1077607
30	3078		DP 1183556	Folio Identifier 3078/ 1183556
31	3075		DP 1183598	Folio Identifier 3075/ 1183568
32	10	1	DP 758887	Folio Identifier 10/1/ 758887
33	1		DP 1117989	Folio Identifier 1/1117989
34	3072		DP 1183430	Folio Identifier 3072/ 1183430
35	1		DP 1077616	Folio Identifier 1/1077616
36	1		DP 1165519	Folio Identifier 1/1165519
37	3055		DP 1183527	Folio Identifier 3055/ 1183527
38	3087		DP 1183548	Folio Identifier 3087/ 1183548
39	2		DP 440230	Part Auto Consol 7508-19
40	3		DP 440230	Part Auto Consol 7508-19
41	4		DP 440230	Part Auto Consol 7508-19
42	5		DP 440230	Part Auto Consol 7508-19
43	8		DP 440230	Part Auto Consol 7508-19
44	9		DP 440230	Part Auto Consol 7508-19
45	11		DP 440230	Part Auto Consol 7508-19
46	13		DP 440230	Part Auto Consol 7508-19
47	1		DP 962769	Part Auto Consol 2916-117
48	2		DP 962769	Part Auto Consol 2916-117
49	1		DP 179685	Part Auto Consol 3980-142
50	2		DP 179685	Part Auto Consol 3980-142
51	1		DP 1117121	Part Auto Consol 5365-128

Torrens Title Land				
	Lot Number	Section	DP	Folio Identifier/Auto Consol
52	2		DP 1117121	Part Auto Consol 5365-128
53	1		DP 168334	Part Auto Consol 3115-196
54	2		DP 168334	Part Auto Consol 3115-196
55	3		DP 168334	Part Auto Consol 3115-196
56	1		DP 449983	Part Auto Consol 3198-60
57	2		DP 449983	Part Auto Consol 3198-60
58	3		DP 449983	Part Auto Consol 3198-60
Untitled Land				
59	The land defined as Taking 496A being an area of 5 perches indicated on Railway Plan DP 11A0351 held by Transport for NSW, approximate lot area 126.m2. Refer to the diagram below as shown by red line.			

Untitled Land shown by red line on the diagram hereunder, approximate representation.



[n2018-1507]

ESTABLISHMENT OF RESERVE TRUST

Pursuant to section 92(1) of the *Crown Lands Act 1989*, the reserve trust specified in Column 1 of the Schedule hereunder is established under the name stated in that Column and is appointed as trustee of the reserve specified opposite thereto in Column 2 of the Schedule.

The Hon Paul Toole, MP
Minister for Lands and Forestry

Schedule

Column 1	Column 2
Snowy Valleys Council Crown Reserves Reserve Trust	Dedication No: 1039111 Public Purpose: Rail Trail for Recreational Use Notified: This Day File Reference: 16/00455

[n2018-1508]

APPOINTMENT OF CORPORATION TO MANAGE RESERVE TRUST

Pursuant to section 95 of the *Crown Lands Act 1989*, the corporation specified in Column 1 of the Schedule hereunder is appointed to manage the affairs of the reserve trust specified opposite thereto in Column 2, which is trustee of the reserve referred to in Column 3 of the Schedule.

The Hon Paul Toole, MP
Minister for Lands and Forestry

Schedule

Column 1	Column 2	Column 3
Snowy Valleys Council	Snowy Valleys Council Crown Reserves Reserve Trust	Dedication No: 1039111 Public Purpose: Rail Trail for Recreational Use Notified: This Day File Reference: 16/00455

[n2018-1509]

APPOINTMENT OF TRUST BOARD MEMBERS

Pursuant to section 93 of the *Crown Lands Act 1989*, the persons whose names are specified in Column 1 of the Schedule hereunder are appointed, for the terms of office specified in that Column, as members of the trust board for the reserve trust specified opposite thereto in Column 2, which has been established and appointed as trustee of the reserve referred to opposite thereto in Column 3 of the Schedule.

The Hon Paul Toole, MP
Minister for Lands and Forestry

Schedule

Column 1	Column 2	Column 3
Joshua Campbell (new member) For a term commencing the date of this notice and expiring 22 September 2021.	Yarrie Lake Flora And Fauna Reserve Trust	Reserve No. 86842 Public Purpose: preservation of native flora and fauna, public recreation Notified: 30 August 1968 File Reference: ME81R39

[n2018-1510]

APPOINTMENT OF TRUST BOARD MEMBERS

Pursuant to section 93 of the *Crown Lands Act 1989*, the persons whose names are specified in Column 1 of the Schedule hereunder are appointed, for the terms of office specified in that Column, as members of the trust board for the reserve trust specified opposite thereto in Column 2, which has been established and appointed as trustee of the reserve referred to opposite thereto in Column 3 of the Schedule.

The Hon Paul Toole, MP
Minister for Lands and Forestry

Schedule

Column 1	Column 2	Column 3
Kenneth John Moran (new member) For a term commencing the date of this notice and expiring 27 February 2019.	Bungonia Park Trust	Reserve No. 35559 Public Purpose: public recreation Notified: 10 January 1903 File Reference: 08/8216

[n2018-1511]

APPOINTMENT OF TRUST BOARD MEMBERS

Pursuant to section 93 of the *Crown Lands Act 1989*, the persons whose names are specified in Column 1 of the Schedule hereunder are appointed, for the terms of office specified in that Column, as members of the trust board for the reserve trust specified opposite thereto in Column 2, which has been established and appointed as trustee of the reserve referred to opposite thereto in Column 3 of the Schedule.

The Hon Paul Toole, MP
Minister for Lands and Forestry

Schedule

Column 1	Column 2	Column 3
Karen Louise Faint (new member) Agnes Anne Woods (re-appointment) Christine Diane Hietbrink (new member) Susan Josephine Rice (re-appointment) James Frederick Souter (re-appointment) Ronald Charles Vickress (re-appointment) Naomi Katherine Davidson (re-appointment) For a term commencing 10 May 2018 and expiring 09 May 2023.	Guyra War Memorial Hall Trust	Reserve No. 87995 Public Purpose: war memorial (hall site) Notified: 6 November 1970 File Reference: AE80R13-002

[n2018-1512]

ADDITION TO RESERVED CROWN LAND

Pursuant to section 88 of the *Crown Lands Act 1989*, the Crown land specified in Column 1 of the Schedule hereunder is added to the reserved land specified opposite thereto in Column 2 of the Schedule.

The Hon Paul Toole, MP
Minister for Lands and Forestry

Schedule

Column 1	Column 2
Land District: Metropolitan Local Government Area: Northern Beaches Council Locality: Forestville Whole Lots: Lot 2683 DP 752038 Area: about 464.8 square metres File Reference: MN80H2741	Reserve No. 100157 Public Purpose: community purposes Notified: 23 December 1988 New Area: about 1478 square metres

[n2018-1513]

Water Notices

WATER ACT 1912

DEPARTMENT OF INDUSTRY – LANDS AND WATER DIVISION

NARRABRI – WEE WAA FLOODPLAIN

An application for a Controlled Work Approval under Part 8 of the *Water Act 1912* has been received from **A L Haire and C L Haire** for a levee on the Lower Namoi Valley Flood Plain on Lot 202 DP859073, Parish of Weeta Waa, County of Jamison.

Objections to the granting of this approval must be registered in writing to DoI Water, PO Box 205, Deniliquin NSW 2710 within 28 days of this notice (90CW811065). The objection must include your name and address and specify the grounds of objection.

Any queries please call 03 5881 9939, Jane Taylor.

[n2018-1514]

WATER MANAGEMENT ACT 2000

DEPARTMENT OF INDUSTRY – LANDS AND WATER

UPPER NAMOI REGULATED RIVER WATER SOURCE

An application to amend **90WA803014** on Lot 7012 DP 93878 and Lots 277 & 219 DP 752191 has been received from **Tamworth Regional Council** to add a water supply work and use.

Objections to the granting of this approval must be registered in writing to DoI Water, 4 Marsden Park Road Calala, NSW 2340 within 28 days of this notice (A012942). The objection must include your name and address and specify the grounds of objection.

Any enquiries please call Chris Binks on 02 6763 1465.

[n2018-1515]

Other Government Notices

ASSOCIATIONS INCORPORATION ACT 2009

Cancellation of registration pursuant to section 80

TAKE NOTICE that KU-RING-GAI NEIGHBOURHOOD CENTRE INC Y0336737 became registered under the *Corporations Act 2001* as KU-RING-GAI NEIGHBOURHOOD CENTRE LTD ACN 623 468 548, a company limited by guarantee, on 5 January 2018, and accordingly its registration under the *Associations Incorporation Act 2009* is cancelled as of that date.

Jodie Matheson
 Delegate of the Commissioner,
 NSW Fair Trading
 2 May 2018

[n2018-1516]

ASSOCIATIONS INCORPORATION ACT 2009

Cancellation of incorporation pursuant to section 74

TAKE NOTICE that the incorporation of the following associations is cancelled by this notice pursuant to section 74 of the *Associations Incorporation Act 2009*.

ALLIANCE NETWORK GROUP INCORPORATED	INC1601557
BIG HILL RURAL FIRE BRIGADE INCORPORATED	INC9879290
CBT&B TENNIS ASSOCIATION INCORPORATED	INC1501121
CROOKWELL DISTRICT LANDSCAPE GUARDIANS	INC9883298
DOUBLE BAY LADIES' PROBUS CLUB INCORPORATED	Y0009706
ETERNAL PLANTS INCORPORATED	INC1700478
EUROBODALLA DISTRICT TENNIS ASSOCIATION INCORPORATED	INC9875962
H.I.M MINISTRIES INCORPORATED	INC1700691
HARDEN MURRUMBURRAH HORTICULTURAL SOCIETY INC	Y0750433
KRAMBACH RACE CLUB INC	Y0380245
N.E.S.H. WOMEN'S SCHEME INC	Y0599841
OCEANIA RAINBOW NETWORK INCORPORATED	INC1601793
PROBUS CLUB OF MONTEREY INC	Y05886036
SMARTER GIVING INCORPORATED	INC1401557
SOUTH COAST ECOFISHERS INCORPORATED	INC9885953
SPECFACTION NSW INCORPORATED	INC9893577
SPRINGWOOD MENS PROBUS CLUB INCORPORATED	Y0328245
TWIN TOWNS MEALS ON WHEELS INC	Y0841037
WAR VETERANS' REMEMBERANCE DRIVE ASSOCIATION	INC9897745

Cancellation is effective as at the date of gazettal.

Dated this 2 May 2018.

Jodie Matheson
 Delegate of the Commissioner
 NSW Fair Trading

[n2018-1517]

ASSOCIATIONS INCORPORATION ACT 2009

Cancellation of Registration pursuant to Section 76

TAKE NOTICE that the registration of the following associations is cancelled by this notice pursuant to section 76 of the *Associations Incorporation Act 2009*.

ABOUT MOSHIACH INCORPORATED	INC9893556
CENTRE FOR JUST PEACE AND DEMOCRACY-AUSTRALIA INCORPORATED	INC9887938
CHRYSALIS MINISTRIES INCORPORATED	Y0930725
ENDEAVOUR – THE PROCHESTA INC	INC9881268
HAWKESBURY GRADUATES CHRISTIAN FELLOWSHIP INCORPORATED	INC9883785
HAY FAMILY FISHING CLUB INCORPORATED	INC9887377
HAY GYMNASTICS CLUB INCORPORATED	Y2751320
HEALTHCARE FIJI ASSOCIATION INCORPORATED	INC9878089
HIGH SECURITY IRRIGATORS-MURRUMBIDGEE INCORPORATED	Y1676945
HILL TOP COMMUNITY TENNIS CLUB INCORPORATED	INC9887100
HOWLONG ADULT RIDING CLUB INCORPORATED	INC9896263
MILTON RUGBY CLUB INCORPORATED	INC1600560
POWERFUL SON REVOLUTION INCORPORATED	INC1501438
PROFESSIONAL WATCHMAKERS OF AUSTRALIA INCORPORATED	INC9897384
PROPERTY INVESTORS ASSOCIATION OF AUSTRALIA INCORPORATED	INC9878952
SYDNEY XIANG YIN PING TAN ASSOCIATION INCORPORATED	INC1700782
THE HUB ACTION GROUP INCORPORATED	INC9882791
THE ORANGE PONY CLUB INCORPORATED	Y1985831
TUMUT ENDURANCE RIDERS INCORPORATED	INC9885862
WENTWORTH POINT MULTICULTURAL COMMUNITY ASSOCIATION INCORPORATED	INC1600120

Cancellation is effective as at the date of gazettal.

Dated this 2nd day of May 2018.

Christine Gowland
 Delegate of the Commissioner
 NSW Fair Trading

[n2018-1518]

CO-OPERATIVES NATIONAL LAW (NSW)

Section 601AA(4) of the Corporations Act 2001 as applied by
 section 453 of the Co-operatives National Law (NSW)

ERRATUM

NOTICE OF PROPOSED DEREGISTRATION – Voluntary

CO-OPERATIVE DETAILS

Co-operative: Codesign Co-operative Limited

Co-operative Number: NSWC31886

NOTICE

THE NOTICE that appeared in the NSW Government Gazette No.46, 27 April 2018, deregistering the above Co-operative was published in error.

Please see correct notice below.

The Registrar has received an application to deregister the Co-operative under section 601AA of the *Corporations Act 2001* as applied by section 453 of the *Co-Operatives National Law (NSW)*

The Registrar may deregister the Co-operative when two months have passed since publication of this Notice in the NSW Government Gazette

This notice corrects the abovementioned error.

Dated this 30th day of April 2018 at Bathurst.

Christine Gowland

Director, Registry Services

DELEGATE OF THE REGISTRAR OF CO-OPERATIVES

[n2018-1519]

NATIONAL PARKS AND WILDLIFE ACT 1974

Kamay Botany Bay National Park Draft Plan of Management and
Draft Master Plan for the Kurnell Precinct
on exhibition until 2 August 2018: comments sought

The Kamay Botany Bay National Park Draft Plan of Management and Draft Master Plan for the Kurnell Precinct are on exhibition until **2 August 2018**.

The plans may be viewed at:

- Kamay Botany Bay National Park, Visitor Centre, Cape Solander Drive, Kurnell
- Royal National Park, Visitor Centre, 2 Lady Carrington Drive, Audley
- Bowen Library, 669-673 Anzac Parade, Maroubra
- Sutherland Library, 30-36 Belmont Street, Sutherland
- Office of Environment and Heritage (OEH) Customer Centre (Level 14, 59–61 Goulburn St, Sydney)
- OEH 'Have your say' website <https://engage.environment.nsw.gov.au/consult>

Submissions on the plans must be received by **2 August 2018** by:

- using the online form on the OEH 'Have your say' website; or
- email to kamaybotanybay.2020@environment.nsw.gov.au; or
- mail to Manager Planning Evaluation and Assessment, PO Box 95, Parramatta NSW 2124

Your comments on the draft plan may include 'personal information'. See www.environment.nsw.gov.au/help/privacy.htm for information on how we will treat any personal information you provide. For more information, contact Andrew Growcock 0295856595.

[n2018-1520]

POISONS AND THERAPEUTIC GOODS REGULATION 2008

ORDER

Withdrawal of Drug Authority

In accordance with the provisions of clause 175(1) of the *Poisons and Therapeutic Goods Regulation 2008* an Order has been made on **Caroline Jane BRADLEY (PHA0001671001)** of Elmore Vale NSW 2287 prohibiting her, until further notice, as a pharmacist, from supplying or having possession of, or manufacturing any preparation, admixture or extract of a drug of addiction as authorised by Clauses 101(1) and 102 of the Regulation.

This Order is to take effect on and from 3 May 2018.

Dated at Sydney, 27 April 2018

Elizabeth Koff
Secretary, NSW Health

[n2018-1521]

POISONS AND THERAPEUTIC GOODS REGULATION 2008

ORDER

Withdrawal of Drug Authority

In accordance with the provisions of clause 175(1) of the *Poisons and Therapeutic Goods Regulation 2008* an Order has been made on **Dr Hany Mahmoud ABDALLA (PHA0000993781)** of Auburn NSW 2144 prohibiting him, until further notice, as a pharmacist, from supplying or having possession of, or manufacturing any preparation, admixture or extract of a drug of addiction as authorised by Clauses 101(1) and 102 of the Regulation.

This Order is to take effect on and from 2 May 2018.

Dated at Sydney, 26 April 2018

Elizabeth Koff
Secretary, NSW Health

[n2018-1522]

COUNCIL NOTICES

ALBURY CITY COUNCIL

ROADS ACT 1993

Naming of Roads

Notice is hereby given that Albury City Council, pursuant to section 162 of the *Roads Act 1993*, has officially named the road(s) as shown hereunder:

Name	Locality
VETERANS LANE	Albury City
Description	
Runs south off Wilson St (starting apx 50m east of Kiewa St) for about 60m, then turns east for about 50m, concluding at the main entry to the Wilson Street carpark.	

The attached diagram shows the extent of the road(s):

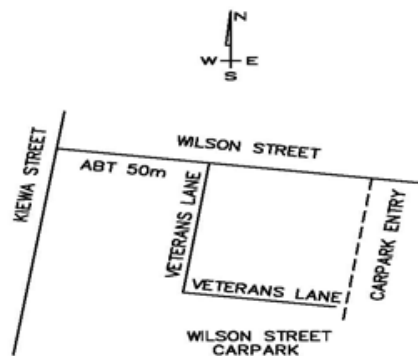

FRANK ZAKNICH, GENERAL MANAGER, Albury City Council, PO Box 323, ALBURY NSW 2640

GNB Ref: 0085

[n2018-1523]

CLARENCE VALLEY COUNCIL

ROADS ACT 1993

Naming of Roads

Notice is hereby given that Clarence Valley Council, pursuant to section 162 of the *Roads Act 1993*, has officially named the road(s) as shown hereunder:

Name	Locality
STOCKMANS PLACE	Gulmarrad
Description	
Council is proposing to name the following road in the subdivision (SUB2009/0038) of Lot 7 DP 1165440, off Rosella Road, Gulmurrad.	

JAMES HAMILTON, Development Assessment Planner, Clarence Valley Council, Locked Bag 23, GRAFTON NSW 2460

GNB Ref: 0090

[n2018-1524]

GOULBURN MULWAREE COUNCIL

ROADS ACT 1993, Section 16

Dedication of Land as Public Road

Notice is hereby given that in accordance with the provisions of section 16 of the *Roads Act 1993*, the land held by Council as described in the Schedule below is hereby dedicated as public road.

Warwick Bennett, General Manager, Goulburn Mulwaree Council, Locked Bag 22, Goulburn NSW 2580

Schedule

The land known as Private Lane No. 88 118A Bourke Street, Goulburn adjoining the southern and western boundaries of Lot 22 DP 1099685 in the Parish of Goulburn County of Argyle as shown highlighted on the plan below.

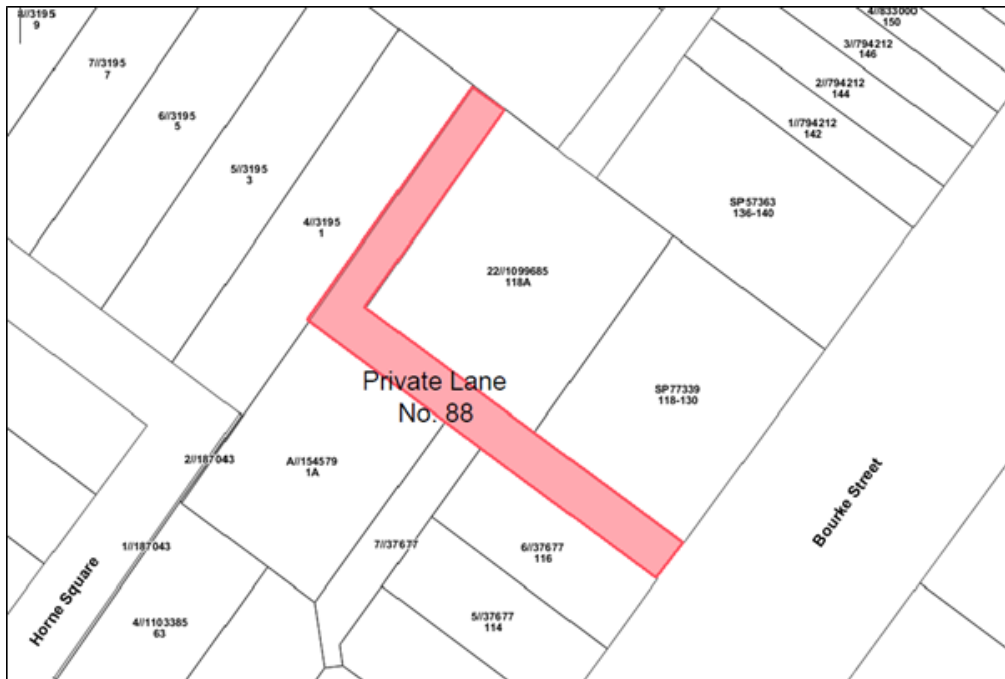

[n2018-1525]

GREATER HUME SHIRE COUNCIL

ROADS ACT 1993

Naming of Roads

Notice is hereby given that Greater Hume Shire Council, pursuant to section 162 of the *Roads Act 1993*, has officially named the road(s) as shown hereunder:

Name	Locality
KLEIN COURT	Jindera
Description	
Runs west off Carroll Ave, Jindera. For a length of 100Mtrs. Sealed road in new stage of Jindera Park Estate.	
Name	Locality
HOLLY TREE COURT	Jindera
Description	
Runs west off Carroll Ave, Jindera Park Estate for a distance of 100 meters.	
Name	Locality
STAN DRIVE	Jindera
Description	
Off Pioneer Drive for a distance of approximately 250 meters.	
Name	Locality
POMEGRANATE DRIVE	Jindera
Description	
Runs South off Drumwood Road, Sealed for a distance of 450Mtrs	

Name	Locality
ANVIL ROAD	Jindera
Description	
Runs off Pomegranate Drive, Sealed for a distance of 345Mtrs	

Name	Locality
FROSTY LANE	Jindera
Description	
Runs off Pomegranate Drive, Sealed for a distance of 240Mtrs	

STEVEN PINNUCK, General Manager, Greater Hume Shire Council, PO Box 99, HOLBROOK NSW 2644

GNB Ref: 0093

[n2018-1526]

HAWKESBURY CITY COUNCIL

ROADS ACT 1993

Naming of Roads

Notice is hereby given that Hawkesbury City Council, pursuant to section 162 of the *Roads Act 1993*, has officially named the road(s) as shown hereunder:

Name	Locality
Barnett Street	Pitt Town
Description	
Bounded by Lots 206 – 209, 211, 212, 215 DP 1240319, Lot 15 DP 793787, Fleming Street and Wilkinson Street.	
Origin	
Named in connection to Daniel Barnett. Daniel arrived on the first fleet in 1788. He was one of the first 22 settlers. Settled on South Creek by 1794. Married Ann and he passed away in Pitt Town 1823.	

Name	Locality
Fleming Street	Pitt Town
Description	
Bounded by Lots 212 – 217 DP 1240319, Lot 1142 DP 635487 and Barnett Street.	
Origin	
Named in connection to Henry Fleming 1791 – 1838 colonial born and an early resident of Pitt Town. He was responsible for building several early buildings including Blighton Arms. Fleming also operated a number of businesses including a store in the town. He married Elizabeth Hall and many of their family were born in Pitt Town.	

Name	Locality
Pendergast Street	Pitt Town
Description	
Bounded by Lots 101 – 112 DP 1240318, Lot 12 Section 3 DP 979242 and Wells Street.	
Origin	
Named in connection to descendants of convict John Pendergast who arrived in 1800 and Jane Williams who arrived in 1801 lived in the Pitt Town area up until to 20th Century.	

Name	Locality
Wilkinson Street	Pitt Town
Description	
Bounded by Lots 201 – 206, 211 DP 1240319, Lot 2 DP 572111, Hall Street and Barnett Street	
Origin	
Named in connection to John Wilkinson. John was a convict arriving in 1790. He was granted land in 1794 which was later sold to John Grono. He passed away 1839 and was buried at Pitt Town.	

The attached diagram shows the extent of the road(s):



PETER CONROY, General Manager, Hawkesbury City Council, PO Box 146, WINDSOR NSW 2756

GNB Ref: 0084

[n2018-1527]

MID-COAST COUNCIL

ROADS ACT 1993

Naming of Roads

Notice is hereby given that Mid-Coast Council, pursuant to section 162 of the *Roads Act 1993*, has officially named the road(s) as shown hereunder:

Name	Locality
TOWN HEAD ROAD	Taree South
Description	
A road coming of The Bucketts Way, Taree South in an southerly direction for approx. 635meters.	

Name	Locality
BUNYAN AVENUE	Old Bar
Description	
Start Coordinate – 460389.667, 6463666.803, End Coordinate – 460290.666, 6463462.005, Length 275m, within Lot 2 DP 1236249	

STEVE EMBRY, Acting General Manager, Mid-Coast Council, PO Box 450, FORSTER NSW 2428

GNB Ref: 0089

[n2018-1528]

MURRAY RIVER COUNCIL

Erratum

In the notice referring to the Naming of Public Roads in the Murray Shire Council Local Government Area, Folio 2904, 15 August 2014, the description of road name The Gums Place was assigned with the incorrect description. The correct description for this road name is The Gums Place off **Rivergums Drive**. This notice corrects that error with the gazettal date remaining 18 July 2014.

Des Bilske, General Manager
Murray Shire Council, PO Box 21, MATHOURA NSW 2710

[n2018-1529]

NEWCASTLE CITY COUNCIL

Roads Act 1993, Section 16

Dedication of Land as Public Road

NOTICE is hereby given that in accordance with the provisions of section 16 of the *Roads Act 1993*, the land held by Council as described in the Schedule below is hereby dedicated as public road.

JEREMY BATH, Chief Executive Officer, Newcastle City Council, PO Box 489, Newcastle, NSW 2300.

SCHEDULE

The land comprising part of streets at Mayfield, in the Parish of Newcastle, County of Northumberland, shown as road on DP 2235, as shown highlighted on the attached plan.



[n2018-1530]

NEWCASTLE CITY COUNCIL

Roads Act 1993, Section 16

Dedication of Land as Public Road

NOTICE is hereby given that in accordance with the provisions of section 16 of the *Roads Act 1993*, the land held by Council as described in the Schedule below is hereby dedicated as public road.

JEREMY BATH, Chief Executive Officer, Newcastle City Council, PO Box 489, Newcastle, NSW 2300.

SCHEDULE

The land comprising part of streets at Mayfield, in the Parish of Newcastle, County of Northumberland, shown as road on DP 975066 and DP 867, as shown highlighted on the attached plan.



[n2018-1531]

NEWCASTLE CITY COUNCIL

Roads Act 1993, Section 16

Dedication of Land as Public Road

NOTICE is hereby given that in accordance with the provisions of section 16 of the *Roads Act 1993*, the land held by Council as described in the Schedule below is hereby dedicated as public road.

JEREMY BATH, Chief Executive Officer, Newcastle City Council, PO Box 489, Newcastle, NSW 2300.

SCHEDULE

The land comprising part of streets known as Section Street and Dora Street at Mayfield, in the Parish of Newcastle, County of Northumberland, shown as road on DP 978483, DP150348, DP 927268 and DP 927269, as shown highlighted on the attached plan.



[n2018-1532]

NEWCASTLE CITY COUNCIL

Roads Act 1993, Section 16

Dedication of Land as Public Road

NOTICE is hereby given that in accordance with the provisions of section 16 of the *Roads Act 1993*, the land held by Council as described in the Schedule below is hereby dedicated as public road.

JEREMY BATH, Chief Executive Officer, Newcastle City Council, PO Box 489, Newcastle, NSW 2300.

SCHEDULE

The land comprising part of streets known as Barber Street and Dora Street at Mayfield, in the Parish of Newcastle, County of Northumberland, shown as road on DP 975396 and DP 36900, as shown highlighted on the attached plan.



[n2018-1533]

NEWCASTLE CITY COUNCIL

Roads Act 1993, Section 16

Dedication of Land as Public Road

NOTICE is hereby given that in accordance with the provisions of section 16 of the *Roads Act 1993*, the land held by Council as described in the Schedule below is hereby dedicated as public road.

JEREMY BATH, Chief Executive Officer, Newcastle City Council, PO Box 489, Newcastle, NSW 2300.

SCHEDULE

The land comprising streets known as Berkley Street and Mulgrave Street at Mayfield, in the Parish of Newcastle, County of Northumberland, shown as road on DP 9980, as shown highlighted on the attached plan.



[n2018-1534]

NEWCASTLE CITY COUNCIL

Roads Act 1993, Section 16

Dedication of Land as Public Road

NOTICE is hereby given that in accordance with the provisions of section 16 of the *Roads Act 1993*, the land held by Council as described in the Schedule below is hereby dedicated as public road.

JEREMY BATH, Chief Executive Officer, Newcastle City Council, PO Box 489, Newcastle, NSW 2300.

SCHEDULE

The land comprising part of streets at Mayfield, in the Parish of Newcastle, County of Northumberland, shown as road on DP 977443 and DP 2236, as shown highlighted on the attached plan.



[n2018-1535]

NORTHERN BEACHES COUNCIL

ROADS ACT 1993

Naming of Roads

Notice is hereby given that Northern Beaches Council, pursuant to section 162 of the *Roads Act 1993*, has officially named the road(s) as shown hereunder:

Name	Locality
BAZ RETREAT	Warriewood
Description	
Beginning at approximately 500m along Lorikeet Grove, bearing north-east for 50m then turning north-west for 100m, terminating at a cul-de-sac	

HELEN LEVER, Acting Chief Executive Officer, Northern Beaches Council, 725 Pittwater Road, DEE WHY NSW 2099

GNB Ref: 0092

[n2018-1536]

ORANGE CITY COUNCIL

Roads Act 1993

Notice of Dedication of Land as Public Road at Orange in the Orange City Council area

Orange City Council, by its General Manager, dedicates the land described in the Schedule below as public road under Section 10 of the *Roads Act 1993*.

Garry Styles
 General Manager
 Orange City Council
 PO Box 35
 Orange NSW 2800

SCHEDULE

ALL those pieces or parcels of land situated in the Orange City Council area, Parish of Orange and County of Bathurst, shown as:

Description of Land	Title Particulars
Lot 211 DP 1209495, Telopea Way, Orange	Certificate of Title Identifier 211/1209495

[n2018-1537]

SHOALHAVEN CITY COUNCIL

ROADS ACT 1993

Naming of Roads

Notice is hereby given that Shoalhaven City Council, pursuant to section 162 of the *Roads Act 1993*, has officially named the road(s) as shown hereunder:

Name	Locality
CONWAY CREST	Berry
Description	
New enclosed road created in the staged subdivision of Lot 528 DP 1235742. The road commences approximately 900m along Parker Crescent in a northerly direction.	

RUSS PIGG, General Manager, Shoalhaven City Council, PO Box 42, NOWRA NSW 2541

GNB Ref: 0091

[n2018-1538]

SINGLETON COUNCIL

ROADS ACT 1993

Naming of Roads

Notice is hereby given that Singleton Council, pursuant to section 162 of the *Roads Act 1993*, has officially named the road(s) as shown hereunder:

Name	Locality
FALCON CRESCENT	Lower Belford
Description	
Approximately 1.3km along proposed road Wren Drive continuing in a North easterly direction to finish in a cul-de-sac	

Name	Locality
KOOKABURRA CLOSE	Lower Belford
Description	
Approximately 800m along Proposed Road Falcon Crescent in a Northerly Direction to head in a easterly direction to finish in a cul de sac	

Name	Locality
BLUEBELL CRESCENT	Lower Belford
Description	
Approximately 300m along proposed Wren Drive, heading in a northerly direction to finish in a cul- de – sac	

Name	Locality
WREN DRIVE	Lower Belford
Description	
Approximately 159m between the junction of Lot 12 DP 1100005 and lot 13 DP 1100005 and heading in a westerly direction for approximately 4.6km to end at existing boundaries of Lot 177 DP 1183864.	

Name	Locality
CURRAWONG STREET	Lower Belford
Description	
Approximately 1km in a southerly direction on proposed road Wren Drive, to head in a South Westerly Direction for approximately 300m to then join with proposed road Eagle Close	

Name	Locality
EAGLE CLOSE	Lower Belford
Description	
Approximately 2.3km in a clockwise direction from the start of proposed road Wren Drive. heading in a Northerly direction to end in a cul de sac	

Name	Locality
HAWK CRESCENT	Lower Belford
Description	
Lot 13 1100005 extending to Lot 12 1100005	

JASON LINNANE, General Manager, Singleton Council, P.O. Box 314, SINGLETON NSW 2330

GNB Ref: 0058

[n2018-1539]

THE HILLS SHIRE COUNCIL

ROADS ACT 1993

Naming of Roads

Notice is hereby given that The Hills Shire Council, pursuant to section 162 of the *Roads Act 1993*, has officially named the road(s) as shown hereunder:

Name	Locality
ARCTURUS RISE	Box Hill
Description	
Extending in a northerly direction from Andromeda Parkway ending at Luminous Way. (Private Road/ Open Access way)	

MICHAEL EDGAR, General Manager, The Hills Shire Council, 3 Columbia Court, BAULKHAM HILLS NSW 2153

GNB Ref: 0086

[n2018-1540]

THE HILLS SHIRE COUNCIL

ROADS ACT 1993

Naming of Roads

Notice is hereby given that The Hills Shire Council, pursuant to section 162 of the *Roads Act 1993*, has officially named the road(s) as shown hereunder:

Name	Locality
MARYLAND STREET	Kellyville
Description	
Extending in a westerly direction from Stringer Road ending in a cul-de-sac (public road)	

Name	Locality
KURNELL PLACE	Kellyville
Description	
Extending in a northerly direction from proposed public road ‘Maryland Street’ ending in a cul-de-sac (private road)	

Name	Locality
RAMORNIE DRIVE	Kellyville
Description	
Extending in a southerly direction from proposed public road ‘Maryland Street’ ending at Expedition Street (private road)	

MICHAEL EDGAR, General Manager, The Hills Shire Council, 3 Columbia Court, BAULKHAM HILLS NSW 2153

GNB Ref: 0088

[n2018-1541]

WINGECARRIBEE SHIRE COUNCIL

Roads Act 1993, Section 10

Dedication of Land as Public Road

NOTICE is hereby given by Wingecarribee Shire Council, pursuant to section 16 of the *Roads Act 1993*, that the land described in the Schedule below is hereby dedicated as public road. Dated at Moss Vale 18 April, 2018. Ann Prendergast, General Manager, Wingecarribee Shire Council, Civic Centre, 68 Elizabeth St, Moss Vale NSW 2577.

.....
General Manager

SCHEDULE

Argyle Street shown within Deposited Plan 2133 dated 12 July 1979.

[n2018-1542]

WOLLONDILLY SHIRE COUNCIL

Roads Act 1993, Section 10

Dedication of Land as Public Road

NOTICE is hereby given by Wollondilly Shire Council, pursuant to section 10 of the *Roads Act 1993*, that the land described in the Schedule below is hereby dedicated as public road. Dated at Picton 28 April 2018, Luke Johnson, General Manager, Wollondilly Shire Council, 62-64 Menangle Street, Picton NSW 2571.

SCHEDULE

Lot 1 in Deposited Plan 667407

[n2018-1543]

PRIVATE NOTICES

Estate Notices

NOTICE OF INTENDED DISTRIBUTION

ESTATE OF LYNN LESLEY DAVIS

NSW GRANT MADE 5 APRIL 2018

Any person having any claim upon the estate of LYNN LESLEY DAVID late of 42 Dalley Street, Bonnells Bay who died on 14 December 2017, must send particulars of the claim to the legal representative for the estate care of Cleary Solicitors, 9 Broken Bay Road, Ettalong Beach NSW 2257 (DX 8809 Woy Woy) within 30 days from publication of this notice. After that time and after 6 months from the date of death of the deceased the legal representative intends to distribute the property in the estate having regard only to the claims of which the legal representative had notice at the time of distribution.

[n2018-1544]

NOTICE OF INTENDED DISTRIBUTION

ESTATE OF KENNETH ALLAN MOSES

NSW GRANT MADE 18 APRIL 2018

Any person having any claim upon the estate of KENNETH ALLAN MOSES late of 25 Nyah Road, Somersby who died on 7 December 2017, must send particulars of the claim to the legal representative for the estate at care of Cleary Solicitors, 9 Broken Bay Road, Ettalong Beach NSW 2257 (DX 8809 Woy Woy) within 30 days from publication of this notice. After that time and after 6 months from the date of death of the deceased the legal representative intends to distribute the property in the estate having regard only to the claims of which the legal representative had notice at the time of distribution.

[n2018-1545]