



NORTHERN TERRITORY OF AUSTRALIA

# Government Gazette

ISSN 0157 8324

No. G20

DARWIN

18 May 2011

## GENERAL INFORMATION

General issues of the *Gazette* contain notices under the following headings: Proclamations; Legislative (Acts of Parliament assented to, Statutory Rules, By laws, Regulations); Government departments administering particular legislation or functions; Notices under the Companies (Northern Territory) Code; Planning Act; Crown Lands Act; Private Notices; Tenders Invited; Contracts Awarded. Copies of each week's General *Gazette* are available for a cost of \$1.10 each (plus postage) and are published on a Wednesday. Copies of each week's Special *Gazettes* are available separately for a cost of \$1.10 each (plus postage). Special *Gazettes* are supplied with General *Gazettes* on a Wednesday and they are sold at \$1.10 per set (plus postage). Annual subscription rates apply from 1 July 2001. All current paid subscriptions will not be effected and will continue until their expiry dates.

**NOTICES FOR PUBLICATION** and related correspondence should be addressed to:

*Gazette* Office  
GPO Box 1447  
Darwin NT 0801  
Telephone: 08 8999 4005  
Facsimile: 08 8999 4037  
Email: ray.ellen@nt.gov.au

or hand delivered to the reception desk  
Government Printing Office  
203 Stuart Highway, Parap.

Notices are accepted for publication in the next available issue, unless otherwise specified.

Two copies with a covering sheet stating contact name, telephone, facsimile and or e mail details is also requested with all material submitted for publication.

**CLOSING TIMES:** Notices for publication should be lodged at the *Gazette* Office by the following time (except holiday periods for which special advice of earlier closing times will be given).

**THE CLOSING TIME FOR ALL NOTICES IN THE GENERAL GAZETTE IS 4PM WEDNESDAY THE WEEK PRIOR TO PUBLICATION.**

**SUBSCRIPTIONS** are payable in advance and are accepted for a maximum period of one calendar year. All subscriptions are on a firm basis and refunds for cancellations will not be given. Rates include surface postage in Australia and overseas. Other carriage rates are available on application.

**AVAILABILITY:** The *Gazette* may be purchased by mail from:

Retail Sales  
Government Printing Office  
GPO Box 1447  
Darwin NT 0801  
Telephone: 08 8999 4031

or purchased from

Retail Sales  
Government Printing Office  
203 Stuart Highway, Parap  
Telephone: 08 8999 4031

Northern Territory Acts, Regulations and other Northern Territory Government legislation are only obtained from the Government Publications Office, Darwin.

The *Gazette* is available for perusal at the Government Printing Office.

**ALLREMITTANCES** should be made payable to: Receiver of Territory Monies, Government Printing Office and marked to the attention of the *Gazette* Office.

## OTHER ISSUES OF THE GAZETTE

**Special *Gazettes*** are published on urgent matters as required. Officers responsible for arranging the insertion of urgent notices should refer to the *Gazette* Officer on this subject. They are supplied free of charge to subscribers to the General *Gazettes* or are available separately for purchase from Retail Sales.

**Registration *Gazettes*** which are published periodically are available for purchase from Retail Sales.



Northern Terri

**Control of Roads Act****TEMPORARY ROAD RESTRICTIONS**

I, PHILLIP HARRIS, Regional Director Katherine, as delegate of the Minister for Transport and Infrastructure, being satisfied saturated pavement may make the road or part of the road specified in column 1 of the Schedule subject to deterioration by the passage of vehicles, pursuant to section 11A(3)(a) and (5) of the *Control of Roads Act*, give notice of the following decisions:

- (a) pursuant to section 11A(1)(b) of the *Act*, use of the road or part of the road is restricted to vehicles
- (i) the mass of each of which does not exceed the mass specified in column 2 of the Schedule; or
  - (ii) the mass of each of which does not exceed the percentage of the mass limit for the type of axle or axle group (other than a steer axle) specified in column 3 of the Schedule and the total number of axles of which does not exceed the number specified in that column;
- (b) pursuant to section 11A(1)(d) of the *Act*, the restrictions on the use or manner of use specified in column 4 of the Schedule are imposed,

from 2.00pm, Thursday, 5 May 2011.

For this notice, "GCM" or an expression relating the specifications for a vehicle has the same meaning as it has under the Motor Vehicle (Standards) Regulations; except that "GVM" has the same meaning as it has under the Australian Road Rules.

Dated 5th May, 2011.

P. HARRIS  
Regional Director  
Katherine

**SCHEDULE**

| Column 1<br>Road  | Column 2<br>Mass | Column 3<br>Percentage mass<br>limit and axles                             | Column 4<br>Restrictions |
|---|------------------|--|--------------------------|
| Duncan<br>Road<br>from<br>Victoria<br>Highway<br>to the<br>Western<br>Australia<br>border | N/A              | 100%<br>Legal Limits,<br>Maximum<br>13 Axles,<br>empty travel<br>permitted | N/A                      |

**1/20**

**Control of Roads Act****REVOCATION OF TEMPORARY  
ROAD RESTRICTIONS**

I, PHILLIP HARRIS, Regional Director Katherine, as delegate of the Minister for Transport and Infrastructure, being satisfied the road or part of the road specified in column one of the Schedule, the use of which has been restricted

- (a) to vehicles the mass of each of which does not exceed the mass specified in column 2 or 3 of the Schedule; and
- (b) in the manner specified in column 4,

is no longer subject to deterioration by the passage of vehicles, pursuant to section 11A(4) and (5) of the *Control of Roads Act*, give notice of revocation of the decision to impose the restrictions from 2.00pm, Thursday, 5 May 2011.

Dated 5th May, 2011.

P. HARRIS  
Regional Director  
Katherine

**SCHEDULE**

| Column 1<br>Road | Column 2<br>Mass          | Column 3<br>Percentage mass<br>limit and axles | Column 4<br>Restrictions |
|------------------|---------------------------|--|--------------------------|
| Duncan<br>Road   | Maximum<br>GVM<br>8 tonne | N/A  | N/A                      |

"Pursuant to s11A(4) of the *Control of Roads Act*, signage removal was authorised on \*2.00pm, Thursday, 5 May 2011."

**2/20**

**Control of Roads Act****REVOCATION OF TEMPORARY  
ROAD RESTRICTIONS**

I, PHILLIP HARRIS, Regional Director Katherine, as delegate of the Minister for Transport and Infrastructure, being satisfied the road or part of the road specified in column one of the Schedule, the use of which has been restricted

- (a) to vehicles the mass of each of which does not exceed the mass specified in column 2 or 3 of the Schedule; and
- (b) in the manner specified in column 4,

is no longer subject to deterioration by the passage of vehicles, pursuant to section 11A(4) and (5) of the *Control of Roads Act*, give notice of revocation of the decision to impose the restrictions from 8.00am, Thursday, 5 May 2011.

Dated 5th May, 2011.

P. HARRIS  
Regional Director  
Katherine

**SCHEDULE**

| Column 1<br>Road       | Column 2<br>Mass | Column 3<br>Percentage mass<br>limit and axles                                  | Column 4<br>Restrictions |
|------------------------|------------------|---|--------------------------|
| Carpentaria<br>Highway | N/A              | 80% Axle<br>Group<br>Limit,<br>Maximum<br>7 Axles,<br>empty travel<br>permitted | N/A                      |

"Pursuant to s11A(4) of the *Control of Roads Act*, signage removal was authorised on \*8.00am, Thursday, 5 May 2011."

**3/20**

**Control of Roads Act****TEMPORARY ROAD RESTRICTIONS**

I, PHILLIP HARRIS, Regional Director Katherine, as delegate of the Minister for Transport and Infrastructure, being satisfied saturated pavement may make the road or part

of the road specified in column 1 of the Schedule subject to deterioration by the passage of vehicles, pursuant to section 11A(3)(a) and (5) of the *Control of Roads Act*, give notice of the following decisions:

- (a) pursuant to section 11A(1)(b) of the *Act*, use of the road or part of the road is restricted to vehicles
  - (i) the mass of each of which does not exceed the mass specified in column 2 of the Schedule; or
  - (ii) the mass of each of which does not exceed the percentage of the mass limit for the type of axle or axle group (other than a steer axle) specified in column 3 of the Schedule and the total number of axles of which does not exceed the number specified in that column;
- (b) pursuant to section 11A(1)(d) of the *Act*, the restrictions on the use or manner of use specified in column 4 of the Schedule are imposed,

from 8.00am, Thursday, 5 May 2011.

For this notice, "GCM" or an expression relating the specifications for a vehicle has the same meaning as it has under the Motor Vehicle (Standards) Regulations; except that "GVM" has the same meaning as it has under the Australian Road Rules.

Dated 5th May, 2011.

P. HARRIS  
Regional Director  
Katherine

**SCHEDULE**

| Column 1<br>Road  | Column 2<br>Mass | Column 3<br>Percentage mass<br>limit and axles              | Column 4<br>Restrictions |
|---|------------------|---|--------------------------|
| Carpentaria Highway from Stuart Highway to the Tablelands Highway | N/A              | 100% Legal Limits, Maximum 13 Axles, empty travel permitted | N/A                      |

**4/20**

**Control of Roads Act**

**REVOCATION OF TEMPORARY ROAD RESTRICTIONS**

I, BONNIE KAPPLER THOMPSON, Acting Regional Director Tennant Creek, as delegate of the Minister for Transport and Infrastructure, being satisfied the road or part of the road specified in column one of the Schedule, the use of which has been restricted

- (a) to vehicles the mass of each of which does not exceed the mass specified in column 2 or 3 of the Schedule; and
- (b) in the manner specified in column 4,

is no longer subject to deterioration by the passage of vehicles, pursuant to section 11A(4) and (5) of the *Control of Roads Act*, give notice of revocation of the decision to impose the restrictions from 2.30pm, Thursday, 5 May 2011.

Dated 5th May, 2011.

B. KAPPLER THOMPSON  
Acting Regional Director  
Tennant Creek

**SCHEDULE**

| Column 1<br>Road   | Column 2<br>Mass | Column 3<br>Percentage mass<br>limit and axles | Column 4<br>Restrictions |
|--|------------------|--|--------------------------|
| Carpentaria Highway between Tablelands Highway and Wollongorang Robinson Road Intersection | N/A              | 80% Axle Group Limit                           | N/A                      |

"Pursuant to s11A(4) of the *Control of Roads Act*, signage removal was authorised on \*2.30pm, Thursday, 5 May 2011."

**5/20**

**Control of Roads Act**

**TEMPORARY ROAD RESTRICTIONS**

I, BONNIE KAPPLER THOMPSON, Acting Regional Director Tennant Creek, as delegate of the Minister for Transport and Infrastructure, being satisfied saturated pavement may make the road or part of the road specified in column 1 of the Schedule subject to deterioration by the passage of vehicles, pursuant to section 11A(3)(a) and (5) of the *Control of Roads Act*, give notice of the following decisions:

- (a) pursuant to section 11A(1)(b) of the *Act*, use of the road or part of the road is restricted to vehicles
  - (i) the mass of each of which does not exceed the mass specified in column 2 of the Schedule; or
  - (ii) the mass of each of which does not exceed the percentage of the mass limit for the type of axle or axle group (other than a steer axle) specified in column 3 of the Schedule and the total number of axles of which does not exceed the number specified in that column;
- (b) pursuant to section 11A(1)(d) of the *Act*, the restrictions on the use or manner of use specified in column 4 of the Schedule are imposed,

from 2.30pm, Thursday, 5 May 2011.

For this notice, "GCM" or an expression relating the specifications for a vehicle has the same meaning as it has under the Motor Vehicle (Standards) Regulations; except that "GVM" has the same meaning as it has under the Australian Road Rules.

Dated 5th May, 2011.

B. KAPPLER THOMPSON  
Acting Regional Director  
Tennant Creek

## SCHEDULE

| Column 1<br>Road   | Column 2<br>Mass | Column 3<br>Percentage mass<br>limit and axles              | Column 4<br>Restrictions |
|--|------------------|---|--------------------------|
| Carpentaria Highway between Tablelands Highway and McArthur River Mine | N/A              | 100% Legal Limits, Maximum 13 Axles, empty travel permitted | N/A                      |

**6/20****Control of Roads Act**

## TEMPORARY ROAD RESTRICTIONS

I, BONNIE KAPPLER THOMPSON, Acting Regional Director Tennant Creek, as delegate of the Minister for Transport and Infrastructure, being satisfied saturated pavement may make the road or part of the road specified in column 1 of the Schedule subject to deterioration by the passage of vehicles, pursuant to section 11A(3)(a) and (5) of the *Control of Roads Act*, give notice of the following decisions:

- (a) pursuant to section 11A(1)(b) of the *Act*, use of the road or part of the road is restricted to vehicles
- (i) the mass of each of which does not exceed the mass specified in column 2 of the Schedule; or
  - (ii) the mass of each of which does not exceed the percentage of the mass limit for the type of axle or axle group (other than a steer axle) specified in column 3 of the Schedule and the total number of axles of which does not exceed the number specified in that column;
- (b) pursuant to section 11A(1)(d) of the *Act*, the restrictions on the use or manner of use specified in column 4 of the Schedule are imposed,

from 2.30pm, Thursday, 5 May 2011.

For this notice, "GCM" or an expression relating the specifications for a vehicle has the same meaning as it has under the Motor Vehicle (Standards) Regulations; except that "GVM" has the same meaning as it has under the Australian Road Rules.

Dated 5th May, 2011.

B. KAPPLER THOMPSON  
Acting Regional Director  
Tennant Creek

## SCHEDULE

| Column 1<br>Road   | Column 2<br>Mass | Column 3<br>Percentage mass<br>limit and axles | Column 4<br>Restrictions |
|--|------------------|--|--------------------------|
| Carpentaria Highway between McArthur River Mine and Wollgorang Road Intersection | N/A              | 80% Axle Group Limit                           | N/A                      |

**7/20****Control of Roads Act**

## REVOCATION OF TEMPORARY ROAD CLOSURE

I, PETER FRANCIS TOLL, Project Director Civil Darwin, as delegate of the Minister for Transport and Infrastructure, being satisfied the road or part of the road specified in the Schedule that has been closed is no longer subject to deterioration by the passage of vehicles, pursuant to section 11A(4) and (5) of the *Control of Roads Act*, give notice of revocation of the decision to close the road or part of the road from 9.30am, Friday, 6 May 2011.

Dated 6th May, 2011.

P. F. TOLL  
Project Director  
Civil Darwin

## SCHEDULE

(Litchfield Park Road at lower Finnis River crossing)

**8/20****Control of Roads Act**

## TEMPORARY ROAD RESTRICTIONS

I, PETER FRANCIS TOLL, Project Director Civil Darwin, as delegate of the Minister for Transport and Infrastructure, being satisfied saturated pavement may make the road or part of the road specified in column 1 of the Schedule subject to deterioration by the passage of vehicles, pursuant to section 11A(3)(a) and (5) of the *Control of Roads Act*, give notice of the following decisions:

- (a) pursuant to section 11A(1)(b) of the *Act*, use of the road or part of the road is restricted to vehicles
- (i) the mass of each of which does not exceed the mass specified in column 2 of the Schedule; or
  - (ii) the mass of each of which does not exceed the percentage of the mass limit for the type of axle or axle group (other than a steer axle) specified in column 3 of the Schedule and the total number of axles of which does not exceed the number specified in that column;
- (b) pursuant to section 11A(1)(d) of the *Act*, the restrictions on the use or manner of use specified in column 4 of the Schedule are imposed,

from 9.30am, Friday, 6 May 2011.

For this notice, "GCM" or an expression relating the specifications for a vehicle has the same meaning as it has under the Motor Vehicle (Standards) Regulations; except that "GVM" has the same meaning as it has under the Australian Road Rules.

Dated 6th May, 2011.

P. F. TOLL  
Project Director  
Civil Darwin

## SCHEDULE

| Column 1<br>Road  | Column 2<br>Mass    | Column 3<br>Percentage mass<br>limit and axles | Column 4<br>Restrictions |
|---|---------------------|--|--------------------------|
| Litchfield Park Road between Wangi Station Intersection and Cox Peninsula Road Intersection | Maximum GVM 8 tonne | N/A  | N/A                      |

**9/20**

**Control of Roads Act**

**ORDER TO CLOSE PART OF ROAD**

I, CRAIG REDMOND BRADLEY, Director Land Administration, as delegate of the Minister for Lands and Planning, under section 32(1)(a) and (b) of the *Control of Roads Act*, order that part of Marlow Road indicated by bold lines on the diagram in the Schedule and more particularly delineated on Survey Plan No. S2010/182B deposited with the Surveyor General, be closed 1 month after the later date of publication of this order under section 32(1) of the *Act*.

Dated 6th May, 2011.

C. R. BRADLEY  
Director  
Land Administration

**SCHEDULE  
PROPOSED ROAD CLOSURE**

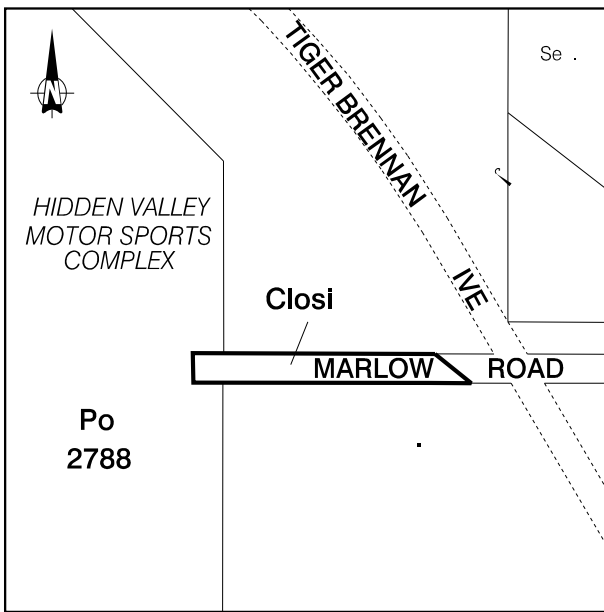

**Note**

Survey Plan No. S2010/182B may be inspected at the office of the Surveyor General, National Australia Bank House, Darwin.

**10/20**

**Control of Roads Act**

**TEMPORARY ROAD RESTRICTIONS**

I, PETER FRANCIS TOLL, Project Director Civil Darwin, as delegate of the Minister for Transport and Infrastructure, being satisfied saturated pavement may make the road or part of the road specified in column 1 of the Schedule subject to deterioration by the passage of vehicles, pursuant to section 11A(3)(a) and (5) of the *Control of Roads Act*, give notice of the following decisions:

- (a) pursuant to section 11A(1)(b) of the *Act*, use of the road or part of the road is restricted to vehicles
  - (i) the mass of each of which does not exceed the mass specified in column 2 of the Schedule; or
  - (ii) the mass of each of which does not exceed the percentage of the mass limit for the type of axle or axle group (other than a steer axle) specified in column 3 of the Schedule and the total number of axles of which does not exceed the number specified in that column;

- (b) pursuant to section 11A(1)(d) of the *Act*, the restrictions on the use or manner of use specified in column 4 of the Schedule are imposed,

from 9.20am, Monday, 9 May 2011.

For this notice, "GCM" or an expression relating the specifications for a vehicle has the same meaning as it has under the Motor Vehicle (Standards) Regulations; except that "GVM" has the same meaning as it has under the Australian Road Rules.

Dated 9th May, 2011.

P. F. TOLL  
Project Director  
Civil Darwin

**SCHEDULE**

| Column 1<br>Road | Column 2<br>Mass | Column 3<br>Percentage mass limit and axles                 | Column 4<br>Restrictions |
|------------------|------------------|---|--------------------------|
| Fog Bay Road     | N/A              | 100% Legal Limits, Maximum 13 Axles, empty travel permitted | N/A                      |

**11/20**

**Control of Roads Act**

**REVOCATION OF TEMPORARY ROAD RESTRICTIONS**

I, PETER FRANCIS TOLL, Project Director Civil Darwin, as delegate of the Minister for Transport and Infrastructure, being satisfied the road or part of the road specified in column one of the Schedule, the use of which has been restricted

- (a) to vehicles the mass of each of which does not exceed the mass specified in column 2 or 3 of the Schedule; and
- (b) in the manner specified in column 4,

is no longer subject to deterioration by the passage of vehicles, pursuant to section 11A(4) and (5) of the *Control of Roads Act*, give notice of revocation of the decision to impose the restrictions from 9.20am, Monday, 9 May 2011.

Dated 9th May, 2011.

P. F. TOLL  
Project Director  
Civil Darwin

**SCHEDULE**

| Column 1<br>Road | Column 2<br>Mass | Column 3<br>Percentage mass limit and axles                   | Column 4<br>Restrictions |
|------------------|------------------|---|--------------------------|
| Fog Bay Road     | N/A              | 80% Axle Group Limit, Maximum 7 Axles, empty travel permitted | N/A                      |

"Pursuant to s11A(4) of the *Control of Roads Act*, signage removal was authorised on \*9.20am, Monday, 9 May 2011."

**12/20**

**Control of Roads Act**  
**REVOCATION OF TEMPORARY**  
**ROAD RESTRICTIONS**

I, PETER FRANCIS TOLL, Project Director Civil Darwin, as delegate of the Minister for Transport and Infrastructure, being satisfied the road or part of the road specified in column one of the Schedule, the use of which has been restricted

- (a) to vehicles the mass of each of which does not exceed the mass specified in column 2 or 3 of the Schedule; and  
(b) in the manner specified in column 4,

is no longer subject to deterioration by the passage of vehicles, pursuant to section 11A(4) and (5) of the *Control of Roads Act*, give notice of revocation of the decision to impose the restrictions from 3.00pm, Monday, 9 May 2011.

Dated 9th May, 2011.

P. F. TOLL  
Project Director  
Civil Darwin

**SCHEDULE**

| Column 1<br>Road | Column 2<br>Mass  | Column 3<br>Percentage mass<br>limit and axles | Column 4<br>Restrictions |
|------------------|---|--|--------------------------|
| Marindja<br>Road | Maximum<br>GVM<br>4.5 tonne,<br>light<br>vehicles<br>only | N/A  | N/A                      |

“Pursuant to s11A(4) of the *Control of Roads Act*, signage removal was authorised on \*3.00pm, Monday, 9 May 2011.”

**13/20**

**Control of Roads Act**  
**TEMPORARY ROAD RESTRICTIONS**

I, PETER FRANCIS TOLL, Project Director Civil Darwin, as delegate of the Minister for Transport and Infrastructure, being satisfied saturated pavement may make the road or part of the road specified in column 1 of the Schedule subject to deterioration by the passage of vehicles, pursuant to section 11A(3)(a) and (5) of the *Control of Roads Act*, give notice of the following decisions:

- (a) pursuant to section 11A(1)(b) of the *Act*, use of the road or part of the road is restricted to vehicles
- (i) the mass of each of which does not exceed the mass specified in column 2 of the Schedule; or
- (ii) the mass of each of which does not exceed the percentage of the mass limit for the type of axle or axle group (other than a steer axle) specified in column 3 of the Schedule and the total number of axles of which does not exceed the number specified in that column;
- (b) pursuant to section 11A(1)(d) of the *Act*, the restrictions on the use or manner of use specified in column 4 of the Schedule are imposed,

from 3.00pm, Monday, 9 May 2011.

Forthis notice, “GCM” or an expression relating the specifications for a vehicle has the same meaning as it has

under the Motor Vehicle (Standards) Regulations; except that “GVM” has the same meaning as it has under the Australian Road Rules.

Dated 9th May, 2011.

P. F. TOLL  
Project Director  
Civil Darwin

**SCHEDULE**

| Column 1<br>Road | Column 2<br>Mass | Column 3<br>Percentage mass<br>limit and axles                             | Column 4<br>Restrictions |
|------------------|------------------|--|--------------------------|
| Marindja<br>Road | N/A              | 100% Legal<br>Limits,<br>Maximum<br>13 Axles,<br>empty travel<br>permitted | N/A                      |

**14/20**

**Control of Roads Act**  
**REVOCATION OF TEMPORARY**  
**ROAD RESTRICTIONS**

I, PETER FRANCIS TOLL, Project Director Civil Darwin, as delegate of the Minister for Transport and Infrastructure, being satisfied the road or part of the road specified in column one of the Schedule, the use of which has been restricted

- (a) to vehicles the mass of each of which does not exceed the mass specified in column 2 or 3 of the Schedule; and  
(b) in the manner specified in column 4,

is no longer subject to deterioration by the passage of vehicles, pursuant to section 11A(4) and (5) of the *Control of Roads Act*, give notice of revocation of the decision to impose the restrictions from 3.00pm, Monday, 9 May 2011.

Dated 9th May, 2011.

P. F. TOLL  
Project Director  
Civil Darwin

**SCHEDULE**

| Column 1<br>Road   | Column 2<br>Mass | Column 3<br>Percentage mass<br>limit and axles                               | Column 4<br>Restrictions |
|--|------------------|--|--------------------------|
| Litchfield<br>Park Road<br>between<br>Windmill<br>Road<br>Intersection<br>and Wangi<br>Station<br>Intersection | N/A              | 80% Axle<br>Group Limit,<br>Maximum<br>7 Axles,<br>empty travel<br>permitted | N/A                      |

“Pursuant to s11A(4) of the *Control of Roads Act*, signage removal was authorised on \*3.00pm, Monday, 9 May 2011.”

**15/20**

**Control of Roads Act**  
**PERMANENT ROAD RESTRICTIONS**

I, PETER FRANCIS TOLL, Project Director Civil Darwin, as delegate of the Minister for Transport and Infrastructure, being satisfied Steep Grade may make the road or part of

the road specified in column 1 of the Schedule subject to deterioration by the passage of vehicles, pursuant to section 11A(3)(a) and (5) of the *Control of Roads Act*, give notice of the following decisions:

- (a) pursuant to section 11A(1)(b) of the *Act*, use of the road or part of the road is restricted to vehicles
  - (i) the mass of each of which does not exceed the mass specified in column 2 of the Schedule; or
  - (ii) the mass of each of which does not exceed the percentage of the mass limit for the type of axle or axle group (other than a steer axle) specified in column 3 of the Schedule and the total number of axles of which does not exceed the number specified in that column;

- (b) pursuant to section 11A(1)(d) of the *Act*, the restrictions on the use or manner of use specified in column 4 of the Schedule are imposed,

from 3.00pm, Monday, 9 May 2011.

For this notice, "GCM" or an expression relating the specifications for a vehicle has the same meaning as it has under the Motor Vehicle (Standards) Regulations; except that "GVM" has the same meaning as it has under the Australian Road Rules.

Dated 9th May, 2011.

P. F. TOLL  
Project Director  
Civil Darwin

**SCHEDULE**

| Column 1<br>Road   | Column 2<br>Mass | Column 3<br>Percentage mass<br>limit and axles              | Column 4<br>Restrictions |
|--|------------------|---|--------------------------|
| Litchfield Park Road between Rum Jungle Road Intersection and Wangi Station Intersection | N/A              | 100% Legal Limits, Maximum 13 Axles, empty travel permitted | N/A                      |

**16/20**

**Control of Roads Act**

**TEMPORARY ROAD RESTRICTIONS**

I, PETER FRANCIS TOLL, Project Director Civil Darwin, as delegate of the Minister for Transport and Infrastructure, being satisfied saturated pavement may make the road or part of the road specified in column 1 of the Schedule subject to deterioration by the passage of vehicles, pursuant to section 11A(3)(a) and (5) of the *Control of Roads Act*, give notice of the following decisions:

- (a) pursuant to section 11A(1)(b) of the *Act*, use of the road or part of the road is restricted to vehicles
  - (i) the mass of each of which does not exceed the mass specified in column 2 of the Schedule; or
  - (ii) the mass of each of which does not exceed the percentage of the mass limit for the type of axle or axle group (other than a steer axle) specified in column 3 of the Schedule and the total number of axles of which does not exceed the number specified in that column;

- (b) pursuant to section 11A(1)(d) of the *Act*, the restrictions on the use or manner of use specified in column 4 of the Schedule are imposed,

from 10.15am, Tuesday, 10 May 2011.

For this notice, "GCM" or an expression relating the specifications for a vehicle has the same meaning as it has under the Motor Vehicle (Standards) Regulations; except that "GVM" has the same meaning as it has under the Australian Road Rules.

Dated 10th May, 2011.

P. F. TOLL  
Project Director  
Civil Darwin

**SCHEDULE**

| Column 1<br>Road   | Column 2<br>Mass    | Column 3<br>Percentage mass<br>limit and axles | Column 4<br>Restrictions |
|--|---------------------|--|--------------------------|
| Litchfield Park Road between Wangi Station Intersection and End of Unsealed Road | Maximum GVM 8 tonne | N/A  | N/A                      |

**17/20**

**Control of Roads Act**

**REVOCAION OF TEMPORARY ROAD RESTRICTIONS**

I, PETER FRANCIS TOLL, Project Director Civil Darwin, as delegate of the Minister for Transport and Infrastructure, being satisfied the road or part of the road specified in column one of the Schedule, the use of which has been restricted

- (a) to vehicles the mass of each of which does not exceed the mass specified in column 2 or 3 of the Schedule; and

- (b) in the manner specified in column 4,

is no longer subject to deterioration by the passage of vehicles, pursuant to section 11A(4) and (5) of the *Control of Roads Act*, give notice of revocation of the decision to impose the restrictions from 10.15am, Tuesday, 10 May 2011.

Dated 10th May, 2011.

P. F. TOLL  
Project Director  
Civil Darwin

**SCHEDULE**

| Column 1<br>Road  | Column 2<br>Mass    | Column 3<br>Percentage mass<br>limit and axles | Column 4<br>Restrictions |
|---|---------------------|--|--------------------------|
| Litchfield Park Road between Wangi Station Intersection Cox Peninsula Road Intersection | Maximum GVM 8 tonne | N/A  | N/A                      |

"Pursuant to s11A(4) of the *Control of Roads Act*, signage removal was authorised on \*10.15am, Tuesday, 10 May 2011."

**18/20**

**Control of Roads Act**  
REVOCATION OF TEMPORARY  
ROAD RESTRICTIONS

I, PETER FRANCIS TOLL, Project Director Civil Darwin, as delegate of the Minister for Transport and Infrastructure, being satisfied the road or part of the road specified in column one of the Schedule, the use of which has been restricted

- (a) to vehicles the mass of each of which does not exceed the mass specified in column 2 or 3 of the Schedule; and  
(b) in the manner specified in column 4,

is no longer subject to deterioration by the passage of vehicles, pursuant to section 11A(4) and (5) of the *Control of Roads Act*, give notice of revocation of the decision to impose the restrictions from 12.00pm, Tuesday, 10 May 2011.

Dated 10th May, 2011.

P. F. TOLL  
Project Director  
Civil Darwin

SCHEDULE

| Column 1<br>Road   | Column 2<br>Mass | Column 3<br>Percentage mass<br>limit and axles | Column 4<br>Restrictions |
|--|------------------|--|--------------------------|
| Dorat Road between Stuart Highway (Adelaide River) and Daly River Road | N/A              | Maximum 7 Axles, empty travel permitted        | N/A                      |

“Pursuant to s11A(4) of the *Control of Roads Act*, signage removal was authorised on \*12.00pm, Tuesday, 10 May 2011.”

**19/20**

**Control of Roads Act**  
REVOCATION OF TEMPORARY  
ROAD RESTRICTIONS

I, PETER FRANCIS TOLL, Project Director Civil Darwin, as delegate of the Minister for Transport and Infrastructure, being satisfied the road or part of the road specified in column one of the Schedule, the use of which has been restricted

- (a) to vehicles the mass of each of which does not exceed the mass specified in column 2 or 3 of the Schedule; and  
(b) in the manner specified in column 4,

is no longer subject to deterioration by the passage of vehicles, pursuant to section 11A(4) and (5) of the *Control of Roads Act*, give notice of revocation of the decision to impose the restrictions from 12.00pm, Tuesday, 10 May 2011.

Dated 10th May, 2011.

P. F. TOLL  
Project Director  
Civil Darwin

SCHEDULE

| Column 1<br>Road  | Column 2<br>Mass | Column 3<br>Percentage mass<br>limit and axles                 | Column 4<br>Restrictions |
|---|------------------|--|--------------------------|
| Dorat Road between Daly River turn off and Ooloo turn off | N/A              | 80% Axle Group Limit, Maximum 13 Axles, empty travel permitted | N/A                      |

“Pursuant to s11A(4) of the *Control of Roads Act*, signage removal was authorised on \*12.00pm, Tuesday, 10 May 2011.”

**20/20**

**Control of Roads Act**  
TEMPORARY ROAD RESTRICTIONS

I, PETER FRANCIS TOLL, Project Director Civil Darwin, as delegate of the Minister for Transport and Infrastructure, being satisfied saturated pavement may make the road or part of the road specified in column 1 of the Schedule subject to deterioration by the passage of vehicles, pursuant to section 11A(3)(a) and (5) of the *Control of Roads Act*, give notice of the following decisions:

- (a) pursuant to section 11A(1)(b) of the *Act*, use of the road or part of the road is restricted to vehicles
- (i) the mass of each of which does not exceed the mass specified in column 2 of the Schedule; or
  - (ii) the mass of each of which does not exceed the percentage of the mass limit for the type of axle or axle group (other than a steer axle) specified in column 3 of the Schedule and the total number of axles of which does not exceed the number specified in that column;

- (b) pursuant to section 11A(1)(d) of the *Act*, the restrictions on the use or manner of use specified in column 4 of the Schedule are imposed,

from 12.00pm, Tuesday, 10 May 2011.

For this notice, “GCM” or an expression relating the specifications for a vehicle has the same meaning as it has under the Motor Vehicle (Standards) Regulations; except that “GVM” has the same meaning as it has under the Australian Road Rules.

Dated 10th May, 2011.

P. F. TOLL  
Project Director  
Civil Darwin

SCHEDULE

| Column 1<br>Road | Column 2<br>Mass | Column 3<br>Percentage mass<br>limit and axles              | Column 4<br>Restrictions |
|------------------|------------------|---|--------------------------|
| Dorat Road       | N/A              | 100% Legal Limits, Maximum 13 Axles, empty travel permitted | N/A                      |

**21/20**

**Territory Parks and Wildlife Conservation Act**  
LITCHFIELD NATIONAL PARK DRAFT PLAN OF  
MANAGEMENT

The Parks and Wildlife Commission, in pursuance of section 18(7) of the *Territory Parks and Wildlife Conservation Act* gives notice that:

- (a) A draft Plan of Management in respect of Litchfield National Park has been prepared; and
- (b) interested persons are invited to make representations in connection with the plan by Friday 17 June 2011.

A copy of the Draft Plan may be viewed at [www.nt.gov.au/nretas/consult/](http://www.nt.gov.au/nretas/consult/) and may be inspected at

- Parks and Wildlife Service Office, Batchelor
- Permits Office, Goyder Centre, Palmerston



Representations in connection with the Draft Plan may be forwarded to:

Park Planning  
NRETAS

PO Box 496 Palmerston NT 0831 or  
Telephone (08) 8999 4555

Or parkplanningNRETAS@nt.gov.au

Dated 10th May, 2011.

M. WAUCHOPE  
A/ Principal Planner  
Parks and Wildlife  
Division, NRETAS

**22/20**

**Control of Roads Act**

**REVOCATION OF TEMPORARY ROAD RESTRICTIONS**

I, PETER FRANCIS TOLL, Project Director Civil Darwin, as delegate of the Minister for Transport and Infrastructure, being satisfied the road or part of the road specified in column one of the Schedule, the use of which has been restricted

- (a) to vehicles the mass of each of which does not exceed the mass specified in column 2 or 3 of the Schedule; and
- (b) in the manner specified in column 4,

is no longer subject to deterioration by the passage of vehicles, pursuant to section 11A(4) and (5) of the *Control of Roads Act*, give notice of revocation of the decision to impose the restrictions from 9.00am, Wednesday, 11 May 2011.

Dated 11th May, 2011.

P. F. TOLL  
Project Director  
Civil Darwin

**SCHEDULE**

| Column 1<br>Road | Column 2<br>Mass | Column 3<br>Percentage mass<br>limit and axles              | Column 4<br>Restrictions |
|------------------|------------------|---|--------------------------|
| Marindja Road    | N/A              | 100% Legal Limits, Maximum 13 Axles, empty travel permitted | N/A                      |

“Pursuant to s11A(4) of the *Control of Roads Act*, signage removal was authorised on \*9.00am, Wednesday, 11 May 2011.”

**23/20**

**Control of Roads Act**

**TEMPORARY ROAD RESTRICTIONS**

I, PETER FRANCIS TOLL, Project Director Civil Darwin, as delegate of the Minister for Transport and Infrastructure, being satisfied saturated pavement may make the road or part of the road specified in column 1 of the Schedule subject to deterioration by the passage of vehicles, pursuant to section 11A(3)(a) and (5) of the *Control of Roads Act*, give notice of the following decisions:

- (a) pursuant to section 11A(1)(b) of the *Act*, use of the road or part of the road is restricted to vehicles

- (i) the mass of each of which does not exceed the mass specified in column 2 of the Schedule; or
- (ii) the mass of each of which does not exceed the percentage of the mass limit for the type of axle or axle group (other than a steer axle) specified in column 3 of the Schedule and the total number of axles of which does not exceed the number specified in that column;

- (b) pursuant to section 11A(1)(d) of the *Act*, the restrictions on the use or manner of use specified in column 4 of the Schedule are imposed,

from 9.00am, Wednesday, 11 May 2011.

Forthis notice, “GCM” or an expression relating the specifications for a vehicle has the same meaning as it has under the Motor Vehicle (Standards) Regulations; except that “GVM” has the same meaning as it has under the Australian Road Rules.

Dated 11th May, 2011.

P. F. TOLL  
Project Director  
Civil Darwin

**SCHEDULE**

| Column 1<br>Road   | Column 2<br>Mass | Column 3<br>Percentage mass<br>limit and axles              | Column 4<br>Restrictions |
|--|------------------|---|--------------------------|
| Marindja Road between Litchfield Park Road Intersection and Labelle Homestead Access | N/A              | 100% Legal Limits, Maximum 13 Axles, empty travel permitted | N/A                      |

**24/20**

**Notification of Subordinate Legislation**

Notice is given of the making of the following subordinate legislation effective from the date of this *Gazette*, unless specified otherwise:

| <b>Subordinate Legislation</b>  | <b>Empowering Act</b>   |
|---|---|
| Unit Title Schemes and Related Legislation Amendment Regulations 2011 (No. 14 of 2011)        | <i>Unit Title Schemes Act</i><br><i>Land Title Act</i><br><i>Registration Act</i> |
| Justices Amendment Regulations 2011 (No. 15 of 2011) <sup>1</sup>                             | <i>Justices Act</i>   |
| Fines and Penalties (Recovery) Amendment (Plant Health) Regulations 2011 (No. 16 of 2011)     | <i>Fines and Penalties (Recovery) Act</i>   |
| Fines and Penalties (Recovery) Amendment (Control of Roads) Regulations 2011 (No. 17 of 2011) | <i>Fines and Penalties (Recovery) Act</i>   |
| Fines and Penalties (Recovery) Amendment (Education) Regulations 2011 (No. 18 of 2011)        | <i>Fines and Penalties (Recovery) Act</i>   |

Utilities Commission Amendment Regulations 2011 (No. 19 of 2011) *Utilities Commission Act*  
 Plant Health Regulations (No. 20 of 2011)<sup>2</sup> *Plant Health Act 2008*  
 Control of Roads (Infringement Notice) Regulations (No. 21 of 2011)<sup>3</sup> *Control of Roads Act*  
 Traffic Amendment (Miscellaneous) Regulations 2011 (No. 22 of 2011) *Traffic Act*

<sup>1</sup> These Regulations commence on the later of the following:

- (a) the commencement of the *Justices Legislation Amendment (Committals Reform) Act 2011*;
- (b) the date of notification of these Regulations in the *Gazette*.

<sup>2</sup> These Regulations commence on the commencement of the *Plant Health Act 2008*.

<sup>3</sup> These Regulations commence on the commencement of the *Control of Roads Amendment Act 2011*.

Copies of the legislation may be purchased at Northern Territory Government Publications, Government Printing Office, Railway Street, Parap, Darwin NT 0800, and the Alice Springs Access Centre, Westpac Building, Todd Mall, Alice Springs NT 0870.

## 25/20

### Crown Lands Act PROCLAMATION

Northern Territory of Australia  
 Thomas Ian Pauling  
 Administrator

By His Honour  
 the Administrator  
 of the Northern  
 Territory of Australia

I, THOMAS IAN PAULING, Administrator of the Northern Territory of Australia, acting with the advice of the Executive Council, under section 76(1)(d) of the *Crown Lands Act*, revoke the reservation of land known as Reserve No. 1241 over Portion 1567, Hundred of Bagot, reserved by proclamation made on 13 May 1968 and published in *Gazette* No. 29 dated 26 June 1968.

Given under my hand and the Public Seal of the Northern Territory of Australia on 10 May 2011.

T. I. PAULING  
 Administrator

By His Honour's Command  
 C. B. BURNS  
 Minister for Education and Training  
 acting for  
 Minister for Lands and Planning

## 26/20

### Control of Roads Act TEMPORARY ROAD RESTRICTIONS

I, PETER FRANCIS TOLL, Project Director Civil Darwin, as delegate of the Minister for Transport and Infrastructure, being satisfied saturated pavement may make the road or part of the road specified in column 1 of the Schedule subject to deterioration by the passage of vehicles, pursuant to section 11A(3)(a) and (5) of the *Control of Roads Act*, give notice of the following decisions:

- (a) pursuant to section 11A(1)(b) of the *Act*, use of the road or part of the road is restricted to vehicles
  - (i) the mass of each of which does not exceed the mass specified in column 2 of the Schedule; or
  - (ii) the mass of each of which does not exceed the percentage of the mass limit for the type of axle or axle group (other than a steer axle) specified in column 3 of the Schedule and the total number of axles of which does not exceed the number specified in that column;
- (b) pursuant to section 11A(1)(d) of the *Act*, the restrictions on the use or manner of use specified in column 4 of the Schedule are imposed,

from 9.00am, Wednesday, 11 May 2011.

For this notice, "GCM" or an expression relating the specifications for a vehicle has the same meaning as it has under the Motor Vehicle (Standards) Regulations; except that "GVM" has the same meaning as it has under the Australian Road Rules.

Dated 11th May, 2011.

P. F. TOLL  
 Project Director  
 Civil Darwin

### SCHEDULE

| Column 1<br>Road   | Column 2<br>Mass                          | Column 3<br>Percentage mass<br>limit and axles | Column 4<br>Restrictions |
|--|---|--|--------------------------|
| Marindja Road between Labelle Homestead Access and Channel Point Nature Park | Maximum GVM 4.5 tonne light vehicles only | N/A  | N/A                      |

## 27/20

### Livestock Act DECLARED AREA CATTLE TICKS (RHIPICEPHALUS MICROPLUS) PARKHURST STRAIN

I, KONSTANTINE VATSKALIS, Minister for Primary Industry, Fisheries and Resources, under section 58(1)(c) of the *Livestock Act*, for the control of the notifiable disease cattle ticks (*Rhipicephalus microplus*) Parkhurst strain in tick free areas, which is an endemic disease, declare the area of land described in Schedule 1 and depicted on the map in Schedule 2 to be an Infected Zone.

Dated 9th May, 2011.

K. VATSKALIS  
 Minister for Primary  
 Industry, Fisheries and  
 Resources

### SCHEDULE 1

The area of land in the Northern Territory of Australia that is west, north and east of the boundary described as follows: South from the Van Diemen Gulf along the western boundary of Kakadu (NT portions 4061 and 220), and then west along the southern boundary of Mary River (NT portion 1631) and

Mary River West (NT portion 1630) to the eastern boundary of Douglas (NT portion 2683) and then south and then west along the eastern and southern boundary of Douglas (NT portion 2683) and then south along the western boundary of Jindare (NT portion 709) and then west along the northern boundary of Wagiman (NT portion 5919) to the Daly River and then north west along the Daly River to and west along the southern boundary of Fish River (NT portions 3435 and 2700) and then north along the western boundary of Elizabeth Downs (NT portion 1666) to the Daly River and then north west along the Daly River to the Timor Sea.

- (a) approve the period of time from 9 am on Friday 1 July 2011 to 12 noon on Saturday 2 July 2011 as a period during which a person may possess shopgoods fireworks, subject to the condition that this approval does not apply to the place specified in the Schedule; and
- (b) approve the period of time from 6 pm to 11 pm on Friday 1 July 2011 as a period during which a person may throw, ignite or explode shopgoods fireworks, subject to the condition that this approval does not apply to the place specified in the Schedule.

Dated 11th May, 2011.

D. P. LAWRIE  
Minister for  
Justice and Attorney General

SCHEDULE 2

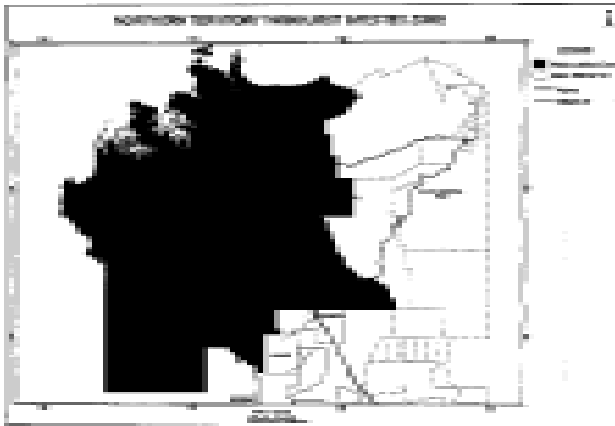

28/20

**Dangerous Goods Regulations**

**APPROVAL OF PERIOD FOR POSSESSING AND  
FOR THROWING, IGNITING OR EXPLODING  
SHOPGOODS FIREWORKS**

I, DELIA PHOEBE LAWRIE, Minister for Justice and Attorney General, under regulation 140(1) of the Dangerous Goods Regulations and with reference to regulation 140A(1) of the Regulations:

SCHEDULE

All that parcel of land at Mindil Beach in the Town of Darwin, Northern Territory of Australia bounded by lines described as follows: Commencing at the intersection of the north westerly prolongation of the north eastern boundary of Lot 5244 with the Low Water Mark of Fannie Bay; thence south easterly by the said prolongation and boundary and its southeasterly prolongation to the north easterly prolongation of the north western boundary of Lot 5257; thence south westerly to the northern corner of the said Lot; thence south easterly by its north eastern boundary to a northwestern boundary of Gilruth Avenue; thence generally north easterly by the said boundary to intersect parallel of south latitude 12 degrees 26 minutes 33.9 seconds, being a point on the centreline of a stormwater drain exiting under Gilruth Avenue; thence generally north westerly by the centreline of the said drain to intersect a south western boundary of Lot 5670; thence north west by the said boundary to the Low Water Mark of Fannie Bay; thence generally south westerly by the said Low Water Mark to the point of commencement, the position of Low Water Mark referred to being as at Lowest Astronomical Tide.

29/20

**CONTRACTS AWARDED FOR VARIOUS DEPARTMENTS**

| <b>Reference</b>                                     | <b>Service or Material</b>   | <b>Value</b>                   | <b>Contractor</b>   |
|--|--|--------------------------------|---|
|  |  | <b>\$</b>                      |   |
| <b>DARWIN PORT CORPORATION</b>                       |  |                                |   |
| Q11 0142   | Fort Hill Wharf Supply and Delivery of a Standby Generator   | 55 990<br>Public<br>Quotation  | Energy Power Systems Australia Pty Ltd,<br>PALMERSTON, NT       |
| <b>DARWIN WATERFRONT CORPORATION</b>                 |  |                                |   |
| TW85 1011<br>T11 1098                                | Darwin Waterfront West Bennett Feeder No. 2  | 586 504<br>Public              | Ribshire Pty Ltd,<br>T/as Goodline,<br>WINNELLIE, NT            |
| <b>DEPARTMENT OF BUSINESS AND EMPLOYMENT</b>         |  |                                |   |
| 11 0179  | All Centres Consultancy Course Design and Delivery for Quotation/Tender Assessment Panel Training  | 42 250<br>Quotation            | Major Training Service Pty Ltd,<br>FRESHWATER, NSW              |
| <b>DEPARTMENT OF CONSTRUCTION AND INFRASTRUCTURE</b> |  |                                |   |
| SD5263/11<br>T11 1065                                | East Arm Wharf Re gravel Shoulder  | 20 900<br>Quotation            | Diggamen Civil Contracting,<br>BERRIMAH, NT                     |
| SD5301/11<br>T11 1063                                | Alawa School Fire Damaged Preschool Playground Equipment Replacement and Installation  | 64 893<br>Sole                 | Swanshore Pty Ltd,<br>T/as Imaginationplay,<br>BAYSWATER, VIC   |
| SD5326/11<br>T11 1240                                | Darwin Upgrading of Cycle Path Corner Vanderlin Drive and Lee Point Road   | 45 480<br>Quotation            | Vrahos Construction Pty Ltd,<br>ANULA, NT                       |
| SD5333/11<br>T11 1231                                | Royal Darwin Hospital Cowdy Ward Modifications to Nurses Station   | 72 300<br>Public<br>Quotation  | ITN Joinery Cabinet Making and Construction,<br>ALAWA, NT       |
| SD5336/11<br>T10 1953B                               | Maningrida Construct Renal Ready Room to Existing Clinic   | 447 713<br>Public              | JMT Builders Pty Ltd,<br>KARAMA, NT                             |
| TW84 1011<br>T10 1852                                | Ooloo Road Upgrade and Seal Ch43.80Km to Ch47.68KM and Upgrade Various Sections of Gravel Road and Infrastructure Ch47.68Km to Ch52.50Km | 1 388 970<br>Public            | Colemans Contracting and Earthmoving Pty Ltd,<br>HUMPTY DOO, NT |
| SK5059/11<br>T11 1026A                               | Nitmiluk Gorge Supply, Delivery, Installation and Commissioning of Potable Water Tank  | 195 800<br>Public              | Scatt's Plumbing Services Pty Ltd,<br>KATHERINE, NT             |
| TW86 1011<br>T11 1012                                | Palmerston Construction of Water Park  | 14 431 151<br>Public           | Gratis Pty Ltd,<br>DARWIN, NT                                   |
| SA5118/11<br>T11 1235                                | Alice Springs CBD Construction of Two Bus Bays at Len Kittle Drive and Percy Court   | 90 930<br>Public<br>Quotation  | Chambers Engineering Services Pty Ltd,<br>ALICE SPRINGS, NT     |
| SA5117/11<br>T11 1234                                | Alice Springs CBD Construction of Two Bus Bays at North Stuart Highway   | 91 440<br>Public<br>Quotation  | Chambers Engineering Services Pty Ltd,<br>ALICE SPRINGS, NT     |
| SA5116/11<br>T11 1250                                | Alice Springs NT Emergency Services Upgrade Emergency Generator Capacity from 35KVA To 88 KVA  | 28 433<br>Quotation            | Perrys Power Equipment,<br>ALICE SPRINGS, NT                    |
| SG5027/11<br>T11 1124                                | Nhulunbuy DCI Office Upgrades  | 146 750<br>Public<br>Quotation | Zenco Constructions,<br>NHULUNBUY, NT                           |
| TW87 1011<br>T10 1902                                | Acacia Hill Special School Various Upgrade Works Stage 2B  | 2 583 545<br>Public            | Asbuild (NT) Pty Ltd,<br>ALICE SPRINGS, NT                      |
| SD5337/11<br>T10 2100                                | Palmerston Bus Interchange Upgrade Service Road  | 196 629<br>Public<br>Quotation | Ciarla Constructions Pty Ltd,<br>CASUARINA, NT                  |
| SD5341/11<br>T11 1303                                | Darwin Tiger Brennan Drive Concrete Pavement Beneath Guard Rail Ch2.60Km to Ch3.10Km Outbound  | 46 350<br>Quotation            | Work Men NT,<br>PALMERSTON, NT                                  |

| Reference  | Service or Material  | Value<br>\$                 | Contractor  |
|--|--|-----------------------------|---|
| <b>DEPARTMENT OF EDUCATION AND TRAINING</b>                          |  |                             |   |
| 10 1170  | Darwin Provision of 1 day Four Wheel Drive Training  | 30 305<br>Quotation         | Top End Training,<br>PINELANDS, NT  |
| 11 0207  | All Centres Supply Delivery and Installation of 2011 DET Show Circuit Stand  | 37 353<br>Quotation         | Fusion Displays and Graphics,<br>DARWIN, NT   |
| <b>DEPARTMENT OF HEALTH</b>  |  |                             |   |
| 352582   | Darwin Consultancy to Develop Evaluation Framework and Travel Expenses   | 27 789<br>Quotation         | Arup Pty Ltd,<br>MILLERS POINT, NSW   |
| IR360037   | Well Women's Cancer Screening, Level 1, 9 Scaturchio Street, Casuarina Repairs and Preventative Maintenance and Service on X Ray Mammography Equipment                           | 20 660<br>Quotation         | Phillips Healthcare,<br>NORTH RYDE, NSW   |
| IR390101   | Darwin Supply and Delivery of BVI6400 Handheld Bladder Scanner   | 15 950<br>Quotation         | Western Biomedical Pty Ltd,<br>SUBIACO, WA  |
| <b>DEPARTMENT OF HEALTH AND FAMILIES</b>                             |  |                             |   |
| Q10 0473   | Alice Springs Hospital Rapid Assessment Discharge Unit Supply Delivery Installation and Commissioning of Eight (8) DASH 4000 Bedside Monitors and One (1) Central Station        | 158 452<br>Sole             | GE Healthcare Australia Pty Ltd,<br>T/as GE Healthcare,<br>EXPORT PARK, SA  |
| <b>DEPARTMENT OF HOUSING, LOCAL GOVERNMENT AND REGIONAL SERVICES</b> |  |                             |   |
| D10 0462   | All Centres Panel Contract for the Provision of Casual Labour Hire for a Period of 36 Months   | 490 000<br>Public<br>(est.) | RP Project Management Pty Ltd,<br>PALMERSTON, NT<br>Ribshire Pty Ltd,<br>T/as as Goodline,<br>WINNELLIE, NT<br>Lavery Plumbing Pty Ltd,<br>TENNANT CREEK, NT<br>Randstad Pty Ltd,<br>DARWIN, NT<br>Ingkerreke Outstations Resources<br>Services,<br>T/as Ingkerreke Commercial,<br>ALICE SPRINGS, NT<br>Ross Human Directions Ltd,<br>T/as Julia Ross,<br>SYDNEY, NSW<br>Zodiac Business Services,<br>ALICE SPRINGS, NT |
| <b>DEPARTMENT OF JUSTICE</b>   |  |                             |   |
| 11 0146  | Darwin Correctional Centre Supply Delivery Installation and Commissioning of Replacement CCTV Cameras Damaged by Lightning Design and Install Solution as Cables Damaged as well | 45 475<br>Quotation         | Security Technology Services,<br>DARWIN, NT   |
| 11 0148  | Don Dale Juvenile Detention Centre Supply Delivery Installation and Commissioning of Additional CCTV Cameras Connected to CCTV Matrix  | 29 348<br>Quotation         | Security Technology Services,<br>DARWIN, NT   |
| <b>DEPARTMENT OF LANDS AND PLANNING</b>                              |  |                             |   |
| SD5338/11  | Provision of Darwin Bus Network Services   | 240 000 000                 | Buslink Pty Ltd,<br>DARWIN, NT  |

| Reference   | Service or Material  | Value<br>\$                             | Contractor   |
|---|--|---|--|
| <b>DEPARTMENT OF NATURAL RESOURCES, ENVIRONMENT, THE ARTS AND SPORT</b> |  |   |  |
| A11 0026  | Alice Springs Telegraph Station Provision of Cleaning and Rubbish Removal Services for a Period of 12 Months           | 49 983<br>Public<br>(est.)              | Alice Springs Cleaning Service,<br>ALICE SPRINGS, NT     |
| Q11 0157  | George Brown Darwin Botanic Gardens Provision of Security Services for a Period of 36 Months                           | 39 387<br>Public<br>Quotation<br>(est.) | Southern Cross Protection Pty Ltd,<br>SYDNEY, NSW        |
| D11 0116  | Consultancy The Potential Role of Market Based Instruments in Safeguarding the Water Quality in Darwin Harbour Phase 1 | 36 972<br>Exempt                        | Charles Darwin University,<br>CASUARINA, NT              |
| D11 0118  | Darwin Consultancy Catchment and Beach Bacteria Assessment Sources and Hotspots Stage 1                                | 27 501<br>Exempt                        | Charles Darwin University,<br>DARWIN, NT                 |
| D11 0080  | Darwin Frog Watch Increasing Community Education, Awareness and Management of Feral Animals for a Period of 36 Months  | 600 000<br>Sole<br>(est.)               | FrogWatch Nth Inc,<br>WAGAMAN, NT                        |
| <b>NORTHERN TERRITORY POLICE, FIRE AND EMERGENCY SERVICES</b>           |  |   |  |
| 11 0348   | Darwin Supply and Delivery of Nightscan Vertical Lights  | 40 425<br>Quotation                     | Britax Automotive Equipment<br>Pty Ltd,<br>VIRGINIA, QLD |
| <b>POWER AND WATER</b>  |  |   |  |
| PWC11 144   | Marrakai Substation Training and Commissioning of SEECO 66kV Isolator  | 16 913<br>Quotation                     | Powerline Supplies,<br>BERRIMAH, NT                      |



**NORTHERN TERRITORY GOVERNMENT PRINTING OFFICE**  
**GENERAL GAZETTE PUBLICATIONS FOR 2011**

| <b>Gazette Number</b> | <b>Publication Date</b> | <b>Closing Date</b> |
|-----------------------|-------------------------|---------------------|
| G1                    | 5 January               | 30 December         |
| G2                    | 12 January              | 5 January           |
| G3                    | 19 January              | 12 January          |
| G4                    | 26 January              | 19 January          |
| G5                    | 2 February              | 26 January          |
| G6                    | 9 February              | 2 February          |
| G7                    | 16 February             | 9 February          |
| G8                    | 23 February             | 16 February         |
| G9                    | 2 March                 | 23 February         |
| G10                   | 9 March                 | 2 March             |
| G11                   | 16 March                | 9 March             |
| G12                   | 23 March                | 16 March            |
| G13                   | 30 March                | 23 March            |
| G14                   | 6 April                 | 30 March            |
| G15                   | 13 April                | 6 April             |
| G16                   | 20 April                | 13 April            |
| G17                   | 27 April                | 20 April            |
| G18                   | 4 May                   | 27 April            |
| G19                   | 11 May                  | 4 May               |
| G20                   | 18 May                  | 11 May              |
| G21                   | 25 May                  | 18 May              |
| G22                   | 1 June                  | 25 May              |
| G23                   | 8 June                  | 1 June              |
| G24                   | 15 June                 | 8 June              |
| G25                   | 22 June                 | 15 June             |
| G26                   | 29 June                 | 22 June             |
| G27                   | 6 July                  | 29 June             |
| G28                   | 13 July                 | 6 July              |
| G29                   | 20 July                 | 13 July             |
| G30                   | 27 July                 | 20 July             |
| G31                   | 3 August                | 27 July             |
| G32                   | 10 August               | 3 August            |
| G33                   | 17 August               | 10 August           |
| G34                   | 24 August               | 17 August           |
| G35                   | 31 August               | 24 August           |
| G36                   | 7 September             | 31 August           |
| G37                   | 14 September            | 7 September         |
| G38                   | 21 September            | 14 September        |
| G39                   | 28 September            | 21 September        |
| G40                   | 5 October               | 28 September        |
| G41                   | 12 October              | 5 October           |
| G42                   | 19 October              | 12 October          |
| G43                   | 26 October              | 19 October          |
| G44                   | 2 November              | 26 October          |
| G45                   | 9 November              | 2 November          |
| G46                   | 16 November             | 9 November          |
| G47                   | 23 November             | 16 November         |
| G48                   | 30 November             | 23 November         |
| G49                   | 7 December              | 30 November         |
| G50                   | 14 December             | 7 December          |
| G51                   | 21 December             | 14 December         |

General *Gazette* publications for 2011 will be on **Wednesday's**, with the closing date for notices being the previous **Wednesday at 4.00pm.**

Notices not received by the closing time will be held over until the next issue.

All notices for publications must have a covering note with Telephone, Facsimile Number and any special requirements required.

Further information may be obtained from the **Gazette Officer** on:

Telephone: **8999 4005**  
 Facsimile: **8999 4037**  
 Email: **ray.ellen@nt.gov.au**  
**scott.sekulich@nt.gov.au**

When Emailing notices they should be sent to the two above mail addresses also a faxed copy is needed for confirmation.

**For all Subscription Enquiries:**

Telephone: **8999 4031**  
 Facsimile: **8999 4001**

**NT PUBLIC HOLIDAYS 2011**

|                    |                               |
|--------------------|-------------------------------|
| <b>3 January</b>   | <b>New Years Day</b>          |
| <b>26 January</b>  | <b>Australia Day</b>          |
| <b>22 April</b>    | <b>Good Friday</b>            |
| <b>23 April</b>    | <b>Easter Saturday</b>        |
| <b>25 April</b>    | <b>Easter Monday</b>          |
| <b>26 April</b>    | <b>Anzac Day</b>              |
| <b>2 May</b>       | <b>May Day</b>                |
| <b>13 June</b>     | <b>Queen's Birthday</b>       |
| <b>24 June</b>     | <b>Borroloola Show Day</b>    |
| <b>1 July</b>      | <b>Alice Springs Show Day</b> |
| <b>8 July</b>      | <b>Tennant Creek Show Day</b> |
| <b>15 July</b>     | <b>Katherine Show Day</b>     |
| <b>22 July</b>     | <b>Darwin Show Day</b>        |
| <b>1 August</b>    | <b>Picnic Day</b>             |
| <b>26 December</b> | <b>Christmas Day</b>          |
| <b>27 December</b> | <b>Boxing Day</b>             |