



Victoria Government Gazette

No. S 63 Friday 26 June 1998
By Authority, Victorian Government Printer

SPECIAL

Melbourne City Link Act 1995

NOTICE TO PUBLIC BODIES

In accordance with section 46 of the **Melbourne City Link Act 1995** ("the Act") notice is given of the proposal to issue a licence or licences under section 56 of the Act in respect of the land described in the Schedule below.

All public bodies (as defined in section 3 of the Act) whose interests, works or functions may be affected by a licence are requested to advise the Melbourne City Link Authority in writing of those interests, works or functions within 7 days of publication of this notice in the Government Gazette.

Responses should be forwarded directly to the Melbourne City Link Authority at Level 13, Nauru House, 80 Collins Street, Melbourne 3000 or to P.O. Box 18185, Collins Street East, Melbourne 8003, for the attention of the Director Property and Public Bodies.

Schedule

The land shown by oblique lines on the following plan beneath a depth from the surface of 15.24 metres:

UNDERGROUND LAND AT RICHMOND

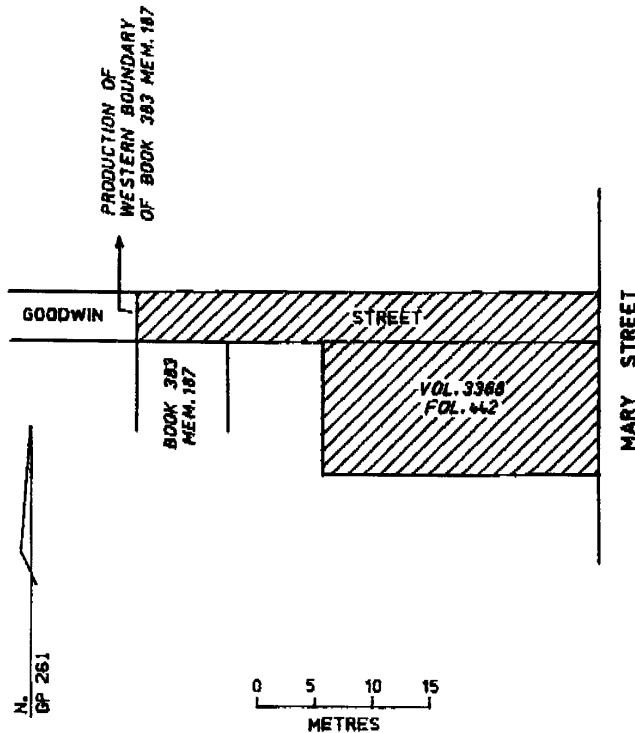

Local Government Act 1989
HUME CITY COUNCIL
Road Discontinuance

At its meeting on 30 March 1998 and acting under clause 3 of Schedule 10 to the **Local Government Act 1989**, Hume City Council ("Council") resolved to discontinue the part of a road shown enclosed by continuous thick lines having an area of 3189 square metres on the plan below.

PLAN OF ROAD CLOSURE
FORMERLY PART OF WESTERN AVENUE
TULLAMARINE

COUNTY OF BOURKE, PARISH OF TULLAMARINE
Dimension and Bearing datum based on LP 9959.
Not based on survey.
ORIGINAL SCALE 1:1000

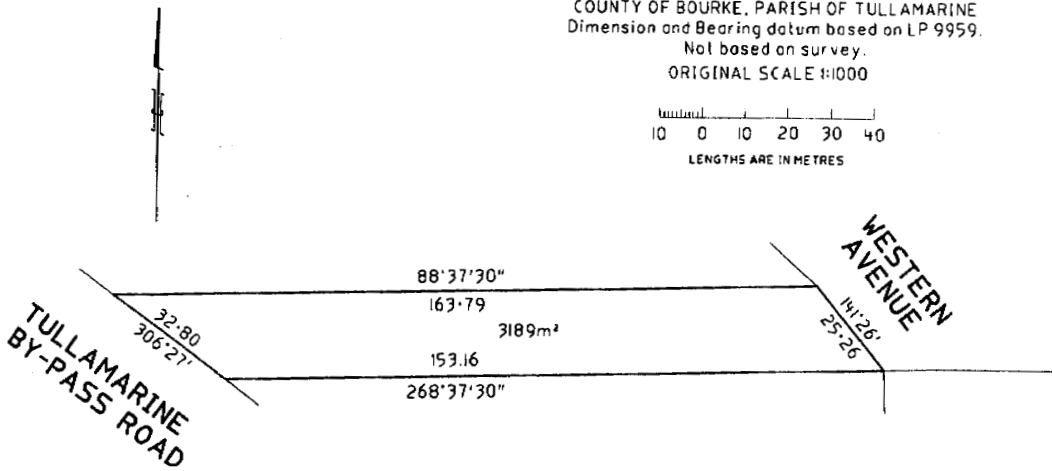
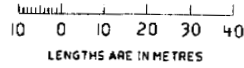

MAL LAWSON
Acting Chief Executive Officer

Gazette Services

The *Victoria Government Gazette* (VGG) is published by The Craftsman Press Pty. Ltd. for the State of Victoria and is produced in three editions.

VGG General is published each Thursday and provides information regarding Acts of Parliament and their effective date of operation; Government notices; requests for tenders; as well as contracts accepted. Private notices are also published.

VGG Special is published any day when required for urgent or special Government notices. VGG Special is made available automatically to subscribers of VGG General.

VGG Periodical is published when required and includes specialised information eg. Medical, Dental, Pharmacist's Registers etc.

Subscriptions

VGG is available by three subscription services:

The Victoria Government Gazette

General and Special - \$170.00 each year

General, Special and Periodical - \$227.00 each year

Periodical - \$113.00 each year

Subscriptions are payable in advance and accepted for a period of one year. All subscriptions are on a firm basis and refunds will not be given.

All payments should be made payable to The Craftsman Press Pty. Ltd.

Subscription enquiries:

The Craftsman Press Pty. Ltd.

125 Highbury Road, Burwood Vic 3125

Telephone: (03) 9926 1233

Fax: (03) 9926 1292

The Victoria Government Gazette is published by The Craftsman Press Pty. Ltd. with the authority of the Government Printer for the State of Victoria
© State of Victoria 1998

ISSN 0819-5471

This publication is copyright. No parts may be reproduced by any process except in accordance with the provisions of the Copyright Act.

Products and services advertised in this publication are not endorsed by The Craftsman Press Pty. Ltd. or the State of Victoria and neither of them accepts any responsibility for the content or the quality of reproduction. The Craftsman Press Pty. Ltd. reserves the right to reject any advertising material it considers unsuitable for government publication.

Address all inquiries to the Government Printer for the State of Victoria

1 Macarthur Street

Melbourne 3002 Victoria Australia

Subscriptions

The Craftsman Press Pty. Ltd.

125 Highbury Road, Burwood

Victoria, Australia 3125

Telephone enquiries (03) 9926 1233

Facsimile (03) 9926 1292

Retail Sales

Information Victoria Bookshop

356 Collins Street Melbourne 3000.

Telephone enquiries 1300 366 356

City Graphics

2nd Floor, 4 Bank Place

Melbourne 3000

Telephone enquiries (03) 9600 0977

Price Code A