



# Victoria Government Gazette

No. G 3 Thursday 21 January 1999

**GENERAL**

## GENERAL AND PERIODICAL GAZETTE

Copy to: Gazette Officer  
The Craftsman Press Pty. Ltd.  
125 Highbury Road,  
Burwood Vic 3125  
Telephone: (03) 9926 1233  
Facsimile: (03) 9926 1292  
DX: 32510 Burwood  
Email: [gazette@craftpress.com.au](mailto:gazette@craftpress.com.au)

### Advertising Rates and Payment

#### Private Notices

Payment must be received in advance with advertisement details.

30 cents per word - Full page \$180.00.

Additional costs must be included in prepayment if a copy of the gazette is required. Copy Prices - Page \$1.50 - Gazette \$3.20 Certified copy of Gazette \$3.50. (all prices include Postage). **Cheques should be made payable to The Craftsman Press Pty. Ltd.**

#### Government and Outer Budget Sector Agencies Notices

Not required to pre-pay.

Advertisements may be faxed or sent via email with a cover sheet, marked to the attention of the Gazette Officer. Floppy Disks (Mac & PC) can also be accepted.

Costs can be calculated on the following basis:

Per Line	Typeset
Single column	\$1.55
Double column	\$3.10
Full Page	\$64.80

The Craftsman Press is pleased to offer a series of discounts from the typesetting costs.

1. Copy supplied on disk.
2. Copy supplied via email.
3. Artwork for forms and other material which require exact reproduction.

#### 1. Copy supplied on disk.

Where a disk is supplied and there is minimum alteration required, **30% off.**

Where a disk is supplied requiring extraneous matter stripped out and styles applied, **20% off.**

#### 2. Copy supplied via email.

Where a notice is sent via email and there is minimum alteration required, **25% off.**

Where email is supplied requiring extraneous matter stripped out and styles applied, **15% off.**

#### 3. Artwork for forms and other material which requires exact reproduction.

Scanning and sizing of artwork for forms, to be reproduced in page format, **35% off.**

#### Copy Deadline for General Gazette

9.30 a.m. Monday - (Private Notices)

9.30 a.m. Tuesday - (Government and Outer Budget Sector Agencies Notices)

### Advertisers should note:

- Late copy received at The Craftsman Press Pty. Ltd. after deadlines will be placed in the following issue of VGG, irrespective of any date/s mentioned in the copy (unless otherwise advised).
- Proofs will be supplied only when requested or at the direction of the Gazette Officer.
- No additions or amendments to material for publications will be accepted by telephone.
- Orders in Council may be lodged prior to receiving assent with the Governor's or Clerk's signature. They will only be published once approved and signed.
- Government and Outer Budget Sector Agencies please note: *See style requirements on back page.*

## SPECIAL GAZETTES

Copy to: Gazette Officer  
The Craftsman Press Pty. Ltd.  
125 Highbury Road,  
Burwood Vic 3125  
Telephone: (03) 9926 1233  
Facsimile: (03) 9926 1292  
Email: [gazette@craftpress.com.au](mailto:gazette@craftpress.com.au)

### Advertising Rates and Payment

#### Private Notices

Full Page \$360.00

Payment must be received in advance with notice details.

#### Government and Outer Budget Sector Agencies Notices

	Typeset
Full Page	\$87.50

#### Note:

The after hours number for Special Gazettes is:  
Telephone: 0419 327 321

## SUBSCRIPTIONS AND RETAIL SALES

Copies of the Victoria Government Gazette can be purchased from The Craftsman Press Pty. Ltd. by subscription.

#### The Victoria Government Gazette

General and Special - \$170.00 each year

General, Special and Periodical - \$227.00 each year

Periodical - \$113.00 each year

Subscriptions are payable in advance and accepted for a period of one year. All subscriptions are on a firm basis and refunds will not be given.

**All payments should be made payable to The Craftsman Press Pty. Ltd.**

#### Subscription enquiries:

The Craftsman Press Pty. Ltd.  
125 Highbury Road, Burwood Vic 3125  
Telephone: (03) 9926 1233

**INDEX TO PRIVATE ADVERTISERS****A**

Aitken Walker &amp; Strachan .....76

**B**

Basile &amp; Co. ....76

Bruce M. Cook &amp; Associates .....76

**C**

Coltmans Price Bent .....76

**D**

D. J. Thwaites LL.B. ....76

**G**

Gray Friend &amp; Long .....77

**H**

Heinz &amp; Partners .....77

**M**

Mal. Ryan &amp; Glen .....77

**P**

Pearsons .....77

Pearce Webster Dugdales .....77

Perpetual Trustees Victoria Limited .....78

Purves Clark Richards. ....78

**S**

Stuart Morgan &amp; Associates .....78

**W**

Wright &amp; Smiths .....78

**PUBLICATION OF THE  
VICTORIA GOVERNMENT  
GAZETTE (GENERAL)  
AUSTRALIA DAY PUBLIC  
HOLIDAY**

**PLEASE NOTE:**

The Victoria Government Gazette for Australia Day week will be published on Thursday 28 January 1999. All copy for private advertisements must reach the Government Gazette Office by 9.30 a.m. on Friday 22 January 1999. Copy for advertisements for the Government and Outer Budget Sector Agencies section must reach the Government Gazette Office by 9.30 a.m. on Monday 25 January 1999.

Where urgent gazettal is required after hours, arrangements should be made with Ann White on 0419 327 321.

ANN WHITE  
Government Gazette Officer

---

## PRIVATE ADVERTISEMENTS

**Partnership Act 1958****DISSOLUTION OF PARTNERSHIP**

In accordance with Section 41 of the **Partnership Act 1958**, notice is hereby given that the partnership carrying on business in Geelong, Victoria, under the name of Geelong Radiological Clinic (GRC) was dissolved by its partners on 31 December 1998.

Notice given by  
PETER MOTTERAM  
Director of P.M. Motteram Pty Ltd  
(A.C.N. 006 596 489)  
which corporation was a partner in GRC

OLGA MARY ABICARE, late of Brighton Lodge, 233 New Street, Brighton, but formerly of 67 South Road, Brighton, spinster, deceased. Creditors, next-of-kin and others having claims in respect of the estate of the deceased, who died on 8 October 1998 are required by the trustees, Michael Frederick Abicare of 17 Frontage Way, Mornington, Victoria, nephew, Julie Anne Broderick of 16 Warida Avenue, East Malvern, Victoria, niece and Robert Russell Aitken of 114 William Street, Melbourne, Victoria, solicitor to send particulars to the trustees by 29 March 1999 after which date the trustees may convey or distribute the assets having regard only to the claims of which the trustees have notice.

AITKEN WALKER & STRACHAN, solicitors,  
2nd Floor, 114 William Street, Melbourne 3000.

In the estate of MARY ALICE TROY of 69 Shadforth Street, Kerang, in the State of Victoria, widow, deceased. Creditors, next-of-kin and all other persons having claims against the estate of the said deceased are required by Peter Lawrence Troy of 8 McCann Crescent, Kerang, Victoria, the executor of the estate of the said deceased to send particulars of such claims to them in care of the undermentioned solicitors within two months from the date of publication of this notice after which date they will distribute the assets having regard only to the claims of which they then have notice.

BASILE & CO., barristers & solicitors,  
46 Wellington Street, Kerang, Vic. 3579.

Creditors, next-of-kin or others having claims in respect of the estate of SEBASTIANO PIRRUCCIO, late of 29 William Street, Fawkner, in the State of Victoria, builder, who died on 13 April 1991 are to send particulars of their claims to the personal representative/s care of the undermentioned solicitors by 22 March 1999 after which date the personal representative/s will distribute the assets having regard only to the claims of which they then had notice.

BRUCE M. COOK & ASSOCIATES,  
barristers & solicitors,  
Level 4, St James Building,  
121 William Street, Melbourne, Vic. 3000.

MARY ELIZABETH FORTUNE, late of Hillview Nursing Home, 764 Canterbury Road, Surrey Hills, Victoria, widow, deceased. Creditors, next-of-kin and others having claims in respect of the estate of the deceased, who died on 7 September 1998, are required by the executors, Charles Robert Fortune and Permanent Trustee Company Limited, A.C.N. 000 000 993, of 294-296 Collins Street, Melbourne, to send particulars of their claims to the said company by 28 March 1999 after which date they will convey or distribute the assets having regard only to the claims of which they then have notice.

COLTMANS PRICE BENT, solicitors,  
500 Bourke Street, Melbourne 3000.

Creditors, next-of-kin and others having claims in respect of the estate of VALDA HAYES, late of Unit 1, 8 Finlayson Street, Rosanna, home duties, deceased, who died on 7 November 1998 are required by the executor, Robert Morris Thomas Jamieson of 10 Learmonth Street, Heidelberg, in the State of Victoria, to send particulars of their claim to him care of the undermentioned lawyer by 12 April 1999 after which date the said executor will distribute the assets of the deceased having regard only to the claims of which he then shall have notice.

D. J. THWAITES LL.B., lawyer,  
106 Lower Plenty Road, Rosanna.

OLIVE MINTA BURNS, late of Unit 2, 6 Churchill Street, Warragul, gentlewoman, deceased. Creditors, next-of-kin and others having claims in respect of the estate of the deceased, who died on 2 November 1998 are required by the trustees, Dennis Richard Heslin and Lindsay James Muirhead, to send particulars of their claims to them care of the undersigned solicitors by 14 March 1999 after which date the trustees may convey or distribute the assets having regard only to the claims of which they then have notice.

GRAY FRIEND & LONG, solicitors  
70 Queen Street, Warragul 3820.

---

Creditors, next-of-kin or others having claims in respect of the estate of MAUREEN THERESA PHELAN, late of Nazareth House, Mill Street, Ballarat, widow, deceased, who died on 28 April 1998 are to send particulars of their claims to the executors care of the undermentioned solicitors by 22 March 1999 after which date the executors will distribute the assets having regard only to the claims of which the executors then have notice.

HEINZ & PARTNERS, solicitors,  
6 Dawson Street North, Ballarat.

---

ARTHUR DANKS FRASER, late of Shaws Road, Merton, Victoria, grazier, deceased. Creditors, next-of-kin and others having claims in respect of the estate of the deceased, who died on 31 August 1998, are required by his trustee John Angus Fraser of Shaws Road, Merton, Victoria, grazier, to send particular to him care of the undermentioned firm of legal practitioners by 29 March 1999 after which date the trustee may convey and distribute the assets having regard only to the claims of which he then has notice.

MAL. RYAN & GLEN,  
legal practitioners for the trustee  
9 High Street, Mansfield 3722.

---

EDITH HEARLE, late of Woodfield, Victoria, farmer, deceased. Creditors, next-of-kin and others having claims in respect of the estate of the deceased, who died on 29 September 1998 are required by her trustees, Ralph Kay Cohen of 66 Paterson Street, Numurkah, Victoria, retired and Thomas Michael Rodney Ryan of 9 High Street, Mansfield, Victoria, solicitor, to send particulars to them care of the

undermentioned firm of legal practitioners by 26 March 1999 after which date the trustees may convey or distribute the assets having regard only to the claims of which they then have notice.

MAL. RYAN & GLEN,  
legal practitioners for the trustees,  
9 High Street, Mansfield 3722.

---

Creditors, next-of-kin and others having claims in respect of the estate of SHAMUS PATRICK CLARK, late of 5 Claredale Avenue, Gladstone Park, Victoria, deceased, who died on 14 January, 1994 are to send particulars of their claims to the executors care of the undermentioned solicitors by 21 March 1999 after which date the executors will distribute the assets having regard only to the claims of which they then have notice.

PEARSONS, solicitors,  
794 Pascoe Vale Road, Glenroy 3046.

---

MARJORY ISABEL DEMPSTER, late of 405 Upper Heidelberg Road, Heidelberg, widow, deceased. Creditors, next-of-kin and others having claims in respect of the estate of the deceased, who died on 8 November 1998 are required by the trustee, Glenys Rae Weigh of 32 Beaconsfield Parade, Northcote, married woman, to send particulars to the trustee by 20 March 1999 after which date the trustee may convey or distribute the assets having regard only to the claims of which the trustee has notice.

PEARCE WEBSTER DUGDALES, solicitors,  
379 Collins Street, Melbourne.

---

ANNIE FRANCES MARGARET MARY WRIGHT, in the will called Anne Frances Wright, late of Kanella, 35 Mitchell Street, Brunswick, Victoria, gentlewoman, deceased. Creditors, next-of-kin and others having claims in respect of the estate of the deceased, who died on 13 September 1998 are required by the trustees, Arthur Dean Pearce and Arthur John Pearce, both of 379 Collins Street, Melbourne, solicitors, to send particulars to the trustees by 20 March 1999 after which date the trustees may convey or distribute the assets having regard only to the claims of which the trustees have notice.

PEARCE WEBSTER DUGDALES, solicitors  
379 Collins Street, Melbourne.

---

MARJORIE EDYTH WRIGHT, late of 11 William Street, Bacchus Marsh, Victoria, widow, deceased. Creditors, next-of-kin and others having claims in respect of the estate of the deceased, who died on 29 November 1998 are required by the trustee, David Neil Wright of 18 Taverner Street, Bacchus Marsh, concreter, to send particulars to the trustee by 20 March 1999 after which date the trustee may convey or distribute the assets having regard only to the claims of which the trustee has notice.

PEARCE WEBSTER DUGDALES, solicitors, 379 Collins Street, Melbourne.

HARRY WELLS PARKER, late of Kenilworth Nursing Home, 3 Kenilworth Parade, Ivanhoe, Victoria 3079. Creditors, next-of-kin and others having claims in respect of the estate of the deceased, who died on 20 November 1998 are required by Perpetual Trustees Victoria Limited, A.C.N. 004 027 258 of 50 Queen Street, Melbourne to send particulars of their claims to the said company by 23 March 1999 after which date it will convey or distribute the assets having regard only to the claims of which the company then has notice.

Creditors, next-of-kin or others having claims in respect of the estate of GERTRUDE MURIEL LAWRENCE, late of Andrina Private Nursing Home, 360 New Street, Brighton, Victoria, retired nursing sister, deceased, who died on 10 October 1998 are to send particulars of their claims to the executor care of the undermentioned solicitors by 25 March 1999 after which date the executor will distribute the assets having regard only to the claims of which the executor then has notice.

PURVES CLARKE RICHARDS, solicitors, 121 William Street, Melbourne.

Creditors, next-of-kin and others having claims in respect of the estate of IRENE ELIZABETH ARMSTRONG of Unit 6, 42 Glen Iris Road, Camberwell, in the State of Victoria, deceased, who died on 6 July 1998 are required by the executors and trustees to send particulars to them care of the undermentioned solicitors by 21 March 1999 after which date the executors and trustees may convey or distribute the assets having regard only to the claims of which they then have notice.

STUART MORGAN & ASSOCIATES, solicitors, 238 Glenferrie Road, Malvern 3144.

EDNA MAY BAILEY, late of 25a Foothills Avenue, McCrae, Victoria, widow, deceased. Creditors, next-of-kin and others having claims in respect of the estate of the deceased, who died on 29 December 1998 are required by the trustees, Kim Syme Price, solicitor and Geoffrey Robert Nicholson, solicitor, both of 2 Seventh Avenue, Rosebud, Victoria, to send particulars to the trustees by 15 March 1999 after which date the trustees may convey or distribute the assets having regard only to the claims of which the trustees then have notice.

WRIGHT SMITHS, solicitors  
2 Seventh Avenue, Rosebud.

#### In the Supreme Court of the State of Victoria SALE BY THE SHERIFF

On the 25 February 1999 at 11.00 a.m. at the Sheriff's Office, Courts Complex, Faithful Street, Wangaratta (unless process be stayed or satisfied).

All the estate and interest (if any) of Trevor John Clamp of RMB 2163 Snow Road, Markood Via Wangaratta, joint proprietor with Nicki Clamp of an estate in fee simple in Lot 4 on Plan of Subdivision No. 112880 containing approximately 3.97 hectares and being the land more particularly described on Certificate of Title Volume 9104 Folio 563 upon which is erected a home and the usual outbuildings and improvements.

The property is situated by travelling North from Melbourne along the Hume Freeway heading towards Wangaratta. Take the Glenrowan-Myrtleford Road also known as Snow Road, travel east along that road for approximately 21 km. The property is on the southern side of the road which is situated at Markwood and is known as RMB 2163 Snow Road, Markwood Via Wangaratta.

Registered Caveat Nos. T508867Q and U59250P affect the said estate and interest.

Terms - Cash only.

SW-98-008485-1

Dated 21 January 1999.

S. BLOXIDGE  
Sheriff's Office

#### In the Supreme Court of the State of Victoria SALE BY THE SHERIFF

On the 25 February 1999 at 2.30 p.m. at the Sheriff's Office, 8-20 King Street, Oakleigh, (unless process be stayed or satisfied).

All the estate and interest (if any) of Youssef Taouk of 51 Darebin Road, Thornbury, as shown on Certificate of Title as Joesef Taouk, joint proprietor with Wadad Taouk of an estate in fee simple being Lot 42 and part of Lot 41 on Plan of Subdivision No. 4731 and described on Certificate of Title Volume 3287 Folio 326 upon which is erected a block of 10 Flats known as 25 Johnson Street, Northcote.

Registered Mortgage No. K167841 affects the said estate and interest.

Terms - Cash only.

SW-98-011279-7

Dated 21 January 1999.

S. BLOXIDGE  
Sheriff's Office

In the Supreme Court of the State of Victoria  
SALE BY THE SHERIFF

On the 25 February 1999 at 2.30 p.m. at the Sheriff's Office, 8-20 King Street, Oakleigh, (unless process be stayed or satisfied).

All the estate and interest (if any) of Helena Folidis of Unit 204, 258 Flinders Lane, Melbourne, proprietor of an estate in fee simple being Lot 204 on Plan of Subdivision 323062B and being the land described on Certificate of Title Volume 10111 Folio 402 upon which is erected a Unit and is known as Unit 204, 258-260 Flinders Lane, Melbourne.

Registered Mortgage No. T499474B affects the said estate and interest.

Terms - Cash only.

SW-97-014357-7

Dated 21 January 1999.

S. BLOXIDGE  
Sheriff's Office

In the County Court of the State of Victoria  
SALE BY THE SHERIFF

To The Highest Bidder At The Best Price  
Offered

On the 25 February 1999 at 11.00 a.m. at the Sheriff's Office, Old Courthouse Annex, Camp Street, Ballarat, (unless process be stayed or satisfied).

All the estate and interest (if any) of Anthony Ivan Smart of "Moorundie" RMB 3608, Ararat, proprietor of an estate in fee simple in Crown Allotments 104 and 105 consisting of approximately 129.48 hectares and being the land more particularly described on

Certificates of Title Volume 9999 Folios 625 and 626 which is vacant grazing land.

The property is located by travelling along the Western Freeway towards Ararat, just before Ararat turn south onto the Old Geelong Road, travel east until you reach Tatyoon North Road, travel south to Logans Road. The property is on the eastern side of Tatyoon North Road and south of Logans Road. The property is on the south east corner of Logans Road and Tatyoon North Road and is known as Crown Allotments 104 and 105 Tatyoon North Road, Tatyoon.

Registered Caveat No. V406708V affects the said estate and interest.

No Reserve set.

Terms - Cash only.

CW-97-007464-3

Dated 21 January 1999.

S. BLOXIDGE  
Sheriff's Office

In the Supreme Court of the State of Victoria  
SALE BY THE SHERIFF

On the 25 February 1999 at 2.30 p.m. at the Sheriff's Office, 8-20 King Street, Oakleigh, (unless process be stayed or satisfied).

All the estate and interest (if any) of John Lanera of 61 Bishop Street, Yarraville, joint proprietor with Judy Ann Lanera of an estate in fee simple in the land described on Certificate of Title Volume 6357 Folio 390 upon which is erected a dwelling known as 61 Bishop Street, Yarraville.

Registered Mortgage No. M963955R, Caveat No. V619341D and the Covenant contained in Transfer 1758666 affect the said estate and interest.

Terms - Cash only.

SW-98-007254-0

Dated 21 January 1999.

S. BLOXIDGE  
Sheriff's Office

# PROCLAMATIONS

## Land Act 1958

### PROCLAMATION OF ROAD

I, James Gobbo, Governor of Victoria acting with the advice of the Executive Council and under Section 25(3)(c) of the **Land Act 1958** proclaim as road the following land:

MUNICIPAL DISTRICT OF THE  
SOUTH GIPPSLAND SHIRE COUNCIL  
DOOMBURRIM — The land in the Parish of Doomburrim shown by hatching on plan hereunder. (D207[6]) — (L10-6630).

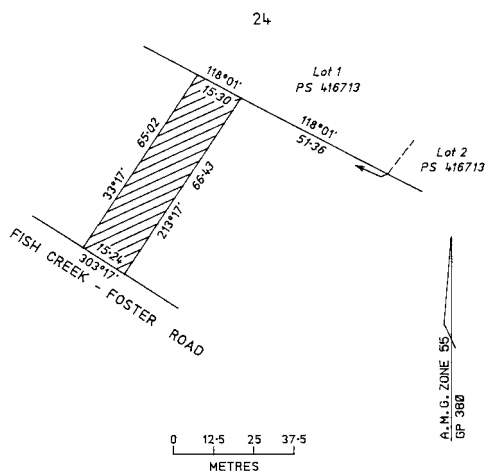

This Proclamation is effective from the date on which it is published in the Victoria Government Gazette.

Given under my hand and the seal of  
Victoria on 19 January 1999.

(L.S.) JAMES GOBBO  
Governor  
By His Excellency's Command

MARIE TEHAN  
Minister for Conservation  
and Land Management

## Land Act 1958

### PROCLAMATION OF ROAD

I, James Gobbo, Governor of Victoria acting with the advice of the Executive Council and under Section 25(3)(c) of the **Land Act 1958** proclaim as road the following land:

MUNICIPAL DISTRICT OF THE  
INDIGO SHIRE COUNCIL

YACKANDANDAH — Crown Allotment 7A1, Section K1, Parish of Yackandandah as shown on Certified Plan No. 119167 lodged in the Central Plan Office. (P204956).

This Proclamation is effective from the date on which it is published in the Victoria Government Gazette.

Given under my hand and the seal of  
Victoria on 19 January 1999.

(L.S.) JAMES GOBBO  
Governor  
By His Excellency's Command

MARIE TEHAN  
Minister for Conservation  
and Land Management

## State Taxation (Further Amendment) Act 1998 PROCLAMATION OF COMMENCEMENT

I, James Gobbo, Governor of Victoria, with the advice of the Executive Council and under section 2(7) of the **State Taxation (Further Amendment) Act 1998**, fix 1 February 1999 as the day on which sections 12, 13, 14, 15, 27 and 30 of that Act come into operation.

Given under my hand and the seal of  
Victoria on 19 January 1999.

(L.S.) JAMES GOBBO  
Governor  
By His Excellency's Command

ALAN R. STOCKDALE  
Treasurer

## Gas Safety Act 1997

### PROCLAMATION OF COMMENCEMENT

I, James Gobbo, Governor of Victoria, acting with the advice of the Executive Council and under section 2(2) of the **Gas Safety Act 1997**, fix 1 February 1999 as the day on which the remaining provisions of that Act come into operation.

Given under my hand and the seal of  
Victoria on 19 January 1999.

(L.S.) JAMES GOBBO  
Governor  
By His Excellency's Command

ALAN R. STOCKDALE  
Treasurer



**GOVERNMENT AND OUTER BUDGET SECTOR AGENCIES  
NOTICES****CITY OF GREATER SHEPPARTON****Road Discontinuance -****Part Northgate Street, Mooroopna**

At its meeting on 11 February, 1991, the former Shire of Rodney acting under Clause 2 of Schedule 10 to the **Local Government Act 1989** resolved to discontinue that part of Northgate Street, Mooroopna, from the intersection of Echuca Road for a distance of 117.18 metres south, as shown hatched on the plan hereunder. The land is to vest in the Council.

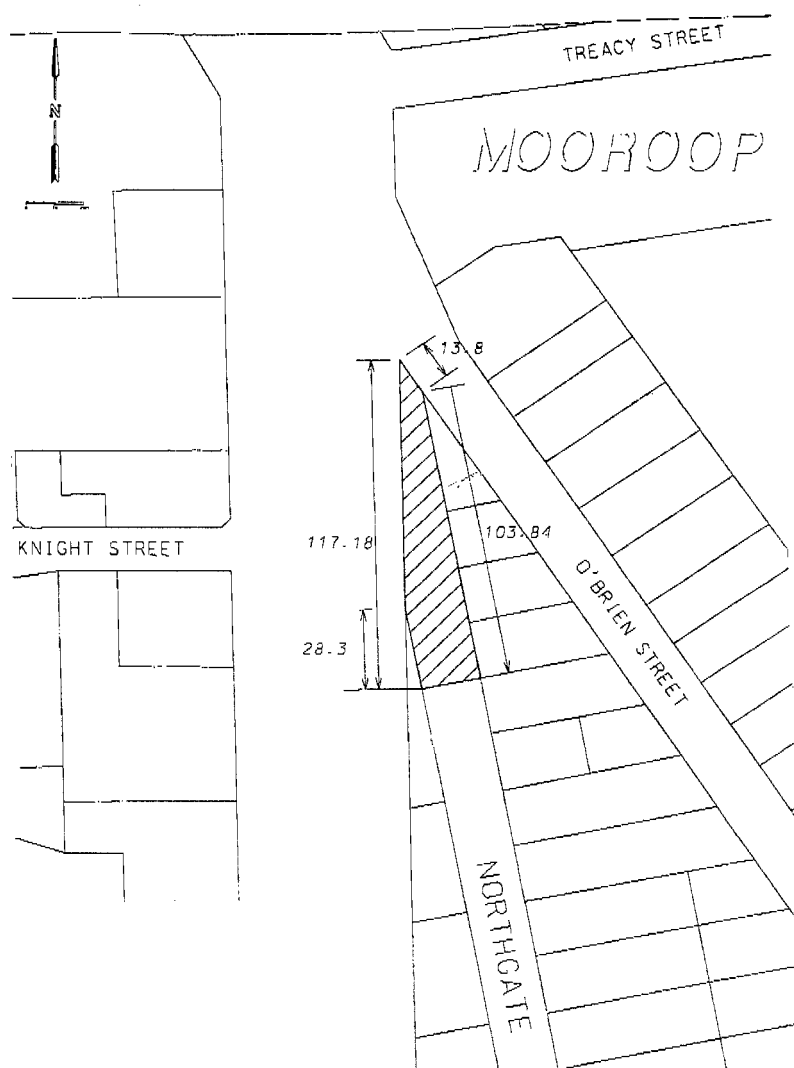

**BILL JABOOR**  
Chief Executive Officer  
City of Greater Shepparton as  
successor in law to the Shire of Rodney

CITY OF BOROONDARA  
Road Discontinuance

Pursuant to section 206 and Schedule 10 Clause 3 of the **Local Government Act 1989** the City of Boroondara at its Ordinary Council Meeting held on 23 November 1998 formed the opinion that the road shown on the plan below is not reasonably required as a road for public use and resolved to discontinue the road and to sell the land from the road to abutting owners.

Notwithstanding such discontinuance, City of Boroondara and Yarra Valley Water shall continue to have and possess the same right, title power, authority or interest in relation to the land shown hatched on the said plan as it had possessed prior to such discontinuance.

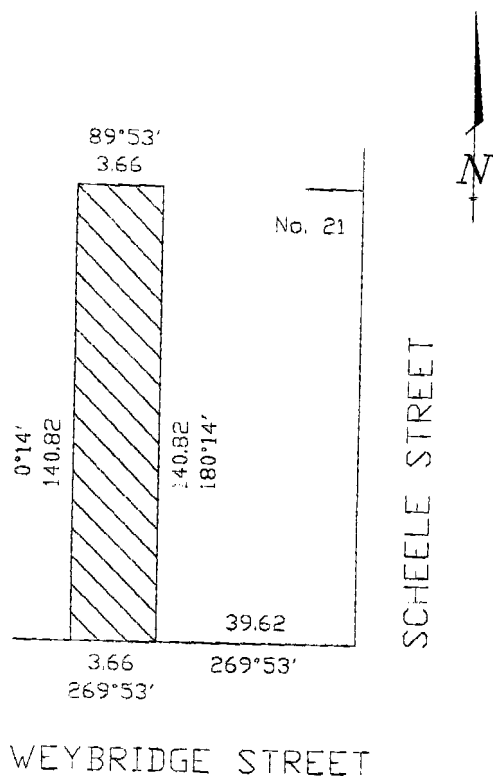

MICHAEL KENNEDY  
Chief Executive Officer

CITY OF WODONGA  
Road Discontinuance

Under Section 206 and Schedule 10 Clause 3 of the **Local Government Act 1989** the City of Wodonga, at its Ordinary meeting held on 14 December 1998, formed the opinion that the road shown on the plan below is not reasonably required as a road for public use and resolved to discontinue the road and to retain the land from the road for municipal purposes.

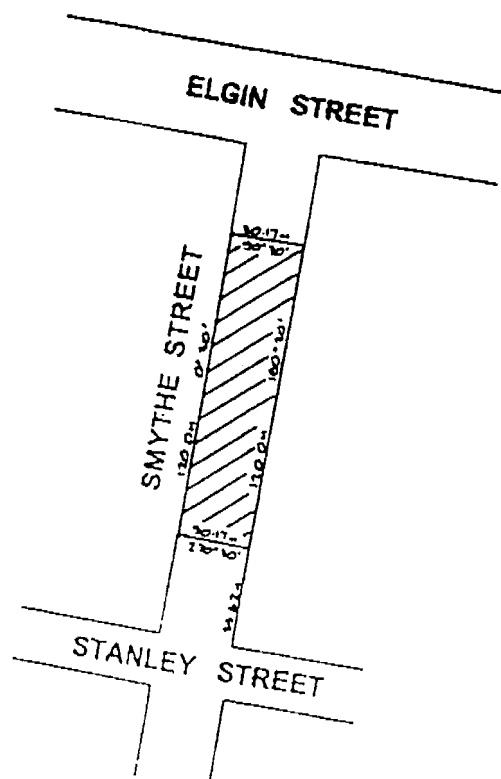

PETER MARSHALL  
Chief Executive Officer

STONNINGTON CITY COUNCIL  
Road Discontinuance

At its meeting on 12 January 1999 and acting under clause 3 of schedule 10 of the **Local Government Act 1989**, Stonnington City Council resolved to discontinue the road shown hatched on the plan below.



Mr FRANK TAIT  
Chief Executive Officer

GLEN EIRA CITY COUNCIL  
Road Discontinuance

Under Section 206 and Schedule 10 Clause 3 of the **Local Government Act 1989** the Glen Eira City Council has formed the opinion that the road shown hatched on the plan below is not reasonably required as a road for public use and has resolved to discontinue the road and to sell the land from the road by private treaty.

GLENHUNTLY ROAD

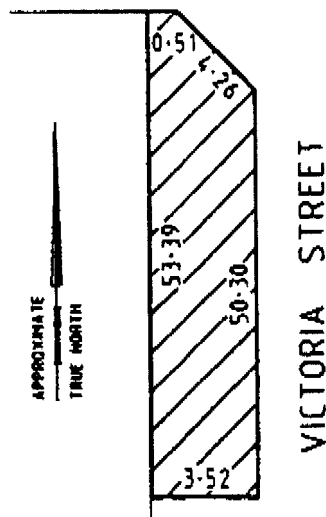

MARGARET DOUGLAS  
Chief Executive

WYNDHAM CITY COUNCIL  
Road Discontinuance

Under Section 206 and Schedule 10 Clause 3 of the **Local Government Act 1989** the Wyndham City Council at its Ordinary meeting held on 10 August 1998, has formed the opinion that the road shown hatched on the plan below is not reasonably required as a road for public use and has resolved to discontinue the road and to sell the land from the road by private treaty subject to any right, power or interest held by the Wyndham City Council and the Melbourne Water Corporation (City West Water) in the road in connection with any sewers, drains or pipes under the control of those authorities in or near the road.

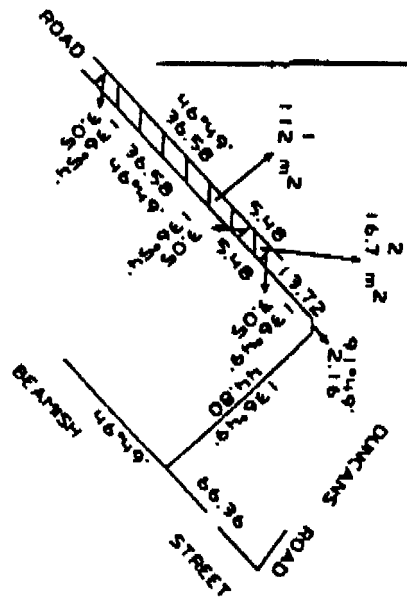

IAN ROBINS  
Chief Executive

BRIMBANK CITY COUNCIL  
Road Discontinuance

Under Section 206 and Schedule 10 Clause 3 of the **Local Government Act 1989** the Brimbank City Council at its Ordinary meeting held on 24 November 1998, formed the opinion that the road shown hatched on the plan below is not reasonably required as a road for public use and has resolved to discontinue the road and to sell the land from the road by private treaty.

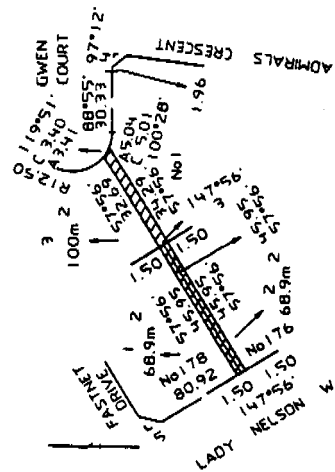

MARILYN DUNCAN  
Chief Executive Officer

INDIGO SHIRE COUNCIL  
Road Deviation and  
Declaration of Public Highway

Pursuant to Sections 522 and 526 of the **Local Government Act 1958**, the Indigo Shire Council hereby gives notice that:

- a) it will deviate a road over the land in the Parish of Yackandandah indicated by cross hatching on the diagram below, which has been purchased, taken or acquired by it, shall be a public highway on and from the date of publication of this order in the Government Gazette; and
- b) declares that such land shall be a public highway in lieu of the land indicated by hatching on the said diagram.

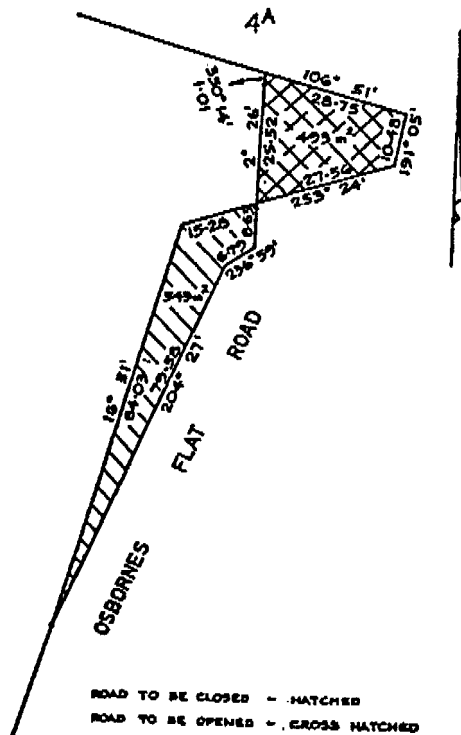

Dated 11 January 1999.

JOHN P. COSTELLO  
Chief Executive Officer

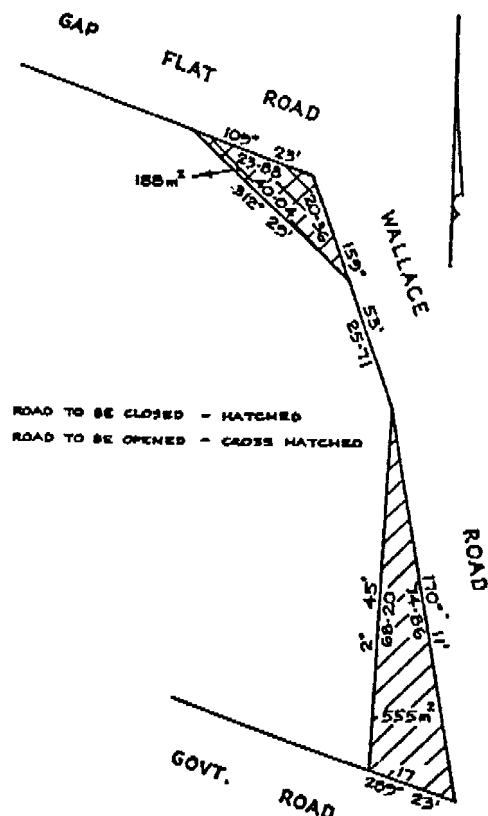

**Planning and Environment Act 1987**  
**GREATER GEELONG PLANNING SCHEME**  
 Notice of Amendment  
 Amendments R224 & R236

The City of Greater Geelong has prepared Amendments R224 & R236 to the Greater Geelong Planning Scheme.

**Amendment R224**

The Amendment proposes to amend the Regional Section of the Greater Geelong Planning Scheme to rezone approximately 16.3 hectares of land at the north western corner of Forest Road South and Canterbury Road West, Lara from Rural General Farming zone to Reserved Residential zone subject to the further investigation of likely occasional sheet-water occurrences, and the determination of satisfactory floor levels.

**Amendment R236**

The Amendment proposes to amend the Regional Section of the Greater Geelong Planning Scheme by rezoning a 0.375 ha site on the east side of Ballan Road, between Carrs & Dorrington Roads, Anakie from Rural General Farming zone to Public Purposes (Existing) reservation No. 4 (Barwon Water).

The amendment can be inspected at: City of Greater Geelong, 2nd Floor, 103 Corio Street, Geelong; Department of Infrastructure, Office of Planning, 63 McKillop Street, Geelong 3220 and Department of Infrastructure, Level 3 Plaza, Nauru House, 80 Collins Street, Melbourne 3000.

Submissions about the amendment must be sent to the Planning Scheme Unit, City of Greater Geelong, P.O. Box 104, Geelong 3220 by Monday 22 February 1999.

CHUBB FADGYAS  
 Co-Ordinator Urban & Regional Planning

**Planning and Environment Act 1987**  
**GLEN EIRA PLANNING SCHEME**  
 Notice of Amendment

Amendment L36

The City of Glen Eira has prepared Amendment No. L36 to the Glen Eira Planning Scheme.

The Amendment changes the Local Section of the Glen Eira Planning Scheme.

The Amendment applies to a 3 hectare area of land located to the north of Station Street, Caulfield. The land comprises a large parcel of vacant land owned by the Victoria Amateur Turf Club (VATC) and known as Members No. 1 Carpark, and a number of abutting residential properties also owned by the VATC. Also included in the land to which the amendment applies are two residential properties abutting the Members No. 1 Carpark which are owned by separate parties.

The land is generally bounded by Normanby Road to the north, Smith Street to the east, Bond and Heywood Streets to the west and Station Street to the south.

The Amendment proposes to rezone land from a Residential C Zone to a Mixed Use Zone.

The purpose of the proposed rezoning of the land to a Mixed Use Zone is to facilitate its future development and use for a range of uses potentially spanning entertainment, commercial and residential.

The Amendment can be inspected free of charge and during office hours at: City of Glen Eira, Municipal Offices, corner Glen Eira & Hawthorn Roads, Caulfield South 3162 and Department of Infrastructure, Customer Service Centre, Upper Plaza, Nauru House, 80 Collins Street, Melbourne 3000.

Submissions about the amendment must be sent to: Mrs Jacqui Brasher, Town Planning Office, City of Glen Eira, P.O. Box 42, Caulfield South 3162 by Monday 22 February 1999.

JACQUI BRASHER  
 Strategic Planner

**Planning and Environment Act 1987**  
**HUME PLANNING SCHEME**  
 Notice of Amendment

Amendment L55

The Hume City Council has prepared Amendment L55 to the Hume Planning Scheme.

The Amendment:

- rezones approximately 13.2 hectares of land located on the northern and, partly, southern sides of Western Avenue from a Corridor A Zone to Part Business 3 Zone and Part Business 2 Zone.

The purpose of the amendment is to facilitate the development of nearly all of the land for a range of industrial, office and other complementary uses. The exception to this is the north western portion of the site (between Western Avenue and the Tullamarine Freeway); this land is proposed to be included in the Business 2 Zone to enable a permit application to be made for a comprehensive freeway service centre inclusive of a residential hotel and information centre. The amendment also proposes to introduce a new Western Avenue Design and Development clause over all of the land that imposes certain requirements in respect of site planning and design.

The amendment maintains the Melbourne Airport Environs Area No. 1 Overlay Control over all of the land.

The amendment can be inspected at the: Hume City Council, Sunbury Office, 36 Macedon Street, Sunbury; Hume City Council, Broadmeadows Office, 1079 Pascoe Vale Road, Broadmeadows and Department of Infrastructure, Customer Service Centre, Nauru House, 80 Collins Street, Melbourne.

Submissions about the amendment must be sent to: Manager City Planning, Hume City Council, P.O. Box 119, Broadmeadows, Vic. 3047 by Monday 22 February 1999.

DARRELL TRELOAR  
Chief Executive Officer

**Planning and Environment Act 1987**  
**MAROONDH PLANNING SCHEME**  
Notice of Amendment

Amendment L25

Maroondah City Council has prepared Amendment L25 to the Maroondah Planning Scheme.

This amendment affects one (1) vacant lot of land located at No. 9 Lusher Road, Croydon. The site adjoins an existing self storage facility at 3-7 Lusher Road and proposes to use the vacant site for expansion of the storage facility. Expansion of the use is currently prohibited under the Maroondah Planning Scheme.

The amendment proposes to introduce a site specific Clause into the Croydon Neighbourhood Residential Zone to allow a planning permit application to be considered for expansion of the Croydon Self Storage Facility, onto the land known as 9 Lusher Road, Croydon.

A Concept Plan submitted by the proponent, showing expansion of the self storage facility onto 9 Lusher Road, is available for inspection with the Amendment.

The Amendment can be inspected at: Maroondah City Council, Ringwood Office, Braeside Avenue, Ringwood; Maroondah City Council, Croydon Office, Civic Square, Croydon; Maroondah City Council, Customer Service Office, 50 Main Street, Croydon; Maroondah City Council, Customer Service Office, Civic Place, Ringwood and the Department of Infrastructure Book Shop, 80 Collins Street, Melbourne.

Submissions about the amendment must be sent to: Maroondah City Council, P.O. Box 156, Ringwood 3134 by Friday 26 February 1999.

MICHAEL MARASCO  
Chief Executive Officer

Creditors, next of kin and others having claims against the estate of any of the undermentioned deceased persons are required to send particulars of their claims to State Trustees Limited, A.C.N 064 593 148, 168 Exhibition Street, Melbourne, Victoria, 3000 the personal representative, on or before March 29, 1999 after which date State Trustees Limited may convey or distribute the assets having regard only to the claims of which State Trustees Limited then has notice.

BERRY Henry George, late of 532 Nicholson Street, North Fitzroy, council worker, who died March 12, 1991.

BEST Winsome Joyce, late of Colanda Training Centre, Eagle Unit, Colac, pensioner, who died November 4, 1998.

CALDER Lucy Leila May, also known as Leila Calder, late of Greensborough Nursing Home, Elder Street, Greensborough, home duties, who died August 17, 1998.

COUCHMAN, Cecily Frances, late of Leighton Private Nursing Home, 1 Templestowe Road, Bulleen, home duties, who died October 8, 1998.

DE BREE Frans Herman Frederik, late of 11 Newell Street, Footscray, engineer, who died September 9, 1998.

DOOLEY Basil Counsel, late of 14-16 Eilsenhower Court, Warragul, pensioner, who died November 29, 1998.

MANLY Evelyn Rose, late of 53 McGibbony Street, Ararat, retired, who died August 14, 1998.

MARSHALL Peter Raymond, late of Flat 4, 16 Darling Street, Footscray, garage attendant, who died February 6, 1998.

McDONALD Irving Christopher, late of 96 Raglan Street, Preston, retired, who died November 21, 1998.

ROBINS Albert Rex, late of 40 Cheviot Avenue, Berwick, retired, who died October 30, 1998.

SCOTT Marjorie Constance, late of Edenvale Nursing Home, 4 Scott Street, Essendon, pensioner, who died September 24, 1998.

STISCIA Silvo, late of 18/40 Park Street, West St. Kilda, pensioner, who died November 5, 1998.

THOMPSON Raymond Ronald, late of Unit 24, Kew Residential Services, Princes Street, Kew, pensioner, who died September 14, 1998.

THYNNE John Francis, late of 39 Old Dandenong Road, Oakleigh, retired, who died October 23, 1998.

VISSER Marion Linda, formerly of 85 Research Road, North Warrandyte, but late of 34 Leber Street, Warrandyte, function co-ordinator, who died May 31, 1998.

WOOD Dorothy Maud, late of North West Hospital, Poplar Road, Parkville, retired, who died November 22, 1998.

WOODS Emily Selina, late of Surrey Hills Private Nursing Home, 16 Florence Road, Surrey Hills, pensioner, who died October 10, 1998.

WOOLLEY Ida Lillian Marguerite, late of 20 Harold Street, McKinnon, home duties, who died November 5, 1998.

Dated at Melbourne, 18 January 1999.

CATHY VANDERFEEN  
Manager, Estate Management  
State Trustees Limited

Creditors, next-of-kin and others having claims against the following estates:-

GUS FISHER, late of Villa Franca Private Nursing Home, Corner Deutgan & Greaves Streets, Werribee, Victoria, pensioner, deceased intestate, who died September 24, 1998.

IAN PETER GUNN, late of 19 Yorkshire Street, Blackburn North, Victoria, pensioner, deceased, who died November 8, 1998.

JUDITH KEILY, late of Graveview Lodge, 4 Mena Street, Moe, Victoria, retired, deceased intestate, who died April 16, 1998.

REMO PARODI, late of 50 McKimmies Road, Lalor, Victoria, pensioner, deceased intestate, who died November 8, 1998.

FLORENCE RICHARDS, late of Baala House Nursing Home Numurkah, Victoria, pensioner, deceased intestate, who died October 7, 1998.

KRYSTYNA RYL, late of Szczecin, ul. Pocztowa 20/9 Poland, pensioner, deceased intestate, who died September 13, 1996.

NELLIE SCOTT, late of Dava Lodge Private Nursing Home, 185 Bentons Road, Mornington, Victoria, pensioner, deceased intestate, who died September 19, 1998.

WINIFRED SIME, late of 1/11 Rutland Street, Clifton Hill, Victoria, pensioner, deceased intestate, who died November 23, 1998.

WILLIAM STRINGER, late of Unit 4, 19 Murphy Street, Richmond, Victoria, pensioner, deceased intestate, who died July 23, 1998.

JOHN WILLIAM TURNER, late of 9 Livingstone Close, Burwood, Victoria, pensioner, deceased intestate, who died July 13, 1998.

Creditors, next-of-kin and others having claims against the abovementioned estates are required pursuant to Section 33 of the **Trustee Act 1958** to send particulars of their claims against the abovementioned estates to State Trustees Limited, 168 Exhibition Street, Melbourne, Victoria, on or before March 29 1999 after which date State Trustees Limited, A.C.N. 064 593 148, may convey or distribute the assets of the abovementioned estates having regard only to the claims of which it then has notice.

Department of Treasury and Finance

SALE OF CROWN LAND  
BY PUBLIC AUCTION

**Date of Auction:** Saturday 27 February 1999 at 10.30 a.m. on site.

**Reference:** 98/02627.



**Address of Property:** 23 Madden Street, Morwell.

**Crown Description:** Allotment 45<sup>c</sup>, Parish of Maryvale.

**Terms of Sale:** Deposit 10%, balance 60 days.

**Area:** 932 m<sup>2</sup>.

**Officer Co-ordinating Sale:** Peter Hollins, Victorian Government Property Group, Department of Treasury and Finance, 10/1 Macarthur Street, Melbourne, Vic. 3002.

**Selling Agent:** B. J. Bennett & Co, Real Estate Pty. Ltd., 26 Commercial Road, Morwell 3840.

ROGER M. HALLAM  
Minister for Finance

---

EXEMPTION  
Application No. 2 of 1999

The Victorian Civil and Administrative Tribunal has considered an application pursuant to Section 83 of the **Equal Opportunity Act 1995** by Brotherhood of St. Laurence, (a body corporate established by the **Brotherhood of St. Laurence (Incorporated) Act 1971**). The application for exemption is to enable the applicant to advertise and appoint a male or female worker, as appropriate in its employment service to enable the service to cater for the needs and wishes of male and female clients.

Upon reading the material tendered in support of this application the Tribunal is satisfied that it is appropriate to grant an exemption from Sections 13, 100 & 195 of the Act to enable the applicant to advertise and appoint a male or female worker, as appropriate in its employment service to enable the service to cater for the needs and wishes of male and female clients.

In granting this exemption the Tribunal noted:

- Brotherhood of St. Laurence, Employment Services ("BSL") currently employ three females and one male worker. The male worker has a full caseload and is unable to take new clients.
- Clients are referred by Centrelink and are given the choice of a male or female worker. The occupational psychologist has in her assessments suggested a male worker for some clients. 75% of clients referred to BSL are male.
- The community support programme assists people with barriers to employment. These barriers can be drug and alcohol misuse,

long criminal records, gambling problems, domestic violence and housing issues.

- BSL wants to offer all clients a choice of male or female worker to assist them in gaining employment. BSL wishes to be able to cater for those clients who express a preference for a male or female worker to assist.

The Tribunal grants an exemption from the operation of Sections 13, 100 and 195 of the **Equal Opportunity Act 1995**, to enable the applicant to advertise and appoint a male or female worker, as appropriate in its employment service to enable the service to cater for the needs and wishes of male and female clients.

This exemption is to remain in force from the day on which notice of the exemption is published in the Government Gazette until 20 January 2002.

Ms CATE McKENZIE  
Deputy President

---

INDUSTRIAL WASTE MANAGEMENT  
POLICY

(Waste Acid Sulfate Soils)

A new industrial waste management policy (Waste Acid Sulfate Soils) has now been declared. This policy was published in Government Gazette No. S86, Thursday 27 August 1998.

Notice is given of the fact that this policy incorporates criteria for determining soil and sediment texture from the *Australian Soil and Land Survey – Field Handbook* (R. C. McDonald et al, 1990 2nd edition) and a method to be followed in determining sulfur trail and acid trail for soils known as *Acid Sulfate Soil Method 21: Peroxide Oxidation - Combined Acidity and Sulfate* (New South Wales Acid Sulfate Soil Management Advisory Committee, 1998). Copies of these incorporated documents have been lodged with the Clerk of the Parliaments.

Copies of the *Australian Soil and Land Survey – Field Handbook* and the *Acid Sulfate Soil Method 21: Peroxide Oxidation – Combined Acidity and Sulfate* are now available for inspection at EPA Library, Ground Floor, 477 Collins Street, Melbourne. Telephone: (03) 9628 5040.

For more information, contact the Customer Service and Information Centre, Telephone: (03) 9628 5533.

MARIE TEHAN, MP  
Minister for Conservation  
and Land Management

---

**Land Acquisition and Compensation Act 1986**

FORM 7

S.21

Reg. 16

**NOTICE OF ACQUISITION****Compulsory Acquisition of Interest in Land**

Maroondah City Council declares that by this notice it acquires the following interest in the land described as Part Lot 11 on LP 4315, Parish of Warrandyte, in Title Volume 8612 Folio 214 and known as 248-250 Wonga Road, Warranwood.

A minor road widening/splay corner shown as Road R1 on PS 426124G.

Published with the authority of Maroondah City Council.

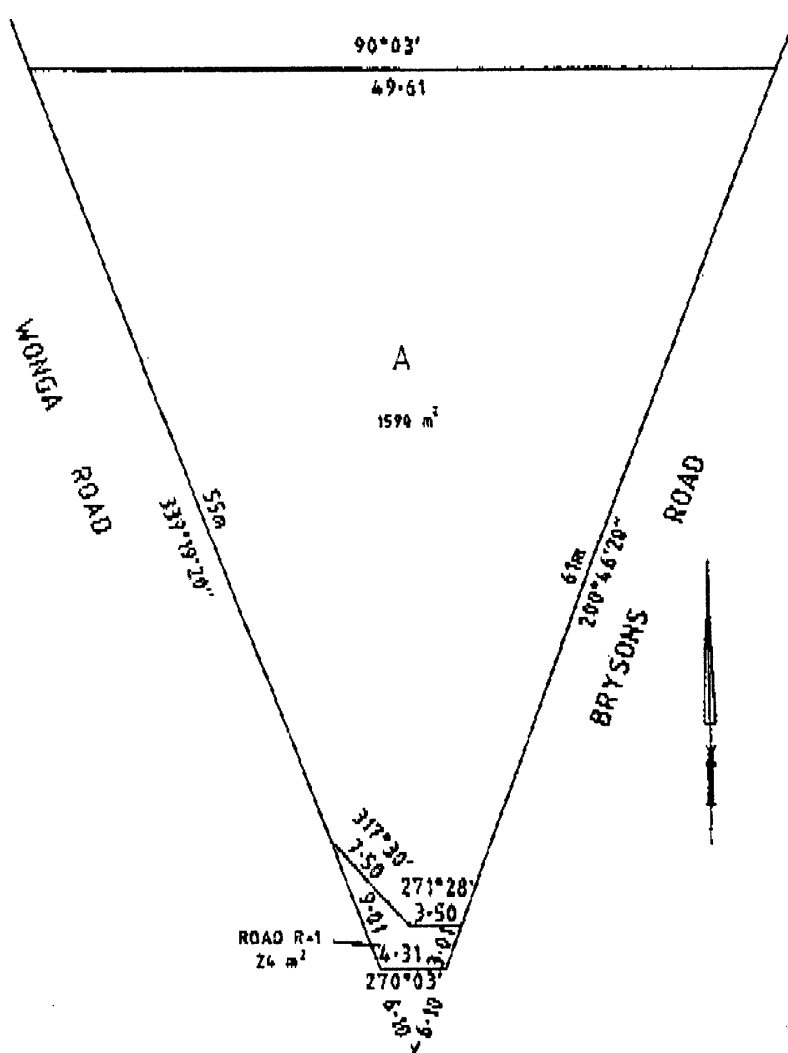

For and on behalf of the Maroondah City Council.  
Dated 18 January 1999.

**Geographic Place Names Act 1998**  
REGISTRAR OF GEOGRAPHIC PLACE NAMES

1. NOTICE OF ASSIGNMENT OF PLACE NAMES

The Registrar of Geographic Names hereby gives notice of the assignment of the undermentioned place names.

File No.	Place Name	Proposer & Location
1723	Abbeyard, Barwidgee, Bogong, Bright, Buckland, Buffalo River, Cobungra, Coral Bank, Dandongadale, Dargo, Dederang, Dinner Plain, Eurobin, Falls Creek, Freeburgh, Gapstead, Germantown, Harrietville, Havilah, Hotham Heights, Kancoona, Kancoona South, Merriang, Merriang South, Mongans Bridge, Mount Beauty, Mount Buffalo, Mudgegonga, Myrtleford, Nug Nug, Ovens, Porepunkah, Rosewhite, Running Creek, Selwyn, Smoko, Tawonga, Tawonga South, Upper Gundowring, Wandiligong, Wongungarra and Wonnangatta.	Alpine Shire. Assignment of the 42 aforementioned urban and rural locality names and their boundaries within the municipality. The plans showing the names and boundaries may be inspected at the Municipal Offices, or the Office of the Registrar of Geographic Names.
1729	Barnawartha, Beechworth, Brimin, Browns Plains, Carlyle, Chiltern, Chiltern Valley, Cornishtown, Gooramadda, Gundowring, Indigo Valley, Kergunyah, Kiewa, Lilliput, Norong, Rutherglen, Sandy Creek, Stanley, Tangambalanga, Wahgunyah, Wooragee and Yackandandah.	Shire of Indigo. Assignment of the 22 aforementioned urban and rural locality names and their boundaries within the municipality. The plans showing the names and boundaries may be inspected at the Municipal Offices, or the Office of the Registrar of Geographic Names.
1661	Bayswater, Boronia, Ferntree Gully, Knoxfield, Lysterfield, Rowville, Sassafra, Scoresby, The Basin, Upper Ferntree Gully, Wantirna and Wantirna South.	City of Knox. Assignment of the aforementioned 12 suburbs locality names and their boundaries within the municipality. The plans showing the names and boundaries may be inspected at the Municipal Offices, or the Office of the Registrar of Geographic Names.
1638	Park Orchards.	City of Manningham. Assignment of the 1 aforementioned suburb locality name and boundary within the municipality. The plans showing the name and boundary may be inspected at the Municipal Offices, or the Office of the Registrar of Geographic Names.
1672	Bayswater North, Croydon, Croydon North, Croydon South, Heathmont, Kilsyth, Kilsyth South, Ringwood, Ringwood East, Ringwood North, Vermont, and Wonga Park.	City of Maroondah. Assignment of the 12 aforementioned suburbs locality names and boundaries within the municipality. The plans showing the names and boundaries may be inspected at the Municipal Offices, or the Office of the Registrar of Geographic Names.

- 1616 Brookfield, Burnside, Caroline Springs, Diggers Rest, Exford, Eynesbury, Hillside, Kurunjang, Melton, Melton South, Melton West, Mount Cottrell, Parwan, Plumpton, Ravenhall, Rockbank, and Truganina. Shire of Melton. Assignment of the 17 aforementioned suburbs locality names and boundaries within the municipality. The plans showing the names and boundaries may be inspected at the Municipal Offices, or the Office of the Registrar of Geographic Names.
- 1741 Almonds, Barmah, Bathumi, Bearii, Boomahnmoonah, Boosey, Boweya North, Bundalong, Bundalong South, Burramine, Burramine South, Cobram, Cobram East, Drumanure, Esmond, Invergordon, Kaarimba, Katamatite, Katamatite East, Katunga, Koonoomoo, Kotupna, Lake Rowan, Lower Moira, Marungi, Muckatah, Mundoona, Mywee, Naring, Nathalia, Numurkah, Peechelba, Pelluebla, Picola, Picola West, Saint James, Strathmerton, Telford, Tungamah, Ulupna, Waia, Waggarandall, Wilby, Wunghnu, Yabba North, Yabba South, Yalca, Yarrawonga, Yarrawonga South, Yarroweyah, Yielima, Youanmite, Youarang and Yundool. Shire of Moira. Assignment of the 54 aforementioned urban and rural locality names and their boundaries within the municipality. The plans showing the names and boundaries may be inspected at the Municipal Offices, or the Office of the Registrar of Geographic Names.
- 1722 Amphitheatre, Avoca, Ballyrogan, Barkly, Beaufort, Bo Peep, Brewster, Buangor, Bung Bong, Burnbank, Burrumbeet, Carngham, Carranballac, Chepstowe, Chute, Cross Roads, Crowlands, Elmhurst, Ercildoune, Evansford, Eversley, Frenchmans, Glenbrae, Glenlofty, Glenlogie, Glenpatrick, Hillcrest, Lake Goldsmith, Lake Wongan, Lamplough, Landsborough, Landsborough West, Langi Kal Kal, Lexton, Lillicur, Linton, Lower Homebush, Main Lead, Mena Park, Middle Creek, Moonambel, Mount Emu, Mount Lonarch, Natte Yallock, Navarre, Nerring, Nowhere Creek, Percydale, Pittong, Raglan, Redbank, Rathscar, Rathscar West, Shays Flat, Skipton, Smythesdale, Snake Valley, Stockyard Hill, Stoneleigh, Streatham, Tanwood, Trawalla, Wareek, Warrenmang, Waterloo, Wattle Creek, Waubra and Yalla-Y-Poora. Shire of Pyrenees. Assignment of the 68 aforementioned urban and rural locality names and their boundaries within the municipality. The plans showing the names and boundaries may be inspected at the Municipal Offices, or the Office of the Registrar of Geographic Names.

- |      |   |   |
|------|---|---|
| 1739 | Annuello, Bannerton, Beauchamp, Beverford, Bolton, Boundary Bend, Bulga, Castle Donnington, Chillingollah, Chinangin, Chinkapook, Cocamba, Fish Point, Gerahmin, Goschen, Gowanford, Happy Valley, Kenley, Kooloonong, Kunat, Lake Boga, Lake Powell, Liparoo, Manangatang, Meatian, Miralie, Murnungin, Murrawee, Murraydale, Narrung, Natya, Nowie, Nyah, Nyah West, Nyrraby, Pental Island, Piangil, Pira, Polisbet, Robinvale, Robinvale Irrigation District Section B, Robinvale Irrigation District Section C, Robinvale Irrigation District Section D, Robinvale Irrigation District Section E, Swan Hill, Swan Hill West, Tol Tol, Towan, Tresco, Tresco West, Turoar, Tyntynder, Tyntynder South, Ultima, Ultima East, Vinifera, Waitchie, Wandown, Wemen, Winlaton, Winnambool, Wood Wood, Woorinen, Woorinen North and Woorinen South. | Rural City of Swan Hill. Assignment of the 65 aforementioned urban and rural locality names and their boundaries within the municipality. The plans showing the names and boundaries may be inspected at the Municipal Offices, or the Office of the Registrar of Geographic Names.                 |
| 1724 | Apsley, Benayeo, Big Desert, Bringalbert, Charam, Chetwynd, Connewirricoo, Dergholm, Dorodong, Douglas, Edenhope, Goroke, Gymbowen, Harrow, Kadnook, Kaniva, Karnak, Langkoop, Lawloit, Lillimur, Miga Lake, Minimay, Miram, Neuarpurr, Nurcoung, Ozenkadnook, Peronne, Poolaijelo, Powers Creek, Pityah, Serviceton, Tarrayoukyan, Telopea Downs, Ullswater and Wombelano  | Proposal from the Shire of West Wimmera. Assignment of the 35 aforementioned urban and rural locality names and their boundaries within the municipality. The plans showing the names and boundaries may be inspected at the Municipal Offices, or the Office of the Registrar of Geographic Names. |
| 1688 | Bandiana, Baranduda, Barnawartha North, Bonegilla, Castle Creek, Ebdon, Gateway Island, Huon Creek, Killara, Leneva, Staghorn Flat, Wodonga and Wodonga West.   | Proposal from the Rural City of Wodonga. Assignment of the 13 aforementioned urban and rural locality names and their boundaries within the municipality. The plans showing the names and boundaries may be inspected at the Municipal Offices, or the Office of the Registrar of Geographic Names. |

## CORRIGENDUM

The Victorian Government Gazette No. G1, dated 7 January 1998, page 25, under Notice of Proposal to Assign, the mentioned Place Names of the suburbs of the City of Greater Bendigo should read (74) - Ascot, Avonmore, Axe Creek, Axedale, Bagshot, Bagshot North, Barnadown, Bendigo, Big Hill, California Gully, Costerfield, Derrinal, Drummartin, Eaglehawk, Eaglehawk North, East Bendigo, Elmore, Emu Creek, Eppalock, Epsom, Flora Hill, Fosterville, Golden Gully,

Golden Square, Goornong, Harcourt North, Heathcote, Hunter, Huntly, Huntly North, Ironbark, Jackass Flat, Junortoun, Kamarooka, Kangaroo Flat, Kennington, Kimbolton, Knowsley, Leichardt, Lockwood, Lockwood South, Long Gully, Longlea, Lyell, Maiden Gully, Mandurang, Mandurang South, Marong, Mia Mia, Mt Camel, Myers Flat, Myrtle Creek, Neilborough, North Bendigo, Quarry Hill, Ravenswood, Raywood, Redcastle, Redesdale, Sailors Gully, Sebastian, Sedgwick, Shelbourne, Spring Gully, Spring Plains, Strathdale, Strathfieldsaye, Toolleen, Wellsford, West Bendigo, Whipstick, White Hills, Wilsons Hill, Woodvale.

PLACE NAMES COMMITTEE

c/- LAND VICTORIA

5th Floor

436 Lonsdale Street

MELBOURNE 3000

ALAN FENNELL

Chairman, Place Names Committee

**Private Agents Act 1966**

**NOTICE OF RECEIPT OF APPLICATIONS FOR LICENCES UNDER THE PROVISIONS OF THE PRIVATE AGENTS ACT 1966**

I, the undersigned, being the Deputy Registrar of the Melbourne Magistrates' Court hereby give notice that applications, as under have been lodged for hearing by the said Court on the date specified.

Any person desiring to object to any such application must:

- (a) lodge with me a notice in the prescribed form of his objection and of the grounds thereof;
- (b) cause a copy of such notice to be served personally or by post upon the applicant at least three days before the hearing of the application; and
- (c) send or deliver
  - (i) where the objection is not made by the officer in charge of the police district in which the Court is situated — a copy of the notice to such officer; and
  - (ii) where the objection is not made by the Registrar or Deputy Registrar — a copy to the Registrar.

<i>Full name of Applicant or in the case of a Firm or Corporation, of the Nominee</i>	<i>Place of Abode of Applicant or Nominee</i>	<i>Name of Firm or Corporation</i>	<i>Address for Registration</i>	<i>Type of Licence</i>	<i>Date of Hearing of Application</i>
Joe Hann Korovulavula	8/7 Ravens Grove, St. Kilda East, Vic. 3183	Redlink Security Pty Ltd	Room 905, 258 Little Bourke Street, Melbourne	Com- mercial agent	

PETER MITHEN

Deputy Registrar Melbourne Magistrates' Court

**Private Agents Act 1966****NOTICE OF RECEIPT OF APPLICATIONS FOR LICENCES UNDER THE PROVISIONS OF  
THE PRIVATE AGENTS ACT 1966**

I, the undersigned, being the Deputy Registrar of the Melbourne Magistrates' Court hereby give notice that applications, as under have been lodged for hearing by the said Court on the date specified.

Any person desiring to object to any such application must:

- (a) lodge with me a notice in the prescribed form of his objection and of the grounds thereof;
- (b) cause a copy of such notice to be served personally or by post upon the applicant at least three days before the hearing of the application; and
- (c) send or deliver
  - (i) where the objection is not made by the officer in charge of the police district in which the Court is situated — a copy of the notice to such officer; and
  - (ii) where the objection is not made by the Registrar or Deputy Registrar — a copy to the Registrar.

<i>Full name of Applicant or in the case of a Firm or Corporation, of the Nominee</i>	<i>Place of Abode of Applicant or Nominee</i>	<i>Name of Firm or Corporation</i>	<i>Address for Registration</i>	<i>Type of Licence</i>	<i>Date of Hearing of Application</i>
John Michael Whelan	5 Herrods Lane, Blakeville Victoria 3342	Industry Funds Credit Control Pty Ltd	Level 4, 365 Little Collins Street, Melbourne Victoria	Commercial agent	
Margaret Joy Petrie	35 Edols Street, Ballan, Vic. 3342	Industry Funds Credit Control Pty Ltd	Level 4, 365 Little Collins Street, Melbourne 3000	Commercial Sub-agent	
Paul John Robinson	11 Norman Street, McKinnon, Vic. 3204	Charter Mercantile Agency	Level 8, 459 Little Collins Melbourne	Commercial Sub-agent	
Belinda Kim Anderson	38 Lawrence Drive, Berwick Vic. 3806	Charter Mercantile Agency (Vic) Pty Ltd	Level 8, 459 Little Collins Street Melbourne	Commercial Sub-agent	
Robyn Joy Quick	12A High Street, Seaholme 3018	Charter Mercantile Agency (Vic) Pty Ltd	Level 8 459 Little Collins Street Melbourne	Commercial Sub-agent	

<i>Full name of Applicant or in the case of a Firm or Corporation, of the Nominee</i>	<i>Place of Abode of Applicant or Nominee</i>	<i>Name of Firm or Corporation</i>	<i>Address for Registration</i>	<i>Type of Licence</i>	<i>Date of Hearing of Application</i>
Belinda June McNamara	18 Cahill Drive, Melton, Victoria	Charter Mercantile Agency	Level 1, 377 Little Lonsdale Street, Melbourne Victoria 3000	Commercial Sub-agent	
Melissa Margaret Martin	7 Prince Edward Avenue, Mitcham	Creditech	301 Burwood Highway Burwood	Commercial Sub-agent	
Christopher Francis Bambridge	14 Sapphire Drive, Hampton Park, Vic. 3976	Commander Credit & Collection Company Pty Limited	5/14 Queens Road, Melbourne Vic. 3004	Commercial agent	
Simon Matthew Clark	9 Benjamin Court, Clayton South 3169	Ivar R. Von Siver trading as I.V.S. Mercantile Agency	Suite 4, 145 Wattletree Road Malvern	Commercial Sub-agent	

PETER MITHEN

Deputy Registrar Melbourne Magistrates' Court

**Transport Act 1983****VICTORIAN TAXI DIRECTORATE**

## Department of Infrastructure

## Commercial Passenger Vehicle Applications

Notice is hereby given that the following applications will be considered by the Victorian Taxi Directorate, a division of the Department of Infrastructure after 24 February 1999.

Notice of any objection to the granting of an application should be forwarded to reach the Manager, Licensing & Certification, Victorian Taxi Directorate, Level 6, 14-20 Blackwood Street, North Melbourne (P.O. Box 666, North Melbourne 3051) not later than 18 February 1999.

Copies of objections are forwarded to the applicants.

It will not be necessary for interested parties to appear on the date specified, unless advised in writing by the Department.

Casino Corporate Cars Pty Ltd, Ormond. Application for variation of conditions of licence SV1410 which authorises the licensed vehicle to operate for the carriage of passengers for wedding parties in respect of a 1965 Ford Lincoln sedan with seating capacity for 4 passengers to change the vehicle to a 1989 Mercedes SEL sedan with seating capacity of 12 or fewer seats and to include the ability to operate as follows:-

- (i) for the carriage of passengers for special occasions and various tours to places of interest throughout the State of Victoria; and
- (ii) for Airport transfers to and from Melbourne Airport, Tullamarine.

Note 1: Passengers on various tours to places of interest will be picked up/set down throughout the State of Victoria.

Note 2: This applicant currently operating under a temporary licence.



Denis Walter Music Pty Ltd, Newtown. Application to license one commercial passenger vehicle in respect of a 1967 Mercedes sedan with seating capacity for 4 passengers to operate a service from 352 Shannon Avenue, Newtown for the carriage of passengers for wedding parties and special occasions.

Getting About Coaches Pty Ltd. Application to license one commercial passenger vehicle in respect of a 1980 Denning coach with seating capacity for 47 passengers to operate as a metropolitan special service omnibus from within a 55 km pick-up radius of the Melbourne GPO.

M. & R. Erceg, Geelong. Application to license one commercial passenger vehicle in respect of a 1997 Toyota van with seating capacity for 11 passengers to operate a service from 7 Pratt Court, Bell Post Hill for the carriage of farm workers between Geelong urban area and farms in Werribee and Bacchus Marsh.

Dated 21 January 1999.

ROBERT STONEHAM  
Manager - Operations  
Victorian Taxi Directorate

### Transport Act 1983

#### ROAD DECLARATIONS AND DEDICATIONS

The Roads Corporation pursuant to the **Transport Act 1983**, upon publication of this notice declares, or varies the declaration of, the roads as described below and on the plans attached, and further declares that such roads are fit to be used as a public highway and are now absolutely dedicated to the public for use as public highways within the meaning of any law now or hereafter in force.

#### STATE HIGHWAY

- 2/99 Goulburn Valley Highway in the City of Greater Shepparton shown hatched on plans numbered GP 19311 & GP 19611.

#### TOURISTS' ROAD

- 3/99 Great Ocean Road in the Shire of Colac-Otway shown cross hatched on plans numbered GP 14373B & GP 14374A.  
4/99 Waratah Road in the Shire of South Gippsland shown hatched and cross hatched on plan numbered GP 19058.

#### ROAD

- 5/99 Road in the City of Manningham shown hatched on plan numbered GP17197C.

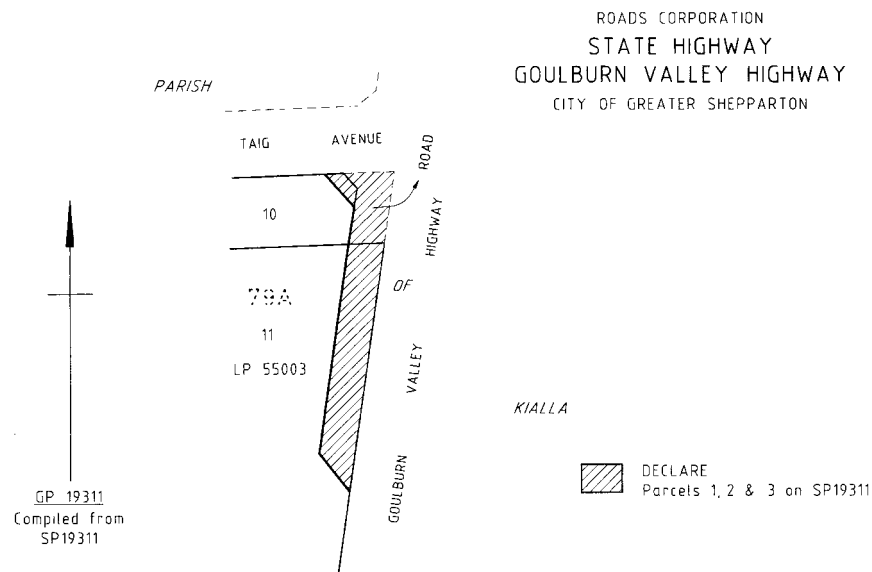

ROADS CORPORATION  
STATE HIGHWAY  
GOULBURN VALLEY HIGHWAY  
CITY OF GREATER SHEPPARTON

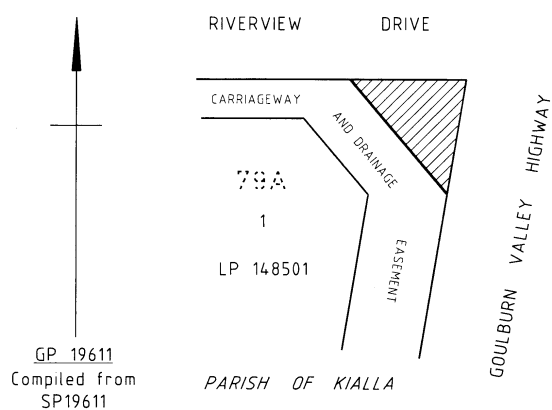

DECLARE  
Parcel 1 on SP 19611

ROADS CORPORATION  
TOURISTS' ROAD  
GREAT OCEAN ROAD  
SHIRE OF COLAC - OTWAY

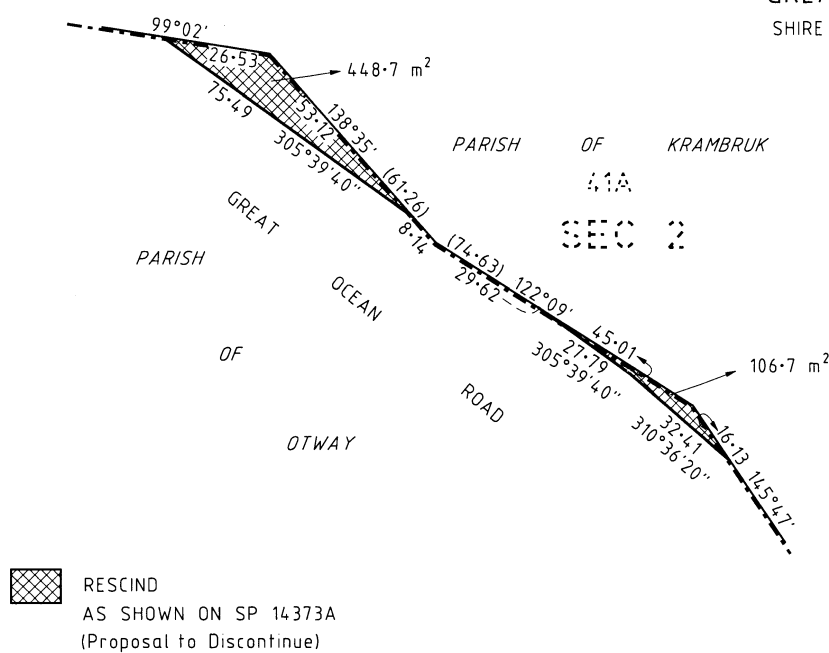

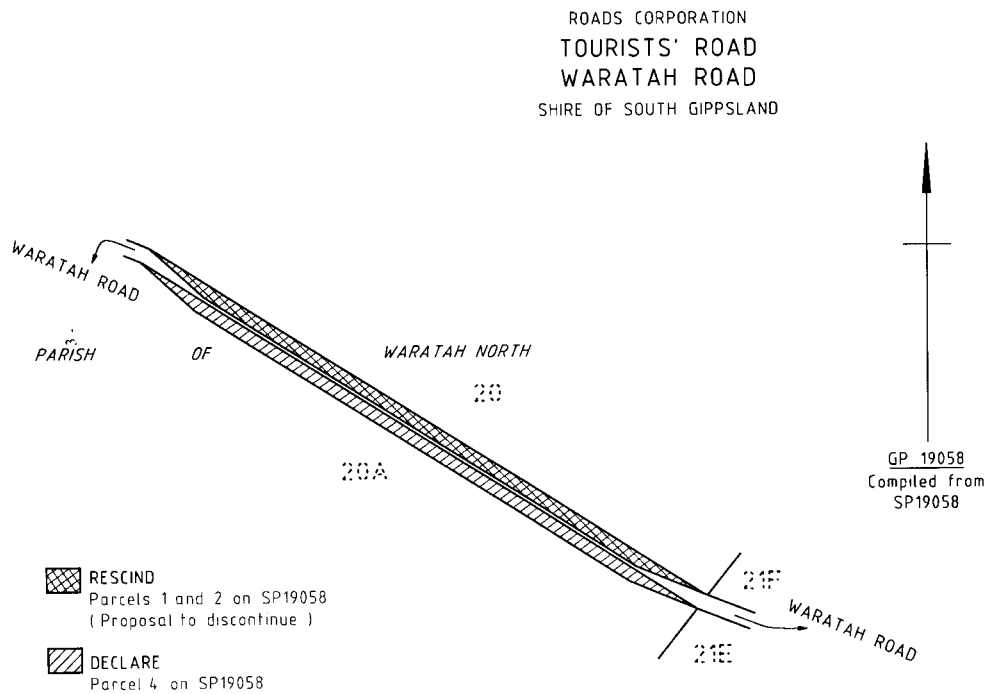
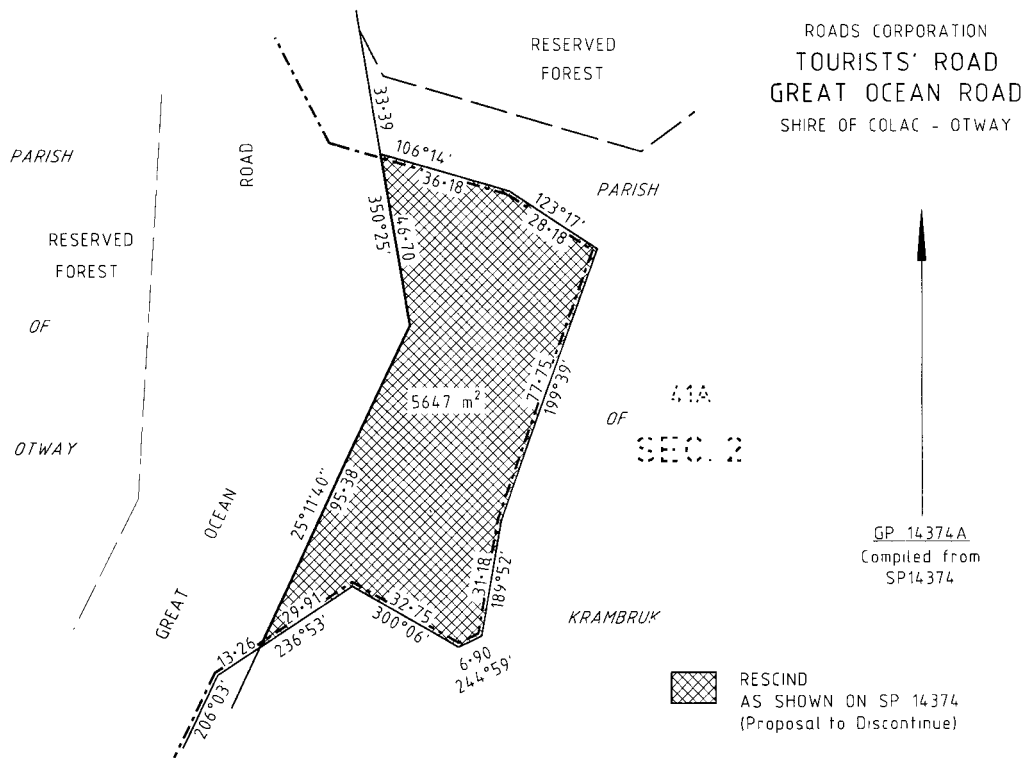

ROADS CORPORATION  
ROAD  
CITY OF MANNINGHAM

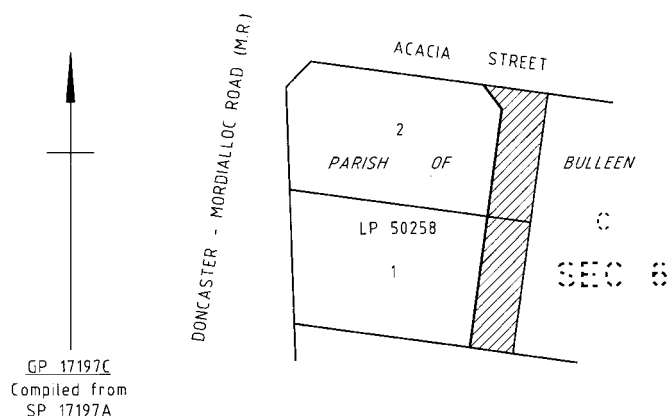

DECLARE  
Parcels 11 & 12 on SP 17197A

Dated 14 January 1999.

COLIN JORDAN  
Chief Executive  
Roads Corporation

### Transport Act 1983

#### DISCONTINUANCE OF ROADS OR PARTS OF ROADS AND SALE OF SURPLUS LAND

The Roads Corporation, in pursuance of the powers conferred by the Clause 2 Schedule 4 of the **Transport Act 1983**, upon publication of this notice hereby discontinues the roads or parts of roads shown cross hatched on the plan hereunder and approves the sale of surplus land as provided in Section 47 of the **Transport Act 1983** and as delegated by the Minister of Transport under Section 32 of the Act.

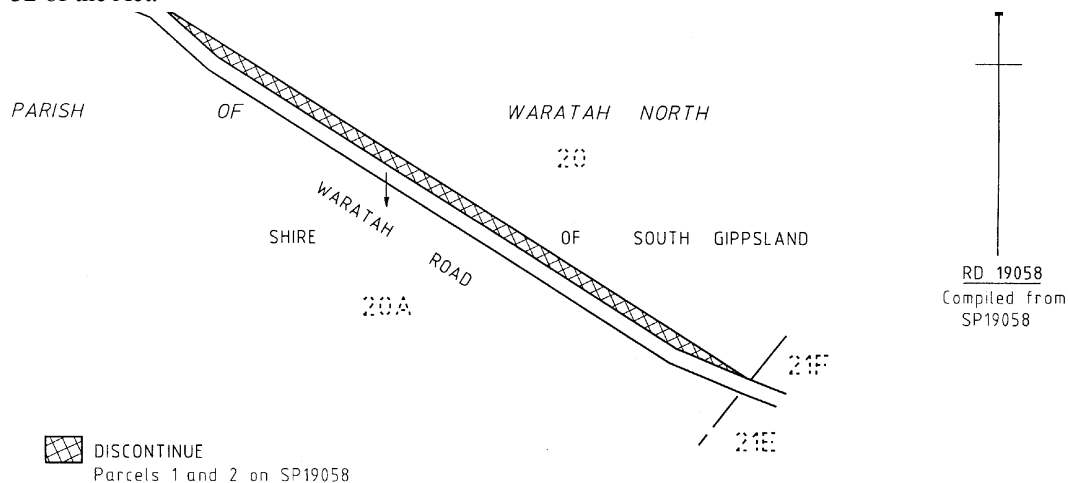

Dated 14 January 1999.

COLIN JORDAN  
Chief Executive  
Roads Corporation

**Transport Act 1983****DISCONTINUANCE OF ROADS OR PARTS OF ROADS AND SALE OF SURPLUS LAND**

The Roads Corporation, in pursuance of the powers conferred by the Clause 2 Schedule 4 of the **Transport Act 1983**, upon publication of this notice hereby discontinues the roads or parts of roads shown cross hatched on the plan hereunder and approves the sale of surplus land as provided in Section 47 of the **Transport Act 1983** and as delegated by the Minister of Transport under Section 32 of the Act.

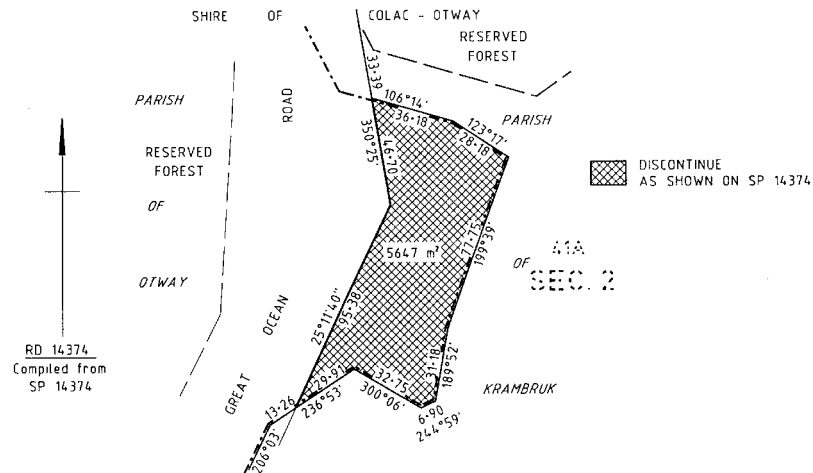

Dated 14 January 1999.

COLIN JORDAN  
Chief Executive  
Roads Corporation

**Transport Act 1983****DISCONTINUANCE OF ROADS OR PARTS OF ROADS AND SALE OF SURPLUS LAND**

The Roads Corporation, in pursuance of the powers conferred by the Clause 2 Schedule 4 of the **Transport Act 1983**, upon publication of this notice hereby discontinues the roads or parts of roads shown cross hatched on the plan hereunder and approves the sale of surplus land as provided in Section 47 of the **Transport Act 1983** and as delegated by the Minister of Transport under Section 32 of the Act.

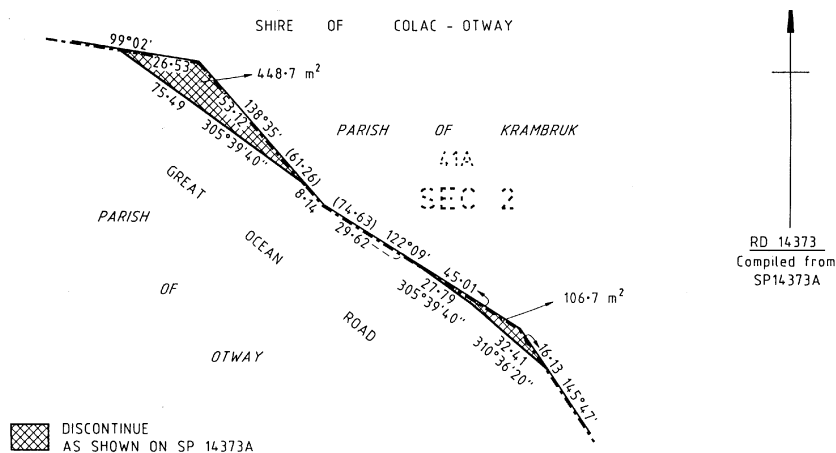

Dated 14 January 1999.

COLIN JORDAN  
Chief Executive  
Roads Corporation

**Education Act 1958****REMOVAL AND APPOINTMENT OF  
MEMBERS OF THE REGISTERED  
SCHOOLS BOARD**

Pursuant to section 36 (4) of the **Education Act 1958**, notice is hereby given that an Order of the Governor in Council was made on 15 December 1998 removing Mr George Holmes and Mr Robert Message from office as members of the Registered Schools Board, and appointing Ms Cynthia Merrill and Mr Dennis Bolster as members of the Registered Schools Board pursuant to section 36(2)(a) of the **Education Act 1958**.

HON. PHILLIP GUDE, MP  
Minister for Education

**Children's Services Act 1996****NOTICE OF EXEMPTION**

I, Denis Napthine, Minister for Youth and Community Services, pursuant to section 6 of the **Children's Services Act 1996** (the Act), declare that Kerang Kindergarten Inc (Children's Services Licence Number 1861) and Kerang Preschool Association Inc (Children's Services Licence Number 1864) are exempt from the following section of the Act:

section 24(2)(c) requiring an application to transfer a children's service licence to be accompanied by the prescribed fee.

This notice remains in force until 31 July 1999.

Declared at Melbourne on 7th December 1998.

HON DENIS NAPTHINE MP  
Minister for Youth and Community Services

**Land Act 1958****NOTICE OF INTENTION TO EXCHANGE  
LAND**

I, Marie Tehan the Honourable Minister for Conservation and Land Management do hereby give notice that, after the expiry of at least 14 days from the date of publication of this notice, I intend to enter into an agreement with B.R.E. & B. Co. Pty Ltd. of 16 Aberdeen Street, Geelong West to exchange the Crown land described as Crown Allotment 6 of Section 48, Parish of Moranghurk for the freehold land

described as being parts of Suburban Crown Allotment twenty-three, Township of Fyansford as contained in Certificates of Title Volume 5295 Folio 849 and Volume 4990 Folio 847.

(Reference (L1-4695)).

**Children and Young Persons Act 1989****APPOINTMENT OF HONORARY  
PROBATION OFFICERS**

I, Brian Joyce, Regional Director of Southern Metropolitan Region of Department of Human Services, under section 34(4) of the **Children and Young Persons Act 1989** appoint the undermentioned as Honorary Probation Officers for the Children's Court in the State of Victoria for the period ending 31 December 2001:

Adams, Judi	McDonough, Paul
Alexander, Inka	McGrory, William
Andison, Allan	Mogg, Michaela
Andrew, Jean	Okeefe, Toni
Ballantine, Peter	Owens, Terry
Bernardo, Tania	Pennaert, Jacqueline
Brittcliff Aston	Peer, Alice
Caspersz, Peter	Pereira, Charlene
Collier, Alan	Reardon, Karla
Collins, Cheryl	Reigosa, Giselle
Corben, Bruce	Reynolds, Gordon
Dennis, Jane	Richards, Sr, Lyn
Dickson, Jenny	Roberts, Grant
Doko, Luana	Sheehy Enid
Douglas, Jane	Sinclair, Laura
Durso, Jane	Sparrow, Jim
Fisher, Ross	Stanzus, Gerhard
Gourlay, Michael	Stanzus, Jillian
Howell, Cindy	Trinh, Vi
Johnson, Graeme	Walmsley, Malcolm
Kristalia, Patsiouras	Walpole, Hugh
Lal, Anandita	Woods, Peggy
Lombardo, Christine	Wright, Judith
Mahoney, John	Zamora, Alexandra
Martin, Lewis	

BRIAN JOYCE  
Regional Director

**Children and Young Persons Act 1989****APPOINTMENT OF HONORARY  
PROBATION OFFICERS**

I, Geoff Lavender, Regional Director of Barwon South West Region of Department of

Human Services, under Section 34(4) of the **Children and Young Persons Act 1989**, appoint the undermentioned persons as Honorary Probation Officers for the Children's Court in the State of Victoria for the period ending 31 December, 2001.

Annersly Heather, 165 George Street, Fitzroy 3065; Birthisel Barbara Anne, 4 Karong Court, Warrnambool 3280; Campbell Mary Anne, 183 Kings Street, Hamilton 3300; Cashion Carol, 2/124 Mortlake Road, Warrnambool 3280; Dowell Deborah, 89 Bank Street, Port Fairy 3284; Eales Ronald George, 9 Ekard Avenue, Warrnambool 3280; Genardini Nancy, RSD 1061, Drumborg via Heywood 3304; Griffith Yvonne, 145 Rippon Road, Hamilton 3300; Herbertson Margaret, 6 Whalers Crescent, Portland 3305; Hinchcliffe Annette, 49 Hurd Street, Portland 3305; Innes (Betty) Elaine, P.O. Box 56, Heywood 3304; Jackson Lesley Ann, 65 Gawler Street, Portland 3305; Lane Michael, RMB 5134, Anderson Road, Tower Hill 3282; Lovett Denise, 56 Lindsay Street, Heywood 3304; Makin Margaret Kay, 16 Bell Street, Warrnambool 3280; Mifsud Jason, 4 Granter Street, Warrnambool 3280; Nagorcka Robyn, 103 George Street, Portland 3305; Roberts Peggy Northcliffe, P.O. Box 503, Portland 3305; Smith Daisyanne, RSD 1122A Princes Highway, Greenwald 3304; Sumner Doreen, 56 Koroit Street, Warrnambool 3280; Van Kalken Jozephus Johannes M. Mondani, 11 Kenna Avenue, Hamilton 3300; Wells Linda, 28 Crawley Street, Warrnambool 3280; Young Heather, 41 Bostock Street, Warrnambool 3280.

Dated 14 January 1998.

GEOFF LAVENDER  
Regional Director

#### **Water Act 1989**

##### **DECLARATION OF THE CREATION OF THE WANDONG HEATHCOTE JUNCTION SEWERAGE DISTRICT ORDER 1998**

1. This Order is called the Declaration of the Wandong Heathcote Junction Sewerage District - Order 1999.
2. This Order is made under Section 96(11)(a) of the **Water Act 1989** and all other available powers.
3. This Order takes effect from the date it is published in the Government Gazette.

4. The proposal for the declaration of a new sewerage district submitted to the Department of Natural Resources and Environment by the Goulburn Valley Region Water Authority on 8 December, 1998 is approved by the Minister.

5. (a) A new sewerage district is declared;
- (b) The new sewerage district is called Wandong Heathcote Junction Sewerage District;
- (c) The Wandong Heathcote Junction Sewerage District is the land within the red border on the accompanying plan No. JS628, a copy of which may be inspected at the offices of the Goulburn Valley Region Water Authority, situated at 104-110 Fryers Street, Shepparton or Hume and Hovell Streets, Seymour, Victoria; and
- (d) The Goulburn Valley Region Water Authority is nominated to manage and control the Wandong Heathcote Junction Sewerage District.

Dated 13 January, 1999.

L. J. GLEESON  
Chief Executive

#### **Water Act 1989**

##### **DECLARATION OF EXTENSION TO THE BONNIE DOON SEWERAGE DISTRICT ORDER 1998**

6. This Order is called the Declaration of the Bonnie Doon Sewerage District - Order 1999.
7. This Order is made under Section 96(11)(a) of the **Water Act 1989** and all other available powers.
8. This Order takes effect from the date it is published in the Government Gazette.
9. The proposal for the declaration of a new sewerage district submitted to the Department of Natural Resources and Environment by the Goulburn Valley Region Water Authority on 24 December, 1998 is approved by the Minister.
10. (a) A new sewerage district is declared;
- (e) The new sewerage district is called Bonnie Doon Sewerage District;
- (f) The Bonnie Doon Sewerage District is the land within the red border on the

accompanying plan No. JW628, a copy of which may be inspected at the offices of the Goulburn Valley Region Water Authority, situated at 104-110 Fryers Street, Shepparton or Hume and Hovell Streets, Seymour, Victoria; and

- (g) The Goulburn Valley Region Water Authority is nominated to manage and control the Bonnie Doon Sewerage District.

Dated 13 January, 1999.

L. J. GLEESON  
Chief Executive

#### **Water Act 1989**

##### **DECLARATION OF THE CREATION OF THE MERRIGUM SEWERAGE DISTRICT ORDER 1998**

11. This Order is called the Declaration of the Merrigum Sewerage District - Order 1999.
12. This Order is made under Section 96(11)(a) of the **Water Act 1989** and all other available powers.
13. This Order takes effect from the date it is published in the Government Gazette.
14. The proposal for the declaration of a new sewerage district submitted to the Department of Natural Resources and Environment by the Goulburn Valley Region Water Authority on 27 November, 1998 is approved by the Minister.
15. (a) A new sewerage district is declared;
- (h) The new sewerage district is called Merrigum Sewerage District;
- (i) The Merrigum Sewerage District is the land within the red border on the accompanying plan No. OIC-Merrigum Sewer, a copy of which may be inspected at the offices of the Goulburn Valley Region Water Authority, situated at 104-110 Fryers Street, Shepparton, Victoria; and
- (j) The Goulburn Valley Region Water Authority is nominated to manage and control the Merrigum Sewerage District.

Dated 13 January, 1999.

L. J. GLEESON  
Chief Executive

#### **Water Act 1989**

##### **DECLARATION OF EXTENSION TO THE MERRIGUM WATER DISTRICT ORDER 1998**

16. This Order is called the Declaration of the Merrigum Water District - Order 1999.
17. This Order is made under Section 96(11)(a) of the **Water Act 1989** and all other available powers.
18. This Order takes effect from the date it is published in the Government Gazette.
19. The proposal for the declaration of a new water district submitted to the Department of Natural Resources and Environment by the Goulburn Valley Region Water Authority on 27 November, 1998 is approved by the Minister.
20. (a) A new sewerage district is declared;
- (k) The new water district is called Merrigum Water District;
- (l) The Merrigum Water District is the land within the red border on the accompanying plan No. OIC-Merrigum Water, a copy of which may be inspected at the offices of the Goulburn Valley Region Water Authority, situated at 104-110 Fryers Street, Shepparton, Victoria; and
- (m) The Goulburn Valley Region Water Authority is nominated to manage and control the Merrigum Water District.

Dated 13 January, 1999.

L. J. GLEESON  
Chief Executive

#### **Water Act 1989**

##### **WESTERNPORT REGION WATER AUTHORITY**

I, David Heeps, Director, Water Agencies, Department of Natural Resources and Environment as the delegate of the Minister for Agriculture and Resources, make the following Order:

##### **EXTENSION OF THE WESTERNPORT SEWERAGE DISTRICT ORDER 1998**

1. This Order is called the Extension of the Westernport Sewerage District Order 1998.
2. This Order is made under Section 96(11) of the **Water Act 1989** and all other available powers.



3. The Order takes effect from the day it is published in the Government Gazette.
4. The proposal dated 16 December 1998, for the extension of the Westernport Sewerage District of the Westernport Region Water Authority submitted to the Minister for Agriculture and Resources by the Westernport Region Water Authority, is approved.
5. The Westernport Sewerage District is extended to include the areas bordered in red on the plans, copies of which may be inspected at the offices of the Westernport Region Water Authority, situated at the Civic Centre, 91-97 Thompson Avenue, Cowes.

Dated 15 January 1999.

DAVID HEEPS  
Director, Water Agencies  
Department of Natural Resources  
and Environment  
(as delegate of the Minister for Agriculture  
and Resources)

---

**Water Act 1989**

I, Patrick McNamara, Minister for Agriculture and Resources, make the following Order:

DENISON

GROUNDWATER SUPPLY PROTECTION  
AREA DECLARATION ORDER 1998

1. This Order is called the Denison Groundwater Supply Protection Area Declaration Order 1998.
2. This Order is made under the powers conferred by Division 3 of Part 3 of the **Water Act 1989** and all other available powers.
3. This Order takes effect on and from the date it is published in the Government Gazette.
4. On and from the date on which this Order takes effect-
  - (a) the area of land shown within the hatched border on Plan No. LGL./97-229 and the aquifers from 0 to 25 meters from the natural surface is declared to be a Groundwater Supply Protection Area; and

- (b) the area shall be known as the Denison Groundwater Supply Protection Area.

5. Plan No. LGL./97-229 referred to in clause 4 may be inspected at the office of Land and Survey Information Services - Department of Natural Resources and Environment, 436 Lonsdale Street, Melbourne during business hours.

Dated 24 November 1998

PATRICK McNAMARA  
Minister administering the **Water Act 1989**

---

**Water Act 1989**

I, Patrick McNamara, Minister for Agriculture and Resources, make the following Order:

MURRAYVILLE

GROUNDWATER SUPPLY PROTECTION  
AREA DECLARATION ORDER 1998

1. This Order is called the Murrayville Groundwater Supply Protection Area Declaration Order 1998.
2. This Order is made under the powers conferred by Division 3 of Part 3 of the **Water Act 1989** and all other available powers.
3. This Order takes effect on and from the date it is published in the Government Gazette.
4. On and from the date on which this Order takes effect-
  - (a) the area of land shown within the hatched border on Plan No. LGL./97-273 and the aquifers from 70 to 200 metres from the natural surface is declared to be a Groundwater Supply Protection Area; and
  - (b) the area shall be known as the Murrayville Groundwater Supply Protection Area.
5. Plan No. LGL./97-273 referred to in clause 4 may be inspected at the office of Land and Survey Information Services - Department of Natural Resources and Environment, 436 Lonsdale Street, Melbourne during business hours.

Dated 16 December 1998

PATRICK McNAMARA  
Minister administering the **Water Act 1989**

---

**Water Act 1989**

I, Patrick McNamara, Minister for Agriculture and Resources, make the following Order:

**NEUARPUR****GROUNDWATER SUPPLY PROTECTION  
AREA DECLARATION ORDER 1998**

1. This Order is called the Neuarpur Groundwater Supply Protection Area Declaration Order 1998.
2. This Order is made under the powers conferred by Division 3 of Part 3 of the **Water Act 1989** and all other available powers.
3. This Order takes effect on and from the date it is published in the Government Gazette.
4. On and from the date on which this Order takes effect-
  - (a) the area of land shown within the hatched border on Plan No. LGL./97-274 and the aquifers from 50 to 175 metres from the natural surface is declared to be a Groundwater Supply Protection Area; and
  - (b) the area shall be known as the Neuarpur Groundwater Supply Protection Area.
5. Plan No. LGL./97-274 referred to in clause 4 may be inspected at the office of Land and Survey Information Services - Department of Natural Resources and Environment, 436 Lonsdale Street, Melbourne during business hours.

Dated 16 December 1998

PATRICK McNAMARA  
Minister administering the **Water Act 1989**

**Planning and Environment Act 1987****BRIMBANK PLANNING SCHEME**

## Notice of Approval of Amendment

## Amendment L41

The Minister for Planning and Local Government has approved Amendment L41 to the Brimbank Planning Scheme.

The amendment comes into operation on the date this notice is published in the Government Gazette.

The amendment rezones land on the north west corner of Kings Road and Taylors Road, Delahey from a Public Purposes Reservation (Commonwealth) to a Business 1 zone. A Development Plan Overlay will also apply to the land.

A copy of the amendment can be inspected, free of charge, during office hours, at the Department of Infrastructure, Customer Service Centre, Upper Plaza, Nauru House, 80 Collins Street, Melbourne and at the offices of the Brimbank City Council, Old Calder Highway, Keilor.

LEIGH PHILLIPS  
Director, Planning Operations  
Planning, Heritage  
and Market Information  
Department of Infrastructure

**Planning and Environment Act 1987****CRANBOURNE PLANNING SCHEME**

## Notice of Approval of Amendment

## Amendment L210

The Minister for Planning and Local Government has approved Amendment L210 to the Cranbourne Planning Scheme.

The amendment comes into operation on the date this notice is published in the Government Gazette.

The amendment rezones land known as 820, 830, 850 and 870 North Road, Pearcedale to a Residential (Rural Landscape) Zone and inserts a site specific control into this zone to facilitate the subdivision of the land into 34 lots subject to the grant of a permit that is generally in accordance with Concept Plan No. 5012D18.

A copy of the amendment can be inspected, free of charge, during office hours, at the Department of Infrastructure, Customer Service Centre, Upper Plaza, Nauru House, 80 Collins Street, Melbourne and at the offices of the Casey City Council, Princes Highway, Narre Warren.

LEIGH PHILLIPS  
Director, Planning Operations  
Planning, Heritage  
and Market Information  
Department of Infrastructure

**Planning and Environment Act 1987**  
**CRANBOURNE PLANNING SCHEME**  
Notice of Approval of Amendment

Amendment L218

The Minister for Planning and Local Government has approved Amendment L218 to the Cranbourne Planning Scheme.

The amendment comes into operation on the date this notice is published in the Government Gazette.

The amendment rezones land generally bound by the Royal Botanic Gardens Cranbourne, the township of Junction Village, Craig Road, Browns Road and Pearcedale Road, Cranbourne South to part Cranbourne Residential Zone and part Corridor A Zone and introduces overlay controls for part of the land.

A copy of the amendment can be inspected, free of charge, during office hours, at the Department of Infrastructure, Customer Service Centre, Upper Plaza, Nauru House, 80 Collins Street, Melbourne and at the offices of the Casey City Council, Princes Highway, Narre Warren.

LEIGH PHILLIPS  
Director, Planning Operations  
Planning, Heritage  
and Market Information  
Department of Infrastructure

**Planning and Environment Act 1987**  
**CRANBOURNE PLANNING SCHEME**  
Notice of Approval of Amendment

Amendment L219

The Minister for Planning and Local Government has approved Amendment L219 to the Cranbourne Planning Scheme.

The amendment comes into operation on the date this notice is published in the Government Gazette.

The amendment inserts a site specific control into the scheme to allow a low density subdivision of approximately 4.55 hectares of land at 775 Dalmore Road, Cardinia subject to a planning permit.

A copy of the amendment can be inspected, free of charge, during office hours, at the Department of Infrastructure, Customer Service Centre, Upper Plaza, Nauru House, 80 Collins

Street, Melbourne and at the offices of the Cardinia Shire Council, Municipal Offices, Henty Way, Pakenham.

LEIGH PHILLIPS  
Director, Planning Operations  
Planning, Heritage  
and Market Information  
Department of Infrastructure

**Planning and Environment Act 1987**  
**GLEN EIRA PLANNING SCHEME**  
Notice of Approval of Amendment

Amendment L29

The Minister for Planning and Local Government has approved Amendment L29 to the Glen Eira Planning Scheme.

The amendment comes into operation on the date this notice is published in the Government Gazette.

The amendment rezones land situated on the corner of Thomas Street and Brewer Road, Bentleigh from a Light Industrial Zone to an Urban Residential 1 Zone and incorporates site specific provisions into the scheme which requires the land to be developed in accordance with an approved Development Plan. The amendment also inserts a Potentially Contaminated Land Overlay over the site and removes a restrictive covenant on a small portion of land.

A copy of the amendment can be inspected, free of charge, during office hours, at the Department of Infrastructure, Customer Service Centre, Upper Plaza, Nauru House, 80 Collins Street, Melbourne and at the offices of the Glen Eira City Council, Corner of Glen Eira and Hawthorn Roads, Caulfield.

LEIGH PHILLIPS  
Director, Planning Operations  
Planning, Heritage  
and Market Information  
Department of Infrastructure

**Planning and Environment Act 1987**  
**GOULBURN PLANNING SCHEME**  
Notice of Approval of Amendment

Amendment L13

The Minister for Planning and Local Government has approved Amendment L13 to the Goulburn Planning Scheme.

The amendment comes into operation on the date this notice is published in the Government Gazette.

The amendment allows for the subdivision of Crown Allotment C<sup>2</sup>, Parish of Tahbilk, into three lots, two of which to be approximately 7.8 hectares in area.

A copy of the amendment can be inspected, free of charge, during office hours, at the Department of Infrastructure, Customer Service Centre, Upper Plaza, Nauru House, 80 Collins Street, Melbourne; Department of Infrastructure, North Eastern Region, 50-52 Clarke Street, Benalla and at the offices of the Strathbogie Shire Council, Binney Street, Euroa.

LEIGH PHILLIPS  
Director, Planning Operations  
Planning, Heritage  
and Market Information  
Department of Infrastructure

---

**Planning and Environment Act 1987**  
MONASH PLANNING SCHEME  
Notice of Approval of Amendment  
Amendment L37

The Minister for Planning and Local Government has approved Amendment L37 to the Monash Planning Scheme.

The amendment comes into operation on the date this notice is published in the Government Gazette.

The amendment rezones land at 171-175 Jells Road, Wheelers Hill from "Reserved Land Local Government Existing" to Residential C.

A copy of the amendment can be inspected, free of charge, during office hours, at the Department of Infrastructure, Customer Service Centre, Upper Plaza, Nauru House, 80 Collins Street, Melbourne and at the offices of the Monash City Council, 293 Springvale Road, Glen Waverley.

LEIGH PHILLIPS  
Director, Planning Operations  
Planning, Heritage  
and Market Information  
Department of Infrastructure

---

**Planning and Environment Act 1987**  
MONASH PLANNING SCHEME  
Notice of Approval of Amendment

Amendment L49

The Minister for Planning and Local Government has approved Amendment L49 to the Monash Planning Scheme.

The amendment comes into operation on the date this notice is published in the Government Gazette.

The amendment rezones land at 2 Einstein Avenue, Mulgrave from Public Open Space to Residential C.

A copy of the amendment can be inspected, free of charge, during office hours, at the Department of Infrastructure, Customer Service Centre, Upper Plaza, Nauru House, 80 Collins Street, Melbourne and at the offices of the Monash City Council, 293 Springvale Road, Glen Waverley.

LEIGH PHILLIPS  
Director, Planning Operations  
Planning, Heritage  
and Market Information  
Department of Infrastructure

---

**Planning and Environment Act 1987**  
MONASH PLANNING SCHEME  
Notice of Approval of Amendment  
Amendment L56

The Minister for Planning and Local Government has approved Amendment L56 to the Monash Planning Scheme.

The amendment comes into operation on the date this notice is published in the Government Gazette.

The amendment deletes the Potentially Contaminated Land Overlay over land at 31 Jacana Street, Chadstone.

A copy of the amendment can be inspected, free of charge, during office hours, at the Department of Infrastructure, Customer Service Centre, Upper Plaza, Nauru House, 80 Collins Street, Melbourne and at the offices of the Monash City Council, 293 Springvale Road, Glen Waverley.

LEIGH PHILLIPS  
Director, Planning Operations  
Planning, Heritage  
and Market Information  
Department of Infrastructure

---

**Planning and Environment Act 1987**

**PAKENHAM PLANNING SCHEME**

**Notice of Approval of Amendment**

**Amendment L159**

The Minister for Planning and Local Government has approved Amendment L159 to the Pakenham Planning Scheme.

The amendment comes into operation on the date this notice is published in the Government Gazette.

The amendment inserts a site specific clause to allow for the creation of one additional lot, subject to a planning permit, on land described as Lots 23 & 24, Lodged Plan 4229, and with frontage to Quinn Road, Gembrook.

A copy of the amendment can be inspected, free of charge, during office hours, at the Department of Infrastructure, Customer Service Centre, Upper Plaza, Nauru House, 80 Collins Street, Melbourne and at the offices of the Cardinia Shire Council, Henty Way, Pakenham.

LEIGH PHILLIPS  
Director, Planning Operations  
Planning, Heritage  
and Market Information  
Department of Infrastructure

**Planning and Environment Act 1987**

**ROSEDALE PLANNING SCHEME**

**Notice of Approval of Amendment**

**Amendment L49**

The Minister for Planning and Local Government has approved Amendment L49 to the Rosedale Planning Scheme.

The amendment comes into operation on the date this notice is published in the Government Gazette.

The amendment inserts a site specific provision to allow part Crown Allotment A2, Parish of Boole Poole, Certificate of Title Volume 5340, Folio 1067844, Mosquito Point, to be subdivided into two lots and a reserve provided certain provisions are met. The proposed development must generally be in accordance with the Eckhardt's Land Concept Plan, dated December 1998. The proposed reserve must be surrendered to the Secretary to the Department of Natural Resources and Environment.

A copy of the amendment can be inspected, free of charge, during office hours, at the Department of Infrastructure, Customer Service Centre, Upper Plaza, Nauru House, 80 Collins Street, Melbourne and at the offices of the East Gippsland Shire Council, Bairnsdale Business Centre, 273 Main Street, Bairnsdale.

LEIGH PHILLIPS  
Director, Planning Operations  
Planning, Heritage  
and Market Information  
Department of Infrastructure

**Planning and Environment Act 1987**

**SALE PLANNING SCHEME**

**Notice of Approval of Amendment**

**Amendment L31**

The Minister for Planning and Local Government has approved Amendment L31 to the Sale Planning Scheme.

The amendment comes into operation on the date this notice is published in the Government Gazette.

The amendment rezones part Lot 3 PS400072, Parish of Sale, County of Tanjil from Light Industrial to Urban Residential 1.

A copy of the amendment can be inspected, free of charge, during office hours, at the Department of Infrastructure, Customer Service Centre, Upper Plaza, Nauru House, 80 Collins Street, Melbourne and at the offices of the Wellington Shire Council, 70 Foster Street, Sale.

LEIGH PHILLIPS  
Director, Planning Operations  
Planning, Heritage  
and Market Information  
Department of Infrastructure

**Planning and Environment Act 1987**

**STONNINGTON PLANNING SCHEME**

**Notice of Approval of Amendment**

**Amendment L54**

The Minister for Planning and Local Government has approved Amendment L54 to the Stonnington Planning Scheme.

The amendment comes into operation on the date this notice is published in the Government Gazette.

The amendment introduces an Urban Conservation Area controls over land at 1-8 Heatherleigh Place, East Malvern.

A copy of the amendment can be inspected, free of charge, during office hours, at the Department of Infrastructure, Customer Service Centre, Upper Plaza, Nauru House, 80 Collins Street, Melbourne and at the offices of the Stonnington City Council, corner Greville and Chapel Streets, Prahran.

LEIGH PHILLIPS  
Director, Planning Operations  
Planning, Heritage  
and Market Information  
Department of Infrastructure

---

**Planning and Environment Act 1987**

**BALLAN PLANNING SCHEME**

**Notice of Lapsing of Amendment**

**Amendment L18**

The Minister for Planning and Local Government has resolved to abandon Amendment L18 to the Ballan Planning Scheme.

The amendment proposed to reserve land for Public Purpose-Police Purposes to facilitate the construction of a new police station.

The amendment lapsed on 14 December 1998.

LEIGH PHILLIPS  
Director, Planning Operations  
Planning, Heritage  
and Market Information  
Department of Infrastructure

---

## ORDERS IN COUNCIL

## Health Services Act 1988

AN ORDER PURSUANT TO SECTIONS 8(1), 33(7) AND 65 OF THE  
**HEALTH SERVICES ACT 1988** IN RELATION TO THE AMALGAMATION OF THE  
 WARRACKNABEAL DISTRICT HOSPITAL, BEULAH PIONEER'S MEMORIAL BUSH  
 NURSING HOSPITAL AND HOPETOUN BUSH NURSING HOSPITAL TO BE KNOWN  
 AS RURAL NORTHWEST HEALTH

THE GOVERNOR IN COUNCIL by this Order -

1. **Directs**, under section 65(1) of the Act, that The Warracknabeal District Hospital, Beulah Pioneer's Memorial Bush Nursing Hospital and Hopetoun Bush Nursing Hospital be amalgamated.
2. **Appoints**, under section 33(7), the initial board of management of the new registered funded agency, Rural Northwest Health, to be constituted as specified in the table below:

MEMBERS OF THE BOARD OF MANAGEMENT:	TERM:
THORNBURN, John Joseph	From 1 February 1999 to 31 October 1999
MALCOLM, Alan James	From 1 February 1999 to 31 October 1999
HEWITT, Robin Garth	From 1 February 1999 to 31 October 1999
KIMBER, Vaun Margaret	From 1 February 1999 to 31 October 2000
LANDRIGAN, Denis Timothy	From 1 February 1999 to 31 October 2000
WILLIAMS, Maurice Roger	From 1 February 1999 to 31 October 2000
AITKEN, Maire-Louise	From 1 February 1999 to 31 October 2001
WACKETT, Malcolm Roderick Charles	From 1 February 1999 to 31 October 2001
BURDETT, Robert Daryl	From 1 February 1999 to 31 October 2001
GIBSON, Maxwell Robert John	From 1 February 1999 to 31 October 2001

3. **Declares**, under section 65(4) of the Act, that the new registered funded agency named Rural Northwest Health shall be a Schedule 1 public hospital under the Act.
4. **Amends** Schedule 1 of the Act such that the name of The Warracknabeal District Hospital be removed under section 8(1)(b) of the Act, and the name of Rural Northwest Health be added under section 8(1)(a) of the Act.

This Order-in-Council is to be made to take effect from 1 February 1999.

Dated: 19 January 1999.

Responsible Minister:  
 ROB KNOWLES,  
 Minister for Health

STACEY ROBERTSON  
 Acting Clerk of the Executive Council

**Gas Safety Act 1997**  
 ORDER UNDER SECTION 5  
 Order in Council

The Governor in Council acting under Section 5 of the **Gas Safety Act 1997** ("the Act") declares that the following owners or operators of a pipeline, a facility or service for the control of the conveyance of gas, or a service for the sale by retail of gas (other than liquified petroleum gas which is used or intended to be used for automotive purposes), are gas companies for the purposes of the Act.

AGL Victoria, A.C.N. 064 651 083, Level 2, 333 Collins Street, Melbourne, Vic. 3000.

Elgas, A.C.N. 002 749 260, 331 Police Road, Mulgrave, Vic. 3170.

Kleenheat Gas, A.C.N. 008 679 543, Corner Tilburn & Derrimut Road, Deer Park, Vic. 3023.

Coastal Gas Australia Pty Ltd, A.C.N. 073 608 269, Level 22, 505 Bourke Street, Melbourne, Vic. 3000.

Mount Buller Resort Management Board, c/o Post Office, Summit Road, Mount Buller, Vic. 3023.

Energy Developments, A.C.N. 053 410 263, 848 Boundary Road, Richlands, Qld 4077.

Linde Gas Pty Ltd, A.C.N. 001 255 312, 3 Milne Street, Thomastown, Vic. 3074.

Gogas, A.C.N. 005 012 715, 1 Spring Street, Melbourne, Vic. 3000.

Boral Energy, A.C.N. 078 868 425, 80 South Gippsland Highway, Dandenong, Vic. 3175.

Alpine Resorts Commission, Hotham, P.O. Box 188, Bright, Vic. 3741.

Eastern Energy, A.C.N. 064 651 118, Level 18, 452 Flinders Street, Melbourne, Vic. 3000.

Dated 19 January 1999.

Responsible Minister:  
ALAN R. STOCKDALE  
Treasurer

STACEY ROBERTSON  
Acting Clerk of the Executive Council

**Taxation (Interest on Overpayments) Act 1986**  
**PRESCRIBED RATE OF INTEREST UNDER**  
**SECTION 7(1)(B)**

**Order in Council**

The Governor in Council acting under Section 7(1)(b) of the **Taxation (Interest on Overpayments) Act 1986** ("the Act"), revokes the Order dated 25 February 1992 and fixes the prescribed rate of interest for the purposes of section 7(1)(b) of the Act at the rate published from time to time in the Commonwealth of Australia Gazette under section 214a of the **Income Tax Assessment Act 1936** of the Commonwealth.

This Order comes into operation on 1 February 1999.

Dated 19 January 1999.

Responsible Minister:  
ALAN R. STOCKDALE  
Treasurer

STACEY ROBERTSON  
Acting Clerk of the Executive Council

**Gas Safety Act 1997**  
**ORDER UNDER SECTION 6**  
**Order in Council**

The Governor in Council acting under Section 6 of the **Gas Safety Act 1997** declares

that part of a pipeline that has a maximum design pressure exceeding 1050 kPa which was owned by a gas distribution company on 11 December 1997 to be a transmission pipeline.

Dated 19 January 1999.

Responsible Minister:  
ALAN R. STOCKDALE  
Treasurer

STACEY ROBERTSON  
Acting Clerk of the Executive Council

**Land Tax Act 1958**  
**DECLARATION OF URBAN ZONES**  
**UNDER SECTION 9(1B)**

**Order in Council**

The Governor in Council, in exercise of the powers contained in section 9(1B) of the **Land Tax Act 1958**, declares the following types of zones under planning schemes to be urban zones for the purposes of that Act:

**BANYULE PLANNING SCHEME**

Civic Centre Precinct, District Centre Greensborough, District Centre Greensborough Office No. 1, Heidelberg Central Office, Heidelberg Future Development, Heidelberg Secondary Commercial, Heidelberg Special Commercial, Ivanhoe Special Commercial, Ivanhoe Special Office, Local Business, Office, Office A, Restricted Business, Service Business, General Industrial, Light Industrial (Eltham), Light Industrial (Heidelberg), Reserved Light Industrial (Diamond Valley), Reserved Light Industrial (Eltham), Restricted General Industrial, Restricted Light Industrial, Reserved Living, Residential C (Diamond Valley and Eltham), Residential C (Heidelberg), Residential D3, Heidelberg Mixed use No. 1, Special Use No. 1.

**BAYSIDE PLANNING SCHEME**

Local Business, Restricted Business, Service Business, Commercial and Industrial, Office, Office A, Brighton Peripheral Business, Brighton Restricted Business, Foreshore Commercial and Residential, Neighbourhood Business, Highway Commercial and Residential, General Industrial - Sandringham, General Industrial - Moorabbin, Light Industrial - Sandringham, Light Industrial - Brighton, Light Industrial - Moorabbin, Reserved Living, Residential C, Residential C - Brighton, Cheltenham Residential, Public Use.



**BERWICK PLANNING SCHEME**

Berwick Business - Endeavour Hills, Berwick Business - Peripheral, Berwick Office, Local Business, Neighbourhood Business Zone, Restricted Business, Service Business, Extractive Industrial, Restricted General Industrial, Restricted Light Industrial, Berwick Residential - Berwick Township, Berwick Residential - Low Density, Berwick Residential - Normal Density, Berwick Residential - Restricted Low Density Zone, Reserved Living, Township A, Special Use No. 1, Special Use No. 9A.

**BOROONDARA PLANNING SCHEME**

Commercial and Industrial Zone, District Centre Camberwell Zone, Local Business Zone, Office Zone, Office A Zone, Restricted Business Zone, Service Business Zone, Camberwell Service Business Zone, Camberwell Urban Conservation Business Zone, Extractive Industrial Zone, Light Industrial Zone, Reserved Light Industrial Zone, Restricted Light Industrial Zone, Heritage Residential Zone, Residential C Zone, Camberwell Residential Zone, Tooronga Mixed Use Residential Zone, Willsmere Special Residential No. 6 Zone, Urban Conservation - Residential Zone No. 1, Camberwell Urban Conservation Residential Zone, Special Use Zone 1, Special Use Zone 10, Willsmere Historic Building Zone, Comprehensive Development Zone No. 4, Comprehensive Development Zone No. 7, Comprehensive Development Zone (Tower Hotel).

**BRIMBANK PLANNING SCHEME**

Keilor Regional Activity Centre Zone, Neighbourhood Business, Office, Restricted Business, Service Business, Sunshine District Centre - Purpose, Sunshine District Centre, Sunshine District Centre No. 1, Sunshine District Centre No. 2, Sunshine District Centre No. 3, Calder Park Garden Industrial Zone, Dangerous Industrial, Extractive Industrial, General Industrial (Keilor), General Industrial (Sunshine), Keilor Park Garden Industrial, Light Industrial (Keilor), Light Industrial (Sunshine), Manufacturing 2 Zone, Manufacturing 3 Zone, Reserved General Industrial (Keilor), Reserved General Industrial (Sunshine), Reserved Light Industrial (Keilor), Reserved Light Industrial (Sunshine), Restricted General Industrial (Keilor), Restricted General Industrial

(Sunshine), Restricted Light Industrial (Keilor), Restricted Light Industrial (Sunshine), Transportation, Reserved Living (Keilor), Reserved Living (Sunshine), Residential C (Keilor), Residential C (Sunshine), Sunshine Urban Development Zone, Special Use Zone No. 1 (Keilor), Special Use Zone No. 1 (Sunshine), Special Use Zone No. 2, Special Use Zone No. 12, Special Use Zone No. 13.

**CRANBOURNE PLANNING SCHEME**

Commercial (Town Centre) A, Commercial (Town Centre) B, Commercial (Town Centre) C, Commercial (Town Centre) D, Commercial (Neighbourhood), Commercial (Local), Commercial (Rural Township), Strategic Industrial, Mixed Industrial, General Industrial, Reserved General Industrial, Public Use Zone, Residential (Urban), Residential (Urban Development) Zone, Residential (Township), Residential (Rural Landscape), Residential (Rural Landscape - Langwarrin), Rural Residential Zone, Village (Coastal), Village (Rural), Special Use A - Sports Grounds and Religious and Educational Institutions, Special Use B - Intensive Horse Stabling, Special Use C - Tourist Facilities, Camping Grounds/Caravan Parks, Special Use Zone D - Sporting, Leisure, Educational and Entertainment Facilities.

**DAREBIN PLANNING SCHEME**

Preston District Centre Zone, Preston District Centre Zone No. 1, Preston District Centre Zone No. 2, Local Business Zone, Neighbourhood Business Zone, Office Zone, Office A Zone, Restricted Business Zone, Northland Regional Retail Centre Zone, Service Business Zone, Extractive Industrial Zone, General Industrial (Preston) Zone, General Industrial (Northcote) Zone, Light Industrial (Preston) Zone, Light Industrial (Northcote) Zone, Reserved General Industrial Zone, Restricted Light Industrial (Preston) Zone, Restricted Light Industrial (Northcote) Zone, Reserved Light Industrial Zone, Reserved Living Zone, Residential C Zone, Strathallan Residential Zone, Darebin Mixed Use Zone No. 1, Special Use Zone No. 1, La Trobe University Technology Park Zone.

**DONCASTER AND TEMPLESTOWE PLANNING SCHEME**

Office, Office A, Restricted Business, Service Business, Neighbourhood Business,

Doncaster Regional Retail Centre, Restricted Light Industrial, Reserved Living, Residential C, Residential D, Residential D1, Environmental Residential Zone, Special Use No. 1, Special Use No. 10.

#### ELTHAM PLANNING SCHEME

Restricted Business, Eltham Town Centre - Core Retailing, Eltham Town Centre - Retail and Office, General Industrial, Light Industrial, Reserved Light Industrial, Eltham Gateway, Reserved Living, Residential C, Residential D1, Residential D2, Residential D3, Township A, Special Use No. 1, Special Use No. 12.

#### FRANKSTON PLANNING SCHEME

Frankston Business 1, Frankston Business 2, Frankston Business 3, Frankston District Centre 1, Frankston District Centre 2, Frankston District Centre 3, Frankston District Centre 4, Frankston District Centre 5 Zone, Frankston District Centre Legal Precinct Zone, Local Business, Service Business, Light Industrial, Reserved Light Industrial, Restricted Light Industrial, Public Use, Frankston Residential 1, Frankston Residential 2, Frankston Residential 3, Frankston Residential (Mount Eliza Centre), Reserved Living, Residential C, Mixed Use, Frankston Special Use, Special Use 1.

#### GLEN EIRA LOCAL SECTION

Local Business Zone, Neighbourhood Business Zone, Office Zone, Office A Zone, Restricted Business Zone, Service Business Zone, Light Industrial Zone, Restricted Light Industrial Zone, General Industrial Zone, Residential C Zone, Special Use Zone 1, Special Use Zone 2, Special Use Zone 10, Specified Areas Zone.

#### GREATER DANDENONG PLANNING SCHEMES

Dandenong Legal Precinct, District Centre Dandenong, Local Business, Office, Office A, Office and Service, Recreation and Service, Restricted Business, Service Business, Garden Industrial, General Industrial, General Industrial (Cranbourne), Light Industrial, Mixed Industrial, Offensive Industrial, Reserved General Industrial, Reserved General Industrial (Cranbourne), Reserved Light Industrial, Restricted General Industrial, Strategic Industrial, Public Use Zone, Reserved Living, Residential C, Special Use No. 1, Special Use No. 2, Special Use No. 10, Special Use No. 16, Special Use No. 16A, Cemetery.

#### HOBSONS BAY PLANNING SCHEME

Altona Fringe Commercial, Local Business, Local Business (Footscray), Neighbourhood Business, Restricted Business, Restricted Business (Altona), Restricted Business (Footscray), Service Business, Altona Garden Industrial, Altona Reserved Industrial, Altona Special Industrial, Extractive Industrial, Garden Industrial (Williamstown), General Industrial (Altona), General Industrial (Footscray), General Industrial (Sunshine), General Industrial (Williamstown), Light Industrial (Altona), Light Industrial (Sunshine), Light Industrial (Werribee), Light Industrial (Williamstown), Light Industrial (Footscray), Manufacturing 1, Manufacturing 3, Marine Engineering, Petroleum Refinery (Altona), Petroleum Refinery (Williamstown), Restricted General Industrial, Transportation, Williamstown Industrial, Reserved General Industrial, Reserved Light Industrial, Reserved Living, Reserved Living (Werribee), Residential C, Residential C (Altona), Residential C (Footscray), Residential C (Werribee), Werribee Urban Development, Special Use No. 1, Williamstown Comprehensive Development Zone.

#### HUME PLANNING SCHEME

Broadmeadows Freight Business, District Centre Broadmeadows, Local Business, Neighbourhood Business, Bulla Office Zone No. 1, Restricted Business, Service Business, Sunbury Town Centre Fringe, Airport Industrial, Extractive Industrial, Bulla Garden Industrial, General Industrial, Light Industrial, Reserved General Industrial (Bulla), Reserved General Industrial (Whittlesea), Reserved General Industrial (Broadmeadows), Reserved Light Industrial (Bulla), Reserved Light Industrial (Whittlesea), Reserved Light Industrial (Broadmeadows), Restricted Light Industrial (Bulla), Restricted Light Industrial (Broadmeadows), Special Industrial (Broadmeadows) Zone, Public Use, Hillcrest Park Residential, Merri Urban Development, Bulla Negotiated Development, Reserved Living, Reserved Living B, Residential C (Bulla), Residential C (Keilor), Residential D, Hume Rural Residential, Hume Rural Residential 1, Special Residential No. 1, Township A, Special Use No.1, Hume Low Density Residential Zone, Special Use No. 1A, Special Use No. 10, Special Use No. 12.

## KINGSTON PLANNING SCHEME

Cheltenham District Centre Zones,  
 Cheltenham District Centre Zone No. 1,  
 Cheltenham District Centre Zone No. 2,  
 Cheltenham District Centre Zone No. 3,  
 Cheltenham District Centre Zone No. 4,  
 Cheltenham District Centre Zone No. 5,  
 Cheltenham District Centre Zone No. 6,  
 Cheltenham District Centre Zone No. 7,  
 Cheltenham District Centre Zone No. 8,  
 Cheltenham District Centre Zone No. 9, Local  
 Business Zone, Mordialloc Special Peripheral  
 Business Zone, Neighbourhood Business Zone,  
 Restricted Business Zone, Service Business  
 Zone, Extractive Industrial Zone, Garden  
 Industrial Zone, General Industrial Zone, Light  
 Industrial Zone, Reserved General Industrial  
 Zone, Reserved Light Industrial, Restricted  
 Light Industrial, Cheltenham Residential Zone,  
 Reserved Living Zone, Residential C Zone,  
 Recreation and Service Zone, Special Use Zone  
 No. 1, Special Use Zone No. 2, Special Use  
 Zone No. 5, Special Use Zone No. 10, Special  
 Use Zone No. 12, Special Use Zone No. 16,  
 Comprehensive Development Zone No. 12.

## KNOX PLANNING SCHEME

Knox Commercial Drive-In, Knox  
 Commercial General, Knox Commercial  
 Industrial, Knox Commercial Local, Knox  
 Office, Knox Service, Knox Special Peripheral  
 Business, Knox Bayswater Central Retail Zone,  
 Knox Bayswater Service - Retail Zone, Knox  
 Bayswater Office/Consultation Zone, Restricted  
 Business, Knox Extractive Industry, Knox  
 Garden Industrial, Knox General Industrial,  
 Knox Industrial Buffer, Knox Light Industrial,  
 Knox Forest Residential, Knox Residential,  
 Knox Residential Development, Knox  
 Residential Medium, Knox Forest Residential  
 Foothills Zone, Knox Residential Medium  
 Foothills Zone, Knox Special Use, Knox Special  
 Use No. 3, Knox Special Investigation.

## LILLYDALE PLANNING SCHEME

Commercial General Zone, Commercial  
 Peripheral Zone, Industrial General Zone,  
 Industrial Extractive Resource Zone, Industrial  
 Garden Zone, Residential General Zone, Special  
 Use Zone.

## MARIBYNONG PLANNING SCHEME

Commercial and Industrial Zone (Footscray)  
 Zone, District Centre Footscray (Footscray)

Zone, Mixed Use (Footscray) Zone, Riverside  
 Mixed Use No. 1 (Footscray) Zone, Riverside  
 Mixed Use No. 1 (Sunshine) Zone, Local  
 Business (Footscray) Zone, Local Business  
 (Sunshine) Zone, Neighbourhood Business  
 (Footscray) Zone, Neighbourhood Business  
 (Sunshine) Zone, Office Zone, Restricted  
 Business (Footscray) Zone, Restricted Business  
 (Sunshine) Zone, Service Business (Footscray)  
 Zone, Service Business (Sunshine) Zone,  
 Highpoint City Regional Retail Centre Zone,  
 Commercial and Industrial (Braybrook) Zone,  
 Riverside Mixed Use No. 2 (Sunshine) Zone,  
 General Industrial (Footscray) Zone, General  
 Industrial (Sunshine) Zone, Light Industrial  
 (Footscray) Zone, Light Industrial (Sunshine)  
 Zone, Restricted Light Industrial (Footscray)  
 Zone, Restricted Light Industrial (Sunshine)  
 Zone, Reserved Light Industrial (Sunshine)  
 Zone, Transportation Zone, Manufacturing 3  
 Zone, Residential C (Footscray) Zone,  
 Residential C (Sunshine) Zone, Reserved Living  
 Zone, Riverside Residential No. 1 (Footscray)  
 Zone, Riverside Residential No. 1 (Sunshine)  
 Zone, Riverside Residential No. 2 (Sunshine)  
 Zone.

## MAROONDAH PLANNING SCHEME

Croydon Central Business Zone, Croydon  
 Neighbourhood Business Zone, Croydon  
 Peripheral Business Zone, Croydon Service  
 Business Zone, Restricted Business Zone,  
 Service Business Zone, Office Zone, Ringwood  
 District Centre Zone No. 1 Regional Retail  
 Focus, Ringwood District Centre Zone No. 2  
 The Entertainment, Ringwood District Centre  
 Zone No. 3 Commercial Boulevard, Ringwood  
 District Centre Zone No. 4 Retail Speciality  
 Core, Ringwood District Centre Zone No. 5  
 Station, Ringwood District Centre Zone No. 7  
 Peripheral Office, Ringwood District Centre No.  
 8 Restricted Light Industrial Zone, Commercial  
 General Zone, Commercial Peripheral Zone,  
 Croydon General Industrial Zone, Croydon  
 Light Industrial Zone, Croydon Commercial  
 Industrial Zone, General Industrial Zone, Light  
 Industrial Zone, Restricted Light Industrial  
 Zone, Industrial General (Lillydale) Zone,  
 Croydon Neighbourhood Residential Zone,  
 Croydon Environmental Living - Part A Zone,  
 Croydon Environmental Living - Part B Zone,  
 Reserved Living Zone, Residential C Zone,  
 Residential D (Ringwood) Zone, Residential D

(Doncaster & Templestowe) Zone, Residential General Zone, Croydon Special Use Zone No. 1, Croydon Special Use Zone No. 2, Croydon Special Use Zone No. 3, Croydon Special Use Zone 5A, Croydon Special Use Zone 5B, Special Use Zone No. 1, Golf Course Zone.

#### MELBOURNE PLANNING SCHEME

Central Area Development DA3, Local Business B3, Melbourne Commercial and Industrial 1B5, Melbourne Local Business 1B1, Melbourne Office 1B7, Restricted Business B2, Arts Centre Locality 8B3, Central Melbourne - Southbank B12, Melbourne Development Zone No. 1, South Melbourne Development Zone No. 2 8D2, South Melbourne Mixed Use Zone No. 2 MU2, Southbank Residential and Service 8B2, General Industrial IN4, Light Industrial IN1, Restricted General Industrial IN5, Restricted Light Industrial IN2, Transportation IN13, South Port High Technology Zone SP, Central Melbourne - Residential and Service R9, Melbourne Residential 1R1, Melbourne Residential 1R2, Melbourne Residential 1R3, Melbourne Residential and Service 1R5, Residential and Office R10, Residential C R1, Lynch's Bridge Development 1LBR, Arts/Barracks Residential Zone 8R2, Special Use No 1 SU1, Special Use No. 2 SU2, Special Use No. 2A SU2A, Special Use No. 3 SU3, Special Use No. 8 SU8, Special Use No. 10 SU10, Special Use No. 10A SU10A, Special Use No. 12 SU12, Specified Areas SP, Melbourne Casino IMC, North Bank Development Zone, Comprehensive Development No. 6 D6, Comprehensive Development No. 10 D10, Comprehensive Development No. 13 D13, Docklands Business Park Zone, Docklands Victoria Harbour Mixed Use Zone, Docklands Yarra Residential Zone, Docklands West End Mixed Use Zone, Docklands Waterways Zone.

#### MELTON PLANNING SCHEME

Local Business, Neighbourhood Business, Restricted Business, Service Business, Melton Business Centre, Light Industrial, Melton Service Industrial, Reserved General Industrial, Reserved Light Industrial, Reserved Living, Residential C, Residential D, Rockbank Residential, Township A, Melton Urban Development, Special Use No. 1, Special Use No. 9B, Special Use Prison, Special Use Zone No. 2.

#### MONASH PLANNING SCHEME

District Centre Oakleigh Zone, Glen Waverley District Centre Regional Retail, Glen Waverley District Centre Central Business and Entertainment, Glen Waverley District Centre Office and Community, Glen Waverley District Centre Civic Administration and Cultural, Glen Waverley District Centre Village Business, Glen Waverley District Centre Hub, Local Business, Neighbourhood Business, Office, Office A, Office B, Restricted Business, Service Business, Waverley Office, Waverley High Technology Office, Business 3 Zone, Extractive Industrial, General Industrial, Industrial Park, Light Industrial, Monash Precinct, Reserved Light Industrial, Restricted Light Industrial, Special Industrial (Oakleigh), Waverley Technology, Reserved Living, Residential C, Waverley Special Residential, Special Use No. 1, Comprehensive Development Zone No. 1, AFL Waverley Park.

#### MOONEE VALLEY - LOCAL SECTION

Commercial and Industrial Zone, Melbourne Commercial and Industrial Zone, District Centre Moonee Ponds Zone No. 1, District Centre Moonee Ponds Zone No. 2, District Centre Moonee Ponds Zone No. 3, District Centre Moonee Ponds Zone No. 4, District Centre Moonee Ponds Zone No. 5, District Centre Moonee Ponds Zone No. 6, District Centre Moonee Ponds Zone No. 7, Local Business (Essendon) Zone, Local Business (Melbourne) Zone, Neighbourhood Business Zone, Office Zone, Office A Zone, Restricted Business Zone, Service Business Zone, General Industrial Zone, General Industrial (Melbourne) Zone, Light Industrial (Essendon) Zone, Light Industrial (Melbourne) Zone, Light Industrial (Keilor) Zone, Restricted General Industrial Zone, Restricted Light Industrial (Essendon) Zone, Restricted Light Industrial (Keilor) Zone, Reserved Living (Essendon) Zone, Reserved Living (Keilor) Zone, Residential C (Essendon) Zone, Residential C (Keilor) Zone, Multi-Unit Residential Zone, Melbourne Residential Zone, Moonee Valley Residential 1 Zone, Special Use Zone No. 1, Special Use Zone No. 2, Special Use Zone No. 3.

#### MORELAND PLANNING SCHEME

Commercial and Industrial Zone, Local Business Zone, Restricted Business Zone,

Service Business Zone, Neighbourhood Business Zone, Office A Zone, Extractive Industrial Zone, General Industrial Zone, General Industrial (Broadmeadows) Zone, Light Industrial Zone, Light Industrial (Broadmeadows) Zone, Reserved General Industrial Zone, Reserved Light Industrial Zone, Reserved Light Industrial (Broadmeadows) Zone, Restricted General Industrial Zone, Restricted Light Industrial (Brunswick) Zone, Restricted Light Industrial (Coburg) Zone, Reserved Living Zone, Residential C Zone, Special Residential Zone 1, Special Residential Zone 2, Special Use Zone 1, Special Use (Brunswick) Zone 1, Special Use Zone 10.

#### NILLUMBIK PLANNING SCHEME

Diamond Valley Neighbourhood Business No. 1 Zone, Diamond Valley Special Business No. 1 Zone, Eltham Town Centre - Core Retailing Zone, Eltham Town Centre - Retail and Office Zone, Office A, Restricted Business Zone, Service Business Zone, Light Industrial Zone, Reserved Light Industrial Zone, Diamond Valley Rural Residential Zone, Diamond Valley Rural Residential R8 Zone, Eltham Gateway Zone, Plenty Low Density Residential Zone, Plenty Residential Zone, Reserved Living Zone, Residential C Zone, Residential D Zone, Residential D1 Zone, Residential D2 Zone, Residential D3 Zone, Township A Zone, Special Use Zone No. 1, Special Use Zone No. 12, Restricted Use (Healesville) Zone.

#### PAKENHAM PLANNING SCHEME

Residential 1 Zone, Residential 2 Zone, Residential 3 Zone, Residential 4 Zone, Country Residential Zone, Country Residential 2 Zone, Industrial 1 Zone, Tourist Resort Zone.

#### PORT OF MELBOURNE PLANNING SCHEME

Light Industrial, Transportation, Marine Engineering, Special Use No 5, Comprehensive Development Zone.

#### PORT PHILLIP PLANNING SCHEME

Residential 1 Zone, Residential 2 Zone, Mixed Use Zone, Industrial 1 Zone, Industrial 3 Zone, Business 1 Zone, Business 2 Zone, Business 3 Zone, Business 5 Zone, Special Use Zone, Comprehensive Development Zone.

#### SPRINGVALE PLANNING SCHEME

Office, Office A, Restricted Business, Service Business, Comprehensive Development Zone No. 12, Garden Industrial, General Industrial,

Light Industrial, Reserved General Industrial, Reserved Light Industrial, Reserved Living, Residential C, Special Use No. 1, Special Use No. 2, Special Use No. 5, Special Use No. 10, Special Use No. 14, Special Use No. 14A, Recreation and Service, Cemetery.

#### STONNINGTON PLANNING SCHEME

Office, Office A, Commercial and Industrial, Chadstone Regional Retail Centre Zone, Prahran District Centre Zone No. 1 - Core Shopping, Prahran District Centre Zone No. 2 - Core Peripheral Shopping, Prahran District Centre Zone No. 4 - Commercial Mixed Use, Prahran District Centre Zone No. 5 - Peripheral Sales, Prahran District Centre Zone No. 6 - Residential Uses, Prahran District Centre Zone No. 7 - Mixed Uses, Prahran District Centre Zone No. 8 - Industrial Uses, Restricted Business, Service Business, South Yarra Mixed Use Zone, South Yarra Business Zone, General Industrial, Light Industrial, Restricted Light Industrial, Reserved Light Industrial, Residential C, Prahran Residential Zone, Special Use No. 1, Special Use No. 10, Comprehensive Development No. 2A, Comprehensive Development No. 2B, Comprehensive Development No. 3.

#### WERRIBEE PLANNING SCHEME

Local Business, Neighbourhood Business, Restricted Business, Werribee District Centre 1 Zone, Werribee District Centre 2 Zone, Werribee District Centre 3 Zone, Service Business, Werribee Business - Peripheral, Werribee Hogan's Corner Business, Werribee Office, Office A Zone, Business 1 Zone, Manufacturing 2 Zone, Manufacturing 3 Zone, General Industrial, Light Industrial, Reserved General Industrial, Reserved Light Industrial, Reserved Living, Residential C, Residential D, Township A, Werribee Urban Development Zone, Point Cook Urban Development Zone, Special Use No. 1, Special Use No. 2, Special Use Prison Zone, Special Use No. 12, Comprehensive Development Zone, Special Use (Freeway Service Centre) Zone.

#### WHITEHORSE PLANNING SCHEME,

Local Business, Office, Office A, Whitehorse Office (Blackburn), Whitehorse Office B (Box Hill), Restricted Business, Whitehorse Regional Retail Centre (Forest Hill), Service Business, Whitehorse Mixed Use (Tally Ho), District Centre Box Hill, District

Centre Box Hill Zone No. 1 Office Boulevard, Office Enterprise Zone, Transport Centre Zone, Extractive Industrial, General Industrial, Light Industrial, Reserved Light Industrial, Restricted Light Industrial, Whitehorse Business Park No. 1 (Tally Ho), Whitehorse Business Park No. 2 (Tally Ho), Whitehorse Technology Campus, Reserved Living, Residential C, Residential D, Special Residential (Nunawading) No. 5, Whitehorse Retirement Village (Box Hill), Special Use No. 1.

#### WHITTLESEA PLANNING SCHEME

Bundoora Office and Peripheral Sales, Neighbourhood Business, Office Zone, Restricted Business, South Morang Activity Centre Zone, Extractive Industrial, General Industrial, Light Industrial, Plenty Valley Employment No. 1, Plenty Valley Employment No. 2, Reserved General Industrial, Reserved Light Industrial, Restricted General Industrial, Restricted Light Industrial, Reserved Living, Reserved Living B, Residential C, Township A, Urban Development, Whittlesea Rural Residential Zone, Special Use No. 1, Special Use No. 2, Special Use No. 3, Janefield Special Use Zone, Special Use No. 10, Special Use No. 12, Latrobe Research and Development.

#### YARRA PLANNING SCHEME

Commercial and Industrial, Local Business, Local Business (Melbourne), Neighbourhood Business, Office, Office A, Restricted Business, Service Business, General Industrial, Light Industrial, Light Industrial (Melbourne), Reserved General Industrial, Reserved Light Industrial, Restricted Light Industrial, Central Melbourne - Residential & Service, Fitzroy Mixed Use Residential, Melbourne Residential 1, Melbourne Residential 2, Residential C, Residential C (Northcote), Richmond River (Residential Zone), Special Use Zone No. 1, Special Use Zone No. 10, Specified Areas, Richmond Mixed Use Zone No. 1, Richmond Mixed Use Zone No. 2, Richmond Mixed Use Zone No. 4, Yarra Mixed Use Zone, Comprehensive Development Zone No. 1, Comprehensive Development Zone No. 8, Richmond Comprehensive Development Zone No. 1.

#### YARRA RANGES PLANNING SCHEME

- Healesville

Residential, Commercial, Service Business, Industrial.

#### YARRA RANGES PLANNING SCHEME

- Sherbrooke

General Residential Zone, Main Activity Centre Zone, Local Activity Centre Zone.

#### YARRA RANGES PLANNING SCHEME

- Upper Yarra

Urban Zone, Urban Conservation Zone, Commercial Zone.

Dated: 19 January 1999

Responsible Minister

Alan R Stockdale

Treasurer

STACEY ROBERTSON

Acting Clerk of the Executive Council

#### Local Government Act 1989

#### MINOR ALTERATION TO THE MUNICIPAL BOUNDARIES OF WHITTLESEA CITY COUNCIL AND NILLUMBIK SHIRE COUNCIL

#### Order in Council

WHEREAS the Minister for Planning and Local Government has certified to the Governor in Council that:

- (a) the proposed change is of a minor nature;
- (b) the Whittlesea City Council and Nillumbik Shire Council are the only Councils whose municipal boundaries will be affected by the proposed change and they have approved of the change; and
- (c) notice of proposed change was published in the Diamond Valley News on 18 November 1998 and the Whittlesea Post on 18 November 1998.

NOW THEREFORE, the Governor in Council acting under Sections 220Q(a), 220S and 220T of the **Local Government Act 1989** orders that:

- (i) this Order comes into operation on the day it is published in the Government Gazette;
- (ii) on the day this Order comes into operation, the boundary of the municipal district of Whittlesea City Council be altered and fixed as described in Schedule 1; and
- (iii) on the day this Order comes into operation, the boundary of the municipal district of

Nillumbik Shire Council be altered and fixed as described in Schedule 2.

Dated 19 January 1999.

Responsible Minister:

ROBERT MACLELLAN

Minister for Planning and Local Government

STACEY ROBERTSON

Acting Clerk of the Executive Council

### **Schedule 1**

#### **WHITTLESEA CITY COUNCIL**

(Altered and Redefined)

Commencing on the Whittlesea-Yea Road at the Whittlesea-Kinglake Road being a point on the Great Dividing Range; thence generally north-westerly by that road to Bruces Creek Road; thence north-westerly by that road to Lords Road; thence south-westerly by that road to Conical Hill Road; thence south-westerly and southerly by that road to the road forming the northern boundary of allotment 7, section D, Parish of Wallan Wallan; thence westerly by that road to the road forming the western boundary of allotment 2; thence southerly and south-easterly by that road to the northern boundary of the Parish of Merriang; thence westerly by that boundary to the western boundary of section 28, Parish of Merriang; thence southerly by that boundary and the western boundaries of sections 21, 16 and 9 and easterly by the southern boundary of the latter section to the Merri Creek; thence generally south-westerly by that creek to the southern boundary of the parish; thence westerly by that boundary to the Merri Creek west of the North-Eastern Railway; thence southerly by that creek to the northern carriageway of Mahoneys Road; thence easterly by that road, Keon Parade and the northern boundary of Portion 14, Parish of Keelbundora to the eastern boundary of Lot 202 on Plan of Subdivision 110906; thence southerly by that boundary and a line in continuation to the Darebin Creek; thence easterly by that creek to the southern boundary of the eastern portion of Section A; thence easterly by that boundary to Plenty Road; thence north-easterly by that road to the northern boundary of portion 19, Parish of Keelbundora; thence easterly by that boundary and the northern boundary of portion 18 to the Plenty River; thence generally northerly by that river to the southern boundary of Lot 2 on Plan of Subdivision 95078; thence easterly and

northerly by the southern and eastern boundaries of that lot to the northern boundary of portion 13, Parish of Morang; thence easterly by that boundary to Yan Yean Road; thence northerly by that road to Ridge Road; thence north-easterly by that road to the road forming the northern boundary of allotment 3A, Parish of Linton; thence easterly by that road to the western boundary of the Kinglake National Park; thence generally north-easterly by the national park boundary to the south-western angle of allotment 13C, Parish of Kinglake; thence northerly by the western boundary of that allotment to the Whittlesea-Kinglake Road, and thence westerly by that road to the point of commencement.

### **Schedule 2**

#### **NILLUMBIK SHIRE COUNCIL**

(Altered and Redefined)

Commencing on the Yarra River at the Fitzsimons Lane; thence northerly by Fitzsimons Lane to Main Road; thence westerly by that road to Bolton Street; thence northerly by that street and north-westerly by Sherbourne Road to Karingal Drive; thence north-westerly by that drive to Weidlich Road; thence northerly by that road to Progress Road; thence north-easterly and easterly by that road to Ryans Road; thence northerly by that road to the proposed Metropolitan Ring Road reservation; thence south-westerly by that road reservation to the Greensborough Highway; thence westerly by that highway to the Metropolitan Ring Road; thence north-westerly by that road to Plenty Road; thence northerly by that road to the northern boundary of portion 19, Parish of Keelbundora; thence easterly by that boundary and the northern boundary of portion 18 to the Plenty River; thence generally northerly by that river to the southern boundary of Lot 2 on Plan of Subdivision 95078; thence easterly and northerly by the southern and eastern boundaries of that lot to the northern boundary of portion 13, Parish of Morang; thence easterly by that boundary to Yan Yean Road; thence northerly by that road to Ridge Road; thence north-easterly by that road to the road forming the northern boundary of allotment 3A, Parish of Linton; thence easterly by that road to the western boundary of the Kinglake National Park; thence generally north-easterly by the national park boundary to the south-western angle of

allotment 13C, Parish of Kinglake, being a point on the northern boundary of that portion of the national park south of the Whittlesea-Kinglake Road; thence generally easterly by the northern boundary of that park to the south-western angle of allotment 33; thence easterly by the southern boundary of that allotment to the western boundary of allotment 33D; thence southerly by that boundary and easterly by the southern boundary of that allotment to the southern boundary of allotment 33A; thence easterly by that boundary and the southern boundaries of lot 2 and lot 1 on Plan of Subdivision 71460 to the western boundary of allotment 68A; thence southerly by that boundary and easterly by the southern boundary of that allotment to the western boundary of allotment 39; thence southerly by that boundary to the southern boundary of that allotment, being a point on the boundary of the Kinglake National Park; thence generally easterly by that boundary to the north-eastern angle of allotment 40A; thence easterly by a direct line to the south-western angle of allotment 4B, section B; thence generally easterly by the boundary of the Kinglake National Park to the south-eastern angle of allotment 4; thence southerly by a direct line to the north-eastern angle of the Parish of Queenstown; thence southerly by the eastern boundary of that parish to Skyline Road North; thence further southerly by that road to the Eltham-Yarra Glen Road; thence south-westerly by that road to Skyline Road; thence south-westerly by that road to Muir Road, being a point on the eastern boundary of the Melbourne Water Sugarloaf Reservoir area; thence generally southerly by that boundary to the north-eastern boundary of allotment 50, Parish of Sutton; thence south-easterly by that boundary and a line in continuation to the Yarra River, and thence generally south-westerly by that river to the point of commencement.

**Interpretation of Legislation Act 1984  
and Local Government Act 1989**

**AMENDMENT OF ORDER APPOINTING A  
BOARD OF INQUIRY**

**Order in Council**

**WHEREAS** by Order in Council made on 17 November 1998 and published in the Government Gazette on 19 November 1998, Mr Wayne Walker was appointed as a board of

inquiry to inquire into and determine a dispute referred to the Governor in Council under section 9(1) of the **Local Government Act 1989** between Kingston City Council and each of Glen Eira City Council, Bayside City Council, Greater Dandenong City Council and Monash City Council relating to the apportionment of the unfunded superannuation liabilities of the former municipalities of Moorabbin, Mordialloc, Springvale and Oakleigh (which municipalities ceased to exist on the constitution or reconstitution of Glen Eira, Kingston, Bayside, Greater Dandenong and Monash City Councils);

**AND WHEREAS** the Minister for Planning and Local Government has recommended that the Governor in Council exercise the powers under section 27 of the **Interpretation of Legislation Act 1984** and section 9 of the **Local Government Act 1989** to amend this Order in Council;

**NOW THEREFORE** the Governor in Council acting pursuant to the power conferred by section 27 of the **Interpretation of Legislation Act 1984** and section 9 of the **Local Government Act 1989** by this Order in Council **HEREBY**:

**AMENDS** the Order in Council made on 17 November 1998 and published in the Government Gazette on 19 November 1998, appointing Mr Wayne Walker as a board of inquiry, so as to:

- add the words “and redundancy costs” after the words “unfunded superannuation liabilities” wheresoever they appear; and
- in paragraph d) which reads “the amount that Bayside City Council is liable to pay to Kingston City Council in respect of the unfunded superannuation liabilities of the former Cities of Moorabbin and Mordialloc under the Amalgamation Agreement between Kingston City Council and Glen Eira City Council”, delete the words “Glen Eira City Council” and replace with “Bayside City Council”.

This Order is to come into effect on the day it is made.

Dated 19 January 1999.

Responsible Minister:  
ROBERT MACLELLAN  
Minister for Planning  
and Local Government

STACEY ROBERTSON  
Acting Clerk of the Executive Council



**Livestock Disease Control Act 1994****ORDER DECLARING DISEASES AND EXOTIC DISEASES**

The Governor in Council, acting under Section 6 of the **Livestock Disease Control Act 1994**:-

- (a) revokes the Orders made by the Governor in Council listed in Schedule 1; and
- (b) declares the contagious or infectious diseases and conditions listed in Schedule 2 to be diseases for the purposes of the Act; and
- (c) declares the contagious or infectious diseases and conditions listed in Schedule 3 to be exotic diseases for the purposes of the Act.

**SCHEDULE 1****Revocations**

<b>Order</b>	<b>Date Order made by Governor in Council</b>	<b>Publication of Order in Government Gazette</b>
Order declaring diseases and exotic diseases	19 December 1995	Published in Government Gazette No. 50 on 21 December 1995, pages 3644 and 3645
Order declaring bat lyssavirus to be an exotic disease	17 December 1996	Published in Government Gazette No. 50 on 19 December 1996, page 3313
Declaration of pig reproductive disease as an exotic disease	2 September 1997	Published in Government Gazette No. 35 on 4 September 1997, page 2490
Order declaring contamination of bees by fireblight to be an exotic disease	14 October 1997	Published in Government Gazette No. 41 on 16 October 1997, page 2879

**SCHEDULE 2****\*Diseases****\*Section 3 definition of "disease"****Part A****Diseases of Mammals and Birds**

Anaplasmosis	Johne's disease
Anthrax	
	Leptospirosis
Babesiosis	Listeriosis
Bovine brucellosis	
Bovine genital campylobacteriosis	Malignant tumour
Bovine malignant catarrh	Mucosal disease
Buffalo fly	
	Ovine brucellosis
Caprine arthritis encephalitis	Ovine footrot
Caprine footrot	Ovine ked
Cattle tick	Ovine lice
Cervine footrot	
Cysticercosis ( <i>C. bovis</i> )	Rabbit calicivirus disease
Enzootic bovine leucosis	Psittacosis
Equine infectious anaemia	Pullorum disease
Equine piroplasmiasis	
Equine viral abortion	Salmonellosis

Equine viral arteritis  
 Infectious bovine rhinotracheitis  
 Infectious laryngotracheitis

Swine brucellosis  
 Trichomoniasis  
 Tuberculosis  
 Verocytotoxigenic *E.coli*

#### Part B

##### Diseases of Bees

American foul brood disease  
 Bee louse (*Braula coeca*)  
 Chalk brood disease

European foul brood disease  
 Nosema (*Nosema apis*)

#### Part C

##### Diseases of Fish

##### Fin Fish

Epizootic haematopoietic necrosis  
 Goldfish ulcer disease (*Aeromonas salmonicida* atypical strains)  
 Viral haemorrhagic septicaemia

##### Molluscs

Bonamiasis (*Bonamia* sp.)

### SCHEDULE 3

#### \*Exotic Diseases

#### \*Section 3 definition of “exotic disease”

#### Part A

##### Exotic Diseases of Mammals and Birds

African horse sickness  
 African swine fever  
 Aujeszky's disease  
 Avian influenza  
 Bat lyssavirus  
 Bluetongue  
 Borna disease  
 Bovine spongiform encephalopathy  
*Brucella melitensis*  
  
 Chagas disease  
 Classical swine fever  
 Contagious equine metritis  
 Contagious bovine pleuropneumonia  
 Contagious caprine pleuropneumonia  
 Cysticercosis (*C. cellulosae*)  
 Duck virus enteritis  
 Duck virus hepatitis  
  
 East coast fever  
 Elaphostrongylosis  
 Epizootic lymphangitis  
 Equine encephalomyelitis  
 Equine influenza  
 Equine morbillivirus  
  
*Fasciola gigantica*

Japanese encephalitis  
 Jembrana disease  
  
 Louping ill  
 Lumpy skin disease  
  
 Maedi-visna  
  
 Nairobi sheep disease  
 Newcastle disease  
  
 Peste des petits ruminants  
 Porcine reproductive and respiratory  
 Syndrome  
 Pig reproductive disease  
 Pulmonary adenomatosis  
 Rabies  
 Rift valley fever  
 Rinderpest  
  
 Scrapie  
 Screw worm fly  
 Sheep and goat pox  
 Sheep scab  
 Spongiform encephalopathies  
 Surra  
 Swine influenza

Foot-and-mouth disease  
Fowl typhoid (*S. gallinarum*)

Glanders  
Haemorrhagic septicaemia

Swine vesicular disease

Transmissible gastroenteritis  
Trichinosis  
Vesicular exanthema  
Vesicular stomatitis  
Warble fly infestation  
Wesselsbron disease

#### Part B

##### Exotic Diseases of Bees

Africanised bees  
Tracheal mite (*Acarapis woodi*)

Tropilaelaps mite (*Tropilaelaps clareae*)  
Varroa mite (*Varroa jacobsoni*)

#### Part C

##### Exotic Diseases of Fish

##### Fin Fish

Bacterial kidney disease (*Renibacterium salmoninarum*)  
Channel catfish virus disease  
Enteric redmouth disease/yersiniosis (*Yersinia ruckeri*)  
Enteric septicaemia of catfish (*Edwardsiella ictaluri*)  
Epizootic ulcerative syndrome (*Aphanomyces invaderis*)  
Furunculosis (*Aeromonas salmonicida* subsp. *salmonicida*)  
Gyrodactylosis (*Gyrodactylus salaris*)  
Infectious haematopoietic necrosis  
Infectious pancreatic necrosis  
Infectious salmon anaemia  
*Oncorhynchus masou* virus disease  
Piscirickettsiosis (*Piscirickettsia salmonis*)  
Spring viraemia of carp  
Viral haemorrhagic septicaemia  
Whirling disease (*Myxobolus cerebralis*)

##### Molluscs

Bonamiosis (*Bonamia ostreae*)  
Haplosporidiosis (*Haplosporidium costale*, *Haplosporidium nelsoni*)  
Marteiliosis (*Marteilia refringens*, *Marteilia sydneyi*)  
Mikrocytosis (*Mikrocytos mackini*, *Mikrocytos roughleyi*)  
Perkinsosis (*Perkinsus marinus*, *Perkinsus olseni*)  
Iridioviroses

##### Crustacea

Baculoviral midgut gland necrosis  
Crayfish plague (*Aphanomyces astaci*)  
Infectious hypodermal and haematopoietic necrosis  
Necrotising hepatopancreatitis  
Nuclear polyhedrosis baculoviroses (*Baculovirus penaei*, *Penaeus monodon*-type baculovirus)  
Taura syndrome  
Whitespot disease  
Yellowhead disease virus

This Order comes into operation on the day it is published in the Government Gazette.

Dated 19 January 1999.

Responsible Minister:  
BILL McGRATH  
Minister for Agriculture and Resources

STACEY ROBERTSON  
Acting Clerk of the Executive Council

**Pipelines Act 1967**

## CANCELLATION OF PERMITS

## Order in Council

The Governor in Council cancels the following permits under section 19(c) of the **Pipelines Act 1967** —

- (a) a Permit to Own and Use a Pipeline 15; and
- (b) a Permit to Own and Use a Pipeline 24; and
- (c) a Permit to Own and Use a Pipeline 45; and
- (d) a Permit to Own and Use a Pipeline 79; and
- (e) a Permit to Own and Use a Pipeline 83.

Dated 19 January 1999.

Responsible Minister:  
BILL McGRATH  
Acting Minister for Agriculture  
and Resources

STACEY ROBERTSON  
Acting Clerk of the Executive Council

**Pipelines Act 1967**

## CANCELLATION OF LICENCES

## Order in Council

The Governor in Council cancels the following licences under section 29A(c) of the **Pipelines Act 1967** —

- (a) a Licence to Construct and Operate a Pipeline 15; and
- (b) a Licence to Construct and Operate a Pipeline 24; and
- (c) a Licence to Construct and Operate a Pipeline 45; and
- (d) a Licence to Construct and Operate a Pipeline 79; and
- (e) a Licence to Construct and Operate a Pipeline 83.

Dated 19 January 1999.

Responsible Minister:  
BILL McGRATH  
Acting Minister for Agriculture  
and Resources

STACEY ROBERTSON  
Acting Clerk of the Executive Council

**Land Act 1958**APPROVAL BY THE GOVERNOR IN  
COUNCIL TO THE SALE OF CROWN  
LAND BY PRIVATE TREATY

## Order in Council

The Governor in Council, pursuant to Section 99A(1)(a) & 99A(2) of the **Land Act 1958**, approves the sale by private treaty of Crown Allotments 16 & 16B, Section 11, Parish of Cardigan and located at Gillies Street, Ballarat.

Dated 19 January 1999.

Responsible Minister:  
ROGER M HALLAM MLC  
Minister for Finance  
Minister for Gaming

STACEY ROBERTSON  
Acting Clerk of the Executive Council

**Crown Land (Reserves) Act 1978**

## NOTICE OF INTENTION

The Governor in Council under Section 10 of the **Crown Land (Reserves) Act 1978**, gives notice of intention to revoke the following temporary reservations to the extent indicated hereunder:

KEELBUNDORA — The temporary reservation by Order in Council of 16 January, 1996 of a total area of 7.142 hectares of land being Crown Allotments 10P1, 10T3, 15H, 15J and 15K, Parish of Keelbundora as a site for Public Recreation, so far only as the portion containing 2963 square metres shown as Crown Allotment 15F2, Parish of Keelbundora on Certified Plan No. 118783 lodged in the Central Plan Office. — (Rs 9113).

KEELBUNDORA — The temporary reservation by Order in Council of 1 April 1980 of an area of 35.75 hectares of land being Crown Allotment 10N, Parish of Keelbundora as a site for Public Recreation, revoked as to part by Order in Council of 5 September, 1995 so far only as the portion containing 2427 square metres shown as Crown Allotment 15F1, Parish of Keelbundora on Certified Plan No. 118783 lodged in the Central Plan Office. — (Rs 9113).

MARYVALE — The whole of the temporary reservation by Order in Council of 25 May, 1976 of an area of 2024 square metres of land being Crown Allotment 69R, Parish of Maryvale as a

site for Public Purposes (Public Offices). — (Rs 10149).

NEERIM — The whole of the temporary reservation by Order in Council of 30 October, 1923 of an area of 683 square metres of land in the Township of Neerim, (formerly Village of Neerim), Parish of Neerim as a site for a State School. — (Rs 2845).

NEERIM — The whole of the temporary reservation by Order in Council of 18 February, 1969 of an area of 127 square metres, more or less, of land in the Township of Neerim, Parish of Neerim as a site for State School purposes. — (Rs 2845).

OAKLEIGH — The temporary reservation by Order in Council of 21 October, 1940 of an area of 17.81 hectares, more or less, of land in the Township of Oakleigh, Parish of Mulgrave as a site for Public Park and Recreation, revoked as to part by various Orders, so far only as the portion containing 313 square metres shown as Crown Allotment 45L, Township of Oakleigh, Parish of Mulgrave on Certified Plan No. 119165 lodged in the Central Plan Office. — (Rs 1121).

This Order is effective from the date on which it is published in the Victoria Government Gazette.

Dated 19 January 1999.

Responsible Minister:  
MARIE TEHAN  
Minister for Conservation  
and Land Management

STACEY ROBERTSON  
Acting Clerk of the Executive Council

### **Crown Land (Reserves) Act 1978**

#### **NOTICE OF INTENTION**

The Governor in Council under Section 10 of the **Crown Land (Reserves) Act 1978** gives notice of intention to revoke the following temporary reservations to the extent indicated hereunder:

DOOLAM — The temporary reservation by Order in Council of 29 July, 1969 of an area of 3238 square metres of land in the Parish of Doolam as a site for Public Purposes (Trigonometrical Survey Station), so far only as the portion containing 29.7 square metres as indicated by hatching on plan hereunder. — (D154[4]) — (Rs 9184).

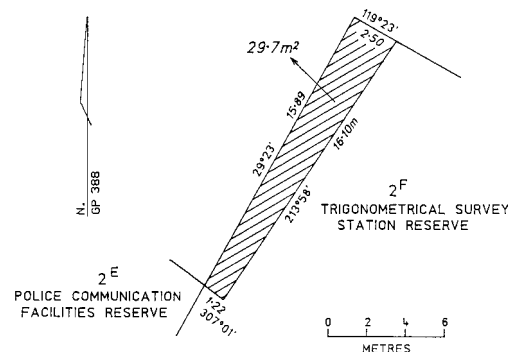

This Order is effective from the date on which it is published in the Victoria Government Gazette.

Dated 19 January 1999.

Responsible Minister:  
MARIE TEHAN  
Minister for Conservation  
and Land Management

STACEY ROBERTSON  
Acting Clerk of the Executive Council

### **Crown Land (Reserves) Act 1978**

#### **REVOCATION OF TEMPORARY RESERVATIONS**

The Governor in Council under Section 10 of the **Crown Land (Reserves) Act 1978** revokes the following temporary reservations to the extent indicated hereunder:

ARARAT — The temporary reservation by Order in Council of 26 March, 1901 of an area of 1.882 hectares of land in Section E, Township of Ararat, (formerly town of Ararat), Parish of Ararat as a site for Public and Municipal purposes, revoked as to part by Orders in Council of 7 July, 1926 and 9 November, 1948 so far only as the portion containing 2081 square metres as indicated by hatching on plan published in the Victoria Government Gazette on 17 December, 1998 page 3091. — (Rs 418).

PENHURST — The whole of the temporary reservation by Order in Council of 31 March, 1885 of an area of 2.023 hectares of land in Section 34, Township of Penhurst, Parish of Yalimba, (formerly being Section 34, town of Penhurst) as a site for a Sanatorium. — (03/2272).

QUEENSCLIFF — The whole of the temporary reservation by Order in Council of 6 April, 1954 of an area of 1.573 hectares of land in Section

22, Township of Queenscliff, Parish of Paywit as a site for State School purposes. — (Rs 7237).

QUEENSCLIFF — The whole of the temporary reservation by Order in Council of 19 December, 1967 of an area of 1922 square metres, more or less, of land in Section 23, Township of Queenscliff, Parish of Paywit as a site for State School purposes. — (Rs 7237).

This Order is effective from the date on which it is published in the Victoria Government Gazette.

Dated 19 January 1999.

Responsible Minister:  
MARIE TEHAN  
Minister for Conservation  
and Land Management

STACEY ROBERTSON  
Acting Clerk of the Executive Council

**Crown Land (Reserves) Act 1978**  
**REVOCATION OF TEMPORARY**  
**RESERVATIONS**

The Governor in Council under Section 10 of the **Crown Land (Reserves) Act 1978** revokes the following temporary reservations:

MOOROOLBARK — The temporary reservation by Order in Council of 10 April, 1979 of an area of 1079 square metres of land being Crown Allotment 10A, Parish of Mooroolbark as a site for Public Buildings. — (Rs 10560).

MOOROOLBARK — The temporary reservation by Order in Council of 4 August, 1970 of an area of 734 square metres of land adjoining Crown Allotment 11C, Parish of Mooroolbark as a site for Public Purposes (Social Welfare Department purposes). — (Rs 9344).

MOOROOLBARK — The temporary reservation by Order in Council of 30 October, 1979 of an area of 864 square metres of land being Crown Allotment 9B, Parish of Mooroolbark as a site for Social Welfare purposes. — (Rs 10805).

MULGRAVE — The temporary reservation by Order in Council of 3 October, 1972 of an area of 658 square metres of land adjoining Crown Portion 84, Parish of Mulgrave as a site for Public Purposes (Social Welfare Department purposes). — (Rs 9655).

MULGRAVE — The temporary reservation by Order in Council of 3 October, 1972 of an area of 734 square metres of land adjoining Crown Portion 84, Parish of Mulgrave as a site for Public Purposes (Social Welfare Department purposes). — (Rs 9663).

NUNAWADING — The temporary reservation by Order in Council of 6 June, 1973 of an area of 809 square metres of land adjoining Crown Portion 68, Parish of Nunawading as a site for Public Purposes (Social Welfare Department purposes). — (Rs 9744).

NUNAWADING — The temporary reservation by Order in Council of 31 October, 1972 of an area of 582 square metres of land adjoining Crown Portion 94, Parish of Nunawading as a site for Public Purposes (Social Welfare Department purposes).

NUNAWADING — The temporary reservation by Order in Council of 4 September, 1973 of an area of 1043 square metres of land adjoining Crown Portion 130, Parish of Nunawading as a site for Public Purposes (Social Welfare Department purposes). — (Rs 9760).

NUNAWADING — The temporary reservation by Order in Council of 2 July, 1974 of an area of 608 square metres of land being Crown Allotment 119D, Parish of Nunawading as a site for Public Purposes (Social Welfare Department purposes). — (Rs 9884).

RINGWOOD — The temporary reservation by Order in Council of 5 April, 1977 of an area of 552 square metres of land being Crown Allotment 15A, Parish of Ringwood as a site for Public Purposes (Social Welfare Department purposes). — (Rs 10245).

SCORESBY — The temporary reservation by Order in Council of 7 June, 1977 of an area of 723 square metres of land being Crown Allotment 58C, Parish of Scoresby as a site for Public Purposes (Social Welfare Department purposes). — (Rs 10280).

WERRIMUL — The temporary reservation by Order in Council of 8 March, 1988 of an area of 1007 square metres of land being Crown Allotment 16, Section F, Township of Werrimul, Parish of Werrimul as a site for Arts, crafts and education purposes. — (Rs 13726).

This Order is effective from the date on which it is published in the Victoria Government Gazette.

Dated 19 January 1999.

Responsible Minister:  
MARIE TEHAN  
Minister for Conservation  
and Land Management

STACEY ROBERTSON  
Acting Clerk of the Executive Council

**Crown Land (Reserves) Act 1978**  
CROWN LANDS TEMPORARILY  
RESERVED

The Governor in Council under Section 4(1) of the **Crown Land (Reserves) Act 1978** temporarily reserves the following Crown lands for the purposes mentioned:-

MUNICIPAL DISTRICT OF THE  
PYRENEES SHIRE COUNCIL

LANDSBOROUGH — Police purposes, 3656 square metres being Crown Allotment 6D, Section 16, Township of Landsborough, Parish of Landsborough and being Lot 1 on Title Plan No. TP10805M lodged at the Office of Titles. — (06/15787).

MUNICIPAL DISTRICT OF THE  
GREATER GEELONG CITY COUNCIL

MOOLAP TO MURTCAIM — Public purposes, being the unappropriated Crown land on the Corio Bay foreshore, situated between the north-western angle of Allotment 16, Parish of Moolap and the south-western angle of Allotment 1B, Parish of Murtaim, and contained between the adjoining Allotment Boundaries and the land permanently reserved for Public Purposes by Order in Council of 3 March 1873 published in Gazette 1873 page 536, and Order in Council of 26 May 1873 published in Gazette 1873 page 1059. — (2001272).

MUNICIPAL DISTRICT OF THE  
BALLARAT CITY COUNCIL

NERRINA — Public purposes, 4.5 hectares, more or less, being Crown Allotment 19D, Section 5, Township of Nerrina, Parish of Ballarat as indicated by hatching on plan hereunder. — (N193[2]) — (96/1041).

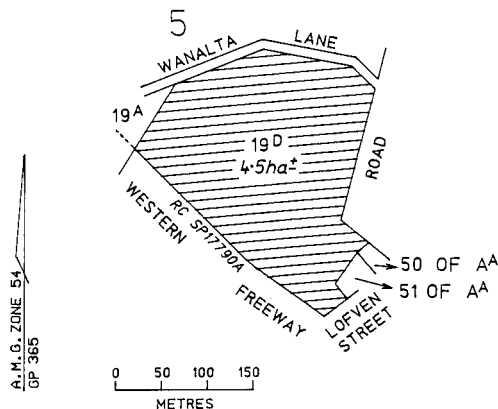

This Order is effective from the date on which it is published in the Victoria Government Gazette.

Dated 19 January 1999.

Responsible Minister:  
MARIE TEHAN  
Minister for Conservation  
and Land Management

STACEY ROBERTSON  
Acting Clerk of the Executive Council

**Crown Land (Reserves) Act 1978**  
INCORPORATION OF COMMITTEE OF  
MANAGEMENT OF THE COBDEN  
RECREATION RESERVE

The Governor in Council under Section 14A(1) of the **Crown Land (Reserves) Act 1978**, being satisfied that it is in the public interest to declare to be a corporation the Committee of Management appointed under Section 14(2) of the Act of the land described in the schedule hereunder:-

- (a) declares that the Committee of Management shall be a corporation;
- (b) assigns the name "COBDEN RECREATION RESERVE COMMITTEE OF MANAGEMENT INCORPORATED" to the corporation; and

under Section 14B(3) of the Act, appoints Evan J. SAVAGE to be Chairperson of the corporation.

SCHEDULE

The land in the Township of Cobden, Parish of Tandarook (area 4.047 hectares) temporarily reserved as a site for Public Recreation by Order in Council of 8 November, 1886. — Rs 683.

This Order is effective from the date on which it is published in the Victoria Government Gazette.

Dated 19 January 1999.

Responsible Minister:  
MARIE TEHAN  
Minister for Conservation  
and Land Management

STACEY ROBERTSON  
Acting Clerk of the Executive Council

**Crown Land (Reserves) Act 1978****INCORPORATION OF COMMITTEE OF  
MANAGEMENT OF THE MEENIYAN  
RECREATION RESERVE**

The Governor in Council under Section 14A(1) of the **Crown Land (Reserves) Act 1978**, being satisfied that it is in the public interest to declare to be a corporation the Committee of Management appointed under Section 14(2) of the Act of the land described in the schedule hereunder:-

- (a) declares that the Committee of Management shall be a corporation;
- (b) assigns the name "MEENIYAN RECREATION RESERVE INCORPORATED" to the corporation; and

under Section 14B(3) of the Act, appoints James Edward GOLDSMITH to be Chairperson of the corporation.

**SCHEDULE**

1. The remaining land in the Township of Meeniyah temporarily reserved for Public Recreation by Order in Council of 11 December, 1894; and
2. The lands in the Township of Meeniyah and the Parish of Nerrena temporarily reserved for Public Recreation by Orders in Council of 2 July, 1912 and 8 August, 1922. — Rs 153.

This Order is effective from the date on which it is published in the Victoria Government Gazette.

Dated 19 January 1999.

Responsible Minister:  
MARIE TEHAN  
Minister for Conservation  
and Land Management

STACEY ROBERTSON  
Acting Clerk of the Executive Council

**Crown Land (Reserves) Act 1978**  
**CROWN LANDS TEMPORARILY  
RESERVED**

The Governor in Council under Section 4(1) of the **Crown Land (Reserves) Act 1978** temporarily reserves the following Crown lands for Public Purposes (Rail Trail):-

MUNICIPAL DISTRICTS OF THE  
GOLDEN PLAINS SHIRE COUNCIL  
AND THE CORANGAMITE SHIRE COUNCIL

SKIPTON — Public Purposes (Rail Trail), 37 hectares, more or less, being Crown Allotments 1B and 1C, Section 2B, Township of Skipton and Crown Allotment 8C, Section 5, Crown Allotment 7A, Section 7, Crown Allotment 5A, Section 13A and Crown Allotments 50C and 50D, Section 15A, Parish of Skipton as shown on Plan No. LEGL./98-66 lodged in the Central Plan Office; and

LINTON and ARGYLE — Public Purposes (Rail Trail), 44 hectares, more or less, being Crown Allotments 4E and 5A, Section 26, Township of Linton, and Crown Allotments C7A, D1A and D22B, No Section, Parish of Argyle as shown on Plan No. LEGL./98-67 lodged in the Central Plan Office. — (Rs 21140).

This Order is effective from the date on which it is published in the Victoria Government Gazette.

Dated 19 January 1999.

Responsible Minister:  
MARIE TEHAN  
Minister for Conservation  
and Land Management

STACEY ROBERTSON  
Acting Clerk of the Executive Council

**Crown Land (Reserves) Act 1978****NOTICE OF INTENTION**

The Governor in Council under Section 10 of the **Crown Land (Reserves) Act 1978** gives notice of intention to revoke the following temporary reservations to the extent indicated hereunder:

CORINELLA — The temporary reservation by Order in Council of 5 April, 1887 of an area of 36.34 hectares of land in the Parish of Corinella as a site for Public Recreation, revoked as to part by various Orders, so far as the balance remaining. — (Rs 523).

CORINELLA — The temporary reservation by Order in Council of 26 February 1952 of an area of 3794 square metres of land in the Parish of Corinella as a site for Public Recreation, in addition to and adjoining the site temporarily reserved therefor by Order in Council of 5 April, 1887, revoked as to part by Order in Council of 12 November, 1991, so far as the balance remaining. — (Rs 523).



**CORINELLA** — The whole of the temporary reservation by Order in Council of 26 February, 1952 of an area of 4047 square metres of land in the Parish of Corinella as a site for Public Recreation, in addition to and adjoining the site temporarily reserved therefor by Order in Council of 5 April, 1887. — (Rs 523).

**ELLERSLIE** — The whole of the temporary reservation by Order in Council of 9 April, 1900 of an area of 1.619 hectares of land in Section 9, Township of Ellerslie, Parish of Ellerslie, (formerly being Crown Allotments 3, 4, 5, 6, 7, 8, 9 and 10 of section 9, Town of Ellerslie) as a site for Public Recreation. — (Rs 1430).

**TRARALGON** — The temporary reservation by Order in Council of 26 May, 1970 of an area of 2.104 hectares, more or less, of land in the Township of Traralgon, Parish of Traralgon as a site for a Public Park, so far only as the portion containing 1393 square metres as indicated by hatching on plan hereunder. — (T115[13]) — (Rs 9314).

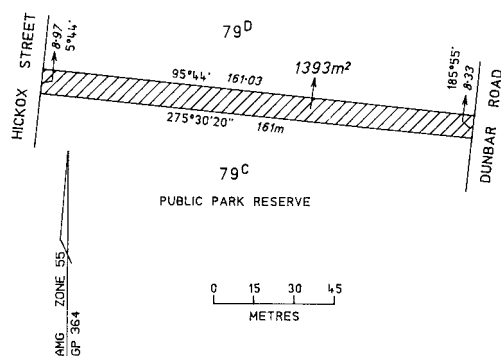

This Order is effective from the date on which it is published in the Victoria Government Gazette.

Dated 19 January 1999.

Responsible Minister:  
MARIE TEHAN  
Minister for Conservation  
and Land Management

STACEY ROBERTSON  
Acting Clerk of the Executive Council

#### **Crown Land (Reserves) Act 1978**

##### **NOTICE OF INTENTION**

The Governor in Council under Section 10 of the **Crown Land (Reserves) Act 1978** gives notice of intention to revoke the following temporary reservation to the extent indicated hereunder:

**SEYMOUR** — The temporary reservation by Order in Council of 31 December, 1930 of an area of 4.856 hectares, more or less, of land in the Township of Seymour, Parish of Seymour as a site for Public Recreation, in addition to and adjoining the site temporarily reserved therefor by Order in Council of 12 February, 1890, revoked as to part by various Orders, so far only as the portion containing 5150 square metres, more or less, as indicated by hatching on plan hereunder. — (S26[3]) — (Rs 4802).

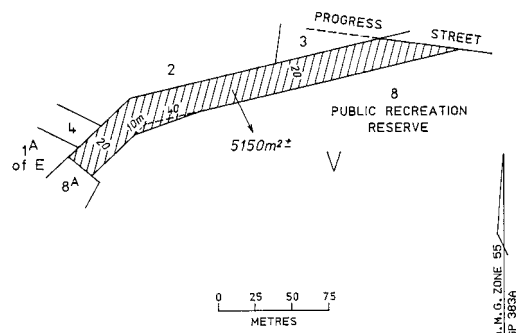

This Order is effective from the date on which it is published in the Victoria Government Gazette.

Dated 19 January 1999.

Responsible Minister:  
MARIE TEHAN  
Minister for Conservation  
and Land Management

STACEY ROBERTSON  
Acting Clerk of the Executive Council

#### **Crown Land (Reserves) Act 1978**

##### **REVOCATION OF TEMPORARY RESERVATIONS**

The Governor in Council under Section 10 of the **Crown Land (Reserves) Act 1978** revokes the following temporary reservations to the extent indicated hereunder:

**BAIRNSDALE** — The temporary reservation by Order in Council of 26 November, 1941 of an area of 4.654 hectares of land in Section 80, Township of Bairnsdale, Parish of Bairnsdale as a site for a Benevolet Home, revoked as to part by Order in Council of 4 August, 1998, so far only as the portion containing 3622 square metres as indicated by hatching on plan published in the Victoria Government Gazette on 17 December, 1998 - page 3094. — (Rs 2256).

**LILLIPUT** — The whole of the temporary reservation by Order in Council of 13 March,

1888 of an area of 3.083 hectares of land in Section 12, Parish of Lilliput as a site for Supply of Gravel. — (Rs 9145).

**MORTLAKE** — The whole of the temporary reservation by Order in Council of 10 August, 1948 of an area of 4047 square metres, more or less, of land being in Section 20, Township of Mortlake, (formerly Town of Mortlake) Parish of Mortlake as a site for a Municipal Store Yard. — (Rs 3107).

**SCARSDALE** — The whole of the temporary reservation by Order in Council of 27 August, 1918 of an area of 1.222 hectares of land in Section 5, Parish of Scarsdale as a site for Supply of Gravel. — (Rs 12706).

**SCARSDALE** — The whole of the temporary reservation by Order in Council of 21 October, 1941 of an area of 3.253 hectares of land in Section 9A, Parish of Scarsdale as a site for Gravel Supply. — (Rs 5289).

**WANGOOM** — The whole of the temporary reservation by Order in Council of 12 July, 1960 of an area of 6779 square metres of land in two separate portions in Section A, Parish of Wangoom as a site for Mental Hygiene Authority purposes, in addition to and adjoining the site temporarily reserved therefor by Order in Council of 18 September, 1956.

**WANGOOM** — The temporary reservation by Order in Council of 18 September, 1956 of an area of 39.34 hectares of land in Section A, Parish of Wangoom as a site for Mental Hygiene Authority purposes, revoked as to part by various Orders, SAVE AND EXCEPT the portion being Crown Allotment 14D, Section A, Parish of Wangoom containing 4185 square metres as indicated by hatching on plan published in the Victoria Government Gazette on 17 December, 1998 - page 3095. — (Rs 7493).

**WHITFIELD** — The whole of the temporary reservation by Order in Council of 18 November, 1986 of an area of 772 square metres of land being Crown Allotment 19E, Section 1, Parish of Whitfield as a site for Public Purposes (Departmental Residence). — (Rs 12756).

This Order is effective from the date on which it is published in the Victoria Government Gazette.

Dated 19 January 1999.

Responsible Minister:  
MARIE TEHAN  
Minister for Conservation  
and Land Management

STACEY ROBERTSON  
Acting Clerk of the Executive Council

### **Crown Land (Reserves) Act 1978**

#### **REVOCATION OF TEMPORARY RESERVATIONS**

The Governor in Council under Section 10 of the **Crown Land (Reserves) Act 1978** revokes the following temporary reservations to the extent indicated hereunder:

**CROSSOVER** — The whole of the temporary reservation by Order in Council of 2 July, 1894 of an area of 8053 square metres of land in the Township of Crossover (formerly Parish of Neerim) as a site for a State School. — (Rs 13806).

**EAGLEHAWK** — The temporary reservation by Order in Council of 5 August, 1980 of an area of 10.97 hectares of land being Crown Allotments 207E, 208B, 246A and 304, Section N, At Eaglehawk, Parish of Sandhurst as a site for Public Park and Preservation of Species of Native Plants, so far only as the portion containing 479 square metres as indicated by hatching on plan published in the Victoria Government Gazette on 17 December, 1998 - page 3095. — (Rs 11088).

**MOOROODUC** — The temporary reservation by Order in Council of 13 February, 1894 of an area of 1.416 hectares of land in the Parish of Moorooduc, (formerly part of Crown Allotment 91A) as a site for a State School, so far only as the portion containing 291 square metres shown as Parcel No. 3 on Roads Corporation Survey Plan No. 19353 lodged in the Central Plan Office. — (Rs 1512).

This Order is effective from the date on which it is published in the Victoria Government Gazette.

Dated 19 January 1999.

Responsible Minister:  
MARIE TEHAN  
Minister for Conservation  
and Land Management

STACEY ROBERTSON  
Acting Clerk of the Executive Council

### **Crown Land (Reserves) Act 1978**

#### **CROWN LANDS TEMPORARILY RESERVED**

The Governor in Council under Section 4(1) of the **Crown Land (Reserves) Act 1978** temporarily reserves the following Crown lands for the purposes mentioned:-

MUNICIPAL DISTRICT OF THE  
SOUTH GIPPSLAND SHIRE COUNCIL

LEONGATHA — Public purposes (Community Use Centre), 1050 square metres, more or less, being Crown Allotment 5, Section 17, Township of Leongatha, Parish of Leongatha as indicated by hatching on plan hereunder. — (L167[6]) — (15/11157).

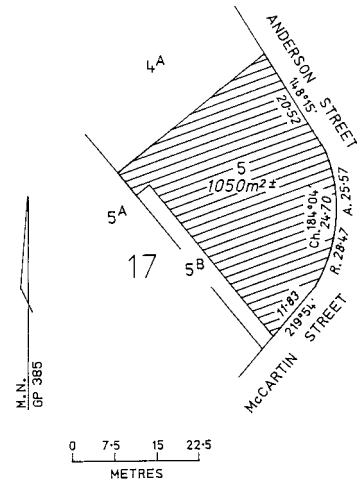

MUNICIPAL DISTRICT OF THE  
SURF COAST SHIRE COUNCIL

LORNE — Public purposes, 1262 square metres being Crown Allotment 14, Section 5, Township of Lorne, Parish of Lorne as shown on Certified Plan No. 78791-M lodged in the Central Plan Office. — (Rs 1690).

MILDURA — Water supply purposes, 1188 square metres being Crown Allotment 230F, Parish of Mildura as indicated by hatching on plan hereunder. (M556[22]) — (L5-3819).

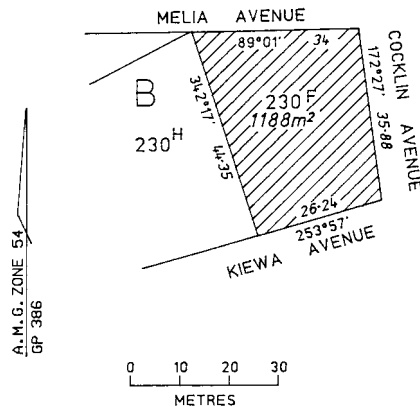

MUNICIPAL DISTRICT OF THE  
MORNINGTON PENINSULA SHIRE  
COUNCIL

MORNINGTON — Public purposes, 172 square metres, being Crown Allotment 8K, Section 1, Township of Mornington, Parish of Moorooduc as shown on Certified Plan No. 119095 lodged in the Central Plan Office.— (Rs 37136).

MUNICIPAL DISTRICT OF THE  
MORNINGTON PENINSULA SHIRE  
COUNCIL

NEPEAN — Public purposes, being Crown Allotment 96J, Parish of Nepean as indicated by hatching on plan hereunder. (N57[5]) — (Rs 229).

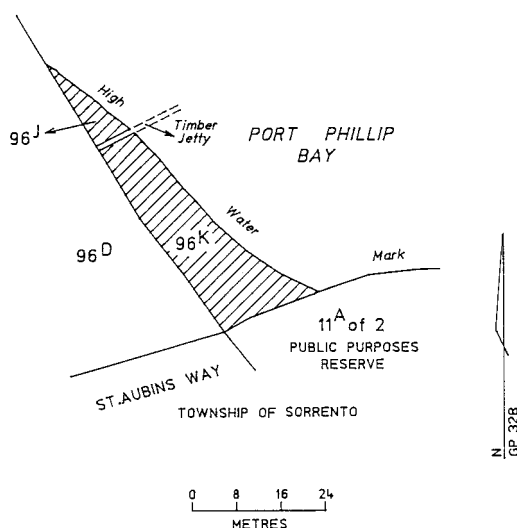

Total area of hatched portions 500m<sup>2</sup>±

MUNICIPAL DISTRICT OF THE  
MORNINGTON PENINSULA SHIRE  
COUNCIL

SORRENTO — Public purposes, 8050 square metres, more or less, being Crown Allotments 11B, 11C and 11D, Section 2, Township of Sorrento, Parish of Nepean as indicated by hatching on plans hereunder. — (S467[2]) — (Rs 229).

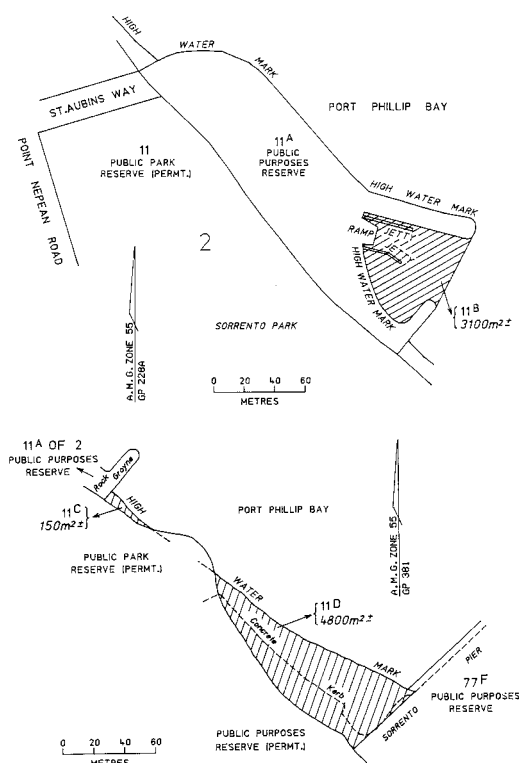

Total area of hatched portions 4950m<sup>2</sup>±

MUNICIPAL DISTRICT OF THE  
PORT PHILLIP CITY COUNCIL

SOUTH MELBOURNE — Public purposes, 1366 square metres being Crown Allotment 49A, Section 430, City of South Melbourne, Parish of Melbourne South as indicated by hatching on plan hereunder. — (M333[28]) — (Rs 37198).

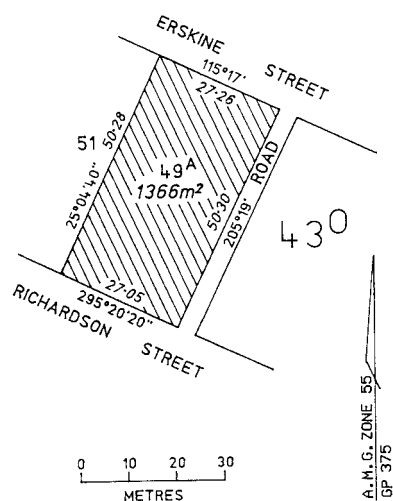

MUNICIPAL DISTRICT OF THE  
MELBOURNE CITY COUNCIL

SOUTH YARRA — Education purposes, 85.2 square metres being Crown Allotment 6B, Section 6A, At South Yarra, Parish of Melbourne South as indicated by hatching on plan hereunder. — (M314[8]) — (Rs 37189).

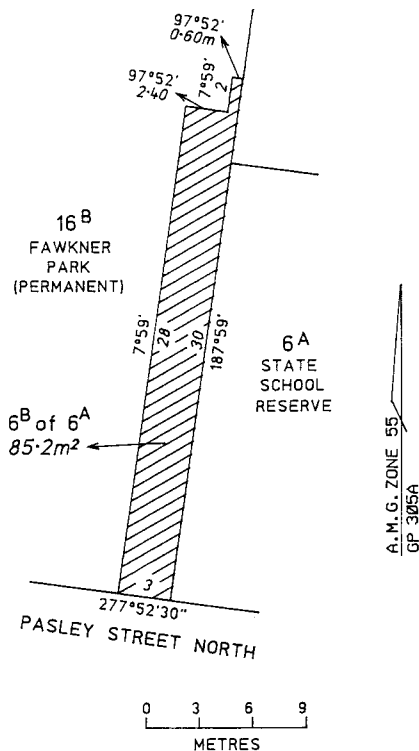

MUNICIPAL DISTRICT OF THE  
WARRNAMBOOL CITY COUNCIL

WARRNAMBOOL — Police purposes, 5012 square metres being Crown Allotments 22 and 23, Section 16, Township of Warrnambool, Parish of Wangoom as shown on Certified Plan No. 112055 lodged in the Central Plan Office. — (Rs 43101).

This Order is effective from the date on which it is published in the Victoria Government Gazette.

Dated 19 January 1999.

Responsible Minister:  
MARIE TEHAN  
Minister for Conservation  
and Land Management

STACEY ROBERTSON  
Acting Clerk of the Executive Council

**Land Act 1958**

UNUSED ROADS CLOSED

The Governor in Council under Section 349 of the **Land Act 1958** and with the consents in writing of the municipalities concerned and the adjoining owners closes the following unused roads:

MUNICIPAL DISTRICT OF THE  
WODONGA RURAL CITY COUNCIL

BARANDUDA — The road in the Parish of Baranduda shown as Crown Allotment 14A, Section 26 on Certified Plan No. 119099 lodged in the Central Plan Office. — (L8-6230).

MUNICIPAL DISTRICT OF THE  
SOUTHERN GRAMPIANS SHIRE  
COUNCIL

BRANXHOLME — The road in the Parish of Branxholme shown as Crown Allotment 1A, Section 6A on Certified Plan No. 119070 lodged in the Central Plan Office. — (03/2291).

MUNICIPAL DISTRICT OF THE  
MARIBYRNONG COUNCIL

BRAYBROOK — The road in the Township of Braybrook, Parish of Cut-paw-paw shown as Crown Allotment 26A on Certified Plan No. 119148 lodged in the Central Plan Office. — (L12/0694).

MUNICIPAL DISTRICT OF THE  
BRIMBANK CITY COUNCIL

KEILOR — The road in the Township of Keilor, Parish of Maribyrnong shown as Crown Allotment 11, Section 3 on Certified Plan No. 119135 lodged in the Central Plan Office. — (L12/0989).

MUNICIPAL DISTRICT OF THE  
GLENELG SHIRE COUNCIL

PORTLAND — The road in the Parish of Portland shown as Crown Allotment D1, Section 2 on Certified Plan No. 119009 lodged in the Central Plan Office. — (03/6025).

MUNICIPAL DISTRICT OF THE  
LATROBE SHIRE COUNCIL

TRARALGON — The road in the Parish of Traralgon shown as Crown Allotment 43C, Section A on Certified Plan No. 119044 lodged in the Central Plan Office. — (L10-5755).

This Order is effective from the date on which it is published in the Victoria Government Gazette.

Dated 19 January 1999.

Responsible Minister:  
MARIE TEHAN  
Minister for Conservation  
and Land Management

STACEY ROBERTSON  
Acting Clerk of the Executive Council

**Crown Land (Reserves) Act 1978**  
**INCORPORATION OF COMMITTEE OF**  
**MANAGEMENT OF THE STANLEY**  
**RECREATION RESERVE**

The Governor in Council under Section 14A(1) of the **Crown Land (Reserves) Act 1978**, being satisfied that it is in the public interest to declare to be a corporation the Committee of Management appointed under Section 14(2) of the Act of the land described in the schedule hereunder:

- (a) declares that the Commonwealth of Management shall be a corporation;
- (b) assigns the name "STANLEY RECREATION RESERVE INCORPORATED COMMITTEE" to the corporation; and

under Section 14B(3) of the Act, appoints Stephen ROUTLEDGE to be Chairperson of the corporation.

**SCHEDULE**

1. The land in the Township of Stanley, (formerly Town of Stanley), Parish of Stanley temporarily reserved as a site for Public Recreation by Order in Council of 6 April, 1914; and
2. The remaining land in the Township of Stanley, (formerly Town of Stanley), Parish of Stanley temporarily reserved as a site for Public Recreation by Order in Council of 22 April, 1952.

Rs 635.

This Order is effective from the date on which it is published in the Victoria Government Gazette.

Dated 19 January 1999.

Responsible Minister:  
MARIE TEHAN  
Minister for Conservation  
and Land Management

STACEY ROBERTSON  
Acting Clerk of the Executive Council

**Forests Act 1958**

**EXCHANGE OF RESERVED FOREST FOR  
CROWN LAND**

The Governor in Council under Section 49(1) of the **Forests Act 1958** authorises, in exchange for the Crown land described in the Dedication Schedule hereunder, the excision of the lands described in the Excision Schedule hereunder from reserved forest.

**DEDICATION SCHEDULE**

An area of 6.6 hectares, more or less, of Crown land comprising:-

- (a) 6.6 hectares, more or less, in the Parish of Lal Lal as indicated by hatching on plan hereunder. — (L122(2) — (05/13070).

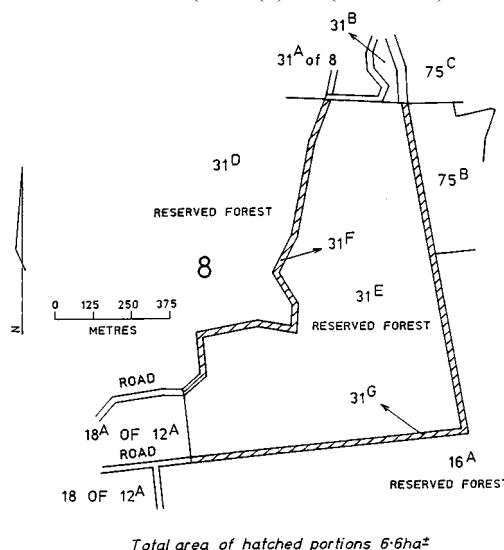

**EXCISION SCHEDULE**

An area of 8.9 hectares, more or less, of reserved forest comprising:-

- (a) 8.9 hectares, more or less, in the Parish of Narrawong as indicated by hatching on plan hereunder. — (3278(1 & 2) — (L2/4190).

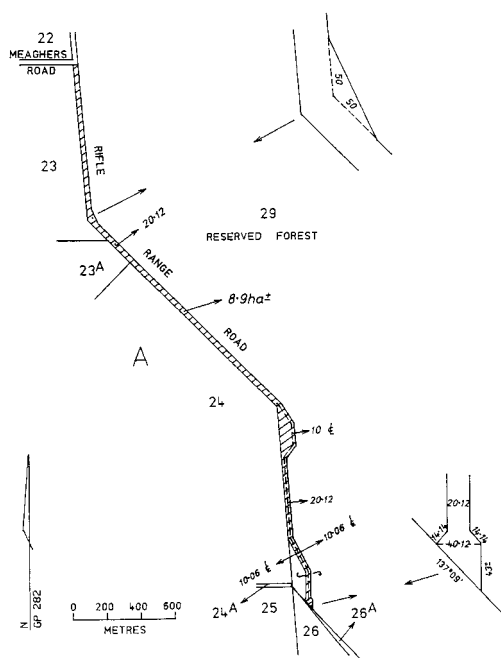

Such excisions and dedication to come into effect on the fourteenth day after publication of this Order in the Victoria Government Gazette.

Dated 19 January 1999.

Responsible Minister:  
MARIE TEHAN  
Minister for Conservation  
and Land Management

STACEY ROBERTSON  
Acting Clerk of the Executive Council

## LATE NOTICES

## EXEMPTION

Application No. 1 of 1999

The Victorian Civil and Administrative Tribunal, has considered an application pursuant to Section 83 of the **Equal Opportunity Act 1995** by Melbourne City Mission Inc. for exemption from Sections 13, 42, 49, 100 and 195 of the Act. The application for exemption is to enable the applicant to advertise and provide accommodation, for lead tenants aged 23 or over to work in its accommodation program to support homeless people aged 17 or less who exhibit challenging behaviours.

Upon reading the material submitted in support of the application and upon hearing submissions from Mary McKinnon and for the Reasons for Decision given by the Tribunal on 18 January 1999, the Tribunal is satisfied that it is appropriate to grant an exemption from Sections 13, 42, 49 100 and 195 of that Act to enable the applicant to advertise and provide accommodation, for lead tenants aged 23 or over to work in its accommodation program to support homeless people aged 17 or less who exhibit challenging behaviours.

The Tribunal hereby grants an exemption to the applicant from the operations of Sections 13, 42, 49, 100 and 195 of the **Equal Opportunity Act 1995** to enable the applicant to advertise and provide accommodation, for lead tenants aged 23 or over to work in its accommodation program to support homeless people aged 17 or less who exhibit challenging behaviours.

This exemption is to remain in force from the day on which notice of the exemption is published in the Government Gazette until 20 January 2002.

Dated this 18 January 1999.

CATE McKENZIE  
Deputy President

N.B. A copy of the Reasons for Decision is available from the Registrar of the Anti-Discrimination List.

---





**SUBORDINATE LEGISLATION ACT 1994  
NOTICE OF MAKING OF STATUTORY  
RULES**

Notice is hereby given under Section 17 (2) of the **Subordinate Legislation Act 1994** of the making of the following Statutory Rules:

1. *Statutory Rule:* Fisheries (Merri River) Regulations 1999  
*Authorising Act:* Fisheries Act 1995  
*Date of making:* 19 January 1999
2. *Statutory Rule:* Local Government (Elections) (Amendment) Regulations 1999  
*Authorising Act:* Local Government Act 1989  
*Date of making:* 19 January 1999
3. *Statutory Rule:* Pay-roll Tax (Employment Agency Contracts) Regulations 1999  
*Authorising Act:* Pay-roll Tax Act 1971  
*Date of making:* 19 January 1999
4. *Statutory Rule:* Gas Safety (Gas Quality) Regulations 1999  
*Authorising Act:* Gas Safety Act 1997  
*Date of making:* 19 January 1999
5. *Statutory Rule:* Gas Safety (Safety Case) Regulations 1999  
*Authorising Act:* Gas Safety Act 1997  
*Date of making:* 19 January 1999
6. *Statutory Rule:* Gas Safety (Gas Installation) Regulations 1999  
*Authorising Act:* Gas Safety Act 1997  
*Date of making:* 19 January 1999

Retail price will vary according to the number of pages in each special or periodical gazette. The table below sets out the prices that apply

<i>Price Code</i>	<i>No. of Pages (Including cover and blank pages)</i>	<i>Price</i>
A	1-16	\$2.90
B	17-32	\$4.30
C	33-48	\$5.90
D	49-96	\$9.15
E	97-144	\$11.85
F	145-192	\$14.00
G	193-240	\$16.15
H	241-288	\$17.20
I	289-352	\$19.35
J	353-416	\$22.60
K	417-480	\$25.80
L	481-544	\$30.10
M	545-608	\$34.40
N	609-672	\$38.70
O	673-736	\$43.00
P	737-800	\$47.30

#### ADVERTISERS PLEASE NOTE

As from 21 January 1999

The last Special Gazette was No. 12 dated 20 January 1999

The last Periodical Gazette was No. 1 dated 2 June 1998

**CONTENTS**

	Page
Estates of Deceased Persons	76
Government and Outer Budget Sector	
Agencies Notices	81
Orders in Council—	111
Acts — Health Services; Gas Safety;	
Taxation (Interest on	
Overpayments); Land Tax; Local	
Government; Interpretation of	
Legislation; Livestock Disease	
Control; Pipelines; Land; Crown	
Land (Reserves); Forests	
Private Advertisements	76
Proclamations	80

The Victoria Government Gazette is published by The Craftsman Press Pty. Ltd. with the authority of the Government Printer for the State of Victoria  
© State of Victoria 1999

ISSN 0819-5471

This publication is copyright. No parts may be reproduced by any process except in accordance with the provisions of the Copyright Act.

Products and services advertised in this publication are not endorsed by The Craftsman Press Pty. Ltd. or the State of Victoria and neither of them accepts any responsibility for the content or the quality of reproduction. The Craftsman Press Pty. Ltd. reserves the right to reject any advertising material it considers unsuitable for government publication.

Address all inquiries to the Government Printer for the State of Victoria  
1 Macarthur Street  
Melbourne 3002 Victoria Australia

**RETAIL SALES**

Information Victoria Bookshop  
356 Collins Street Melbourne 3000.  
Telephone enquiries 1300 366 356

City Graphics  
2nd Floor, 4 Bank Place  
Melbourne 3000  
Telephone enquiries (03) 9600 0977

**Recommended Retail Price \$1.70**

*Government and Outer Budget Sector Agencies please note:*  
**STYLE REQUIREMENTS.**

To ensure that material received can be reproduced, and that errors are minimised, the following guidelines are to be observed when submitting material by fax.

**Fax resolution:**

Material sent by fax should be transmitted using Fine Resolution (200 dots per inch by 200 dpi).

**Font size:**

Use 12 point (10 pitch) or larger.

**Font Style:**

Clear plain font styles, such as Helvetica, should be used.

**Graphics:**

Line drawings should be transmitted as large as possible to ensure clarity. Drawings up to A4 size sent by fax using Fine Resolution provide a good quality for reproduction.

**Avoid:**

Italics, underlining and full justification.

Ensure document is square when sending as documents that are sent skewed are difficult to read and process.

ISSN 0819-5471

