



Victoria Government Gazette

No. S 200 Thursday 21 December 2000
By Authority. Victorian Government Printer

SPECIAL

Melbourne City Link Act 1995

NOTICE OF DECLARATION OF LINK ROAD — SOUTHERN LINK

I, Peter Batchelor, Minister for Transport and Minister administering the **Melbourne City Link Act 1995** (“the Act”), in accordance with section 61 (3) of the Act, give notice that I have today made a declaration under section 61 (1) of the Act. A copy of that declaration is printed with this notice.

By operation of the definition of “Link road” in section 3 of the Act, the land the subject of the declaration is part of the Link road.

On the publication of this notice in the Government Gazette, by operation of section 61 (4) of the Act, the road specified in the declaration is deemed to be—

- a. a declared road within the meaning of the **Transport Act 1983**; and
- b. a road open to and for use by the public for passage with vehicles; and
- c. a highway within the meaning of the **Road Safety Act 1986**.

The declaration applies to the land comprised in the Crown Allotments and parts of Crown Allotments described in the declaration, as shown on the plans referred to in the declaration and lodged at the Central Plan Office of the Department of Natural Resources and Environment. Copies of these plans are available from the Land and Survey Information Centre, Department of Natural Resources and Environment, Ground Floor, 456 Lonsdale Street, Melbourne, 3000.

Overview plans and diagrams of the Southern Link are also published with this notice for information purposes only.

This declaration covers the entire Southern Link, including the Burnley Tunnel, and supersedes previous road declarations over parts of the Southern Link.

PETER BATCHELOR MP
Minister for Transport

Dated 21 December, 2000

Melbourne City Link Act 1995

DECLARATION OF LINK ROAD — SOUTHERN LINK

I, Peter Batchelor, Minister for Transport and Minister administering the **Melbourne City Link Act 1995** (“the Act”), acting under section 61 (1) of the Act and under section 27 of the **Interpretation of Legislation Act 1994**:

1. Repeal the following declarations of roads under section 61 (1) of the Act—
 - a. the declaration made on 21 December 1999 and published in Government Gazette No. S 190 on that date, and
 - b. the declaration made on 4 May 2000 and published in Government Gazette No. S 58 on that date.
2. Declare to be a road the land and strata of land comprised in the Crown Allotments listed in Schedule 1, being land and strata of land to which section 61 (1) (b) of the Act applies.
3. State that—
 - a. the following parts of the road are to be treated as State highway—
 - i. the land and strata of land shown hatched, cross-hatched and filled on plans LEGL./99-204 to LEGL./99-211 in Schedule 2 (the originals of which are lodged in the Central Plan Office),
 - ii. Crown Allotment 5E, Parish of Jika Jika (as shown on the plan numbered LEGL./99-198 lodged in the Central Plan Office),
 - iii. Crown Allotment 5F, Parish of Jika Jika (as shown on the plan numbered LEGL./99-198 lodged in the Central Plan Office),
 - iv. all strata of land more than 1 metre below the surface of elevated roadways on the Monash Freeway, and
 - b. the remainder of the road the subject of this instrument is to be treated as a freeway.

PETER BATCHELOR MP

Minister for Transport

Dated: 21 December, 2000

SCHEDULE 1**CROWN ALLOTMENTS COMPRISING THE SOUTHERN LINK OF THE LINK ROAD**

Crown Allotment	Section	Parish	LEGL Plan No. lodged at the Central Plan Office
22A	E	City of South Melbourne, Parish of Melbourne South	LEGL./99-194
22C	E	City of South Melbourne, Parish of Melbourne South	LEGL./99-194
44E	D	City of South Melbourne, Parish of Melbourne South	LEGL./99-195
Q3		City of Melbourne, Parish of Melbourne South	LEGL./99-195
Q2		City of Melbourne, Parish of Melbourne South	LEGL./99-196
5	19D	At East Melbourne, City of Melbourne, Parish of Melbourne North	LEGL./99-196
6	19D	At East Melbourne, City of Melbourne, Parish of Melbourne North	LEGL./99-196
7	19D	At East Melbourne, City of Melbourne, Parish of Melbourne North	LEGL./99-197
5C		Parish of Jika Jika	LEGL./99-196
5D		Parish of Jika Jika	LEGL./99-198
5E		Parish of Jika Jika	LEGL./99-198
5F		Parish of Jika Jika	LEGL./99-198
8P		City of Richmond, Parish of Jika Jika	LEGL./99-198
8Q		City of Richmond, Parish of Jika Jika	LEGL./99-199
1A	39A	City of Richmond, Parish of Jika Jika	LEGL./99-196
1B	39A	City of Richmond, Parish of Jika Jika	LEGL./99-200
16Y		Parish of Jika Jika	LEGL./99-200
9E		Boroondara	LEGL./99-201

SCHEDULE 2

PARTS OF THE SOUTHERN LINK THAT ARE TO BE TREATED AS STATE HIGHWAY

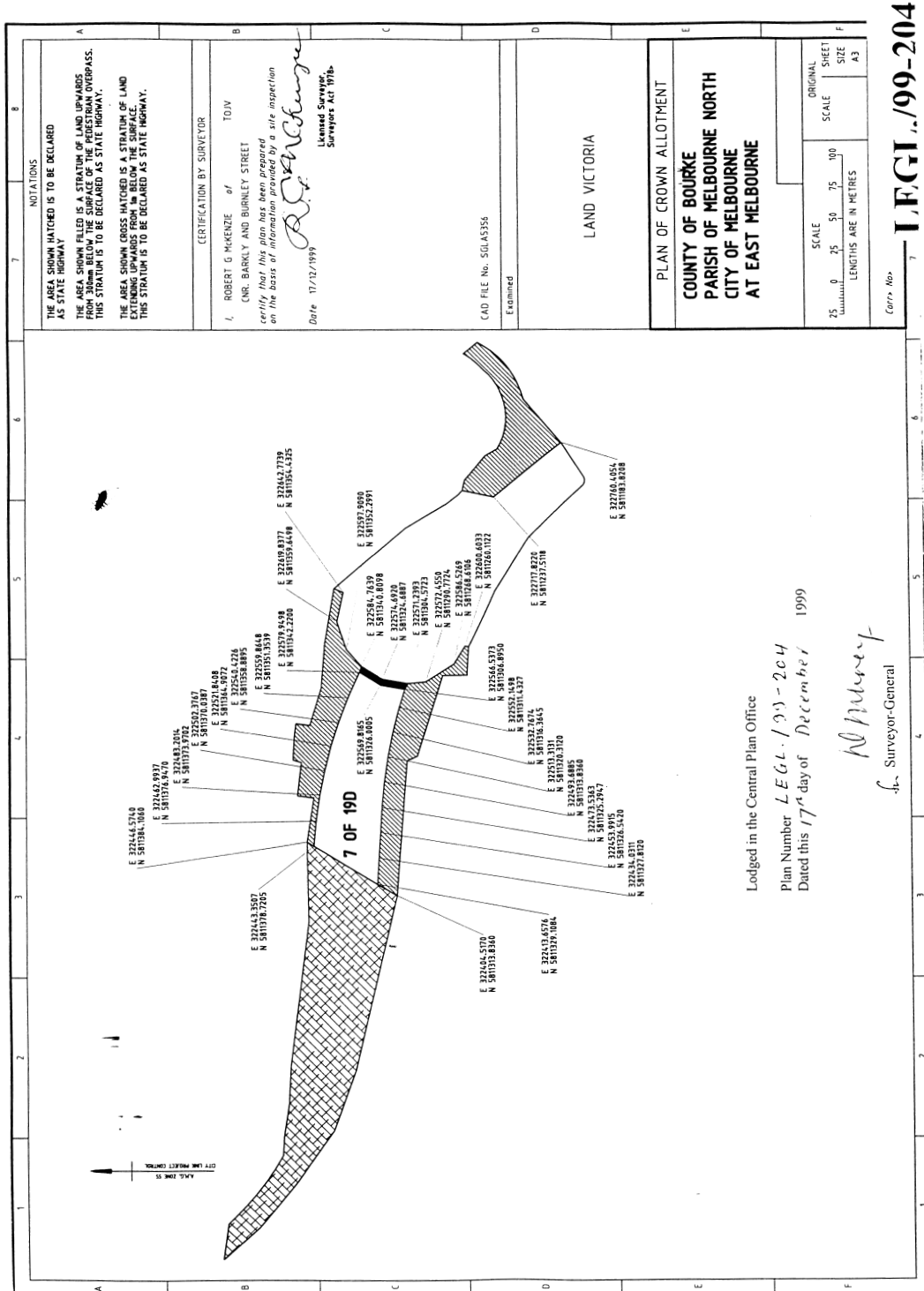

NOTATIONS

THE AREA SHOWN HATCHED IS TO BE DECLARED AS STATE HIGHWAY.

THE AREA SHOWN HATCHED IS A STRATHAM OF LAND, BECAUSE THIS STRATHAM IS TO BE DECLARED AS STATE HIGHWAY.

THE AREA SHOWN CROSS HATCHED IS A STRATHAM OF LAND, BECAUSE THIS STRATHAM IS TO BE DECLARED AS STATE HIGHWAY.

CERTIFICATION BY SURVEYOR

I, ROBERT G. MCKENZIE of TOIV (ENR. BARKLY AND BURNLEY STREET) certify that this plan has been prepared on the basis of information provided to me by a site inspection.

Date 17/12/1999

R.G. McKenzie
Licensed Surveyor,
Surveyors Act 1976.

LAND VICTORIA

Examined

LAO FILE No. SCL45356

PLAN OF CROWN ALLOTMENT

COUNTY OF BOURKE
PARISH OF MELBOURNE NORTH
CITY OF MELBOURNE
AT EAST MELBOURNE

SCALE

1:5000

LENGTHS ARE IN METRES

ORIGINAL SHEET SIZE A3

Lodged in the Central Plan Office

Plan Number *LEG. 199-204*

Dated this *17th* day of *December* 1999

R. Murray
Surveyor-General

Corr. No. **LEG. 199-204**

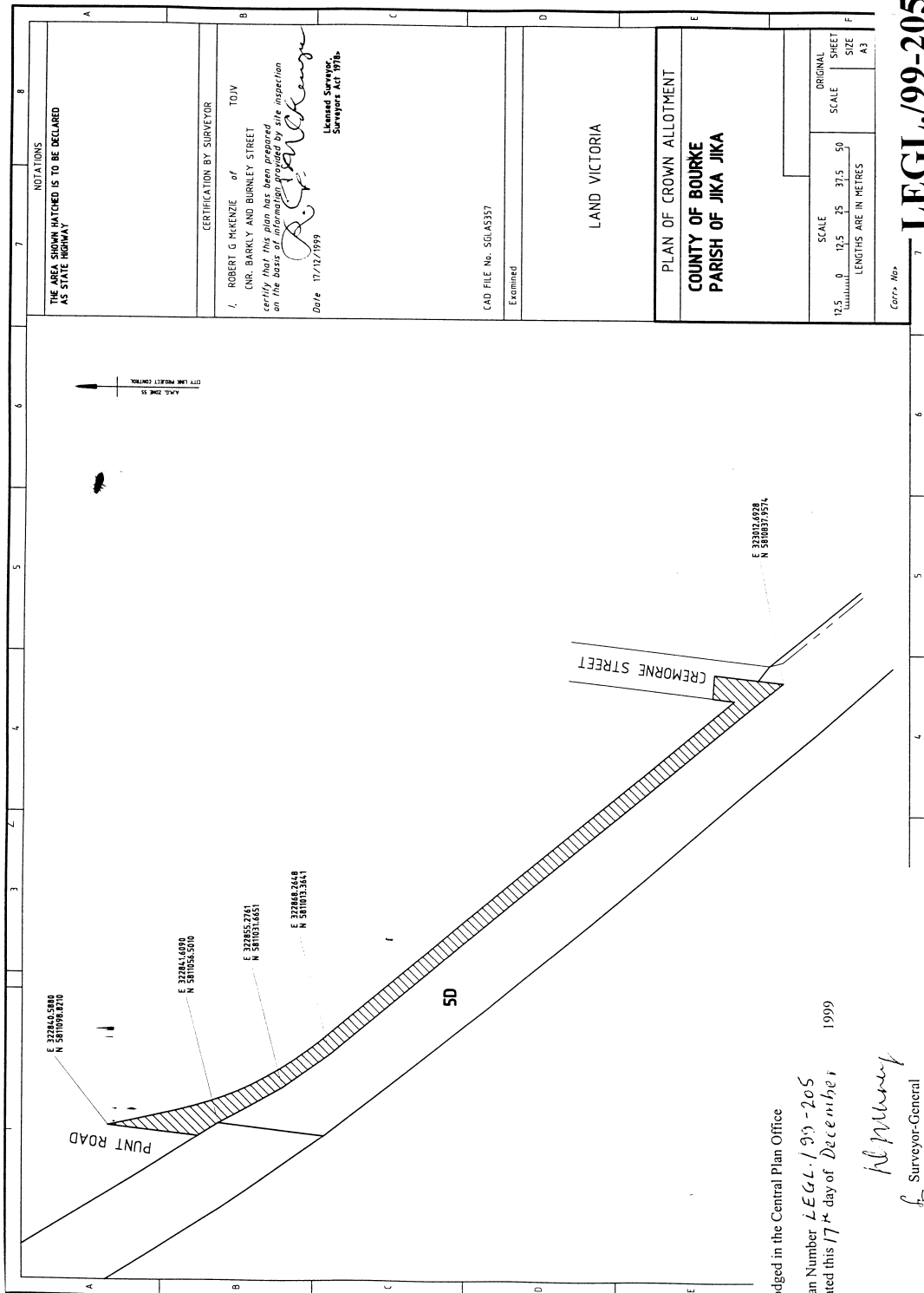

L E G L . / 9 9 - 2 0 5

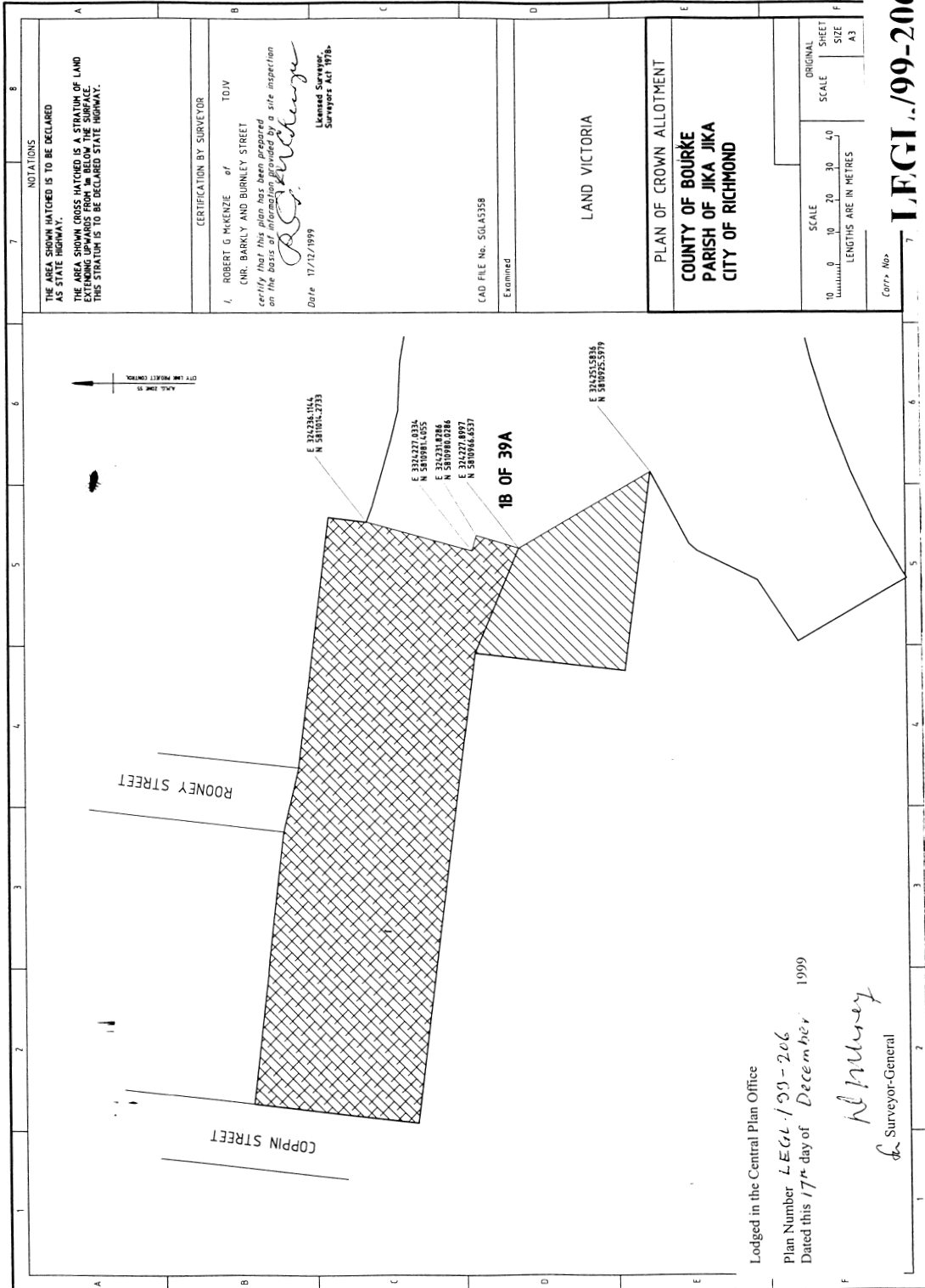

NOTATIONS

THE AREA SHOWN HATCHED IS TO BE DECLARED AS STATE HIGHWAY.

THE AREA SHOWN CROSS-HATCHED IS A STRATUM OF LAND EXTENDING UPWARDS FROM AND BELOW THE SURFACE. THIS STRATUM IS TO BE DECLARED STATE HIGHWAY.

CERTIFICATION BY SURVEYOR

I, ROBERT G. MCKENZIE of CNR, BARKLY AND BURNLEY STREET certify that this plan has been prepared on the basis of information provided by a site inspection.

Robert G. McKenzie
 Licensed Surveyor,
 Surveyors Act 1978.
 Date: 17/12/1999

CAD FILE No. 5GLA5358
 Examined

LAND VICTORIA

PLAN OF CROWN ALLOTMENT
 COUNTY OF BOURKE
 PARISH OF JIKA JIKA
 CITY OF RICHMOND

SCALE
 10 0 10 20 30 40
 LENGTHS ARE IN METRES

ORIGINAL SHEET SIZE A3

Corr. No.

Lodged in the Central Plan Office
 Plan Number L.E.G.L./99-206
 Dated this 17th day of December 1999

R. Murray
 Surveyor-General

L.E.G.L./99-206

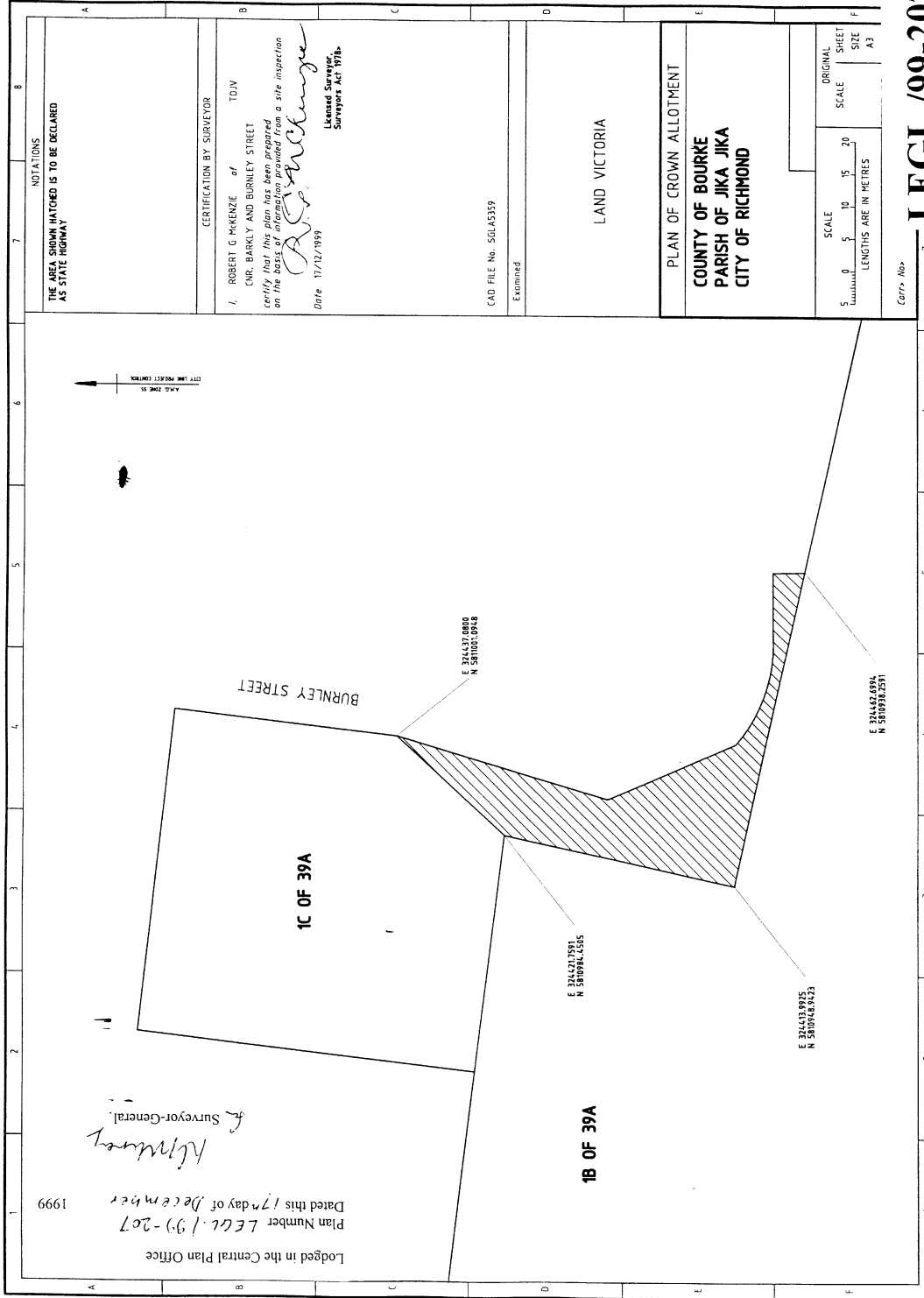

LECG.199-207

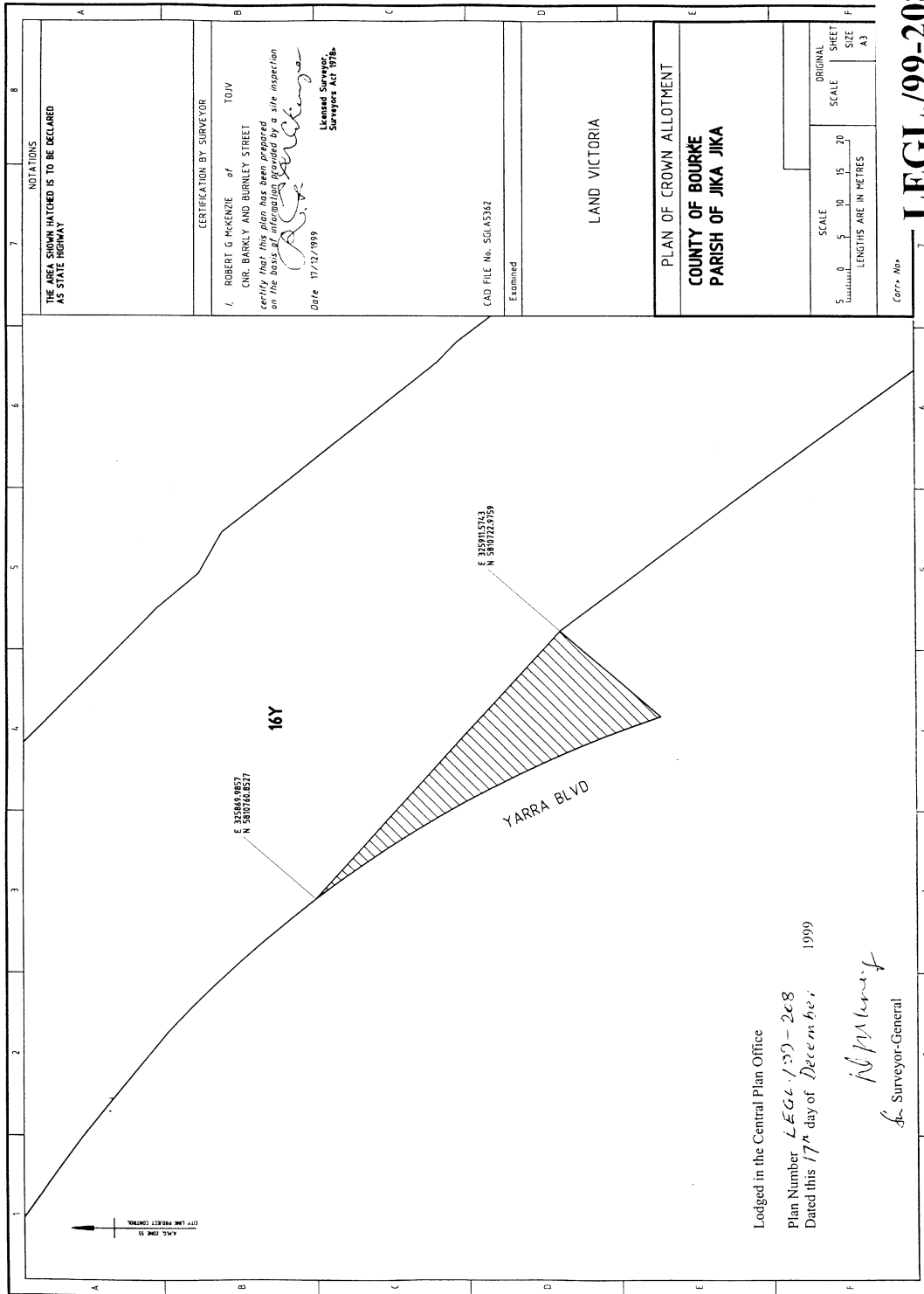

NOTATIONS

THE AREA SHOWN HATCHED IS TO BE DECLARED AS STATE HIGHWAY

CERTIFICATION BY SURVEYOR

I, ROBERT G MCKENZIE of TOIV CNR BARKLY AND BURNLEY STREET certify that this plan has been prepared on the basis of an inspection made by a site inspection

[Signature]

Date: 17/12/1999

Licensed Surveyor, Surveyors Act 1978.

CAD FILE No. SCLAS342

Examined

LAND VICTORIA

PLAN OF CROWN ALLOTMENT

COUNTY OF BOURKE

PARISH OF JIKA JIKA

SCALE	SCALE	ORIGINAL
0 5 10 15 20	SCALE	SHEET
LENGTHS ARE IN METRES		SIZE
		A3

Corr. No.

L.F.G.L./99-208

STATE PROJECT CONTROL

SCALE 1:500

Lodged in the Central Plan Office

Plan Number L.F.G.L./99-208

Dated this 17th day of December, 1999

[Signature]

Surveyor-General

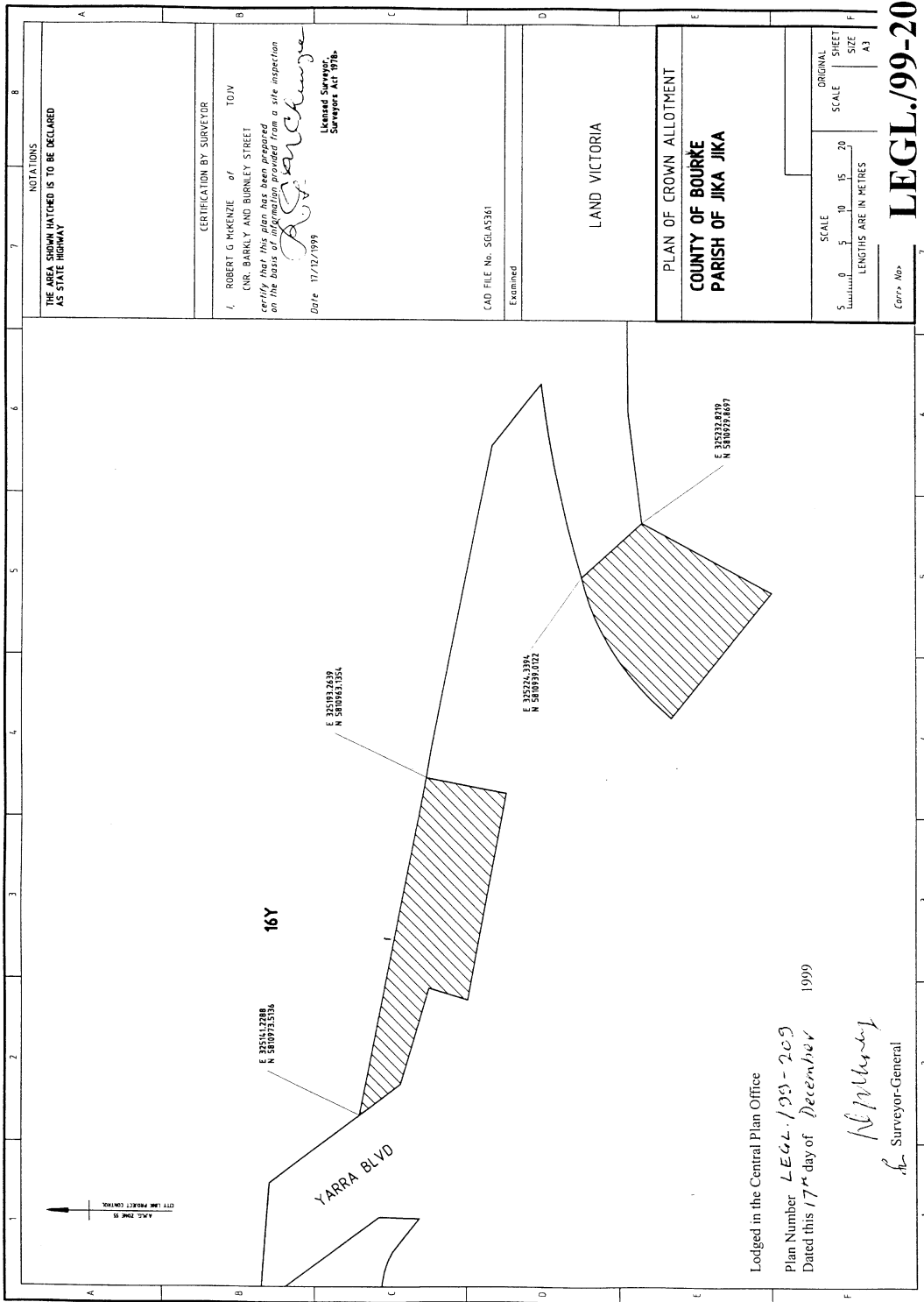

NOTATIONS
THE AREA SHOWN HATCHED IS TO BE DECLARED AS STATE HIGHWAY

CERTIFICATION BY SURVEYOR
I, ROBERT G. MCKENZIE of TOJV
CNR BARAKLY AND BURLEY STREET
16Y, have the plan prepared
on the basis of information obtained from a site inspection
Date 17/12/1999
Robert G. McKenzie
Licensed Surveyor,
Surveyors Act 1976.

CAD FILE No. SGLA5361
Examined

LAND VICTORIA

PLAN OF CROWN ALLOTMENT
COUNTY OF BOURKE
PARISH OF JIKA JIKA

SCALE
0 5 10 15 20
LENGTHS ARE IN METRES
ORIGINAL SHEET SIZE A3

Lodged in the Central Plan Office
Plan Number LEGL./99-209
Dated this 17th day of December 1999
R. McKenzie
Surveyor-General

LEGL./99-209

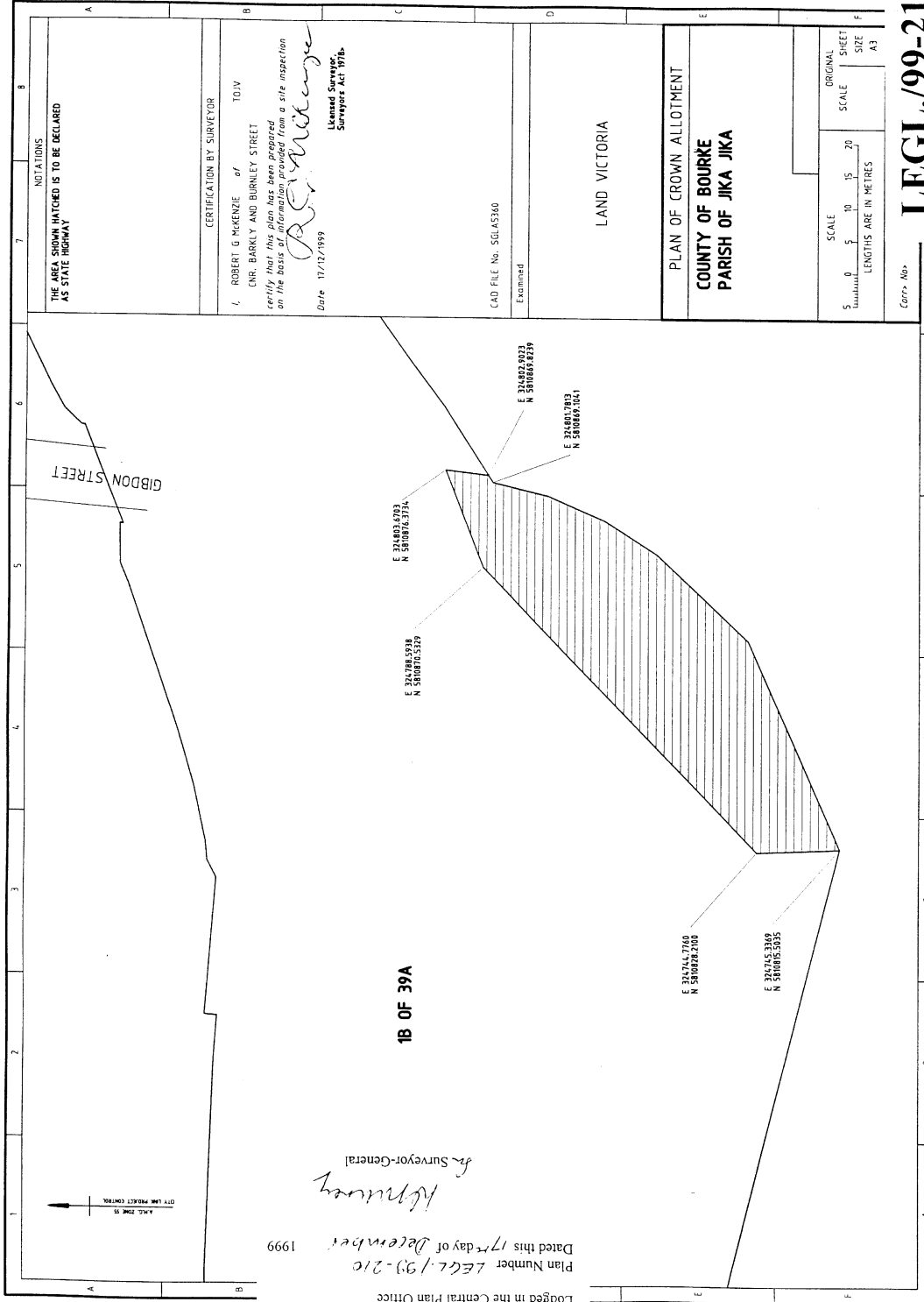

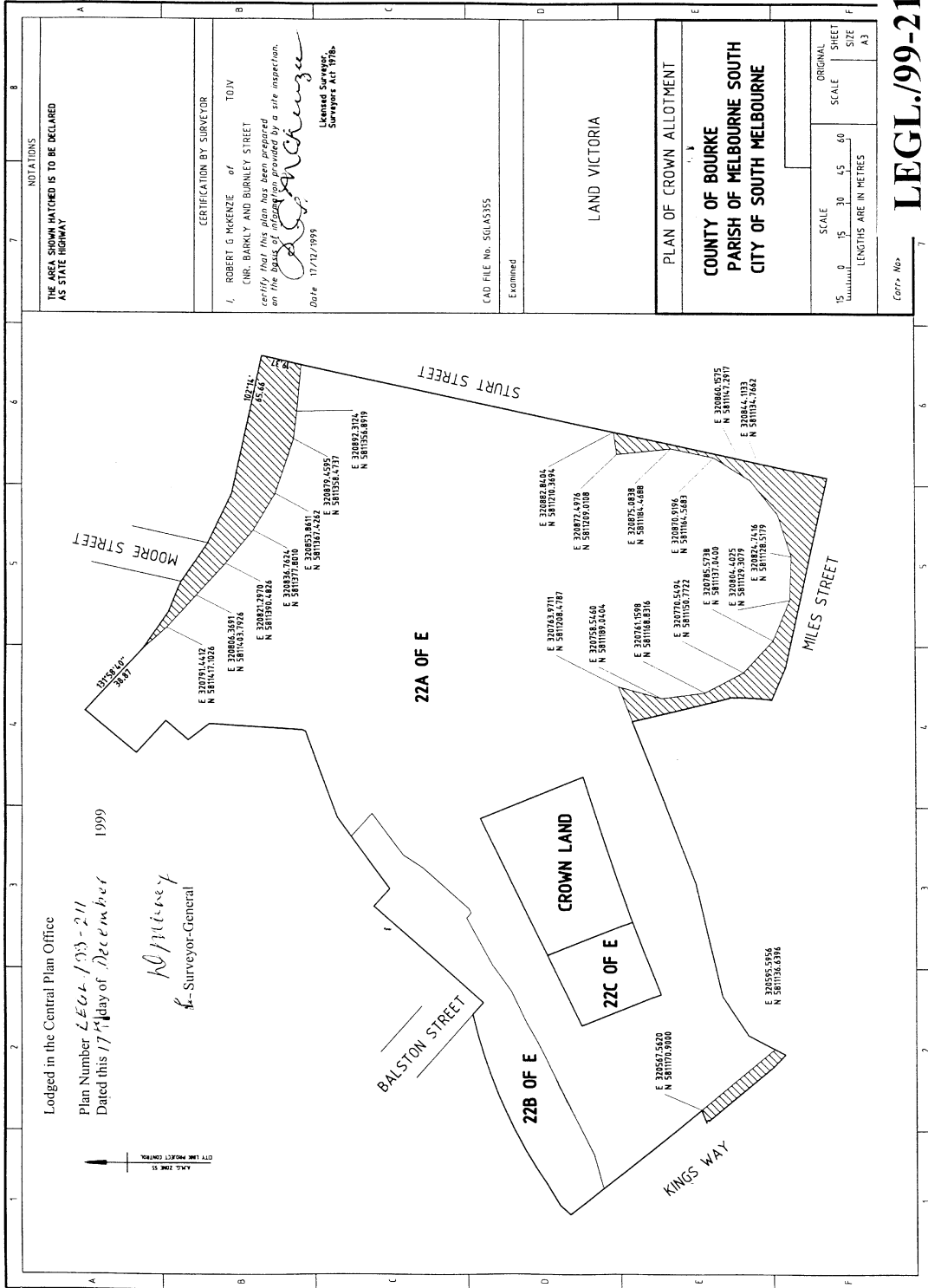

LEG-1993-211

Copy No.

SCALE
15 30 45 60
LENGTHS ARE IN METRES

ORIGINAL
SCALE
SHEET
SIZE
A3

PLAN OF CROWN ALLOTMENT
COUNTY OF BOURKE
PARISH OF MELBOURNE SOUTH
CITY OF SOUTH MELBOURNE

LAND VICTORIA
Examined
CAD FILE No. SGLA3555

NOTATIONS
THE AREA SHOWN HATCHED IS TO BE DECLARED AS STATE HIGHWAY



CERTIFICATION BY SURVEYOR
I, ROBERT G MCKENZIE of
CHR. BARKLY AND BURNLEY STREET
TOIV
certify that this plan has been inspected
on the basis of information provided by a site inspection.
Robert G. McKenzie
Date 17/12/1999
Licensed Surveyor
Surveyors Act 1978.

Lodged in the Central Plan Office
Plan Number LEG-1993-211
Dated this 17th day of December 1999
Anthony
Surveyor-General

PLANS AND DIAGRAMS OF THE SOUTHERN LINK

NOTE: The following Plans and Diagrams are published for information purposes only. They show the parts of the Southern Link roads that are declared as roads under the **Melbourne City Link Act 1995**. For details of Allotment and road boundaries, refer to the plans listed in Schedule 1 to the road declaration instrument. These are available at the Land and Survey Information Centre, Department of Natural Resources and Environment, Ground Floor, 456 Lonsdale Street, Melbourne

KEY:

-  The Allotments and parts of Allotments shown with diagonal hatching are being declared as roads for the first time.
-  The Allotments and parts of Allotments shown with no hatching were already declared as roads by previous road declaration instruments. They have been redeclared as roads by the road declaration instrument published in this Gazette.
-  The areas shown with cross-hatching are not declared as roads under the **Melbourne City Link Act 1995**.

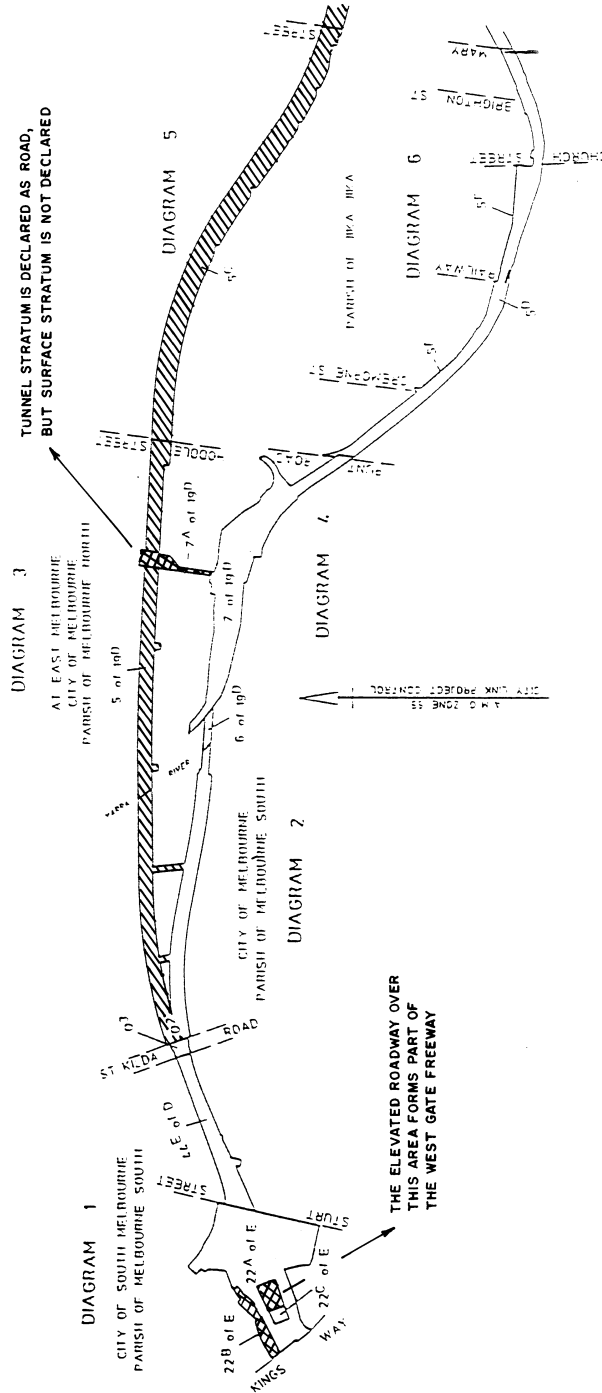

PLAN A

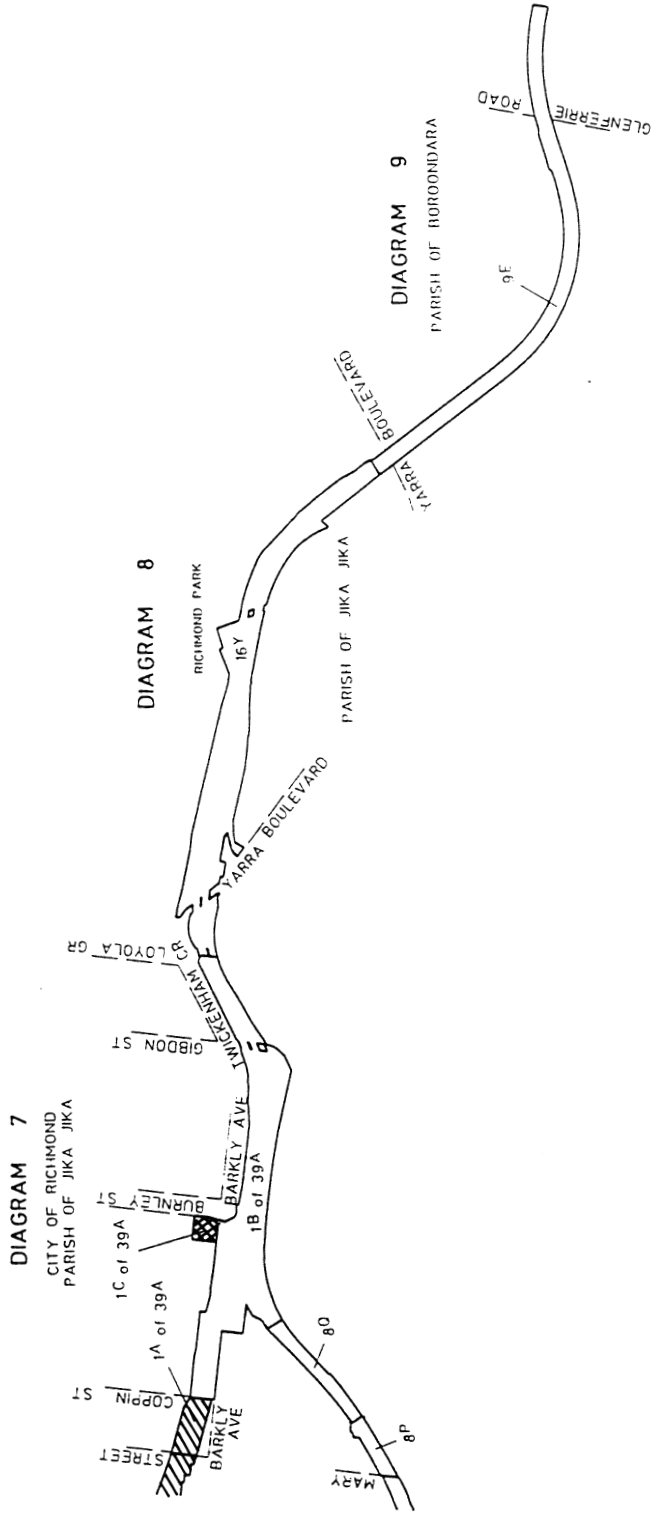

PLAN B

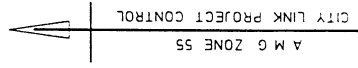
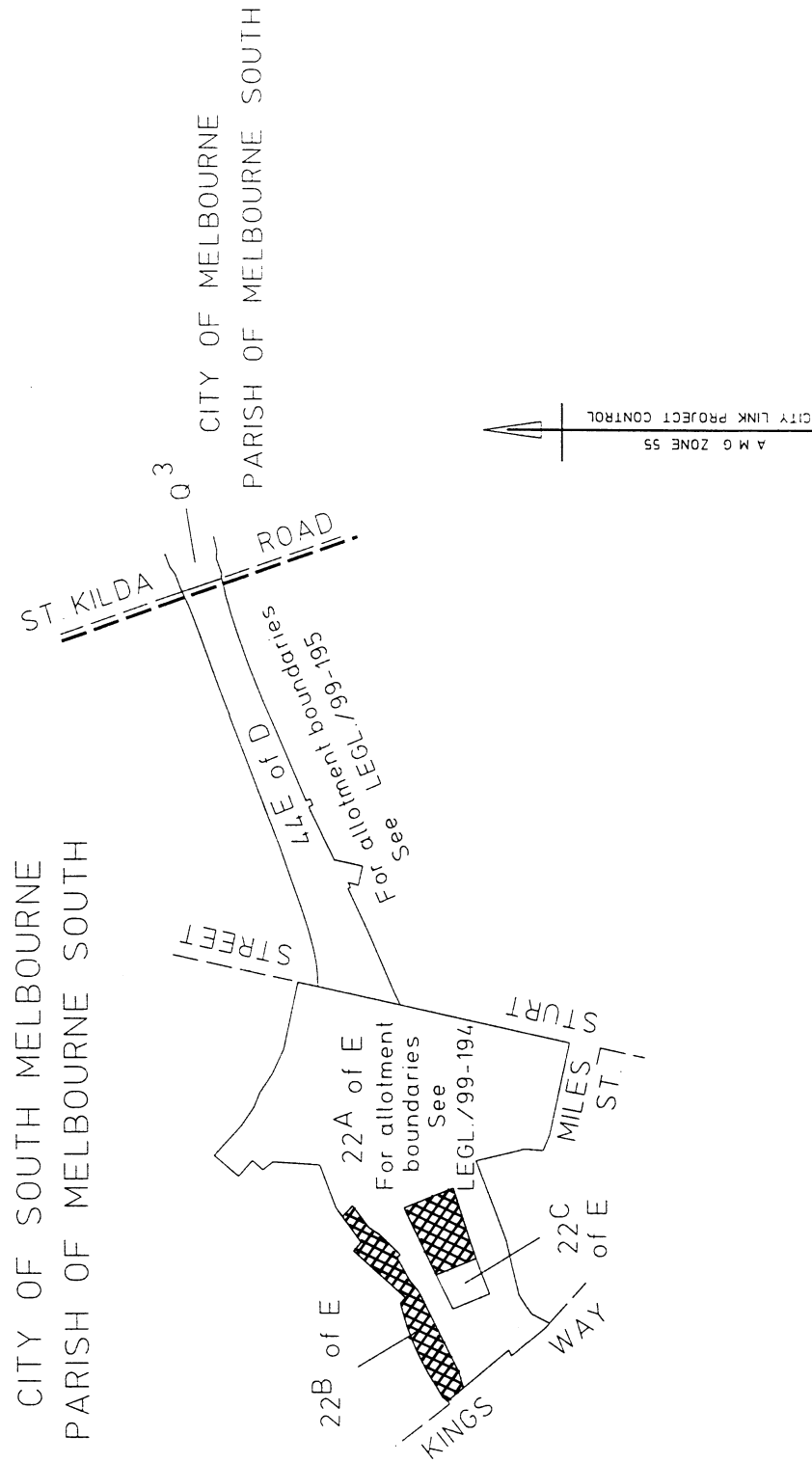
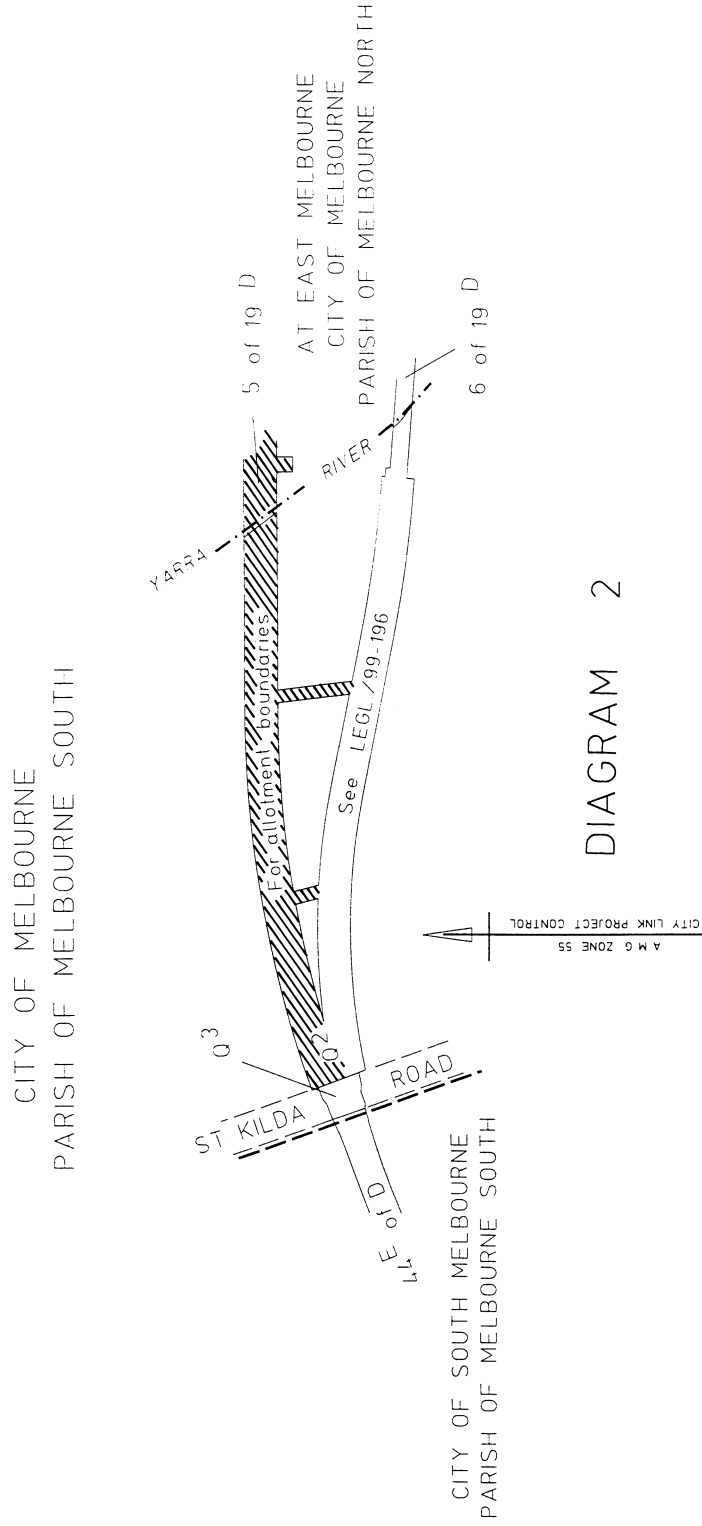

DIAGRAM 1



AT EAST MELBOURNE
CITY OF MELBOURNE
PARISH OF MELBOURNE NORTH

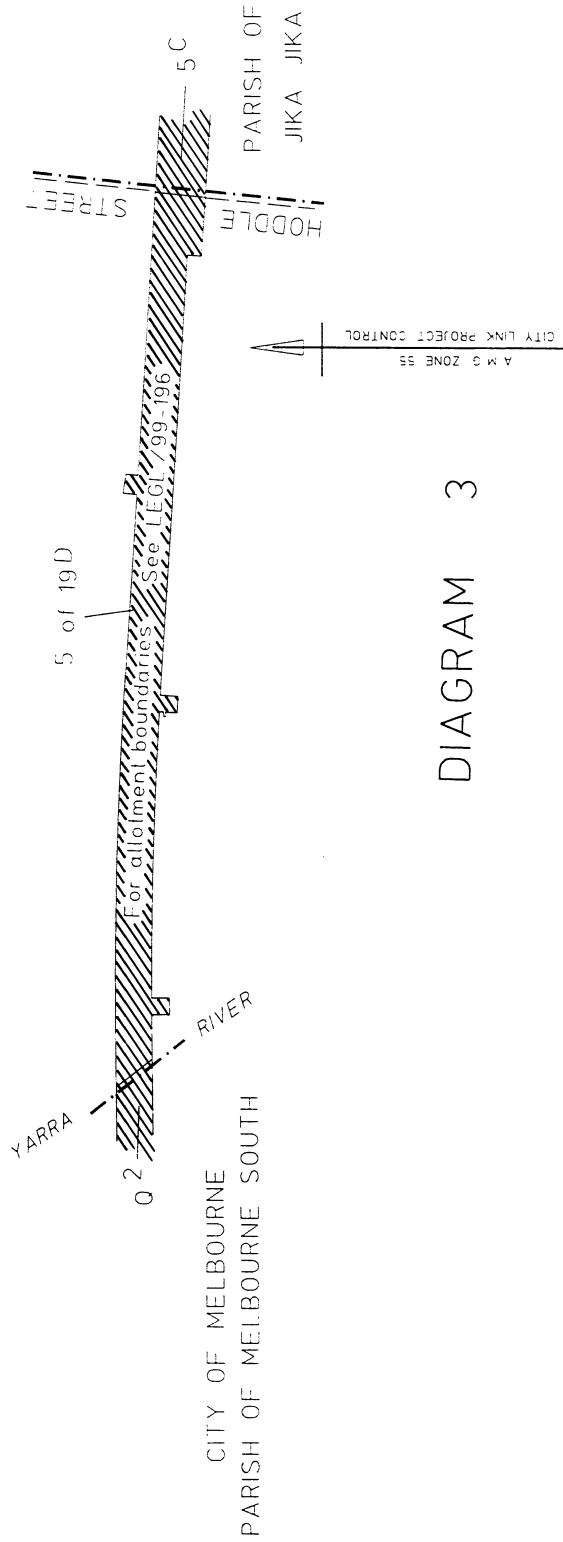

DIAGRAM 3

AT EAST MELBOURNE
CITY OF MELBOURNE
PARISH OF MELBOURNE NORTH

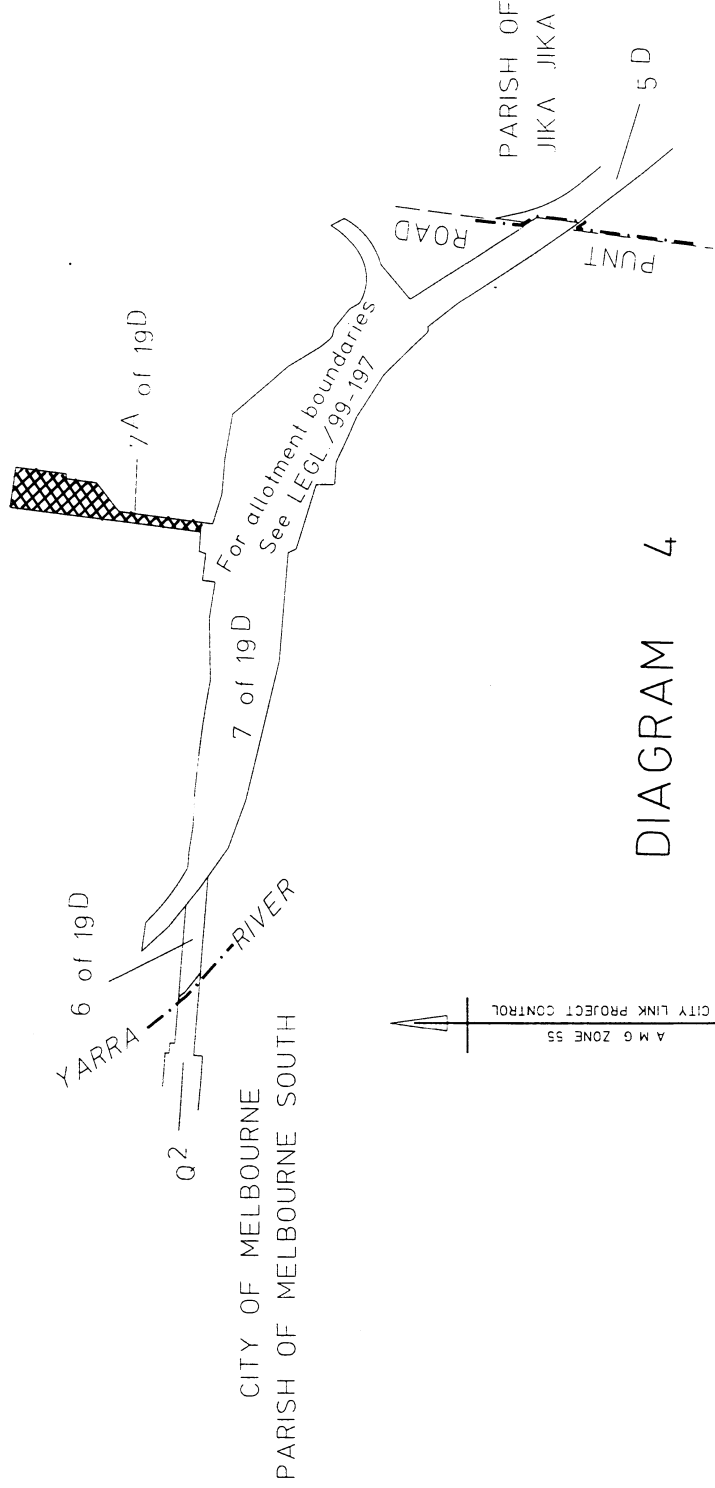
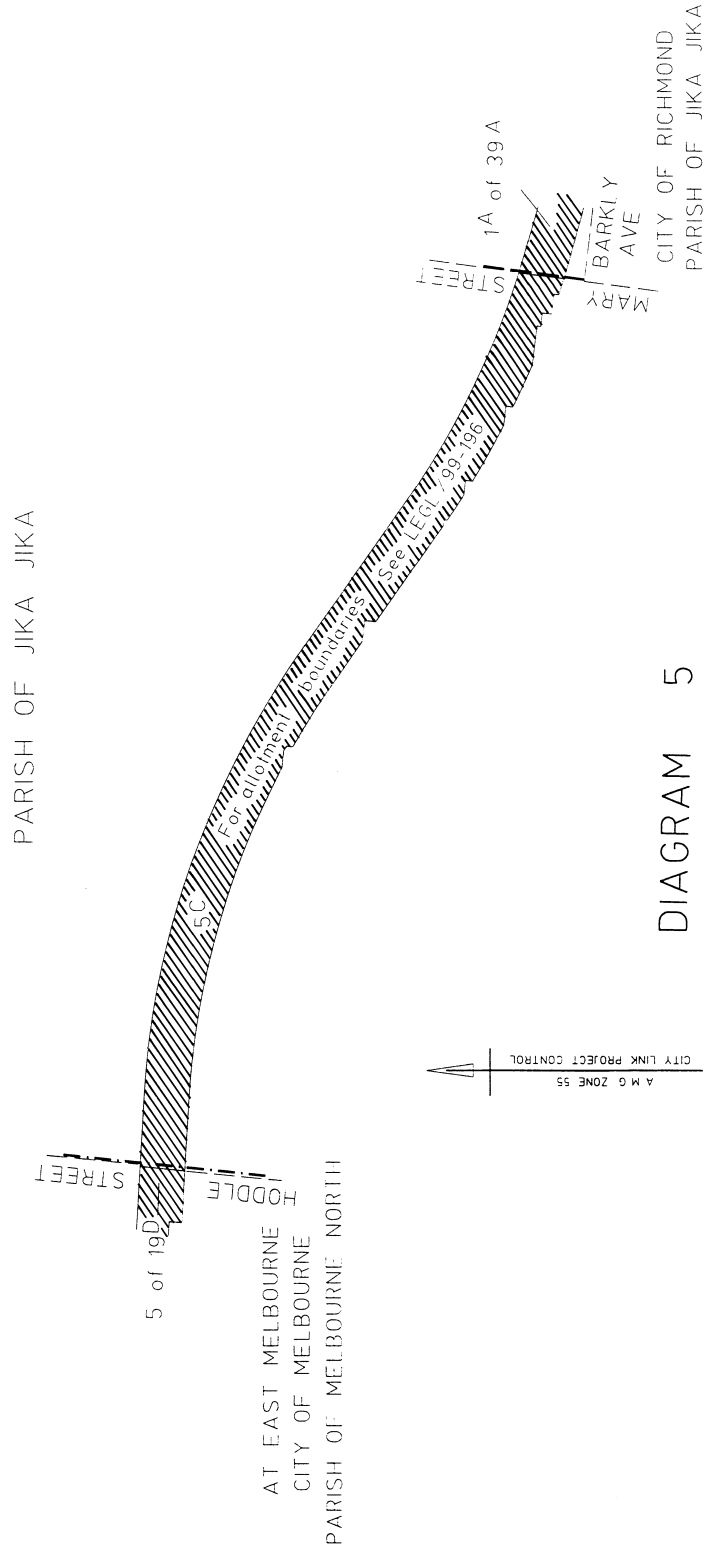

DIAGRAM 4



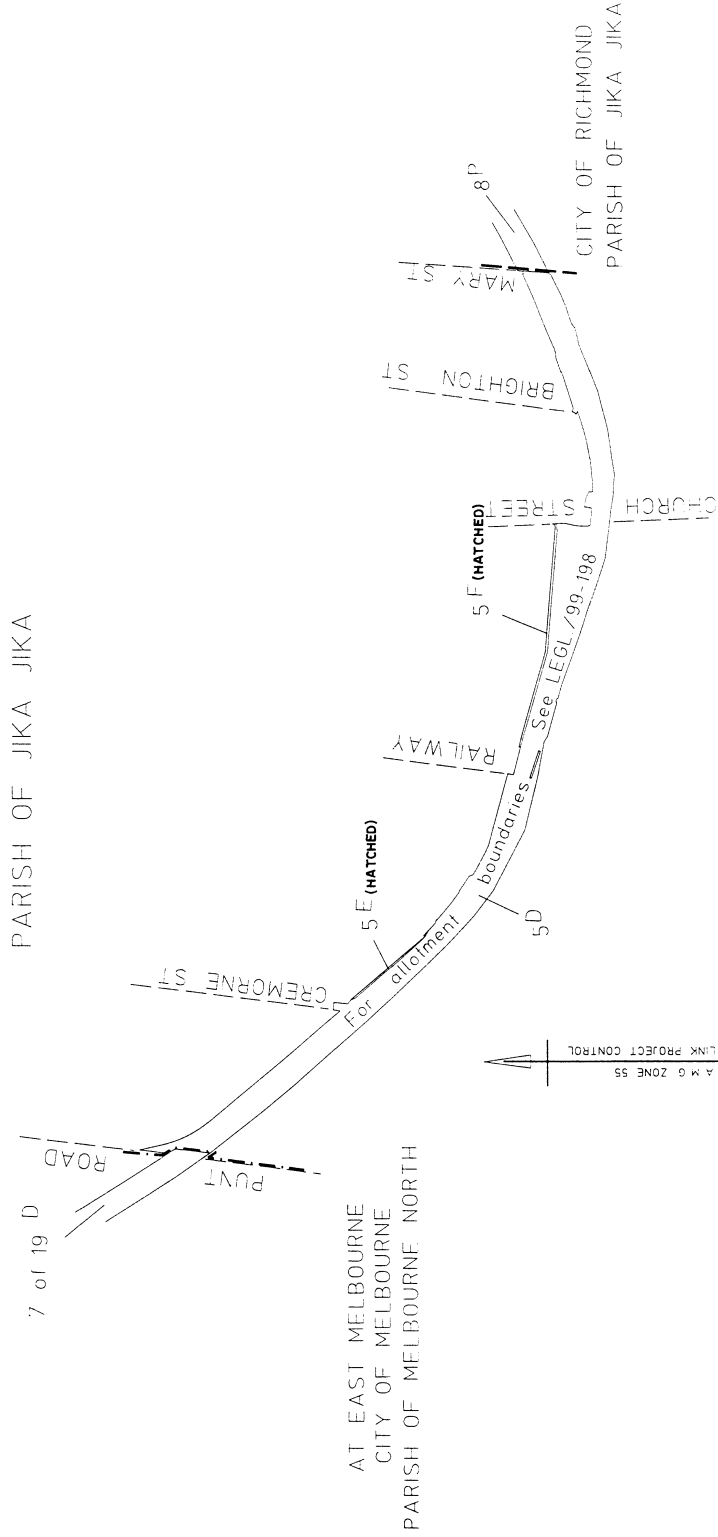

DIAGRAM 6

CITY OF RICHMOND
PARISH OF JIKA JIKA

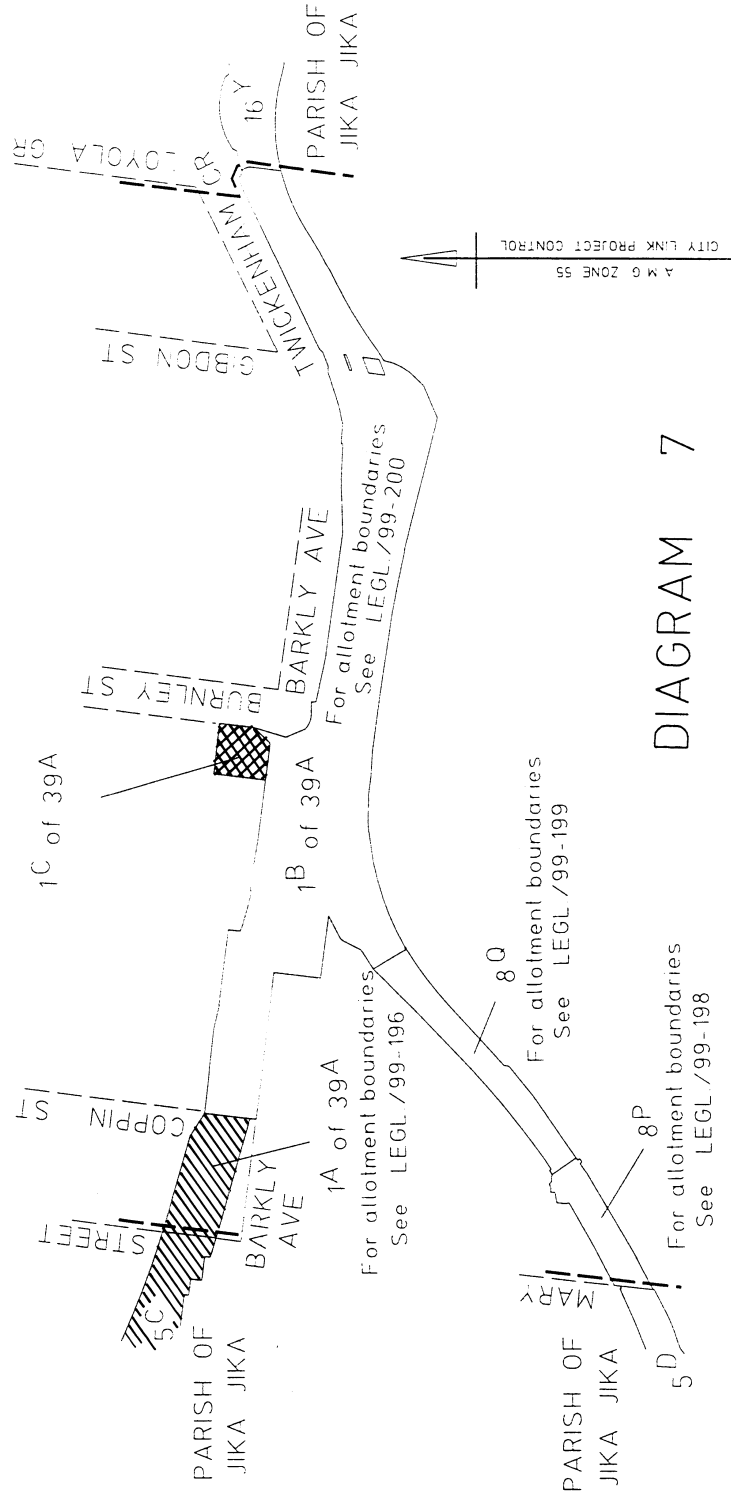
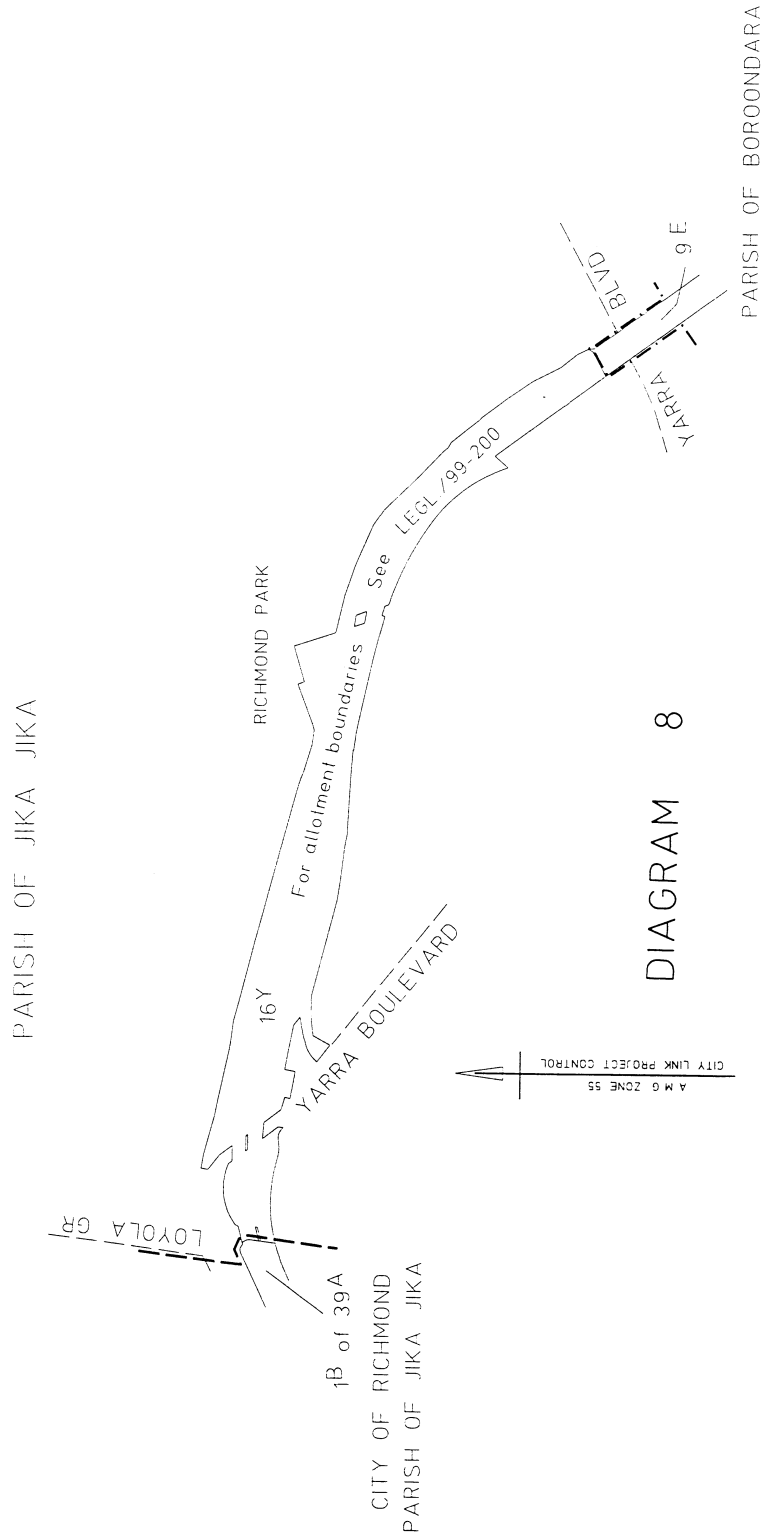

DIAGRAM 7



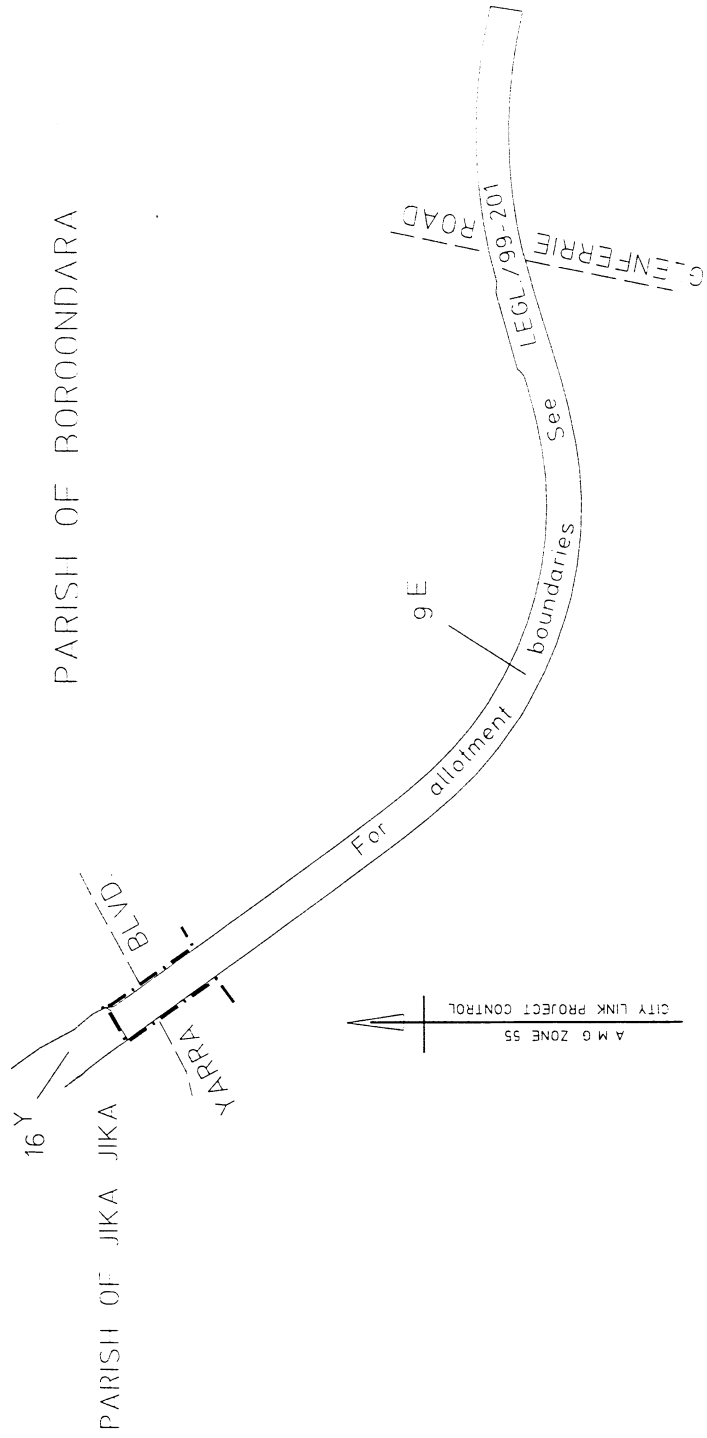

DIAGRAM 9

Gazette Services

The *Victorian Government Gazette* (VGG) is published by The Craftsman Press Pty. Ltd. for the State of Victoria and is produced in three editions.

VGG General is published each Thursday and provides information regarding Acts of Parliament and their effective date of operation; Government notices; requests for tenders; as well as contracts accepted. Private Notices are also published.

VGG Special is published any day when required for urgent or special Government notices. VGG Special is made available automatically to subscribers of VGG General.

VGG Periodical is published when required and includes specialised information eg. Medical, Dental, Pharmacist's Registers, etc.

Subscriptions

VGG is available by three subscription services:

The Victoria Government Gazette
 General and Special — \$170.00 each year
 General, Special and Periodical — \$227.00 each year
 Periodical — \$113.00 each year.

Subscriptions are payable in advance and accepted for a period of one year. All subscriptions are on a firm basis and refunds will not be given.

All payments should be made payable to
 The Craftsman Press Pty. Ltd.

Subscription enquiries:

The Craftsman Press Pty. Ltd.
 125 Highbury Road, Burwood Vic 3125
 Telephone: (03) 9926 1233
 Fax (03) 9926 1292

The Victoria Government Gazette is published by
 The Craftsman Press Pty. Ltd. with the authority of the
 Government Printer for the State of Victoria

© State of Victoria 1999

ISSN 0819-5471

This publication is copyright. No parts may be reproduced
 by any process except in accordance with the provisions of
 the Copyright Act.

Products and services advertised in this publication are not
 endorsed by The Craftsman Press Pty. Ltd. or the State of
 Victoria and neither of them accepts any responsibility for
 the content or the quality of reproduction. The Craftsman
 Press Pty. Ltd. reserves the right to reject any advertising
 material it considers unsuitable for government
 publication.

Address all inquiries to the Government Printer for the
 State of Victoria

Government Information and Communications Branch

Department of Premier and Cabinet

Level 3, 356 Collins Street

Melbourne 3000

Victoria Australia

Subscriptions

The Craftsman Press Pty. Ltd.

125 Highbury Road, Burwood

Victoria, Australia 3125

Telephone enquiries: (03) 9926 1233

Facsimile (03) 9926 1292

Retail Sales

Information Victoria Bookshop

356 Collins Street Melbourne 3000.

Telephone enquiries 1300 366 356

City Graphics

2nd Floor, 4 Bank Place

Melbourne 3000

Telephone enquiries (03) 9600 0977

Price Code B