



Victoria Government Gazette

No. G 49 Thursday 7 December 2000

GENERAL

GENERAL AND PERIODICAL GAZETTE

Copy to: Gazette Officer
The Craftsman Press Pty. Ltd.
125 Highbury Road,
Burwood Vic 3125
Telephone: (03) 9926 1233
Facsimile: (03) 9926 1292
DX: 32510 Burwood
Email: gazette@craftpress.com.au

Advertising Rates and Payment

Private Notices

Payment must be received in advance with advertisement details.

30 cents per word - Full page \$180.00.

Additional costs must be included in prepayment if a copy of the gazette is required. Copy Prices - Page

\$1.50 - Gazette \$3.20 Certified copy of Gazette \$3.50. (all prices include Postage). **Cheques should be made payable to The Craftsman Press Pty. Ltd.**

Government and Outer Budget Sector Agencies Notices

Not required to pre-pay.

Advertisements may be faxed or sent via email with a cover sheet, marked to the attention of the Gazette Officer.

Floppy Disks (Mac & PC) can also be accepted.

Costs can be calculated on the following basis:

| Per Line | Typeset |
|---------------|---------|
| Single column | \$1.55 |
| Double column | \$3.10 |
| Full Page | \$64.80 |

The Craftsman Press is pleased to offer a series of discounts from the typesetting costs.

1. Copy supplied on disk.
2. Copy supplied via email.
3. Artwork for forms and other material which require exact reproduction.

1. Copy supplied on disk.

Where a disk is supplied and there is minimum alteration required, **30% off.**

Where a disk is supplied requiring extraneous matter stripped out and styles applied, **20% off.**

2. Copy supplied via email.

Where a notice is sent via email and there is minimum alteration required, **25% off.**

Where email is supplied requiring extraneous matter stripped out and styles applied, **15% off.**

3. Artwork for forms and other material which requires exact reproduction.

Scanning and sizing of artwork for forms, to be reproduced in page format, **35% off.**

Copy Deadline for General Gazette

9.30 a.m. Monday - (Private Notices)

9.30 a.m. Tuesday - (Government and Outer Budget Sector Agencies Notices)

Advertisers should note:

- Late copy received at The Craftsman Press Pty. Ltd. after deadlines will be placed in the following issue of VGG, irrespective of any date/s mentioned in the copy (unless otherwise advised).
- Proofs will be supplied only when requested or at the direction of the Gazette Officer.
- No additions or amendments to material for publications will be accepted by telephone.
- Orders in Council may be lodged prior to receiving assent with the Governor's or Clerk's signature. They will only be published once approved and signed.
- Government and Outer Budget Sector Agencies please note: *See style requirements on back page.*

SPECIAL GAZETTES

Copy to: Gazette Officer
The Craftsman Press Pty. Ltd.
125 Highbury Road,
Burwood Vic 3125
Telephone: (03) 9926 1233
Facsimile: (03) 9926 1292
Email: gazette@craftpress.com.au

Advertising Rates and Payment

Private Notices

Full Page \$360.00

Payment must be received in advance with notice details.

Government and Outer Budget Sector Agencies Notices

| | |
|-----------|---------|
| | Typeset |
| Full Page | \$87.50 |

Note:

The after hours number for Special Gazettes is:
Telephone: 0419 327 321

SUBSCRIPTIONS AND RETAIL SALES

Copies of the Victoria Government Gazette can be purchased from The Craftsman Press Pty. Ltd. by subscription.

The Victoria Government Gazette

General and Special - \$170.00 each year

General, Special and Periodical - \$227.00 each year

Periodical - \$113.00 each year

Subscriptions are payable in advance and accepted for a period of one year. All subscriptions are on a firm basis and refunds will not be given.

All payments should be made payable to The Craftsman Press Pty. Ltd.

Subscription enquiries:

The Craftsman Press Pty. Ltd.
125 Highbury Road, Burwood Vic 3125
Telephone: (03) 9926 1233

INDEX TO PRIVATE ADVERTISERS

A

| | |
|--------------------------------|-------|
| A. B. Natoli Pty | .2858 |
| Aitken Walker & Strachan | .2858 |
| AXA Trustees Limited | .2859 |

B

| | |
|----------------------------------|-------|
| Basile & Co. Pty. Ltd. | .2859 |
| Borchard & Moore | .2859 |
| Bruce M. Cook & Associates | .2860 |

C

| | |
|-------------------|-------|
| Celina Roth | .2860 |
|-------------------|-------|

D

| | |
|-------------------------------|-------|
| Deacons | .2860 |
| Dwyer Mahon & Robertson | .2860 |

G

| | |
|-------------------------|-------|
| Gilbert Bell & Co. | .2860 |
|-------------------------|-------|

L

| | |
|--------------------------------|-------|
| Lawson Hughes McComas | .2861 |
| Lester Fielden & Faraone | .2861 |

M

| | |
|---------------------------|-------|
| McKean & Park | .2861 |
| Mason Sier Turnbull | .2861 |

N

| | |
|---------------------|-------|
| Nunan & Bloom | .2861 |
|---------------------|-------|

P

| | |
|---|-------|
| Paul McGuinness & Associates Pty ... | .2862 |
| Pearce Webster Dugdales | .2862 |
| Perpetual Trustees Victoria Limited ... | .2862 |

R

| | |
|------------------------|-------|
| Roberts Partners | .2862 |
|------------------------|-------|

V

| | |
|---------------------|-------|
| Verna A. Cook | .2862 |
|---------------------|-------|

W

| | |
|------------------------|-------|
| Wilckens & Roche | .2863 |
|------------------------|-------|

**PUBLICATION OF THE
VICTORIA GOVERNMENT
GAZETTE (GENERAL)
CHRISTMAS/NEW YEAR PERIOD**

PLEASE NOTE:

The final issue of the Victoria Government Gazette for 2000 will be published on Thursday 21 December 2000. Copy deadlines for this issue remain unchanged ie copy for Private Advertisements must reach the Government Gazette Office by 9.30 am on Monday 18 December 2000. Copy for Government and Outer Budget Sector Agencies Notices must reach the Government Gazette Office by 9.30 am on Tuesday 19 December 2000.

The first issue of the General Gazette for 2001 will be published on Thursday 4 January 2001, and thereafter on each Thursday.

Where urgent gazettal is required after hours, arrangements should be made with Ann White on 0419 327 321.

ANN WHITE
Government Gazette Officer

PRIVATE ADVERTISEMENTS

Land Act 1958

Notice is hereby given that Powercor Australia Limited has applied for a lease pursuant to Section 134 of the **Land Act 1958** for a term of 21 years in respect of Allotment 24A in the Parish of Toltol containing 120 square metres as a site for a Radio Station.

DISSOLUTION OF PARTNERSHIP

Notice is hereby given that the partnership previously subsisting between Mary Careri and Ralph Crea carrying on business as an accountancy firm at Moonee Ponds, Victoria, under the style or firm of Taxwise Consultants, has been dissolved as from 5.00 p.m., 17 November 2000. This notice is given pursuant to section 41 of the Partnership Act 1958.

HOLDING REDLICH, lawyers,
350 William Street, Melbourne, Vic. 3000.

DISSOLUTION OF PARTNERSHIP

Notice is hereby given that the partnership previously subsisting between Ian Leslie Kent and Bronwyn Jane Kent carrying on business as plasterers at Black Rock, Victoria, under the name "IL & BJ Kent" dissolved by mutual consent on 30 June 1999.

KYROU DEFREITAS & ASSOCIATES,
solicitors,
1st Floor, 14 Balcombe Road, Mentone 3194.

**NOTICE OF DISSOLUTION OF
PARTNERSHIP AGREEMENT**

Notice is hereby given that the partnership subsisting between the undersigned Gregory Michael Read and Scott David Welsh, carrying on business as Read's Reliable Gardening at 25 Dawson Street, Reservoir, in the State of Victoria and at 23 Godfrey Street, North Sunshine, in the said State, has been dissolved by mutual consent as and from 30 November 2000. All debts due and owing by the said late firm will be received and paid by Gregory Michael Read who will continue to carry on the business at 25 Dawson Street, Reservoir, in the said State.

B.T.E. FLYNN MURONE & CO., solicitors,
125 Bell Street, Coburg.

DISSOLUTION OF PARTNERSHIP

Take notice that the partnership previously subsisting between Lacemore Amber Pty Ltd (A.C.N. 079 023 144) and Mark Raberger Physiotherapy Pty Ltd (A.C.N. 005 555 724) and trading as Waverley Park Physiotherapy Centre, McKinley Industrial Physiotherapy, McKinley Industrial Ergonomics and McKinley Industrial Ergonomics and Rehabilitation at 439 Police Road, Mulgrave has been dissolved with effect from 23 October 2000. The practices of Waverley Park Physiotherapy Centre and McKinley Industrial Physiotherapy will be continued by Lacemore Amber Pty Ltd and the practices of McKinley Industrial Ergonomics and McKinley Industrial Ergonomics and Rehabilitation will be continued by Mark Raberger Physiotherapy Pty Ltd.

MASON SIER TURNBULL, solicitors,
5 Hamilton Place, Mount Waverley.

RONALD ALBERT THOMPSON, late of 22 Coronation Street, West Footscray, Victoria, pensioner, deceased. Creditors, next-of-kin and others having claims in respect of the estate of the abovenamed deceased, who died on 24 October 2000, are required by Iris Joan Gardner of 3 Reilly Street, Springvale, Victoria, pensioner, the executor of the deceased's will, to send particulars of their claim to the said executor care of the undermentioned solicitors by 15 February 2001 after which date they will convey or distribute the assets having regard only to the claims which they then have notice.

A. B. NATOLI PTY, solicitors,
24 Cotham Road, Kew 3101.

NORMAN WILLIAM CAIRNES, late of "Broadmead" 27 Wattle Road, Hawthorn, retired, deceased. Creditors, next-of-kin and others having claims in respect of the estate of the deceased, who died on 11 September 2000, are required by the personal representatives, Robert Russell Aitken and Philip Edginton Aitken, both of 114 William Street, Melbourne, to send particulars to them care of the undermentioned solicitors by 15 February 2001 after which date the personal representatives may convey or distribute the assets having

regard only to the claims of which they then have notice.

AITKEN WALKER & STRACHAN, solicitors,
114 William Street, Melbourne 3000.

GEORGE MONTAGUE RENNISON BOND, late of Bayview Nursing Home, 26 Fernhill Road, Sandringham, retired. Creditors, next-of-kin and others having claims in respect of the estate of the deceased, who died on 16 July 2000, are required by AXA Trustees Ltd of 65 Southbank Boulevard, Southbank, Victoria 3006, the applicant for a grant of probate, to send particulars to it by 19 February 2001 after which date the applicant for a grant of probate may convey or distribute the assets having regard only to the claims of which it then has notice.

AXA TRUSTEES LIMITED,
65 Southbank Boulevard, Southbank 3006.

ELVA SOPHIA HAYES, late of Kingston Centre, Warrigal Road, Cheltenham, widow. Creditors, next-of-kin and others having claims in respect of the estate of the deceased, who died on 31 July 2000, are required by AXA Trustees Ltd of 65 Southbank Boulevard, Southbank, Victoria 3006, the applicant for a grant of probate, to send particulars to it by 19 February 2001 after which date the applicant for a grant of probate may convey or distribute the assets having regard only to the claims of which it then has notice.

AXA TRUSTEES LIMITED,
65 Southbank Boulevard, Southbank 3006.

Re: Estate JAMES HENRY BELL, deceased. In the estate of JAMES HENRY BELL, late of Eliza House, Barham, in the State of New South Wales, gentleman, deceased. Creditors, next-of-kin and all other persons having claims against the estate of the said deceased, are required by Peter Anthony Bell of 101 Grigg Road, Koondrook, Victoria and Michael Stephen Bell of 109 Grigg Road, Koondrook, Victoria, the executors of the will of the said deceased, to send particulars of such claims to her in care of the undermentioned solicitors within two months from the date of publication of this notice after which date she will distribute the assets having regard only to the claims of which they then have notice.

BASILE & CO PTY LTD, legal practitioners,
46 Wellington Street, Kerang, Vic. 3579.

Re: Estate MARY JOYCE DAVEY, deceased. In the estate of MARY JOYCE DAVEY, late of 205 Westblade Avenue, Kerang, in the State of Victoria, pensioner, deceased. Creditors, next-of-kin and all other persons having claims against the estate of the said deceased, are required by Harold Alfred Davey of 34 Mitchell Street, Kerang, Victoria and Geoffrey Kenneth Davey of Airport Road, Kerang 3579, the executors of the will of the said deceased, to send particulars of such claims to them in care of the undermentioned solicitors within two months from the date of publication of this notice, after which date they will distribute the assets having regard only to the claims of which they then have notice.

BASILE & CO PTY LTD, legal practitioners,
46 Wellington Street, Kerang, Vic. 3579.

Re: Estate STANLEY GEORGE McINDOE, deceased. In the estate of STANLEY GEORGE McINDOE, late of 42 Marne Street, Kerang, in the State of Victoria, pensioner, deceased. Creditors, next-of-kin and all other persons having claims against the estate of the said deceased, are required by Geoffrey Robert McIndoe of 13 McAdam Court, Swan Hill 3585, Victoria and Neil Ashlen McIndoe of 18 Park Road, Kerang 3579, Victoria, the executors of the will of the said deceased, to send particulars of such claims to her in care of the undermentioned solicitors within two months from the date of publication of this notice after which date she will distribute the assets having regard only to the claims of which they then have notice.

BASILE & CO PTY LTD., legal practitioners,
46 Wellington Street, Kerang, Vic. 3579.

Creditors, next-of-kin and others having claims in respect of the estate of KAY MARILYN LEYDEN, (also known as Kay Leyden), late of Unit 1, 24 Vizard Street, Dandenong, Victoria, pensioner, deceased, who died on 2 June 2000, are required to send particulars of their claims to the administrator care of the undermentioned solicitors by 2 February 2001 after which date the administrator will distribute the assets having regard only to the claims for which notice has been received.

BORCHARD & MOORE, solicitors,
44 Douglas Street, Noble Park.

Creditors, next-of-kin and others having claims in respect of the estate of GRACE WHELDON, formerly of 53 Croydon Avenue, Croydon, New South Wales, but late of St. Paul's Court, 1315 Nolan Street, Frankston, Victoria, retired clerk, deceased, who died on 5 May 2000, are required to send particulars of their claims to the executrix care of the undermentioned solicitors by 5 February 2001 after which date the executrix will distribute the assets having regard only to the claims for which notice has been received.

BORCHARD & MOORE, solicitors,
44 Douglas Street, Noble Park.

Re: Estate FRANK LAURENCE BLACKMAN, deceased. Creditors, next-of-kin or others having claims in respect of the estate of FRANK LAURENCE BLACKMAN, late of Glendale Aged Care Hostel, 1 Glendale Court, Werribee, in the State of Victoria, retired, who died on 1 September 2000, are to send particulars of their claims to the personal representative/s care of the undermentioned solicitors by 8 February 2001 after which date the personal representative/s will distribute the assets having regard only to the claims of which they then had notice.

BRUCE M. COOK & ASSOCIATES,
barristers & solicitors,
Level 4, St James Building,
121 William Street, Melbourne, Vic. 3000.

Re: Estate ETHEL ADA HILL, deceased. Creditors, next-of-kin or others having claims in respect of the estate of ETHEL ADA HILL, of 6 Loch Street, East Geelong, in the State of Victoria, widow, who died on 6 October 2000, are to send particulars of their claims to the personal representative/s care of the undermentioned solicitors by 8 February 2001 after which date the personal representative/s will distribute the assets having regard only to the claims of which they then had notice.

BRUCE M. COOK & ASSOCIATES,
solicitors,
Level 4, St James Building,
121 William Street, Melbourne, Vic. 3000.

Creditors, next-of-kin and others having claims in respect of the estate of CZESLAWA

SZYLING, late of Unit 11, 24 Hughenden Road, St. Kilda East, in the State of Victoria, the deceased, who died on 7 August 2000, are required by Elza Schilling, the executor named in the will of the said Czeslawa Szyling, to send particulars to her care of the undermentioned solicitors by a date not later than two months from the date of publication hereof, after which date she will distribute the assets having regard only to the claims of which notice has been received.

CELINA ROTH, lawyer,
146 Church Street, Brighton 3186.

ROSE DIANA CROWTHER, late of 5 Torresdale Court, Toorak, Victoria, deceased. Creditors, next-of-kin and others having claims in respect of the estate of the deceased, who died on 18 October 2000, are required by the personal representatives, Martin John O'Dell Armstrong and Robert Henry Neil Symons, both of 385 Bourke Street, Melbourne, Victoria, to send particulars to them care of the below mentioned solicitors by 7 February 2001 after which date the personal representatives may convey or distribute the assets having regard only to the claims of which they then have notice.

DEACONS, solicitors for the estate,
385 Bourke Street, Melbourne.

Re: Estate of THELMA MARY LOUISA HOLDEN. Creditors, next-of-kin or others having claims in respect of the estate of THELMA MARY LOUISA HOLDEN, late of ECU Swan Hill District Hospital, Splatt Street, Swan Hill, widow, deceased, who died on 18 October 2000, are to send particulars of their claim to the executor care of the undermentioned solicitors by 25 January 2001 after which date the executor will distribute the assets having regard only to the claims of which he then has notice.

DWYER MAHON & ROBERTSON, solicitors,
Beveridge Dome,
194-208 Beveridge Street, Swan Hill.

Creditors, next-of-kin and other persons having claims against the estate of BARBARA SHEPHERD WOOLLEY, late of 3128 Frankston-Flinders Road, Balnarring,

Victoria, retired bank officer, deceased, who died on 23 August 2000, are required by the administrator of her estate, Paul Shepherd Woolley of 15 Balwyn Road, Canterbury, Victoria, stockbroker, to send particulars of their claims to him care of the undersigned by 8 February 2001 after which date he may convey or distribute the estate having regard only to the claims of which he then has notice.

GILBERT BELL & CO., lawyers,
Level 1, 455 Bourke Street, Melbourne.

CHARLES PATRICK KANE-WHITE, late of 124 Maroondah Highway, Croydon, Victoria, gentleman, deceased. Creditors, next-of-kin and others having claims in respect of the estate of the abovenamed deceased, who died on 4 May 2000, are required by the executrix, Margaret Ouida Tinsley of 18 Mast Gully Road, Upwey, Victoria, to send particulars of their claims to the executrix care of the undermentioned solicitors by 20 February 2001 after which date the executrix will distribute the assets having regard only to the claims of which the executrix then has notice.

LAWSON HUGHES McCOMAS, solicitors,
83 William Street, Melbourne.

LORRAINE DOROTHY SKATE, late of 22 Eumeralla Road, South Caulfield, Victoria, widow, deceased. Creditors, next-of-kin and others having claims in respect of the estate of the abovenamed deceased, who died on 28 May 2000, are required by the executor, Equity Trustees Limited of 472 Bourke Street, Melbourne, Victoria, to send particulars of their claims to the executor care of the undermentioned solicitors by 20 February 2001 after which date the executor will distribute the assets having regard only to the claims of which the executor then has notice.

LAWSON HUGHES McCOMAS, solicitors,
83 William Street, Melbourne.

Re: Estate of DORIS IRENE LATIMER, late of 4 Clarence Avenue, Carnegie, deceased. Creditors, next-of-kin and others having claims in respect of the estate of the deceased, who died on 23 July 2000, are required by the trustees, Walter Henry Henson and AXA Trustees Limited of 65 Southbank Boulevard, Southbank, Victoria, to send particulars to the trustees

by 21 February 2001 after which date the trustees may convey or distribute the assets having regard only to the claims of which the trustees have notice.

LESTER FIELDEN & FARAONE, solicitors,
14 Haughton Road, Oakleigh 3166.

Re: MYRA ANNIE GOUGH, late of 20 Burwood Road, Hawthorn, Victoria, deceased. Creditors, next-of-kin and others having claims in respect of the estate of the deceased, who died on 19 November 2000, are required by the trustees, Ian William Cox of "Four Oaks", Gardens Road, Rosebud, Victoria, retired solicitor and Mark Andrew Flynn of 405 Little Bourke Street, Melbourne, Victoria, solicitor, to send particulars to the trustees care of the undermentioned solicitors by 18 February 2001 after which date the trustees may convey or distribute the assets having regard only to the claims of which they then have notice.

McKEAN & PARK, solicitors,
405 Little Bourke Street, Melbourne.

Creditors, next-of-kin and others having claims in respect of the estate of ELLA JEAN RADNELL, late of Strathdon Nursing Home, Jolimont Road, Forest Hill, Victoria, retired, deceased, who died on 14 July 2000, are required to send particulars of their claims to the executors care of the undermentioned solicitors by 7 February 2001 after which date the executors will distribute the assets having regard only to the claims of which they then have notice.

MASON SIER TURNBULL, solicitors,
5 Hamilton Place, Mount Waverley.

Re: CORA COLMAN, deceased, Creditors, next-of-kin and others having claims in respect of the estate of CORA COLMAN, also known as Nina Colman, late of 21 Springfield Avenue, Toorak, who died on 31 August 2000, are to send particulars of their claims to the executor, John Thomas Bloom, care of the undermentioned solicitors by 7 February 2001 after which date the executor will distribute the assets having regard only to the claims of which the executor then has notice.

NUNAN & BLOOM, solicitors,
343 Little Collins Street, Melbourne.

HERBERT JAMES DUNSTONE, late of 8 Warranilla Avenue, Rosebud West, Victoria, retired, deceased. Creditors, next-of-kin and others having claims in respect of the estate of the deceased, who died on 15 September 2000, are required to send particulars of their claims to the trustee care of the undermentioned solicitors by 5 February 2001 after which date the trustee or personal representative or applicant for grant of administration may convey or distribute the assets having regard only to the claims of which he then has notice.

PAUL McGUINNESS & ASSOCIATES PTY.,
solicitors,
3 Eighth Avenue, Rosebud 3939.
Telephone (03) 5986 6999.

Re: MICHAEL HOWARD KING, late of 8 Soderlund Drive, Doncaster, retired airline pilot, deceased. Creditors, next-of-kin and others having claims in respect of the estate of the deceased, who died on 4 August 2000, are required by the trustee, Yvonne Jean King of 8 Soderlund Drive, Doncaster, widow, to send particulars to the trustee by 6 February 2001 after which date the trustee may convey or distribute the assets having regard only to the claims of which the trustee has notice.

PEARCE WEBSTER DUGDALES, solicitors,
379 Collins Street, Melbourne.

THELMA MAY COLVIN, late of Baxter Village Nursing Home, 8 Robinson Road, Baxter, Victoria 3911. Creditors, next-of-kin and others having claims in respect of the estate of the deceased, who died on 12 August 2000, are required by Perpetual Trustees Victoria Limited, A.C.N. 004 027 258 of 50 Queen Street, Melbourne, Victoria, the applicant/s for a grant of administration, to send particulars of their claims to the said applicants in care of the said company by 9 February 2001 after which date they will convey or distribute the assets having regard only to the claims of which they then have notice.

EVA MARGARET REMFRY, late of Ripplebrook Private Nursing Home, 21 - 25 Inverness Street, Clarinda, Victoria 3169. Creditors, next-of-kin and others having claims in respect of the estate of the deceased, who died on 29 July 2000, are required by Perpetual Trustees Victoria Limited, A.C.N. 004 027 258

of 50 Queen Street, Melbourne, Victoria, the applicant/s for a grant of administration, to send particulars of their claims to the said applicants in care of the said company by 9 February 2001 after which date they will convey or distribute the assets having regard only to the claims of which they then have notice.

Re: MARJORIE LEILA McLEAN, late of 11 Marcus Road, Frankston, widow, deceased. Creditors, next-of-kin or others having claims in respect of the estate of the deceased, who died on 2 September 2000, are required by the trustee, Jeanette Marina Stirling of 11 Marcus Road, Frankston, Victoria, retired, to send particulars to the trustee by 8 February 2001 after which date the trustee may convey or distribute the assets having regard only to the claims of which the trustee then has notice.

ROBERTS PARTNERS,
216 Main Street, Mornington.

Re: MARY PETTIGROVE, late of Unit 1, 13 Seaton Road, Mornington, home duties, deceased. Creditors, next-of-kin or others having claims in respect of the estate of the deceased, who died on 21 October 2000, are required by the trustees, Susan Barr of 21 Playfield Avenue, Mornington, Victoria, business proprietor and Daniel Patrick Pettigrove of 15 Brewster Road, Rye, Victoria, contractor, to send particulars to the trustees by 8 February 2001 after which date the trustees may convey or distribute the assets having regard only to the claims of which the trustees then have notice.

ROBERTS PARTNERS,
216 Main Street, Mornington.

GREGORY ROBERT MARTIN, deceased. Creditors, next-of-kin and others having claims against the estate of GREGORY ROBERT MARTIN, late of 4/138 New Street, Brighton, Victoria, computer consultant, deceased, who died on 25 August 2000, are required to send particulars of their claims to the administrator care of the undermentioned solicitor by 6 February 2001 after which date the administrator will proceed to distribute the assets having regard only to the claims of which she shall then have notice.

VERNA A. COOK, solicitor,
5/8 St. Andrews Street, Brighton 3186.

ROGER FLORANCE TAYLOR, deceased. Creditors, next-of-kin and others having claims against the estate of ROGER FLORANCE TAYLOR, late of 26 Blackbutt Street, Cornubia, Queensland, manager, deceased, who died on 15 January 2000, are required to send particulars of their claims to the executor care of the undermentioned solicitor by 10 February 2001 after which date the executor will proceed to distribute the assets having regard only to the claims of which she shall then have had notice.

VERNA A. COOK, solicitor,
5/8 St. Andrews Street, Brighton 3186.

Creditors, next-of-kin or others having claims in respect of the estate of HARRY OTTO HERMANN PUESCHEL, late of Unit 70 The Village, Paas Place, Williamstown, Victoria, deceased, who died on 1 October 2000, are to send particulars of their claims to the executor care of the undermentioned solicitors by 28 February 2001 after which date the executor will distribute the assets having regard only to the claims of which he then has notice.

WILCKENS & ROCHE, solicitors,
43 Ferguson Street, Williamstown.

Unclaimed Moneys Act 1962

Register of Unclaimed Moneys held by the —

| <i>Name of Owner on Books and Last Known Address</i> | <i>Total Amount Due to Owner</i> | <i>Description Of Unclaimed Money</i> | <i>Date when Amount first became Payable</i> |
|--|--|---|--|
| L. F. SARTORI — SOLICITOR | | | |
| | \$ | | |
| J. J. Deed, 64 Lebanon Street, Strathmore | 114.00 | Cheque | 05/08/97 |
| 00211 | | | |
| CONTACT: DELFINA SARTORI, PHONE: (03) 9482 3811. | | | |

Unclaimed Moneys Act 1962

Register of Unclaimed Moneys held by the —

| <i>Name of Owner on Books and Last Known Address</i> | <i>Total Amount Due to Owner</i> | <i>Description Of Unclaimed Money</i> | <i>Date when Amount first became Payable</i> |
|---|--|---|--|
| AINSWORTHS, LAWYERS | | | |
| | \$ | | |
| Trudi Jessica Bellia, 14 Parkland Drive, Hamlyn Heights | 3,997.67 | Cheque | 09/07/98 |
| Jodie Constance Syddall, 53 Iona Avenue, Belmont | 3,997.67 | " | " |
| Jamie Victor Syddall, 53 Iona Avenue, Belmont | 3,997.67 | " | " |
| Derek Maurice Syddall, P.O. Box 64, Gordon | 3,997.67 | " | " |
| Craig Andrew Syddall, 10 Collins Street, Belmont | 3,997.67 | " | " |
| 00198 | | | |
| CONTACT: AINSWORTHS, PHONE: (03) 5221 2499. | | | |

PROCLAMATIONS

ACTS OF PARLIAMENT

Proclamation

I, James Gobbo, Governor of Victoria, declare that I have today assented in Her Majesty's name to the following bills:

No. 85/2000 **Building (Legionella) Act 2000**

No. 86/2000 **Crimes (Questioning of Suspects) Act 2000**

No. 87/2000 **Domestic (Feral and Nuisance) Animals (Amendment) Act 2000**

No. 88/2000 **Gambling Legislation (Miscellaneous Amendments) Act 2000**

No. 89/2000 **Gaming Acts (Gaming Machine Levy) Act 2000**

No. 90/2000 **Gaming No. 2 (Community Benefit) Act 2000**

No. 91/2000 **Gas Industry Acts (Amendment) Act 2000**

No. 92/2000 **Magistrates' Court (Committal Proceedings) Act 2000**

No. 93/2000 **Marine (Amendment) Act 2000**

No. 94/2000 **Nurses (Amendment) Act 2000**

No. 95/2000 **Superannuation Acts (Beneficiary Choice) Act 2000**

No. 96/2000 **Victorian Curriculum and Assessment Authority Act 2000**

No. 97/2000 **Victorian Qualifications Authority Act 2000**

Given under my hand and the seal of Victoria on 5 December 2000.

(L.S.) JAMES GOBBO
Governor
By His Excellency's Command

STEVE BRACKS
Premier

No. 85/2000 (1) This section and sections 1, 3, 10, 11 and 14 come into operation on the day after the day on which this Act receives the Royal Assent.

(2) Subject to sub-section (4), section 9 comes into operation on a day to be proclaimed.

(3) Subject to sub-section (4), the remaining provisions of this Act come into operation on a day to be proclaimed.

(4) If a provision referred to in sub-section (2) or (3) does not come into operation before 1 January 2002, it comes into operation on that day.

No. 86/2000 This Act comes into operation on the day after the day on which it receives the Royal Assent.

No. 87/2000 (1) This Act (other than sections 4(a) and (b), 9, 19(2), 38 and 39) comes into operation on the day after the day on which it receives the Royal Assent.

(2) Sections 4(a) and (b), 9, 19(2), 38 and 39 come into operation on a day or days to be proclaimed.

(3) If a provision referred to in sub-section (2) does not come into operation before 1 January 2002, it comes into operation on that day.

No. 88/2000 (1) Section 1 and this section come into operation on the day after the day on which this Act receives the Royal Assent.

(2) The remaining provisions of this Act, except sections 25 and 56, come into operation on a day or days to be proclaimed.

(3) Section 25 is deemed to have come into operation on 31 August 1998.

(4) Section 56 is deemed to have come into operation on 8 June 1999.

(5) If a provision referred to in sub-section (2) has not come into operation before 1 December 2001, it comes into operation on that day.

No. 89/2000 This Act comes into operation on the day after the day on which it receives the Royal Assent.

No. 90/2000 (1) Subject to sub-section (2), this Act comes into operation on a day or days to be proclaimed.

(2) If a provision of this Act does not come into operation before 31 December 2002, it comes into operation on that day.

No. 91/2000 (1) This Part comes into operation on the day on which this Act receives the Royal Assent.

(2) Section 4 is deemed to have come into operation on 1 September 2000.

(3) The remaining provisions of this Act come into operation on a day or days to be proclaimed.

(4) If a provision referred to in sub-section (3) does not come into operation before 31 December 2001, it comes into operation on that day.

No. 92/2000 (1) Subject to sub-section (2), this Act comes into operation on a day or days to be proclaimed.

(2) If a provision of this Act does not come into operation before 1 July 2001, it comes into operation on that day.

No. 93/2000 (1) Subject to sub-section (2), the provisions of this Act come into operation on a day or days to be proclaimed.

(2) If a provision referred to in sub-section (1) does not come into operation before 1 February 2002, it comes into operation on that day.

No. 94/2000 (1) Section 1 and this section come into operation on the day after the day on which this Act receives the Royal Assent.

(2) Subject to sub-section (3), the remaining provisions of this Act, come into operation on a day or days to be proclaimed.

(3) If a provision referred to in sub-section (2) does not come into operation before 1 November 2001, it comes into operation on that day.

No. 95/2000 (1) This Act, except sections 3, 6, 10, 16, 18, 19 and 21 comes into operation on the day after the day on which it receives the Royal Assent.

(2) Section 19(1) is deemed to have come into operation on 23 January 1980.

(3) Section 19(2) is deemed to have come into operation on 1 January 1987.

(4) Section 19(3) is deemed to have come into operation on 1 July 1988.

(5) Section 10 is deemed to have come into operation on 1 July 1999.

(6) Sections 3, 6, 16, 18 and 21 come into operation on 1 July 2001.

No. 96/2000 (1) Subject to sub-section (2), the provisions of this Act come into operation on a day or days to be proclaimed.

(2) If a provision referred to in sub-section (1) does not come into operation before 1

December 2001, it comes into operation on that day.

No. 97/2000 (1) Subject to sub-section (2), the provisions of this Act (including the items in the Schedules) come into operation on a day or days to be proclaimed.

(2) If a provision referred to in sub-section (1) does not come into operation before 1 December 2001, it comes into operation on that day.

Business Registration Acts (Amendment) Act 2000

PROCLAMATION OF COMMENCEMENT

I, James Gobbo, Governor of Victoria, with the advice of the Executive Council and under section 2(1) of the **Business Registration Acts (Amendment) Act 2000**, fix 11 December 2000 as the day on which sections 18, 20(1), 21, 23 and 27 of that Act come into operation.

Given under my hand and the seal of
Victoria on 5 December 2000.

(L.S.) JAMES GOBBO
Governor

By His Excellency's Command

MARSHA THOMSON
Minister for Consumer Affairs

Transport Accident (Amendment) Act 2000
PROCLAMATION OF COMMENCEMENT

I, James Gobbo, Governor of Victoria, with the advice of the Executive Council and under section 2(3) of the **Transport Accident (Amendment) Act 2000**:

Fix 7 December 2000 as the day on which sections 3(1), 3(2), 3(5) and sections 4 and 41 come into operation; and

Fix 1 January 2001 as the day on which sections 3(3) (with the exception of section 3(3)(c)), 3(4), 5, 7, 8, 15(1), 15(2), 15(5), 19, 20, 23(2), 28 and 38 come into operation.

Given under my hand and the seal of
Victoria on 5 December 2000.

(L.S.) JAMES GOBBO
Governor

By His Excellency's Command

BOB CAMERON
Minister for WorkCover

**GOVERNMENT AND OUTER BUDGET SECTOR AGENCIES
NOTICES**



DELATITE SHIRE
ROAD EXCHANGE/ROAD CLOSURE
South of Crown Allotment 34
Parish of Dueran

Pursuant to the provisions of clause 2, Schedule 10 of the **Local Government Act 1989**, the Council having advertised its intentions in local papers and received no submissions pursuant to Section 223 of the **Local Government Act 1989**, resolved by instrument of delegation by the Director Technical and Environmental Services to authorise and approve the road exchange and closure set out on the plan below.

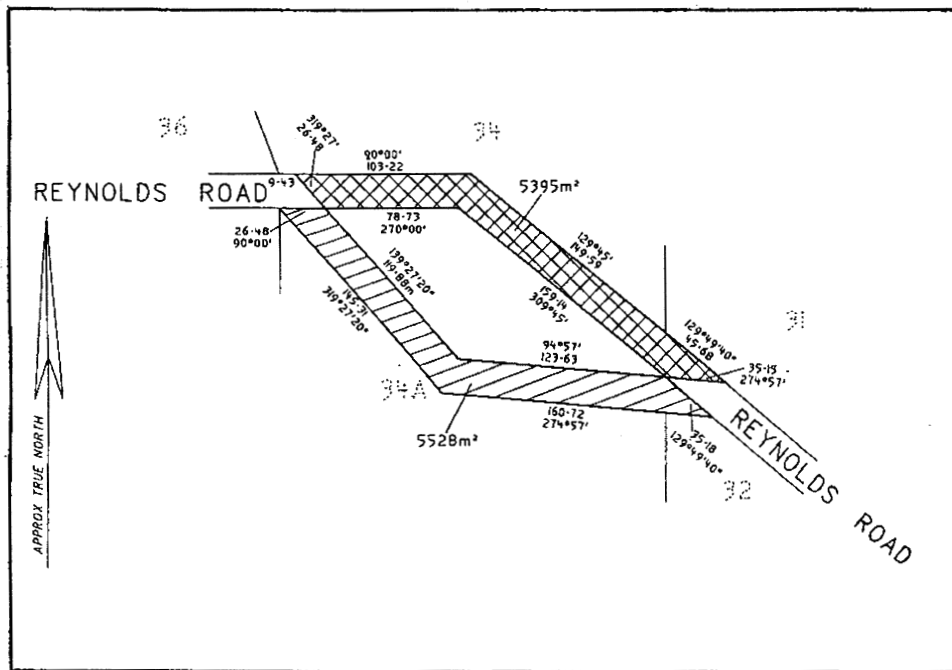

| NOTATIONS | |
|------------------------------|--|
| ROAD TO BE CLOSED SHOWN THUS | |
| ROAD TO BE OPENED SHOWN THUS | |

KEN CARPENTER
Director Technical and Environmental Services

GREATER SHEPPARTON CITY COUNCIL
Road Discontinuance

Pursuant to Section 206 and Clause 3 of Schedule 10 of the **Local Government Act 1989**, the Greater Shepparton City Council, at its meeting on 7 November 2000 formed the opinion that part of the disused road off Albert Street, Tatura, shown hatched on the plan below, is not reasonably required as a road for public use and resolved to discontinue that part of the road.

Upon closure, the land will vest in the Crown.

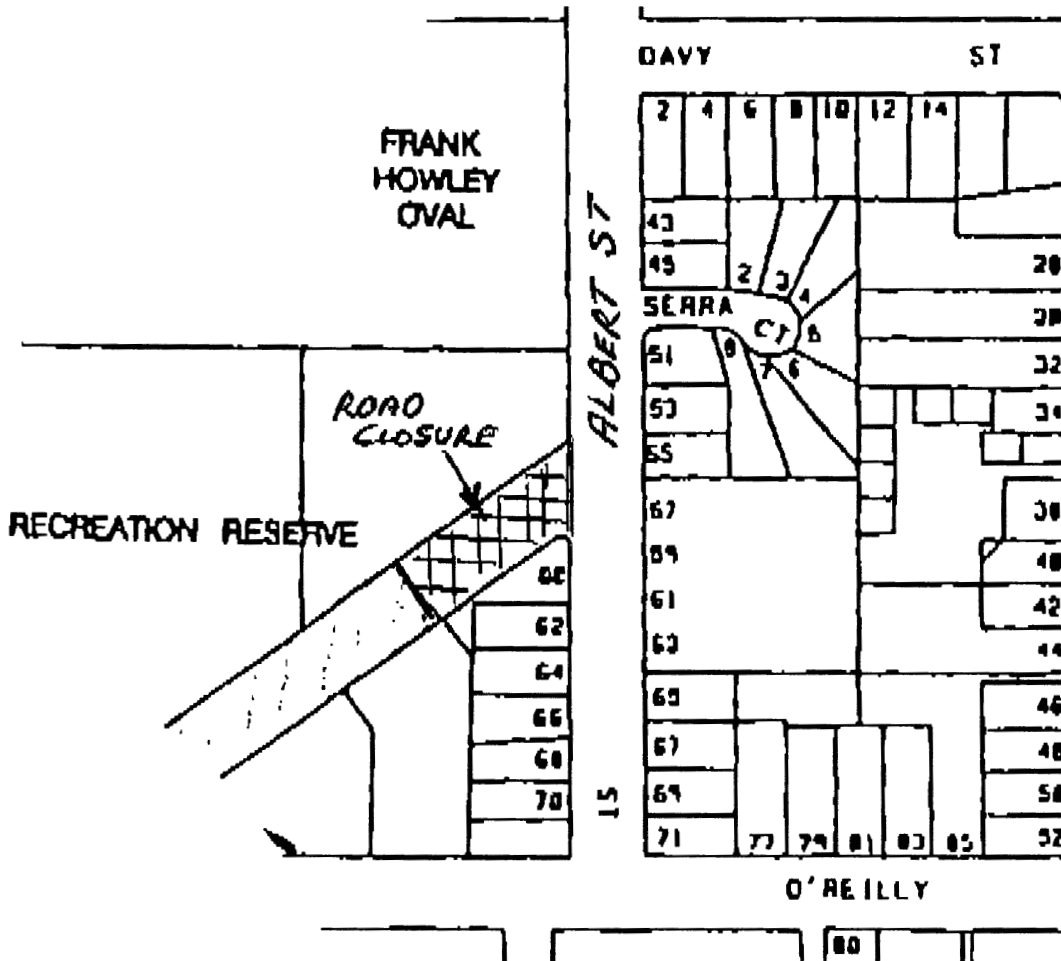

BILL JABOOR
Chief Executive Officer

KINGSTON CITY COUNCIL
Road Discontinuance

Pursuant to section 206 and schedule 10, Clause 3 of the **Local Government Act 1989**, the Kingston City Council has formed the opinion that the road at the rear of 2 to 20 & 26 to 50 Catherine Avenue and 1 to 11 & 15 to 33 Sherwood Avenue and 346 Station Street, Chelsea, and shown by hatching on the plan below, is not reasonably required as a road for public use and resolved to discontinue the road and to sell the land from the road by Private Treaty to abutting property owners.

The road is to be sold subject to the right, power or interest held by South East Water Limited in the road in connection with any sewers, drains or pipes under the control of that authority.

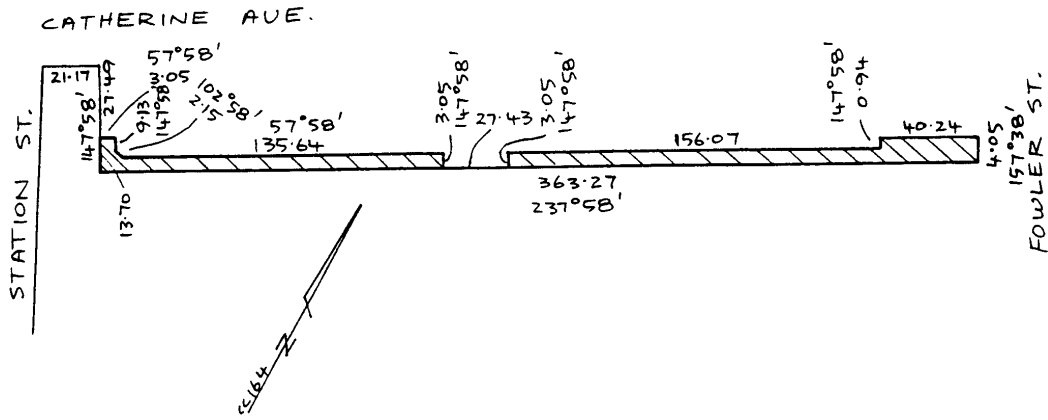

ROB SKINNER
Chief Executive Officer

HOBSONS BAY CITY COUNCIL
Road Discontinuance

Under Section 206 and Schedule 10, Clause 3 of the **Local Government Act 1989** the Hobsons Bay City Council, at its Ordinary meeting held on 19 October 2000, formed the opinion that the road shown cross-hatched on the plan below is not reasonably required as a road for public use and has resolved to discontinue the road and to sell the land from the road by private treaty subject to any right, power or interest held by the Melbourne Water Corporation (City West Water Ltd) in the road in connection with any sewers, drains, pipes, wires or cables under the control of that authority in or near the road.

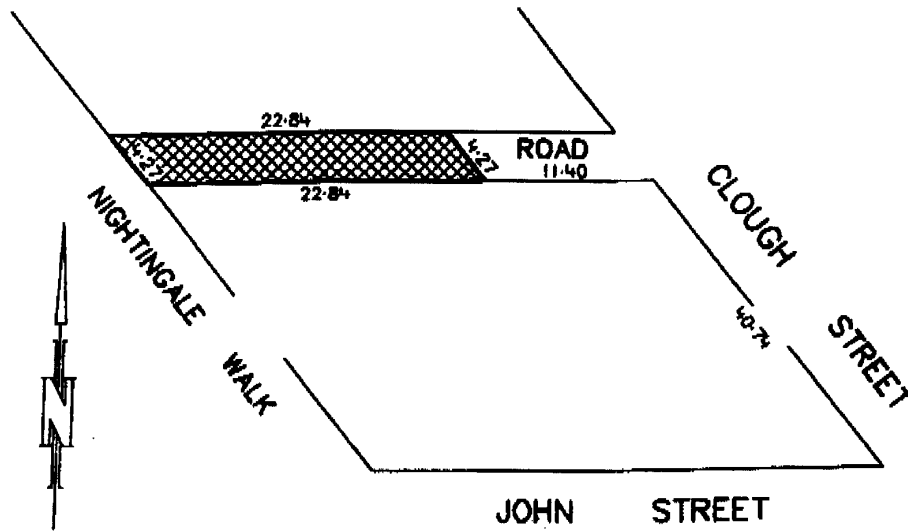

KEN McNAMARA
Chief Executive Officer

MOONEE VALLEY CITY COUNCIL
Road Discontinuance

At its meeting on 17 October 2000 and acting under Clause 3 of schedule 10 to the **Local Government Act 1989** Moonee Valley City Council resolved to discontinue the road shown hatched on the plan below.

The road is to be sold subject to any right, power or interest held by City West Water in the road in connection with any sewers, drains or pipes under the control of that authority in or near the road.

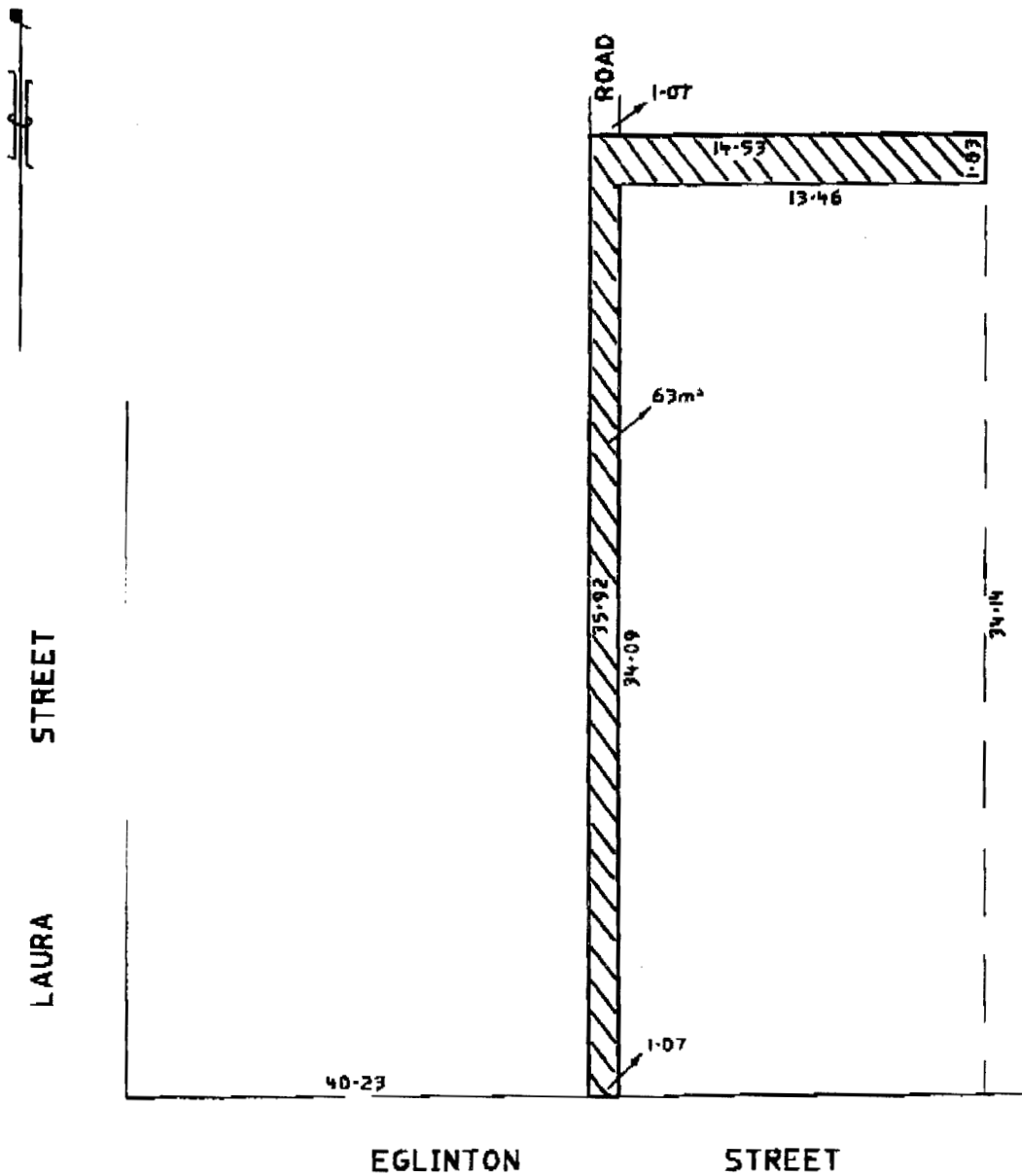

Mr MURRAY DOUGLAS
Chief Executive

CITY OF WHITEHORSE
 Order No. 2 of Whitehorse City Council
 Section 26(2)
**Domestic (Feral and Nuisance)
 Animals Act 1994**

This Order repeals Order No. 1.

1. Dogs must be under effective control

The owner of any dog must keep the dog in effective control by means of a chain, cord or leash, not exceeding 1.5 metres in length, held by the owner and attached to the dog while the dog is in: – a reserve; – or a public place.

2. Owner's obligations

A dog may be exercised off a chain, cord or leash in a Designated Reserve, if the owner: carries a chain, cord or leash not exceeding 1.5 metres in length, sufficient to bring the dog under effective control if the dog behaves in a manner which threatens any person or animal; remains in effective voice or hand control of the dogs so as to be able to promptly bring the dog under effective control by placing the dog on a chain, cord or leash not exceeding 1.5 metres in length if that becomes necessary; and does not allow the dog to worry or threaten any person or animal.

3. Controls

If a dog is off a chain, cord or leash in a Designated Reserve, the dog must be brought under the effective control of the owner by means of chain, cord or leash not exceeding 1.5 metres in length if the dog roams, or is likely to roam, to within 50 metres of: the principal location of an organised sporting event; a children's play equipment area; the principal location of an organised public meeting; or a permanent barbecue or picnic area.

4. Meaning of word

In this Order

Owner has the same meaning as in the **Domestic (Feral and Nuisance) Animals Act 1994**;

Designated Reserve means any of the following reserves or part of the following reserves:—Masons Road Retarding Basin; Simpson Park, Somers Trail, Davy Lane Reserve, Ballyshanassy Reserve, Morton Park, Glen Valley Retarding Basin, Nicoll Park, Gardiners Creek Reserve, Koonung Creek Reserve, Bushy Creek Reserve West (between Elgar Road and Woodhouse

Grove), Sparks Reserve, Boisdale Reserve, Mont Albert Reserve, Blackburn South Link (between Holland Road and Royton Street), Mahoney's Reserve, Hunter Knoll, Terrara Park, Forest Hill Reserve.

This Order becomes effective 11 December 2000.

NOELENE DUFF
 Chief Executive Officer

CITY OF PORT PHILLIP

Council Meetings Procedures Local Law

Notice is hereby given that the Port Phillip City Council (the Council) at its meeting of 27 November 2000 resolved to repeal Local Law No. 6/1997, Council Meetings Procedures, and replace it by making a new Local Law No. 2/2000 under Sections 91 and 111 of the **Local Government Act 1989**.

The purpose of this Local Law, which came into operation on 28 November 2000 is to:—

- (a) regulate proceedings at Council meetings and special committees conducted by or on behalf of the Council;
- (b) provide for the election of the Mayor of Council and the Chairpersons of the special committees;
- (c) regulate the use of the common seal of the Council; and
- (d) substitute Council Meetings Procedures Local Law No. 2/2000 for the previously existing Council Meetings Procedures Local Law No. 6/1997.

The general purport of Local Law No. 2/2000 includes specification of the form of regulation with a view to achieving the stated objectives and in particular provides for:

- (a) the manner in which the Mayor and Chairpersons of Council Committees are elected;
- (b) the quorums for meetings;
- (c) the meeting procedures and administrations;
- (d) the method of addressing confidential reports;
- (e) the conduct of question time;
- (f) the procedures for motions and debate;
- (g) the manner in which the standards of conduct will be regulated;

- (h) the manner for receiving deputations and public comment; and
- (i) the procedures for and restriction of the use of the common seal of the Council and the prohibition of unauthorised use of any device resembling the common seal.

A copy of the Local Law may be obtained from or inspected at the Council Offices at the corner of Carlisle Street and Brighton Road, St Kilda, during normal office hours.

ANNE DUNN
Chief Executive Officer



CITY OF KINGSTON

**ADOPTION OF LOCAL LAW 1
(AS AMENDED) – PUBLIC HEALTH**

Notice is given that the Council of the City of Kingston adopted Local Law Number 1 as amended (Public Health) at its meeting held on 27 November 2000.

The purpose and general purport of Local Law Number 1 (Public Health) is to promote an environment free of hazards to health, and to prevent and remedy nuisances or conditions liable to be dangerous to health or offensive to people. Local Law Number 1 contained waste management provisions which were inconsistent with new waste collection procedures being introduced throughout the City. Council has amended this local law so that it reflects these new procedures.

Copies of Local Law 1 may be inspected (or purchased for the sum of \$2) at the City of Kingston Municipal Office, corner Brindisi Street and Mentone Parade, during business hours.

ROB SKINNER
Chief Executive Officer

Planning and Environment Act 1987
GREATER BENDIGO PLANNING SCHEME
Notice of Amendment
Amendment C3

Amendment C3 has been prepared to the Greater Bendigo Planning Scheme. The Amendment applies to land at the Coliban Water

Headquarters and Depot at Alder Street, Golden Square. The land is bounded by Cooper Street to the north, Northern Railway to the east, Sunkist Street and Alder Street to the south and McLachlan and Panton Streets to the west.

The Amendment proposes to rezone the land from public Purpose 1 Zone (Service Utility) to Residential 1 Zone. An Environmental Audit Overlay will apply to part of the land and Development Plan Overlay will apply to all of the site.

The purpose of the Amendment is to rezone the land to allow residential development to proceed and to provide relevant planning controls for the existing and future pattern of development of the land.

The Amendment can be inspected at: Department of Infrastructure, Nauru House, Level 3 Plaza, 80 Collins Street, Melbourne, Vic. 3000; Department of Infrastructure, (VicRoads Office), Lansell Street, Bendigo, Vic. 3550 and City of Greater Bendigo, Planning and Building Business Unit, "The Mill", 15 Hopetoun Street, Bendigo, Vic. 3550.

Submissions about the Amendment must be sent to: Mr Andrew Paul, The Chief Executive Officer, City of Greater Bendigo, PO Box 733, Bendigo, Vic. 3550 by 22 December 2000.

Planning and Environment Act 1987
GREATER BENDIGO PLANNING SCHEME
Notice of Amendment
Amendment C5

The land affected by the Amendment is bounded by Havlin Street East, Miller, Wolstencroft and Rodney Streets, Bendigo and includes 23–27 Miller Street (Lot 1 LP 213427), 29 Miller Street (Lot 2 LP 213427) and 53 Havlin Street East (Lot 2 LP 206131).

The Amendment proposes to rezone the land from Industrial 1 Zone to Residential 1 Zone. In order to ensure that the land is developed in an orderly and an environmentally sensitive manner an Environmental Audit Overlay and a Development Plan Overlay will apply to all of the land.

The purpose of this Amendment is to provide relevant planning controls for the use of part of the land for public open space and to allow appropriate residential development of the land.

The Amendment can be inspected at: Department of Infrastructure, Nauru House, Level 3 Plaza, 80 Collins Street, Melbourne, Vic. 3000; Department of Infrastructure, (VicRoads Office), Lansell Street, Bendigo, Vic. 3550 and City of Greater Bendigo, Planning and Building Business Unit, "The Mill", 15 Hopetoun Street, Bendigo, Vic. 3550.

Submissions about the Amendment must be sent to: Mr Andrew Paul, The Chief Executive Officer, City of Greater Bendigo, PO Box 733, Bendigo, Vic. 3550 by 22 December 2000.

Planning and Environment Act 1987
YARRA RANGES PLANNING SCHEME
Notice of Amendment
Amendment C11
Application YR2000/1449

The land affected by the Amendment and the application is located on the south west corner of Maroondah Highway and Don Road in Healesville. The address of the land is 316–364 Maroondah Highway, Healesville and it comprises two different parcels of land shown on Certificate of Title Folio 6173, Volume 1234570 and Certificate of Title Volume 9050, Folio 986.

The Amendment proposes to change the Yarra Ranges Planning Scheme by rezoning the above parcels of land from part Business 4 and part Special Use Zone, to a Business 3 Zone, and to insert a site specific control in the schedule to Clause 52.03 which provides for the use of part of the land as a bakery with associated retail and restaurant/cafe uses.

The application seeks a planning permit to develop and use the land for the purposes of a mixed use tourist facility comprising a bakery, with associated cafe/restaurant facilities and a micro-brewery with associated restaurant and bar uses, with some manufacturing sales. The application also seeks a licence to sell and consume liquor on both premises, dispensation from car parking requirements of the Yarra Ranges Planning Scheme and tree removal.

The organisation that requested the Amendment is Environmental Resources Management Australia Pty Ltd on behalf of Little Creatures Brewing Pty Ltd and New Valley Pty Ltd.

You may inspect the Amendment and application, and any documents that support the amendment, and the explanatory report about the amendment and the application at the office of the planning authority, the Shire of Yarra Ranges and the office of the Department of Infrastructure which are located at Yarra Ranges Service Centres: Lilydale, Anderson Street, Lilydale; Monbulk, 94 Main Street, Monbulk; Healesville, 276 Maroondah Highway, Healesville; Upwey, 40 Main Street, Upwey; Yarra Junction, Warburton Highway/Hoddle Street, Yarra Junction and Department of Infrastructure, Customer Service Centre, Level 3 Plaza, Nauru House, 80 Collins Street, Melbourne.

Any submissions about the Amendment must: Be made in writing, giving the submitter's name, address and, if practicable, a phone number for contact during office hours. Set out the views on the Amendment that the submitter wishes to put before Council and indicate what changes (if any) the submitter wishes made to the amendment. State whether the person/s making the submission/s wishes to be heard in support of their submission.

This can be done during office hours and is free of charge.

Any person who may be affected by the Amendment or by the granting of the permit may make a submission to the planning authority.

Please be aware that copies of objections/submissions received may be made available to any person for the purpose of consideration as part of the planning process under the **Planning & Environment Act 1987**.

The closing date for submissions is 31 January 2001. A submission must be sent to the undersigned, Graham Whitt, Manager Planning Services, Shire of Yarra Ranges, PO Box 105, Lilydale 3140.

Planning and Environment Act 1987
CAMPASPE PLANNING SCHEME
Notice of Amendment
Amendment C15

The Shire of Campaspe has exhibited Amendment C15 to the Campaspe Planning Scheme.

The Amendment seeks to rezone Part Crown Allotment 70, No Section, Parish of Rochester, (south west corner of Pascoe Street and Cohen Street, Rochester), from Public Conservation and Resource Zone to Low Density Residential.

The Amendment can be inspected at: Campaspe Shire Council, corner of Hare and Heygarth Streets, Echuca 3564; Campaspe Shire Council, Rochester Service Centre, Mackay Street, Rochester 3561; Department of Infrastructure, 57 Lansell Street, Bendigo 3550 and Department of Infrastructure, Planning Information Centre, Upper Plaza, Nauru House, 80 Collins Street, Melbourne 3000.

Submissions about this Amendment must be sent to: David Merrett, Planning and Development Manager, Shire of Campaspe, PO Box 35, Echuca 3564 by 29 January 2001.

Dated 5 December 2000

JEAN ANDREWS
Acting Chief Executive Officer

Planning and Environment Act 1987
KNOX PLANNING SCHEME
Notice of Amendment
Amendment C4

Knox City Council has prepared an Amendment which proposes to amend the Local Section of the Knox Planning Scheme.

Rezoning of part of the land at the south-west corner of Wellington Road and Gearon Avenue, Rowville is proposed to provide for development of a neighbourhood shopping centre. The site is identified as the location for a proposed new centre in the Framework Plan forming part of the Municipal Strategic Statement.

The Amendment proposes to rezone the land from the Residential 1 Zone to the Business 1 Zone, with a Development Plan Overlay to facilitate the use and development of a supermarket based neighbourhood shopping centre that includes specialty shops, a medical centre, tavern, office/non retail uses and a petrol station. An environmental audit overlay on the site is to be retained and the site is proposed to be added to the list of shopping complexes where gaming is prohibited.

A Development Plan is being publicly exhibited in conjunction with the Amendment.

The Amendment can be inspected at: Knox City Council, Civic Centre, 511 Burwood Highway, Wantirna South 3152 and Department of Infrastructure, Level 3 Plaza, Nauru House, 80 Collins Street, Melbourne 3000.

Any persons affected by the Amendment may make a submission in writing, which must be sent to Knox City Council, Private Bag Knox 1, M.D.C. Wantirna South 3152 by 12 January 2001.

JOHN KNAGGS
Group Manager –
City Development

Planning and Environment Act 1987
BAYSIDE PLANNING SCHEME

Notice of Amendment
Amendment C6

Bayside City Council has prepared Amendment C6 to the Bayside Planning Scheme.

Land affected by the Amendment:

The amendment affects land within the City of Bayside as identified on the Heritage Overlay (HO) Map.

The Amendment proposes to change the Bayside Planning Scheme by: Amending The MSS at 21.09. Adding a Local Policy at 22.06. Placing additional Buildings, Precincts and Landscape elements on the existing Heritage Overlay (HO), Clause 43.01. Defining land affected by the HO on the planning scheme maps. Adding an incorporated document.

A copy of the amendment can be inspected, free of charge, during office hours at: Bayside City Council, Corporate Centre, Royal Avenue, Sandringham, Vic. 3191 and the Department of Infrastructure, Customer Service Centre, Upper Plaza, Nauru House, 80 Collins Street, Melbourne 3000.

Written submissions on the amendment should be sent before the due date of Wednesday 28 February 2001 to: Chief Executive, Bayside City Council, PO Box 27, Sandringham, Vic. 3191.

IAN WILSON
Chief Executive

Planning and Environment Act 1987**HUME PLANNING SCHEME**

Notice of Amendment

Amendment C12

Hume City Council has prepared Amendment C12 to the Hume Planning Scheme.

The Amendment applies to land known as the Sunbury Railway Station. This site includes buildings on both sides of the Railway Line. The land is situated approximately 300 metres South of the Macedon Road Bridge and comprises an area of approximately 0.13 hectares. The subject land is Crown Allotment 16C, Section 17, Parish of Buttlejork, Township of Sunbury.

The Amendment proposes to introduce a Heritage Overlay to the Sunbury Railway Station buildings.

A copy of the Amendment may be inspected at the following locations during office hours: Hume City Council, Broadmeadows Office, 1079 Pascoe Vale Road, Broadmeadows; Hume City Council, Sunbury Office, 36 Macedon Street, Sunbury and Department of Infrastructure, Customer Service Centre & Bookshop, Upper Plaza, Nauru House, 80 Collins Street, Melbourne.

Submissions about the Amendment must be sent to: Margaret Abbey, Manager City Planning, Hume City Council, P.O. Box 119, Broadmeadows, Vic. 3047 by Friday 12 January 2001.

DARRELL TRELOAR
Chief Executive Officer

Creditors, next of kin and others having claims against the estate of any of the undermentioned deceased persons are required to send particulars of their claims to State Trustees Limited, A.C.N 064 593 148, 168 Exhibition Street, Melbourne, Victoria 3000, the personal representative, on or before 12 February 2001 after which date State Trustees Limited may convey or distribute the assets having regard only to the claims of which State Trustees Limited then has notice.

BREWSTER, Frederick Garland, late of Ravenswood Court, 15A Tovey Street, Reservoir, retired, who died 22 August 2000.

BROWN, Roger Alan, late of 211-213 Gisborne-Melton Road, Melton, labourer, who died 10 August 2000.

IRVINE, Gerald John, late of 6 Beech Street, Langwarrin, pensioner, who died 14 July 2000.

JONES, Ruth Ellen, late of Glenroy Private Nursing Home, 87 Chapman Street, Glenroy, pensioner, who died 29 September 2000.

LINFORD, John Stuart, late of 41 Brosnan Crescent, Strathmore, pensioner, who died 3 November 2000.

MARSHALL, Elsie May, late of Room 5 Domain Gardens, 14 Sandpiper Place, Frankston, retired, who died 19 September 2000.

NOREIKA, Stasys, formerly of 59 Sanderling Crescent, Mornington, but late of Warrnambool Nursing Centre, 170 Raglan Parade, Warrnambool, pensioner, who died 7 September 2000.

SKINNER, Mavis, late of 82 Helene Street, Bulleen, housewife, who died 1 October 2000.

WATSON, Knowle Travis, late of Unit 1/32 Banff Street, Reservoir, retired, who died 14 September 2000.

Dated at Melbourne, 4 December 2000.

CATHY VANDERFEEN
Manager, Estate Management
State Trustees Limited

Creditors, next-of-kin and others having claims against the following estates:-

COLLINS, Sydney Charles, late of Mornington Private Nursing Home, 680 Nepean Highway, Mornington, retired, deceased, who died 9 October 2000.

MANE, NEKO, late of Mancurisht, Devol Korce, Albania, deceased intestate, who died 28 August 1997.

PROBERT, Alva Joyce, late of 15 Gerald Street, Ferntree Gully, pensioner, deceased, who died 30 October 2000.

SMYTHE, Dorothy Jean, late of Queen Street, Elizabeth Centre, 102 Ascot Street, Ballarat, pensioner, deceased intestate, who died 30 September 2000.

VAN DEN VOSCH, Phyllis, late of Wangaratta Nursing Home, Green Street, Wangaratta, pensioner, deceased intestate, who died 29 August 2000.

Creditors, next-of-kin and others having claims against the abovementioned estates are required pursuant to Section 33 of the **Trustee Act 1958** to send particulars of their claims against the abovementioned estates to State Trustees Limited, 168 Exhibition Street, Melbourne, Victoria, on or before 12 February 2001 after which date State Trustees Limited, A.C.N. 064 593 148, may convey or distribute the assets of the abovementioned estates having regard only to the claims of which it then has notice.

EXEMPTION

Application No. A 479 of 2000

The Victorian Civil and Administrative Tribunal has considered an application pursuant to Section 83 of the **Equal Opportunity Act 1995** by The Graduate Union of the University of Melbourne Inc. The application for exemption is to enable the applicant to exclude from the activities of the "Graduate Links" group of the Union, members of the Union aged 45 years and over and to advertise those activities on the basis of that exclusion.

Upon reading the material submitted in support of the application, the Tribunal is satisfied that it is appropriate to grant an exemption from Sections 42, 59, 60, 100 and 195 of the Act to enable the applicant to exclude from the activities of the "Graduate Links" group of the Union, members of the Union aged 45 years and over and to advertise those activities on the basis of that exclusion.

In granting this exemption, the Tribunal noted:

- The "Graduate Links" group is a sub-group of the Graduate Union, an association of the university graduates.
- The applicant wishes to regularise a grouping of its membership that is known as "Graduate Links" which has in fact existed informally for some years, which caters for single graduates aged under 45 years and aims to create an opportunity for people with different interests and qualifications to enjoy each others company in a friendly environment.
- The Graduate Union has social activities open to all members. Another sub-group, the Solo Graduates, consists of single university

graduates of any age. Both groups organise similar functions. Members who are 45 years and over have the opportunity to attend a wide range of social functions, even if excluded from the activities of "Graduate Links".

- It is felt by some members of "Graduate Links" that open age events can scare away younger females. The group feels that they have fought very hard to achieve a group where young women feel comfortable and the activities provided are attractive to younger people.
- The union has previously been granted an exemption in respect of the Mono Group. That Group has since changed its name to Graduate Links.

The Tribunal grants an exemption from the operation of Sections 42, 59, 60, 100 and 195 of the **Equal Opportunity Act 1995**, to enable the applicant to exclude from the activities of the "Graduate Links" group of the Union, members of the Union aged 45 years and over and to advertise those activities on the basis of that exclusion.

This exemption is to remain in force from the day on which notice of the exemption is published in the Government Gazette until 6 December 2003.

Dated 30 November 2000

Ms CATE McKENZIE
Deputy President

Transport Act 1983

DETERMINATION OF CHARGES PURSUANT TO SECTION 184A

I, John McMillan, Deputy Director of Public Transport, Department of Infrastructure, determine that the amounts which are to be charged by operators of tow trucks for the towing and storage of damaged motor vehicles, being vehicles less than 4.0 tonnes gross vehicle mass within the controlled area of Melbourne as gazetted in the Victoria Government Gazette on 1 October 1999 shall be –

1. For towing from the scene of an accident in the controlled area –
A base fee of \$158.00 inclusive of the first 8 kilometres of travel by the allocated tow truck, plus a rate of \$2.50 per kilometre for travel beyond the first 8 kilometres.

For the purpose of calculating towing charges, the distance travelled is to be measured from the authorised depot to the accident scene and then from the accident scene to the address to where the motor vehicle is to be towed.

In addition to the above charges, an after-hours surcharge of \$54.00 (\$158.00+\$54.00 = \$212.00 total charge) applies to tows allocated by the Accident Allocation Centre between 7.00 pm and 7.00 am.

2. For locked storage following towing from the scene of an accident within the controlled area, the following daily rates in accordance with Section 176 of the **Transport Act 1983** shall apply:

| | |
|--------------------------------------|---------|
| Motor car, under cover, per day | \$12.10 |
| Motor cycle, under cover, per day | \$4.10 |
| Motor car, in locked yard, per day | \$8.05 |
| Motor cycle, in locked yard, per day | \$2.65 |

3. The prescribed charges shall be reviewed and sunset two years from the effective date.

The charges, inclusive of GST, take effect from 8 December 2000

JOHN McMILLAN
Deputy Director of Public Transport

Transport Act 1983

VICTORIAN TAXI DIRECTORATE

Department of Infrastructure

Commercial Passenger Vehicle Applications

Notice is hereby given that the following applications will be considered by the Victorian Taxi Directorate, a division of the Department of Infrastructure after 10 January 2000.

Notice of any objection to the granting of an application should be forwarded to reach the Manager, Licensing & Certification, Victorian Taxi Directorate, Level 6, 14 – 20 Blackwood Street, North Melbourne (P.O. Box 666, North Melbourne 3051) not later than 4 January 2000.

Copies of objections are forwarded to the applicants.

It will not be necessary for interested parties to appear on the date specified, unless advised in writing by the Department.

R. J. Brewer, Dandenong. Application to license one commercial passenger vehicle to be purchased in respect of a 1976 Daimler/Jaguar

sedan with seating capacity for 4 passengers to operate a service from 21 Pickett Street, Dandenong for the carriage of passengers for wedding parties and debutante balls.

A. A. Dupont, Viewbank. Application to license one commercial passenger vehicle to be purchased in respect of any vehicle that meets the standards approved by the Victorian Taxi Directorate to operate as a hire car from 17 Sherlowe Crescent, Viewbank.

Razeng Park Pty Ltd, Sale. Application to license one commercial passenger vehicle to be purchased in respect of a 1998 Ford stationwagon with seating capacity for 4 passengers to operate a service from 7140 Maffra Road, Sale for the carriage of incapacitated persons between their place of residence and hospitals or any similar institution situated throughout the State of Victoria where the use of a trained nurse or carer is an essential feature of the hiring.

Dated 7 December 2000

IRENE KAMBOURIS
Manager – Licensing & Certification
Victorian Taxi Directorate

Transport Act 1983

TOW TRUCK DIRECTORATE OF
VICTORIA

Tow Truck Applications

Notice is hereby given that the following application will be considered by the Licensing Authority after 10 January 2001.

Notice of any objection to the granting of this application should be forwarded to reach the Director, Tow Truck Directorate of Victoria, Level 6, 14–20 Blackwood Street, North Melbourne (P.O. Box 666, North Melbourne 3051) not later than 4 January 2001.

It will not be necessary for interested parties to appear on the date specified, unless advised in writing.

Mazzeo Nominees Pty Ltd. Application for variation of conditions of tow truck licence numbers TOW492, TOW502 and TOW709 which authorises the licensed vehicles to be managed, controlled and operated from a depot situated at 1848 Dandenong Road, Clayton to change the depot address to 33–35 Franklyn Street, Huntingdale.

Dated 7 December 2000

STEVE STANKO
Director

Transport Act 1983

DISCONTINUANCE OF ROADS OR PARTS OF ROADS

The Roads Corporation, in pursuance of the powers conferred by Clause 2, Schedule 4 of the **Transport Act 1983**, hereby approves the discontinuance of the roads or parts of roads as described in the schedule and on the plans attached: and approves the sale of the surplus land described in the schedule as provided in Section 47 of the **Transport Act 1983** and as delegated by the Minister for Transport under Section 32 of the said Act.

SCHEDULE

12/00 The land in the Shire of Colac-Otway described as formerly Forrest-Apollo Bay Road, Parish of Barramunga, shown cross hatched on plan numbered RD 19778.

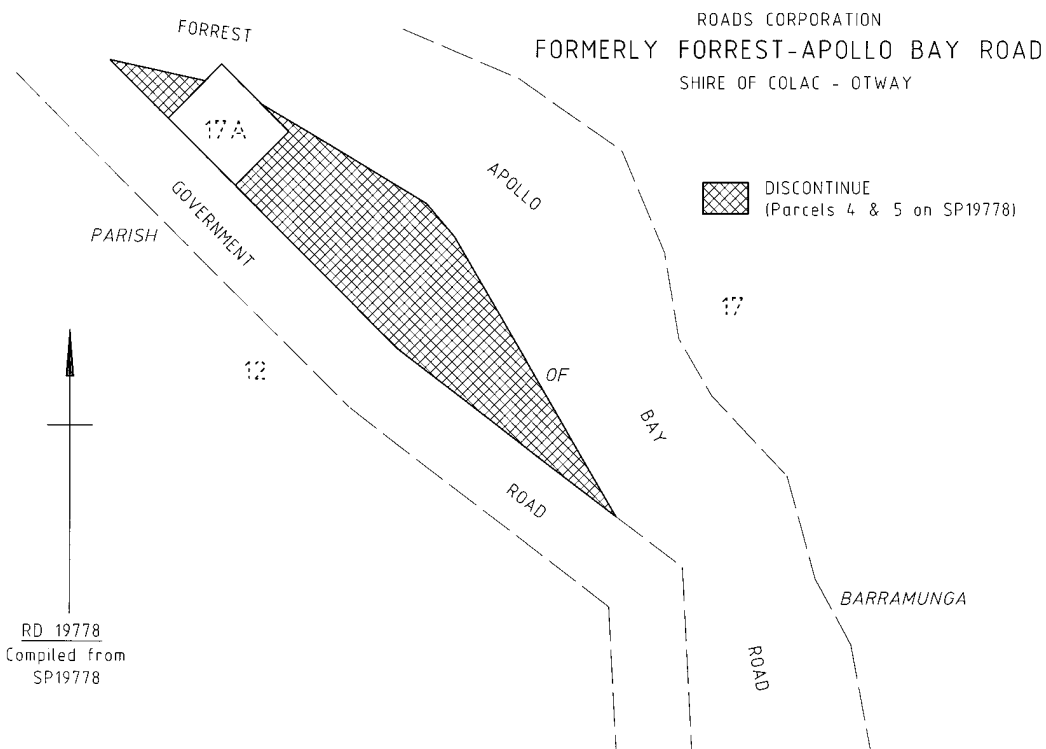

Dated 30 November 2000

COLIN JORDAN
Chief Executive
Roads Corporation

Transport Act 1983

ROAD DECLARATIONS AND DEDICATIONS

The Roads Corporation pursuant to the **Transport Act 1983**, upon publication of this notice declares, or varies the declaration of, the roads as described below and on the plans attached, and further declares that such roads are fit to be used as a public highway and are now absolutely dedicated to the public for use as public highways within the meaning of any law now or hereafter in force.

STATE HIGHWAY

87/00 Calder Highway in the City of Greater Bendigo shown hatched on plan numbered GP 19919.

MAIN ROAD

- 88/00 Epping-Kilmore Road in the Shire of Mitchell shown hatched on plan numbered GP 19909.
- 89/00 Forrest-Apollo Bay Road in the Shire of Colac-Otway shown cross hatched on plan numbered GP 19778.
- 90/00 Edgars Road in the City of Whittlesea shown hatched on plan numbered GP 19907.

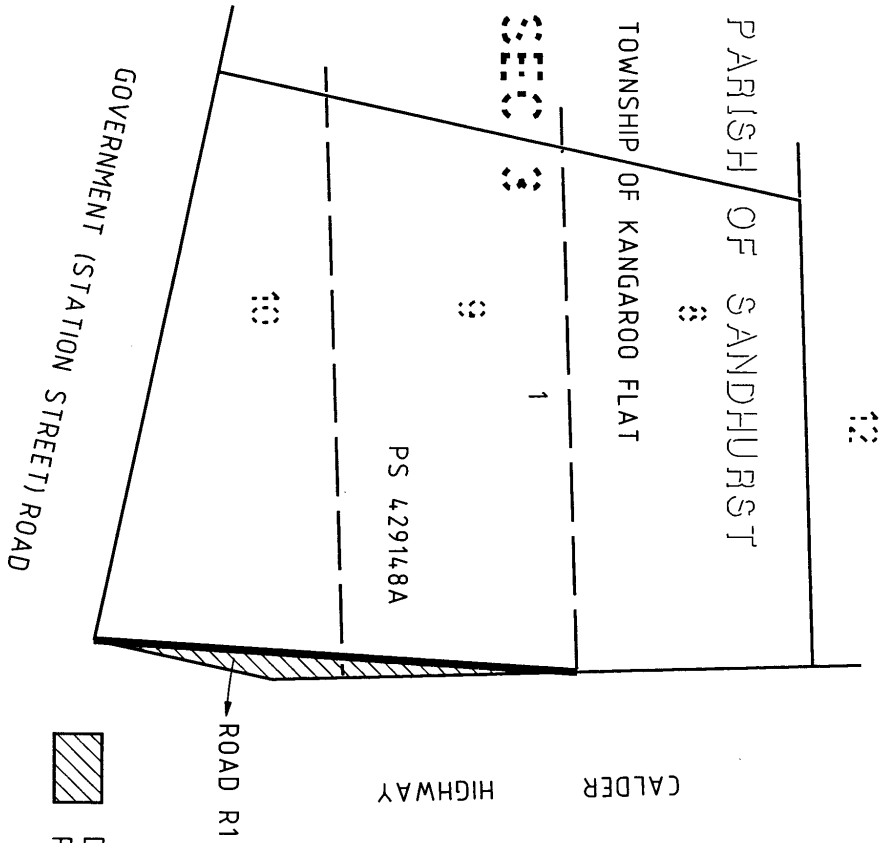

ROADS CORPORATION
 STATE HIGHWAY
 CALDER HIGHWAY
 CITY OF GREATER BENDIGO

DECLARE
 Parcel 1 on SP19919
 GP 19919
 Compiled from
 SP19919

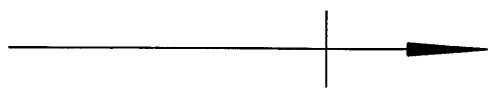

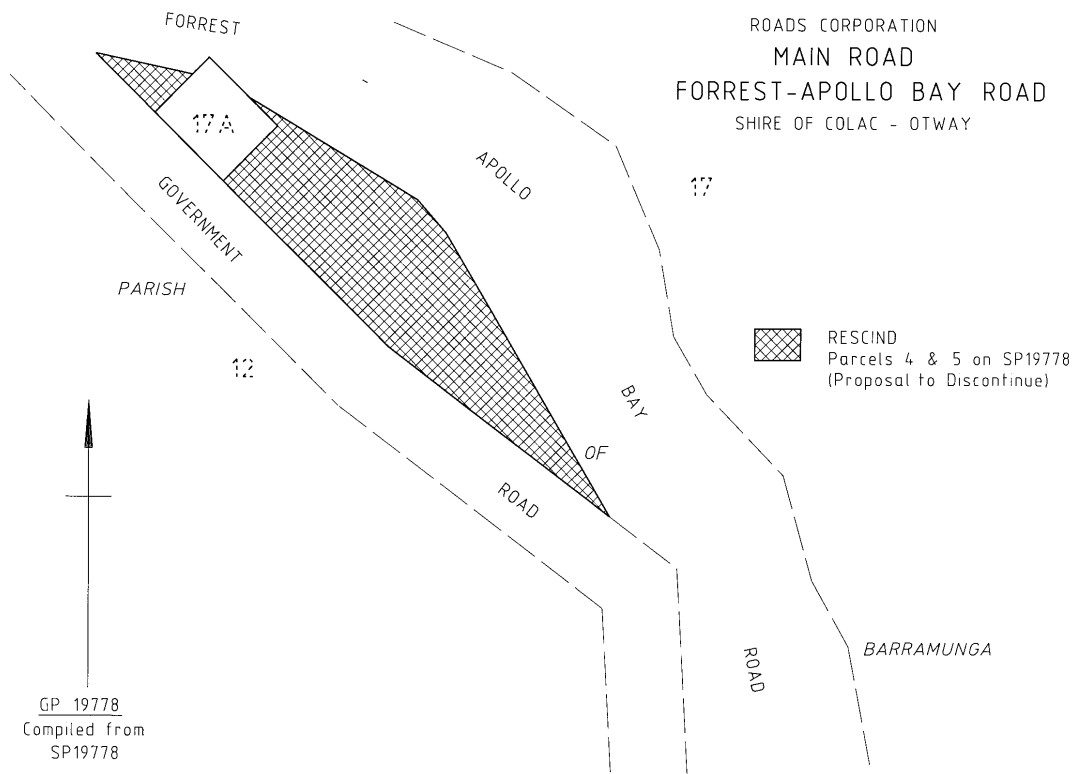
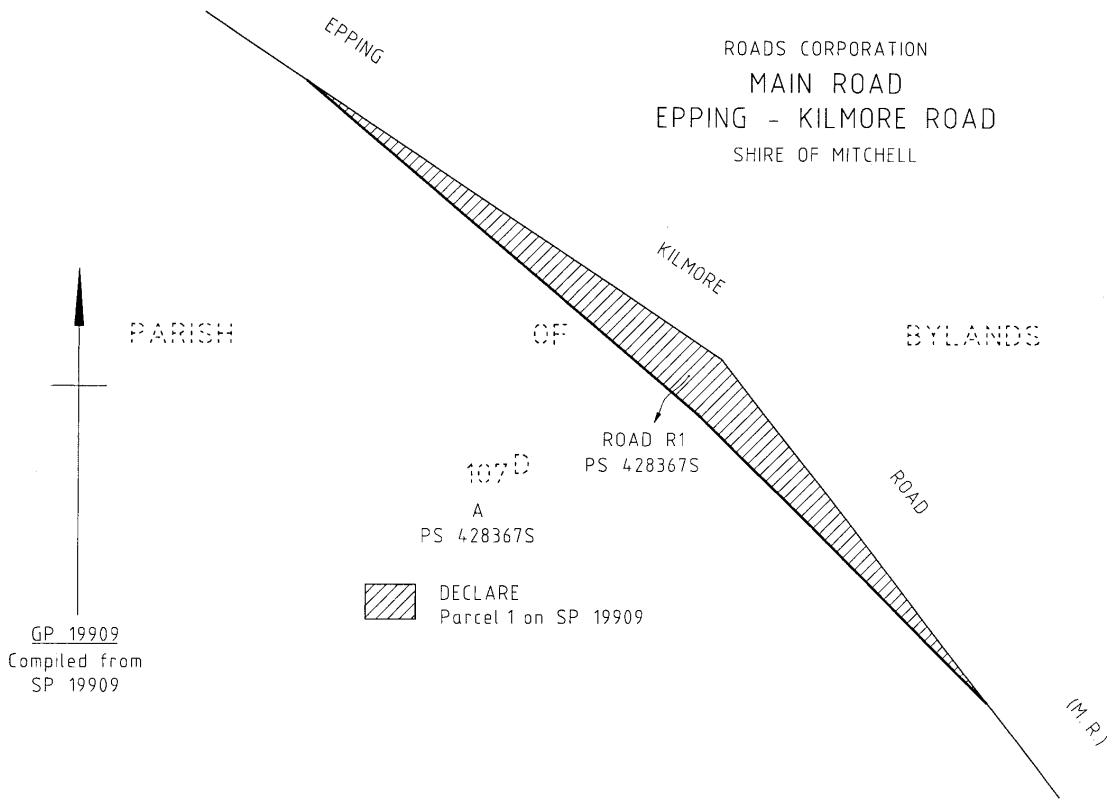

ROADS CORPORATION
MAIN ROAD
EDGARS ROAD
 CITY OF WHITTLESEA

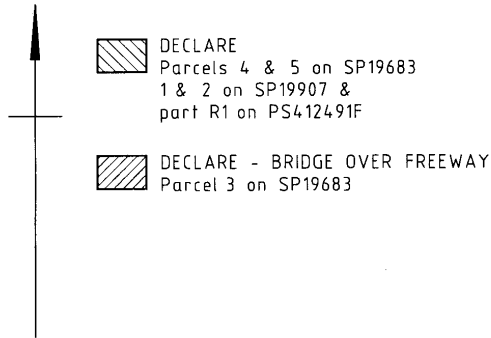

GP 19907
 Compiled from
 SP19683, SP19907
 & PS412491F

NOTE:
 THE HEAVIEST LINE INDICATES
 1 A restriction of access.
 2 The limits of the Freeway Reservation.

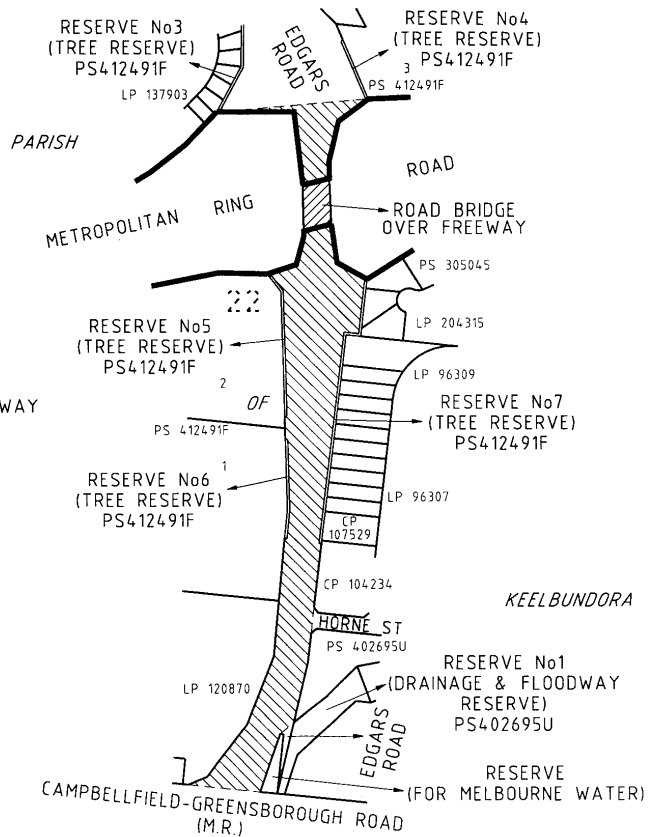

Dated 30 November 2000

COLIN JORDAN
 Chief Executive
 Roads Corporation

Melbourne and Metropolitan Board of Works Act 1958

NOTICE OF DETERMINATION

In accordance with Section 281A (1)-(3) of the **Melbourne and Metropolitan Board of Works Act 1958** and with Section 139 (3A) - (3C) of the **Water Industry Act 1994**, the Valuer General has determined the following valuation equalisation factors. These are the factors by which, in the opinion of the Valuer General, the net annual value of land within the specified area or postcode determined, as at 1 January 2000, ought to be multiplied if the net annual value of the land is to accord with levels of value generally prevailing in that area as at 30 June 1990.

| Postcode | Suburb or Area | Residential Equalisation Factor | Commercial Equalisation Factor | Industrial Equalisation Factor |
|----------|--------------------------|---------------------------------|--------------------------------|--------------------------------|
| 3000 | Melbourne | 0.90 | 1.50 | 1.15 |
| 3001 | Melbourne G.P.O. | 0.90 | 1.50 | 1.15 |
| 3002 | Melbourne East, Jolimont | 0.77 | 1.20 | 1.20 |
| 3003 | Melbourne West | 0.70 | 1.30 | 1.26 |

| Postcode | Suburb or Area | Residential Equalisation Factor | Commercial Equalisation Factor | Industrial Equalisation Factor |
|-----------------|---|--|---|---|
| 3004 | St Kilda Road (City of Melbourne) | 0.95 | 1.30 | 1.30 |
| 3005 | World Trade Centre | 0.90 | 1.08 | 1.08 |
| 3006 | Southbank | 0.92 | 1.40 | 1.26 |
| 3008 | Docklands | na | 0.88 | 1.08 |
| 3011 | Coode Island (Melbourne) | na | na | 1.08 |
| 3011 | Footscray (Maribyrnong) | 0.60 | 1.20 | 1.10 |
| 3012 | Brooklyn (Brimbank) | 0.65 | 1.10 | 1.10 |
| 3012 | Tottenham, Footscray West (Maribyrnong) | 0.65 | 1.10 | 1.25 |
| 3013 | Yarraville | 0.55 | 0.90 | 1.20 |
| 3015 | Newport, Spotswood | 0.58 | 0.92 | 1.10 |
| 3016 | Williamstown | 0.53 | 0.92 | 1.02 |
| 3018 | Altona | 0.66 | 0.92 | 1.02 |
| 3019 | Braybrook | 0.79 | 1.20 | 1.20 |
| 3020 | Sunshine | 0.94 | 1.10 | 1.10 |
| 3021 | St Albans | 0.98 | 1.10 | 1.02 |
| 3022 | Ardeer | 0.97 | 1.10 | 1.02 |
| 3023 | Deer Park (Brimbank) | 0.97 | 1.10 | 1.10 |
| 3023 | Burnside, Caroline Springs, Ravenhall (Melton) | 0.97 | 1.13 | 1.20 |
| 3024 | Wyndham Vale | 0.91 | 1.08 | 1.12 |
| 3025 | Altona North | 0.68 | 0.92 | 1.02 |
| 3026 | Laverton North | na | 0.96 | 1.04 |
| 3027 | Laverton RAAF | 0.80 | 1.00 | 1.00 |
| 3028 | Altona Meadows (Hobsons Bay) | 0.83 | 1.10 | 1.20 |
| 3028 | Laverton (Wyndham) | 0.83 | 1.08 | 1.20 |
| 3029 | Hoppers Crossing | 0.89 | 0.96 | 1.04 |
| 3030 | Truganina (Melton) | 0.92 | 0.98 | 1.22 |
| 3030 | Werribee, Point Cook (Wyndham) | 0.92 | 1.00 | 1.20 |
| 3031 | Flemington, Kensington (Melbourne) | 0.61 | 0.98 | 1.05 |
| 3031 | Flemington, Kensington (Moonee Valley) | 0.64 | 0.90 | 1.01 |
| 3032 | Maribyrnong, Highpoint Shopping Centre (Maribyrnong) | 0.64 | 0.90 | 1.10 |
| 3032 | Ascot Vale (Moonee Valley) | 0.64 | 0.94 | 1.08 |
| 3033 | Keilor East (Brimbank) | 0.77 | 0.95 | 1.10 |
| 3033 | Keilor East (Moonee Valley) | 0.77 | 0.94 | 1.08 |
| 3034 | Avondale Heights | 0.75 | 0.94 | 1.16 |
| 3036 | Keilor | 0.87 | 1.10 | 1.10 |
| 3037 | Sydenham (Brimbank) | 0.89 | 0.95 | 1.10 |
| 3037 | Hillside (Melton) | 0.89 | 0.90 | 1.20 |

| Postcode | Suburb or Area | Residential Equalisation Factor | Commercial Equalisation Factor | Industrial Equalisation Factor |
|-----------------|---------------------------------------|--|---|---|
| 3038 | Taylors Lakes | 0.95 | 0.95 | 1.10 |
| 3039 | Moonee Ponds | 0.56 | 1.02 | 0.99 |
| 3040 | Essendon | 0.60 | 0.87 | 0.90 |
| 3041 | Strathmore | 0.55 | 0.87 | 0.95 |
| 3042 | Keilor Park (Brimbank) | 0.70 | 0.95 | 1.02 |
| 3042 | Airport West, Niddrie (Moonee Valley) | 0.70 | 0.94 | 0.99 |
| 3043 | Tullamarine (Brimbank) | 0.82 | 0.95 | 1.10 |
| 3043 | Tullamarine (Hume) | 0.82 | 0.98 | 1.10 |
| 3043 | Tullamarine (Moreland) | 0.82 | 0.98 | 1.05 |
| 3044 | Pascoe Vale | 0.67 | 0.80 | 0.92 |
| 3045 | Melbourne Airport | na | 0.98 | 1.10 |
| 3046 | Glenroy | 0.76 | 0.90 | 1.05 |
| 3047 | Broadmeadows | 0.86 | 0.98 | 0.90 |
| 3048 | Coolaroo | 0.88 | 0.98 | 0.90 |
| 3049 | Westmeadows | 0.87 | 0.98 | 0.90 |
| 3050 | Royal Melbourne Hospital | 0.70 | 0.99 | 0.99 |
| 3051 | North Melbourne (Melbourne) | 0.70 | 1.10 | 1.08 |
| 3051 | North Melbourne (Moonee Valley) | 0.72 | 0.99 | 1.05 |
| 3052 | Parkville | 0.70 | 0.99 | 0.99 |
| 3053 | Carlton | 0.70 | 0.95 | 1.05 |
| 3054 | Carlton North | 0.62 | 0.85 | 0.95 |
| 3055 | Brunswick West | 0.58 | 0.80 | 1.05 |
| 3056 | Brunswick | 0.61 | 0.85 | 0.96 |
| 3057 | Brunswick East | 0.60 | 0.90 | 1.00 |
| 3058 | Coburg | 0.63 | 0.90 | 0.96 |
| 3059 | Greenvale | 0.74 | 0.98 | 0.81 |
| 3060 | Fawkner | 0.80 | 0.85 | 0.85 |
| 3061 | Campbellfield | 0.87 | 0.98 | 0.81 |
| 3062 | Somerton | 0.87 | 0.98 | 0.81 |
| 3064 | Craigieburn, Roxburgh Park (Hume) | 0.88 | 0.95 | 0.81 |
| 3064 | Craigieburn (Whittlesea) | 0.88 | 0.92 | 0.80 |
| 3065 | Fitzroy | 0.56 | 0.83 | 0.82 |
| 3066 | Collingwood | 0.57 | 0.86 | 0.87 |
| 3067 | Abbotsford | 0.52 | 0.90 | 0.87 |
| 3068 | Fitzroy North (Moreland) | 0.54 | 0.85 | 0.85 |
| 3068 | Fitzroy North (Yarra) | 0.54 | 0.86 | 0.85 |
| 3070 | Northcote | 0.60 | 0.87 | 0.97 |
| 3071 | Thornbury | 0.70 | 0.87 | 0.97 |
| 3072 | Preston | 0.70 | 0.87 | 0.97 |

| Postcode | Suburb or Area | Residential Equalisation Factor | Commercial Equalisation Factor | Industrial Equalisation Factor |
|-----------------|------------------------------|--|---|---|
| 3073 | Reservoir | 0.75 | 0.87 | 0.97 |
| 3074 | Thomastown | 0.89 | 0.88 | 0.86 |
| 3075 | Lalor | 0.92 | 0.88 | 0.86 |
| 3076 | Epping | 0.78 | 0.88 | 0.86 |
| 3078 | Fairfield (Darebin) | 0.60 | 0.87 | 0.97 |
| 3078 | Fairfield (Yarra) | 0.60 | 0.86 | 0.91 |
| 3079 | Ivanhoe | 0.59 | 0.92 | 0.90 |
| 3081 | Heidelberg West | 0.71 | 0.92 | 0.90 |
| 3082 | Mill Park | 0.77 | 0.88 | 0.86 |
| 3083 | Bundoora (Banyule) | 0.77 | 0.92 | 0.90 |
| 3083 | Bundoora (Darebin) | 0.77 | 0.87 | 0.97 |
| 3083 | Bundoora (Whittlesea) | 0.77 | 0.93 | 1.02 |
| 3084 | Heidelberg | 0.67 | 0.92 | 0.90 |
| 3085 | Macleod | 0.69 | 0.92 | 0.90 |
| 3087 | Watsonia | 0.76 | 0.92 | 0.90 |
| 3088 | Greensborough (Banyule) | 0.78 | 0.92 | 0.90 |
| 3088 | Greensborough (Nillumbik) | 0.78 | 0.94 | 0.89 |
| 3089 | Diamond Creek | 0.82 | 0.94 | 0.89 |
| 3090 | Plenty | 0.80 | 0.94 | 0.89 |
| 3091 | Yarrambat | 0.78 | 0.92 | 0.89 |
| 3093 | Lower Plenty | 0.74 | 0.92 | 0.90 |
| 3094 | Montmorency | 0.76 | 0.92 | 0.90 |
| 3095 | Eltham | 0.76 | 0.94 | 1.14 |
| 3096 | Wattle Glen | 0.80 | 0.82 | 1.14 |
| 3097 | Kangaroo Ground | 0.77 | 0.82 | 1.14 |
| 3099 | Hurstbridge | 0.81 | 0.82 | 1.05 |
| 3101 | Kew | 0.62 | 0.90 | 0.87 |
| 3102 | Kew East | 0.60 | 0.90 | 0.87 |
| 3103 | Balwyn | 0.55 | 0.90 | 0.87 |
| 3104 | Balwyn North | 0.55 | 0.90 | 0.87 |
| 3105 | Bulleen | 0.71 | 0.90 | 0.90 |
| 3106 | Templestowe | 0.75 | 0.82 | 0.90 |
| 3107 | Lower Templestowe | 0.71 | 0.82 | 0.90 |
| 3108 | Doncaster | 0.72 | 0.90 | 0.90 |
| 3109 | Doncaster East | 0.73 | 0.90 | 0.90 |
| 3111 | Donvale | 0.75 | 0.82 | 0.90 |
| 3113 | Warrandyte (Manningham) | 0.78 | 0.82 | 0.90 |
| 3113 | Warrandyte North (Nillumbik) | 0.78 | 0.82 | 0.89 |
| 3114 | Park Orchards | 0.76 | 0.82 | 0.90 |

| Postcode | Suburb or Area | Residential Equalisation Factor | Commercial Equalisation Factor | Industrial Equalisation Factor |
|-----------------|--|--|---|---|
| 3115 | Wonga Park | 0.75 | 0.82 | 0.90 |
| 3116 | Chirnside Park | 0.79 | 0.70 | 0.75 |
| 3121 | Richmond | 0.52 | 0.80 | 0.91 |
| 3122 | Hawthorn | 0.59 | 0.90 | 0.87 |
| 3123 | Hawthorn East | 0.61 | 0.90 | 0.87 |
| 3124 | Camberwell | 0.57 | 0.90 | 0.87 |
| 3125 | Burwood (Boroondara) | 0.60 | 0.90 | 0.87 |
| 3125 | Burwood (Monash) | 0.60 | 0.93 | 0.76 |
| 3125 | Burwood (Whitehorse) | 0.60 | 0.93 | 0.78 |
| 3126 | Canterbury | 0.60 | 0.90 | 0.87 |
| 3127 | Surrey Hills | 0.61 | 0.82 | 0.87 |
| 3128 | Box Hill | 0.63 | 1.02 | 0.70 |
| 3129 | Box Hill North | 0.62 | 0.82 | 0.65 |
| 3130 | Blackburn | 0.75 | 0.86 | 0.70 |
| 3131 | Nunawading | 0.77 | 0.90 | 0.70 |
| 3132 | Mitcham (Manningham) | 0.80 | 0.82 | 0.85 |
| 3132 | Mitcham (Whitehorse) | 0.80 | 0.82 | 0.78 |
| 3133 | Vermont, Vermont South | 0.80 | 0.80 | 0.78 |
| 3134 | Ringwood North (Manningham) | 0.75 | 0.82 | 0.90 |
| 3134 | Ringwood (Maroondah) | 0.75 | 0.77 | 0.85 |
| 3135 | Ringwood East, Heathmont | 0.72 | 0.71 | 0.80 |
| 3136 | Croydon | 0.80 | 0.76 | 0.83 |
| 3137 | Kilsyth South (Maroondah) | 0.85 | 0.76 | 0.83 |
| 3137 | Kilsyth (Yarra Ranges) | 0.85 | 0.75 | 0.85 |
| 3138 | Mooroolbark | 0.90 | 0.75 | 0.80 |
| 3139 | Wandin | 0.85 | 0.75 | 0.80 |
| 3140 | Lilydale | 0.83 | 0.70 | 0.75 |
| 3141 | South Yarra (Melbourne) | 0.75 | 0.95 | 0.95 |
| 3141 | South Yarra (Stonnington) | 0.69 | 0.88 | 0.88 |
| 3142 | Toorak | 0.71 | 0.84 | 0.85 |
| 3143 | Armadale | 0.65 | 0.84 | 0.92 |
| 3144 | Malvern | 0.66 | 0.91 | 0.97 |
| 3145 | Malvern East | 0.69 | 0.98 | 0.97 |
| 3146 | Glen Iris (Boroondara) | 0.62 | 0.90 | 0.89 |
| 3146 | Glen Iris (Stonnington) | 0.62 | 0.91 | 0.95 |
| 3147 | Ashburton (Boroondara) | 0.60 | 0.90 | 0.87 |
| 3147 | Ashwood (Monash) | 0.60 | 0.93 | 0.83 |
| 3148 | Chadstone (Monash) | 0.67 | 0.97 | 0.94 |
| 3148 | Malvern East, Chadstone Shopping Centre (Stonnington) | 0.67 | 0.98 | 0.97 |

| Postcode | Suburb or Area | Residential Equalisation Factor | Commercial Equalisation Factor | Industrial Equalisation Factor |
|-----------------|---|--|---|---|
| 3149 | Mount Waverley | 0.71 | 0.97 | 0.83 |
| 3150 | Glen Waverley | 0.77 | 0.97 | 0.83 |
| 3151 | Burwood East | 0.73 | 0.86 | 0.86 |
| 3152 | Wantirna, Wantirna South | 0.81 | 0.90 | 1.00 |
| 3153 | Bayswater (Knox) | 0.84 | 0.90 | 1.00 |
| 3153 | Bayswater North (Maroondah) | 0.84 | 0.90 | 0.95 |
| 3154 | The Basin | 0.81 | 0.90 | 1.00 |
| 3155 | Boronia | 0.85 | 0.90 | 1.00 |
| 3156 | Ferntree Gully, Lysterfield (Knox) | 0.77 | 0.90 | 0.90 |
| 3156 | Upper Ferntree Gully (Yarra Ranges) | 0.77 | 0.85 | 0.85 |
| 3158 | Upwey | 0.80 | 0.70 | 0.85 |
| 3159 | Menzies Creek, Selby | 0.81 | 0.75 | 0.85 |
| 3160 | Belgrave, Tecoma | 0.82 | 0.70 | 0.75 |
| 3161 | Caulfield North | 0.62 | 0.90 | 0.90 |
| 3162 | Caulfield, Caulfield South | 0.60 | 0.90 | 0.90 |
| 3163 | Carnegie, Glen Huntly | 0.60 | 0.90 | 0.90 |
| 3165 | Bentleigh East | 0.60 | 0.90 | 0.90 |
| 3166 | Oakleigh | 0.68 | 0.97 | 0.76 |
| 3167 | Oakleigh South | 0.75 | 0.97 | 0.83 |
| 3168 | Clayton | 0.72 | 0.93 | 0.80 |
| 3169 | Clarinda, Clayton South | 0.74 | 0.93 | 0.96 |
| 3170 | Mulgrave | 0.74 | 1.07 | 0.80 |
| 3171 | Springvale | 0.89 | 1.05 | 0.88 |
| 3172 | Springvale South (Gr Dandenong) | 0.87 | 1.05 | 0.96 |
| 3172 | Dingley (Kingston) | 0.87 | 1.05 | 0.96 |
| 3173 | Keysborough | 0.89 | 0.92 | 0.90 |
| 3174 | Noble Park | 0.93 | 1.05 | 0.96 |
| 3175 | Dandenong | 0.89 | 1.01 | 1.04 |
| 3177 | Doveton | 1.00 | 1.02 | 0.89 |
| 3178 | Rowville | 0.82 | 0.90 | 1.00 |
| 3179 | Scoresby | 0.81 | 0.90 | 1.00 |
| 3180 | Knoxfield | 0.79 | 0.90 | 1.00 |
| 3181 | Prahran, Windsor | 0.63 | 0.84 | 0.89 |
| 3182 | St Kilda | 0.55 | 0.83 | 1.02 |
| 3183 | Ripponlea (Glen Eira) | 0.65 | 0.90 | 0.90 |
| 3183 | St Kilda East, Balaclava (Port Phillip) | 0.59 | 0.86 | 0.93 |
| 3184 | Elwood | 0.55 | 0.70 | 0.93 |
| 3185 | Elsternwick | 0.55 | 0.80 | 0.90 |

| Postcode | Suburb or Area | Residential Equalisation Factor | Commercial Equalisation Factor | Industrial Equalisation Factor |
|-----------------|--|--|---|---|
| 3186 | Brighton | 0.57 | 0.75 | 0.86 |
| 3187 | Brighton East | 0.59 | 0.75 | 0.86 |
| 3188 | Hampton | 0.55 | 0.75 | 0.86 |
| 3189 | Moorabbin (Batside) | 0.61 | 0.78 | 0.89 |
| 3189 | Moorabbin (Kingston) | 0.61 | 0.78 | 0.89 |
| 3190 | Highett (Bayside) | 0.61 | 0.78 | 0.89 |
| 3190 | Highett (Kingston) | 0.61 | 0.78 | 0.89 |
| 3191 | Sandringham | 0.55 | 0.70 | 0.78 |
| 3192 | Cheltenham (Bayside) | 0.64 | 0.78 | 0.89 |
| 3192 | Cheltenham (Kingston) | 0.64 | 0.78 | 0.89 |
| 3193 | Beaumaris, Black Rock | 0.57 | 0.70 | 0.86 |
| 3194 | Mentone | 0.64 | 0.82 | 0.96 |
| 3195 | Mordialloc, Aspendale | 0.67 | 0.93 | 0.96 |
| 3196 | Chelsea, Edithvale | 0.69 | 0.82 | 0.89 |
| 3197 | Bonbeach, Carrum, Patterson Lakes | 0.68 | 0.82 | 0.96 |
| 3198 | Seaford | 0.90 | 1.20 | 0.92 |
| 3199 | Frankston, Frankston South | 0.91 | 1.20 | 0.92 |
| 3200 | Frankston North | 0.99 | 0.97 | 0.92 |
| 3201 | Carrum Downs | 0.91 | 0.87 | 0.87 |
| 3202 | Heatherton | 0.72 | 0.82 | 0.96 |
| 3204 | Bentleigh, Mckinnon, Ormond | 0.55 | 0.80 | 0.90 |
| 3205 | South Melbourne, Southbank (Port Phillip) | 0.65 | 1.20 | 1.10 |
| 3206 | Albert Park, Middle Park | 0.58 | 0.78 | 0.93 |
| 3207 | Port Melbourne (Melbourne) | na | 1.20 | 1.30 |
| 3207 | Port Melbourne, Beacon Cove (Port Phillip) | 0.70 | 1.20 | 1.25 |
| 3211 | Little River | 0.95 | 1.00 | 1.04 |
| 3335 | Rockbank | 0.98 | 1.10 | 1.08 |
| 3337 | Melton | 1.05 | 0.90 | 0.99 |
| 3338 | Melton South | 1.10 | 0.84 | 1.08 |
| 3340 | Bacchus Marsh | 0.90 | 0.98 | 0.86 |
| 3427 | Diggers Rest | 0.97 | 0.96 | 1.03 |
| 3428 | Bulla | 0.95 | 0.98 | 1.03 |
| 3429 | Sunbury | 1.01 | 0.98 | 1.03 |
| 3750 | Wollert | 0.78 | 0.88 | 0.86 |
| 3751 | Beveridge | 0.90 | 0.88 | 0.89 |
| 3752 | South Morang | 0.85 | 0.88 | 0.86 |
| 3754 | Doreen (Nillumbik) | 0.85 | 0.82 | 0.98 |
| 3754 | Mernda (Whittlesea) | 0.85 | 0.88 | 0.90 |
| 3755 | Yan Yean (Nillumbik) | 0.88 | 0.82 | 0.98 |

| Postcode | Suburb or Area | Residential Equalisation Factor | Commercial Equalisation Factor | Industrial Equalisation Factor |
|-----------------|-------------------------------|--|---|---|
| 3755 | Yan Yean (Whittlesea) | 0.88 | 0.88 | 0.90 |
| 3757 | Whittlesea | 0.91 | 0.88 | 0.86 |
| 3759 | Panton Hill | 0.80 | 0.82 | 1.05 |
| 3760 | Smiths Gully | 0.79 | 0.82 | 1.05 |
| 3761 | St Andrews | 0.79 | 0.82 | 1.05 |
| 3765 | Montrose | 0.83 | 0.75 | 0.85 |
| 3766 | Kalorama | 0.78 | 0.75 | 0.85 |
| 3767 | Mount Dandenong | 0.80 | 0.75 | 0.85 |
| 3770 | Coldstream | 0.88 | 0.80 | 0.85 |
| 3775 | Christmas Hills (Nillumbik) | 0.84 | 0.82 | 0.89 |
| 3775 | Yarra Glen (Yarra Ranges) | 0.84 | 0.85 | 0.85 |
| 3777 | Healesville | 0.80 | 0.80 | 0.85 |
| 3781 | Cockatoo | 0.81 | 0.94 | 0.81 |
| 3782 | Clematis, Emerald | 0.78 | 0.94 | 0.81 |
| 3783 | Gembrook | 0.90 | 0.94 | 0.81 |
| 3785 | Tremont | 0.77 | 0.70 | 0.75 |
| 3786 | Ferny Creek | 0.76 | 0.70 | 0.75 |
| 3787 | Sassafras | 0.79 | 0.70 | 0.75 |
| 3788 | Olinda | 0.76 | 0.70 | 0.75 |
| 3789 | Sherbrooke | 0.74 | 0.70 | 0.75 |
| 3791 | Kallista | 0.78 | 0.75 | 0.75 |
| 3792 | The Patch | 0.80 | 0.75 | 0.75 |
| 3793 | Monbulk | 0.79 | 0.75 | 0.75 |
| 3795 | Silvan | 0.82 | 0.75 | 0.75 |
| 3796 | Mount Evelyn | 0.88 | 0.70 | 0.75 |
| 3797 | Yarra Junction | 0.84 | 0.70 | 0.80 |
| 3799 | Warburton, Millgrove, Wesburn | 0.87 | 0.75 | 0.80 |
| 3802 | Endeavour Hills | 0.88 | 0.90 | 0.89 |
| 3803 | Hallam | 0.85 | 0.90 | 0.89 |
| 3804 | Narre Warren North | 0.86 | 0.80 | 0.89 |
| 3805 | Narre Warren | 0.88 | 0.80 | 0.89 |
| 3806 | Berwick | 0.90 | 0.90 | 0.89 |
| 3807 | Beaconsfield (Cardinia) | 0.82 | 0.94 | 0.81 |
| 3807 | Beaconsfield (Casey) | 0.82 | 0.90 | 0.83 |
| 3808 | Beaconsfield Upper | 0.80 | 0.94 | 0.81 |
| 3809 | Officer | 0.88 | 0.94 | 0.81 |
| 3810 | Pakenham | 0.88 | 0.94 | 0.81 |
| 3812 | Maryknoll, Nar Nar Goon | 0.91 | 0.94 | 0.81 |
| 3813 | Tynong | 0.96 | 0.94 | 0.81 |

| Postcode | Suburb or Area | Residential Equalisation Factor | Commercial Equalisation Factor | Industrial Equalisation Factor |
|-----------------|-----------------------------------|--|---|---|
| 3814 | Cora Lynn, Garfield | 0.90 | 0.94 | 0.81 |
| 3815 | Bunyip | 0.85 | 0.94 | 0.81 |
| 3816 | Labertouche | 1.02 | 0.90 | 0.90 |
| 3818 | Drouin | 0.88 | 0.95 | 0.90 |
| 3820 | Warragul | 0.89 | 0.85 | 0.90 |
| 3821 | Buln Buln, Brandy Creek, Lardner | 0.96 | 1.00 | 0.90 |
| 3831 | Neerim | 0.88 | 0.90 | 0.90 |
| 3910 | Langwarrin | 0.90 | 0.77 | 0.87 |
| 3911 | Baxter | 0.91 | 0.99 | 0.89 |
| 3912 | Pearcedale (Casey) | 0.83 | 1.02 | 0.95 |
| 3912 | Somerville (Mornington Peninsula) | 0.83 | 0.99 | 1.02 |
| 3913 | Tyabb | 0.92 | 0.99 | 1.02 |
| 3915 | Hastings | 0.87 | 1.15 | 1.17 |
| 3916 | Merricks, Point Leo, Shoreham | 0.80 | 0.95 | 1.17 |
| 3918 | Bittern | 0.85 | 1.15 | 1.17 |
| 3919 | Crib Point | 0.93 | 1.15 | 1.17 |
| 3920 | HMAS Cerberus | 0.93 | na | 1.17 |
| 3926 | Balnarring | 0.85 | 1.15 | 1.17 |
| 3927 | Somers | 0.85 | 0.95 | 1.17 |
| 3928 | Main Ridge | 0.75 | 1.15 | 1.17 |
| 3929 | Flinders | 0.64 | 0.99 | 1.17 |
| 3930 | Mount Eliza | 0.82 | 0.99 | 1.17 |
| 3931 | Mornington | 0.76 | 0.88 | 0.89 |
| 3933 | Moorooduc | 0.80 | 0.95 | 1.17 |
| 3934 | Mount Martha | 0.81 | 1.15 | 1.17 |
| 3936 | Dromana | 0.85 | 1.10 | 0.99 |
| 3937 | Red Hill | 0.84 | 0.84 | 1.05 |
| 3938 | McCrae | 0.86 | 1.06 | 1.30 |
| 3939 | Rosebud, Boneo, Cape Schanck | 0.90 | 1.10 | 1.30 |
| 3940 | Rosebud West | 0.93 | 0.98 | 1.30 |
| 3941 | Rye, Tootgarook | 0.85 | 1.10 | 1.30 |
| 3942 | Blairgowrie | 0.75 | 0.95 | 1.30 |
| 3943 | Sorrento | 0.62 | 1.15 | 1.12 |
| 3944 | Portsea, Point Nepean | 0.72 | 0.84 | 1.12 |
| 3951 | Ranceby | 0.95 | 0.98 | 1.05 |
| 3975 | Lyndhurst (Casey) | 0.82 | 1.02 | 0.89 |
| 3975 | Lyndhurst (Gr Dandenong) | 0.82 | 1.05 | 0.80 |
| 3976 | Hampton Park (Casey) | 0.91 | 1.02 | 0.89 |
| 3976 | Dandenong South (Gr Dandenong) | 0.91 | 1.05 | 0.80 |

| Postcode | Suburb or Area | Residential Equalisation Factor | Commercial Equalisation Factor | Industrial Equalisation Factor |
|----------|---------------------|---------------------------------------|--------------------------------------|--------------------------------------|
| 3977 | Cranbourne (Casey) | 0.91 | 0.90 | 0.89 |
| 3977 | Skye (Frankston) | 0.91 | 0.97 | 0.92 |
| 3978 | Clyde | 0.89 | 1.02 | 0.89 |
| 3979 | Clyde North | 0.85 | 1.02 | 0.89 |
| 3980 | Tooradin, Warneet | 0.95 | 1.00 | 0.89 |
| 3981 | Bayles, Koo Wee Rup | 0.89 | 0.94 | 0.81 |
| 3984 | Lang Lang | 0.85 | 0.94 | 0.81 |
| 3987 | Nyora | 1.02 | 0.98 | 1.05 |
| 3988 | Poowong | 0.93 | 0.98 | 1.05 |

Geographic Place Names Act 1998

NOTICE OF REGISTRATION OF GEOGRAPHIC NAMES

The Registrar of Geographic Names hereby gives notice of the registration of the undermentioned place names.

| File No. | Place Name | Proposer & Location |
|----------|---------------------|---|
| GPN 268 | Olives Corner | City of Port Phillip. Corner of Liardet, Bay and Lalor Streets, Port Melbourne. |
| GPN 336 | Alexander Webb Park | City of Greater Geelong. High Street, Belmont. |

Office of the Registrar of Geographic Names
c/-LAND VICTORIA
2nd Floor
456 Lonsdale Street
Melbourne 3000

KEITH C. BELL
Registrar of Geographic Names

Geographic Place Names Act 1998

CORRIGENDUM

In Victoria Government Gazette No. G29, 23 July 1998, page 1987, under Notice of Assignment of Place Names, the place name of Glen Lee in the Shire of Hindmarsh should read Glenlee.

In Victoria Government Gazette No. G27, 8 July 1999, page 1591, under Notice of Registration of Geographic Names, the place names of Bundaluguah and Moiwera in the Wellington Shire should read Bundalugah and Miowera respectively.

Office of the Registrar of Geographic Names
c/-LAND VICTORIA
2nd Floor
456 Lonsdale Street
Melbourne 3000

KEITH C. BELL
Registrar of Geographic Names

Stamps Act 1958

NOTICE UNDER SECTION 40A

Pursuant to section 40A of the **Stamps Act 1958** I hereby declare and make effective from 1 December 2000, that:

AP 219 – John James Tait, John Morton Ardlie & Donald Aitken trading as Tait's Solicitors & Consultants

to be no longer an "authorised person" in relation to the stamping of transfers of land, mortgages, bonds, debentures and covenants, marketable securities, leases, agreements to lease, assignments or transfers of lease and instruments of settlement.

DAVID POLLARD
Commissioner of State Revenue

Stamps Act 1958

NOTICE UNDER SECTION 40A

Pursuant to section 40A of the **Stamps Act 1958** I hereby declare and make effective from 29 November 2000, that:

AP405 – One Hundredth Goblin Pty Ltd trading as Nambour Secretarial Services

to be no longer an "authorised person" in relation to the stamping of transfers of land, mortgages, bonds, debentures and covenants, marketable securities, leases, agreements to lease, assignments or transfers of lease and instruments of settlement.

DAVID POLLARD
Commissioner of State Revenue

Stamps Act 1958

NOTICE UNDER SECTION 40A

Pursuant to section 40A of the **Stamps Act 1958** I hereby declare and make effective from 1 December 2000, that:

AP 436 – Donald Aitken, John James Tait, John Morton Ardlie, Grant Adrian Ezzy, Bruce Robert Leishman, Sergio Umberton Bacchetti & Erol Robert Francis Chakir trading as Tait Taylor Lawyers

be an "authorised person" in relation to the stamping of transfers of land, mortgages, bonds, debentures or covenants, marketable securities, leases, agreements to lease, assignments or transfers of lease and instruments of settlement.

DAVID POLLARD
Commissioner of State Revenue

Building Act 1993

BUILDING REGULATIONS 1994

Notice of Exemption under Section 216A
of the **Building Act 1993** for
Cardinia Shire Council

I, Johnstone William Thwaites, Minister for Planning, on being satisfied that sufficient private building surveyors are available to consider applications for building permits for building work other than prescribed domestic building work in relation to land in the Council's municipal district and pursuant to section 216A of the **Building Act 1993** ("the Act"), exempt the Municipal Building Surveyor of Cardinia Shire Council from any requirement to consider applications for building permits for building work other than prescribed domestic building work. This exemption shall have effect provided for under section 216A(3) of the Act and may be revoked at any time.

JOHN THWAITES
Minister for Planning

Country Fire Authority Act 1958

DECLARATION OF FIRE DANGER
PERIOD

In pursuance of the powers conferred by Section 4 of the **Country Fire Authority Act 1958**, I Leonard Raymond Foster, Chairman of the Country Fire Authority, after consultation with the Secretary of Natural Resources and Environment, hereby declare the following periods to be the Fire Danger Period in the municipal districts of the municipalities or parts of municipalities specified, commencing on the dates shown and, unless varied by subsequent declaration, ending at 01.00 hours on Monday 1 May, 2001.

To commence from 01.00 hours on Monday 11 December 2000: Glenelg Shire (whole), Colac/Otway (whole), Corangamite (whole), Mitchell Shire (whole), Murrindindi Shire (whole), Horsham Rural City (remainder), Hindmarsh Shire (remainder), West Wimmera Shire (whole), Yarriambiack Shire (remainder), City of Greater Shepparton (whole), Shire of Moira (whole).

Southern Grampians Shire (Northern part – Glenisla area) That part north of Mountain Dam, Old Henty Highway (south), Henty Highway, Billywing Road, Goat Track and Syphon Road (north to Glenelg River).

Southern Grampians Shire Council (Western Part):- That portion west of the line described:- Commencing on the Chetwynd/Nareen Road following a southerly direction to a point two kilometres north to the Wando Vale North Road then easterly to Saw Pit Gully Road and Carrols Road. Then south easterly to the Wannon River. Following the Wannon River to Murrindale Road then southerly following the Condah/Coleraine Road to McMillans Road. Then easterly to the Henty Highway then north to Lens Road. Easterly to the Wallacedale/Hamilton Road to Branxholme/Byaduk Road to Kinghorn Road then following in a south westerly direction to a point south of Ryans Road where the Glenelg, Moyne and Southern Grampians Shires meet.

Loddon Shire Council (Northern Part) – That part north of a line commencing on the western boundary of the shire travelling easterly along the Borung-Charlton Road to Borung, then along the Borung-Hurstwood Road to the Loddon River, then generally southerly along the Loddon River to the Bridgewater-Serpentine Road, then along Foleys Road to the Loddon Valley Highway, then Northerly to Rothackers Road, then continue east along Rothackers Road and Tandarra-Serpentine Road, then south along Thompsons Road then east along Tandarra-Elmore Road and Steads Road to the shire's eastern boundary.

To commence from 01.00 hours on Monday 18 December, 2000: Shire of Campaspe (whole), Shire of Strathbogie (whole).

L. FOSTER
Executive Chairman

Co-Operatives Act 1996

NOTICE OF ISSUE OF CERTIFICATE OF REGISTRATION PURSUANT TO SECTION 26(1)(B) OF THE CO-OPERATIVES ACT 1996

Notice is hereby given pursuant to section 26(1)(b) of the **Co-Operatives Act 1996** that a certificate of registration was issued by the Registrar of Co-operatives on 28 November 2000 to North East Flower Growers Co-Operative Limited and the Co-operative is now incorporated under the said Act.

Dated at Melbourne 28 November 2000

PAUL HOPKINS
Deputy Registrar of Co-operatives

Rail Corporations Act 1996

NOTICE UNDER SECTION 39(2) OF THE RAIL CORPORATIONS ACT 1996

Pursuant to Section 39(2) of the **Rail Corporations Act 1996** (the Act), I fix 1 December 2000 as the relevant date for the purposes of an allocation statement dated 28 November 2000 made under Section 41 of the Act to transfer certain property, rights and liabilities of Victorian Rail Track to the Spencer Street Station Authority.

Dated 28 November 2000

PETER BATCHELOR
Minister for Transport
of the State of Victoria

Australian Grands Prix Act 1994

DESIGNATED ACCESS AREA

This Notice shall take effect on and from the date of its publication in the Government Gazette.

In accordance with section 32A of the **Australian Grands Prix Act 1994**, as the Minister administering the **Road Safety Act 1986**, the Minister administering the **Crown Land (Reserves) Act 1978** and the Minister administering the **Australian Grands Prix Act 1994**, we jointly declare that the area, being all of the land situated within 1.5 metres east of the Queens Road boundary of Albert Park (as defined in the **Australian Grands Prix Act 1994**) between the points marked A and B on the plan numbered LEGL./95-128 and lodged in the Central Plan Office, is a designated access area for the period commencing at 12.02 am on Monday 11 December 2000 and ending at 11.58 pm on Monday 2 April 2001.

Dated 27 November 2000

PETER BATCHELOR MLA
Minister for Transport
SHERRYL GARBUTT MLA
Minister for Environment
and Conservation

JOHN PANDAZOPOULOS MLA
Minister for Major Projects & Tourism

Australian Grands Prix Act 1994

DESIGNATED ACCESS AREA

This Notice shall take effect on and from the date of its publication in the Government Gazette.

In accordance with section 32A of the **Australian Grands Prix Act 1994**, as the Minister administering the **Road Safety Act 1986**, the Minister administering the **Crown Land (Reserves) Act 1978** and the Minister administering the **Australian Grands Prix Act 1994**, we jointly declare that the area, being all of the land coloured yellow on the plan numbered LEGL./95-128 and lodged in the Central Plan Office, is a designated access area for the period commencing at 12.02 am on Monday 11 December 2000 and ending at 11.58 pm on Monday 2 April 2001.

Dated 27 November 2000

PETER BATCHELOR MLA
Minister for Transport
SHERRYL GARBUTT MLA
Minister for Environment
and Conservation

JOHN PANDAZOPOULOS MLA
Minister for Major Projects & Tourism

Australian Grands Prix Act 1994

DESIGNATED ACCESS AREA

This Notice shall take effect on and from the date of its publication in the Government Gazette.

In accordance with section 32A of the **Australian Grands Prix Act 1994**, as the Minister administering the **Road Safety Act 1986**, the Minister administering the **Crown Land (Reserves) Act 1978** and the Minister administering the **Australian Grands Prix Act 1994**, we jointly declare that the area, being all of the land coloured green on the plan numbered LEGL./95-128 and lodged in the Central Plan Office, is a designated access area for the period commencing at 12.02 am on Tuesday 13 February 2001 and ending at 11.58 pm on Monday 12 March 2001.

Dated 27 November 2000

PETER BATCHELOR MLA
Minister for Transport
SHERRYL GARBUTT MLA
Minister for Environment
and Conservation

JOHN PANDAZOPOULOS MLA
Minister for Major Projects & Tourism

Australian Grands Prix Act 1994

DESIGNATED ACCESS AREA

This Notice shall take effect on and from the date of its publication in the Government Gazette.

In accordance with section 32A of the **Australian Grands Prix Act 1994**, as the Minister administering the **Road Safety Act 1986**, the Minister administering the **Crown Land (Reserves) Act 1978** and the Minister administering the **Australian Grands Prix Act 1994**, we jointly declare that the area, being all of the stratum of land hatched and coloured green on the plan numbered LEGL./95-128 and lodged in the Central Plan Office, is a designated access area for the period commencing at 12.02 am on Tuesday 13 February 2001 and ending at 11.58 pm on Monday 12 March 2001.

Dated 27 November 2000

PETER BATCHELOR MLA
Minister for Transport
SHERRYL GARBUTT MLA
Minister for Environment
and Conservation

JOHN PANDAZOPOULOS MLA
Minister for Major Projects & Tourism

Australian Grands Prix Act 1994

DECLARED AREA

This Notice shall take effect on and from the date of its publication in the Government Gazette.

In accordance with section 27 of the **Australian Grands Prix Act 1994**, as the Minister administering the **Crown Land (Reserves) Act 1978** and the Minister administering the **Australian Grands Prix Act 1994**, we jointly declare that the whole of the area of Albert Park (as defined in the **Australian Grands Prix Act 1994**) is the declared area in respect of the year commencing Monday 11 December 2000 and ending on Monday 10 December 2001.

Dated 27 November 2000

SHERRYL GARBUTT MLA
Minister for Environment
and Conservation

JOHN PANDAZOPOULOS MLA
Minister for Major Projects & Tourism

Australian Grands Prix Act 1994
RACE PERIOD

This Notice shall take effect on and from the date of its publication in the Government Gazette.

In accordance with section 27 of the **Australian Grands Prix Act 1994**, as the Minister administering the **Crown Land (Reserves) Act 1978** and the Minister administering the **Australian Grands Prix Act 1994**, we jointly declare that the period commencing at 12.01 am on Tuesday 27 February 2001 and ending at 11.59 pm on Monday 5 March 2001 is the race period in respect of the year commencing Monday 11 December 2000 and ending on Monday 10 December 2001.

Dated 27 November 2000

SHERRYL GARBUTT MLA
Minister for Environment
and Conservation

JOHN PANDAZOPOULOS MLA
Minister for Major Projects & Tourism

Physiotherapists Registration Act 1998
INQUIRY HELD UNDER SECTION 41

Notice is hereby given that on 5 October 2000 the Physiotherapists Registration Board of Victoria held an inquiry into the activities of a registered physiotherapist, namely Mr Gregory Kolt, registration number 5403. As a result of the inquiry the Board found Mr Kolt has engaged in unprofessional conduct and that the unprofessional conduct was of a serious nature.

The Board suspended Mr Kolt's registration to practice as a physiotherapist in the State of Victoria for a period of six months from 1 December 2000 to 1 June 2001.

Dated 24 November 2000

J. G. BARKLA
Registrar

Fisheries Act 1995

FISHERIES NOTICE NO. 5/2000

I, Candy Broad, Minister for Energy and Resources, after consultation with the Fisheries Co-Management Council and VRFish, make the following Fisheries Notice:

Dated 1 December 2000

CANDY BROAD
Minister for Energy and Resources

**FISHERIES (SPINY FRESHWATER
CRAYFISH REGIONAL CLOSURE)
NOTICE NO. 5/2000**

1. Title

This Notice may be cited as the Fisheries (Spiny Freshwater Crayfish Regional Closure) Notice No. 5/2000.

2. Objective

The objective of this Notice is to prohibit the taking or possession of spiny freshwater crayfish (*Euastacus armatus*) in, on or next to certain Victorian waters.

3. Authorising provision

This Notice is made under sections 67 and 152 of the **Fisheries Act 1995**.

4. Commencement

This Notice comes into operation on the day on which it is published in the Victoria Government Gazette.

5. Prohibition

A person must not take or possess spiny freshwater crayfish (*Euastacus armatus*) in, on or next to the following Victorian waters —

- (a) the backed up floodwaters adjoining the Murray River, from the junction of the Goulburn River and the Murray River, upstream along the Murray River to Picnic Point;
- (b) the Goulburn River and its backed up floodwaters, from its junction with the Murray River, upstream to McCoy's Bridge;
- (c) the Broken Creek and its backed up floodwaters, from its junction with the Murray River, upstream to the Nathalia township.

Penalty: 20 penalty units (\$2,000).

6. Revocation

This Notice is revoked on 1 January 2001.

Co-operatives Act 1996

F D J F L CO-OPERATIVE LIMITED
LANG LANG GOLF CLUB NO 2
CO-OPERATIVE LTD
MELBOURNE LABOUR
CO-OPERATIVE LTD

Notice is hereby given in pursuance of Section 316 (1) of the **Co-operatives Act 1996**

and Section 601AB(3) (e) of the Corporations Law that, at the expiration of two months from the date hereof, the names of the aforementioned Co-operatives will, unless cause is shown to the contrary, be struck off the register and the Co-operatives will be dissolved.

Dated at Melbourne 28 November 2000

PAUL HOPKINS
Deputy Registrar of Co-operatives

Planning and Environment Act 1987
GREATER GEELONG PLANNING SCHEME
Notice of Approval of Amendment
Amendment C10

The Minister for Planning has approved Amendment C10 to the Greater Geelong Planning Scheme.

The Amendment comes into operation on the date this notice is published in the Government Gazette.

The Amendment introduces a permit requirement for the extension or construction of a dwelling that is higher than 7.5 metres above natural ground level in a Residential Zone in the City of Greater Geelong. The provisions expire on 30 June 2002.

A copy of the Amendment can be inspected, free of charge, during office hours, at the Department of Infrastructure, Customer Service Centre, Upper Plaza, Nauru House, 80 Collins Street, Melbourne and at the offices of the City of Greater Geelong, 131 Myers Street, Geelong 3220.

PAUL JEROME
Executive Director
Planning, Heritage and
Building Division
Department of Infrastructure

Planning and Environment Act 1987
KNOX PLANNING SCHEME
Notice of Approval of Amendment
Amendment C11

The Minister for Planning has approved Amendment C11 to the Kingston Planning Scheme.

The Amendment comes into operation on the date this notice is published in the Government Gazette.

The Amendment rezones land described in Certificate of Title Volume 10469 and Plan of Subdivision Number 405913V and located at Centre Dandenong Road, Cheltenham from Public Parks and Recreation Zone to Residential 1 Zone.

A copy of the Amendment can be inspected, free of charge, during office hours, at the Department of Infrastructure, Planning Information Centre, Upper Plaza, Nauru House, 80 Collins Street, Melbourne and at the offices of the Kingston City Council, Mentone Municipal Offices, Brindisi Street, Mentone or the Moorabbin Municipal Offices, 999 Nepean Highway, Moorabbin.

PAUL JEROME
Executive Director
Planning, Heritage and
Building Division
Department of Infrastructure

Planning and Environment Act 1987
STONNINGTON PLANNING SCHEME
Notice of Approval of Amendment
Amendment C4

The Minister for Planning has approved Amendment C4 to the Stonnington Planning Scheme.

The Amendment comes into operation on the date this notice is published in the Government Gazette.

The Amendment includes seven buildings in the Schedule to the Heritage Overlay and removes twenty seven buildings that have interim protection from the Schedule.

A copy of the Amendment can be inspected, free of charge, during office hours, at the Department of Infrastructure, Planning Information Centre, Upper Plaza, Nauru House, 80 Collins Street, Melbourne and at the offices of the Stonnington City Council, corner Chapel and Greville Streets, Prahran.

PAUL JEROME
Executive Director
Planning, Heritage and
Building Division
Department of Infrastructure

Planning and Environment Act 1987

SURF COAST PLANNING SCHEME

Notice of Approval of Amendment

Amendment C2

The Minister for Planning has approved Amendment C2 to the Surf Coast Planning Scheme.

The Amendment comes into operation on the date this notice is published in the Government Gazette.

The Amendment applies to land comprising approximately 101.4 ha bounded by Coombes Road to the north, Grossmans Road to the south, Ghazeeopore Road to the west and Messmate Road to the east. The Amendment rezones land from the Rural zone with the Low Density Residential Zone and includes it in a Development Plan Overlay. The Amendment modifies the Local Planning Policy Framework to reflect the new zoning and the strategic intent for the land.

The Amendment will facilitate the coordinated and staged development of the eight separately owned parcels of land, generally in accordance with a Local Structure Plan, as an environmentally sustainable low density residential node.

A copy of the Amendment can be inspected, free of charge, during office hours, at the Department of Infrastructure, Planning Information Centre, Upper Plaza, Nauru House, 80 Collins Street, Melbourne and at the offices of the Surf Coast Shire Council 25 Grossmans Road.

PAUL JEROME
Executive Director
Planning, Heritage and
Building Division
Department of Infrastructure

Planning and Environment Act 1987

WHITTLESEA PLANNING SCHEME

Notice of Approval of Amendment

Amendment C13

The Minister for Planning has approved Amendment C13 to the Whittlesea Planning Scheme.

The Amendment comes into operation on the date this notice is published in the Government Gazette.

The Amendment includes land located at 223 – 225 High Street, Thomastown in a Public Acquisition Overlay.

A copy of the Amendment can be inspected, free of charge, during office hours, at the Department of Infrastructure, Planning Information Centre, Upper Plaza, Nauru House, 80 Collins Street, Melbourne and at the offices of the Whittlesea City Council, Ferres Boulevard, South Morang.

PAUL JEROME
Executive Director
Planning, Heritage and
Building Division
Department of Infrastructure

Planning and Environment Act 1987

WYNDHAM PLANNING SCHEME

Notice of Approval of Amendment

Amendment C18

The Minister for Planning has approved Amendment C18 to the Wyndham Planning Scheme.

The Amendment comes into operation on the date this notice is published in the Government Gazette.

The Amendment: rezones land described as Crown Allotments 12A, 12B, 16A, 16B, 16C and 16D Dunnings Road, Point Cook to a Residential 1 Zone; includes the land described in a Development Plan Overlay No. 6; and inserts Schedule 6 into the Development Plan Overlay.

A copy of the Amendment can be inspected, free of charge, during office hours, at the Department of Infrastructure, Planning Information Centre, Upper Plaza, Nauru House, 80 Collins Street, Melbourne and at the offices of the Wyndham City Council, Princes Highway, Werribee.

PAUL JEROME
Executive Director
Planning, Heritage and
Building Division
Department of Infrastructure

Planning and Environment Act 1987

YARRA PLANNING SCHEME

Notice of Approval of Amendment

Amendment C21

The Minister for Planning has approved Amendment C21 to the Yarra Planning Scheme.

The Amendment comes into operation on the date this notice is published in the Government Gazette.

The Amendment substitutes a new “Development Guidelines for Heritage Places” policy at Clause 22.02 of the Local Planning Policy Framework section of the Yarra Planning Scheme on a interim basis. The new policy will replace the existing “Development Guidelines for Heritage Places” policy located at Clause 22.02 of the Yarra Planning Scheme.

A copy of the Amendment can be inspected, free of charge, during office hours, at the Department of Infrastructure, Planning Information Centre, Upper Plaza, Nauru House, 80 Collins Street, Melbourne and at the offices of the Yarra City Council, Richmond Town Hall, 333 Bridge Road, Richmond.

PAUL JEROME
Executive Director
Planning, Heritage and
Building Division
Department of Infrastructure

ORDERS IN COUNCIL

Local Government Act 1989

MACEDON RANGES SHIRE COUNCIL, CAMPASPE WARD

Specification of Dates

Order in Council

The Governor in Council, with the advice of the Executive Council acting under Sections 3, 21, 21A and 22 **Local Government Act 1989** **ORDERS THAT:**

the dates for the Macedon Ranges Shire Council, Campaspe Ward by-election to be held on 24 February 2001 shall be:

- Monday 11 December 2000 Entitlement date for the purposes of Division 1 of Part 3 of the **Local Government Act 1989**;
- Tuesday 19 December 2000 The date by which the Electoral Commissioner must supply to the Chief Executive Officer a voters' list for the purposes of section 21(2) of the **Local Government Act 1989**;
- Wednesday 10 January 2001 The date by which the Chief Executive Officer must make out a voters' list for the purposes of sections 22(2) and 22(2A) of the **Local Government Act 1989**;

Dated 5 December 2000

Responsible Minister
BOB CAMERON MP
Minister for Local Government

HELEN DOYE
Clerk of the Executive Council

Land Act 1958

SALE OF CROWN LAND BY PRIVATE
TREATY

Order in Council

The Governor in Council, pursuant to section 99A(1)(a) & 99A(2) of the **Land Act 1958**, approves the sale by private treaty of Crown Allotment 2A, Section 10, Township and Parish of Mortlake and located in Shaw Street, Mortlake.

Dated 5 December 2000

Responsible Minister
LYNNE KOSKY MP
Minister for Finance

HELEN DOYE
Clerk of the Executive Council

1958, approves the sale by private treaty of the Crown land described below.

Property Address: McIvor Highway, Axedale.

Crown Description: Allotment 11A, Section B, Parish of Weston.

Dated 5 December 2000

Responsible Minister
LYNNE KOSKY MP
Minister for Finance

HELEN DOYE
Clerk of the Executive Council

Crown Land (Reserves) Act 1978

NOTICE OF INTENTION TO REVOKE
TEMPORARY RESERVATIONS

The Governor in Council, with the advice of the Executive Council under section 10 of the **Crown Land (Reserves) Act 1978** gives notice of intention to revoke the following temporary reservations:

GOORAMADDA — The temporary reservation by Order in Council of 17 February, 1914 of an area of 4.740 hectares of land in the Parish of

Land Act 1958

APPROVAL BY THE GOVERNOR IN
COUNCIL TO THE SALE OF CROWN
LAND BY PRIVATE TREATY

Order in Council

The Governor in Council, pursuant to section 99A(1)(a) & 99A(2) of the **Land Act**

Gooramadda as a site for Supply of Gravel. — (Rs 1012).

MURRAMURRANGBONG — The temporary reservation by Order in Council of 4 July, 1899 of an area of 4.047 hectares of land being Crown Allotment 2A, Section 2, Parish of Murramurrangbong as a site for Public Recreation, so far only as the portion containing 116 square metres shown as Crown Allotment 2F, Section 2, Parish of Murramurrangbong on Original Plan No. 121034 lodged in the Central Plan Office. — (Rs 815).

This Order is effective from the date on which it is published in the Government Gazette.

Dated 5 December 2000

Responsible Minister
SHERRYL GARBUTT
Minister for Environment
and Conservation

HELEN DOYE
Clerk of the Executive Council

Crown Land (Reserves) Act 1978
REVOCATION OF TEMPORARY
RESERVATIONS

The Governor in Council, with the advice of the Executive Council under section 10 of the **Crown Land (Reserves) Act 1978** revokes the following temporary reservations:

FREEBURGH — The temporary reservation by Order in Council of 12 February, 1963 of an area of 1.083 hectares of land in the Township of Freeburgh, Parish of Freeburgh as a site for a Sanitary Depot. — (Rs 8202).

HEATHCOTE — The temporary reservation by Order in Council of 11 April, 1962 of an area of 1214 square metres, more or less, of land in Section 3A, Township of Heathcote, Parish of Heathcote as a site for the purposes of the Forests Act. — (Rs 7612).

HEATHCOTE — The temporary reservation by Order in Council of 6 May, 1913 of an area of 1214 square metres of land in Section 3A, Township of Heathcote, Parish of Heathcote as a site for Municipal purposes. — (Rs 1395).

HEATHCOTE — The temporary reservation by Order in Council of 13 November, 1947 of an area of 1821 square metres, more or less, of land in Section 3A, Township of Heathcote, Parish of

Heathcote as a site for Municipal purposes, in addition to and adjoining the site temporarily reserved therefor by Order in Council of 6 May, 1913. — (Rs 1395).

HEATHCOTE — The temporary reservation by Order in Council of 11 April, 1962 of an area of 1771 square metres, more or less, of land in Section 3A, Township of Heathcote, Parish of Heathcote as a site for Municipal purposes, in addition to and adjoining the site temporarily reserved therefor by Order in Council of 13 November, 1947. — (Rs 1395).

HEATHCOTE — The temporary reservation by Order in Council of 1 June, 1971 of an area of 1568 square metres of land in Section 3A, Township of Heathcote, Parish of Heathcote in two separate parts as a site for Municipal purposes, so far only as the portion containing 1117 square metres as indicated by hatching on the plan published in the Government Gazette on November, 2000 – page 2689. — (Rs 1395).

MALMSBURY — The temporary reservation by Order in Council of 2 July, 1958 of an area of 3136 square metres of land in Section 6, Township of Malmsbury, Parish of Edgcombe as a site for Police purposes. — (Rs 7316).

POREPUNKAH — The temporary reservation by Order in Council of 19 October, 1971 of an area of 4553 square metres of land in Section 1A, Parish of Porepukah as a site for Public Purposes (Supply of Gravel). — (Rs 9228).

PYALONG — The temporary reservation by Order in Council of 13 January, 1868 of an area of 5.023 hectares of land in Section 8, Township of Pyalong, Parish of Pyalong as a site for Police purposes, revoked as to part by various Orders, SAVE AND EXCEPT the portion containing 4517 square metres as indicated by hatching on the plan published in the Government Gazette on November, 2000 – page 2689. — (Rs 1989).

This Order is effective from the date on which it is published in the Government Gazette.

Dated 5 December 2000

Responsible Minister
SHERRYL GARBUTT
Minister for Environment
and Conservation

HELEN DOYE
Clerk of the Executive Council

Crown Land (Reserves) Act 1978
REVOCATION OF TEMPORARY
RESERVATIONS

The Governor in Council, with the advice of the Executive Council under section 10 of the **Crown Land (Reserves) Act 1978** revokes the following temporary reservations:

JUMBUK — The temporary reservation by Order in Council of 19 October, 1948 of an area of 7841 square metres, more or less, of land in Section A, Parish of Jumbuk as a site for a State school. — (Rs 5689).

PICOLA — The temporary reservation by Order in Council of 14 February, 1883 of an area of 3326 square metres of land in Section B, Parish of Picola as a site for Public purposes (State School). — (Rs 04635).

SMYTHESDALE — The temporary reservation by Order in Council of 30 October, 1876 of an area of 2.023 hectares of land in Section 15A, Parish of Smythesdale as a site for Public purposes (State School). — (2004240).

STAWELL — The temporary reservation by Order in Council of 28 November, 1950 of an area of 8853 square metres, more or less, of land in Section 38, Parish of Stawell (formerly Borough of Stawell) as a site for State School purposes. — (Rs 2885).

STAWELL — The temporary reservation by Order in Council of 22 December, 1964 of an area of 506 square metres, more or less, of land in Section 38, Parish of Stawell as a site for State School purposes, in addition to and adjoining the site temporarily reserved therefor by Order in Council of 28 November, 1950. — (Rs 2885).

STAWELL — The temporary reservation by Order in Council of 8 December, 1969 of an area of 759 square metres, more or less, of land in Section 38, Parish of Stawell as a site for State School purposes. — (Rs 2885).

WONTHAGGI — The temporary reservation by Order in Council of 25 March, 1969 of an area of 5.567 hectares of land in Section 26, Township of Wonthaggi, Parish of Wonthaggi as a site for State Technical School purposes. — (Rs 9107).

YALCA — The temporary reservation by Order in Council of 24 October, 1881 of an area of 8094 square metres of land in Section F, Parish

of Yalca (formerly part of Crown Allotment 1) as a site for Public purposes (State School). — (Rs 04668).

This Order is effective from the date on which it is published in the Government Gazette.

Dated 5 December 2000

Responsible Minister
SHERRYL GARBUTT
 Minister for Environment
 and Conservation

HELEN DOYE
 Clerk of the Executive Council

Crown Land (Reserves) Act 1978
REVOCATION OF PERMANENT
RESERVATION

The Governor in Council, with the advice of the Executive Council under section 11(2) of the **Crown Land (Reserves) Act 1978** revokes the following permanent reservation:

RICHMOND — The permanent reservation by Order in Council of 21 January, 1925 of an area of 7932 square metres of land in Section 35, City of Richmond, Parish of Jika Jika as a site for Public Educational purposes. — (Rs 3044).

This Order is effective from the date on which it is published in the Government Gazette.

Dated 5 December 2000

Responsible Minister
SHERRYL GARBUTT
 Minister for Environment
 and Conservation

HELEN DOYE
 Clerk of the Executive Council

Crown Land (Reserves) Act 1978
TEMPORARY RESERVATION OF CROWN
LANDS

The Governor in Council, with the advice of the Executive Council under section 4(1) of the **Crown Land (Reserves) Act 1978** temporarily reserves the following Crown lands which in his opinion are required for the purposes mentioned :-

MUNICIPAL DISTRICT OF THE
LATROBE SHIRE COUNCIL

HAZELWOOD — Police purposes, 1150 square metres, being Crown Allotment 26K, Section A,

Parish of Hazelwood as indicated by hatching on plan hereunder. (H120[A4]) — (2010434).

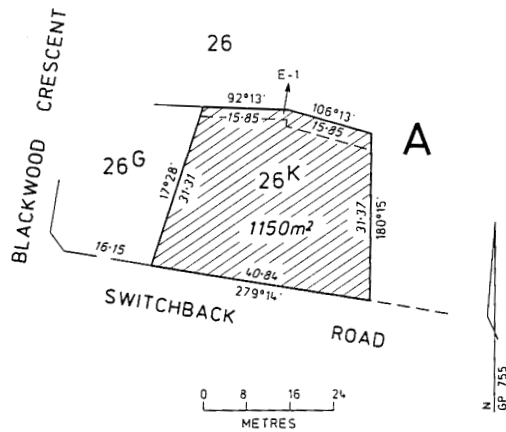

E-1 DRAINAGE AND SEWERAGE EASEMENT VIDE LP 83765

**MUNICIPAL DISTRICT OF THE
INDIGO SHIRE COUNCIL**

STANLEY — Public Recreation, 2.7 hectares, more or less, being Crown Allotment 22D, Section F, Township of Stanley, Parish of Stanley as shown outlined green on Plan LEGL./00-22 lodged in the Central Plan Office. — (2010500).

STANLEY — Public Recreation and Conservation of an Area of Natural Interest, 41.06 hectares, more or less, being Crown Allotment 12G, Section X, and Crown Allotment 9, Section U, Township of Stanley, and Crown Allotment 20D, Section 17, Crown Allotment 15B, Section N, and Crown Allotments 4A and 5A, Section F1, Parish of Stanley as shown outlined red on Plan LEGL./00-22 lodged in the Central Plan Office. — (2010500).

**MUNICIPAL DISTRICT OF THE
LATROBE SHIRE COUNCIL**

YINNAR — Public Park and Recreation, 1.271 hectares, being Crown Allotment 67, Parish of Yinnar as shown on Certified Plan No. 111082-C lodged in the Central Plan Office. — (1510275)

This Order is effective from the date on which it is published in the Government Gazette.

Dated 5 December 2000

Responsible Minister
SHERRYL GARBUTT
Minister for Environment
and Conservation

HELEN DOYE
Clerk of the Executive Council

Crown Land (Reserves) Act 1978
ASSIGNMENT OF NEW NAME TO
INCORPORATED COMMITTEE OF
MANAGEMENT

The Governor in Council, with the advice of the Executive Council under Section 14A(5) of the **Crown Land (Reserves) Act 1978** assigns the new name “Walwa Tourist Park Incorporated” to the corporation constituted as the “Committee of Management Walwa Camping Reserve Incorporated” under Section 14A(1) of the **Crown Land (Reserves) Act 1978** by Order in Council of 24 April, 1990 and published in the Government Gazette on 2 May, 1990 – page 1244. — 114644

This Order is effective from the date on which it is published in the Government Gazette.

Dated 5 December 2000

Responsible Minister
SHERRYL GARBUTT
Minister for Environment
and Conservation

HELEN DOYE
Clerk of the Executive Council

Land Act 1958

CLOSURE OF UNUSED ROADS

The Governor in Council, with the advice of the Executive Council under section 349 of the **Land Act 1958** and with the concurrence in writing of the municipalities in which the roads are situated and the owners of land adjoining those roads closes the following unused roads:

**MUNICIPAL DISTRICT OF THE
SURF COAST SHIRE COUNCIL**

ANGAHOOK — The road in the Parish of Angahook shown as Crown Allotments 1 and 2, Section A on Original Plan No. 120792 lodged in the Central Plan Office. — (05/2003988).

**MUNICIPAL DISTRICT OF THE
COLAC OTWAY SHIRE COUNCIL**

BARWONGEMOONG — The road in the Parish of Barwongemoong as indicated by hatching on plan hereunder. (B742[5]) — (05/L1-683).

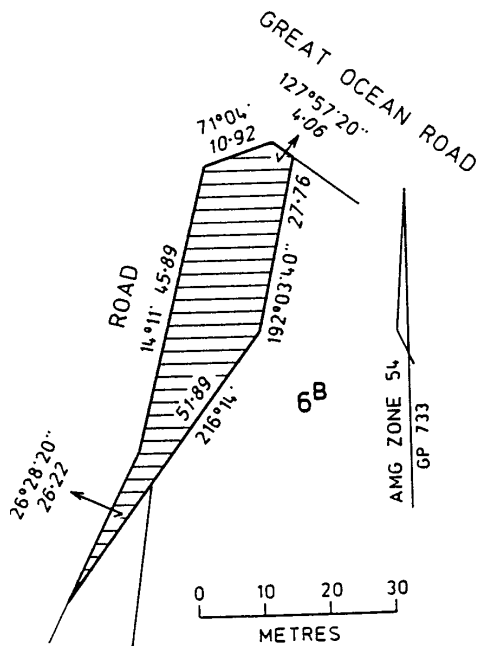

MUNICIPAL DISTRICT OF THE
INDIGO SHIRE COUNCIL

GOORAMADDA — The road in the Parish of Gooramadda as indicated by hatching on plan hereunder. (2703) — (11/P201931).

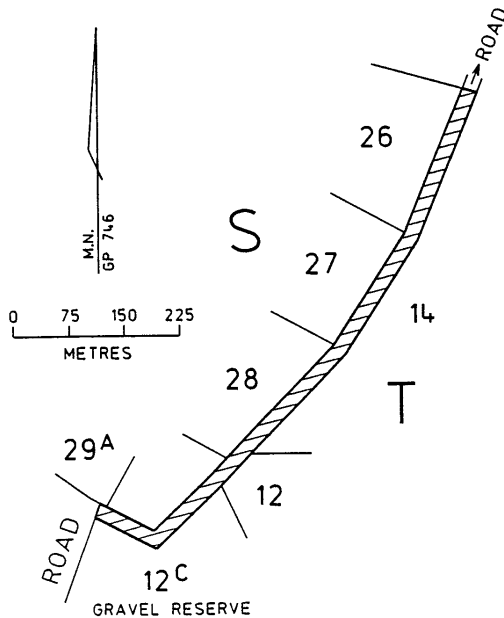

MUNICIPAL DISTRICT OF THE
STRATHBOGIE SHIRE COUNCIL

GOORAM GOORAM GONG — The road in the Parish of Gooram Gooram Gong as

indicated by hatching on plan hereunder. (G149[3]) — (08/P161365).

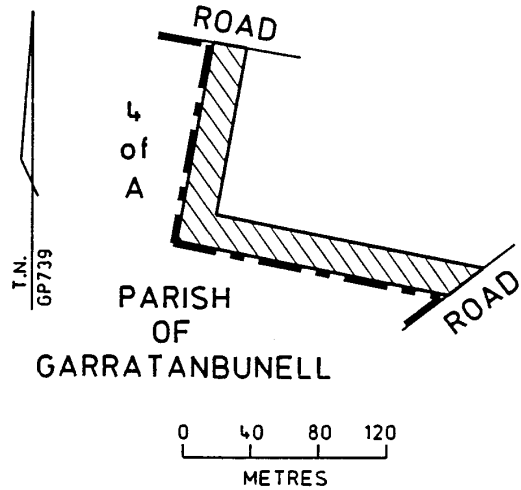

MUNICIPAL DISTRICT OF THE
LATROBE SHIRE COUNCIL

MARYVALE — The road in the Parish of Maryvale shown as Crown Allotment 49F on Original Plan No. 120975 lodged in the Central Plan Office. — (L10-6326).

MUNICIPAL DISTRICT OF THE
GOLDEN PLAINS SHIRE COUNCIL

WABDALLAH — The road in the Parish of Wabdallah shown as Crown Allotment 1B, Section 17 on Original Plan No. 121032 lodged in the Central Plan Office. — (L1-4782).

MUNICIPAL DISTRICT OF THE
INDIGO SHIRE COUNCIL

YACKANDANDAH — The road in the Parish of Yackandandah shown as Crown Allotment 5A, Section B3 on Original Plan No. 120939 lodged in the Central Plan Office. — (L8-6449).

This Order is effective from the date on which it is published in the Government Gazette.

Dated 5 December 2000

Responsible Minister
SHERRYL GARBUTT
Minister for Environment
and Conservation

HELEN DOYE
Clerk of the Executive Council

Crown Land (Reserves) Act 1978**INCORPORATION OF COMMITTEES OF MANAGEMENT AND APPOINTMENT OF CHAIRPERSONS**

The Governor in Council, with the advice of the Executive Council under section 14A(1) of the **Crown Land (Reserves) Act 1978**, being satisfied that it is in the public interest to declare to be corporations the Committees of Management appointed under section 14(2) of the Act of the lands described in Column 1 of the schedule hereunder :-

- (a) declares that the Committees of Management shall be corporations;
 (b) assigns the names shown in Column 2 to the corporations; and
 under section 14B(3) of the Act, appoints the persons listed in Column 3 to be Chairpersons of the corporations.

SCHEDULE

| Column 1 Reserve details | Column 2 Corporate name | Column 3 Chairperson |
|---|--|---------------------------------|
| Harkaway Public Hall Reserve The land in the Parish of Berwick permanently reserved for Public Hall by Order in Council of 24 April, 1923 (vide Government Gazette of 2 May, 1923 – page 1153) [Rs 2734]. | Harkaway Public Hall Committee Incorporated | Michael PENDER |
| Vite Vite North Public Hall Reserve The land in the Parish of Vite Vite temporarily reserved for a Public Hall by Order in Council of 22 April, 1952 (vide Government Gazette of 30 April, 1952 – page 1947) [Rs 6898]. | Vite Vite North Public Hall Reserve Committee of Management Incorporated | Steven James McARTHUR |

This Order is effective from the date on which it is published in the Government Gazette.

Dated 5 December 2000

Responsible Minister
 SHERRYL GARBUTT
 Minister for Environment and Conservation

HELEN DOYE
 Clerk of the Executive Council

Land Act 1958**ORDER IN COUNCIL FOR THE OCCUPATION OF CROWN LAND STRATA**

The Governor in Council with the advice of the Executive Council under Section 138A(11) of the **Land Act 1958** authorises the occupation of 31 Spring Street Pty Ltd its successors and permitted assigns without licence of Crown land strata described in the Schedule subject to the following terms and conditions:

1. 31 Spring Street Pty Ltd its successors and permitted assigns indemnifying the Crown in respect of any claim or liability for property damage and/or injury or death of any person which arises directly or indirectly out of negligence, tort, contract, or breach of a statutory duty by 31 Spring Street Pty Ltd its successors and permitted assigns or any associated party consequential to the use or occupation of the occupied Crown land strata, including, but without restricting the generality of the foregoing, the pollution or contamination of land or water, and any costs, charges and expenses incurred in connection therewith.
2. 31 Spring Street Pty Ltd its successors and permitted assigns maintaining a public liability insurance policy over the occupied Crown land strata (providing no less limit of indemnity for any one occurrence during the policy period than \$10,000,000), which is endorsed (as follows), to note:

‘the Crown in the right of the State of Victoria, the Secretary to the Department of Natural Resources and Environment, its servants, agents and employees in respect to providing indemnity for personal injury and/or property damage caused by an occurrence, and/or for breach of Professional duty arising out of the negligent acts, errors or omissions of 31 Spring Street Pty Ltd its successors and permitted assigns and/or its servants agents and employees. The endorsement and extension to the policy does not extend to negligent acts, errors or omissions of the Crown (and others above mentioned), and is limited to \$10,000,000 for any one occurrence.’

3. 31 Spring Street Pty Ltd its successors and permitted assigns maintaining a plate glass and other glass insurance policy, if there is any plate glass or other glass on the projections.
4. 31 Spring Street Pty Ltd its successors and permitted assigns complying with the provisions of all statutes, regulations, local laws and by-laws relating to the Crown land strata and all lawful orders or directions made under them.
5. 31 Spring Street Pty Ltd its successors and permitted assigns ensuring that the projections and each of them are kept and maintained in good and tenantable repair and are maintained in a structurally sound and safe condition.
6. At the date upon which the Body Corporate with respect to the Philadelphia Building development is formed and 31 Spring Street Pty Ltd, its successors and permitted assigns, no longer has responsibility for the projections over Crown land strata, the obligations contained in 1, 2, 3, 4 and 5 above shall pass to the Body Corporate for the time being, its successors and permitted assigns.
7. This authorisation is to continue from the date the Order is published in the Government Gazette until the demolition of the building or the earlier removal of the balconies.

SCHEDULE

Crown land strata containing balconies projecting over Government roads being Spring Street and Flinders Lane Melbourne abutting Number 31 Spring Street Melbourne as shown on Levels 6 to 14 of approved Plan referred to in Planning Permit TP97/1296 (Amended) dated 7 January 1999. — 12L12/0969.

This Order is effective from the day on which it is published in the Government Gazette.

Dated 5 December 2000

Responsible Minister
SHERRYL GARBUTT
Minister for Environment and Conservation

HELEN DOYE
Clerk of the Executive Council

**SUBORDINATE LEGISLATION ACT 1994
NOTICE OF MAKING OF STATUTORY
RULES**

Notice is hereby given under Section 17 (2) of the **Subordinate Legislation Act 1994** of the making of the following Statutory Rules:

- | | | | |
|-----------------------------|--|-----------------------------|--|
| 122. <i>Statutory Rule:</i> | Business Names (Prescribed Particulars) Regulations 2000 | 126. <i>Statutory Rule:</i> | Road Safety (Road Rules) (Road Rules Modification No. 2) Regulations 2000 |
| <i>Authorising Act:</i> | Business Names Act 1962 | <i>Authorising Act:</i> | Road Safety Act 1986 |
| <i>Date of making:</i> | 5 December 2000 | <i>Date of making:</i> | 5 December 2000 |
| 123. <i>Statutory Rule:</i> | Subordinate Legislation (Health (Quality of Drinking Water) Regulations 1991 - Extension of Operation) Regulations 2000 | 127. <i>Statutory Rule:</i> | Dangerous Goods (Storage and Handling) Regulations 2000 |
| <i>Authorising Act:</i> | Subordinate Legislation Act 1994 | <i>Authorising Act:</i> | Dangerous Goods Act 1985 |
| <i>Date of making:</i> | 5 December 2000 | <i>Date of making:</i> | 5 December 2000 |
| 124. <i>Statutory Rule:</i> | Subordinate Legislation (Health Services (Residential Care) Regulations 1991 - Extension of Operation) Regulations 2000 | | |
| <i>Authorising Act:</i> | Subordinate Legislation Act 1994 | | |
| <i>Date of making:</i> | 5 December 2000 | | |
| 125. <i>Statutory Rule:</i> | Subordinate Legislation (Health Services (Private Hospitals and Day Procedure Centres) Regulations 1991 - Extension of Operation) Regulations 2000 | | |
| <i>Authorising Act:</i> | Subordinate Legislation Act 1994 | | |
| <i>Date of making:</i> | 5 December 2000 | | |

**SUBORDINATE LEGISLATION ACT 1994
NOTICE THAT STATUTORY RULES ARE
OBTAINABLE**

Notice is hereby given under Section 17 (3) of the **Subordinate Legislation Act 1994** that the following Statutory Rules were first obtainable from Information Victoria, 356 Collins Street, Melbourne on the date specified:

117. *Statutory Rule:* Forests (Timber Promotion Council) (Amendment) Regulations 2000

Authorising Act: Forests Act 1958

Date first obtainable: 5 December 2000

Code A

118. *Statutory Rule:* Club Keno (Amendment) Regulations 2000

Authorising Acts: Club Keno Act 1993
Tattersall Consultations Act 1958

Date first obtainable: 5 December 2000

Code A

119. *Statutory Rule:* County Court (Chapter I Amendment No. 3) Rules 2000

Authorising Act: County Court Act 1958

Date first obtainable: 5 December 2000

Code C

Retail price will vary according to the number of pages in each special or periodical gazette. The table below sets out the prices that apply

| <i>Price Code</i> | <i>No. of Pages (Including cover and blank pages)</i> | <i>Price</i> |
|-------------------|---|--------------|
| A | 1-16 | \$2.90 |
| B | 17-32 | \$4.30 |
| C | 33-48 | \$5.90 |
| D | 49-96 | \$9.15 |
| E | 97-144 | \$11.85 |
| F | 145-192 | \$14.00 |
| G | 193-240 | \$16.15 |
| H | 241-288 | \$17.20 |
| I | 289-352 | \$19.35 |
| J | 353-416 | \$22.60 |
| K | 417-480 | \$25.80 |
| L | 481-544 | \$30.10 |
| M | 545-608 | \$34.40 |
| N | 609-672 | \$38.70 |
| O | 673-736 | \$43.00 |
| P | 737-800 | \$47.30 |

ADVERTISERS PLEASE NOTE

As from 7 December 2000

The last Special Gazette was No. 183 dated 5 December 2000

The last Periodical Gazette was No. 1 dated 22 June 2000

CONTENTS

| | Page |
|--|------|
| Estates of Deceased Persons | 2858 |
| Government and Outer Budget Sector | |
| Agencies Notices | 2866 |
| Orders in Council— | 2898 |
| Acts — Local Government; Land; Crown Land (Reserves); | |
| Private Advertisements | 2858 |
| Proclamations | 2864 |

The Victoria Government Gazette is published by The Craftsman Press Pty. Ltd. with the authority of the Government Printer for the State of Victoria
© State of Victoria 2000

ISSN 0819-5471

This publication is copyright. No parts may be reproduced by any process except in accordance with the provisions of the Copyright Act.

Products and services advertised in this publication are not endorsed by The Craftsman Press Pty. Ltd. or the State of Victoria and neither of them accepts any responsibility for the content or the quality of reproduction. The Craftsman Press Pty. Ltd. reserves the right to reject any advertising material it considers unsuitable for government publication.

Address all enquiries to the Government Printer for the State of Victoria
Government Information and Communications Branch
Department of Premier and Cabinet
Level 3, 356 Collins Street
Melbourne 3000
Victoria Australia

RETAIL SALES

Information Victoria Bookshop
356 Collins Street Melbourne 3000.
Telephone enquiries 1300 366 356

City Graphics
Level 1, 520 Bourke Street
Melbourne 3000
Telephone enquiries (03) 9600 0977

Recommended Retail Price \$1.70

Government and Outer Budget Sector Agencies please note:
STYLE REQUIREMENTS.

To ensure that material received can be reproduced, and that errors are minimised, the following guidelines are to be observed when submitting material by fax.

Fax resolution:

Material sent by fax should be transmitted using Fine Resolution (200 dots per inch by 200 dpi).

Font size:

Use 12 point (10 pitch) or larger.

Font Style:

Clear plain font styles, such as Helvetica, should be used.

Graphics:

Line drawings should be transmitted as large as possible to ensure clarity. Drawings up to A4 size sent by fax using Fine Resolution provide a good quality for reproduction.

Avoid:

Italics, underlining and full justification.

Ensure document is square when sending as documents that are sent skewed are difficult to read and process.

ISSN 0819-5471



9 770819 548499