



Victoria Government Gazette

No. G 44 Thursday 31 October 2002

GENERAL

GENERAL AND PERIODICAL GAZETTE

Copy to: Gazette Officer
The Craftsman Press Pty. Ltd.
125 Highbury Road,
Burwood Vic 3125
Telephone: (03) 9926 1233
Facsimile: (03) 9926 1292
DX: 32510 Burwood
Email: gazette@craftpress.com.au

Advertising Rates and Payment

All prices include GST

Private Notices

Payment must be received in advance with advertisement details.

33 cents per word – Full page \$198.00.

Additional costs must be included in prepayment if a copy of the gazette is required. Copy Prices – Page
\$1.65 – Gazette \$3.52 – Certified copy of Gazette \$3.85
(all prices include postage). **Cheques should be made payable to The Craftsman Press Pty. Ltd.**

Government and Outer Budget Sector Agencies Notices

Not required to prepay.

Advertisements may be faxed or sent via email with a cover sheet, marked to the attention of the Gazette Officer. Floppy Disks (Mac & PC) can also be accepted.

Costs can be calculated on the following basis:

Per Line	Typeset
Single column	\$1.71
Double column	\$3.41
Full Page	\$71.28

The Craftsman Press is pleased to offer a series of discounts from the typesetting costs.

1. Copy supplied on disk.
2. Copy supplied via email.
3. Artwork for forms and other material which require exact reproduction.

1. Copy supplied on disk.

Where a disk is supplied and there is minimum alteration required, **30% off.**

Where a disk is supplied requiring extraneous matter stripped out and styles applied, **20% off.**

2. Copy supplied via email.

Where a notice is sent via email and there is minimum alteration required, **25% off.**

Where email is supplied requiring extraneous matter stripped out and styles applied, **15% off.**

3. Artwork for forms and other material which requires exact reproduction.

Scanning and sizing of artwork for forms, to be reproduced in page format, **35% off.**

Copy Deadline for General Gazette

9.30 a.m. Monday – (Private Notices)

9.30 a.m. Tuesday – (Government and Outer Budget Sector Agencies Notices)

Advertisers should note:

- Late copy received at The Craftsman Press Pty. Ltd. after deadlines will be placed in the following issue of VGG, irrespective of any date/s mentioned in the copy (unless otherwise advised).
- Late withdrawal of advertisements (after client approval, before printing) will incur 50 per cent of the full advertising rate to cover typesetting, layout and proofreading costs.
- Proofs will be supplied only when requested or at the direction of the Gazette Officer.
- No additions or amendments to material for publications will be accepted by telephone.
- Orders in Council may be lodged prior to receiving assent with the Governor's or Clerk's signature. They will only be published once approved and signed.
- Accounts over 90 days will be issued with a letter of demand.
- Government and Outer Budget Sector Agencies please note: *See style requirements on back page.*

SPECIAL GAZETTES

Copy to: Gazette Officer
The Craftsman Press Pty. Ltd.
125 Highbury Road
Burwood Vic 3125
Telephone: (03) 9926 1233
Facsimile: (03) 9926 1292
Email: gazette@craftpress.com.au

Advertising Rates and Payment

Private Notices

Full Page \$396.00

Payment must be received in advance with notice details.

Government and Outer Budget Sector Agencies Notices

	Typeset
Full Page	\$96.25

Note:

The after hours number for Special Gazettes is:
Telephone: 0419 327 321

SUBSCRIPTIONS AND RETAIL SALES

Copies of the *Victoria Government Gazette* can be purchased from The Craftsman Press Pty. Ltd. by subscription.

The *Victoria Government Gazette*

General and Special – \$187.00 each year

General, Special and Periodical – \$249.70 each year

Periodical – \$124.30 each year

Subscriptions are payable in advance and accepted for a period of one year. All subscriptions are on a firm basis and refunds will not be given.

All payments should be made payable to The Craftsman Press Pty. Ltd.

Subscription enquiries:

The Craftsman Press Pty. Ltd.
125 Highbury Road, Burwood Vic 3125
Telephone: (03) 9926 1233

INDEX TO PRIVATE ADVERTISERS

A

Andrew G. J. Rowan2900

B

Basile & Co. Pty Ltd2900

Bruce M. Cook & Associates2901

D

Dwyer Mahon & Robertson2901

G

G. R. Herbert & Co.2901

G. W. H. Chambers2901

Garden & Green2901

Gray Friend & Long2901

H

Hartleys2902

K

Kelly & Chapman2902

L

Littleton Hackford2903

M

McSwineys2903

Mills Oakley2903

O

Osborne & Osborne Pty Ltd2903

R

Roberts Partners2903

S

Stewarts2903

**PUBLICATION OF THE VICTORIA GOVERNMENT GAZETTE (GENERAL)
MELBOURNE CUP HOLIDAY**

Please Note:

The Victoria Government Gazette for Melbourne Cup week will be published on **Thursday 7 November 2002**.

Copy deadlines:

Private Advertisements **9.30am on Friday 1 November 2002.**

Government and Outer

Budget Sector Agencies Notices **9.30am on Monday 4 November 2002.**

Where urgent gazettal is required after hours, arrangements should be made with the Government Gazette Officer on 0419 327 321.

JENNY NOAKES
Government Gazette Officer

PRIVATE ADVERTISEMENTS

Land Act 1958

Notice is hereby given that Telstra Corporation Ltd has applied for a lease pursuant to Section 134A of the **Land Act 1958** for a term of 21 years in respect of Part Crown Allotment 24C, Parish of Toltol containing 91.4m² as a site for a telecommunications network facility.

DISSOLUTION OF PARTNERSHIP

Notice is hereby given that the partnership previously subsisting between Langbrook Pty Ltd (ACN 101 562 930) of Level 3, 293 Camberwell Road, Camberwell and The Marketing Document Company Pty Ltd (ACN 085 317 700) of 24 Denver Crescent, Elsternwick, known as "Broden Industries" (ABN 32 600 384 739) was dissolved as of 22 October 2002.

DISSOLUTION OF PARTNERSHIP

Take notice that Bredle Investments Pty Ltd, ACN 084 642 099 of 1 Victoria Street, Bulleen, Victoria (hereinafter called "the Remaining Partners") and Michael Pignataro Investments Pty Ltd, ACN 084 642 062 of 27 Boorool Road, East Kew, Victoria (hereinafter called "the Retiring Partner"), who have been carrying on the Restaurant business under the business name of Viaponte at 332 Bridge Road, Richmond, Victoria, in partnership with each other, have dissolved such partnership as at 17 September 2002. The said Retiring Partner has retired from the partnership and the said Remaining Partner is continuing the business on its own account under the said business name from the premises, 332 Bridge Road, Richmond, Victoria.

Dated 20 October 2002

Executed on behalf of
BREDLE INVESTMENTS PTY LTD

Executed on behalf of
MICHAEL PIGNATARO
INVESTMENTS PTY LTD

DISSOLUTION OF PARTNERSHIP

Notice is hereby given that the partnership previously subsisting between Mashka Pty Ltd (ACN 097 870 203) and Gourmet Nosh Catering Pty Ltd (ACN 063 468 191) carrying on

business as restaurant at 10-12 Armstrong Street, Middle Park, Victoria, under the style or name "Union Food and Wine" has been dissolved by mutual consent as from 7 October 2002 so far as concerns to the said Gourmet Nosh Catering Pty Ltd (ACN 063 468 191) who retire from the said firm. All debts due to and owing to the firm will be received and paid respectively by Mashka Pty Ltd (ACN 097 870 203) who will continue to carry on the said business in partnership under the style or firm of "Union Food and Wine".

Dated 10 October 2002

GODDARD ELLIOTT, solicitors,
For and on behalf of the continuing partners

JESSIE CAMPBELL BROWN, late of Unit 8, 18 Parkside Street, Elsternwick, Victoria, retired, deceased. Creditors, next-of-kin and others having claims in respect of the estate of the deceased, who died on 21 June 2002, are required by Equity Trustees Limited, ACN 004 031 298, the proving executor of the Will of the deceased, to send particulars of their claims to the executor in the care of the undermentioned solicitor, by 3 January 2003 after which date the executor may convey or distribute the assets having regard only to the claims of which it then has notice.

ANDREW G. J. ROWAN, solicitor,
Level 4, 472 Bourke Street, Melbourne 3000.

Re: Estate of JESSIE MARGARET DRUMMOND, deceased. In the estate of JESSIE MARGARET DRUMMOND of 58 Kelly Street, Pyramid Hill, in the State of Victoria, widow, deceased. Creditors, next-of-kin and all other persons having claims against the estate of the deceased, are required by Karyn Lee Hawken of 10 Findlay Avenue, Leitchville, Victoria, the executrix of the Will of the said deceased, to send particulars of such claims to her in care of the undermentioned solicitors within two months from the date of publication of this notice, after which date she will distribute the assets having regard only to the claims of which they then have notice.

BASILE & CO PTY LTD, legal practitioners,
46 Wellington Street, Kerang, Vic. 3579.

Re: Estate of IRMA GERTRUDE BALSTRUP, deceased. Creditors, next-of-kin or others having claims in respect of the estate of IRMA GERTRUDE BALSTRUP of 17 Redan Road, Caulfield, in the State of Victoria, home duties, who died on 19 September 2002, are to send particulars of their claims to the personal representative/s care of the undermentioned solicitors by 1 January 2003 after which date the personal representative/s will distribute the assets having regard only to the claims of which they then had notice.

BRUCE M. COOK & ASSOCIATES,
barristers & solicitors,
Level 19, AMP Tower,
535 Bourke Street, Melbourne, Vic. 3000.

Re: Estate of DOROTHY FAY WATSON. Creditors, next-of-kin or others having claims in respect of the estate of DOROTHY FAY WATSON, late of 47 Parkview Drive, Swan Hill, in the State of Victoria, married woman, deceased, who died on 7 July 2002, are to send particulars of their claim to the executor care of the undermentioned legal practitioners by 15 January 2003 after which date the executor will distribute the assets having regard only to the claims of which he then has notice.

DWYER MAHON & ROBERTSON,
legal practitioners,
Beveridge Dome,
194–208 Beveridge Street, Swan Hill.

Re: FREDERICK CHARLES TWOSE, late of 374 Nepean Highway, Frankston, Victoria, retired company director, deceased. Creditors, next-of-kin and others having claims in respect of the estate of the deceased, who died on 16 June 2002, are required by the trustee, Donald Ewen Cameron of 8 Bluff Road, Black Rock, Victoria, solicitor, to send particulars to the trustee by 30 December 2002 after which date the trustee may convey or distribute the assets, having regard only to the claims of which the trustee has notice.

G.R. HERBERT & CO, solicitors,
Level 1, 8 Bluff Road, Black Rock 3193.

Re: REBA DESIREE WELLS, in the Will and Codicil called Reba Desaree Wells, late of 352 Warrigal Road, Oakleigh South, Victoria, but formerly of 10 Clements Street, Highett, home duties, deceased. Creditors, next-of-kin and others having claims in respect of the estate

of the deceased, who died on 11 June 2002, are required by the trustee, Merrill Adamson of 42 Acacia Avenue, Upwey, Victoria, home duties, the daughter, to send particulars to the trustee by 30 December 2002 after which date the trustee may convey or distribute the assets, having regard only to the claims of which the trustee has notice.

G.R. HERBERT & CO, solicitors,
Level 1, 8 Bluff Road, Black Rock 3193.

DORA REBECCA GIBBS, late of Chelsea Park Nursing Home, 53–59 Broadway, Chelsea, home duties. Creditors, next-of-kin and others having claims in respect of the estate of the deceased, who died on 14 September 2002, are required by the trustees, care of G.W.H. Chambers, solicitor of 338 Charman Road, Cheltenham, to send particulars to them by 31 December 2002 after which date the trustees may convey or distribute the assets, having regard only to the claims of which they then have notice.

G.W.H. CHAMBERS, solicitor,
338 Charman Road, Cheltenham 3192.

UNA EDNA PEACHEY, late of 12 Victoria Street, Sandringham, commercial artist. Creditors, next-of-kin and others having claims in respect of the estate of the deceased, who died on 19 September 2002, are required by the trustees, care of G.W.H. Chambers, solicitor of 338 Charman Road, Cheltenham, to send particulars to them by 31 December 2002 after which date the trustees may convey or distribute the assets, having regard only to the claims of which they then have notice.

G.W.H. CHAMBERS, solicitor,
338 Charman Road, Cheltenham 3192.

Re: KATHLEEN EDNA WARD, late of Jacaranda Lodge, Monash Avenue, Nyah West, Victoria, home duties, deceased. Creditors, next-of-kin and others having claims in respect of the estate of the deceased, who died on 28 August 2002, are required by the trustee, Edmund Walter Ward, to send particulars to him care of the undermentioned solicitors by 8 January 2003 after which date the trustee may convey or distribute the assets, having regard only to the claims of which they then have notice.

GARDEN & GREEN, solicitors,
4 McCallum Street, Swan Hill 3585.

RONALD ERNEST FOWKES, late of Unit 7, 26 Young Street, Drouin, retired deceased. Creditors, next-of-kin and others having claims in respect of the estate of the deceased, who died on 14 September 2002, are required by the trustee, Jean Grace Fowkes, to send particulars of their claims to her care of the undersigned solicitors by 2 January 2003 after which date the trustee may convey or distribute the assets having regard only to the claims of which she then has notice.

GRAY FRIEND & LONG, solicitors,
70 Queen Street, Warragul 3820.

Re: DOREEN MAY DUFFY, deceased, late of 174 Station Street, Carlton, Victoria, retired. Creditors, next-of-kin and all others having claims in respect of the estate of the deceased, who died on 9 July 2002, are required by the executor, Patricia May Duffy, (also known as Patricia Ann Duffy), to send particulars of such claims to their solicitors, Hartleys Lawyers at 76 Station Road, Deer Park, Victoria, by 30 December 2002 after which date the executors will distribute the assets having regard only to the claims of which they have notice.

HARTLEYS, lawyers,
76 Station Road, Deer Park, Victoria 3023.

Re: CHRISTINA THEOFANOUS (in the Will called Christina Theophanos), deceased, late of 41 Entally Drive, St Albans, Victoria, home duties. Creditors, next-of-kin and all others having claims in respect of the estate of the deceased, who died on 29 May 2002, are required by the executors, Haralambos Theofanous (in the Will called Haralambos Theophanos) and Leondios Theofanous (in the Will called Leondios Theophanos), to send particulars of such claims to their solicitors, Hartleys Lawyers at 76 Station Road, Deer Park, Victoria, by 30 December 2002 after which date the executors will distribute the assets having regard only to the claims of which they have notice.

HARTLEYS, lawyers,
76 Station Road, Deer Park, Victoria 3023.

Re: WILLIAM JAMES WARD, deceased, late of 4 William Street, Newport, Victoria and formerly of 55/63 Hanmer Street, Williamstown, Victoria, retired. Creditors, next-of-kin and all

others having claims in respect of the estate of the deceased, who died on 3 July 2002, are required by the executor, George Fredrick Ward, to send particulars of such claims to their solicitors, Hartleys Lawyers at 76 Station Road, Deer Park, Victoria, by 30 December 2002 after which date the executors will distribute the assets having regard only to the claims of which they have notice.

HARTLEYS, lawyers,
76 Station Road, Deer Park, Victoria 3023.

Creditors, next-of-kin and others having claims in respect of the estate of ATHOL CLEMENT COUSTLEY, deceased, late of 5 Delatite Court, Hallam, Victoria, retired carpenter, who died on 24 September 2002, are required by the executor namely, Glynis Joy Eagland of 5 Delatite Court, Hallam, Victoria, cashier, who is applying to the Supreme Court for a Grant of Probate of the deceased's last Will and Testament dated 6 May 1999, to send particulars of such claims to the solicitors acting for the said executor, namely Kelly & Chapman, 437 Centre Road, Bentleigh, by 14 January 2003 after which date the said executor may convey or distribute the assets of the deceased, having regard only to the claims of which she or her solicitors then have notice.

KELLY & CHAPMAN, solicitors,
437 Centre Road, Bentleigh 3204.
Solicitors for the executor.

Creditors, next-of-kin and others having claims in respect of the estate of BESSIE CATHERINE FARMER, late of 7 Centre Road, East Brighton, widow, deceased, who died on 18 September 2002, are required by the executor namely, Lawrence Kenneth Stanley Farmer of 192A Beach Road, Mordialloc, retired retailer, to send particulars of such claims to the solicitors acting for the said executor, namely Kelly & Chapman, 437 Centre Road, Bentleigh, by 7 January 2003 after which date the said executor may convey or distribute the assets of the deceased, having regard only to the claims of which he or his solicitors then have notice.

KELLY & CHAPMAN, lawyers,
437 Centre Road, Bentleigh 3204.

Creditors, next-of-kin and others having claims in respect of the estate of NOEL CLAYTON WILLS, late of 114 Shakespeare Street, Traralgon, Victoria, carpenter, deceased, who died on 5 September 2002, are to send their claims to the trustee, Noelene Gladys Wills of 114 Shakespeare Street, Traralgon, Victoria, care of the below mentioned solicitors by 31 December 2002 after which date she will distribute the assets of the deceased having regard only to the claims of which she then has notice.

LITTLETON HACKFORD, solicitors,
Law Chambers,
115 Hotham Street, Traralgon, Vic. 3844.

Re: MALCOLM STANLEY PULLIN, late of 1447 Kookaburra Street, Loch Sport, Victoria, motor mechanic, deceased. Creditors, next-of-kin and others having claims in respect of the estate of the deceased, who died on 5 June 2002, are required by the trustee, Maree Patricia Murphy, in the Will called Maree Murphy of 29 Roy Street, Wangaratta, Victoria, nurse, the daughter, to send particulars to the trustee by 31 January 2003 after which date the trustee may convey or distribute the assets, having regard only to the claims of which the trustee has notice.

McSWINEYS, solicitors,
57 Reid Street, Wangaratta 3677.

Estate of MARGARET CATHERINE DUNLOP. Creditors, next-of-kin and others having claims in respect of the estate of MARGARET CATHERINE DUNLOP, deceased, late of "Alder Court", 15 Turanga Road, Gisborne, Victoria, widow, (who died on 27 September 2002), are required by the executor, ANZ Executors & Trustee Company Limited (ABN 33 006 132 332) of 530 Collins Street, Melbourne, Victoria, to send particulars to it by 31 December 2002 after which date it may convey or distribute the assets having regard only to the claims of which it then has notice.

MILLS OAKLEY, lawyers,
131 Queen Street, Melbourne.

Re: DRAGICA RJAZANCEW, late of 21 Loco Street, Seymour, Victoria, married woman, deceased. Creditors, next-of-kin and others having claims in respect of the estate of the deceased, who died on 19 June 2002, are

required by the trustee, Stefan Rjazancew of 21 Loco Street, Seymour, Victoria, retired, the husband, to send particulars to the trustee care of the undersigned by 17 January 2003 after which date the trustee may convey or distribute the assets having regard only to the claims of which the trustee has notice.

OSBORNE & OSBORNE PTY LTD, solicitors,
6 Wallis Street, Seymour 3660.

SADIE IRIS MARTIN, late of 64 Army Road, Boronia, Victoria. Creditors, next-of-kin and others having claims in respect of the estate of the deceased, who died on 23 May 2002, are required by Perpetual Trustees Limited, ACN 004 029 841, (in the Will called National Mutual Trustees Limited) of 360 Collins Street, Melbourne, Victoria, to send particulars of their claims to the said company by 31 December 2002 after which date it will convey or distribute the assets having regard only to the claims of which the company then has notice.

Re: PEGGY VICTORIA BROWN, late of Unit 88, 183 Osborne Drive, Mount Martha, Victoria, home duties, deceased. Creditors, next-of-kin and others having claims in respect of the estate of the deceased, who died on 17 September 2002, are required by the trustees, Owen Clive Brown of 129 Rotary Park Road, Alberton, Queensland, truck driver, son and Graemme Lloyd Brown of 33 Maple Avenue, Aberfoyle Park, South Australia, retired, son, to send particulars to the trustees by 1 January 2003 after which date the trustees may convey or distribute the assets, having regard only to the claims of which the trustees have notice.

ROBERTS PARTNERS, solicitors,
216 Main Street, Mornington 3931.

Creditors, next-of-kin or others having claims in respect of the estate of JOHN ROBERT McCLUSKEY, late of 6/800 Nepean Highway, Mornington, motorcycle mechanic, deceased, who died on 12 June 2001, are to send particulars of their claims to the executor, Marjorie Elizabeth McCluskey, care of the undermentioned solicitors by 30 December 2002 after which date the executor will distribute the assets having regard only to the claims of which she then has notice.

STEWARTS, solicitors,
231 Anstruther Street, Echuca 3564.

In the Supreme Court of the State of Victoria
SALE BY THE SHERIFF

On Wednesday 4 December 2002 at 2.30 p.m. at the Sheriff's Office, 8-20 King Street, Oakleigh. (Unless process be stayed or satisfied).

All the estate and interest (if any) of Amocet Pty Ltd c/o A.C. Geermans & Associates Pty Ltd, Level 1, 26 Thomson Street, South Melbourne, proprietor of an estate in fee simple in the land described on Certificate of Title Volume 10280, Folios 730, 731, 732 which are residences known as Units 1, 2 and 3 at 4 Sophia Grove, Tecoma.

Notice **Retirement Villages Act 1986** R375581V and Agreement 173 **Planning and Environment Act 1987** S053428Y affect the said estate and interest.

Terms - Cash/Eftpos
(Debit Cards only. No Credit Cards).
SW-02-007506-8

Dated 31 October 2002

V. PARKIN
Sheriff's Office

In the Supreme Court of the State of Victoria
SALE BY THE SHERIFF

On Thursday 5 December 2002 at 11.00 a.m. at the Sheriff's Office, Lloyd Street, Moe. (Unless process be stayed or satisfied).

All the estate and interest (if any) of Patrick Brosnan of 27 Strickland Street, Wonthaggi, as shown on Certificate of Title as Patrick John Brosnan, proprietor of an estate in fee simple in the land described on Certificate of Title Volume 6689, Folio 715, upon which is erected a dwelling known as 27 Strickland Street, Wonthaggi.

Registered Mortgage No. V497996C affects the said estate and interest.

Terms - Cash only.
SW-01-012054-8

Dated 31 October 2002

V. PARKIN
Sheriff's Office

In the County Court of the State of Victoria
SALE BY THE SHERIFF

On Friday 6 December 2002 at 11.00 a.m. at the Sheriff's Office, 107 Baxter Street, Bendigo. (Unless process be stayed or satisfied).

All the estate and interest (if any) of Werner Piechatschek and Joan Piechatschek of 32 Memorial Drive, Epping, as shown on Certificate of Title as Werner Piechatschek and Joan Evelyn Piechatschek, joint proprietor of an estate in fee simple in the following properties described as:

Firstly - Certificate of Title Volume 8113, Folio 241, which is a block of land known as 6 Nine Mile Road, Wedderburn.

Secondly - Certificate of Title Volume 9732, Folio 188, upon which is erected a home known as 63 Godfrey Street, Wedderburn.

Registered Mortgage No. T186842C affects the said estate and interest.

Thirdly - Certificate of Title Volume 10014, Folio 731, which is a block of land known as Lot 2, Hard Hill Court, Wedderburn.

Registered Mortgage No. T466145U and Caveat No. T9316193 affect the said estate and interest.

Fourthly - Certificate of Title Volume 9980, Folio 688, upon which is erected a house known as Lot 8, McFarlane Road, Lake Charm. Refer RACV VicRoads Country Directory Edition 4, Map 20, E3.

Registered Mortgage Nos. T714705E and W479451F affect the said estate and interest.

Terms - Cash only.
CW-01-008116-8

Dated 31 October 2002

V. PARKIN
Sheriff's Office

In the Supreme Court of the State of Victoria
SALE BY THE SHERIFF

To the Highest Bidder at the Best Price Offered

On Wednesday 4 December 2002 at 2.30 p.m. at the Sheriff's Office, 8-20 King Street, Oakleigh. (Unless process be stayed or satisfied).

All the estate and interest (if any) of Wayne Whiteoak of 6 Harlow Court, Deer Park, as shown on Certificate of Title as Wayne John Whiteoak, joint proprietor with Jovelyn Coma Whiteoak of an estate in fee simple in the land described on Certificate of Title Volume 9216, Folio 337, upon which is erected a house known as 6 Harlow Court, Deer Park.

Registered Mortgage No. N520047N affects the said estate and interest.

No Reserve set

Terms – Cash/Eftpos

(Debit Card only. No Credit Cards).

SW-00-004348-7

Dated 31 October 2002

V. PARKIN
Sheriff's Office

Unclaimed Moneys Act 1962

Register of Unclaimed Moneys held by the —

<i>Name of Owner on Books and Last Known Address</i>	<i>Total Amount Due to Owner</i>	<i>Description Of Unclaimed Money</i>	<i>Date when Amount first became Payable</i>
COULTER ROACHE LAWYERS			
	\$		
Maria Dos Santos, 2/12 Orbit Avenue, Whittington	452.76	Cheque	30/09/01

02270

CONTACT: ALI LUDAS, PHONE: (03) 5273 5273.

PROCLAMATIONS

ACTS OF PARLIAMENT

Proclamation

I, John Landy, Governor of Victoria, declare that I have today assented in Her Majesty's name to the following Bill:

No. 50/2002 **National Parks (Box-Ironbark and Other Parks) Act 2002**

Given under my hand and the seal of Victoria at Melbourne on 29 October 2002.

(L.S.) JOHN LANDY
Governor
By His Excellency's Command

STEVE BRACKS
Premier

2002 fix 1 November 2002 as the day on which that Act comes into operation.

Given under my hand and the seal of Victoria on the 29th day of October 2002.

(L.S.) JOHN LANDY
Governor
By His Excellency's Command

SHERRYL GARBUTT
Minister for Environment
and Conservation

No. 50/2002 This Act comes into operation on the day after the day on which it receives the Royal Assent.

Road Safety (Responsible Driving) Act 2002

PROCLAMATION OF COMMENCEMENT

I, John Landy, Governor of Victoria, with the advice of the Executive Council and under section 2(2) of the **Road Safety (Responsible Driving) Act 2002**, fix 15 December 2002 as the day on which the remaining provisions of that Act (except for sections 3, 4, 5 and 6 and paragraphs (b), (c), (d), (e) and (f) of section 10) come into operation.

Given under my hand and the seal of Victoria on the 29th day of October 2002.

(L.S.) JOHN LANDY
Governor
By His Excellency's Command

PETER BATCHELOR MP
Minister for Transport

Wildlife (Amendment) Act 2002

PROCLAMATION OF COMMENCEMENT

I, John Landy, Governor of Victoria, with the advice of the Executive Council and under section 2 of the **Wildlife (Amendment) Act**

**GOVERNMENT AND OUTER BUDGET SECTOR AGENCIES
NOTICES**



YARRA CITY COUNCIL

Road Discontinuance

At its meeting on 9 July 2002 and acting under clause 3 of schedule 10 to the **Local Government Act 1989**, Yarra City Council resolved to discontinue the road shown hatched on the plan below.

The road is to be sold subject to any right, power or interest held by City West Water, in the road in connection with any sewers, drains or pipes under the control of that authority in or near the road.

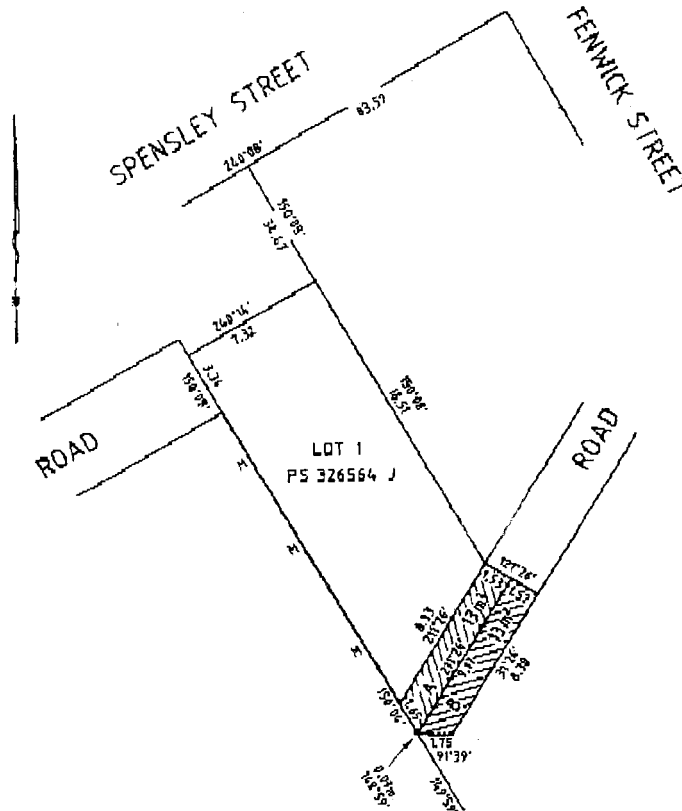

STEVE DUNN
Chief Executive Officer

GREATER GEELONG CITY COUNCIL

Declaration of Public Highway

Further to the notice published in the Victoria Government Gazette on 9 January 1991, the Greater Geelong City Council has resolved as follows:

Under section 204 of the **Local Government Act 1989** ("the Act"), Greater Geelong City Council, at its meeting on 22 October 2002 resolved to declare part of the discontinued road shown outlined on the plan below, to be a public highway for the purposes of the Act.

Notwithstanding such declaration, the Barwon Regional Authority shall continue to have and possess the same right, title, power, authority or interest in or in relation to that part of the land shown outlined below.

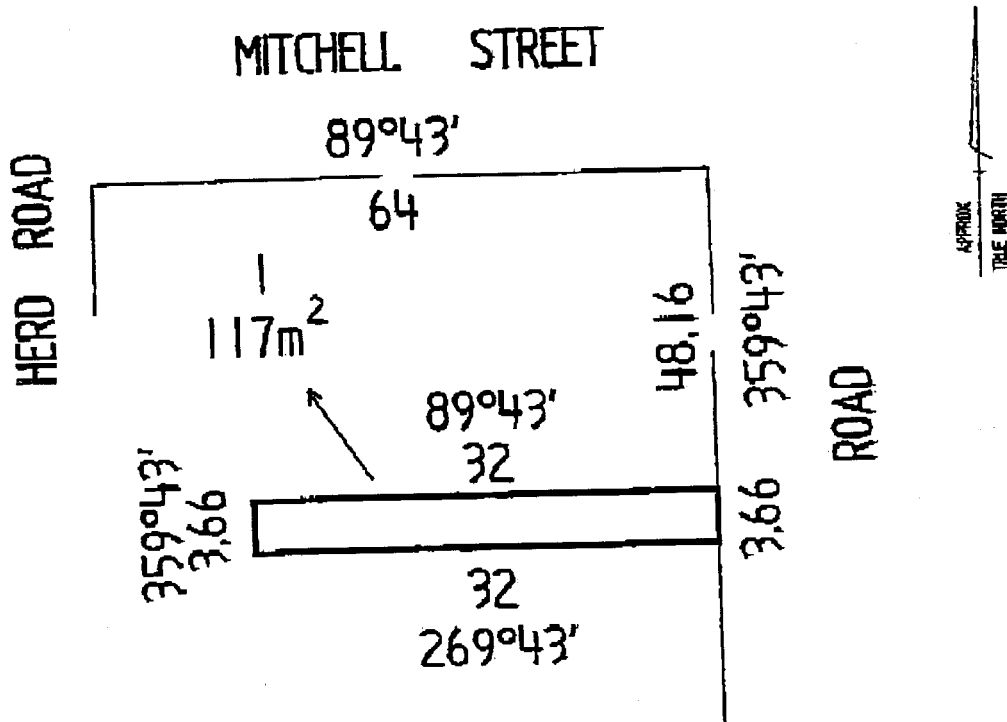

PROPOSED AMENDMENT OF LOCAL LAW No. 3 – MUNICIPAL PLACES AMENDMENT No. 5

The Council pursuant to the provisions of Section 119(2) of the **Local Government Act 1989**, proposes to amend Local Law No. 3.

The general purpose of the amendment is as follows:–

- to prohibit the consumption of alcohol in Chittick Park, Seymour at any time;
- this alters the current arrangement where alcohol may be consumed in Chittick Park, Seymour, outside the hours sunset to sunrise;
- continue to allow exception to these arrangements providing a permit has been granted by the Council.

Persons affected by the making of the amendments to Local Law No. 3 may make a submission pursuant to the provisions of Section 223 of the **Local Government Act 1989**. Written submissions

must be received by 4.00 p.m. on Thursday 14 November 2002 and should indicate whether the person wishes to be heard in support of their submission.

Copies of the Local Law, with the proposed amendments, are available for inspection at the Municipal Offices, 113 High Street, Broadford or by visiting Council's website - www.mitchellshire.vic.gov.au

GARRY CECIL
Chief Executive Officer

BALLARAT CITY COUNCIL
Local Government Act 1989
Section 206 Clause 3 Schedule 10
Discontinuance of Part of Road

Ballarat City Council hereby gives notice that it has discontinued that part of Eyre Street, Buninyong adjacent to the Inglis, Eyre Street intersection, Buninyong being part of the road that is now occupied by a Tennis Court shown hatched on the plan hereunder.

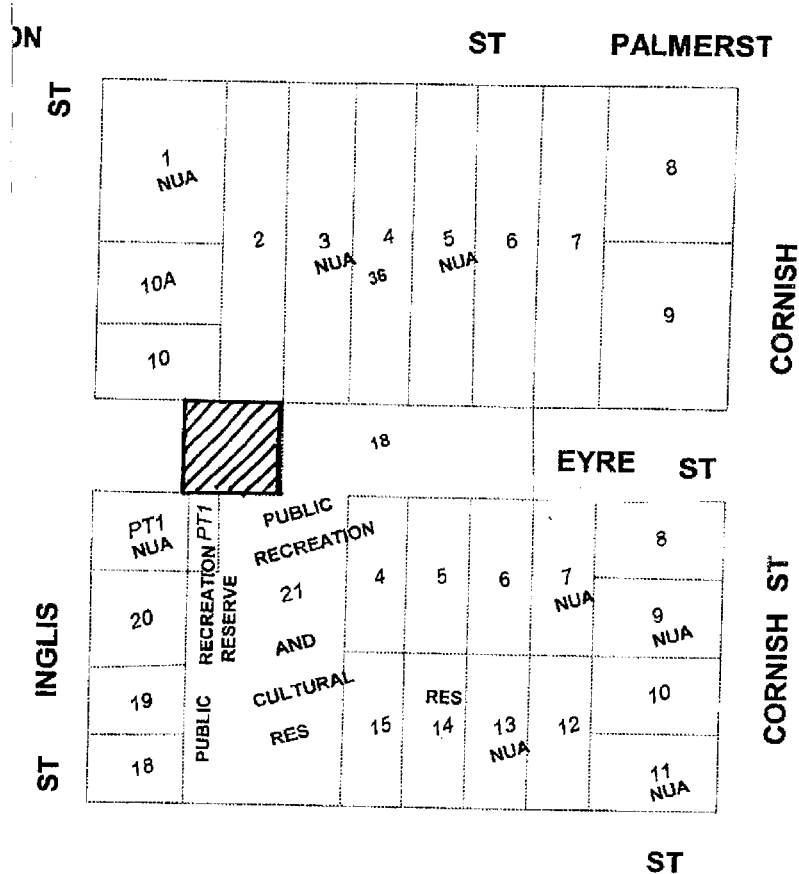

JOHN McLEAN
Chief Executive Officer

Planning and Environment Act 1987
HOBSONS BAY PLANNING SCHEME
Notice of Preparation of Amendment
Amendment C30

The land affected by the Amendment is all of the land at 100–122 Mason Street, Newport, bounded by Newport Lakes and 1–3 Johnston Street to the north, Johnston Street to the east, Mason Street to the south and the gravel roadway to the west.

The Amendment proposes to:

- rezone the above area from Industrial 3 Zone to Residential 1 Zone;
- apply an Environment Audit Overlay as the land may be potentially contaminated due to its current industrial use;
- introduce a Design and Development Overlay to guide the future built form of the development.

You may inspect the Amendment, any documents that support the Amendment and the explanatory report about the Amendment at: Department of Infrastructure, Customer Service Centre, Upper Plaza, Nauru House, 80 Collins Street, Melbourne; Hobsons Bay City Council, 115 Civic Parade, Altona; the Williamstown Library, 104 Ferguson Street, Williamstown; the Altona Library, 123 Queen Street, Altona; the Newport Library, 13 Mason Street, Newport; the Laverton Library, Shop 2, Central Square Shopping Centre, Laverton.

This can be done during office hours and is free of charge.

Any person who may be affected by the Amendment may make a submission to the planning authority.

The closing date for submission is Tuesday 3 December 2002. A submission must be sent to: Mr Ken McNamara, Chief Executive Officer, Hobsons Bay City Council, PO Box 21, Altona, Vic. 3018.

KEN McNAMARA
Chief Executive Officer

Planning and Environment Act 1987
COLAC OTWAY PLANNING SCHEME
Notice of Preparation of an Amendment
Amendment C15

The land affected by the Amendment includes lot 1 and 2, PS 508027Y, Queen Street and Wilson Street, Colac.

The Amendment proposes to correct the present anomalous zoning from Public Use Zone (PUZ4 – transport) to part Residential 1 Zone (R1Z), part Public Park & Recreation Zone (PPRZ), and part Public Use Zone (PUZ1). The corrected zoning reflects the existing and likely future uses of the land.

The person who requested the Amendment is Colac Otway Shire.

You may inspect the Amendment and any documents that support the Amendment; and the explanatory report about the Amendment at Colac Otway Shire, Rae Street, Colac, 3250; Department of Infrastructure, Office of Planning, 180 Fyans Street, South Geelong, 3219 and Department of Infrastructure, Level 3 Plaza, Nauru House, 80 Collins Street, Melbourne, 3000.

This can be done during office hours and is free of charge.

Any person who may be affected by the Amendment may make a submission to the planning authority.

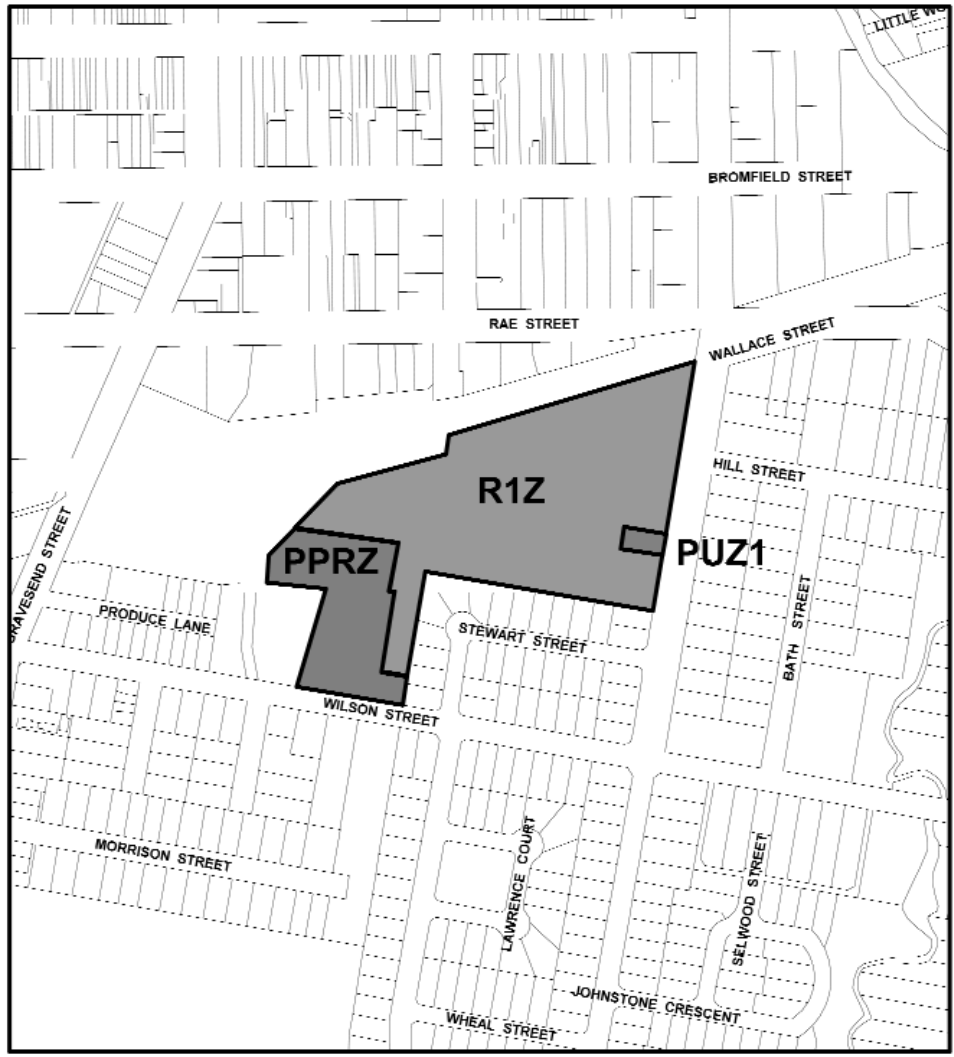

The closing date for the submission is Friday 29 November 2002, Submissions must be addressed to: Tony McGann, General Manager, Infrastructure & Planning, Colac Otway Shire, PO Box 283, Colac 3250.



MAPSCALE 1:5000

Part of Planning Scheme Maps 11

LEGEND

-  PPRZ
-  R1Z
-  PUZ1



MERV HAIR
Acting Chief Executive Officer

Planning and Environment Act 1987
INDIGO PLANNING SCHEME

Notice of Preparation of an Amendment
Amendment C16

Integrated Urban Management on behalf of the Department of Justice has prepared Amendment C16 to the Indigo Planning Scheme.

The Amendment proposes to rezone Crown Allotments 7A, 7C, 7D and part 7 Section A1 and Crown Allotment 18 Section I Parish of Beechworth being part of the Wangaratta Farm Penal Purposes Reserve (WFPPR) from Public Conservation and Recreation Zone (PCRZ) to Rural Use Zone (RUZ). The balance of the WFPPR is zoned Special Use to allow for the development of a minimum security prison.

The WFPPR comprises an area of approximately 452 ha of which approximately 50 per cent is improved pasture currently used for rearing Friesian heifers which go to support the Dhurringile Prison milking operation. The WFPPR has been reserved for Penal Purposes since 1943.

The Amendment can be inspected free of charge during office hours at: Department of Infrastructure, Customer Service Centre, Upper Plaza, Nauru House, 80 Collins Street, Melbourne; Department of Infrastructure, North Eastern Region, 50-52 Clarke Street, Benalla; IWS Offices 34 Main Street, Yackandandah; and Indigo Shire Council, High Street, Beechworth.

Submissions in writing about the Amendment must be sent to Mr Peter O'Dwyer, Manager IWS-Planning, PO Box 75, Yackandandah 3747 by 6 December 2002.

Planning and Environment Act 1987
MANNINGHAM PLANNING SCHEME
Notice of Amendment
Amendment C28

The Manningham City Council has prepared Amendment C28 to the Manningham Planning Scheme.

The Amendment applies to land within the Residential 1 Zone within the municipality.

The Amendment proposes to change the schedule to the Residential 1 Zone to require a permit to construct or extend a dwelling on a lot

of between 300 square metres and 500 square metres.

The Amendment can be inspected free of charge, during office hours at: Manningham City Council Municipal Offices, 699 Doncaster Road, Doncaster and Department of Infrastructure, Planning Information Centre, Upper Plaza, Nauru House, 80 Collins Street, Melbourne.

Any owner or occupier of land who considers that they may be affected by this amendment may make a submission to Council. Submissions about the Amendment must be sent to: Mr Roger Collins, Manager Economic and Environmental Planning, Manningham City Council, PO Box 1, Doncaster, Vic. 3108 by Friday 20 December 2002.

JOHN BENNIE
Chief Executive

Creditors, next-of-kin and others having claims against the estate of any of the undermentioned deceased persons are required to send particulars of their claims to State Trustees Limited, ACN 064 593 148, 168 Exhibition Street, Melbourne, Victoria 3000, the personal representative, on or before 2 January 2003 after which date State Trustees Limited may convey or distribute the assets having regard only to the claims of which State Trustees Limited then has notice.

GRAHAM, Ian Robert, 37A Mine Road, Korumburra, Victoria, retired, who died 12 June 2002.

ANTONIOU, Helen, late of 20 Fehon Street, Yarraville, Victoria, retired, who died 30 June 2002.

MIRENDA, Antonio, formerly of 27 McMillan Street, Clayton, but late of Trentleigh Lodge, 155 Gladstone Road, Dandenong, Victoria, retired, who died 25 May 2002.

ASHMORE, Norman Allen, late of 390 Maroondah Highway, Healesville, Victoria, retired, who died 31 March 2002.

STIRLING, Leonard Hepburn, late of Grace McKellar Centre, 95 Ballarat Road, Geelong North, retired, who died 27 June 2002.

TURNER, John McComas, late of Hampton House, 158 Ludstone Street, Hampton, retired, who died 22 July 2002.

COLLINSON, Richard Wilfred, late of 19 Thames Street, Glenroy, who died 17 August 2002.

JEFFEREY, William Reginald, late of "Lochiel" McLachlan Street, Rylstone, NSW 2849, who died 13 November 1980.

Dated at Melbourne, 22 October 2002

LAURIE TAYLOR
Manager, Estate Management
State Trustees Limited

STATE TRUSTEES LIMITED
ACN 064 593 148
Section 79

Notice is hereby given that State Trustees Limited, ACN 064 593 148 intends administering the estates of:-

DOROTHY ELLA WILSON, late of 187 Oriel Road, Heidelberg West, Victoria, retired, who died on 18 August 2002, leaving a Will dated 26 October 1982.

EURO VITRI, late of 213 Booran Road, Caulfield South, Victoria, pensioner, who died 22 April 2002, leaving a Will dated 14 February 1989.

EDITH MAVIS TURNER, late of Abberfield Private Nursing Home, 2 Carre Street, Elsternwick, Victoria, pensioner, who died on 27 January 2002, leaving a Will dated 5 September 1982.

MAVIS MARY THOMSON, late of St Aidans Nursing Home, 79-81 Mansfield Street, Thornbury, Victoria, pensioner, deceased intestate, who died on 15 September 2002.

HENRY OPTLAND, late of Graceland Manor Private Nursing Home, 508 Glenhuntly Road, Elsternwick, Victoria, pensioner, deceased intestate, who died on 12 August 2002.

STEFAN KOCHMAN, late of 81 Plumpton Avenue, Glenroy, Victoria, pensioner, deceased intestate, who died on 28 February 2002.

GORDON CHANDLER, late of Kingston Centre, Warrigal Road, Cheltenham, Victoria, pensioner, who died on 23 June 2002, leaving a Will dated 30 November 1999.

LAWRENCE THOMAS BUTLER, late of 4 Windsor Road, Pascoe Vale, Victoria, pensioner, who died on 17 September 2002, leaving a Will dated 23 February 1978.

CYRIL MALCOLM HULME, also known as Callum Hulme, late of Abbeyfield Society, (Richmond) Inc. Hostel, 269 Burnley Street, Richmond, deceased intestate, who died on 25 January 2002.

Creditors, next-of-kin and others having claims against the abovementioned estates are required pursuant to Section 33 of the **Trustee Act 1958** to send particulars of their claims against the abovementioned estates to State Trustees Limited, 168 Exhibition Street, Melbourne, Victoria, on or before 3 January 2003 after which date State Trustees Limited, ACN 064 593 148, may convey or distribute the assets of the abovementioned estates having regard only to the claims of which it then has notice.

EXEMPTION

Application No. A350 of 2002

The Victorian Civil and Administrative Tribunal has considered an application, pursuant to Section 83 of the **Equal Opportunity Act 1995** (the Act), by the National Australia Bank Ltd (the applicant). The application for exemption is to enable the applicant to advertise for and employ persons of Aboriginal or Torres Strait Islander descent (Indigenous Australians) as paralegals, articulated clerks and solicitors in positions designated for Indigenous Australians in the applicant's legal department.

Upon reading the material submitted in support of the application and upon hearing Mr Newnham, the Tribunal is satisfied that it is appropriate to grant an exemption from Sections 13, 100 and 195 of the Act to enable the applicant to advertise for and employ persons of Aboriginal or Torres Strait Islander descent (Indigenous Australians) as paralegals, articulated clerks and solicitors in positions designated for Indigenous Australians in the applicant's legal department.

In granting this exemption the Tribunal noted:

- the proposal to offer the positions is put forward under a project initiative sponsored by the Federal Government to improve employment amongst Indigenous Australians;
- the project, titled "CEOs for Indigenous Employment Project", involves CEOs from 34 major Australian companies signing a commitment to provide more employment opportunities for Indigenous Australians within their organisations. The project is administered by the Federal Department of

Employment, Workplace Relations and Small Business;

- the proposed employment is consistent with the objectives of the “special needs” exception set out in Section 82 of the Act in that the applicant is promoting opportunities for Indigenous Australians in a field and profession where Indigenous Australians have achieved limited penetration;
- the proposed employment will:
 - (i) help to meet the special needs of Indigenous Australians; and
 - (ii) help to prevent or reduce the disadvantage experienced by such people regarding their training or welfare.
- the proposed employment is consistent with the overall objectives of the Act and would promote the objectives of the Act by:
 - (i) promoting the recognition and acceptance of everyone’s right to equality of opportunity; and
 - (ii) attempting to redress discrimination against Indigenous Australians.

The Tribunal hereby grants an exemption to the applicant from the operation of Sections 13, 100 and 195 of the Act to enable the applicant to advertise for and employ persons of Aboriginal or Torres Strait Islander descent (Indigenous Australians) as paralegals, articulated clerks and solicitors in positions designated for Indigenous Australians in the applicant’s legal department.

This exemption is to remain in force from the day on which notice of the exemption is published in the Government Gazette until 31 October 2005.

Dated 24 October 2002

Mrs A. COGHLAN
Deputy President

Department of Treasury and Finance
SALE OF CROWN LAND
BY PUBLIC AUCTION

Date of Auction: Thursday 21 November 2002
at 10.30 a.m. on site.

Reference: 2001/01832.

Address of Property: Corner Thackray & Woolboard Roads, Port Melbourne.

Crown Description: Crown Allotment 6^J of 59, Parish of Melbourne South.

Terms of Sale: Deposit 10%, Balance 90/120 days.

Area: 2.914 ha.

Officer Co-ordinating Sale: Lara Morton-Cox, Victorian Government Property Group, Department of Treasury and Finance, 5/1 Treasury Place, Melbourne, Vic. 3002.

Selling Agent: CB Richard Ellis, 101 Collins Street, Melbourne, Vic. 3000.

JOHN LENDERS MP
Minister for Finance

Agricultural and Veterinary Chemicals (Control of Use) Act 1992

APPOINTMENT OF AN AUTHORISED OFFICER UNDER SECTION 53

I, PETER BAILEY, Director Quality Assurance in the Department of Natural Resources and Environment under Section 53 of the **Agricultural and Veterinary Chemicals (Control of Use) Act 1992**, hereby appoint:

PETER ROKEWOOD CARR

being a person who holds an office in the Public Service to be an authorised officer for the purpose of all the provisions under this Act.

Dated 21 October 2002

PETER BAILEY
Director Quality Assurance
Department of Natural Resources
and Environment

Children’s Services Act 1996

NOTICE OF EXEMPTION

I, Bronwyn Pike, Minister for Community Services and Housing, pursuant to section 6 of the **Children’s Services Act 1996**, declare that Mildura West Preschool (Children’s Services Licence Number [LICENCE ID2409]) is exempt from the following regulation of the Children’s Services Regulations 1998:

- Regulation 24 that requires the proprietor must ensure that whenever children are being cared for or educated by the children’s service, qualified staff and staff members must be present in the required ratios for the number of children in attendance.

This exemption is granted on the following conditions:

- Mildura West Preschool Inc employs a person having a primary teaching qualification as a staff member during the period August 2002 to 31 December 2002.

This exemption remains in place until 31 December 2002.

Declared at Melbourne on 11 August 2002.

HON BRONWYN PIKE
Minister for Community Services
and Housing

Children's Services Act 1996

NOTICE OF EXEMPTION

I, Bronwyn Pike, Minister for Community Services and Housing, pursuant to section 6 of the **Children's Services Act 1996** (the Act), declare that Ararat Child Care Centre (Children's Services Licence Number 44) is exempt from the following regulations of the Children's Services Regulations 1998 (the Regulations):—

- Regulation 24 requiring the proprietor to ensure that whenever children are being cared for or educated by the children's service, the qualified staff members are as follows:—
 - a) 1 qualified staff member for 15 or less children present at the centre; and
 - b) where 16 or more children are present at the centre there is to be 1 qualified staff member for every 15 children or fraction of that number under 3 years of age and 1 qualified staff member for every 30 children or fraction of that number over three years of age.
- Regulation 25 requiring a person is a qualified staff member if that person:—
 - a) has successfully completed a 2 year full-time, or part time equivalent, post secondary early childhood qualification which has been approved by the Secretary and notice of which has been published in the Government Gazette and in the publication circulating generally among children's services; and

- b) holds a qualification that the Secretary is satisfied is substantially equivalent to a qualification referred to in paragraph (a).

This exemption is granted for a period of three months.

Declared at Melbourne on 3 October 2002

HON BRONWYN PIKE MP
Minister for Community Services
and Housing

Country Fire Authority Act 1958

DECLARATION OF FIRE DANGER PERIOD

In pursuance of the powers conferred by Section 4 of the **Country Fire Authority Act 1958**, I, Neil Graeme Bibby, Acting Chief Executive Officer of the Country Fire Authority, after consultation with the Secretary of Natural Resources and Environment, hereby declare the following periods to be the Fire Danger Period in the municipal districts of the municipalities or parts of municipalities specified, commencing on the dates shown and, unless varied by subsequent declaration, ending at 01.00 hours on 1 May 2003.

To commence from 01.00 hours on 4 November 2002:

Murrindindi Shire Council;

Mitchell Shire Council;

City of Greater Bendigo;

Shire of Strathbogie: That part north of the Hume Freeway;

Gannawarra Shire Council;

Mt Alexander Shire Council;

Loddon Shire Council: That part south of a line commencing on the western boundary of the shire travelling easterly along the Borung-Charlton Road to Borung, then along the Borung-Hurstwood Road to the Loddon River, then generally southerly along the Loddon River to the Bridgewater-Serpentine Road, then along Foleys Road to the Loddon Valley Highway, then northerly to Rothackers Road, then continue east along Rothackers Road and Tandarra-Serpentine Road, then south along Thompsons Road then east along Tandarra-Elmore Road and Steads Road to the Shire's eastern boundary;

Northern Grampians Shire Council;
Shire of Campaspe;
Shire of Moira;
City of Greater Shepparton;
Mildura Rural City Council.

To commence from 01.00 hours on
11 November 2002:

Loddon Shire Council (Remainder);
Shire of Yarriambiack: That part north of the
wire netting fence.

N. BIBBY
Acting Chief Executive Officer

Electricity Industry Act 2000

Gas Industry Act 2001

PULSE ENERGY PTY LTD

Notification of Variation to Licences

The Essential Services Commission gives notice under section 30 of the **Electricity Industry Act 2000** and section 39 of the **Gas Industry Act 2001** that it has, pursuant to section 29(1)(b) of the **Electricity Industry Act 2000** and section 38(1)(b) of the **Gas Industry Act 2001** varied the electricity and gas retail licences of Pulse Energy Pty Ltd (ACN 090 538 337) to reflect the change of its name to AGL Victoria Pty Limited.

A copy of AGL Victoria's electricity and gas retail licences is available on the Commission's website located at <http://www.esc.vic.gov.au> or a copy can be obtained by calling Ms Julie Schmidt on (03) 9651 0231.

Dated 23 October 2002

JOHN C. TAMBLYN
Chairperson

Electricity Industry Act 2000

PACIFIC HYDRO LIMITED

Notice of Grant of Licence

The Essential Services Commission gives notice under section 30 of the Act that it has, pursuant to section 19 of the Act, issued a licence to Pacific Hydro Limited (ACN 057 279 508) to generate electricity for supply and sale in Victoria.

A copy of the licence is available on the Commission's website located at <http://www.esc.vic.gov.au> or a copy can be obtained by calling Ms Julie Schmidt on (03) 9651 0231.

Dated 23 October 2002

JOHN C. TAMBLYN
Chairperson

Emergency Services Superannuation Act 1986

ELECTION OF THREE (3) MEMBER
REPRESENTATIVES AND THREE DEPUTY
MEMBER REPRESENTATIVES TO THE
EMERGENCY SERVICES
SUPERANNUATION BOARD

In accordance with the Emergency Services Superannuation Scheme Procedure for the 2002 Board Elections, I hereby declare the following candidates elected for appointment to the Emergency Services Superannuation Board:

Member Representative to represent Police Members and Members of the Police Association under Section 7 (1) (A):

- Graeme Leslie Larkin.

Member Representative to represent MFB & CFA members under Section 7 (1) (B):

- Philip Errol Jones.

Member Representative to represent Ambulance Members, Emergency Services Superannuation Scheme Staff, Members of the Department of Natural Resources & Environment and any other Members not represented by the other two elected Member Representatives under Section 7 (1) (C):

- John Gregory Taplin.

Deputy Member Representatives under Section 7 (1) (C):

- Douglas Witschi – Police;
- Raymond John Goddard – MFB & CFA;
- Gordon Charles Bowman – Ambulance & Others.

SHIRLEY BEAN
Returning Officer
Victorian Electoral Commission

Forests Act 1958, No. 6254
DECLARATION OF
THE PROHIBITED PERIOD

In pursuance of the powers conferred by section 3 sub-section (2) of the **Forests Act 1958**, I, Gary Morgan, delegated officer for the Minister for Environment and Conservation in the State of Victoria, hereby declare the Prohibited Period for all land within the Fire Protected Area (other than State forest, National park and protected public land) within the municipalities nominated for the period specified in the schedule below:

SCHEDULE 1

The Prohibited Period shall commence at 01.00 hours on Monday 4 November 2002 and end at 01.00 on Thursday 1 May 2003 (unless varied) in the following municipalities: Shire of Strathbogie, Shire of Murrindindi, Shire of Mitchell.

GARY MORGAN
Chief Fire Officer
Department of Natural Resources
and Environment
Delegated Officer, pursuant to section 11,
Conservation Forests and Land Act 1987

Fisheries Act 1995

FISHERIES REGULATIONS 1998

Declaration in relation to the levy for
Aquaculture (Crown Land) Type A Licences
Regulation 617A

For the purposes of regulation 617A(5) of the Fisheries Regulations 1998, the Secretary to the Department of Natural Resources and Environment, being the body corporate established by Part 2 of the **Conservation, Forests and Lands Act 1987**, declares in respect of the period 1 November 2002 until 31 October 2003 (inclusive) —

- (a) the following areas to be a growing area —
- (i) Flinders Growing Area;
 - (ii) Grassy Point Growing Area;
 - (iii) Clifton Springs Growing Area;
 - (iv) Dromana Bay Growing Area; and
- (b) the estimated total fixed costs of the Secretary for administering Aquaculture

(Crown Land) Type A Licences to be \$82,504; and

- (c) the total area in hectares of Aquaculture (Crown Land) Type A Licences, at the time of making this declaration, to be 212.4 hectares; and
- (d) the estimated total variable costs of the Secretary for administering Aquaculture (Crown Land) Type A Licences in each growing area to be —
- (i) Flinders Growing Area — \$31,987;
 - (ii) Grassy Point Growing Area — \$26,806;
 - (iii) Clifton Springs Growing Area — \$26,806;
 - (iv) Dromana Bay Growing Area — \$32,883; and
- (e) the total area in hectares of Aquaculture (Crown Land) Type A Licences in each growing area at the time of making this declaration to be —
- (i) Flinders Growing Area — 86.4 hectares;
 - (ii) Grassy Point Growing Area — 42 hectares;
 - (iii) Clifton Springs Growing Area — 81 hectares;
 - (iv) Dromana Bay Growing Area — 3 hectares.

By authority, the seal of the Secretary to the Department of Natural Resources and Environment was affixed to this declaration on 24 October 2002 by

CHLOE MUNRO
Secretary

Subordinate Legislation Act 1994

PROPOSED ENVIRONMENT PROTECTION
(DISTRIBUTION OF LANDFILL LEVY)
REGULATIONS 2002

Notice is given in accordance with section 11 of the **Subordinate Legislation Act 1994** of the proposed making of the Environment Protection (Distribution of Landfill Levy) Regulations 2002.

The objective of the proposed regulations, which are to be made under the **Environment Protection Act 1970** (the Act), is to specify how landfill levies are to be distributed for the purposes of section 70(6B) of the Act. The

proposed regulations would distribute funds arising from levies on municipal and industrial waste between the key state government bodies responsible for planning for and managing waste in Victoria, namely regional waste management groups, EcoRecycle Victoria and EPA Victoria.

A Regulatory Impact Statement has been prepared in accordance with the requirements of the **Subordinate Legislation Act 1994**.

The Regulatory Impact Statement concludes that the proposed statutory rule would ensure the key bodies receive sufficient funding to meet their statutory functions under the Act, provide certainty and transparency to enable confident planning, and ensure an adequate flow of funds to a new sustainability fund for priority projects and initiatives. The proposed statutory rule would therefore help deliver on Government commitments to improve resource use efficiency and waste management in Victoria. The Regulatory Impact Statement concludes that the benefits of making the proposed regulations outweigh the associated costs.

Public comments and submissions are invited on the proposed regulations and Regulatory Impact Statement by 29 November 2002. Copies of the Regulatory Impact Statement and the proposed regulations can be obtained by contacting EPA's Information Centre, GPO Box 4395QQ, Melbourne 3001, Telephone: (03) 9695 2722 or by visiting EPA's website: www.epa.vic.gov.au

SHERRYL GARBUTT
Minister for Environment
and Conservation

Subordinate Legislation Act 1994

NOTICE OF PREPARATION OF REGULATORY IMPACT STATEMENT

Land Conservation (Vehicle Control) Regulations 2003

Notice is given under section 11 of the **Subordinate Legislation Act 1994** that a Regulatory Impact Statement (RIS) has been prepared in relation to the proposed Land Conservation (Vehicle Control) Regulations 2003.

The objective of the proposed regulations is to control the use of motorised vehicles on public land (thereby minimising environmental damage and potential danger or nuisance to other users of public land).

The reason for the proposed regulations is to replace the existing Land Conservation (Vehicle Control) Regulations 1992, which are due to 'sunset' or expire on 1 February 2003.

The RIS examined two alternatives to the proposed Land Conservation (Vehicle Control) Regulations 2003:

- (a) Voluntary code(s) of conduct;
- (b) Combination of existing legislation and regulations (governing specific categories of public land).

The RIS demonstrates that the proposed regulations are the most effective means of meeting the objectives by establishing an enforceable framework for the control of motorised vehicles on public land.

Copies of the proposed regulations and accompanying RIS may be obtained from the Information Centre, Department of Natural Resources and Environment, 8 Nicholson Street, East Melbourne, Victoria 3002 (phone 9637 8325) between 8:30 am and 5:30 pm. Alternatively, the proposed regulations and accompanying RIS are located at <http://www.nre.vic.gov.au/ris/>

Public comments or submissions on the proposed regulations and RIS are invited. All comments or submissions must be in writing and must be received by the Parks Flora and Fauna Division (Attention Mr G. Niewand), Department of Natural Resources and Environment, Level 14, 8 Nicholson Street, East Melbourne, Victoria 3002 or on gary.niewand@nre.vic.gov.au by no later than 5:30 pm on 29 November 2002.

All submissions will be treated as public documents.

SHERRYL GARBUTT
Minister for Environment
and Conservation

Subordinate Legislation Act 1994

NOTICE OF DECISION

Petroleum (Submerged Lands) (Amendment) Regulations 2002

I, Candy Broad, Minister for Energy and Resources and Minister responsible for the administration of the **Petroleum (Submerged Lands) Act 1982**, give notice under section 12 of the **Subordinate Legislation Act 1994**, as follows:

A Regulatory Impact Statement (RIS) was prepared in relation to the proposed Petroleum (Submerged Lands) (Amendment) Regulations

2002. The objective of the proposed Regulations is to amend the Petroleum (Submerged Lands) Regulations 2001 to mirror Commonwealth regulations by:

- revising provisions relating to fees for the release of information and samples, to refer to the new Part IIIA of the **Petroleum (Submerged Lands) Act 1982** which replaces section 118 (repealed);
- inserting annual fees for infrastructure licences;
- inserting offences that replace offences previously set out in sections 34(2) and (3), 35 and 121 (repealed) of the Act; and
- omitting fees for renewal of production licences and pipelines licences (as renewals are no longer provided for in the Act); and
- inserting application fees for leases, infrastructure licences and variation to infrastructure licences.

The RIS was advertised seeking public comment and no submissions were received.

As a result, I have decided that the proposed Petroleum (Submerged Lands) (Amendment) Regulations 2002 should be made without amendment.

Dated 23 October 2002

CANDY BROAD
Minister for Energy
and Resources

Transport Act 1983

TOW TRUCK DIRECTORATE OF VICTORIA

Declaration of Controlled Area

I, Steve Stanko, Director, Victorian Taxi and Tow Truck Directorate, pursuant to Section 183A of the **Transport Act 1983**, declare that, effective from 1 December 2002, have determined the following area to be the Controlled Area for the purpose of Division 8 of Part 6 of the said Act.

1. That area firstly bounded by a notional line drawn from the coastline at Western Port Bay at a point in line with Jetty Lane, then to the terminus of Jetty Lane, along Jetty Lane to its intersection with the Bass Highway, in a northerly direction along Bass Highway to its intersection with the South Gippsland Highway, in a south-easterly direction along the South Gippsland Highway to its

intersection with Kettles Road, along Kettles Road to its intersection with McDonalds Track, in an easterly direction along McDonalds Track to Camms Road, along Camms Road to its terminus, in an easterly direction to the intersection of Mt Lyall Road and Cochranes Road, along Cochranes Road to its intersection with Anthony's Road, in a northerly direction along Anthony's Road to its intersection with Hook Road, along Hook Road to its intersection with Lyons Road, then in a northerly direction to the southern bank of the Lang Lang River, along the southern bank of the Lang Lang River in a westerly direction to its intersection with Westernport Road, along Westernport Road in a north-easterly direction to its intersection with Thwaites Road, along Thwaites Road to its intersection with Purvis Road, along Purvis Road to its intersection with North Yannathan Road, in a westerly direction along North Yannathan Road to its intersection with Bridge Road, along Bridge Road to its intersection with Koo-Wee-Rup-Longwarry Road, in a northerly direction along Koo-Wee-Rup-Longwarry Road to the Melbourne to Sale Railway, in a north-westerly direction along the railway to its intersection with the east bank of the Bunyip River, in a northerly direction along the east bank of the Bunyip River to its intersection with Seven Acre Creek, along the eastern bank of Seven Acre Creek in a north-westerly direction to its intersection with Bunyip Road, in a westerly direction along Bunyip Road to its intersection with the northern bank of the Tomahawk Creek, in a westerly direction along the northern bank of Tomahawk Creek to its intersection with the northern bank of Shepherd Creek, in a north-westerly direction along the northern bank of Shepherd Creek to its intersection with Healesville-Koo-Wee-Rup Road (also known as Woori Yallock Road), in a south-westerly direction along Healesville-Koo-Wee-Rup Road to its intersection with Belgrave-Gembrook Road, in a westerly direction along Belgrave-Gembrook Road to its intersection with Wellington Road, in a northerly direction to the intersection of Trumpington Grove and Ridge Road, in a

northerly direction to the intersection of Kallista–Emerald Road and Waterfield Road, along Waterfield Road and Rankins Road to its intersection with David Hill Road, in a northerly direction along David Hill Road to its intersection with Vika Avenue, along Vika Avenue to its intersection with Allandale Road, in a north-westerly direction to the terminus of Emerald Creek Road, along Emerald Creek Road to its intersection with McAllister Road, along McAllister Road to its intersection with Old Emerald Road, in a westerly direction along Old Emerald Road to its intersection with Anderson Road, along Anderson Road to its intersection with Monbulk Road, in a north-easterly direction along Monbulk Road to its intersection with Monbulk–Seville Road, along Monbulk–Seville Road to its intersection with Link Road, in a northerly direction to the intersection of Parker Road and Graham Road, along Graham Road to its intersection with Queens Road, in a south-westerly direction along Queens Road to its intersection with Lewis Road, along Lewis Road to its intersection with Hunter Road, in an easterly direction along Hunter Road to its intersection with McKillop Road, along McKillop Road to its intersection with Forest Road, along Forest Road and Bailey Road to its intersection with Seth Place, in a northerly direction to the intersection of Warburton Highway and Boundary Road, along Boundary Road to the point at which it crosses the GPU Powernet Pty Ltd electricity transmission line, in a north-westerly direction along the transmission line to the point at which it crosses Eltham–Yarra Glen Road, in a northerly direction along Eltham–Yarra Glen Road to its intersection with Kangaroo Ground–St Andrews Road, along Kangaroo Ground–St Andrews Road to its intersection with Church Road, along Church Road to its intersection with Heidelberg–Kinglake Road, in a south-westerly direction along Heidelberg–Kinglake Road to its intersection with Cottles Bridge–Strathewen Road, along Cottles Bridge–Strathewen Road to its intersection with Nankervis Road, along Nankervis Road to its intersection with Arthurs Creek Road, along Arthurs Creek Road to its intersection with Ridge Road,

along Ridge Road to its intersection with Yea Road, in a north-easterly direction along Yea Road to its intersection with Wildwood Road, along Wildwood Road (Milky Lane) to its intersection with Wallan Road, in a south-easterly direction along Wallan Road to its intersection with Clarks Road, along Clarks Road, Glenburnie Road and Janna Road to its intersection with Merriang Road, in a southerly direction along Merriang Road and Epping Road to its intersection with Summerhill Road, along Summerhill Road and Mount Ridley Road to its intersection with Konagaderra Road, in a westerly direction to its terminus of Feehans Road, along Feehans Road to its intersection with Wildwood Road, in a north-westerly direction to the terminus of Clark Court, along Clark Court to its intersection with Melbourne–Lancefield Road, in a westerly direction to the right angled bend on Settlement Road situated 2 kilometres east of its intersection with Riddell Road, in a westerly direction along Settlement Road and Settlement Road West to its terminus, in a southerly direction to the intersection of Dalrymple Road and Mundy Road, along Mundy Road and Couangalt Road to its intersection with Berrie Road, along Berrie Road to its intersection with Millett Road, in a westerly direction along Millett Road to its intersection with Black Hill Road, in a southerly direction along Black Hill Road to its intersection with Diggers Rest–Coimadai Road, in a south-westerly and westerly direction along Diggers Rest–Coimadai Road to its intersection with the western bank of Djerriwarrh Creek, in a southerly direction along the western bank of Djerriwarrh Creek to its intersection with the Western Freeway, in a south-easterly direction to the intersection of the western bank of the Werribee River and Exford Road, in a southerly direction along the western bank of the Werribee River to a point where it crosses the GPU Powernet Pty Ltd electricity transmission line, in a south-westerly direction along the transmission line to a point at which it crosses the Little River, in a southerly direction along the western bank of the Little River to the coast, secondly by the coastline from the Little River to the

coastline at Western Port Bay at a point in line with Jetty Lane.

2. The line drawn as projected in clause 1 shall be deemed to be drawn twenty metres beyond and parallel to the right hand edge of the carriageway, road, street, drive, court, or land referred to in such clause.

STEVE STANKO
Director

Transport Act 1983

TOW TRUCK DIRECTORATE OF VICTORIA

Tow Truck Application

Notice is hereby given that the following application will be considered by the Licensing Authority after 4 December 2002.

Notice of any objection to the granting of an application should be forwarded to reach the Director, Tow Truck Directorate of Victoria, Level 6, 14–20 Blackwood Street, North Melbourne (PO Box 666, North Melbourne 3051) not later than 28 November 2002.

It will not be necessary for interested parties to appear on the date specified, unless advised in writing.

Westland Towing Services Pty Ltd. Application for variation of conditions of tow truck licence number TOW715 which authorises the licensed vehicle to be managed, controlled and operated from a depot situated at 15–17 Elm Park Drive, Hoppers Crossing to change the depot address to 21 Triholm Avenue, Laverton.

Note: This licence is under consideration for transfer to Laszlo Fekete.

Dated 31 October 2002

STEVE STANKO
Director

Education Act 1958

NOTICE OF MAKING OF ORDER UNDER SECTION 13

An Order of the Minister for Education Services was made on 21 October 2002 under section 13(4) of the **Education Act 1958** and Administrative Arrangements Order (No. 180) 2002 amending Schedule 1 of the constituting

Order of the school council of the State school proposed to be called Roxburgh Park Primary School.

MONICA GOULD
Minister for Education Services

Education Act 1958

NOTICE OF MAKING OF ORDER UNDER SECTION 13

An Order of the Minister for Education Services was made on 21 October 2002 under sections 13(4) and 13(11) of the **Education Act 1958** and Administrative Arrangements Order (No. 180) 2002 amending the constituting Orders of the school councils of all State schools as follows:—

- omit the definition of “DEET” and insert “DE&T” means the Department of Education and Training;
- for “DEET” wherever occurring, substitute “DE&T”;
- for “DET” wherever occurring, substitute “DE&T”;
- in clauses 26(b) and 26(c)(i) for “Minister for Education” substitute, “Minister for Education and Training”;
- in clause 33.8, for “Minister for Education”, substitute “Minister administering section 13(1) of the **Education Act 1958** (Vic.)”, and
- in clause 33.9, for “Minister”, substitute “Minister administering section 13(1) of the **Education Act 1958** (Vic.)”.

MONICA GOULD
Minister for Education Services

Education Act 1958

NOTICE OF MAKING OF ORDER UNDER SECTION 13

An Order of the Minister for Education Services was made on 21 October 2002 under sections 13(1), 13(4), 13(5) and 13(11) of the **Education Act 1958** and Administrative Arrangements Order (No. 180) 2002 dissolving the school council originally constituted in respect of the State school now known as Ruthven Primary School, and constituting a school council for the State school called Ruthven Primary School.

MONICA GOULD
Minister for Education Services

Education Act 1958

NOTICE OF MAKING OF ORDERS UNDER SECTION 13

Eight Orders of the Minister for Education Services were made on 21 October 2002 pursuant to sections 13(4) and 13(11) of the **Education Act 1958** and Administrative Arrangements Order (No. 180) 2002 each amending the constituting Order of a school council to change its name. The changes are as follows:

Old Name	New Name
Birchip Education Centre School Council	Birchip P-12 School Council
Boronia Heights Secondary College Council	Boronia Heights College Council
Buckley Park Secondary College Council	Buckley Park College Council
Carwatha College School Council	Carwatha College P-12 School Council
Cobram Consolidated School Council	Cobram Primary School Council
Grovedale Secondary College Council	Grovedale College Council
Mildura Special Developmental School Council	Mildura Specialist School Council
Moorabbin Heights Primary School Council	East Bentleigh Primary School Council

In addition, an Order of the Minister for Education Services was made on 21 October 2002 pursuant to section 13(4) of the **Education Act 1958** and Administrative Arrangements Order (No. 180) 2002 amending the constituting Order of a school council to change its name. The change is as follows:-

Old Name	New Name
Council of the State school proposed to be called Kaniva P-12 College	Council of the State school called Kaniva College

MONICA GOULD
Minister for Education Services

Education Act 1958

NOTICE OF MAKING OF ORDER UNDER SECTION 13

An Order of the Minister for Education Services was made on 21 October 2002 under sections 13(1), 13(4), 13(5) and 13(11) of the **Education Act 1958** and Administrative Arrangements Order (No. 180) 2002 dissolving the Corryong Secondary College Council and Corryong Consolidated School Council, and constituting a school council for the State school proposed to be called Corryong College.

MONICA GOULD
Minister for Education Services

Education Act 1958

NOTICE OF MAKING OF ORDERS UNDER SECTION 13

Six Orders of the Minister for Education Services were made on 21 October 2002 under sections 13(4) and 13(11) of the **Education Act 1958** and Administrative Arrangements Order (No. 180) 2002 amending the constituting Orders of Diamond Creek Primary School Council, Flowerdale Primary School Council, Grovedale Primary School Council, Mitta Mitta Primary School Council,

Preston East Primary School Council and the school council of Swan Hill College in respect of the memberships of the school councils.

MONICA GOULD
Minister for Education Services

Education Act 1958

NOTICE OF MAKING OF ORDERS UNDER SECTION 13

Nine Orders of the Minister for Education Services were made on 21 October 2002 under sections 13(4) and 13(11) of the **Education Act 1958** and Administrative Arrangements Order (No. 180) 2002 amending the constituting Orders of Alvie Consolidated School Council, Ardmona Primary School Council, Darraweit Guim Primary School Council, Drouin South Primary School Council, Drummond Primary School Council, Fawkner Secondary College Council, Nicholson Primary School Council, Ripplebrook Primary School Council and Stanley Primary School Council in respect of the memberships of the school councils.

MONICA GOULD
Minister for Education Services

Environment Protection Act 1970

ACT NO. 8056/1970

Industrial Waste Management Policy (Prescribed Industrial Waste) 2000

No. S 183 December 2000

Prescribed Industrial Waste Classification

1. For the purpose of clause 11(1) and in accordance with Schedule 1 of the industrial waste management policy (Prescribed Industrial Waste) the Authority hereby classifies certain types of designated contaminated soil in terms of opportunities for its reuse, recycling, recovery of energy and treatment as shown in Table 1.
2. The classification applies to contaminated soils (other than contaminated soils (low level)) prescribed in Schedule 1 of the Environment Protection (Prescribed Waste) Regulations 1998, contaminated with the stated contaminant types as specified in Table 1 below.
3. This classification will come into effect upon publication in the Government Gazette.

**TABLE 1 –
CLASSIFICATION OF DESIGNATED ORGANIC CONTAMINATED SOILS**

Classification – Opportunities for Reuse, Recycling, Recovery of Energy and Treatment	Prescribed Industrial Waste - Contaminated Soil Waste Type
Available in the foreseeable future(a)	Soil contaminated with: <ul style="list-style-type: none"> ● Total Petroleum Hydrocarbons ● Monocyclic Aromatic Hydrocarbons ● Organochlorine Compounds ● Polycyclic Aromatic Hydrocarbons

- (a) The contaminated soil has potential for reuse, recycling, recovery of energy or treatment, and facilities necessary to realise this potential are practicable, with the exception that the facilities required are not currently available in the State of Victoria, or elsewhere in a location practicably accessible.

Sports Event Ticketing (Fair Access) Act 2002

MINISTER'S GUIDELINE

AUTHORISATION OF NOMINATING AUTHORITIES

I, Justin Madden, Minister for Sport and Recreation issue the following Guideline under Part 4 of the **Sports Event Ticketing (Fair Access) Act 2002** ("the Act") which provides that an event organiser must within 60 days after receiving notice that the Minister has declared an event for the purposes of the Act, give the Minister a ticket scheme proposal. The proposal must comply with these guidelines.

The Minister may require the event organiser to provide further details of the proposal within a specified time, may extend the time for providing a proposal or extend the time for providing further details of a proposal.

An event organiser may, with the Minister's written approval, give the Minister a replacement ticket scheme proposal at any time before receiving notice from the Minister that:

- the ticket scheme set out in the original proposal is an approved ticket scheme; or
- otherwise that the Minister has refused to approve the ticket scheme set out in the original proposal.

Guidelines – Information requirements (the questions)

The Guidelines are a series of questions which when answered are designed to provide the Minister with the detail necessary to permit informed consideration of the proposals.

Attachments and ancillary documentation may be provided but should not be submitted in lieu of a detailed specific response to relevant questions.

The guideline questions are grouped under the following categories:

- A. Event Identification
- B. Ticket Allocation
- C. Control of Tickets
- D. Sale and Distribution of Tickets
- E. Industry Codes and Standards

All sections and questions must be completed.

Questions considered "not applicable" must be clarified with a brief explanation.

All information which is deemed as commercially sensitive (commercial in confidence) or where there are personal privacy considerations must be clearly identified.

A. Event Identification

When answering the following questions relating to the description and timing of the event and event venue, the applicant should provide the fullest possible response and a level of detail necessary to permit informed consideration for the proposal. The applicant must include:

- (a) What is the formal name of the event?
- (b) Under what other name(s) is the event proposed to be promoted?

Notes:

An event may have a formal name, but be promoted under other descriptions.

- (a) What is the date(s) of the event?
- (b) At what venue(s) will the event be held?

Notes:

An event may be held over a number of days, eg, the Australian Tennis Open, and, at a number of venues.

B. Ticket Allocation

The specified minimum proportion of tickets available for sales or distribution to the public generally or to particular classes of persons should be answered by the following questions:

- (a) What proportion of all seats in the venue is specified as being available for the sale or distribution of tickets to the general public?

Notes:

- (i) Information should be provided of the total number of seats at the venue for the event and the percentage number of that total available for sale or distribution to the public.
- (ii) A distinction is made between “sale”, being the purchase of tickets, and, “distribution”, being tickets made available at no cost or as part of a promotional initiative, eg a prize in a competition.

- (b) What proportion of all seats in the venue is specified as being available for the sale or distribution of tickets to a particular class, or classes, of persons?

Notes:

- (i) Information should be provided of the total number of seats at the venue for the event (ie, how many can be admitted irrespective of whether or not paying admission) and the percentage number of that total available for sale or distribution to a particular class, or classes of, persons.
- (ii) A distinction is made between “sale”, being the purchase of tickets, and, “distribution”, being tickets made available at no cost or as part of a promotional initiative, eg a prize in a competition.
- (iii) A particular class, or particular classes, of persons should be understood to include members of a club affiliated with the event.

Example: In the case of the AFL Grand Final the particular classes may be the members of the competing clubs, the members of the non-competing clubs, AFL members and Melbourne Cricket Club members.

- (c) What is the breakdown of tickets allocated otherwise than by sale and distribution to the general public or to a particular class, or classes, of persons?

Notes:

Information should be provided of such tickets allocated, including other entry authority if not admitted by ticket (eg, media passes, other complimentary passes, competitions, charity auctions, contra arrangements).

- (d) How is the venue to be configured to ensure the objective of a fair process, maximising public access to the venue?

Notes:

Information should be provided that demonstrates that the venue is configured to enable fair public access. Re-configuration of a venue to substantially emphasise corporate accommodation would not be consistent with fair public access.

C. Control of Tickets

Answers to the following questions will be taken into account in considering the process for tracing the ultimate use made of a ticket:

- (a) What steps will be taken to ensure that a person authorised to sell or distribute tickets to the event is aware of the obligations imposed on the event organiser under the Act?
- (b) What steps will be taken to ensure that a person authorised to sell or distribute tickets to the event is aware of the obligations imposed on him or her under the Act?

Notes:

- (i) Part 5 of the Sports Event Ticketing (Fair Access) Act provides that it is an offence:
- for the event organiser, without reasonable excuse to sell, or authorise the sale of, tickets or conduct the event in the absence of the Minister's approval;
 - if the event organiser knowingly fails to comply with the approved ticket scheme for the event;
 - if the event organiser fails to ensure that a person authorised in writing to sell or distribute tickets to the event on behalf of the event organiser does so in accordance with the approved ticket scheme for the event;
 - if such an authorised person, without reasonable excuse, sells or distributes tickets otherwise than in accordance with the approved ticket scheme for the event;
 - for a person to engage in ticket scalping.
- (ii) Steps that may be considered would be to include in the event organiser's contract with the authorised ticket seller/distributor:
- specific references to the statutory obligations;
 - compensation provisions for the event organiser where the authorised seller/distributor breaches the statutory obligations (perhaps set at a level commensurate with the penalties under the Act);
- conduct information/training seminars with the authorised seller/distributor.

- (c) Who will be authorised to sell and/or distribute tickets to the event?
- (d) What arrangements are in place to monitor the sub-contracting of sale and distribution of tickets?

Notes:

- (i) Information should be provided demonstrating the breakdown of tickets available to be sold or distributed direct to the public or others by the event organiser.
- (ii) Similarly, there should be a breakdown of tickets allocated for sale or distribution by entities other than the event organiser (eg, Ticketmaster, AFL clubs, tourism agencies including airlines, promotional agencies including media, such as radio stations).

- (e) What specific measures are proposed or implemented to ensure that the above breakdowns will result in achieving the objective of a fair process, maximising public access to the event?

Notes:

- (i) Information should be provided of arrangements made by the event organiser to ensure that those agencies or entities selling or distributing tickets do so in accordance with the objective.
- (ii) Perhaps one measure may be a condition in the contractual or licensing arrangements between the event organiser and the selling/distributing agencies or entities. Such a condition may impose a penalty reasonably corresponding to any penalty incurred by the event organiser for a contravention of the legislation where that contravention resulted from the action of those agencies or entities.

- (f) What arrangements are proposed for recording allocation of individual tickets or batches of tickets?

Notes:

- (i) Measures that might be taken include the numbering of tickets and colour coded tickets.

- (g) What arrangements are proposed for the return of unwanted tickets?

Notes:

- (i) The focus here is on the extent to which the distribution of the tickets is being accounted for. Full transparency is sought from the event organiser. Under these guidelines the event organiser should provide information on the following:
1. Numbered tickets.
 2. Specify where each ticket is going. For example, tickets 1–10,000 sold through ticket agency to general public. Tickets 10,000–15,000 given to Sponsors. Tickets 15,000–16,000 sold through packaged deals. Tickets 16,000 to 17,000 used in house by event organisers.
 3. Arrangements for seeking similar diligence and disclosure from its sponsors and agents in their allocation.
 4. Non-Transferable tickets. Tickets made null and void if sold to a third party (similar to existing rules on AFL Membership tickets).
 5. The measures to be implemented to enable ticket purchasers to clearly identify authorised ticket sellers/distributors.

The information required for the conditions on tickets to prevent ticket scalping is obtained by answering this question:

- (a) What arrangements are proposed to ensure that individuals don't buy a large number of tickets to later re-sell (ticket scalping)?

Notes:

- (i) Consistent with the objective of fair access to tickets, information should be provided on proposals to limit the number of tickets available for purchase by an individual (including a corporate entity), eg, where a limit of one order per individual is imposed.
- (ii) Information should be provided of any conditions on the ticket concerning resale or transfer of tickets. For example, such a condition may stipulate that tickets must not be resold or transferred, used in lotteries or competitions, included in travel or hospitality packages, handled in any way which conflicts with any event organiser sponsorship or commercial arrangements or dealt with in any way whatsoever which is not in accordance with private use. By way of example, the conditions of sale appearing on Australian Rugby Union tickets reads as follows:
It is a condition of sale that this ticket may not, without prior written consent of the ARU, be resold at a premium nor used for advertising, promotion or other commercial purposes (including competitions or trade promotions) or to enhance the demand for other goods or services. If a ticket is sold or used in breach of this condition, the bearer of the ticket will be denied admission.”

D Sale and Distribution of Tickets

The ticket purchasing arrangements should be outlined by answering the following questions:

- (a) What is the method(s) for purchasing tickets?

Notes:

- (i) Some major sporting events have, in effect, a public lottery process, such as the Sydney 2000 Olympics.

- (b) Can tickets be purchased in person?
- (c) Can tickets be purchased as a group?
- (d) Can tickets be purchased by order made by telephone?
- (e) What arrangements are there to order tickets online?

Notes:

- (i) Information should be provided of how a sale made by telephone or online is validated.

- (f) Will decentralised arrangements be made for purchase of tickets?

Notes:

- (i) Information should be provided on the number (if limited) of tickets available for purchase at decentralised outlets and the location of such outlets.

- (g) What is the timeframe for the release of tickets for sale at all outlets and purchase modes?

Notes:

- (i) Information should be provided on the timeframe for the sale and distribution of tickets.

- (h) What arrangements are proposed for tickets with special seating for disabled patrons?

Notes:

- (i) Information should be provided of arrangements for wheelchair spaces (with companion seats) and easy access seats for use by disabled spectators.

- (i) Who should a purchaser contact with questions about access to tickets?
- (j) What arrangements are proposed for dealing with complaints?

Notes:

- (i) Details should be provided of the processes for resolution of complaints.

- (k) Are measures proposed to prevent ticket fraud (eg, ticket forgery, internet ticket scams)?

Notes:

- (i) It might be expected that security measures would be incorporated into the tickets. Specific details need not be provided where disclosure of such information would be reasonably likely to jeopardise the integrity of the security measures.

The applicant is required to answer the following question relating to the public awareness of all authorised tickets sale and distribution arrangements:

- (a) What strategies are proposed to ensure that the general public is aware of the arrangements for the sale and distribution of tickets?

Notes:

- (i) A fundamental principle underpinning the statutory requirements is that there should be transparency. A person wishing to seek tickets to the event should have ready access to all information relating to access to tickets. Similarly a person seeking tickets should be able to readily ascertain the authority of the organisation/agency to offer to sell and/or distribute tickets to the event.
- (ii) Information may be provided on the publicity and promotional arrangements of the event.

E Industry Codes and Standards

The required industry codes and standards information is to be given by the answering the following question:

- (a) Does the ticketing scheme comply with any existing industry codes/best practice for event ticketing?

Notes:

- (i) Industry codes may be developed for event ticketing covering a number of matters not included in these guidelines, such as sight-lines, refund policy, etc.
- (ii) It is expected that the ticketing scheme will comply with any accepted "best practice" ticketing standards, and therefore, reflect or improve upon current industry standards.

JUSTIN MADDEN MLC
Minister for Sport and Recreation

Water Act 1989

GOULBURN–MURRAY
RURAL WATER AUTHORITY

Diminishment of Goulburn–Murray Irrigation District and West Loddon Waterworks District

Notice is hereby given that Goulburn–Murray Rural Water Authority intends to diminish the extent of its Goulburn–Murray Irrigation District, incorporating:

Central Goulburn Area:

Crown Allotment	Section	Parish
Pts 14, 18, 18A	C	Tongala

Rochester Area:

Crown Allotment	Section	Parish
146A, 146B, 147, Pt 148	–	Nanneella
158, Pts 51, 159	–	Wharparilla

Shepparton Area:

Crown Allotment	Section	Parish
Pts 71, 77B, 77C	–	Kialla
77C, Pts 23B, 77	–	Shepparton
Pt 22	E	Shepparton

Torrumbarry Area:

Crown Allotment	Section	Parish
Pt 40	B	Castle Donnington
Pt 1	A	Murrabit West

Notice is hereby given that Goulburn–Murray Rural Water Authority intends to diminish the extent of its West Loddon Waterworks District, incorporating:

Crown Allotment	Section	Parish
9, 11, Pts 12, 13	E	Boort
18, 18A	F	Boort
17	–	Kinypanial

**EXTENSION OF CAMPASPE AND GOULBURN–MURRAY IRRIGATION DISTRICTS
& NORMANVILLE WATERWORKS DISTRICT**

Notice is hereby given that Goulburn–Murray Rural Water Authority intends to extend the boundary of its Campaspe Irrigation District, incorporating:

Crown Allotment	Section	Parish
146A, 146B, 147, Pt 148	–	Nanneella
Notice is hereby given that Goulburn–Murray Rural Water Authority intends to extend the boundary of its Goulburn–Murray Irrigation District, incorporating:		
Murray Valley Area:		
Crown Allotment	Section	Parish
Pt 7	E	Barwo
Pt 38, Katamatite Township	–	Katamatite
2, 31G	D	Yarroweyah
Pyramid–Boort Area:		
Crown Allotment	Section	Parish
18, 18A	F	Boort
17	–	Kinypanial
Rochester Area:		
Crown Allotment	Section	Parish
4	C	Colbinabbin
Torrumbarry Area:		
Crown Allotment	Section	Parish
Pts 63, 64	A	Castle Donnington
6	2	Kunat Kunat
Notice is hereby given that Goulburn–Murray Rural Water Authority intends to extend the boundary of its Normanville Waterworks District, incorporating:		
Crown Allotment	Section	Parish
9, 11, Pts 12, 13	E	Boort

The Proposals have been advertised in accordance with The **Water Act 1989**. Submissions will be received for one month after the publication of this notice.

Submissions should state grounds of objections to the proposal and will be considered at the Board of the Authority's next meeting.

Copies of the Proposals may be inspected free of charge at the office of Goulburn–Murray Water, 40 Casey Street, Tatura during business hours.

DENIS FLETT
Chief Executive

Water Act 1989

UNION OF COMMITTEES

I, Sherryl Garbutt, Minister for Environment and Conservation hereby give notice pursuant to Section 110 of the **Water Act 1989**, that the following committees as established by the North East Region Water Authority are united to form the Porepunkah Consultative Committee:

- Porepunkah Reference Group;
- Bright–Porepunkah Groundwater Monitoring Group; and
- Porepunkah Sewerage Consultative Committee.

This notice takes effect on and from the date of publication in the Government Gazette.

Dated 22 October 2002

SHERRYL GARBUTT MP
Minister for Environment
and Conservation

Interpretation of Legislation Act 1984**FAIR TRADING (PRESCRIBED SAFETY STANDARD FOR BABY WALKERS)
REGULATIONS 2002**

Notice of Incorporation of Documents and Address for Inspection of Documents

As required by section 32 of the **Interpretation of Legislation Act 1984**, I give notice that the Fair Trading (Prescribed Safety Standard for Baby Walkers) Regulations 2002 apply, adopt or incorporate the following documents:

Table of Applied, Adopted or Incorporated Matter

Statutory Rule Provision	Title of applied, adopted or incorporated document	Matter in applied, adopted or incorporated document
Regulation 4	American Society for Testing and Materials Consumer Safety Specification for Infant Walkers, published in July 2000 and available from the website of the American Society for Testing and Materials (www.astm.org) (designated as F 977-00)	Sections 6.1, 6.4 and 9.3

A copy of the material applied, adopted or incorporated by the regulation was lodged with the Clerk of the Parliaments on 15 October 2002.

A copy of the aforementioned documents applied, adopted or incorporated by the Fair Trading (Prescribed Safety Standard for Baby Walkers) Regulations 2002 shall be kept available for inspection during normal office hours by members of the public without charge at the office of the Director of Consumer Affairs Victoria, Level 3, 452 Flinders Street, Melbourne 3000.

Dated 22 October 2002

CHRISTINE CAMPBELL MP
Minister for Consumer Affairs

Planning and Environment Act 1987**VICTORIA PLANNING PROVISIONS**

Notice of Approval of Amendment

Amendment VC15

The Minister for Planning has approved Amendment VC15 to the Victoria Planning Provisions.

The Amendment comes into operation on the date this notice is published in the Government Gazette.

The Amendment:

- amends Clause 17.04-2 to update the reference to the tourism guidelines;
- amends the condition opposite Adult sex bookshop in the table of uses in the business and industrial zones to replace "school" with "primary school or secondary school";
- amends the industrial and business zones and Clauses 15.02, 52.10 and 56.07 to replace "school" with "education centre";
- introduces a new Particular provision and Land use term for Shipping container storage and includes Shipping container storage in the Table of uses in the Industrial 1, Business 3 and Business 4 Zones;

- amends the Design and Development Overlay and Neighbourhood Character Overlay to exempt the construction of an outdoor swimming pool associated with a dwelling from the requirement for a permit unless a specific requirement for this matter is specified in a schedule to the overlay;
- amends the Heritage Overlay and the Public Acquisition Overlay to exempt the removal, destruction, pruning or lopping of vegetation from a permit requirement if it presents an immediate risk of personal injury or damage to property;
- amends Clause 52.01 to be consistent with the Section 18(5) and 18(6) of the **Subdivision Act 1988** and to clarify the Class 1 exemption for the subdivision of buildings used for residential purposes;
- amends Clause 52.04–3 to extend the expiry date for transitional arrangements for residential development to 30 June 2003;
- amends Standard C21 in Clause 56.06–4 to facilitate the use of building envelopes on lots in new subdivisions that provide for greater design flexibility and protect the amenity of adjoining properties;
- amends the definitions of ‘Materials recycling’, ‘Store’ and ‘Wall height’;
- makes minor typographical and format changes to improve the operation of schemes.

The Amendment makes relevant corresponding changes to all planning schemes in Victoria except the Port of Melbourne Planning Scheme.

A copy of the Amendment can be inspected, free of charge, during office hours, at: Department of Infrastructure, Planning Information Centre, Upper Plaza, Nauru House, 80 Collins Street, Melbourne 3000; Department of Infrastructure, North Eastern Region, 50–52 Clarke Street, Benalla 3672; Department of Infrastructure, Eastern Region, 120 Kay Street, Traralgon 3844; Department of Infrastructure, Northern Region, 57 Lansell Street, Bendigo 3550; Department of Infrastructure, South Western Region, 63 McKillop Street, Geelong 3220 and Department of Infrastructure, Western Region, 1315 Sturt Street, Ballarat 3550.

All municipal council offices in Victoria.

PAUL JEROME
Executive Director
Planning, Heritage and
Building Division
Department of Infrastructure

Planning and Environment Act 1987

BRIMBANK PLANNING SCHEME

Notice of Approval of Amendment

Amendment C40

The Minister for Planning has approved Amendment C40 to the Brimbank Planning Scheme.

The Amendment comes into operation on the date this notice is published in the Government Gazette.

The Amendment rezones part of the former Albion Explosives Factory land from Commonwealth Land to Business 1 Zone and includes a Development Plan Overlay and Environmental Audit Overlay on the land.

A copy of the Amendment can be inspected, free of charge, during office hours, at the Department of Infrastructure, Planning Information Centre, Upper Plaza, Nauru House, 80 Collins Street, Melbourne and at the offices of the Brimbank City Council, Alexandra Avenue, Sunshine (also at Old Calder Highway, Keilor).

PAUL JEROME
Executive Director
Planning, Heritage and
Building Division
Department of Infrastructure

Planning and Environment Act 1987

BRIMBANK PLANNING SCHEME

Notice of Approval of Amendment

Amendment C47

The Minister for Planning has approved Amendment C47 to the Brimbank Planning Scheme.

The Amendment comes into operation on the date this notice is published in the Government Gazette.

The Amendment rezones land in the Cairnlea Estate identified as part of Lot Y on PS506348N from Commonwealth land to Residential 1 Zone and the Development Plan Overlay and Environmental Audit Overlay are also applied to the land.

A copy of the Amendment can be inspected, free of charge, during office hours, at the Department of Infrastructure, Planning

Information Centre, Upper Plaza, Nauru House, 80 Collins Street, Melbourne and at the offices of the Brimbank City Council, Alexandra Avenue, Sunshine (also at Old Calder Highway, Keilor).

PAUL JEROME
Executive Director
Planning, Heritage and
Building Division
Department of Infrastructure

Planning and Environment Act 1987

GREATER BENDIGO PLANNING SCHEME
Notice of Approval of Amendment
Amendment C45

The Minister for Planning has approved Amendment C45 to the Greater Bendigo Planning Scheme.

The Amendment comes into operation on the date this notice is published in the Government Gazette.

The Amendment inserts 47 Myers Street, Bendigo into the schedule to the Heritage Overlay, and includes the site as HO698 on Planning Scheme Map 19HO, on an interim basis.

A copy of the Amendment can be inspected, free of charge, during office hours, at the Department of Infrastructure Customer Service Centre, Upper Plaza, Nauru House, 80 Collins Street, Melbourne; the Department of Infrastructure Northern Regional Office, 57 Lansell Street, Bendigo, and at the Planning Office of the Greater Bendigo City Council, 15 Hopetoun Street, Bendigo.

PAUL JEROME
Executive Director
Planning, Heritage and
Building Division
Department of Infrastructure

Planning and Environment Act 1987

HUME PLANNING SCHEME
Notice of Approval of Amendment
Amendment C29

The Minister for Planning has approved Amendment C29 to the Hume Planning Scheme.

The Amendment comes into operation on the date this notice is published in the Government Gazette.

The Amendment:

- corrects a mapping error and rezones land at 149–155 Malmsbury Drive, Meadow Heights from Public Use No. 7 to Residential 1.

A copy of the Amendment can be inspected, free of charge, during office hours, at the Department of Infrastructure, Customer Service Centre, Upper Plaza, Nauru House, 80 Collins Street, Melbourne and at the offices of Hume City Council, Broadmeadows Office, 1079 Pascoe Vale Road, Broadmeadows 3047 and the Sunbury Office, 36 Macedon Street, Sunbury 3429.

PAUL JEROME
Executive Director
Planning, Heritage and
Building Division
Department of Infrastructure

Planning and Environment Act 1987

EAST GIPPSLAND PLANNING SCHEME
Notice of Lapsing of Amendment
Amendment C6

The East Gippsland Shire Council has resolved to abandon Amendment C6 to the East Gippsland Planning Scheme.

The Amendment proposed to include land in the Township of Nowa Nowa, being Parts Crown Allotments 6B, 12, 13 (Lots 1 and 2 LP 119907), 14, 15, 17, 18, 19B and 50B, in a Public Acquisition Overlay (PAO5) for the purpose of acquiring land to construct the realigned Bruthen–Nowa Nowa Road.

The Amendment lapsed on 25 September 2002.

PAUL JEROME
Executive Director
Planning, Heritage and
Building Division
Department of Infrastructure

ORDERS IN COUNCIL

**Crown Land (Reserves) Act 1978
CROWN LAND PERMANENTLY
RESERVED**

The Governor in Council under Section 4(1) of the **Crown Land (Reserves) Act 1978** permanently reserves the following Crown land which in his opinion is required for the purpose mentioned:-

**MUNICIPAL DISTRICT OF THE
PORT PHILLIP CITY COUNCIL**

SOUTH MELBOURNE — Public Park, 9283 square metres being Crown Allotment 2027, City of South Melbourne, Parish of Melbourne South as indicated by hatching on plan hereunder. (GP1060) — (C65472).

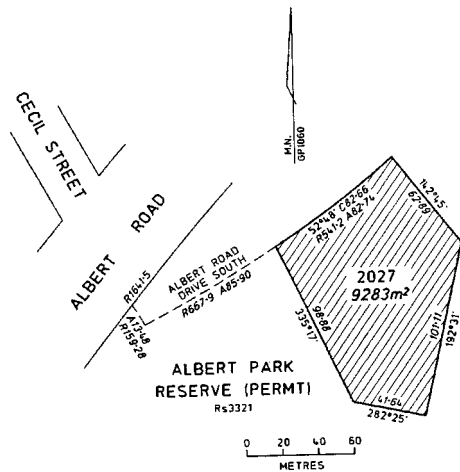

This Order is effective from the date on which it is published in the Government Gazette.

Dated 29 October 2002

Responsible Minister
SHERRYL GARBUTT
Minister for Environment
and Conservation

HELEN DOYE
Clerk of the Executive Council

**Crown Land (Reserves) Act 1978
CROWN LANDS TEMPORARILY
RESERVED**

The Governor in Council under Section 4(1) of the **Crown Land (Reserves) Act 1978** temporarily reserves the following Crown lands which in his opinion are required for the purpose mentioned:-

**MUNICIPAL DISTRICT OF THE
MELBOURNE CITY COUNCIL**

SOUTH MELBOURNE — Cultural, Recreational and Educational purposes, 3480 square metres being Crown Allotment 18F, Section D, City of South Melbourne, Parish of Melbourne South as shown on Certified Plan No. 121184 lodged in the Central Plan Office and 2514 square metres, being Crown Allotment 2008, City of South Melbourne, Parish of Melbourne South as indicated by hatching on plan hereunder. (GP922) — (Rs 37032).

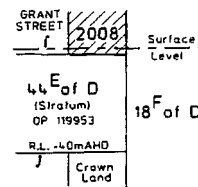
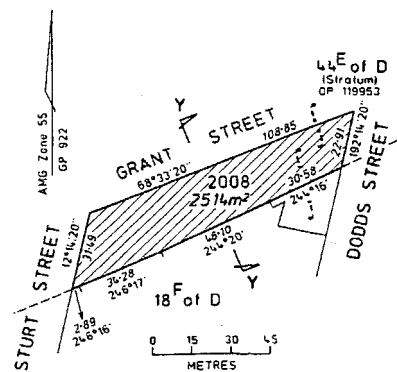

SECTION Y-Y

This Order is effective from the date on which it is published in the Government Gazette.

Dated 29 October 2002

Responsible Minister
SHERRYL GARBUTT
Minister for Environment
and Conservation

HELEN DOYE
Clerk of the Executive Council

**Project Development and Construction
Management Act 1994
APPLICATION ORDER**

The Governor in Council under section 8 of the **Project Development and Construction Management Act 1994** ("the Act") and on the

recommendation of the Premier, declares in respect of the Southern and Eastern Integrated Transport Project (the "Project"), a nominated project under section 6 of the Act that:

- (a) the following provisions of Part 3 of the Act apply in relation to the Project – sections 14, 15, 16, 17, 18, 18A, 19, 20, 20A, 20B, 20C, 20D, 20E, 20F, 20G, 20H, 20I, 20J, 21, 22, 23, 24, 25 and 26.
- (b) the following provisions of Part 3 of the Act apply to the Secretary to the Department of Infrastructure which is the facilitating agency for the Project – sections 14, 15, 16, 17, 18, 18A, 19, 20, 20A, 20B, 20C, 20D, 20E, 20F, 20G, 20H, 20I, 20J, 21, 22, 23, 24, 25 and 26.
- (c) sections 19, 20 and 22 apply in relation to the responsible Minister for the nominated project; and
- (d) pursuant to section 28 of the Act, the facilitating agency for the Project, the Secretary to the Department of Infrastructure, is deemed to be an authority for the purposes of the **Borrowing and Investment Powers Act 1987** to which sections 5, 8, 10 and 21 of that Act apply.

Dated 29 October 2002

Responsible Minister:
STEVE BRACKS
Premier

HELEN DOYE
Clerk of the Executive Council

**Project Development and Construction
Management Act 1994**

NOMINATION ORDER

The Governor in Council under section 6 of the **Project Development and Construction Management Act 1994** ("the Act") and on the recommendation of the Premier, declares the following development to be a project to which the Act applies:

- the Southern and Eastern Integrated Transport Project, being a project for an integrated transport corridor connecting the Eastern Freeway to the Frankston Freeway, including tunnels under the Mullum Mullum Creek, a link with the Ringwood By-Pass and ancillary works.

AND in accordance with section 7 of the Act specifies that:

- (a) the Minister for Transport is to be responsible for the nominated project; and
- (b) the Secretary to the Department of Infrastructure, being a body corporate established under section 35 of the Act, is to be the facilitating agency for the nominated project.

Dated 29 October 2002

Responsible Minister:
STEVE BRACKS
Premier

HELEN DOYE
Clerk of the Executive Council

Local Government Act 1989

**ALTERATION OF WARD BOUNDARIES OF
NORTHERN GRAMPAINS SHIRE
COUNCIL**

Order in Council

The Governor in Council hereby directs that:

- a) This Order comes into operation on the day it is published in the Government Gazette; and
- b) Under Section 220Q (k) of the **Local Government Act 1989**, on the day this Order comes into operation the boundaries of the wards of the Northern Grampians Shire Council shall be fixed as described in the Schedule to this Order.
- c) Under Section 220Q (n) of the **Local Government Act 1989**, the number of councillors assigned to each of the wards fixed as six Councillors in the Grampians Ward and three Councillors in the Bolangum Ward described in the Schedule to this Order.

Dated 29 October 2002

Responsible Minister
BOB CAMERON MP
Minister for Local Government

HELEN DOYE
Clerk of the Executive Council

SCHEDULE

**Boundaries of the Wards of
Northern Grampians Shire Council**

Altered and Redefined

Grampians Ward

Commencing on the Glenorchy–Donald Road at Bismark–Lubeck Road being a point on

the north-western boundary of the Shire; thence easterly by the Bismark–Lubeck Road to the Marnoo West Soldiers Road; thence northerly by that road to the Warranook–Strathcona Road; thence south-easterly by that road, the Strathcona–Bolangum Road and the Marnoo–Wallaloo East Road to the Wallaloo East–Kanya Road; thence easterly by that road to Kanya–Navarre Road; thence south-easterly by that road to Stawell–Avoca Road; thence easterly by that road to the Tulkara–Navarre Road; thence southerly by that road to the Shire boundary, and thence southerly, westerly, again southerly, north-westerly, generally north-easterly and easterly by the shire boundary to the point of commencement.

Bolangum Ward

Commencing on the Glenorchy–Donald Road at Bismark–Lubeck Road being a point on the north-western boundary of the Shire; thence easterly by the Bismark–Lubeck Road to the Marnoo West Soldiers Road; thence northerly by that road to the Warranook–Strathcona Road; thence south-easterly by that road, the Strathcona–Bolangum Road and the Marnoo–Wallaloo East Road to the Wallaloo East–Kanya Road; thence easterly by that road to Kanya–Navarre Road; thence south-easterly by that road to Stawell–Avoca Road; thence easterly by that road to the Tulkara–Navarre Road; thence southerly by that road to the Shire boundary, and thence easterly, generally northerly, generally westerly and generally southerly by the shire boundary to the point of commencement.

Interpretation of Legislation Act 1984

Local Government Act 1989

AMENDMENT ORDER FOR THE ALTERATION OF WARD BOUNDARIES OF WHITTLESEA CITY COUNCIL

Order in Council

The Governor in Council hereby directs that:

- a) Under Section 27 of the **Interpretation of Legislation Act 1984** and Section 220Q of the **Local Government Act 1989** the Order signed on 15 October 2002 for the alteration of ward boundaries for Whittlesea City Council be revoked and replaced with this new Order.

- b) Under Section 220S (1)(a) of the **Local Government Act 1989**, this Order comes into operation on the day it is published in the Government Gazette; and
- c) Under Section 220Q (k), (l) and (m) of the **Local Government Act 1989**, on the day this Order comes into operation the boundaries of the wards, the number of wards, names of the wards of the Whittlesea City Council shall be fixed as described in the Schedule to this Order.
- d) Under Section 220Q (n) of the **Local Government Act 1989**, on the day this Order comes into operation the number of councillors assigned to each of the wards fixed as described in the Schedule to this Order shall be one.

Dated 29 October 2002

Responsible Minister
BOB CAMERON MP
Minister for Local Government

HELEN DOYE
Clerk of the Executive Council

SCHEDULE

Boundaries of the Wards of Whittlesea City Council Altered and Redefined

South West Ward

Commencing on the southern boundary of the City at Edgars Creek; thence generally northerly by Edgars Creek to Kingsway Drive; thence westerly by that drive to Edgars Road; thence southerly by that road to Barry Road; thence westerly by that road and the northern boundary of allotment 24A, Parish of Keelbundora to the Merri Creek, being a point on the western boundary of the City, and thence southerly and easterly by the boundary to the point of commencement.

South Central Ward

Commencing on the southern boundary of the City at Edgars Creek; thence generally northerly by Edgars Creek to Kingsway Drive; thence easterly by that drive and a line in continuation to the northern part of Paschke Crescent; thence easterly by that crescent to Curtin Avenue; thence north-easterly and easterly by that avenue to Dalton Road; thence southerly and south-westerly by that road to the southern boundary of the City, and thence

westerly by the city boundary to the point of commencement.

South Ward

Commencing on Plenty Road at the Metropolitan Ring Road, being a point on the southern boundary of the City; thence westerly by the Metropolitan Ring Road to Tasman Drive; thence northerly by that drive to Betula Avenue; thence north-westerly and northerly by that avenue to McKimmies Road; thence westerly by that road to Dalton Road; thence southerly and south-westerly by that road to the southern boundary of the City, and thence easterly and north-easterly by the city boundary to the point of commencement.

Central Ward

Commencing on Childs Road at Redleap Avenue; thence north-easterly by Redleap Avenue to Centenary Drive; thence westerly by that drive to the Yan Yean Pipe Track; thence north-easterly by that pipe track to McDonald Road; thence westerly by that road to the former Epping to Whittlesea Railway, thence westerly by that former railway to the Darebin Creek; thence southerly and south-easterly by that creek to the Electricity Transmission Line; thence north-easterly by that Transmission Line to Childs Road, and thence south-easterly by that road to the point of commencement.

North Ward

Commencing on the Merri Creek at a point in line with O'Herns Road, being a point on the western boundary of the City; thence easterly by a line, O'Herns Road and Findons Road to Civic Drive; thence south-easterly by that drive to McDonalds Road; thence easterly by that road to the Yan Yean Pipe Track; thence north-easterly by that pipe track to the former Epping to Whittlesea Railway, thence north-easterly by that former railway to Gordons Road; thence easterly by that road to the south-eastern boundary of the City, and thence generally north-easterly, north-westerly, south-westerly and southerly by the city boundary to the point of commencement.

East Central Ward

Commencing on Plenty Road at the Metropolitan Ring Road, being a point on the southern boundary of the City; thence westerly by the Metropolitan Ring Road to Tasman Drive; thence northerly by that drive to Betula

Avenue; thence north-westerly and northerly by that avenue to McKimmies Road; thence westerly by that road to Dalton Road; thence northerly by that road to Darebin Drive; thence easterly and south-easterly by that drive to the W.A.Smith Reserve; thence easterly and generally northerly by the boundary of that reserve to the south-eastern angle of Lot 327 on Plan of Subdivision 88814; thence north-easterly by the south-eastern boundary of that lot and a line in continuation to the Darebin Creek; thence generally south-easterly by that creek to the Electricity Transmission Line; thence north-easterly by that Transmission Line to Childs Road; thence south-easterly by that road to Plenty Road, and thence southerly by that road to the point of commencement.

West Ward

Commencing on the Merri Creek at a point in line with O'Herns Road, being a point on the western boundary of the City; thence easterly by a line and O'Herns Road to Miller Street; thence southerly by that street to Cooper Street; thence easterly by that street to the former Epping to Whittlesea Railway, thence north-easterly by that former railway to the Darebin Creek; thence southerly by that creek to a point in line with the south-eastern boundary of Lot 327 on Plan of Subdivision 88814; thence south-westerly by a line to the most eastern angle of that lot, being a point on the western boundary of the W.A.Smith Reserve; thence generally southerly and westerly by that reserve to Darebin Drive; thence north-westerly and westerly by that drive to Curtin Avenue; thence westerly and south-westerly by that avenue to the northern part of Paschke Crescent; thence westerly by that crescent and a line in continuation to Kingsway Drive; thence westerly by that drive to Edgars Road; thence southerly by that road to Barry Road; thence westerly by that road and the northern boundary of allotment 24A, Parish of Keelbundora to the Merri Creek, being a point on the western boundary of the City, and thence north-westerly by the city boundary to the point of commencement.

North Central Ward

Commencing on O'Herns Road at Miller Street; thence southerly by Miller Street to Cooper Street; thence easterly by that street to the former Epping to Whittlesea Railway; thence north-easterly by that former railway to

McDonalds Road; thence westerly by that road to Civic Drive; thence north-westerly by that drive to Findon Road, and thence north-westerly and westerly by that road to the point of commencement.

East Ward

Commencing on Plenty Road at the Metropolitan Ring Road, being a point on the southern boundary of the City; thence northerly by Plenty Road to Childs Road; thence westerly and north-westerly by that road to Redleap Avenue; thence north-easterly by that avenue to Centenary Drive; thence westerly by that drive to the Yan Yean Pipe Track; thence north-easterly by that pipe track to the former Epping to Whittlesea Railway, thence north-easterly by that former railway to Gordons Road; thence easterly by that road to the south-eastern boundary of the City, and thence generally southerly and westerly by the city boundary to the point of commencement.

Local Government Act 1989

ALTERATION OF WARD BOUNDARIES OF YARRA RANGES SHIRE COUNCIL

Order in Council

The Governor in Council hereby directs that:

- a) Under Section 220S (1)(a) of the **Local Government Act 1989**, this Order comes into operation on the day it is published in the Government Gazette; and
- b) Under Section 220Q (k) of the **Local Government Act 1989**, on the day this Order comes into operation the boundaries of the wards of the Yarra Ranges Shire Council shall be fixed as described in the Schedule to this Order.

Dated 29 October 2002

Responsible Minister

BOB CAMERON MP

Minister for Local Government

HELEN DOYE

Clerk of the Executive Council

SCHEDULE

Boundaries of the Wards of Yarra Ranges Shire Council

Altered and Redefined

Chirnside Ward

Commencing on Brushy Creek at Bellara Drive being a point on the western boundary of the Shire; thence easterly by Bellara Drive and northerly by Manchester Road to Shadowplay

Road; thence easterly by that road, the northern boundary of Shadowplay Reserve, Turella Court, a line in continuation of that court and Bimbadeen Drive to the western boundary of Plan of Subdivision 349597; thence southerly and easterly by the western and southern boundaries of that plan of Subdivision to Mooroolbark Road; thence northerly by that road, Victoria Road and a line in continuation to the Yarra River; thence north-westerly and south-westerly by that river to the western boundary of the Shire, and thence generally south-westerly and south-easterly by the shire boundary to the point of commencement.

Walling Ward

Commencing on Canterbury Road at Liverpool Road being a point on the western boundary of the Shire; thence north-easterly by Canterbury Road and Mt. Dandenong Road to Stradbroke Road; thence southerly by that road to Currawong Road; thence south-easterly by that road to Sheffield Road; thence north-easterly by that road and Sheffield Road North to the boundary of the Dandenong Ranges National Park; thence northerly by that boundary to the southern boundary of Lot 2 on LP202800; thence westerly by that boundary and northerly by the eastern boundary of Lot 50 on LP94334 to The Boulevard; thence westerly by that boulevard to Swansea Road; thence north-easterly and northerly by that road to Olinda Creek; thence northerly by that creek to the Melbourne Water Pipe Track; thence south-westerly by that pipe track to Cardigan Road; thence westerly by that road to Dryden Concourse; thence southerly by that concourse and Holmes Road to Cambridge Road; thence north-westerly by that road to the western boundary of the Shire, and thence southerly and easterly by the shire boundary to the point of commencement.

Melba Ward

Commencing on Brushy Creek at Bellara Drive being a point on the western boundary of the Shire; thence easterly by Bellara Drive and northerly by Manchester Road to Shadowplay Road; thence easterly by that road, the northern boundary of Shadowplay Reserve, Turella Court, a line in continuation of that court and Bimbadeen Drive to the western boundary of Plan of Subdivision 349597; thence southerly and easterly by the western and southern

boundaries of that plan of Subdivision to Mooroolbark Road; thence northerly by that road and Victoria Road to Nelson Road; thence easterly by that road, a line in continuation and again Nelson Road to the disused railway east of Anderson Road; thence southerly by that disused railway to Maroondah Highway at Queen Road; thence south-easterly by Queen Road to Old Gippsland Road; thence westerly by that road and a line in continuation to Olinda Creek; thence south-easterly by that creek, the bed of that creek through the Lillydale Lake and further south-easterly and southerly by the Olinda Creek to the Melbourne Water Pipe Track; thence south-westerly by that pipe track to Cardigan Road; thence westerly by that road to Dryden Concourse; thence southerly by that concourse and Holmes Road to Cambridge Road; thence north-westerly by that road to the western boundary of the Shire, and thence north-westerly by the shire boundary to the point of commencement.

O'Shannassy Ward

Commencing on Cockatoo Creek at Shepherd Creek being a point on the south-eastern boundary of the Shire; thence north-westerly and northerly by Cockatoo Creek and northerly by Woori Yallock Creek to the Warburton Trail; thence south-easterly by that trail to Haggards Lane; thence north-easterly by that lane to the Yarra River; thence north-easterly by that river to a point in line with Timberline Road; thence northerly by a line and Timberline Road to Dalry Road; thence south-easterly by that road to the O'Shannassy Pipeline; thence north-easterly by that pipeline to Don Road; thence generally northerly by that road to a point east of Panton Gap on the north-western boundary of the former Shire of Upper Yarra; thence generally northerly and north-easterly by that former boundary to the northern boundary of the Shire of Yarra Ranges, and thence north-easterly, easterly, generally southerly and generally south-westerly by the shire boundary to the point of commencement.

Billanook Ward

Commencing on Victoria Road at Nelson Road; thence easterly by Nelson Road, a line in continuation and again Nelson Road to the disused railway east of Anderson Road; thence southerly by that disused railway to Maroondah

Highway at Queen Road; thence south-easterly by Queen Road to Old Gippsland Road; thence westerly by that road and a line in continuation to Olinda Creek; thence south-easterly by that creek, the bed of that creek through the Lillydale Lake and further south-easterly and southerly by the Olinda Creek to Swansea Road; thence southerly by that road to York Road; thence easterly by that road to the eastern boundary of Lot 19 on LP97549; thence southerly by that boundary, easterly by the northern boundary of Lots 40 and 39 on LP5699 and further easterly by Mountain Crescent to Inverness Road; thence southerly and north-easterly by that road to Wilkilla Road; thence easterly by a direct line to the junction of Hunter Road with the Lillydale-Monbulk Road; thence north-easterly by Hunter Road to McKillop Road; thence north-westerly by that road to Forest Road; thence northerly by that road and north-westerly and south-westerly by Bailey Road to Birch Drive; thence northerly by that drive to the Little Stringybark Creek; thence north-easterly by that creek to Victoria Road; thence south-easterly and north-easterly by that road to Maurice Road; thence northerly by that road and northerly and westerly by the eastern and northern boundaries of Lot 1 on PS423591 to the northern boundary of allotment 37, Parish of Gruyere; thence westerly by that boundary to Boundary Road; thence northerly by that road to Ingram Road; thence westerly by that road and the northern boundary of crown sections 24 and 23, Parish of Yering to Victoria Road, and thence southerly by that road to the point of commencement.

Chandler Ward

Commencing on the Emerald-Monbulk Road at Stewart Road being a point on the boundary of the Shire; thence northerly and westerly by the Emerald-Monbulk Road to Rankins Road; thence north-westerly by that road to Gerber Road; thence westerly by that road to the Sassafras Creek; thence north-westerly and generally westerly by that creek to Perrins Creek; thence northerly by that creek to the Olinda-Monbulk Road; thence north-westerly and westerly by that road to The Georgian Way; thence northerly by that way and Falls Road to Ridge Road; thence north-easterly by that road and Mt Dandenong Tourist Road to Old Coach Road; thence northerly by that road and north-easterly by Jasper Road to the north-eastern

boundary of Lot 40 on LP6176; thence north-westerly by that boundary and south-westerly by Thompsons Road to the eastern boundary of allotment 2002, Parish of Mooroolbark; thence northerly by that boundary and north-westerly by the southern boundary of Lot 4 on LP9536 to Mt. Dandenong Tourist Road; thence westerly by that road to Sheffield Road North; thence north-easterly by that road to the boundary of the Dandenong Ranges National Park; thence northerly by that boundary to the southern boundary of Lot 2 on LP202800; thence westerly by that boundary and northerly by the eastern boundary of Lot 50 on LP94334 to The Boulevard; thence westerly by that boulevard to Swansea Road; thence north-easterly and northerly by that road to York Road; thence easterly by York Road to the eastern boundary of Lot 19 on LP97549; thence southerly by that boundary, easterly by the northern boundary of Lots 40 and 39 on LP5699 and further easterly by Mountain Crescent to Inverness Road; thence southerly and north-easterly by that road to Wilkilla Road; thence easterly by a direct line to the junction of Hunter Road with the Lilydale–Monbulk Road; thence north-easterly by Hunter Road to McKillop Road; thence north-westerly by that road to Forest Road; thence northerly by that road and north-westerly and south-westerly by Bailey Road to Birch Drive; thence northerly by that drive to the Little Stringybark Creek; thence north-easterly by that creek to Victoria Road; thence south-easterly and easterly by that road to a point in line with Howard Street; thence southerly by a line towards Howard Street to Wild Cattle Creek; thence easterly by that creek and north-easterly by Wandin Yallock Creek to Victoria Road; thence easterly by that road to the Warburton Trail; thence north-easterly by that trail to an unnamed creek west of the north-western boundary of Lot 1 on Plan of Subdivision 111939; thence south-easterly by that creek running through Lot 1 to Victoria Road; thence easterly by that road and further easterly by the southern boundary of the Parish of Gruyere to the Woori Yallock Creek; thence southerly by that creek to Cockatoo Creek; thence generally southerly by that creek to Merritts Road being a point on the boundary of the Shire, and thence westerly, southerly and again westerly by the shire boundary to the point of commencement.

Ryrie Ward

Commencing on the Yarra River at a point in line with Victoria Road; thence southerly by a line and Victoria Road to the northern boundary of crown section 23, Parish of Yering; thence easterly by that boundary, the northern boundary of crown section 24 and Ingram Road to Boundary Road; thence southerly by that road to the northern boundary of allotment 37, Parish of Gruyere; thence easterly by that road, easterly and southerly by the northern and eastern boundaries of Lot 1 on PS423591 and further southerly by Maurice Road to Victoria Road; thence easterly by that road to a point in line with Howard Street; thence southerly by a line towards Howard Street to Wild Cattle Creek; thence easterly by that creek and north-easterly by Wandin Yallock Creek to Victoria Road; thence easterly by that road to the Warburton Trail; thence north-easterly by that trail to an unnamed creek west of the north-western boundary of Lot 1 on Plan of Subdivision 111939; thence south-easterly by that creek running through Lot 1 to Victoria Road; thence easterly by that road and further easterly by the southern boundary of the Parish of Gruyere to the Woori Yallock Creek; thence northerly by that creek to the Warburton Trail; thence south-easterly by that trail to Haggards Lane; thence north-easterly by that lane to the Yarra River; thence north-easterly by that river to a point in line with Timberline Road; thence northerly by a line and Timberline Road to Dalry Road; thence south-easterly by that road to the O'Shannassy Pipeline; thence north-easterly by that pipeline to Don Road; thence generally northerly by that road to a point east of Panton Gap on the north-western boundary of the former Shire of Upper Yarra; thence generally northerly and north-easterly by that former boundary to the northern boundary of the Shire of Yarra Ranges, and thence generally north-westerly and southerly by the shire boundary to the point of commencement.

Lyster Ward

Commencing on Glenfern Road at New Road being a point on the western boundary of the Shire; thence south-easterly by Glenfern Road to the western boundary of Lot 16 on LP 54338; thence southerly by that boundary, easterly by the southern boundaries of Lots 16, 17, 18, 19, 20 and northerly by the eastern

boundary of the later lot to Glenfern Road; thence easterly by that road to the western boundary of Lot 21; thence southerly by that boundary and easterly by the southern boundaries of Lots 21, 22, 23, 24, 25 and 26 to the western boundary of Lot 2 on LP84793; thence southerly, easterly and northerly by that lot to the southern boundary of Lot 1 on LP 143827; thence north-easterly, south-easterly, north-easterly and again south-easterly by the northern boundary of land on CP156269 to Toorac Road; thence north-easterly by that road to the southern boundary of Lot 38 on LP8833; thence easterly by that boundary to the western boundary of CP160840; thence northerly by that boundary and a line in continuation to the most southern angle of Lot 34 on LP13052; thence north-easterly by the south-eastern boundaries of Lots 34 to 19 and westerly by the northern boundary of the later lot to the eastern boundary of Lot 18 on LP12419; thence northerly by the rear boundaries of properties at 30, 28, 26, 24, 22, 20, 18, 16, 14, 12, 10, 8, and 4 Centre Road Upwey and further northerly by the rear boundaries of properties at 37, 35, 33, 31, 29, 27, 25, 23, 21, 19, 17, 15, 13, 11, 9, 7, 5, 3, and 1 Fairy Dell Road Tecoma to Clifford Road; thence westerly by that road and northerly by Glenfern Road to the Burwood Highway; thence easterly by that highway to Sophia Grove; thence northerly by that grove to Hakea Street; thence westerly and northerly by that street and further northerly by Pauline Avenue to Tinto Grove; thence westerly by that grove to Acacia Avenue; thence westerly and northerly by that avenue to Blackwood Street; thence easterly by that street to Myrtle Grove; thence northerly by that grove to Cecil Court; thence easterly by that court and a line in continuation to the Ferny Creek; thence northerly by that creek to a point in line with the southern boundary of CP171037; thence easterly by a line, the southern boundary of that CP171037 and further easterly by a line in continuation to Moore Break Track; thence generally northerly by that track to the Mt. Dandenong Tourist Road; thence northerly by that road to Sherbrooke Road; thence generally easterly by that road to Nobles Lane; thence north-easterly by that lane and a line in continuation to Sassafras Creek; thence generally easterly by that creek to a point in line with Gerber Road; thence easterly by a line and Gerber Road to Rankins Road; thence

southerly by that road to the Emerald–Monbulk Road; thence north-easterly and south-easterly by that road to the boundary of the Shire at Stewart Road, and thence generally south-westerly, westerly and northerly by the shire boundary to the point of commencement.

Streeton Ward

Commencing on Glenfern Road at New Road being a point on the western boundary of the Shire; thence south-easterly by Glenfern Road to the western boundary of Lot 16 on LP54338; thence southerly by that boundary, easterly by the southern boundaries of Lots 16, 17, 18, 19, 20 and northerly by the eastern boundary of the later lot to Glenfern Road; thence easterly by that road to the western boundary of Lot 21; thence southerly by that boundary and easterly by the southern boundaries of Lots 21, 22, 23, 24, 25 and 26 to the western boundary of Lot 2 on LP84793; thence southerly, easterly and northerly by that lot to the southern boundary of Lot 1 on LP143827; thence north-easterly, south-easterly, north-easterly and again south-easterly by the northern boundary of land on CP156269 to Toorac Road; thence north-easterly by that road to the southern boundary of Lot 38 on LP8833; thence easterly by that boundary to the western boundary of CP160840; thence northerly by that boundary and a line in continuation to the most southern angle of Lot 34 on LP13052; thence north-easterly by the south-eastern boundaries of Lots 34 to 19 and westerly by the northern boundary of the later lot to the eastern boundary of Lot 18 on LP12419; thence northerly by the rear boundaries of properties at 30, 28, 26, 24, 22, 20, 18, 16, 14, 12, 10, 8, and 4 Centre Road, Upwey and further northerly by the rear boundaries of properties at 37, 35, 33, 31, 29, 27, 25, 23, 21, 19, 17, 15, 13, 11, 9, 7, 5, 3, and 1 Fairy Dell Road, Tecoma to Clifford Road; thence westerly by that road and northerly by Glenfern Road to the Burwood Highway; thence easterly by that highway to Sophia Grove; thence northerly by that grove to Hakea Street; thence westerly and northerly by that street and further northerly by Pauline Avenue to Tinto Grove; thence westerly by that grove to Acacia Avenue; thence westerly and northerly by that avenue to Blackwood Street; thence easterly by that street to Myrtle Grove; thence northerly by that grove to Cecil Court; thence easterly by that court and a line in continuation to the Ferny Creek; thence northerly by that creek to a point in line with the southern boundary of CP171037;

thence easterly by a line, the southern boundary of that CP171037 and further easterly by a line in continuation to Moore Break Track; thence generally northerly by that track to the Mt. Dandenong Tourist Road; thence northerly by that road to Sherbrooke Road; thence generally easterly by that road to Nobles Lane; thence north-easterly by that lane and a line in continuation to Sassafras Creek; thence generally easterly by that creek to Perrins Creek; thence northerly by that creek to the Olinda–Monbulk Road; thence north-westerly and westerly by that road to The Georgian Way; thence northerly by that way and Falls Road to Ridge Road; thence north-easterly by that road and the Mt. Dandenong Tourist Road to Old Coach Road; thence northerly by that road and north-easterly by Jasper Road to the north-eastern boundary of Lot 40 on LP6176; thence north-westerly by that boundary and south-westerly by Thompsons Road to the eastern boundary of allotment 2002 Parish of Mooroolbark; thence northerly by that boundary and north-westerly by the southern boundary of Lot 4 on LP9536 to the Mt. Dandenong Tourist Road; thence westerly by that road to Sheffield Road; thence south-westerly by that road to Currawong Road; thence north-westerly by that road and northerly by Stradbroke Road to Canterbury Road; thence south-westerly by that road to the western boundary of the Shire, and thence generally southerly by the shire boundary to the point of commencement.

Catchment and Land Protection Act 1994

ABOLITION OF THE PORT PHILLIP CATCHMENT AND LAND PROTECTION REGION AND DETERMINATION OF THE PORT PHILLIP AND WESTERNPORT CATCHMENT AND LAND PROTECTION REGION AND THE DEFINITION OF ITS BOUNDARIES

Order in Council

The Governor in Council, under Section 10(1) of the **Catchment and Land Protection Act 1994** and on the recommendation of the Minister for Environment and Conservation:

1. abolishes the catchment and land protection region known as Port Phillip Catchment and Land Protection Region determined by Order of the Governor-in-Council dated 29 November 1994 and published in the Government Gazette on 1 December 1994;
2. determines that the area within Victoria delineated in heavy black on plan numbered S-1525/1 contained in the Schedule to this Order, the original of which is held at Head Office of the Department of Natural Resources and Environment, and a true copy of which is held at the Central Plan Office, is a catchment and land protection region to be known as the Port Phillip and Westernport Catchment and Land Protection Region, and
3. defines the boundaries of the Port Phillip and Westernport Catchment and Land Protection Region, as follows:
 - (i) by heavy black delineation on Plan S-1525/1; and
 - (ii) where any boundary is formed by a roadway reserve, the boundary is situated in the centre of the road for the time being on that roadway reserve.

Dated 29 October 2002

Responsible Minister:

SHERRYL GARBUTT

Minister for Environment and Conservation

HELEN DOYE
Clerk of the Executive Council

Catchment and Land Protection Act 1994

ABOLITION OF THE PORT PHILLIP CATCHMENT AND LAND PROTECTION REGION AND DETERMINATION OF THE PORT PHILLIP AND WESTERNPORT CATCHMENT AND LAND PROTECTION REGION AND THE DEFINITION OF ITS BOUNDARIES

SCHEDULE TO THE ORDER IN COUNCIL

Port Phillip and Westernport Catchment and Land Protection Region – Plan S-1525/1

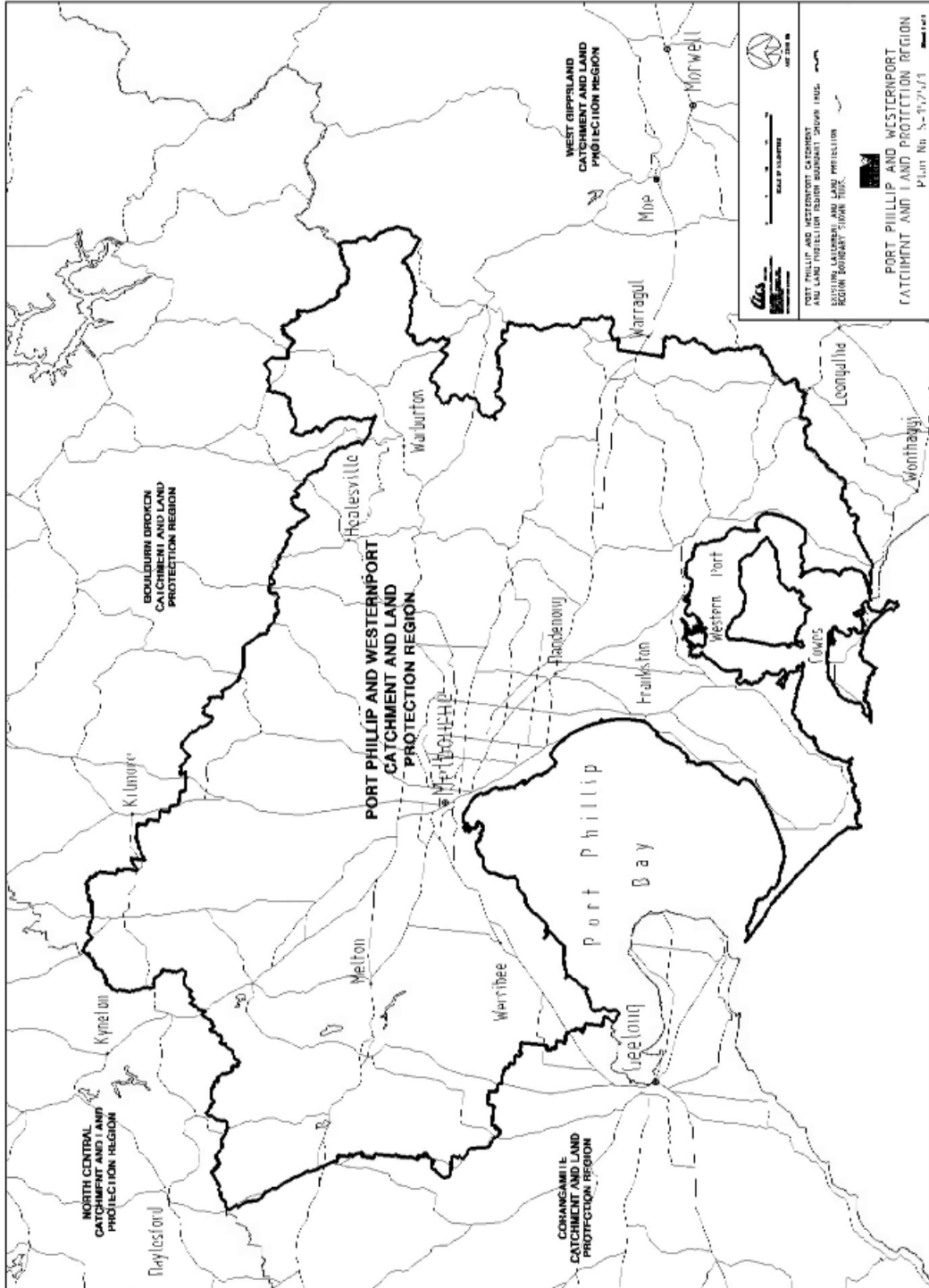

**SUBORDINATE LEGISLATION ACT 1994
NOTICE OF MAKING OF STATUTORY
RULES**

Notice is hereby given under Section 17 (2) of the **Subordinate Legislation Act 1994** of the making of the following Statutory Rules:

- | | | | |
|-----------------------------|---|-----------------------------|---|
| 105. <i>Statutory Rule:</i> | Magistrates' Court General (Further Infringement) Regulations 2002 | 111. <i>Statutory Rule:</i> | Fire Services (Amendment) Regulations 2002 |
| <i>Authorising Act:</i> | Magistrates' Court Act 1989 | <i>Authorising Act:</i> | Metropolitan Fire Brigades Act 1958
Country Fire Authority Act 1958 |
| <i>Date of making:</i> | 29 October 2002 | <i>Date of making:</i> | 29 October 2002 |
| 106. <i>Statutory Rule:</i> | Fundraising Appeals (Renewals) Regulations 2002 | 112. <i>Statutory Rule:</i> | Trade Measurement (Fuel Measurement) Regulations 2002 |
| <i>Authorising Act:</i> | Fundraising Appeals Act 1998 | <i>Authorising Act:</i> | Trade Measurement Act 1995
Trade Measurement (Administration) Act 1995 |
| <i>Date of making:</i> | 29 October 2002 | <i>Date of making:</i> | 29 October 2002 |
| 107. <i>Statutory Rule:</i> | Wildlife (Whales) (Amendment) Regulations 2002 | 113. <i>Statutory Rule:</i> | Road Safety (Vehicles) (Amendment) Regulations 2002 |
| <i>Authorising Act:</i> | Wildlife Act 1975 | <i>Authorising Act:</i> | Road Safety Act 1986 |
| <i>Date of making:</i> | 29 October 2002 | <i>Date of making:</i> | 29 October 2002 |
| 108. <i>Statutory Rule:</i> | National Parks (Point Hicks Marine National Park) Regulations 2002 | 114. <i>Statutory Rule:</i> | Road Safety (General) (Responsible Driving) Regulations 2002 |
| <i>Authorising Act:</i> | National Parks Act 1975 | <i>Authorising Act:</i> | Road Safety Act 1986 |
| <i>Date of making:</i> | 29 October 2002 | <i>Date of making:</i> | 29 October 2002 |
| 109. <i>Statutory Rule:</i> | Gaming Machine Control (Responsible Gambling Information) (Amendment) Regulations 2002 | 115. <i>Statutory Rule:</i> | Road Safety (Drivers) (Demerit Points) Regulations 2002 |
| <i>Authorising Act:</i> | Gaming Machine Control Act 1991 | <i>Authorising Act:</i> | Road Safety Act 1986 |
| <i>Date of making:</i> | 29 October 2002 | <i>Date of making:</i> | 29 October 2002 |
| 110. <i>Statutory Rule:</i> | Subordinate Legislation (Country Fire Authority Regulations 1992 – Extension of Operation) Regulations 2002 | 116. <i>Statutory Rule:</i> | Road Safety (Road Rules) (Speeding Offences) Regulations 2002 |
| <i>Authorising Act:</i> | Subordinate Legislation Act 1994 | <i>Authorising Act:</i> | Road Safety Act 1986 |
| <i>Date of making:</i> | 29 October 2002 | <i>Date of making:</i> | 29 October 2002 |

**SUBORDINATE LEGISLATION ACT 1994
NOTICE THAT STATUTORY RULES ARE
OBTAINABLE**

Notice is hereby given under Section 17 (3) of the **Subordinate Legislation Act 1994** that the following Statutory Rules were first obtainable from Information Victoria, 356 Collins Street, Melbourne on the date specified:

- | | | | | | | | |
|-----------------------------|---|-------------------------|--|-------------------------------|-----------------|---------------|--|
| 96. <i>Statutory Rule:</i> | Magistrates' Court
General (Further
Amendment)
Regulations 2002 | <i>Authorising Act:</i> | Magistrates' Court
Act 1989 | <i>Date first obtainable:</i> | 31 October 2002 | <i>Code A</i> | |
| 97. <i>Statutory Rule:</i> | Health (Pest
Control)
Regulations 2002 | <i>Authorising Act:</i> | Health Act 1958 | <i>Date first obtainable:</i> | 31 October 2002 | <i>Code A</i> | |
| 98. <i>Statutory Rule:</i> | Fair Trading
(Safety Standard)
(Bunk Beds)
Regulations 2002 | <i>Authorising Act:</i> | Fair Trading Act
1999 | <i>Date first obtainable:</i> | 31 October 2002 | <i>Code A</i> | |
| 99. <i>Statutory Rule:</i> | Mineral Resources
Development
Regulations 2002 | <i>Authorising Act:</i> | Mineral Resources
Development Act
1990 | <i>Date first obtainable:</i> | 31 October 2002 | <i>Code D</i> | |
| 100. <i>Statutory Rule:</i> | Subordinate
Legislation
(Forests (Diseases
of Trees)
Regulations 1992 –
Extension of
Operation)
Regulations 2002 | <i>Authorising Act:</i> | Subordinate
Legislation Act
1994 | <i>Date first obtainable:</i> | 31 October 2002 | <i>Code A</i> | |
| | | <i>Authorising Act:</i> | Subordinate
Legislation Act
1994 | <i>Date first obtainable:</i> | 31 October 2002 | <i>Code A</i> | |
| | | <i>Authorising Act:</i> | Subordinate
Legislation Act
1994 | <i>Date first obtainable:</i> | 31 October 2002 | <i>Code A</i> | |
| | | <i>Authorising Act:</i> | Subordinate
Legislation Act
1994 | <i>Date first obtainable:</i> | 31 October 2002 | <i>Code A</i> | |
| | | <i>Authorising Act:</i> | Subordinate
Legislation Act
1991 | <i>Date first obtainable:</i> | 31 October 2002 | <i>Code A</i> | |
| | | <i>Authorising Act:</i> | Occupational
Health and Safety
(Mines)
Regulations 2002 | <i>Date first obtainable:</i> | 31 October 2002 | <i>Code D</i> | |

As from 1 April 2002, the pricing structure for the Victoria Government Gazette and Victorian Government Legislation will be as follows.

Retail price will vary according to the number of pages in each special or periodical gazette. The table below sets out the prices that apply.

<i>Price Code</i>	<i>No. of Pages (Including cover and blank pages)</i>	<i>Price*</i>
A	1–16	\$3.65
B	17–32	\$5.40
C	33–48	\$7.40
D	49–96	\$11.50
E	97–144	\$14.85
F	145–192	\$17.55
G	193–240	\$20.25
H	241–288	\$21.55
I	289–352	\$24.25
J	353–416	\$28.35
K	417–480	\$32.35
L	481–544	\$37.75
M	545–608	\$43.15
N	609–672	\$48.55
O	673–736	\$53.90
P	737–800	\$59.30

**All Prices Include GST*

ADVERTISERS PLEASE NOTE

As from 31 October 2002

The last Special Gazette was No. 199 dated 30 October 2002

The last Periodical Gazette was No. 1 dated 4 June 2002

This page left blank intentionally

CONTENTS

	Page
Estates of Deceased Persons	2900
Government and Outer Budget Sector	
Agencies Notices	2907
Orders in Council	2934
Acts — Crown Land (Reserves); Project Development and Construction Management; Local Government; Interpretation of Legislation; Catchment and Land Protection	
Private Advertisements	2900
Proclamations	2906

The Victoria Government Gazette is published by The Craftsman Press Pty. Ltd. with the authority of the Government Printer for the State of Victoria
© State of Victoria 2002

ISSN 0819-5471

This publication is copyright. No parts may be reproduced by any process except in accordance with the provisions of the Copyright Act.

Products and services advertised in this publication are not endorsed by The Craftsman Press Pty. Ltd. or the State of Victoria and neither of them accepts any responsibility for the content or the quality of reproduction. The Craftsman Press Pty. Ltd. reserves the right to reject any advertising material it considers unsuitable for government publication.

Address all enquiries to the Government Printer for the State of Victoria
Government Information and Communications Branch
Department of Premier and Cabinet
Level 3, 356 Collins Street
Melbourne 3000
Victoria Australia

RETAIL SALES

Information Victoria Bookshop
356 Collins Street Melbourne 3000.
Telephone enquiries 1300 366 356

City Graphics
Level 1, 520 Bourke Street
Melbourne 3000
Telephone enquiries (03) 9600 0977

Recommended Retail Price \$1.85 (includes GST)

Government and Outer Budget Sector Agencies please note:
STYLE REQUIREMENTS.

To ensure that material received can be reproduced, and that errors are minimised, the following guidelines are to be observed when submitting material by fax.

Fax resolution:

Material sent by fax should be transmitted using Fine Resolution (200 dots per inch by 200 dpi).

Font size:

Use 12 point (10 pitch) or larger.

Font Style:

Clear plain font styles, such as Helvetica, should be used.

Graphics:

Line drawings should be transmitted as large as possible to ensure clarity. Drawings up to A4 size sent by fax using Fine Resolution provide a good quality for reproduction.

Avoid:

Italics, underlining and full justification.

Ensure document is square when sending as documents that are sent skewed are difficult to read and process.

ISSN 0819-5471



9 770819 549472