



Victoria Government Gazette

No. G 12 Thursday 21 March 2002

GENERAL

GENERAL AND PERIODICAL GAZETTE

Copy to: Gazette Officer
The Craftsman Press Pty. Ltd.
125 Highbury Road,
Burwood Vic 3125
Telephone: (03) 9926 1233
Facsimile: (03) 9926 1292
DX: 32510 Burwood
Email: gazette@craftpress.com.au

Advertising Rates and Payment

All prices include GST

Private Notices

Payment must be received in advance with advertisement details.

33 cents per word – Full page \$198.00.

Additional costs must be included in prepayment if a copy of the gazette is required. Copy Prices – Page

\$1.65 – Gazette \$3.52 – Certified copy of Gazette \$3.85 (all prices include postage). *Cheques should be made payable to The Craftsman Press Pty. Ltd.*

Government and Outer Budget Sector Agencies Notices

Not required to prepay.

Advertisements may be faxed or sent via email with a cover sheet, marked to the attention of the Gazette Officer.

Floppy Disks (Mac & PC) can also be accepted.

Costs can be calculated on the following basis:

Per Line	Typeset
Single column	\$1.71
Double column	\$3.41
Full Page	\$71.28

The Craftsman Press is pleased to offer a series of discounts from the typesetting costs.

1. Copy supplied on disk.
2. Copy supplied via email.
3. Artwork for forms and other material which require exact reproduction.

1. Copy supplied on disk.

Where a disk is supplied and there is minimum alteration required, **30% off.**

Where a disk is supplied requiring extraneous matter stripped out and styles applied, **20% off.**

2. Copy supplied via email.

Where a notice is sent via email and there is minimum alteration required, **25% off.**

Where email is supplied requiring extraneous matter stripped out and styles applied, **15% off.**

3. Artwork for forms and other material which requires exact reproduction.

Scanning and sizing of artwork for forms, to be reproduced in page format, **35% off.**

Copy Deadline for General Gazette

9.30 a.m. Monday – (Private Notices)

9.30 a.m. Tuesday – (Government and Outer Budget Sector Agencies Notices)

Advertisers should note:

- Late copy received at The Craftsman Press Pty. Ltd. after deadlines will be placed in the following issue of VGG, irrespective of any date/s mentioned in the copy (unless otherwise advised).
- Late withdrawal of advertisements (after client approval, before printing) will incur 50 per cent of the full advertising rate to cover typesetting, layout and proofreading costs.
- Proofs will be supplied only when requested or at the direction of the Gazette Officer.
- No additions or amendments to material for publications will be accepted by telephone.
- Orders in Council may be lodged prior to receiving assent with the Governor's or Clerk's signature. They will only be published once approved and signed.
- Accounts over 90 days will be issued with a letter of demand.
- Government and Outer Budget Sector Agencies please note: *See style requirements on back page.*

SPECIAL GAZETTES

Copy to: Gazette Officer
The Craftsman Press Pty. Ltd.
125 Highbury Road
Burwood Vic 3125
Telephone: (03) 9926 1233
Facsimile: (03) 9926 1292
Email: gazette@craftpress.com.au

Advertising Rates and Payment

Private Notices

Full Page \$396.00

Payment must be received in advance with notice details.

Government and Outer Budget Sector Agencies Notices

	Typeset
Full Page	\$96.25

Note:

The after hours number for Special Gazettes is:
Telephone: 0419 327 321

SUBSCRIPTIONS AND RETAIL SALES

Copies of the *Victoria Government Gazette* can be purchased from The Craftsman Press Pty. Ltd. by subscription.

The *Victoria Government Gazette*

General and Special – \$187.00 each year

General, Special and Periodical – \$249.70 each year

Periodical – \$124.30 each year

Subscriptions are payable in advance and accepted for a period of one year. All subscriptions are on a firm basis and refunds will not be given.

All payments should be made payable to The Craftsman Press Pty. Ltd.

Subscription enquiries:

The Craftsman Press Pty. Ltd.
125 Highbury Road, Burwood Vic 3125
Telephone: (03) 9926 1233

INDEX TO PRIVATE ADVERTISERS

A

Aitken Walker & Strachan498
 Andrew G. J. Rowan498

B

Bruce M. Cook & Associates498

E

E. P. Johnson & Davies498

F

Findlay Arthur Phillips498

G

G. W. H. Chambers498

J

James Hopper499

K

Kahns499

Kelly & Chapman499

M

Michael Rickards499

Mitchell, McKenzie & Co.499

P

Peitrzak Solicitors499

Petersen Westbrook Cameron500

T

Trust Company of Australia500

V

Verna A. Cook500

W

Wills & Probate Victoria500

**PUBLICATION OF THE VICTORIA GOVERNMENT GAZETTE (GENERAL)
EASTER HOLIDAYS**

Please Note:

The Victoria Government Gazette for Easter week will be published on Thursday 4 April 2002.

Copy deadlines:

Private Advertisements **9.30am on Thursday 28 March 2002.**

Government and Outer

Budget Sector Agencies Notices **9.30am on Tuesday 2 April 2002.**

Where urgent gazettal is required after hours, arrangements should be made with the Government Gazette Officer on 0419 327 321.

JENNY NOAKES
Government Gazette Officer

PRIVATE ADVERTISEMENTS

DISSOLUTION OF PARTNERSHIP

Take notice that the partnership which formerly existed between Everton Ridge Pty Ltd and Empire Waters Pty Ltd in the conduct of the business "Tuscany Hair" has been amicably dissolved effective from 25 January 2002.

ROBERTS PARTNERS, solicitors, Morningson.

PAMELA JOY JONES, late of 2 Wilela Court, Noble Park, retired, deceased. Creditors, next-of-kin and others having claims in respect of the estate of the deceased, who died on 2 September 2001, are required by the personal representatives, Trust Company of Australia Limited of 151 Rathdowne Street, Carlton South, to send particulars to them care of the undermentioned solicitors by 22 May 2002 after which date the personal representatives may convey or distribute the assets having regard only to the claims of which they then have notice.

AITKEN WALKER & STRACHAN, solicitors, 114 William Street, Melbourne 3000.

CORNELIUS TWOMEY, late of 27 Underwood Road, Boronia, retired, deceased. Creditors, next-of-kin and others having claims in respect of the estate of the deceased, who died on 17 December 2001, are required by Equity Trustees Limited, ACN 004 031 298, the proving executor of the will of the deceased, to send particulars of their claims to the executor in the care of the undermentioned solicitor by 22 May 2002 after which date the executor may convey or distribute the assets having regard only to the claims of which it then has notice.

ANDREW G. J. ROWAN, solicitor, Level 4, 472 Bourke Street, Melbourne 3000.

Re: Estate BRIAN ROBERT CARL TISCHER, deceased. Creditors, next-of-kin or others having claims in respect of the estate of BRIAN ROBERT CARL TISCHER of Winifred Street, Essendon, in the State of Victoria, who died on 10 December 2001, are to send particulars of their claims to the personal representative/s care of the undermentioned solicitors by 22 May 2002 after which date the

personal representative/s will distribute the assets having regard only to the claims of which they then have notice.

BRUCE M. COOK & ASSOCIATES,
barristers & solicitors,
Level 19, AMP Tower,
535 Bourke Street, Melbourne, Vic. 3000.

Re: DOROTHY GLADYS FLORENCE REINHOLTZ, deceased. Creditors, next-of-kin and others having claims in respect of the estate of DOROTHY GLADYS FLORENCE REINHOLTZ, late of Inala Senior Citizens' Village, 220 Middleborough Road, Blackburn South, but formerly of 42 Coburg Street, Coburg, Victoria, retired Salvation Army Officer, deceased, who died on 24 September 2001, are to send particulars of their claims to the executor care of the undermentioned solicitors by 31 May 2002 after which date the executor will distribute the assets having regard only to the claims of which the executor then has notice.

E. P. JOHNSON & DAVIES, solicitors,
30 Collins Street, Melbourne 3000.

Re: ALAN BROMLEY WYATT, deceased. Creditors, next-of-kin and others having claims in respect of the estate of ALAN BROMLEY WYATT of 12 Yendon Road, Glenhuntly, Victoria 3163, who died on 25 April 1995, are required by Esther May Wyatt, the executrix of the estate of the deceased, to send particulars of their claims to the said executrix care of the undermentioned solicitors by 20 May 2002 after which date she will distribute the assets of the estate having regard only to the claims of which she then has notice.

FINDLAY ARTHUR PHILLIPS, solicitors,
Suite 9, Level 3,
620 Chapel Street, South Yarra, Victoria.

HAROLD EDWIN WOODWARD, late of 3/9 Elman Road, Cheltenham. Creditors, next-of-kin and others having claims in respect of the estate of the deceased, who died on 4 February 2002, are required by the trustee, care of G.W.H. Chambers, solicitor of 338 Charman Road, Cheltenham, to send

particulars to him by 22 May 2002 after which date the trustee may convey or distribute the assets, having regard only to the claims of which they then have notice.

G.W.H. CHAMBERS, solicitor,
338 Charman Road, Cheltenham 3192.

MARGARET WINIFRED LEACH, late of Unit 3, 9 Highfield Road, Canterbury, widow, deceased. Creditors, next-of-kin and others having claims in respect of the estate of the abovenamed deceased, who died on 29 November 2001, are required to send particulars of their claims to the executors, Joyce Mary Maddock and Peter John Mackenzie, care of the undernoted solicitor by 28 May 2002 after which date they will convey or distribute the assets having regard only to the claims of which they then have notice.

JAMES HOPPER, solicitor,
409 Whitehorse Road, Balwyn.

SYDNEY MORGAN, late of 88 Cunningham Street, Northcote, furrier, deceased. Creditors, next-of-kin and others having claims in respect of the estate of the deceased, who died on 5 December 2001, are required by Janice Leila Epstein, one of the executors of the will, the other named executor having predeceased the deceased, of the deceased to send particulars of their claim to her care of the undermentioned solicitors by 21 May 2002 after which date she will convey or distribute the assets having regard only to the claims of which she then has notice.

KAHNS, lawyers,
Level 9, 501 Latrobe Street, Melbourne 3000.

Creditors, next-of-kin and others having claims in respect of the estate of PAMELA JOY WARREN, deceased, late of 58 Cochrane Street, Brighton, Victoria, married woman, who died on 20 November 2001, are required by Marie Jane Harrington of 13 Aileen Avenue, South Caulfield, Victoria, mothercraft nurse, who is applying to the Supreme Court for a Grant of Probate of the deceased's last Will and Testament dated 24 June 1994 and the first and only Codicil thereto dated 27 September 1999, to send particulars of such claims to Messrs Kelly & Chapman of 437 Centre Road,

Bentleigh, Victoria, the solicitors acting for the said executor by 28 May 2002 after which date the said executor may convey or distribute the assets of the deceased, having regard only to the claims of which the executor or her solicitors then have notice.

KELLY & CHAPMAN solicitors,
solicitors for the executor,
437 Centre Road, Bentleigh 3204.

Re: LEAH CONWAY, late of 12 Burns Street, Elwood, Victoria, widow, deceased. Creditors, next-of-kin and others having claims in respect of the estate of the abovenamed deceased, who died on 1 December 2001, are required by Alfred Ernest Langford and Arthur Edward Cutler, the personal representatives of the said deceased, to send particulars of their claims to them care of their undermentioned solicitor by 25 May 2002 after which date they will convey or distribute the assets of the said deceased, having regard only to the claims of which they then have notice.

MICHAEL RICKARDS, solicitor,
for the abovenamed personal representatives,
731 Glenhuntly Road, Caulfield South, Vic. 3162.

Re: NANCY THOMAS, deceased. Creditors, next-of-kin or others having claims in respect of the estate of NANCY THOMAS, late of "Sandy Camp", Stratton Road, Echuca, Victoria, retired farmer, deceased, who died on 30 August 2000, are to send particulars of their claims to the executors care of the undermentioned solicitors by 11 June 2002 after which date the executors will distribute the assets having regard only to the claims of which the executors then have notice.

MITCHELL, McKENZIE & CO., solicitors,
51-55 Heygarth Street, Echuca.

Creditors, next-of-kin and others having claims in respect of the estate of DORA MANSON STANLEY, late of Unit 117, Cumberland View, Whalley Drive, Wheelers Hill, in the State of Victoria, widow, deceased, who died on 5 January 2002, are required to send particulars of such claims to the administrator care of the undermentioned solicitors by 21 May 2002 after which date the administrator will convey or distribute the assets

having regard only to the claims of which the administrator then has notice.

PEITRZAK SOLICITORS,
222 Latrobe Street, Melbourne.

AREND VAN DE WETERING, late of Old Boort Road, Wedderburn. Creditors, next-of-kin and others having claims in respect of the estate of the deceased, who died on 16 December 2001, are requested to send particulars of their claims to the executor, Stephen Mark Brooks, care of the undermentioned legal practitioners by 20 May 2002 after which date he will distribute the assets having regard only to the claims of which he then has notice.

PETERSEN WESTBROOK CAMERON,
legal practitioners,
121 McCrae Street, Bendigo 3550.

THOMAS CHARLES WILSON, late of 777 High Street Road, Glen Waverley, in the State of Victoria, retired administration manager, deceased. Creditors, next-of-kin and others having claims in respect of the estate of the deceased, who died on 25 August 2001, are required by Trust Company of Australia Limited of 151 Rathdowne Street, South Carlton, Victoria, one of the executors, to send particulars to it by 28 May 2002 after which date the executors may convey or distribute the assets having regard only to the claims of which they then have notice.

TRUST COMPANY OF AUSTRALIA LTD,
151 Rathdowne Street, South Carlton.

MURIEL ISOBEL CANT, deceased. Creditors, next-of-kin and others having claims against the estate of MURIEL ISOBEL CANT, late of 54/80 Outer Crescent, Brighton, Victoria, retired, deceased, who died on 2 November 2001, are required to send particulars of their claims to the executors care of the undermentioned solicitor by 20 May 2002 after which date the executors will proceed to distribute the assets having regard only to the claims of which they shall then have notice.

VERNA A COOK, solicitor,
5/8 St. Andrews Street, Brighton 3186.

Re: RUDOLF GRUENHUT, late of 1197 Mount Dandenong Tourist Road, Kalorama, Victoria. Creditors, next-of-kin and others having claims in respect of the estate of the deceased, who died on 4 December 2001, are required to send particulars of their claims to the executor C/- Wills & Probate Victoria – lawyers, PO Box 1946R Melbourne, Victoria 3000 by 14 June 2002 after which date the executor may convey or distribute the assets having regard only to the claims of which she then has notice.

WILLS & PROBATE VICTORIA – lawyers,
Level 5, 360 Little Bourke Street, Melbourne.

In the Supreme Court of the State of Victoria
SALE BY THE SHERIFF

On Wednesday 24 April 2002 at 2.30 p.m. at the Sheriff's Office, 8-20 King Street, Oakleigh, (unless process be stayed or satisfied).

All the estate and interest (if any) of Paul Michael Drabik of 13 Burgess Street, Tullamarine, proprietor of an estate in fee simple in the land described on Certificate of Title Volume 8759, Folio 903 upon which is erected a dwelling known as 13 Burgess Street, Tullamarine.

Registered Mortgage No. U325102H affects the said estate and interest.

Terms – Cash/Eftpos
(Debit Card only. No Credit Cards)

SW-01-011157-2

Dated 21 March 2002

S. BLOXIDGE
Sheriff's Office

In the Supreme Court of the State of Victoria
SALE BY THE SHERIFF

On Wednesday 24 April 2002 at 2.30 p.m. at the Sheriff's Office, 8-20 King Street, Oakleigh, (unless process be stayed or satisfied).

All the estate and interest (if any) of Phat Quang Temple Inc. of 178 Rupert Street, West Footscray, proprietor of an estate in fee simple in the land described on Certificate of Title Volume 5355, Folio 909 upon which is erected a temple known as 178 Rupert Street, West Footscray.

Registered Mortgage No. V761549W and
Covenant 0889490 affect the said estate and
interest.

Terms – Cash/Eftpos
(Debit Card only. No Credit Cards)

SW-01-009914-2

Dated 21 March 2002

S. BLOXIDGE
Sheriff's Office

In the Supreme Court of the State of Victoria
SALE BY THE SHERIFF

On Friday 19 April 2002 at 11.00 a.m. at the
Sheriff's Office, 4th Floor, corner Fenwick &
Little Malop Streets, Geelong, (unless process
be stayed or satisfied).

All the estate and interest (if any) of Karl
Grull of 48 Cresta Street, Leopold as shown on
Certificate of Title as Karl Andrew Grull,
proprietor of an estate in fee simple in the land
described on Certificate of Title Volume 8964,
Folio 632 upon which is erected a dwelling
known as 48 Cresta Street, Leopold.

Registered Mortgage No. W835424F affects
the said estate and interest.

Terms – Cash only

SW-01-011158-3

Dated 14 March 2002

S. BLOXIDGE
Sheriff's Office

PROCLAMATIONS

**Health Services (Conciliation and Review)
(Amendment) Act 2001**

PROCLAMATION OF COMMENCEMENT

I, John Landy, Governor of Victoria, with the advice of the Executive Council, and under section 2(1) of the **Health Services (Conciliation and Review) (Amendment) Act 2001**, fix 25 March 2002 as the day on which that Act comes into operation.

Given under my hand and the seal of
Victoria on 19 March 2002.

(L.S.) JOHN LANDY
Governor
By His Excellency's Command

JOHN THWAITES
Minister for Health

**GOVERNMENT AND OUTER BUDGET SECTOR AGENCIES
NOTICES**

BAYSIDE CITY COUNCIL

Road Discontinuance

At its meeting on 25 February 2002 and acting under Clause 3 of Schedule 10 to the **Local Government Act 1989** Bayside City Council resolved to discontinue the road shown hatched on the plan below.

The road is to be sold subject to any right, power or interest held by South East Water Limited and Bayside City Council in the road in connection with any sewers, drains or pipes under the control of those authorities in or near the road.

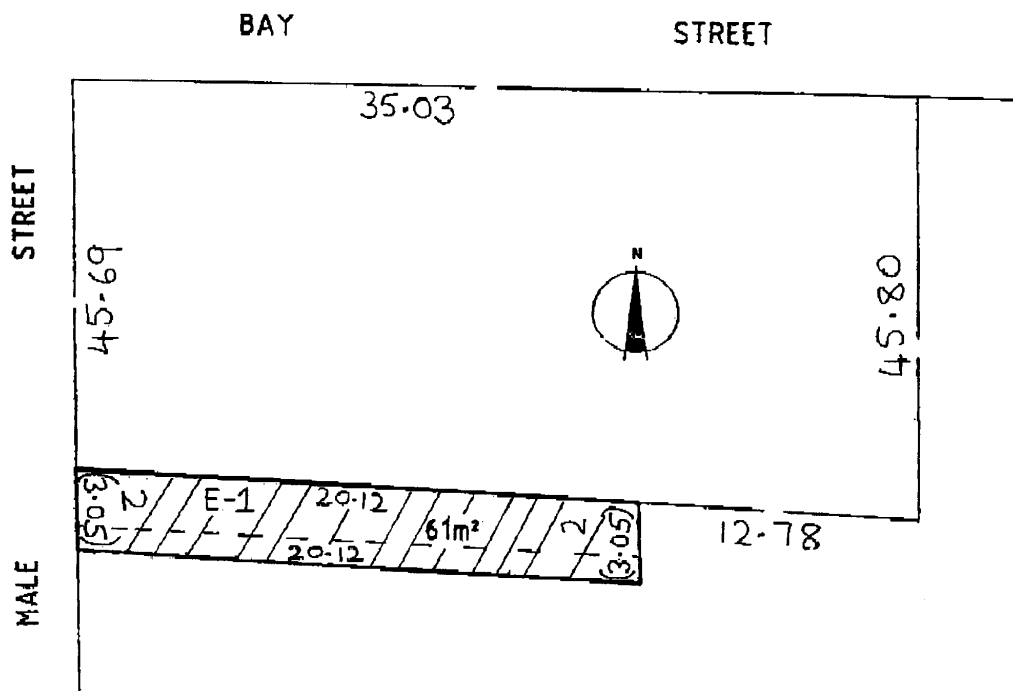

I. WILSON
Chief Executive

DAREBIN CITY COUNCIL

Road Discontinuance

Pursuant to Section 206 and Schedule 10, Clause 3 of the **Local Government Act 1989**, the Darebin City Council at its meeting held on 4 February 2002, formed the opinion that the road at the rear of 3 to 13 Monash Street and 78 to 96 Regent Street and adjacent to 2 Crispe Street, Reservoir, and shown by hatching on the plan below, is not reasonably required as a road for public use and resolved to discontinue the road and to sell the land from the road by private treaty to the abutting property owners.

The road is to be sold subject to the right, power or interest held by Yarra Valley Water Limited, in the road in connection with any sewers, drains or pipes under the control of that authority in or near the road.

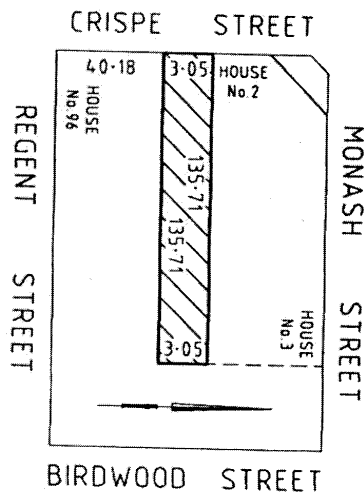

PHILLIP SHANAHAN
Chief Executive Officer

DAREBIN CITY COUNCIL

Road Discontinuance

Pursuant to Section 206 and Schedule 10, Clause 3 of the **Local Government Act 1989**, the Darebin City Council at its meeting held on 4 February 2002, formed the opinion that the road adjacent to 113 Tyler Street, Preston, and shown by hatching on the plan below, is not reasonably required as a road for public use and resolved to discontinue the road and to sell the land from the road by private treaty to the abutting property owners.

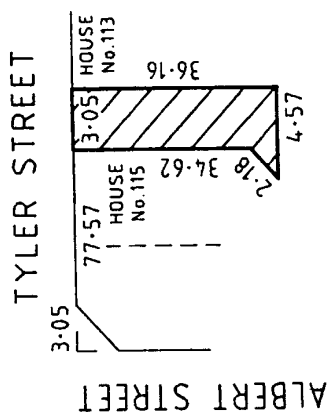

PHILLIP SHANAHAN
Chief Executive Officer

CITY OF PORT PHILLIP

Discontinuance of Road

Notice is hereby given that the Port Phillip City Council, at its ordinary meeting 27 August 2001, formed the opinion that the section of road shown hatched on the plan below, is not reasonably required as a road for public use and resolved to discontinue the road, and having advertised and served notices regarding the proposed discontinuance and hearing submissions under Section 223 of the **Local Government Act 1989**, orders that the road at the rear of 109 Market Street, South Melbourne also called Stewart Place, South Melbourne, be discontinued pursuant to Section 206 and Schedule 10, Clause 3 of the said Act, and the land of the discontinued road be sold by private treaty to the owners of the land abutting the road.

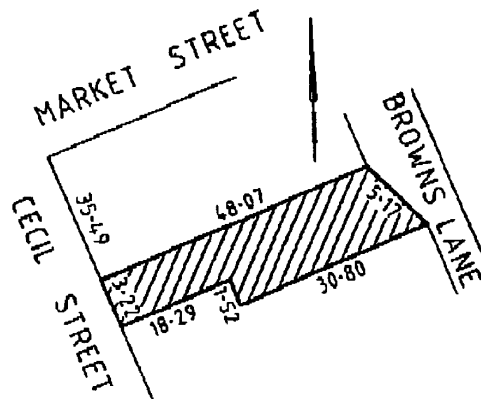

DAVID SPOKES
Chief Executive Officer

LATROBE CITY COUNCIL

Public Holidays Act 1993

Notice is hereby given that the Latrobe City Council pursuant to Section 7 of the **Public Holidays Act 1993** appoints half-day Public Holidays commencing at 12 noon for the declared town and rural districts of:

- Thursday 17 October 2002 – Moe, Newborough, Yallourn, Moe South, Hernes Oak, Tanjil South and Yallourn North.
- Friday 15 November 2002 – Traralgon, Traralgon East and Loy Yang.

The purpose of these half-day public holidays is in recognition of the respective Moe Cup and Traralgon Cup Race Meetings.

RICHARD HANCOCK
Chief Executive Officer

Planning and Environment Act 1987
MOONEE VALLEY PLANNING SCHEME
 Notice of Amendment
 Amendment C31

The City of Moonee Valley has prepared Amendment C31 to the Moonee Valley Planning Scheme.

The Amendment affects land at No. 26 Fletcher Street, Essendon.

The Amendment proposes to include the above site within the Heritage Overlay of the Moonee Valley Planning Scheme.

A copy of the Amendment may be inspected at the following locations during office hours:

- City of Moonee Valley, corner Kellaway Avenue & Pascoe Vale Road, Moonee Ponds;
- Department of Infrastructure, Customer Service Centre, Upper Plaza, Nauru House, 80 Collins Street, Melbourne.

Submissions about the Amendment must be sent to: Attention: Catherine Hunichen, Senior Strategic Policy Officer, City of Moonee Valley, PO Box 126, Moonee Ponds 3039 by 24 April 2002.

Dated 19 March 2002

SVEN KLING
 Chief Executive

Planning and Environment Act 1987
MORELAND PLANNING SCHEME
 Notice of Amendment
 Amendment C14

Moreland City Council has prepared Amendment C14 to the Moreland Planning Scheme.

The Amendment affects at 23–35 Cumberland Road, Pascoe Vale. Comprising an area of approximately 1.155 hectares, the site has its main alignment to Cumberland Road of 113.24 metres and a depth of 102.10 metres.

The Amendment proposes to change the local provisions of the Moreland Planning Scheme by rezoning the land from Public Use Zone 2 (Education) to Residential 1 Zone. This rezoning will enable the sale of the site by the Department of Education, Employment and Training.

The Amendment is available for public inspection, free of charge, during office hours at the following places: Moreland City Council, Moreland Civic Centre, 90 Bell Street, Coburg 3058 and Department of Infrastructure, Customer Service Centre, Nauru House, 80 Collins Street, Melbourne, Vic. 3000.

Submissions on the Amendment are welcome and should be received in writing at the Council Offices by close of business on the 27 April 2002. Submissions should be sent to: Ms. Liz Nairn, Team Leader – Strategic Planning, Moreland City Council, Locked Bag 10, Moreland, Vic. 3058.

ADRIAN ROBB
 Director City Strategy

Planning and Environment Act 1987
MORELAND PLANNING SCHEME
 Notice of Amendment
 Amendment C20

Moreland City Council has prepared Amendment C20 to the Moreland Planning Scheme. The Shell Company of Australia Ltd, is the proponent for the Amendment.

The Amendment affects the site at 737–757 Sydney Road, Coburg. Comprising an area of approximately 2811 square metres. The site is located on the north west corner of the Sydney Road and Gaffney Street intersection and was previously used as a petrol filling station.

The Amendment proposes to rezone the land from Residential 1 Zone (R1Z) to the Business 3 Zone (B3Z) and applies an Environmental Audit Overlay (EAO) to the site.

The Amendment is available for public inspection, free of charge, during office hours at the following locations: Moreland City Council, Customer Service Counter, 90 Bell Street, Coburg 3058 and Department of Infrastructure, Customer Service Centre, Nauru House, 80 Collins Street, Melbourne 3000.

Any person or agency who may be affected by the Amendment can make a submission to Moreland City Council. Submissions on the Amendment are welcomed and should be made in writing and received by Council by the close of business on the 27 April 2002. Submissions should be addressed as follows: Submission to

Amendment C20, Ms Liz Nairn, Team Leader – Strategic Planning, Moreland City Council, Locked Bag 10, Moreland 3058.

ADRIAN ROBB
Director City Strategy

Planning and Environment Act 1987

MORNINGTON PENINSULA

PLANNING SCHEME

Notice of Amendment

Notice of an Application for Planning Permit

Amendment C43

Application CP 02002

The land affected by the Amendment is 95 Watt Road, Mornington, it has an area of 22.426ha and is more particularly described as:

- Plan of Consolidation No. 17346W, Volume 9966, Folio 242.
- Lot S2 on PS346179Y, Volume 10330, Folio 374.

The land affected by the application is as above.

The Amendment proposes to:

- rezone a 4.0 hectare parcel of land which is in the process of being acquired by the Shire of Mornington Peninsula for public open space and stormwater detention and treatment from Low Density Residential Zone to Public Park and Recreation Zone;
- rezone the balance of the land (18.426ha) from Low Density Residential Zone to Residential 1 Zone;
- remove the Vegetation Protection Overlay (VPO1: Township Vegetation) which applies to all of the land (22.426ha);
- remove the Design and Development Overlay (DDO6: Low Density – Landscape) which applies to all of the land (22.426ha).

The application is for subdivision.

The person who requested the Amendment and the applicant for the permit is Matrix Planning Australia P/L.

You may inspect the Amendment and the application, and any documents that support the Amendment and application, and the explanatory report about the Amendment and application at the office of the planning authority, the

Mornington Peninsula Shire Council: Mornington – Queen Street, Mornington; Hastings Office – Marine Parade, Hastings; Rosebud Office – Besgrove Street, Rosebud and at the Department of Infrastructure, Customer Service Centre, Upper Plaza, Nauru House, 80 Collins Street, Melbourne.

This can be done during office hours and is free of charge.

Any person who may be affected by the Amendment or by the granting of the permit may make a submission to the planning authority. The closing date for submission is 22 April 2002. A submission must be sent to: The Manager – Strategic Planning, Mornington Peninsula Shire Council, Private Bag 1000, Rosebud 3939.

LYNTON SHEDDEN
Manager – Strategic Planning
Mornington Peninsula Shire Council

Planning and Environment Act 1987

TOWONG PLANNING SCHEME

Notice of Amendment

Amendment C8

Towong Shire Council has prepared Amendment C8 to the Towong Planning Scheme. The Amendment affects all of the land associated with the Dartmouth Regulation Dam (Lake Banimboola) located to the south and southwest of the Dartmouth township in the Shire of Towong.

The Amendment proposes to make the following changes to the Towong Planning Scheme:

- Change the zoning of all of the land associated with the Dartmouth Regulation Dam (Lake Banimboola) near the Dartmouth township. The proposal includes land rezoning changes from Public Conservation and Resource Zone (PCRZ) and Rural Zone (RUZ) to Public Use Zone – Service and Utility (PUZ1).

The Amendment, explanatory report and accompanying documentation can be inspected, free of charge, during office hours at:– Towong Shire Council, Shire Offices, 32 Towong Street, Tallangatta, and Shire Offices, 76 Hanson Street, Corryong; Department of Infrastructure,

North Eastern Region, 50–52 Clarke Street, Benalla and Department of Infrastructure, Customer Service Centre, Upper Plaza, Nauru House, 80 Collins Street, Melbourne.

Submissions in writing about the Amendment must be sent to Mr James Laycock, Shire Planner, Towong Shire Council, PO Box 55, Tallangatta 3700 by 22 April, 2002.

RAY PARK
Chief Executive
Towong Shire Council

Planning and Environment Act 1987
WELLINGTON PLANNING SCHEME

Notice of Amendment

Amendment C7

The land affected by the amendment is in or adjoins the Township of Heyfield and can generally be described as:

- (1) South of Munstons Lane, east of Golf Course Road, north of Dawson Road and Commercial Road and west of Heyfield–Licola Road and Davis Street; and
- (2) North of Skeels Street from the east side of Tyson Road extending to the west side of Weir Road and then in a southerly direction the land between Anderson Street to the west, Weir Road to the east and Traralgon–Maffra Road to the South; and
- (3) East and north of the intersection of Weir Road and Traralgon–Maffra Road including all the properties in Portas Mill Lane and Justice Parade and the land in an easterly direction including the properties in Bolton Street; and
- (4) Land in Fawaz Street, the former Heyfield Railway Station land between George Street and Mary Street, properties fronting Davis Street between Harbeck Street and MacFarlane Street and properties in the blocks bounded by Traralgon–Maffra Road and MacFarlane Street to the north, Dudley Street to the east and River Road to the south including the properties fronting Bessant Road; and
- (5) Proposed laneway at the rear of properties on the east side of Temple Street between Harbeck Street and MacFarlane Street; and

- (6) Land at the rear of properties on the west side of Pearson Street between Harbeck Street and MacFarlane Street; and
- (7) Land at and nearby to the north-east corner of the intersection of Heyfield–Licola Road and Eleanor Street; and
- (8) Land at and nearby to the northern corner of the intersection of Heyfield–Licola Road, Tyson Road and Mary Street.

The Amendment proposes to:–

- rezone land, remove and apply overlays; and
- introduce into the Wellington Planning Scheme the Mixed Use Zone and Schedule, and, Design and Development Overlay Schedule 8; and
- replace Clause 21.06 of the Wellington Planning Scheme, in particular, add one dot point to Clause 21.06-1 Applying Zones and Overlays and replace Clause 21.06-5 Heyfield and the Heyfield Strategy Plan, and
- correct errors in the zoning and overlay maps which occurred at the time of preparing the Wellington Planning Scheme.

The Amendment has been prepared by the Wellington Shire.

You may inspect the Amendment; and any documents that support the Amendment; and the explanatory report about the Amendment at the office of the planning authority, Wellington Shire Council, 70 Foster Street, Sale. Inspection can be made during office hours and is free of charge.

Any person who may be affected by the Amendment may make a written submission to the planning authority.

The closing date for a submission is 29 April 2002. The written submission must be sent to Ray Smith, Strategic Planner.

RAY SMITH
Strategic Planner

Creditors, next-of-kin and others having claims against the estate of any of the undermentioned deceased persons are required to send particulars of their claims to State Trustees Limited, ACN 064 593 148, 168 Exhibition

Street, Melbourne, Victoria 3000, the personal representative, on or before 24 May 2002 after which date State Trustees Limited may convey or distribute the assets having regard only to the claims of which State Trustees Limited then has notice.

BALL, Elizabeth Winifred, late of 71/197 Canterbury Road, St Kilda West, home duties, who died on 30 December 2001.

BENCIVENGA, Daniela also known as Daniella Bencivinga, late of 47 Cyprus Street, Lalor, process worker, who died on 21 December 2001.

CLARK, Ilma May, late of 4 Adelaide Avenue, Mount Waverley, gentlewoman, who died on 22 February 2002.

CROMBIE, Martha Martin, formerly of Flat 19, 47 Sutherland Road, but late of Harcourt Special Accommodation Home, 300 High Street, Windsor, pensioner, who died on 20 September 2001.

CROTTY, Meleita Kathleen, late of Unit 76, Heatherglen Village, Glendale Court, Werribee, retired, who died on 1 January 2002.

HOLTKAMP, John Bernard, late of 8 Cadle Court, Bayswater, driver, who died on 11 December 2001.

JOMANTAS, Vincas also known as Vincent Jomantas, late of 1 Mena Avenue, Cheltenham, retired, who died on 19 December 2001.

MAGUIRE, Ann Maree, late of Alfred Hospital, Commercial Road, Prahran, pensioner, who died on 19 December 2001.

NIBLETT, William John, late of 23 Roige Street, Wedderburn, who died on 10 December 2001.

NORWOOD, Lily, late of West Gate Private Nursing Home, 4 William Street, Newport, retired, who died on 22 November 2001.

O'BRIEN, Edward Albert, late of 11 Armstrong Street, Reservoir, who died on 28 January 2002.

RIEUSSET, Peter John, formerly of 8 Latrose Street, Keilor Park, but late of Unit 384/800 Kings Road, Taylors Lakes, who died on 31 December 2001.

RUSSELL, Sylvia Edith, late of Cresthaven Special Accommodation House, 26 Lightwood Road, Springvale, who died on 10 December 1998.

THOMSON, James, late of Argyll Private Nursing Home, 143 Finch Street, Glen Iris, retired gentleman, who died on 13 December 2001.

TYSON, Greta Helene, late of 68 Sandells Road, Tecoma, retired, who died on 5 March 2002.

WRIGHT, Kevin Vivian, late of 79 Kathryn Road, Knoxfield, retired, who died on 30 May 2001.

Dated at Melbourne, 13 March 2002

CATHY VANDERFEEN
Manager, Estate Management
State Trustees Limited

STATE TRUSTEES LIMITED

ACN 064 593 148

Section 79

BOWDEN, Violet Raye, also known as Peggy Raye Bowden, late of 14 Edwards Street, Burwood, pensioner, who died 24 December 2001.

BUGDEN, Bruce Colin, late of 8 Davies Street, Seaspray, draftsman, who died 30 July 2001.

GEORGE, Frederick James Lewis, late of Sandhurst Centre, 62 Finn Street, Bendigo, retired, deceased intestate, who died on 10 February 2002.

GOODWIN, Leslie William, late of 16 Glamiz Road, Footscray West, retired, who died on 1 January 2002.

Creditors, next-of-kin and others having claims against the abovementioned estates are required pursuant to Section 33 of the **Trustee Act 1958** to send particulars of their claims against the abovementioned estates to State Trustees Limited, 168 Exhibition Street, Melbourne, Victoria, on or before 24 May 2002 after which date State Trustees Limited, ACN 064 593 148, may occur convey or distribute the assets of the abovementioned estates having regard only to the claims of which it then has notice.

Fisheries Act 1995

FURTHER QUOTA ORDER FOR THE
GIANT CRAB FISHERY IN THE
WESTERN ZONE

Pursuant to Section 64A of the
Fisheries Act 1995

I, Candy Broad, Minister for Energy and Resources, having consulted with the commercial peak body and other relevant

consultative bodies and having considered the comments made by those bodies, make the following Further Quota Order for the giant crab fishery in Victorian waters west of longitude 143°40' east (the western zone).

1. This Further Quota Order applies to the giant crab fishery in the western zone for the period commencing on 1 April 2002 and ending on 31 March 2003 ("the quota period").
2. The total allowable catch (TAC) for the giant crab fishery in the western zone for the quota period is 25 tonnes.
3. The quantity of giant crabs comprising a quota unit for the quota period will be 50 kilograms.¹

Note:

1. There are 500 individual quota units for the western zone giant crab fishery, as determined by an Initial Quota Order pursuant to Section 64(1)(b) of the **Fisheries Act 1995**.

This Order commences on 1 April 2002 and remains in force until 31 March 2003.

Dated 12 March 2002

CANDY BROAD
Minister for Energy
and Resources

Fisheries Act 1995

FURTHER QUOTA ORDER FOR THE WESTERN ZONE OF THE VICTORIAN ROCK LOBSTER FISHERY

Pursuant to Section 64A of the
Fisheries Act 1995

I, Candy Broad, Minister for Energy and Resources, having consulted with the commercial peak body and other relevant consultative bodies and having considered the comments made by those bodies, make the following Further Quota Order for the western zone of the Victorian rock lobster fishery.

1. This Further Quota Order applies to the western zone of the Victorian rock lobster fishery for the period commencing on 1 April 2002 and ending on 31 March 2003 ("the quota period").
2. The total allowable catch (TAC) for the western rock lobster zone for the quota period is 450 tonnes of rock lobster.
3. The quantity of rock lobsters comprising a quota unit for the quota period in the western rock lobster zone will be 112.5 kilograms.¹

Note:

1. There are 4000 individual quota units for the western zone, as determined by an Initial Quota Order pursuant to Section 64(1)(b) of the **Fisheries Act 1995**.

This Order commences on 1 April 2002 and remains in force until 31 March 2003.

Dated 12 March 2002

Responsible Minister:
CANDY BROAD
Minister for Energy
and Resources

Fisheries Act 1995

FURTHER QUOTA ORDER FOR THE EASTERN ZONE OF THE VICTORIAN ROCK LOBSTER FISHERY

Pursuant to Section 64A of the
Fisheries Act 1995

I, Candy Broad, Minister for Energy and Resources, having consulted with the commercial peak body and other relevant consultative bodies and having considered the comments made by those bodies and other individuals, make the following Further Quota Order for the eastern zone of the Victorian rock lobster fishery.

1. This Further Quota Order applies to the eastern zone of the Victorian rock lobster fishery for the period commencing on 1 April 2002 and ending on 31 March 2003 ("the quota period").
2. The total allowable catch (TAC) for the eastern rock lobster zone for the quota period is 60 tonnes of rock lobster.
3. The quantity of rock lobsters comprising a quota unit for the quota period in the eastern rock lobster zone will be 60 kilograms.¹

Note:

1. There are 1000 individual quota units for the eastern zone, as determined by an Initial Quota Order pursuant to Section 64(1)(b) of the **Fisheries Act 1995**.

This Order commences on 1 April 2002 and remains in force until 31 March 2003.

Dated 12 March 2002

Responsible Minister:
CANDY BROAD
Minister for Energy
and Resources

AGREEMENT FOR THE MELBOURNE CITY LINK AND AGREEMENT FOR THE
EXHIBITION STREET EXTENSION PROJECT

Notice under Schedule 4 of the Agreement for Integrating and Facilitating the Project and the Exhibition Street Extension Project between the Crown in right of the State of Victoria, CityLink Melbourne Limited, Perpetual Trustee Company Limited, City Link Management Limited and City Link Extension Pty Limited (the "IFA") (as substituted for (and as if incorporated in lieu of) Schedule 3 of the Agreement for the Melbourne City Link between the Crown in right of the State of Victoria, CityLink Melbourne Limited, Perpetual Trustee Company Limited and City Link Management Limited (the "Concession Deed") and Schedule 1 of the Agreement for the Exhibition Street Extension Project between the Crown in right of the State of Victoria and City Link Extension Pty Limited ("the ESEP Deed")).

CityLink Melbourne Limited (ABN 65 070 810 678) (for itself and as agent of City Link Extension Pty Limited (ABN 40 082 058 615)) ("CityLink Melbourne") gives notice of the following Charge Tolls, Maximum Charge Tolls, Day Tolls, Taxi Tolls and Taxi Day Tolls for the Melbourne City Link and the Exhibition Street Extension:

Schedule of Charge Tolls and Maximum Charge Tolls**Charge Tolls (\$/vehicle)**

Category of Vehicle Tollable Section	Car	Light Commercial Vehicle	Heavy Commercial Vehicle	Motor Cycle
Tullamarine Freeway Upgrade, between Moreland Road and Brunswick Road	1.23	1.96	2.33	0.61
Western Link Section 1, between Racecourse Road and Dynon Road	1.23	1.96	2.33	0.61
Western Link Section 2, between Footscray Road and West Gate Freeway	1.53	2.45	2.91	0.77
Domain Tunnel and that part of the Southern Link leading into that Tunnel between the eastern portal of that Tunnel and Punt Road, other than that part of Southern Link Section 1:				
(a) between Punt Road and the exit to Boulton Parade; and				
(b) comprising Boulton Parade	1.53	2.45	2.91	0.77
Burnley Tunnel and that part of the Southern Link leading out of that Tunnel between the eastern portal of that Tunnel and Burnley Street	2.76	4.42	5.24	1.38
Southern Link Section 1, between Burnley Street and Punt Road and including that part of Southern Link Section 1:				
(a) between Punt Road and the exit to Boulton Parade; and				
(b) comprising Boulton Parade	1.23	1.96	2.33	0.61
Southern Link Section 5, between Punt Road and Burnley Street other than that part of the Southern Link leading out of the Burnley Tunnel between the eastern portal of that Tunnel and Burnley Street	1.23	1.96	2.33	0.61
Southern Link Section 1, between Glenferrie Road and Burnley Street	1.23	1.96	2.33	0.61
Southern Link Section 5, between Burnley Street and Glenferrie Road	1.23	1.96	2.33	0.61
Exhibition Street Extension	0.77	1.23	1.46	0.38

Southern Link Section 1, between Punt Road and Swan Street Intersection, other than:				
(a) that part of Southern Link Section 1:				
(i) between Punt Road and the exit to Boulton Parade; and				
(ii) comprising Boulton Parade; and				
(b) that part of the Southern Link leading into the Domain Tunnel between the eastern portal of that Tunnel and Punt Road	0.77	1.23	1.46	0.38
Southern Link Section 5, between Swan Street Intersection and Punt Road	0.77	1.23	1.46	0.38

Notes:

1. When travelling on Southern Link Section 1 between Burnley Street and Punt Road and then onto Batman Avenue, the Tollable Sections may be combined for the purposes of levying Tolls.
2. When travelling on Southern Link Section 1 and into the Domain Tunnel, the Tollable Sections may be combined for the purposes of levying Tolls.
3. A reference in the description of a Tollable Section to a part of the Southern Link between a particular street or road and Burnley Street, includes that part of the Southern Link between that particular street or road and where Burnley Street would cross the Southern Link if Burnley Street continued in a straight southerly direction from its southernmost extremity.
4. In this table:
 - “Boulton Parade” includes the off-ramp connecting the rest of the Southern Link to Boulton Parade;
 - “Burnley Tunnel” means the eastbound tunnel between Sturt Street and Burnley Street;
 - “Domain Tunnel” means the westbound tunnel between Punt Road and Sturt Street; and
 - “Swan Street Intersection” means the intersection between Swan Street and Batman Avenue.

Maximum Charge Tolls (\$/vehicle)

Category of Vehicle	Car	Light Commercial Vehicle	Heavy Commercial Vehicle	Motor Cycle
Trips where the passage of the Vehicle on the last Tollable Section comprising the Trip before exiting the Total Link occurs between 6.00 am and 8.00 pm	4.60	6.13	6.13	2.30
Trips where the passage of the Vehicle on the last Tollable Section comprising the Trip before exiting the Total Link occurs between 8.00 pm and 6.00 am	4.60	4.60	4.60	2.30

Day Tolls (\$/vehicle)

Category of Vehicle	Car	Light Commercial Vehicle	Heavy Commercial Vehicle	Motor Cycle
Day Toll	8.80	14.10	16.75	4.40

Taxi Tolls (\$/Taxi)

Trip	Taxi Toll
Trips involving use of any or all of the Tollable Sections which comprise the Western Link* and no other Tollable Sections	2.20
Trips involving use of any or all of the Tollable Sections which comprise the Southern Link** and/or Exhibition Street Extension*** and no other Tollable Sections	2.20
Trips involving use of Tollable Sections which comprise both the Western Link* and either or both of the Southern Link** and the Exhibition Street Extension***	3.85

* The Western Link comprises the following three Tollable Sections:

1. Tullamarine Freeway Upgrade, between Moreland Road and Brunswick Road.
2. Western Link Section 1, between Racecourse Road and Dynon Road.
3. Western Link Section 2, between Footscray Road and West Gate Freeway.

** The Southern Link comprises the following eight Tollable Sections:

1. Domain Tunnel and that part of the Southern Link leading into that Tunnel between the eastern portal of that Tunnel and Punt Road, other than that part of Southern Link Section 1:
 - (a) between Punt Road and the exit to Boulton Parade; and

- (b) comprising Boulton Parade.
 - 2. Southern Link Section 1, between Burnley Street and Punt Road and including that part of Southern Link Section 1:
 - (a) between Punt Road and the exit to Boulton Parade; and
 - (b) comprising Boulton Parade.
 - 3. Southern Link Section 5, between Punt Road and Burnley Street other than that part of the Southern Link leading out of the Burnley Tunnel between the eastern portal of that Tunnel and Burnley Street.
 - 4. Burnley Tunnel and that part of the Southern Link leading out of that Tunnel between the eastern portal of that Tunnel and Burnley Street.
 - 5. Southern Link Section 1, between Glenferrie Road and Burnley Street.
 - 6. Southern Link Section 5, between Burnley Street and Glenferrie Road.
 - 7. Southern Link Section 1, between Punt Road and Swan Street Intersection, other than:
 - (a) that part of Southern Link Section 1:
 - (i) between Punt Road and the exit to Boulton Parade; and
 - (ii) comprising Boulton Parade; and
 - (b) that part of the Southern Link leading into the Domain Tunnel between the eastern portal of that Tunnel and Punt Road.
 - 8. Southern Link Section 5, between Swan Street Intersection and Punt Road.
- *** The Exhibition Street Extension comprises the following Tollable Section:
- 1. Exhibition Street Extension.

Taxi Day Tolls (\$/Taxi)

Taxi	Taxi Day toll
Metropolitan Taxi	7.70
A Taxi not being a Metropolitan Taxi	5.50

CityLink Melbourne intends that each Charge Toll, Maximum Charge Toll, Day Toll, Taxi Toll and Taxi Day Toll specified above will first apply in the quarter ending 30 June 2002.

Capitalised terms in this notice that are defined in:

- (a) the Concession Deed have, subject to paragraph (b), that meaning in this notice;
- (b) the ESEP Deed have that meaning in this notice, but only to the extent that the provision applies to the ESEP Deed,

subject to the provisions of the IFA.

P G B O'SHEA
 Company Secretary
 CityLink Melbourne Limited
 (ABN 65 070 810 678)

G R PHILLIPS
 Finance Director
 CityLink Melbourne Limited
 (ABN 65 070 810 678)

AGREEMENT FOR THE EXHIBITION STREET EXTENSION PROJECT

Notice under Schedule 1 of the Agreement for the Exhibition Street Extension Project between the Crown in right of the State of Victoria and City Link Extension Pty Limited (the "ESEP Deed").

City Link Extension Pty Limited (ABN 40 082 058 615) ("Clepcoc") gives notice of the following Charge Tolls for the Exhibition Street Extension:

Charge Tolls (\$/vehicle)

Category of Vehicle	Car	Light Commercial Vehicle	Heavy Commercial Vehicle	Motor Cycle
Tollable Section				
Exhibition Street Extension	0.77	1.23	1.46	0.38

Clepcoc intends that these Charge Tolls will first apply in the quarter ending 30 June 2002.

Capitalised terms in this notice that are defined in the ESEP Deed have the same meaning as given by the ESEP Deed.

P G B O'SHEA
Company Secretary
City Link Extension Pty Limited
ABN 40 082 058 615

G R PHILLIPS
Finance Director
City Link Extension Pty Limited
ABN 40 082 058 615

AGREEMENT FOR THE MELBOURNE CITY LINK

Notice under Schedule 3 of the Agreement for the Melbourne City Link between the Crown in right of the State of Victoria, CityLink Melbourne Limited, Perpetual Trustee Company Limited and City Link Management Limited (the "Concession Deed").

CityLink Melbourne Limited (ABN 65 070 810 678) ("CityLink Melbourne") gives notice of the following Charge Tolls, Maximum Charge Tolls, Day Tolls, Taxi Tolls and Taxi Day Tolls for the Melbourne City Link:

Charge Tolls (\$/vehicle)

Category of Vehicle Tollable Section	Car	Light Commercial Vehicle	Heavy Commercial Vehicle	Motor Cycle
Tullamarine Freeway Upgrade, between Moreland Road and Brunswick Road	1.23	1.96	2.33	0.61
Western Link Section 1, between Racecourse Road and Dynon Road	1.23	1.96	2.33	0.61
Western Link Section 2, between Footscray Road and West Gate Freeway	1.53	2.45	2.91	0.77
Domain Tunnel and that part of the Southern Link leading into that Tunnel between the eastern portal of that Tunnel and Punt Road, other than that part of Southern Link Section 1:				
(a) between Punt Road and the exit to Boulton Parade; and				
(b) comprising Boulton Parade	1.53	2.45	2.91	0.77
Burnley Tunnel and that part of the Southern Link leading out of that Tunnel between the eastern portal of that Tunnel and Burnley Street	2.76	4.42	5.24	1.38
Southern Link Section 1, between Burnley Street and Punt Road and including that part of Southern Link Section 1:				
(a) between Punt Road and the exit to Boulton Parade; and				
(b) comprising Boulton Parade	1.23	1.96	2.33	0.61
Southern Link Section 5, between Punt Road and Burnley Street other than that part of the Southern Link leading out of the Burnley Tunnel between the eastern portal of that Tunnel and Burnley Street	1.23	1.96	2.33	0.61
Southern Link Section 1, between Glenferrie Road and Burnley Street	1.23	1.96	2.33	0.61

Southern Link Section 5, between Burnley Street and Glenferrie Road	1.23	1.96	2.33	0.61
Southern Link Section 1, between Punt Road and Swan Street Intersection, other than: (a) that part of Southern Link Section 1: (i) between Punt Road and the exit to Boulton Parade; and (ii) comprising Boulton Parade; and (b) that part of the Southern Link leading into the Domain Tunnel between the eastern portal of that Tunnel and Punt Road	0.77	1.23	1.46	0.38
Southern Link Section 5, between Swan Street Intersection and Punt Road	0.77	1.23	1.46	0.38

Notes:

- When travelling on Southern Link Section 1 between Burnley Street and Punt Road and then onto Batman Avenue, the Tollable Sections may be combined for the purposes of levying Tolls.
- When travelling on Southern Link Section 1 and into the Domain Tunnel, the Tollable Sections may be combined for the purposes of levying Tolls.
- A reference in the description of a Tollable Section to a part of the Southern Link between a particular street or road and Burnley Street, includes that part of the Southern Link between that particular street or road and where Burnley Street would cross the Southern Link if Burnley Street continued in a straight southerly direction from its southernmost extremity.
- In this table:
 - “Boulton Parade” includes the off-ramp connecting the rest of the Southern Link to Boulton Parade;
 - “Burnley Tunnel” means the eastbound tunnel between Sturt Street and Burnley Street;
 - “Domain Tunnel” means the westbound tunnel between Punt Road and Sturt Street; and
 - “Swan Street Intersection” means the intersection between Swan Street and Batman Avenue.

Maximum Charge Tolls (\$/vehicle)

Category of Vehicle	Car	Light Commercial Vehicle	Heavy Commercial Vehicle	Motor Cycle
Trips where the passage of the Vehicle on the last Tollable Section comprising the Trip before exiting the Link occurs between 6.00 am and 8.00 pm	4.60	6.13	6.13	2.30
Trips where the passage of the Vehicle on the last Tollable Section comprising the Trip before exiting the Link occurs between 8.00 pm and 6.00 am	4.60	4.60	4.60	2.30

Day Tolls (\$/vehicle)

Category of Vehicle	Car	Light Commercial Vehicle	Heavy Commercial Vehicle	Motor Cycle
Day Toll	8.80	14.10	16.75	4.40

Taxi Tolls (\$/Taxi)

Trip	Taxi Toll
Trips involving use of any or all of the Tollable Sections which comprise the Western Link* and no other Tollable Sections	2.20
Trips involving use of any or all of the Tollable Sections which comprise the Southern Link** and no other Tollable Sections	2.20
Trips involving use of Tollable Sections which comprise both the Western Link* and the Southern Link**	3.85

* The Western Link comprises the following three Tollable Sections:

1. Tullamarine Freeway Upgrade, between Moreland Road and Brunswick Road.
2. Western Link Section 1, between Racecourse Road and Dynon Road.
3. Western Link Section 2, between Footscray Road and West Gate Freeway.

** The Southern Link comprises the following eight Tollable Sections:

1. Domain Tunnel and that part of the Southern Link leading into that Tunnel between the eastern portal of that Tunnel and Punt Road, other than that part of Southern Link Section 1:
 - (a) between Punt Road and the exit to Boulton Parade; and
 - (b) comprising Boulton Parade.
2. Southern Link Section 1, between Burnley Street and Punt Road and including that part of Southern Link Section 1:
 - (a) between Punt Road and the exit to Boulton Parade; and
 - (b) comprising Boulton Parade.
3. Southern Link Section 5, between Punt Road and Burnley Street other than that part of the Southern Link leading out of the Burnley Tunnel between the eastern portal of that Tunnel and Burnley Street.
4. Burnley Tunnel and that part of the Southern Link leading out of that Tunnel between the eastern portal of that Tunnel and Burnley Street.
5. Southern Link Section 1, between Glenferrie Road and Burnley Street.
6. Southern Link Section 5, between Burnley Street and Glenferrie Road.
7. Southern Link Section 1, between Punt Road and Swan Street Intersection, other than:
 - (a) that part of Southern Link Section 1:

- (i) between Punt Road and the exit to Boulton Parade; and
 - (ii) comprising Boulton Parade; and
 - (b) that part of the Southern Link leading into the Domain Tunnel between the eastern portal of that Tunnel and Punt Road.
8. Southern Link Section 5, between Swan Street Intersection and Punt Road.

Taxi Day Tolls (\$/Taxi)

Taxi	Taxi Day toll
Metropolitan Taxi	7.70
A Taxi not being a Metropolitan Taxi	5.50

CityLink Melbourne intends that each Charge Toll, Maximum Charge Toll, Day Toll, Taxi Toll and Taxi Day Toll specified above will first apply in the quarter ending 30 June 2002.

Capitalised terms in this notice that are defined in the Concession Deed have the same meaning as given by the Concession Deed.

P G B O'SHEA
Company Secretary
CityLink Melbourne Limited
(ABN 65 070 810 678)

G R PHILLIPS
Finance Director
CityLink Melbourne Limited
(ABN 65 070 810 678)

Geographic Place Names Act 1998

REGISTRATION OF AMENDMENT OF GEOGRAPHIC NAMES

The Registrar of Geographic Names hereby gives notice of the registration of amendment of the undermentioned place name.

File No.	Place Names	Proposer & Location
LA/12/0193	Merger between Hawkesdale Primary School and Hawkesdale Secondary College to form Hawkesdale P12 College	Department of Education. Corner of Mitchell and Spring Streets, Hawkesdale.

Office of the Registrar of Geographic Names

c/-**LAND VICTORIA**
Level 15,
570 Bourke Street,
Melbourne 3000

KEITH C. BELL
Registrar of Geographic Names

Land Act 1958NOTICE OF INTENTION
TO EXCHANGE LAND

I, Norma Marshall, Director Crown Land Management, as a delegated officer of the Minister for Environment and Conservation, do hereby give notice that after the expiry of at least 14 days from the date of publication of this notice, I intend to enter into an agreement with Coral Six Pty. Ltd. of 341 St. Kilda Street, Brighton 3186, to exchange the freehold land described as part of Section 11, Parish of Truganina being part of the land contained in Certificate of Title Volume 8961, Folio 074

and designated as "Proposed Conservation Reserve" on plan labelled PS428564Q (Ref: 99-3-17 version 1) for the Crown land being part of Crown Allotment 6 of Section 19, Parish of Truganina as shown on plan (ref: 99-3-17 version 4A) plus the portion of Government road adjoining Lots 12 and 18 on plan PS 428564Q (ref: 99-3-17 version 1).

Contact: P. Barber.

Telephone: 9296 4511.

Reference: PP-LA/20/0053.



Heritage
VICTORIA

Heritage Act 1995

NOTICE OF REGISTRATION

As Executive Director for the purpose of the Heritage Act, I give notice under section 46 that the Victorian Heritage Register is amended by including the Heritage Register Number 1966 in the category described as a Heritage place:

Former HV McKay Offices, Devonshire Road, Sunshine, Brimbank City Council.

EXTENT:

1. All of the land shown on Diagram 1966 held by the Executive Director.

2. All of the buildings, the 1909 office and the 1926-7 office shown as B1 and B2 on diagram 1966 held by the Executive Director.

3. All of the objects being the Boardroom table and chairs.

Dated 21 March 2002

RAY TONKIN
Executive Director



Heritage
VICTORIA

Heritage Act 1995

NOTICE OF REGISTRATION

As Executive Director for the purpose of the Heritage Act, I give notice under section 46 that the Victorian Heritage Register is amended by including the Heritage Register Number 1981 in the category described as a Heritage place:

Camp Eureka, Tarrango Road, Yarra Junction, Yarra Ranges Shire Council.

EXTENT:

1. All the land as shown on diagram 1981 held by the Executive Director including the land described in Certificates of Title Volume 6737, Folios 360 & 361.

2. The following buildings shown on diagram 1981 held by the Executive Director: B1 Recreation Hall, B2 Mess Hall, B3 Kitchen, B4 Medical Hut, B5 Model Hut 1, B6 Model Hut 2.

Dated 21 March 2002

RAY TONKIN
Executive Director



Heritage
VICTORIA

Heritage Act 1995

NOTICE OF REGISTRATION

As Executive Director for the purpose of the Heritage Act, I give notice under section 46 that the Victorian Heritage Register is amended by including the Heritage Register Number 1970 in the category described as a Heritage place:

Former St John's the Less Anglican Church & Schoolroom, 709 Hawthorn Road, Brighton East, Bayside City Council.

EXTENT:

1. All of the building marked B1 on diagram 606340 held by the Executive Director.

2. All of the land marked L1 on diagram 606340 held by the Executive Director, being part of the land described as Lot 1 on Title Plan 012711L.

Dated 21 March 2002

RAY TONKIN
Executive Director



Heritage
VICTORIA

Heritage Act 1995

NOTICE OF REGISTRATION

As Executive Director for the purpose of the Heritage Act, I give notice under section 46 that the Victorian Heritage Register is amended in

that the Heritage Register Number 1501 in the category described as a Heritage place is now described as:

Royal Exhibition Building & Carlton Gardens, Nicholson, Victoria, Rathdowne & Carlton Streets, Carlton, Melbourne City Council.

EXTENT:

1. All of the buildings and structures marked as follows on Diagram 1501 held by the Executive Director: B1 Royal Exhibition Building, B2 Curator's Cottage, B3 Hochgurtel Fountain, B4 French Fountain, B5 Westgarth Drinking Fountain, B6 Stawell Sandstone Sample, B7 Palisade Fence and Gate, B8 Remnants of Bluestone Base to Palisade Fence, B9 Iron Rod Fence.

2. All of the landscape features marked as follows on Diagram 1501 held by the Executive Director: P1 Pathways (south garden), P2 Pathways (north garden), P3 Pond and Island, P4 Pond and Islands.

3. All the trees and palms, including avenues, rows and individuals growing in the Carlton Gardens including the following species: *Acmena ingens*, *Angophora floribunda*, *Araucaria bidwillii*, *Araucaria cunninghamii*, *Araucaria heterophylla*, *Cedrus deodara*, *Chamaecyparis funebris*, *Corymbia citriodora*, *Cupressus macrocarpa*, *Cupressus torulosa*, *Eucalyptus cladocaylx*, *Ficus macrophylla*, *Ficus platypoda*, *Harpephyllum caffrum*, *Magnolia grandiflora*, *Phoenix canariensis*, *Pinus canariensis*, *Pinus nigra var. corsicana*, *Pinus pinea*, *Pittosporum undulatum*, *Platanus x acerifolia*, *Populus alba*, *Populus x canadensis 'Aurea'*, *Quercus acutissima*, *Quercus bicolor*, *Quercus canariensis*, *Quercus cerris*, *Quercus ilex*, *Quercus robur*, *Robinia pseudoacacia*, *Salix babylonica*, *Schinus molle*, *Taxodium distichum*, *Tilia x europaea*, *Ulmus procera*, *Ulmus x hollandica*, *Washingtonia robusta*, *Waterhousea floribunda*.

4. All of the Crown Land Reserve Rs 9990 (Carlton Gardens) and Rs 37130 (Royal Exhibition Building and Museum of Victoria), crown allotment 19A, shown on Diagram 1501 held by the Executive Director, being the land bounded by Rathdowne Street, Carlton Street, Nicholson Street and Victoria Street.

Dated 18 March 2002

RAY TONKIN
Executive Director

Land Acquisition and Compensation Act 1986

LAND ACQUISITION AND
COMPENSATION REGULATIONS 1987

Form 7 S.21
Reg.16

Notice of Acquisition

Compulsory Acquisition of Interest in land

The Minister for Education and Training declares that by this notice she acquires the following interests in the land which contains an area of 2.003 hectares and is located at 261 McCormicks Road, Carrum Downs.

The parcel is formally described as Lot 2 on Plan of Subdivision No. 95116, Parish of Lyndhurst, more particularly being the whole of the land contained in Certificate of Title Volume 8935, Folio 557.

The interests of Ruby May Boutcher, Adrian John Clyde Boutcher, Geoffrey Roland Boutcher and Vivienne May Lowe, as the registered proprietors of the holding.

Dated 18 March 2002

Published with the authority of the
Minister for Education and Training

Land Acquisition and Compensation Act 1986

FORM 7 S.21
Reg. 16

Notice of Acquisition

Compulsory Acquisition of Interest in Land

The Roads Corporation (VicRoads), declares that by this notice it acquires the following interest in the land described as part of Crown Sections 2, 5 and 6, Parish of Carlyle, comprising 2.621 hectares and being land described in Certificate of Title Volume 2721, Folio 066; Certificate of Title Volume 7775, Folio 048; Certificate of Title Volume 2721, Folio 071; Certificate of Title Volume 8113, Folio 789; Certificate of Title Volume 3684, Folio 644; Certificate of Title Volume 1373, Folio 502; Certificate of Title Volume 1373, Folio 499; Certificate of Title Volume 1373, Folio 498, shown as Parcels 4, 5, 6, 7, 8, 9, 10, 11 12, 13, 14 and 15 on Roads Corporation Survey Plan 20017A.

Interest Acquired: That of Brown Brothers Nominees Pty Ltd and all other interests.

Published with the authority of VicRoads.

The Survey plan referred to in this notice may be viewed without charge at the office of Property Services Department, VicRoads, 4th Floor, North Building, 60 Denmark Street, Kew during the hours 9.00 a.m. to 4.00 p.m.

Dated 21 March 2002

For and on behalf of VicRoads:
GERRY TURNER,
Manager – Property Services Department

Land Acquisition and Compensation Act 1986

FORM 7 S.21
Reg.16

Notice of Acquisition

Compulsory Acquisition of Interest in land

The Roads Corporation (VicRoads), declares that by this notice it acquires the following interest in the land described as part of Crown Section 18 at Bendigo, Parish of Sandhurst comprising 185 square metres and being land described in Book 39, Memorial 96, shown as Parcel 7A on Roads Corporation Survey Plan 19279A.

Interest Acquired: That of The Estate of Samuel Le Capelain and all other interests.

Published with the authority of VicRoads.

The Survey plan referred to in this notice may be viewed without charge at the office of Property Services Department, VicRoads, 4th Floor, North Building, 60 Denmark Street, Kew during the hours 9.00 am to 4.00 pm.

Dated 21 March 2002

For and on behalf of VicRoads:
G. TURNER,
Manager Property Services Department.

Prostitution Control Act 1994

NOTICE OF MAKING OF A DECLARATION

In the Magistrates' Court of Victoria
at Dandenong

Case Nos.: Z00481485 and Z00481474

In the matter of an application under Section 80
of the **Prostitution Control Act 1994**.

Upon an application by the Greater Dandenong City Council, the Magistrates' Court at Dandenong did on 27 February 2002 declare that for a period of 3 months from the date of this declaration the premises situated at and known as 1524 Heatherton Road, Dandenong to be a proscribed brothel under Section 80(1) of the **Prostitution Control Act 1994**.

Dated 27 February 2002

WARWICK HEINE
Chief Executive Officer
Greater Dandenong City Council

Prostitution Control Act 1994

NOTICE OF MAKING OF A DECLARATION

In the Magistrates' Court of Victoria
at Dandenong

Case Nos.: Z00481372 and Z00481383

In the matter of an application under Section 80
of the **Prostitution Control Act 1994**.

Upon an application by the Greater Dandenong City Council, the Magistrates' Court at Dandenong did on 27 February 2002 declare that for a period of 3 months from the date of this declaration the premises situated at and known as 1 Southdowne Close, Springvale to be a proscribed brothel under Section 80(1) of the **Prostitution Control Act 1994**.

Dated 27 February 2002

WARWICK HEINE
Chief Executive Officer
Greater Dandenong City Council

Prostitution Control Act 1994

NOTICE OF MAKING OF A DECLARATION

In the Magistrates' Court of Victoria
at Dandenong

Case Nos.: Z00485810 and Z00485821

In the matter of an application under Section 80
of the **Prostitution Control Act 1994**.

Upon an application by the Greater Dandenong City Council, the Magistrates' Court at Dandenong did on 27 February 2002 declare that for a period of 3 months from the date of this declaration the premises situated at and known as Shop 3, 309–315 Thomas Street,

Dandenong to be a proscribed brothel under Section 80(1) of the **Prostitution Control Act 1994**.

Dated 27 February 2002

WARWICK HEINE
Chief Executive Officer
Greater Dandenong City Council

Prostitution Control Act 1994
NOTICE OF MAKING OF A
DECLARATION

In the Magistrates' Court of Victoria
at Dandenong

Case No.: Z00481521

In the matter of an application under Section 80
of the **Prostitution Control Act 1994**.

Upon an application by the Greater Dandenong City Council, the Magistrates' Court at Dandenong did on 27 February 2002 declare that for a period of 3 months from the date of this declaration the premises situated at and known as 473 Princes Highway, Noble Park to be a proscribed brothel under Section 80(1) of the **Prostitution Control Act 1994**.

Dated 27 February 2002

WARWICK HEINE
Chief Executive Officer
Greater Dandenong City Council

Prostitution Control Act 1994
NOTICE OF MAKING OF A
DECLARATION

In the Magistrates' Court of Victoria
at Dandenong

Case No.: Z00485865

In the matter of an application under Section 80
of the **Prostitution Control Act 1994**.

Upon an application by the Greater Dandenong City Council, the Magistrates' Court at Dandenong did on 4 March 2002 declare that for a period of 3 months from the date of this declaration the premises situated at and known as 65 Princes Highway, Dandenong to be a proscribed brothel under Section 80(1) of the **Prostitution Control Act 1994**.

Dated 4 March 2002

WARWICK HEINE
Chief Executive Officer
Greater Dandenong City Council

Prostitution Control Act 1994

NOTICE OF MAKING OF A
DECLARATION

In the Magistrates' Court of Victoria
at Dandenong

Case No.: Z00481419

In the matter of an application under Section 80
of the **Prostitution Control Act 1994**.

Upon an application by the Greater Dandenong City Council, the Magistrates' Court at Dandenong did on 4 March 2002 declare that for a period of 3 months from the date of this declaration the premises situated at and known as 1/1680 Centre Road, Dandenong to be a proscribed brothel under Section 80(1) of the **Prostitution Control Act 1994**.

Dated 4 March 2002

WARWICK HEINE
Chief Executive Officer
Greater Dandenong City Council

Prostitution Control Act 1994

NOTICE OF MAKING OF A
DECLARATION

In the Magistrates' Court of Victoria
at Dandenong

Case No.: Z00485854

In the matter of an application under Section 80
of the **Prostitution Control Act 1994**.

Upon an application by the Greater Dandenong City Council, the Magistrates' Court at Dandenong did on 4 March 2002 declare that for a period of 3 months from the date of this declaration the premises situated at and known as 10 Jeffers Street, Noble Park to be a proscribed brothel under Section 80(1) of the **Prostitution Control Act 1994**.

Dated 4 March 2002

WARWICK HEINE
Chief Executive Officer
Greater Dandenong City Council

Prostitution Control Act 1994

NOTICE OF MAKING OF A
DECLARATION

In the Magistrates' Court of Victoria
at Dandenong

Case Nos.: Z00481496 and Z00481510

In the matter of an application under Section 80
of the **Prostitution Control Act 1994**.

Upon an application by the Greater Dandenong City Council, the Magistrates' Court at Dandenong did on 4 March 2002 declare that for a period of 3 months from the date of this declaration the premises situated at and known as 17 Ian Street, Noble Park to be a proscribed brothel under Section 80(1) of the **Prostitution Control Act 1994**.

Dated 4 March 2002

WARWICK HEINE
Chief Executive Officer
Greater Dandenong City Council

Plant Health and Plant Products Act 1995

NOTICE OF EXTENSION

Order Prohibiting or Restricting the Entry or Importation of Lupin into Victoria

I, Keith Hamilton, Minister for Agriculture give notice that the Order in force under section 24 of the **Plant Health and Plant Products Act 1995** dated 28 March 2001 prohibiting or restricting the entry or importation of lupin into Victoria is extended for a further period of 12 months.

The Order prohibits subject to conditions or restricts the entry or importation of any plant or plant product of *Lupinus* species and any agricultural equipment or package that has been used with that species so as to prevent the introduction or spread of the exotic disease Lupin anthracnose *Colletotrichum gloeosporioides* (severe strain) into Victoria.

A copy of the Order may be obtained by contacting the Plant Standards Branch on (03) 92109390.

KEITH HAMILTON
Minister for Agriculture

Subordinate Legislation Act 1994

NOTICE OF PREPARATION OF REGULATORY IMPACT STATEMENT (RIS)

Domestic (Feral and Nuisance) Animals (Amendment) Regulations 2002.

Notice is given that, in accordance with section 11 of the **Subordinate Legislation Act 1994**, a Regulatory Impact Statement (RIS) has been prepared for the Domestic (Feral and Nuisance) Animals (Amendment) Regulations 2002.

The primary objective of the proposed Regulations is to amend the Domestic (Feral and Nuisance) Animals Regulations 1996 –

- to make provision for penalties for offences for which an infringement notice may be served; and
- to prescribe the requirements for perimeter fencing for dangerous dogs guarding non-residential premises; and
- to make miscellaneous amendments to those Regulations.

The Regulations are to be made under the **Domestic (Feral and Nuisance) Animals Act 1994** ('the Act'). The RIS discusses possible alternatives to the proposed Regulations. The proposed Regulations were considered the best means of achieving the objective and the most appropriate method to improve the management of dangerous dogs, to reduce the possibility of dog attacks and to raise the standards of training for dogs and their owners.

The RIS assesses the costs and benefits of the proposed Regulations and concludes that the benefits of the Regulations are greater than the costs they impose.

Copies of the RIS and the proposed Regulations may be obtained from the Customer Service Centre by phoning 136 186 (between 8am to 8pm), the Department's Information Centre (Ground Floor, 8 Nicholson Street, East Melbourne between 8.30am and 5.30pm), or the internet at <http://www.nre.vic.gov.au/ris>.

Public comments are invited on the RIS and the accompanying Regulations. All comments must be in writing and should be sent to Mr John McCrory, Senior Scientific Officer, Bureau of Animal Welfare 475 Mickleham Road, Attwood, Victoria, 3049 or by email to John.McCrory@nre.vic.gov.au by no later than 5pm on Friday, 19 April 2002.

KEITH HAMILTON MP
Minister for Agriculture

Transport Act 1983

VICTORIAN TAXI DIRECTORATE

Department of Infrastructure

Commercial Passenger Vehicle Applications

Notice is hereby given that the following applications will be considered by the Victorian Taxi Directorate, a division of the Department of Infrastructure after 24 April 2002.

Notice of any objection to the granting of an application should be forwarded to reach the Manager, Licensing & Certification, Victorian Taxi Directorate, Level 6, 14–20 Blackwood Street, North Melbourne (P.O. Box 666, North Melbourne 3051) not later than 18 April 2002.

Copies of objections are forwarded to the applicants.

It will not be necessary for interested parties to appear on the date specified, unless advised in writing by the Department.

VHA Chauffeured Cars Pty Ltd, North Melbourne. Application to license six (6) commercial passenger vehicles to be purchased in respect of any vehicle that meets the standards approved by the Victorian Taxi Directorate to operate as a hire car from 221 Abbotsford Street, North Melbourne.

Melbourne's Best Tours Pty Ltd, Tullamarine. Application to license one commercial passenger vehicle to be purchased in respect of a 1998 or later model Chrysler/Toyota/Kia wagon or similar vehicle with seating capacity for seven (7) passengers to operate a service from 1 Prima Court, Tullamarine for the carriage of interstate and overseas tourists on various tours to places of interest throughout the State of Victoria.

Note:— passengers on various tours will be picked up/set down from their hotels/motels and accommodation residences within a 30km radius of the Melbourne GPO.

Dated 18 March 2002

ROBERT STONEHAM
Manager – Operations
Victorian Taxi Directorate

It will not be necessary for interested parties to appear on the date specified, unless advised in writing.

B. A. Mack & Co Pty Ltd. Application for variation of conditions of tow truck licence number TOW959 which authorises the licensed vehicle to be managed, controlled and operated from a depot situated at 33–35 Franklyn Street, Huntingdale to change the depot address to 400 Neerim Road, Murrumbeena.

Lymenko Pty Ltd. Application for variation of conditions of tow truck licence number TOW748 which authorises the licensed vehicle to be managed, controlled and operated from a depot situated at 400 Neerim Road, Murrumbeena to change the depot address to 33–35 Franklyn Street, Huntingdale.

Modern Towing & Salvage (Aust) Pty Ltd. Application for variation of conditions of tow truck licence numbers 002HTT, 008HTT and 012HTT which authorises the licensed vehicles to be managed, controlled and operated from a depot situated at 1–3 Ponting Street, Williamstown to change the depot address to 33 Cherry Lane, Laverton North.

Modern Towing & Salvage (Holdings) Pty Ltd. Application for variation of conditions of tow truck licence numbers 003HTT and 009HTT which authorises the licensed vehicles to be managed, controlled and operated from a depot situated at 1–3 Ponting Street, Williamstown to change the depot address to 33 Cherry Lane, Laverton North.

Dated 21 March 2002

STEVE STANKO
Director

Transport Act 1983

TOW TRUCK DIRECTORATE OF VICTORIA

Tow Truck Application

Notice is hereby given that the following applications will be considered by the Licensing Authority after 24 April 2002.

Notice of any objection to the granting of an application should be forwarded to reach the Director, Tow Truck Directorate of Victoria, Level 6, 14–20 Blackwood Street, North Melbourne (P O Box 666, North Melbourne 3051) not later than 18 April 2002.

Planning and Environment Act 1987

BANYULE PLANNING SCHEME

Notice of Approval of Amendment Amendment C25

The Minister for Planning has approved Amendment C25 to the Banyule Planning Scheme.

The Amendment comes into operation on the date this notice is published in the Government Gazette.

The Amendment rezones approximately 1.89 hectares of land located to the east of

Plenty Road and south of the Northern Ring Road, Bundoora, from Public Use Zone 1 (Service and Utility) to Residential 1 Zone and applies a Development Plan Overlay (Schedule 3) to the land.

A copy of the Amendment can be inspected, free of charge, during office hours, at the Department of Infrastructure, Planning Information Centre, Upper Plaza, Nauru House, 80 Collins Street, Melbourne and at the offices of the Banyule City Council, 275 Upper Heidelberg Road, Ivanhoe.

PAUL JEROME
Executive Director
Planning, Heritage and
Building Division
Department of Infrastructure

Planning and Environment Act 1987

CARDINIA PLANNING SCHEME

Notice of Approval of Amendment

Amendment C25

The Minister for Planning has approved Amendment C25 to the Cardinia Planning Scheme.

The Amendment comes into operation on the date this notice is published in the Government Gazette.

The Amendment rezones land located at the north-west corner of Henry Road and McGregor Road, Pakenham, more specifically part lot 2 on plan of subdivision 441732V, from Residential 1 Zone to Business 1 Zone.

A copy of the Amendment can be inspected, free of charge, during office hours, at the Department of Infrastructure, Planning Information Centre, Upper Plaza, Nauru House, 80 Collins Street, Melbourne and at the offices of the Cardinia Shire Council, Henty Way, Pakenham.

PAUL JEROME
Executive Director
Planning, Heritage and
Building Division
Department of Infrastructure

Planning and Environment Act 1987

HEPBURN PLANNING SCHEME

Notice of Approval of Amendment

Amendment C6

The Minister for Planning has approved Amendment C6 to the Hepburn Planning Scheme.

The Amendment comes into operation on the date this notice is published in the Government Gazette.

The Amendment replaces Schedule 1 to the Environmental Significance Overlay. The new schedule expands the circumstances where exemptions for planning permits apply and adds to the list of Environmental Objectives in the schedule.

A copy of the Amendment can be inspected, free of charge, during office hours, at the Department of Infrastructure, Planning Information Centre, Upper Plaza, Nauru House, 80 Collins Street, Melbourne; the Western Regional Office of the Department of Infrastructure, 88 Learmonth Road, Wendouree, and at the offices of the Hepburn Shire Council, 76 Vincent Street, Daylesford.

PAUL JEROME
Executive Director
Planning, Heritage and
Building Division
Department of Infrastructure

Planning and Environment Act 1987

GLENELG PLANNING SCHEME

Notice of Approval of Amendment

Amendment C6

The Minister for Planning has approved Amendment C6 to the Glenelg Planning Scheme.

The Amendment comes into operation on the date this notice is published in the Government Gazette.

The Amendment alters the planning scheme maps and the schedule to the Heritage Overlay so that five heritage places are shown in the Glenelg Planning Scheme consistent with the Victorian Heritage Register.

A copy of the Amendment can be inspected, free of charge, during office hours, at the Department of Infrastructure, Planning Information Centre, Upper Plaza, Nauru House, 80 Collins Street, Melbourne and at the offices of the Glenelg Shire Council, Cliff Street, Portland.

PAUL JEROME
Executive Director
Planning, Heritage and
Building Division
Department of Infrastructure

Planning and Environment Act 1987
GREATER GEELONG PLANNING SCHEME
Notice of Approval of Amendment
Amendment C15

The Minister for Planning has approved Amendment C15 to the Greater Geelong Planning Scheme.

The Amendment comes into operation on the date this notice is published in the Government Gazette.

The Amendment:

- rezones a 3.5 hectare site located on the west side of Grubb Road, Ocean Grove, immediately south the existing water storage basin from Rural Zone to Public Use 1 Zone;
- rezones land at 50 Ash Road, Leopold from Public Use 1 Zone to Residential 1 Zone.

A copy of the Amendment can be inspected, free of charge, during office hours, at the Department of Infrastructure, Customer Service Centre, Upper Plaza, Nauru House, 80 Collins Street, Melbourne and at the offices of the City of Greater Geelong, 2nd Floor, 131 Myers Street, Geelong.

PAUL JEROME
Executive Director
Planning, Heritage and
Building Division
Department of Infrastructure

Planning and Environment Act 1987
MELBOURNE PLANNING SCHEME
Notice of Approval of Amendment
Amendment C40

The Minister for Planning has approved Amendment C40 to the Melbourne Planning Scheme.

The Amendment comes into operation on the date this notice is published in the Government Gazette.

The Amendment rezones land situated at 235 Faraday Street, Carlton, from a Public Use Zone 3 (Health and Community) to a Mixed Use Zone.

A copy of the Amendment can be inspected, free of charge, during office hours, at the Department of Infrastructure, Planning Information Centre, Upper Plaza, Nauru House, 80 Collins Street, Melbourne and at the offices of the Melbourne City Council, 6th Floor, Council House, 200 Little Collins Street, Melbourne.

PAUL JEROME
Executive Director
Planning, Heritage and
Building Division
Department of Infrastructure

Planning and Environment Act 1987
MITCHELL PLANNING SCHEME
Notice of Approval of Amendment
Amendment C26

The Minister for Planning has approved Amendment C26 to the Mitchell Planning Scheme.

The Amendment comes into operation on the date this notice is published in the Government Gazette.

The Amendment alters Mitchell Planning Scheme Map No. 13HO so that the boundary of Habbies Howe Homestead, Dropmore Road, Dropmore is consistent with the Victorian Heritage Register.

A copy of the Amendment can be inspected, free of charge, during office hours, at the Department of Infrastructure, Planning Information Centre, Upper Plaza, Nauru House, 80 Collins Street, Melbourne and at the Northern Regional Office, 57 Lansell Street, Bendigo and at the offices of the Mitchell Shire Council, 113 High Street, Broadford.

PAUL JEROME
Executive Director
Planning, Heritage and
Building Division
Department of Infrastructure

Planning and Environment Act 1987

MORNINGTON PENINSULA
PLANNING SCHEME

Notice of Approval of Amendment

Amendment C36

The Minister for Planning has approved Amendment C36 to the Mornington Peninsula Planning Scheme.

The Amendment comes into operation on the date this notice is published in the Government Gazette.

The Amendment introduces and applies interim heritage protection over 68 heritage places identified through the Hastings District Heritage Study 2002, applying to the area of the former Shire of Hastings. The Amendment makes minor consequential changes to the Scheme as well.

A copy of the Amendment can be inspected, free of charge, during office hours, at the Department of Infrastructure, Planning Information Centre, Upper Plaza, Nauru House, 80 Collins Street, Melbourne and at the offices of the Mornington Peninsula Shire Council, Rosebud Office, Besgrove Street, Rosebud; Mornington Office, Queen Street, Mornington and Hastings Office, Marine Parade, Hastings.

PAUL JEROME
Executive Director
Planning, Heritage and
Building Division
Department of Infrastructure

Planning and Environment Act 1987

NILLUMBIK PLANNING SCHEME

Notice of Approval of Amendment

Amendment C3 (Part 2)

The Minister for Planning has approved Amendment C3 (Part 2) to the Nillumbik Planning Scheme.

The Amendment comes into operation on the date this notice is published in the Government Gazette.

The Amendment incorporates 31 identified heritage places into the Heritage Overlay of the Nillumbik Planning Scheme and revokes interim controls for each of the places and two other places (interim HO1 and HO43).

A copy of the Amendment can be inspected, free of charge, during office hours, at the Department of Infrastructure, Planning Information Centre, Upper Plaza, Nauru House, 80 Collins Street, Melbourne and at the offices of the Nillumbik Shire Council, Civic Drive, Greensborough.

PAUL JEROME
Executive Director
Planning, Heritage and
Building Division
Department of Infrastructure

Planning and Environment Act 1987

YARRA PLANNING SCHEME

Notice of Lapsing of Amendment

Amendment C10

Pursuant to Section 30(1)(a) of the **Planning and Environment Act 1987**, Amendment C10 to the Yarra Planning Scheme has lapsed.

The Amendment proposed to replace the Design and Development Overlay 2 with the Design and Development 4. The Overlay proposed to introduce specific building height, set back and building envelop controls to Punt Road and Hoddle Street and its immediate environs.

The Amendment lapsed on 25 February 2002.

PAUL JEROME
Executive Director
Planning, Heritage and
Building Division
Department of Infrastructure

ORDERS IN COUNCIL

Crown Land (Reserves) Act 1978

INCORPORATION OF COMMITTEES OF MANAGEMENT AND
APPOINTMENT OF CHAIRPERSONS

The Governor in Council under section 14A(1) of the **Crown Land (Reserves) Act 1978**, being satisfied that it is in the public interest to declare to be corporations the Committees of Management appointed under section 14(2) of the Act of the lands described in Column 1 of the schedule hereunder:—

- (a) declares that the Committees of Management shall be corporations;
- (b) assigns the names shown in Column 2 to the corporations; and
- under section 14B(3) of the Act, appoints the persons listed in Column 3 to be Chairpersons of the corporations.

SCHEDULE

Column 1 Reserve details	Column 2 Corporate name	Column 3 Chairperson
Fawcett Mechanics Institute Reserve – The land in the Parish of Alexandra permanently reserved for a Mechanics' Institute and Free Library by Order in Council of 14 November, 1887 (vide Government Gazette of 18 November, 1887 – page 3307) [Rs 5840].	Fawcett Mechanics Institute Reserve Committee of Management Incorporated	Geoff SPARKE
Lake Moodemere Reserve – The lands in the Parishes of Norong and Carlyle temporarily reserved for public purposes and recreation and permanently reserved for public purposes (Murray River Reserve) as shown bordered red and coloured yellow respectively on plan CN/14.9.94 attached to Department of Natural Resources and Environment File No.11/04645 as well as Crown Allotment 2001, Parish of Norong deemed to be temporarily reserved for the Conservation of an area of natural interest [11/04645]	Lake Moodemere Reserve Management Committee Incorporated	Malcolm David CAMPBELL
Gunbower Racecourse and Recreation Reserve – The land in the Parish of Patho temporarily reserved for Racecourse and other purposes of Public Recreation by Order in Council of 30 January, 1894 (vide Government Gazette of 2 February, 1894 – page 629) [Rs 4829]	Gunbower Racecourse and Recreation Reserve Incorporated	Greg TOLL

Column 1 Reserve details	Column 2 Corporate name	Column 3 Chairperson
Chetwynd Public Hall and Recreation Reserves – The lands in the Township of Chetwynd and Parish of Ganoo Ganoo temporarily reserved for a Public Hall by Order in Council of 23 October, 1905 and for Public Recreation by Orders in Council of 6 December, 1955 and 25 January, 1972 [Rs 2600 & Rs 7404]	Chetwynd Public Hall and Recreation Reserve Committee Incorporated	Ken STEPHENS
Tallangatta Public Hall Reserve – The land in the Parish of Beethang temporarily reserved for a Public Hall by Order in Council of 4 March, 1980 (vide Government Gazette of 12 March, 1980 – page 797) [Rs 10695].	Tallangatta Memorial Hall Incorporated	Norman Frank CRISP
Stawell Showgrounds Reserve – The land in the Parish of Stawell temporarily reserved for Public Purposes (Show Purposes) by Order in Council of 21 January, 1975 (vide Government Gazette of 29 January, 1975 – page 185) [Rs 8626].	Reg Coote Reserve Committee Incorporated	George Henry HOLDEN

This Order is effective from the date on which it is published in the Government Gazette.

Dated 19 March 2002

Responsible Minister

SHERRYL GARBUTT

Minister for Environment and Conservation

HELEN DOYE

Clerk of the Executive Council

Environment Protection Act 1970

VARIATION OF STATE ENVIRONMENT PROTECTION POLICY (GROUNDWATERS OF VICTORIA)

The Governor in Council under section 16(2) of the **Environment Protection Act 1970**, and on the recommendation of the Environment Protection Authority, declares the following variation to State environment protection policy (Groundwaters of Victoria) to be observed throughout Victoria.

1. Purpose

The purpose of this Order is to vary the State environment protection policy (Groundwaters of Victoria) (the principal policy).

2. Commencement

This Order will come into operation upon publication in the Government Gazette.

3. Variation

- (1) In clauses 3, 4, 9(2)(d), 10(2)(b) and 17(5) of the principal policy for “polluted groundwater zone” substitute “groundwater quality restricted use zone”.

(2) For clause 19 of the principal policy substitute –

“19. Groundwater quality restricted use zone

- (1) Where the Authority is satisfied that an existing level of contamination of groundwater precludes one or more beneficial uses that would otherwise apply to that groundwater, the Authority may identify a groundwater quality restricted use zone.
- (2) The Authority will require groundwater within groundwater quality restricted use zones to be:
 - (a) managed to contain polluted groundwater within the zone; and
 - (b) cleaned up to the extent practicable in order to move towards the objectives prescribed in this policy to protect beneficial uses.
- (3) The Authority will periodically require the reassessment of the practicability of clean up of polluted groundwater within groundwater quality restricted use zones.
- (4) The Authority will not issue or amend any works approval or licence, or transfer any licence in respect of any premises situated within a groundwater quality restricted use zone unless the Authority is satisfied that:
 - (a) beyond any proposed or currently designated attenuation zone there will not be any risk of further degradation of groundwater quality in the groundwater quality restricted use zone as a result of any activity or proposed activity at the premises; and
 - (b) there will not be any detriment to any beneficial use of surface waters or groundwater beyond the boundaries of the groundwater quality restricted use zone.

Dated 19 March 2002

Responsible Minister

SHERRYL GARBUTT

Minister for Environment and Conservation

HELEN DOYE

Clerk of the Executive Council

Shrine of Remembrance Act 1978

APPROVAL OF UNDERCROFT DEVELOPMENT

The Governor in Council under Section 2B (1) of the **Shrine of Remembrance Act 1978** approves the attached plan of survey and gives approval to the development by the trustees of the undercroft land as shown in the attached plan of survey in accordance with the plan and subject to the Minister for Environment and Conservation approving the final scope of works for the undercroft development and the Minister for Environment and Conservation being satisfied that sufficient funds are available to the trustees to commit to the undercroft development.

This Order is effective from the date on which it is published in the Government Gazette.

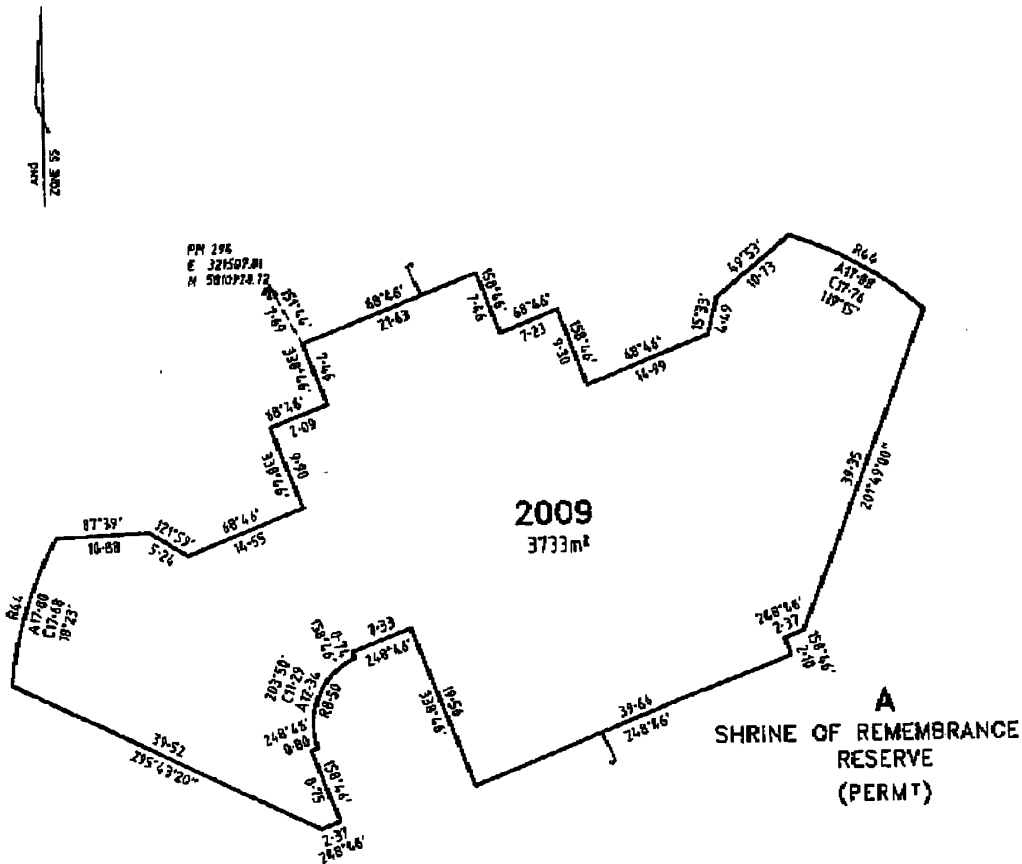

Dated 19 March 2002
 Responsible Minister
 SHERRYL GARBUTT
 Minister for Environment
 and Conservation

HELEN DOYE
 Clerk of the Executive Council

Land Act 1958

APPROVAL BY THE GOVERNOR IN COUNCIL TO THE SALE OF CROWN LAND BY PRIVATE TREATY

Order in Council

The Governor in Council, pursuant to Sections 99A(1)(a) & 99A(2) of the **Land Act 1958**, approves the sale by private treaty of the 8 parcels of Crown Land described in Schedule Number 99A/02/2002 attached to the Order.

Dated 19 March 2002
 Responsible Minister:
 JOHN LENDERS MP
 Minister for Finance

HELEN DOYE
 Clerk of the Executive Council

SCHEDULE NO. 99A/02/2002
PROPERTIES TO BE SOLD BY THE
DEPT OF NATURAL RESOURCES AND
ENVIRONMENT

1. **DESCRIPTION** Allotment 2001
Township of Wunghnu
AREA: 3.215 hectares
PROPERTY ADDRESS: Off Orchard Street
Wunghnu
 2. **DESCRIPTION** Allotment 2001
Parish of Baring
AREA: 309.9 hectares
PROPERTY ADDRESS: Off Pine Plains Road
Patchewollock
 3. **DESCRIPTION** Allotment 28D
Section A
Parish of Boorolite
AREA: 11.17 hectares
PROPERTY ADDRESS: Off Davies Road
Boorolite
 4. **DESCRIPTION** Allotment 2001
Parish of Timberoo
AREA: 92 hectares
PROPERTY ADDRESS: Off Hynams Road
Patchewollock North
 5. **DESCRIPTION** Allotment 2001
Parish of Patchewollock
North
AREA: 62.99 hectares
PROPERTY ADDRESS: Off Hynams Road
Patchewollock North
 6. **DESCRIPTION** Allotment 2001
Parish of Yelta
AREA: 230.7 hectares
PROPERTY ADDRESS: Cnr Boy Creek Road
and Fifth Street Yelta
 7. **DESCRIPTION** Allotments 2001 & 2002
Parish of Lillimur
AREA: 14.49 hectares
PROPERTY ADDRESS: Dave Dodsons Road
Kaniva
 8. **DESCRIPTION** Allotment 17
Section 24
Township of Edenhope
AREA: 18.33 hectares
PROPERTY ADDRESS: Wimmera Highway
Edenhope
-

**SUBORDINATE LEGISLATION ACT 1994
NOTICE THAT STATUTORY RULES ARE
OBTAINABLE**

Notice is hereby given under Section 17 (3) of the **Subordinate Legislation Act 1994** that the following Statutory Rules were first obtainable from Information Victoria, 356 Collins Street, Melbourne on the date specified:

17. *Statutory Rule:* Victorian Civil and Administrative Tribunal (Fees) (Further Amendment) Regulations 2002
Authorising Act: Victorian Civil and Administrative Tribunal Act 1998
Date first obtainable: 21 March 2002
Code A
18. *Statutory Rule:* Conservation, Forests and Lands (Infringement Notice) (Amendment) Regulations 2002
Authorising Act: Conservation, Forests and Lands Act 1987
Date first obtainable: 21 March 2002
Code B

Retail price will vary according to the number of pages in each special or periodical gazette. The table below sets out the prices that apply.

<i>Price Code</i>	<i>No. of Pages (Including cover and blank pages)</i>	<i>Price*</i>
A	1–16	\$3.15
B	17–32	\$4.70
C	33–48	\$6.45
D	49–96	\$10.00
E	97–144	\$13.00
F	145–192	\$15.40
G	193–240	\$17.50
H	241–288	\$18.90
I	289–352	\$21.25
J	353–416	\$24.80
K	417–480	\$28.35
L	481–544	\$33.10
M	545–608	\$37.80
N	609–672	\$42.55
O	673–736	\$47.30
P	737–800	\$52.00

**All Prices Include GST*

ADVERTISERS PLEASE NOTE

As from 21 March 2002

The last Special Gazette was No. 50 dated 19 March 2002

The last Periodical Gazette was No. 1 dated 29 May 2001

CONTENTS

	Page
Estates of Deceased Persons	498
Government and Outer Budget Sector	
Agencies Notices	503
Orders in Council	529
Acts — Crown Land (Reserves); Environment Protection; Shine of Remembrance; Land	
Private Advertisements	498
Proclamations	502

The Victoria Government Gazette is published by The Craftsman Press Pty. Ltd. with the authority of the Government Printer for the State of Victoria
© State of Victoria 2002

ISSN 0819-5471

This publication is copyright. No parts may be reproduced by any process except in accordance with the provisions of the Copyright Act.

Products and services advertised in this publication are not endorsed by The Craftsman Press Pty. Ltd. or the State of Victoria and neither of them accepts any responsibility for the content or the quality of reproduction. The Craftsman Press Pty. Ltd. reserves the right to reject any advertising material it considers unsuitable for government publication.

Address all enquiries to the Government Printer for the State of Victoria
Government Information and Communications Branch
Department of Premier and Cabinet
Level 3, 356 Collins Street
Melbourne 3000
Victoria Australia

RETAIL SALES

Information Victoria Bookshop
356 Collins Street Melbourne 3000.
Telephone enquiries 1300 366 356

City Graphics
Level 1, 520 Bourke Street
Melbourne 3000
Telephone enquiries (03) 9600 0977

Recommended Retail Price \$1.85 (includes GST)

Government and Outer Budget Sector Agencies please note:
STYLE REQUIREMENTS.

To ensure that material received can be reproduced, and that errors are minimised, the following guidelines are to be observed when submitting material by fax.

Fax resolution:

Material sent by fax should be transmitted using Fine Resolution (200 dots per inch by 200 dpi).

Font size:

Use 12 point (10 pitch) or larger.

Font Style:

Clear plain font styles, such as Helvetica, should be used.

Graphics:

Line drawings should be transmitted as large as possible to ensure clarity. Drawings up to A4 size sent by fax using Fine Resolution provide a good quality for reproduction.

Avoid:

Italics, underlining and full justification.

Ensure document is square when sending as documents that are sent skewed are difficult to read and process.

ISSN 0819-5471



9 770819 549151