



Victoria Government Gazette

No. S 80 Wednesday 31 March 2004

By Authority. Victorian Government Printer

Commonwealth Games Arrangements Act 2001

COMMONWEALTH GAMES PROJECT ORDER

In accordance with section 15 of the **Commonwealth Games Arrangements Act 2001** (“the Act”), as Minister administering the Act, I declare the Yarra Precinct Pedestrian Link a project to develop facilities at a Commonwealth Games venue to be a project to which the Act applies and I authorise the development of that project for the period commencing 1 April 2004 until 31 March 2006.

In accordance with sections 17 of the Act I specify that the Secretary to the Department for Victorian Communities, being a body corporate constituted under section 25A of the Act, as the body responsible for managing or developing the Commonwealth Games project to which this Order applies.

This Order shall take effect from the date of its publication in the Government Gazette.

Dated 30 March 2004

Responsible Minister
JUSTIN MADDEN MLC
Minister for Commonwealth Games

SPECIAL

Commonwealth Games Arrangements Act 2001

COMMONWEALTH GAMES VENUE ORDER

In accordance with section 14 of the **Commonwealth Games Arrangements Act 2001** (“the Act”), as the Minister administering the Act, I declare the following area of land to be a Commonwealth Games venue to which the Act applies:

the whole of the area of the “Yarra Precinct Pedestrian Link” defined and shown hatched on the plan numbered LEGL./03–219 (sheets 2 — 5) and attached to this venue Order.

This Order shall take effect from the date of its publication in the Government Gazette.

Dated 30 March 2004

Responsible Minister
JUSTIN MADDEN MLC
Minister for Commonwealth Games

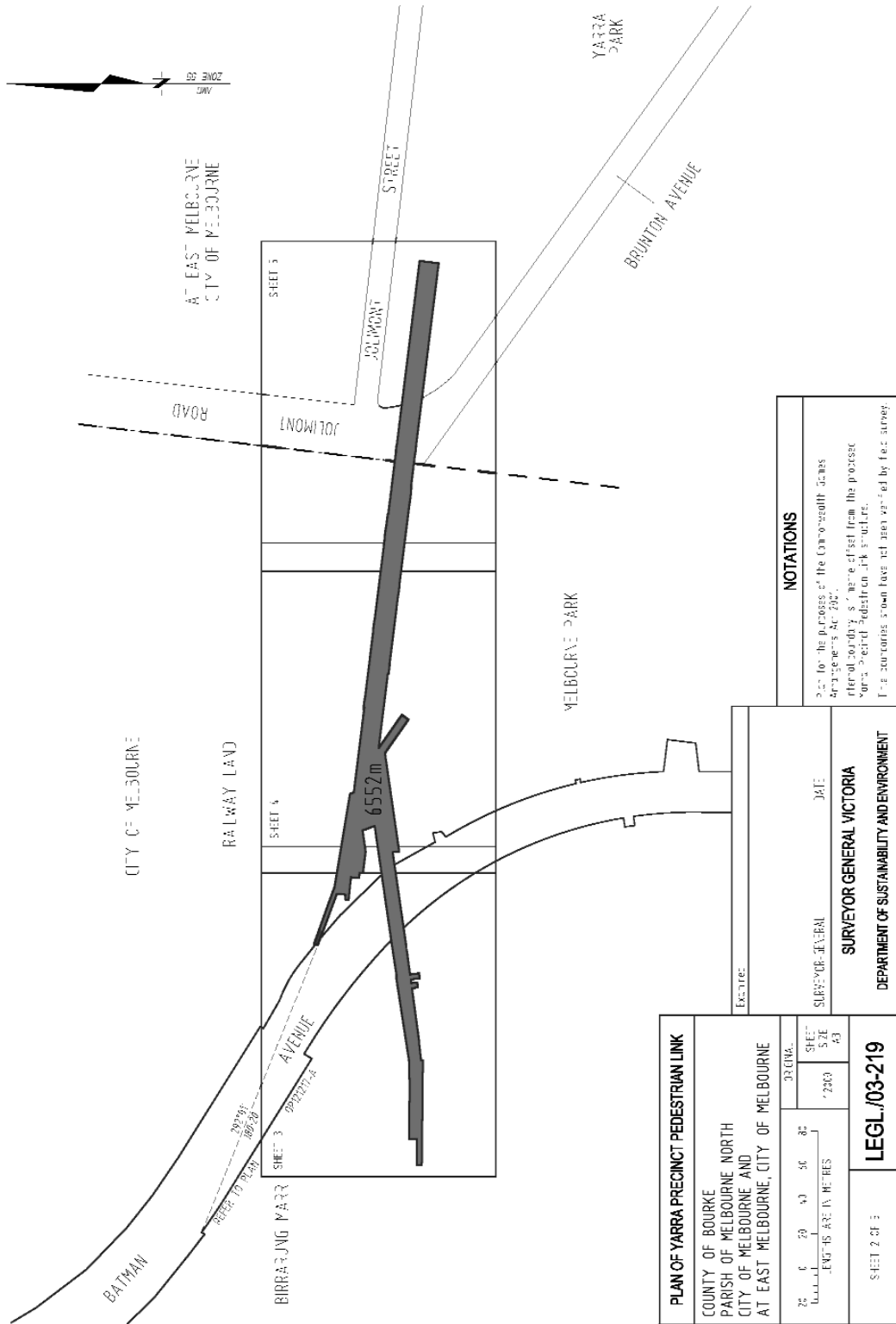

PLAN OF YARRA PRECINCT PEDESTRIAN LINK		SHEET 2 OF 3	
COUNTY OF BOURKE PARISH OF MELBOURNE NORTH CITY OF MELBOURNE AND AT EAST MELBOURNE, CITY OF MELBOURNE		LEG/L03-219	
SCALE	1:2000	SHEET	5 OF 43
DATE	12/03/04	SURVEYOR GENERAL	DATE
SURVEYOR GENERAL		SURVEYOR GENERAL VICTORIA	
DEPARTMENT OF SUSTAINABILITY AND ENVIRONMENT		DEPARTMENT OF SUSTAINABILITY AND ENVIRONMENT	

NOTATIONS

Plan for the purposes of the Commonwealth Access Arrangements Act 2002.
 Internal boundary shown as offset from the proposed works. Precinct Pedestrian Link structure.
 The boundaries shown have not been verified by field survey.

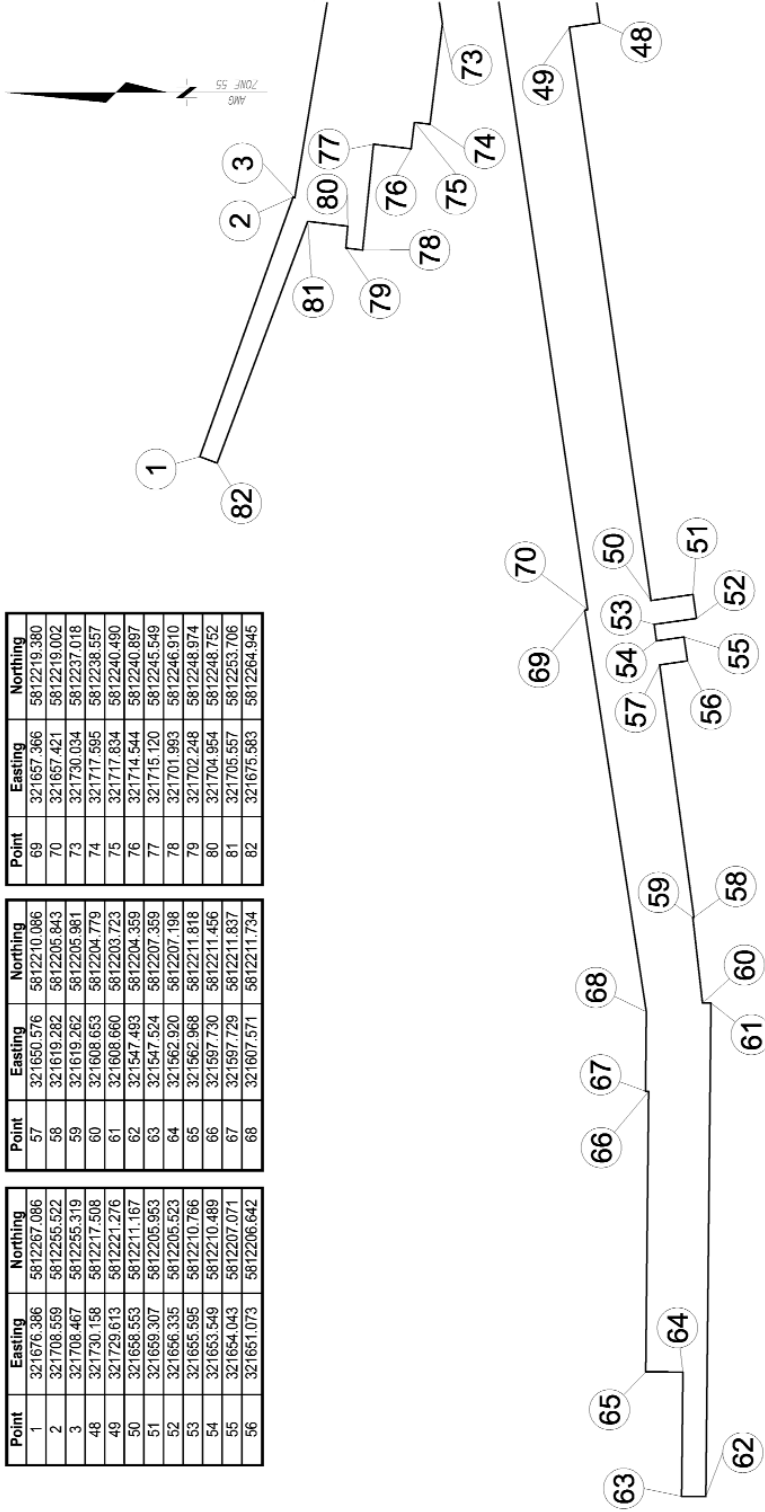

Point	Easting	Northing
69	321657.366	5812219.380
70	321657.421	5812219.002
73	321730.034	5812237.018
74	321717.595	5812238.657
75	321717.834	5812240.490
76	321714.544	5812240.887
77	321715.120	5812245.549
78	321701.993	5812246.910
79	321702.248	5812248.974
80	321704.954	5812248.752
81	321705.567	5812253.706
82	321675.583	5812264.945

Point	Easting	Northing
57	321650.576	5812210.086
58	321619.282	5812205.843
59	321619.262	5812205.981
60	321608.653	5812204.779
61	321608.660	5812203.723
62	321547.493	5812204.359
63	321547.524	5812207.359
64	321562.920	5812207.198
65	321562.968	5812211.818
66	321567.730	5812211.456
67	321567.729	5812211.837
68	321607.571	5812211.734

Point	Easting	Northing
1	321676.386	5812257.086
2	321708.569	5812255.522
3	321708.467	5812255.319
48	321730.158	5812217.508
49	321729.613	5812221.276
50	321658.553	5812211.167
51	321659.307	5812205.953
52	321656.335	5812205.523
53	321655.595	5812210.766
54	321653.549	5812210.489
55	321654.043	5812207.071
56	321651.073	5812206.642

LEGL/03-219

SHEET 3 OF 5

Point	Eastings	Northings	Point	Eastings	Northings
4	321763.687	5812246.163	40	321839.338	5812223.054
5	321764.502	5812243.956	41	321839.576	5812222.885
6	321813.626	5812237.876	42	321833.805	5812223.600
7	321812.848	5812238.426	43	321833.027	5812224.150
8	321816.619	5812237.712	44	321790.372	5812229.429
9	321818.858	5812237.543	45	321809.618	5812215.981
10	321858.769	5812232.603	46	321806.903	5812212.096
11	321858.531	5812232.772	47	321787.329	5812225.773
12	321864.303	5812232.057	48	321730.158	5812217.508
13	321864.541	5812231.889	49	321729.613	5812221.276
36	321885.021	5812217.399	71	321744.896	5812231.609
37	321885.259	5812217.231	72	321742.317	5812238.793
38	321879.488	5812217.945	73	321730.034	5812237.018
39	321879.250	5812218.114			

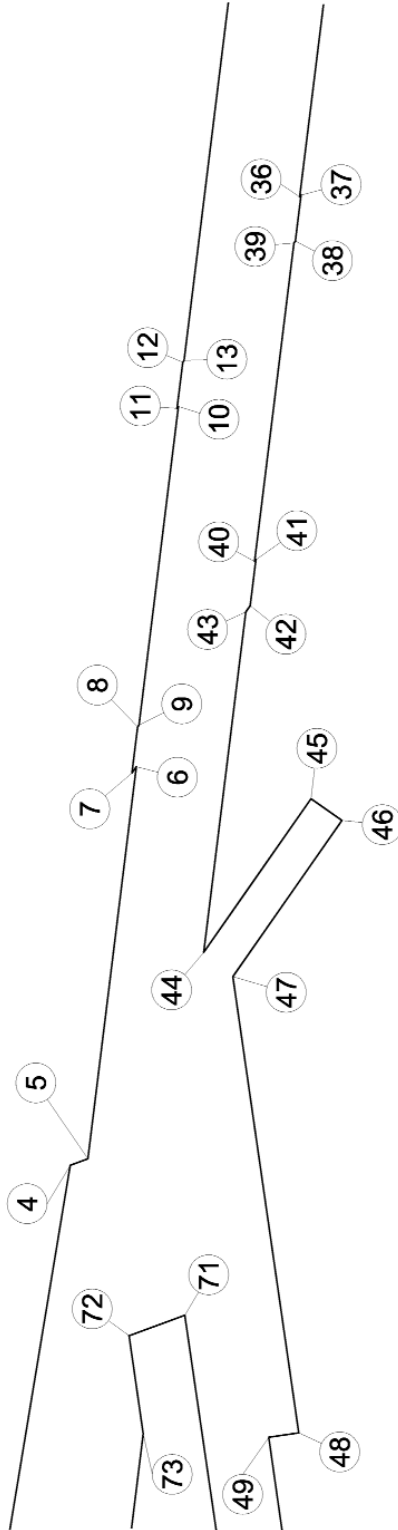

LEGL./03-219

SHEET 4 OF 5

Point	Easting	Northing	Point	Easting	Northing
14	321912.694	5812225.929	25	322072.318	5812194.534
15	321912.456	5812226.097	26	321964.732	5812207.849
16	321918.227	5812225.383	27	321964.715	5812207.709
17	321918.465	5812225.214	28	321961.985	5812208.047
18	321926.425	5812224.229	29	321962.003	5812208.187
19	321926.387	5812223.919	30	321942.414	5812210.611
20	321963.383	5812219.340	31	321942.375	5812210.301
21	321963.401	5812219.480	32	321938.945	5812210.725
22	321966.130	5812219.142	33	321939.183	5812210.557
23	321966.112	5812219.003	34	321933.412	5812211.271
24	322073.694	5812205.687	35	321933.174	5812211.439

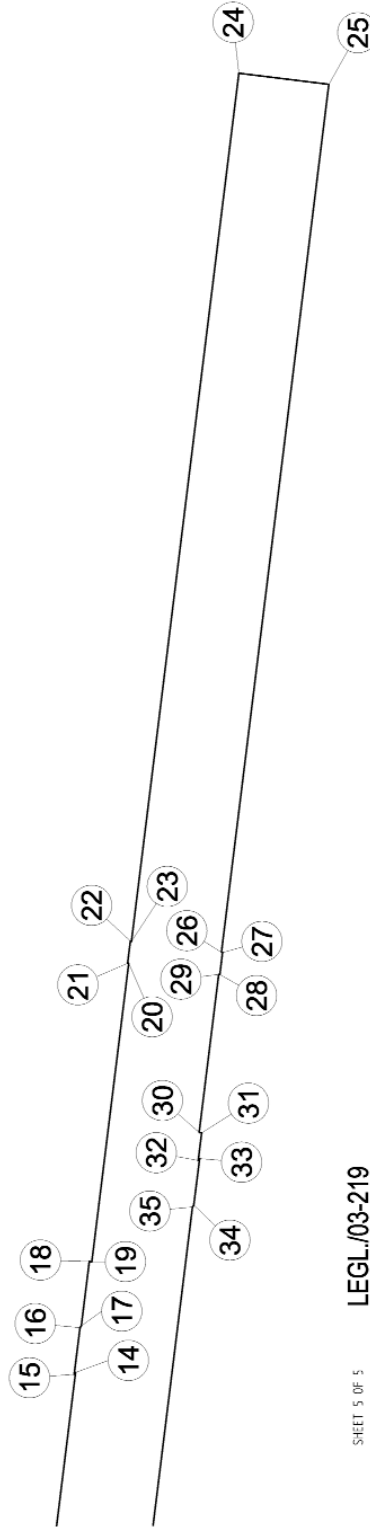

LEGL./03-219

SHEET 5 OF 5

This page left blank intentionally

craftsmanpress



The *Victoria Government Gazette* is published by The Craftsman Press Pty Ltd with the authority of the Government Printer for the State of Victoria

© State of Victoria 2004

This publication is copyright. No part may be reproduced by any process except in accordance with the provisions of the Copyright Act.

Address all enquiries to the Government Printer for the State of Victoria
Level 2 1 Macarthur Street
Melbourne 3002
Victoria Australia

How To Order



Mail Order

Craftsman Press Pty Ltd

125 Highbury Road
Burwood 3125

DX – 32510 Burwood



Telephone

(03) 9926 1233



Fax

(03) 9926 1292

email

gazette@craftpress.com.au



Retail & Mail Sales

Information Victoria

356 Collins Street
Melbourne 3000



Telephone

1300 366 356



Fax

(03) 9603 9920



Retail Sales

City Graphics

Level 1 520 Bourke Street
Melbourne 3000



Telephone

(03) 9600 0977



Fax

(03) 9600 0989

Price Code A