

Victoria Government Gazette

By Authority of Victorian Government Printer

No. G 38 Thursday 16 September 2004

www.gazette.vic.gov.au

GENERAL

TABLE OF PROVISIONS

Private Advertisements		Sales by the Sheriff	
Education Design Systems Pty Ltd	2541	Keith Balcombe	2546
Avalon Airport Australia Pty Ltd	2541	Unclaimed Moneys	
Dissolution of Partnership		MRPE Pty Ltd	2548
Apollo Bay Plumbing Warehouse	2541	Ray White Clayton	2548
Caffe Envy	2541	University of Melbourne	2548
Cafe 253	2542	Proclamations	2550
Estates of Deceased Persons		Government and Outer Budget Sector	
A. B. Natoli Pty	2542	Agencies Notices	2551
Biggs & Co.	2542	Orders in Council	2581
Chessell Williams	2542	Acts:	
Donaldson Trumble	2542	Cemeteries;	
E. P. Johnson & Davies	2543	Children and Young Persons;	
Equity Trustees Ltd	2543	Crown Land (Reserves);	
Garden & Green	2543	Land;	
Harris & Chambers	2543	Public Records	
Holding Redlich	2543		
Juliano Furletti & Scott	2544		
Kelly & Chapman	2544		
Maddocks	2544		
Mason Sier Turnbull	2545		
Mills Oakley	2545		
O'Brien & Galante	2545		
Osborne & Osborne Pty Ltd	2545		
Paul McGuinness & Assoc. Pty	2545		
Pietrzak	2545		
Rossi Ryan & Raniga	2545		
Stidston & Williams Weblaw	2546		
Verhoeven & Curtain	2546		
Verna A. Cook	2546		

Advertisers Please Note

As from 16 September 2004

The last Special Gazette was No. 200 dated 15 September 2004.

The last Periodical Gazette was No. 1 dated 17 June 2004.

How To Submit Copy

- See our webpage www.craftpress.com.au
 - or contact our office on 9926 1233
between 8.30 am and 5.30 pm Monday to Friday
-

Copies of recent Special Gazettes can now be viewed at the following display cabinets:

- 1 Treasury Place, Melbourne (behind the Old Treasury Building), and
 - Craftsman Press Pty Ltd, 125 Highbury Road, Burwood 3125
(front of building).
-

PRIVATE ADVERTISEMENTS

A two day course

Intelligence Procedures for Investigators

Education Design Systems now offers a two day course in 'Intelligence Procedures for Investigators', designed to develop and enhance investigative skills and processes for investigators who wish to develop their analytical skills and techniques. Focussing on the practical implementation of investigative best practice, we assist investigators to effectively gauge and react to issues uncovered during investigations and to utilise these skills to develop efficient and effective strategic responses.

Analytic and charting skills are developed in an interactive and sequential learning environment where participants are encouraged to share their experiences and perspectives on the role of investigator and the ethics and attributes necessary for high quality performance.

Now in its 16th year EDS has provided cost effective, high quality, professional development for over 8500 private and government sector investigators.

Dates: Thursday 7th - Friday 8th October 2004

Venue: Downtowner on Lygon, 66 Lygon Street, Carlton

Cost: \$880.00 including GST, morning and afternoon refreshments and course handbook

For registration or further information please contact Conference Co-ordinators at conference@confco.com.au or on 02 6292 9000.

Full course information at www.educationdesignsystems.com.au.



EDUCATION DESIGN SYSTEMS PTY LTD

Quality endorsed in accord with international standard AS/NZS ISO 9001:2000.
QA Licence Number QEC20726.



Excellence in Professional Development

Aerodrome Landing Fees Act 2003

AERODROME FEES NOTICE

Avalon Airport Australia Pty Ltd gives notice that the following fees have, under the **Aerodrome Landing Fees Act 2003** ("Act"), been fixed and operate at Avalon Airport on and from 1 September 2004.

A fee per arrival for:

All aircraft, of \$7 per 1,000 kilograms (pro-rata) of the aircraft's maximum take-off weight with a minimum charge per arrival of \$35; and

Each approach including a training flight (as defined under the Act) is an arrival.

The above fees do not include GST.

DISSOLUTION OF PARTNERSHIP

Take notice that the partnership heretofore subsisting between David John Jones and Stefan Christopher Traube at 75 Montrose Avenue, Apollo Bay, carrying on the business of selling plumbing fixtures and fittings under the style or

firm name of Apollo Bay Plumbing Warehouse was dissolved on 30 June 2004 pursuant to S. 36(c) of the **Partnership Act 1958** and Stefan Christopher Traube will continue to carry on such business.

DISSOLUTION OF PARTNERSHIP

Notice pursuant to Section 41 of
Partnership Act 1958

Take notice that the partnership previously subsisting between Vivian Joy Boin and Nigel Marcus Nicholls and carrying on the café/takeaway food business under the name and style of Caffe Envy at 1122 Glenhantly Road, Glenhantly has been dissolved as from 14 January 2004.

Vivian Joy Boin will be no longer responsible or have any liability with regard to the debts of the partnership incurred after the date of dissolution.

VIVIAN JOY BOIN

DISSOLUTION OF PARTNERSHIP

Notice pursuant to Section 41 of
Partnership Act 1958

Take notice that the partnership previously subsisting between Vivian Joy Boin and Nigel Marcus Nicholls and carrying on the café/takeaway food business under the name and style of Café 253 at 251–253 Charman Road, Cheltenham has been dissolved as from 19 September 2003.

Vivian Joy Boin will be no longer responsible or have any liability with regard to the debts of the partnership incurred after the date of dissolution.

VIVIAN JOY BOIN

MICHAEL GERARD CALLINAN, late of 22 Younger Street, Wangaratta, Victoria, arborist, deceased.

Creditors, next-of-kin and others having claims in respect of the estate of the abovenamed deceased, who died on 6 June 2004, are required by Brenda Mary Purtell, the executor of the deceased's Will, to send particulars of their claim to the said executor care of the undermentioned solicitors by a date not later than two months from the date of publication hereof, after which date she will convey or distribute the assets having regard only to the claims of which she then has notice.

A. B. NATOLI PTY, solicitors,
24 Cotham Road, Kew 3101.

STANLEY DANDO, late of 1/23 Hull Street, Hawthorn, Victoria, retired, deceased.

Creditors, next-of-kin and others having claims in respect of the estate of the abovenamed deceased, who died on 18 April 2004, are required by Paul Morris Natoli, the executor of the deceased's Will, to send particulars of their claim to the said executor care of the undermentioned solicitors by a date not later than two months from the date of publication hereof, after which date he will convey or distribute the assets having regard only to the claims of which he then has notice.

A. B. NATOLI PTY, solicitors,
24 Cotham Road, Kew 3101.

Re: Estate of the late BETTY CLINNICK, also known as JOAN LORRAINE CLINNICK, deceased.

Creditors, next-of-kin and all persons having claims against the estate of BETTY CLINNICK, also known as JOAN LORRAINE CLINNICK, late of 14 Herman Street, Rosebud, deceased, who died on 23 June 2004, are required to send particulars to the administrator Rosemary Jean Hickey care of Biggs & Co., 2273 Point Nepean Road, Rye, Victoria 3941 on or before 30 November 2004, after which date she will distribute the assets having regard only to the claims of which she shall then have notice.

BIGGS & CO., solicitors,
2273 Point Nepean Road, Rye, Victoria 3941.

Estate of DOROTHY JOYCE DENNY.

Creditors, next-of-kin and others having claims against the estate of DOROTHY JOYCE DENNY, late of Arlington Nursing Home, 3 Collins Street, Thornbury, Victoria, widow, deceased, who died on 15 June 2004, are requested to send particulars of their claims to the executor care of the undermentioned solicitors by 20 November 2004, after which date he will distribute the assets having regard only to the claims on which date he then has notice.

CHESSELL WILLIAMS, solicitors,
379 Collins Street, Melbourne, 3000.

DIETER JOACHIM BLASSE, late of 16 Stawell Street, Beaumaris, Victoria, company director, deceased.

Creditors, next-of-kin and others having claims in respect of the estate of the deceased, who died on 1 September 2003, are required by the executors, Roger Paul Blasse of 15 Hornby Street, Beaumaris, Victoria and Ian Geoffrey Poupard of 11 Jedburgh Place, Greenvale, Victoria, to send particulars to the said Roger Paul Blasse by 20 December 2004 after which date the executors may convey or distribute the assets having regard only to the claims of which they then have notice.

DONALDSON TRUMBLE, lawyers,
Level 5, 84 William Street, Melbourne.

Re: EDWARD ERIC RODDA, deceased.

Creditors, next-of-kin and others having claims in respect of the estate of EDWARD ERIC RODDA, late of The Willows, 171 Jells Road, Wheelers Hill, Victoria, who died on 27 April 2004, are to send particulars of their claims to the executor care of the undermentioned solicitors by 6 December 2004 after which date the executor will distribute the assets having regard only to the claims of which the executor then has notice.

E. P. JOHNSON & DAVIES, solicitors,
52 Collins Street, Melbourne, 3000.

Creditors, next-of-kin and others having claims in respect of the estate of GWLADYS JOAN CRACKNELL, late of Karana Community, Walpole Street, Kew, Victoria, but formerly of Flat 1, 20–26 Manningtree Road, Hawthorn, Victoria, deceased, who died on 25 May 2004, are required to send particulars of their claims to Equity Trustees Limited, ACN 004 031 298, of 575 Bourke Street, Melbourne, Victoria, the executor of the Will of the deceased, by 18 November 2004, after which date the executor may distribute the assets, having regard only to the claims of which it then has notice.

EQUITY TRUSTEES LIMITED,
Level 2,
575 Bourke Street, Melbourne, Vic. 3000.

Re: JOHN ALAN CADD, late of 2036 Pental Island Road, Swan Hill, Victoria, farmer, deceased.

Creditors, next-of-kin and others having claims in respect of the estate of the deceased, who died on 25 March 2004, are required by the trustee, Barbara Cadd, to send particulars to her care of the undermentioned solicitors by 17 November 2004, after which date the trustee may convey or distribute the assets, having regard only to the claims of which they have notice.

GARDEN & GREEN, solicitors,
4 McCallum Street, Swan Hill 3585.

Re: LORNA JOAN PROCKTER, late of 15 Kima Street, Swan Hill, Victoria, home duties, deceased.

Creditors, next-of-kin and others having claims in respect of the estate of the deceased, who died on 9 March 2004, are required by the trustees, Colin James Prockter and Rodney John Prockter, to send particulars to them care of the undermentioned solicitors by 17 November 2004, after which date the trustees may convey or distribute the assets, having regard only to the claims of which they have notice.

GARDEN & GREEN, solicitors,
4 McCallum Street, Swan Hill 3585.

Re: JACK PARKEN WHITFIELD, late of 32 Churchill Avenue, Cheltenham, Victoria, plumber, deceased.

Creditors, next-of-kin and others having claims in respect of the estate of the deceased, who died on 10 July 2004, are required by the trustee, care of Harris & Chambers, lawyers, to send particulars to her by 17 November 2004 after which date the trustee may convey or distribute the assets, having regard only to the claims of which the trustee then has notice.

HARRIS & CHAMBERS, lawyers,
338 Charman Road, Cheltenham 3192.

Creditors, next-of-kin and others having claims in respect of the estate of GEORGE GANAVAS, deceased, who died on 23 September 2003, are required by the trustee, Irimi Ganavas, to send particulars to the trustee care of the undermentioned solicitors by 16 November 2004 after which date the trustee may convey or distribute the assets, having regard only to the claims of which they then have notice.

HOLDING REDLICH, solicitors,
350 William Street, Melbourne.

Creditors, next-of-kin and others having claims in respect of the estate of RICHARD ELGIN McGARVIE, deceased, who died on 24 May 2003, are required by the trustees, Sheila Lesley McGarvie and Richard Wallace McGarvie, to send particulars to the trustees care of the undermentioned solicitors by 16 November 2004 after which date the trustees may convey or distribute the assets, having regard only to the claims of which they then have notice.

HOLDING REDLICH, solicitors,
350 William Street, Melbourne.

Creditors, next-of-kin and others having claims in respect of the estate of ROBERT DAVID GRANT, deceased, who died on 17 January 2004, are required by the administrator, Ginette Grant, to send particulars to the trustee care of the undermentioned solicitors by 16 November 2004 after which date the trustee may convey or distribute the assets, having regard only to the claims of which she then has notice.

HOLDING REDLICH, solicitors,
350 William Street, Melbourne.

Creditors, next-of-kin and others having claims against the estate of MARIA GIUSEPPINA NATALE (in the Will called Giuseppa Natale), late of 3 Wilson Street, Moonee Ponds, Victoria, home duties, deceased, who died on 11 February 2003, are required to send particulars of their claims to the executor, Concetta Amalfi, care of the undermentioned solicitors before the expiration of two calendar months of the date of the publication of this notice after which date the executor will distribute the assets having regard only to the claims of which she then has notice.

JULIANO FURLETTI & SCOTT, solicitors,
Level 2, 19-21 Argyle Place South, Carlton,
Victoria 3053.

Creditors, next-of-kin and others having claims in respect of the estate of PHYLLIS ALBERTINE WARREN, late of 157 Male Street, Brighton, Victoria, widow, deceased, who died on 27 June 2004, are required by the executor, namely Graham Ross Warren of 21 Bruce Street, Bentleigh, Victoria, meteorologist, one of the executors nominated in the deceased's last Will and Testament dated 6 March 1979, who is applying to the Supreme Court for a Grant of Probate of the said last Will and Testament, to send particulars of such claims to the solicitors acting for the said executor, namely Kelly & Chapman of 300 Centre Road, Bentleigh, by 25 November 2004 after which date the said executor may convey or distribute the assets of the deceased, having regard only to claims of which the executor or his solicitors then have notice.

KELLY & CHAPMAN, lawyers,
300 Centre Road, Bentleigh.

Re: MARGOT LESLEY CURTIS, late of 8 Dunlop Avenue, Kew, Victoria, widow, deceased.

Creditors, next-of-kin and others having claims in respect of the estate of the deceased, who died on 16 June 2004, are required by the trustees, Susan Gale McPhail and Perpetual Trustees Consolidated Limited of 360 Collins Street, Melbourne, Victoria, to send particulars to the trustees by 16 November 2004 after which date the trustees may convey or distribute the assets, having regard only to the claims of which the trustees have notice.

MADDOCKS, lawyers,
140 William Street, Melbourne 3000.

Re: ROLAND JAMES LANGMAN, late of 14 Glyndebourne Avenue, Toorak, Victoria, company director, deceased.

Creditors, next-of-kin and others having claims in respect of the estate of the deceased, who died on 5 June 2004, are required by the trustees, Perpetual Trustees Victoria Limited of 360 Collins Street, Melbourne, Victoria and James Alistair Cairnes Langman of 4 Pine Avenue, Camberwell, Victoria, to send particulars to the trustees by 16 November 2004 after which date the trustees may convey or distribute the assets, having regard only to the claims of which the trustees have notice.

MADDOCKS, lawyers,
140 William Street, Melbourne 3000.

Re: MARY NIALL, late of Central Park, 101 Punt Road, Windsor, gentlewoman, deceased.

Creditors, next-of-kin and others having claims in respect of the estate of the deceased, who died on 21 July 2004, are required by the trustee, Perpetual Trustees Victoria Limited of 360 Collins Street, Melbourne, Victoria, to send particulars to the trustee by 16 November 2004 after which date the trustee may convey or distribute the assets, having regard only to the claims of which the trustee has notice.

MADDOCKS, lawyers,
140 William Street, Melbourne 3000.

Re: ELIZABETH MARY UREN, late of Grandview Gardens Aged Care, 147-151 David Street, Dandenong, Victoria, deceased.

Creditors, next-of-kin and others having claims in respect of the estate of the deceased, who died on 16 July 2004, are required by the trustees, Margaret Elaine Baker and Elizabeth Ann Kuipers, to send particulars to the trustees care of the undermentioned solicitors by 15 November 2004 after which date the trustees may convey or distribute the assets having regard only to the claims of which the trustees have notice.

MASON SIER TURNBULL, solicitors,
315 Ferntree Gully Road, Mount Waverley 3149.

Re: MARY GILPIN, late of 1/292 The Avenue, Parkville, Victoria, widow, deceased.

Creditors, next-of-kin and others having claims in respect of the estate of the deceased, who died on 24 August 2004, are required by the executor, ANZ Executors & Trustee Company Limited (ABN 33 006 132 332) of 530 Collins Street, Melbourne, Victoria, to send particulars to it by 16 November 2004 after which date it may convey or distribute the assets having regard only to the claims of which it then has notice.

MILLS OAKLEY, lawyers,
121 William Street, Melbourne.

MARY FISHER, late of 21 Elstone Avenue, Airport West, Victoria, home duties, deceased.

Creditors, next-of-kin and others having claims in respect of the estate of the abovenamed deceased, who died on 15 July 2004, are to send particulars of their claims to the executor, June Elizabeth Healey, care of the undermentioned solicitors by 30 November 2004 after which date the said executor will distribute the assets having regard only to the claims of which she then has notice.

O'BRIEN & GALANTE, solicitors,
27 Norwood Crescent, Moonee Ponds.

Re: Estate of JOHN MILES PARDOE, late of 14 Smythe Street, Avenel, Victoria, retired, deceased.

Creditors, next-of-kin and others having claims in respect of the estate of the deceased, who died on 19 April 2004, are required by the trustee, Warren Stephen Osborne of 6 Wallis Street, Seymour, Victoria, solicitor, to send particulars to the trustee by 17 December 2004 after which date the trustee may convey or distribute the assets, having regard only to the claims of which the trustee has notice.

OSBORNE & OSBORNE PTY LTD, solicitors,
6 Wallis Street, Seymour 3660.

RALPH COMRIE NISH, late of Fairhaven, Morning Street, Maryborough, Queensland, retired, deceased.

Creditors, next-of-kin and others having claims in respect of the estate of the deceased, who died on 9 February 2004, are required to send particulars of their claims to the trustee care of the undermentioned solicitors by 6 December 2004 after which date the trustee or personal representative or applicant for grant of administration may convey or distribute the assets, having regard only to the claims of which he then has notice.

PAUL McGUINNESS & ASSOC. PTY,
solicitors,
3 Eighth Avenue, Rosebud 3939.

Creditors, next-of-kin and others having claims in respect to the estate of WERONIKA KAZIUKAJTIS, late of 17 Kilsyth Avenue, Burwood in the State of Victoria, pensioner, deceased, who died on 18 August 2004, are required to send particulars of such claims to the executor, care of the undermentioned solicitors, by 8 November 2004 after which date the executor will convey or distribute the assets having regard only to the claims of which the executor then has notice.

PIETRZAK, solicitors,
222 Latrobe Street, Melbourne.

Re: WILMA ELLA DIMSEY, deceased, late of Unit 2/25 Albury Road, North Balwyn, Victoria, widow.

Creditors, next-of-kin and others having claims in respect of the estate of the deceased, who died on 12 March 2004, are required by Janice Crosswhite, in the Will called Janet Crosswhite, the proving executrix of the

deceased's Will, to send particulars of their claims to the executrix care of the undermentioned solicitors by 16 November 2004 after which date the executrix may convey or distribute the assets having regard only to the claims of which she then has notice.

ROSSI RYAN & RANIGA, legal practitioners,
PO Box 20, East Brunswick, Victoria.

DOROTHY MAY PANNIER, late of Somer Care, 22 Graf Road, Somerville, Victoria. Creditors, next-of-kin and others having claims in respect of the estate of the deceased, who died on 4 June 2004, are required by the executrix, Shirley Anne Pettigrove of 20 McGregor Avenue, Mount Martha, Victoria, to send particulars to her by 20 November 2004 after which date the executrix may convey or distribute the assets, having regard only to the claims of which she then has notice.

STIDSTON & WILLIAMS WEBLAW,
solicitors,
Suite 1, 10 Blamey Place, Mornington.

EDNA ROSA COOKSON, late of Southern Cross Homes, Springvale Road, Springvale, Victoria.

Creditors, next-of-kin and others having claims in respect of the estate of the deceased, who died on 11 May 2004, are required by the executrix, Rosemary Edna Arkcoll of 24 Jackson Street, Mount Martha, Victoria, to send particulars to her by 20 November 2004 after which date the executrix may convey or distribute the assets, having regard only to the claims of which she then has notice.

STIDSTON & WILLIAMS WEBLAW,
solicitors,
Suite 1, 10 Blamey Place, Mornington.

ANDREW ARNOTT MCLEOD, late of RMB 5084 Old Telegraph Road, Rokeby in the State of Victoria, storeman, deceased.

Creditors, next-of-kin and others having claims in respect of the estate of the deceased, who died on 8 March 2004, are required by the personal representatives, Jo-Anne Sharman and Michelle McLeod, to send particulars to them care of the undermentioned solicitors by 29 November 2004 after which date the personal

representatives may convey or distribute the assets, having regard only to the claims of which they then have notice.

VERHOEVEN & CURTAIN, solicitors,
136 Commercial Road, Morwell.
Suite 4, 46 Haigh Street, Moe.

DENIS BARRY-MURPHY, late of 38 Cansick Street, Rosedale in the State of Victoria, unit controller, deceased.

Creditors, next-of-kin and others having claims in respect of the estate of the deceased, who died on 10 September 2003, are required by the personal representatives, Margaret Anne Blanck and Catherine Ellen Barry-Murphy, to send particulars to them care of the undermentioned solicitors by 22 November 2004 after which date the personal representatives may convey or distribute the assets, having regard only to the claims of which they then have notice.

VERHOEVEN & CURTAIN, solicitors,
136 Commercial Road, Morwell.
Suite 4, 46 Haigh Street, Moe.

ELIZABETH JEAN CLARK, deceased.

Creditors, next-of-kin and others having claims against the estate of Elizabeth Jean Clark, late of Villa 36, 155 Warrigal Road, Burwood, Victoria, widow, deceased, who died on 20 June 2004, are required to send particulars of their claims to the executors care of the undermentioned solicitor by 23 November 2004, after which date the executors will proceed to distribute the assets, having regard only to the claims of which they shall then have had notice.

VERNA A. COOK, solicitor,
5/8 St Andrews Street, Brighton 3186.

In the Supreme Court of the State of Victoria
SALE BY THE SHERIFF

On Wednesday 13 October 2004 at 2.30 p.m. at the Sheriff's Office, 8-20 King Street, Oakleigh (unless process be stayed or satisfied).

All the estate and interest (if any) of Keith Balcombe of 25 Mulcare Street, Nar Nar Goon, as shown on Certificate of Title as Keith Lindsay Balcombe, joint proprietor with Brogitte Sybylla Smedley of an estate in fee

simple in the land described on Certificate of Title Volume 6813, Folio 473 upon which is a dwelling known as 25 Mulcare Street, Nar Nar Goon.

Registered Mortgage No. AB163739Y affects the said estate and interest.

Terms – Cash/Eftpos
(Debit Cards only. No Credit Cards).
SW-04-002991-3

Dated 9 September 2004

V. PARKIN
Sheriff's Office

Unclaimed Moneys Act 1962

Register of Unclaimed Moneys held by the —

<i>Name of Owner on Books and Last Known Address</i>	<i>Total Amount Due to Owner</i>	<i>Description Of Unclaimed Money</i>	<i>Date when first became Payable</i>
MPRE PTY LTD			
	\$		
Julia White	500.00	Cheque	02/08/03
04263 CONTACT: KERRI ROBERTSON, PHONE: (03) 9781 5211.			

Unclaimed Moneys Act 1962

Register of Unclaimed Moneys held by the —

<i>Name of Owner on Books and Last Known Address</i>	<i>Total Amount Due to Owner</i>	<i>Description Of Unclaimed Money</i>	<i>Date when first became Payable</i>
RAY WHITE CLAYTON			
	\$		
Cenk & Nil Barut, 505B Clayton Road, Clayton	170.06	Cheque	19/03/01
04233 CONTACT: IRENE KARAMALLOUDIS, PHONE: (03) 9543 7088.			

Unclaimed Moneys Act 1962

Register of Unclaimed Moneys held by the —

<i>Name of Owner on Books and Last Known Address</i>	<i>Total Amount Due to Owner</i>	<i>Description Of Unclaimed Money</i>	<i>Date when first became Payable</i>
UNIVERSITY OF MELBOURNE			
	\$		
Chris Wheat, 49 Elgin Street, Hawthorn	100.00	Cheque	03/05/02
Chris Wheat, 49 Elgin Street, Hawthorn	100.00	"	22/07/02
Chris Wheat, 49 Elgin Street, Hawthorn	100.00	"	10/10/02
Shane Morris, 2a Mollison Street, Abbotsford	104.00	"	09/04/02
Kelly, Daniel Joseph, 620 Westernport Hwy, Cranbourne	108.00	"	15/11/02
Mr Dan Disney, 5 Batman Street, Fitzroy North	111.92	"	25/07/02
Monash Unicomm, PO Box 1535, Clayton South	113.69	"	15/11/02

APPS, Dr Rick Lang, Department of Physiology, Monash University, Clayton	120.00	''	29/10/02
Yuko Nagano, C/- Debbie Wallace LTRC, University of Melbourne	120.00	''	19/04/02
Naoko Imazu, C/- Debbie Wallace LTRC, University of Melbourne	120.00	''	26/04/02
Dr Hugh Millar, 183 Victoria Parade, Fitzroy	131.00	''	17/01/02
Paul John Clarke, 24 Studley Park Road, Kew	132.00	''	02/12/02
Total Auto Group P/L, 644 Victoria Street, North Melbourne	147.28	''	15/05/02
Cavin Ashley Adams, 6/101 Palmerston Street, Carlton	150.00	''	11/12/02
Mohammed Habib Tuferu, 16/36 Holmes Street, Brunswick	150.00	''	17/06/02
Fiona McIntyre Finlayson, C/- Sages, University of Melbourne, Parkville	154.15	''	05/12/02
Automation Systems & Machine Development, Unit 3, 38-40 Brunswick Road, Mitcham	165.00	''	28/11/02
Waite Group, PO Box 1051, Moonee Ponds	176.00	''	20/05/02
Stuart Anthony Prentice, 43 Amelia Avenue, Wheelers Hill	185.32	''	12/11/02
Dr Katrina Amanda Alford, 315 Marionvale Road, Katandra	193.86	''	02/12/02
Bipina Behari Dhal, 12C/131 Lonsdale Street, Lonsdale Height Apartment, Melbourne	197.53	''	08/07/02
Madoka Miyamoto, 14 Lambert Street, Richmond	200.00	''	18/06/02
Ms Tiffany Karabatsas, 23 Dechene Parade, Coburg	200.00	''	11/12/02
Alex Smith, C/- Faculty of Engineering, University of Melbourne, Parkville	200.00	''	12/09/02
Bernard James Schrader, 27 Regent Street, Shepparton	209.03	''	13/05/02
Hsiao Su-An Sandy, 18/38 Grange Road, Toorak	217.00	''	25/02/02
A Y Company Pty Ltd, 2/318-322 Little Collins Street, Melbourne	271.50	''	18/12/02
Springvale AMES, Cnr Springvale Road & Boulton Street, Springvale	272.25	''	05/12/02
Ms Jane Forse, 55/158 Starke Street, Holt, ACT	279.64	''	30/05/02
Allan McLean, 8/5 Garran Place, Garran, ACT	281.00	''	18/11/02
Emily Wilson, 4/13 Wanda Road, Caulfield North	283.60	''	22/08/02
Emily Wilson, 4/13 Wanda Road, Caulfield North	283.60	''	12/11/02
Ms Kate Regan, 384 Church Street, Richmond	360.00	''	19/04/02
Ms Leona Quek, 590 Lygon Street, Carlton	370.30	''	05/02/02
Ann Cecile Marie Taille, 1/37 Narong Road, Caulfield North	384.06	''	21/11/02
Lauren Kate Gurrieri, 37 Leslie Road, Essendon	403.82	''	13/09/02
Laetitia Vellutini, 3/43 Barkly Street, Carlton	450.00	''	01/07/02
Luke Maher, PO Box 79, Nyah West	485.00	''	28/11/02
Australian Neuroscience Society Inc, ANS 2003 Secretariat, PO Box 2331, Kent Town Private Boxes, SA	495.00	''	17/12/02
D.W. & R.M. Hannigan, C/- Paul Hannigan, RMB 509, Charlton	574.70	''	12/12/02
Mr Wei Kang Yeo, 5/29 The Avenue, Prahran	600.00	''	''
Mary Vaile, 16/9 Park Avenue, Glen Huntly	712.88	''	13/12/02
Brunswick English Language Centre, 47 Dawson Street, Brunswick	866.25	''	09/12/02
Paul Gibson-Roy, 103 Moore Street, Coburg	1,500.00	''	31/07/02
Techrack Pty Ltd, 12 Summer Lane, Ringwood	2,046.44	''	17/12/02
Wei Cheng Adrian Fann, Unit 11/92 The Avenue, Parkville	5,000.00	''	16/12/02

04220

CONTACT: ROBYN GILLILAND, PHONE: (03) 8344 6044.

PROCLAMATIONS

Land Act 1958

PROCLAMATION OF ROAD

I, John Landy, Governor of Victoria with the advice of the Executive Council and under section 25(3)(c) of the **Land Act 1958** proclaim as road the following land:

MUNICIPAL DISTRICT OF THE CENTRAL GOLDFIELDS SHIRE COUNCIL
TALBOT – The land in the Township of Talbot, Parish of Amherst, being Crown Allotment 2001 shown by hatching on plan hereunder. (GP1559) – (0614624).

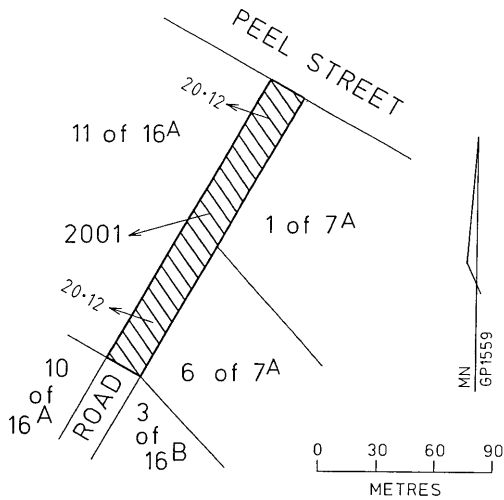

This Proclamation is effective from the date on which it is published in the Government Gazette.

Given under my hand and the seal of Victoria on 14th September 2004.

(L.S.) JOHN LANDY
Governor
By His Excellency's Command
MARY DELAHUNTY, MP
Minister for Planning

**GOVERNMENT AND OUTER BUDGET
SECTOR AGENCIES NOTICES**

MITCHELL SHIRE COUNCIL

Road Discontinuance and Road Deviation

Pursuant to Section 207E of the **Local Government Act 1989** and Item 3, Schedule 10, of the **Local Government Act 1989**, the Mitchell Shire Council at its ordinary meeting held on 14 October 2002 resolved to discontinue the road known Ashes Bridge Road (the land marked "C") and deviate the road (the land marked "A") on the road exchange plan below. The discontinued road (the land marked "C") is to be transferred to the property owner.

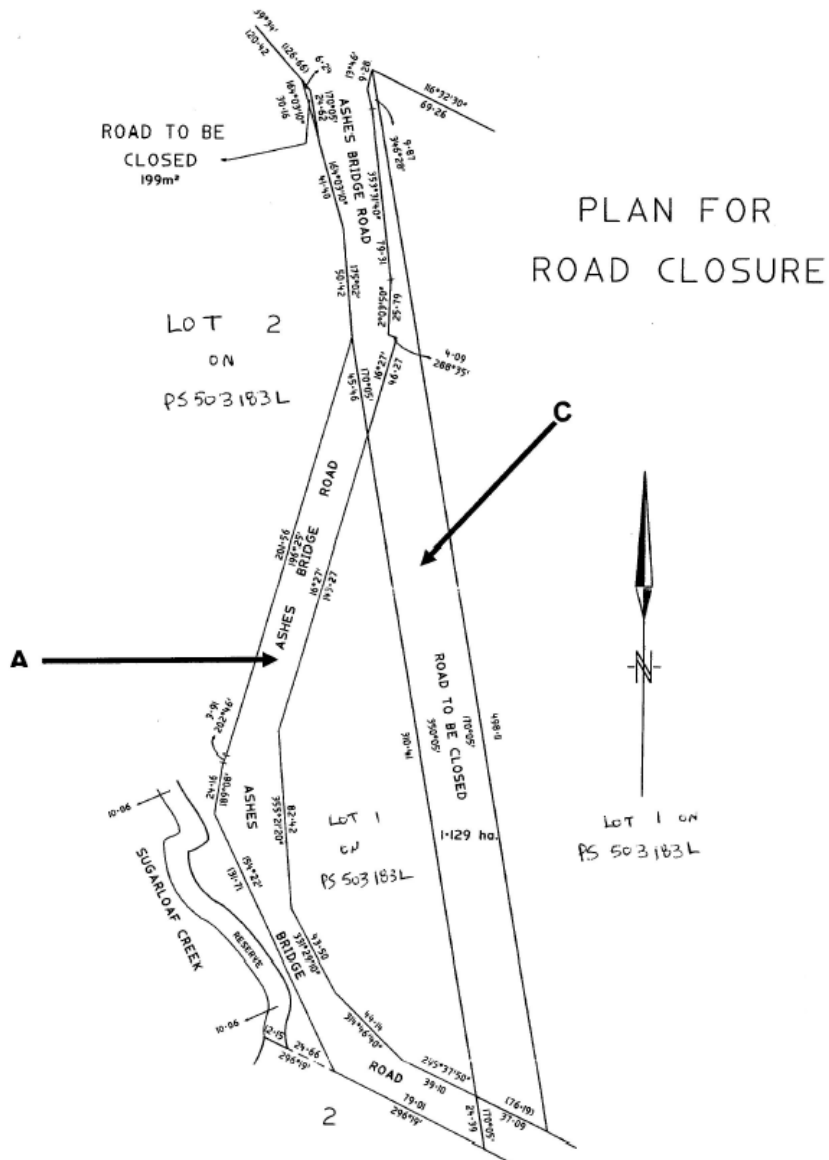

BAW BAW SHIRE COUNCIL

Notice of Intention to Make a
Road Management Plan

In accordance with the provisions of the **Road Management Act 2004**, Baw Baw Shire Council gives notice of its intention to make a Road Management Plan and invites public submission on the Draft Road Management Plan.

The purpose of the Road Management Plan is to identify and set the responsibility for road users and the levels of service for management and maintenance of assets within the road reserve, subject to Council funds.

Documents are available for inspection in either the Warragul Civic Centre, Infrastructure & Environment Department, Civic Place, Warragul; the Drouin Customer Service Centre, 33 Young Street, Drouin; or the Trafalgar Customer Service Centre, Princes Highway, Trafalgar.

Questions regarding the Draft Road Management Plan may be referred to Mr Colin Holmes, Executive Support Engineer on 5624 2510.

Submissions in writing, addressed to 'Baw Baw Shire Council – Road Management Plan', PO Box 304, Warragul, Victoria 3820, must be received by Council no later than 4.00 pm on Friday 22 October 2004.

JOHN F. DYER
Chief Executive Officer

Enforcement of Alcohol Possession
or Consumption

Benalla Rural City Council, in accordance with Clause 224A of the **Local Government Act 1989** does, by publishing this notice, state that any police officer may from 18 August 2004 to until this law becomes invalid, enforce the provisions of Benalla Rural City Council Local Law No. 2 – Municipal Places, Part 4 – Consumption and Possession of Alcoholic Beverages.

TONY McILROY
Chief Executive Officer

BULOKE SHIRE COUNCIL

Notice of Intention to make a
Road Management Plan

Buloke Shire Council proposes to make a Road Management Plan in accordance with Section 54 of the **Road Management Act 2004**.

The purpose of this initial version of the plan is to establish the existing system used to manage Council's road infrastructure. The plan records the relevant standard in relation to discharge of duties in the performance of those road management functions within the approved budget.

A copy of the proposed Road Management Plan may be inspected at each of Council's Customer Service Centres. Alternatively a copy may be obtained from Council's Technical Services Department, Birchip, phone (03) 5492 2200.

Any person who wishes to make comment to the proposed Road Management Plan may make a submission to Council within 28 days of the date of this notice.

Submissions should be addressed to the Manager Technical Services, Buloke Shire Council, PO Box 1, Wycheproof 3527, or emailed to assets@buloke.vic.gov.au.

MARK AMIRTHARAJAH
Chief Executive Officer

SOUTH GIPPSLAND SHIRE COUNCIL

Notice of Intention to Make Local Law
Proposed Local Law No. 13
(Amendment No. 1)

Council proposes to amend a Local Law No. 13, titled Process of Municipal Government (Meeting Procedure and Common Seal).

The purpose of the proposed Amendment Local Law is to –

- amend Local Law No. 13;
- provide for the peace, order and good government of the municipality;
- and provide for the uniform and fair administration of this Local Law.

The general purport of the Amendment Local Law is to make amendments to –

- Clause 7 – Election of Mayor and Chairpersons.

- Clauses 44 & 45 – Suspension of Standing Orders.
- Clause 50 – Moving a Motion.
- Clause 52 – Right of Reply.
- Clause 57 – An Amendment Once Carried.
- Clause 58 – Deferral of Matter Before the Chair.
- Clause 99 – Urgent and Other Business.
- Clause 107 – Council's Common Seal.

Copies of the proposed Amendment Local Law can be obtained from Council's offices at 9 Smith Street, Leongatha or the Council's website at sgsc.vic.gov.au.

Written submission about the proposed Amendment Local Law will be considered in accordance with Section 223 of the **Local Government Act 1989** and must be received at the South Gippsland Shire Council offices by 5 pm on Thursday 30 September 2004.

Any persons who request to be heard in support of their written submission may appear in person or by a person acting on their behalf before a meeting of Council at the Foster War Memorial Arts Centre in Foster at 10 am on Wednesday 6 October 2004.

JOSEPH CULLEN
Chief Executive

TOWONG SHIRE COUNCIL

Road Management Plan

Pursuant to section 54 of the **Road Management Act 2004**, the Towong Shire Council, at its Ordinary Meeting on 6 September 2004, resolved to make a road management plan and gives notice that:

- a) the proposed road management plan includes details of the management system that Towong Shire Council proposes to implement in the discharge of its duty to inspect, maintain and repair public roads for which it is the coordinating or responsible road authority;
- b) a copy of the proposed road management plan may be inspected at the Towong Shire offices in Tallangatta or Corryong; and
- c) that any person who is aggrieved by the proposed road management plan may make a submission on the proposed road management plan to the Council within a period of 28 days.

RAY PARK
Chief Executive

Planning and Environment Act 1987

ARARAT PLANNING SCHEME

Notice of Preparation of Amendment

Amendment C8

The Ararat Rural City Council has prepared Amendment C8 to the Ararat Planning Scheme.

The land affected by the Amendment is as follows:

- Lot 1 TP 405412G, Pt Crown Allotment 40, Parish of Willaura (Willaura–Wickliffe Road, Willaura); and
- part of Lot 2 on Plan of Subdivision 64752 (Bald Hill Road, Willaura).

The Amendment proposes to include the land described above within a Public Acquisition Overlay 3 for the use and development of a water treatment plant and a clear water storage facility in the township of Willaura for Grampians Wimmera Mallee Water.

You may inspect the Amendment, any documents that support the Amendment and the explanatory report about the Amendment at the following locations: at the office of the planning authority, Ararat Rural City Council, corner of Vincent and High Streets, Ararat; at the Department of Sustainability and Environment, Western Region Office, 402–406 Mair Street, Ballarat; and at the Department of Sustainability and Environment, Planning Information Centre, Upper Plaza, Nauru House, 80 Collins Street, Melbourne.

This can be done during office hours and is free of charge.

Any person who may be affected by the Amendment may make a submission to the planning authority.

The closing date for submissions is 16 October 2004. A submission must be sent to Mrs Rosalie Bilson, Manager Planning, Ararat Rural City Council, PO Box 246, Ararat Vic. 3377.

Mrs ROSALIE BILSON
Planning Manager

Planning and Environment Act 1987

BRIMBANK PLANNING SCHEME

Notice of Preparation of Amendment

Amendment C78

Brimbank City Council has prepared Amendment C78 to Council's Planning Scheme.

The land affected by the Amendment is within the area bounded by Mt Derrimut Road, Boundary Road, Robinsons Road and Middle Road, Derrimut.

The Amendment proposes to rezone land from the Rural Zone to the Industrial 1 Zone, apply a new Schedule 11 to the Development Plan Overlay, and replace the existing Schedule 10 to the Development Plan Overlay with a new Schedule 10.

The new Schedule 11 to the Development Plan Overlay applies to the area zoned or proposed to be zoned Industrial 1 Zone and includes a Concept Plan that will guide future development of the land. The new Schedule 10 to the Development Plan Overlay applies to the area zoned Industrial 2 Zone, and updates and corrects differences with the existing Schedule 10.

The Amendment also proposes to delete the Local Planning Policy at clause 22.02, 'South West Non Urban Land Policy'.

The Amendment is available to the public, free of charge, during office hours at: Department of Sustainability and Environment, Planning Information Centre, Upper Plaza, Nauru House, 80 Collins Street, Melbourne 3000; Brimbank City Council, Keilor Office, Municipal Office, Old Calder Highway, Keilor 3036; and Brimbank City Council, Harvester Customer Service Centre, 301 Hampshire Road, Sunshine 3020.

The documentation is also available for review on Council's website: www.brimbank.vic.gov.au.

Any person who may be affected by the Amendment may make a submission to the planning authority.

The closing date for submissions is Monday 18 October 2004, addressed to Brimbank City Council, PO Box 70, Sunshine 3020.

Signature for the Planning Authority

Planning and Environment Act 1987

EAST GIPPSLAND PLANNING SCHEME

Notice of the Preparation of
an Amendment to a Planning Scheme and
Notice of an Application for Planning Permit
Amendment C32

Planning Permit Application No. 190/2004/P

The land affected by the Amendment and the application for planning permit is 65 Bream Road, Lake Tyers Beach.

The Amendment proposes to:

- rezone 65 Bream Road, Lake Tyers Beach, from Rural Zone (Schedule 1) to Residential 1 Zone;
- include a new Incorporated Document, being in the form of an Overall Development Plan, into Clause 81 of the Planning Scheme;
- make a minor change to the wording within the Municipal Strategic Statement in anticipation of the need to ensure that future development on this land is done so in accordance with an approved Overall Development Plan.

The application for planning permit is to subdivide the land into 25 lots.

The person who requested the Amendment and the applicant for the permit is G. Warfe, C/- Crowther and Sadler Pty Ltd.

You may inspect the Amendment and the application, and any documents that support the Amendment and application, and the explanatory report about the Amendment and application, at: East Gippsland Shire Council, Corporate Centre, 273 Main Street, Bairnsdale; East Gippsland Shire Council, Lakes Entrance Library and Business Centre, 18 Mechanics Street, Lakes Entrance; Department of Sustainability and Environment, Planning Information Centre, Upper Plaza, Nauru House, 80 Collins Street, Melbourne, Vic. 3000; and Department of Sustainability and Environment, Eastern Region Office, 71 Hotham Street, Traralgon, Vic. 3844.

This can be done during office hours and is free of charge.

Any person who may be affected by the Amendment or by the granting of the permit may make a submission in writing, which must be sent to Courtney Campbell, Planning Officer, East Gippsland Shire Council, PO Box 1618, Bairnsdale, Vic. 3875, by 18 October 2004.

STEVE KOZLOWSKI
Chief Executive Officer

Planning and Environment Act 1987

GANNAWARRA PLANNING SCHEME

Notice of Amendment

Amendment C8

The Gannawarra Shire Council has prepared Amendment C8 to the Gannawarra Planning Scheme.

The purpose of the Amendment is to rezone land known as Lot 1 on Plan of Subdivision 417944R located on Ninth Street, Kerang from Industrial 1 Zone to Mixed Use Zone and to introduce the Design and Development Overlay to the land.

The rezoning of the land will provide an area for the co-location of dwellings and light industrial areas.

The Amendment is available for public inspection, free of charge, during office hours at: Department of Sustainability and Environment, Planning Information Centre, Upper Plaza, Nauru House, 80 Collins Street, Melbourne 3000; Department of Sustainability and Environment, North West Regional Office, 1 Taylor Street, Epsom 3551; and Gannawarra Shire Council, 49 Victoria Street, Kerang 3579.

Submissions about the Amendment must be sent to: John McCurdy, Manager Planning, Gannawarra Shire Council, PO Box 287, Kerang 3579 by close of business 18 October 2004.



Planning and Environment Act 1987
GREATER GEELONG PLANNING SCHEME
 Notice of Preparation of Amendment
 Amendment C97

The City of Greater Geelong has prepared Amendment C97 to the Greater Geelong Planning Scheme.

The Amendment applies to privately owned land at 250 Latrobe Terrace, Newtown, and proposes to include an area of approximately 282 sq metres of the land in a Public Acquisition Overlay, Schedule 3 (PAO3) to enable VicRoads to acquire the land for the construction of a future Left Turn Slip Lane.

You may inspect the Amendment, any documents that support the Amendment and the explanatory report about the Amendment at the following locations: at the office of the planning authority, City of Greater Geelong, Ground Floor, 131 Myers Street, Geelong; via City's website, www.geelongaustralia.com.au Public Comments section; at the Department of Sustainability and Environment, 4th Floor, State

Government Offices, corner of Little Malop and Fenwick Streets, Geelong; and at the Department of Sustainability and Environment, Planning Information Centre, Upper Plaza, Nauru House, 80 Collins Street, Melbourne.

This can be done during office hours and is free of charge.

Any person who may be affected by the Amendment may make a submission to the planning authority.

The closing date for submissions is Monday 18 October 2004. A submission must be sent to Co-ordinator Strategic Planning, City of Greater Geelong, PO Box 104, Geelong, Vic. 3220.

IAN McCARTNEY
 Co-ordinator Strategic Planning

Planning and Environment Act 1987
GREATER SHEPPARTON
PLANNING SCHEME

Notice of Preparation of Amendment
 Amendment C52

The Greater Shepparton Council has prepared Amendment C52 to the Greater Shepparton Planning Scheme.

The land affected by the Amendment is 135 Channel Road (Lot 2, LP123252), 65 Channel Road (CA 2, Section D, Parish of Shepparton), 70 Feiglin Road (Lot 4 on LP95107) and 145 Channel Road (Lot 1, LP123252) Shepparton.

The Amendment proposes to:

- rezone the subject land from Rural Zone (RUZ) to Residential 1 Zone (R1Z);
- remove the Development Plan Overlay 1 from the land;
- include the land in a Development Plan Overlay (DPO) Schedule 9;
- amend the Municipal Strategic Statement to include reference to the Development Plan.

You may inspect the Amendment, any documents that support the Amendment and the explanatory report about the Amendment during office hours and free of charge at the Greater Shepparton City Council office, 90 Welsford Street, Shepparton; the Regional Office of the Department of Sustainability and Environment, 35 Sydney Road, Benalla; or at the Department of Sustainability and Environment, Planning

Information Centre, Upper Plaza, Nauru House, 80 Collins Street, Melbourne.

Any person who may be affected by the Amendment may make a submission to the planning authority.

In addition to the Amendment to the Greater Shepparton Planning Scheme, the Council is exhibiting the Development Plan for part of the site.

The closing date for submissions is 18 October 2004. A submission must be sent to the Greater Shepparton City Council, Locked Bag 1000, Shepparton, Vic. 3632.

Planning and Environment Act 1987
MELBOURNE PLANNING SCHEME

Notice of the Preparation of
an Amendment to a Planning Scheme and
Notice of an Application for Planning Permit
Amendment C97

Application 2004/0567

The land affected by the Amendment is the eastern elevation of the Dudley Street rail bridge, West Melbourne, predominantly above the inbound lane.

The land affected by the application is the eastern elevation of the Dudley Street rail bridge, West Melbourne, predominantly above the inbound lane.

The Amendment proposes to amend the schedule to Clause 36.01 (Public Use Zone) of the Melbourne Planning Scheme to designate the eastern elevation of the Dudley Street rail bridge, West Melbourne as being suitable for Category 2 signage.

The application is for a permit to erect and display one (1) internally illuminated major promotion sign in accordance with the draft permit (2004/0567) prepared by the Minister for Planning.

The person who requested the Amendment and the applicant for the permit is VicTrack Access, care of Glossop Town Planning.

You may inspect the Amendment and the application, and any documents that support the Amendment and application, and the explanatory report about the Amendment and application, at either Department of Sustainability and Environment, Planning Information Centre,

Upper Plaza, Nauru House, 80 Collins Street, Melbourne, Vic. 3000; or Melbourne City Council, Level 6, 200 Little Collins Street, Melbourne, Vic. 3000.

This can be done during office hours and is free of charge.

Any person who may be affected by the Amendment or by the granting of the permit may make a submission to the planning authority.

The closing date for submissions is 18 October 2004. A submission must be sent to the Minister for Planning, care of Planning Panels Victoria, Attention: Adrian Williams, Department of Sustainability and Environment, Upper Plaza, Nauru House, 80 Collins Street, Melbourne, Vic. 3000.

PAUL JEROME
Deputy Secretary
Built Environment
Department of Sustainability
and Environment

Creditors, next-of-kin and others having claims against the estate of any of the undermentioned deceased persons are required to send particulars of their claims to State Trustees Limited, ABN 68 064 593 148, 168 Exhibition Street, Melbourne, Victoria 3000, the personal representative, on or before 18 November 2004 after which date State Trustees Limited may convey or distribute the assets having regard only to the claims of which State Trustees Limited then has notice.

ANDERSON, Nancy Winifred, formerly of Unit 2, 12 Toward Street, Murrumbena, Victoria, but late of Unit 3, 113 Surrey Road, Blackburn North, Victoria, pensioner and who died on 26 August 2004.

BURGE, Gladys Edna, late of Anna House Private Nursing Home, 12 Athol Street, Moonee Ponds, home duties and who died on 3 April 2004.

HICKEY, Mary Matilda, late of Little Sisters of the Poor, St Joseph's Home, 112B St George's Road, Northcote, Victoria 3070, retired and who died on 21 July 2004.

HILL, Marjorie Caroline, formerly of 77 Mascoma Street, Strathmore, but late of Edith Bendall Lodge, 11 Park Street, Pascoe Vale, Victoria 3044, retired and who died on 30 July 2004.

JUDD, Walter Thomas Roy, formerly of 1230 Mountain Way, The Basin, but late of Eastern Districts Nursing Home, 124 Maroondah Highway, Croydon and who died on 8 July 2004.

KING, Edgar Henry, late of Unit 1, 148 Ogilvie Street, Essendon, retired public servant and who died on 7 July 2004.

PAYNE, Dorothy Alice, late of 2 Middlebrook Drive, Ringwood North, retired and who died on 30 July 2004.

ROSS, Elsie Mary, late of Lakeview Lodge Hostel, 22 Church Street, Nagambie, pensioner and who died on 7 July 2004.

SEIDEL, Karl Gottfried, also known as Gottfried Karl Seidel, late of Unit 4, 208–210 High Street, Lower Templestowe, Victoria 3107.

WOODMAN, Betty Amy Wilson, late of Gracedale Nursing Home, Warrandyte Road, Ringwood, pensioner and who died on 3 August 2004.

Dated 9 September 2004

DAVID BAKER
Manager
Executor and Trustees Services

STATE TRUSTEES LIMITED
ACN 064 593 148
Section 79

Notice is hereby given that State Trustees Limited, ACN 064 593 148, intends administering the estate of:—

ARTHUR JAMES MARTIN, late of McCulloch House, 246 Clayton Road, Clayton, Victoria, retired, deceased, who died on 15 July 2004 leaving a Will dated 11 September 2003.

HELEN MCKAY, late of Springvale Private Nursing Home, 340 Springvale Road, Springvale, Victoria, pensioner, deceased, intestate, who died on 25 July 2004.

Creditors, next-of-kin and others having claims against the abovementioned estates are required pursuant to Section 33 of the **Trustee Act 1958** to send particulars of their claims against the abovementioned estates to State Trustees Limited, 168 Exhibition Street, Melbourne, Victoria on or before 18 November 2004 after which date State Trustees Limited, ACN 064 593 148, may convey or distribute assets of the abovementioned estates having regard only to the claims of which it then has notice.

Creditors, next-of-kin and others having claims against the estate of any of the undermentioned deceased persons are required to send particulars of their claims to State Trustees Limited, ABN 68 064 593 148, 168 Exhibition Street, Melbourne, Victoria 3000, the personal representative, on or before 22 November 2004 after which date State Trustees Limited may convey or distribute the assets having regard only to the claims of which State Trustees Limited then has notice.

ARTER, Marie Therese, late of Singleton Project, 30 Meehan Street, Rutherglen, Victoria 3685, pensioner and who died on 7 June 2004.

CAMERON, Eric, late of Napier Street Hostel, 179 Napier Street, South Melbourne, retired and who died on 11 July 2004.

CHARLES, Roy Benjamin Frederick, late of 114 Miranda Road, Reservoir, Victoria 3073, retired and who died on 5 August 2004.

CLEMENTS, Moira Rose, late of 4 Churchill Street, Kew 3101, retired and who died on 2 July 2004.

COOPER, Joy Mary, also known as Joyce Mary Cooper, formerly of 14 Moffat Street, Avondale Heights, but late of Plumpton Villa Nursing Home, 7 Lewis Street, Glenroy, pensioner and who died on 25 May 2004.

GOTTSCHALK, Janina, late of Benllyne Park Private Nursing Home, 2 Killara Avenue, Sunshine, Victoria 3020, pensioner and who died on 10 July 2004.

HEATON, Margaret Beverley, late of 97 Connolly Avenue, Coburg, Victoria 3058, pensioner and who died on 16 August 2004.

HOOTON, Mavis Agnes Frances, late of 59 Kellett Street, Northcote, pensioner and who died on 31 August 2004.

O'LEARY, William, late of 33 Thompson Street, Ballarat 3350, pensioner and who died on 29 August 2004.

Dated 13 September 2004

DAVID BAKER
Manager
Executor and Trustee Services

Children's Services Act 1996

NOTICE OF EXEMPTION

Under Section 6 of the **Children's Services Act 1996** ("the Act"), the Minister for Community Services hereby declares that the Blackburn North Baptist Preschool, Licence ID 2707 ("the service") is exempt from the qualified staff members requirement as set out in regulation 24 of the Children's Services Regulations 1998.

This exemption is granted subject to the conditions that the proprietor must ensure that:

1. whenever children are being cared for or educated by the service, the number of staff members as set out in regulation 24 are caring for or educating the children;
2. the nominated staff member is undertaking studies to attain a post-secondary early childhood qualification which has been approved by the Secretary to the Department of Human Services;
3. the nominated staff member is mentored by a staff member at the service with an approved early childhood qualification;
4. the nominated staff member conducts 3 year old group sessions with the "Platypus Group" on Tuesday mornings and Thursday afternoons only.

This exemption remains in force until 31 December 2004.

Declared at Melbourne on 9 June 2004

HON SHERRYL GARBUTT MP
Minister for Community Services

Co-operatives Act 1996

BAYSWATER SOUTH PRIMARY SCHOOL

CO-OPERATIVE LTD

DROUIN PRIMARY SCHOOL

CO-OPERATIVE LTD

GRAY STREET PRIMARY SCHOOL

CO-OPERATIVE LTD

Notice is hereby given in pursuance of Section 316(1) of the **Co-operatives Act 1996** and Section 601AB(3)(e) of the **Corporations Act 2001** that, at the expiration of two months from the date hereof, the names of the

forementioned co-operatives will, unless cause is shown to the contrary, be struck off the register and the co-operatives will be dissolved.

Dated at Melbourne, 8 September 2004

ANDREW LEVENS
Assistant Registrar
of Co-operatives

Environment Protection Act 1970SUSTAINABILITY FUND GUIDELINES
AND PRIORITY STATEMENT

Notice is given in accordance with section 70C of the **Environment Protection Act 1970** of the making of the Sustainability Fund Guidelines.

The Sustainability Fund Guidelines provide an overview of the Sustainability Fund and its objectives, and provide potential Fund applicants with information about how the Sustainability Fund will be administered.

All potential Sustainability Fund applicants are encouraged to read the Sustainability Fund Guidelines and to use the Guidelines, in conjunction with the Priority Statement, to guide Sustainability Fund applications.

Notice is also given of the making of the Sustainability Fund Priority Statement. In accordance with the requirements of the **Environment Protection Act 1970**, a draft Priority Statement was released on 25 March 2004 for a period of public consultation. Public consultation closed on 16 April 2004, with 24 submissions received.

Comments received were considered by the Treasurer and myself and a final Priority Statement has now been published. In addition, a public Response to Comments document has been issued.

The Sustainability Fund Guidelines, Priority Statement and Response to Comments document are available from the EPA website at www.epa.vic.gov.au, or can be obtained from the Sustainability Fund Secretariat at: Secretariat, Sustainability Fund, EPA Victoria, GPO Box 4395QQ, Melbourne 3001. Ph: (03) 9695 2685. Email: sustainability.fund@epa.vic.gov.au.

JOHN THWAITES MP
Minister for Environment

Gas Industry Act 2001**MILDURA RETAIL GAS MARKET RULES**

Pursuant to section 63 of the **Gas Industry Act 2001** (the "Gas Act") Envestra Ltd submitted to the Essential Services Commission for approval a Scheme to develop Retail Gas Market Rules (the "Scheme"), and Retail Gas Market Rules (the "Retail Rules") for the Mildura distribution network (dated 12 July 2004).

In August 2004 the Commission, exercising its statutory power under sections 63(2) and 65(1)(b) of the **Gas Industry Act 2001**, made a Decision to approve the Scheme and the Retail Rules as submitted to the Commission by Envestra Ltd, to give them the necessary legal effect under the **Gas Industry Act 2001**. The Retail Rules can be viewed or downloaded from the website of the Retail Energy Market Company (REMCo) www.remco.net.au.



Heritage
VICTORIA

Heritage Act 1995**NOTICE OF REGISTRATION**

As Executive Director for the purpose of the **Heritage Act 1995**, I give notice under section 104 that the following remains of a ship be included in the Victorian Heritage Register in the category described as Historic Shipwreck:

SS Edina, Eastern Riverbank, Maribyrnong River, West Melbourne, Melbourne City Council.

Dated 16 September 2004

RAY TONKIN
Executive Director

VICTORIA

Public Records Act 1973**SUB-SECTION 14(1)**

Whereas, in accordance with the provisions of sub-section 14(1) of the **Public Records Act 1973**, the Minister for Victorian Communities may appoint a place outside the Public Record Office Victoria as a place of deposit for any specified class of public records;

I, John Thwaites, Minister for Victorian Communities, hereby appoint the place specified in Schedule One to be a place of deposit for sentenced temporary and unsentenced records subject to the conditions set out in Schedule Two. This appointment applies for a period of fifteen (15) years, unless revoked sooner, from the date of gazettal.

SCHEDULE ONE

Grace Records Management, 27/9 Ashley Street, West Footscray.

SCHEDULE TWO

That:—

the records transferred to Grace Records Management are not identified as permanent records in a records management standard established by the Keeper of Public Records under section 12 of the **Public Records Act 1973**;

the records are transferred and destroyed in accordance with Public Record Office Standards;

descriptions of the records to be transferred are submitted to the Public Record Office for approval prior to transfer;

the commercial facility is clean, weather proof and secure; and

the Keeper of Public Records has the right to inspect the facility at any time.

Dated 30 August 2004

JOHN THWAITES MP
Minister for Victorian Communities

Victorian Managed Insurance Authority Act 1996**DECLARATION OF PARTICIPATING BODY**

I, John Lenders MP, being the Minister responsible for administering the **Victorian Managed Insurance Authority Act 1996** (the "Act"), pursuant to section 4 of the Act, hereby declare the entity specified below to be a participating body for the purposes of the Act.

VICFORESTS

JOHN LENDERS MP
Minister for Finance

Casino Control Act 1991—section 60(1)
CASINO RULES NOTICE No. 12 OF 2004
Rules of the Game—Blackjack

By this notice, the Victorian Commission for Gambling Regulation amends the Rules in respect of the game “Blackjack”¹ as set out in the Schedule.

This notice operates with effect from 6.00am on Friday 17 September 2004.

Dated 13 September 2004

PETER COHEN

Executive Commissioner

Schedule

For rules 15.4.2 and 15.4.3, **substitute** the following rules:

- 15.4.2 A Table Games Operations Manager (or above) may permit a player to place a Perfect Pairs wager/s on any Perfect Pairs betting area provided that there is a valid Blackjack or Crown Blackjack wager placed in the betting area corresponding to the Perfect Pairs wager.
- 15.4.3 A Perfect Pairs betting area may contain no more than three Perfect Pairs wagers. A player/s that has placed a valid Blackjack or Crown Blackjack wager on a specific betting area will have first entitlement to place a Perfect Pairs wager in the corresponding area for Perfect Pairs wagers.
- (a) Commencing with players with first entitlement and moving in a clockwise direction, second and subsequent entitlements will go to the remaining players.
-

1 The full set of Rules for the game of Blackjack was most recently approved by the Victorian Casino and Gaming Authority by notice published in the Victorian Government Gazette on 5 February 2003 (S18). The rules have subsequently been amended by –

- Casino Rules Notice No. 10 of 2003 published on 22 May 2003 (G21);
 - Casino Rules Notice No. 13 of 2003 published on 10 June 2003 (G 28);
 - Casino Rules Notice No. 3 of 2004 published on 12 February 2004 (G7);
 - Casino Rules Notice No. 6 of 2004 published on 17 March 2004 (S65); and
 - Casino Rules Notice No. 8 of 2004 published on 18 March 2004 (G12).
-

Marine Act 1988
SECTION 15 NOTICE

I, the Director of Marine Safety, on the recommendation of The Regional Manager City and Bays, Parks Victoria, hereby give notice under subsection 15(1) of the **Marine Act 1988** of the following amendments to Notice No. 1 under section 15(2) of the **Marine Act 1988**:

1. Amendment to Schedule 1
Waters – The Designated Port of Port Phillip

In Schedule 1, Item 6 insert:

- “(g) Yarra River – special light provisions
A Recreational Vessel–
- (i) used for training or competition; and
 - (ii) is not powered but is propelled by using oars or paddles;
- on the waters of the Yarra River within the Designated Port of Port Phillip shall exhibit between sunset and sunrise–
- (i) a light in accordance with Rule 25 of the International Rules for Preventing Collisions at Sea, 1972; or

- (ii) a fixed 180 degree white light located on the bow of the vessel and a flashing 180 degree white light located on the stern of the vessel.”

**2. Amendment to Schedule 3
Waters – The Yarra River upstream of the Designated Port of Port Phillip**

In Schedule 3, Item 4 insert:

- “(b) Yarra River – special light provisions

A Recreational Vessel–

- (i) used for training or competition; and
(ii) is not powered but is propelled by using oars or paddles;
on the waters of the Yarra River upstream of the Designated Port of Port Phillip to Dight's Falls shall exhibit between sunset and sunrise–
(i) a light in accordance with Rule 25 of the International Rules for Preventing Collisions at Sea, 1972; or
(ii) a fixed 180 degree white light located on the bow of the vessel and a flashing 180 degree white light located on the stern of the vessel.”

**3. Amendment to Schedule 4
Waters – The Maribyrnong River Upstream of the Designated Port of Port Phillip**

In Schedule 4 insert:

- “3. Exclusive use and special purpose areas for the purposes of Clause 13.

- (a) Maribyrnong River – special light provisions

A Recreational Vessel–

- (i) used for training or competition; and
(ii) is not powered but is propelled by using oars or paddles;
on the waters of the Maribyrnong River upstream of the Designated Port of Port Phillip to the Canning Street Bridge shall exhibit between sunset and sunrise–
(i) a light in accordance with Rule 25 of the International Rules for Preventing Collisions at Sea, 1972; or
(ii) a fixed 180 degree white light located on the bow of the vessel and a flashing 180 degree white light located on the stern of the vessel.”

Reference No. 284/002/2004

Dated 13 September 2004

TONY MIDDLETON
Director of Marine Safety

Geographic Place Names Act 1998

NOTICE OF REGISTRATION OF GEOGRAPHIC NAMES

The Registrar of Geographic Names hereby gives notice of the registration of undermentioned place names.

File No.	Place Name	Proposer & Location
GPN 596	Mavis Hutter Reserve	Kingston City Council. Located in Carroll Road, Oakleigh South.
GPN 609	Garibaldi Creek	Pyrenees Shire Council. Located between Beaufort Lake and Yams Hole Creek, Beaufort.

GPN 610	Jocks Creek	Pyrenees Shire Council. Main feeder to the Beaufort Lake (south of the lake) in Beaufort.
---------	-------------	---

Office of the Registrar of Geographic Names
c/- **LAND VICTORIA**
15th Floor
570 Bourke Street
MELBOURNE 3000

JOHN E. TULLOCH
Registrar of Geographic Names

Occupational Health and Safety Act 1985

VICTORIAN WORKCOVER AUTHORITY

Notice of Issue of Major Hazard Licence

On 1 September 2004, a licence under Part 8 of the Occupational Health and Safety (Major Hazard Facilities) Regulations 2000 was issued to Caltex Australia Petroleum Australia Pty Ltd, PO Box 57, Newport 3015, and authorises the Caltex Newport Terminal located at 411 Douglas Parade, Newport, Victoria 3015, to be operated as a major hazard facility.

The Major Hazard Facility Licence was issued for a term of 5 years and will expire on 22 July 2009.

The licence did not include conditions.

The following Schedule 1 materials were authorised by the licence:

From Table 1 of Schedule 1

Material	UN Nos included under name
Nil	Nil

From Table 2 of Schedule 1

Material	Description
Flammable Materials	Liquid which meet the criteria for Class 3 PG II or III

GREG TWEEDLY
Chief Executive

Psychologists Registration Act 2000

PSYCHOLOGISTS REGISTRATION BOARD OF VICTORIA

Fees Payable to the Board: 2005

In accordance with section 92 of the **Psychologists Registration Act 2000** the Board has fixed the following registration and other fees for the period 1 January 2005 to 31 December 2005.

The following fees are payable to the Board:

- on application for general registration as a psychologist \$336.00
- on application for probationary registration as a psychologist \$336.00

●	on application for specific registration as a psychologist	\$336.00
●	for the annual renewal of general registration as a psychologist	\$336.00
●	renewal extension (continuous) of probationary registration	\$168.00 (1 year) ***
●	for late application for renewal of registration (renewal fee plus 50% of registration fee)	\$504.00
●	for restoration to the register (renewal fee plus late fee plus 20% of renewal fee)	\$570.00
●	for application and registration as a psychologist under the Mutual Recognition (Victoria) Act 1998	\$336.00
●	for registration certificate replacement (per copy)	\$20.00
●	for additional registration certificates (per copy)	\$20.00
●	for a copy of the register	\$500.00
●	for an extract of the register	\$50.00

*** Probationary psychologists who have been registered until the end of 2004 and have not completed their supervised practice/study can obtain an extension for one year only by paying a fee of \$168.00.

This space has been left blank intentionally

Rural Finance Act 1988
NOTICE OF VESTING OF LAND IN
RURAL FINANCE CORPORATION OF VICTORIA

Rural Finance Corporation of Victoria hereby gives notice that the land referred to in the Schedule has vested in Rural Finance Corporation of Victoria in fee simple pursuant to section 48 of the **Rural Finance Act 1988**.

SCHEDULE

All those pieces of land shown on the following plans lodged at the Central Planning Office of the Department of Sustainability and Environment.

(a) Plan reference LEGL./ 04 – 244

Parish of Coradjil		
Crown Allotment	Section	Area
79A	A	294 ha±
Parish of Natte Murrang		
Crown Allotment	Section	Area
40	–	147 ha±
Parish of Irrewillipe		
Crown Allotment	Section	Area
101	–	606 ha±
TOTAL AREA		1047 ha±

(b) Plan reference LEGL./ 04 – 245

Parish of Coradjil		
Crown Allotment	Section	Area
17	–	101 ha±
2002	–	1414 ha±
78	A	49 ha±
79	A	167 ha±
TOTAL AREA		1731 ha±

(c) Plan reference LEGL./ 04 – 246

Parish of Natte Murrang		
Crown Allotment	Section	Area
47A	–	223 ha±
Parish of Newlingbrook		
Crown Allotment	Section	Area
27A	–	27 ha±
TOTAL AREA		250 ha±

(d) Plan reference LEGL./ 04 – 247

Parish of La Trobe		
Crown Allotment	Section	Area
132B	–	197 ha±
150	–	134 ha±
TOTAL AREA		331 ha±

Total area: 3359 ha±

Dated 8 September 2004

M. McG. SMITH
Acting Chief Executive Officer
Rural Finance Corporation of Victoria

AGREEMENT FOR THE EXHIBITION STREET EXTENSION PROJECT

Notice under Schedule 1 of the Agreement for the Exhibition Street Extension Project between the Crown in right of the State of Victoria and City Link Extension Pty Limited (the "ESEP Deed").

City Link Extension Pty Limited (ABN 40 082 058 615) ("Cleppo") gives notice of the following Charge Tolls for the Exhibition Street Extension:

Charge Tolls (\$/vehicle)

Category of Vehicle	Car	Light Commercial Vehicle	Heavy Commercial Vehicle	Motor Cycle
Tollable Section				
Exhibition Street Extension	0.86	1.37	1.63	0.43

Cleppo intends that these Charge Tolls will first apply in the quarter ending 31 December 2004.

Capitalised terms in this notice that are defined in the ESEP Deed have the same meaning as given by the ESEP Deed.

P G B O'SHEA
 Company Secretary
 City Link Extension Pty Limited
 ABN 40 082 058 615

G R PHILLIPS
 Director
 City Link Extension Pty Limited
 ABN 40 082 058 615

AGREEMENT FOR THE MELBOURNE CITY LINK AND
AGREEMENT FOR THE EXHIBITION STREET EXTENSION PROJECT

Notice under Schedule 4 of the Agreement for Integrating and Facilitating the Project and the Exhibition Street Extension Project between the Crown in right of the State of Victoria, CityLink Melbourne Limited, Transurban Infrastructure Management Limited and City Link Extension Pty Limited (the "IFA") (as substituted for (and as if incorporated in lieu of) Schedule 3 of the Agreement for the Melbourne City Link between the Crown in right of the State of Victoria, CityLink Melbourne Limited and Transurban Infrastructure Management Limited (the "Concession Deed") and Schedule 1 of the Agreement for the Exhibition Street Extension Project between the Crown in right of the State of Victoria and City Link Extension Pty Limited ("the ESEP Deed")).

CityLink Melbourne Limited (ABN 65 070 810 678) (for itself and as agent of City Link Extension Pty Limited (ABN 40 082 058 615)) ("CityLink Melbourne") gives notice of the following Charge Tolls, Maximum Charge Tolls, Day Tolls, Taxi Tolls and Taxi Day Tolls for the Melbourne City Link and the Exhibition Street Extension:

Schedule of Charge Tolls and Maximum Charge Tolls**Charge Tolls (\$/vehicle)**

Category of Vehicle Tollable Section	Car	Light Commercial Vehicle	Heavy Commercial Vehicle	Motor Cycle
Tullamarine Freeway Upgrade, between Moreland Road and Brunswick Road	1.37	2.19	2.61	0.69
Western Link Section 1, between Racecourse Road and Dynon Road	1.37	2.19	2.61	0.69
Western Link Section 2, between Footscray Road and West Gate Freeway	1.72	2.74	3.26	0.86
Domain Tunnel and that part of the Southern Link leading into that Tunnel between the eastern portal of that Tunnel and Punt Road, other than that part of Southern Link Section 1:				
(a) between Punt Road and the exit to Boulton Parade; and				
(b) comprising Boulton Parade	1.72	2.74	3.26	0.86
Burnley Tunnel and that part of the Southern Link leading out of that Tunnel between the eastern portal of that Tunnel and Burnley Street	3.09	4.94	5.86	1.54
Southern Link Section 1, between Burnley Street and Punt Road and including that part of Southern Link Section 1:				
(a) between Punt Road and the exit to Boulton Parade; and				
(b) comprising Boulton Parade	1.37	2.19	2.61	0.69
Southern Link Section 5, between Punt Road and Burnley Street other than that part of the Southern Link leading out of the Burnley Tunnel between the eastern portal of that Tunnel and Burnley Street	1.37	2.19	2.61	0.69
Southern Link Section 1, between Glenferrie Road and Burnley Street	1.37	2.19	2.61	0.69
Southern Link Section 5, between Burnley Street and Glenferrie Road	1.37	2.19	2.61	0.69
Exhibition Street Extension	0.86	1.37	1.63	0.43

Southern Link Section 1, between Punt Road and Swan Street Intersection, other than:				
(a) that part of Southern Link Section 1:				
(i) between Punt Road and the exit to Boulton Parade; and				
(ii) comprising Boulton Parade; and				
(b) that part of the Southern Link leading into the Domain Tunnel between the eastern portal of that Tunnel and Punt Road	0.86	1.37	1.63	0.43
Southern Link Section 5, between Swan Street Intersection and Punt Road	0.86	1.37	1.63	0.43

Notes:

1. When travelling on Southern Link Section 1 between Burnley Street and Punt Road and then onto Batman Avenue, the Tollable Sections may be combined for the purposes of levying Tolls.
2. When travelling on Southern Link Section 1 and into the Domain Tunnel, the Tollable Sections may be combined for the purposes of levying Tolls.
3. A reference in the description of a Tollable Section to a part of the Southern Link between a particular street or road and Burnley Street, includes that part of the Southern Link between that particular street or road and where Burnley Street would cross the Southern Link if Burnley Street continued in a straight southerly direction from its southernmost extremity.
4. In this table:
 - “Boulton Parade” includes the off-ramp connecting the rest of the Southern Link to Boulton Parade;
 - “Burnley Tunnel” means the eastbound tunnel between Sturt Street and Burnley Street;
 - “Domain Tunnel” means the westbound tunnel between Punt Road and Sturt Street; and
 - “Swan Street Intersection” means the intersection between Swan Street and Batman Avenue.

Maximum Charge Tolls (\$/vehicle)

Category of Vehicle	Car	Light Commercial Vehicle	Heavy Commercial Vehicle	Motor Cycle
Trips where the passage of the Vehicle on the last Tollable Section comprising the Trip before exiting the Total Link occurs between 6.00 am and 8.00 pm	5.15	6.86	6.86	2.57
Trips where the passage of the Vehicle on the last Tollable Section comprising the Trip before exiting the Total Link occurs between 8.00 pm and 6.00 am	5.15	5.15	5.15	2.57

Day Tolls (\$/vehicle)

Category of Vehicle	Car	Light Commercial Vehicle	Heavy Commercial Vehicle	Motor Cycle
Day Toll	9.85	15.75	18.75	4.90

Taxi Tolls (\$/Taxi)

Trip	Taxi Toll
Trips involving use of any or all of the Tollable Sections which comprise the Western Link* and no other Tollable Sections	2.20
Trips involving use of any or all of the Tollable Sections which comprise the Southern Link** and/or Exhibition Street Extension*** and no other Tollable Sections	2.20
Trips involving use of Tollable Sections which comprise both the Western Link* and either or both of the Southern Link** and the Exhibition Street Extension***	3.85

* The Western Link comprises the following three Tollable Sections:

1. Tullamarine Freeway Upgrade, between Moreland Road and Brunswick Road.
2. Western Link Section 1, between Racecourse Road and Dynon Road.
3. Western Link Section 2, between Footscray Road and West Gate Freeway.

** The Southern Link comprises the following eight Tollable Sections:

1. Domain Tunnel and that part of the Southern Link leading into that Tunnel between the eastern portal of that Tunnel and Punt Road, other than that part of Southern Link Section 1:
 - (a) between Punt Road and the exit to Boulton Parade; and
 - (b) comprising Boulton Parade.

2. Southern Link Section 1, between Burnley Street and Punt Road and including that part of Southern Link Section 1:
 - (a) between Punt Road and the exit to Boulton Parade; and
 - (b) comprising Boulton Parade.
 3. Southern Link Section 5, between Punt Road and Burnley Street other than that part of the Southern Link leading out of the Burnley Tunnel between the eastern portal of that Tunnel and Burnley Street.
 4. Burnley Tunnel and that part of the Southern Link leading out of that Tunnel between the eastern portal of that Tunnel and Burnley Street.
 5. Southern Link Section 1, between Glenferrie Road and Burnley Street.
 6. Southern Link Section 5, between Burnley Street and Glenferrie Road.
 7. Southern Link Section 1, between Punt Road and Swan Street Intersection, other than:
 - (a) that part of Southern Link Section 1:
 - (i) between Punt Road and the exit to Boulton Parade; and
 - (ii) comprising Boulton Parade; and
 - (b) that part of the Southern Link leading into the Domain Tunnel between the eastern portal of that Tunnel and Punt Road.
 8. Southern Link Section 5, between Swan Street Intersection and Punt Road.
- *** The Exhibition Street Extension comprises the following Tollable Section:
1. Exhibition Street Extension.

Taxi Day Tolls (\$/Taxi)

Taxi	Taxi Day toll
Metropolitan Taxi	7.70
A Taxi not being a Metropolitan Taxi	5.50

CityLink Melbourne intends that each Charge Toll, Maximum Charge Toll, Day Toll, Taxi Toll and Taxi Day Toll specified above will first apply in the quarter ending 31 December 2004.

Capitalised terms in this notice that are defined in:

- (a) the Concession Deed have, subject to paragraph (b), that meaning in this notice;
- (b) the ESEP Deed have that meaning in this notice, but only to the extent that the provision applies to the ESEP Deed,

subject to the provisions of the IFA.

P G B O'SHEA
Company Secretary
CityLink Melbourne Limited
(ABN 65 070 810 678)

G R PHILLIPS
Director
CityLink Melbourne Limited
(ABN 65 070 810 678)

AGREEMENT FOR THE MELBOURNE CITY LINK

Notice under Schedule 3 of the Agreement for the Melbourne City Link between the Crown in right of the State of Victoria, CityLink Melbourne Limited and Transurban Infrastructure Management Limited (the "Concession Deed").

CityLink Melbourne Limited (ABN 65 070 810 678) ("CityLink Melbourne") gives notice of the following Charge Tolls, Maximum Charge Tolls, Day Tolls, Taxi Tolls and Taxi Day Tolls for the Melbourne City Link:

Charge Tolls (\$/vehicle)

Category of Vehicle Tollable Section	Car	Light Commercial Vehicle	Heavy Commercial Vehicle	Motor Cycle
Tullamarine Freeway Upgrade, between Moreland Road and Brunswick Road	1.37	2.19	2.61	0.69
Western Link Section 1, between Racecourse Road and Dynon Road	1.37	2.19	2.61	0.69
Western Link Section 2, between Footscray Road and West Gate Freeway	1.72	2.74	3.26	0.86
Domain Tunnel and that part of the Southern Link leading into that Tunnel between the eastern portal of that Tunnel and Punt Road, other than that part of Southern Link Section 1:				
(a) between Punt Road and the exit to Boulton Parade; and				
(b) comprising Boulton Parade	1.72	2.74	3.26	0.86
Burnley Tunnel and that part of the Southern Link leading out of that Tunnel between the eastern portal of that Tunnel and Burnley Street	3.09	4.94	5.86	1.54
Southern Link Section 1, between Burnley Street and Punt Road and including that part of Southern Link Section 1:				
(a) between Punt Road and the exit to Boulton Parade; and				
(b) comprising Boulton Parade	1.37	2.19	2.61	0.69
Southern Link Section 5, between Punt Road and Burnley Street other than that part of the Southern Link leading out of the Burnley Tunnel between the eastern portal of that Tunnel and Burnley Street	1.37	2.19	2.61	0.69
Southern Link Section 1, between Glenferrie Road and Burnley Street	1.37	2.19	2.61	0.69

Southern Link Section 5, between Burnley Street and Glenferrie Road	1.37	2.19	2.61	0.69
Southern Link Section 1, between Punt Road and Swan Street Intersection, other than:				
(a) that part of Southern Link Section 1:				
(i) between Punt Road and the exit to Boulton Parade; and				
(ii) comprising Boulton Parade; and				
(b) that part of the Southern Link leading into the Domain Tunnel between the eastern portal of that Tunnel and Punt Road	0.86	1.37	1.63	0.43
Southern Link Section 5, between Swan Street Intersection and Punt Road	0.86	1.37	1.63	0.43

Notes:

1. When travelling on Southern Link Section 1 between Burnley Street and Punt Road and then onto Batman Avenue, the Tollable Sections may be combined for the purposes of levying Tolls.
2. When travelling on Southern Link Section 1 and into the Domain Tunnel, the Tollable Sections may be combined for the purposes of levying Tolls.
3. A reference in the description of a Tollable Section to a part of the Southern Link between a particular street or road and Burnley Street, includes that part of the Southern Link between that particular street or road and where Burnley Street would cross the Southern Link if Burnley Street continued in a straight southerly direction from its southernmost extremity.
4. In this table:
 - “Boulton Parade” includes the off-ramp connecting the rest of the Southern Link to Boulton Parade;
 - “Burnley Tunnel” means the eastbound tunnel between Sturt Street and Burnley Street;
 - “Domain Tunnel” means the westbound tunnel between Punt Road and Sturt Street; and
 - “Swan Street Intersection” means the intersection between Swan Street and Batman Avenue.

Maximum Charge Tolls (\$/vehicle)

Category of Vehicle	Car	Light Commercial Vehicle	Heavy Commercial Vehicle	Motor Cycle
Trips where the passage of the Vehicle on the last Tollable Section comprising the Trip before exiting the Link occurs between 6.00 am and 8.00 pm	5.15	6.86	6.86	2.57
Trips where the passage of the Vehicle on the last Tollable Section comprising the Trip before exiting the Link occurs between 8.00 pm and 6.00 am	5.15	5.15	5.15	2.57

Day Tolls (\$/vehicle)

Category of Vehicle	Car	Light Commercial Vehicle	Heavy Commercial Vehicle	Motor Cycle
Day Toll	9.85	15.75	18.75	4.90

Taxi Tolls (\$/Taxi)

Trip	Taxi Toll
Trips involving use of any or all of the Tollable Sections which comprise the Western Link* and no other Tollable Sections	2.20
Trips involving use of any or all of the Tollable Sections which comprise the Southern Link** and no other Tollable Sections	2.20
Trips involving use of Tollable Sections which comprise both the Western Link* and the Southern Link**	3.85

* The Western Link comprises the following three Tollable Sections:

1. Tullamarine Freeway Upgrade, between Moreland Road and Brunswick Road.
2. Western Link Section 1, between Racecourse Road and Dynon Road.
3. Western Link Section 2, between Footscray Road and West Gate Freeway.

** The Southern Link comprises the following eight Tollable Sections:

1. Domain Tunnel and that part of the Southern Link leading into that Tunnel between the eastern portal of that Tunnel and Punt Road, other than that part of Southern Link Section 1:
 - (a) between Punt Road and the exit to Boulton Parade; and
 - (b) comprising Boulton Parade.

2. Southern Link Section 1, between Burnley Street and Punt Road and including that part of Southern Link Section 1:
 - (a) between Punt Road and the exit to Boulton Parade; and
 - (b) comprising Boulton Parade.
3. Southern Link Section 5, between Punt Road and Burnley Street other than that part of the Southern Link leading out of the Burnley Tunnel between the eastern portal of that Tunnel and Burnley Street.
4. Burnley Tunnel and that part of the Southern Link leading out of that Tunnel between the eastern portal of that Tunnel and Burnley Street.
5. Southern Link Section 1, between Glenferrie Road and Burnley Street.
6. Southern Link Section 5, between Burnley Street and Glenferrie Road.
7. Southern Link Section 1, between Punt Road and Swan Street Intersection, other than:
 - (a) that part of Southern Link Section 1:
 - (i) between Punt Road and the exit to Boulton Parade; and
 - (ii) comprising Boulton Parade; and
 - (b) that part of the Southern Link leading into the Domain Tunnel between the eastern portal of that Tunnel and Punt Road.
8. Southern Link Section 5, between Swan Street Intersection and Punt Road.

Taxi Day Tolls (\$/Taxi)

Taxi	Taxi Day toll
Metropolitan Taxi	7.70
A Taxi not being a Metropolitan Taxi	5.50

CityLink Melbourne intends that each Charge Toll, Maximum Charge Toll, Day Toll, Taxi Toll and Taxi Day Toll specified above will first apply in the quarter ending 31 December 2004.

Capitalised terms in this notice that are defined in the Concession Deed have the same meaning as given by the Concession Deed.

P G B O'SHEA
 Company Secretary
 CityLink Melbourne Limited
 (ABN 65 070 810 678)

G R PHILLIPS
 Director
 CityLink Melbourne Limited
 (ABN 65 070 810 678)

Planning and Environment Act 1987

FRANKSTON PLANNING SCHEME

Notice of Approval of Amendment

Amendment C30

The Minister for Planning has approved Amendment C30 to the Frankston Planning Scheme.

The Amendment comes into operation on the date this notice is published in the Government Gazette.

The Amendment clarifies areas of potential ambiguity in Schedule 3 to the Special Use Zone and its associated Incorporated Document formerly introduced through Amendment C15 facilitating and guiding the development of the Olivers Hill Safe Boating Facilities at Frankston South.

The Amendment also reintroduces Victoria's Native Vegetation Management – A Framework for Action – August 2002 as an Incorporated Document into the Schedule to Clause 81.

A copy of the Amendment can be inspected, free of charge, during office hours, at the Department of Sustainability and Environment, Planning Information Centre, Upper Plaza, Nauru House, 80 Collins Street, Melbourne and at the offices of the Frankston City Council, Civic Centre, corner of Young and Davey Streets, Frankston.

PAUL JEROME
Deputy Secretary
Built Environment
Department of Sustainability
and Environment

Planning and Environment Act 1987

LATROBE PLANNING SCHEME

Notice of Approval of Amendment

Amendment C7

The Minister for Planning has approved Amendment C7 to the Latrobe Planning Scheme.

The Amendment comes into operation on the date this notice is published in the Government Gazette.

The Amendment:

- Rezones the land located at Purvis Road, Tanjil South being Lots 1 & 2, PS447176, and Lot 1, LP65163 from Rural Living Zone to Environmental Rural Zone.
- Rezones the land located north of Brown Coalmine Road, Yallourn North being CAs 15, 17, PT23 & 25C, Sec A, Parish of Tanjil East, CAs 14C & PT18D, Sec C, Parish of Tanjil East, Lots 1 to 4, LP219181, Lots 1 to 3, LP200104, Lot 1, LP143362, Lot 2, LP132020, Lot 1, TP11002, Lot 1, LP121622, Lots 1 & 2, PS304632, Lots 1 & 2, TP10556, Lots 1 & A, LP205776, Lot 1, LP128961, Lot 3, LP200802 and CM, CS1210, from Rural Living Zone to Rural Zone.
- Rezones the land north of Cedar Court, Tyers being Lot 10, LP142521 from Rural Living Zone to Rural Zone.
- Rezones the land located at Fitzgibbons and Brady's Roads, Tyers generally adjacent to the Rintouls Creek being CAs 17, 20, 20B & 20E, Parish of Boola Boola, Lot 2, LP149153, Lot 4, LP140727, CP174488, CP170516 from Rural Living Zone to Rural and Environmental Rural Zones.
- Rezones the land adjacent to the unmade road off Mays Road, Glengarry West being CAs 5A & 5B, Sec A, Parish of Boola Boola, from Rural Living Zone to the Environmental Rural Zone with a minimum lot size of 30 hectares specified in the schedule to the Zone.
- Rezones the land located at Francis Road, Glengarry West being Lot 2, LP70099 (part), Lot 2, LP141121, Lot 2, LP131567, County of Tanjil from Rural Living Zone to Rural Zone.
- Rezones the land located at Hakea Court, Glengarry West being Lot 18 on LP145766 from Rural Living Zone to Environmental Rural Zone.
- Rezones the land located at Sunderland Road, Glengarry West being part CA4, Section A, Parish of Boola Boola, County of Tanjil from Rural Living Zone to Rural Zone.
- Rezones the land located east of Two Mile Road, Moe South being part CA7, Parish of Narracan, County of Buln Buln from Rural Zone to Rural Living Zone.
- Rezones the land south of Loy Yang Creek, north of the Princes Highway and adjacent to Sheepwash Creek Road being Lots 1, 2, 3 and 4 on LP146282, Lot 14 on LP218296, Lot C on LP218296 and Lot B on LP218295 from Rural Living Zone to Rural Zone.

- Rezones the land in the neighbourhood adjacent to and west of the suburban area of Traralgon bounded by Bradford Drive, Freemans Road and Grey Street being CA 45B, Parish of Traralgon, Lots 1 & 2, LP81335, Lots A & B, LP93053, Lots 1 & 2, LP96827, Lots 2 to 6, LP86260, Lots 1 to 8, LP93437, Lots 1 & 2, LP95779, Lots 1 & 2, LP424867, Lot 4, LP95779, Lots 1 to 10, LP86033, Lot 1, LP141400, Lots 2 & 3 LP141401, Lots 2 & 3, LP126470, Lots 1 to 3, LP97228, Lots 1 & 2, LP132448, Lots 1 to 3, LP82825, Lots 1 & 2, LP206152, Lots 1 to 4 & Lots 6 to 9, LP110075, Lot 1 & 2, PS340415, from Rural Living Zone to Low Density Residential Zone.
 - Rezones land north of Sagars Road, Hazelwood North being Lots 1 to 5 on LP240121 in the Parish of Traralgon, County of Buln Buln from Rural Zone to Rural Living Zone.
 - Rezones the land south of Mackeys Road, Churchill being Lots 1 and 2 on LP317587 in the Parish of Maryvale, County of Buln Buln from Rural Living Zone to Low Density Residential Zone.
 - Rezones the land in the neighbourhood area generally along Considine Drive, Jumbuk Road, Pages Road, Perry Court, Wakanene Drive and Kowloon Road, Jeeralang Junction being CA PT15, Sec A, Parish of Yinnar, Lot 1, LP202574, Lots 2 to 21, LP202575, Lots 1 to 4, LP132704, Lots 5 & 6, LP126518, Lots 1 & 2, PS410563, Lots 1 to 8, LP126516, Lots 1 to 11, LP126768, Lots 1 & 2, LP132331, Lots 1 to 8, LP218329, Lots 1 to 3, LP130663, Lots 15 to 37 & Lots 39, LP122046, Lots 1 to 4 & Lot 14, LP120603, from Rural Zone to Rural Living Zone.
 - Rezones the land located generally in the neighbourhood of Guthries Hill Road, Johnstones Road, Antonia Road, Schiebels Road and Halls Road being Lot 1 on LP146233, Lots 1 and 2 on LP145962, part CA's 6A, 6C, 6E, Lot 1 on LP42059, Lot 1 on LP113927, Lots 1 and 2 on LP122955 from Rural Living Zone to Rural Zone.
 - Rezones the land located adjacent to Monash Way, Boolarra being part CAs 6D, 8A, 8B, Lots 1, 2 and 3 on LP203580 and Lots 2 and 3 LP84789 from Rural Zone to Rural Living Zone.
 - Rezones the land located at the un-named road off the Moe South Road south of Simon Court, Moe South being part CA170B and part CA B, Parish of Moe, and Ryland Way and Matthew Court, Moe South being Lots 38 to 59 inclusive on PS300458, from Rural Zone to Rural Living Zone.
 - Rezones the land located at the Moe Thorpdale Road being Lot 17 on LP130910 and Pearces Track, Moe South being Lots 1 and 2 and Reserve for H.P. on PS410202 and part Lots 9, 11, 12, 13, 14 and 15 on LP121738, from Rural Living Zone to Rural Zone.
 - Rezones the land located in the neighbourhood of Arwon Drive and Sayers Track, Hernes Oak being CAs 10E, 10F and 10G on TP800008 and Lot 41 on LP131391 and Lot 1 on LP121093 being Drainage & Recreation Reserve, Lots 1 to 5 & Lots 7 to 19, CP128914, Drainage & Recreation Reserve, Lots 29 to 33, LP131391, Lots 48 to 64, LP136221 from Rural Living Zone to Rural Zone.
 - Rezones the land located at Walhalla–Old Sale Road, Moe being CA 11A, Lots 1 and 2 on LP126976 and Lot 2 (part) on LP139465 from Rural Living Zone to Rural Zone.
 - Rezones the land located at Thompson's Road, Moe being Lots 1 and 2 on LP80593 and Lots 4, 5, 6 and 7 on LP93886 from Rural Zone to Rural Living Zone.
 - Rezones the land at Bunderra Drive, Boolarra being Lots 1 to 13, CS1481 and Lots 26 & 27, LP211053 from Rural Zone to Rural Living Zone.
 - Changes Clause 21.04 relating to rural living to reflect the Latrobe Rural Living Study.
 - Inserts Clause 35.02, Environmental Rural Zone and a new schedule to the zone.
 - Replaces the schedule to Clause 35.03, Rural Living Zone.
- A copy of the Amendment can be inspected, free of charge, during office hours, at the Department of Sustainability and Environment, Planning Information Centre, Upper Plaza, Nauru House, 80 Collins Street, Melbourne and at the offices of the Latrobe City Council, 34–38 Kay Street, Traralgon.

PAUL JEROME
Deputy Secretary
Built Environment
Department of Sustainability
and Environment

Planning and Environment Act 1987
MANNINGHAM PLANNING SCHEME
 Notice of Approval of Amendment
 Amendment C35

The Minister for Planning has approved Amendment C35 to the Manningham Planning Scheme.

The Amendment comes into operation on the date this notice is published in the Government Gazette.

The Amendment introduces new parking provisions for the Doncaster Hill Activity Centre (excluding Doncaster Westfield Shoppingtown). Specifically, the Amendment makes the following changes:

- incorporation of the 'Doncaster Hill Parking Precinct Plan' (5 July 2004) prepared by GTA Consultants for Manningham City Council, into the schedule to Clause 81;
- inclusion of changes to the schedule to Clause 52.06-6 relating to the variation of car parking requirements to reflect those specified within the 'Doncaster Hill Parking Precinct Plan' (5 July 2004) prepared by GTA Consultants for Manningham City Council; and
- referral to the 'Doncaster Hill Parking Precinct Plan' (5 July 2004) prepared by GTA Consultants for Manningham City Council, in Clause 21.21-2 under 'Policy and exercise of discretion' under Key issue 3 (Infrastructure requirements in the Doncaster Hill Activity Centre).

A copy of the Amendment can be inspected, free of charge, during office hours, at the Department of Sustainability and Environment, Planning Information Centre, Upper Plaza, Nauru House, 80 Collins Street, Melbourne and at the office of the Manningham City Council, City Offices, 699 Doncaster Road, Doncaster.

PAUL JEROME
 Deputy Secretary
 Built Environment
 Department of Sustainability
 and Environment

Planning and Environment Act 1987
MELBOURNE PLANNING SCHEME
 Notice of Approval of Amendment
 Amendment C79

The Minister for Planning has approved Amendment C79 to the Melbourne Planning Scheme.

The Amendment comes into operation on the date this notice is published in the Government Gazette.

The Amendment rezones Nos 557-563 St Kilda Road, Melbourne from Special Use Zone 3 to a Business 5 Zone.

A copy of the Amendment can be inspected, free of charge, during office hours, at the Department of Sustainability and Environment, Planning Information Centre, Upper Plaza, Nauru House, 80 Collins Street, Melbourne and at the offices of the Melbourne City Council, 6th Floor, Council House, 200 Little Collins Street, Melbourne.

PAUL JEROME
 Deputy Secretary
 Built Environment
 Department of Sustainability
 and Environment

Planning and Environment Act 1987
MELTON PLANNING SCHEME
 Notice of Approval of Amendment
 Amendment C29

The Minister for Planning has approved Amendment C29 to the Melton Planning Scheme.

The Amendment comes into operation on the date this notice is published in the Government Gazette.

The Amendment introduces the Green Wedge Zone over land known as Lot 1, LP 47592 Plumpton Road, Diggers Rest; Part Crown Allotment, Section 9, Plumpton Road, Diggers Rest; Part Crown Allotment, Section 14, Diggers Rest-Coimadai Road, Diggers Rest; and Part Crown Allotment, Section 10, Diggers Rest-Coimadai Road, Diggers Rest.

A copy of the Amendment can be inspected, free of charge, during office hours, at the Department of Sustainability and Environment, Planning Information Centre, Upper Plaza, Nauru House, 80 Collins Street, Melbourne and at the offices of the Melton Shire Council, High Street, Melton.

PAUL JEROME
 Deputy Secretary
 Built Environment
 Department of Sustainability
 and Environment

Planning and Environment Act 1987
WHITEHORSE PLANNING SCHEME

Notice of Approval of Amendment
Amendment C46 Part 2

The Minister for Planning has approved Amendment C46 Part 2 to the Whitehorse Planning Scheme.

The Amendment comes into operation on the date this notice is published in the Government Gazette.

The Amendment implements the Blackburn Lake Surrounds Study by applying the Neighbourhood Character Overlay and/or Significant Landscape Overlay to land near Blackburn Lake and makes consequential changes to the Local Planning Policy Framework (Clauses 21.04, 21.05, 21.07 and 22.04).

A copy of the Amendment can be inspected, free of charge, during office hours, at the Department of Sustainability and Environment, Planning Information Centre, Upper Plaza, Nauru House, 80 Collins Street, Melbourne and at the office of the Whitehorse City Council, 379–397 Whitehorse Road, Nunawading.

PAUL JEROME
Deputy Secretary
Built Environment
Department of Sustainability
and Environment

Planning and Environment Act 1987
WHITEHORSE PLANNING SCHEME

Notice of Approval of Amendment
Amendment C53

The Minister for Planning has approved Amendment C53 to the Whitehorse Planning Scheme.

The Amendment comes into operation on the date this notice is published in the Government Gazette.

The Amendment applies the Significant Landscape Overlay – Schedule 5 to three institutional sites at 1 Lake Road and 57–69 Central Road, Blackburn and 131–173 Central Road, Nunawading on an interim basis to expire on 31 December 2005.

A copy of the Amendment can be inspected, free of charge, during office hours, at the Department of Sustainability and Environment, Planning Information Centre, Upper Plaza, Nauru House, 80 Collins Street, Melbourne and at the offices of the Whitehorse City Council, 379–397 Whitehorse Road, Nunawading.

PAUL JEROME
Deputy Secretary
Built Environment
Department of Sustainability
and Environment

Planning and Environment Act 1987
WODONGA PLANNING SCHEME

Notice of Approval of Amendment
Amendment C24

The Minister for Planning has approved Amendment C24 to the Wodonga Planning Scheme.

The Amendment comes into operation on the date this notice is published in the Government Gazette.

The Amendment:

- rezones land for the Albury Wodonga National Highway Project Victorian Section from Public Conservation and Resource, Public Park and Recreation, Rural, Industrial 1, Public Use 4 (Transport) and Residential 1 Zones to Road Zone, Category 1;
- reduces the existing Heritage Overlay 1 (Cambourne Park Homestead) in High Street/Hume Highway to only apply to that part of the title that is being retained in private ownership (not being acquired by VicRoads);
- retains the existing Rural Floodway Overlay over sections of the project to the north-east of Wodonga, but indicates this land as Rural Floodway Overlay 2 (RFO2);
- removes the Public Acquisition Overlay 1 from all of the proposed Albury Wodonga National Highway Project Victorian Section (all land being rezoned to Road Zone Category 1 as part of this Amendment);
- removes the Design and Development Overlay 2 from land being rezoned to Road Zone Category 1, being a small section of land on the Murray Valley Highway, west of Bakers Lane;

- removes the Development Plan Overlay 1 from land being rezoned to Road Zone Category 1, being a small section of land east of DeKerilleau Drive;
- replaces Schedule 1 with a new Schedule to the Rural Floodway Overlay;
- inserts a new Schedule (Schedule 2) to the Rural Floodway Overlay to exempt the need for a planning permit for construction and related works for the section of land for the project that is affected by the Rural Floodway Overlay;
- removes the Public Acquisition Overlay 1 (PAO 1) notation for the internal Hume Freeway bypass route and Bandiana link from the Public Acquisition Overlay Schedule;
- inserts a schedule to Clause 52.17 to remove the need for a planning permit to remove, destroy or lop native vegetation on the Albury Wodonga National Highway Project Victorian Section that is being rezoned to Road Zone Category 1.

A copy of the Amendment can be inspected, free of charge, during office hours, at the Department of Sustainability and Environment, Planning Information Centre, Upper Plaza, Nauru House, 80 Collins Street, Melbourne; the Department of Sustainability and Environment north-eastern regional office, 35 Sydney Road, Benalla; and at the offices of the City of Wodonga, Hovell Street, Wodonga.

PAUL JEROME
Deputy Secretary
Built Environment
Department of Sustainability
and Environment

Bend) from an Industrial 1 Zone to a Business 3 Zone. The site was formerly owned by Hawker de Havilland.

The Amendment lapsed on 29 July 2004.

PAUL JEROME
Deputy Secretary
Built Environment
Department of Sustainability
and Environment

Planning and Environment Act 1987

MELBOURNE PLANNING SCHEME

Notice of Lapsing of Amendment

Amendment C49

The Melbourne City Council has resolved to abandon Amendment C49 to the Melbourne Planning Scheme.

The Amendment proposed to rezone 280 Lorimer Street, Port Melbourne (Fishermans

ORDERS IN COUNCIL

Cemeteries Act 1958

PUBLIC CEMETERY TRUSTS

Scales of Fees

Order in Council

The Governor in Council under section 17(1) of the **Cemeteries Act 1958**, consents the Scales of Fees of the listed public cemetery trusts.

- The Donald Cemetery Trust
- The Korong Vale Cemetery Trust
- The Trustees of the Lilydale Memorial Park and Cemeteries
- The Narrawong Cemetery Trust
- The Tatura Cemetery Trust
- The Geelong Cemeteries Trust

Cemeteries Act 1958

SCALE OF FEES

By resolution of the Trust, the following fees will apply in the Donald Public Cemetery from the date of approval by the Governor-in-Council. All other fees are rescinded to the extent to which they conflict with this scale.

	\$
LAWN SECTION	
Land 2.44m x 1.22m	410.00
Land for infant 1.22m x 0.66m	93.00
Land for ashes 0.6m x 0.6m	79.00
Sinking grave 1.83m (6')	243.00
Each additional 0.3m	69.00
Re-opening/second interment	243.00
Sinking grave for infant	90.00
Interment of ashes	70.00
Weekend rate – Additional	93.00
Interment Fee	105.00
Monumental Headstone	514.00
Monumental Headstone – Infant	380.00
Bronze plaque – Ashes	380.00
MONUMENTAL SECTION	
Land 2.44m x 1.22m	126.00
Sinking grave 1.83m (6')	195.00
Each additional 0.3m	69.00
Re-opening/second interment	195.00
Removal of slab	69.00
Sinking grave – Infant	93.00

Weekend rate – Additional	93.00
Interment fee	105.00
EXTRAS	
Oversize grave – sinking	243.00
Exhumation	867.00
Record Search Fee	32.00
5% Fee on Contract Work	

MAX L. HARRIS, trustee
 PETER J. RAYNES, trustee
 ROBERT C. GILMOUR, trustee

Cemeteries Act 1958

SCALE OF FEES

By resolution of the Trust, the following fees will apply in the Korong Vale Public Cemetery from the date of approval by the Governor-in-Council. All other fees are rescinded to the extent to which they conflict with this scale.

	\$
Land 2.44m x 1.22m	200.00
Sinking grave 1.83m deep	200.00
Re-open grave (no cover)	200.00
Permission to erect headstone, monument	10% of cost with min. \$70.00
Exhumation charge	\$1,130.00
Search fee	25.00
Own selection of grave (reserve) (extra)	110.00
Memorial (cremation)	250.00

JOHN GIBSON, trustee
 GERALD GODFREY trustee
 ALBERT TONKIN, trustee

Cemeteries Act 1958

SCALE OF FEES

By resolution of the Trust the following fees will apply in the Lilydale Lawn, Lilydale Memorial Park, Yarra Glen & Healesville Public Cemeteries from the date of approval by the Governor in Council. All other fees are rescinded to the extent to which they conflict with this scale.

MONUMENTAL GRAVES	\$
Monumental grave includes site and sinking to 2.1m	
Lilydale Lawn Cemetery	2,253.00
Healesville Cemetery	1,822.00
Yarra Glen Cemetery	1,822.00
Sinking pre-purchased grave to 2.1m	1,219.00
Re-open Grave	1,219.00

PRE-PURCHASE MONUMENTAL GRAVE	
Healesville Cemetery	603.00
Yarra Glen Cemetery	603.00
LAWN GRAVES	
Lawn grave includes site and sinking to 2.1m	
Lilydale Memorial Park	2,117.00
Lilydale Lawn Cemetery	2,117.00
Healesville Cemetery	1,686.00
Yarra Glen Cemetery	1,686.00
Sinking pre-purchased grave to 2.1m	1,083.00
Re-open all lawn graves	1,034.00
PRE-PURCHASE LAWN GRAVE	
Lilydale Memorial Park	1,309.00
Healesville	878.00
Yarra Glen	878.00
GARDEN LAWN GRAVE	
(Headstone not included) includes site and sinking to 2.1m	3,960.00
Pre-purchase garden lawn grave	3,201.00
PAVILLION LAWN GRAVE	
Includes site and sinking to 2.1m	3,097.00
Pre-purchase pavilion lawn grave	2,289.00
CONCRETE LINED GRAVE	
Concrete Lined grave (Vault) includes site concrete liner and 1st Interment	
Lilydale Memorial Park	8,425.00
Lilydale Lawn Cemetery	8,425.00
Healesville Cemetery	7,583.00
Re-open concrete lined grave	1,325.00
PRE-PURCHASED CONCRETE LINED GRAVE	
Lilydale Memorial Park	7,375.00
Healesville Cemetery	6,533.00
CHILDREN'S LAWN GRAVE	
Children's lawn grave includes site, sinking and vase receptacle, No Plaque included (maximum coffin length 1.10m)	
Lilydale Memorial Park	879.00
Healesville Cemetery	879.00
Remove ledger, replace and reseal	383.00
Extra sinking depth to 2.7m	265.00
Lilydale Lawn Cemetery	
Lilydale Memorial Park	
Yarra Glen Cemetery	
Healesville Cemetery	

MEMORIAL FEES	
All Cemeteries	
Lilydale Lawn Cemetery	
Lilydale Memorial Park	
Healesville Cemetery	
Yarra Glen Cemetery	10%
CREMATION FEES	
Child – 1 to 12 years of age with service in Chapel	350.00
Child – 1 to 12 years of age delivery only	300.00
Stillborn – 12 months with service in Chapel	170.00
Stillborn – 12 months delivery only	120.00
CREMATION	
Delivery only	685.00
Cremation with service in Chapel	735.00
PRE-NEED CREMATION	
Delivery only	685.00
PRE-NEED SERVICE – CREMATION	
With service in Chapel	735.00
SERVICE ONLY	
Chapel service only	160.00
CATERING CHARGES	
Menu 1 – Up to 60 Guests	
Tea, Coffee, Cordial & Assorted Biscuits	210.00
Additional \$3.50 per head	
Menu 2 – Minimum 40 Guests	
Tea, Coffee, Cordial, Assorted Biscuits & Platter of mixed cakes (1 piece per head)	200.00
Additional \$5.00 per head	
Menu 3 – Minimum 40 Guests	
Tea, Coffee, Cordial, Assorted Biscuits, Sandwiches (3 pieces per head), Platter of mixed cakes (1 piece per head)	240.00
Additional \$6.00 per head	
Menu 4 – Minimum 40 Guests	
Tea, Coffee, Cordial, Assorted Biscuits, Hot Finger Food (3 pieces per head), Platter of mixed cakes (1 piece per head)	320.00
Additional \$8.00 per head	
Catering items by Special request	Cost +100%
Menu 5 – Minimum 40 Guests	
Tea, Coffee, Cordial, Hot Finger Food (3 pieces per head), Sandwiches (3 pieces per head), Platter of Mixed cakes (1 piece per head)	400.00
Additional \$10.00 per head	
Additional Options	Cost + 100%

ADDITIONAL INFORMATION

Items by special request not listed in account list.	Contractor fee + 80%
After hours fee	354.00
POSTAGE	
Cremated remains	Cost + 50%
Administration fee	150.00
Grave selection fee	50.00
	Mr JOHN UPTON, trustee
	Mr RAY SHEEDY, trustee
	Mr ROD BLACKBURN, trustee

Cemeteries Act 1958

SCALE OF FEES

By resolution of the Trust, the following fees will apply in the Narrawong Public Cemetery from the date of approval by the Governor in Council. All other fees are rescinded to the extent to which they conflict with this scale.

	\$
Land 2.44 m x 1.22 m	170.00
Administration per interment	80.00
Permission to erect headstone	65.00
Exhumation	1,030.00
	IVAN BOYER, trustee
	EDWARD TAYLOR, trustee
	CHARLES PETERS, trustee

Cemeteries Act 1958

SCALE OF FEES

By resolution of the Trust, the following fees will apply in the Tatura Public Cemetery from the date of approval by the Governor in Council. All other fees are rescinded to the extent to which they conflict with this scale.

LAWN SECTION	\$
Land	780.00
Sinking grave	290.00
Interment	100.00
Flower container	35.00
Infant grave in special lawn area	355.00
Plus Plaques at	Contract price plus 20%
VAULTS	
Vault	2,835.00
Opening & Sealing	425.00
Interment	100.00

MONUMENTAL GRAVES

Land	316.00
Sinking	295.00
Interment	100.00
Removal of slab at	Contract price

INTERMENT OF ASHES

Private Grave	75.00
Niche Wall	85.00
Memorial Garden	75.00
Concrete block to suit 9x7 inch plaque	100.00
Shrub	100.00
Interment fee	100.00
Plus plaques at	Contract price plus 20%

MISCELLANEOUS CHARGES

Reservation of a site	Cost of land
Exhuming when authorized	1,350.00
Search fee	15.00
Extra depth, Saturday, Sunday, & Public Holidays	150.00
Permission to erect a monument	\$25.00 minimum or 10% of total cost

CONSTRUCTION OF PRIVATE MAUSOLEUMS

Application fee	525.00
Land per single site	350.00
Non refundable fee per crypt	525.00
10% of cost of monument	
Includes GST	

BRIAN WOODMAN, trustee
 WILLIAM CRAVEN, trustee
 GEORGE TAYLOR (Jr), trustee

Cemeteries Act 1958

SCALE OF FEES

By resolution of the Trust, the following fees will apply in the Geelong Cemeteries Trust from the date of approval by the Governor in Council. All other fees are rescinded to the extent to which they conflict with this scale.

FEE incl. GST
 \$

1. FEE FOR RIGHT OF BURIAL
 - A grave for adults (at-need or pre-need)
 - (a) Lawn areas, non-denominational
 - *limit of 2 adult burials per grave, or 3 burials subject to the prior agreement of the Trust
 - *interment fee is additional

In approved bronze plaque memorial areas	1,133.00
In approved headstone memorial areas	1,133.00
In approved lawn monument memorial areas	1,727.00
(b) Monument (non-lawn) areas, denominational	836.00
*limit of 2 adult burials per grave, or 3 burials subject to the prior agreement of the Trust	
*interment fee is additional	
Monument areas, with foundations for a monument pre-installed by the Trust (subject to availability)	1,144.00
(c) Concrete-lined graves – EASTERN CEMETERY ONLY	5,500.00
*limit of 2 interments per grave	
*subject to availability	
*interment fee and sand are additional	
Lawn area graves for children (includes interment fee)	
*maximum coffin dimensions for Children's lawn areas	
1250 mm x 500 mm (incl. handles)	
Child to 3 months (incl. stillborn)	297.00
Child over 3 months and under 11 years	418.00
Second interment	88.00
Child's Lawn Garden (Under 11 years) – BARRABOOL HILLS CEMETERY, GEELONG MEMORIAL PARK AND FLINDERS MEMORIAL PARK ONLY	561.00
Saturdays or public holidays (when permitted) Additional	242.00
2. INTERMENT FEES (at-need or pre-need)	
(a) Sinking or re-opening of grave to 2.4m long by 1.2m wide by 2.3m deep	
Weekdays, to 4.00 pm arrival	935.00
Saturdays or public holidays (when permitted) Additional	242.00
(b) Public graves – EASTERN CEMETERY ONLY	
Upon presentation to the Trust of an Order signed by a Magistrate directing that the body of a poor person be buried free of charge. Interment is included, and there is no exclusive Right of Burial	Nil
(c) Additional charges	
Sand or loam for backfilling grave	99.00
Insufficient notice	99.00
Late fee: after 4.00 p.m., Monday to Friday	187.00
after 12.00 noon, Saturdays	187.00
Acting on altered instructions from the Funeral Director, to enlarge (if possible) the dimensions of an open grave after it has been dug to the Funeral Director's original confirmed instructions	275.00
Sinking to 2.7m deep (when permitted) weekdays to 4.00 pm	1,001.00
Removal of ledger	143.00
Casket fee (or oversize coffin), grave larger than 2.4m long by 1.2m wide	143.00
Exhumation (when approved)	1,804.00
Interment of cremated remains in a grave, with entry in Trust Register	
– without mourners attending	165.00
– with mourners attending	220.00
Mourners attend placement of cremated remains at a memorial	55.00

3. MISCELLANEOUS CEMETERY CHARGES		
(a) Certificate of Right of Burial (optional)		
(b) Administration fee for surrender to the Trust of an unexercised Right of Burial, including grave maintenance fee.		
4% of the original fee paid for each completed year since the Right of Burial was issued, subject to a minimum of 12%.		
(c) Search fee- routine		22.00
– by surname per surname		11.00
– extended per hour		44.00
(d) Permit fees for monument work, including renovations:		
If, in the opinion of the Trust, the retail value of the monument work for which a permit is sought has been understated, the Trust may require payment of a permit fee based on the Trust's estimate of the retail value of the proposed work.		
● Retail value up to \$1,100 (incl. GST)	% of retail value (incl. GST)	10%
● Retail value over \$1,100 value (incl. GST)	{% of retail value (incl. GST) {minimum	7% 110.00
● Additional inscription		
* retail value up to \$1,100 (incl. GST)	{% of retail value (incl. GST) {minimum	10% 22.00
* retail value over \$1,100 (incl. GST)	{% of retail value (incl. GST) {minimum	7% 110.00
● Flower Containers or approved attachments not included on original permit	{% of retail value (incl. GST)	7%
● Replacement copy of a monument permit		22.00
● Search for permit per half hour or part thereof		22.00
(e) Installation on a grave of an approved bronze plaque purchased other than through the Trust		132.00
(e) Entry in Trust Register to record cremated Remains interred in a coffin		44.00
(g) Children's Memorial wall position (East or West)		
– memorial for child's public burial (under 2 years of age), includes position & bronze plaque (8 lines) 137mm x 102mm (motifs extra)		275.00
4. CREMATORIUM		
(a) Use of Chapel, at need (for cremation or burial) committal service (30 minutes maximum)		66.00
– full service (60 minutes maximum)		88.00
(b) Cremation Fee, at-need		
*there are no concession rates for pensioners or ex-service personnel		
Weekdays, not including use of chapel		
– Adult, delivered for cremation before 10.00 a.m.		682.00
– Adult, delivered for cremation from 10.00 a.m.		748.00
– Stillborn to 1 month of age		110.00
– Child 1 month to under 6 years		286.00
– Child 6 years to under 11 years		407.00
Saturday mornings and public holidays (when permitted)		
– Adult or child Additional		242.00

(c) Cremation Fee, pre-need	
Weekdays. Optional use of chapel included.	
– Adult, delivered for cremation before 10.00 a.m.	682.00
– Adult, delivered for cremation from 10.00 a.m.	748.00
(d) Miscellaneous Charges:	
Collection of cremated remains	
*notice required, available 24 hours after cremation	Nil
Packaging and despatch of cremated remains	
*within Australia	66.00
*outside Australia	110.00
5. MEMORIALISATION OF CREMATED REMAINS	
All new positions provided by Geelong Cemeteries Trust (“the Trust”) for the memorialisation of cremated remains are subject to a tenure period of 50 years from the date on which application is made for each such position. Positions arranged pre-need are subject to the same tenure period of 50 years, irrespective of whether the cremated remains occupy the position for a shorter time. All memorials are offered subject to availability. Some existing Niche Walls at the Eastern and Western cemeteries have provision to accept only a token amount of cremated remains in each niche.	
The Trust will not accept payment for memorial plaques until the time each plaque is ordered.	
Installation at a cremation memorial of an approved bronze plaque purchased other than through the Trust	44.00
GEELONG MEMORIAL PARK, MT. DUNEED	
Niche Wall (single position) Range	374.00
	594.00
	792.00
Memorial Wall plaque position	
(with cremated remains placed at an unmarked location in the grounds of the crematorium)	264.00
Rose Garden (single position)	561.00
Crescent Shrub Garden, border position	451.00
Shared Tree (includes cost of 4 positions)	
(Total of 16 positions at the tree)	4,620.00
Family Tree, subject to availability	
(includes cost of the only 4 positions at the tree)	9,020.00
Family Tree Garden, subject to availability	
(includes cost of the only 4 positions at the tree)	11,000.00
Family Shrub Garden (includes cost of 4 positions)	2,409.00
EASTERN CEMETERY GEELONG	
Niche Wall (single position – token remains only)	242.00
Weeping Rose Garden position (single position)	
(Total of 12 positions at each rose, each position sold individually)	451.00
Rose Garden Border position (single position)	451.00
Geddie Rose Garden border position (single position)	451.00
Paved Rose Garden (single position)	561.00

Fountain Garden			
● Standard rose (single position)			561.00
● Weeping cherry tree			
* 2 of 4 positions			3,410.00
● Fountain naming rights, to include all 4 positions at nearby cherry tree			11,000.00
MT. DUNEED CEMETERY			
Memorial Garden (single position)			451.00
DRYSDALE CEMETERY			
Native Shrub & Rose Garden, single border position			451.00
PORTARLINGTON CEMETERY			
Memorial Shrub Garden, single border position			451.00
6. CREMATED REMAINS – OTHER			
Strewing of cremated remains by the Trust, with entry in Trust Register			
(1) at unmarked position as determined by the Trust (no mourners present)			Nil
(2) at an unmarked position which is at a specified location agreed by the Trust (no mourners present)			44.00
Removal of cremated remains from a memorial for collection or transfer to another position within the cemetery			44.00
Attendance by mourners at placement or strewing of cremated remains			55.00
7. BOOK OF REMEMBRANCE			
These prices are inclusive of 10% GST			
	Entry in Book of Remembrance \$	Leather Bound Miniature Book \$	
2 line entry	143.00	143.00	
3 line entry	165.00	165.00	
4 line entry	187.00	187.00	
5 line entry – maximum	209.00	209.00	
Optional motif – only with 5 line entry	154.00	154.00	
	Remembrance Card \$	Leather Book (Additional entry) \$	
2 line entry	66.00	66.00	
3 line entry	88.00	88.00	
4 line entry	110.00	110.00	
5 line entry – maximum	132.00	132.00	
Optional motif – only with 5 line entry	110.00	110.00	
GEELONG WESTERN PUBLIC CEMETERY			
Niche Wall (single position – new walls) Range			352.00
			451.00
			550.00
Niche wall (double position) Range			517.00
			616.00
			715.00
Memorial Cross, garden border (single position)			451.00
Rose Position (single position)			
(Total of 4 positions at each rose, each position sold individually)			451.00

Lavender or Shrub Garden (single border position)		451.00
Garden of Reflection:		
● Standard rose position (single)		561.00
● Fountain position (single)		594.00
● Weeping rose position (single)		451.00
Norman Bender Garden:		
● Weeping Cherry Tree	2 of 4 positions	3,300.00
● Manchurian Pear Tree	2 of 4 positions	3,300.00
● Bench Seat	incl. all 2 positions	2,200.00
● Weeping Lilly Pilly	incl. all 2 positions	1,980.00
● Cypress Tree position	1 of 4 positons	550.00
BARRABOOL HILLS (HIGHTON) CEMETERY		
Garden Border Position (single position)		451.00
Standard Rose Position (at garden opposite rotunda)		
– total of 4 positions at each rose		561.00
Niche Wall (single position)	Range	352.00
		451.00
		550.00
Niche Wall (double position)	Range	517.00
		616.00
		715.00
Rapids Garden:		
Standard rose position (single) (4 positions at each rose)		561.00
Memorial boulder position (single)		726.00
Shrub garden position (single)		451.00
Weeping Rose Garden position (single position)		
(Total of 12 positions at each rose, each position sold individually)		451.00
FLINDERS MEMORIAL PARK, LARA SOUTH		
Rose Garden (single position) (total of 4 positions at each rose)		561.00
Family Tree Garden, subject to availability		
(includes cost of the only 4 positions at the tree)		11,000.00
LEOPOLD CEMETERY		
Memorial Shrub Garden, single border position		451.00
Family Boulder in Memorial Shrub Garden		
(includes 4 positions & boulder name plate)		2,310.00
Native Shrub Garden position		451.00
8. BRONZE CEMETERY PLAQUES		
	ITEM	PLAQUE SIZE
Single Plaque – up to 6 lines		381mm x 216mm (15" x 8.5")
*Plain design		319.00
*Book of Life		330.00
*Special design		374.00
Single Plaque – up to 8 lines		381mm x 279mm (15" x 11")
Single Plaque – up to 8 lines		305mm x 279mm (11" x 12")
Single Plaque – up to 4 lines		559mm x 305mm (22" x 12")
		495.00

Double Plaque – Provision for 2nd interment, includes 1st D/Plate	559mm x 305mm (22" x 12")	594.00
* 3 lines of inscription on main plaque & * 5 lines on D/Plate		
Detachable Plate for Double Plaque – up to 5 lines (max.17 letters & spaces per line)	5 lines maximum	121.00
Book of Life (Provision for 2nd interment) –up to 8 lines of inscription	559mm x 305mm (22" x 12")	638.00
Book of Life (2nd Page) – up to 8 lines of inscription	305mm x 279mm (11" x 12")	286.00
Additional lines	(all plaques)	26.40
Teddy	230 mm	330.00
Teddy	330 mm	484.00
Layout Proof		33.00
Memorial Plaque (for Cremated Remains in a Grave) on masonry paver	137mm x 102mm	187.00
Memorial Plaque – up to 12 lines	190mm x 190mm	220.00
Memorial Plaque – up to 6 lines	102mm x 80mm	143.00
Memorial Plaque – up to 8 lines	137mm x 102mm	165.00
Memorial Plaque – up to 10 lines	152mm x 152mm	198.00
Memorial Plaque – up to 12 lines	165mm x 210mm	220.00
Memorial Plaque – up to 12 lines	285mm x 210mm	253.00
Coloured plaques (burgundy, navy, green), where permitted	Additional	22.00
The Trust will not pre-sell bronze memorial plaques.		
9. FLOWER CONTAINERS		
Eastern Cemetery – Plastic insert, brown (rectangle)		26.40
– Plastic insert, green (round)		11.00
Western Cemetery Lawn Section: – Plastic insert, brown (rectangle)		26.40
Barrabool Hills (Highton) – Concrete flower pot		13.20

NOTE: All prices are subject to variation without notice.

L.H. MILLER, trust member
I.D. MACDONALD, trust member
A.I. JICKELL, trust member

This Order is effective on the day of gazettal.

Dated 14 September 2004

Responsible Minister:
HON BRONWYN PIKE MP
Minister for Health

ANDREW MARRIOTT
Acting Clerk of the Executive

Cemeteries Act 1958

DISCONTINUANCE OF BURIALS

Glenpatrick Public Cemetery

Order in Council

The Governor in Council under section 44 of the **Cemeteries Act 1958**, and on the recommendation of the Minister for Health, directs that burials in the Glenpatrick Public Cemetery discontinue after the expiry of a period of three months from the date of Gazettal.

Dated 14 September 2004

Responsible Minister
HON BRONWYN PIKE MP
Minister for Health

ANDREW MARRIOTT
Acting Clerk of the Executive Council

Children and Young Persons Act 1989

ESTABLISHMENT OF COMMUNITY SERVICES

Order in Council

The Governor in Council, acting under section 57 of the **Children and Young Persons Act 1989**, and on the recommendation of the Minister for Community Services, with effect from the date of publication in the Government Gazette:

Establishes the following community services:

Jessie Street Contingency Unit
49 Jessie Street
PRESTON

Jukes Road Residential Community Facility
168 Jukes Road
FAWKNER

Melbourne Avenue Family Group Home
170 Melbourne Avenue
GLENROY

Elizabeth Street Family Group Home
31a Elizabeth Street
COBURG

Marjorie Street Residential Unit
27 Marjorie Street
PRESTON

Heatherlea Crescent Family Group Home
29 Heatherlea Crescent
KEILOR PARK

Heatherlea Crescent Contingency Unit
11 Heatherlea Crescent
KEILOR PARK

Kerrison Avenue Contingency Unit
9 Kerrison Avenue
ST ALBANS

Dated 14 September 2004

Responsible Minister
HON SHERRYL GARBUTT
Minister for Community Services

ANDREW MARRIOTT
Acting Clerk of the Executive Council

Crown Land (Reserves) Act 1978

NOTICE OF INTENTION TO REVOKE TEMPORARY RESERVATIONS

The Governor in Council under section 10 of the **Crown Land (Reserves) Act 1978** gives notice of intention to revoke the following temporary reservations:

BELLARINE – The temporary reservation by Order in Council of 27 August 1963 of an area of 835 square metres of land in Section 4, Parish of Bellarine as a site for Police purposes. – (Rs 8241).

CRESWICK – The temporary reservation by Order in Council of 23 August 1977 of an area of 12.15 hectares of land in three separate portions being Crown Allotment 1A, Section 21; Crown Allotment 9, Section 23, and Crown Allotment 1, Section 59, Township of Creswick, Parish of Creswick as a site for Public Purposes (Forest Commission purposes), revoked as to part by Order in Council of 21 June 1994 so far only as the portion being Crown Allotment 1, Section 59, Township of Creswick, Parish of Creswick. – (Rs 10424).

JEFFCOTT – The temporary reservation by Order in Council of 22 November 1880 of an area of 16.547 hectares of land in Parish of Jeffcott as a site for Public purposes, revoked as to part by various Orders, so far as the balance remaining containing 14.05 hectares, more or less. – (Rs 1465).

JEFFCOTT – The temporary reservation by Order in Council of 15 March 1892 of an area of 2023 square metres of land in Parish of Jeffcott (formerly part of Crown Allotment 78A) as a site for a Mechanics' Institute and Free Library. – (Rs 1465).

LANDSBOROUGH – The temporary reservation by Order in Council of 4 October 1886 of an area of 8.094 hectares, more or less, of land in Section 4, Parish of Landsborough as a site for supply of material for Road-making purposes, revoked as to part by Order in Council of 24 January 1967 so far as the balance remaining containing 5.868 hectares, more or less. – (2003928).

MOE – The temporary reservation by Order in Council of 12 December 1938 of an area of 1219 square metres of land in Section 9, Township of Moe, Parish of Moe (formerly portion of Crown Allotment 4) as a site for Police purposes. – (Rs 4892).

MOE – The temporary reservation by Order in Council of 12 January 1982 of an area of 70.1 square metres of land being Crown Allotment 20, Section 9, Township of Moe, Parish of Moe as a site for Police purposes. – (Rs 4892).

MOYREISK – The temporary reservation by Order in Council of 6 June 1892 of an area of

20.234 hectares, more or less, of land in Section 1, Parish of Moyreisk as a site for Water Supply purposes, revoked as to part by Orders in Council of 18 April 1905 and 15 July 1913 so far as the balance remaining containing 7.327 hectares, more or less. – (Rs 14201).

WORMANGAL – The temporary reservation by Order in Council of 21 February 1870 of an area of 63.94 hectares of land in the Parish of Wormangal (formerly Crown Allotment 32) as a site for Watering purposes, revoked as to part by Order in Council of 5 September 1887 so far as the balance remaining containing 15.86 hectares, more or less. – (Rs 804666).

This Order is effective from the date on which it is published in the Government Gazette.

Dated 14 September 2004

Responsible Minister
MARY DELAHUNTY
Minister for Planning

ANDREW MARRIOTT
Acting Clerk of the Executive Council

Crown Land (Reserves) Act 1978

REVOCATION OF TEMPORARY RESERVATIONS

The Governor in Council under section 10 of the **Crown Land (Reserves) Act 1978** revokes the following temporary reservations:

SCARSDALE – The temporary reservation by Order in Council of 14 February 1882 of an area of 8094 square metres more or less, of land in Section 50, Parish of Scarsdale as a site for conservation of Water. – (0513733).

WARRACKNABEAL – The temporary reservation by Order in Council of 7 September 1903 of an area of 6.66 hectares of land in Section 27, Township of Warracknabeal, Parish of Werrigar as a site for Public Recreation, so far only as the portion containing 1127 square metres being Crown Allotment 2001, Township of Warracknabeal as indicated by hatching on plan published in the Government Gazette on July/August 2004 page 2144. – (Rs 02154).

WILL-WILL-ROOK – The temporary reservation by Order in Council of 20 May 1997 of an area of 687 square metres of land being Crown Allotment 3F, Parish of Will-will-rook as a site for Cemetery purposes, so far only as the portion containing 562 square metres being

Crown Allotment 2003, Parish of Will-will-rook as indicated by hatching on plan published in the Government Gazette on July/August 2004 page 2144. – (Rs 8641).

This Order is effective from the date on which it is published in the Government Gazette.

Dated 14 September 2004

Responsible Minister
 MARY DELAHUNTY
 Minister for Planning

ANDREW MARRIOTT
 Acting Clerk of the Executive Council

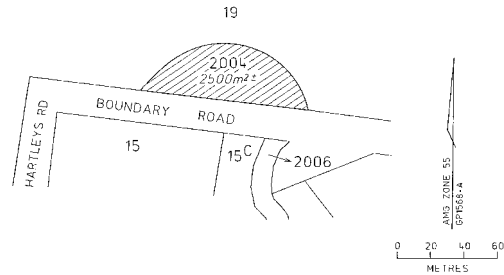

MUNICIPAL DISTRICT OF
 THE SURF COAST SHIRE COUNCIL
 ANGAHOOK – Public purposes, area 9 hectares, more or less, being Crown Allotment 2007, Parish of Angahook as indicated by hatching on plan hereunder. (GP1568B) – (Rs 7974).

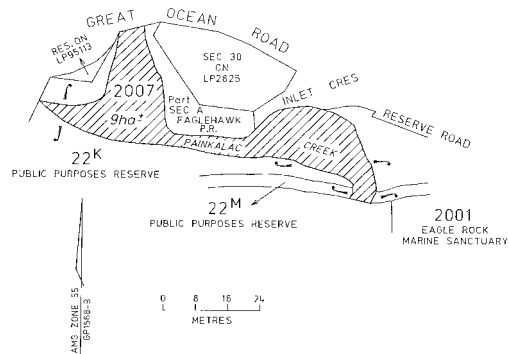

MUNICIPAL DISTRICT OF
 THE CITY OF BALLARAT
 BALLARAT – Educational purposes, 1164 square metres, being Crown Allotment 63A, Section 4A, Township of Ballarat, Parish of Ballarat as indicated by hatching on plan hereunder. (GP1586) – (0505393).

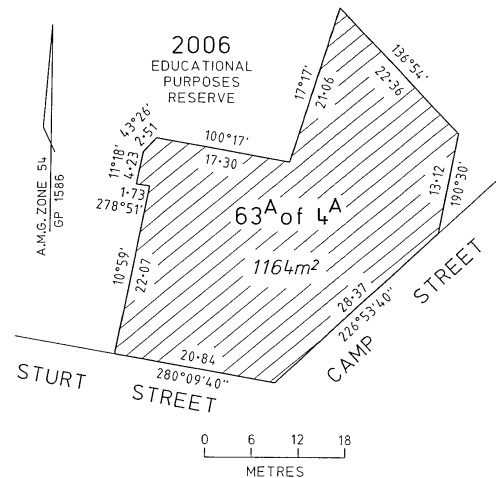

Crown Land (Reserves) Act 1978
 TEMPORARY RESERVATION
 OF CROWN LANDS

The Governor in Council under section 4(1) of the **Crown Land (Reserves) Act 1978** temporarily reserves the following Crown lands which in his opinion are required for the purposes mentioned:–

MUNICIPAL DISTRICT OF
 THE SURF COAST SHIRE COUNCIL
 ANGAHOOK – Public purposes, combined area 7.75 hectares, more or less, being Crown Allotment 2, Section A, and Crown Allotments 2004 and 2006, Parish of Angahook as indicated by hatching on plans hereunder. (GP1568 & 1568A) – (Rs 5369).

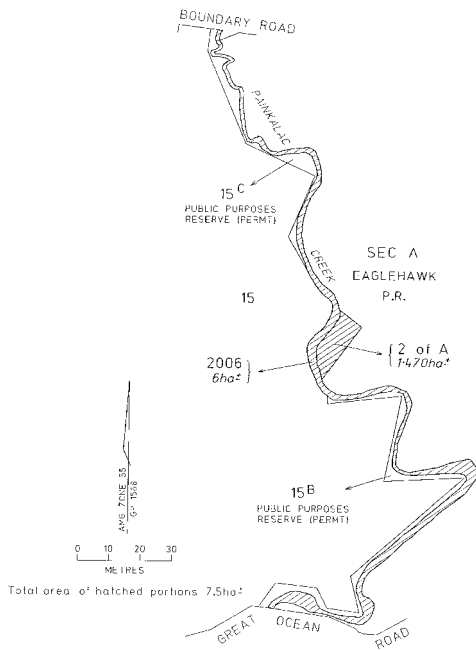

MUNICIPAL DISTRICT OF THE CITY OF BALLARAT

BORHONEYGHURK – Public Recreation, 3.885 hectares, being Crown Allotment 102B, Parish of Borhoneyghurk as indicated by hatching on plan hereunder. (GP1590) – (052013931).

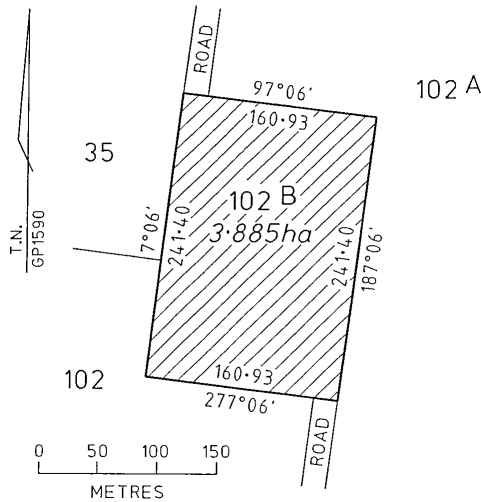

indicated by hatching on plan hereunder. (GP1252A) – (Rs 1109905).

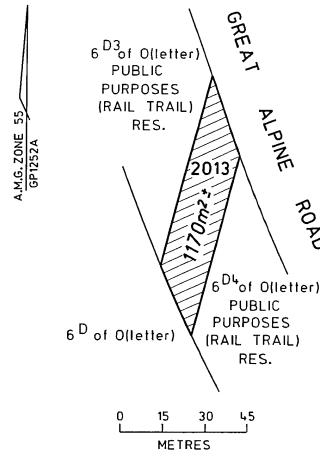

MUNICIPAL DISTRICT OF THE CITY OF BALLARAT

BUNINYONG – Public Recreation, 8.74 hectares, more or less, being Crown Allotment 2010, Parish of Buninyong as indicated by hatching on plan hereunder. (GP1588A) – (052013932).

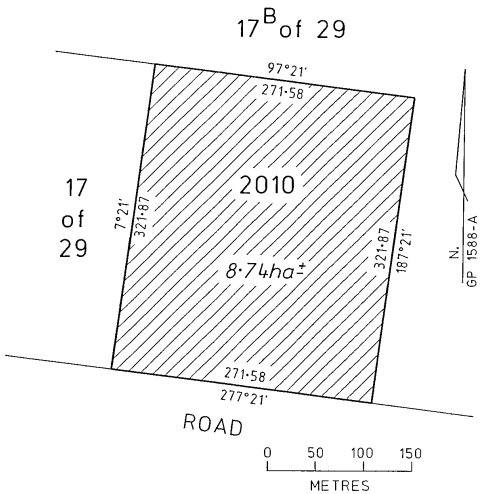

MUNICIPAL DISTRICT OF THE GOLDEN PLAINS SHIRE COUNCIL

SCARSDALE – Public Recreation, 9207 square metres being Crown Allotment 2008, Parish of Scarsdale as shown on Original Plan No. 122126 lodged in the Central Plan Office of the Department of Sustainability and Environment. (0513733).

MUNICIPAL DISTRICT OF THE YARRIAMBICK SHIRE COUNCIL

WARRACKNABEAL – Pre-school Centre, 1127 square metres being Crown Allotment 2001, Township of Warracknabeal, Parish of Werrigar as indicated by hatching on plan hereunder. (GP1557) – (Rs 02154).

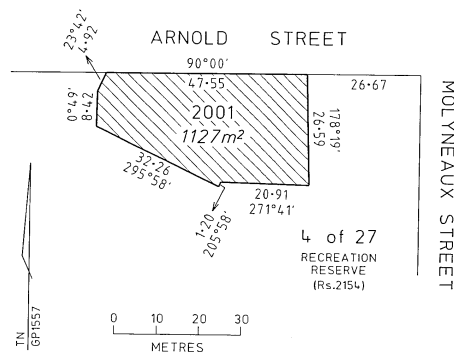

MUNICIPAL DISTRICT OF THE ALPINE SHIRE COUNCIL

MYRTLEFORD – Public purposes (Rail Trail), 1170 square metres, more or less, being Crown Allotment 2013, Parish of Myrtleford as

MUNICIPAL DISTRICT OF THE MORELAND CITY COUNCIL

WILL-WILL-ROOK – Public purposes (Police purposes), 8304 square metres, being Crown Allotment 2004, Parish of Will-will-rook as indicated by hatching on plan hereunder. (GP1386) – (Rs 37314).

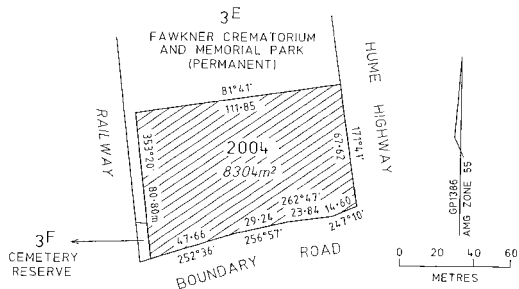

This Order is effective from the date on which it is published in the Government Gazette.

Dated 14 September 2004

Responsible Minister
 MARY DELAHUNTY
 Minister for Planning

ANDREW MARRIOTT
 Acting Clerk of the Executive Council

MUNICIPAL DISTRICT OF
 THE ALPINE SHIRE COUNCIL
 MYRTLEFORD – The road in the Parish of Myrtleford being Crown Allotment 2013 as indicated by hatching on plan hereunder. (GP1252A) – (L8-6839).

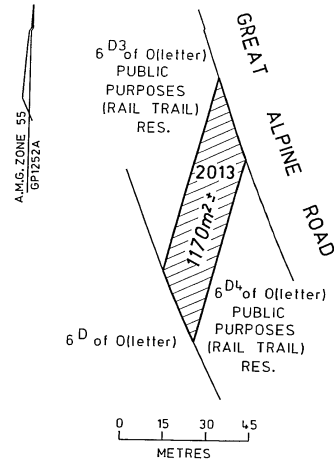

Land Act 1958

CLOSURE OF UNUSED ROADS

The Governor in Council under section 349 of the **Land Act 1958** and with the concurrence in writing of the municipalities in which the roads are situated and the owners of land adjoining those roads closes the following unused roads:

**MUNICIPAL DISTRICT OF
 THE CITY OF BALLARAT**

BUNINYONG – The road in the Parish of Buninyong being Crown Allotment 2009 as indicated by hatching on plan hereunder. (GP1588) – (052013932).

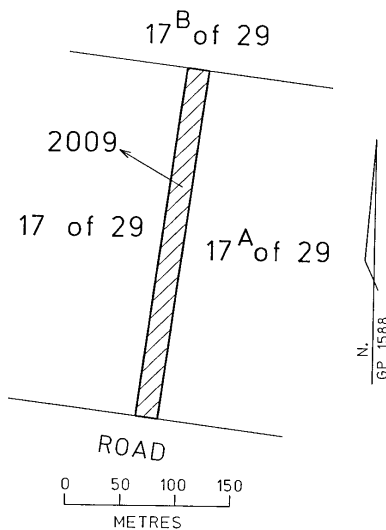

**MUNICIPAL DISTRICT OF
 THE MORNINGTON PENINSULA
 SHIRE COUNCIL**

WANNAEUE – The road in the Parish of Wannaeue shown as Crown Allotment 2001 on Original Plan No. 121708 lodged in the Central Plan Office. – (12L12-1159).

**MUNICIPAL DISTRICT OF
 THE CITY OF WODONGA**

WODONGA – The road in the Township of Wodonga, Parish of Wodonga being Crown Allotment 2022 as indicated by hatching on plan hereunder. (GP1595) – (L8-6922).

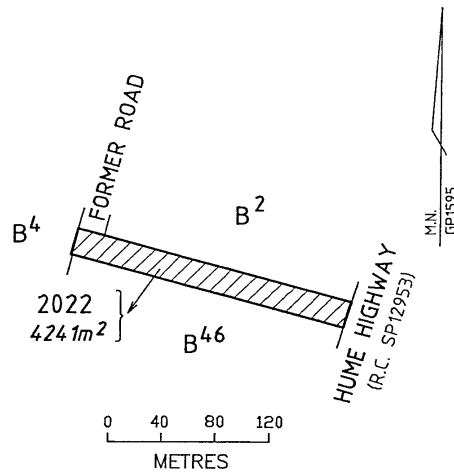

Land Act 1958

AMENDMENT TO TOWNSHIP AREA –
CRESWICK

The Governor in Council under Section 25(3)(d) of the **Land Act 1958** amends the area of the Township of Creswick, proclaimed on 17 April 1951, by the addition thereto of the land indicated by hatching on plan hereunder. (GP1602) – (0505940).

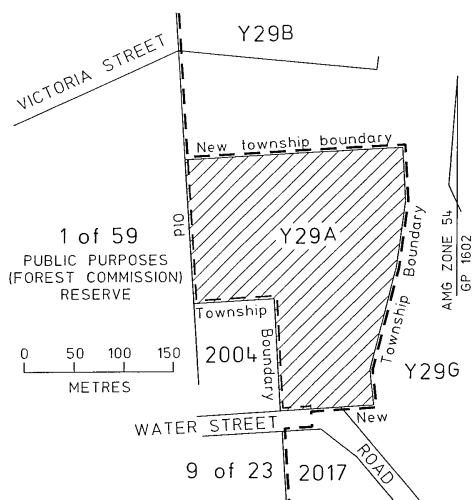

This Order is effective from the date on which it is published in the Government Gazette.

Dated 14 September 2004

Responsible Minister
MARY DELAHUNTY
Minister for Planning

ANDREW MARRIOTT
Acting Clerk of the Executive Council

This order is effective from the date it is published in the Government Gazette.

Dated 14 September 2004

Responsible Minister
JOHN THWAITES MP
Minister for Victorian Communities

ANDREW MARRIOTT
Acting Clerk of the Executive Council

Public Records Act 1973

SUSPENSION OF PROVISIONS OF
SECTIONS 9, 10 AND 11

Order in Council

The Governor in Council, under section 2(3) of the **Public Records Act 1973** declares that sections 9, 10 and 11 shall not apply in relation to public records held at Caval Collaborative Limited, 4 Park Drive, Bundoora.

This order is effective from the date it is published in the Government Gazette.

Dated 14 September 2004

Responsible Minister
JOHN THWAITES MP
Minister for Victorian Communities

ANDREW MARRIOTT
Acting Clerk of the Executive Council

Public Records Act 1973

SUSPENSION OF PROVISIONS OF
SECTIONS 9, 10 AND 11

Order in Council

The Governor in Council, under section 2(3) of the **Public Records Act 1973** declares that sections 9, 10 and 11 shall not apply in relation to public records held at Grace Records Management, 27/9 Ashley Street, West Footscray.

**SUBORDINATE LEGISLATION ACT 1994
NOTICE OF MAKING OF STATUTORY
RULES**

Notice is hereby given under Section 17 (2) of the **Subordinate Legislation Act 1994** of the making of the following Statutory Rules:

112. *Statutory Rule:* Ambulance Services (Exemption) Regulations 2004
Authorising Act: Ambulance Services Act 1986
Date of making: 14 September 2004
113. *Statutory Rule:* Building (Siting and Design) Regulations 2004
Authorising Act: Building Act 1993
Date of making: 14 September 2004

**SUBORDINATE LEGISLATION ACT 1994
NOTICE THAT STATUTORY RULES ARE
OBTAINABLE**

Notice is hereby given under Section 17 (3) of the **Subordinate Legislation Act 1994** that the following Statutory Rules were first obtainable from Information Victoria, 356 Collins Street, Melbourne on the date specified:

111. *Statutory Rule:* Fair Trading (Safety Standard) (Children's Toys) Regulations 2004
Authorising Act: Fair Trading Act 1999
Date first obtainable: 14 September 2004
Code B

**PRICING FOR SPECIAL GAZETTE,
PERIODICAL GAZETTE AND
VICTORIAN LEGISLATION**

Retail price varies according to the number of pages in each Victoria Government Special Gazette, Victoria Government Periodical Gazette and Victorian legislation. The table below sets out the prices that apply.

<i>Price Code</i>	<i>No. of Pages (Including cover and blank pages)</i>	<i>Price*</i>
A	1-16	\$3.70
B	17-32	\$5.50
C	33-48	\$7.55
D	49-96	\$11.75
E	97-144	\$15.20
F	145-192	\$17.95
G	193-240	\$20.70
H	241-288	\$22.05
I	289-352	\$24.80
J	353-416	\$29.00
K	417-480	\$33.10
L	481-544	\$38.60
M	545-608	\$44.10
N	609-672	\$49.65
O	673-736	\$55.10
P	737-800	\$60.65

**All Prices Include GST*

craftsmanpress

The *Victoria Government Gazette* is published by The Craftsman Press Pty Ltd with the authority of the Government Printer for the State of Victoria

© State of Victoria 2004

This publication is copyright. No part may be reproduced by any process except in accordance with the provisions of the Copyright Act.

Address all enquiries to the Government Printer for the State of Victoria
Level 2 1 Macarthur Street
Melbourne 3002
Victoria Australia

How To Order

Mail Order **Craftsman Press Pty Ltd**
125 Highbury Road
Burwood 3125
DX – 32510 Burwood



Telephone (03) 9926 1233



Fax (03) 9926 1292

email gazette@craftpress.com.au



Retail & Mail Sales **Information Victoria**
356 Collins Street
Melbourne 3000



Telephone 1300 366 356



Fax (03) 9603 9920



Retail Sales **City Graphics**
Level 1 520 Bourke Street
Melbourne 3000



Telephone (03) 9600 0977



Fax (03) 9600 0989

ISSN 0819-5471



9 770819 550454

Recommended Retail Price \$1.95 (includes GST)