



Victoria Government Gazette

By Authority of Victorian Government Printer

No. G 7 Thursday 17 February 2005

www.gazette.vic.gov.au

GENERAL

TABLE OF PROVISIONS

Private Advertisements		Government and Outer Budget Sector	
PM & R Reardon Superannuation Fund	265	Agencies Notices	272
Estates of Deceased Persons		Orders in Council	299
Aughtersons	265	Acts: Administrative Arrangements;	
Borchard & Moore	265	Cemeteries	
Cuthberts	265		
De Marco & Co.	266		
Dwyer Mahon & Robertson	266		
Engel & Partners Pty.	266		
Gullaci & Gullaci	266		
John Burgess & Co.	266		
John Stewart	267		
Judge & Papaleo	267		
Littleton Hackford	267		
Mahons with Yuncken & Yuncken	267		
Mason Sier Turnbull	268		
McNab McNab & Starke	268		
M. K. Steele & Giammario	268		
MMR Legal	268		
Rigby Cooke	268		
Roberts Beckwith Partners	268		
Ryan, Mackey & McClelland	269		
Stidston & Williams Weblaw	269		
Wisewoulds	269		
Sales by the Sheriff			
Mark Coules	269		
Aleksandar Mirkovic	270		
Unclaimed Moneys			
Gerard Hughes, Lawyer	271		
R. Malcolm Pty Ltd	271		

Advertisers Please Note

As from 17 February 2005

The last Special Gazette was No. 28 dated 14 February 2005.

The last Periodical Gazette was No. 2 dated 23 September 2004.

How To Submit Copy

- See our webpage www.craftpress.com.au
 - or contact our office on 9926 1233
between 8.30 am and 5.30 pm Monday to Friday
-

Copies of recent Special Gazettes can now be viewed at the following display cabinets:

- 1 Treasury Place, Melbourne (behind the Old Treasury Building), and
 - Craftsman Press Pty Ltd, 125 Highbury Road, Burwood 3125
(front of building).
-

PRIVATE ADVERTISEMENTS

Trustee Act 1958

DETERMINATION OF A TRUST
PURSUANT TO SECTION 33

The trustees of the PM & R REARDON SUPERANNUATION FUND have resolved that the Fund be determined in accordance with the Fund's Trust Deed. Notice is hereby given of the trustees' intention to make distribution of the Trust Fund in accordance with the Deed. The trustees require any person interested to send to Warren Graham & Murphy of 119 Main Street, Bairnsdale, Victoria 3875 within two months of the date of this notice particulars of their claim in respect of the Trust property or any part thereof. At the expiration of the said period of two months, the trustees may distribute the Trust property having regard only to claims to which they then have notice.

Dated 4 February 2005

WARREN GRAHAM & MURPHY, solicitors,
119 Main Street, Bairnsdale, Victoria 3875.

MONICA PHYLLIS DE BRUIN, late of "Olivet Aged Persons Home", 7-9 Rupert Street, Ringwood, Victoria, home duties, deceased. Creditors, next-of-kin and others having claims in respect of the estate of the abovenamed deceased, who died on 16 November 2003, are required by the executors, Reginald Felix Oorloff and Hilary Yolande Oorloff, both of 8 Heatherdew Close, Endeavour Hills, Victoria, to send particulars thereof to them care of the office of Messrs Aughtersons, 267 Maroondah Highway, Ringwood, within sixty days from the date of publication of this notice, after which the executors will distribute the estate having regard only to the claims of which they have notice.

AUGHTERSONS, solicitors,
current practitioners for the executors,
267 Maroondah Highway, Ringwood 3134.

Re: ALAN BLACK, late of Unit 4, 2 Rutherglen Street, Noble Park, Victoria, retired supervisor, deceased.

Creditors, next-of-kin and others having claims in respect of the estate of the deceased, who died on 2 December 2004, are required by

the trustees, Alan James Black of 23 Cairnes Crescent, Malvern East, Victoria, panel beater, and Betty Gweneth Gooch of Unit 4, 2 Rutherglen Street, Noble Park, Victoria, retired, to send particulars to the trustees by 29 April 2005 after which date the trustees may convey or distribute the assets, having regard only to the claims of which the trustees have notice.

BORCHARD & MOORE, solicitors,
44 Douglas Street, Noble Park 3174.

Re: PETER RONALD CALDWELL, late of 24 Sharrock Drive, Dingley, Victoria, retired technician, deceased.

Creditors, next-of-kin and others having claims in respect of the estate of the deceased, who died on 17 October 2004, are required by the trustees, Barbara Joan O'Brien of 28 Paterson Street, Numurkah, Victoria, home duties, and Patrick James O'Brien, in the Will called Patrick O'Brien, of 28 Paterson Street, Numurkah, Victoria, consultant, to send particulars to the trustees by 5 May 2005 after which date the trustees may convey or distribute the assets, having regard only to the claims of which the trustees have notice.

BORCHARD & MOORE, solicitors,
44 Douglas Street, Noble Park 3174.

Re: BRUCE EDWIN McDONALD, late of 29 Kennedys Road, Chepstowe, Victoria 3351, farmer, deceased.

Creditors, next-of-kin and others having claims in respect of the estate of the deceased, who died on 10 July 2004, are required by the executors, Andrew Robert Robson, Donald Bruce Robinson and Rodney Malcolm Jacobs, all of 101 Lydiard Street North, Ballarat, Victoria, to send particulars to the executors by 18 April 2005 after which date the executors may convey or distribute the assets, having regard only to the claims of which the executors have notice.

CUTHBERTS, solicitors,
101 Lydiard Street North, Ballarat 3350.

Re: REGINALD JOHN LARRAD, late of 24 Nepean Street, Broadmeadows, Victoria, retired truck driver, deceased.

Creditors, next-of-kin and others having claims in respect of the estate of the deceased, who died on 1 October 2004, are required by the trustee, Sola June Larrad of 24 Nepean Street, Broadmeadows, Victoria, to send particulars to the trustee within sixty days from the publication hereof, after which date the trustee may convey or distribute the assets, having regard only to the claims of which the trustee has notice.

DE MARCO & CO., solicitors,
209 Glenroy Road, Glenroy 3046.

Re: Estate of THELMA EDNA MAY GILLICK.

Creditors, next-of-kin or others having claims in respect of the estate of THELMA EDNA MAY GILLICK, formerly of 16 Cadell Street, Swan Hill, but late of Alcheringa Hostel, 44 Rutherford Street, Swan Hill, in the State of Victoria, widow, deceased, who died on 2 December 2004, are to send particulars of their claim to the executors care of the undermentioned legal practitioners by 6 May 2005 after which date the executors will distribute the assets having regard only to the claims of which they then have notice.

DWYER MAHON & ROBERTSON,
legal practitioners,
Beveridge Dome
194–208 Beveridge Street, Swan Hill.

Re: Estate of WILLIAM GEORGE BUTCHER.

Creditors, next-of-kin or others having claims in respect of the estate of WILLIAM GEORGE BUTCHER, late of Kalleista Hostel, 33–43 McClelland Avenue, Sea Lake, in the State of Victoria, retired gentleman, deceased, who died on 17 December 2004, are to send particulars of their claim to the executrix care of the undermentioned legal practitioners by 29 April 2005 after which date the executrix will distribute the assets having regard only to the claims of which she then has notice.

DWYER MAHON & ROBERTSON,
legal practitioners,
Beveridge Dome
194–208 Beveridge Street, Swan Hill.

Creditors, next-of-kin and others who have claims in respect of the estate of CLARENCE REUBEN EDDY, late of 31 McMillan Grove, Paynesville, retired, in the State of Victoria, deceased, who died on 26 November 2004, are to send particulars of their claims to the administrators care of Engel & Partners Pty of 109 Main Street, Bairnsdale by 17 May 2005 after which date it will distribute the assets having regard only to the claims of which it then has notice.

ENGEL & PARTNERS PTY, legal practitioners,
109 Main Street, Bairnsdale.

Re: LOIS KAY COBURN, late of 1265 Dandenong Road, East Malvern 3145, in the State of Victoria, home duties, deceased.

Creditors, next-of-kin and others having claims in respect of the estate of the abovenamed deceased, who died on 15 November 2004, are required by Russell Marshall Coburn, the executor of the said estate, to send particulars by 29 April 2005 to his solicitors, Gullaci & Gullaci, of 158 Bell Street, Coburg, after which date the executor may convey or distribute the assets, having regard only to the claims of which he then has notice.

Dated 11 February 2005

GULLACI & GULLACI, solicitors,
158 Bell Street, Coburg, Victoria 3058.

Re: ESMA IRENE ELLIOTT, late of 286 Police Road, Noble Park North, deceased. Creditors, next-of-kin and others having claims in respect of the estate of the deceased, who died on 8 July 2004, are required by the trustee to send particulars of their claim to her at the office of her solicitors, John Burgess & Co., solicitors, 255 Springvale Road, Springvale by 24 April 2005 after which date the trustee may convey or distribute the assets having regard only to the claims of which the trustee has notice.

JOHN BURGESS & CO., solicitors,
255 Springvale Road, Springvale 3171.

Re: MARGARET JUNE DODSON, late of 119 Lightwood Road, Noble Park, deceased. Creditors, next-of-kin and others having claims

in respect of the estate of the deceased, who died on 13 August 2004, are requested by the trustee to send particulars of their claim to him at the office of his solicitors, John Burgess & Co., solicitors, 255 Springvale Road, Springvale by 24 April 2005 after which date the trustee may convey or distribute the assets having regard only to the claims of which the trustee has notice.

JOHN BURGESS & CO., solicitors,
255 Springvale Road, Springvale 3171.

Creditors, next-of-kin and others having claims in respect of the Will of GIOVANNA PAGNIN, late of 122 Sterling Drive, East Keilor, Victoria, widow, deceased, who died on 8 January 2005, are requested to send particulars of their claims to the executor, Vincenzo Pagnin, care of the undermentioned legal practitioner by 18 April 2005 after which date he will distribute the assets having regard only to the claims of which he then has notice.

JOHN STEWART, legal practitioner,
290 Racecourse Road, Newmarket.

STELLA LOUISE TWEEDIE, late of 139 Atherton Road, Oakleigh, Victoria, pensioner, deceased. Creditors, next-of-kin and others having claims in respect of the estate of the deceased, who died on 11 October 2004, are required by the personal representative of Stella Louise Tweedie, namely Wilma Minogue of 55 Rosella Street, Murrumbeena, Victoria, to send particulars to her by 17 April 2005, after which date the personal representative may convey or distribute the assets, having regard only to the claims of which she then has notice.

Dated 17 February 2005

JUDGE & PAPALEO, solicitors,
33–37 Hotham Street, Collingwood, Vic. 3066.

Creditors, next-of-kin and others having claims in respect of the estate of STEWART ROSSITER CARTER, late of Unit 1, 13 Hunter Road, Traralgon, Victoria, retired Lands Department inspector, deceased, who died on 5 January 2005, are to send their claims to the trustee, Gregory Stewart Carter of RMB 3070, Morgan Drive, Traralgon South, Victoria, care of the below-mentioned solicitors by 18 April

2005 after which date he will distribute the assets of the deceased having regard only to the claims of which he then has notice.

LITTLETON HACKFORD, solicitors,
Law Chambers,
115–119 Hotham Street, Traralgon. Vic. 3844.

Re: ANNA SOCHON, late of Unit 57, Karingal Court, Inala Village, 220 Middleborough Road, Blackburn South, widow, deceased.

Creditors, next-of-kin and others having claims in respect of the estate of the deceased, who died on 24 April 2004, are required by the trustee, Joseph Adam Semenow, to send particulars to the trustee care of Mahons with Yuncken & Yuncken by 18 April 2005 after which date the trustee may convey or distribute the assets, having regard only to the claims of which the trustee has notice.

MAHONS WITH YUNCKEN & YUNCKEN,
solicitors,
178 Whitehorse Road, Blackburn 3130.

Re: DUDLEY EUGENE CALLAHAN, late of Darley House East Repatriation Hospital, Heidelberg West, Victoria, but formerly of 94 Wungan Street, Macleod, Victoria, retired, deceased.

Creditors, next-of-kin and others having claims in respect of the estate of the deceased, who died on 19 January 2004, are required by the trustee, Anthony John Mahon, to send particulars to the trustee care of Mahons with Yuncken & Yuncken by 18 April 2005 after which date the trustee may convey or distribute the assets, having regard only to the claims of which the trustee has notice.

MAHONS WITH YUNCKEN & YUNCKEN,
solicitors,
178 Whitehorse Road, Blackburn 3130.

Re: MARY URSULA KIERCE, late of Unit 2, 48 Brunswick Road, Mitcham, Victoria, deceased.

Creditors, next-of-kin and others having claims in respect of the estate of the deceased, who died on 2 May 2004, are required by the trustee, Anthony John Mahon, to send particulars to the trustee care of Mahons with

Yuncken & Yuncken by 18 April 2005 after which date the trustee may convey or distribute the assets, having regard only to the claims of which the trustee has notice.

MAHONS WITH YUNCKEN & YUNCKEN,
solicitors,
178 Whitehorse Road, Blackburn 3130.

Re: LEILA CLYDE ALGIE, late of 31 Begonia Street, Box Hill South, Victoria, retired, deceased.

Creditors, next-of-kin and others having claims in respect of the estate of the deceased, who died on 3 July 2004, are required by the trustees, Jillian Anne Cobb and John Scott Turnbull, to send particulars to the trustees care of the undermentioned solicitors by 18 April 2005 after which date the trustees may convey or distribute the assets, having regard only to the claims of which the trustees have notice.

MASON SIER TURNBULL, solicitors,
315 Ferntree Gully Road, Mount Waverley 3149.

Re: MARJORIE PHYLLIS SCOTT, late of 24 Bedford Street, Airport West, in the State of Victoria.

Creditors, next-of-kin and others having claim in respect of the estate of the above deceased, who died at Airport West on 1 July 2004, are required by the executrix and trustee of the said deceased, Cheryle Rhonda Shaw, care of McNab McNab & Starke of 21 Keilor Road, Essendon, to send particulars to her by 21 April 2005 after which date the trustee may convey or distribute the assets having regard only to the claims of which she then has notice.

McNAB McNAB & STARKE, solicitors,
21 Keilor Road, Essendon 3040.
Telephone: 9379 2819.

MABEL LILLIAN BOWEN, late of Darley House Nursing Home, Banksia Street, Heidelberg West, Victoria, widow. Creditors, next-of-kin and others having claims in respect of the estate of the deceased, who died on 9 December 2004, are required by the trustees, Phillip Victor Sparrow and Marjorie Lillian Sparrow, both of 4 Williams Road, Briar Hill, to send particulars to them by 18 April 2005 after which date the

trustees may convey or distribute the assets, having regard only to the claims of which they then have notice.

Dated 9 February 2005

M. K. STEELE & GIAMMARIO, solicitors,
Suite 1, 1st Floor,
corner of Grimshaw and Church Streets,
Greensborough 3088.

Re: MOYA FAY VARGA, late of 45 Junction Road, Blackburn North, Victoria, deceased.

Creditors, next-of-kin and others having claims in respect of the estate of the deceased, who died on 21 July 2004, are required by the trustees, Carly Michelle Spiegel of 42 Azarow Circuit, Croydon, Victoria, waitress, granddaughter and William Brian Woods of 132 Hurd Street, Portland, retiree, to send particulars to the trustees by 18 April 2005 after which date the trustees may convey or distribute the assets, having regard only to the claims of which the trustees have notice.

MMR LEGAL, solicitors,
526 Whitehorse Road, Mitcham 3132.

Re: Estate of THORA GIBSON, deceased.

Creditors, next-of-kin or others having claims in respect of the estate of THORA GIBSON, late of Milpara/Inala Village, 220 Middleborough Road, Blackburn South, Victoria, but formerly of Unit 13/6 Balwyn Road, Canterbury, Victoria, widow, deceased, who died on 29 November 2004, are to send particulars of their claims to the executors care of the undermentioned solicitors by 21 April 2005 after which date the executors will distribute the assets having regard only to the claims of which the executors then have notice.

RIGBY COOKE, solicitors,
Level 13, 469 La Trobe Street, Melbourne 3000.

Re: EDWARD JOHN SHEPHERD, late of Unit 4, 22 Tanti Avenue, Mornington, company director, deceased.

Creditors, next-of-kin and others having claims in respect of the estate of the deceased, who died on 30 September 2004, are required by the trustees, Marie Purthyna Shepherd of Unit 4, 22 Tanti Avenue, Mornington, Victoria, home

duties, wife and Margaret Purthyna Shepherd of 28 Tassel Road, Safety Beach, Victoria, accountant, daughter, to send particulars to the trustees by 17 April 2005 after which date the trustees may convey or distribute the assets, having regard only to the claims of which the trustees have notice.

ROBERTS BECKWITH PARTNERS, solicitors,
216 Main Street, Mornington 3931.

Re: ROSA MAVIS PORTER, late of Unit 11, 5 Grandview Grove, Hawthorn East 3123, retired, deceased.

Creditors, next-of-kin and others having claims in respect of the estate of the deceased, who died on 20 December 2004, are required by the trustee, Kaye Charlesworth of 98 Wimborne Avenue, Mount Eliza, Victoria, office manager, niece, to send particulars to the trustee by 17 April 2005 after which date the trustee may convey or distribute the assets, having regard only to the claims of which the trustee has notice.

ROBERTS BECKWITH PARTNERS, solicitors,
216 Main Street, Mornington 3931.

Re: BETTY LORRAINE BURR-GILLILAND, late of 20 Medfield Avenue, Avondale Heights, Victoria, home duties, deceased.

Creditors, next-of-kin and all other persons having claims against the estate of the said deceased are required by Pauline Anne Burr, the executor of the estate of the said deceased, to send particulars of such claims to her care of the undermentioned solicitors by the date being two calendar months from the date of this advertisement, after which date they will distribute the estate having regard only to the claims of which they then have notice.

RYAN, MACKEY & McCLELLAND,
solicitors,
65 Main Street, Greensborough.

KEITH ROSS MILLER, late of 24 Kent Street, Mornington, Victoria, deceased. Creditors, next-of-kin and others having claims in respect of the estate of the deceased, who died on 11 October 2004, are required by the executor, Sam Stidston of Suite 1, 10 Blamey Place, Mornington, Victoria, to send particulars to him

by 23 April 2005 after which date the executor may convey or distribute the assets, having regard only to the claims of which he then has notice.

STIDSTON & WILLIAMS WEBLAW,
solicitors,
Suite 1, 10 Blamey Place, Mornington.

STANLEY STEWART DOW, late of 2/9 Coppin Grove, Hawthorn, Victoria, retired, deceased.

Creditors, next-of-kin and others having claims in respect of the estate of the abovenamed deceased, who died on 5 November 2004, are required by the executors, Olive Mary Dow of 2/9 Coppin Grove, Hawthorn and Ian Andrew Ness of 459 Collins Street, Melbourne, to send particulars to the executors by 19 April 2005 after which date the executors intend to convey or distribute the assets of the estate having regard only to the claims of which the executors may have notice.

WISEWOULDS, solicitors,
459 Collins Street, Melbourne.

In the Supreme Court of the State of Victoria
SALE BY THE SHERIFF

On Wednesday 16 March 2005 at 2.30 p.m. at the Sheriff's Office, 8-20 King Street, Oakleigh (unless process be stayed or satisfied).

All the estate and interest (if any) of Mark Coules of 1 Mathilde Road, Surrey Hills, as shown on Certificate of Title as Mark Edward Coules, joint proprietor with Kristine Coules of an estate in fee simple in the land described on Certificate of Title Volume 8160, Folio 443 upon which is erected a dwelling known as 1 Mathilde Road, Surrey Hills.

Registered Mortgage Nos. W386748R, X067105B and AB003433W and Caveat No. AC741154Y and Unregistered Dealing No. AD064452F affect the said estate and interest.

Terms – Cash/Eftpos
(Debit Cards only. No Credit Cards).
SW-04-001500-8

Dated 10 February 2005

V. PARKIN
Sheriff's Office

In the Supreme Court of the State of Victoria
SALE BY THE SHERIFF

On Wednesday 16 March 2005 at 2.30 p.m.
at the Sheriff's Office, 8-20 King Street,
Oakleigh (unless process be stayed or satisfied).

All the estate and interest (if any) of
Aleksandar Mirkovic of Lot 507 Egan Close,
Werribee, proprietor of an estate in fee simple in
the land described on Certificate of Title Volume
10690, Folio 012 upon which is erected a house
known as Lot 507 Egan Close, Werribee.

Registered Mortgage No. AC132857J and
Covenant AC132856L affect the said estate and
interest.

Terms – Cash/Eftpos
(Debit Cards only. No Credit Cards).
SW-04-007570-6

Dated 10 February 2005

V. PARKIN
Sheriff's Office

Unclaimed Moneys Act 1962

Register of Unclaimed Moneys held by the —

<i>Name of Owner on Books and Last Known Address</i>	<i>Total Amount Due to Owner</i>	<i>Description Of Unclaimed Money</i>	<i>Date when Amount first became Payable</i>
GERARD HUGHES, LAWYER			
	\$		
M. Gordon, Pascoe Vale South	1,568.51	Cheque	08/12/92

04301

CONTACT: GERARD HUGHES, PHONE: (03) 9375 4226.

Unclaimed Moneys Act 1962

Register of Unclaimed Moneys held by the —

<i>Name of Owner on Books and Last Known Address</i>	<i>Total Amount Due to Owner</i>	<i>Description Of Unclaimed Money</i>	<i>Date when Amount first became Payable</i>
R. MALCOLM PTY LTD			
	\$		
Pepprell	481.59	Cheque	29/04/97

04306

CONTACT: LORRAINE DUNN, PHONE: (03) 9584 1355.

**GOVERNMENT AND OUTER BUDGET
SECTOR AGENCIES NOTICES**



**WARRNAMBOOL
CITY COUNCIL**

Road Discontinuance

Pursuant to Section 206 and Clause 3g, Schedule 10 of the **Local Government Act 1989**, Warrnambool City Council resolved on 10 May 2004 to discontinue that section of Caroline Street, Allansford between Ziegler Parade and the northern boundary of 8 Frank Street, as shown hatched on plan below; such discontinued road is then proposed to be sold to the Department of Education and Training for the purpose of expanding the Allansford Primary School.



LINDSAY A. MERRITT
Chief Executive



CITY OF
BALLARAT

PROPOSED
PART ROAD DISCONTINUANCE,
ANDERSON STREET EAST, BALLARAT

Section 206 Schedule 10(3)

Local Government Act 1989

Notice is hereby given that the Ballarat City Council has discontinued that part of the roadway fronting No. 5 Anderson Street East, Ballarat.

It is proposed to advise the Department of Sustainability & Environment accordingly so that they may offer the discontinued portion of roadway for purchase by the adjoining property owner for incorporation into their existing property.

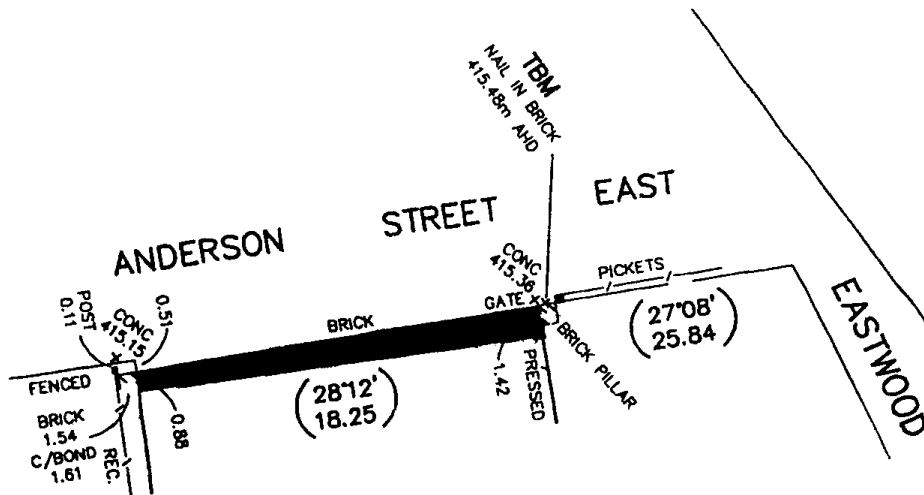

RICHARD HANCOCK
Chief Executive Officer.

MOORABOOL SHIRE COUNCIL

Local Law 1 2005
Open Air Burning

Notice is hereby given pursuant to Section 119(2) of the **Local Government Act 1989** that at a Moorabool Shire Council meeting on 25 January 2005 Council made Local Law 1 2005 Open Air Burning.

Purposes of the Local Law

The purpose of the Local Law is to amend General Local Law 2000 2.5 and 2.6 to allow property owners on rural and rural residential land to burn materials for fire prevention purposes, to prohibit the burning of noxious materials at all times and to allow authorised officers entry to premises to which a direction under this Local Law has been made and take any action necessary with regard to this direction.

General Purport of the Local Law

Local Law will provide for improved fire prevention activities in rural areas.

It will also prohibit burning off within township areas as designated on the maps that form part of this Local Law, and burning of noxious materials at all times.

A copy of the Local Law may be inspected at or obtained from Council offices located at 15 Stead Street, Ballan; and 197 Main Street, Bacchus Marsh during business hours of 8.30 am to 5.00 pm or from the Council website www.moorabool.vic.gov.au.

Enquiries should be directed to Rhonda Taylor Compliance Co-ordinator on 5366 7100.

ROBERT DOBRZYNSKI
Chief Executive Officer



Northern Grampians *Shire Council*

Road Exchange

Pursuant to Sections 206 and 207B and Schedule 10, Clause 2 of the **Local Government Act 1989** the Northern Grampians Shire Council at its ordinary meeting held on 3 February 2005 resolved to publish a notice describing the proposed road deviation adjacent to 2372 Grampians Road, Halls Gap and part of PC 362727, Parish of Boroka as shown on the plan set out below where the land shown hatched is to be exchanged for the land shown cross hatched.

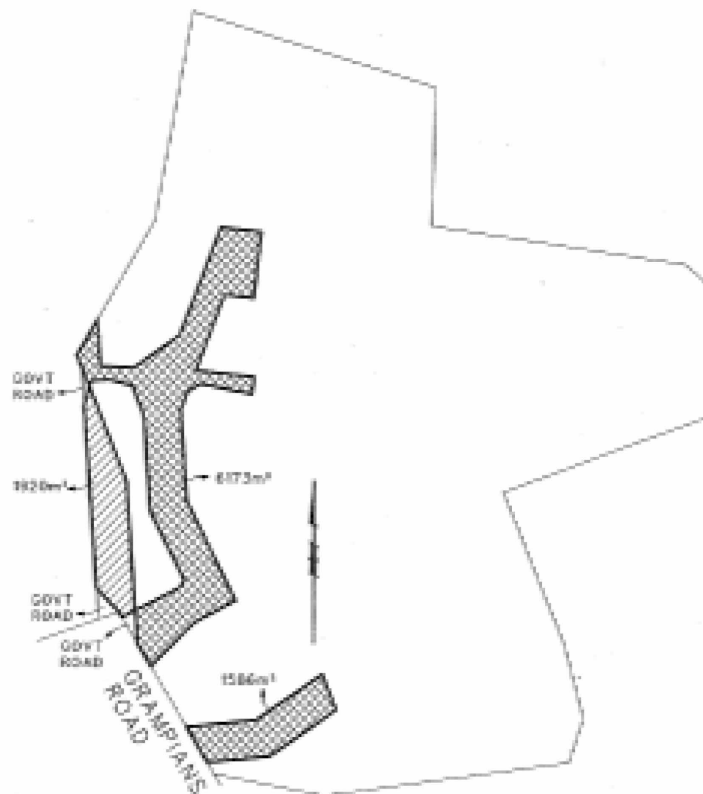

GINA LYONS
Chief Executive Officer

The land affected by the Amendment is land on the western side of Izett Street, Prahran included in the Business 2 Zone.

The Amendment proposes to change the schedule to the Business 2 Zone to remove the 0m² maximum combined leasable floor area of shop in Izett Street, Prahran.

The person who requested the Amendment is Contour Consultants (Aust) Pty Ltd acting on behalf of Hornmax Nominees Pty Ltd.

You may inspect Amendment C39, any documents that support the Amendment and the explanatory report about the Amendment, free of charge, during office hours at the following locations: City of Stonnington, Planning Counter, Prahran Centre, Prahran Town Hall, corner of Greville and Chapel Streets, Prahran; and Department of Sustainability and Environment, Planning Information Centre, Upper Plaza, Nauru House, 80 Collins Street, Melbourne.

Any person who is affected by the Amendment may make a submission. Submissions must be made in writing (by or on behalf of the submitter) giving the address of the affected property and the submitter's name and contact address; and clearly state the grounds on which the Amendment is supported or opposed and indicate what changes (if any) the submitter wishes to make to the Amendment or the planning permit.

Names and contact details for submitters are required for Council to consider submissions and to notify submitters of the opportunity to attend Council meetings and any Hearings held to consider submissions. In accordance with the **Planning and Environment Act 1987**, Council must make a copy of any submissions available to any person to inspect. For further information on Council's Privacy Policy ring 8290 1333.

The closing date for submissions is Monday 21 March 2005.

Submissions must be sent to Andrew Clarke, Planning Services Unit, City of Stonnington, PO Box 21, Prahran 3181; or by facsimile: 9521 2255.

STUART DRAFFIN
Manager – Planning Services



Planning and Environment Act 1987

CAMPASPE PLANNING SCHEME

Notice of the Preparation of an Amendment
to a Planning Scheme and
Notice of an Application for Planning Permit
Amendment C38

Application No. 2005–076

The land affected by the Amendment is Lot 3, PS 81884, Parish of Kyabram, 1210 McEwen Road, Kyabram.

The land affected by the application is Lot 3, PS 81884, Parish of Kyabram, 1210 McEwen Road, Kyabram.

The Amendment proposes to introduce a Public Acquisition Overlay over part of the above property. The overlay comprises both map and ordinance changes.

The application is for a permit to use and develop the land for a utility installation, remove native vegetation and subdivide the land in accord with the Public Acquisition Overlay.

The person who requested the Amendment and the applicant for the permit is Goulburn Valley Water.

You may inspect the Amendment and the application, and any documents that support the Amendment and application, and the explanatory report about the Amendment and application at the office of the planning authority, Shire of Campaspe offices, Lake Road, Kyabram and Shire of Campaspe offices, corner of Heygarth and Hare Streets, Echuca; and at the Department of Sustainability and Environment, Planning Information Centre, Upper Plaza, Nauru House, 80 Collins Street, Melbourne 3000.

This can be done during office hours and is free of charge.

Any person who may be affected by the Amendment or by the granting of the permit may make a submission to the planning authority.

The closing date for submissions is 21 March 2005. A submission must be sent to Peter McKinnon, Team Leader Town Planning at the Shire of Campaspe, PO Box 35, Echuca 3564.

WAYNE HARVEY
Chief Executive Officer



Knox City Council
Serving the People of Knox

Planning and Environment Act 1987

KNOX PLANNING SCHEME

Notice of Preparation of Amendment

Amendment C45

The Knox City Council has prepared Amendment C45 to the Knox Planning Scheme.

The land affected by the Amendment is described as Reservoir Crescent, at the eastern end of Providence Place and adjoining Lot 20 Reservoir Crescent, in Rowville.

The Amendment proposes to apply an Environmental Significance Overlay Schedule 1 (Site of Biological Significance (Reservoir Crescent, Rowville) and a Public Acquisition Overlay Schedule 5 to the subject land.

You may inspect the Amendment, any documents that support the Amendment and the explanatory report about the Amendment at the following locations: at the office of the planning authority, Knox City Council, 511 Burwood Highway, Wantirna South; and at the Department of Sustainability and Environment, Planning Information Centre, Upper Plaza, Nauru House, 80 Collins Street, Melbourne.

This can be done during office hours and is free of charge.

Any person who may be affected by the Amendment may make a submission to the planning authority.

The closing date for submissions is Monday 21 March 2005. A submission must be sent to the Knox City Council, Locked Bag 1, Wantirna South 3152.

STEVE DUNN
Director City Development

Planning and Environment Act 1987

WARRNAMBOOL PLANNING SCHEME

Notice of the Preparation of an Amendment to a Planning Scheme

Notice of an Application for Planning Permit

Amendment C37

Application 2004-225

The land affected by the Amendment and the application is 72-80 Hopkins Highway and 35-45 Hayley Drive, Warrnambool.

The Amendment proposes to rezone land which is currently within the Residential 1 Zone to the Business 1 Zone. A floor space schedule is also proposed. The Design and Development Overlay (Schedule 4 – Single Dwellings) which currently applies to the Residential 1 Zone is also proposed to be removed.

The application is for:

- buildings and works associated with the neighbourhood shopping centre (supermarket, speciality shops, convenience restaurant and fast food outlet and medical centre), the tavern and the extension to the existing bottle shop;
- the use of the tavern and associated liquor licence;
- dispensation from the carparking requirements of Clause 52.06 of the Planning Scheme;
- alterations to the existing access to a Road Zone, Category 1 (Hopkins Highway);
- creation of a carriageway easement to provide access to the tavern across the land occupied by the shopping centre.

The person who requested the Amendment and the applicant for the permit is Lascorp Development Group (Aust) Pty Ltd and Mt. Kimberley Homes.

You may inspect the Amendment and the application, and any documents that support the Amendment and application, and the explanatory report about the Amendment and application, at the office of the planning authority, Warrnambool City Council, Civic Centre, 25 Liebig Street, Warrnambool 3280; Department of Sustainability and Environment, Planning Information Centre, Upper Plaza, Nauru House, 80 Collins Street, Melbourne 3000; and Department of Sustainability and Environment, South West Regional Office, State Government Offices, corner of Fenwick and Little Malop Streets, Geelong 3220.

This can be done during office hours and is free of charge.

Any person who may be affected by the Amendment or by the granting of the permit may make a submission to the planning authority.

The closing date for submission is Monday 21 March 2005. A submission must be sent to Julie Kearney, Strategic Planner, Warrnambool City Council, Civic Centre, 25 Liebig Street, Warrnambool 3280.

LINDSAY A. MERRITT
Chief Executive

Planning and Environment Act 1987

WYNDHAM PLANNING SCHEME

Notice of Preparation of Amendment

Amendment C72

The Wyndham City Council has prepared Amendment C72 to the Wyndham Planning Scheme.

The Amendment affects the Werribee South Intensive Agricultural Area (map 1 of the Schedule to the Green Wedge Zone in the Wyndham Planning Scheme). It is situated to the South of the Werribee CBD and is abutted by Port Phillip Bay to the south. The land was designated 'Green Wedge' as a result of the 'Melbourne 2030' Policy of 2002. On 19 May 2004 VC23 amended the Victorian Planning Provisions and new Green Wedge Zones were applied outside the Urban Growth Boundary. Alternatively, the land affected is covered by maps 16, 17, 18, 22 & 23 of the Wyndham Local Planning Scheme (marked 'GWZ').

The Amendment proposes to alter the maximum lot size excision of 2,000m² to a minimum of 4,000m² from lots of 5 hectares or more in area in the Schedule to the Green Wedge Zone. The proposed Amendment is consistent with all relevant sections and clauses of the State Planning Policy Framework, Melbourne 2030 and the Municipal Strategic Statement. The proposed Amendment is required to halt further fragmentation of the rural land in the zone and allows for excisions that are more sustainable to the current use of the area. By increasing the minimum lot size excision of the Schedule to the Zone, the Amendment is recognising the State and Local importance and significance of the Werribee South Agricultural Area as described in the Wyndham Planning Scheme Municipal Strategic Statement (MSS).

You may inspect the Amendment, any document that support the Amendment and the explanatory report about the Amendment at the following locations: at the office of the planning authority, Wyndham City Council, Town Planning Department, Civic Centre, 45 Princes Highway, Werribee 3030; at the Department of Sustainability and Environment, Planning Information Centre, Upper Plaza, Nauru House, 80 Collins Street, Melbourne; and online at www.wyndham.vic.gov.au.

This can be done during office hours and is free of charge.

Any person who is affected by the Amendment may make a submission to the planning authority.

The closing date for submissions is 22 March 2005. A submission must be sent to: Ms Karen Hose, Planning Policy and Projects Co-ordinator, Wyndham City Council, PO Box 197, Werribee 3030.

KAREN HOSE

Planning Policy and Projects Co-ordinator

STATE TRUSTEES LIMITED

ACN 064 593 148

Section 79

Notice is hereby given that State Trustees Limited, ACN 064 593 148, intends administering the estates of:-

JOSEPH PAUL WALTER WALLIS CARUANA, in the Will called Joseph Walter Caruana, late of McCulloch House, 246 Clayton Road, Clayton, Victoria, retired, deceased, who died on 23 June 2004 leaving a Will dated 7 June 1975.

NETTIE COOPER, late of Heatherleigh Private Nursing Home, 759 Burwood Road, Hawthorn East, Victoria, pensioner, deceased intestate, who died on 14 November 2004.

NEIL ARTHUR LORIMER, late of 31 Fisher Street, Maidstone, Victoria, tyre engineer, deceased, who died on 24 October 2004 leaving a Will dated 22 July 1993.

NANCY ADA WAKE, late of 4 Farey Avenue, Dromana, Victoria, pensioner, deceased, who died on 29 September 2003 leaving a Will dated 21 June 1994.

Creditors, next-of-kin and others having claims against the abovementioned estates are required pursuant to Section 33 of the **Trustee Act 1958** to send particulars of their claims against the abovementioned estates to State Trustees Limited, 168 Exhibition Street, Melbourne, Victoria, on or before 22 April 2005 after which date State Trustees Limited, ACN 064 593 148, may convey or distribute the assets of the abovementioned estates having regard only to the claims of which it then has notice.

Creditors, next-of-kin and others having claims against the estate of any of the undermentioned deceased persons are required to send particulars of their claims to State Trustees Limited, ABN 68 064 593 148, 168 Exhibition Street, Melbourne, Victoria 3000, the personal representative, on or before 22 April 2005 after which date State Trustees Limited may convey or distribute the assets having regard only to the claims of which State Trustees Limited then has notice.

BAKER, William Thomas, formerly of 219 Rathmines Street, Fairfield, but late of Sir William Hall Hostel, 61 Edwin Street, Heidelberg Heights 3081, retired and who died on 20 January 2005.

BUBULIS, Antoni, late of 29 Laughlin Avenue, Nunawading 3131, retired and who died on 15 October 2004.

GRAHAM, Ethel Elizabeth, late of 40 Highbury Grove, Prahran, home duties and who died on 20 March 1980.

GRAY, Thelma Maude, late of George Vowell Centre, corner of Cobb Road and Nepean Highway, Mount Eliza, retired and who died on 4 December 2004.

LEVER, Muriel Joan, late of Plumpton Villa, 73 Plumpton Avenue, Glenroy, pensioner and who died on 26 January 2005.

WRIGHT, Hazel Phyllis, late of 4 Linton Court, Foster, and who died on 10 October 2004.

Dated 10 February 2005

DAVID BAKER
Manager
Executor and Trustee Services

Creditors, next-of-kin and others having claims against the estate of any of the undermentioned deceased persons are required to send particulars of their claims to State Trustees Limited, ABN 68 064 593 148, 168 Exhibition Street, Melbourne, Victoria 3000, the personal representative, on or before 26 April 2005 after which date State Trustees Limited may convey or distribute the assets having regard only to the claims of which State Trustees Limited then has notice.

KRUPA, Jan, late of Room 14, Glengowrie Hostel, 52 Box Forest Road, Glenroy, retired and who died on 12 November 2004.

LORIMER, William Alfred, late of Noble Gardens, 55 Thomas Street, Noble Park, Vic. 3174, pensioner and who died on 4 November 2004.

McKAY, Francis Michael, late of Unit 8, 20 Simpson Street, Bacchus Marsh, retired electrician and who died on 8 November 1990.

MORRISON, Veronica Elizabeth, late of 54 Canonbury Circle, Laverton, retired and who died on 15 October 2004.

PRIESTLEY, Herbert Charles, late of Anne Caudle Centre, 100 Barnard Street, Bendigo, and who died on 10 December 2004.

TAYLOR, Christina Phoebe, late of 13 Bent Street, Moonee Ponds, widow and who died on 15 September 2004.

TAYLOR, John Matthew, late of Surrey Hills Private Nursing Home, 16-18 Florence Street, Surrey Hills, and who died on 19 November 2004.

TYACK, Walter Henry, late of Sumner House, 67 Brunswick Street, Fitzroy 3065, pensioner, and who died on 20 October 2004.

Dated 14 February 2005

DAVID BAKER
Manager
Executor and Trustee Services

EXEMPTION

Application No. A46 of 2005

The Victorian Civil and Administrative Tribunal has considered an application pursuant to Section 83 of the **Equal Opportunity Act 1995** by the Maltese Community Council of Victoria Inc. The application for exemption is to enable the applicant to advertise and employ Maltese speaking staff to work with elderly Maltese people.

Upon reading the material submitted in support of the application and hearing Mr Michael Caruana, the Tribunal is satisfied that it is appropriate to grant an exemption from Sections 13, 100 and 195 of the Act to enable the applicant to advertise and employ Maltese speaking staff to work with elderly Maltese people.

In granting this exemption the Tribunal noted:

- The applicant receives State and Federal grants to provide services for frail and disabled older Maltese people.

- Many of these elderly clients either do not speak English or are not confident speaking English.
- In order to ensure good communication between staff and clients, and to promote a comfortable and secure environment, it is essential to employ staff who speak the Maltese language.

The Tribunal hereby grants an exemption to the applicant from the operation of Sections 13, 100 and 195 of the **Equal Opportunity Act 1995** to enable the applicant to advertise and employ Maltese speaking staff to work with elderly Maltese people.

This exemption is to remain in force from the day on which notice of the exemption is published in the Government Gazette until 16 February 2008.

Dated 11 February 2005

C. McKENZIE
Deputy President

Associations Incorporation Act 1981
NOTICE PURSUANT TO SECTION 10(4)(C)
OF THE ASSOCIATIONS
INCORPORATION ACT 1981

Notice is hereby given pursuant to section 10(4)(c) of the **Associations Incorporation Act 1981** (the Act) that a certificate of incorporation was granted pursuant to section 10(4)(a) of the Act by the Registrar of Incorporated Associations on 10 February 2005 to PANTON HILL COMMUNITY CARE ASSOCIATION INC. (Registered No. A0046859Y) and the Association is now incorporated under the Act.

Dated at Melbourne 10 February 2005.

ANDREW LEVENS
Assistant Registrar
Incorporated Associations

Electoral Act 2002
PROPOSED DE-REGISTRATION OF
POLITICAL PARTY

I hereby give notice that I am considering de-registering the Hope Party Victoria ethics equality ecology under section 56 of the **Electoral Act 2002**, because pursuant to section 56(1)(b) I am satisfied that the political party has ceased to have at least 500 eligible members.

Dated 15 February 2005

STEVE TULLY
Electoral Commissioner

Land Acquisition and Compensation Act 1986
and **Water Act 1989**

NOTICE OF ACQUISITION

Compulsory Acquisition of Interest in Land

The Goulburn–Murray Rural Water Authority declares that by this notice it acquires the following interest in the land described hereunder.

Owners' Names: Thomas Clement O'Dwyer, Patrick John O'Dwyer and Anne Elizebeth O'Dwyer.

Caveator: Dominic John Connell and Bernard Gregory Connell.

Interest Acquired: Freehold for Drainage Channel.

Land in which Interest Subsists: Part of Crown Allotment 100A and 100B, Parish of Boosey.

Area of Interest: 2.1273 hectares.

Title Details: Certificate of Title Volume 2018, Folio 413. Certificate of Title Volume 8761, Folio 894.

Plans Numbered 190 and 191 detailing the location of the land being acquired are available for perusal at the Central Office of the Goulburn–Murray Rural Water Authority, 40 Casey Street, Tatura 3616.

Published with the authority of the Goulburn–Murray Rural Water Authority.

Dated 17 February 2005.

ANTHONY NATALIZIO
Manager Property and Legal
For and on behalf of
Goulburn–Murray Rural Water Authority

Land Acquisition and Compensation Act 1986
and **Water Act 1989**

NOTICE OF ACQUISITION

Compulsory Acquisition of Interest in Land

The Goulburn–Murray Rural Water Authority declares that by this notice it acquires the following interest in the land described hereunder.

Owners' Names: Patrick John O'Dwyer and Anne Elizebeth Hill and all other interests.

Caveator: Dominic John Connell and Bernard Gregory Connell.

Interest Acquired: Freehold for Drainage Channel.

Land in which Interest Subsists: Part of Lot 1 on LP 55520 being part of Crown Allotment 101, Parish of Boosey.

Area of Interest: 1.629 hectares.

Title Details: Certificate of Title Volume 8353, Folio 800.

Plan Numbered 192 detailing the location of the land being acquired is available for perusal at the Central Office of the Goulburn–Murray Rural Water Authority, 40 Casey Street, Tatura 3616.

Published with the authority of the Goulburn–Murray Rural Water Authority.

Dated 17 February 2005.

ANTHONY NATALIZIO
Manager Property and Legal
For and on behalf of
Goulburn–Murray Rural Water Authority

Prevention of Cruelty to Animals Act 1986

APPROVAL OF INSPECTORS

I, Peter John Bailey, Executive Director Biosecurity Victoria in the Department of Primary Industries, pursuant to the powers, duties and functions given to me by a delegation under section 38 of the **Prevention of Cruelty to Animals Act 1986** and of my respective powers to approve inspectors under section 18 of the **Prevention of Cruelty to Animals Act 1986**, hereby approve the following persons, who are inspectors of livestock under the provisions of the **Livestock Disease Control Act 1994**, as inspectors for the purposes of Part 2 of the **Prevention of Cruelty to Animals Act 1986**. These approvals remain in force until 30 June 2006.

Name of person	Position number
Samuel Anderson Ellis	514311
Miranda Ebony Hankinson	507327

Dated 10 February 2005

PETER JOHN BAILEY
Executive Director
Biosecurity Victoria

Agricultural and Veterinary Chemicals (Control of Use) Act 1992

APPOINTMENT OF AUTHORISED OFFICERS

I, Alison Margaret Lee, A/Manager Animal Health Operations in the Department of Primary Industries, pursuant to the powers, duties and functions given to me by a delegation under section 74 of the **Agricultural and Veterinary Chemicals (Control of Use) Act 1992** and of my respective powers to appoint authorised officers under section 53 of the **Agricultural and Veterinary Chemicals (Control of Use) Act 1992**, hereby appoint the following persons employed in the Public Service, as authorised officers for the purposes of all of the provisions of the **Agricultural and Veterinary Chemicals (Control of Use) Act 1992** and any Regulation or Order made under this Act.

Name of person	Position number
Samuel Anderson Ellis	514311
Miranda Ebony Hankinson	507327

Dated 27 January 2005

ALISON MARGARET LEE
Acting Manager
Animal Health Operations

Livestock Disease Control Act 1994

APPOINTMENT OF INSPECTORS

I, Alison Margaret Lee, A/Manager Animal Health Operations in the Department of Primary Industries, pursuant to the powers, duties and functions given to me by a delegation under section 103 of the **Livestock Disease Control Act 1994** and of my respective powers to appoint inspectors under section 108 of the **Livestock Disease Control Act 1994**, hereby appoint the following persons, who hold positions under the provisions of the **Public Sector Management and Employment Act 1998**, as inspectors for the purposes of all of the provisions of the **Livestock Disease Control Act 1994** and in respect of all livestock.

Name of person	Position number
Samuel Anderson Ellis	514311
Miranda Ebony Hankinson	507327

Dated 27 January 2005

ALISON MARGARET LEE
Acting Manager
Animal Health Operations

Victorian Institute of Teaching Act 2001

NOTIFICATION CANCELLING REGISTRATION OF A TEACHER

Pursuant to section 25 of the **Victorian Institute of Teaching Act 2001** the Victorian Institute of Teaching must disqualify a registered teacher from teaching and cancel their registration where that person has been convicted or found guilty at anytime in Victoria, or elsewhere, of a sexual offence.

On 28 January 2005 Stuart Graham Sutherland (DOB: 16/06/1964) was convicted of one count of sexual penetration of a child under 16 years and three counts of an indecent act with a child under the age of 16 years in breach of sections 45 and 47 of the **Crimes Act 1958** (Vic.).

On 10 February 2005 Stuart Graham Sutherland was disqualified from teaching and his registration as a teacher in Victoria was cancelled from 28 January 2005.

Dated 10 February 2005

JANET SHERRY
Chairperson
Disciplinary Proceedings Committee
Victorian Institute of Teaching

Children's Services Act 1996

NOTICE OF EXEMPTION

Under section 6 of the **Children's Services Act 1996** ("the Act"), the Minister for Children, Minister for Community Services hereby declares that the children's services listed below are exempt from regulation 24 of the Children's Services Regulations 1998:

- Fernwood Female Fitness Centre Creche, licence number 2740
- Hawthorn Aquatic and Leisure Centre, licence number 1669
- Riddells Creek Leisure Centre, licence number 9842
- Kilmore Leisure Centre Creche, licence number 1901
- Looking Good Northside Creche, licence number 3259

This exemption is granted subject to the following conditions:

1. The service holds a restricted licence; and
2. No child is cared for or educated at the service for more than 3 hours each day and more than 10 hours each week; and
3. The proprietor ensures that whenever children are being cared for or educated by the children's service, there is present 1 staff member at the service for every 7 children, or fraction of that number; and
4. Information is displayed prominently at the entrance to the children's service which indicates the conditions of this exemption and parents or guardians are to be informed that the service is not required to employ qualified staff at all times during operation; and
5. Each staff member at the service is not less than 18 years of age.

This exemption remains in force until 1 June 2006 unless revoked earlier.

Dated 11 February 2005

HON SHERRYL GARBUTT MP
Minister for Children
Minister for Community Services

Children's Services Act 1996

NOTICE OF EXEMPTION

Under section 6 of the **Children's Services Act 1996** ("the Act"), the Minister for Children, Minister for Community Services hereby declares that the children's services listed below are exempt from regulation 24 of the Children's Services Regulations 1998:

- Aquamoves Lakeside Shepparton, licence number 9646
- Diamond Valley YMCA Sports & Fitness Centre, licence number 1158

This exemption is granted subject to the following conditions:

1. The service holds a restricted licence; and
2. No child is cared for or educated at the service for more than 3 hours each day and more than 10 hours each week; and
3. Information is displayed prominently at the entrance to the children's service which indicates the conditions of this exemption; and
4. Each staff member at the service is not less than 18 years of age; and
5. The proprietor ensures that whenever children are being cared for or educated by the children's service, the number of staff members set out in the table are caring for or educating the children –

No. of children present	Age of children	Number of staff members	Number of total staff members who must be qualified staff members
15 or less	under 3 years (all children under 3 years)	1 for every 7 children or fraction of that number	1 qualified staff member
	mixed age grouping (children under 3 years and 3 years or more)		
	3 years or more (all children 3 years or more)		
16 or more	under 3 years (all children under 3 years)	1 for every 7 children or fraction of that number	1 qualified staff member for every 15 children or fraction of that number
	mixed age grouping (children under 3 years and 3 years or more)	1 for every 7 children or fraction of that number	1 qualified staff member for every 15 children or fraction of that number
	3 years or more (all children 3 years or more)	1 for every 7 children or fraction of that number	1 qualified staff member for every 30 children or fraction of that number

This exemption remains in force until 1 June 2006 unless revoked earlier.

Dated 11 February 2005

HON SHERRYL GARBUTT MP
Minister for Children
Minister for Community Services

Children's Services Act 1996

NOTICE OF EXEMPTION

Under section 6 of the **Children's Services Act 1996** ("the Act"), the Minister for Children, Minister for Community Services hereby declares that the children's services listed below are exempt from regulation 24 of the Children's Services Regulations 1998:

- Koala Kinder Group, licence number 2604
- Jika Jika Community Centre, licence number 2690
- Preston Neighbourhood House, licence number 2969
- Diamond Creek Living & Learning Centre, licence number 1182
- Blind Bight Community Centre, licence number 1004
- Westvale Community Centre Occasional Child Care Service, licence number 1835
- Southport Playhouse, licence number 3358
- Selwyn House the Home of Cragieburn Education & Community Centre, licence number 602

This exemption is granted subject to the following conditions:

1. The service holds a restricted licence; and
2. No child is cared for or educated at the service for more than 3 hours each day and more than 10 hours each week; and
3. Information is displayed prominently at the entrance to the children's service which indicates the conditions of this exemption; and
4. Each staff member at the service is not less than 18 years of age; and
5. The proprietor ensures that whenever children are being cared for or educated by the children's service, the number of staff members set out in the table are caring for or educating the children –

No. of children present	Age of children	Number of staff members	Number of total staff members who must be qualified staff members
15 or less	under 3 years (all children under 3 years)	1 for every 7 children or fraction of that number	1 qualified staff member
	mixed age grouping (children under 3 years and 3 years or more)		
	3 years or more (all children 3 years or more)		
16 or more	under 3 years (all children under 3 years)	1 for every 7 children or fraction of that number	1 qualified staff member for every 15 children or fraction of that number
	mixed age grouping (children under 3 years and 3 years or more)	1 for every 7 children or fraction of that number	1 qualified staff member for every 15 children or fraction of that number

	3 years or more (all children 3 years or more)	1 for every 7 children or fraction of that number	1 qualified staff member for every 30 children or fraction of that number
--	--	---	---

This exemption remains in force until 1 June 2006 unless revoked earlier.

Dated 11 February 2005

HON SHERRYL GARBUTT MP
Minister for Children
Minister for Community Services

Children's Services Act 1996

NOTICE OF EXEMPTION

Under section 6 of the **Children's Services Act 1996** ("the Act"), the Minister for Children, Minister for Community Services hereby declares that the children's services listed below are exempt from regulation 24 of the Children's Services Regulations 1998:

- Leisure Link Child Care Centre, licence number 3328
- Oakleigh Occasional Care, licence number 2791
- Oakleigh Occasional Care, licence number 2823
- Vermont South Community House, licence number 2745
- Ballan & District Preschool, licence number 90
- Castlemaine Occasional Day Care Centre, licence number 723
- Diamond Valley Learning Centre, licence number 1179
- Sandringham Playhouse, licence number 3202
- South Kingsville Community Centre, licence number 1479
- North Shepparton Occasional Child Care, licence number 3233
- Merinda Park Community Centre, licence number 990
- Glen Waverley Occasional Child Care, licence number 3720
- Cann River Community Centre Occasional Care, licence number 2836
- Kangaroo Flat Community House, licence number 2250
- Broadmeadows Community Women's House, licence number 543
- Kilmore & District Community Centre, licence number 1899
- Rupanyup Activity Group, licence number 4152
- Minyip Class 2, licence number 4153
- Robinvale Network House, licence number 3539
- Rosebud Community House, licence number 1464
- Kurung Pre Kinder, licence number 9943
- Arrabri Playgroup, licence number 1061

This exemption is granted subject to the conditions that:

4. The service holds a restricted licence; and
5. No child is cared for or educated at the service for more than 3 hours each day and more than 10 hours each week; and
6. Each staff member at the service is not less than 18 years of age; and

7. A staff member at the service is enrolled and attending an approved early childhood course of study; and
8. Information is displayed prominently at the entrance to the children's service which indicates the conditions of this Exemption; and parents or guardians are informed that the service is not required to meet the qualified staff ratios at all times during operation, as a staff member is undertaking an approved early childhood course; and
9. The proprietor ensures that whenever children are being cared for or educated by the children's service, the number of staff members set out in the Table are caring for or educating the children –

No. of children present	Age of children	Number of staff members	Number of total staff members who must be qualified staff members or undertaking an approved early childhood course
15 or less	Under 3 years (all children under 3 years)	1 for every 7 children or fraction of that number	1
	Mixed age grouping (under 3 years and 3 years or more)	1 for every 7 children or fraction of that number	
	3 years or more (all children 3 years or more)	1 for every 7 children or fraction of that number	
16 or more	Under 3 years (all children under 3 years)	1 for every 7 children or fraction of that number	1 qualified staff member for every 15 children or fraction of that number
	Mixed age grouping (under 3 years and 3 years or more)	1 for every 7 children or fraction of that number	1 qualified staff member for every 15 children or fraction of that number
	3 years or more (all children 3 years or more)	1 for every 7 children or fraction of that number	1 qualified staff member for every 30 children or fraction of that number

This exemption remains in force until 1 June 2006 unless revoked earlier.

Dated 11 February 2005

HON SHERRYL GARBUTT MP
Minister for Children
Minister for Community Services

**Marine Act 1988**

SECTION 15 NOTICE

I, the Director of Marine Safety, on the recommendation of Southern Rural Water, hereby give notice under subsection 15(1) of the **Marine Act 1988** of the following amendments to Notice No. 1 under section 15(2) of the **Marine Act 1988**:

1. revoke the rules regulating the operation of vessels on the waters of Melton Reservoir set out in Schedule 150 of the Notice made under section 15(2) of the **Marine Act 1988**; and
2. give notice of the following rules regulating the operation of vessels on the waters of Melton reservoir:

SCHEDULE 150

WATERS – MELTON RESERVOIR

Local Authority – Southern Rural Water

Interpretation in this Schedule – ‘the bridge’ means the Melbourne to Ballarat railway bridge spanning Melton Reservoir.

Vessel Operating and Zoning Rules for water levels above 75.000 metres Australian Height Datum (AHD) – being 20% of maximum capacity – as measured at the head gauge board located on the right abutment of the dam wall at Melton Reservoir.

1. Excluded speed limits for the purpose of Clause 3(a).

The whole of the waters of Melton Reservoir south of the bridge and approximately 3.5 kilometres upstream of the bridge are not subject to the requirements of Clause 3(a) of this notice unless otherwise specified in this Schedule.
2. 5 knot speed restriction zones for the purpose of Clause 7.

The following waters of Melton Reservoir are subject to a 5 knot speed restriction:

 - (a) upstream of an imaginary line between the signs and marked by yellow buoys located 3.5 kilometres upstream of the bridge;
 - (b) north of an imaginary line between the signs and marked by buoys at the entrance to an inlet located approximately 3.4 kilometres north of the bridge;
 - (c) north of an imaginary line between the signs and marked by yellow buoys at the entrance to an inlet located approximately 2.5 kilometres north of the bridge;
 - (d) north of an imaginary line between the signs and marked by yellow buoys at the entrance to an inlet located approximately 2.0 kilometres north of the bridge;
 - (e) north of an imaginary line between the signs and marked by yellow buoys at the entrance to an inlet located approximately 350 metres north of the bridge;
 - (f) the waters bounded by an imaginary line between signs on opposite shores and marked by yellow buoys located approximately 50 metres upstream of the bridge and an imaginary line between signs on opposite shores and marked by yellow buoys located approximately 50 metres downstream of the bridge and including the inlet to Arnolds Creek;

- (g) west of an imaginary line between the signs and marked by yellow buoys at the entrance to two inlets located approximately 350 metres south of the bridge; and
- (h) west of an imaginary line between the signs and marked by yellow buoys at the entrance to an inlet located approximately 450 metres north-west of the reservoir retaining wall.

3. Areas prohibited to vessels for the purposes of Clause 9.

The waters upstream of the reservoir retaining wall for a distance of approximately 200 metres to an imaginary line between signs located on each bank and marked by red buoys are prohibited to vessels.

Vessel Operating and Zoning Rules for water levels between 74.000 metres AHD – being 15% of maximum capacity – and 74.999 metres Australian Height Datum (AHD) – being 20% of maximum capacity – as measured at the head gauge board located at the right abutment of the dam wall at Melton Reservoir.

1. Excluded speed limits for the purpose of Clause 3(a).

The whole of the waters of Melton Reservoir downstream of the bridge and approximately 3.5 kilometres upstream of the bridge are not subject to the requirements of Clause 3(a) of this notice unless otherwise specified in this Schedule.

2. 5 knot speed restriction zones for the purpose of Clause 7.

- (a) All waters north of an imaginary line between signs on opposite shores and marked by yellow buoys approximately 50 metres south of the bridge, including the entrance to Arnolds Creek;
- (b) west of an imaginary line between the signs and marked by yellow buoys at the entrance to two inlets approximately 350 metres south of the bridge; and
- (c) west of an imaginary line between the signs and marked by yellow buoys at the entrance to an inlet approximately 450 metres north-west of the reservoir retaining wall.

3. Areas prohibited to vessels for the purposes of Clause 9.

Waters upstream of the reservoir retaining wall for a distance of approximately 200 metres to an imaginary line between signs located on each bank and marked by red buoys are prohibited to vessels.

Vessel Operating and Zoning Rules for water levels 73.999 metres AHD or less – being 15% of maximum capacity, as measured at the head gauge board located at the right abutment of the dam wall at Melton Reservoir.

1. 5 knot speed restriction zones for the purpose of Clause 7.

All waters of Melton Reservoir excluding those areas described below as being prohibited for vessels.

2. Areas prohibited to vessels for the purposes of Clause 9.

All waters upstream of the reservoir retaining wall for a distance of approximately 200 metres to an imaginary line between signs located on each bank and marked by red buoys are prohibited to vessels.

- 3. revoke the rules regulating the operation of vessels on the waters of Pykes Creek Reservoir set out in Schedule 41 of the Notice made under section 15(2) of the **Marine Act 1988**; and
- 4. give notice of the following rules regulating the operation of vessels on the waters of Pykes Creek Reservoir:

SCHEDULE 41
WATERS – PYKES CREEK RESERVOIR

Local Authority – Southern Rural Water

Vessel Operating and Zoning Rules for water levels above 385.500 metres Australian Height Datum (AHD) – being 30% of maximum capacity – as measured at the head gauge board located on the outlet tower at the embankment of Pykes Creek Reservoir.

1. Access lanes for the purposes of Clause 5.
The following waters of Pykes Creek Reservoir are access lanes:
 - (a) The waters extending approximately 60 metres from the edge of the water for the time being in an area approximately 145 metres wide with the northern boundary located approximately 55 metres south of the launching ramp on the eastern shore; and
 - (b) the waters extending approximately 60 metres from the edge of the water for the time being in an area approximately 60 metres wide with the southern boundary located approximately 25 metres north of the launching ramp on the eastern shore.
2. 5 knot speed restriction zones for the purposes of Clause 7.
The waters of Pykes Creek Reservoir–
 - (a) in Korobeit Creek Inlet east of a line between two beacons located on opposite shores of the reservoir at the entrance to the inlet;
 - (b) in Dales Creek Inlet north of a line between two beacons located on opposite shores of the reservoir at the entrance to the inlet;
 - (c) in Korojamunip Creek Inlet north of a line between two beacons located on opposite shores of the reservoir at the entrance to the inlet; and
 - (d) around the perimeter of the reservoir for a distance of approximately 60 metres from the edge of the water for the time being except in the access lanes and in the prohibited areas –are subject to a speed restriction of 5 knots.
3. Areas prohibited to vessels for the purposes of Clause 9.
The waters of Pykes Creek Reservoir–
 - (a) between the dam wall of the reservoir and a line approximately 400 metres to the north thereof between two beacons inscribed “Stop” and “Prohibited Water Beyond This Point” located on opposite shores of the reservoir; and
 - (b) in a swimming area located in Swimmers Cove east of a line marked by red buoys in the water –are prohibited to vessels.

Vessel Operating and Zoning Rules for water levels 385.499 metres AHD or less – being 30% of maximum capacity – as measured at the head gauge board located on the outlet tower at the embankment of Pykes Creek Reservoir.

1. 5 knot speed restriction zones for the purposes of Clause 7.
All the waters of Pykes Creek Reservoir excluding those areas described below as being prohibited for vessels.
2. Areas prohibited to vessels for the purposes of Clause 9.
The waters of Pykes Creek Reservoir–
 - (a) between the dam wall of the reservoir and a line approximately 400 metres to the north thereof between two beacons inscribed “Stop” and “Prohibited Water Beyond This Point” located on opposite shores of the reservoir; and

- (b) in a swimming area located in Swimmers Cove east of a line marked by red buoys in the water –
are prohibited to vessels.

SCHEDULE 111
WATERS – LAKE GLENMAGGIE

Local Authority – Southern Rural Water

Vessel Operating and Zoning Rules for water levels above 70.000 metres Australian Height Datum (AHD) – being 44% of maximum capacity – as measured at the head gauge board located on the main embankment at Glenmaggie reservoir.

1. Access lanes for the purpose of clause 5.
The following waters of Lake Glenmaggie are access lanes:
 - (a) the waters extending 50 metres from the waters edge in an area 100 metres wide located immediately east of Sandy Point;
 - (b) the waters extending 50 metres from the waters edge in an area 100 metres wide located immediately south of Stuckey's Point;
 - (c) the waters extending 50 metres from the waters edge in an area 100 metres wide located adjacent to the Tinamba Glenmaggie Road approximately one kilometre from the junction of that road and the Glenmaggie–Heyfield Road;
 - (d) the waters extending 50 metres from the waters edge in an area 100 metres wide located approximately 200 metres north of the Lake Glenmaggie Caravan Park area No. 1;
 - (e) the waters extending 50 metres from the waters edge in an area 100 metres wide located approximately 300 metres north of the Lake Glenmaggie Caravan Park area No. 2;
 - (f) the waters extending 50 metres from the waters edge in an area 150 metres wide located adjacent to the Glenmaggie and District Boat Club clubhouse;
 - (g) the waters extending 50 metres from the waters edge in an area 200 metres wide located adjacent to Seaton Road approximately one kilometre from the junction of that road and the Glenmaggie–Heyfield Road;
 - (h) the waters extending 50 metres from the waters edge in an area 100 metres wide located approximately 50 metres west of the Kelly Cove launching ramp;
 - (i) the waters extending 50 metres from the waters edge in an area 100 metres wide located approximately 100 metres south of the entrance to Wooton Cove;
 - (j) the waters extending from the waters edge in an area 100 metres wide located on the northern side of Glenmaggie Point at the end of Catrina Crescent.
2. 5 knot speed restriction zones for the purposes of Clause 7.
The waters of Lake Glenmaggie–
 - (a) adjacent to the Seaton Road foreshore for a distance of approximately 100 metres from the edge of the water for the time being;
 - (b) in the Macalister River Inlet north of a line between beacons located on the foreshore each side of the entrance to the inlet;

- (c) in the Glenmaggie Creek Inlet east of a line of beacons located on the northern and southern foreshore approximately 200 metres west of the Glenmaggie–Licola Bridge;
 - (d) between the Glenmaggie-Licola Bridge and a line of beacons located on the northern and southern foreshore approximately 200 metres west of the bridge;
 - (e) in Wooton Cove north of a line passing in an east-westerly direction through a yellow buoy located in the water at the entrance to the cove;
 - (f) in Kelly Cove north-east of a line passing in a north-westerly direction through a yellow buoy located in the water at the entrance to the cove;
 - (g) in Ryan Cove north of a line passing east-west through a yellow buoy situated in the water at the entrance to the cove;
 - (h) in Munjara Cove south of a line passing through two or more yellow buoys located in the water at the entrance to the cove;
 - (i) in Sandy Cove south of a line passing through two or more yellow buoys located in the water within the cove –
- are subject to a speed restriction of 5 knots.

3. Areas prohibited to vessels for the purposes of Clause 9.

The waters of Lake Glenmaggie–

- (a) between the dam wall and a line 150 metres to the south-west thereof between two beacons inscribed “Stop” and “Prohibited Water Beyond This Point” located on opposite shores of the lake;
- (b) extending 50 metres from the waters edge between side boundaries marked by two red buoys at the following locations:
 - (i) a swimming area 60 metres wide on the eastern shore approximately 50 metres south of the launching ramp in Kelly Cove;
 - (ii) a swimming area 50 metres wide located approximately 100 metres north-west of the launching ramp on the southern shore of Sandy Point–

are prohibited to vessels.

Vessel Operating and Zoning Rules for water levels between 67.000 metres AHD (being 44% of maximum capacity) and 69.999 metres AHD (being 25% of maximum capacity) – as measured at the head gauge board located on the main embankment at Glenmaggie reservoir.

1. 5 knot speed restriction for the purpose of Clause 7.

The waters of Lake Glenmaggie –

- (a) the waters west of a straight line extending from a yellow beacon situated on Sandy Point, through a line of yellow buoys to a similar beacon situated on Wootons Point, including the Seaton Road foreshore.

2. Areas prohibited to vessels for the purposes of Clause 9.

The waters of Lake Glenmaggie–

- (a) between the dam wall and a line approximately 150 metres to the south-west thereof between two beacons inscribed “Stop” and “Prohibited Water Beyond This Point” located on opposite shores of the lake;

- (b) extending 50 metres from the waters edge between side boundaries marked by two red buoys at the following locations:
- (i) in a swimming area 60 metres wide on the eastern shore approximately 50 metres south of the launching ramp in Kelly Cove;
 - (ii) in a swimming area 50 metres wide located approximately 100 metres north-west of the launching ramp on the southern shore of Sandy Point –

are prohibited to vessels.

Vessel Operating and Zoning Rules for water levels 66.999 metres AHD (being 25% of maximum capacity) or less – as measured at the head gauge board located on the main embankment at Glenmaggie reservoir.

1. 5 knot speed restriction for the purposes of Clause 7.
All the waters of Lake Glenmaggie excluding areas prohibited for vessels.
2. Areas prohibited to vessels for the purposes of Clause 9.
The waters of Lake Glenmaggie–
 - (a) between the dam wall and a line 150 metres to the south-west thereof between two beacons inscribed “Stop” and “Prohibited Water Beyond This Point” located on opposite shores of the lake –

are prohibited to vessels.

Reference No. 272/002/2005

Dated 11 February 2005

MARK HUGHES
Director of Marine Safety

Road Safety Act 1986

NOTICE UNDER SECTION 68

Australian Grand Prix Rally

Silverband Road – 28 February 2005

Under Section 68(3) of the **Road Safety Act 1986**, I declare that the provisions of sub-sections (1) and (2) of Section 68 of the Act and Road Rules Victoria 1999 shall not apply with respect to the event known as the Australian Grand Prix Rally.

This notice operates on 28 February 2005 as detailed in the following table.

Location	Date	Road Closure Times
Silverband Road Lookout Carpark at Dairy Creek to Rosea Camping Ground	28 February 2005	10.00 am to 3.00 pm

Dated 8 February 2005

LANCE MIDGLEY
Regional Manager – Western Victoria
delegate for the Minister for Transport

Road Management Act 2004
ROAD DECLARATIONS

VicRoads, pursuant to Sections 11 and 14 of the **Road Management Act 2004**, upon publication of this notice declares the roads described in the Schedule and on the plans attached.

SCHEDULE

FREEWAY

- a) Those parts of Hume Freeway identified by hatching on the plan numbered GP 20166 are declared as described in the legend in the said plan.

ARTERIAL ROAD

- b) Those parts of Darebin Road and Fairfield-Reservoir Road identified by hatching on the plan numbered GP 20466 are declared as described in the legend in the said plan.
- c) Those parts of Darebin Road and Grange Road identified by hatching on the plan numbered GP 20467 are declared as described in the legend in the said plan.

MUNICIPAL ROAD

- d) The road identified by hatching on the plan numbered GP 20075 is declared as described in the legend in the said plan.

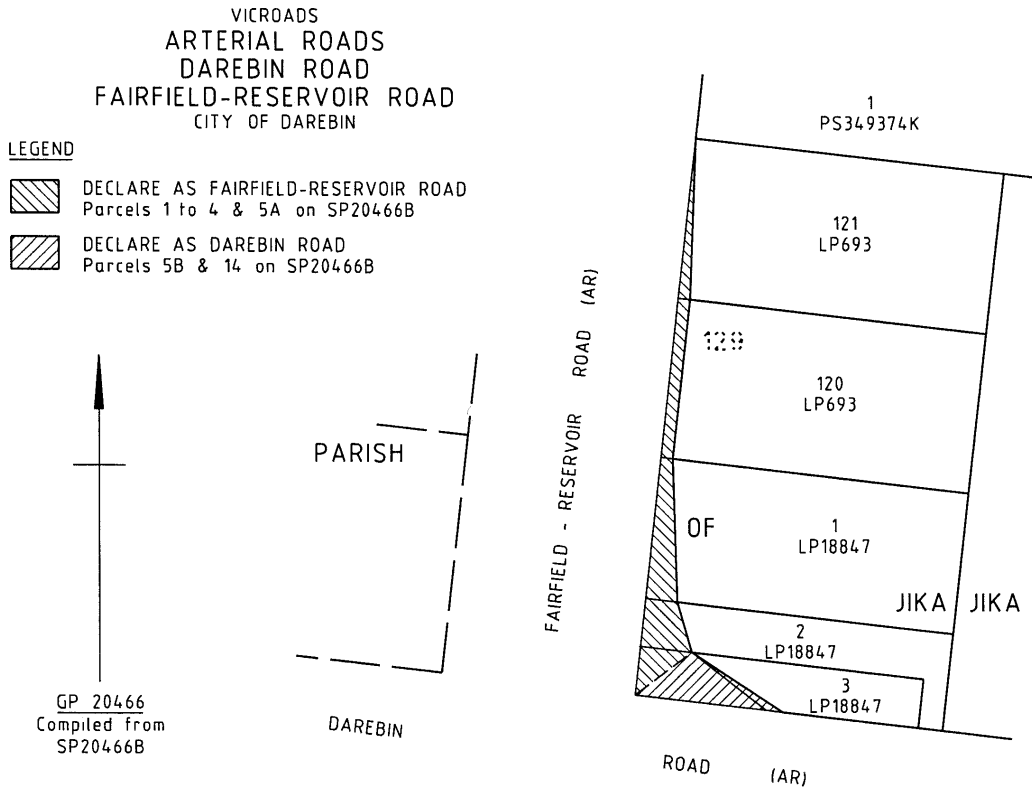

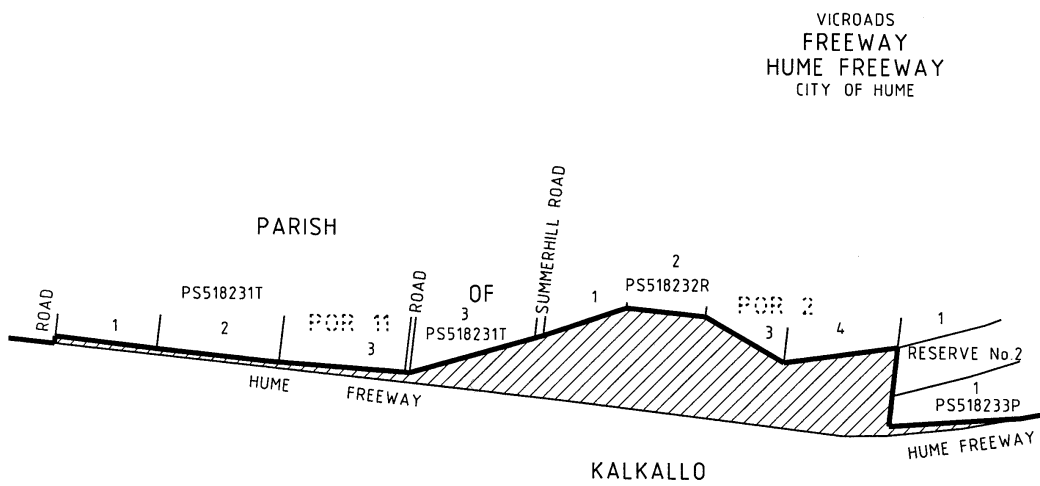
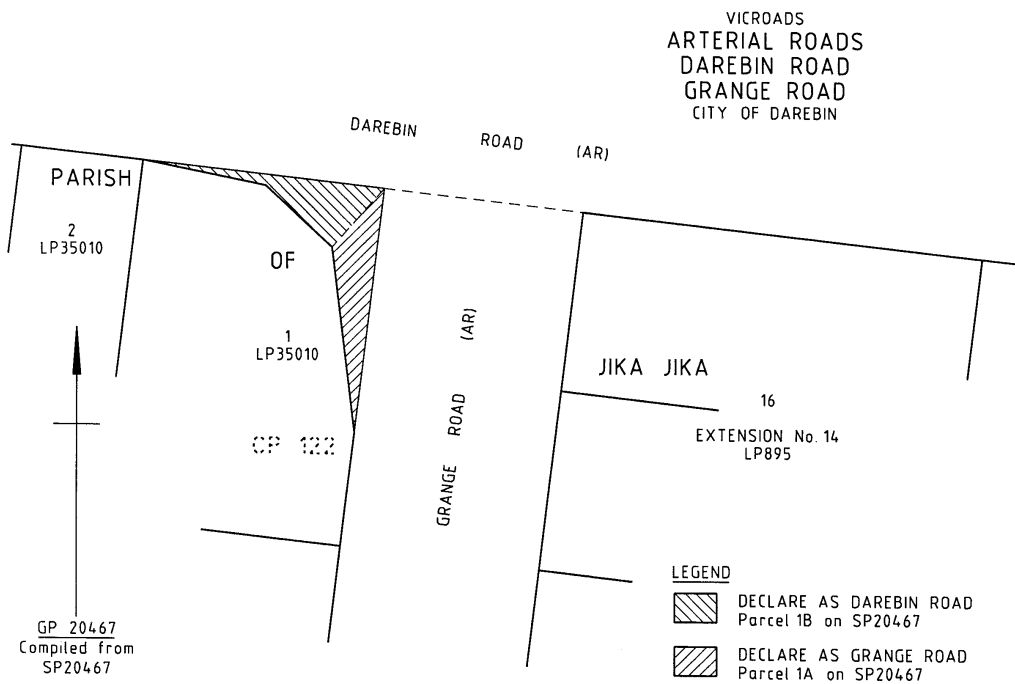

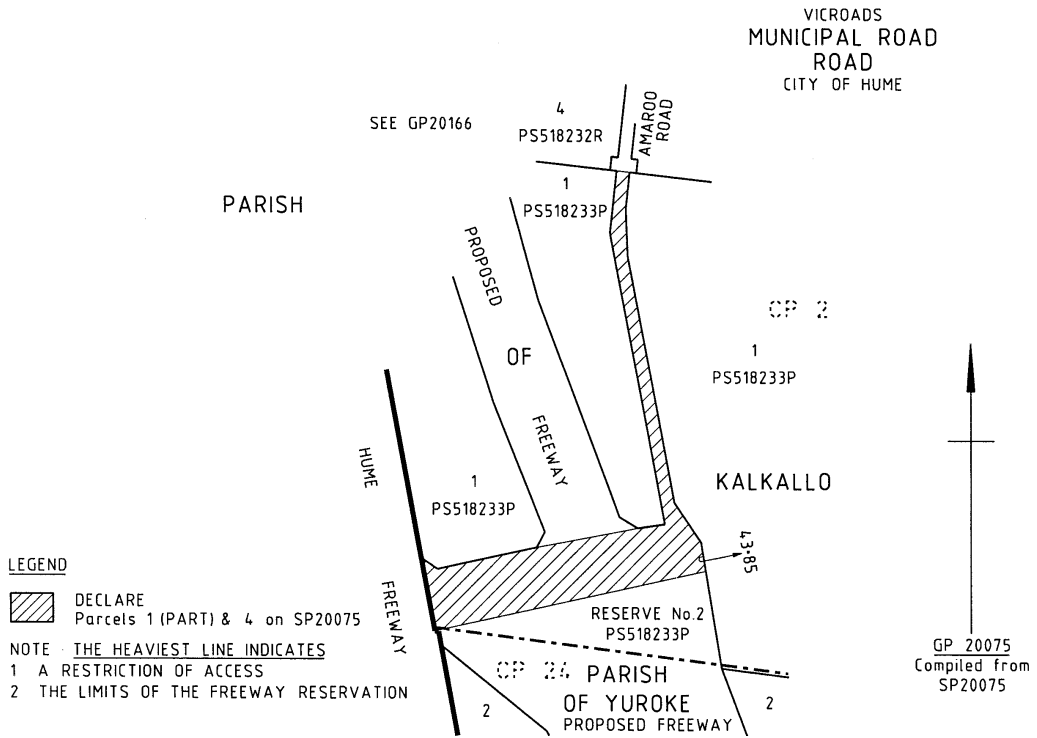

Dated 9 February 2005

DAVID ANDERSON
Chief Executive
VicRoads

Planning and Environment Act 1987

CARDINIA PLANNING SCHEME

Notice of Approval of Amendment

Amendment C61

The Minister for Planning has approved Amendment C61 to the Cardinia Planning Scheme.

The Amendment comes into operation on the date this notice is published in the Government Gazette.

The Amendment rezones land at Lots 26, 27, 28 and 29 Main Street, Bunyip from a Public Use Zone 4 to a Business 1 Zone and applies a new Schedule 3 to the Design and Development Overlay to the land. The Amendment also re-aligns the Business 1 Zone boundary on the west side of the site where the current Public Use Zone inadvertently includes part of the Main Street.

A copy of the Amendment can be inspected, free of charge, during office hours, at the Department of Sustainability and Environment, Planning Information Centre, Upper Plaza, Nauru House, 80 Collins Street, Melbourne; and at the offices of the Cardinia Shire Council, Henty Way, Pakenham.

GENEVIEVE OVERELL
Deputy Secretary
Built Environment
Department of Sustainability
and Environment

Planning and Environment Act 1987

GREATER GEELONG PLANNING SCHEME

Notice of Approval of Amendment

Amendment C52

The Minister for Planning has approved Amendment C52 to the Greater Geelong Planning Scheme.

The Amendment comes into operation on the date this notice is published in the Government Gazette.

The Amendment rezones the northern section of 181–185 Bellarine Highway, Newcomb from Low Density Residential Zone (LDRZ) to Business 4 Zone (B4Z). The Amendment will delete the existing Design and Development Overlay (DDO14) and apply DDO15 over the entire site.

A copy of the Amendment can be inspected, free of charge, during office hours, at the Department of Sustainability and Environment, Planning Information Centre, Upper Plaza, Nauru House, 80 Collins Street, Melbourne; and at the offices of the City of Greater Geelong, 131 Myers Street, Geelong.

GENEVIEVE OVERELL
Deputy Secretary
Built Environment
Department of Sustainability
and Environment

Planning and Environment Act 1987

MORNINGTON PENINSULA

PLANNING SCHEME

Notice of Approval of Amendment

Amendment C71

The Minister for Planning has approved Amendment C71 to the Mornington Peninsula Planning Scheme.

The Amendment comes into operation on the date this notice is published in the Government Gazette.

The Amendment replaces the Design and Development Overlay – Schedule 4 applying to part of Lot C PS 420741, Hove Road, Mount Martha with the Design and Development Overlay – Schedule 3. The Amendment ensures that a single overlay schedule applies to the whole of Lot C PS 420741.

A copy of the Amendment can be inspected, free of charge, during office hours, at the Department of Sustainability and Environment, Planning Information Centre, Upper Plaza, Nauru House, 80 Collins Street, Melbourne; and at the offices of the Mornington Peninsula Shire Council, Mornington Office, 2 Queen Street, Mornington; Hastings Office, Marine Parade, Hastings and Rosebud Office, Besgrove Street, Rosebud.

GENEVIEVE OVERELL
Deputy Secretary
Built Environment
Department of Sustainability
and Environment

Planning and Environment Act 1987
MOONEE VALLEY PLANNING SCHEME
 Notice of Approval of Amendment
 Amendment C35

The Minister for Planning has approved Amendment C35 to the Moonee Valley Planning Scheme.

The Amendment comes into operation on the date this notice is published in the Government Gazette.

The Amendment:

- introduces a new Clause 22.12 Mount Alexander Road South Urban Design Policy into the Local Planning Policy Framework (LPPF) of the Moonee Valley Planning Scheme;
- deletes Clause 22.08, Mount Alexander Road Urban Design Policy and replaces it with a new Clause 22.08, entitled Mount Alexander Road North Urban Design Policy. This provides a distinction between the two local policies that apply along different parts of the Mount Alexander Road boulevard;
- modifies Clause 21.21 of the MSS, "Mount Alexander Road", by adding a new statement to the key issues and updating references to the two sets of development guidelines;
- deletes Schedule 2 to the Design and Development Overlay (DDO) "Flemington Road Height Control". The Overlay imposed a 9 metre height restriction on all development fronting Flemington Road and is deleted from Planning Scheme Map 16DDO;
- introduces a new DDO, Schedule 4, the Mount Alexander Road South Urban Design Area, to provide guidance on preferred design criteria and recommended building heights; and
- deletes Schedule 3 to the DDO, Mount Alexander Road Urban Design Area, and replaces it with a new Schedule 3, entitled Mount Alexander Road North. This provides a distinction between the two different schedules that apply along different parts of the Mount Alexander Road boulevard.

A copy of the Amendment can be inspected, free of charge, during office hours, at the Department of Sustainability and Environment, Planning Information Centre, Upper Plaza,

Nauru House, 80 Collins Street, Melbourne; and at the offices of Moonee Valley City Council, Kellaway Avenue, Moonee Ponds.

GENEVIEVE OVERELL
 Deputy Secretary
 Built Environment
 Department of Sustainability
 and Environment

Planning and Environment Act 1987
NILLUMBIK PLANNING SCHEME
 Notice of Approval of Amendment
 Amendment C20

The Minister for Planning has approved Amendment C20 to the Nillumbik Planning Scheme.

The Amendment comes into operation on the date this notice is published in the Government Gazette.

The Amendment:

- inserts land comprising the Plenty Low Density Area in a Development Contributions Plan Overlay 4 and requires an open space site value contribution of 7.9% under the Schedule to Clause 52.01 for new subdivision in the area;
- modifies the boundary of the DPO applying the Plenty Low Density Area.

A copy of the Amendment can be inspected, free of charge, during office hours, at the Department of Sustainability and Environment, Planning Information Centre, Upper Plaza, Nauru House, 80 Collins Street, Melbourne; and at the offices of the Nillumbik Shire Council, Civic Drive, Greensborough.

GENEVIEVE OVERELL
 Deputy Secretary
 Built Environment
 Department of Sustainability
 and Environment

Planning and Environment Act 1987
SOUTH GIPPSLAND PLANNING SCHEME
 Notice of Approval of Amendment
 Amendment C25

The Minister for Planning has approved Amendment C25 to the South Gippsland Planning Scheme.

The Amendment comes into operation on the date this notice is published in the Government Gazette.

The Amendment:

- rezones Lot 1 on PS 87973 and Lot 1 TP 229523 (formerly Lot 2 on PS 87973), South Gippsland Highway, Korumburra from Rural Zone to Mixed Use Zone;
- removes the Environmental Significance Overlay Schedule 5 (Areas Susceptible to Erosion) from the subject land.

A copy of the Amendment can be inspected, free of charge, during office hours, at the Department of Sustainability and Environment, Planning Information Centre, Upper Plaza, Nauru House, 80 Collins Street, Melbourne; and at the offices of the South Gippsland Shire Council, 9 Smith Street, Leongatha.

GENEVIEVE OVERELL
Deputy Secretary
Built Environment
Department of Sustainability
and Environment

Planning and Environment Act 1987

TOWONG PLANNING SCHEME

Notice of Approval of Amendment

Amendment C12

The Minister for Planning has approved Amendment C12 to the Towong Planning Scheme.

The Amendment comes into operation on the date this notice is published in the Government Gazette.

The Amendment rezones 3,788m² of Lot 3 LP 200079, Lookout Road, Tallangatta from Rural Zone (RUZ) to Public Acquisition Overlay (PAO) for the purposes of extending the existing Lookout Road.

A copy of the Amendment can be inspected, free of charge, during office hours, at the Department of Sustainability and Environment, Planning Information Centre, Upper Plaza, Nauru House, 80 Collins Street, Melbourne; the North East Regional office, 35 Sydney Road, Benalla; and at the offices of the Towong Shire Council, Towong Street, Tallangatta.

GENEVIEVE OVERELL
Deputy Secretary
Built Environment
Department of Sustainability
and Environment

Planning and Environment Act 1987

WYNDHAM PLANNING SCHEME

Notice of Approval of Amendment

Amendment C63

The Minister for Planning has approved Amendment C63 to the Wyndham Planning Scheme.

The Amendment comes into operation on the date this notice is published in the Government Gazette.

The Amendment rezones two parcels of land comprising approximately 2.5893 hectares of land on the corner of Tarneit Road and Railway Avenue, Werribee (known as Lots A and B PS 512772P, County of Bourke, Parish of Deutgam) from a Public Use Zone – Services and Utility to a Residential 1 Zone.

A copy of the Amendment can be inspected, free of charge, during office hours, at the Department of Sustainability and Environment, Planning Information Centre, Upper Plaza, Nauru House, 80 Collins Street, Melbourne; and at the offices of the Wyndham City Council, Princes Highway, Werribee.

GENEVIEVE OVERELL
Deputy Secretary
Built Environment
Department of Sustainability
and Environment

ORDERS IN COUNCIL**Administrative Arrangements Act 1983****ADMINISTRATIVE ARRANGEMENTS ORDER (NO. 189) 2005**

The Governor in Council makes the following Order:

Dated 16 February 2005

Responsible Minister

S. P. BRACKS

Premier

SUDHA KASYNATHAN

Acting Clerk of the Executive Council

1. Title

This Order is called the Administrative Arrangements Order (No. 189) 2005.

2. Authorising Provision

This Order is made under section 3 of the **Administrative Arrangements Act 1983**.

3. Commencement

This Order takes effect on 1 July 2004.

4. Definitions

In this Order—

“**instrument**” includes contract or agreement;

“**New Body**” means the Minister specified in Column 3 of an item in the Schedule;

“**Old Body**” means the Minister specified in Column 1 of an item in the Schedule;

“**Schedule**” means the Schedule to this Order;

“**transaction**” includes –

- (a) agreement, bond, contract, deed or other consensual arrangement; and
- (b) action, appeal, arbitration, prosecution or other legal proceeding; and
- (c) assignment, charge, lease, mortgage, transfer or other dealing with property; and
- (d) loan, guarantee, indemnity or other dealing with money; and
- (e) approval, consent, delegation, direction, licence, order, permit, requirement or other authority; and
- (f) notice; and
- (g) any other act, entitlement or liability at law.

5. Construction of References

In respect of each item in the Schedule, a reference to the Old Body—

- (a) in a provision of an Act specified in Column 2 in the Schedule; or
- (b) in a statutory instrument or other instrument made under any provision of an Act specified in Column 2 of the Schedule; or
- (c) in respect of any other matter or thing done under a provision of an Act specified in Column 2 in the Schedule –

is deemed to be a reference to the New Body.

6. Saving of existing transactions

If a transaction happened in relation to the Old Body before this Order takes effect –

- (a) this Order does not affect the validity or continuity of the transaction; and

- (b) the transaction shall continue and may be completed in relation to the New Body in the same way as it would have been continued and may have been completed in relation to the Old Body if this Order had not been made.

SCHEDULE

Item No.	Column 1 (Old Body)	Column 2 (Legislation)	Column 3 (New Body)
1.	Minister for Gaming	Gambling Regulation Act 2003 <ul style="list-style-type: none"> ● Division 2 of Part 2 of Chapter 4 ● Part 5 of Chapter 4 	Minister for Racing
2.	Minister for Gaming	Gambling Regulation Act 2003 <ul style="list-style-type: none"> ● Division 1 of Part 3 of Chapter 10 	Minister for Victorian Communities

Cemeteries Act 1958

PUBLIC CEMETERY TRUSTS

Scales of Fees

Order in Council

The Governor in Council under section 17(1) of the **Cemeteries Act 1958** consents to the Trustees making the attached Scales of Fees of the following public cemetery trusts.

- THE ALTONA MEMORIAL PARK
- THE BAIRNSDALE PUBLIC CEMETERY
- THE DROUIN PUBLIC CEMETERY

Cemeteries Act 1958

SCALE OF FEES

By resolution of the Trust, the following fees will apply in the Altona Memorial Park and Williamstown Cemeteries from the date of approval by the Governor in Council. All other fees are rescinded to the extent to which they conflict with this scale.

ITEM	PROPOSED FEES
RIGHT OF BURIAL	\$
Right of Burial (Altona)	1,600.00
Right of Burial – Floral/Headstone Lawn (Williamstown)	1,800.00
Right of Burial – Monumental (Williamstown)	1,900.00
Right of Burial – Common Foundations (Williamstown)	2,400.00
Right of Burial – Pre Need (Altona)	1,600.00
Right of Burial – Pre Need – Floral/Headstone Lawn (Williamstown)	1,800.00
Right of Burial – Pre Need – Monumental (Williamstown)	1,900.00
Right of Burial – Pre Need – Common Foundations (Williamstown)	2,400.00

MAUSOLEUM	
MC – Mausoleum – Atrium – A	34,900.00
MC – Mausoleum – Atrium – B & C	40,400.00
MC – Mausoleum – Meditation (Tandem) – A	35,100.00
MC – Pre Need – Maus – Atrium – A	34,900.00
MC – Pre Need – Maus – Atrium – B & C	40,400.00
MC – Pre Need – Maus – Meditation (Tandem) – A	35,100.00
INTERMENT	
Interment (Altona)	1,050.00
Interment – 3 Deep (Altona)	1,600.00
Interment – 3 Deep (Williamstown)	1,700.00
Interment (Williamstown)	1,250.00
Interment – Child (Altona) – Adult Grave	850.00
Interment – Child (Williamstown) – Adult Grave	850.00
Interment – Standard – Public (Williamstown)	400.00
Interment – Child – Public (Williamstown)	200.00
Interment – Cremated Remains (Altona)	180.00
Interment – Cremated Remains (Williamstown)	180.00
Interment – Pre Need (Altona)	1,050.00
Interment – Pre Need – 3 Deep (Altona)	1,600.00
Interment – Pre Need (Williamstown)	1,250.00
Interment – Pre Need – Cremated Remains (Altona)	180.00
Interment – Pre Need – Cremated Remains (Williamstown)	180.00
Entombment (Mausoleum)	1,000.00
Entombment – Pre Need (Mausoleum)	1,000.00
CREMATED REMAINS	
Post Cremated Remains Overseas	170.00
Post Cremated Remains Within Australia	77.00
Repacking of Cremated Remains	44.00
MEMORIALS	
Azalea Bed Position	640.00
Book of Remembrance	115.00
Boulder Memorial 1 Position	1,650.00
Boulder Memorial 2 Positions	2,750.00
Boulder Memorial 3 Positions	3,300.00
Boulder Memorial 4 Positions	4,400.00
Boulder Memorial 5 Positions	5,500.00
Boulder Memorial 6 Positions	6,600.00
Boulder – Name Plate (Up to 7 Letters)	203.00
Boulder – Name Plate (8–12 Letters)	285.00
Conifer – Child	517.00
Court of Tranquility – Fountain Position and Plaque	1,400.00

Court of Tranquility – Standard Rose (for 2)	3,300.00
Court Position – Standard Rose	2,400.00
Court Position – Sundial/Fountain	680.00
Lavender Bed Position	640.00
Lilypond – Garden	680.00
Lilypond – Tree	3,630.00
Mt Olivet – Family Position – Standard Rose (4 Positions)	3,300.00
Mt Olivet – Family Position – Weeping Rose/Wisteria	4,950.00
Mt Olivet – Family Position – Standard Rose (2 Positions)	2,600.00
Mt Olivet – Rose Garden Position	970.00
Mt Olivet – Tree/Shrub Position	680.00
Mount Olivet Tree (4 positions)	4,400.00
Mt Olivet – Wall “A” Position	2,200.00
Mt Olivet – Wall “B” Position	1,860.00
Mt Olivet – Wall “C” Position	1,485.00
Niche Wall – Aust. War Grave Position	240.00
Niche Wall Position	400.00
Premium Memorial Position	9,000.00
Rock Garden – Memorial Position	640.00
Rock Pool Position	740.00
Rose Bed – Individual	2,160.00
Rose Garden Bed Position	740.00
Rose Individual – Child	1,419.00
Rose Garden Bed Position – Child	565.00
Shrub – Memorial	1,700.00
Tree Garden Position	460.00
Weeping Rose – Memorial	3,200.00
Avenue Tree (4 positions, plus up to 4 375x215 plaques)	5,720.00
Large Tree (6 positions)	7,260.00
Medium Tree (6 positions)	4,840.00
Small Tree (6 positions)	3,520.00
MISCELLANEOUS	
Administration of Relinquishment	80.00
Certificate Transfer	50.00
Copy of Certificate	35.00
Exhumation	2,200.00
Maintenance of Graves – (Williamstown Only)	200.00
Relocation of Cremated Remains within Cemetery	60.00
Search of Records (per Page)	70.00
Use of Chapel (Burial – 45 Minutes)	230.00
Use of Chapel (Cremation – Extra 60 Min.)	250.00
Pre-Need Use of Chapel	230.00
Weekend/Pub. Holiday Service – Burial	370.00
Weekend/Pub. Holiday Service – Other	370.00

URNS

Anakie Gold Inscription Pottery Urn (Name & Dates)	55.00
Anakie Large Pottery Urn (Assorted Designs)	330.00
Anakie Medium Pottery Urn (Assorted Designs)	165.00
Anakie Miniature Pottery Urn (Cherub & Teddy Bear)	88.00
Anakie Small Pottery Urn (Assorted Designs)	88.00
Arrow Bronze Fidelity Urn	550.00
Arrow Bronze Floral Urn (for 2)	1,100.00
Arrow Bronze Harmonia (Rose) Urn	880.00
Arrow Bronze Rectangular Urn	275.00
Arrow Bronze Thira Urn	1,100.00
Belgium Pewter Urn (for 2)	385.00
Belgium Pewter Urn – Large	330.00
Belgium Pewter Urn – Medium	192.00
Belgium Pewter Urn – Small	110.00
Rose Wood & Walnut Urn	192.00
Trinket Box – Medium (Rose & Butterfly)	55.00
Trinket Box (Assorted Shapes & Designs)	27.00
Watson Designer Urn	330.00
Watson Pottery Urn (Assorted Colours and Shapes)	88.00

BASES

Granite Base – Standard	285.00
Granite Base – Child	170.00
Granite Base – Rockedge (Correa)	560.00
Granite Base – Rockedge (Beam)	560.00
Granite Base – Rockedge (Floral Lawn)	560.00

PLAQUES

Additional Inscription (Memorial Plaques)	24.00
Additional Inscription – Rockedge (per line)	40.00
A/P Rosette Plaque (Court of Gospels)	175.00
A/P Rosette Flower Container (Court of Gospels)	55.00
Armillary Sundial Double Plaque (381279E)	460.00
Book of Life Plaque	825.00
Book of Life Plaque (2nd Page)	350.00
Book of Life Plaque (Blank Page)	165.00
Coloured Plaque (Memorial)	28.00
Coloured Plaque (Burial)	77.00
Companion Plaque (2 Line Ribbon)	682.00
Companion Plaque (Additional 2 Line Ribbon)	70.00
Companion Plaque (Additional 5 Line Ribbon)	115.00
Companion Plaque (5 Line)	715.00
Emblem – Type A, B or C	46.00

Emblem – Type D	82.00
Flower Container – Single Niche	46.00
Foreign Inscription	82.00
Granite Gold Emblem	77.00
Granite Gold Lettering Reguilding (per letter)	44.00
Individual Plaque – Floral Lawn (22x12)	590.00
Lid & Frame (for photos)	250.00
Lilypond – Computer Plaque (M130065)	135.00
Lilypond – Computer Plaque (M135115)	175.00
Mausoleum Inscription (per Letter)	10.00
Mausoleum Ceramic Photo – Black & White	77.00
Mausoleum Ceramic Photo – Coloured	125.00
Modular Design Plate	88.00
Mt. Olivet Family Plaque	330.00
Mt. Olivet Single Plaque	175.00
Niche Plaque – Single (5x4)	93.00
Niche Plaque – Double Niche & “A” Position	175.00
Photo – Coloured	350.00
Plaque (11x12)	330.00
Plaque (11x15)	460.00
Plaque Placement (Client Supplied) – Lawn	375.00
Plaque Placement (Client Supplied) – Memorial	180.00
Recondition Plaque – Lawn (11x12 & 22x12)	110.00
Recondition Plaque – Memorial Position	70.00
Recondition Plaque – Rockedge	285.00
Reservation Plaque – A/P Rosette (Court of Gospels)	77.00
Reservation Plaque – Double Niche	68.00
Reservation Plaque – Memorial Position/Single Niche	46.00
Rockedge Book of Life	1,705.00
Rockedge Book of Life – Blank Page	230.00
Rockedge Book of Life – 2nd Page	395.00
Rockedge Gold Lettering (up to 10 letters)	135.00
Rockedge Plaque – Additional Ribbon	200.00
Rockedge Plaque – Lawn – Individual (864x356)	1,110.00
Rockedge Plaque – Lawn – Companion (864x356)	1,110.00
Rose Garden/Rockpool – Computer Plaque (C114076)	145.00
Rockedge Reguilding (each letter)	44.00
Rubbing for Plaque	30.00
Special Plaque	as negotiated
Tapping for Ribbon – Lawn	55.00
Teddy Bear Childrens Plaque (9’)	320.00
278291 Heart Children’s Plaque	425.00

Together Forever Plaque	135.00
Tree Garden Plaque (with Granite Base)	210.00
Tree Plaque (9x7)	175.00
Tree Plaque – Computer (135x115)	175.00
Tree Plaque with Flower Container	187.00
NEW PRODUCTS	
Commission – Catering	10% of takings
Right of Burial – South Eastern Section (Altona)	2,000.00
Right of Burial – South Eastern Section (Special Lawn, Altona)	2,500.00
Right of Burial – Children's Lawn – Small Graves (incl interment)	600.00
Diamond Shield	14.00
Sympathy Pins	6.00
Filming (first 4 hours or part thereof)	400.00
Filming (per hour for time in excess of 4 hours)	80.00
Weekend or Public Holiday Call Out	250.00
Timbers for Muslim Funerals	250.00
Sand Backfill (per cubic metre)	30.00
Use of Chapel (Memorial Service)	230.00
Flower Seller Rental (per month)	560.00
Additional Inscription – 15x9 Burial Plaque (per line)	30.00
Additional Inscription – 11x12 Burial Plaque (per line)	32.00
Additional Inscription – 22x12 Burial Plaque (per line)	35.00
Emblem – Border	80.00
Emblem – Special	Cost + 25%
Granite Base – Memorial Position (Single)	260.00
Granite Base – Memorial Position (Double)	400.00
Book of Remembrance – Additional Inscription (per line)	25.00
Vase insert – Concrete Rest (Williamstown)	20.00

JOSEPH AUGUSTINE YACANO, trustee
 J. B. WHITTAKER, trustee
 JOHN PATTERSON, trustee
 JOHN SHAW, General Manager

Cemeteries Act 1958

SCALE OF FEES

By resolution of the Trust, the following fees will apply in the Bairnsdale Public Cemetery from the date of approval by the Governor in Council. All other fees are rescinded to the extent to which they conflict with this scale.

	\$
Land	826.00
Interment	414.00

Reopen	653.00
Childrens Lawn	615.00
Memorial Garden	370.00
Niche Wall – 160x210	344.00
Niche Wall – 130x160mm	272.00
Reservation	599.00
Concrete-lined Grave	4,820.00
Interment of Ashes in Private Grave	158.00
Removal of Ashes	100.00
Exhumation Fee	1,376.00

H. E. COVERDALE, trustee
 GEOFFREY J. CASSIDY, trustee
 MARGARET E. HANNINGTON, trustee

Cemeteries Act 1958

SCALE OF FEES

By resolution of the Trust, the following fees will apply in the Drouin Public Cemetery from the date of approval by the Governor in Council. All other fees are rescinded to the extent to which they conflict with this scale.

DETAILS	PROPOSED \$
LAWN SECTION	
Land	620.00
Interment	275.00
Grave Digging	Contract Plus 25%
REOPEN	
Interment	275.00
Grave Digging	Contract Plus 25%
RESERVATION LAWN	
Land only	620.00
EXTRA DEPTH OR WIDTH of Grave Digging	Contract Plus 25%
MONUMENTAL SECTION	
Land	620.00
Interment	275.00
Grave Digging	Contract Plus 25%
REOPEN	
Interment	275.00
Grave Digging	Contract Plus 25%
REMOVE, REPLACE Ledger or Other Coverings	Contract Plus 25%
MEMORIAL BEAM SECTION	
Land	700.00

Interment	275.00
Grave Digging	Contract Plus 25%
REOPEN MEMORIAL BEAM SECTION	
Interment	275.00
Grave Digging	Contract Plus 25%
RESERVATION MEMORIAL BEAM SECTION	
MEMORIAL WALL FOR CREMATED REMAINS	700.00
Wall Niche	250.00
Interment	275.00
RESERVATION OF WALL NICHE	250.00
ROSE GARDEN	
Plot, Interment	850.00
RESERVATION ROSE GARDEN PLOT	350.00
Interment	275.00
CREMATED REMAINS INTERMENT (All Sections of Cemetery)	275.00
EXHUMATION of Remains of Body	1,130.00
WEEKEND OR PUBLIC HOLIDAY INTERMENT TO	
Lawn, Monumental, Memorial Beam – Additional	250.00
PREPAID LAWN GRAVE	
1st Interment	1,690.00
Administration Charge on 1st Interment	110.00
2nd Interment	1,340.00
Administration Charge on 2nd Interment	33.00
ALL MEMORIAL PLAQUES	All supplied Contract Plus 25%
All Memorial Plaques must satisfy Trust specifications	
Memorial Plaques not supplied by Trust: Additional	80.00
IAN THOMAS GAFFNEY, trustee	
DONALD RAY BLACKLEY, trustee	
TERRY BLUNDELL, trustee	

This Order is effective on the day of gazettal.

Dated 16 February 2005
Responsible Minister
HON BRONWYN PIKE MP
Minister for Health

SUDHA KASYNATHAN
Acting Clerk of the Executive Council

**SUBORDINATE LEGISLATION ACT 1994
NOTICE OF MAKING OF STATUTORY
RULES**

Notice is hereby given under Section 17 (2) of the **Subordinate Legislation Act 1994** of the making of the following Statutory Rules:

5. *Statutory Rule:* Magistrates' Court
Civil Procedure
(Amendment No. 12)
Rules 2005
- Authorising Act:* Magistrates' Court
Act 1989
- Date of making:* 10 February 2005
6. *Statutory Rule:* Petroleum
(Amendment)
Regulations 2005
- Authorising Act:* Petroleum Act 1998
- Date of making:* 16 February 2005

**PRICING FOR SPECIAL GAZETTE,
PERIODICAL GAZETTE AND
VICTORIAN LEGISLATION**

Retail price varies according to the number of pages in each Victoria Government Special Gazette, Victoria Government Periodical Gazette and Victorian legislation. The table below sets out the prices that apply.

<i>Price Code</i>	<i>No. of Pages (Including cover and blank pages)</i>	<i>Price*</i>
A	1–16	\$3.70
B	17–32	\$5.50
C	33–48	\$7.55
D	49–96	\$11.75
E	97–144	\$15.20
F	145–192	\$17.95
G	193–240	\$20.70
H	241–288	\$22.05
I	289–352	\$24.80
J	353–416	\$29.00
K	417–480	\$33.10
L	481–544	\$38.60
M	545–608	\$44.10
N	609–672	\$49.65
O	673–736	\$55.10
P	737–800	\$60.65

**All Prices Include GST*

craftsmanpress

The *Victoria Government Gazette* is published by The Craftsman Press Pty Ltd with the authority of the Government Printer for the State of Victoria

© State of Victoria 2005

This publication is copyright. No part may be reproduced by any process except in accordance with the provisions of the Copyright Act.

Address all enquiries to the Government Printer for the State of Victoria
Level 2 1 Macarthur Street
Melbourne 3002
Victoria Australia

How To Order

	Mail Order	Craftsman Press Pty Ltd 125 Highbury Road Burwood 3125 DX – 32510 Burwood
	Telephone	(03) 9926 1233
	Fax	(03) 9926 1292
	email	gazette@craftpress.com.au
	Retail & Mail Sales	Information Victoria 356 Collins Street Melbourne 3000
	Telephone	1300 366 356
	Fax	(03) 9603 9920
	Retail Sales	City Graphics Level 1 520 Bourke Street Melbourne 3000
	Telephone	(03) 9600 0977
	Fax	(03) 9600 0989

Recommended Retail Price \$1.95 (includes GST)

ISSN 0819-5471



9 770819 550669