



Victoria Government Gazette

No. S 349 Wednesday 19 December 2007
By Authority, Victorian Government Printer

Casino Control Act 1991

Sections 62AB(4), 62AC(2) and 81AAB(2)

Gambling Regulation Act 2003

Sections 3.2.3(1)(g) and 3.2.3(1)(h)

VICTORIAN COMMISSION FOR GAMBLING REGULATION

Notice of Specified Areas in the Melbourne Casino

By this notice, the Victorian Commission for Gambling Regulation –

1. Revokes all areas previously specified by notices published in the Government Gazette as specified areas; and
2. Subject to the following conditions, specifies the areas shown in the attached Schedule for the purposes of sections 62AB(4), 62AC(2) and 81AAB(2) of the **Casino Control Act 1991**.

Conditions:

The conditions of this notice are that:

- (i) the total of –
 - (A) the total number of gaming machines which are operating at any time in a mode where spin rate, bet limit, autoplay and note acceptors are unrestricted in all areas specified by notice under section 62AB(4) or 62AC(2) of the **Casino Control Act 1991**; plus
 - (B) the total number of gaming machines from which winnings or accumulated credits in excess of \$2,000 may be paid out in cash in all areas specified by notice under section 81AAB(2) of the **Casino Control Act 1991**; minus
 - (C) the total number of gaming machines which are both operating in the mode referred to in sub paragraph (A) and from which winnings or accumulated credits in excess of \$2,000 may be paid out in cash as referred to in sub paragraph (B),must not exceed 1,000.
- (ii) a gaming machine located in an area specified by a notice under sections 62AB(4), 62AC(2) and 81AAB(2) of the **Casino Control Act 1991** referred to in Section 3.2.3(1)(g) of the **Gambling Regulation Act 2003** may only operate in a mode where spin rate, bet limit, autoplay and note acceptors are unrestricted if that gaming machine may only be played in that mode by means of a card, Personal Identification Number (PIN) or similar technology which requires the player to nominate limits on time and net loss before play can commence; and
- (iii) the payment of winnings or accumulated credits in excess of \$2000 may only be paid by cash if the winnings or credits are from one of the up to 1,000 machines specified in condition (i) (B). This provision regarding the payment of winnings by cash applies to the up to 1,000 machines specified in condition (i)(B) regardless of whether or not the machine:
 - (A) was also a machine capable of operating in a mode described in condition (i)(A); and
 - (B) was actually being played in exempt mode by means of card, PIN or similar technology at the time of the accumulation or payment of winnings as described in condition (ii).

This notice operates with effect from 19 December 2007.

PETER COHEN
Executive Commissioner

SPECIAL

Schedule
LEVEL 1 - GAMING

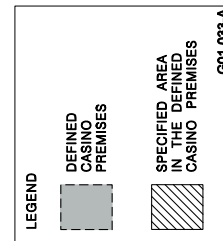
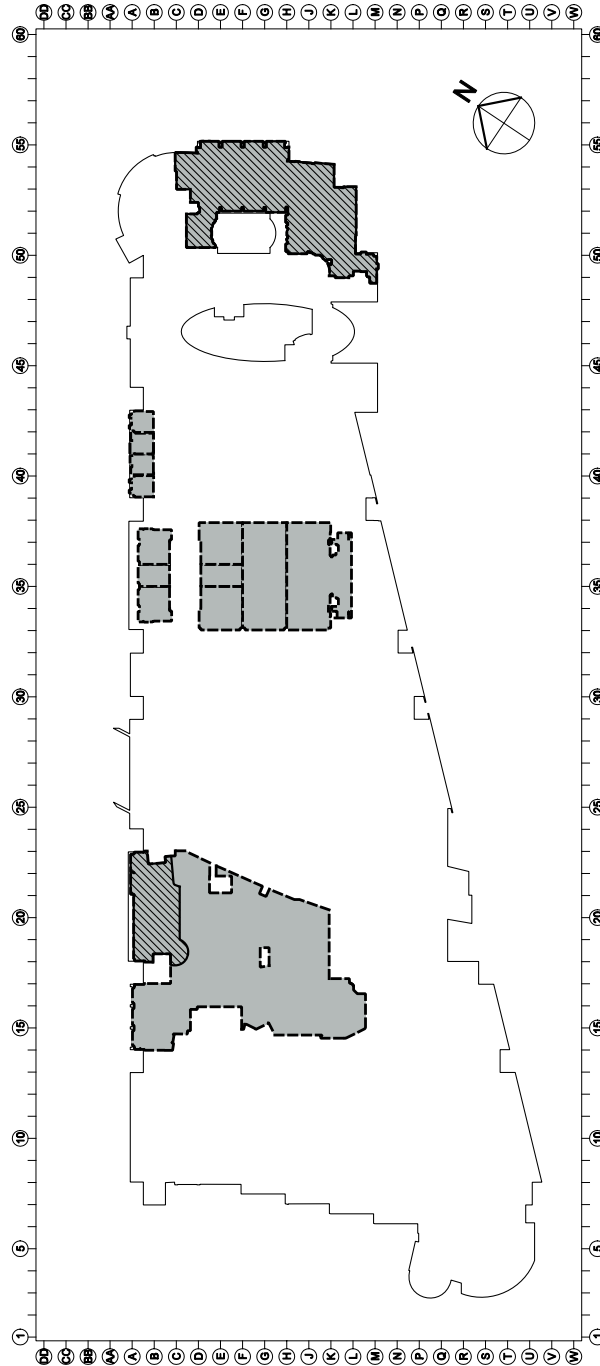

MAIN CASINO LEVEL - GROUND FLOOR

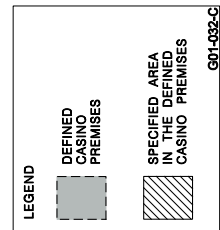
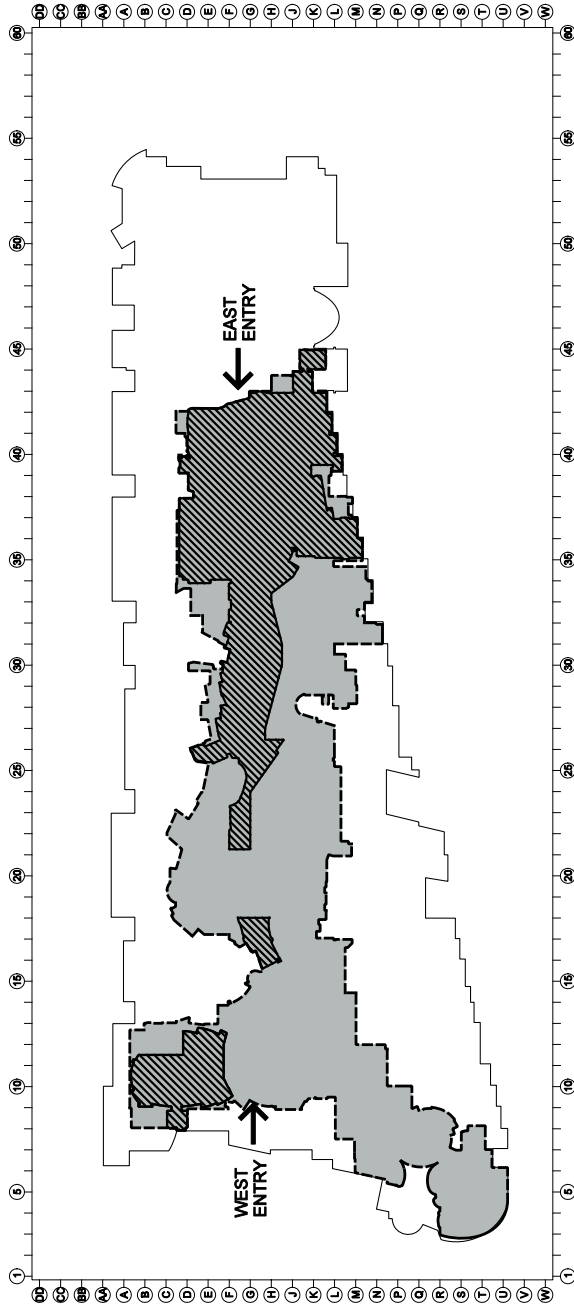

craftsmanpress

The *Victoria Government Gazette* is published by The Craftsman Press Pty Ltd with the authority of the Government Printer for the State of Victoria

© State of Victoria 2007

This publication is copyright. No part may be reproduced by any process except in accordance with the provisions of the Copyright Act.

Address all enquiries to the Government Printer for the State of Victoria
Level 2 1 Macarthur Street
Melbourne 3002
Victoria Australia

How To Order

	Mail Order	Victoria Government Gazette Level 1 520 Bourke Street Melbourne 3000 PO Box 1957 Melbourne 3001 DX 106 Melbourne
	Telephone	(03) 9642 5808
	Fax	(03) 9600 0478
	email	gazette@craftpress.com.au
	Retail & Mail Sales	Victoria Government Gazette Level 1 520 Bourke Street Melbourne 3000 PO Box 1957 Melbourne 3001
	Telephone	(03) 9642 5808
	Fax	(03) 9600 0478
	Retail Sales	Information Victoria 505 Little Collins Street Melbourne 3000
	Telephone	1300 366 356
	Fax	(03) 9603 9920

Price Code A