



Victoria Government Gazette

No. S 20 Friday 2 February 2007
By Authority. Victorian Government Printer

Road Management Act 2004 ROAD DECLARATIONS

VicRoads, pursuant to sections 11 and 14 of the **Road Management Act 2004**, upon publication of this notice declares the roads described in the Schedule and on the plans attached.

SCHEDULE

ARTERIAL ROAD

- That part of Great Alpine Road identified by hatching on the plan numbered GP21063 is declared as described in the legend in the said plan.
- Those parts of Thompson Road identified by hatching on the plan numbered GP21051 are declared as described in the legend in the said plan.

MUNICIPAL ROAD

- Those parts of Evans Road identified by hatching on the plan numbered GP21051A are declared as described in the legend in the said plan.

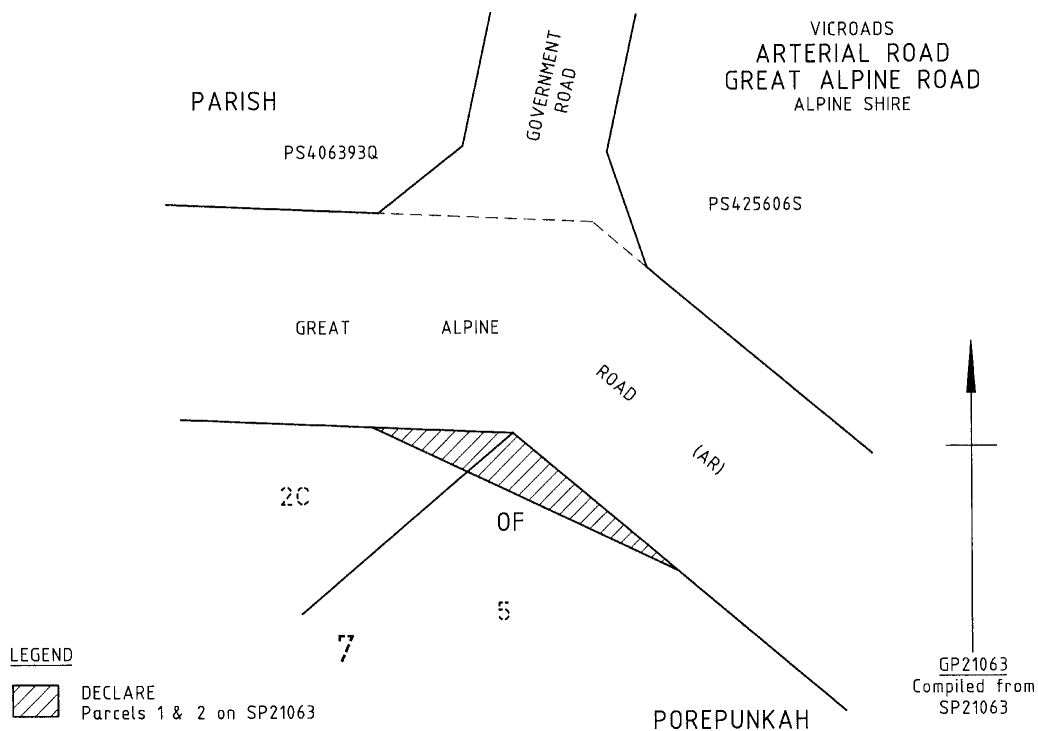

SPECIAL

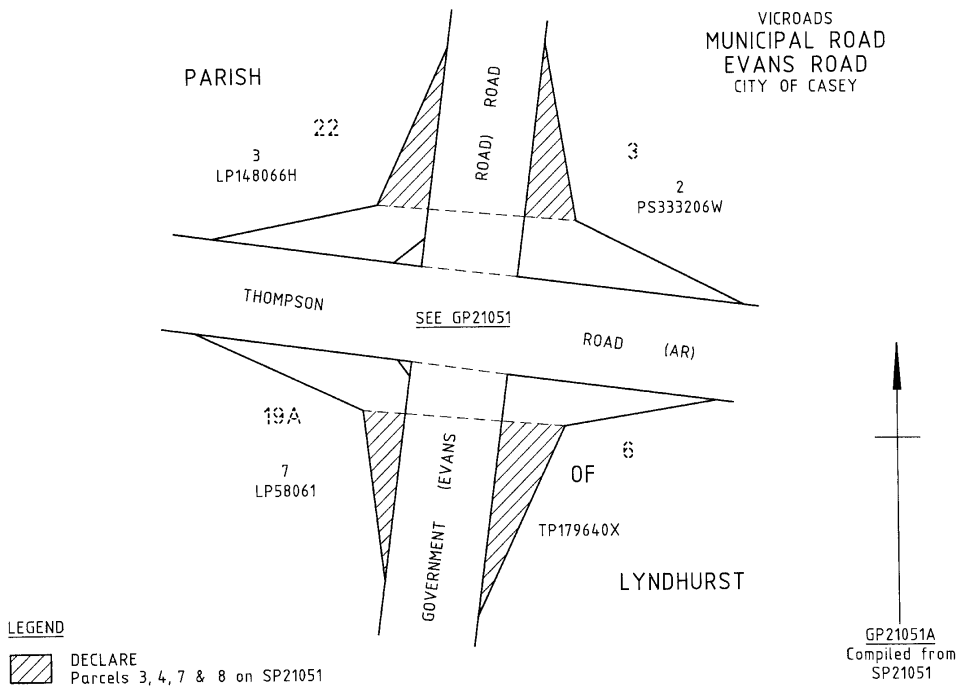
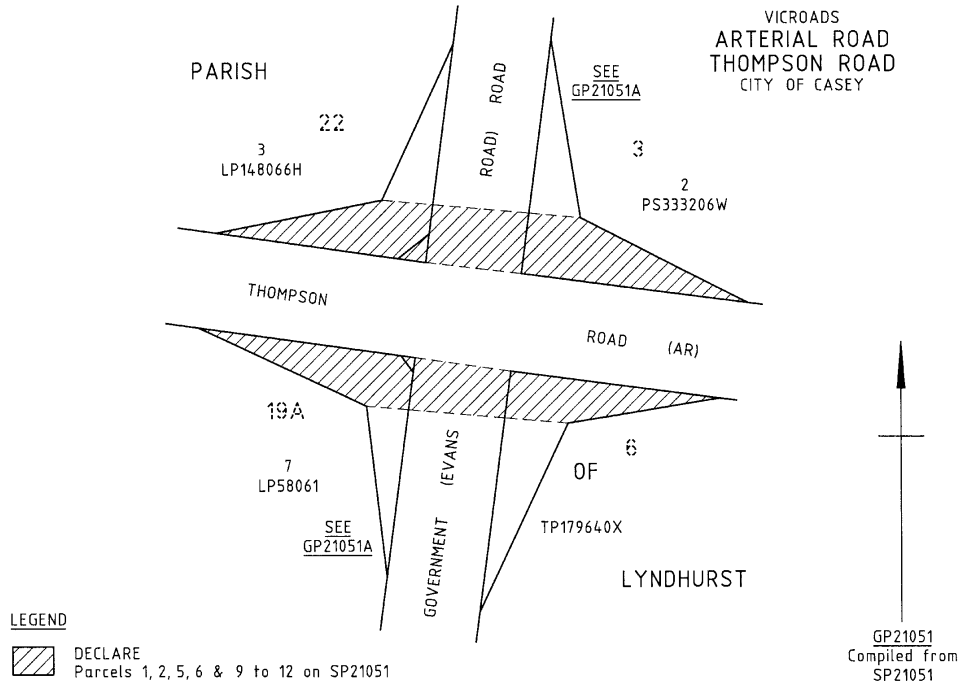

Dated 27 January 2007

GARY LIDDLE
Acting Chief Executive
VicRoads

This page was left blank intentionally

craftsmanpress



The *Victoria Government Gazette* is published by The Craftsman Press Pty Ltd with the authority of the Government Printer for the State of Victoria

© State of Victoria 2007

This publication is copyright. No part may be reproduced by any process except in accordance with the provisions of the Copyright Act.

Address all enquiries to the Government Printer for the State of Victoria
Level 2 1 Macarthur Street
Melbourne 3002
Victoria Australia

How To Order

	Mail Order	Victoria Government Gazette Level 1 520 Bourke Street Melbourne 3000 DX – 106 Melbourne
	Telephone	(03) 9642 5808
	Fax	(03) 9600 0478
	email	gazette@craftpress.com.au
	Retail & Mail Sales	Victoria Government Gazette Level 1 520 Bourke Street Melbourne 3000
	Telephone	(03) 9642 5808
	Fax	(03) 9600 0478
	Retail Sales	Information Victoria 356 Collins Street Melbourne 3000
	Telephone	1300 366 356
	Fax	(03) 9603 9920

Price Code A