



Victoria Government Gazette

No. S 124 Friday 2 May 2008
By Authority, Victorian Government Printer

EastLink Project Act 2004

NOTICE OF DECISION TO DISCONTINUE ROADS

Pursuant to section 133 of the **EastLink Project Act 2004**, the Southern and Eastern Integrated Transport Authority (SEITA) made a decision on 30 April 2008 that part of the road(s) identified on the plans numbered GP20282B, GP 20278B, GP17976A, GP 20255D, GP 20272C, GP20273B, GP 20256C, GP 17939D, GP 17976D, GP 20246E, GP 20275A, GP 20387, GP 20389C, GP 20821, GP 20439, GP 20276, GP 20245A, GP 17977A, GP 20270, GP 17939E, GP 20255C, GP 20413A, GP 20412A, GP 20363, GP 20352A, GP 20273A, GP 17939C, GP 20278A, GP 20436A, GP 20440, GP 20272B, GP 17976B, GP 20389B, GP 20415, GP 20266A, GP 20438A, GP 20321C, GP 20321B, GP 20355A, GP 20360, GP 20246D and GP 20354A, as set out below, be discontinued as described in the legend in each of the said plans.

Pursuant to section 137(2)(d) of the **EastLink Project Act 2004**, that decision provided that the land the subject of the decision was to be reserved for the purposes of the Project (as that term is defined in the **EastLink Project Act 2004**).

SOUTHERN & EASTERN INTEGRATED TRANSPORT AUTHORITY
MUNICIPAL ROAD
BANGHOLME ROAD
CITY OF GREATER DANDENONG

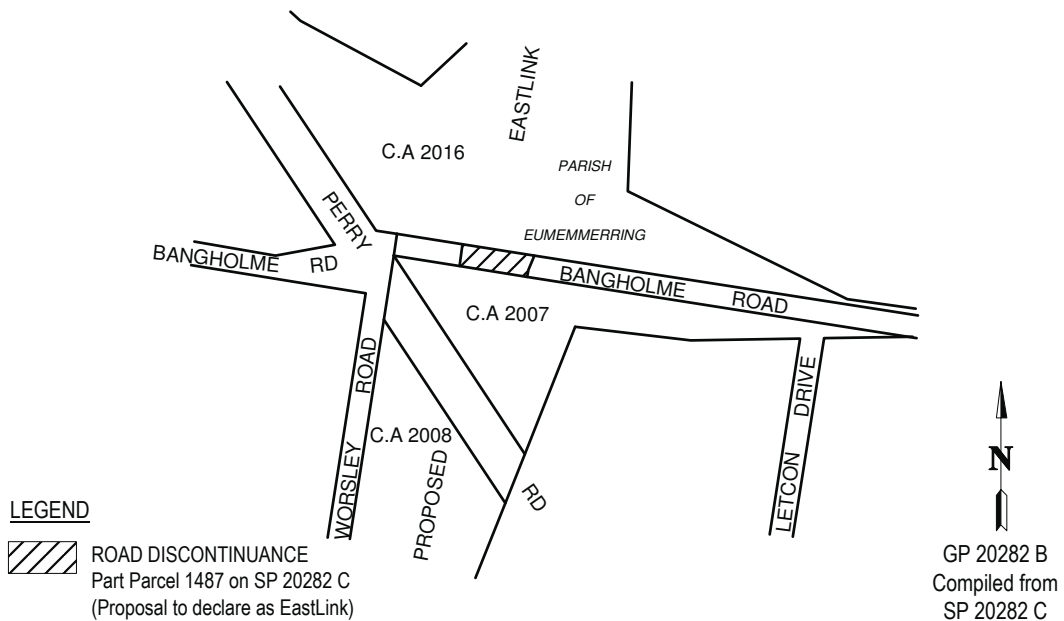

SPECIAL

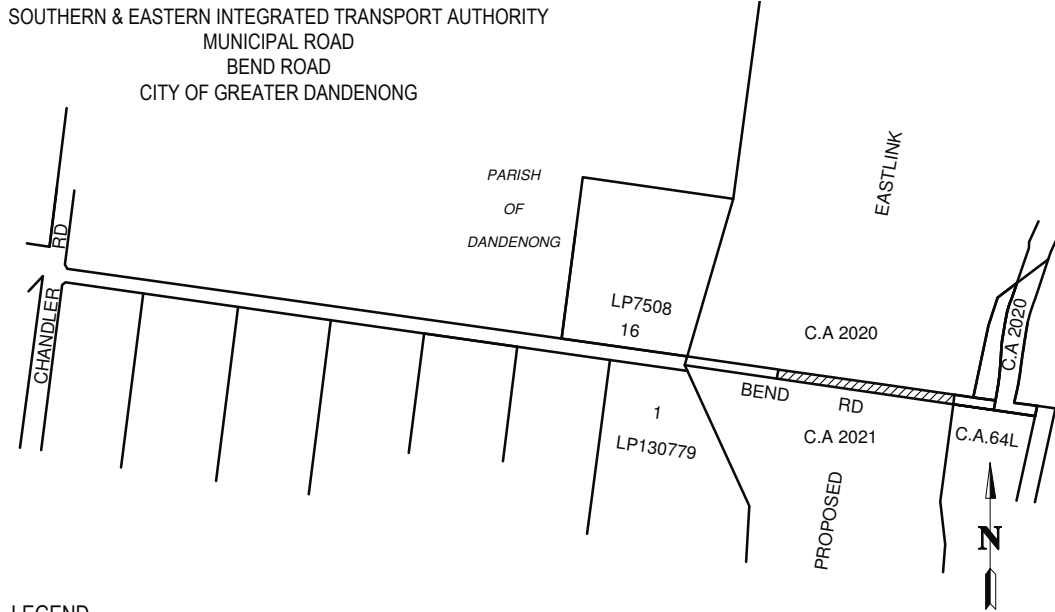

LEGEND

ROAD DISCONTINUANCE
Parcel 1380 & Part Parcel 1376 on SP 20278 D
(Proposal to declare as EastLink)

GP 20278 B
Compiled from
SP 20278 D

SOUTHERN & EASTERN INTEGRATED TRANSPORT AUTHORITY
MUNICIPAL ROADS
BON VIEW AVENUE AND HEATHERBRAE AVENUE
CITY OF MAROONDAH

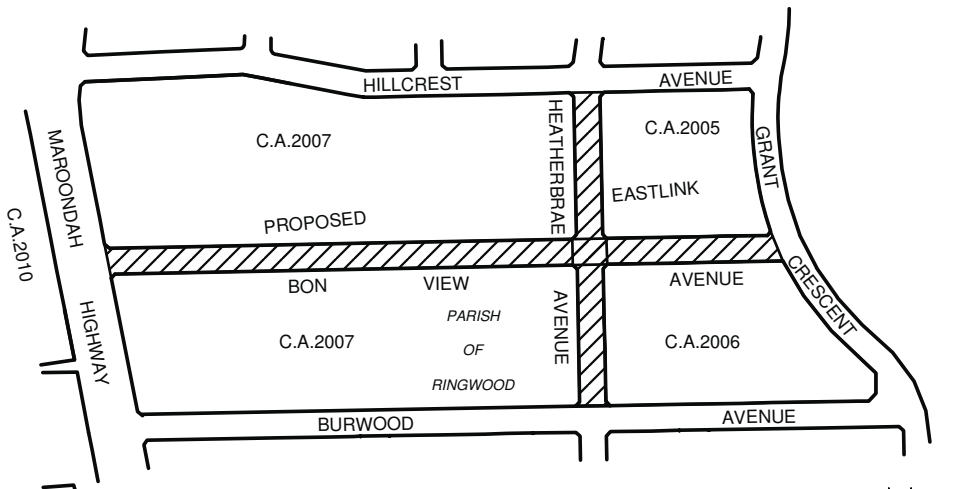

LEGEND

ROAD DISCONTINUANCE
Parcels 303, 304, 304A, 305, 305A and 306 on SP 17976 A
(Proposal to declare as EastLink)

GP 17976 A
Compiled from
SP 17976 A

SOUTHERN & EASTERN INTEGRATED TRANSPORT AUTHORITY
MUNICIPAL ROAD
BOUNDARY ROAD
CITY OF FRANKSTON

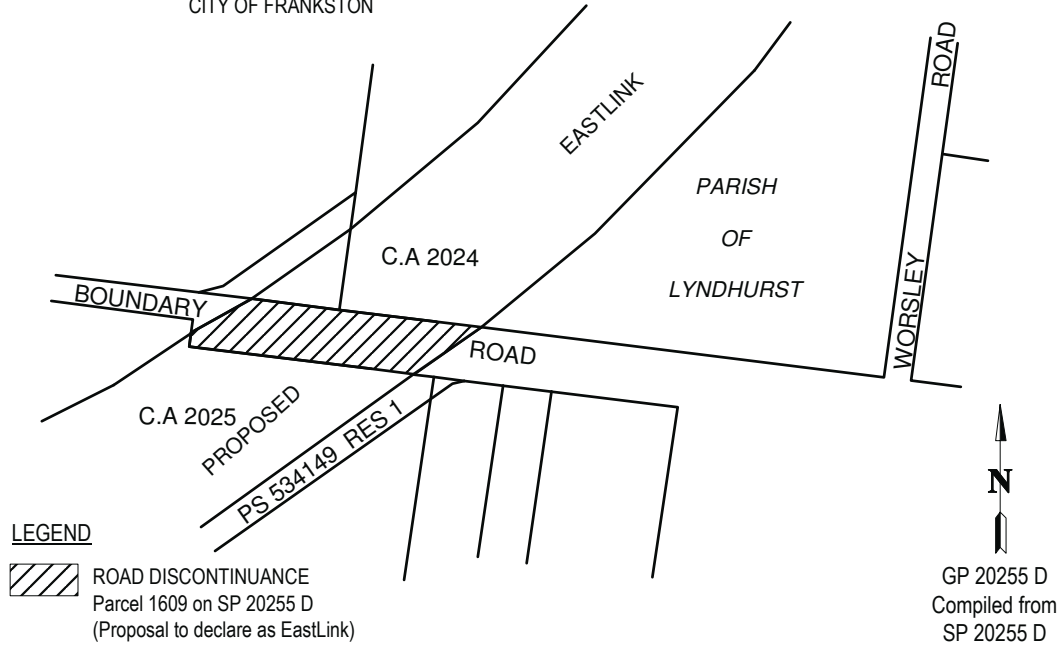

SOUTHERN & EASTERN INTEGRATED TRANSPORT AUTHORITY
MUNICIPAL ROAD
CATHIES LANE
CITY OF KNOX

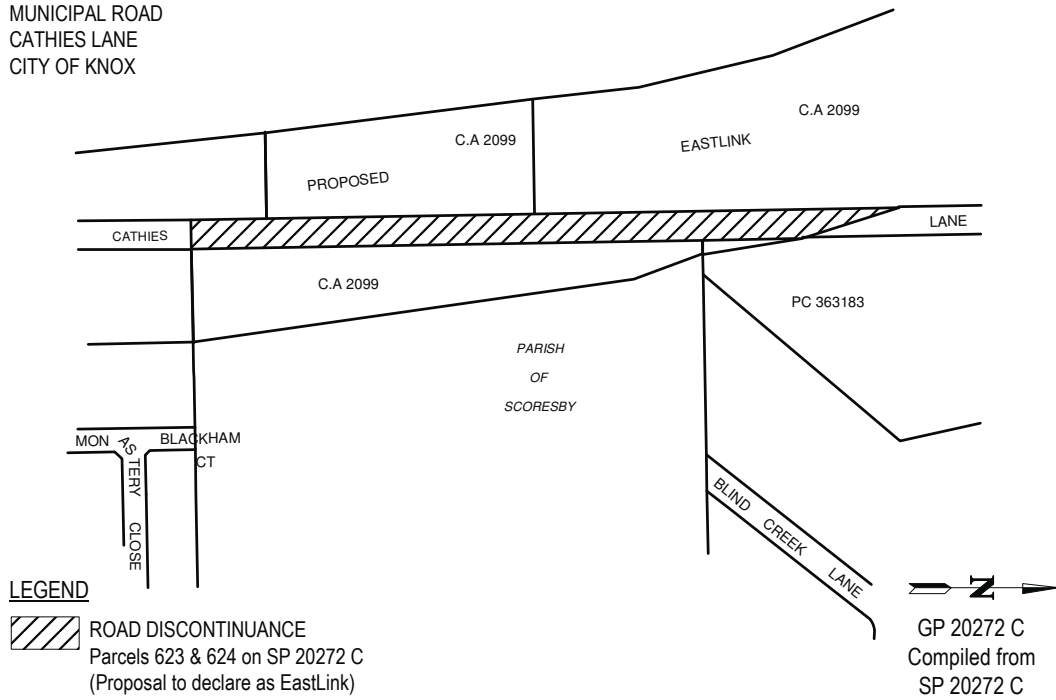

SOUTHERN & EASTERN INTEGRATED TRANSPORT AUTHORITY
MUNICIPAL ROAD
CATHIES LANE
CITY OF KNOX

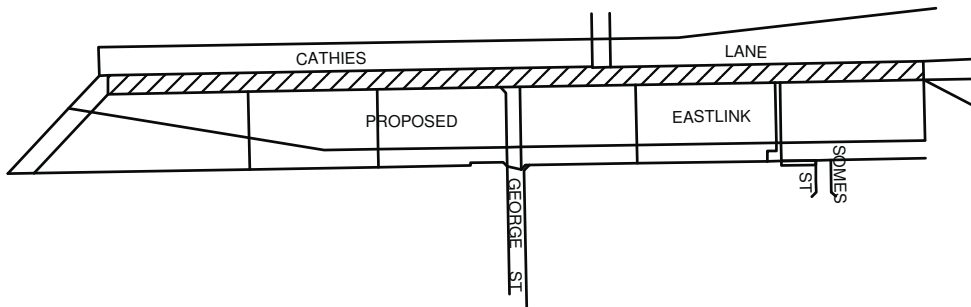

LEGEND

 ROAD DISCONTINUANCE
Parcel 662 on SP 20273 A
(Proposal to declare as EastLink)

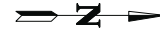

GP 20273 B
Compiled from
SP 20273 A

SOUTHERN & EASTERN INTEGRATED TRANSPORT AUTHORITY
MUNICIPAL ROAD
COLEMANS ROAD
CITY OF FRANKSTON

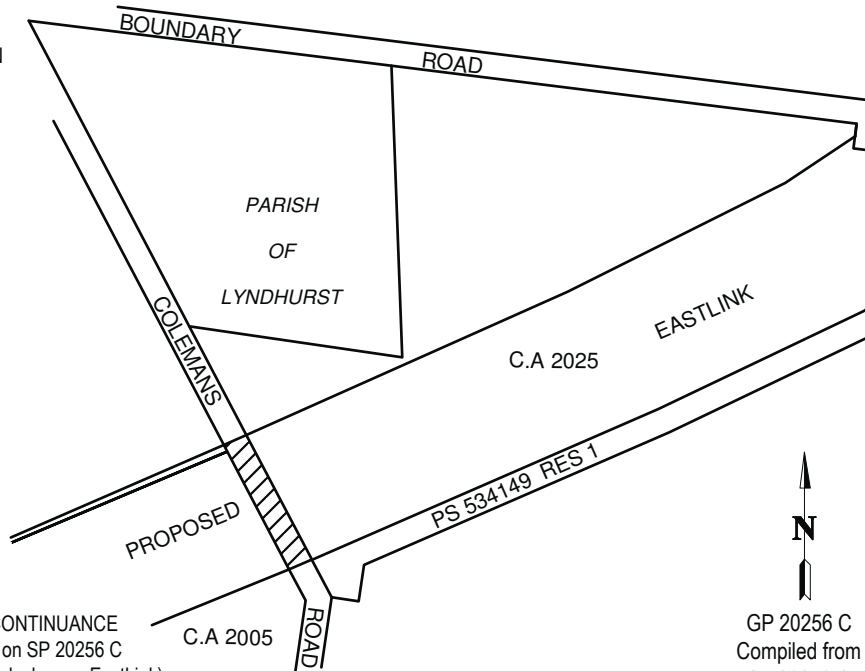

LEGEND

 ROAD DISCONTINUANCE
Parcel 1641 on SP 20256 C
(Proposal to declare as EastLink)



GP 20256 C
Compiled from
SP 20256 C

SOUTHERN & EASTERN INTEGRATED TRANSPORT AUTHORITY
 MUNICIPAL ROAD
 DEEP CREEK / LOUGHNAN ROAD
 CITY OF MANNINGHAM / CITY OF WHITEHORSE /
 CITY OF MAROONDAH

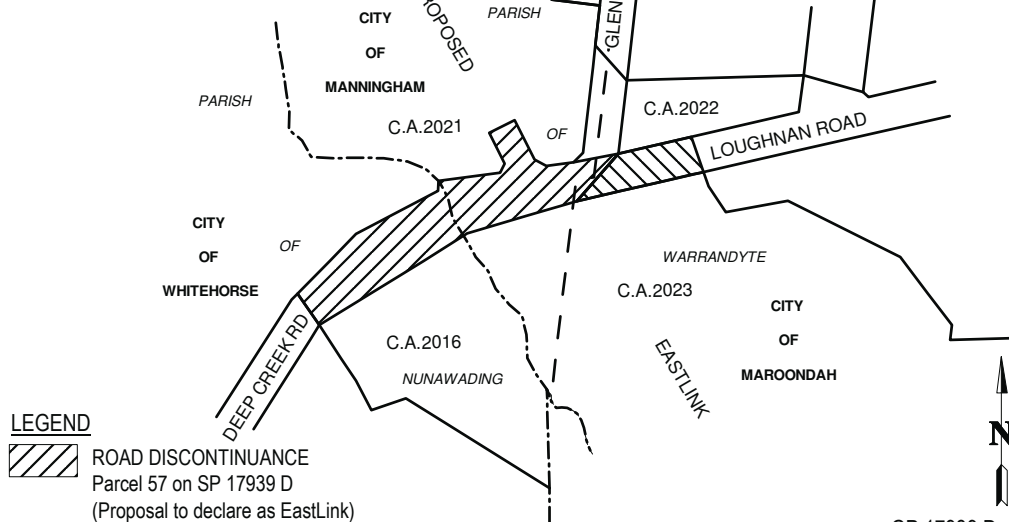

LEGEND

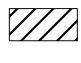
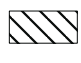
-  ROAD DISCONTINUANCE
Parcel 57 on SP 17939 D
(Proposal to declare as EastLink)
-  ROAD DISCONTINUANCE
Parcel 301 on SP 17977 C
(Proposal to declare as EastLink)

GP 17939 D
 Compiled from
 SP 17939 D & SP 17977 C

SOUTHERN & EASTERN INTEGRATED TRANSPORT AUTHORITY
 MUNICIPAL ROAD
 GRANT CRESCENT / BURWOOD AVENUE
 CITY OF MAROONDAH

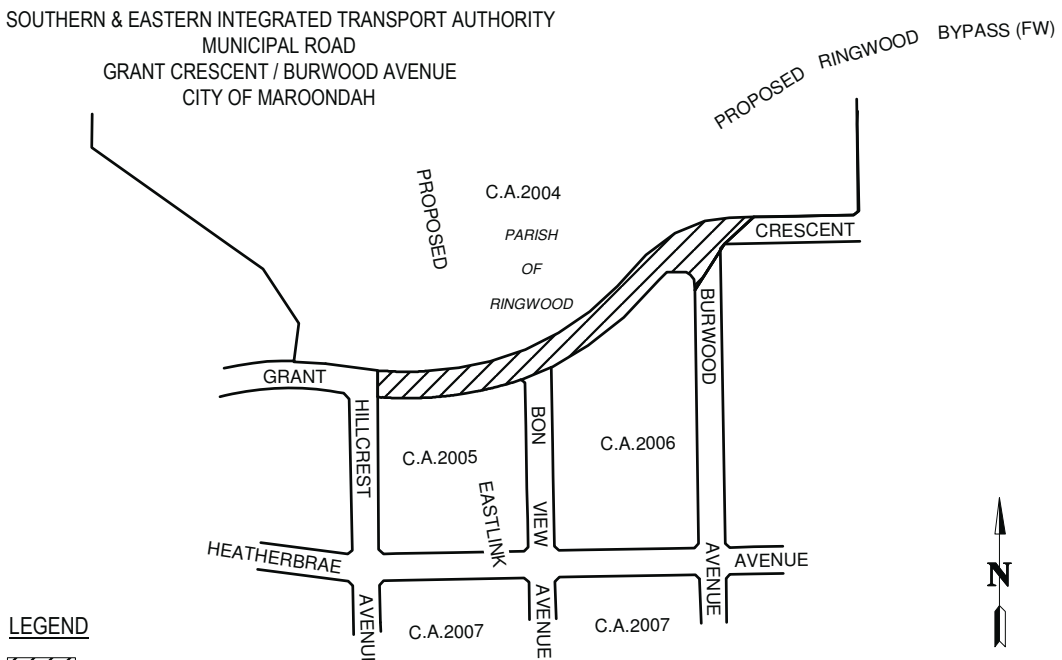

LEGEND

-  ROAD DISCONTINUANCE
Part Parcel 300 on SP 17976 A
(Proposal to declare as EastLink)

GP 17976 D
 Compiled from
 SP 17976 A

SOUTHERN & EASTERN INTEGRATED TRANSPORT AUTHORITY
 MUNICIPAL ROAD
 HARWOOD ROAD
 CITY OF GREATER DANDENONG

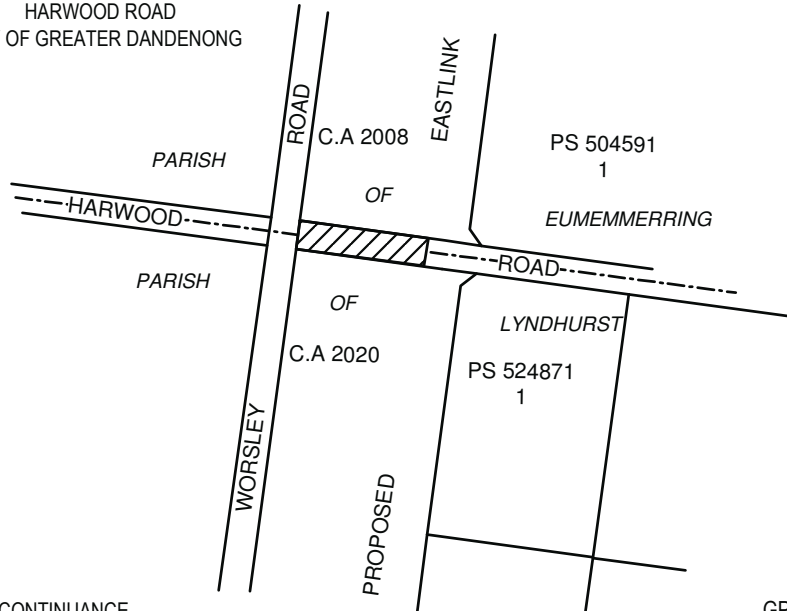

LEGEND

 ROAD DISCONTINUANCE
 Part Parcel 1540 on SP 20246 D
 (Proposal to declare as EastLink)

 GP 20246 E
 Compiled from
 SP 20246 D

SOUTHERN & EASTERN INTEGRATED TRANSPORT AUTHORITY
 MUNICIPAL ROAD
 KIRKHAM ROAD WEST
 CITY OF GREATER DANDENONG

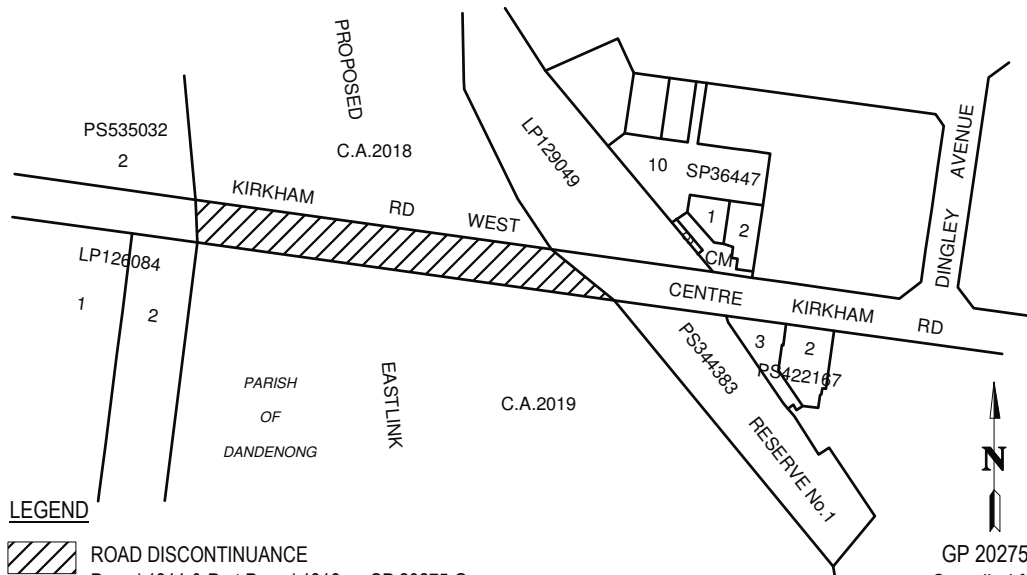

LEGEND

 ROAD DISCONTINUANCE
 Parcel 1311 & Part Parcel 1318 on SP 20275 G
 (Proposal to declare as EastLink)

 GP 20275 A
 Compiled from
 SP 20275 G

SOUTHERN & EASTERN INTEGRATED TRANSPORT AUTHORITY
MUNICIPAL ROAD
MADDEN STREET
CITY OF MAROONDAH

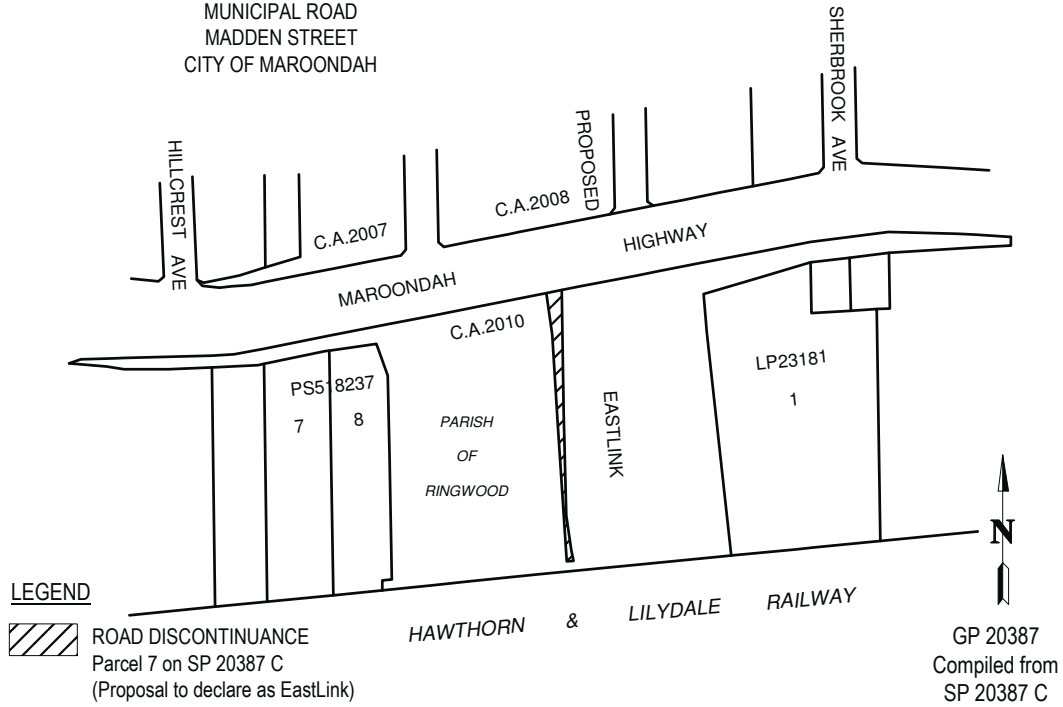

SOUTHERN & EASTERN INTEGRATED TRANSPORT AUTHORITY
MUNICIPAL ROAD
MADDEN STREET
CITY OF MAROONDAH

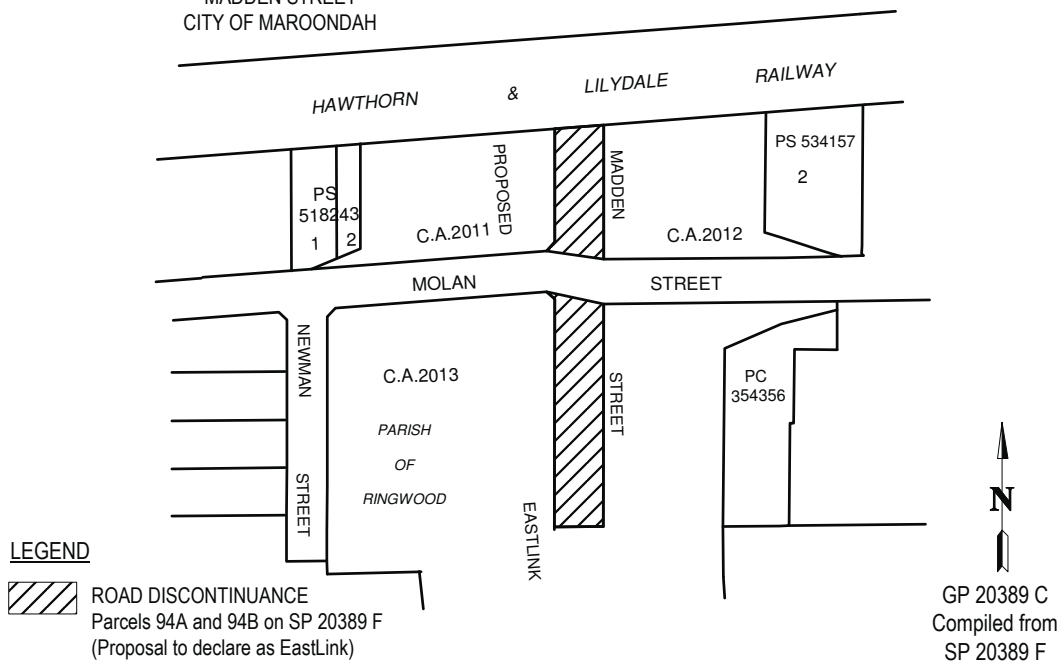

SOUTHERN & EASTERN INTEGRATED TRANSPORT AUTHORITY
 MUNICIPAL ROAD
 MITCHAM ROAD
 CITY OF MANNINGHAM /
 CITY OF WHITEHORSE

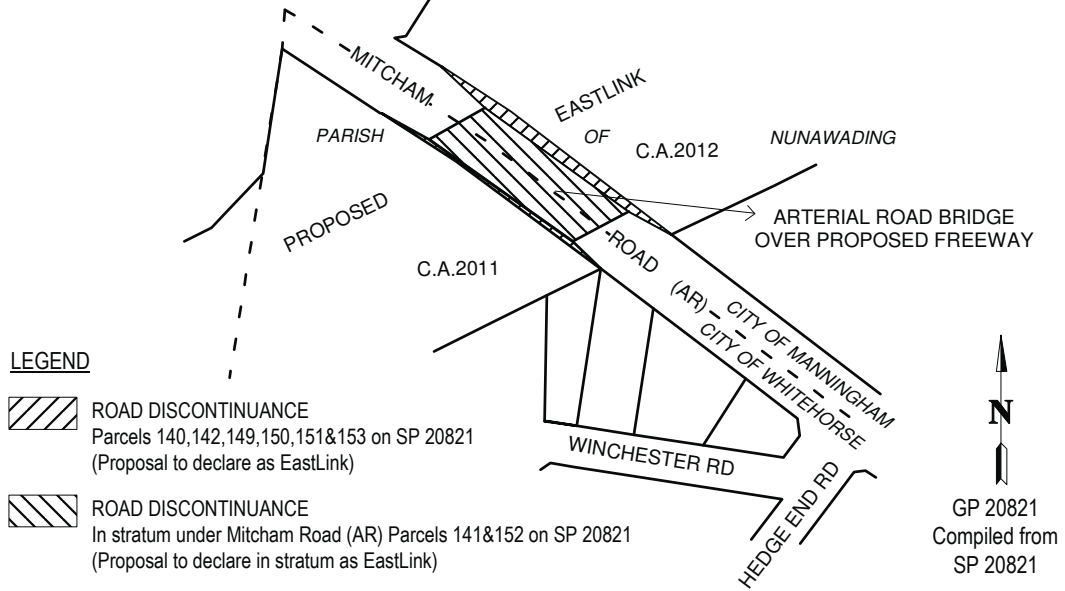

LEGEND

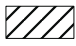
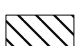
-  ROAD DISCONTINUANCE
 Parcels 140, 142, 149, 150, 151 & 153 on SP 20821
 (Proposal to declare as EastLink)
-  ROAD DISCONTINUANCE
 In stratum under Mitcham Road (AR) Parcels 141 & 152 on SP 20821
 (Proposal to declare in stratum as EastLink)

GP 20821
 Compiled from
 SP 20821

SOUTHERN & EASTERN INTEGRATED TRANSPORT AUTHORITY
 MUNICIPAL ROAD
 MOLLISON STREET
 CITY OF GREATER DANDENONG

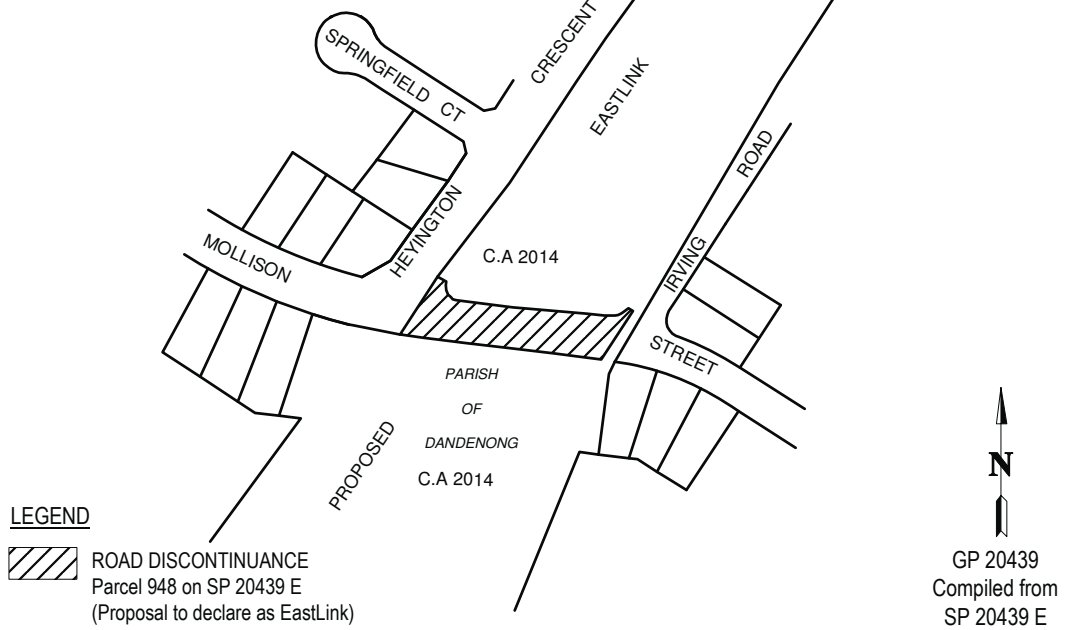

LEGEND

-  ROAD DISCONTINUANCE
 Parcel 948 on SP 20439 E
 (Proposal to declare as EastLink)

GP 20439
 Compiled from
 SP 20439 E

SOUTHERN & EASTERN INTEGRATED TRANSPORT AUTHORITY
MUNICIPAL ROAD
OLIVE GROVE
CITY OF GREATER DANDENONG

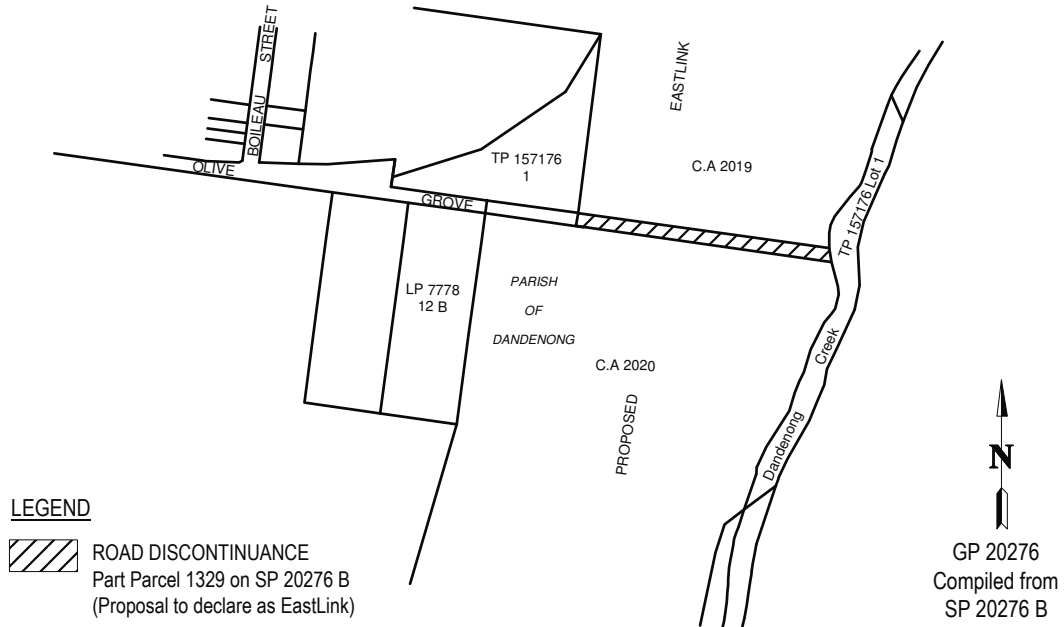

SOUTHERN & EASTERN INTEGRATED TRANSPORT AUTHORITY
MUNICIPAL ROAD
PERRY ROAD
CITY OF GREATER DANDENONG

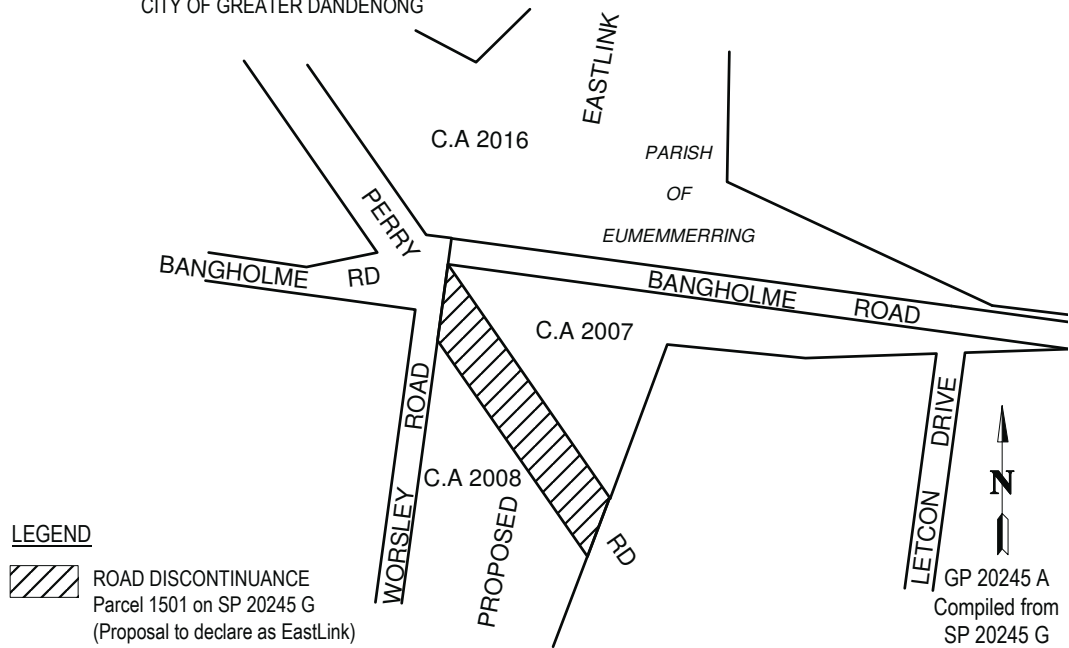

SOUTHERN & EASTERN INTEGRATED TRANSPORT AUTHORITY
MUNICIPAL ROAD
POYNTON AVE
CITY OF MAROONDAH

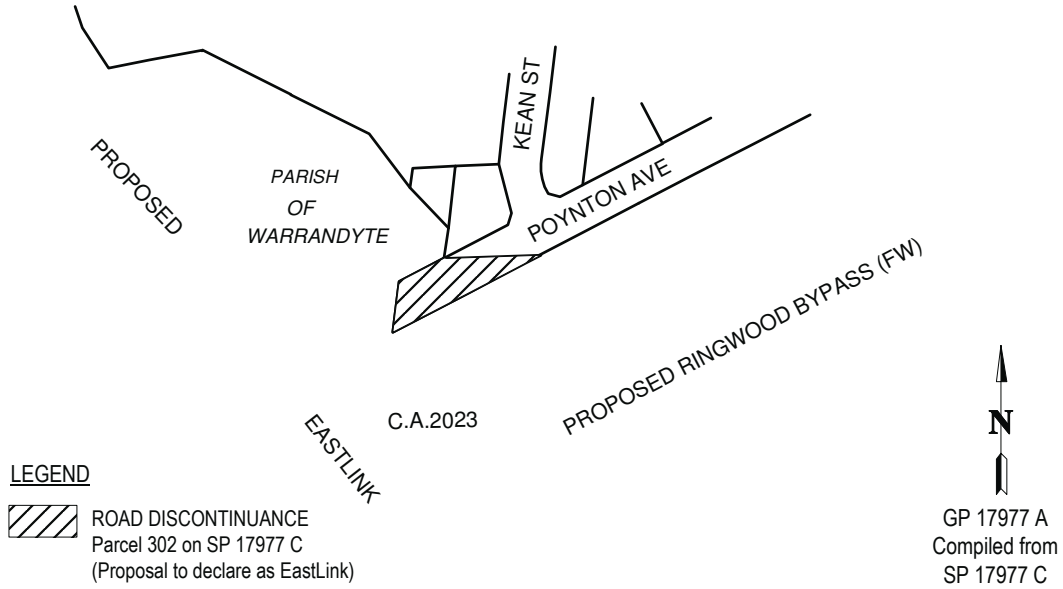

LEGEND

-  ROAD DISCONTINUANCE
Parcel 302 on SP 17977 C
(Proposal to declare as EastLink)

SOUTHERN & EASTERN INTEGRATED TRANSPORT AUTHORITY
MUNICIPAL ROAD
PUMPS ROAD
CITY OF KNOX

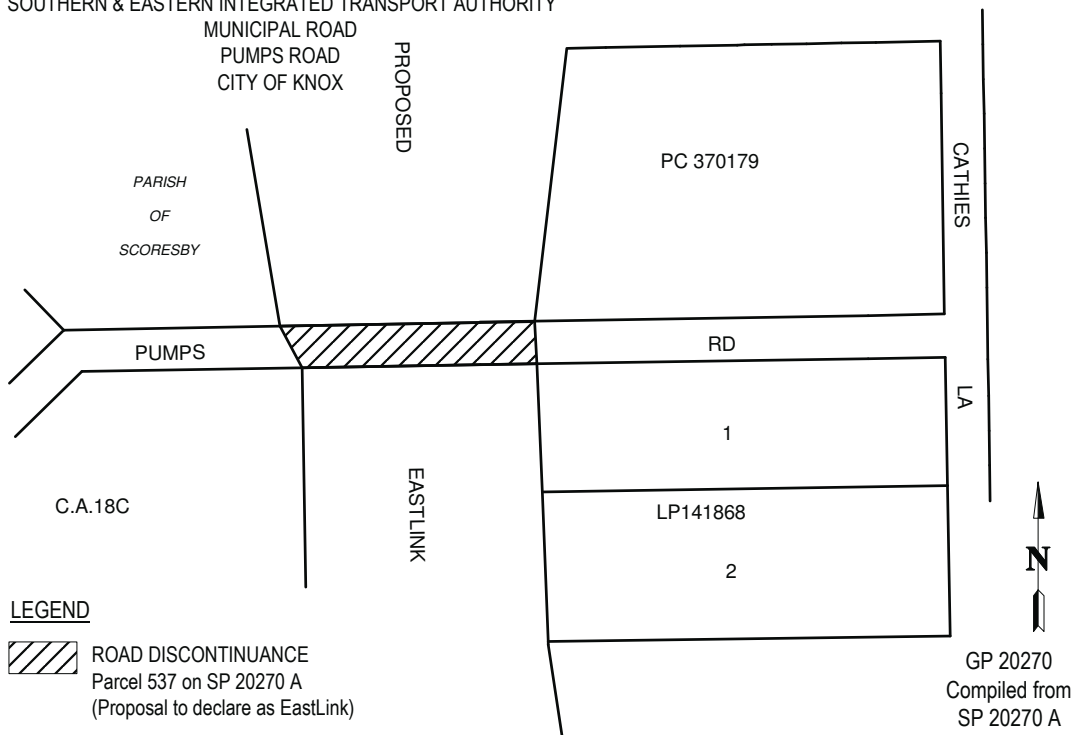

LEGEND

-  ROAD DISCONTINUANCE
Parcel 537 on SP 20270 A
(Proposal to declare as EastLink)

SOUTHERN & EASTERN INTEGRATED TRANSPORT AUTHORITY

MUNICIPAL ROAD
STOCK COURT
CITY OF MANNINGHAM

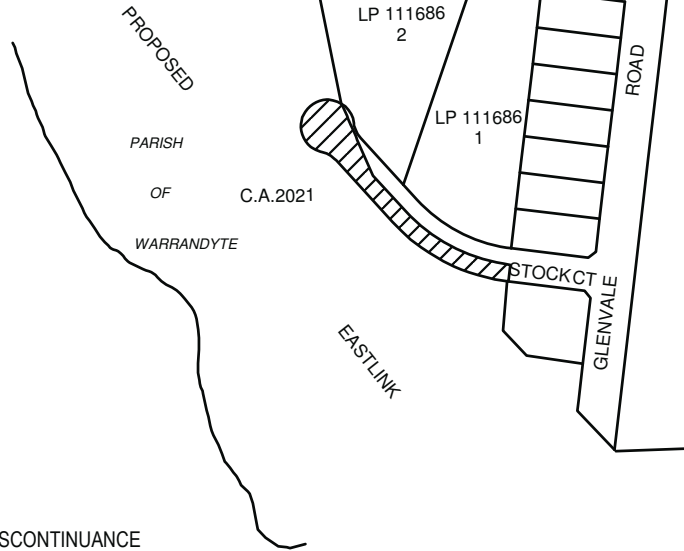

LEGEND

 ROAD DISCONTINUANCE
Parcel 58 on SP 17939 D
(Proposal to declare as EastLink)



GP 17939 E
Compiled from
SP 17939 D

SOUTHERN & EASTERN INTEGRATED TRANSPORT AUTHORITY

MUNICIPAL ROAD
WORSLEY ROAD
CITY OF FRANKSTON

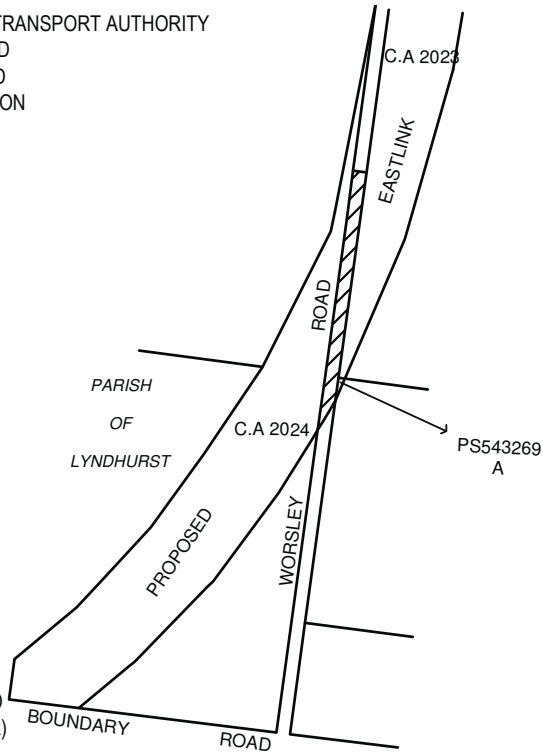

LEGEND

 ROAD DISCONTINUANCE
Part Parcel 1601 on SP 20255 D
(Proposal to declare as EastLink)



GP 20255 C
Compiled from
SP 20255 D

SOUTHERN & EASTERN INTEGRATED TRANSPORT AUTHORITY
 ARTERIAL ROAD
BORONIA ROAD
 CITY OF KNOX

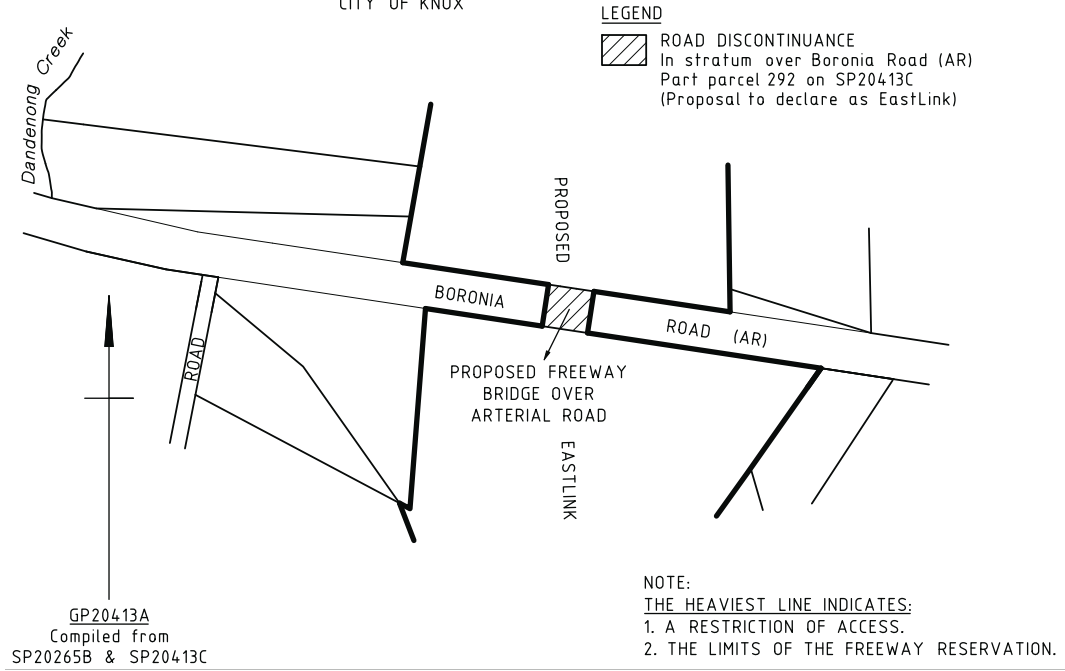

SOUTHERN & EASTERN INTEGRATED TRANSPORT AUTHORITY
 ARTERIAL ROAD
CANTERBURY ROAD
 CITY OF MAROONDAH

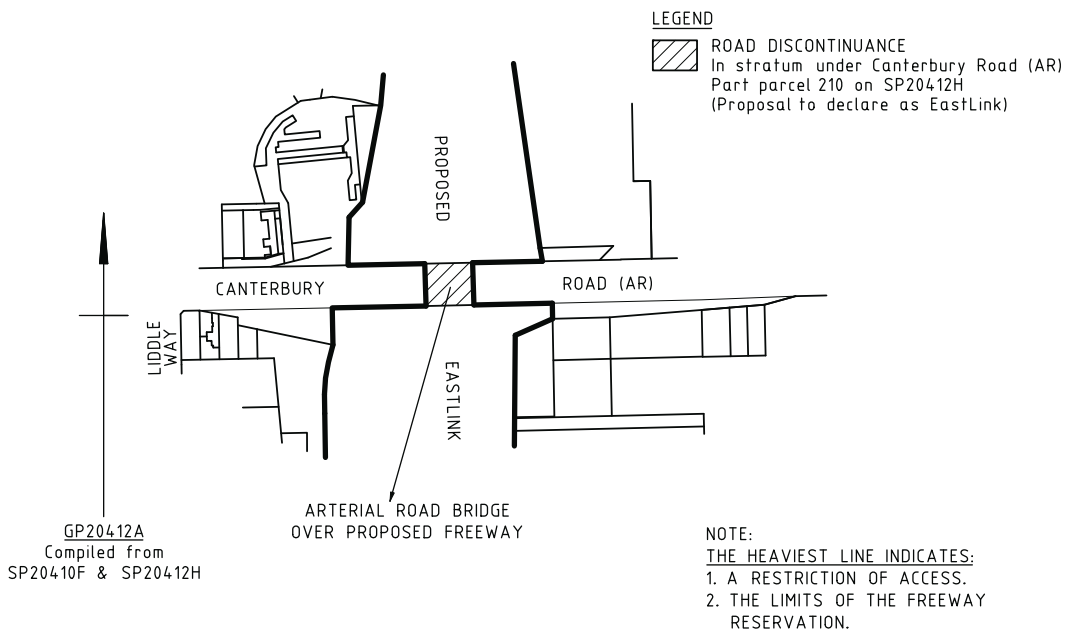

SOUTHERN & EASTERN INTEGRATED TRANSPORT AUTHORITY
 ARTERIAL ROAD
STATE HIGHWAY (LOWER DANDENONG CHELTENHAM ROAD)
 CITY OF GREATER DANDENONG

LEGEND

-  ROAD DISCONTINUANCE
 In stratum over State Highway (Lower Dandenong Cheltenham Road) (AR)
 Part parcel 1262 on SP20363C
 (Proposal to declare as EastLink)

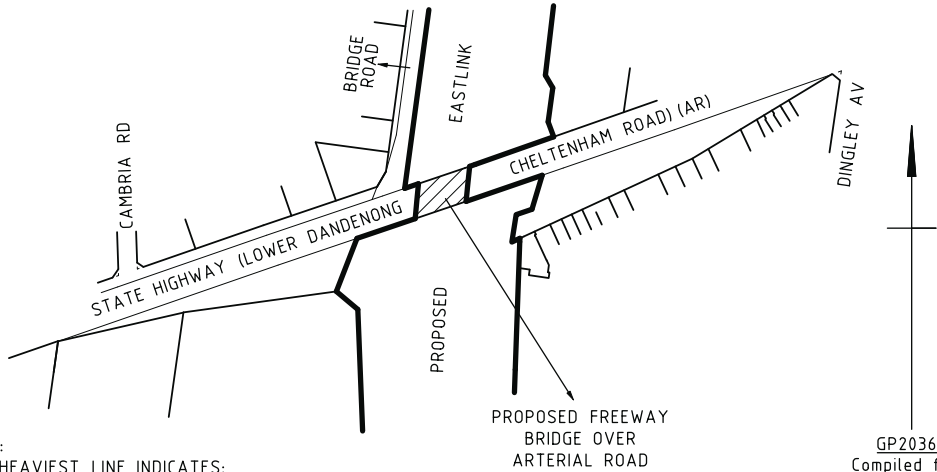

NOTE:
 THE HEAVIEST LINE INDICATES:
 1. A RESTRICTION OF ACCESS.
 2. THE LIMITS OF THE FREEWAY RESERVATION.

GP20363
 Compiled from
 SP20363C & SP20275G

SOUTHERN & EASTERN INTEGRATED TRANSPORT AUTHORITY
 ARTERIAL ROAD
FERNTREE GULLY ROAD
 CITY OF KNOX

LEGEND

-  ROAD DISCONTINUANCE
 In stratum over Ferntree Gully Road (AR)
 Part parcel 706 on SP20352
 (Proposal to declare as EastLink)

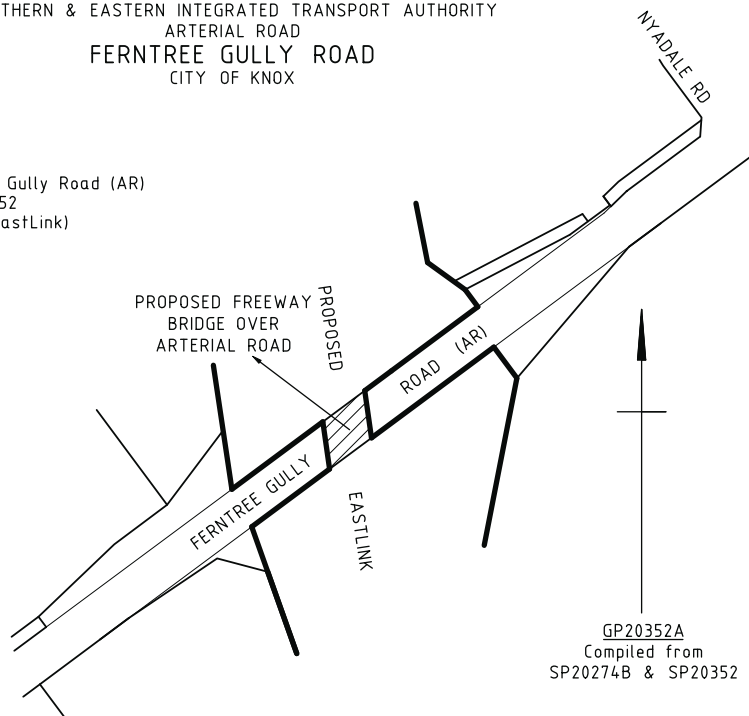

NOTE:
 THE HEAVIEST LINE INDICATES:
 1. A RESTRICTION OF ACCESS.
 2. THE LIMITS OF THE FREEWAY RESERVATION.

GP20352A
 Compiled from
 SP20274B & SP20352

SOUTHERN & EASTERN INTEGRATED TRANSPORT AUTHORITY
MUNICIPAL ROAD
GEORGE STREET
CITY OF KNOX

LEGEND

-  ROAD DISCONTINUANCE
In stratum under George Street (MU)
Part parcels 662 & 663 on SP20273A
(Proposal to declare as EastLink)

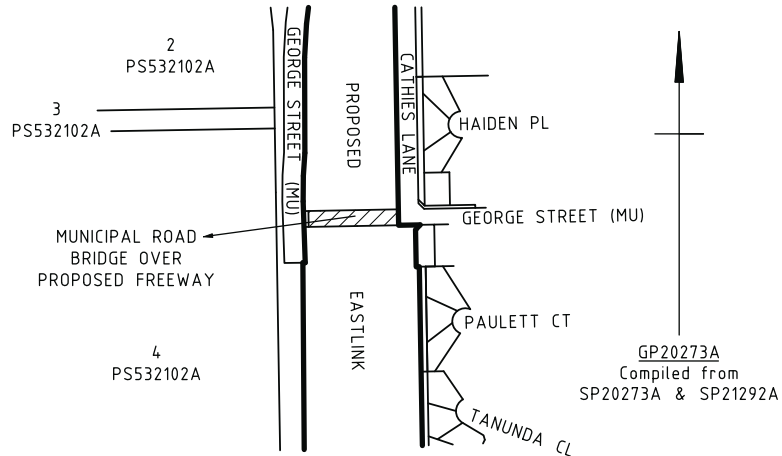

NOTE:
THE HEAVIEST LINE INDICATES:
1. A RESTRICTION OF ACCESS.
2. THE LIMITS OF THE FREEWAY RESERVATION.

SOUTHERN & EASTERN INTEGRATED TRANSPORT AUTHORITY
MUNICIPAL ROAD
GLENVALE ROAD
CITY OF MANNINGHAM AND CITY OF MAROONDAH

LEGEND

-  ROAD DISCONTINUANCE
Parcel 59 on SP17939D
(Proposal to declare as EastLink)

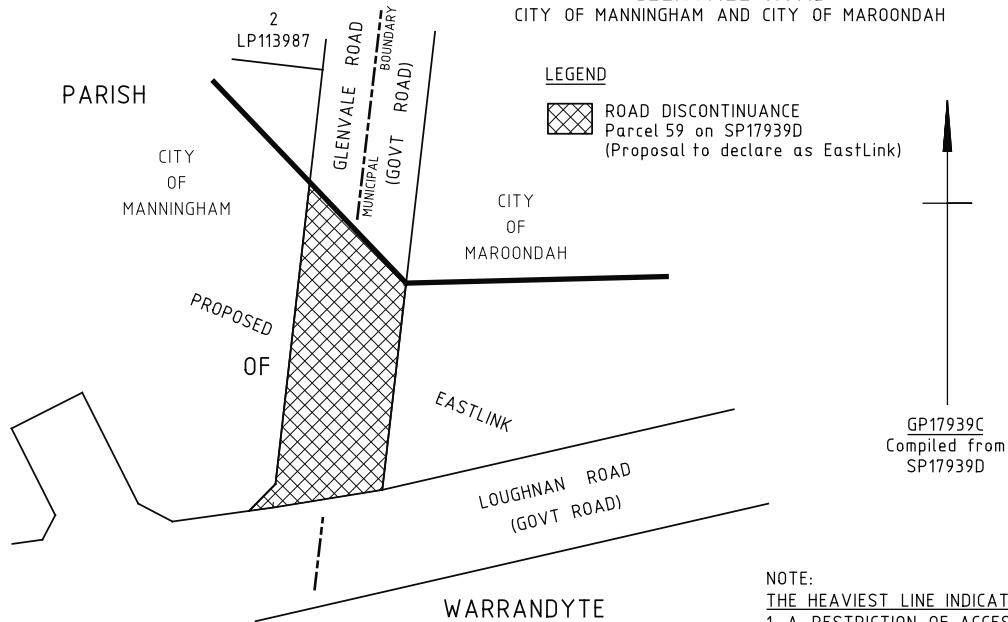

NOTE:
THE HEAVIEST LINE INDICATES:
1. A RESTRICTION OF ACCESS.
2. THE LIMITS OF THE FREEWAY RESERVATION.

SOUTHERN & EASTERN INTEGRATED TRANSPORT AUTHORITY
 ARTERIAL ROAD
BRAESIDE DANDENONG ROAD
 CITY OF GREATER DANDENONG

LEGEND

-  ROAD DISCONTINUANCE
 In stratum under Braeside Dandenong Road (AR)
 Part parcel 1379 on SP20278D
 (Proposal to declare as EastLink)

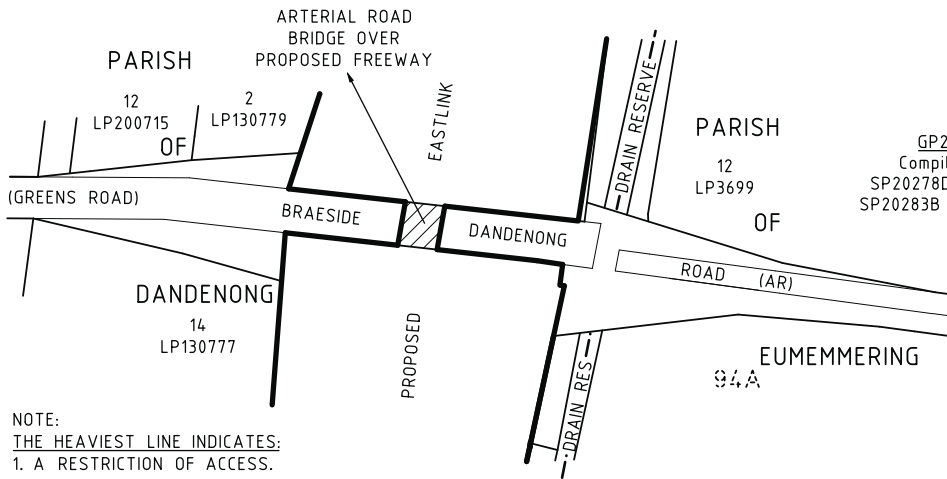

GP20278A
 Compiled from
 SP20278D, SP20279C,
 SP20283B & SP20284C

NOTE:
 THE HEAVIEST LINE INDICATES:
 1. A RESTRICTION OF ACCESS.
 2. THE LIMITS OF THE FREEWAY RESERVATION.

SOUTHERN & EASTERN INTEGRATED TRANSPORT AUTHORITY
 MUNICIPAL ROAD
HALTON ROAD
 CITY OF GREATER DANDENONG

LEGEND

-  ROAD DISCONTINUANCE
 In stratum under Halton Road (MU)
 Part parcel 912 on SP20436A
 (Proposal to declare as EastLink)

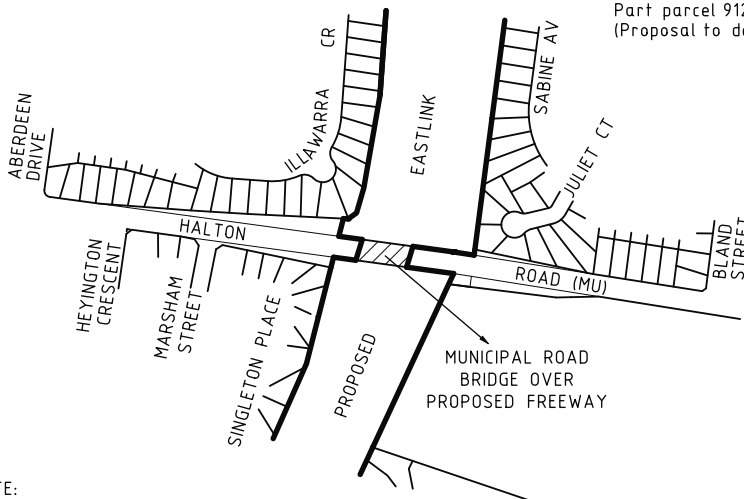

GP20436A
 Compiled from
 SP20436A & SP20417A

NOTE:
 THE HEAVIEST LINE INDICATES:
 1. A RESTRICTION OF ACCESS.
 2. THE LIMITS OF THE FREEWAY RESERVATION.

SOUTHERN & EASTERN INTEGRATED TRANSPORT AUTHORITY
 ARTERIAL ROAD
HEATHERTON ROAD, PRINCES HIGHWAY
 CITY OF GREATER DANDENONG

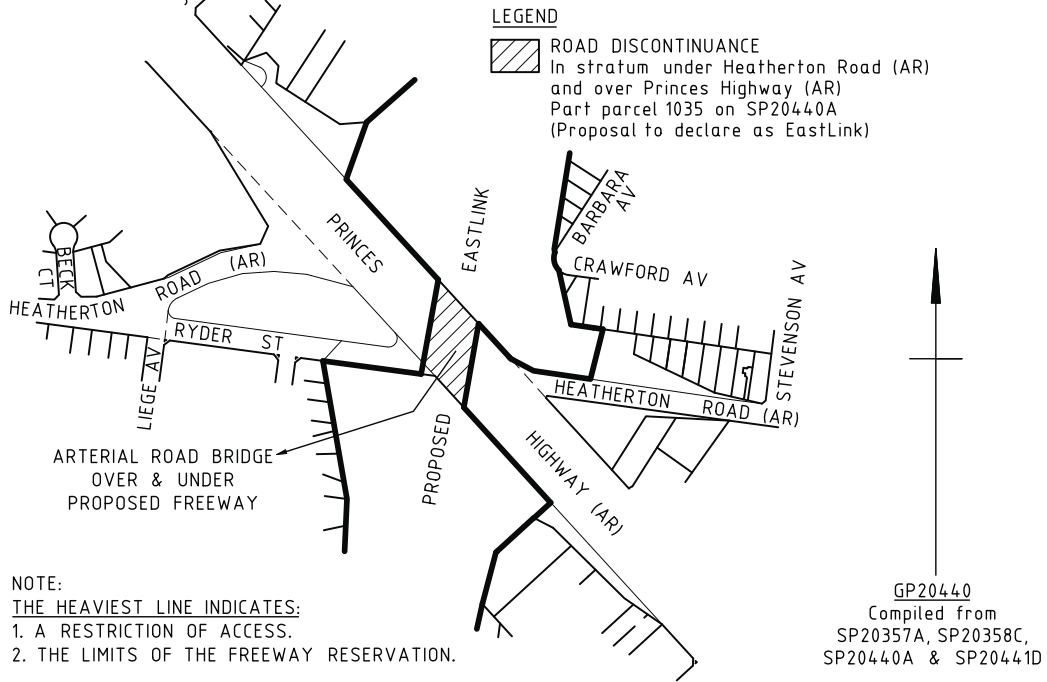

SOUTHERN & EASTERN INTEGRATED TRANSPORT AUTHORITY
 ARTERIAL ROAD
HIGH STREET ROAD
 CITY OF KNOX

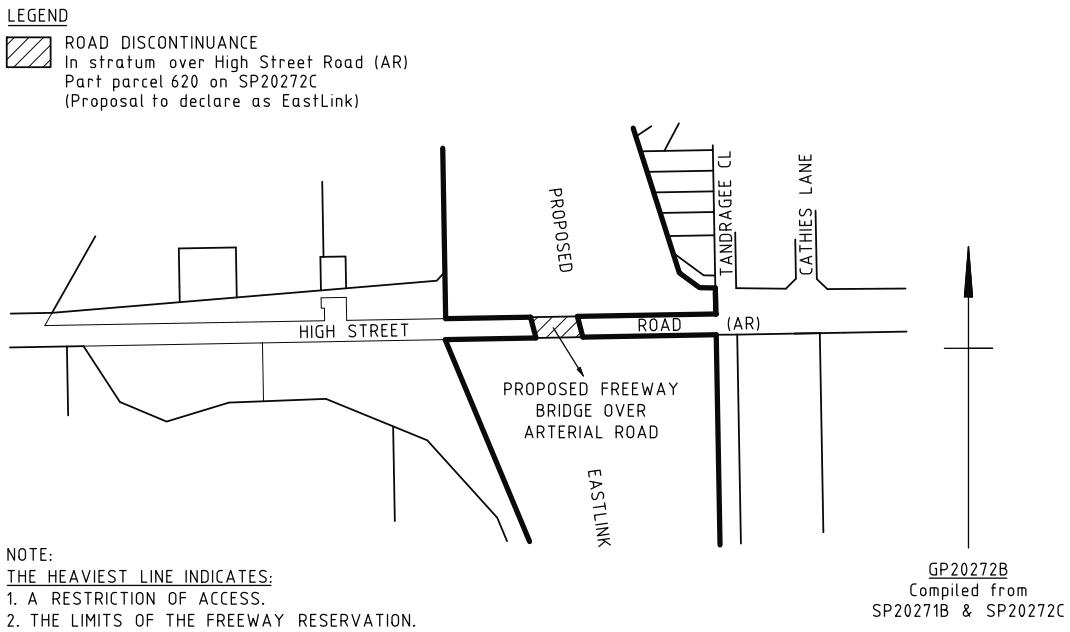

SOUTHERN & EASTERN INTEGRATED TRANSPORT AUTHORITY
 ARTERIAL ROAD
MAROONDAH HIGHWAY
 CITY OF MAROONDAH

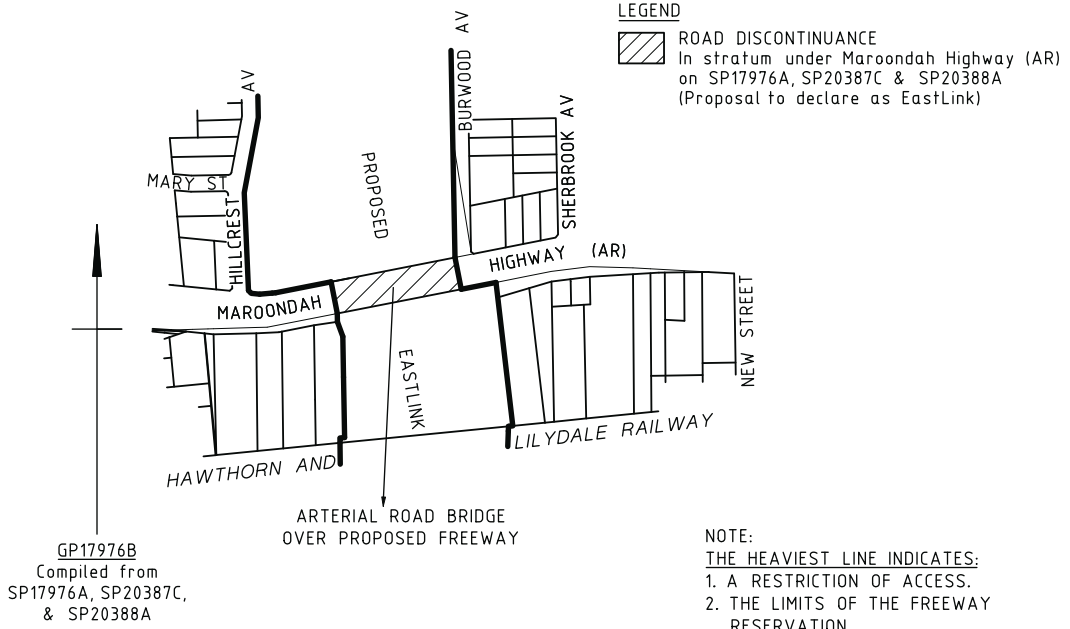

SOUTHERN & EASTERN INTEGRATED TRANSPORT AUTHORITY
 MUNICIPAL ROAD
MOLAN STREET
 CITY OF MAROONDAH

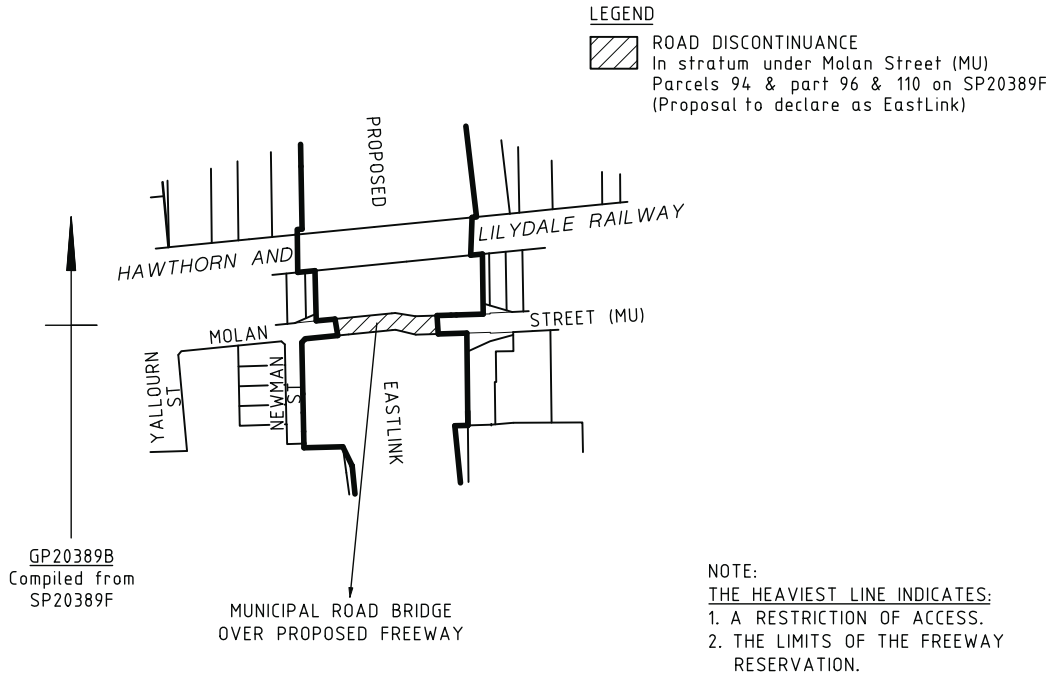

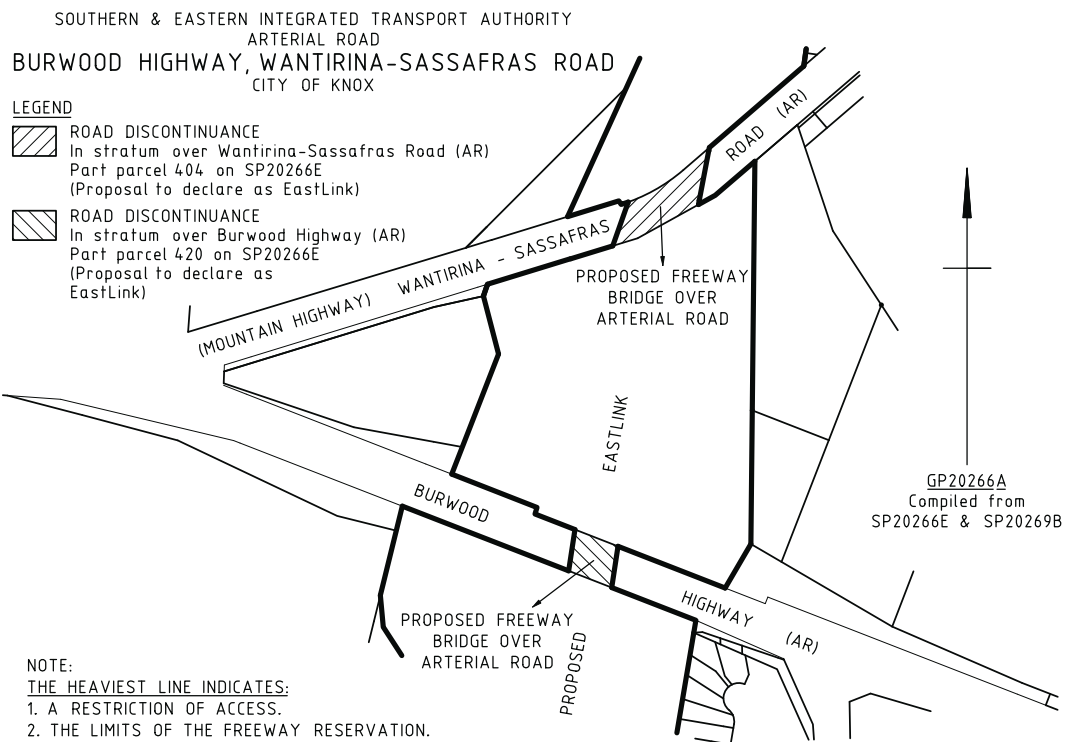
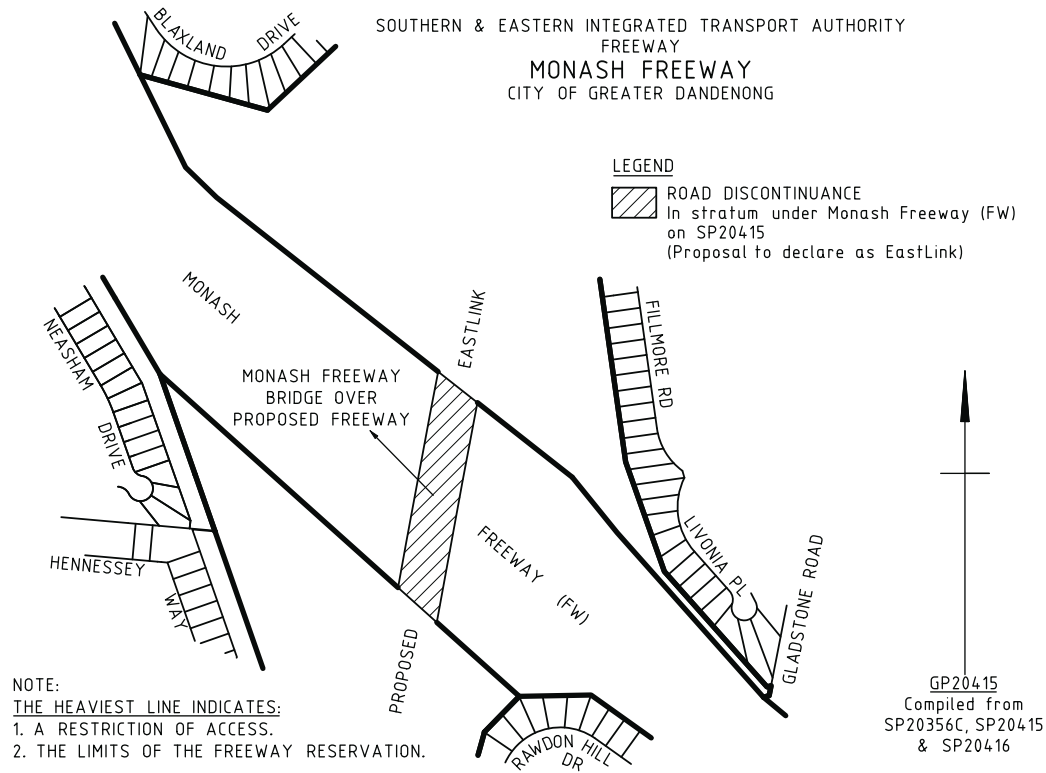

SOUTHERN & EASTERN INTEGRATED TRANSPORT AUTHORITY
 MUNICIPAL ROAD
OAKWOOD AVENUE
 CITY OF GREATER DANDENONG

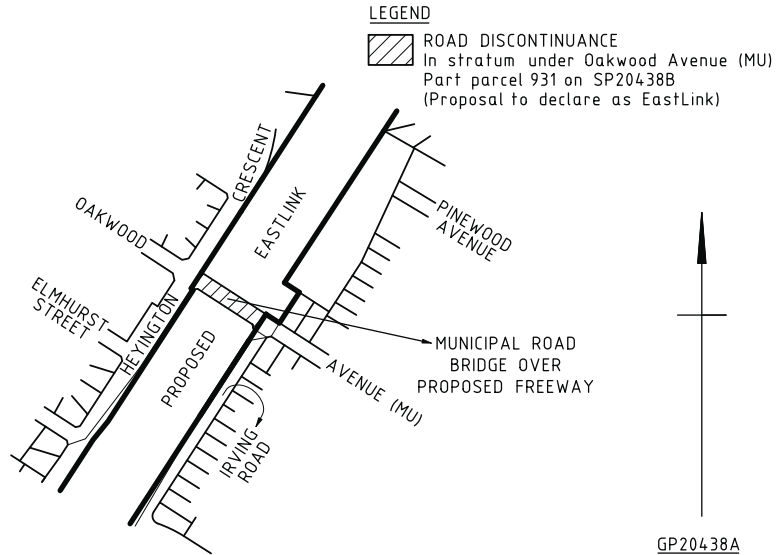

NOTE:
THE HEAVIEST LINE INDICATES:
 1. A RESTRICTION OF ACCESS.
 2. THE LIMITS OF THE FREEWAY RESERVATION.

GP20438A
 Compiled from
 SP20437 & SP20438B

SOUTHERN & EASTERN INTEGRATED TRANSPORT AUTHORITY
 MUNICIPAL ROAD
PARK ROAD
 CITY OF MANNINGHAM

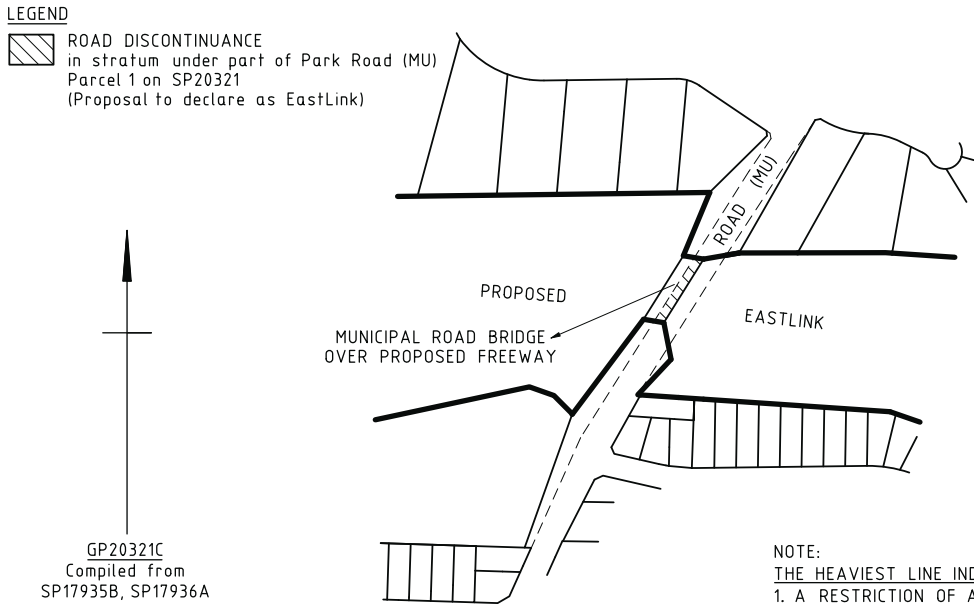

GP20321C
 Compiled from
 SP17935B, SP17936A
 & SP20321

NOTE:
THE HEAVIEST LINE INDICATES:
 1. A RESTRICTION OF ACCESS.
 2. THE LIMITS OF THE FREEWAY RESERVATION.

SOUTHERN & EASTERN INTEGRATED TRANSPORT AUTHORITY
MUNICIPAL ROAD
PARK ROAD
CITY OF MANNINGHAM

LEGEND

-  ROAD DISCONTINUANCE
Parcel 7 on SP20321
(Proposal to declare as EastLink)

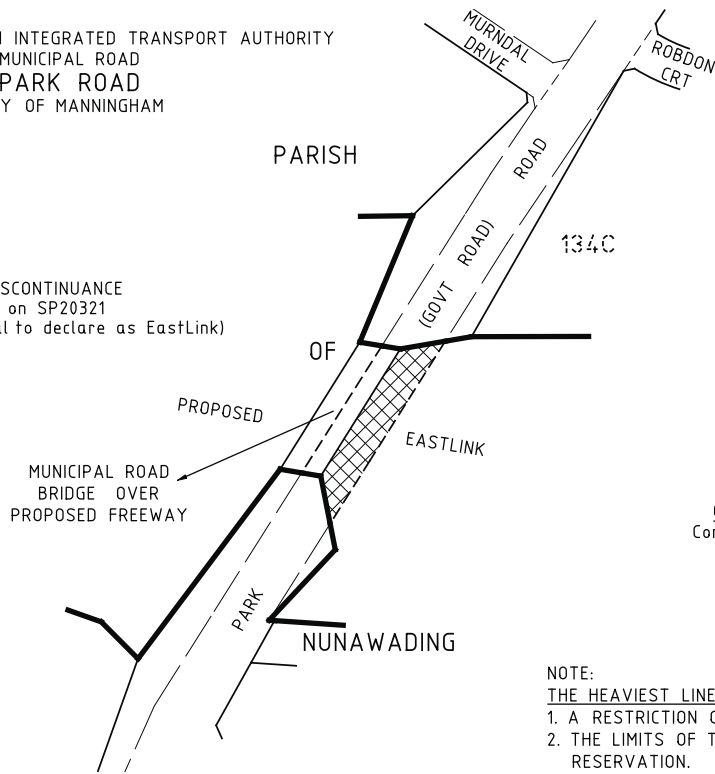

GP20321B
Compiled from
SP20321

NOTE:
THE HEAVIEST LINE INDICATES:
1. A RESTRICTION OF ACCESS.
2. THE LIMITS OF THE FREEWAY
RESERVATION.

SOUTHERN & EASTERN INTEGRATED TRANSPORT AUTHORITY
MUNICIPAL ROAD
POLICE ROAD
CITY OF GREATER DANDENONG, CITY OF MONASH

LEGEND

-  ROAD DISCONTINUANCE
In stratum under Police Road (MU)
Part parcel 784 on SP20355C
(Proposal to declare as EastLink)

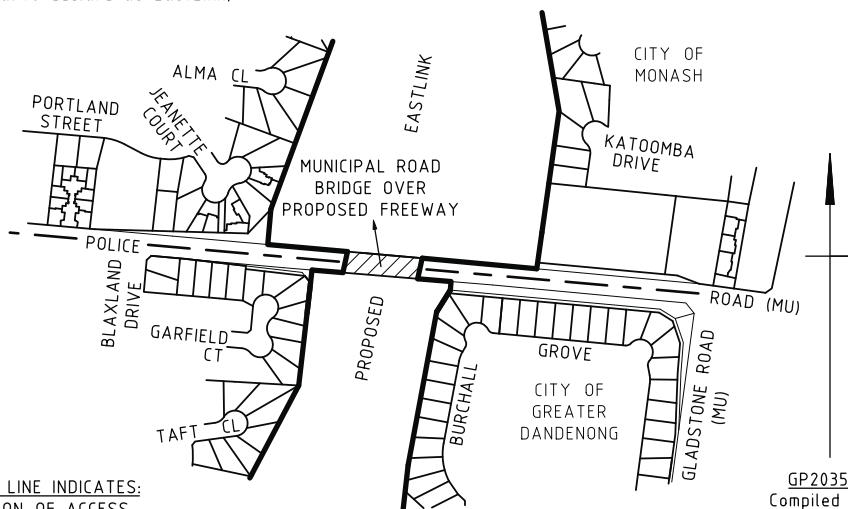

NOTE:
THE HEAVIEST LINE INDICATES:
1. A RESTRICTION OF ACCESS.
2. THE LIMITS OF THE FREEWAY RESERVATION.

GP20355A
Compiled from
SP203555C & SP20356C

SOUTHERN & EASTERN INTEGRATED TRANSPORT AUTHORITY
MUNICIPAL ROAD
RAILWAY PARADE
CITY OF GREATER DANDENONG

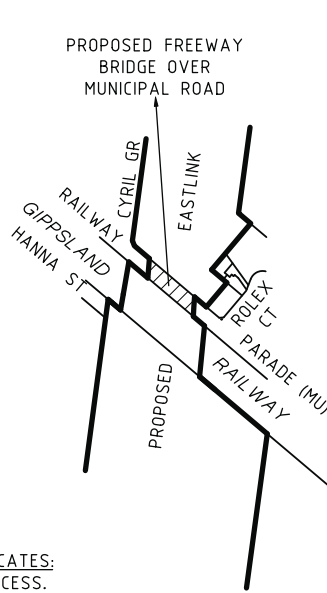

LEGEND

 ROAD DISCONTINUANCE
In stratum over Railway Parade (MU)
Part parcel 1173 on SP20360A
(Proposal to declare as EastLink)

NOTE:
THE HEAVIEST LINE INDICATES:
1. A RESTRICTION OF ACCESS.
2. THE LIMITS OF THE FREEWAY RESERVATION.

GP20360
Compiled from
SP20360A

SOUTHERN & EASTERN INTEGRATED TRANSPORT AUTHORITY
ARTERIAL ROAD
THOMPSON ROAD
CITY OF GREATER DANDENONG

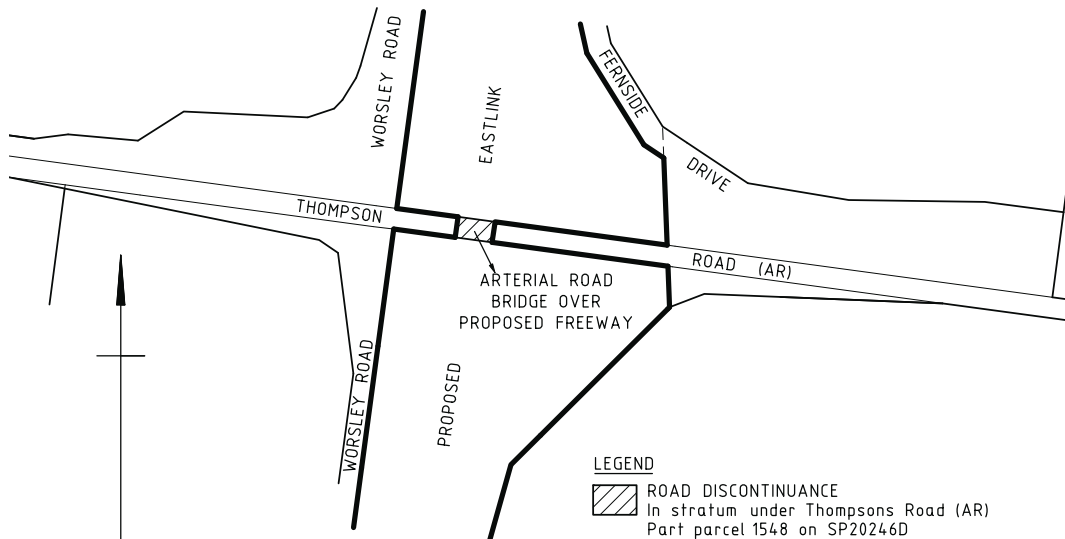

LEGEND

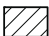
 ROAD DISCONTINUANCE
In stratum under Thompsons Road (AR)
Part parcel 1548 on SP20246D
(Proposal to declare as EastLink)

GP20246D
Compiled from
SP20246D & SP20255D

NOTE:
THE HEAVIEST LINE INDICATES:
1. A RESTRICTION OF ACCESS.
2. THE LIMITS OF THE FREEWAY RESERVATION.

SOUTHERN & EASTERN INTEGRATED TRANSPORT AUTHORITY
ARTERIAL ROAD
WELLINGTON ROAD
CITY OF KNOX

LEGEND

-  ROAD DISCONTINUANCE
In stratum under Wellington Road (AR)
Part parcel 746 on SP20354A
(Proposal to declare as EastLink)

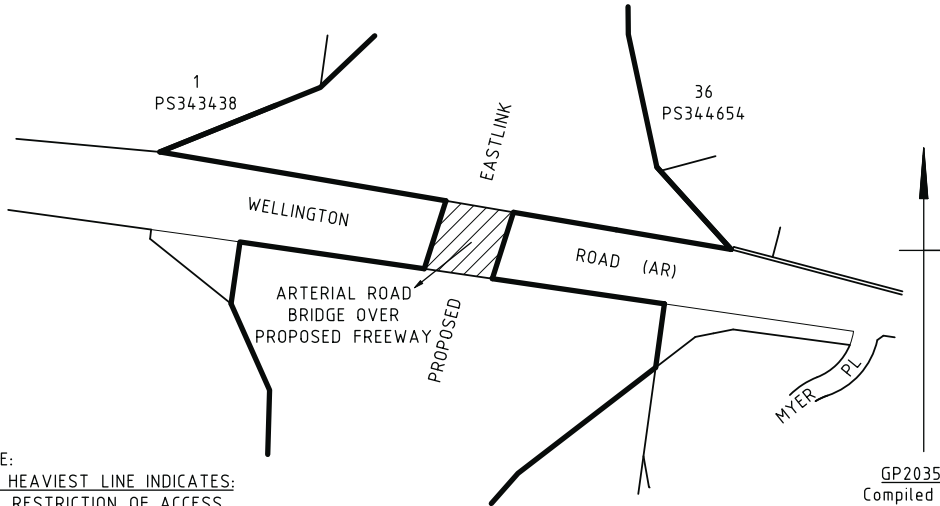

NOTE:
THE HEAVIEST LINE INDICATES:
1. A RESTRICTION OF ACCESS.
2. THE LIMITS OF THE FREEWAY RESERVATION.

GP20354A
Compiled from
SP20353 & SP20354A

Dated 30 April 2008

KEN MATHERS
Chief Executive Officer
Southern and Eastern
Integrated Transport Authority

This page was left blank intentionally

craftsmanpress

The *Victoria Government Gazette* is published by The Craftsman Press Pty Ltd with the authority of the Government Printer for the State of Victoria

© State of Victoria 2008

This publication is copyright. No part may be reproduced by any process except in accordance with the provisions of the Copyright Act.

Address all enquiries to the Government Printer for the State of Victoria
Level 2 1 Macarthur Street
Melbourne 3002
Victoria Australia

How To Order**Mail Order****Victoria Government Gazette**

Level 1 520 Bourke Street
Melbourne 3000
PO Box 1957 Melbourne 3001
DX 106 Melbourne

**Telephone**

(03) 9642 5808

**Fax**

(03) 9600 0478

email

gazette@craftpress.com.au

**Retail & Mail Sales****Victoria Government Gazette**

Level 1 520 Bourke Street
Melbourne 3000
PO Box 1957 Melbourne 3001

**Telephone**

(03) 9642 5808

**Fax**

(03) 9600 0478

**Retail Sales****Information Victoria**

505 Little Collins Street
Melbourne 3000

**Telephone**

1300 366 356

**Fax**

(03) 9603 9920

Price Code B