



Victoria Government Gazette

No. S 348 Thursday 8 October 2009
By Authority of Victorian Government Printer

Road Management Act 2004

ROAD DECLARATIONS

VicRoads, pursuant to sections 11 and 14 of the **Road Management Act 2004**, upon publication of this notice declares the roads described in the Schedule and on the plans attached.

SCHEDULE

ARTERIAL ROAD

- a) That part of Mount Baw Baw Road identified by a heavy solid line or hatching on the plans numbered GP252AR and GP253AR are declared as described in the legend in the said plans and the road reserve boundaries of the parts of the road identified by a heavy solid line are determined in accordance with the Notes, unless otherwise shown on the plans.
- b) That part of Lake Mountain Road identified by a heavy solid line on the plan numbered GP254AR is declared as described in the legend in the said plan and the road reserve boundaries are in accordance with the Notes, unless otherwise shown on the plan.
- c) That part of Mount Stirling Road identified by a heavy solid line on the plans numbered GP255AR and GP256AR are declared as described in the legend in the said plans and the road reserve boundaries are in accordance with the Notes, unless otherwise shown on the plans.
- d) That part of Mount Buller Road identified by a heavy solid line or hatching on the plans numbered GP257AR, GP258AR and GP259AR are declared as described in the legend in the said plans and the road reserve boundaries of the parts of the road identified by a heavy solid line are determined in accordance with the Notes unless, otherwise shown on the plans.
- e) That part of Bogong High Plains Road identified by hatching on the plan numbered GP260AR is declared as described in the said plan.

NOTES

Unless otherwise shown on the plans attached, the road reserve boundaries for the parts of the roads shown by a heavy solid line are:

- (i) where the road adjoins unalienated Crown land that is not subject to lease or license, 15 metres perpendicularly from the road centreline as determined by the principal through traffic lanes, except where the boundary of the road determined by clause 3(1)(a) of Schedule 5 to the **Road Management Act 2004** is greater than 15 metres from the road centreline, in which case the road reserve boundary shall be in accordance with that clause or to the boundary or part of the boundary of the alpine resort, whichever is closest to the road centreline; or
- (ii) where the road adjoins freehold land, a boundary of the alpine resort or Crown land held under a lease or license and the boundaries of those lands are less than 15 metres from the road centreline, the boundaries or parts of the boundaries of the adjoining freehold land, the alpine resort or Crown land held under a lease or license; or
- (iii) where the road adjoins freehold land, a boundary of the alpine resort or Crown land held under a lease or license and the boundaries of those lands are greater than 15 metres from the road centreline, the boundaries determined by clause 3(1)(a) of Schedule 5 to the **Road Management Act 2004** or the freehold land, a boundary of the alpine resort or Crown land held under a lease or license, whichever is the closest to the road centreline.

SPECIAL

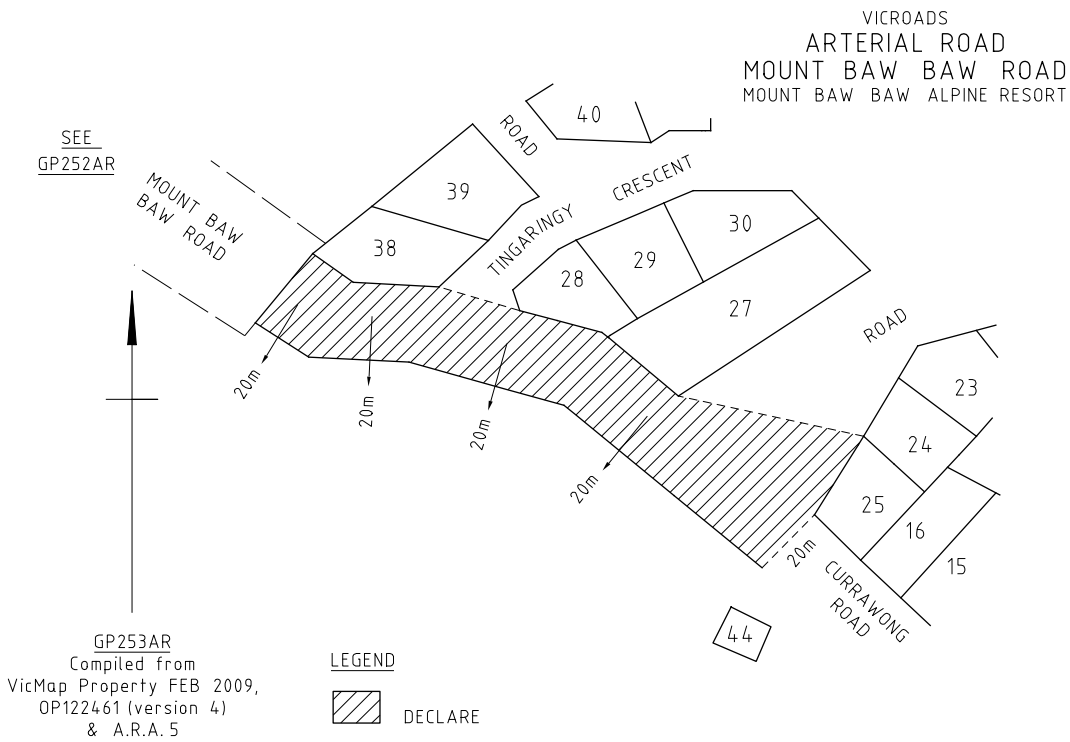
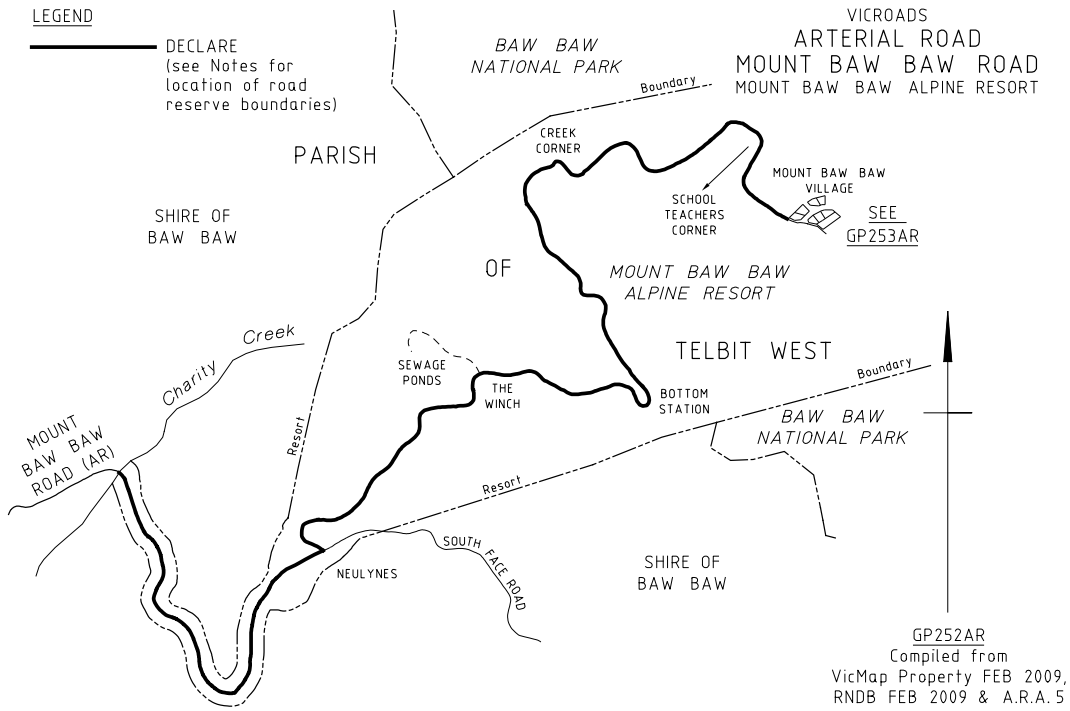

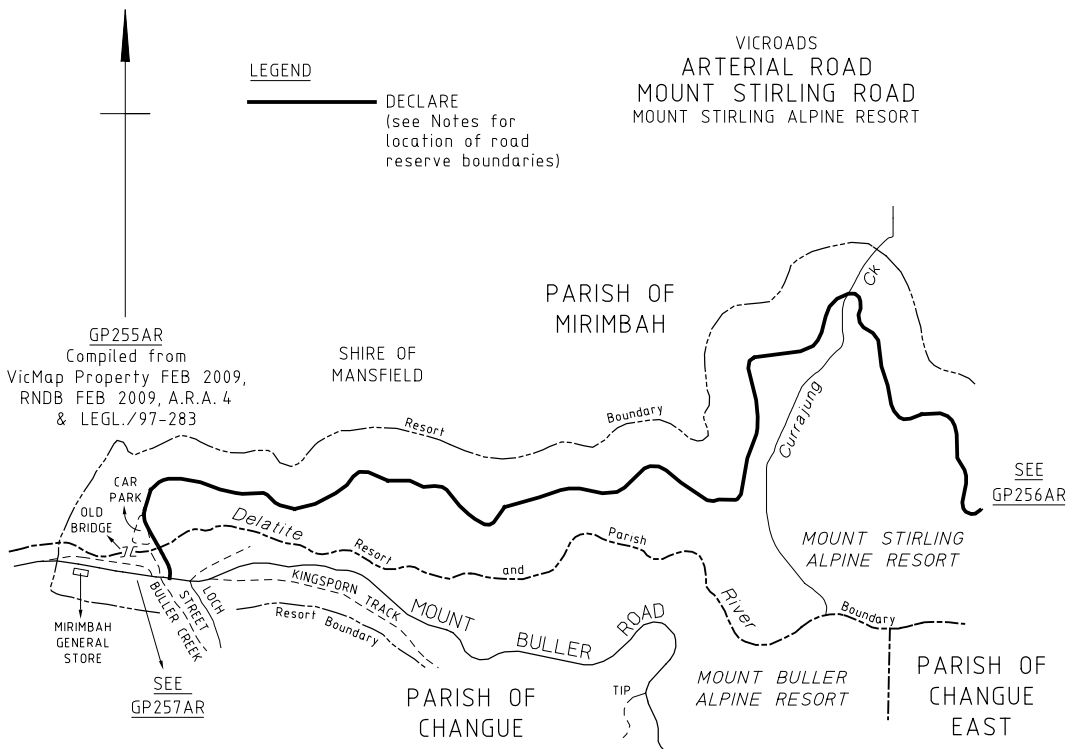
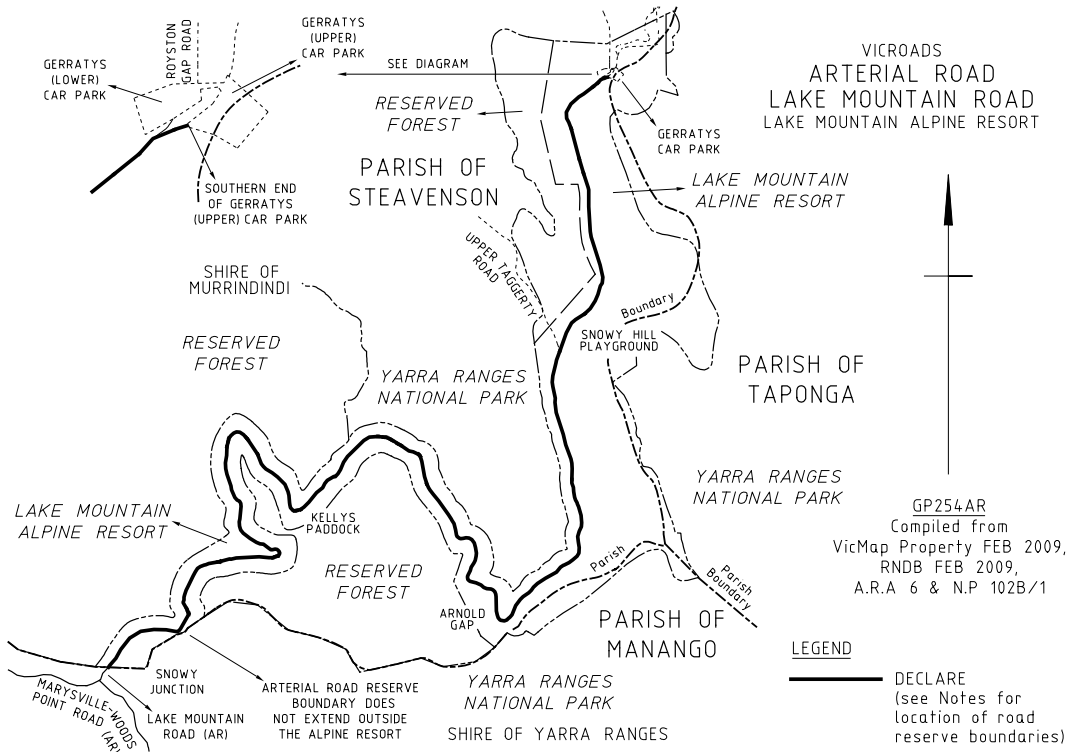

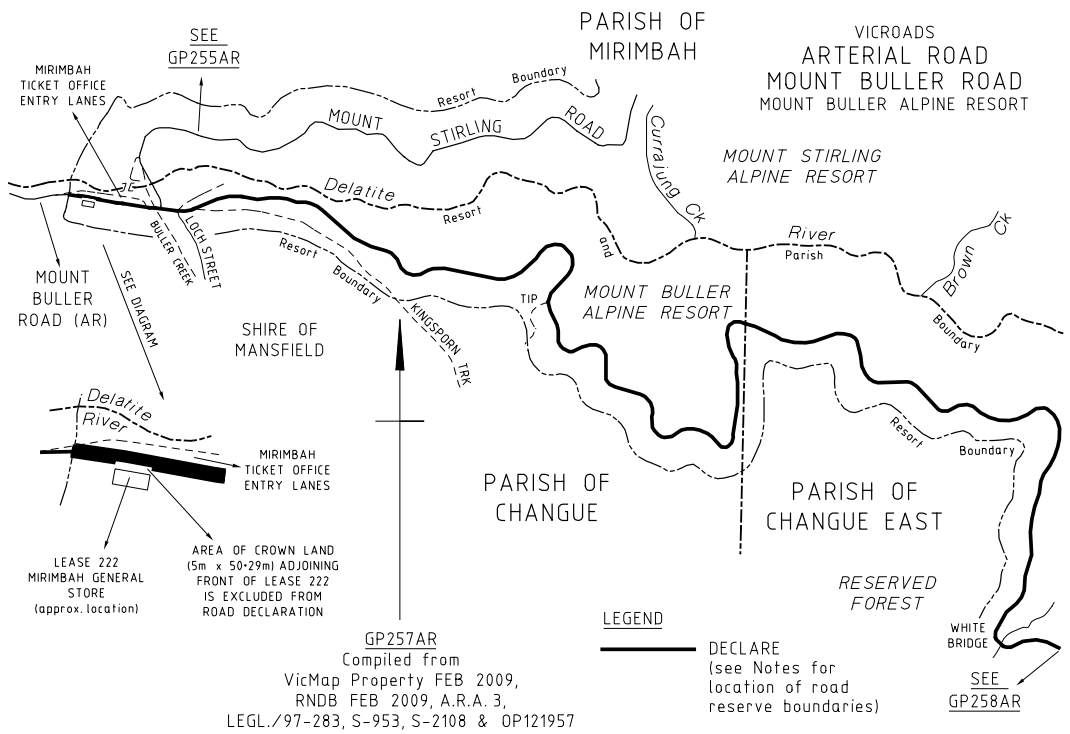
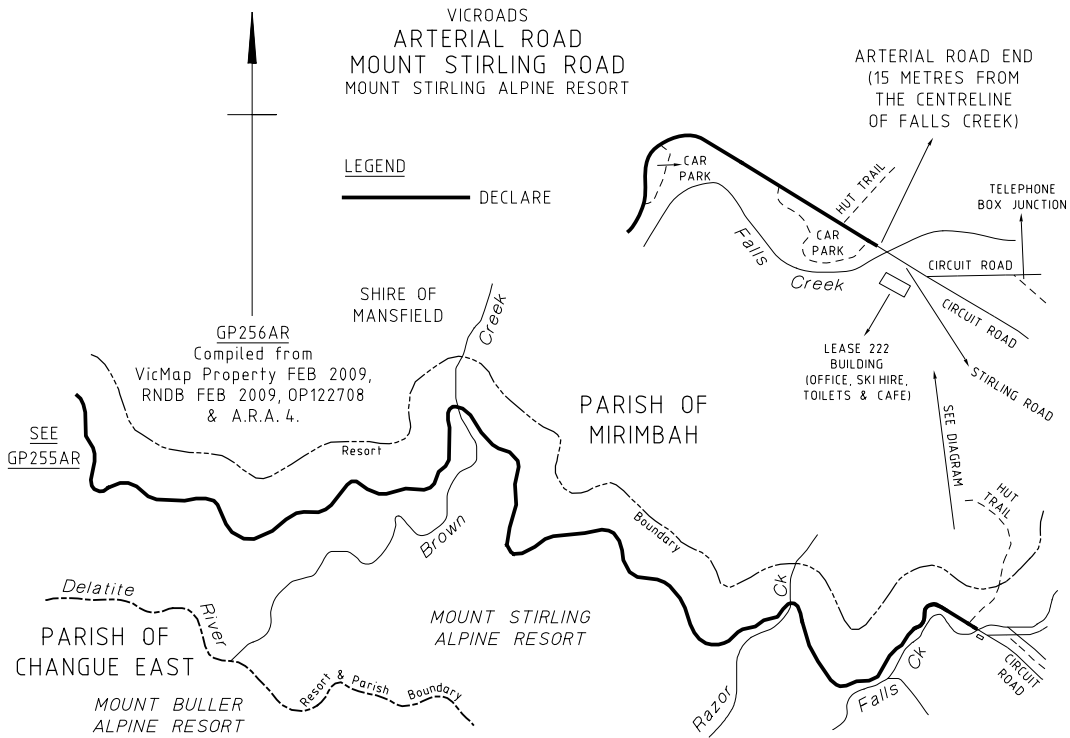

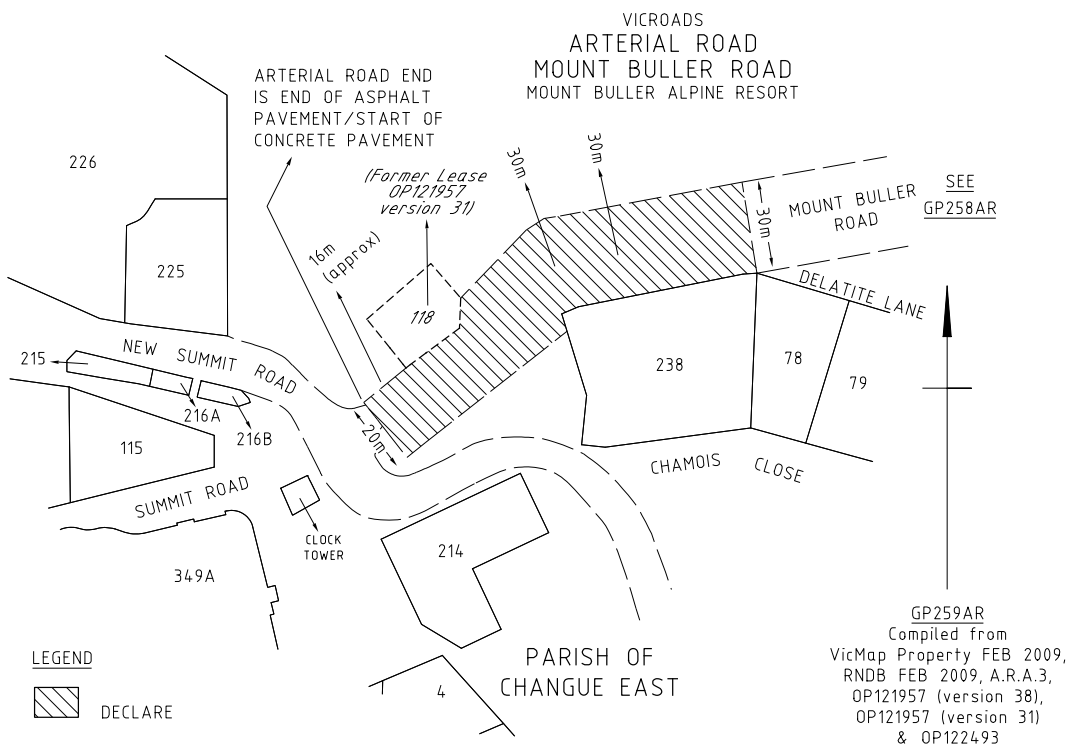
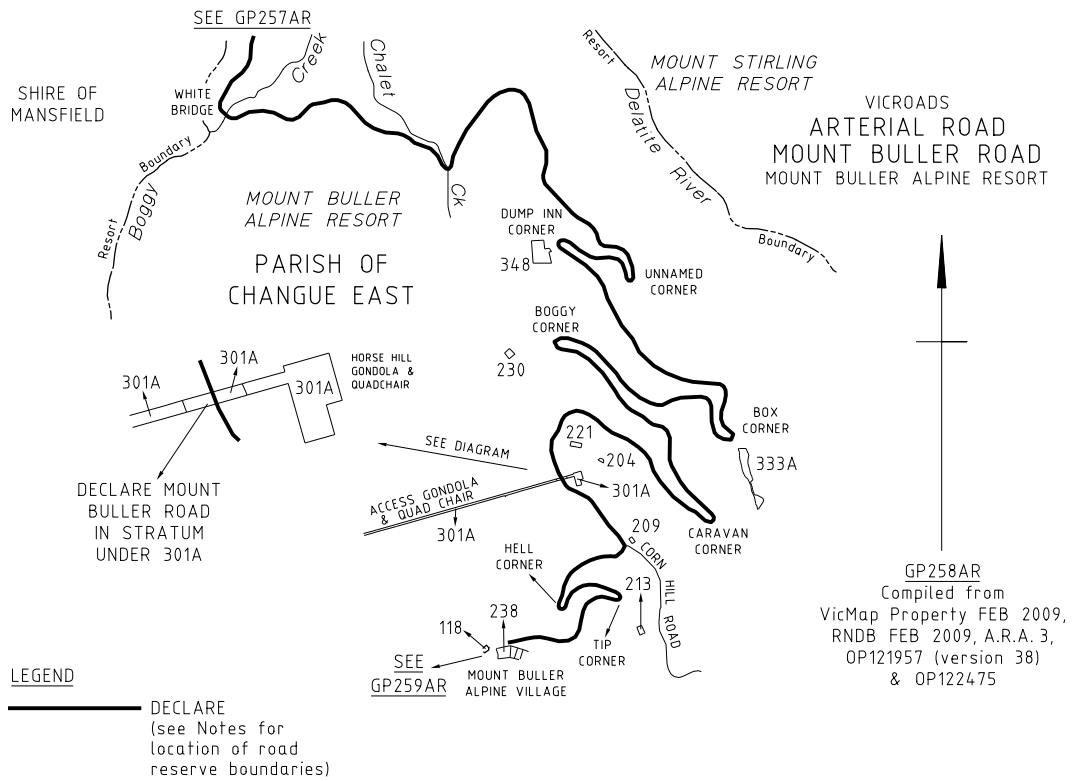

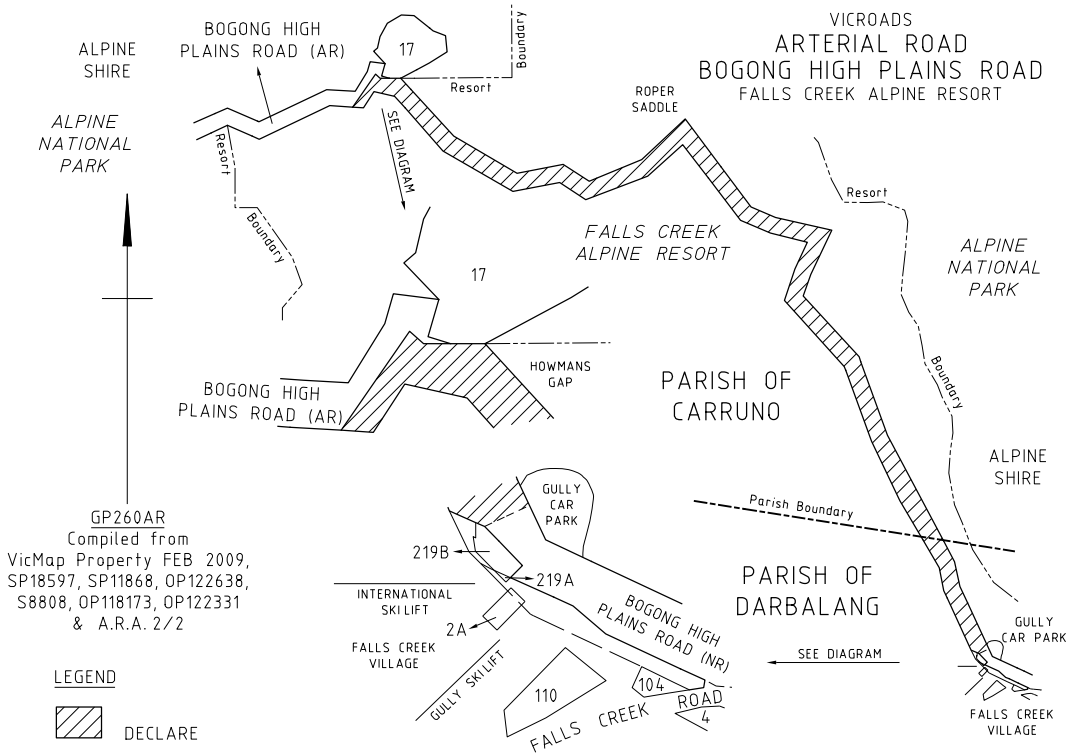

Dated 6 October 2009

GARY LIDDLE
Chief Executive
VicRoads

This page was left blank intentionally

craftsmanpress

The *Victoria Government Gazette* is published by The Craftsman Press Pty Ltd with the authority of the Government Printer for the State of Victoria

© State of Victoria 2009

This publication is copyright. No part may be reproduced by any process except in accordance with the provisions of the Copyright Act.

Address all enquiries to the Government Printer for the State of Victoria
Level 2 1 Macarthur Street
Melbourne 3002
Victoria Australia

How To Order

	Mail Order	Victoria Government Gazette Level 5 460 Bourke Street Melbourne 3000 PO Box 1957 Melbourne 3001 DX 106 Melbourne
	Telephone	(03) 8523 4601
	Fax	(03) 9600 0478
	email	gazette@bsp.gov.au
	Retail & Mail Sales	Victoria Government Gazette Level 5 460 Bourke Street Melbourne 3000 PO Box 1957 Melbourne 3001
	Telephone	(03) 8523 4601
	Fax	(03) 9600 0478
	Retail Sales	Information Victoria 505 Little Collins Street Melbourne 3000
	Telephone	1300 366 356
	Fax	(03) 9603 9920

Price Code A