



Victoria Government Gazette

No. S 103 Friday 17 April 2009
By Authority of Victorian Government Printer



Victorian Commission
for Gambling Regulation

ERRATUM

Notice of Specified Areas in Gaming Venues

Notice is hereby given that the reference to Skyways Hotel published on pages 5 and 6, S101 of the Victoria Government Gazette, dated 17 April 2009 is incorrect. The Notices below replace all Notices set out in Government Gazette S101 published on 17 April 2009.

PETER COHEN
Executive Commissioner

Gambling Regulation Act 2003

Sections 3.2.3(1)(g) and 3.2.3(1)(h)

Sections 3.5.29(3) and 3.5.30(2)

VICTORIAN COMMISSION FOR GAMBLING REGULATION

Notice of Specified Areas in Gaming Venue: Bayswater Hotel

By this notice, the Victorian Commission for Gambling Regulation –

Subject to the following conditions, specifies the area shown in the attached Schedule for the purposes of sections 3.2.3(1)(g), 3.2.3(1)(h), 3.5.29(3) and 3.5.30(2) of the **Gambling Regulation Act 2003**.

Conditions:

The conditions of this notice are that:

- (i) The specified area must be within an approved venue under the Act;
- (ii) The proportion of gaming machines in all specified areas of the approved venue must not exceed 20 percent of the total number of gaming machines in the approved venue;
- (iii) a gaming machine located in an area specified by a notice under sections 3.5.29(3) and 3.5.30(2) of the **Gambling Regulation Act 2003** may only operate in a mode where spin rate, bet limit, autoplay and note acceptors are unrestricted if that gaming machine may only be played in that mode by means of a card, Personal Identification Number (PIN) or similar technology which requires the player to nominate limits on time or net loss before play can commence.

Dated 8 April 2009

PETER COHEN
Executive Commissioner

SPECIAL

SCHEDULE

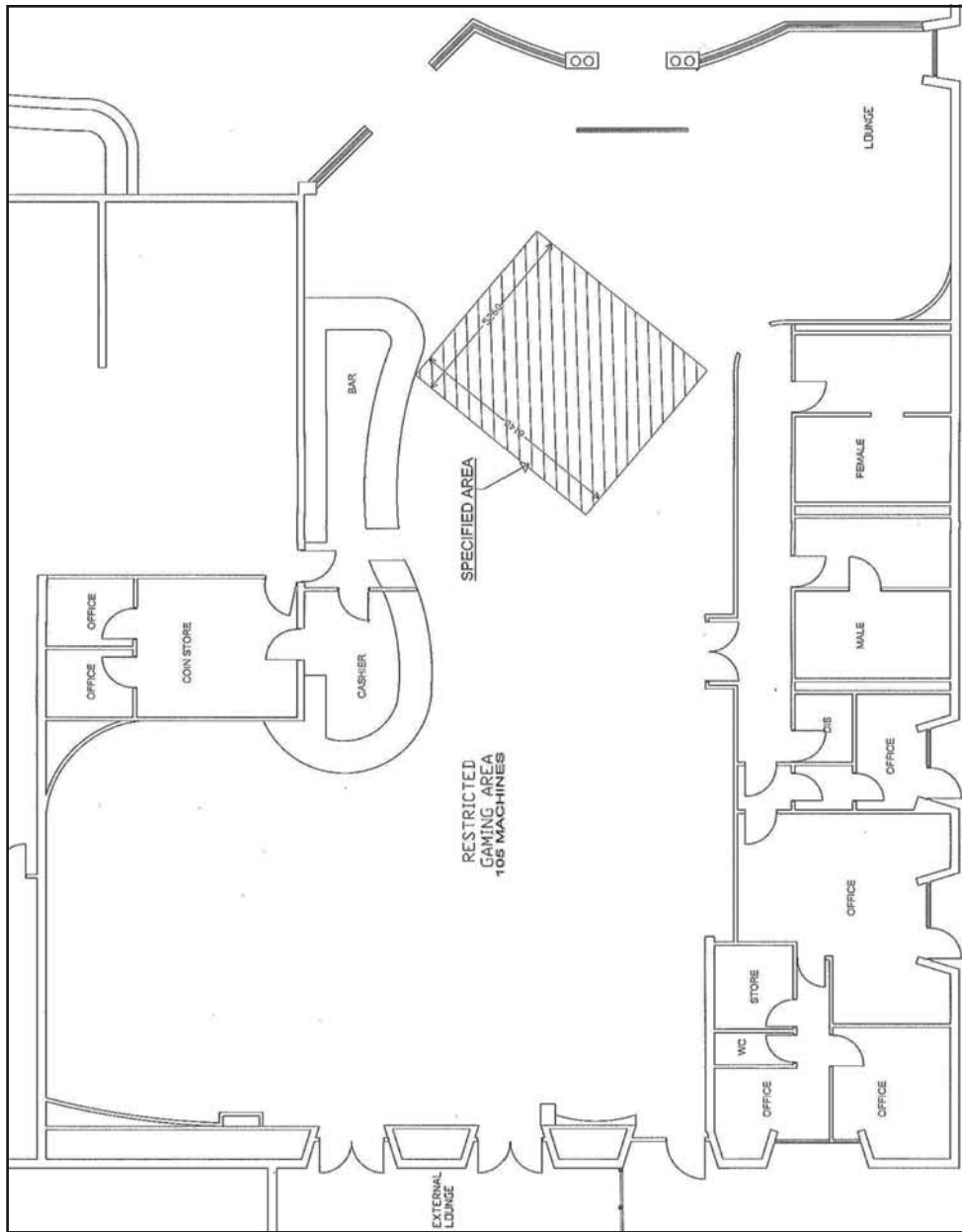

Gambling Regulation Act 2003

Sections 3.2.3(1)(g) and 3.2.3(1)(h)

Sections 3.5.29(3) and 3.5.30(2)

VICTORIAN COMMISSION FOR GAMBLING REGULATION

Notice of Specified Areas in Gaming Venue: Box Hill RSL

By this notice, the Victorian Commission for Gambling Regulation –

Subject to the following conditions, specifies the area shown in the attached Schedule for the purposes of sections 3.2.3(1)(g), 3.2.3(1)(h), 3.5.29(3) and 3.5.30(2) of the **Gambling Regulation Act 2003**.

Conditions:

The conditions of this notice are that:

- (i) The specified area must be within an approved venue under the Act;
- (ii) The proportion of gaming machines in all specified areas of the approved venue must not exceed 20 percent of the total number of gaming machines in the approved venue;
- (iii) a gaming machine located in an area specified by a notice under sections 3.5.29(3) and 3.5.30(2) of the **Gambling Regulation Act 2003** may only operate in a mode where spin rate, bet limit, autoplay and note acceptors are unrestricted if that gaming machine may only be played in that mode by means of a card, Personal Identification Number (PIN) or similar technology which requires the player to nominate limits on time or net loss before play can commence.

Dated 8 April 2009

PETER COHEN
Executive Commissioner

SCHEDULE

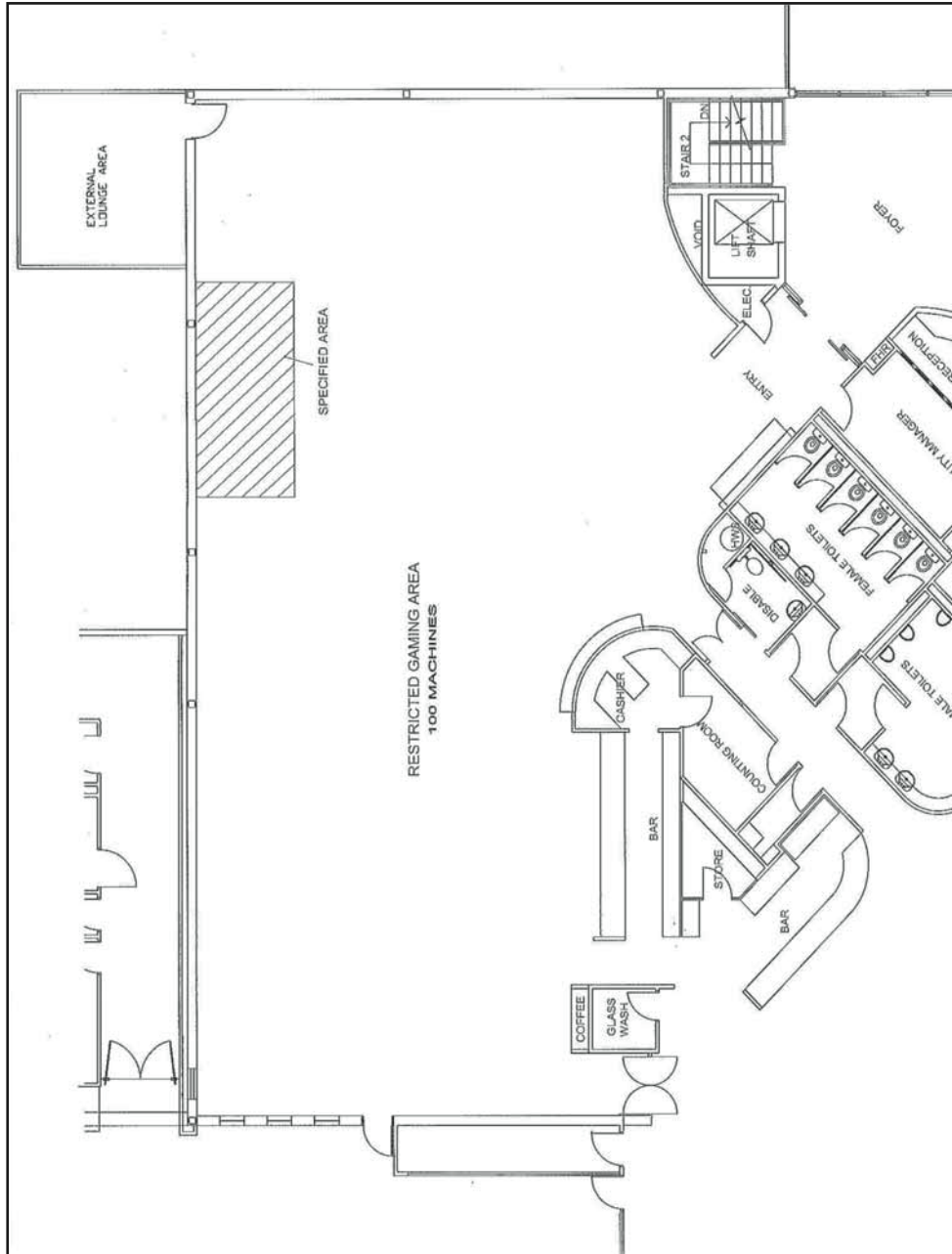

Gambling Regulation Act 2003

Sections 3.2.3(1)(g) and 3.2.3(1)(h)

Sections 3.5.29(3) and 3.5.30(2)

VICTORIAN COMMISSION FOR GAMBLING REGULATION

Notice of Specified Areas in Gaming Venue: Melton Country Club

By this notice, the Victorian Commission for Gambling Regulation –

Subject to the following conditions, specifies the area shown in the attached Schedule for the purposes of sections 3.2.3(1)(g), 3.2.3(1)(h), 3.5.29(3) and 3.5.30(2) of the **Gambling Regulation Act 2003**.

Conditions:

The conditions of this notice are that:

- (i) The specified area must be within an approved venue under the Act;
- (ii) The proportion of gaming machines in all specified areas of the approved venue must not exceed 20 percent of the total number of gaming machines in the approved venue;
- (iii) a gaming machine located in an area specified by a notice under sections 3.5.29(3) and 3.5.30(2) of the **Gambling Regulation Act 2003** may only operate in a mode where spin rate, bet limit, autoplay and note acceptors are unrestricted if that gaming machine may only be played in that mode by means of a card, Personal Identification Number (PIN) or similar technology which requires the player to nominate limits on time or net loss before play can commence.

Dated 8 April 2009

PETER COHEN
Executive Commissioner

SCHEDULE

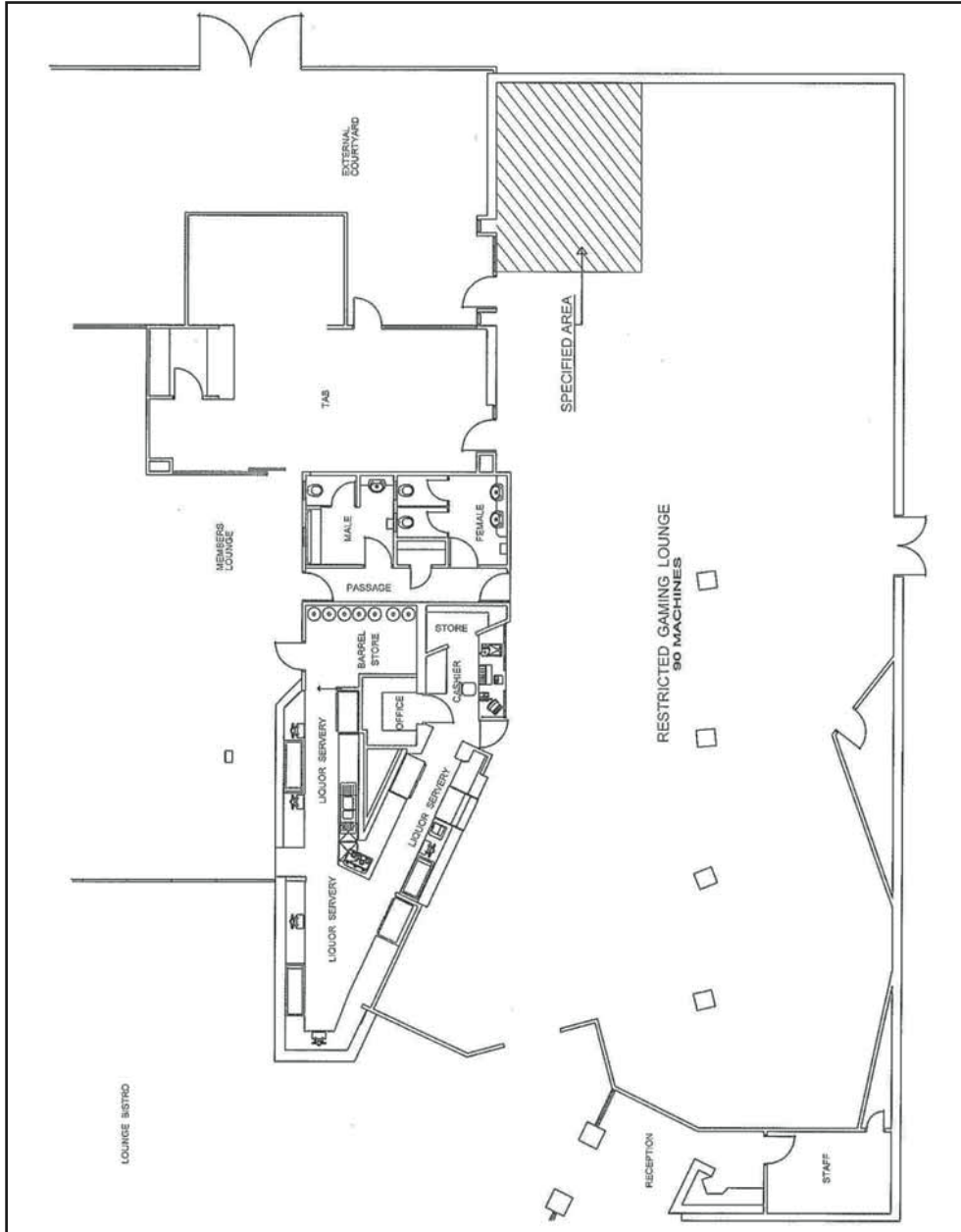

This page was left blank intentionally

craftsmanpress

The *Victoria Government Gazette* is published by The Craftsman Press Pty Ltd with the authority of the Government Printer for the State of Victoria

© State of Victoria 2009

This publication is copyright. No part may be reproduced by any process except in accordance with the provisions of the Copyright Act.

Address all enquiries to the Government Printer for the State of Victoria
Level 2 1 Macarthur Street
Melbourne 3002
Victoria Australia

How To Order

	Mail Order	Victoria Government Gazette Level 1 520 Bourke Street Melbourne 3000 PO Box 1957 Melbourne 3001 DX 106 Melbourne
	Telephone	(03) 9642 5808
	Fax	(03) 9600 0478
	email	gazette@craftpress.com.au
	Retail & Mail Sales	Victoria Government Gazette Level 1 520 Bourke Street Melbourne 3000 PO Box 1957 Melbourne 3001
	Telephone	(03) 9642 5808
	Fax	(03) 9600 0478
	Retail Sales	Information Victoria 505 Little Collins Street Melbourne 3000
	Telephone	1300 366 356
	Fax	(03) 9603 9920

Price Code A