



# Victoria Government Gazette

No. S 138 Thursday 21 May 2009  
By Authority of Victorian Government Printer

## Road Management Act 2004

### ROAD DECLARATIONS AND DISCONTINUATION

#### ROAD DECLARATIONS

VicRoads, pursuant to sections 11 and 14 of the **Road Management Act 2004**, upon publication of this notice declares or revokes the roads described in Schedule A and on the plans attached.

#### ROAD DISCONTINUATION

VicRoads, pursuant to section 12 of the **Road Management Act 2004**, upon publication of this notice discontinues the parts of the road described in Schedule B and on the plans attached and approves the sale of the surplus land as provided in section 47 of the **Transport Act 1983** and as delegated by the Minister for Roads and Ports under section 32 of the latter said Act.

#### SCHEDULE A

##### ARTERIAL ROAD

- a) Those parts of South Gippsland Highway identified by hatching on the plans numbered GP19876, GP19877 and GP20293 are declared or revoked as described in the legend in the said plans.

##### MUNICIPAL ROAD

- b) That part of Road identified by the hatching on the plan numbered GP19878 is declared as described in the legend in the said plan.
- c) That part of Old Koonwarra Meeniyen Road on the plan numbered GP19878 is declared as described in the legend in the said plan.
- d) Those parts of Swan Road on the plan numbered GP19878 are declared as described in the legend in the said plan.
- e) Those parts of Station Road on the plan numbered GP19878 are declared as described in the legend in the said plan.

#### SCHEDULE B

- a) Those parts of South Gippsland Highway identified by hatching on the plan numbered GP19877 are discontinued as described in the legend in the said plans.

**SPECIAL**

VICROADS  
ARTERIAL ROAD  
SOUTH GIPPSLAND HIGHWAY  
SHIRE OF SOUTH GIPPSLAND

GP19876  
Compiled from  
SP19876

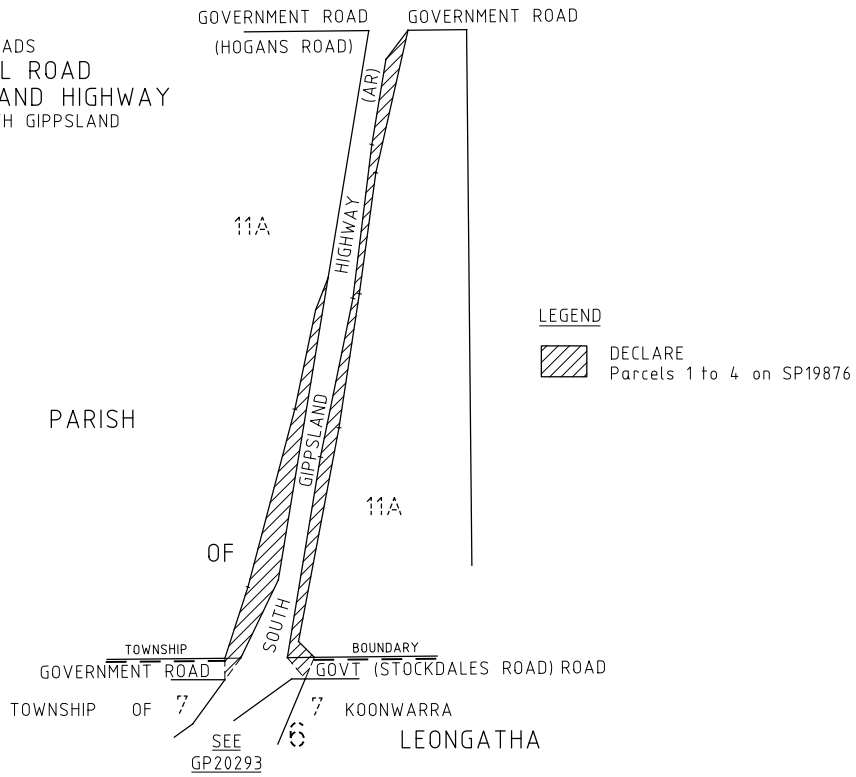

VICROADS  
ARTERIAL ROAD  
SOUTH GIPPSLAND HIGHWAY  
SHIRE OF SOUTH GIPPSLAND

GP19877  
Compiled from  
SP19877A & SP19878A

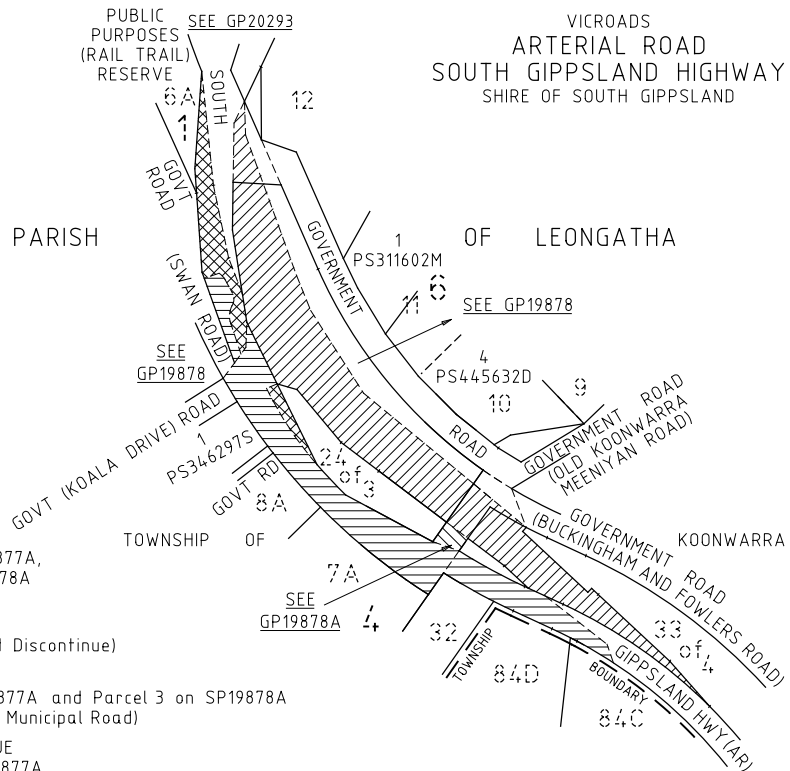

LEGEND

- DECLARE  
Parcels 2 & 3 on SP19877A,  
Parcels 1 & 2 on SP19878A
- DECLARE  
Parcel 5 on SP19878A  
(Proposal to Revoke and Discontinue)
- REVOKE  
Parcels 4 & 5 on SP19877A and Parcel 3 on SP19878A  
(Proposal to declare as Municipal Road)
- REVOKE AND DISCONTINUE  
Parcels 8 & 10 on SP19877A





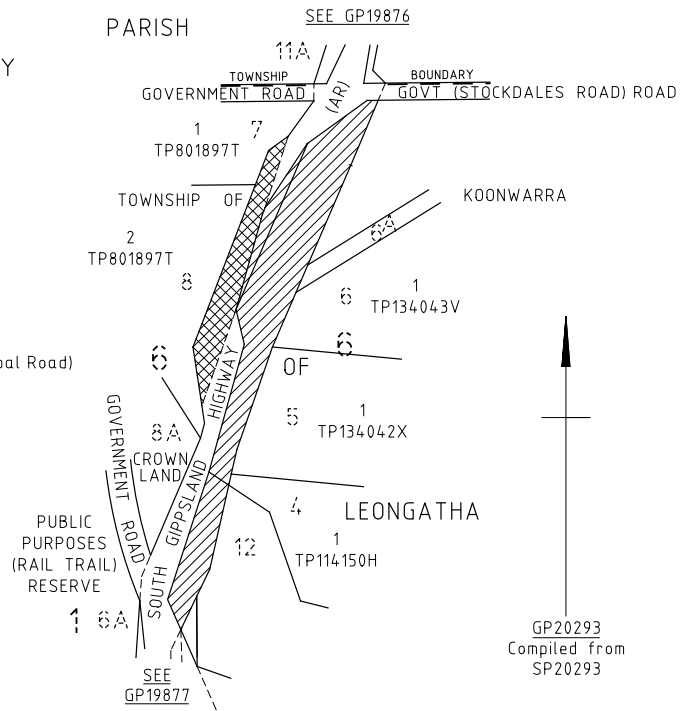

VICROADS  
ARTERIAL ROAD  
SOUTH GIPPSLAND HIGHWAY  
SHIRE OF SOUTH GIPPSLAND

LEGEND

-  DECLARE  
Parcels 2 to 4 on SP20293
-  REVOKE  
Parcel 1 on SP20293  
(Proposal to declare as Municipal Road)



LEGEND

-  DECLARE AS ROAD  
Parcel 1 on SP20293
-  DECLARE AS OLD KOONWARRA MEENIYAN ROAD  
Parcel 4 on SP19878A
-  DECLARE AS SWAN ROAD  
Parcels 4 & 5 on SP19877A & Parcel 3 on SP19878A
-  DECLARE AS STATION ROAD  
Parcels 1, 9 & 11 on SP19877A

VICROADS  
MUNICIPAL ROAD  
ROAD  
OLD KOONWARRA MEENIYAN ROAD  
SWAN ROAD  
STATION ROAD  
SHIRE OF SOUTH GIPPSLAND

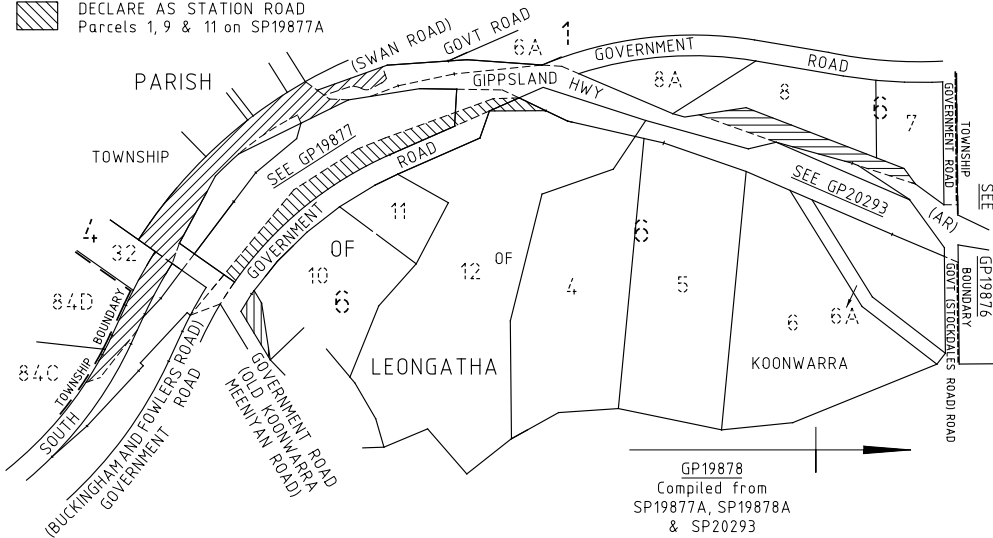

Dated 14 May 2009

GARY LIDDLE  
Chief Executive  
VicRoads

**craftsmanpress**

The *Victoria Government Gazette* is published by The Craftsman Press Pty Ltd with the authority of the Government Printer for the State of Victoria

© State of Victoria 2009

This publication is copyright. No part may be reproduced by any process except in accordance with the provisions of the Copyright Act.

Address all enquiries to the Government Printer for the State of Victoria  
Level 2 1 Macarthur Street  
Melbourne 3002  
Victoria Australia

**How To Order****Mail Order****Victoria Government Gazette**

Level 1 520 Bourke Street  
Melbourne 3000  
PO Box 1957 Melbourne 3001  
DX 106 Melbourne

**Telephone**

(03) 9642 5808

**Fax**

(03) 9600 0478

**email**

gazette@craftpress.com.au

**Retail & Mail Sales****Victoria Government Gazette**

Level 1 520 Bourke Street  
Melbourne 3000  
PO Box 1957 Melbourne 3001

**Telephone**

(03) 9642 5808

**Fax**

(03) 9600 0478

**Retail Sales****Information Victoria**

505 Little Collins Street  
Melbourne 3000

**Telephone**

1300 366 356

**Fax**

(03) 9603 9920

**Price Code A**