



Victoria Government Gazette

No. S 125 Friday 8 May 2009
By Authority of Victorian Government Printer

Road Management Act 2004

ROAD DECLARATIONS AND DISCONTINUATION

ROAD DECLARATIONS

VicRoads, pursuant to sections 11 and 14 of the **Road Management Act 2004**, upon publication of this notice declares or revokes the parts of the roads described in Schedule A and on the plans attached.

ROAD DISCONTINUATION

VicRoads, pursuant to section 12 of the **Road Management Act 2004**, upon publication of this notice discontinues the parts of the road described in Schedule B and on the plan attached and approves the sale of the surplus land as provided in section 47 of the **Transport Act 1983** and as delegated by the Minister for Roads and Ports under section 32 of the latter said Act.

SCHEDULE A

ARTERIAL ROAD

- a) That part of Pascoe Vale Road identified by hatching on the plan numbered GP20009 is declared as described in the legend in the said plan.
- b) Those parts of Lilydale–Monbulk Road identified by hatching on the plan numbered GP21164A are revoked as described in the legend in the said plan.
- c) Those parts of Berwick–Cranbourne Road and Thompson Road identified by hatching on the plan numbered GP21215 are declared as described in the legend in the said plan.
- d) Those parts of Berwick–Cranbourne Road identified by hatching on the plans numbered GP21166, GP21167, GP19808 and GP15293C are declared as described in the legend in the said plans.
- e) Those parts of Western Port Highway identified by hatching on the plan numbered GP21331 are declared as described in the legend in the said plan.

MUNICIPAL ROAD

- f) Those parts of Bungower Road identified by hatching on the plan numbered GP21331A are declared as described in the legend in the said plan.
- g) That part of Thompsons Road identified by hatching on the plan numbered GP21215A is declared as described in the legend in the said plan.

SCHEDULE B

- a) Those parts of Lilydale–Monbulk Road identified by hatching on the plan numbered GP21164A are discontinued as described in the legend in the said plan.

SPECIAL

VICROADS
ARTERIAL ROAD
PASCOE VALE ROAD
CITY OF HUME

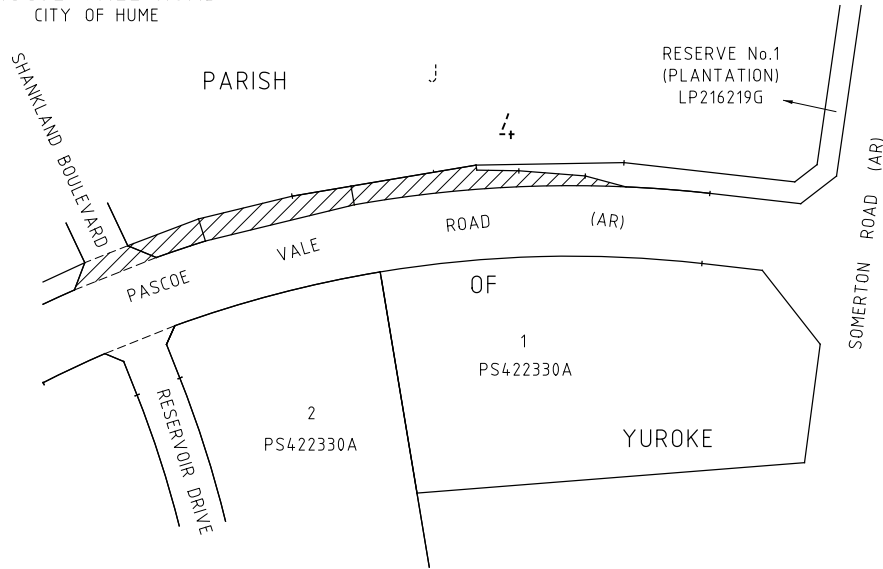

LEGEND

 DECLARE
Parcels 28, 29 & 31 on SP20009B
and Part of Shankland Boulevard

GP20009
Compiled from
SP20009B

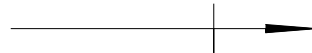

VICROADS
ARTERIAL ROAD
LILYDALE-MONBULK ROAD
SHIRE OF YARRA RANGES

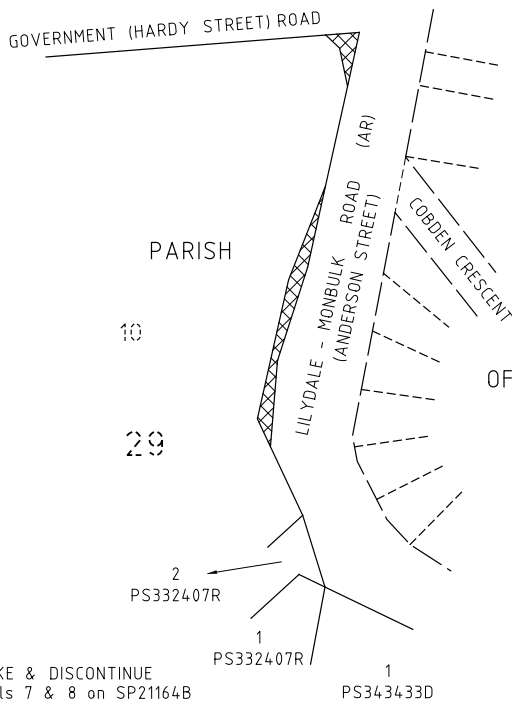

LEGEND

 REVOKE & DISCONTINUE
Parcels 7 & 8 on SP21164B

GP21164A
Compiled from
SP21164B



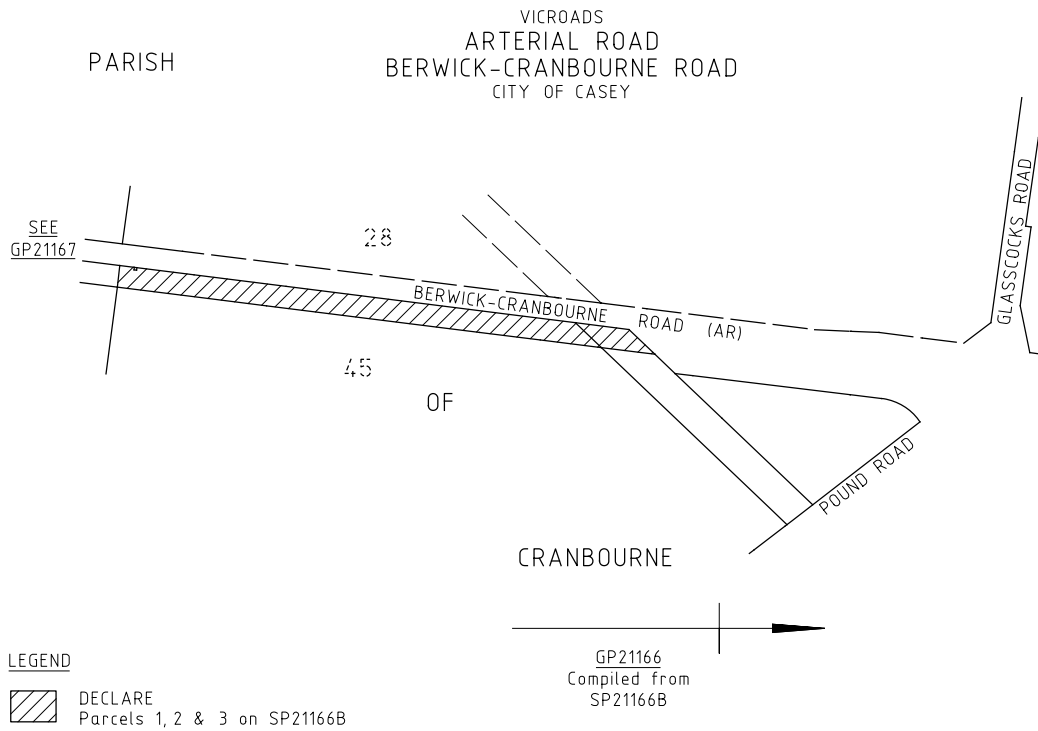
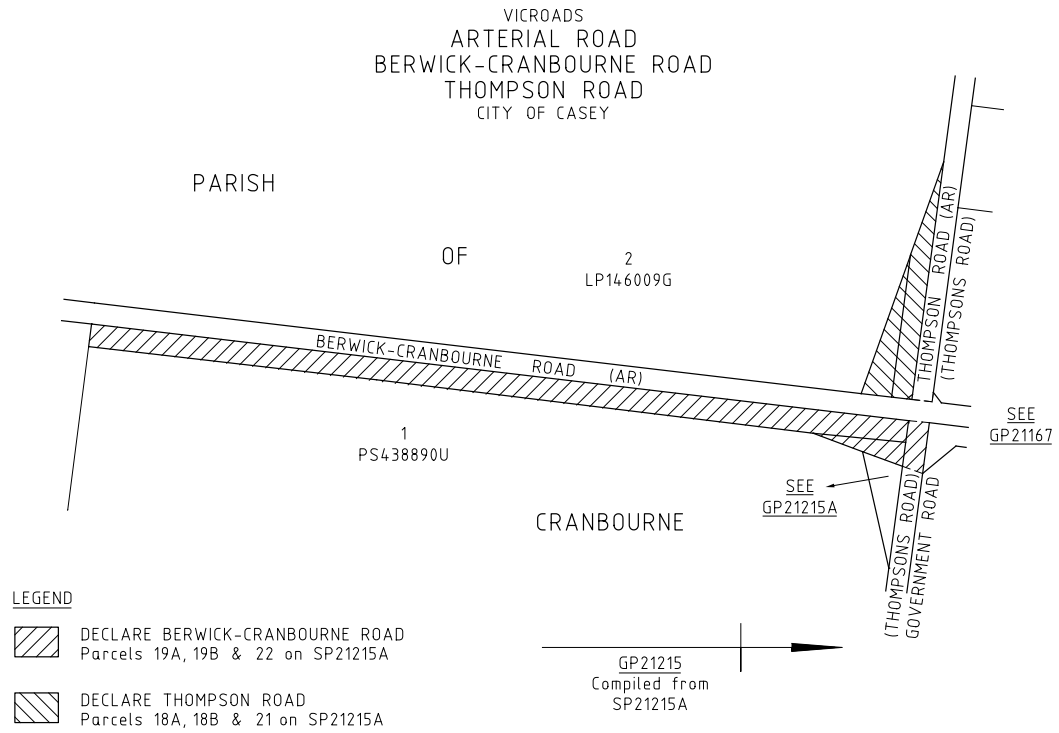

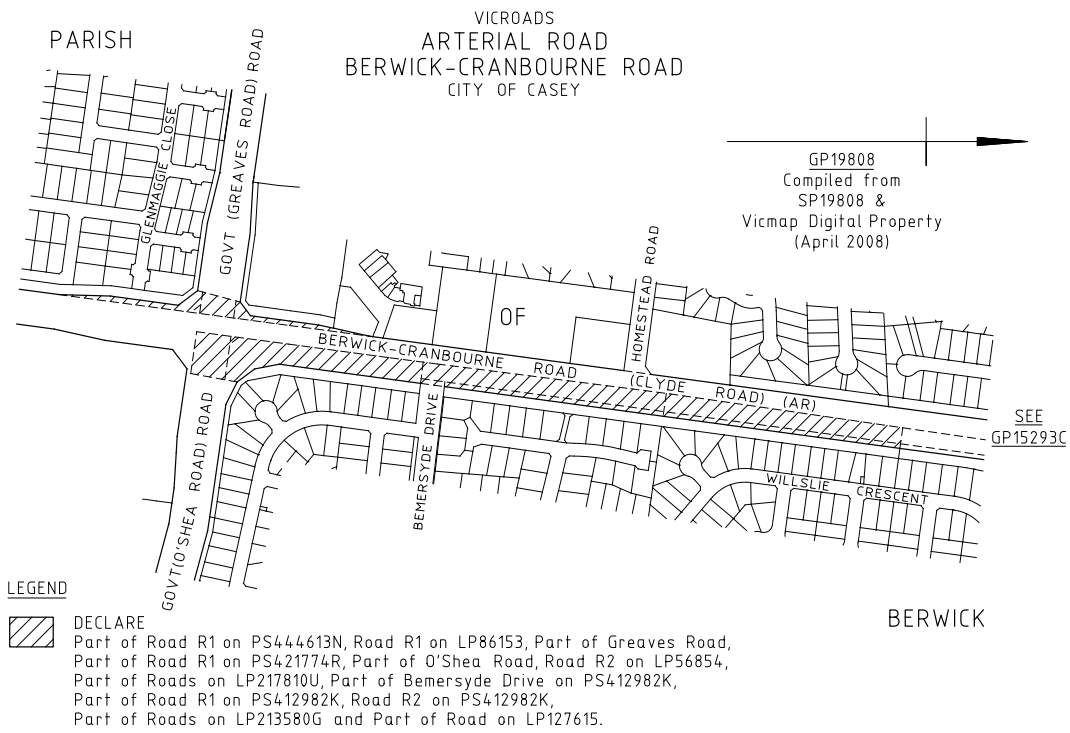
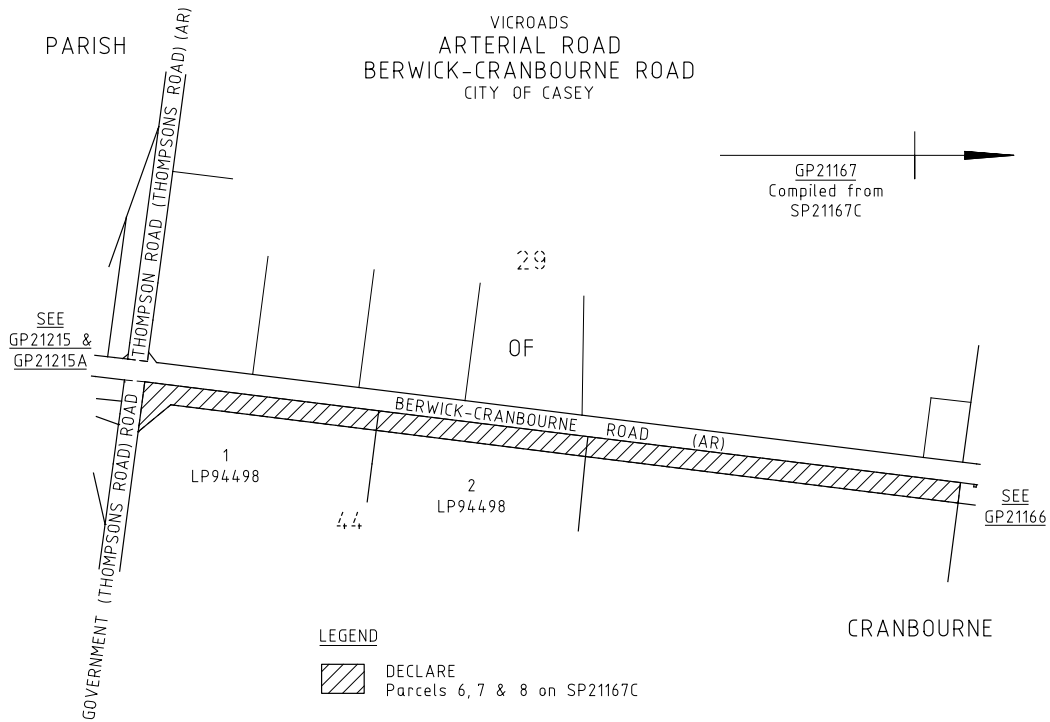

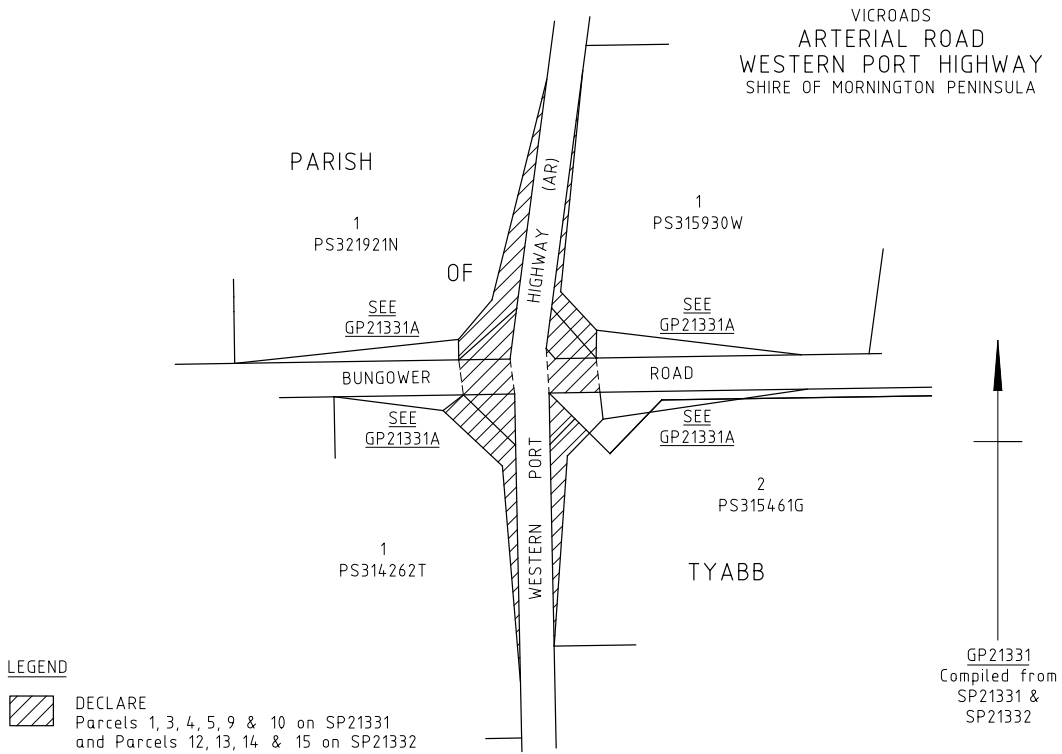
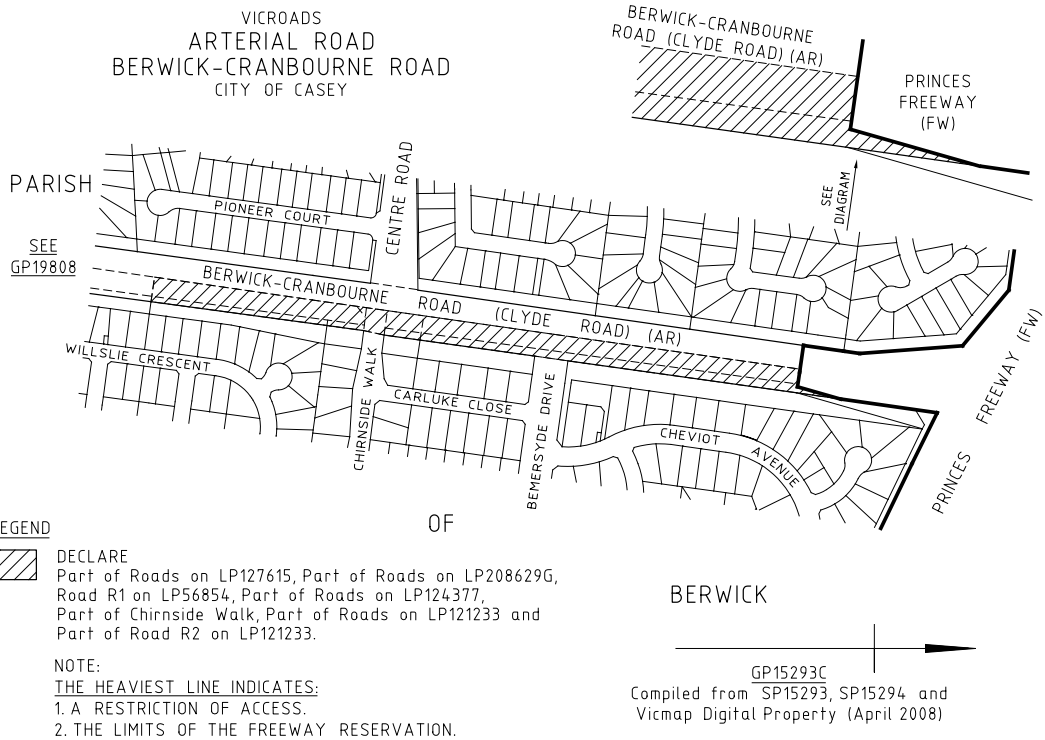

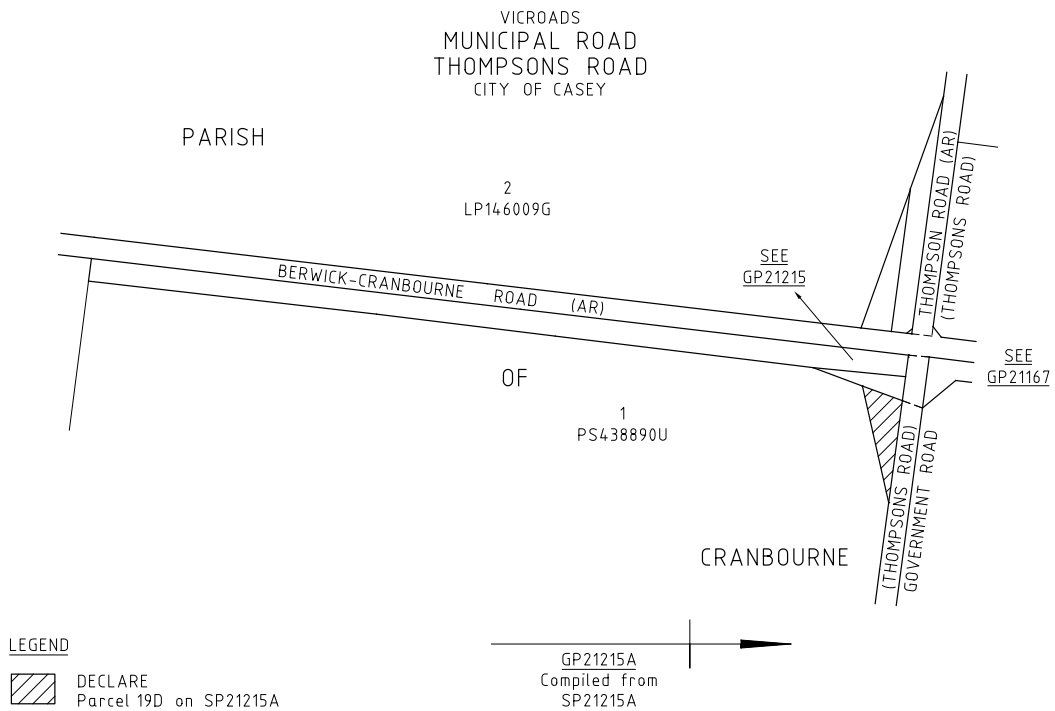
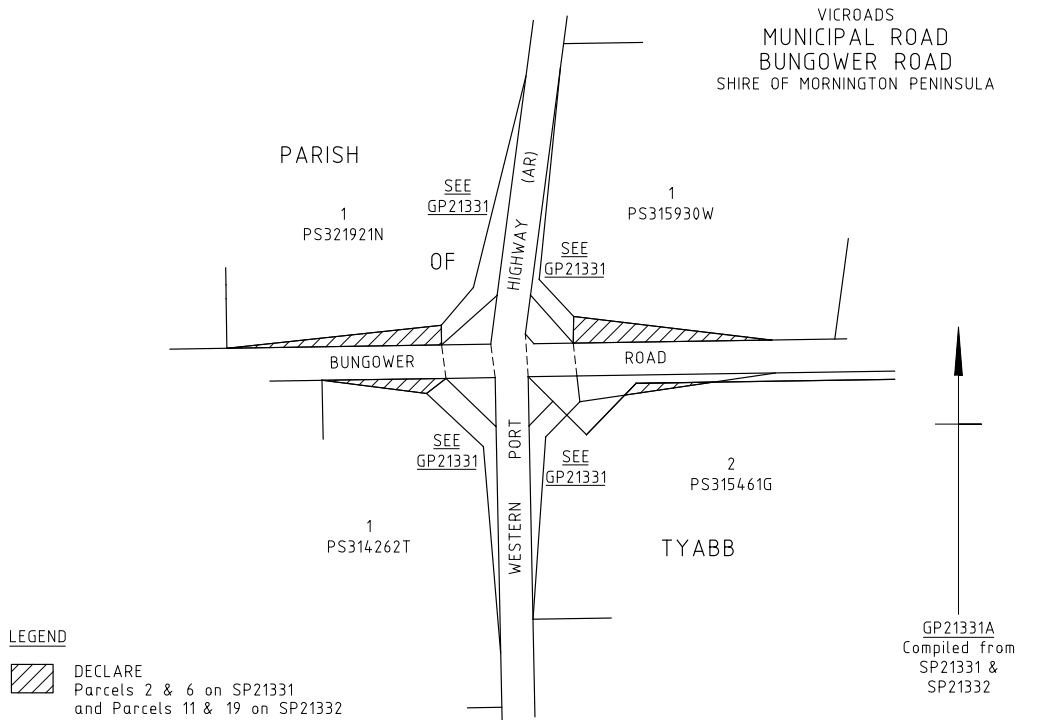

Dated 5 May 2009

GARY LIDDLE
Chief Executive
VicRoads

This page was left blank intentionally

craftsmanpress

The *Victoria Government Gazette* is published by The Craftsman Press Pty Ltd with the authority of the Government Printer for the State of Victoria

© State of Victoria 2009

This publication is copyright. No part may be reproduced by any process except in accordance with the provisions of the Copyright Act.

Address all enquiries to the Government Printer for the State of Victoria
Level 2 1 Macarthur Street
Melbourne 3002
Victoria Australia

How To Order

	Mail Order	Victoria Government Gazette Level 1 520 Bourke Street Melbourne 3000 PO Box 1957 Melbourne 3001 DX 106 Melbourne
	Telephone	(03) 9642 5808
	Fax	(03) 9600 0478
	email	gazette@craftpress.com.au
	Retail & Mail Sales	Victoria Government Gazette Level 1 520 Bourke Street Melbourne 3000 PO Box 1957 Melbourne 3001
	Telephone	(03) 9642 5808
	Fax	(03) 9600 0478
	Retail Sales	Information Victoria 505 Little Collins Street Melbourne 3000
	Telephone	1300 366 356
	Fax	(03) 9603 9920

Price Code A