



Victoria Government Gazette

No. S 464 Friday 12 November 2010
By Authority of Victorian Government Printer

Road Management Act 2004

ROAD DECLARATIONS AND DISCONTINUATIONS

ROAD DECLARATIONS

VicRoads, pursuant to sections 11 and 14 of the **Road Management Act 2004**, upon publication of this notice declares and revokes the roads described in Schedule A and on the plans attached.

ROAD DISCONTINUATIONS

VicRoads, pursuant to section 12 of the **Road Management Act 2004**, upon publication of this notice discontinues the parts of the road described in Schedule B and on the plans attached and approves the sale of the surplus land as provided in section 94 of the **Transport Integration Act 2010** and as delegated by the Minister for Roads and Ports under section 31 of the latter said Act.

SCHEDULE A

ARTERIAL ROAD

- a) Those parts of Ferntree Gully Road identified by hatching on the plans numbered GP21415, GP21415A, GP21416, GP21416A and GP21417 are declared as described in the legend in the said plans.
- b) That part of Springvale Road identified by hatching on the plan numbered GP21415 is declared as described in the legend in the said plan.
- c) Those parts of Bass Highway identified by hatching on the plans numbered GP21542, GP21543 and GP21544 are declared and revoked as described in the legend in the said plans.
- d) Those parts of Kelletts Road identified by hatching on the plans numbered GP21202, GP21203 and GP21205 are declared as described in the legend in the said plans.
- e) That part of Mickleham Road identified by hatching on the plan numbered GP21024 is declared as described in the legend in the said plan.

MUNICIPAL ROAD

- f) That part of Road identified by hatching on the plan numbered GP21543A is declared as described in the legend in the said plan.

SCHEDULE B

- a) Those parts of Bass Highway identified by cross hatching on the plans numbered GP21542, GP21543 and GP21544 are discontinued as described in the legend in the said plans.

SPECIAL

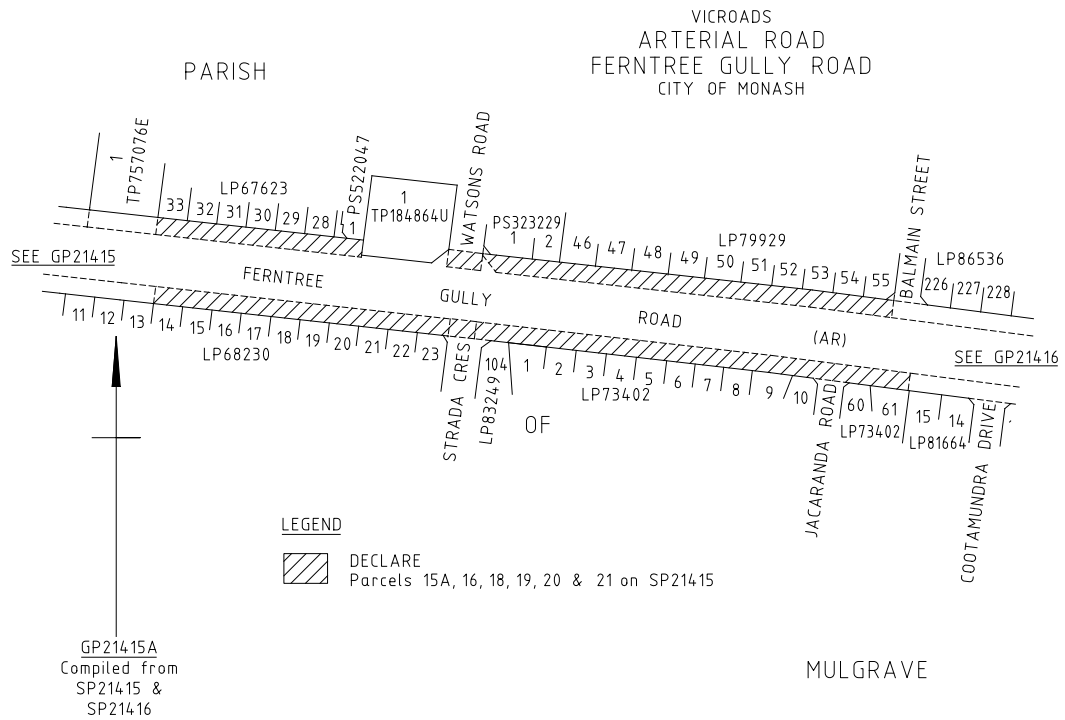
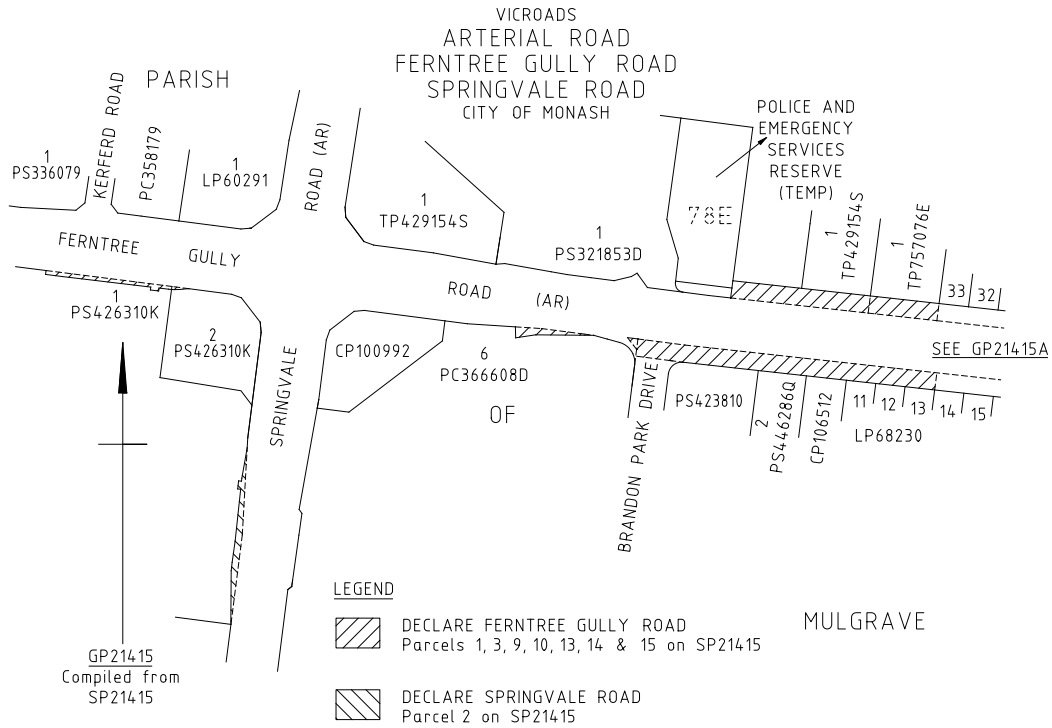

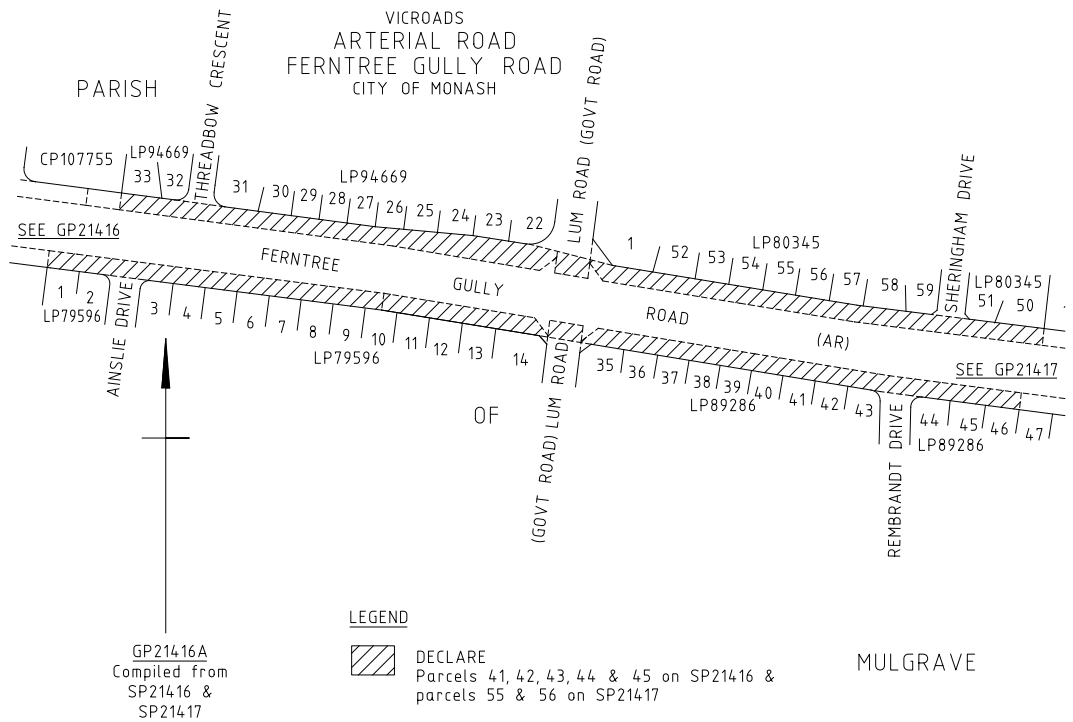
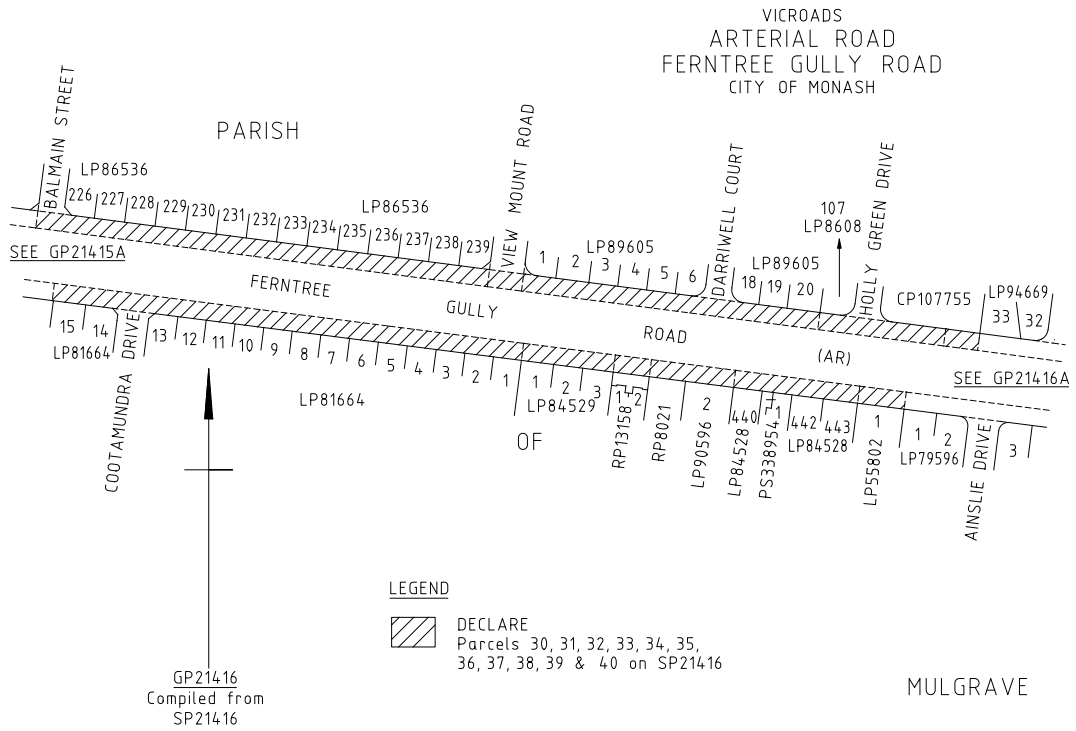

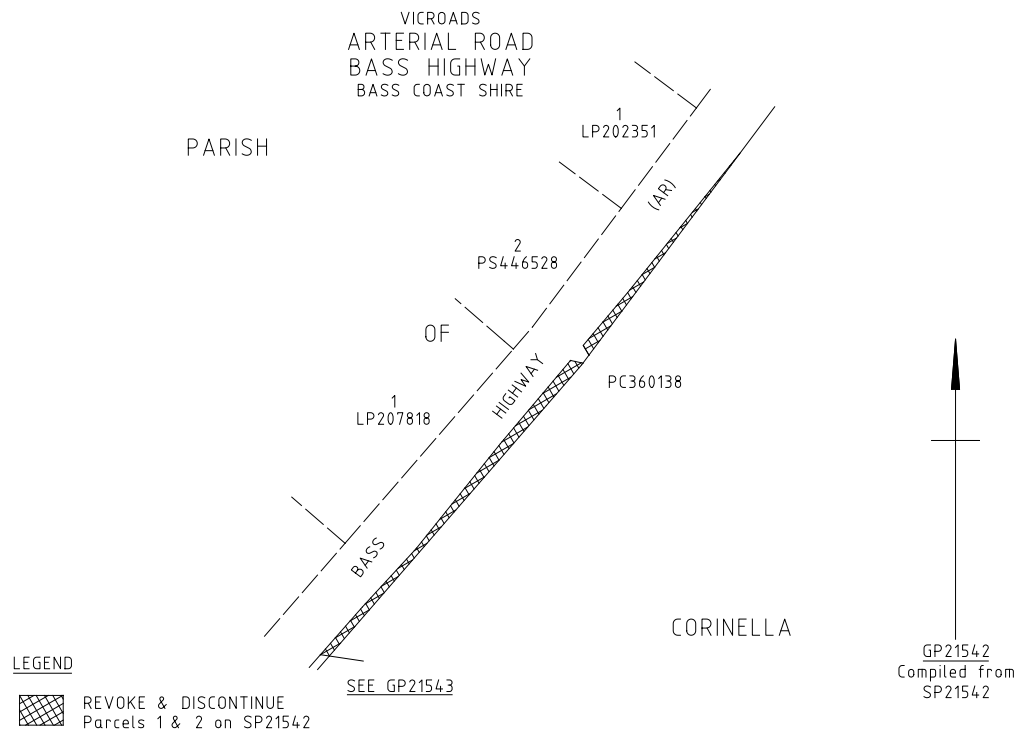
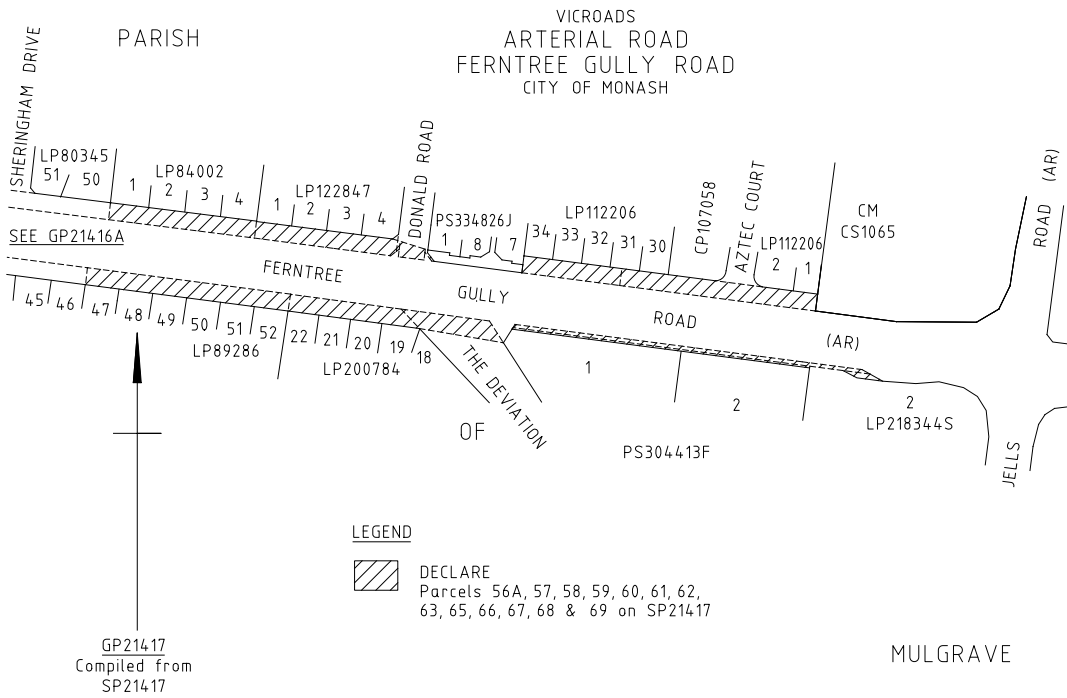

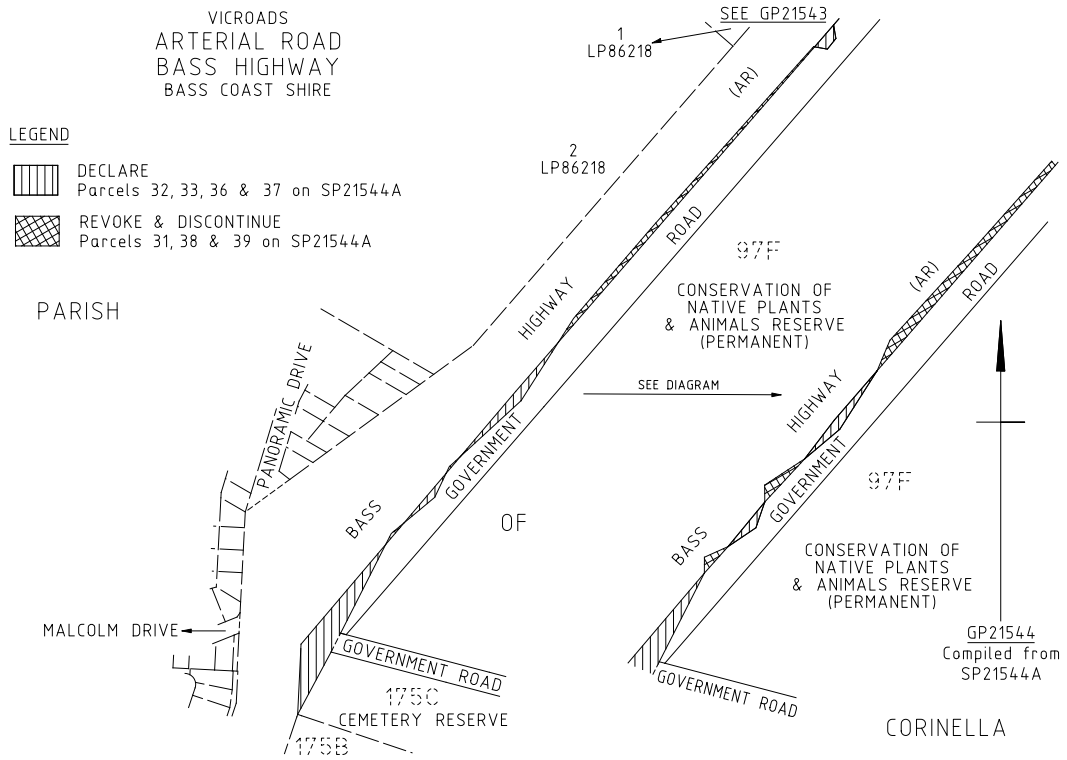
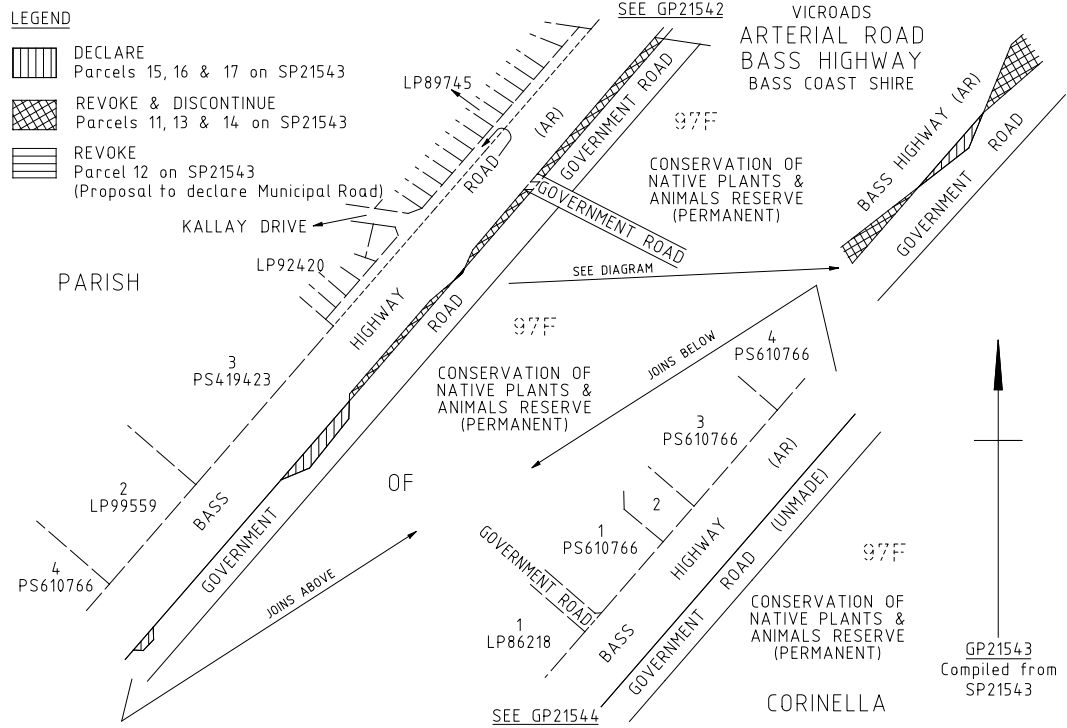

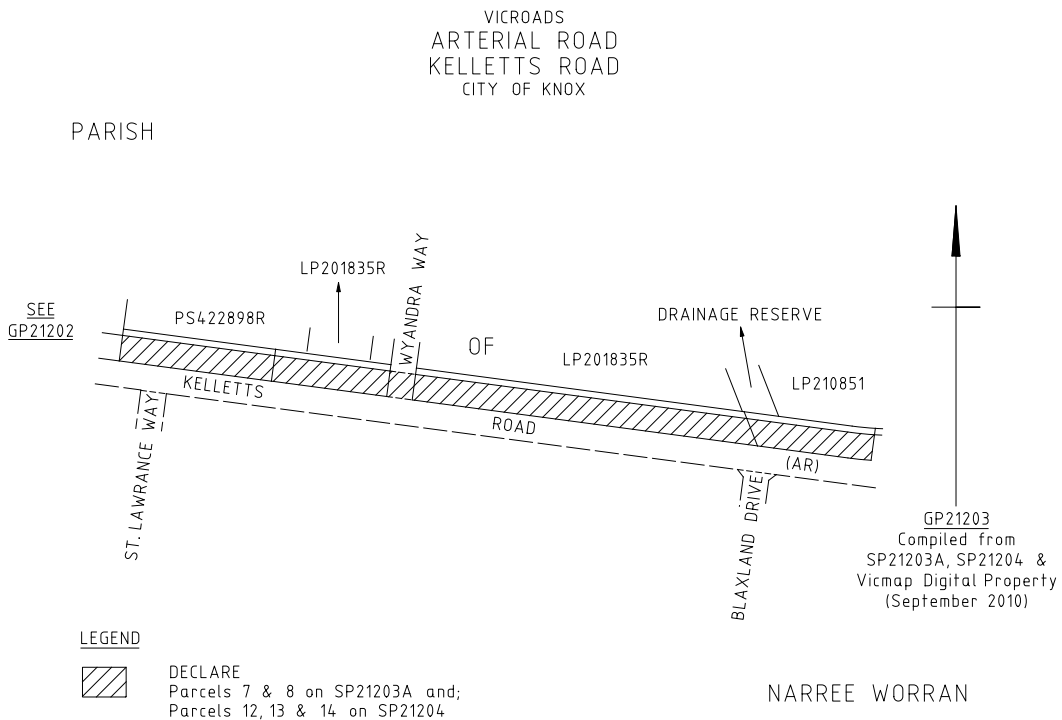
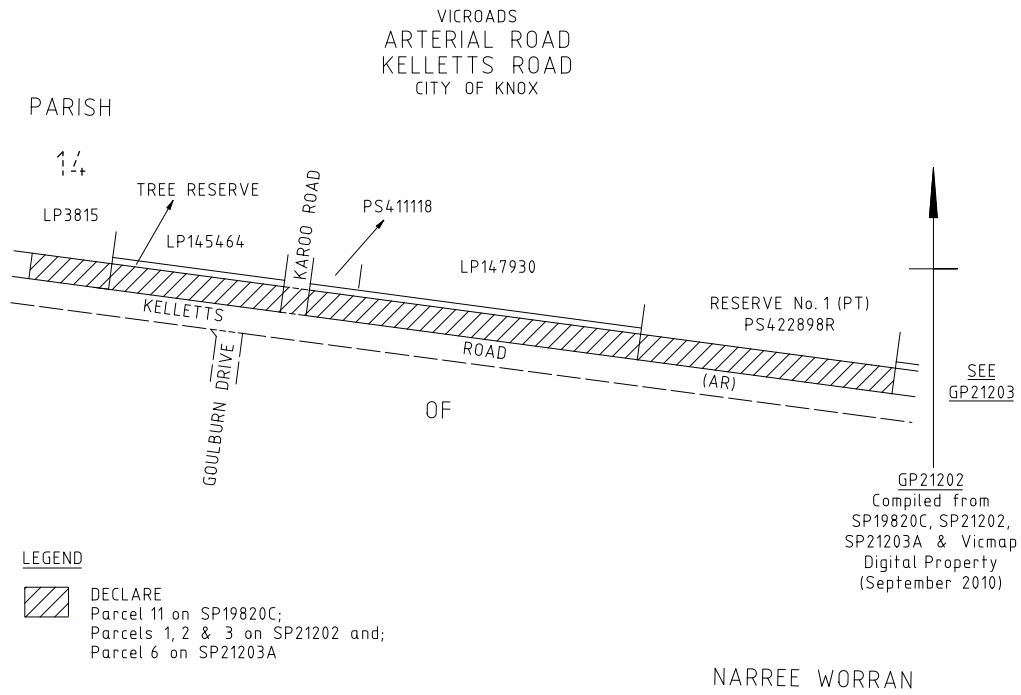

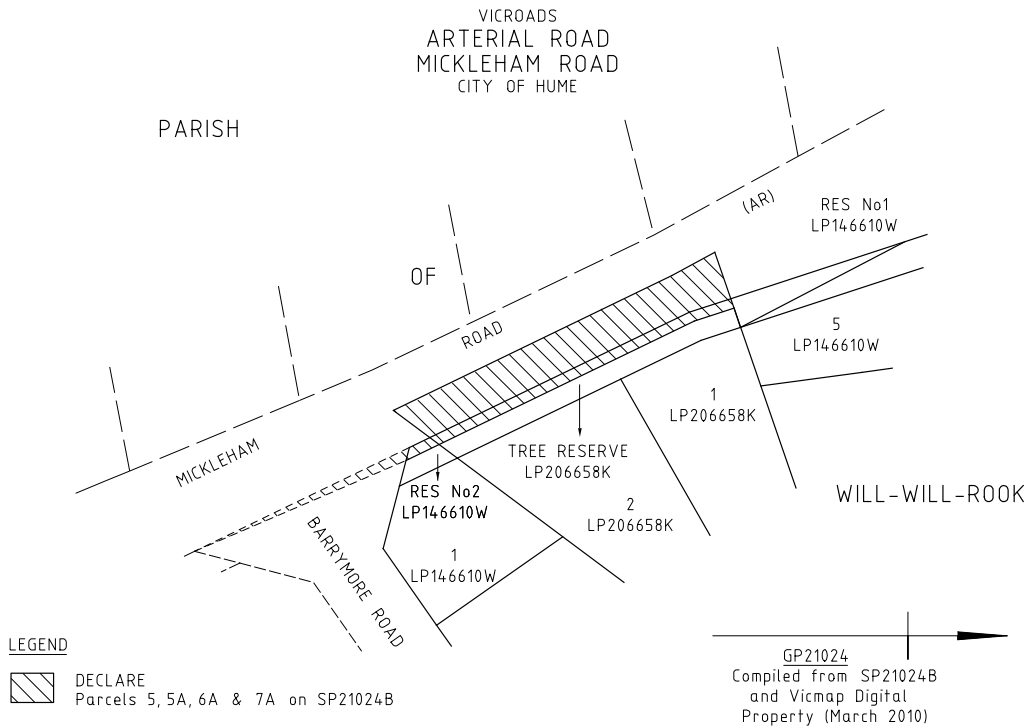
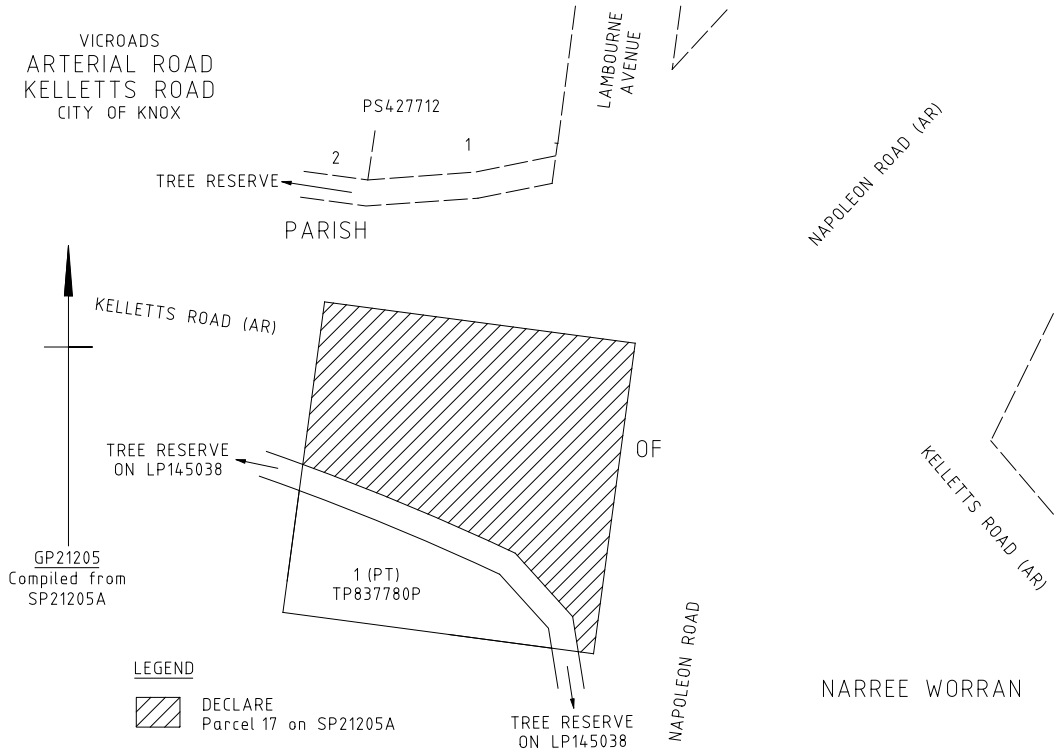

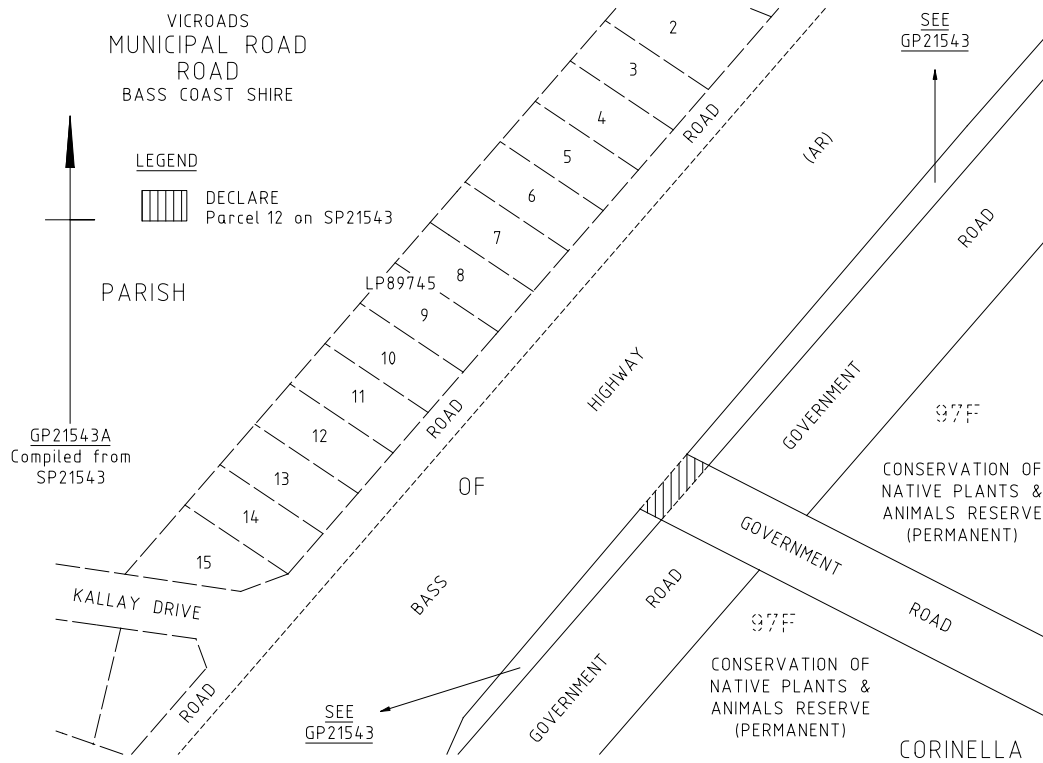

Dated 10 November 2010

GARY LIDDLE
Chief Executive
VicRoads

This page was left blank intentionally

This page was left blank intentionally

This page was left blank intentionally

bluestar  **PRINT**

The *Victoria Government Gazette* is published by Blue Star Print with the authority of the Government Printer for the State of Victoria

© State of Victoria 2010

This publication is copyright. No part may be reproduced by any process except in accordance with the provisions of the Copyright Act.

Address all enquiries to the Government Printer for the State of Victoria

Level 2 1 Macarthur Street
Melbourne 3002
Victoria Australia

How To Order**Mail Order****Victoria Government Gazette**

Level 5 460 Bourke Street
Melbourne 3000
PO Box 1957 Melbourne 3001
DX 106 Melbourne

**Telephone**

(03) 8523 4601

**Fax**

(03) 9600 0478

email

gazette@bluestargroup.com.au

**Retail &
Mail Sales****Victoria Government Gazette**

Level 5 460 Bourke Street
Melbourne 3000
PO Box 1957 Melbourne 3001

**Telephone**

(03) 8523 4601

**Fax**

(03) 9600 0478

**Retail
Sales****Information Victoria**

505 Little Collins Street
Melbourne 3000

**Telephone**

1300 366 356

**Fax**

(03) 9603 9920

Price Code A