

# **Victoria Government Gazette**

By Authority of Victorian Government Printer

**No. G 49 Thursday 9 December 2010**

[www.gazette.vic.gov.au](http://www.gazette.vic.gov.au)

---

**GENERAL**

---

**TABLE OF PROVISIONS**

|                                      |      |
|--------------------------------------|------|
| Private Advertisements               |      |
| Estates of Deceased Persons          |      |
| Armstrong Ross Lawyers               | 2993 |
| Cole & Co.                           | 2993 |
| Dwyer Mahon & Robertson              | 2993 |
| Engel & Partners                     | 2993 |
| Fischer McCrae                       | 2993 |
| G. A. Black & Co.                    | 2993 |
| Hill Legal                           | 2993 |
| Icko Szloma Tenenbaum                | 2994 |
| Jessop & Komesaroff Pty              | 2994 |
| Kim Bainbridge Legal Service Pty Ltd | 2994 |
| Littleton Hackford & D'Alessandro    | 2994 |
| Nicholas John Egerton Lovett         | 2994 |
| Pearce Webster Dugdales              | 2994 |
| Slater & Gordon                      | 2995 |
| Stidston Warren                      | 2995 |
| Tait Legal                           | 2995 |
| T. J. Mulvany & Co.                  | 2995 |
| Proclamations                        | 2996 |
| Government and Outer Budget Sector   |      |
| Agencies Notices                     | 2997 |

---

**Advertisers Please Note**

As from 9 December 2010

The last Special Gazette was No. 486 dated 3 December 2010.

The last Periodical Gazette was No. 1 dated 9 June 2010.

---

---

**How To Submit Copy**

- See our webpage [www.gazette.vic.gov.au](http://www.gazette.vic.gov.au)
  - or contact our office on 8523 4601  
between 8.30 am and 5.30 pm Monday to Friday
- 

**Copies of recent Special Gazettes can now be viewed at the following display cabinet:**

- 1 Treasury Place, Melbourne (behind the Old Treasury Building)
-

**PUBLICATION OF THE VICTORIA GOVERNMENT GAZETTE (GENERAL)  
CHRISTMAS PERIOD 2010**

**PLEASE NOTE:**

The final Victoria Government Gazette (General) for 2010 (G52/10) will be published on  
**Thursday 30 December 2010.**

**Copy deadlines:**

|                                                        |                                           |
|--------------------------------------------------------|-------------------------------------------|
| Private Advertisements                                 | <b>9.30 am on Friday 24 December 2010</b> |
| Government and Outer<br>Budget Sector Agencies Notices | <b>9.30 am on Friday 24 December 2010</b> |

**Office Hours:**

The Victoria Government Gazette Office is open during normal office hours over the holiday period, i.e. 8.30 am to 5.30 pm Monday to Friday, excluding public holidays.

Where urgent gazettal is required after hours, arrangements should be made with the Government Gazette Officer on 0419 327 321.

JENNY NOAKES  
Government Gazette Officer

**PUBLICATION OF THE VICTORIA GOVERNMENT GAZETTE (GENERAL)  
NEW YEAR WEEK 2011**

**Please Note:**

The Victoria Government Gazette (General) for New Year week (G1/11) will be published on **Thursday 6 January 2011.**

**Copy deadlines:**

|                                                        |                                           |
|--------------------------------------------------------|-------------------------------------------|
| Private Advertisements                                 | <b>9.30 am on Friday 31 December 2010</b> |
| Government and Outer<br>Budget Sector Agencies Notices | <b>9.30 am on Tuesday 4 January 2011</b>  |

**Office Hours:**

The Victoria Government Gazette Office is open during normal office hours over the holiday period, i.e. 8.30 am to 5.30 pm Monday to Friday, excluding public holidays.

Where urgent gazettal is required after hours, arrangements should be made with the Government Gazette Officer on 0419 327 321.

JENNY NOAKES  
Government Gazette Officer

**VICTORIA GOVERNMENT GAZETTE**

**Subscribers and Advertisers**

**Our contact details are as follows:**

Victoria Government Gazette Office  
Level 5, 460 Bourke Street  
Melbourne, Victoria 3000

PO Box 1957  
Melbourne, Victoria 3001

DX 106 Melbourne

Telephone: (03) 8523 4601  
Fax: (03) 9600 0478  
Mobile (after hours): 0419 327 321

Email: [gazette@bluestargroup.com.au](mailto:gazette@bluestargroup.com.au)  
Website: [www.gazette.vic.gov.au](http://www.gazette.vic.gov.au)

JENNY NOAKES  
Government Gazette Officer

---

**PRIVATE ADVERTISEMENTS**

Re: KATHLEEN MARY WALLS, deceased.

Creditors, next-of-kin and others having claims in respect of the estate of the deceased, who died on 4 July 2010, are required by the executor to send particulars of their claim to the executor, care of the undermentioned solicitors, by 10 February 2011, after which date the trustees may convey or distribute the assets, having regard only to the claims of which the executor has notice.

ARMSTRONG ROSS, lawyers,  
Suite 1, 1693a Burwood Highway, Belgrave,  
Victoria 3160.

Re: ELLA MARTHA GUMMICH, late of 775 Warrigal Road, Bentleigh East, Victoria, home duties, deceased.

Creditors, next-of-kin and others having claims in respect of the estate of the deceased, who died on 25 August 2010, are required by the trustee, Equity Trustees Limited, to send particulars of their claims to the trustee, of Level 2, 575 Bourke Street, Melbourne, Victoria 3000, by 8 February 2011, after which date the trustee may convey or distribute the assets, having regard only to the claims of which the trustee then has notice.

COLE & CO., solicitors,  
3 Station Street, Oakleigh 3166.

Re: Estate of MERVYN SILVESTER BREMNER.

Creditors, next-of-kin or others having claims in respect of the estate of MERVYN SILVESTER BREMNER, late of 2/2 Wood Street, Swan Hill 3585, in the State of Victoria, retired gentleman, deceased, who died on 1 October 2010, are to send particulars of their claim to the executors, care of the undermentioned legal practitioners, by 28 February 2011, after which the executors will distribute the assets, having regard only to the claims of which they then have notice.

DWYER MAHON & ROBERTSON,  
legal practitioners,  
Beveridge Dome, 194–208 Beveridge Street,  
Swan Hill 3585.

Creditors, next-of-kin and others who have claims in respect of the estate of FRANCIS WILLIAM HEBBARD, late of 6 Ross Street, Bairnsdale, in the State of Victoria, deceased, who died on 1 May 2010, are to send particulars of their claims to the administrators, care of Engel & Partners Pty, of 109 Main Street, Bairnsdale, by 9 February 2011, after which date it will distribute the assets, having regard only to the claims of which it then has notice.

ENGEL & PARTNERS PTY, legal practitioners,  
109 Main Street, Bairnsdale 3875.

SHIRLEY ETHERIDGE, late of Domain by the Bay, 185 Racecourse Road, Mount Martha, Victoria, retired, deceased.

Creditors, next-of-kin and others having claims in respect of the estate of the deceased, who died on 25 July 2010, are required by the trustees, Dorothea Mabel Dalglish (in the Will called Mabel Dorothy Dalglish) and Bruce George Dalglish, to send particulars to the trustees by 9 February 2011, care of the undermentioned solicitors, after which date the trustees may convey or distribute the assets, having regard only to the claims of which the trustees have notice.

FISCHER McCRAE, solicitors,  
Level 3, 389 Lonsdale Street, Melbourne 3000.

Re: MARY AGNES BEAN, late of Noble Gardens Aged Care, 55 Thomas Street, Noble Park, retired, deceased.

Creditors, next-of-kin and others having claims in respect of the estate of the deceased, who died on 25 August 2010, are required by the trustee, Maureen Ellen O'Brien, to send particulars to her, care of the undersigned, by 14 February 2011, after which date the trustee may convey or distribute the assets, having regard only to the claims of which the trustee has notice.

G. A. BLACK & CO., solicitors,  
222 Maroondah Highway, Healesville 3777.

Creditors, next-of-kin and others having claims in respect of the estate of MURRAY ARTHUR BARNETT, late of 9 Lorikeet Court, Mornington, disabled pensioner, deceased, who died on 23 July 2010, are to send particulars of their claims to Graham Henry Jones and Helen

Alice Jones, care of Hill Legal, Suite 2, Ground Floor, 346 Main Street, Mornington 3931, by 9 March 2011, after which date they will distribute the assets of the estate, having regard only to the claims of which they then have notice.

HILL LEGAL, lawyers and consultants,  
Suite 2, Ground Floor, 346 Main Street,  
Mornington, Victoria 3931.

HILDA FREDRIKSEN, late of 18/350 Beaconsfield Parade, St Kilda, Victoria 3182, deceased.

Creditors, next-of-kin and others having claims in respect of the estate of the abovenamed deceased, who died on 6 October 2010, are required by the trustee, Icko Szloma Tenenbaum, of Level 11, 100 Collins Street, Melbourne 3000, to send particulars of their claims to him by 11 February 2011, after which date the trustee may convey or distribute the assets, having regard only to the claims of which he then has notice. Probate was granted in Victoria on 25 November 2010.

Re: ARTHUR STRANGE (also known as Arthur Edward Strange), late of Unit 6, 435 St Kilda Street, Elwood, Victoria 3184, retired, deceased.

Creditors, next-of-kin and others having claims in respect of the estate of the abovenamed deceased, who died on 2 November 2010, are required by the executor, Beverley Mary Jessop, to send particulars of their claims to the personal representative, care of the undermentioned solicitors, by a date not later than two months from the date of publication hereof, after which date the personal representative will distribute the assets, having regard only to those claims of which she then has notice.

JESSOP & KOMESAROFF PTY, solicitors,  
6 Ormond Road, Elwood 3184.

Re: RONALD ALFRED BULL, deceased.

Creditors, next-of-kin and others having claims in respect of the estate of the deceased, who died on 16 August 2009, are required by the trustees, Eileen Isobel Jean Bull and Gregory Ronald Bull, to send particulars to them, care of the undersigned, by 10 February 2011, after

which date the trustees may convey or distribute the assets, having regard only to the claims of which they then have notice.

KIM BAINBRIDGE LEGAL SERVICE PTY LTD (t/as Garden & Green), lawyers,  
4 McCallum Street, Swan Hill, Victoria 3585.

Re: THOMAS NOEL FLETCHER, late of Unit 104, Yallambee Village, Gwalia Street, Traralgon, retired gentleman, deceased.

Creditors, next-of-kin and others having claims in respect of the estate of the deceased, who died on 9 September 2010, are required by the trustee, Peter Robert Fletcher, to send particulars to him, care of the undermentioned solicitors, by 28 February 2011, after which date the trustee may convey or distribute the assets, having regard only to the claims of which the trustee has notice.

LITTLETON HACKFORD & D'ALESSANDRO, solicitors,  
256A Commercial Road, Morwell 3840.

JOHN REECE LOVETT, Apartment 102 Classic Residence, 1-3 Brewer Road, Brighton East, Victoria, company director (retired).

Creditors, next-of-kin and all others having claims in respect of the deceased, who died on 1 October 2009, are required by the executor, Nicholas John Egerton Lovett, PO Box 1176, Darling, Victoria 3145, to send particulars of such claims to the said executor by 9 February 2011, after which date the executors will distribute the assets, having regard only to the claims of which they have notice.

Re: DONALD GORDON AITKEN, deceased.

Creditors, next-of-kin and others having claims in respect of the estate of the deceased, who died on 27 September 2010, are required by the trustees, Anthony Hine Walstab and Christopher Stanley Johnson, to send particulars to them, care of the undermentioned solicitors, by 17 February 2011, after which date they may convey or distribute the assets, having regard only to the claims of which they then have notice.

PEARCE WEBSTER DUGDALES, solicitors,  
4th Floor, 379 Collins Street, Melbourne 3000.

Re: ANTONIE LINE MELITTA FRICK (also known as Melitta Frick, Antonia Frick, Antonia Melitta Frick, Antonie Frick, Antonie Lina Melitia Frick and Antonie Lina Melitta Frick), deceased.

Creditors, next-of-kin and others having claims in respect of the estate of ANTONIE LINE MELITTA FRICK (also known as Melitta Frick, Antonia Frick, Antonia Melitta Frick, Antonie Frick, Antonie Lina Melitia Frick and Antonie Lina Melitta Frick), deceased, late of Unit 86, Glendale Aged Care, Glendale Court, Werribee, home duties, who died on 6 April 2010, are requested to send particulars of their claims to the executor, Paul Lindsay Kelly, care of the undersigned solicitors, by 8 February 2011, after which date he will convey or distribute the assets, having regard only to the claims of which he then has notice.

SLATER & GORDON, solicitors,  
100 Paisley Street, Footscray 3011.

---

MARGARETTA COWAN LOWES (also known as Margaretta Lowes), late of Lorikeet Lodge, 24–28 Moorooduc Highway, Frankston, Victoria, deceased.

Creditors, next-of-kin and others having claims in respect of the estate of the deceased, who died on 24 July 2010, are required by the executor, Sam Stidston of Suite 1, 10 Blamey Place, Mornington, Victoria, to send particulars to him, care of Stidston Warren Lawyers, by 13 February 2011, after which date the executor may convey or distribute the assets, having regard only to the claims of which he then has notice.

STIDSTON WARREN LAWYERS,  
Suite 1, 10 Blamey Place, Mornington 3931.

---

Re: MELVA MARY REITER, late of Harbourside Lodge, Bentinck Street, Portland, deceased.

Creditors, next-of-kin and others having claims in respect of the estate of the deceased, who died on 28 June 2010, are required by the executors to send particulars to them, care of the undermentioned solicitors, by 14 February 2011, after which date they may convey or distribute the assets, having regard only to the claims of which they then have notice.

TAITS LEGAL,  
121 Kepler Street, Warrnambool 3280.

---

BARRY KEITH TAYLOR, late of 43 Chesterville Road, Bentleigh East, Victoria, deceased.

Creditors, next-of-kin and others having claims in respect of the estate of the abovenamed deceased, who died on 12 August 2010, are required to send particulars of their claims to the executors, Carolyn Margaret Taylor and Michelle Suzanne Dooley and Timothy John Mulvany, care of the undermentioned lawyers, by 7 February 2011, after which date the said executors will distribute the assets, having regard only to the claims of which they then have notice.

T. J. MULVANY & CO., lawyers,  
PO Box 560, Melbourne 3001.

---

DANTE ALBERT TESORIERO, late of 34 The Avenue, Balaclava, Victoria, deceased.

Creditors, next-of-kin and others having claims in respect of the estate of the abovenamed deceased, who died on 21 August 2010, are required to send particulars of their claims to the executor, Peter James Tesoriero, care of the undermentioned solicitors, by 8 February 2011, after which date the said executor will distribute the assets, having regard only to the claims of which he then has notice.

T. J. MULVANY & CO., lawyers,  
Suite 5.01, Level 5, 45 William Street,  
Melbourne 3000.

---

**PROCLAMATIONS**

**Constitution Act 1975**

**PROCLAMATION**

I, David de Kretser, AC, Governor of the State of Victoria, acting under sections 8 and 20 of the **Constitution Act 1975** and all other powers vested in me, fix 21 December 2010 at 11.00am as the time for the commencement and holding of the first session of the Fifty-seventh Parliament of Victoria for the dispatch of business, at Parliament House, Melbourne. The Members of the Legislative Council and the Members of the Legislative Assembly are required to attend at that time and place.

Given under my Hand and the Seal of the State of Victoria, at Melbourne, this 3rd day of December 2010.

(L.S.)

DAVID DE KRETSER

Governor

By His Excellency's Command

TED BAILLIEU MP

Premier of Victoria

---



# GOVERNMENT AND OUTER BUDGET SECTOR AGENCIES NOTICES

## ALPINE SHIRE COUNCIL

### Deviation of Road

In pursuant of the powers conferred by section 207E of the **Local Government Act 1989**, the Alpine Shire Council hereby orders that as and from the date of publication in the Government Gazette, the land shown hatched on the plan hereunder, being land taken, purchased or acquired by it and being part of Crown Allotment 10, Lot 1 TP246771 in the Parish of Mullagong, shall be a public highway in lieu of the land in the said Parish shown on the cross-hatched on the said plan.

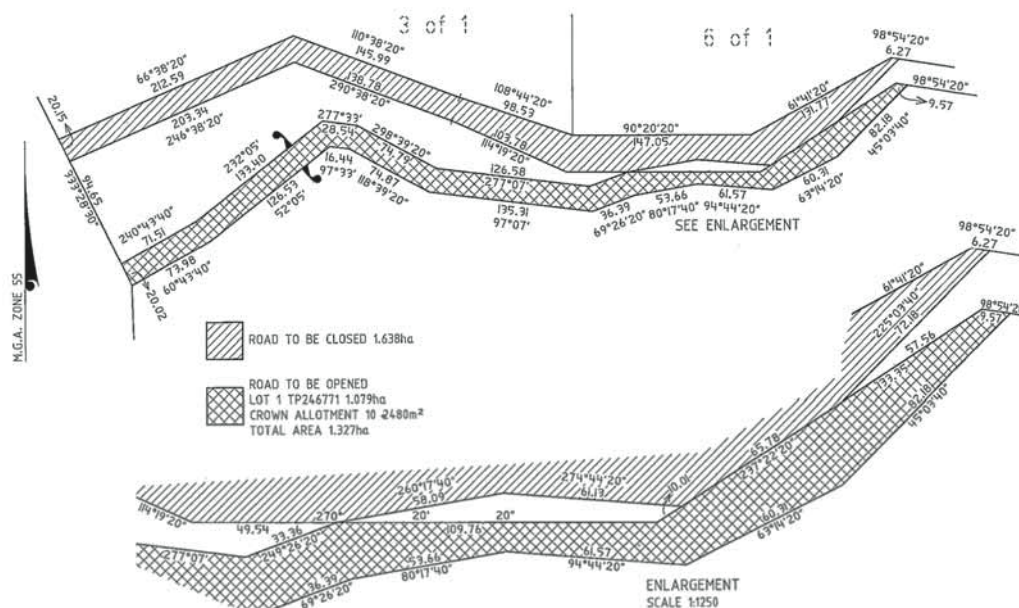

Dated 6 December 2010

IAN NICHOLLS  
CEO

## GREATER SHEPPARTON CITY COUNCIL

## Road Discontinuance

Pursuant to section 206 and clause 3 of schedule 10 of the **Local Government Act 1989**, the Greater Shepparton City Council, at its meeting on 16 November 2010, formed the opinion that the unused road between 3 and 5 Mason Street, Shepparton, shown hatched on the plan below, is not reasonably required as a road for public use and resolved to discontinue the road.

Upon closure, the section of land will be sold to the adjoining property owners and will be consolidated with their respective titles.

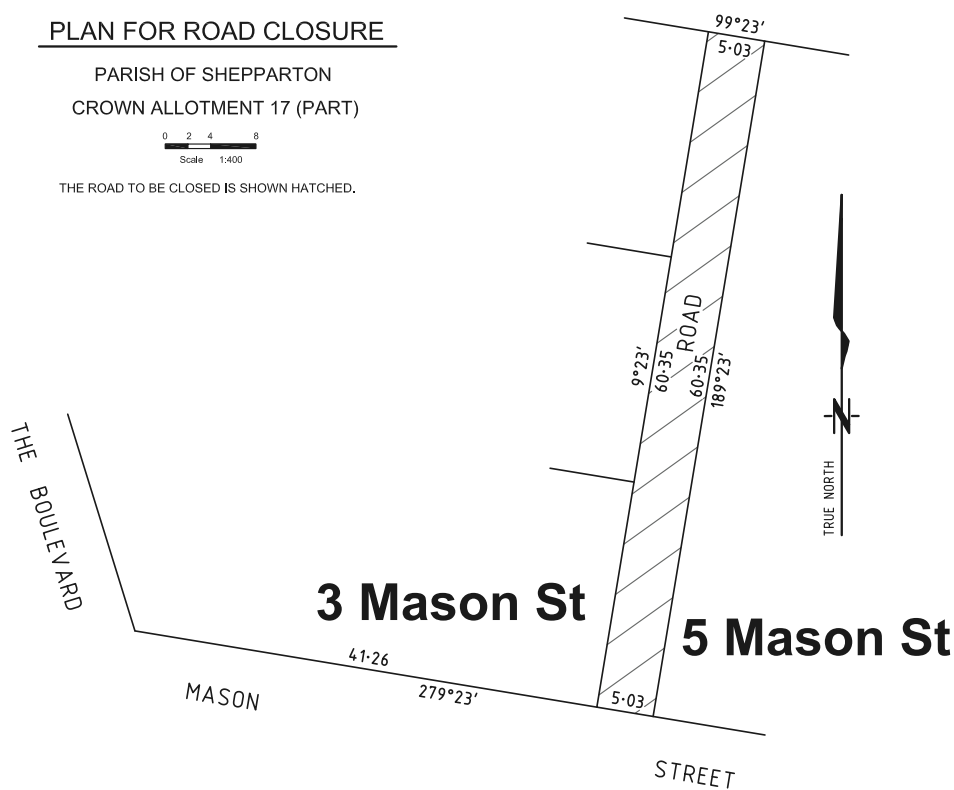

PHILLIP WARREN PEARCE  
Chief Executive Officer



### Notice of Intention to Introduce Alcohol Free Zones in Clarinda and Clayton South

Notice is given that at its meeting on 22 November 2010, Council adopted two new alcohol free zones in Clarinda and Clayton South. It is proposed to introduce 24 hour alcohol free zones in the following locations. These 2 alcohol free zones will commence on 1 January 2011.

1. The south side of Centre Road, including the Clarinda shopping precinct, between west of Arunta Crescent and east of Crawford Road, Clarinda.

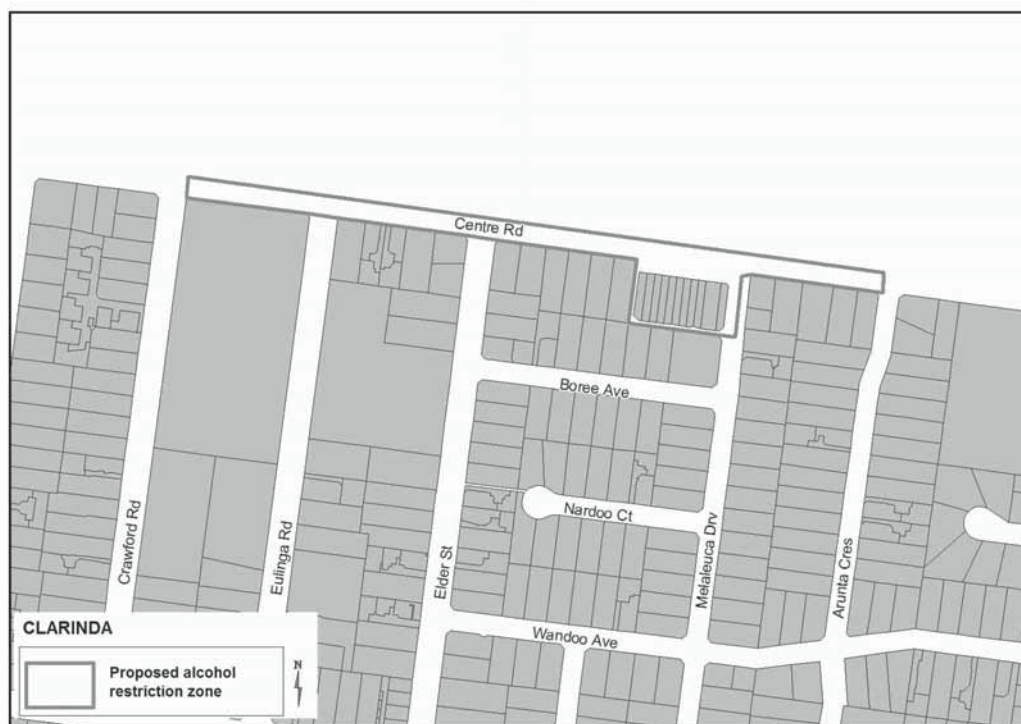

2. The west side of Westall Road and the railway line, south to Fairbank Road, west along Fairbank Road to Brady Avenue, north along Brady Avenue to Rosebank Avenue, east to Moore Avenue, north along Moore Avenue to the railway line, east along the railway line to Westall Road.



A copy of the new alcohol free zones may be inspected at or obtained from the Council office, 1230 Nepean Highway, Cheltenham. Office hours are 8.30 am–5.30 pm Monday to Friday.

JOHN NEVINS  
Chief Executive Officer

**Notice under Domestic Animals Act 1994**

Notice is hereby given that at its meeting held on 22 November 2010, the Council of the City of Kingston has adopted an Order under the provisions of section 26(2) of the **Domestic Animals Act 1994**. This Order will be effective from 1 January 2011.

**1. Dogs must be on leashes**

The owner of the dog must keep attached to the dog a chain, cord or leash and held by the owner when in any public place not designated as an off leash area, school grounds, railway land, or shopping centres where an agreement pursuant to section 26(2A) of the **Domestic Animals Act 1994** is in place in the municipality.

**2. Owners must be equipped to remove dog faeces**

The owner of a dog must not allow any part of that dog's excrement to remain on any public place, school ground, shopping centre or railway land in the municipality. The owner must carry a litter removal device to pick up and remove all of the dog's faeces and must produce the litter removal device upon request of an Authorised Officer.

**3. Owner's obligations**

3.1 A dog may be exercised off a chain, cord or leash in a designated off leash area provided the owner:

- a. Carries a chain, cord or leash, sufficient to bring the dog under effective control if the dog behaves in a manner which threatens any person or animal;
- b. Remains in effective voice or hand control of the dog and within constant sight of the dog so as to be able to promptly place the dog on a chain, cord or leash if that becomes necessary; and
- c. Does not allow the dog to worry, cause a nuisance or threaten any person or animal.

3.2 If a dog is off a chain, cord or a leash in a designated area it must be brought under effective control by means of a chain or cord or a leash if the dog is or likely to be within 20 metres of:

- a. The arena or ground of an organised sporting or practice event
- b. A children's play equipment area
- c. A principal location of an organised public meeting or event
- d. A permanent barbecue or picnic area.

**4. Meaning of words**

In this order

**'Owner'** has the same meaning as the **Domestic Animals Act 1994**; and

**'Designated off leash area'** means any reserves, or part of a reserve, declared by resolution of the Council.

**'Litter removal device'** means an apparatus designed for or able to be used for the purpose of removing dog excrement and includes a paper or plastic bag.

**'Public Place'** means any reserves, or part of a reserve and Road (as defined in the **Local Government Act 1989**).

A copy of the Order may be inspected at or obtained from the Council office, 1230 Nepean Highway, Cheltenham. Office hours are 8.30 am–5.30 pm, Monday to Friday.

JOHN NEVINS  
Chief Executive Officer



Local Law 5 Environment and Amenity

Notice is given that at its meeting on 22 November 2010, the Council of the City of Kingston adopted an amendment to its Local Law 5 Environment and Amenity.

The following information is provided in accordance with section 119 of the **Local Government Act 1989**.

**Purpose of amendment**

Local Law 5 to include a new provision to prescribe the manner in which aerosol spray paint containers are to be stored at the point of sale, in that they are not to be accessible to the public.

**General Purport of amendment**

Control of Sale of Aerosol Paint Containers

The new provision makes it an offence:

For a person who sells aerosol spray paint containers to store or display any aerosol spray paint container containing spray paint in an area accessible to the public.

A copy of Local Law 5 (as amended) may be inspected at or obtained from the Council office, 1230 Nepean Highway, Cheltenham. Office hours are 8.30 am–5.30 pm Monday to Friday.

JOHN NEVINS  
Chief Executive Officer

---

## LATROBE CITY COUNCIL

## Road Discontinuance

Pursuant to section 206 and Schedule 10, Clause 3 of the **Local Government Act 1989**, the Latrobe City Council, at its Ordinary Meeting held on 18 August 2010, formed the opinion that the section of Hinde Road, Tyers, shown hatched on the plan below, being part of the road created on LP 30583 and contained in Certificate of Title Volume 7295 Folio 820, is not reasonably required as a road for public use, and resolved to discontinue the road and exchange the land with the adjoining property owners.

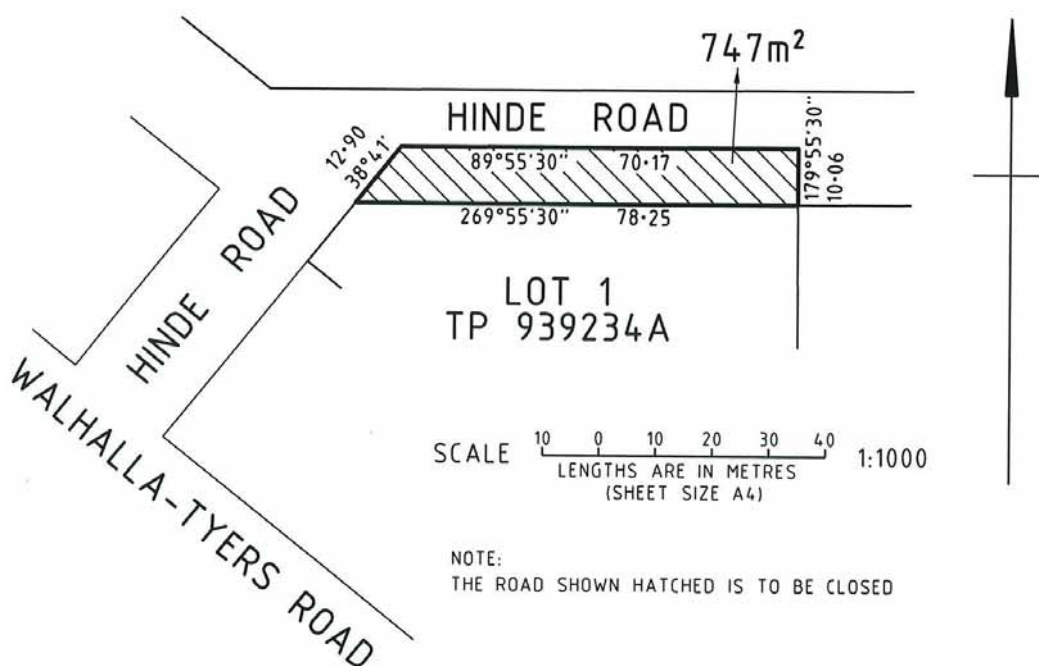

PAUL BUCKLEY  
Chief Executive Officer



## Discontinuance and Sale of Road Reserve adjacent to 223 Eastbourne Road, Rosebud

Pursuant to section 206 and schedule 10, clause 3 of the **Local Government Act 1989**, the Mornington Peninsula Shire Council has formed the opinion that part of the road reserve of Ashenden Square, adjacent to 223 Eastbourne Road, Rosebud, as shown hatched on the plan below, is not reasonably required as a road for public use. The Shire has resolved to discontinue the road and to sell the land by private treaty to the adjoining land-owner for consolidation with the adjoining title.

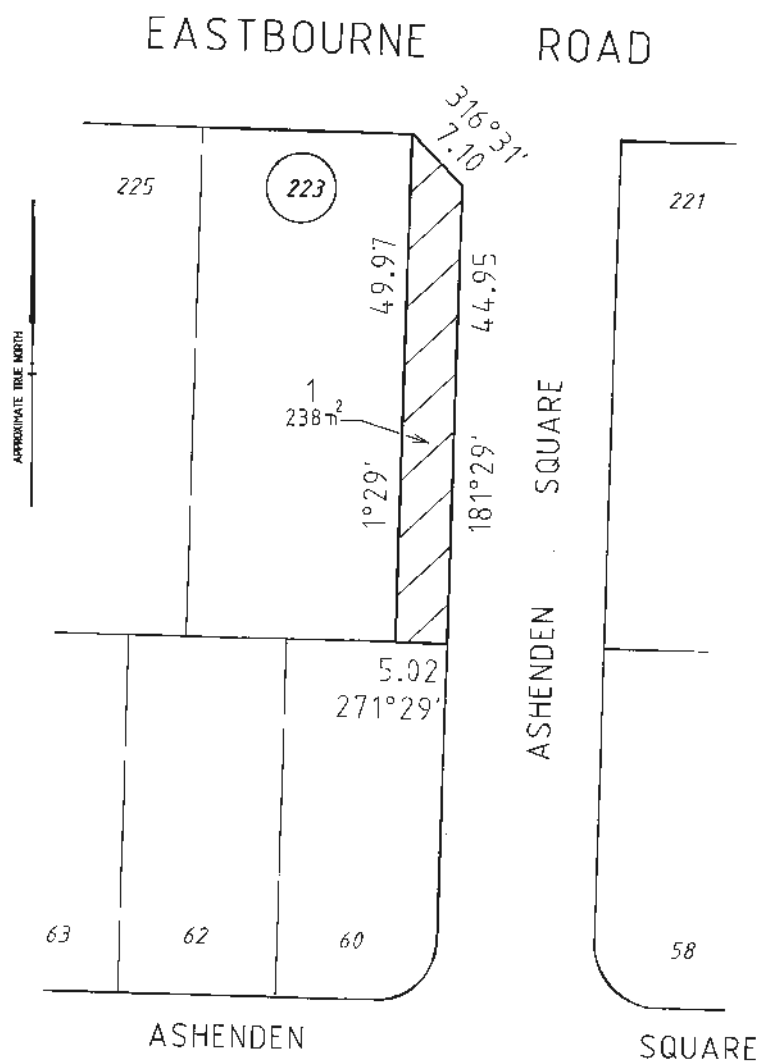

10.009297

DR MICHAEL KENNEDY (OAM)  
Chief Executive Officer



## SURF COAST SHIRE COUNCIL

**Local Government Act 1989**

## Schedule 10 Notice

## Road Discontinued, Road Deviation and Land Exchange

**Definitions:**

In this notice:

**Act** means the **Local Government Act 1989**.

**Council** means Surf Coast Shire Council.

**Owner** means Ronald John McCann, Judith Elaine McVey, Beverley Jean Callan and Herbert William McCann.

**Plan** means the plan included in this notice.

**Private Land** means the land in Certificates of Title Volume 10224 Folio 214 and Volume 10809 Folio 711.

- 1 The Council, in pursuance of its powers under the provisions of clauses 2 and 3 of Schedule 10 and sections 206 and 207B of the Act, and all other powers thereby enabling it, at its meeting held on the 26th day of May 2010 resolved (amongst other matters):
  - 1.1 that the government road shown on the Plan in this notice be discontinued (closed) in part to the extent shown by cross-hatching on the plan;
  - 1.2 that a road deviation (opening of new road) be made through the Private Land to the extent shown by hatching on the Plan; and
  - 1.3 that the land comprised in the parts of the discontinued (closed) road vest in Council as provided in the Act.
- 2 The Council has obtained the consent of the Minister administering the **Land Act 1958** as required by clause 2 of Schedule 10 of the Act and has also given public notice under section 223 of the Act concerning the right of persons to make submissions to Council on the road discontinuance (closure) and road deviation (opening of new road) proposal as well as on the land exchange described in paragraph 5.
- 3 The land comprising the said parts of the discontinued (closed road) vests in fee simple in the Council on the date this notice is published in the Government Gazette as provided in sub-section 207B (1)(b) and (2A) of the Act.
- 4 Section 207C of the Act provides that section 207B does not affect any right, power or interest held by a public authority in a road in connection with any sewers, drains, pipes, wires or cables under the control of the authority in or near the road. The relevant authorities have each advised the Council that they have no assets in the subject parts of the government road discontinued (closed).
- 5 Following the vesting, an exchange of land between Council and the Owner will take place pursuant to section 207E of the Act under which:
  - 5.1 The Owners will become the registered proprietors of the land comprised in the discontinued (closed) parts of the government road (being the part shown cross-hatched) on the Plan abutting the Private Land and being the 'included' land within the meaning of section 207E(2) of the Act; and
  - 5.2 The Council will become the registered proprietor of parts of the adjoining Private Land through which the road deviation (the new road) is made (being the part shown hatched on the plan and being the 'excluded' land within the meaning of section 207E(2)).

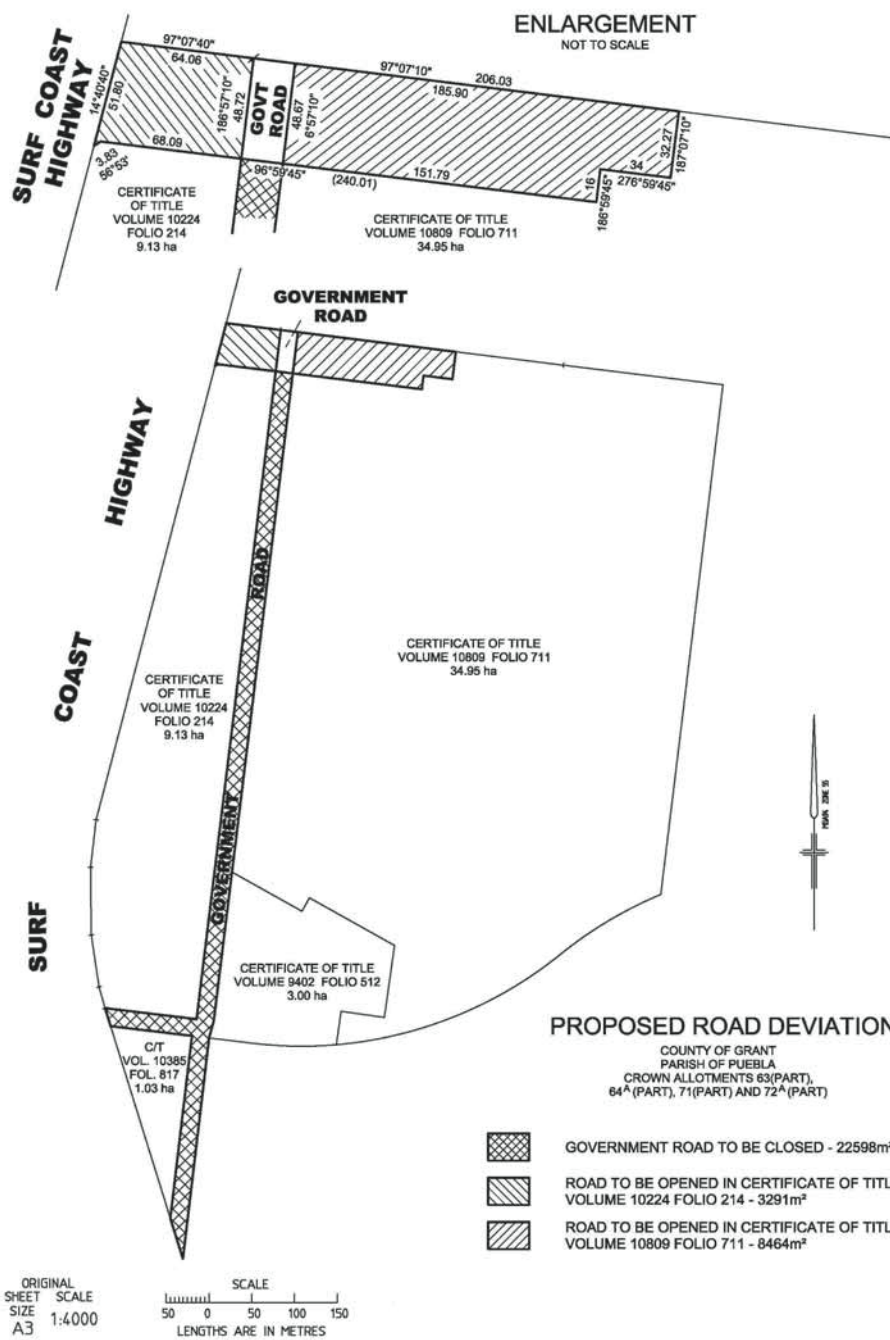

Surf Coast Shire Council  
MARK DAVIES  
Chief Executive Officer



Notice is hereby given that at a meeting of the Mount Alexander Shire Council held on 23 November 2010, the Council resolved to make the following Local Laws:

- Local Law No. 2 of 2010 Roads and Council Land
- Local Law No. 3 of 2010 Environment
- Local Law No. 4 of 2010 Animals
- Local Law No. 5 of 2010 Trading
- Local Law No. 6 of 2010 Fundraising and Events.

Each of the abovementioned Local Laws commenced operation on 23 November 2010 and unless revoked prior, will cease operation on 24 November 2020.

The following information about each of the Local Laws is provided in accordance with section 119(3) of the **Local Government Act 1989**.

**TITLE: LOCAL LAW NO. 2 OF 2010 ROADS AND COUNCIL LAND**

**The purpose of the Local Law**

The purpose of this local law is to provide for the peace order and good governance of the Mount Alexander Shire by:—

1. managing the uses and activities on roads and Council land so that the Council is aware of uses or activities which may:
  - (a) interfere with the safety and convenience of people travelling on or using roads or land;
  - (b) impede free and safe access for people in particular those with sight and movement disabilities;
  - (c) cause damage to Council and community assets;
  - (d) create a danger or expose others to a risk; or
  - (e) be detrimental to the amenity of the area or the enjoyment of facilities on roads or land;
2. identifying activities and uses on roads and Council land where a permit is not required but conditions are applicable to the use so that the purposes identified in sub-clause (1) are achieved;
3. identifying activities and uses that are not permitted on roads and Council land;
4. regulating and controlling activities on roads and Council land in a way that is consistent with the community expectations and demands about their desired lifestyle and the availability of goods and services provided to them; and
5. providing for the administration of the Council's powers and functions.

**The general purport of the Local Law**

The local law:—

- makes it an offence if the following works or activities are carried out without a permit:
  - install construct or alter a temporary vehicle crossing
  - undertake any works or activity on a road or council land such as making a hole or excavation, connecting to or altering a Council drain, fencing off part of a road, erecting a hoarding, scaffolding, using a mobile crane or locating a bulk rubbish container

- planting a tree or placing a structure in or on a nature strip
- carry out landscaping of a nature strip
- repair a vehicle on a road
- remove a tree, vegetation or timber from a road or Council land or erect a sign or hoarding on a road or Council land
- park a vehicle in a restricted parking bay for the purpose of undertaking works.
- makes it an offence for a person not to observe the requirements relating to:
  - temporary vehicle crossings
  - properly constructed vehicle crossings
  - removal of vehicle crossings
  - location of trees, plants or signs
  - display of property numbers
  - use of recreational conveyances e.g. skateboards and roller-skates
  - damaging roads or Council land
  - consumption of alcohol on a road or designated area
  - busking
  - parking a vehicle to carry out works.

TITLE: LOCAL LAW NO. 3 OF 2010 ENVIRONMENT

**The purpose of the Local Law**

The purpose of this local law is to provide for the peace order and good governance of the Mount Alexander Shire by:–

1. managing activities and uses which may be dangerous, cause damage or a nuisance or be detrimental to the amenity of the area and the environment;
2. regulating and controlling activities to maintain a healthy and safe environment in the municipal district for residents and visitors;
3. identifying requirements or conditions that must be observed to ensure that a safe, healthy and enjoyable environment for residents and visitors is maintained; and
4. providing for the administration of the Council's powers and functions.

**The general purport of the Local Law**

The local law:–

- makes it an offence if the following works or activities are carried out without a permit:
  - camping on Council land, public land and private land unless the land or place is designated as a camping area
  - place, establish, erect or occupy any temporary dwelling
  - light an incinerator or fire in the open
  - place a commercial or industrial waste or recycling receptacle on a road or Council land.
- makes it an offence for a person not to observe certain requirements concerning:
  - temporary dwellings
  - disposing of waste and recyclable materials
  - disposing of commercial and industrial trade waste
  - use of scareguns to protect crops.
- makes it an offence to allow or permit land to be kept in a dangerous or unsightly condition or to be detrimental to the general amenity of the neighbourhood.
- makes it an offence not to keep a nature strip in good condition.

## TITLE: LOCAL LAW NO. 4 OF 2010 ANIMALS

**The purpose of the Local Law**

The purpose of this local law is to provide for the peace order and good governance of the Mount Alexander Shire by:—

1. managing activities and uses which may be dangerous, cause a nuisance or be detrimental to the amenity of the area and the environment;
2. regulating and controlling the activities to maintain a healthy and safe environment in the municipal district for residents and visitors;
3. regulating the manner in which the animals are kept and housed and the number of certain animals that may be kept on the property; and
4. providing for the administration of the Council's powers and functions.

**The general purport of the Local Law**

The local Law:—

- makes it an offence if the following activities are carried out without a permit:
  - graze livestock on a road
  - engage in driving livestock on a road
  - keeping or allowing to be kept more than the number of animals specified in the local law.
- makes it an offence for a person not to observe certain requirements concerning:
  - roadside grazing
  - droving livestock on a road
  - transferring livestock by foot on a local road
  - horse riding on a road or Council land
  - the keeping animals including the provision for adequate housing and enclosures
  - the keeping of horses, cattle, sheep, goats or like animals in any yard or enclosed area
  - the keeping of birds.
- makes it an offence for a person not to immediately collect and remove all of the excrement left by an animal of which they are in charge on a road or Council land or in a public place.
- makes it an offence for an owner or occupier of a property not to take all necessary steps to prevent any objectionable animal or bird noise from the property.

## TITLE: LOCAL LAW NO. 5 OF 2010 TRADING

**The purpose of the Local Law**

The purpose of this local law is to provide for the peace order and good governance of the Mount Alexander Shire by:—

1. managing the uses and activities on roads and Council land so that the Council is aware of uses or activities which may:
  - a) interfere with the safety and convenience of people travelling on or using roads or land;
  - b) impede the free and safe access for people, in particular those with sight and movement impairment or disabilities;
  - c) create a danger or expose others to risk; or
  - d) be detrimental to the amenity of the area or the enjoyment of facilities on roads or land;

2. identifying activities and uses on roads and Council land where a permit is not required but conditions are applicable to the use so that the purposes identified in subclause (1) are achieved;
3. identifying activities and uses that are not permitted on roads and Council land;
4. regulating and controlling activities on roads and Council land in a way that is consistent with community expectations and demands about their desired lifestyle and the availability of goods and services provided to them; and
5. providing for the administration of the Council's powers and functions.

**The general purport of the Local Law**

The Local Law:—

- makes it an offence if the following activities are carried out without a permit:
  - place an A-frame advertising sign on a road or in any area designated by the Council
  - display goods on a road
  - place tables, chairs or other equipment used for or in connection with outdoor eating on a road
  - engage in itinerant trading except for the home delivery of newspapers or magazines and goods purchased at another location, home delivery where requested by the owner of the house or the sale of products for fund raising purposes only.
- makes it an offence not to observe the requirements relating to:
  - placing A-frame advertising signs on a road or any area designated by Council
  - displaying goods on a road
  - placing tables, chairs or other equipment used for or in connection with outdoor eating on a road.
- makes it an offence for a person to leave a vehicle on a road or Council land for the purposes of offering such a vehicle for sale or with a 'For Sale' sign displayed on such a vehicle.
- makes it an offence for a person to trade goods or services within the designated trading site of another person trading similar goods or services.

TITLE: LOCAL LAW NO. 6 OF 2010 FUNDRAISING AND EVENTS

**The purpose of the Local Law**

The purpose of this local law is to provide for the peace order and good governance of the Mount Alexander Shire by:—

1. managing the uses and activities on roads and Council land so that the Council is aware of uses or activities which may:
  - (a) interfere with the safety and convenience of people travelling on or using roads or land;
  - (b) impede the free and safe access for people, in particular those with sight and movement impairment or disabilities;
  - (c) be detrimental to the amenity of the area or the enjoyment of facilities on roads or land;
2. identifying activities and uses on roads and Council land where a permit is not required but conditions are applicable to the use so that the purposes identified in subclause (1) are achieved;
3. identifying activities and uses that are not permitted on roads and Council land;
4. regulating and controlling activities on roads and Council land in a way that is consistent with community expectations and demands about their desired lifestyle and the availability of goods and services provided to them; and
5. providing for the administration of the Council's powers and functions.

**The general purport of the Local Law**

The Local Law:—

- makes it an offence if the following activities are carried out without a permit:
  - place an advertising sign on a road, in any area designated by the Council, on a vehicle left standing or parked on a road, or in any other location likely to interfere with the vision of a pedestrian or driver of a vehicle
  - conduct an event which involves the closure or partial closure of a road
  - engage in the collection of money, gifts or subscriptions on a road or Council land or from premise to premises
  - engage in a fundraising activity such as a raffle, sausage sizzle or food stall on a road or Council land.
- makes it an offence not to observe the requirements relating to:
  - placing advertising signs on a road, in any area designated by the Council, on a vehicle left standing or parked on a road, or in any other location likely to interfere with the vision of a pedestrian or driver of a vehicle
  - conducting an event which involves the closure or partial closure of a road
  - engaging in a fundraising activity such as a raffle, sausage sizzle or food stall on a road or Council land.

**LOCAL LAWS NO. 2, 3, 4, 5 AND 6 OF 2010**

Local Laws No. 2, 3, 4, 5 and 6 of 2010 also:

- regulates applications for, and the granting of, permits under the proposed local law;
- regulates the correction, revocation and registration of permits;
- creates an offence for a person who fails to comply with a Notice of Comply;
- empowers an Authorised Officer to impound certain objects;
- empowers an Authorised Officer to issue an infringement notice for contravention of the proposed local law;
- makes it an offence for a person to make a false representation or declaration or to intentionally omit relevant information in an application for a permit or exemption;
- makes it an offence for a person to fail to comply with a permit or any condition in a permit; and
- makes it an offence for a person not to comply with a reasonable direction or instruction of an authorised officer.

A copy of the Local Laws may be inspected or obtained from Council's offices located at 25 Lyttleton Street and 9 Halford Street, Castlemaine, during office hours and may be downloaded from the Council website at [www.mountalexander.vic.gov.au](http://www.mountalexander.vic.gov.au)

---

**MOONEE VALLEY CITY COUNCIL****Declaration of Alcohol Restriction Areas**

Notice is given that at its meeting on 16 November 2010, Council resolved to declare new alcohol restriction areas in accordance with Clause 17 of Council's General Purposes Local Law 2008.

These new alcohol restriction areas (excluding trading premises operating pursuant to Council's Activity Policy) will operate from 9 pm to 9 am throughout the year and in addition, a 24 hour restriction will also apply to roads in the vicinity of major venues and events, such as Moonee Valley Racecourse (Cox Plate), Flemington Racecourse (Spring Racing Carnival) and the Melbourne Showgrounds.

It will be an offence against Council's General Purposes Local Law 2008, to consume or be in possession of an open container of alcohol during the stipulated times, within one of the designated alcohol restriction areas:

**Travancore, Flemington, Moonee Ponds, Essendon**

From Buckley Street along Moonee Ponds Creek and Citylink to Railway line then along Racecourse Road, then along Epsom Road, then along Langs Road, then along Fisher Parade, then along Maribyrnong River, then along Maribyrnong Road, then along Orford Street, then along Burns Street, then along Argyle Street, then along Maribyrnong Road, including Union Road to Athol Street, continuing along Maribyrnong Road to Railway Line and to Buckley Street.

**Essendon, Strathmore**

From Buckley Street along Forbes Street, then along Fletcher Street, then along Hoddle Street, then along Brewster Street, then along Mt Alexander Road to Keilor Road and Bulla Road intersection, including Winifred Street, then along Bulla Road to Citylink, then continuing along Keilor Road, including:

- a) that area bounded by Collins Street, William Street, Richardson Street, Flower Street, to Buckley Street;
- b) that area bounded by Deakin Street, Market Street and Hoffmans Road;
- c) continuing along Keilor Road to Calder Freeway.

**Airport West**

Matthews Avenue (from Keilor Road to Westfield Drive).

**East Keilor**

The Centreway, Wyong Street and Wingara Avenue.

In accordance with section 224A of the **Local Government Act 1989**, any member of Victoria Police is authorised to enforce Clause 17 of Council's General Purposes Local Law 2008.

NEVILLE SMITH  
Chief Executive

**Planning and Environment Act 1987****BRIMBANK PLANNING SCHEME****Notice of Preparation of Amendment****Amendment C93****Authorisation A01741**

The Brimbank City Council has prepared Amendment C93 to the Brimbank Planning Scheme.

In accordance with section 8A(3) of the **Planning and Environment Act 1987**, the Minister for Planning authorised the Brimbank City Council as planning authority to prepare the Amendment.

The land affected by the Amendment includes all land within the municipality.

The Amendment proposes to replace the existing Municipal Strategic Statement (MSS) (Clause 21 of the Brimbank Planning Scheme) with a new format MSS and remove all local policies at Clause 22 with the exception of the Brimbank Heritage Policy which will be renumbered to Clause 22.01.

You may inspect the Amendment, any documents that support the Amendment and the explanatory report about the Amendment, free of charge, at the following locations: during office hours, at the office of the planning authority, Brimbank City Council, Sunshine Harvester Customer Service Centre, 301 Hampshire Road, Sunshine; Brimbank City Council, Keilor Office Customer Service Centre, Municipal Office, Old Calder Highway (corner Borrell Street), Keilor; and at the Department of Planning and Community Development website, [www.dpcd.vic.gov.au/planning/publicinspection](http://www.dpcd.vic.gov.au/planning/publicinspection)



Any person who may be affected by the Amendment may make a submission to the planning authority.

The closing date for submissions is 11 February 2011. A submission must be sent to the Strategic Planning Office, PO Box 70, Sunshine 3020.

NICHOLAS FOA  
Chief Executive Officer

---

**Planning and Environment Act 1987**

**BRIMBANK PLANNING SCHEME**

**Notice of Preparation of Amendment**

**Amendment C133**

**Authorisation A01826**

Brimbank City Council has prepared Amendment C133 to the Brimbank Planning Scheme.

In accordance with section 8A(3) of the **Planning and Environment Act 1987**, the Minister for Planning authorised Brimbank City Council as the planning authority to prepare the Amendment.

The Amendment proposes to:

- apply the Special Building Overlay (SBO) and the Land Subject to Inundation Overlay (LSIO) to land in Brimbank that has been identified by Melbourne Water as being liable to inundation during a severe storm of 1 in 100 year intensity; and
- amend the Schedule to Clause 61.03.

You may inspect the Amendment, any documents that support the Amendment and the explanatory report about the Amendment, free of charge, at the following locations: during office hours, at the office of the planning authority; Brimbank City Council, Sunshine Harvester Customer Service Centre, 301 Hampshire Road, Sunshine; Brimbank City Council, Keilor Office Customer Service Centre Municipal Office, Old Calder Highway (corner Borrell Street), Keilor; and at the Department of Planning and Community Development website, [www.dpcd.vic.gov.au/planning/publicinspection](http://www.dpcd.vic.gov.au/planning/publicinspection)

Any person who may be affected by the Amendment may make a submission to the planning authority.

The closing date for submissions is 11 February 2011. A submission must be sent to the Strategic Planning Office, PO Box 70, Sunshine 3020.

NICHOLAS FOA  
Chief Executive Officer

---

**Planning and Environment Act 1987**

**MOIRA PLANNING SCHEME**

**Notice of Preparation of Amendment**

**Amendment C65**

**Authorisation A01771**

The Moira Shire Council has prepared Amendment C65 to the Moira Planning Scheme.

In accordance with section 9(2) of the **Planning and Environment Act 1987**, the Minister for Planning authorised the Moira Shire Council as planning authority to prepare the Amendment.

The Amendment proposes to correct mapping anomalies in the Planning Scheme and rezones a number of parcels of land affected by dual zonings throughout the municipality.

You may inspect the Amendment, any documents that support the Amendment and the explanatory report about the Amendment, free of charge, at the following locations: during office hours, at the office of the planning authority, Moira Shire Council, 44 Station Street, Cobram 3644; and at the Department of Planning and Community Development website, [www.dpcd.vic.gov.au/planning/publicinspection](http://www.dpcd.vic.gov.au/planning/publicinspection)

Any person who may be affected by the Amendment may make a submission to the planning authority.

The closing date for submissions is 24 January 2011.

A submission must be sent to the Moira Shire, PO Box 578, Cobram 3644.

GARY ARNOLD  
Chief Executive Officer

**Planning and Environment Act 1987****MORNINGTON PENINSULA PLANNING SCHEME**

## Notice of Preparation of Amendment

## Amendment C109

## Authorisation A01746

The Mornington Peninsula Shire Council has prepared Amendment C109 to the Mornington Peninsula Planning Scheme.

In accordance with section 8A(3) of the **Planning and Environment Act 1987**, the Minister for Planning authorised the Mornington Peninsula Shire Council as planning authority to prepare the Amendment.

The land affected by the Amendment is listed in the second column of the table below.

The Amendment proposes to make the changes listed in the third column of the table below.

| Item | Address                                                                                                             | What the Amendment does                                                                                                                                                                                                                                                                                    |
|------|---------------------------------------------------------------------------------------------------------------------|------------------------------------------------------------------------------------------------------------------------------------------------------------------------------------------------------------------------------------------------------------------------------------------------------------|
| 792  | 51–53, 57–67, part 70–80, 85–87 and part 86 Byrnes Road, 1 Steen Avenue, and part of Byrnes Road, Shoreham.         | Applies the Heritage Overlay to: <ul style="list-style-type: none"> <li>the Shoreham village centre precinct (HO343);</li> <li>the ‘Old Post Office’ at 80 Byrnes Road (HO342).</li> </ul> Inserts a reference to the Avenue of Honour within the existing HO35 schedule affecting the former school site. |
| 920  | 1100 Frankston–Flinders Road and part 79 Station Street, Somerville.                                                | Removes interim Heritage Overlay (HO341).                                                                                                                                                                                                                                                                  |
| 942  | Former St Macartan’s Primary School and Convent, 17–31 Tanti Avenue, Mornington.                                    | Applies the Heritage Overlay on various land parcels throughout the Shire.                                                                                                                                                                                                                                 |
| 943  | 2461–2463 and 2465 Point Nepean Road, Rye.                                                                          |                                                                                                                                                                                                                                                                                                            |
| 945  | Spring Farm, 245 Mornington–Tyabb Road, Moorooduc.                                                                  |                                                                                                                                                                                                                                                                                                            |
| 805  | Former RSL Memorial Hall, 250 Point Nepean Road, Dromana.                                                           |                                                                                                                                                                                                                                                                                                            |
| 947  | Shop, 187 Mt Eliza Way, Mount Eliza.                                                                                |                                                                                                                                                                                                                                                                                                            |
| 433  | Woodthorpe area in Rosebud West as shown on exhibited Part of Planning Scheme Map 26DDO.                            | Applies the Vegetation Protection Overlay Schedule 1; and, introduces and applies a new Design and Development Overlay Schedule 17.                                                                                                                                                                        |
| 771  | Land included within Design and Development Overlay – Mount Eliza (North of Tower Road) Development Design (DDO11). | Amends the schedule to Clause 52.01, to require additional open space contributions.                                                                                                                                                                                                                       |

| Item | Address                                                                            | What the Amendment does                                                                                                             |
|------|------------------------------------------------------------------------------------|-------------------------------------------------------------------------------------------------------------------------------------|
| 919  | 18 and 22 Darling Road, Sorrento.                                                  | Rezones 18 Darling Road from a Public Use Zone (PUZ) to a Residential 1 Zone (R1Z) and rezones 22 Darling Road from a R1Z to a PUZ. |
| 935  | Lord Somers Camp, 148 and 159 Lord Somers Road, Somers.                            | Extends the Heritage Overlay (HO302) over the whole camp property.                                                                  |
| 913  | Crown Allotments 16D, 16E, 16F and 16H, Milne Street Bushland Reserve, Crib Point. | Rezones land from a R1Z and a PUZ to a Public Conservation and Resource Zone (PCRZ).                                                |
| 929  | 31 Beach Drive, Hastings.                                                          | Rezones from a PCRZ to a Special Use Zone 1.                                                                                        |

You may inspect the Amendment, any documents that support the Amendment and the explanatory report about the Amendment, free of charge, at the following locations: during office hours, at the office of the planning authority, Mornington Peninsula Shire Council, Hastings Office – 21 Marine Parade, Hastings; Mornington Office – 2 Queen Street, Mornington; Rosebud Office – 90 Besgrove Street, Rosebud; and at the Department of Planning and Community Development website, [www.dpcd.vic.gov.au/planning/publicinspection](http://www.dpcd.vic.gov.au/planning/publicinspection)

Any person who may be affected by the Amendment may make a submission to the planning authority.

The closing date for submissions is Monday 10 January 2011. A submission must be sent to the Manager Strategic Planning, Mornington Peninsula Shire, Private Bag 1000, Rosebud 3939.

ALLAN COWLEY  
Manager Strategic Planning

Creditors, next-of-kin and others having claims against the estate of any of the undermentioned deceased persons are required to send particulars of their claims to State Trustees Limited, ABN 68 064 593 148, 168 Exhibition Street, Melbourne, Victoria 3000, the personal representative, on or before 11 February 2011, after which date State Trustees Limited may convey or distribute the assets, having regard only to the claims of which State Trustees Limited then has notice.

BORDENY, Bruno, late of Terry Barker Nursing Home, Broadford Crescent, Macleod, Victoria 3085, deceased, who died on 11 May 2010.

JONES, Melva Elizabeth, late of The Armitage Manor, 241 Dandenong Road, Windsor, Victoria 3181, deceased, who died on 7 July 2010.

MORRIS, Sydney Hugh, late of Room 7, 'Silverwood', 105 Porter Street, Templestowe, Victoria 3106, pensioner, deceased, who died on 28 July 2010.

PETRANICH, Livio, late of Vonlea Manor Aged Care Facility, 1 Moran Place, Norlane, Victoria 3214, deceased, who died on 26 August 2010.

SEMMENS, Joyce Alma, late of Morrie Evans Wing Nursing Home, 45–53 Coster Street, Benalla, Victoria 3672, deceased, who died on 24 June 2010.

Dated 3 December 2010

ROD SKILBECK  
Manager  
Client Services

Creditors, next-of-kin and others having claims against the estate of any of the undermentioned deceased persons, are required to send particulars of their claims to State Trustees Limited, ABN 68 064 593 148, 168 Exhibition Street, Melbourne, Victoria 3000, the personal representative, on or before 9 February 2011, after which date State Trustees Limited may convey or distribute the assets, having regard only to the claims of which State Trustees Limited then has notice.

EDWARDS, Brian Thomas, late of 23 Luckie Street, Nunawading, Victoria 3131, retired, deceased, who died on 2 October 2010.

KRAUJA, Valdemars, late of 9 Fraser Crescent, Wantirna South, Victoria 3152, pensioner, deceased, who died on 3 September 2010.

MATTHEWS, Kathleen Margaret, formerly of 78 Riversdale Road, Hawthorn, Victoria 3122, but late of St Catherine's Hostel, 1 Clayton Road, Balwyn, Victoria 3103, deceased, who died on 20 March 2010.

PICKERING, Joyce Lexie, late of Karinya Grove Nursing Home, 3 Aberdeen Road, Sandringham, Victoria 3191, pensioner, deceased, who died on 6 November 2010.

SIEVERS, Veronica Mary, late of Anzac Lodge, 10–12 Anzac Avenue, Coburg North, Victoria 3058, retired, deceased, who died on 20 September 2010.

WEE, Peggy Angeline, also known as Peggy Angelina WEE, late of Aberdeen Aged Care Facility, 1 Aberdeen Street, Reservoir, Victoria 3073, pensioner, deceased, who died on 13 September 2010.

Dated 1 December 2010

ROD SKILBECK  
Manager  
Client Services

#### EXEMPTION

Application No. A294/2010

The Victorian Civil and Administrative Tribunal (the Tribunal) has considered an application, pursuant to section 83 of the **Equal Opportunity Act 1995** (the Act), by Cummeragunja Housing and Development Aboriginal Corporation (the applicant). The application for exemption is to enable the applicant to advertise for and employ an Aboriginal person in the position of Trainee Mental Health Worker (the exempt conduct).

Upon reading the material submitted in support of the application, including the affidavit of Julie Calleja, the Tribunal is satisfied that it is appropriate to grant an exemption from sections 13, 100 and 195 of the Act to enable the applicant to engage in the exempt conduct.

In granting this exemption the Tribunal noted:

- The applicant is a community controlled Aboriginal organisation and, through the Viney Morgan Aboriginal Medical Service, provides a medical service. While the

applicant is based in Shepparton, the medical service and this position will be located in Deniliquin.

- The applicant has gained Commonwealth Department of Health and Ageing funding for the above position. That funding is dependent on the person recruited being Aboriginal. The holder of the position will work as part of a multidisciplinary team working towards developing and implementing drug and alcohol services to promote the social and emotional wellbeing of Aboriginal people and the wider community. The position is focused towards activities to prevent and intervene in the development of drug and alcohol and mental health problems.
- The holder of the position will be required to enrol in the Bachelor of Health Science (Mental Health) degree offered at Charles Sturt University. To be admitted to that course the student must have an Aboriginal or Torres Strait Islander background.

The Tribunal hereby grants an exemption to the applicant from the operation of sections 13, 100 and 195 of the Act to enable the applicant to engage in the exempt conduct.

This exemption is to remain in force from the day on which notice of the exemption is published in the Government Gazette until 1 December 2013.

Dated 29 November 2010

A. DEA  
Member

#### EXEMPTION

Application No. A314/2010

The Victorian Civil and Administrative Tribunal (the Tribunal) has considered an application, pursuant to section 83 of the **Equal Opportunity Act 1995** (the Act), by Pines Community Men's Shed Inc. (the applicant). The application for exemption is to enable the applicant to limit membership of the applicant to males only, to provide services to men only and to advertise those matters (the exempt conduct).

Upon reading the material submitted in support of the application, including the affidavit of John Holmes, the Tribunal is satisfied that it is appropriate to grant an exemption from sections 42, 59 and 195 of the Act to enable the applicant to engage in the exempt conduct.

In granting this exemption the Tribunal noted:

- The applicant is a not-for-profit incorporated association which, at the time of the application, is run by a committee of all men and which has only males as members.
- The purposes of the applicant include: encouraging social inclusion and participation for men of all ages living in Frankston North and surrounding areas by maintaining a Men's Shed; providing recreational opportunities for men including activities, entertainment and use of facilities; providing men with opportunities to contribute to their local community, learn and share new skills, make friends and network; providing information on men's health issues and seeking to address isolation, loneliness and depression; to focus on the cultural memories and traditions for the betterment of men of all ages, in particular through the Australian cultural tradition of the backyard shed, where men traditionally engaged in practical and creative pursuits; and encouraging mateship, communication and a sense of self-worth by connecting men with each other by sharing practical and creative skills in a non-threatening environment.
- The applicant intends to target vulnerable, disadvantaged and isolated men, including men with disabilities and those experiencing major life changes, including family breakdown. Many isolated and disadvantaged men struggle to relate to women and feel uncomfortable in their presence. These feelings can limit the attendance of men.
- The applicant believes that it is important for the benefit of isolated men and the community generally that vulnerable men are empowered by having ownership and control of the Pines Community Men's Shed and this can only be achieved by the exclusion of women from membership of the incorporated association and its committee.

The Tribunal hereby grants an exemption to the applicant from the operation of sections 42, 59 and 195 of the Act to enable the applicant to engage in the exempt conduct.

This exemption is to remain in force from the day on which notice of the exemption is published in the Government Gazette until 1 December 2013.

Dated 29 November 2010

A. DEA  
Member

## EXEMPTION

Application No. A317/2010

The Victorian Civil and Administrative Tribunal (the Tribunal) has considered an application, pursuant to section 83 of the **Equal Opportunity Act 1995** (the Act), by Songlines Aboriginal Music Corporation (the applicant). The application for exemption is to enable the applicant to advertise for and employ a person of Aboriginal or Torres Strait Islander background to the position of Chief Executive Officer (the exempt conduct).

Upon reading the material submitted in support of the application, including the affidavit of Justin Coburn, the Tribunal is satisfied that it is appropriate to grant an exemption from sections 13, 100 and 195 of the Act to enable the applicant to engage in the exempt conduct.

In granting this exemption the Tribunal noted that:

- The applicant is a Victorian based Aboriginal controlled and run state-wide peak music body that has supported Indigenous musicians in Victoria for more than a decade. The applicant represents and promotes the interests of established musicians, organises festivals and events, runs music programs for youth and provides support and avenues through which young and new artists may emerge.
- The Chief Executive Officer has responsibility for strategic planning and organisational development, financial management and administration, fundraising and liaising with all funding bodies, governance, public relations and communications and staff recruitment, development, training and support.
- The position holder must be able to communicate with diverse stakeholders to build partnerships. In addition, the position holder must be able to demonstrate an understanding of Aboriginal culture and issues. As the applicant is an Aboriginal controlled and run organisation it is preferable that the Chief Executive Officer is of Aboriginal or Torres Strait Islander background.

The Tribunal hereby grants an exemption to the applicant from the operation of sections 13, 100 and 195 of the Act to enable the applicant to engage in the exempt conduct.

This exemption is to remain in force from the day on which notice of the exemption is published in the Government Gazette until 8 December 2013.

Dated 6 December 2010

A. DEA  
Member**Agricultural and Veterinary Chemicals  
(Control of Use) Act 1992**APPOINTMENT OF  
AUTHORISED OFFICERS

I, Anthony Gerard Britt, Manager Animal Standards in the Department of Primary Industries, pursuant to the powers, duties and functions given to me by a delegation under section 74 of the **Agricultural and Veterinary Chemicals (Control of Use) Act 1992** and of my respective powers to appoint authorised officers under section 53 of the **Agricultural and Veterinary Chemicals (Control of Use) Act 1992**, hereby appoint the following persons employed in the Public Service, as authorised officers for the purposes of all of the provisions of the **Agricultural and Veterinary Chemicals (Control of Use) Act 1992** and any Regulation or Order made under this Act. These appointments remain in force until revoked or until 30 June 2012.

Name of person:

Kirsty Anne Fraser

Leanne Horstman

Elizabeth Caroline Alsop

James Barry Walsh

Simon Andrew Hall

William Michael Forsyth

Dated 25 November 2010

ANTHONY GERARD BRITT  
Manager Animal Standards**Livestock Disease Control Act 1994**

## APPOINTMENT OF INSPECTORS

I, Anthony Gerard Britt, Manager Animal Standards in the Department of Primary Industries, pursuant to the powers, duties and functions given to me by a delegation under section 103 of the **Livestock Disease Control Act 1994** and of my respective powers to appoint

inspectors under section 108 of the **Livestock Disease Control Act 1994**, hereby appoint the following persons, who hold positions under the provisions of the **Public Administration Act 2004**, as inspectors for the purposes of all of the provisions of the **Livestock Disease Control Act 1994** and in respect of all livestock. These appointments remain in force until revoked or until 30 June 2012.

Name of person:

Kirsty Anne Fraser

Leanne Horstman

Elizabeth Caroline Alsop

James Barry Walsh

Simon Andrew Hall

William Michael Forsyth

Dated 25 November 2010

ANTHONY GERARD BRITT  
Manager Animal Standards

---

**Prevention of Cruelty to Animals Act 1986**  
APPROVAL OF GENERAL INSPECTORS

I, Hugh Warwick Chorley Millar, Executive Director Biosecurity Victoria in the Department of Primary Industries, pursuant to the powers, duties and functions given to me by a delegation under section 38 of the **Prevention of Cruelty to Animals Act 1986** and of my respective powers to approve inspectors under section 18 of the **Prevention of Cruelty to Animals Act 1986**, hereby approve the following persons, who are inspectors of livestock under the provisions of the **Livestock Disease Control Act 1994**, as general inspectors for the purposes of Part 2A and Part 3A of the **Prevention of Cruelty to Animals Act 1986**. These approvals remain in force until revoked or until 30 June 2012.

Name of person:

Kirsty Anne Fraser

Leanne Horstman

Elizabeth Caroline Alsop

James Barry Walsh

Simon Andrew Hall

William Michael Forsyth

Dated 29 November 2010

HUGH WARWICK CHORLEY MILLAR  
Executive Director Biosecurity Victoria

**Associations Incorporation Act 1981**

SUB-SECTION 36E(5)

Notice is hereby given that the incorporation of the associations mentioned below is cancelled in accordance with section 36E(5) of the **Associations Incorporation Act 1981**.

Roof Over Our Families Inc.; Australian Chaoshan Society of Mel Inc.; Hidden Angels Australia Inc.; Parsons Pavilion Committee of Management Inc.; Dobell Avenue Kindergarten Inc.; Plenty Players Inc.; Future Environment Association Inc.; Heathcote Vignerons Association Inc.; Eureka Tile Social Club Inc.; The Big Switch Off Inc.; The North Star Hotel Social Club Inc.; Corporate Social Responsibility Australia Inc.; Nathalia and District Amateur Basketball Association Inc.; Ballarat Y.M.C.A. Camera Group Inc.; Parents of Hearing Impaired Children, Victorian Federation Inc.; Serbian Social Recreation Club Banija Inc.; Shepparton Junior Cricket Association Inc.; Montessori Association of Victoria Inc.; Monash Ratepayers Association Inc.; Just Add Water Swimming Club Inc.; Longbeach Life Activities Club Inc.; Millgrove Community Garden Inc.; Lavers Hill & Districts Pre School Inc.; BMX Benalla Club Inc.; The Australian Hydroponics Suppliers/Manufactures Association Inc.; Campmeadows Kindergarten Inc.; Southern & Western Combined Churches Cricket Association Incorporated; Geelong Churches Cricket Association Inc.; One Earth Alliance Inc.; Ararat Advisory and Assistance Centre Inc.; Petrel Hotel Golf Club Inc.; Royal Claytons Golf Club Inc.; Blue Duck Hotel Social Club Inc.; Women Sustainable Energy & Environment Inc.; Medicine Uncharted Inc.; Kerang Table Tennis Association Inc.

Dated this day 9 December 2010

DAVID BETTS  
Deputy Registrar of  
Incorporated Associations  
PO Box 4567  
Melbourne, Victoria 3001

---

**Associations Incorporation Act 1981**

SUB-SECTION 36E(5)

Notice is hereby given that the incorporation of the associations mentioned below is cancelled in accordance with section 36E(5) of the **Associations Incorporation Act 1981**.

Hellenic Independent Theatre of Melbourne  
Australia Inc.; 'Thiasos Parikia' Inc.

Dated this day 9 December 2010

DAVID BETTS  
Deputy Registrar of  
Incorporated Associations  
PO Box 4567  
Melbourne, Vic. 3001

#### **Children's Services Act 1996** NOTICE OF EXEMPTION

Pursuant to section 29A of the **Children's Services Act 1996** (the Act), I declare that children's services listed below are exempt from the requirements of regulation 54(b) of the Children's Services Regulations 2009 (the Regulations):

- Booroondara Park Primary OSHClub, licence ID 12095
- Balwyn North Primary School OSHClub, licence ID 12374
- Kialla West Primary School OSHC, licence ID 12382
- Bannockburn Primary School OSHC – Extend, licence ID 12498.

This exemption remains in force until 1 February 2011 unless revoked earlier.

Dated 30 November 2010

PETER DAWKINS  
Secretary  
Department of Education and  
Early Childhood Development

#### **Co-operatives Act 1996**

##### KISMET PARK BUILDING PROJECT NUMBER 1 CO-OPERATIVE LTD

On application under section 314 of the **Co-operatives Act 1996** (the Act) and Parts 5.4 to 5.7 of the **Corporations Act 2001** by the co-operative named above, notice is hereby given that a special resolution in favour of voluntary wind up was passed and that the co-operative listed above will be removed from the register of co-operatives and the registration will be dissolved.

Dated at Melbourne 6 December 2010

DAVID BETTS  
Deputy Registrar of Co-operatives

#### **Country Fire Authority Act 1958**

##### DECLARATION OF FIRE DANGER PERIOD 2010/2011

In pursuance of the powers conferred by section 4 of the **Country Fire Authority Act 1958**, I, Mick Bourke, Chief Executive Officer of the Country Fire Authority, after consultation with the Secretary to the Department of Sustainability and Environment, hereby declare the following periods to be the Fire Danger Period in the municipal districts of the municipalities or parts of municipalities specified, commencing on the dates shown and, unless varied by subsequent declaration, ending at 0100 hours on 1 May 2011.

To commence from 0100 hours on 13 December 2010:

Buloke Shire (remainder)

Loddon Shire Council

Campaspe Shire Council

MICK BOURKE  
Chief Executive Officer

#### **Electricity Industry Act 2000**

##### NOTIFICATION OF DETERMINATION BY THE ESSENTIAL SERVICES COMMISSION

The Essential Services Commission has determined that the proposed interest to be acquired by GDF SUEZ S.A. in International Power Plc is not a prohibited interest for the purposes of section 68(2), (3) or (4) of the **Electricity Industry Act 2000** (EI Act).

Under section 68(8)(b)(ii) of the EI Act, the Essential Services Commission has determined that it is satisfied that the Australian Competition and Consumer Commission (ACCC) has considered the proposed acquisition, and that the ACCC has notified GDF SUEZ S.A. that it does not intend to review the acquisition of the interest under section 50 of the **Trade Practices Act 1974** (Cth).

A copy of the Determination is available on the Commission's website located at <http://www.esc.vic.gov.au> or a copy can be obtained by calling the Commission's reception on (03) 9651 0222.

Dated 2 December 2010

DR RON BEN-DAVID  
Chairperson



**Heritage**  
VICTORIA**Heritage Act 1995**

NOTICE UNDER SECTION 88 OF  
THE **HERITAGE ACT 1995**  
REGARDING  
COVENANT PURSUANT TO SECTION 85  
OF THE **HERITAGE ACT 1995**  
HERITAGE PLACE NO. H1002

Royal Victorian Institute for the Blind,  
557–563 St Kilda Road and  
1–23 Moubray Street, Melbourne (Lot 2)

It is proposed that the Heritage Council of Victoria enter into a Covenant pursuant to section 85(1) of the **Heritage Act 1995** in relation to the above Heritage Place with Stockland Development Pty Ltd, the owner of the above Heritage Place.

The Covenant will bind the owner of the above Heritage Place to the development, use or conservation of the Heritage Place in accordance with the terms of the Covenant.

H1002 Royal Victorian Institute for the Blind,  
557–563 St Kilda Road, Melbourne.

Under the **Heritage Act 1995**.

Date of covenant:

Between Stockland Development Pty Ltd and  
Heritage Council.

Agreement: Maintain the ongoing conservation and repair of heritage infrastructure in accordance with the Heritage Infrastructure and Landscape Management Plan (Lot 2).

The form of the Covenant is viewable at the offices of Heritage Victoria, Level 4 of 55 Collins Street, Melbourne, telephone 03 8644 8800, during business hours.

Any person wishing to make a written submission in response to the Covenant should write to the Executive Director, Heritage Victoria care of the above address within 28 days of the publication of this notice.

JIM GARD'NER  
Executive Director  
Heritage Victoria

**Heritage**  
VICTORIA**Heritage Act 1995**

NOTICE UNDER SECTION 88 OF  
THE **HERITAGE ACT 1995**  
REGARDING  
COVENANT PURSUANT TO SECTION 85  
OF THE **HERITAGE ACT 1995**  
HERITAGE PLACE NO. H1002

Royal Victorian Institute for the Blind,  
557–565 St Kilda Road and  
1–23 Moubray Street, Melbourne (Lot 1)

It is proposed that the Heritage Council of Victoria enter into a Covenant pursuant to section 85(1) of the **Heritage Act 1995** in relation to the above Heritage Place with Stockland Development Pty Ltd, the owner of the above Heritage Place.

The Covenant will bind the owner of the above Heritage Place to the development, use or conservation of the Heritage Place in accordance with the terms of the Covenant.

H1002 Royal Victorian Institute for the Blind,  
557–565 St Kilda Road, Melbourne.

Under the **Heritage Act 1995**.

Date of covenant:

Between Stockland Development Pty Ltd and  
Heritage Council.

Agreement: Maintain the ongoing conservation and repair of heritage infrastructure and landscape in accordance with the Heritage Infrastructure and Landscape Management Plan (Lot 1).

The form of the Covenant is viewable at the offices of Heritage Victoria, Level 4 of 55 Collins Street, Melbourne, telephone 03 8644 8800, during business hours.

Any person wishing to make a written submission in response to the Covenant should write to the Executive Director, Heritage Victoria care of the above address within 28 days of the publication of this notice.

JIM GARD'NER  
Executive Director  
Heritage Victoria



### Heritage Act 1995

#### NOTICE OF REGISTRATION

As Executive Director for the purpose of the **Heritage Act 1995**, I give notice under section 46 that the Victorian Heritage Register is amended by including the Heritage Register Number 2242 in the category described as Heritage Place.

Former Leitrim Hotel  
128–130 Little Lonsdale Street  
Melbourne  
Melbourne City

#### EXTENT

1. All of the building marked B1 on Diagram 2242 held by the Executive Director.
2. All of the land marked L1 on Diagram 2242 held by the Executive Director being all of Lot 1 on Title Plan 419418.

Dated 9 December 2010

JIM GARD'NER  
Executive Director



### Heritage Act 1995

#### NOTICE OF REGISTRATION

As Executive Director for the purpose of the **Heritage Act 1995**, I give notice under section 46 that the Victorian Heritage Register is amended by including the Heritage Register Number 2262 in the category described as Heritage Place.

Queen Victoria Park  
High Street and Sydney Road  
Beechworth  
Indigo Shire

#### EXTENT

1. All the buildings marked as follows on Diagram 2262 held by the Executive Director.
  - B1 Rotunda
  - B2 Stone Picnic Shelter
  - B3 Stone Toilet
  - B4 Ex-army Hut

2. All the features marked as follows on Diagram 2262 held by the Executive Director.
  - F1 Remnant Bowling and Croquet Lawn
  - F2 Two Cannons
  - F3 Rock
  - F4 Commemorative Plaque
  - F5 Open Air Theatre Screen Base
  - F6 Quarry Remnants
  - F7 Lamp Posts
3. All the paths marked as P1 on Diagram 2262 held by the Executive Director.
4. All of the land marked L1 on Diagram 2262 held by the Executive Director being all of Crown Allotment 4, Section 23, Township of Beechworth, and part of the road reserve of Ford Street.

Dated 9 December 2010

JIM GARD'NER  
Executive Director



### Heritage Act 1995

#### NOTICE OF REGISTRATION

As Executive Director for the purpose of the **Heritage Act 1995**, I give notice under section 46 that the Victorian Heritage Register is amended by including the Heritage Register Number 2260 in the category described as Heritage Place.

Benalla Botanical Gardens  
Bridge Street West  
Benalla  
Benalla Rural City

#### EXTENT

1. All the buildings marked as follows on Diagram 2260 held by the Executive Director.
  - B1 Band Rotunda
  - B2 Grandstand
2. All the features marked as follows on Diagram 2260 held by the Executive Director.
  - F1 Sports Oval
  - F2 Main Entrance Gates

- F3 War Memorial  
 F4 Rose Gardens  
 F5 Tennis Courts and Club House Facilities  
 F6 Cannon  
 F7 Weary Dunlop Memorial  
 F8 Avenue of Honour Memorial
3. All the paths marked as follows on Diagram 2260 held by the Executive Director.
  4. All of the land marked L1 on Diagram 2260 held by the Executive Director being part of Crown Allotment 14 and all of Crown Allotment 15, Section 7A, Township of Benalla, and all of Crown Allotments 4, 5 and 6, Section K1, Township of Benalla, and part of the road reserve of the Midland Highway.

Dated 9 December 2010

JIM GARD'NER  
 Executive Director



#### Heritage Act 1995

##### NOTICE OF REGISTRATION

As Executive Director for the purpose of the **Heritage Act 1995**, I give notice under section 46 that the Victorian Heritage Register is amended by including the Heritage Register Number 2259 in the category described as Heritage Place.

Colac Botanic Gardens  
 1-5 Fyans Street  
 Colac  
 Colac Otway Shire

##### EXTENT

1. All the buildings marked as follows on Diagram 2259 held by the Executive Director.
  - B1 Former curator's residence (now café)
  - B2 Old brick toilet block
2. All the features marked as follows on Diagram 2259 held by the Executive Director.
  - F1 Bilson gates at Gellibrand Street entrance
  - F2 Terraces
  - F3 Lily pond
  - F4 Cannon

3. The circular driveway and paths marked P1 on Diagram 2259 held by the Executive Director.
4. All of the land marked L1 on Diagram 2259 held by the Executive Director being parts of Crown Allotment 25B and 25C, Township of Colac, and part of Crown Allotment 62A, Parish of Colac.

Dated 9 December 2010

JIM GARD'NER  
 Executive Director

#### Mineral Resources (Sustainable Development) Act 1990

##### DEPARTMENT OF PRIMARY INDUSTRIES

##### Exemption of Land from an Exploration or Mining Licence

I, David Boothroyd, Manager Earth Resources Tenements, pursuant to section 7 of the **Mineral Resources (Sustainable Development) Act 1990** and under delegation from the Minister for Energy and Resources, hereby exempt all that Crown land situated within the boundaries of exploration application 5327 from being subject to an exploration licence and a mining licence.

Dated 1 December 2010

DAVID BOOTHROYD  
 Manager Earth Resources Tenements  
 Earth Resources Regulation Branch



#### Land Act 1958

##### NORTH EAST REGION WATER CORPORATION (NORTH EAST WATER)

Proposed Lease to  
 North East Region Water Corporation  
 CA 2010, No Sec., Parish of Gibbo  
 off Dartmouth Road, Dartmouth

Notice is hereby given that North East Region Water Corporation has applied for a lease pursuant to section 134 of the **Land Act 1958** for term of 21 years in respect of Crown Allotment 2010, Parish of Gibbo, for the purposes of 'Construction, maintenance and operation of a Water storage and Water treatment facility'.

File Ref: 2018541 Wodonga.

**Land Acquisition and Compensation Act 1986**  
FORM 7

S. 21(a)  
Reg. 16

Notice of Acquisition

Compulsory Acquisition of Interest in Land

The Roads Corporation (VicRoads) declares that by this notice it acquires the following interest in the land described as part of Lot 1 on Title Plan 128518H Parish of Duneed, comprising 3,476 square metres and being part of the land described in Certificate of Title Volume 7756 Folio 028 shown as Parcel 82 on Survey Plan 22259.

**Interest Acquired:** That of Kerry Maxine Reed and all other interests.

Published with the authority of VicRoads.

For and on behalf of VicRoads

Signed TIM PONTEFRAC

Name Tim Pontefract

Dated 9 December 2010

**Land Acquisition and Compensation Act 1986**  
FORM 7

S. 21(a)  
Reg. 16

Notice of Acquisition

Compulsory Acquisition of Interest in Land

The Roads Corporation (VicRoads) declares that by this notice it acquires the following interest in the land described as part of Lot 3 on Plan of Subdivision 144500 Parish of Modewarre, comprising 1.421 hectares and being land described in Certificate of Title Volume 9565 Folio 093 shown as Parcel 51 on Survey Plan 22273.

**Interest Acquired:** That of Groves Properties Pty Ltd and all other interests.

Published with the authority of VicRoads.

For and on behalf of VicRoads

Signed TIM PONTEFRAC

Name Tim Pontefract

Dated 9 December 2010

**Land Acquisition and Compensation Act 1986**  
FORM 7

S. 21(a)  
Reg. 16

Notice of Acquisition

Compulsory Acquisition of Interest in Land

The Roads Corporation (VicRoads) declares that by this notice it acquires the following interest in the land described as Lot 1 on Plan of Subdivision 338718Q and part of Lot 1 on 338719N, Parish of Duneed, comprising 3.384 hectares and being land described in Certificate of Title Volume 10297 Folio 141 and Certificate of Title Volume 10324 Folio 819 shown as Parcels 21 and 22 on Survey Plan 22256.

**Interest Acquired:** That of Neil Rex Clark and Leona Frances Clark and all other interests.

Published with the authority of VicRoads.

For and on behalf of VicRoads

Signed TIM PONTEFRAC

Name Tim Pontefract

Dated 9 December 2010

**Land Acquisition and Compensation Act 1986**  
FORM 7

S. 21(a)  
Reg. 16

Notice of Acquisition

Compulsory Acquisition of Interest in Land

The Roads Corporation (VicRoads) declares that by this notice it acquires the following interest in the land described as part of Lot 4 on Plan of Subdivision 58589 Parish of Modewarre, comprising 2.247 hectares and being land described in Certificate of Title Volume 8530 Folio 394 shown as Parcel 41 on Survey Plan 22272.

**Interest Acquired:** That of Peter Joseph Chudek and Elizabeth Theresa Chudek and all other interests.

Published with the authority of VicRoads.

For and on behalf of VicRoads

Signed TIM PONTEFRAC

Name Tim Pontefract

Dated 9 December 2010

**Land Acquisition and Compensation Act 1986**  
FORM 7S. 21(a)  
Reg. 16

## Notice of Acquisition

## Compulsory Acquisition of Interest in Land

The Roads Corporation (VicRoads) declares that by this notice it acquires the following interest in the land described as part of Lot 1 on Plan of Subdivision 331581E Parish of Lake Lake Wollard, comprising 2460 square metres and being land described in Certificate of Title Volume 10267 Folio 792 shown as Parcel 61 on Survey Plan 22275.

**Interest Acquired:** That of Trevor Shane Chandler, Carolyn Ann Chandler, Benjamin William McIntyre, Louise Nicole Chandler and all other interests.

Published with the authority of VicRoads.

For and on behalf of VicRoads

Signed TIM PONTEFRACT

Name Tim Pontefract

Dated 9 December 2010

**Land Acquisition and Compensation Act 1986**  
FORM 7S. 21(a)  
Reg. 16

## Notice of Acquisition

## Compulsory Acquisition of Interest in Land

The Roads Corporation (VicRoads) declares that by this notice it acquires the following interest in the land described as part of Lot 1 on Title Plan 817617P Parish of Lake Lake Wollard, comprising 3170 square metres and being land described in Certificate of Title Volume 10126 Folio 967 shown as Parcel 91 on Survey Plan 22278.

**Interest Acquired:** That of Norman Lester Boddington and all other interests.

Published with the authority of VicRoads.

For and on behalf of VicRoads

Signed TIM PONTEFRACT

Name Tim Pontefract

Dated 9 December 2010

**Land Acquisition and Compensation Act 1986**  
FORM 7S. 21(a)  
Reg. 16

## Notice of Acquisition

## Compulsory Acquisition of Interest in Land

The Roads Corporation (VicRoads) declares that by this notice it acquires the following interest in the land described as part of Lot 3 on Plan of Subdivision 330319Y Parish of Duneed, comprising 1.102 hectares and being land described in Certificate of Title Volume 10191 Folio 867 shown as Parcel 1 on Survey Plan 22255.

**Interest Acquired:** That of Keith Frank Richard Larcombe and Beverley Dawn Larcombe and all other interests.

Published with the authority of VicRoads.

For and on behalf of VicRoads

Signed TIM PONTEFRACT

Name Tim Pontefract

Dated 9 December 2010

**Land Acquisition and Compensation Act 1986**  
FORM 7S. 21(a)  
Reg. 16

## Notice of Acquisition

## Compulsory Acquisition of Interest in Land

The Roads Corporation (VicRoads) declares that by this notice it acquires the following interest in the land described as part of Lot 1 on Plan of Subdivision 507538C Parish of Lake Lake Wollard, comprising 1.726 hectares and being land described in Certificate of Title Volume 10705 Folio 172 shown as Parcel 116 on Survey Plan 22281.

**Interest Acquired:** That of Rosalie Faye Guye and all other interests.

Published with the authority of VicRoads.

For and on behalf of VicRoads

Signed TIM PONTEFRACT

Name Tim Pontefract

Dated 9 December 2010

**Land Acquisition and Compensation Act 1986**  
FORM 7

S. 21(a)  
Reg. 16

Notice of Acquisition

Compulsory Acquisition of Interest in Land

The Roads Corporation (VicRoads) declares that by this notice it acquires the following interest in the land described as part of Crown Allotment B of Section 4 of Parish of Duneed, comprising 1.693 hectares and being land described in Certificate of Title Volume 11232 Folio 352 shown as Parcel 3 on Survey Plan 22301B.

**Interest Acquired:** That of Donald Percy Larcombe and all other interests.

Published with the authority of VicRoads.

For and on behalf of VicRoads

Signed TIM PONTEFRACT

Name Tim Pontefract

Dated 9 December 2010

**Land Acquisition and Compensation Act 1986**  
FORM 7

S. 21(a)  
Reg. 16

Notice of Acquisition

Compulsory Acquisition of Interest in Land

The Roads Corporation (VicRoads) declares that by this notice it acquires the following interest in the land described as part of Lot 1 on Title Plan 017233U Parish of Duneed, comprising 1073 square metres and being land described in Certificate of Title Volume 10509 Folio 267 shown as Parcel 2 on Survey Plan 22301B.

**Interest Acquired:** That of Robert Joseph Hegyesi and Maria Hegyesi and all other interests.

Published with the authority of VicRoads.

For and on behalf of VicRoads

Signed TIM PONTEFRACT

Name Tim Pontefract

Dated 9 December 2010

**Land Acquisition and Compensation Act 1986**  
FORM 7

S. 21(a)  
Reg. 16

Notice of Acquisition

Compulsory Acquisition of Interest in Land

The Roads Corporation (VicRoads) declares that by this notice it acquires the following interest in the land described as Part of Crown Portion 5, Section 9, Parish of Modewarre, comprising 3.646 hectares land described in Certificate of Title Volume 10753 Folio 628 shown as Parcel 2 on Survey Plan 22268.

**Interest Acquired:** That Darren Robert Stiles and Paula Lynette Stiles, Rodney Stuart Stiles and Tania Louise Stiles, Natalie Jane Hunt and David John Hunt, Amanda Glenys Collins and Anthony John Collins and all other interests.

Published with the authority of VicRoads.

For and on behalf of VicRoads

Signed TIM PONTEFRACT

Name Tim Pontefract

Dated 9 December 2010

**Land Acquisition and Compensation Act 1986**  
FORM 7

S. 21(a)  
Reg. 16

Notice of Acquisition

Compulsory Acquisition of Interest in Land

The Roads Corporation (VicRoads) declares that by this notice it acquires the following interest in the land described as Part of Lot 1 on Title Plan 116491T (formerly known as part of portion 13 Parish of Modewarre), comprising 1.787 hectares and being land described in Certificate of Title Volume 9704 Folio 344 shown as Parcel 221 on Survey Plan 22266

**Interest Acquired:** Rodney Alan Francis Batson and Lynette Jean Batson and all other interests.

Published with the authority of VicRoads.

For and on behalf of VicRoads

Signed TIM PONTEFRACT

Name Tim Pontefract

Dated 9 December 2010

**Land Acquisition and Compensation Act 1986**  
FORM 7S. 21(a)  
Reg. 16

## Notice of Acquisition

## Compulsory Acquisition of Interest in Land

The Roads Corporation (VicRoads) declares that by this notice it acquires the following interest in the land described as part of Lot 1 on Plan of Subdivision 338717S Parish of Duneed, comprising 2529 square metres and being land described in Certificate of Title Volume 10584 Folio 286 shown as Parcel 83 on Survey Plan 22259.

**Interest Acquired:** That of Steven Maxwell John Moore and Alison Maree Moore and all other interests.

Published with the authority of VicRoads.

For and on behalf of VicRoads

Signed TIM PONTEFRACT

Name Tim Pontefract

Dated 9 December 2010

**Land Acquisition and Compensation Act 1986**  
FORM 7S. 21(a)  
Reg. 16

## Notice of Acquisition

## Compulsory Acquisition of Interest in Land

The Roads Corporation (VicRoads) declares that by this notice it acquires the following interest in the land described as part of Lot 7 on Title Plan 003486R and part of Lot 2 on Plan of Subdivision 328482A Parishes of Barrarbool and Duneed, comprising 1.390 hectares being land described in Certificate of Title Volume 10212 Folio 043 and Certificate of Title Volume 10141 Folio 598 shown as Parcels 141 and 142 on Survey Plan 22262.

**Interest Acquired:** That of Walter David Ibbs and all other interests.

Published with the authority of VicRoads.

For and on behalf of VicRoads

Signed TIM PONTEFRACT

Name Tim Pontefract

Dated 9 December 2010

**Land Acquisition and Compensation Act 1986**  
FORM 7S. 21(a)  
Reg. 16

## Notice of Acquisition

## Compulsory Acquisition of Interest in Land

The Roads Corporation (VicRoads) declares that by this notice it acquires the following interest in the land described as Part of Crown Portion 13, Parish of Modewarre, comprising 1.811 hectares being land described in Conveyance Book 860 Memorial No. 875 shown as Parcel 222 on Survey Plan 22266.

**Interest Acquired:** David Franklin Stiles and Marion Jean Stiles, Stuart William Stiles and Glenys Cheryl Stiles and all other interests.

Published with the authority of VicRoads.

For and on behalf of VicRoads

Signed TIM PONTEFRACT

Name Tim Pontefract

Dated 9 December 2010

**Land Acquisition and Compensation Act 1986**  
FORM 7S. 21(a)  
Reg. 16

## Notice of Acquisition

## Compulsory Acquisition of Interest in Land

The Roads Corporation (VicRoads) declares that by this notice it acquires the following interest in the land described as part of Lot 1 on Title Plan 332144K (formerly known as part of Crown Allotment 7 Section 9), Parish of Modewarre, comprising 5503 square metres being land described in Certificate of Title Volume 8168 Folio 237 shown as Parcel 14 on Survey Plan 22269.

**Interest Acquired:** That of Kim Maree Armstrong and all other interests.

Published with the authority of VicRoads.

For and on behalf of VicRoads

Signed TIM PONTEFRACT

Name Tim Pontefract

Dated 9 December 2010

**Land Acquisition and Compensation Act 1986**  
FORM 7

S. 21(a)  
Reg. 16

Notice of Acquisition

Compulsory Acquisition of Interest in Land

The Roads Corporation (VicRoads) declares that by this notice it acquires the following interest in the land described as part of Lot 1 on Title Plan 000972X, Parish of Lake Wollard, comprising 1.139 hectares and being land described in Certificate of Title Volume 10126 Folio 966 shown as Parcel 92 on Survey Plan 22278.

**Interest Acquired:** That of Lindee Ann Ong and all other interests.

Published with the authority of VicRoads.

For and on behalf of VicRoads

Signed TIM PONTEFRACT

Name Tim Pontefract

Dated 9 December 2010

**Land Acquisition and Compensation Act 1986**  
FORM 7

S. 21(a)  
Reg. 16

Notice of Acquisition

Compulsory Acquisition of Interest in Land

The Roads Corporation (VicRoads) declares that by this notice it acquires the following interest in the land described as part of Lot 1 on Title Plan 022101J Parish of Duneed, comprising 1.277 hectares and being land described in Certificate of Title Volume 10586 Folio 148 shown as Parcel 163 on Survey Plan 22263.

**Interest Acquired:** That of Peter Anthony Wemyss and Rosemary Anne Wemyss and all other interests.

Published with the authority of VicRoads.

For and on behalf of VicRoads

Signed TIM PONTEFRACT

Name Tim Pontefract

Dated 9 December 2010

**Land Acquisition and Compensation Act 1986**  
FORM 7

S. 21(a)  
Reg. 16

Notice of Acquisition

Compulsory Acquisition of Interest in Land

The Roads Corporation (VicRoads) declares that by this notice it acquires the following interest in the land described as part of Lot 1 on Title Plan 020220L, Parish of Duneed, comprising 2002 square metres and being land described in Certificate of Title Volume 10563 Folio 844 shown as Parcel 121 on Survey Plan 22261.

**Interest Acquired:** That of Neville David Rogers and Annette Cheryl Rogers and all other interests.

Published with the authority of VicRoads.

For and on behalf of VicRoads

Signed TIM PONTEFRACT

Name Tim Pontefract

Dated 9 December 2010

**Land Acquisition and Compensation Act 1986**  
FORM 7

S. 21(a)  
Reg. 16

Notice of Acquisition

Compulsory Acquisition of Interest in Land

The Roads Corporation (VicRoads) declares that by this notice it acquires the following interest in the land described as part of Lot 1 on Title Plan 019402M, Parish of Duneed, comprising 3073 square metres and being land described in Certificate of Title Volume 10548 Folio 581 shown as Parcel 223 on Survey Plan 22266.

**Interest Acquired:** That of Robert John Corney and Elizabeth Caroline Millard and all other interests.

Published with the authority of VicRoads.

For and on behalf of VicRoads

Signed TIM PONTEFRACT

Name Tim Pontefract

Dated 9 December 2010



**Land Acquisition and Compensation Act 1986**  
FORM 7S. 21(a)  
Reg. 16

## Notice of Acquisition

## Compulsory Acquisition of Interest in Land

The Roads Corporation (VicRoads) declares that by this notice it acquires the following interest in the land described as part of Crown Allotment 5D, Parish of Lake Lake Wollard, comprising 7188 square metres and being land described in Certificate of Title Volume 5096 Folio 093 shown as Parcel 81 on Survey Plan 22277.

**Interest Acquired:** That of Stanley Lloyd Gosling and Erika Maria Gosling and all other interests.

Published with the authority of VicRoads.

For and on behalf of VicRoads

Signed TIM PONTEFRAC

Name Tim Pontefract

Dated 9 December 2010

**Land Acquisition and Compensation Act 1986**  
FORM 7S. 21(a)  
Reg. 16

## Notice of Acquisition

## Compulsory Acquisition of Interest in Land

The Roads Corporation (VicRoads) declares that by this notice it acquires the following interest in the land described as part of Crown Allotment 5C, Section 14, Parish of Lake Lake Wollard, comprising 1460 square metres and being land described in Crown Grant Volume 876 Folio 174 shown as Parcel 82 on Survey Plan 22277.

**Interest Acquired:** That of Arthur Henry Atkinson and Gail Dianne Atkinson and all other interests.

Published with the authority of VicRoads.

For and on behalf of VicRoads

Signed TIM PONTEFRAC

Name Tim Pontefract

Dated 9 December 2010

**Land Acquisition and Compensation Act 1986**  
FORM 7S. 21(a)  
Reg. 16

## Notice of Acquisition

## Compulsory Acquisition of Interest in Land

The Roads Corporation (VicRoads) declares that by this notice it acquires the following interest in the land described as part of Lot 1 on Title Plan 215679W (formerly known as part of Lot 2 on Plan of Subdivision 125350), Parish of Lake Lake Wollard, comprising 1.219 hectares and being land described in Certificate of Title Volume 9394 Folio 103 shown as Parcel 121 on Survey Plan 22282.

**Interest Acquired:** That of Jesus Blanco and Carmen Blanco and all other interests.

Published with the authority of VicRoads.

For and on behalf of VicRoads

Signed TIM PONTEFRAC

Name Tim Pontefract

Dated 9 December 2010

**Retirement Villages Act 1986**

## SECTION 39

## Cancellation of Retirement Village Notice

I hereby declare that pursuant to section 9 of the **Retirement Villages Act 1986**, Retirement Village Notice AF695609K registered on 4 March 2008, on Certificates of Title Volume 05626 Folio 118, Volume 07162 Folio 230, Volume 10976 Folio 672 and Volume 07139 Folio 771, is cancelled.

Dated 29 November 2010

CLAIRE NOONE

Director

Consumer Affairs Victoria

**Retirement Villages Act 1986**

## SECTION 32

## Extinguishment of Retirement Village Charge

I hereby declare that pursuant to section 29 of the **Retirement Villages Act 1986**, Retirement Village Charge AF695610B created on 4 March 2008 on Certificates of Title Volume 05626

Folio 118, Volume 07162 Folio 230, Volume 10976 Folio 672 and Volume 07139 Folio 771 under the **Transfer of Land Act 1958**, is extinguished.

Dated 29 November 2010

CLAIRE NOONE  
Director  
Consumer Affairs Victoria

### Retirement Villages Act 1986

#### SECTION 39

##### Cancellation of Retirement Village Notice

I hereby declare that pursuant to section 9 of the **Retirement Villages Act 1986**, Retirement Village Notice S360539W, registered on 17 February 1993, on the following Certificates of Title:

- Volume 10276 Folios 769 to 780 (inclusive)
- Volume 10276 Folio 782
- Volume 10276 Folio 784 to 791 (inclusive)
- Volume 10276 Folio 793 to 800 (inclusive)
- Volume 10276 Folio 802 to 806 (inclusive)
- Volume 10657 Folio 436
- Volume 11200 Folio 718 and
- Volume 11211 Folio 492

under the **Transfer of Land Act 1958**, is cancelled.

Dated 29 November 2010

CLAIRE NOONE  
Director  
Consumer Affairs Victoria



### Water Act 1989

#### NOTIFICATION OF

#### PROPOSED EXTENSION TO THE KYABRAM WATER SUPPLY DISTRICT

Notice is hereby given that Goulburn Valley Region Water Corporation, pursuant to section 122P of the **Water Act 1989**, has prepared a proposal for the extension of the existing water supply district boundary at Kyabram.

Areas included in the proposal are in the general vicinity of:

- McEwen Road, Graham Road, Albion Street and Kulhe Court;
- Brose Road;
- Aldersyde Drive and Curtis Court;
- South Boundary Road, Lake Road, Kashelmara Drive, Gardadale Drive, Jenmar Drive, Breen Avenue, Bolithos Road, Byrneside-Kyabram Road, Goddard Road, The Avenue, Carmaria Court and Amarco Lane.

The proposal to extend the district is to only reflect where town water services are currently available and where they would be expected to be provided in the future based on Campaspe Shire's land zoning. The district extension is not facilitating any current new works proposals and will not impact on town water charges and tariffs applicable to properties within the affected areas.

Full details of the proposal and a copy of the plan showing the proposed district are available for inspection, free of charge, at the Corporation's office located at 104-110 Fryers Street, Shepparton (during normal office hours), the Corporation's Shepparton Operations Centre located at 60 Old Dookie Road, Shepparton (corner of Florence Street), and also on the Corporation's website, [www.gvwater.vic.gov.au](http://www.gvwater.vic.gov.au)

Alternatively, the plan is available for inspection, free of charge, at the Kyabram Post Office located at 196 Allan Street, Kyabram (during normal office hours).

Members of the public are invited to make a written submission to the Corporation on the proposal. Any submission must set out the grounds for any objection to the proposal. Submissions should be addressed to: Managing Director, Goulburn Valley Region Water Corporation, PO Box 185, Shepparton 3632.

The Corporation must receive any submission by 9 January 2011, which is one (1) month after the final publication of this notice.

The Corporation will consider any submission received at a Board meeting following this date.



### Water Act 1989

#### NOTIFICATION OF PROPOSED EXTENSION TO THE KYABRAM SEWERAGE DISTRICT

Notice is hereby given that Goulburn Valley Region Water Corporation, pursuant to section 122P of the **Water Act 1989**, has prepared a proposal for the extension of the existing sewerage district boundary at Kyabram.

Areas included in the proposal are in the general vicinity of:

- McEwen Road, Wood Road, Greed Road, Crichton Road, Lilford Court, Slattery Road, Graham Road, Albion Street, Kulhe Court and Tisdall Road;
- Goegan Drive, McLennan Close, Pigatto Close, Tehan Avenue and Connally Close;
- Eden Grove and Lake Road;
- Munro Crescent, Koala Court, Corella Crescent and Emu Close;
- Beech Street, South Boundary Road, Breen Avenue, Bolithos Road, Allan Street and Edis Street.

The proposal to extend the district is to only reflect where sewerage services are currently available and where they would be expected to be provided in the future based on Campaspe Shire's land zoning. The district extension is not facilitating any current new works proposals and will not impact on sewerage charges and tariffs applicable to properties within the affected areas.

Full details of the proposal and a copy of the plan showing the proposed district are available for inspection, free of charge, at the Corporation's office located at 104–110 Fryers Street, Shepparton (during normal office hours), the Corporation's Shepparton Operations Centre located at 60 Old Dookie Road, Shepparton (corner of Florence Street) and also on the Corporation's website, [www.gvwater.vic.gov.au](http://www.gvwater.vic.gov.au)

Alternatively, the plan is available for inspection, free of charge, at the Kyabram Post Office located at 196 Allan Street, Kyabram (during normal office hours).

Members of the public are invited to make a written submission to the Corporation on the proposal. Any submission must set out the grounds for any objection to the proposal. Submissions should be addressed to: Managing Director, Goulburn Valley Region Water Corporation, PO Box 185, Shepparton 3632.

The Corporation must receive any submission by 9 January 2011, which is one (1) month after the final publication of this notice.

The Corporation will consider any submission received at a Board meeting following this date.



### Water Act 1989

#### NOTIFICATION OF PROPOSED EXTENSION TO THE SHEPPARTON URBAN WATER DISTRICT

Notice is hereby given that Goulburn Valley Region Water Corporation, pursuant to section 122P of the **Water Act 1989**, has prepared a proposal for the extension of the existing urban water district boundary at Shepparton.

Areas included in the proposal are in the general vicinity of:

- SHEPPARTON:  
Wanganui Road, The Boulevard, Parkside Drive, Banks Place, Evergreen Way, Purra Way, The Boulevard Estate; Doyles Road, Poplar Avenue, Channel Road, Archer Road, Fig Avenue, Almond Place, Quince Street, Walnut Court, Cherry Court, Feiglin Road, Wolks Lane, Appletree Crescent, Joseph Baldwin Place, McHarry Place;
- SHEPPARTON NORTH:  
Goulburn Valley Highway, Shepparton–Barmah Road, Shepparton–Zeerust Road, Grace Road, Daldy Road, McCracken Road, McClland Road, Congupna West Road, Freemans Road, Ford Road, Wanganui Road, Garley Nook, Trinity Drive, Scotch Court, Wesley Court, Xavier Crescent, Peninsula Drive, Verney Road North, Verney Road, Knights Road, Connolly Park Estate, Hawkins Heights Estate;

- CONGUPNA:  
Bowland Close, Verney Road North, Goulburn Valley Highway, Katamatite–Shepparton Main Road;
- GRAHAMVALE:  
Verney Road, Ford Road, Grahamvale Road, Doyles Road, Old Dookie Road, New Dookie Road, Robert Court, Mildred Court, Hutton Road, Mouser Road;
- LEMNOS:  
Mouser Road, Ford Road, Cosgrove-Lemnos Road, Hill Road, Lemnos North Road, New Dookie Road;
- SHEPPARTON EAST:  
Old Dookie Road, New Dookie Road, Central Avenue, Boundary Road, Swainston Road, School Road, Doyles Road, Blossom Way, Hosie Road, Ackers Court, Midland Highway, Beckham Road, Hanlon Road, Channel Road, Latoris Road;
- ORRVALE:  
Midland Highway, Central Avenue, Channel Road, Orrvale Road, Doyles Road, Poplar Avenue, Reynolds Court, Sunshine Drive;
- KIALLA:  
Archer Road, Adams Road, Urana Court, Charm Court, Mulwala Court, Cooper Place, Hindmarsh Court, Gordon Drive, Kialla Lakes Estate south of Kialla Lakes Drive, Goulburn Valley Highway, Gash Court, River Road, Needlewood Road, Peppercorn Road, Bursaria Road, Wattletree Road, Magnolia Avenue, Cassinia Road, Lomandra Drive, Raftery Road, Arcadia Downs Drive, Edgewater Road, Furphy Avenue, Cimmarron Way, Yellowgum Drive, Riverview Drive, Honeysuckle Drive, Sugargum Crescent, Forest Drive, Taig Avenue.

The proposal to extend the district is to reflect where town water services are currently available and where they would be expected to be provided in the future based on Greater Shepparton City Council's land zoning. The district extension is not facilitating any current new works proposals and will not impact on town water charges and tariffs applicable to properties within the affected areas.

Full details of the proposal and a copy of the plan showing the proposed district are available for inspection, free of charge, at the Corporation's office located at 104–110 Fryers Street, Shepparton (during normal office hours), the Corporation's Shepparton Operations Centre located at 60 Old Dookie Road, Shepparton (corner of Florence Street), and also on the Corporation's website, [www.gvwater.vic.gov.au](http://www.gvwater.vic.gov.au)

Alternatively, the plan is available for inspection, free of charge, at the Shepparton East Post Office located at 713 Midland Highway, Shepparton East or Lemnos Licensed Post Office located at 101 Lemnos North Road, Lemnos (during normal office hours).

Members of the public are invited to make a written submission to the Corporation on the proposal. Any submission must set out the grounds for any objection to the proposal. Submissions should be addressed to: Managing Director, Goulburn Valley Region Water Corporation, PO Box 185, Shepparton 3632.

The Corporation must receive any submission by 9 January 2011, which is one (1) month after the final publication of this notice.

The Corporation will consider any submission received at a Board meeting following this date.



### Water Act 1989

#### NOTIFICATION OF PROPOSED EXTENSION TO THE SHEPPARTON SEWERAGE DISTRICT

Notice is hereby given that Goulburn Valley Region Water Corporation, pursuant to section 122P of the **Water Act 1989**, has prepared a proposal for the extension of the existing sewerage district boundary at Shepparton.

Areas included in the proposal are in the general vicinity of:

- McCelland Road, Congupna West Road, Barmah–Shepparton Road, Daldy Road;
- Goulburn Valley Highway, Trinity Drive, Scotch Court, Wesley Court, Xavier Crescent, Peninsula Drive;
- Kittles Road, The Boulevard, The Boulevard Estate;

- Doyles Road, Old Dookie Road, Telford Drive, Florence Street;
- Blossom Way, Midland Highway;
- New Dookie Road, Lemnos North Road;
- Archer Road, Marlboro Drive;
- Doyles Road (south of Midland Highway);
- Riverview Drive;
- Goulburn Valley Highway, Kialla;
- Goulburn Valley Highway, River Road, Needlewood Road, Peppercorn Road, Bursaria Road, Wattletree Road, Magnolia Avenue, Cassinia Road, Lomandra Drive.

The proposal to extend the district is to reflect where sewerage services are currently available and where they would be expected to be provided in the future based on Greater Shepparton City Council's land zoning. The district extension is not facilitating any current new works proposals and will not impact on sewerage charges and tariffs applicable to properties within the affected areas.

Full details of the proposal and a copy of the plan showing the proposed district are available for inspection, free of charge, at the Corporation's office located at 104–110 Fryers Street, Shepparton (during normal office hours), the Corporation's Shepparton Operations Centre located at 60 Old Dookie Road, Shepparton (corner of Florence Street), and also on the Corporation's website: [www.gvwater.vic.gov.au](http://www.gvwater.vic.gov.au)

Alternatively, the plan is available for inspection, free of charge, at the Shepparton East Post Office located at 713 Midland Highway, Shepparton East, or Lemnos Licensed Post Office located at 101 Lemnos North Road, Lemnos (during normal office hours).

Members of the public are invited to make a written submission to the Corporation on the proposal. Any submission must set out the grounds for any objection to the proposal. Submissions should be addressed to: Managing Director, Goulburn Valley Region Water Corporation, PO Box 185, Shepparton 3632.

The Corporation must receive any submission by 9 January 2011, which is one (1) month after the final publication of this notice.

The Corporation will consider any submission received at a Board meeting following this date.



### Water Act 1989

#### NOTIFICATION OF PROPOSED EXTENSION TO THE TATURA URBAN WATER DISTRICT

Notice is hereby given that Goulburn Valley Region Water Corporation, pursuant to section 122P of the **Water Act 1989**, has prepared a proposal for the extension of the existing urban water district boundary at Tatura.

Areas included in the proposal are in the general vicinity of:

- Tatura–Undera Road;
- Dhurringile Road, Pyke Road, Thomson Street, Brookwater Crescent, Charters Street, Riviera Close, Sunningdale Boulevard, Lytham Court and Killarney Crescent area;
- Tatura–Murchison Road and Murton Road.

The proposal to extend the district is to reflect where town water services are currently available and where they would be expected to be provided in the future based on Greater Shepparton City Council's land zoning. The district extension is not facilitating any current new works proposals and will not impact on town water charges and tariffs applicable to properties within the affected areas.

Full details of the proposal and a copy of the plan showing the proposed district are available for inspection, free of charge, at the Corporation's office located at 104–110 Fryers Street, Shepparton (during normal office hours), the Corporation's Shepparton Operations Centre located at 60 Old Dookie Road, Shepparton (corner of Florence Street), and also on the Corporation's website, [www.gvwater.vic.gov.au](http://www.gvwater.vic.gov.au)

Alternatively, the plan is available for inspection, free of charge, at the Tatura Licensed Post Office located at 164 Hogan Street, Tatura (during normal office hours).

Members of the public are invited to make a written submission to the Corporation on the proposal. Any submission must set out the grounds for any objection to the proposal. Submissions should be addressed to: Managing

Director, Goulburn Valley Region Water Corporation, PO Box 185, Shepparton 3632.

The Corporation must receive any submission by 9 January 2011, which is one (1) month after the final publication of this notice.

The Corporation will consider any submission received at a Board meeting following this date.



### **Water Act 1989**

#### **NOTIFICATION OF PROPOSED EXTENSION TO THE TATURA SEWERAGE DISTRICT**

Notice is hereby given that Goulburn Valley Region Water Corporation, pursuant to Section 122P of the **Water Act 1989**, has prepared a proposal for the extension of the existing sewerage district boundary at Tatura.

Areas included in the proposal are in the general vicinity of:

- Dhurringile Road (in the vicinity of Brown Street and Pyke Street);
- Dhurringile Road, Pyke Road, Thomson Street, Brookwater Crescent, Charters Street, Riviera Close, Sunningdale Boulevard, Lytham Court and Killarney Crescent area;
- Ferguson Road;
- Tatura–Murchison Road and Murton Road.

The proposal to extend the district is to reflect where sewerage services are currently available and where they would be expected to be provided in the future based on Greater Shepparton City Council's land zoning. The district extension is not facilitating any current new works proposals and will not impact on sewerage charges and tariffs applicable to properties within the affected areas.

Full details of the proposal and a copy of the plan showing the proposed district are available for inspection, free of charge, at the Corporation's office located at 104–110 Fryers Street, Shepparton (during normal office hours),

the Corporation's Shepparton Operations Centre located at 60 Old Dookie Road, Shepparton (corner of Florence Street), and also on the Corporation's website, [www.gvwater.vic.gov.au](http://www.gvwater.vic.gov.au)

Alternatively, the plan is available for inspection, free of charge, at the Tatura Licensed Post Office located at 164 Hogan Street, Tatura (during normal office hours).

Members of the public are invited to make a written submission to the Corporation on the proposal. Any submission must set out the grounds for any objection to the proposal. Submissions should be addressed to: Managing Director, Goulburn Valley Region Water Corporation, PO Box 185, Shepparton 3632.

The Corporation must receive any submission by 9 January 2011, which is one (1) month after the final publication of this notice.

The Corporation will consider any submission received at a Board meeting following this date.

**Geographic Place Names Act 1998****NOTICE OF REGISTRATION OF GEOGRAPHIC NAMES**

The Registrar of Geographic Names hereby gives notice of the registration of the undermentioned place names.

Localities:

| <b>File Number</b> | <b>Naming Authority</b>      | <b>Affected Localities</b>                    | <b>Location</b>                                                                                                                                                                                                                                                                                                                                                                                                                                                                                                                                                                                           |
|--------------------|------------------------------|-----------------------------------------------|-----------------------------------------------------------------------------------------------------------------------------------------------------------------------------------------------------------------------------------------------------------------------------------------------------------------------------------------------------------------------------------------------------------------------------------------------------------------------------------------------------------------------------------------------------------------------------------------------------------|
| LA/12/0031         | East Gippsland Shire Council | Woodglen, Walpa, Iguana Creek and Glenaladale | <p>Glenaladale will extend north to incorporate properties numbered 10 and 25 on Wallers Road, and will also include properties numbered 3595 and 3543 on that road. The Glenaladale locality boundary will also incorporate properties facing Glenaladale–Fernbank Road starting at property numbered 2460 to 1755.</p> <p>The Walpa locality boundary will extend north-west to include properties numbered 50 and 120 on Careys Road, and 2070 on Dargo Road, in Walpa.</p> <p>For further details see map at <a href="http://www.dse.vic.gov.au/namingplaces">www.dse.vic.gov.au/namingplaces</a></p> |
| LA/12/0031         | East Gippsland Shire Council | Johnsonville and Swan Reach                   | <p>The locality boundary on the east side of Johnsonville will extend further east to incorporate all properties addressed to Bumberrah Road, into the locality of Johnsonville.</p> <p>For further details see map at <a href="http://www.dse.vic.gov.au/namingplaces">www.dse.vic.gov.au/namingplaces</a></p>                                                                                                                                                                                                                                                                                           |
| LA/12/0019         | Baw Baw Shire Council        | Ripplebrook and Heath Hill                    | <p>The locality boundary between Ripplebrook and Heath Hill will move west at Westernport Road, to the back of properties numbered 1855 and 1823, and will move west around property numbered 1794, and extend to the centreline of the Lang Lang River.</p> <p>For further details see map at <a href="http://www.dse.vic.gov.au/namingplaces">www.dse.vic.gov.au/namingplaces</a></p>                                                                                                                                                                                                                   |
| LA/12/0031         | East Gippsland Shire Council | Brumby and Wulgulmerang East                  | <p>The locality boundary between Brumby and Wulgulmerang East will move west, behind properties numbered 590 to 52 on Snowy River Road, so that these properties are included in the locality of Wulgulmerang East.</p> <p>For further details see map at <a href="http://www.dse.vic.gov.au/namingplaces">www.dse.vic.gov.au/namingplaces</a>.</p>                                                                                                                                                                                                                                                       |

## Road Naming:

| Road Name         | Locality     | Proposer and Location                                                                                                                |
|-------------------|--------------|--------------------------------------------------------------------------------------------------------------------------------------|
| Matheson Way      | Cowes        | Formerly known as Phillip Street.<br>Bass Coast Shire Council.<br>The road traverses east off Justice Road, Cowes.                   |
| Giffard West Road | Giffard West | Formerly known as Giffard-Giffard West Road.<br>Wellington Shire Council.<br>The road traverses west off Giffard Road, Giffard West. |
| Couta Boat Lane   | Newhaven     | Bass Coast Shire Council.<br>The road traverses east off Bluebird Court, Newhaven.                                                   |
| Salvation Lane    | Wonthaggi    | Bass Coast Shire Council.<br>The road traverses west off White Road, Wonthaggi.                                                      |
| Best Place        | Newtown      | Greater Geelong City Council.<br>The road traverses east off Pleasant Street, Newtown.                                               |
| Minnitt Road      | Anakie       | Greater Geelong City Council.<br>The road traverses west off Old Boundary Road, Anakie.                                              |
| Cassowary Way     | Junortoun    | Greater Bendigo City Council.<br>The road traverses south west off Homebush Drive, Junortoun.                                        |
| Fryingpan Road    | Barnawartha  | Indigo Shire Council.<br>The road traverses south east off White Street, Barnawartha.                                                |
| Wallace Lane      | Rutherglen   | Indigo Shire Council.<br>The road traverses south east off Ready Street, Rutherglen.                                                 |
| Teal Lane         | Wurruk       | Wellington Shire Council.<br>The road traverses east off Settlement Road, Wurruk.                                                    |
| Turner Road       | Norong       | Indigo Shire Council.<br>The road traverses south off Murray Valley Highway, Norong.                                                 |
| Williamson Road   | Rutherglen   | Indigo Shire Council.<br>The road traverses north off the Murray Valley Highway, Rutherglen.                                         |
| Bath Lane         | Lilliput     | Indigo Shire Council.<br>The road traverses south off United Road, Lilliput.                                                         |
| Moore Road        | Rutherglen   | Indigo Shire Council.<br>The road traverses south off Kilborn Road, Rutherglen.                                                      |
| Jordan Road       | Laanecoorie  | Loddon Shire Council.<br>The road traverses east off Cains Road, Laanecoorie.                                                        |



| Road Name    | Locality      | Proposer and Location                                                                       |
|--------------|---------------|---------------------------------------------------------------------------------------------|
| Birtles Road | Wooragee      | Indigo Shire Council.<br>The road traverses south off Fanning Lane, Wooragee.               |
| Beck Lane    | Barnawartha   | Indigo Shire Council.<br>The road traverses south off Harkins Road, Barnawartha.            |
| Devitt Road  | Indigo Valley | Indigo Shire Council.<br>The road traverses south east off Brewers Road, Indigo Valley.     |
| Pascoe Road  | Rutherglen    | Indigo Shire Council.<br>The road traverses east off Hopetoun Road, Rutherglen.             |
| Macrae Lane  | Leongatha     | South Gippsland Shire Council.<br>The road traverses south east off Parr Street, Leongatha. |
| Apex Lane    | Rutherglen    | Indigo Shire Council.<br>The road traverses east off Nilsson Street, Rutherglen.            |

Office of Geographic Names

c/- **LAND VICTORIA**

17th Floor

570 Bourke Street

Melbourne 3000

JOHN E. TULLOCH  
Registrar of Geographic Names

**Housing Act 1983****LAND THE DIRECTOR OF HOUSING IS DEEMED TO HAVE AN INTEREST IN  
UNDER SECTION 107 OF THE HOUSING ACT 1983**

Community Housing (Vic.) Limited

I, Margaret Crawford, Director of Housing (the Director), hereby issue the following declaration pursuant to section 107 of the **Housing Act 1983** (the Act).

In accordance with a Funding Deed dated 20 December 2005 between the Director and Community Housing (Vic.) Limited the following land is land in which the Director is deemed to have an interest in under section 107 of the Act.

| <b>Volume</b> | <b>Folio</b> | <b>Address</b>                          |
|---------------|--------------|-----------------------------------------|
| 04033         | 426          | 21–23 Fahey Street, Wonthaggi           |
| 04982         | 390          | 408 Main Street, Bairnsdale             |
| 05097         | 229          | 21–23 Fahey Street, Wonthaggi           |
| 07706         | 089          | 28 Wallace Street, Bairnsdale           |
| 08596         | 105          | 15 Muriel Street, Crib Point            |
| 08659         | 884          | 5 Hakea Court, Dennington (Warrnambool) |
| 09804         | 286          | 42 Laverock Road, Warrnambool           |
| 10867         | 664          | 29 Moroney Street, Bairnsdale           |
| 10873         | 544          | 26 Cherlin Drive, Warrnambool           |
| 11105         | 623          | 10 Autumn Court, Hastings               |
| 11169         | 147          | 44 Peterson Street, Crib Point          |

Dated 24 November 2010

Signed at Melbourne in the State of Victoria  
MARGARET CRAWFORD  
Director of Housing

**Occupational Health and Safety Act 2004****VICTORIAN WORKCOVER AUTHORITY****Notice of Transfer of Major Hazard Facility Licence**

On 24 November 2010, Hexion Specialty Chemicals Pty Ltd Major Hazards Facility Licence MHL 014 was transferred under Chapter 6 – Licensing and Registration (Regulation 6.1.30) of the Occupational Health and Safety Regulations 2007 as outlined below:

Following notification the licence was transferred to reflect the change in operator name to Momentive Specialty Chemicals Pty Ltd for the facility located at Gate 3, 765 Ballarat Road, Deer Park, Victoria 3023.

The transferred Major Hazard Facility Licence was issued for the remainder of the current 5 year term and will expire on 18 November 2012.

The licence did not include conditions.

The following Schedule 1 materials are authorised by the licence:

From Table 1 of Schedule 9

| <b>Material</b> | <b>UN Nos. included under Name</b> |
|-----------------|------------------------------------|
| Formaldehyde    | 2209                               |

From Table 2 of Schedule 9

| <b>Material</b>          | <b>Description</b>                                                       |
|--------------------------|--------------------------------------------------------------------------|
| Flammable Materials      | Liquids that meet the criteria for Class 3 Packing Group II or III       |
| Toxic Solids and liquids | Materials that meet the criteria for Very Toxic in Table 3 of Schedule 9 |

Note: The small quantities of other Schedule 9 materials mentioned in the Safety Case are noted.

GREG TWEEDLY  
Chief Executive

**Occupational Health and Safety Act 2004****VICTORIAN WORKCOVER AUTHORITY****Notice of Transfer of Major Hazard Facility Licence**

On 24 November 2010, Hexion Specialty Chemicals Pty Ltd Major Hazards Facility Licence MHL 031 was transferred under Chapter 6 – Licensing and Registration (Regulation 6.1.30) of the Occupational Health and Safety Regulations 2007 as outlined below:

Following notification the licence was transferred to reflect the change in operator name to Momentive Specialty Chemicals Pty Ltd for the facility located at 2–8 James Street, Laverton North, Victoria 3026.

The transferred Major Hazard Facility Licence was issued for the remainder of the current 5 year term and will expire on 26 March 2013.

The following conditions are attached to the licence:

1. The operator must reduce the methanol inventory in tank V7 (east corner of James Street property), by site usage to less than 200 tonne and then maintain the inventory not exceeding 200 tonne to control risk reasonably practicably.
2. The operator must not operate the methanol storage tank known as V7 beyond 1 April 2009 unless the V7 fire protection systems have been upgraded.

The following Schedule 1 materials are authorised by the licence:

From Table 1 of Schedule 9

| <b>Material</b> | <b>UN Nos. included under Name</b> |
|-----------------|------------------------------------|
| Formaldehyde    | 2209                               |

From Table 2 of Schedule 9

| <b>Material</b>                                                                                                                            | <b>Description</b>                                                  |
|--------------------------------------------------------------------------------------------------------------------------------------------|---------------------------------------------------------------------|
| Flammable Materials                                                                                                                        | Liquids which meet the criteria for Class 3 Packing Group I         |
| Flammable materials                                                                                                                        | Liquids which meet the criteria for Class 3 Packing Group II or III |
| Toxic Solids and liquids (other than materials which are classified as Infectious Substances (Class 6.2) or as Radioactive (Class 7))      | Materials which meet the criteria for Toxic in Table 3              |
| Very Toxic Solids and liquids (other than materials which are classified as Infectious Substances (Class 6.2) or as Radioactive (Class 7)) | Materials which meet the criteria for Very Toxic in Table 3         |

Note: The small quantities of other Schedule 9 materials mentioned in the Safety Case are noted.

GREG TWEEDLY  
Chief Executive

**Occupational Health and Safety Act 2004****VICTORIAN WORKCOVER AUTHORITY**

## Notice of Issue of Major Hazard Facility Licence

On 24 November 2010, a licence under Chapter 6 of the Occupational Health and Safety Regulations 2007 was issued to LyondellBasell Australia Pty Ltd, Level 5, 627 Chapel Street, South Yarra, Victoria 3141, and authorises the facility located at the Polypropylene Plant – Refinery Road, Corio, Victoria 3214, to be operated as a major hazard facility.

The Major Hazard Facility Licence was issued for a term of 5 years and will expire on 28 November 2010.

The licence did not include conditions.

The following Schedule 9 materials were authorised by the licence:

From Table 1 of Schedule 9

| <b>MATERIAL</b> | <b>UN Nos. included under Name</b> |
|-----------------|------------------------------------|
| Hydrogen        | 1049                               |
| LP Gases        | 1077, 1978, 1075                   |

From Table 2 of Schedule 9

| <b>MATERIAL</b>                | <b>DESCRIPTION</b>                                                                              |
|--------------------------------|-------------------------------------------------------------------------------------------------|
| Compressed and liquefied gases | Compressed or liquefied gases of Class 2.1 or Subsidiary Risk 2.1                               |
| Flammable materials            | Spontaneously combustible materials which meet the criteria for Class 4.2 Packing Group I or II |
| Peroxides                      | Organic Peroxides which meet the criteria for Class 5.2                                         |

Note: The small quantities of other Schedule 9 materials mentioned in the Safety Case are noted.

GREG TWEEDLY  
Chief Executive

**Private Agents Act 1966****NOTICE OF RECEIPT OF APPLICATIONS FOR LICENCES  
UNDER THE PROVISIONS OF THE PRIVATE AGENTS ACT 1966**

I, the undersigned, being the Deputy Registrar of the Magistrates' Court at Ringwood, hereby give notice that applications, as under, have been lodged for hearing by the said Court on the date specified.

Any person desiring to object to any of such applications must –

- (a) lodge with me a notice in the prescribed form of his/her objection and of the grounds thereof;
- (b) cause a copy of such notice to be served personally or by post upon the applicant at least three days before the hearing of the application; and
- (c) send or deliver
  - (i) where the objection is not made by the officer in charge of the police district in which the Court is situated – a copy of the notice to such officer; and
  - (ii) where the objection is not made by the Registrar or Deputy Registrar – a copy to the Registrar.

| <i>Full Name of Applicant or in the case of a Firm or Corporation, of the Nominee</i> | <i>Address for Registration</i> | <i>Type of Licence</i> | <i>Date of Hearing</i> |
|---------------------------------------------------------------------------------------|---------------------------------|------------------------|------------------------|
| Kenneth Peter Lesar                                                                   | 6 McGlone Street, Mitcham       | Commercial Sub-agent's | 7 January 2011         |

Dated at Ringwood 3 December 2010

BRUCE HAMILTON  
Deputy Registrar  
Magistrates' Court of Victoria

**Private Agents Act 1966****NOTICE OF RECEIPT OF APPLICATIONS FOR LICENCES  
UNDER THE PROVISIONS OF THE PRIVATE AGENTS ACT 1966**

I, the undersigned, being a Deputy Registrar of the Magistrates' Court of Victoria at Frankston, hereby give notice that application, as listed below, has been lodged for hearing at the Frankston Magistrates' Court on 6 January 2011.

Any person desiring to object to any of such applications must –

- (a) lodge with me a notice in the prescribed form of his/her objection and of the grounds thereof;
- (b) cause a copy of such notice to be served personally or by post upon the applicant at least three days before the hearing of the application; and
- (c) send or deliver
  - (i) where the objection is not made by the officer in charge of the police district in which the Court is situated – a copy of the notice to such officer; and
  - (ii) where the objection is not made by the Registrar or Deputy Registrar – a copy to the Registry.

| <i>Full Name of Applicant or in the case of a Firm or Corporation, of the Nominee</i> | <i>Name of Firm or Corporation</i> | <i>Address for Registration</i>                   | <i>Type of Licence</i>         | <i>Date of Hearing</i>  |
|---------------------------------------------------------------------------------------|------------------------------------|---------------------------------------------------|--------------------------------|-------------------------|
| John David Innes                                                                      | Skiptracer Pty Ltd                 | 860A Pakenham Road, Pakenham Upper, Victoria 3810 | Commercial Sub-agent's Licence | Thursday 6 January 2011 |

Dated at Frankston 2 December 2010

DEBRA CLARK  
Deputy Registrar  
Magistrates' Court of Victoria

AGREEMENT FOR THE MELBOURNE CITY LINK AND  
AGREEMENT FOR THE EXHIBITION STREET EXTENSION PROJECT

Notice under Schedule 4 of the Agreement for Integrating and Facilitating the Project and the Exhibition Street Extension Project between the Crown in right of the State of Victoria, CityLink Melbourne Limited, Transurban Infrastructure Management Limited and City Link Extension Pty Limited (the 'IFA') (as substituted for (and as if incorporated in lieu of) Schedule 3 of the Agreement for the Melbourne City Link between the Crown in right of the State of Victoria, CityLink Melbourne Limited and Transurban Infrastructure Management Limited (the 'Concession Deed') and Schedule 1 of the Agreement for the Exhibition Street Extension Project between the Crown in right of the State of Victoria and City Link Extension Pty Limited ('the ESEP Deed')).

CityLink Melbourne Limited (ABN 65 070 810 678) (for itself and as agent of City Link Extension Pty Limited (ABN 40 082 058 615)) ('CityLink Melbourne') gives notice of the following Charge Tolls, Maximum Charge Tolls, Day Tolls, Taxi Tolls and Taxi Day Tolls for the Melbourne City Link and the Exhibition Street Extension:



**Schedule of Charge Tolls and Maximum Charge Tolls****Charge Tolls (\$/vehicle)**

| <b>Category of Vehicle</b><br><b>Tollable Section</b>                                                                                                                                                  | Car  | Light<br>Commercial<br>Vehicle | Heavy<br>Commercial<br>Vehicle | Motor<br>Cycle |
|--------------------------------------------------------------------------------------------------------------------------------------------------------------------------------------------------------|------|--------------------------------|--------------------------------|----------------|
| Tullamarine Freeway Upgrade, between Moreland Road and Brunswick Road                                                                                                                                  | 1.82 | 2.92                           | 3.47                           | 0.91           |
| Western Link Section 1, between Racecourse Road and Dynon Road                                                                                                                                         | 1.82 | 2.92                           | 3.47                           | 0.91           |
| Western Link Section 2, between Footscray Road and West Gate Freeway                                                                                                                                   | 2.28 | 3.66                           | 4.34                           | 1.14           |
| Domain Tunnel and that part of the Southern Link leading into that Tunnel between the eastern portal of that Tunnel and Punt Road, other than that part of Southern Link Section 1:                    | 2.28 | 3.66                           | 4.34                           | 1.14           |
| (a) between Punt Road and the exit to Boulton Parade; and                                                                                                                                              |      |                                |                                |                |
| (b) comprising Boulton Parade                                                                                                                                                                          |      |                                |                                |                |
| Burnley Tunnel and that part of the Southern Link leading out of that Tunnel between the eastern portal of that Tunnel and Burnley Street                                                              | 4.11 | 6.58                           | 7.81                           | 2.05           |
| Southern Link Section 1, between Burnley Street and Punt Road and including that part of Southern Link Section 1:                                                                                      | 1.82 | 2.92                           | 3.47                           | 0.91           |
| (a) between Punt Road and the exit to Boulton Parade; and                                                                                                                                              |      |                                |                                |                |
| (b) comprising Boulton Parade                                                                                                                                                                          |      |                                |                                |                |
| Southern Link Section 5, between Punt Road and Burnley Street other than that part of the Southern Link leading out of the Burnley Tunnel between the eastern portal of that Tunnel and Burnley Street | 1.82 | 2.92                           | 3.47                           | 0.91           |
| Southern Link Section 1, between Glenferrie Road and Burnley Street                                                                                                                                    | 1.82 | 2.92                           | 3.47                           | 0.91           |
| Southern Link Section 5, between Burnley Street and Glenferrie Road                                                                                                                                    | 1.82 | 2.92                           | 3.47                           | 0.91           |
| Exhibition Street Extension                                                                                                                                                                            | 1.14 | 1.82                           | 2.17                           | 0.57           |

|                                                                                                                           |      |      |      |      |
|---------------------------------------------------------------------------------------------------------------------------|------|------|------|------|
| Southern Link Section 1, between Punt Road and Swan Street Intersection, other than:                                      | 1.14 | 1.82 | 2.17 | 0.57 |
| (a) that part of Southern Link Section 1:                                                                                 |      |      |      |      |
| (i) between Punt Road and the exit to Boulton Parade; and                                                                 |      |      |      |      |
| (ii) comprising Boulton Parade; and                                                                                       |      |      |      |      |
| (b) that part of the Southern Link leading into the Domain Tunnel between the eastern portal of that Tunnel and Punt Road |      |      |      |      |
| Southern Link Section 5, between Swan Street Intersection and Punt Road                                                   | 1.14 | 1.82 | 2.17 | 0.57 |

## Notes:

- When travelling on Southern Link Section 1 between Burnley Street and Punt Road and then onto Batman Avenue, the Tollable Sections may be combined for the purposes of levying Tolls.
- When travelling on Southern Link Section 1 and into the Domain Tunnel, the Tollable Sections may be combined for the purposes of levying Tolls.
- A reference in the description of a Tollable Section to a part of the Southern Link between a particular street or road and Burnley Street, includes that part of the Southern Link between that particular street or road and where Burnley Street would cross the Southern Link if Burnley Street continued in a straight southerly direction from its southernmost extremity.
- In this table:  
‘Boulton Parade’ includes the off-ramp connecting the rest of the Southern Link to Boulton Parade;  
‘Burnley Tunnel’ means the eastbound tunnel between Sturt Street and Burnley Street;  
‘Domain Tunnel’ means the westbound tunnel between Punt Road and Sturt Street; and  
‘Swan Street Intersection’ means the intersection between Swan Street and Batman Avenue.

**Maximum Charge Tolls (\$/vehicle)**

| <b>Category of Vehicle</b>                                                                                                                               | <b>Car</b> | <b>Light Commercial Vehicle</b> | <b>Heavy Commercial Vehicle</b> | <b>Motor Cycle</b> |
|----------------------------------------------------------------------------------------------------------------------------------------------------------|------------|---------------------------------|---------------------------------|--------------------|
| Trips where the passage of the Vehicle on the last Tollable Section comprising the Trip before exiting the Total Link occurs between 6.00 am and 8.00 pm | 6.86       | 9.14                            | 9.14                            | 3.43               |
| Trips where the passage of the Vehicle on the last Tollable Section comprising the Trip before exiting the Total Link occurs between 8.00 pm and 6.00 am | 6.86       | 6.86                            | 6.86                            | 3.43               |

**Day Tolls (\$/vehicle)**

| <b>Category of Vehicle</b> | Car   | Light Commercial Vehicle | Heavy Commercial Vehicle | Motor Cycle |
|----------------------------|-------|--------------------------|--------------------------|-------------|
| <b>Day Toll</b>            | 13.15 | 21.00                    | 24.95                    | 6.55        |

**Taxi Tolls (\$/Taxi)**

| <b>Trip</b>                                                                                                                                                        | <b>Taxi Toll</b> |
|--------------------------------------------------------------------------------------------------------------------------------------------------------------------|------------------|
| Trips involving use of any or all of the Tollable Sections which comprise the Western Link* and no other Tollable Sections                                         | 4.10             |
| Trips involving use of any or all of the Tollable Sections which comprise the Southern Link** and/or Exhibition Street Extension*** and no other Tollable Sections | 4.10             |
| Trips involving use of Tollable Sections which comprise both the Western Link* and either or both of the Southern Link** and the Exhibition Street Extension***    | 6.40             |

\* The Western Link comprises the following three Tollable Sections:

1. Tullamarine Freeway Upgrade, between Moreland Road and Brunswick Road.
2. Western Link Section 1, between Racecourse Road and Dynon Road.
3. Western Link Section 2, between Footscray Road and West Gate Freeway.

\*\* The Southern Link comprises the following eight Tollable Sections:

1. Domain Tunnel and that part of the Southern Link leading into that Tunnel between the eastern portal of that Tunnel and Punt Road, other than that part of Southern Link Section 1:
  - (a) between Punt Road and the exit to Boulton Parade; and
  - (b) comprising Boulton Parade.
2. Southern Link Section 1, between Burnley Street and Punt Road and including that part of Southern Link Section 1:
  - (a) between Punt Road and the exit to Boulton Parade; and
  - (b) comprising Boulton Parade.
3. Southern Link Section 5, between Punt Road and Burnley Street other than that part of the Southern Link leading out of the Burnley Tunnel between the eastern portal of that Tunnel and Burnley Street.
4. Burnley Tunnel and that part of the Southern Link leading out of that Tunnel between the eastern portal of that Tunnel and Burnley Street.
5. Southern Link Section 1, between Glenferrie Road and Burnley Street.
6. Southern Link Section 5, between Burnley Street and Glenferrie Road.

7. Southern Link Section 1, between Punt Road and Swan Street Intersection, other than:
- (a) that part of Southern Link Section 1:
    - (i) between Punt Road and the exit to Boulton Parade; and
    - (ii) comprising Boulton Parade; and
  - (b) that part of the Southern Link leading into the Domain Tunnel between the eastern portal of that Tunnel and Punt Road.
8. Southern Link Section 5, between Swan Street Intersection and Punt Road.
- \*\*\* The Exhibition Street Extension comprises the following Tollable Section:
1. Exhibition Street Extension.

**Taxi Day Tolls (\$/Taxi)**

| <b>Taxi</b>                          | <b>Taxi Day Toll</b> |
|--------------------------------------|----------------------|
| Metropolitan Taxi                    | 13.15                |
| A Taxi not being a Metropolitan Taxi | 7.00                 |

CityLink Melbourne intends that each Charge Toll, Maximum Charge Toll, Day Toll, Taxi Toll and Taxi Day Toll specified above will first apply in the quarter ending 31 March 2011.

Capitalised terms in this notice that are defined in:

- (a) the Concession Deed have, subject to paragraph (b), that meaning in this notice;
- (b) the ESEP Deed have that meaning in this notice, but only to the extent that the provision applies to the ESEP Deed,

subject to the provisions of the IFA.

E. M. MILDWATER  
Company Secretary  
CityLink Melbourne Limited  
(ABN 65 070 810 678)

B. J. BOURKE  
Director  
CityLink Melbourne Limited  
(ABN 65 070 810 678)

## AGREEMENT FOR THE EXHIBITION STREET EXTENSION PROJECT

Notice under Schedule 1 of the Agreement for the Exhibition Street Extension Project between the Crown in right of the State of Victoria and City Link Extension Pty Limited (the 'ESEP Deed').

City Link Extension Pty Limited (ABN 40 082 058 615) ('Cleppo') gives notice of the following Charge Tolls for the Exhibition Street Extension:

**Charge Tolls (\$/vehicle)**

| <b>Category of Vehicle</b><br><b>Tollable Section</b> | Car  | Light<br>Commercial<br>Vehicle | Heavy<br>Commercial<br>Vehicle | Motor<br>Cycle |
|-------------------------------------------------------|------|--------------------------------|--------------------------------|----------------|
| Exhibition Street Extension                           | 1.14 | 1.82                           | 2.17                           | 0.57           |

Cleppo intends that these Charge Tolls will first apply in the quarter ending 31 March 2011.

Capitalised terms in this notice that are defined in the ESEP Deed have the same meaning as given by the ESEP Deed.

E. M. MILDWATER  
Company Secretary  
City Link Extension Pty Limited  
ABN 40 082 058 615

B. J. BOURKE  
Director  
City Link Extension Pty Limited  
ABN 40 082 058 615

### AGREEMENT FOR THE MELBOURNE CITY LINK

Notice under Schedule 3 of the Agreement for the Melbourne City Link between the Crown in right of the State of Victoria, CityLink Melbourne Limited and Transurban Infrastructure Management Limited (the 'Concession Deed').

CityLink Melbourne Limited (ABN 65 070 810 678) ('CityLink Melbourne') gives notice of the following Charge Tolls, Maximum Charge Tolls, Day Tolls, Taxi Tolls and Taxi Day Tolls for the Melbourne City Link:

#### Charge Tolls (\$/vehicle)

| <b>Category of Vehicle</b><br><b>Tollable Section</b>                                                                                                                               | Car  | Light<br>Commercial<br>Vehicle | Heavy<br>Commercial<br>Vehicle | Motor<br>Cycle |
|-------------------------------------------------------------------------------------------------------------------------------------------------------------------------------------|------|--------------------------------|--------------------------------|----------------|
| Tullamarine Freeway Upgrade, between Moreland Road and Brunswick Road                                                                                                               | 1.82 | 2.92                           | 3.47                           | 0.91           |
| Western Link Section 1, between Racecourse Road and Dynon Road                                                                                                                      | 1.82 | 2.92                           | 3.47                           | 0.91           |
| Western Link Section 2, between Footscray Road and West Gate Freeway                                                                                                                | 2.28 | 3.66                           | 4.34                           | 1.14           |
| Domain Tunnel and that part of the Southern Link leading into that Tunnel between the eastern portal of that Tunnel and Punt Road, other than that part of Southern Link Section 1: | 2.28 | 3.66                           | 4.34                           | 1.14           |
| (a) between Punt Road and the exit to Boulton Parade; and                                                                                                                           |      |                                |                                |                |
| (b) comprising Boulton Parade                                                                                                                                                       |      |                                |                                |                |
| Burnley Tunnel and that part of the Southern Link leading out of that Tunnel between the eastern portal of that Tunnel and Burnley Street                                           | 4.11 | 6.58                           | 7.81                           | 2.05           |
| Southern Link Section 1, between Burnley Street and Punt Road and including that part of Southern Link Section 1:                                                                   | 1.82 | 2.92                           | 3.47                           | 0.91           |
| (a) between Punt Road and the exit to Boulton Parade; and                                                                                                                           |      |                                |                                |                |
| (b) comprising Boulton Parade                                                                                                                                                       |      |                                |                                |                |

|                                                                                                                                                                                                        |      |      |      |      |
|--------------------------------------------------------------------------------------------------------------------------------------------------------------------------------------------------------|------|------|------|------|
| Southern Link Section 5, between Punt Road and Burnley Street other than that part of the Southern Link leading out of the Burnley Tunnel between the eastern portal of that Tunnel and Burnley Street | 1.82 | 2.92 | 3.47 | 0.91 |
| Southern Link Section 1, between Glenferrie Road and Burnley Street                                                                                                                                    | 1.82 | 2.92 | 3.47 | 0.91 |
| Southern Link Section 5, between Burnley Street and Glenferrie Road                                                                                                                                    | 1.82 | 2.92 | 3.47 | 0.91 |
| Southern Link Section 1, between Punt Road and Swan Street Intersection, other than:                                                                                                                   | 1.14 | 1.82 | 2.17 | 0.57 |
| (a) that part of Southern Link Section 1:                                                                                                                                                              |      |      |      |      |
| (i) between Punt Road and the exit to Boulton Parade; and                                                                                                                                              |      |      |      |      |
| (ii) comprising Boulton Parade; and                                                                                                                                                                    |      |      |      |      |
| (b) that part of the Southern Link leading into the Domain Tunnel between the eastern portal of that Tunnel and Punt Road                                                                              |      |      |      |      |
| Southern Link Section 5, between Swan Street Intersection and Punt Road                                                                                                                                | 1.14 | 1.82 | 2.17 | 0.57 |

## Notes:

- When travelling on Southern Link Section 1 between Burnley Street and Punt Road and then onto Batman Avenue, the Tollable Sections may be combined for the purposes of levying Tolls.
- When travelling on Southern Link Section 1 and into the Domain Tunnel, the Tollable Sections may be combined for the purposes of levying Tolls.
- A reference in the description of a Tollable Section to a part of the Southern Link between a particular street or road and Burnley Street, includes that part of the Southern Link between that particular street or road and where Burnley Street would cross the Southern Link if Burnley Street continued in a straight southerly direction from its southernmost extremity.
- In this table:
  - ‘Boulton Parade’ includes the off-ramp connecting the rest of the Southern Link to Boulton Parade;
  - ‘Burnley Tunnel’ means the eastbound tunnel between Sturt Street and Burnley Street;
  - ‘Domain Tunnel’ means the westbound tunnel between Punt Road and Sturt Street; and
  - ‘Swan Street Intersection’ means the intersection between Swan Street and Batman Avenue.

**Maximum Charge Tolls (\$/vehicle)**

| <b>Category of Vehicle</b>                                                                                                                         | Car  | Light Commercial Vehicle | Heavy Commercial Vehicle | Motor Cycle |
|----------------------------------------------------------------------------------------------------------------------------------------------------|------|--------------------------|--------------------------|-------------|
| Trips where the passage of the Vehicle on the last Tollable Section comprising the Trip before exiting the Link occurs between 6.00 am and 8.00 pm | 6.86 | 9.14                     | 9.14                     | 3.43        |
| Trips where the passage of the Vehicle on the last Tollable Section comprising the Trip before exiting the Link occurs between 8.00 pm and 6.00 am | 6.86 | 6.86                     | 6.86                     | 3.43        |

**Day Tolls (\$/vehicle)**

| <b>Category of Vehicle</b> | Car   | Light Commercial Vehicle | Heavy Commercial Vehicle | Motor Cycle |
|----------------------------|-------|--------------------------|--------------------------|-------------|
| <b>Day Toll</b>            | 13.15 | 21.00                    | 24.95                    | 6.55        |

**Taxi Tolls (\$/Taxi)**

| <b>Trip</b>                                                                                                                  | <b>Taxi Toll</b> |
|------------------------------------------------------------------------------------------------------------------------------|------------------|
| Trips involving use of any or all of the Tollable Sections which comprise the Western Link* and no other Tollable Sections   | 4.10             |
| Trips involving use of any or all of the Tollable Sections which comprise the Southern Link** and no other Tollable Sections | 4.10             |
| Trips involving use of Tollable Sections which comprise both the Western Link* and the Southern Link**                       | 6.40             |

\* The Western Link comprises the following three Tollable Sections:

1. Tullamarine Freeway Upgrade, between Moreland Road and Brunswick Road.
2. Western Link Section 1, between Racecourse Road and Dynon Road.
3. Western Link Section 2, between Footscray Road and West Gate Freeway.

\*\* The Southern Link comprises the following eight Tollable Sections:

1. Domain Tunnel and that part of the Southern Link leading into that Tunnel between the eastern portal of that Tunnel and Punt Road, other than that part of Southern Link Section 1:
  - (a) between Punt Road and the exit to Boulton Parade; and
  - (b) comprising Boulton Parade.



2. Southern Link Section 1, between Burnley Street and Punt Road and including that part of Southern Link Section 1:
  - (a) between Punt Road and the exit to Boulton Parade; and
  - (b) comprising Boulton Parade.
3. Southern Link Section 5, between Punt Road and Burnley Street other than that part of the Southern Link leading out of the Burnley Tunnel between the eastern portal of that Tunnel and Burnley Street.
4. Burnley Tunnel and that part of the Southern Link leading out of that Tunnel between the eastern portal of that Tunnel and Burnley Street.
5. Southern Link Section 1, between Glenferrie Road and Burnley Street.
6. Southern Link Section 5, between Burnley Street and Glenferrie Road.
7. Southern Link Section 1, between Punt Road and Swan Street Intersection, other than:
  - (a) that part of Southern Link Section 1:
    - (i) between Punt Road and the exit to Boulton Parade; and
    - (ii) comprising Boulton Parade; and
  - (b) that part of the Southern Link leading into the Domain Tunnel between the eastern portal of that Tunnel and Punt Road.
8. Southern Link Section 5, between Swan Street Intersection and Punt Road.

**Taxi Day Tolls (\$/Taxi)**

| <b>Taxi</b>                          | <b>Taxi Day Toll</b> |
|--------------------------------------|----------------------|
| Metropolitan Taxi                    | 13.15                |
| A Taxi not being a Metropolitan Taxi | 7.00                 |

CityLink Melbourne intends that each Charge Toll, Maximum Charge Toll, Day Toll, Taxi Toll and Taxi Day Toll specified above will first apply in the quarter ending 31 March 2011.

Capitalised terms in this notice that are defined in the Concession Deed have the same meaning as given by the Concession Deed.

E. M. MILDWATER  
Company Secretary  
CityLink Melbourne Limited  
(ABN 65 070 810 678)

B. J. BOURKE  
Director  
CityLink Melbourne Limited  
(ABN 65 070 810 678)

This page was left blank intentionally

### PRICING FOR SPECIAL GAZETTE, PERIODICAL GAZETTE AND VICTORIAN LEGISLATION

Retail price varies according to the number of pages in each Victoria Government Special Gazette, Victoria Government Periodical Gazette and Victorian legislation. The table below sets out the prices that apply.

| <i>Price Code</i> | <i>No. of Pages<br/>(Including cover<br/>and blank pages)</i> | <i>Price*</i> | <i>Price Code</i>                                    | <i>No. of Pages<br/>(Including cover<br/>and blank pages)</i> | <i>Price*</i> |
|-------------------|---------------------------------------------------------------|---------------|------------------------------------------------------|---------------------------------------------------------------|---------------|
| A                 | 1–16                                                          | \$3.80        | # Z                                                  | 1406–1470                                                     | \$113.00      |
| B                 | 17–32                                                         | \$5.70        | # ZA                                                 | 1471–1535                                                     | \$118.00      |
| C                 | 33–48                                                         | \$7.80        | # ZB                                                 | 1536–1610                                                     | \$123.00      |
| D                 | 49–96                                                         | \$12.20       | # ZC                                                 | 1611–1665                                                     | \$128.00      |
| E                 | 97–144                                                        | \$15.75       | # ZD                                                 | 1666–1730                                                     | \$133.00      |
| F                 | 145–192                                                       | \$18.65       | # ZE                                                 | 1731–1795                                                     | \$138.00      |
| G                 | 193–240                                                       | \$21.50       | # ZF                                                 | 1796–1860                                                     | \$143.00      |
| H                 | 241–288                                                       | \$22.90       | # ZG                                                 | 1861–1925                                                     | \$148.00      |
| I                 | 289–352                                                       | \$25.75       | # ZH                                                 | 1926–1990                                                     | \$153.00      |
| J                 | 353–416                                                       | \$30.10       | # ZI                                                 | 1991–2055                                                     | \$158.00      |
| K                 | 417–480                                                       | \$34.35       | * All prices include GST<br># Printed as two volumes |                                                               |               |
| L                 | 481–544                                                       | \$40.10       |                                                      |                                                               |               |
| M                 | 545–608                                                       | \$45.80       |                                                      |                                                               |               |
| N                 | 609–672                                                       | \$50.55       |                                                      |                                                               |               |
| O                 | 673–736                                                       | \$57.25       |                                                      |                                                               |               |
| P                 | 737–820                                                       | \$63.00       |                                                      |                                                               |               |
| # Q               | 821–885                                                       | \$68.50       |                                                      |                                                               |               |
| # R               | 886–950                                                       | \$73.00       |                                                      |                                                               |               |
| # S               | 951–1015                                                      | \$78.00       |                                                      |                                                               |               |
| # T               | 1016–1080                                                     | \$83.00       |                                                      |                                                               |               |
| # U               | 1081–1145                                                     | \$88.00       |                                                      |                                                               |               |
| # V               | 1146–1210                                                     | \$93.00       |                                                      |                                                               |               |
| # W               | 1211–1275                                                     | \$98.00       |                                                      |                                                               |               |
| # X               | 1276–1340                                                     | \$103.00      |                                                      |                                                               |               |
| # Y               | 1341–1405                                                     | \$108.00      |                                                      |                                                               |               |

**bluestar★PRINT**

The *Victoria Government Gazette* is published by Blue Star Print with the authority of the Government Printer for the State of Victoria

© State of Victoria 2010

This publication is copyright. No part may be reproduced by any process except in accordance with the provisions of the Copyright Act.

Address all enquiries to the Government Printer for the State of Victoria  
Level 2 1 Macarthur Street  
Melbourne 3002  
Victoria Australia

**How To Order****Mail Order****Victoria Government Gazette**

Level 5 460 Bourke Street  
Melbourne 3000  
PO Box 1957 Melbourne 3001  
DX 106 Melbourne

**Telephone**

(03) 8523 4601

**Fax**

(03) 9600 0478

**email**

gazette@bluestargroup.com.au

**Retail &  
Mail Sales****Victoria Government Gazette**

Level 5 460 Bourke Street  
Melbourne 3000  
PO Box 1957 Melbourne 3001

**Telephone**

(03) 8523 4601

**Fax**

(03) 9600 0478

**Retail  
Sales****Information Victoria**

505 Little Collins Street  
Melbourne 3000

**Telephone**

1300 366 356

**Fax**

(03) 9603 9920

ISSN 0819-5471

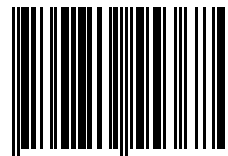

9 770819 553684

**Recommended Retail Price \$1.95 (includes GST)**