



Victoria Government Gazette

No. S 356 Friday 3 September 2010
By Authority of Victorian Government Printer

Road Management Act 2004

ROAD DECLARATIONS AND DISCONTINUATIONS

ROAD DECLARATIONS

VicRoads, pursuant to sections 11 and 14 of the **Road Management Act 2004**, upon publication of this notice declares and revokes the roads described in Schedule A and on the plans attached.

ROAD DISCONTINUATIONS

VicRoads, pursuant to section 12 of the **Road Management Act 2004**, upon publication of this notice discontinues the roads or parts of the roads described in Schedule B and on the plans attached and approves the sale of the surplus land as provided in section 94 of the **Transport Integration Act 2010** and as delegated by the Minister for Roads and Ports under section 31 of the latter said Act.

SCHEDULE A

ARTERIAL ROAD

- a) Those parts of McDonalds Road identified by hatching on the plans numbered GP21521 and GP21521A are declared or revoked as described in the legend in the said plans.
- b) That part of Lower Dandenong Road identified by hatching on the plan numbered GP21112A is declared as described in the legend in the said plan.
- c) That part of Cheltenham Road identified by hatching on the plan numbered GP21113A is declared as described in the legend in the said plan.
- d) Those parts of Pyrenees Highway identified by hatching on the plan numbered GP21358 are declared as described in the legend in the said plan.
- e) Those parts of Main Whittlesea Road identified by hatching on the plans numbered GP21002, GP21004 and GP21006 are declared as described in the legend in the said plans.

MUNICIPAL ROAD

- f) That part of Ferres Boulevard identified by hatching on the plan numbered GP21521B is declared as described in the legend in the said plan.
- g) That part of The Gateway identified by hatching on the plan numbered GP21230 is declared as described in the legend in the said plan.

SCHEDULE B

- a) Those parts of McDonalds Road identified by cross hatching on the plan numbered GP21521 and GP21521A are discontinued as described in the legend in the said plan.
- b) Those parts of Road identified by hatching on the plan numbered GP21521C are discontinued as described in the legend in the said plan.
- c) That part of Civic Drive identified by hatching on the plan numbered GP21521D is discontinued as described in the legend in the said plan.

SPECIAL

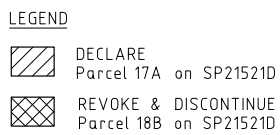
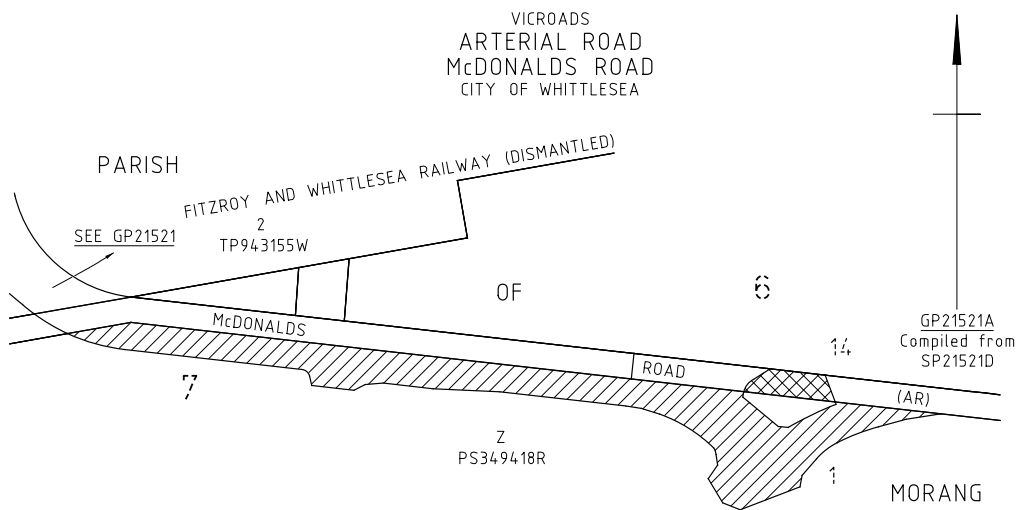
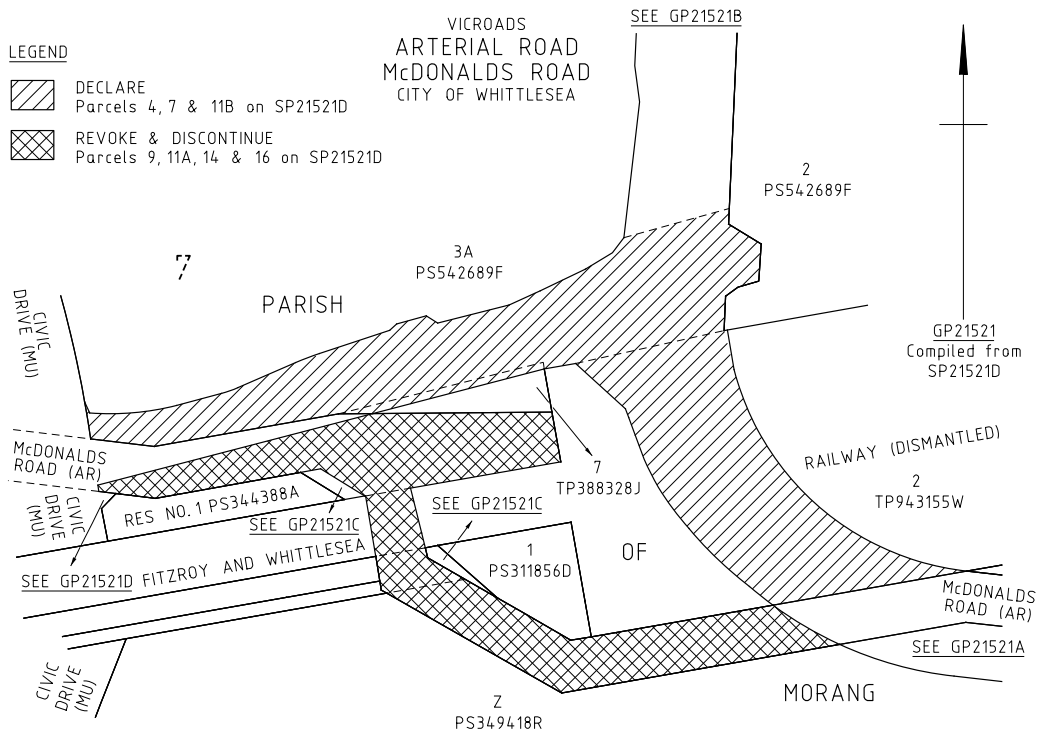

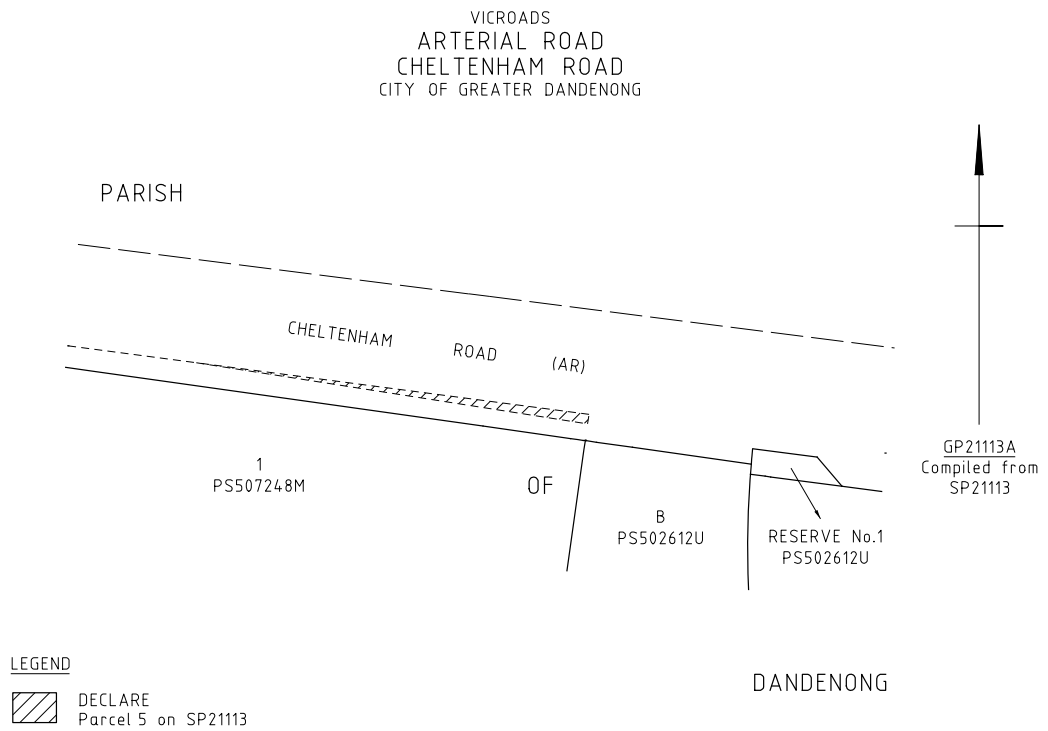
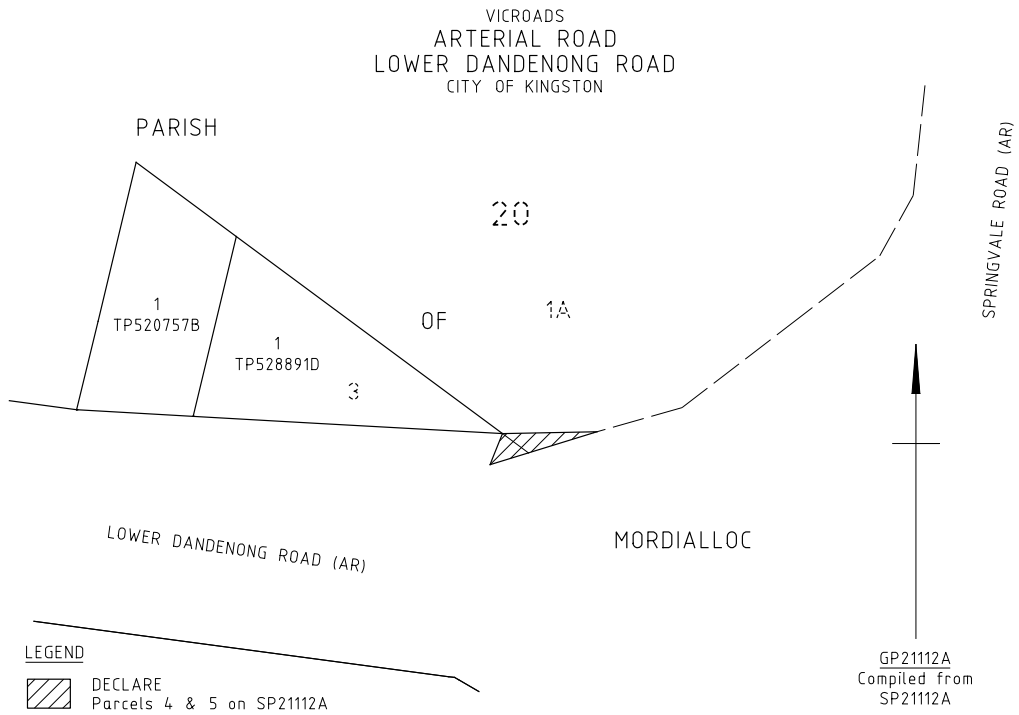

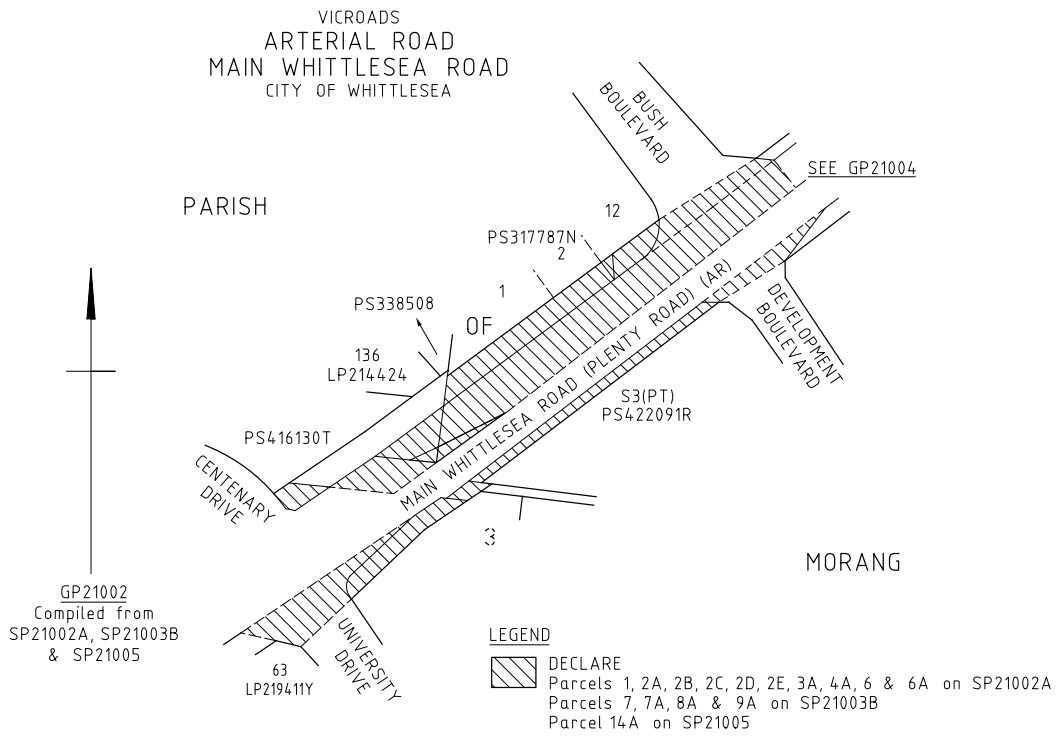
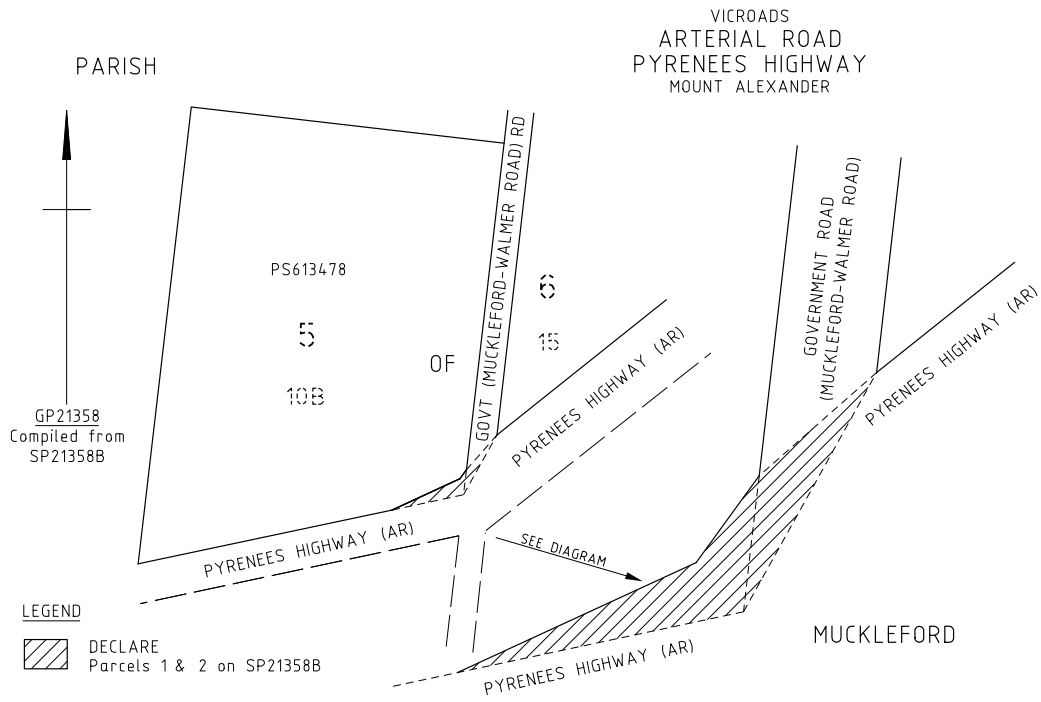

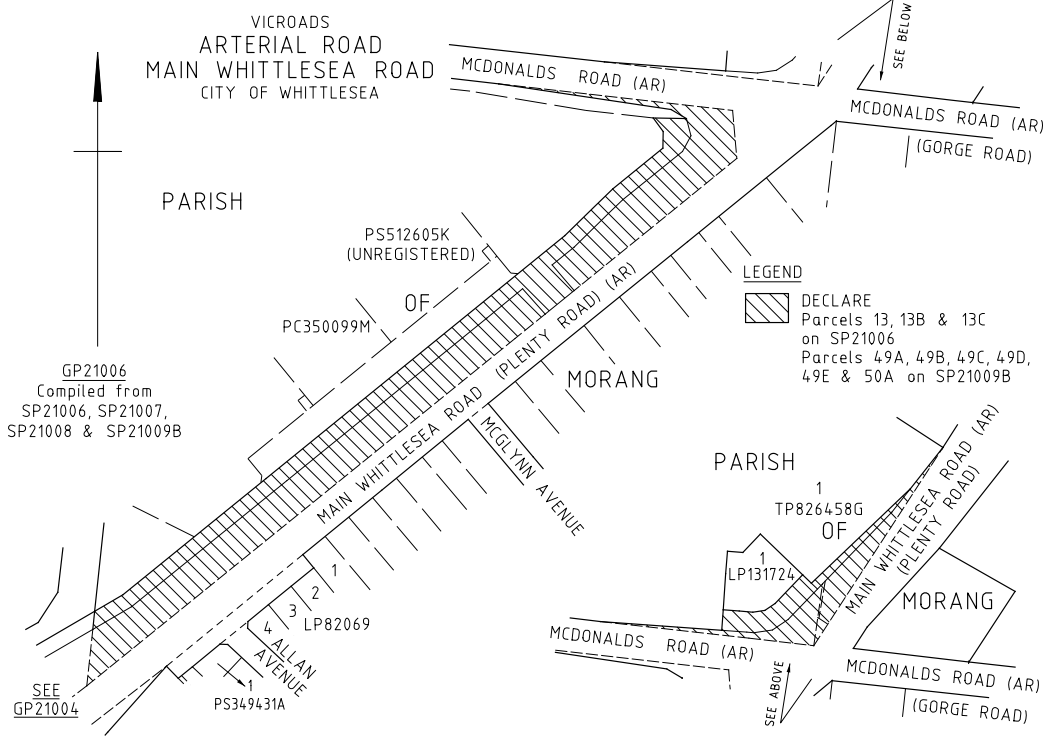
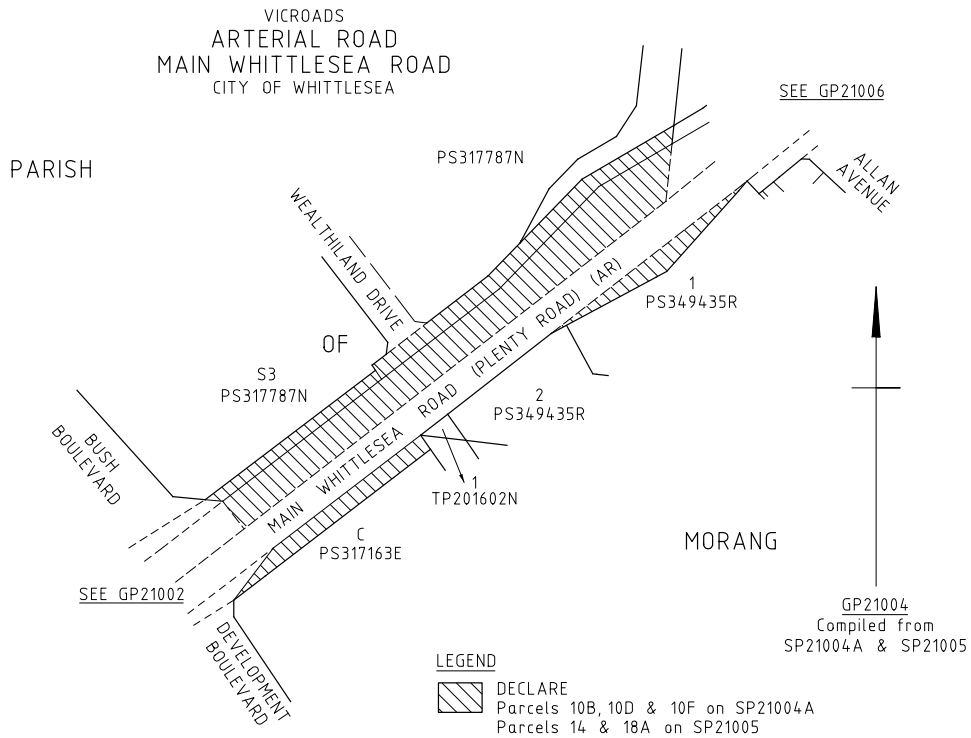

VICROADS
MUNICIPAL ROAD
FERRES BOULEVARD
CITY OF WHITTLESEA

LEGEND

 DECLARE
Parcel 2 on SP21521D

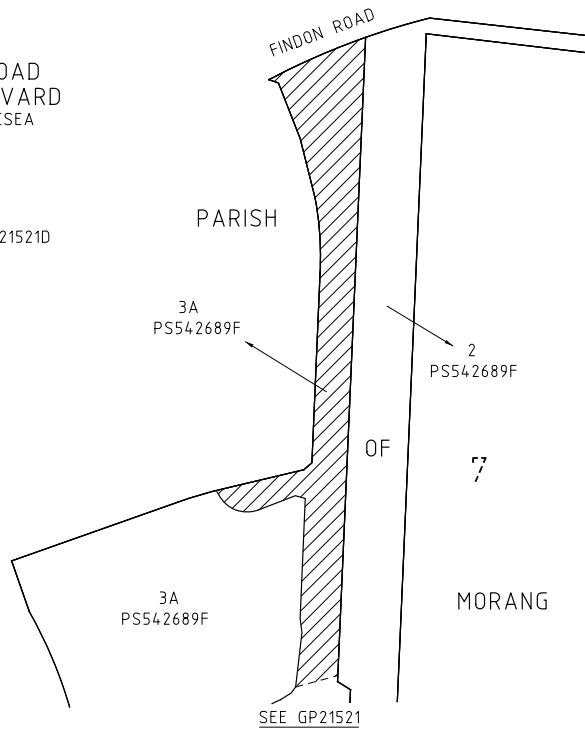

GP21521B
Compiled from
SP21521D

PARISH



GP21230
Compiled from
SP21230 &
Vicmap Digital Property
(March 2010)

VICROADS
MUNICIPAL ROAD
THE GATEWAY
CITY OF HOBSONS BAY

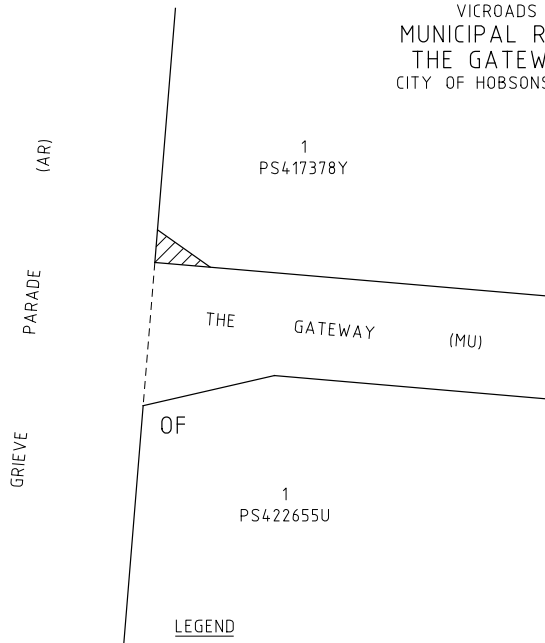

LEGEND

 DECLARE
Parcel 1 on SP21230

TRUGANINA

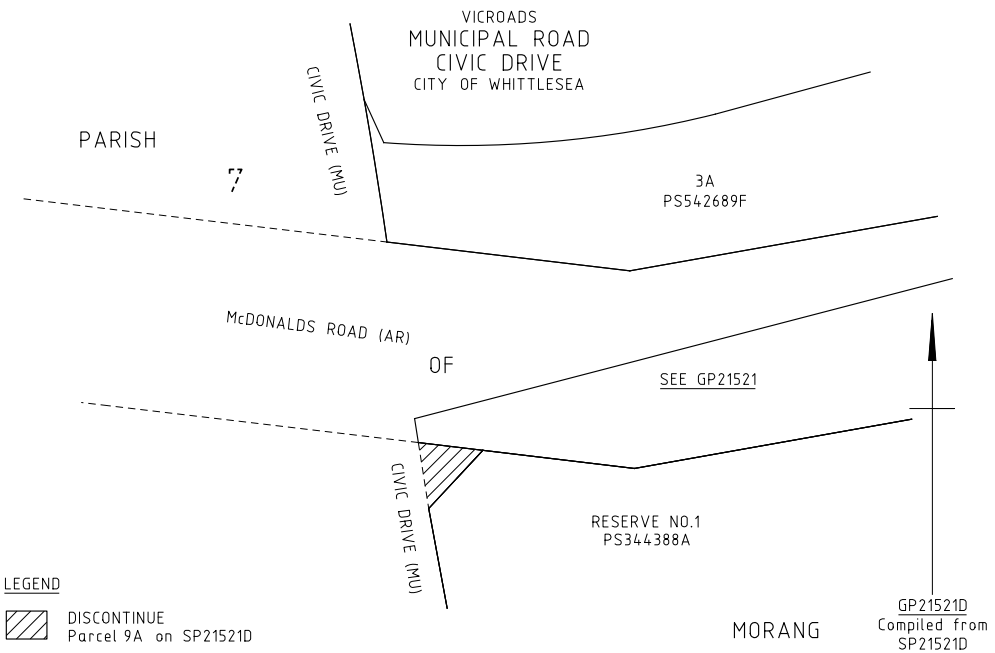
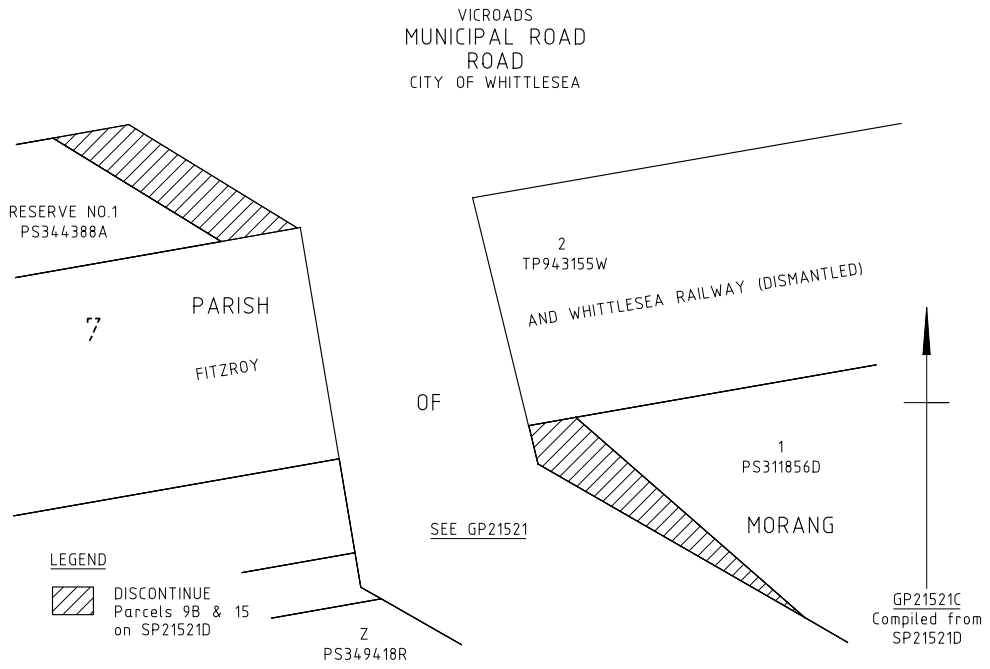

Dated 28 August 2010

GARY LIDDLE
Chief Executive
VicRoads

bluestar  **PRINT**

The *Victoria Government Gazette* is published by Blue Star Print with the authority of the Government Printer for the State of Victoria

© State of Victoria 2010

This publication is copyright. No part may be reproduced by any process except in accordance with the provisions of the Copyright Act.

Address all enquiries to the Government Printer for the State of Victoria

Level 2 1 Macarthur Street
Melbourne 3002
Victoria Australia

How To Order**Mail Order****Victoria Government Gazette**

Level 5 460 Bourke Street
Melbourne 3000
PO Box 1957 Melbourne 3001
DX 106 Melbourne

**Telephone**

(03) 8523 4601

**Fax**

(03) 9600 0478

email

gazette@bluestargroup.com.au

**Retail &
Mail Sales****Victoria Government Gazette**

Level 5 460 Bourke Street
Melbourne 3000
PO Box 1957 Melbourne 3001

**Telephone**

(03) 8523 4601

**Fax**

(03) 9600 0478

**Retail
Sales****Information Victoria**

505 Little Collins Street
Melbourne 3000

**Telephone**

1300 366 356

**Fax**

(03) 9603 9920

Price Code A