



Victoria Government Gazette

No. S 246 Tuesday 26 July 2011
By Authority of Victorian Government Printer

Road Management Act 2004

ROAD DECLARATIONS, REVOCATIONS AND DISCONTINUATIONS

ROAD DECLARATIONS AND REVOCATIONS

VicRoads, pursuant to sections 11 and 14 of the **Road Management Act 2004**, upon publication of this notice declares or revokes the roads described in Schedule A and on the plans attached.

ROAD DISCONTINUATIONS

VicRoads, pursuant to section 12 of the **Road Management Act 2004**, upon publication of this notice discontinues the roads or parts of the roads described in Schedule B and on the plans attached and approves the sale of the surplus land as provided in section 94 of the **Transport Integration Act 2010** and as delegated by the Minister for Roads under section 31 of the latter said Act.

SCHEDULE A

FREEWAY

- a) That part of Calder Freeway identified by hatching on the plan numbered GP21577B is declared as described in the legend in the said plan.

ARTERIAL ROAD

- b) That part of Hyland Highway identified by hatching on the plan numbered GP22331 is declared as described in the legend in the said plan.
- c) That part of Elphinstone–Harcourt North Road identified by hatching on the plan numbered GP22232 is revoked as described in the legend in the said plan.
- d) That part of Malmsbury–Elphinstone Road identified by hatching on the plan numbered GP22232 is revoked as described in the legend in the said plan.
- e) That part of Western Highway identified by hatching on the plan numbered GP22231 is declared as described in the legend in the said plan.
- f) That part of Melbourne–Lancefield Road identified by hatching on the plans numbered GP22022 and GP22022A is declared and revoked as described in the legend in the said plans.
- g) Those parts of Old Dandenong Road identified by hatching on the plan numbered GP21296 are declared as described in the legend in the said plan.
- h) That part of Heatherton Road identified by hatching on the plan numbered GP21296 is declared as described in the legend in the said plan.

SCHEDULE B

ARTERIAL ROAD

- a) That part of Elphinstone–Harcourt North Road identified by hatching on the plan numbered GP22232 is discontinued as described in the legend in the said plan.
- b) That part of Malmsbury–Elphinstone Road identified by hatching on the plan numbered GP22232 is discontinued as described in the legend in the said plan.
- c) That part of Melbourne–Lancefield Road identified by hatching on the plan numbered GP22022A is discontinued as described in the legend in the said plan.

MUNICIPAL ROAD

- d) That part of Rices Lane identified by hatching on the plan numbered GP22093A is discontinued as described in the legend in the said plan.

SPECIAL

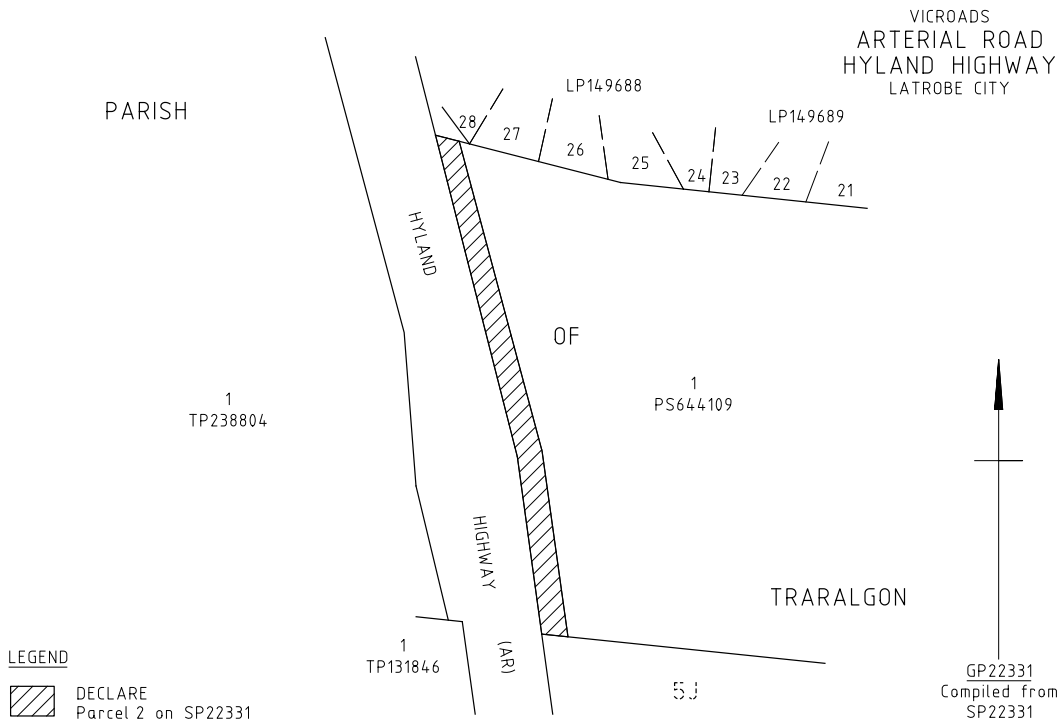
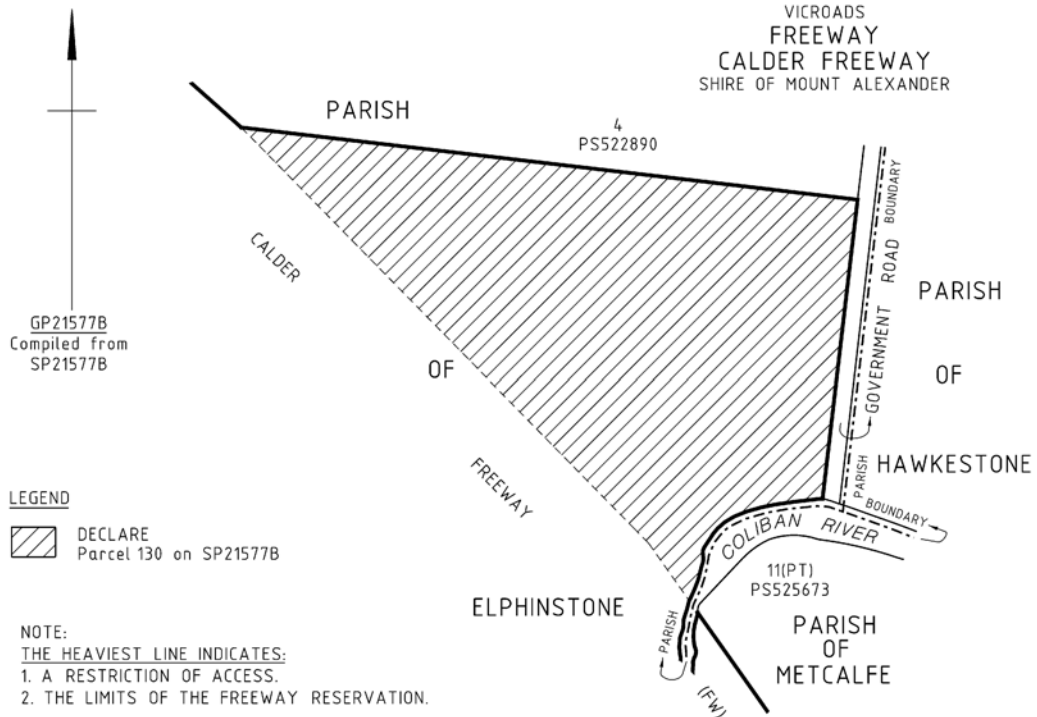

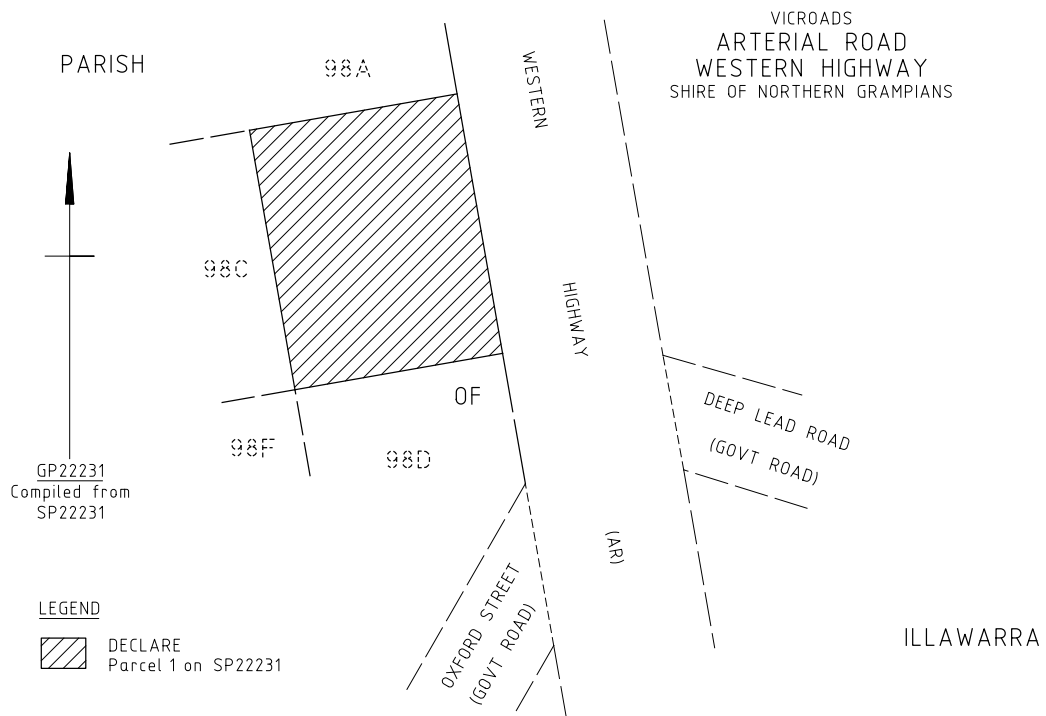
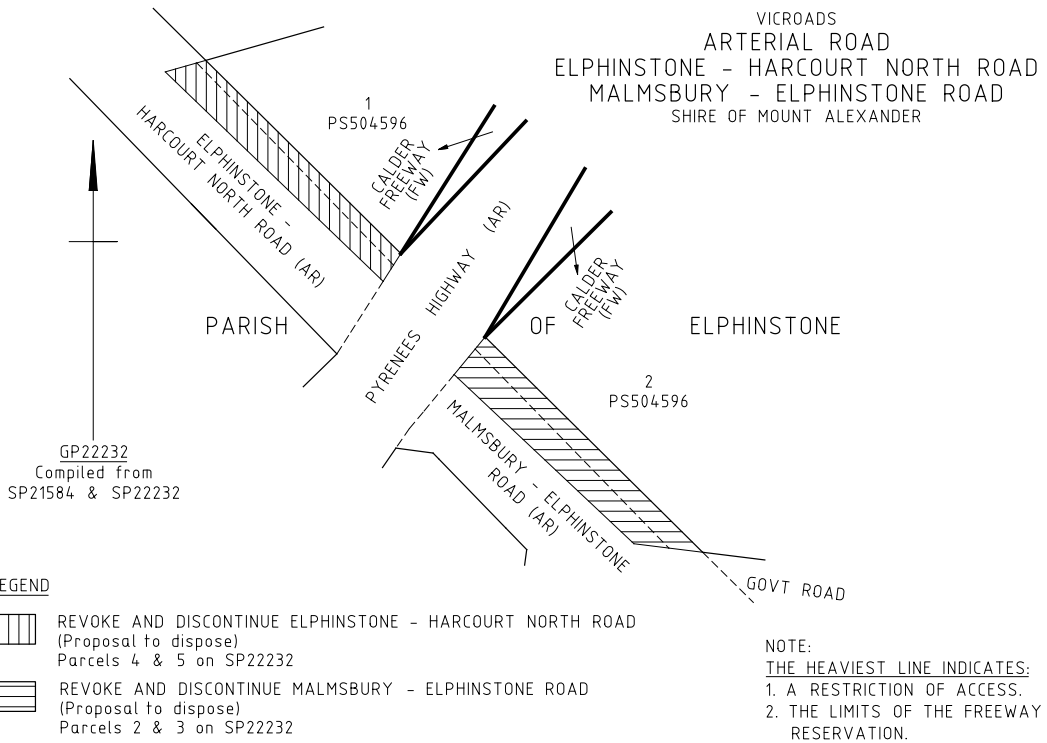

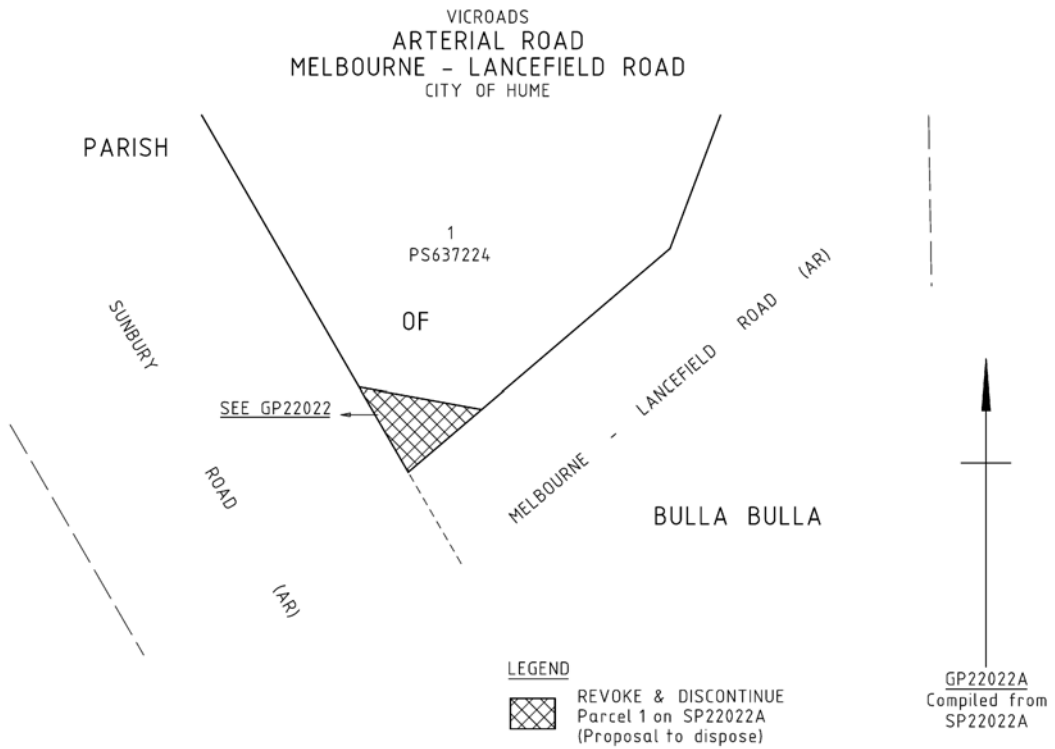
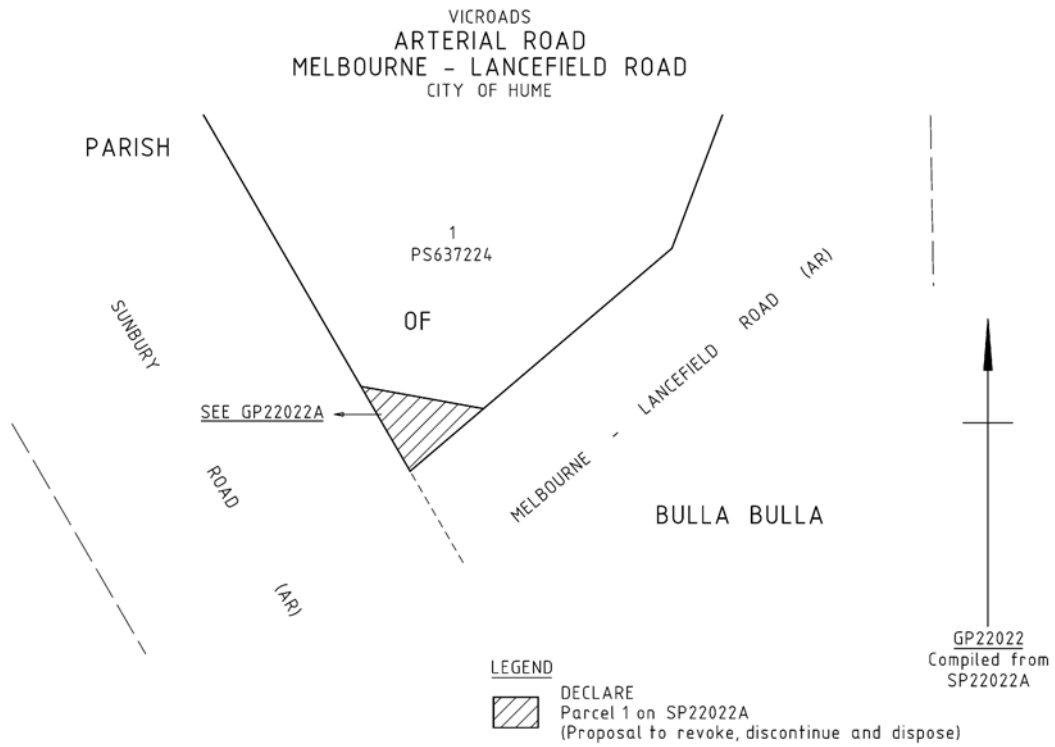

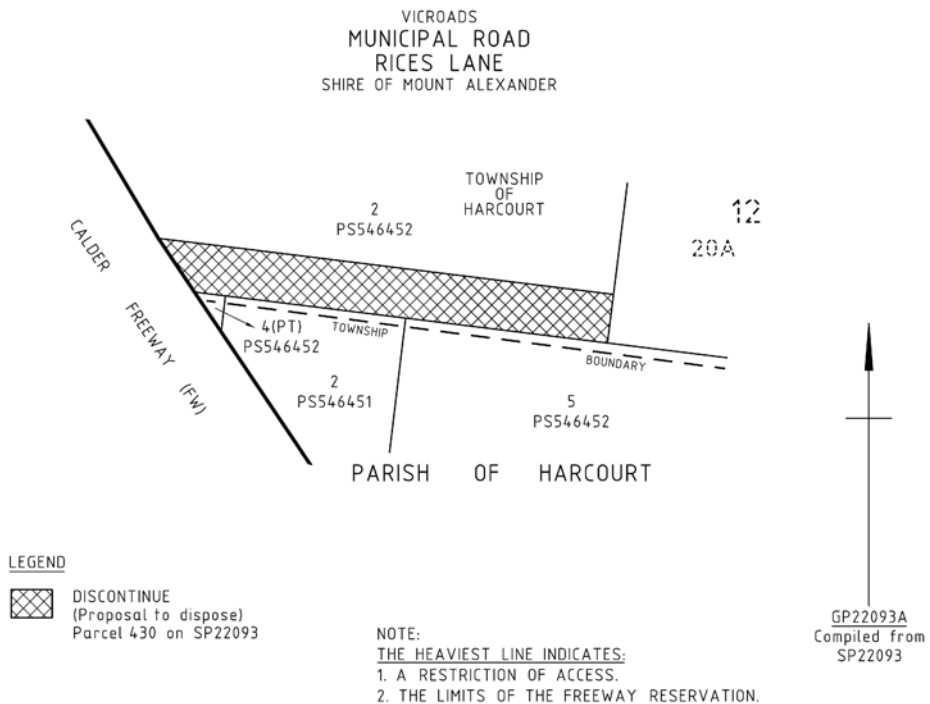
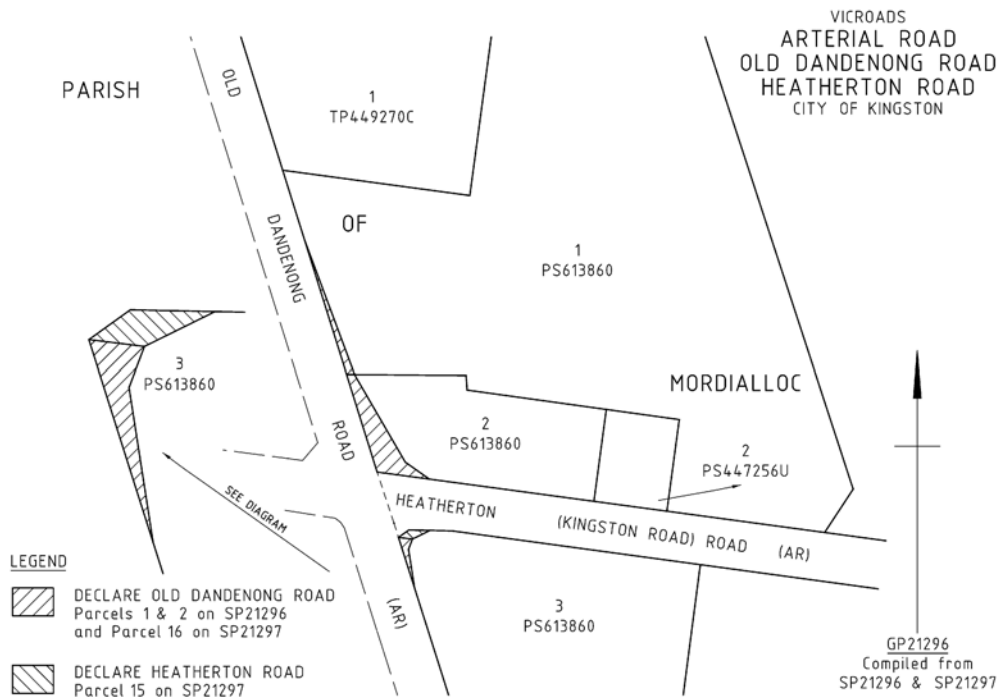

Dated 19 July 2011

GARY LIDDLE
Chief Executive
VicRoads

This page was left blank intentionally

This page was left blank intentionally

bluestar  **PRINT**

The *Victoria Government Gazette* is published by Blue Star Print with the authority of the Government Printer for the State of Victoria

© State of Victoria 2011

This publication is copyright. No part may be reproduced by any process except in accordance with the provisions of the Copyright Act.

Address all enquiries to the Government Printer for the State of Victoria

Level 2 1 Macarthur Street
Melbourne 3002
Victoria Australia

How To Order**Mail Order****Victoria Government Gazette**

Level 5 460 Bourke Street
Melbourne 3000
PO Box 1957 Melbourne 3001
DX 106 Melbourne

**Telephone**

(03) 8523 4601

**Fax**

(03) 9600 0478

email

gazette@bluestargroup.com.au

**Retail &
Mail Sales****Victoria Government Gazette**

Level 5 460 Bourke Street
Melbourne 3000
PO Box 1957 Melbourne 3001

**Telephone**

(03) 8523 4601

**Fax**

(03) 9600 0478

**Retail
Sales****Information Victoria**

505 Little Collins Street
Melbourne 3000

**Telephone**

1300 366 356

**Fax**

(03) 9603 9920

Price Code A