



# Victoria Government Gazette

No. S 402 Thursday 29 November 2012  
By Authority of Victorian Government Printer

## Road Management Act 2004

### ROAD DECLARATIONS AND DISCONTINUATIONS

#### ROAD DECLARATIONS

VicRoads, pursuant to sections 11 and 14 of the **Road Management Act 2004**, upon publication of this notice revokes or declares the roads described in Schedule A and on the plans attached. VicRoads also authorises the access point described in Schedule B and on the plan attached. The effects of these revocations and declarations on road names are described in Table 1.

#### ROAD DISCONTINUATIONS

VicRoads, pursuant to section 12 of the **Road Management Act 2004**, upon publication of this notice discontinues parts of the roads described in Schedule C and on the plans attached and approves the sale of the surplus land as provided in section 94 of the **Transport Integration Act 2010** and as delegated by the Minister for Roads under section 31 of the latter said Act.

#### SCHEDULE A

##### FREEWAY

- a) Those parts of Princes Freeway identified by hatching on the plans numbered GP21125A and GP21550A are declared as described in the legend in the said plans.

##### ARTERIAL ROAD

- b) That part of Cheltenham Road identified by hatching on the plan numbered GP21141 is revoked as described in the legend in the said plan.

##### MUNICIPAL ROAD

- c) Those parts of George Street identified by hatching on the plans numbered GP21142 and GP21143 are declared as described in the legend in the said plans.
- d) Those parts of Road identified by hatching on the plan numbered GP21282 are declared as described in the legend in the said plan.
- e) Those parts of Thornhill Road identified by hatching on the plan numbered GP21282 are declared as described in the legend in the said plan.
- f) That part of Broderick Road identified by hatching on the plan numbered GP21551B is declared as described in the legend in the said plan.
- g) That part of Metcalfe–Taradale Road identified by hatching on the plan numbered GP21576C is revoked as described in the legend in the said plan.

#### SCHEDULE B

Plan No. (Identifier)	Purpose of Access Point	Authorised Users
GP21550A (AA1)	Water Utility Access	Water Utility Only
The access point is authorised for the time being only and VicRoads may withdraw the authorisation at any time it so desires.		

**SPECIAL**

**SCHEDULE C****MUNICIPAL ROAD**

- a) Those parts of Road identified by hatching on the plan numbered GP21143A are discontinued as described in the legend in the said plan.
- b) That part of Metcalfe–Taradale Road identified by hatching on the plan numbered GP21576C is discontinued as described in the legend in the said plan.
- c) That part of Road identified by hatching on the plan numbered GP22232A is discontinued as described in the legend in the said plan.

**TABLE 1****EFFECTS ON ROAD NAMES**

1. Names in Column 2 are unaffected by this notice, unless otherwise stated.
2. **Column 1 names are for VicRoads administrative purposes only and are independent of names in Column 2.**
3. Names in Column 2 may not apply to the whole length of the road and are for general information purposes only.

**FREEWAY**

<b>GP Number</b>	<b>VicRoads Administrative Name Column 1</b>	<b>Primary Road Name for Addressing Purposes Column 2</b>
GP21125A GP21550A	Princes Freeway	Not Applicable

**ARTERIAL ROAD**

<b>GP Number</b>	<b>VicRoads Administrative Name Column 1</b>	<b>Primary Road Name for Addressing Purposes Column 2</b>
GP21141	Cheltenham Road	Cheltenham Road

**MUNICIPAL ROAD**

<b>GP Number</b>	<b>VicRoads Administrative Name Column 1</b>	<b>Primary Road Name for Addressing Purposes Column 2</b>
GP21142 GP21143	None	George Street
GP21143A	None	None
GP21282	None	Thornhill Road Pigdons Road
GP21551B	None	Broderick Road
GP21576C	None	Metcalfe–Taradale Road
GP22232A	None	None

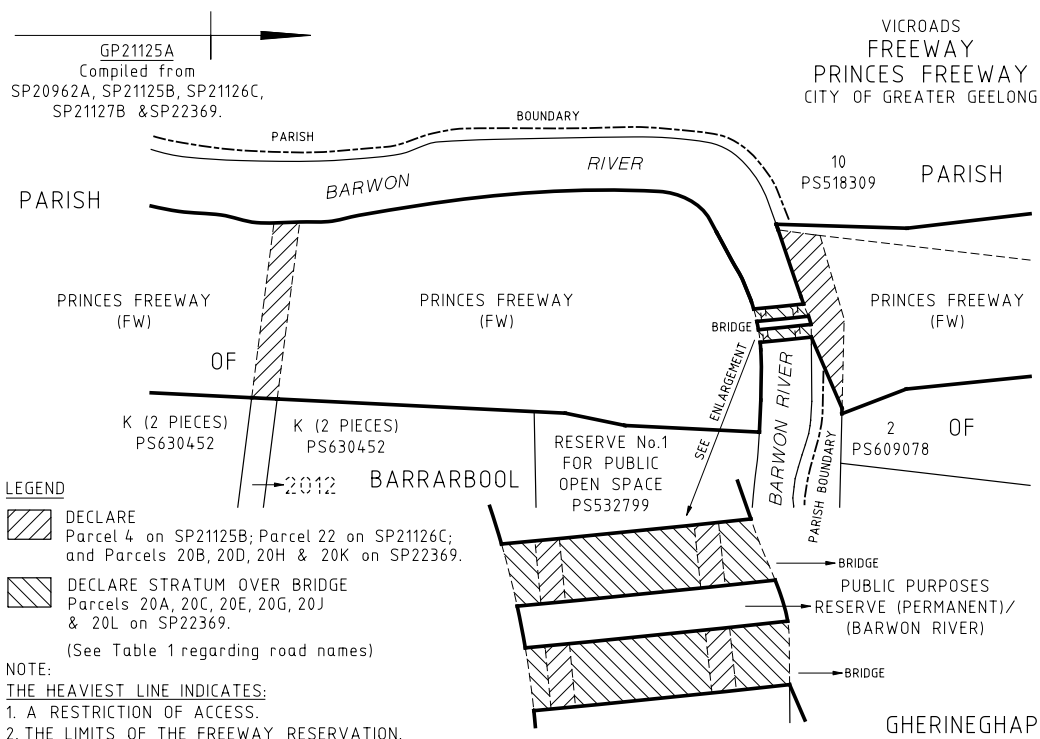

**NOTE:**  
THE HEAVIEST LINE INDICATES:  
1. A RESTRICTION OF ACCESS.  
2. THE LIMITS OF THE FREEWAY RESERVATION.

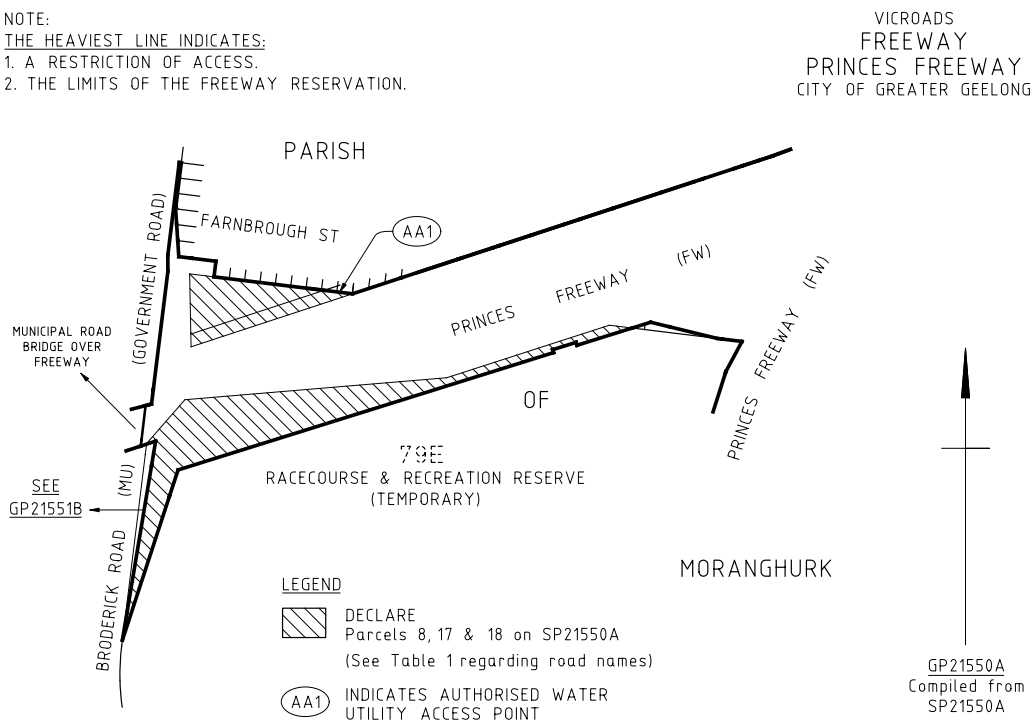

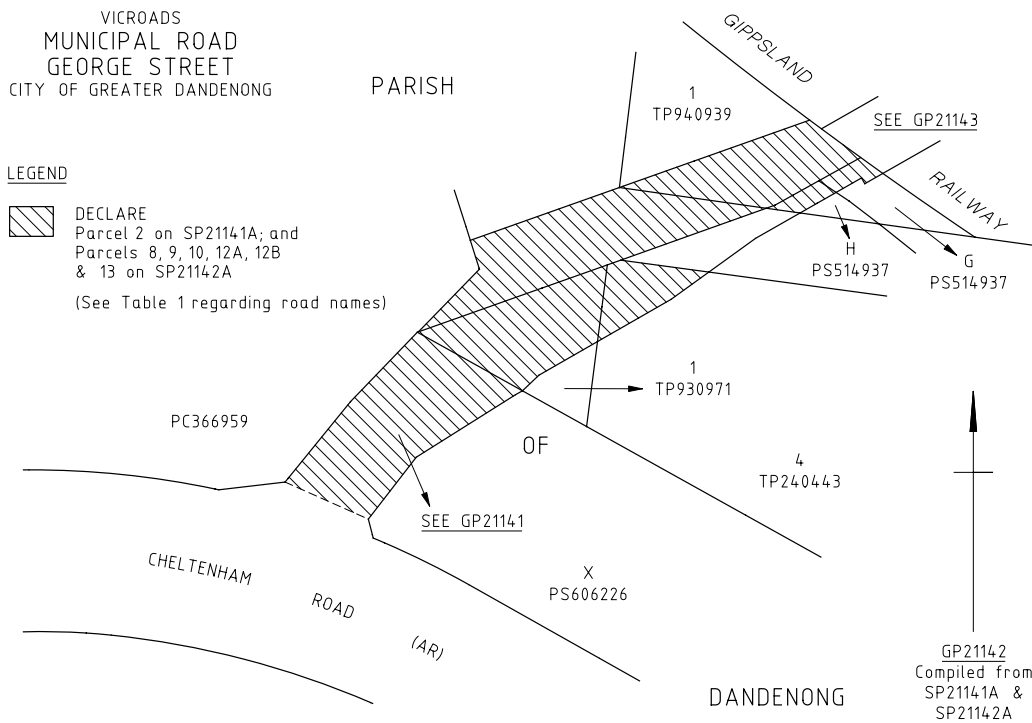
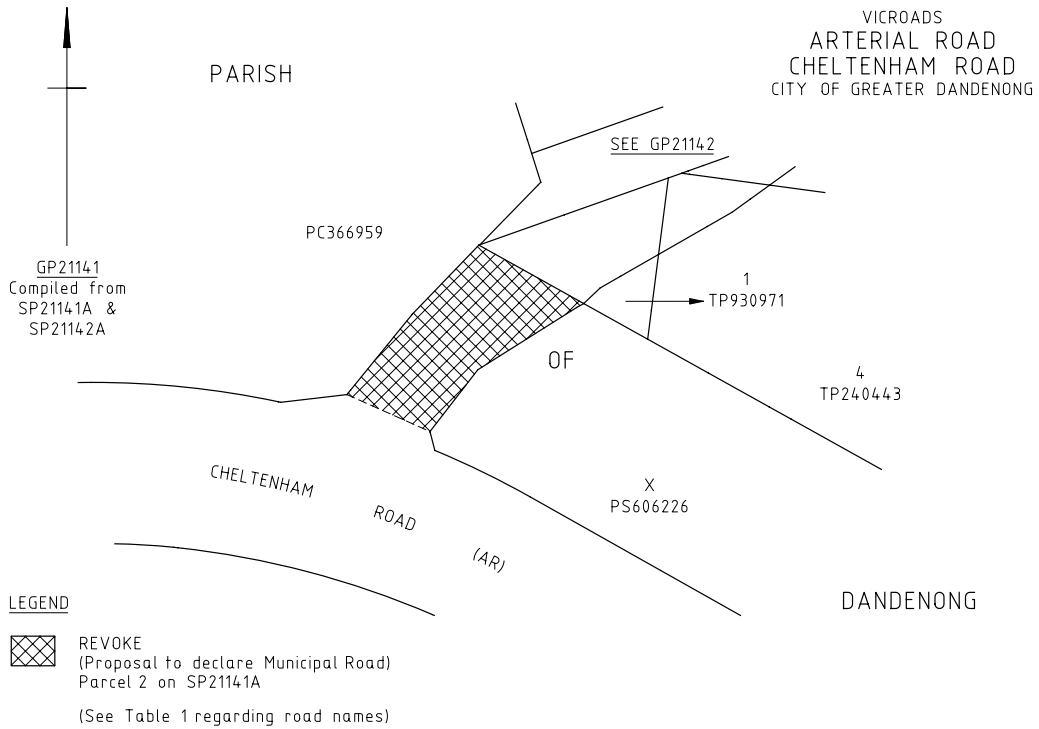

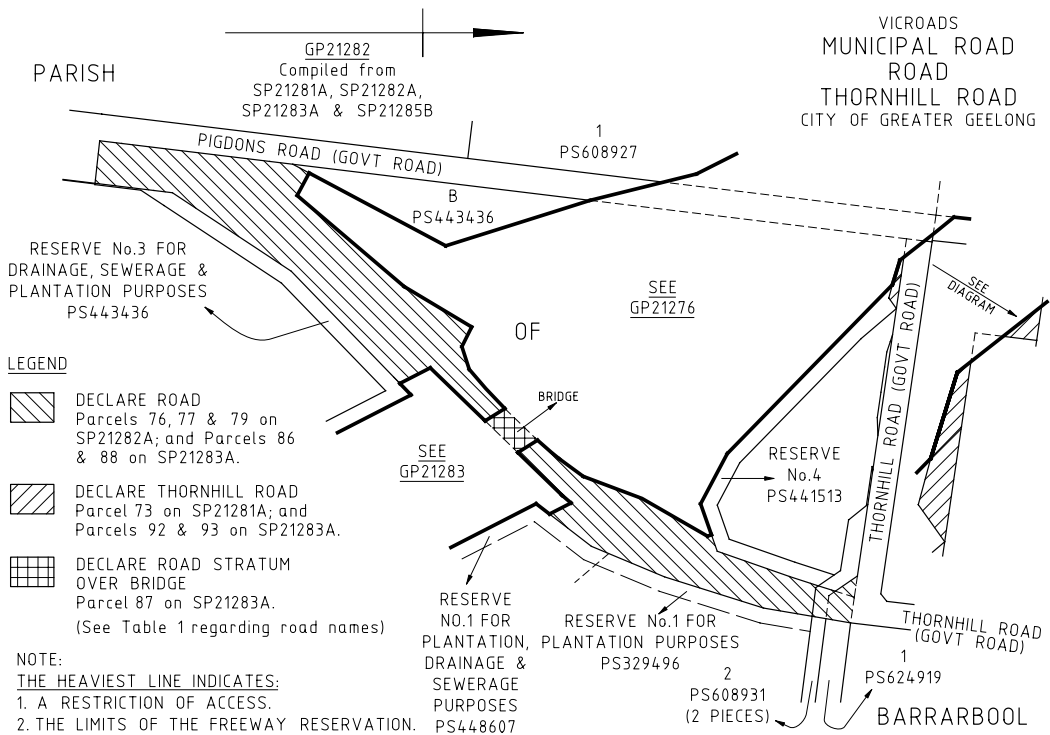
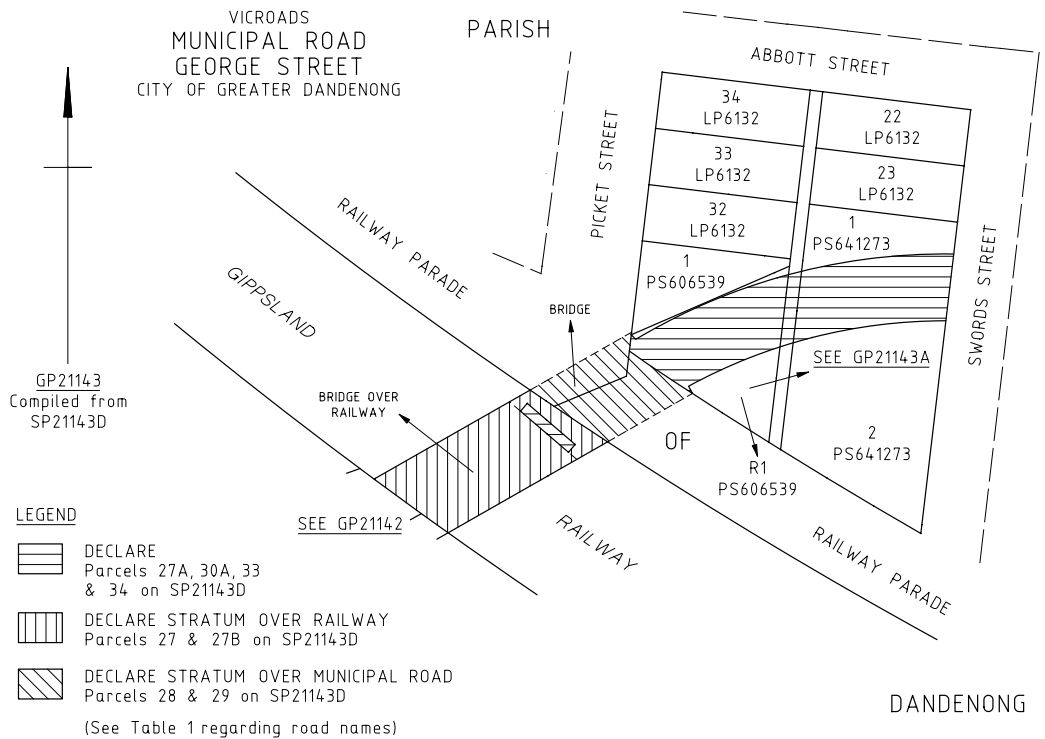

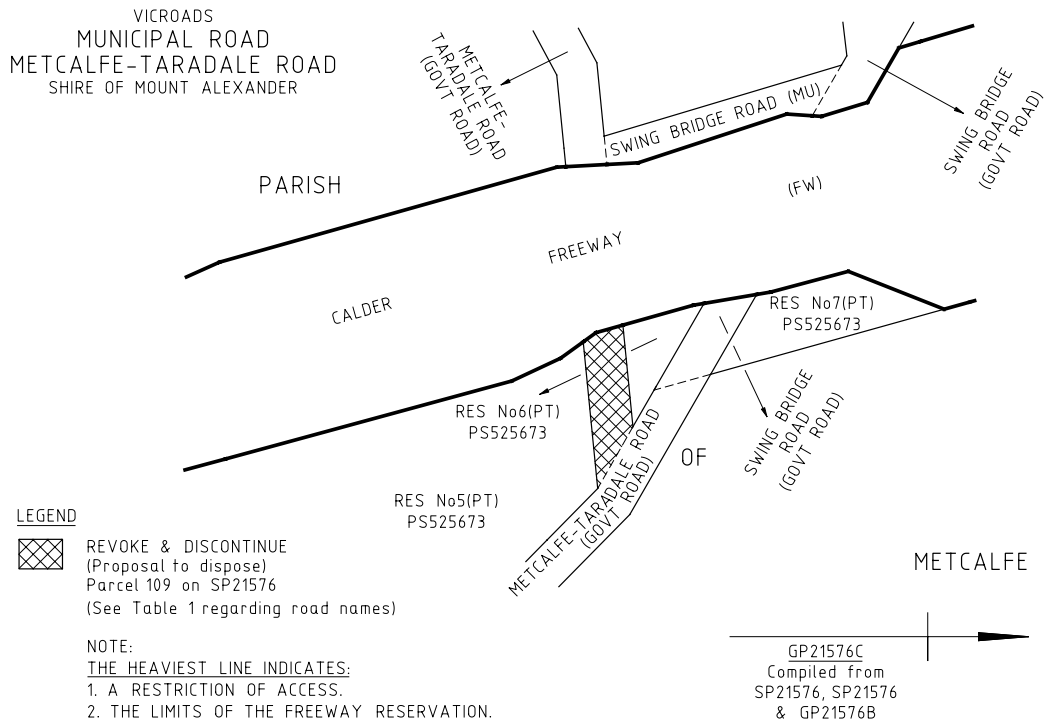
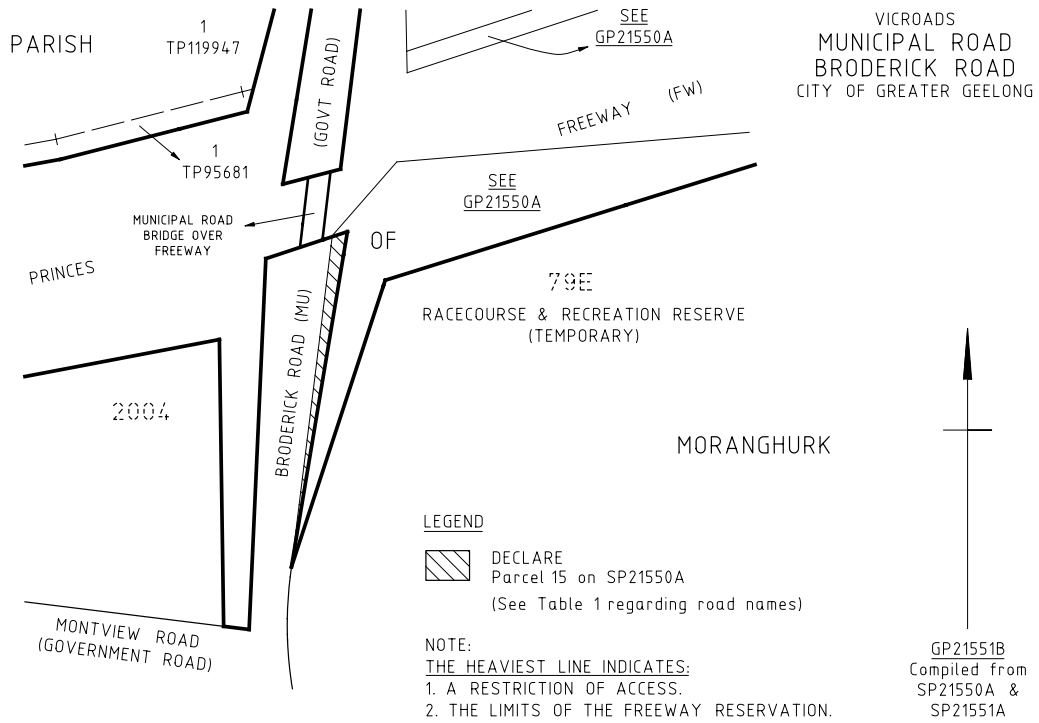

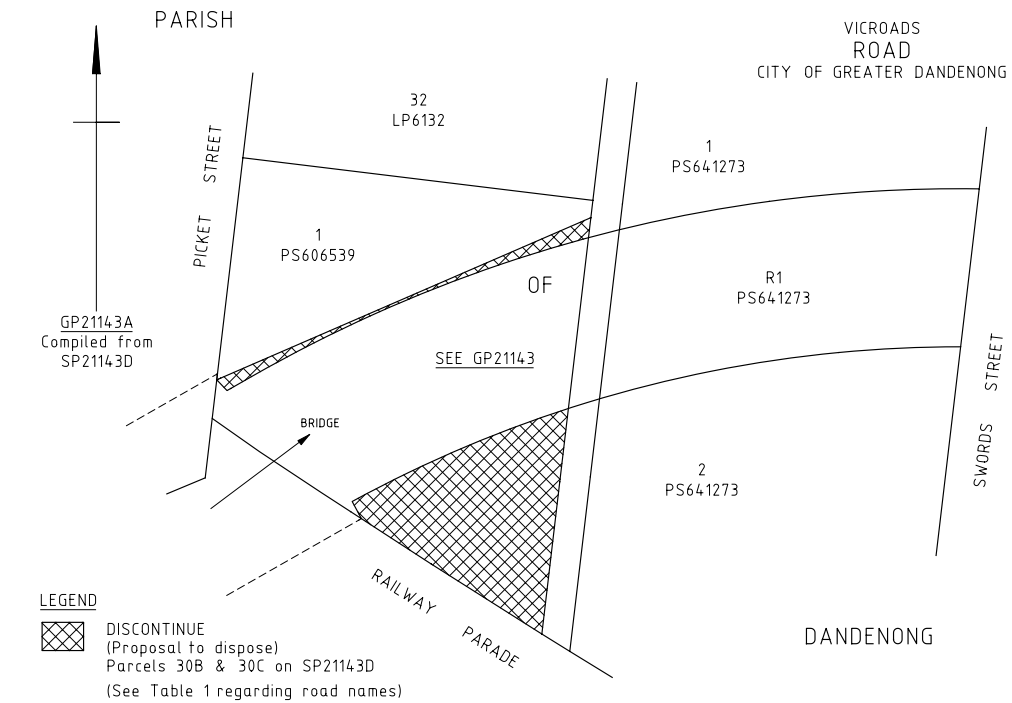

VICROADS ROAD  
SHIRE OF MOUNT ALEXANDER

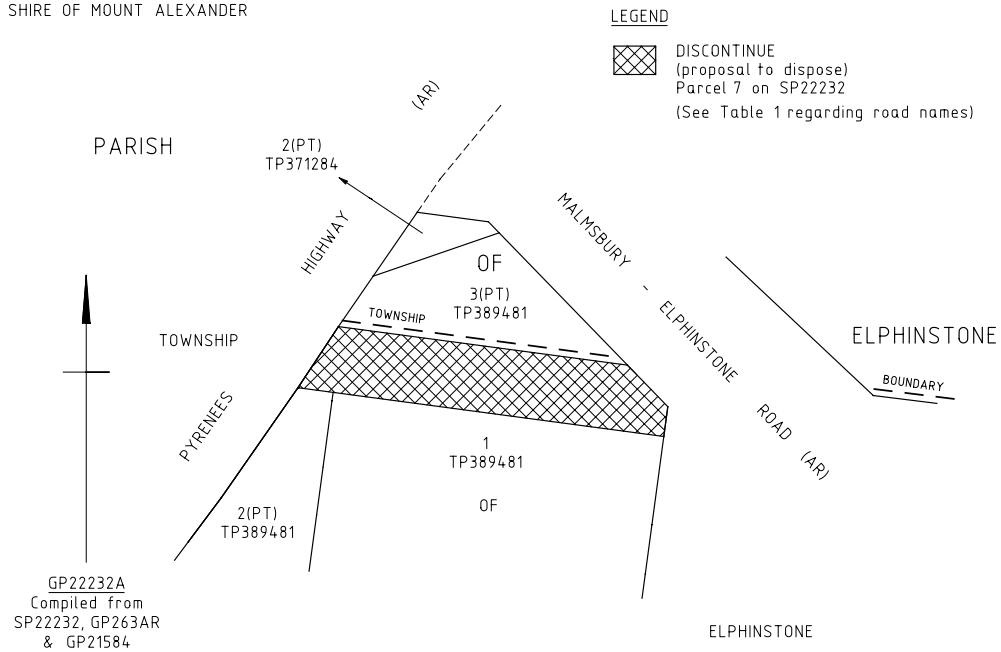

Dated 25 November 2012

GARY LIDDLE  
Chief Executive  
VicRoads

**bluestar** \* **PRINT**

The *Victoria Government Gazette* is published by Blue Star Print with the authority of the Government Printer for the State of Victoria

© State of Victoria 2012

This publication is copyright. No part may be reproduced by any process except in accordance with the provisions of the Copyright Act.

Address all enquiries to the Government Printer for the State of Victoria

Level 2, 1 Macarthur Street  
Melbourne 3002  
Victoria Australia

**How To Order****Mail Order****Victoria Government Gazette**

Level 5, 460 Bourke Street  
Melbourne 3000  
PO Box 1957 Melbourne 3001  
DX 106 Melbourne

**Telephone**

(03) 8523 4601

**Fax**

(03) 9600 0478

**email**

gazette@bluestargroup.com.au

**Retail & Mail Sales****Victoria Government Gazette**

Level 5, 460 Bourke Street  
Melbourne 3000  
PO Box 1957 Melbourne 3001

**Telephone**

(03) 8523 4601

**Fax**

(03) 9600 0478

**Retail Sales****Victorian Government Bookshop**

Level 20, 80 Collins Street  
Melbourne 3000

**Telephone**

1300 366 356

**Fax**

(03) 9208 3316

**Price Code A**