



Victoria Government Gazette

No. S 223 Thursday 13 August 2015
By Authority of Victorian Government Printer

Road Management Act 2004

ROAD DECLARATIONS AND DISCONTINUANCES

ROAD DECLARATIONS

VicRoads, pursuant to sections 11 and 14 of the **Road Management Act 2004**, upon publication of this notice declares or revokes the roads described in Schedule A and on the plans attached.

ROAD DISCONTINUANCES

VicRoads, pursuant to section 12 of the **Road Management Act 2004**, upon publication of this notice discontinues the part of the road described in Schedule B and on the plan attached and approves the sale of the surplus land as provided in section 94 of the **Transport Integration Act 2010** and as delegated by the Minister for Roads and Road Safety under section 31 of the latter said Act.

The effects of these Road Declarations and Road Discontinuances on road names are described in Table 1.

SCHEDULE A

ARTERIAL ROAD

- a) Those parts of Pascoe Vale Road identified by hatching on the plan numbered GP22456C are declared as described in the legend in the said plan.
- b) Those parts of Somerton Road identified by hatching on the plans numbered GP22456C, GP22456, GP22456A and GP22455 are declared or revoked as described in the legend in the said plans.
- c) That part of Coburg–Craigieburn Road identified by hatching on the plan numbered GP22455 is declared as described in the legend in the said plan.
- d) Those parts of South Gippsland Highway identified by hatching on the plans numbered GP20370, GP22389, GP20373, GP20375, GP20376, GP20431A, GP20433A and GP20432 are declared or revoked as described in the legend in the said plans.

MUNICIPAL ROAD

- e) Those parts of Cliffords Road, Mills Avenue and Union Road identified by hatching on the plan numbered GP22456B are declared as described in the legend in the said plan.
- f) That part of Bingham Road identified by hatching on the plan numbered GP22389A is declared as described in the legend in the said plan.
- g) Those parts of Main Road and Bass Valley Road identified by hatching on the plan numbered GP20431 are declared as described in the legend in the said plan.
- h) That part of Bena-Korumburra Road identified by hatching on the plan numbered GP20432A is declared as described in the legend in the said plan.

SCHEDULE B

ROAD

- a) That part of Somerton Road identified by hatching on the plan numbered GP22456 is discontinued as described in the legend in the said plan.
- b) Those parts of South Gippsland Highway identified by hatching on the plans numbered GP20373, GP20431A and GP20432 are discontinued as described in the legend in the said plans.

SPECIAL

TABLE 1

EFFECTS ON ROAD NAMES

1. Names in Column 2 are existing Vicmap Address names, which are unaffected by this notice.
2. **Names in Column 1 are for VicRoads administrative purposes only and are independent of names in Column 2.**
3. Names in Column 2 may not apply to the whole length of the road and are for general information only.

ARTERIAL ROADS

GP Number	VicRoads Administrative Road Name Column 1	Vicmap Address Road Name (for property addressing purposes) Column 2
GP22456C	Pascoe Vale Road	Not detailed – Road boundary adjustment only
GP22456C GP22456 GP22456A GP22455	Somerton Road	Not detailed – Road boundary adjustment only
GP22455	Coburg–Craigieburn Road	Not detailed – Road boundary adjustment only
GP20370 GP22389 GP20373 GP20375 GP20376 GP20431A GP20433A GP20432	South Gippsland Highway	Not detailed – Road boundary adjustment only

MUNICIPAL ROADS

GP Number	VicRoads Administrative Road Name Column 1	Vicmap Address Road Name (for property addressing purposes) Column 2
GP22456B	Not Applicable	Not detailed – Road boundary adjustment only
GP22389A	Not Applicable	Bingham Road
GP20431	Not Applicable	Not detailed – Road boundary adjustment only
GP20432A	Not Applicable	Not detailed – Road boundary adjustment only

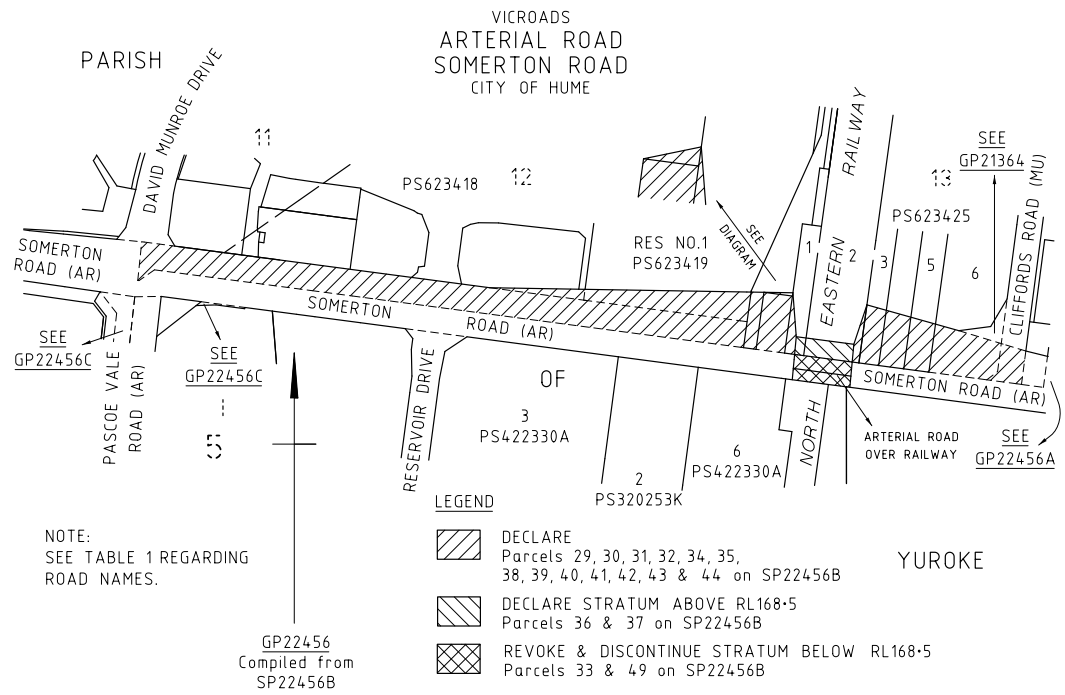
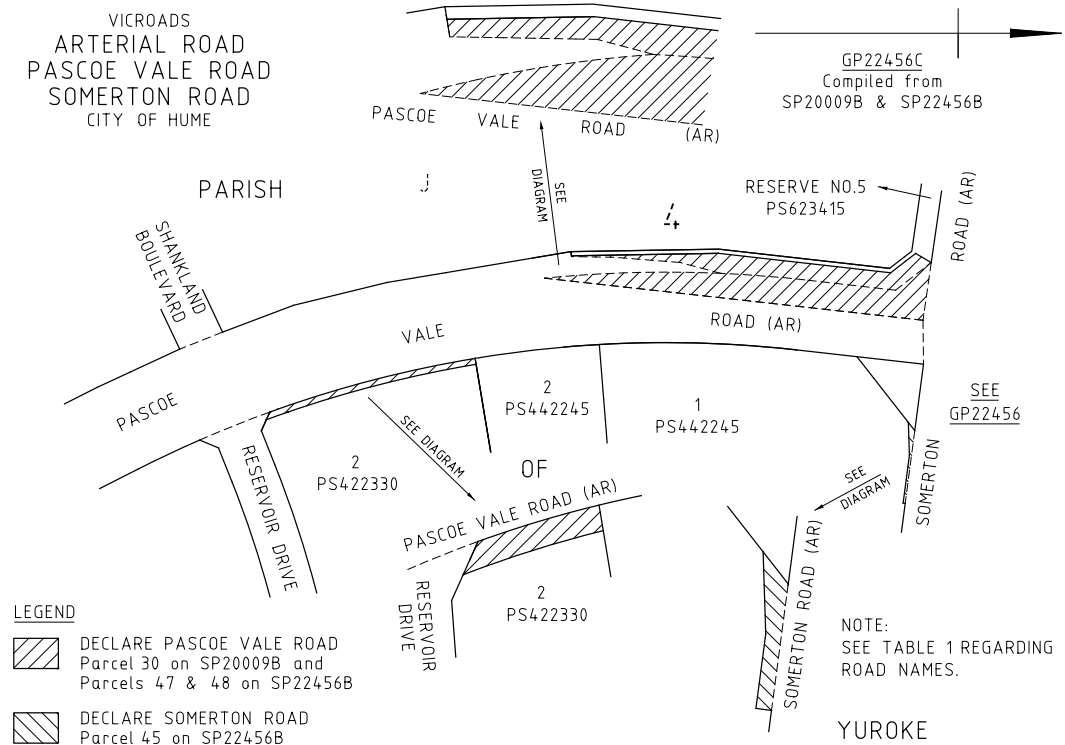

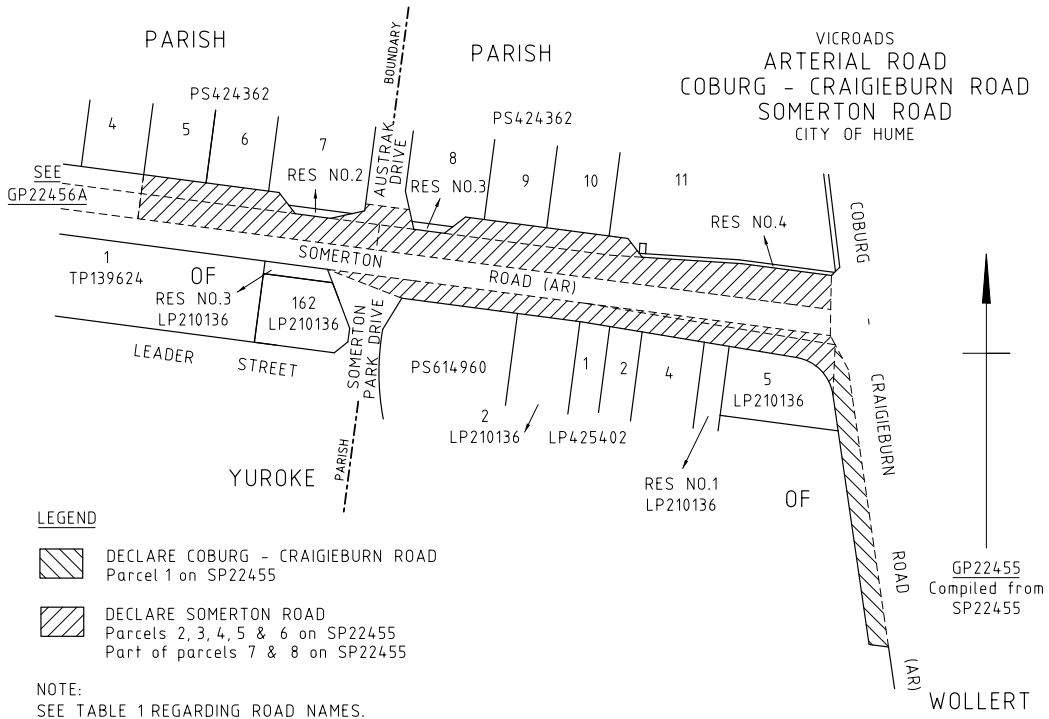
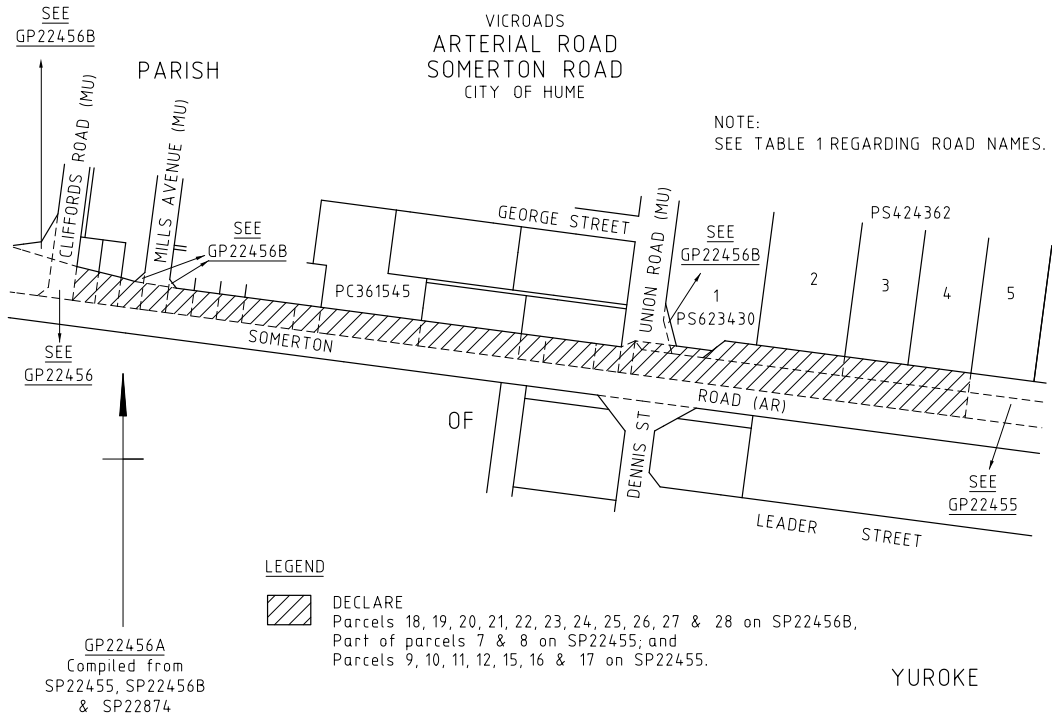

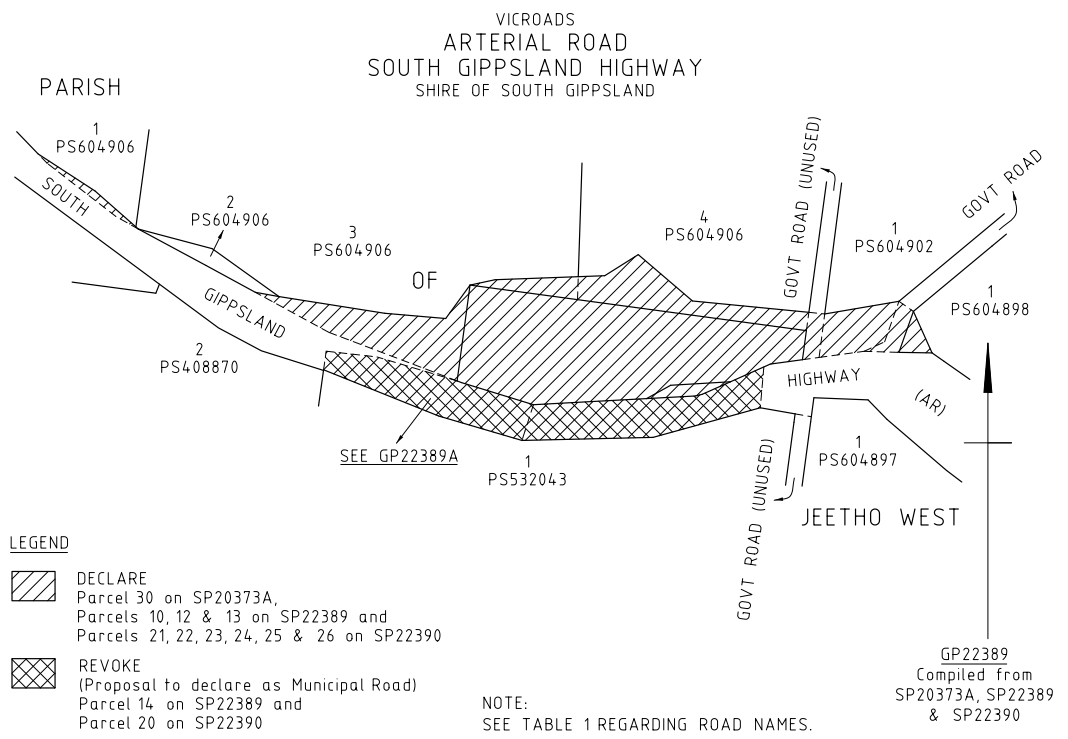
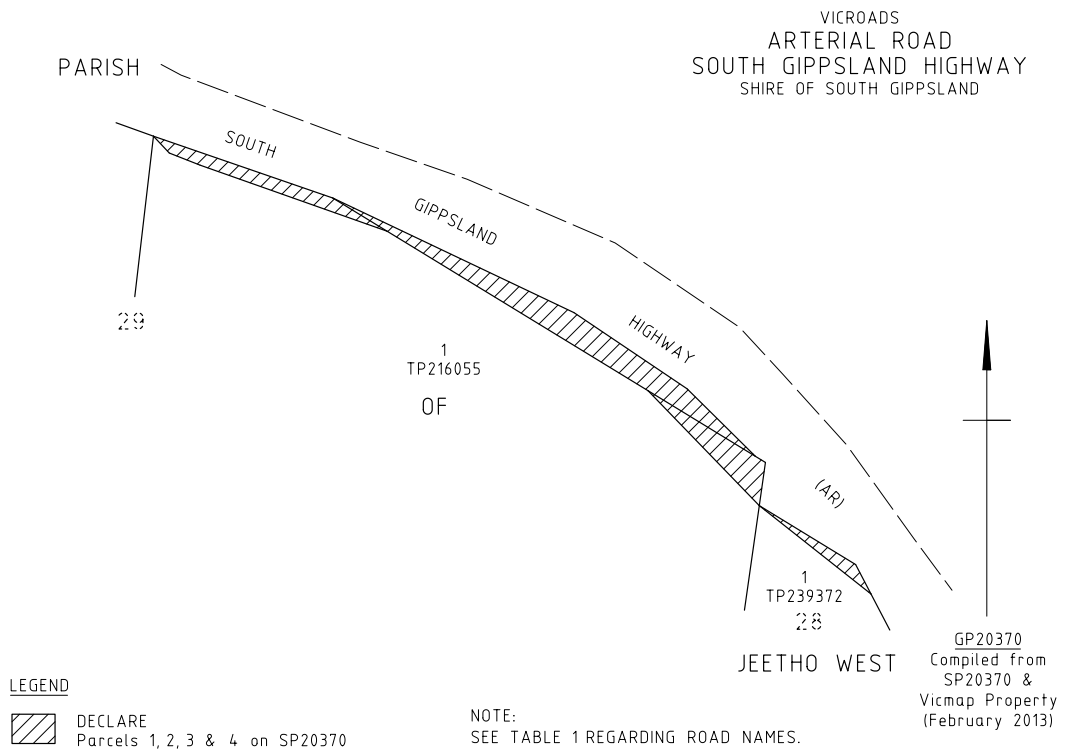

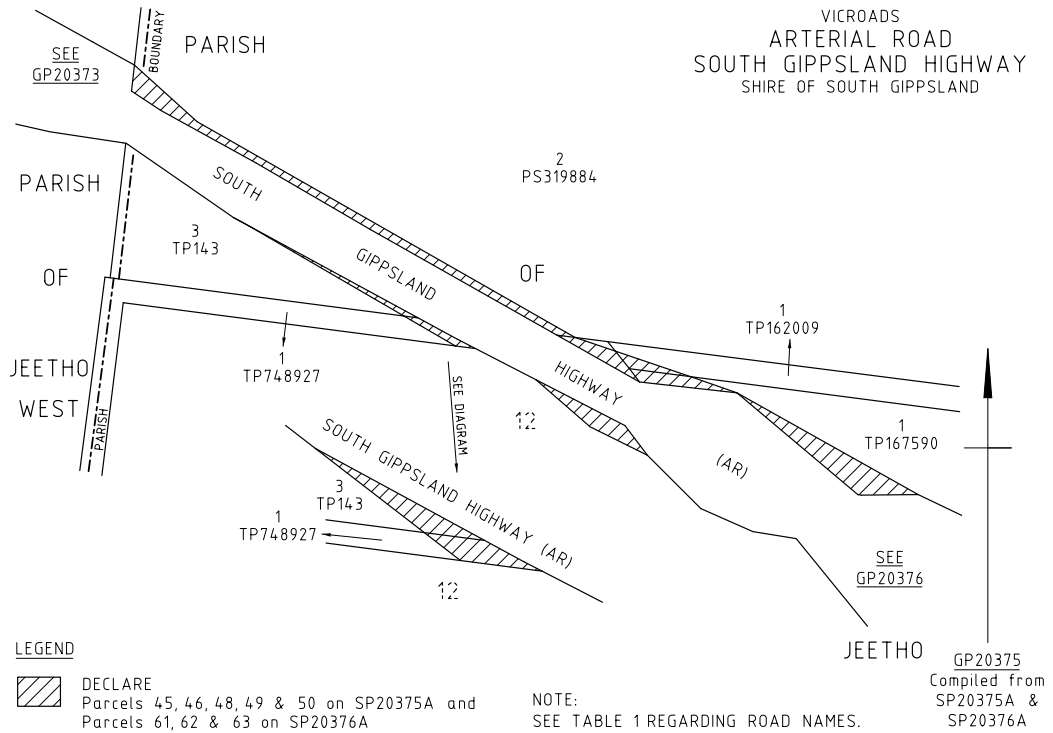
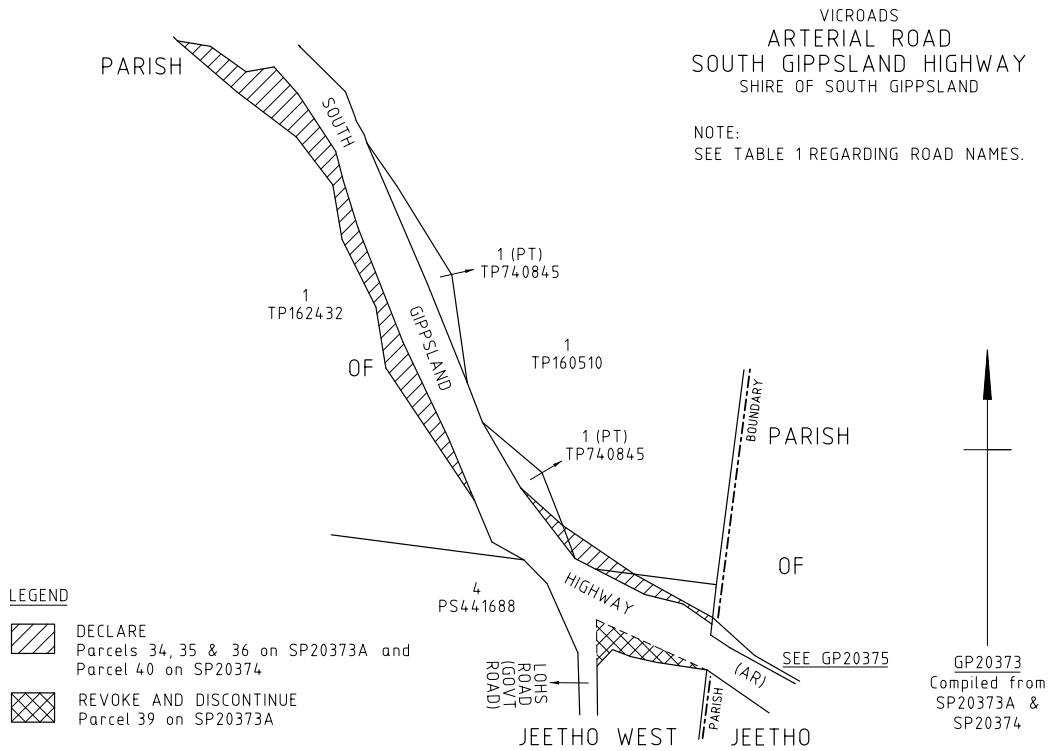

VICROADS
 ARTERIAL ROAD
 SOUTH GIPPSLAND HIGHWAY
 SHIRE OF SOUTH GIPPSLAND

NOTE:
 SEE TABLE 1 REGARDING ROAD NAMES.

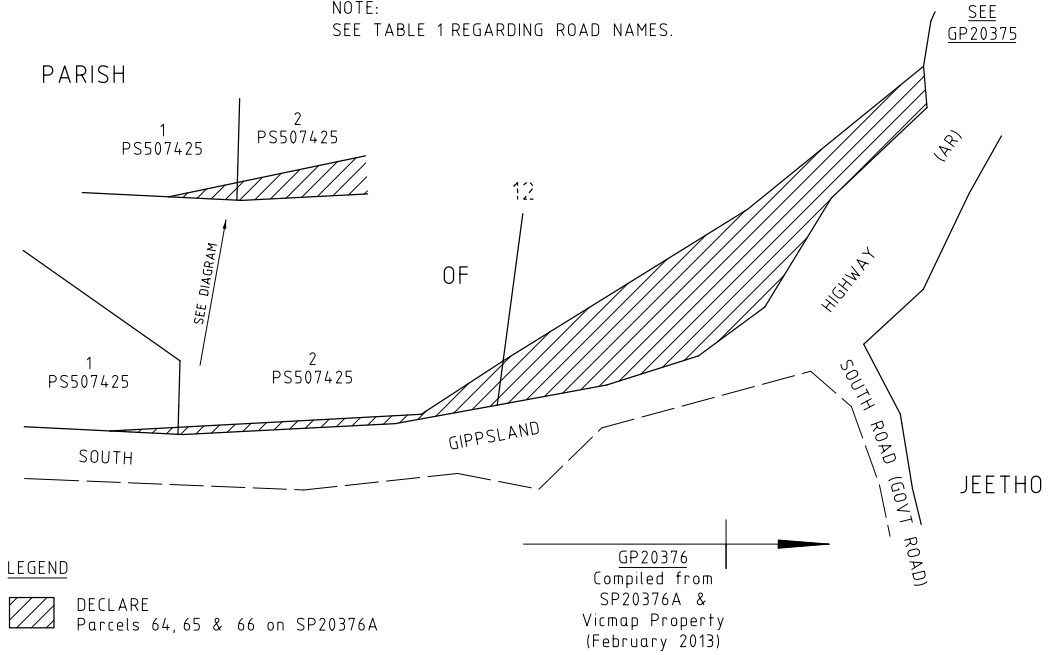

VICROADS
 ARTERIAL ROAD
 SOUTH GIPPSLAND HIGHWAY
 SHIRE OF SOUTH GIPPSLAND

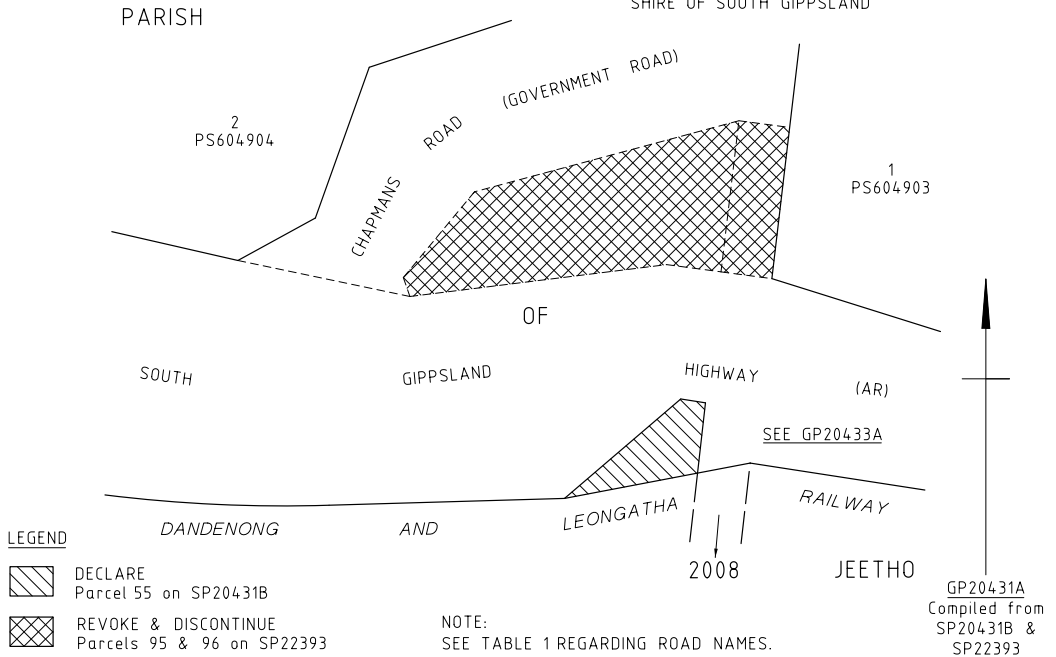

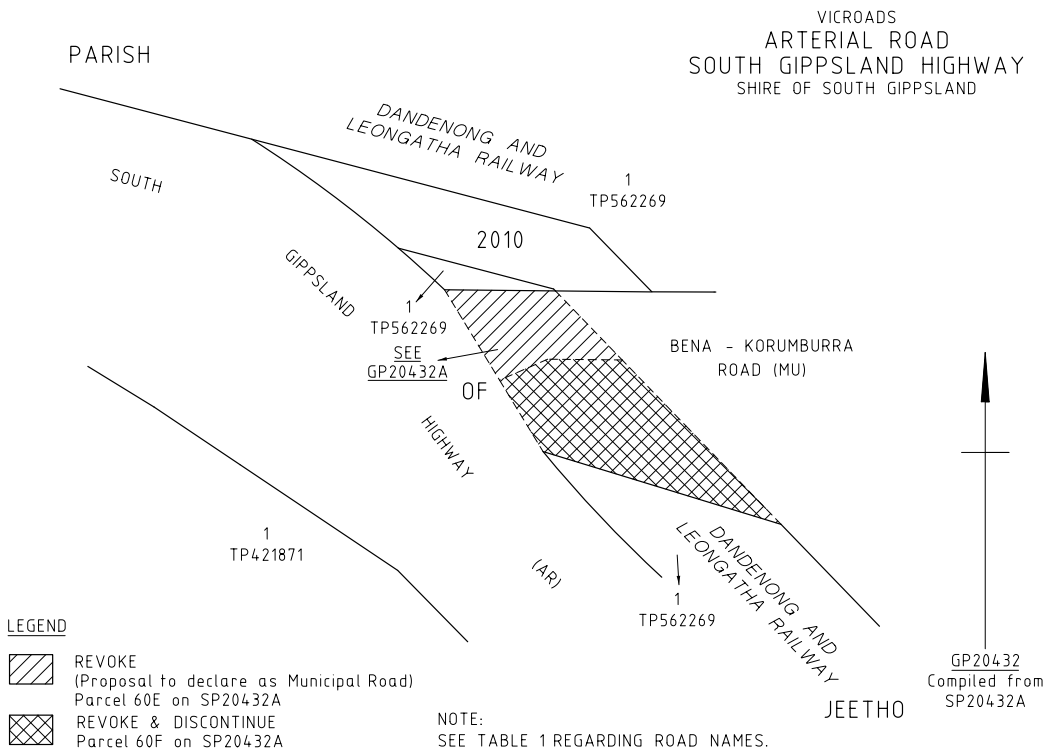
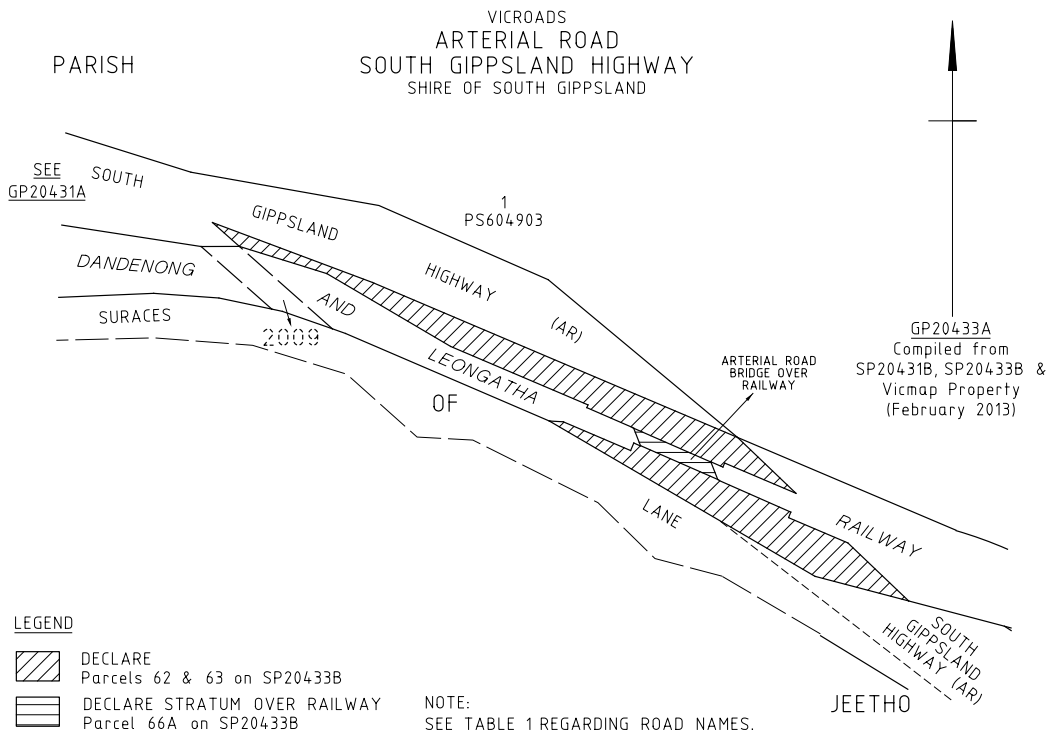

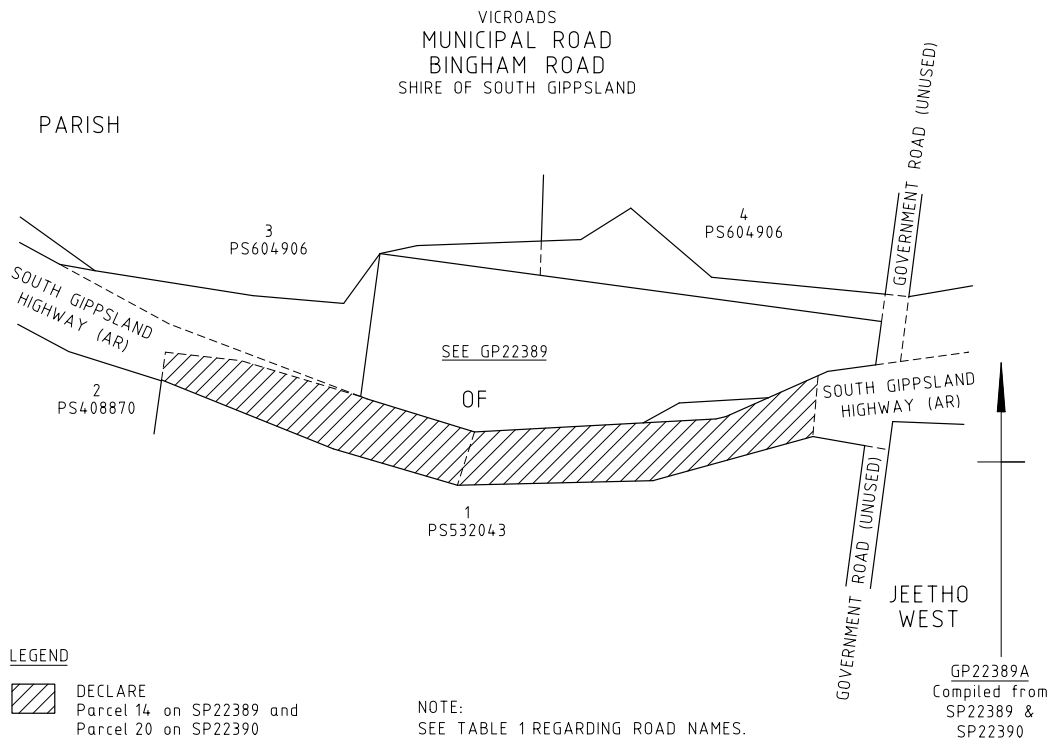
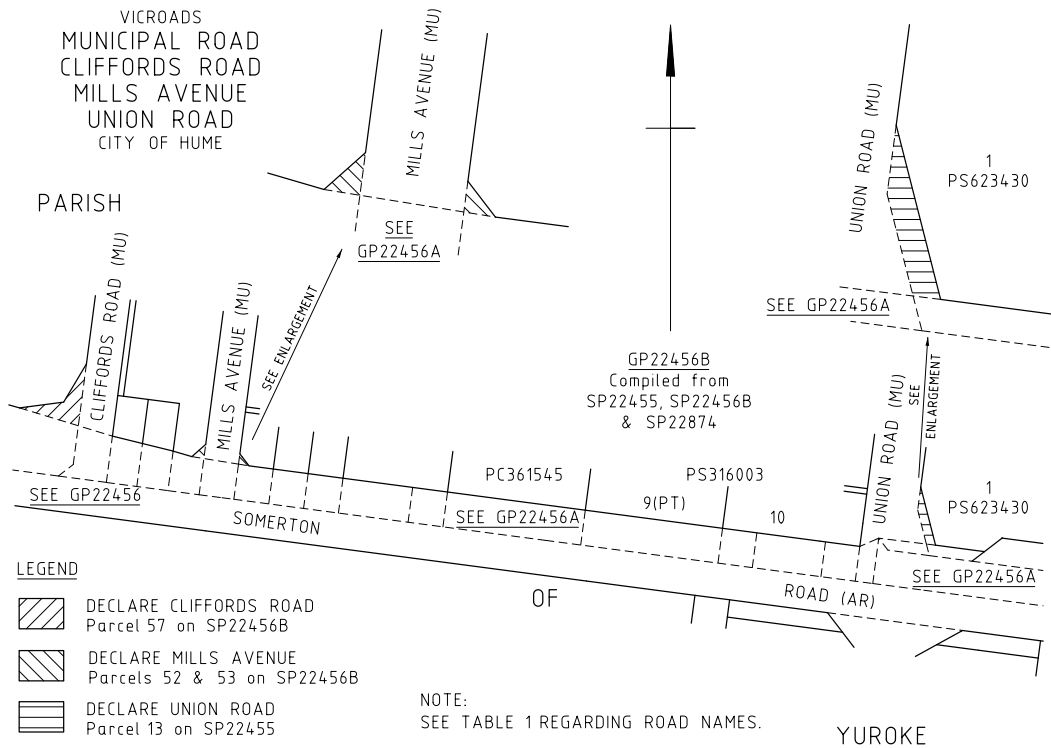

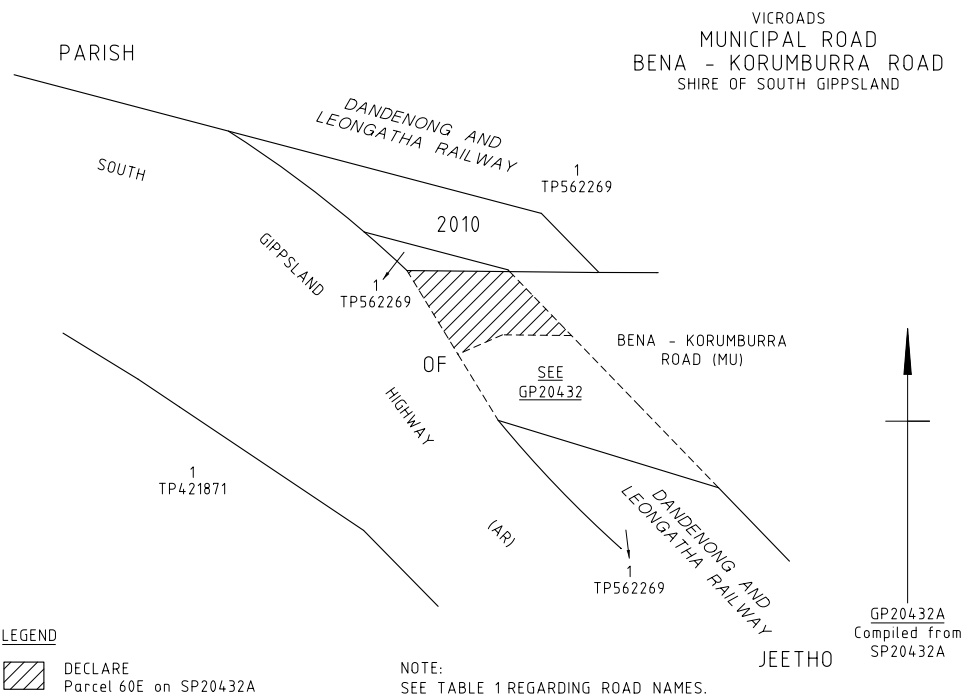
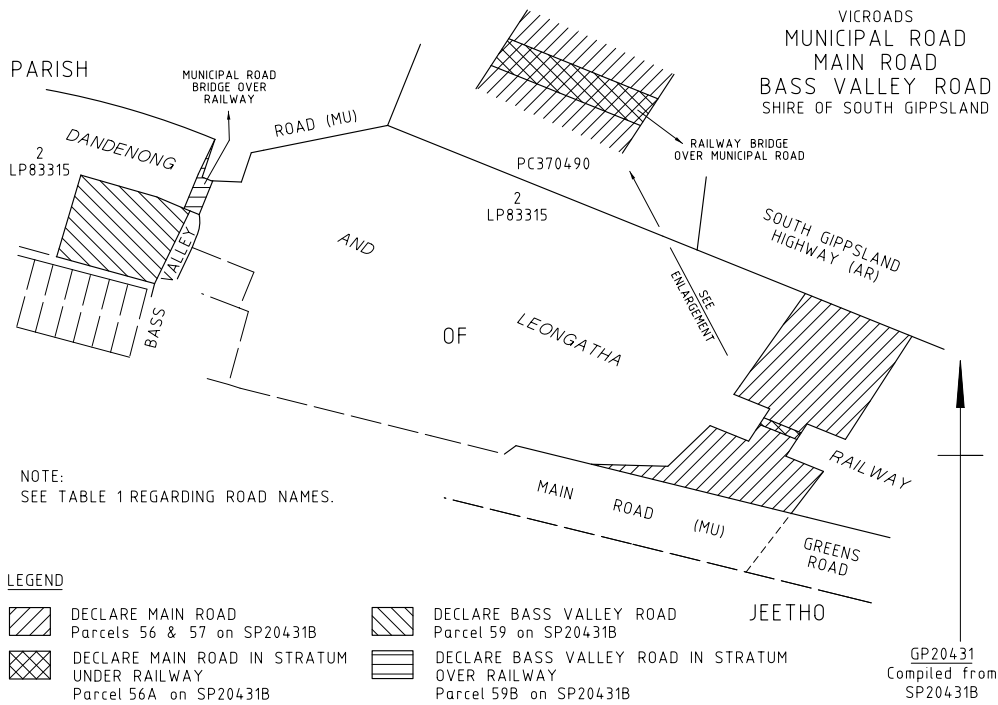

Dated 31 July 2015

JOHN MERRITT
Chief Executive
VicRoads

This page was left blank intentionally

bluestar * **PRINT**

The *Victoria Government Gazette* is published by Blue Star Print with the authority of the Government Printer for the State of Victoria

© State of Victoria 2015

This publication is copyright. No part may be reproduced by any process except in accordance with the provisions of the Copyright Act.

Address all enquiries to the Government Printer for the State of Victoria

Level 2, 1 Macarthur Street
Melbourne 3002
Victoria Australia

How To Order



**Retail &
Mail Sales**

Victoria Government Gazette

Level 5, 460 Bourke Street
Melbourne 3000
PO Box 1957 Melbourne 3001
DX 106 Melbourne



Telephone

(03) 8523 4601



Fax

(03) 9600 0478

email

gazette@bluestargroup.com.au

Price Code A