



Victoria Government Gazette

No. S 13 Thursday 19 January 2017
By Authority of Victorian Government Printer

Road Management Act 2004

ROAD DECLARATIONS

VicRoads, pursuant to sections 11 and 14 of the **Road Management Act 2004**, upon publication of this notice declares or revokes the roads described in the Schedule and on the plans attached.

The effects of these Road Declarations on road names are described in Table 1.

SCHEDULE

ARTERIAL ROAD

- a) Those parts of Princes Highway identified by hatching on the plans numbered GP22849, GP22853, GP22854, GP22854A, GP22855, GP22856, GP22857, GP22857A, GP22858, GP22830, GP22832, GP22833, GP22377, GP22378, GP22379, GP22381, GP22382, GP22159, GP22161 and GP22164 are declared or revoked as described in the legend in the said plans.
- b) That part of Sale-Heyfield Road identified by hatching on the plan numbered GP22381 is declared as described in the legend in the said plan.

MUNICIPAL ROAD

- c) Those parts of Wrights Lane identified by hatching on the plan numbered GP22855A are declared as described in the legend in the said plan.
- d) That part of Smiths Lane identified by hatching on the plan numbered GP22858A is declared as described in the legend in the said plan.
- e) Those parts of Nambrok Road identified by hatching on the plan numbered GP22831 are declared as described in the legend in the said plan.
- f) That part of Templetons Road identified by hatching on the plan numbered GP22377A is declared as described in the legend in the said plan.
- g) Those parts of Hopkins Road and Williams Drive identified by hatching on the plan numbered GP22380 are declared as described in the legend in the said plan.
- h) Those parts of Polocross Lane and Reid Drive identified by hatching on the plan numbered GP22160 are declared as described in the legend in the said plan.
- i) Those parts of Golding Street, Settlement Road, The Ridge and Wurruk Way identified by hatching on the plan numbered GP22162 are declared as described in the legend in the said plan.

SPECIAL

TABLE 1

EFFECTS ON ROAD NAMES

1. Names in Column 2 are existing Vicmap Address names, which are unaffected by this notice.
2. **Names in Column 1 are for VicRoads administrative purposes only and are independent of names in Column 2.**
3. Names in Column 2 may not apply to the whole length of the road and are for general information only.

ARTERIAL ROAD

GP Number	VicRoads Administrative Road Name Column 1	Vicmap Address Road Name (for property addressing purposes) Column 2
GP22849 GP22853 GP22854 GP22854A GP22855 GP22856 GP22857 GP22857A GP22858 GP22830 GP22832 GP22833 GP22377 GP22378 GP22379 GP22381 GP22382 GP22159 GP22161 GP22164	Princes Highway Note: VicRoads administrative road name (Princes Highway) ceases where revoked.	Not detailed – Road boundary adjustment only.
GP22381	Sale–Heyfield Road	Not detailed – Road boundary adjustment only.

MUNICIPAL ROAD

GP Number	VicRoads Administrative Road Name Column 1	Vicmap Address Road Name (for property addressing purposes) Column 2
GP22855A	Not applicable	Wrights Lane
GP22858A	Not applicable	Smiths Lane
GP22831	Not applicable	Nambrok Road
GP22377A	Not applicable	Templetons Road
GP22380	Not applicable	Hopkins Road Williams Drive
GP22160	Not applicable	Polocross Lane Reid Drive
GP22162	Not applicable	Golding Street Settlement Road The Ridge Wurruk Way

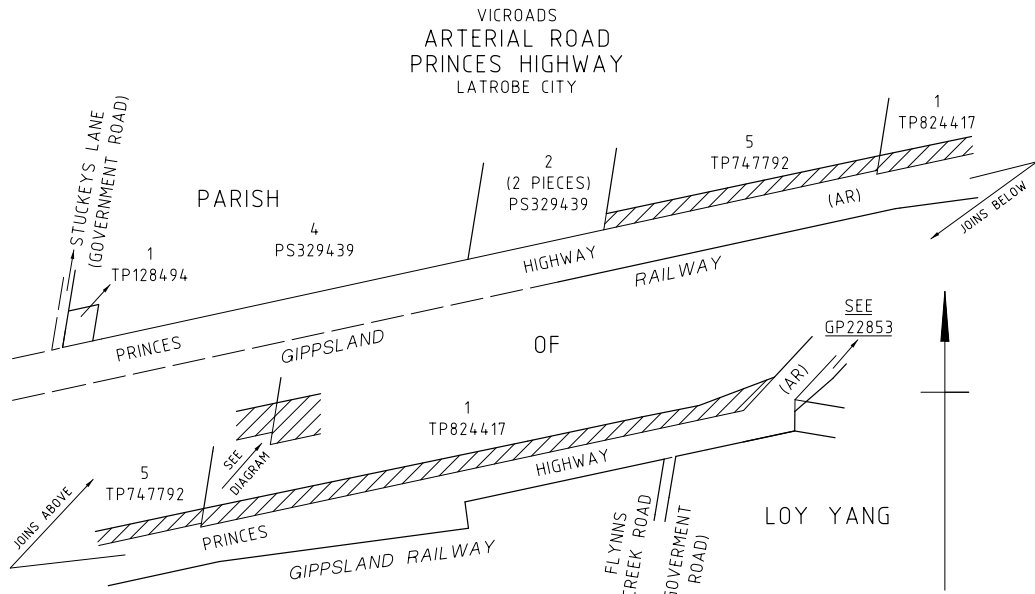

LEGEND

 DECLARE Parcel 12 on SP22850 and Parcel 21 on SP22851.

NOTE:
SEE TABLE 1 REGARDING ROAD NAMES.

GP22849
Compiled from
SP22849, SP22850
SP22851 &
Vicmap Property
(June 2016)

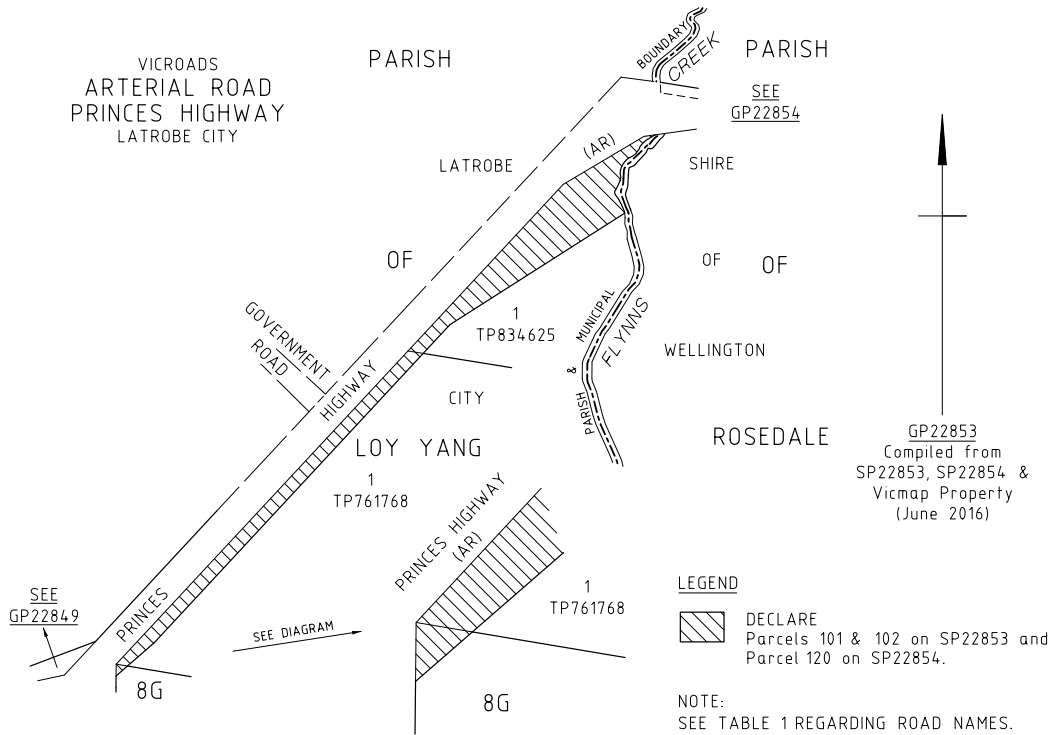

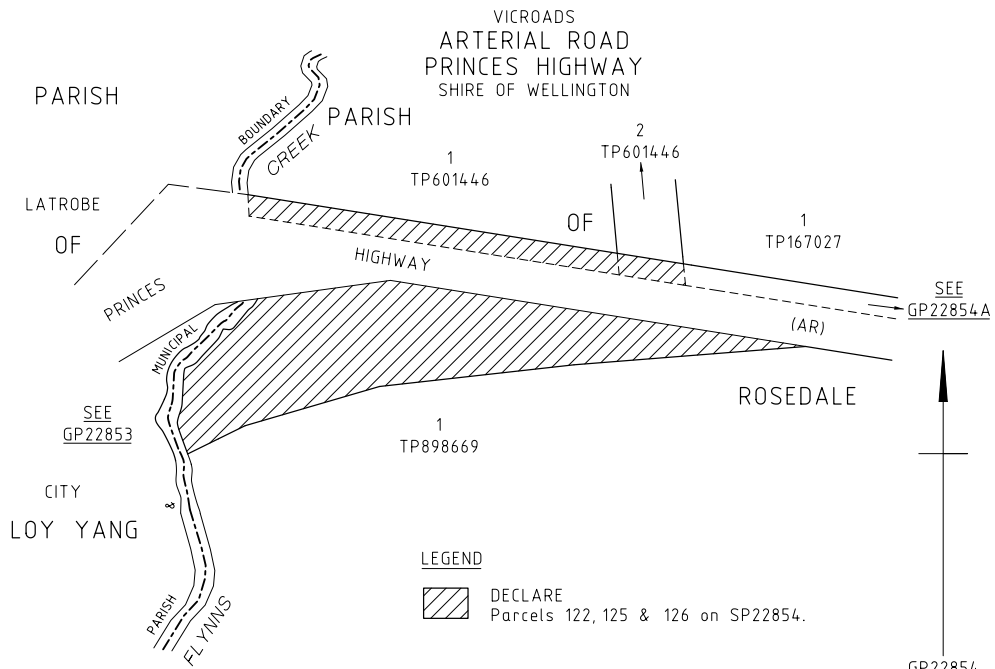

NOTE:
SEE TABLE 1 REGARDING ROAD NAMES.

GP22854
Compiled from
SP22854, SP8928 &
Vicmap Property
(June 2016)

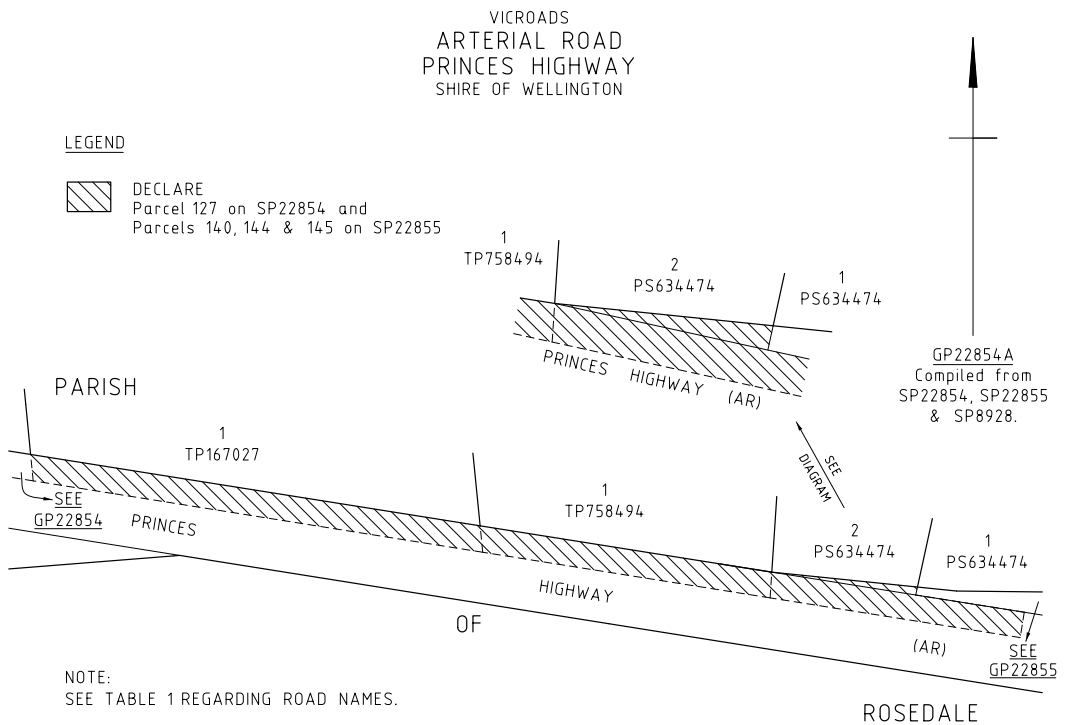

NOTE:
SEE TABLE 1 REGARDING ROAD NAMES.

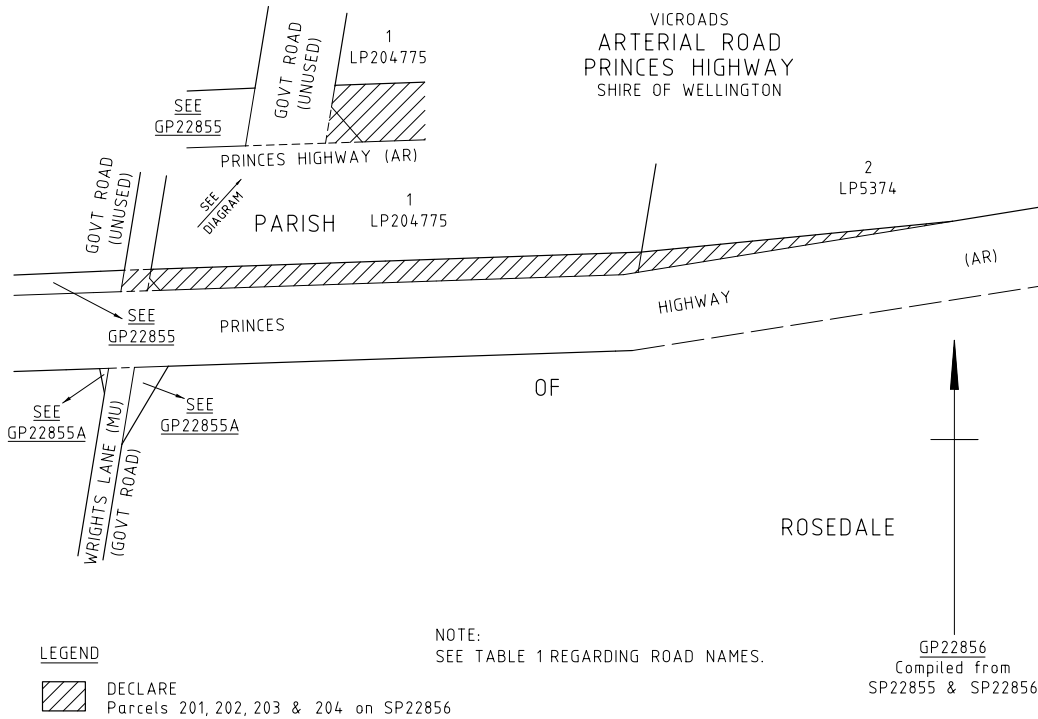
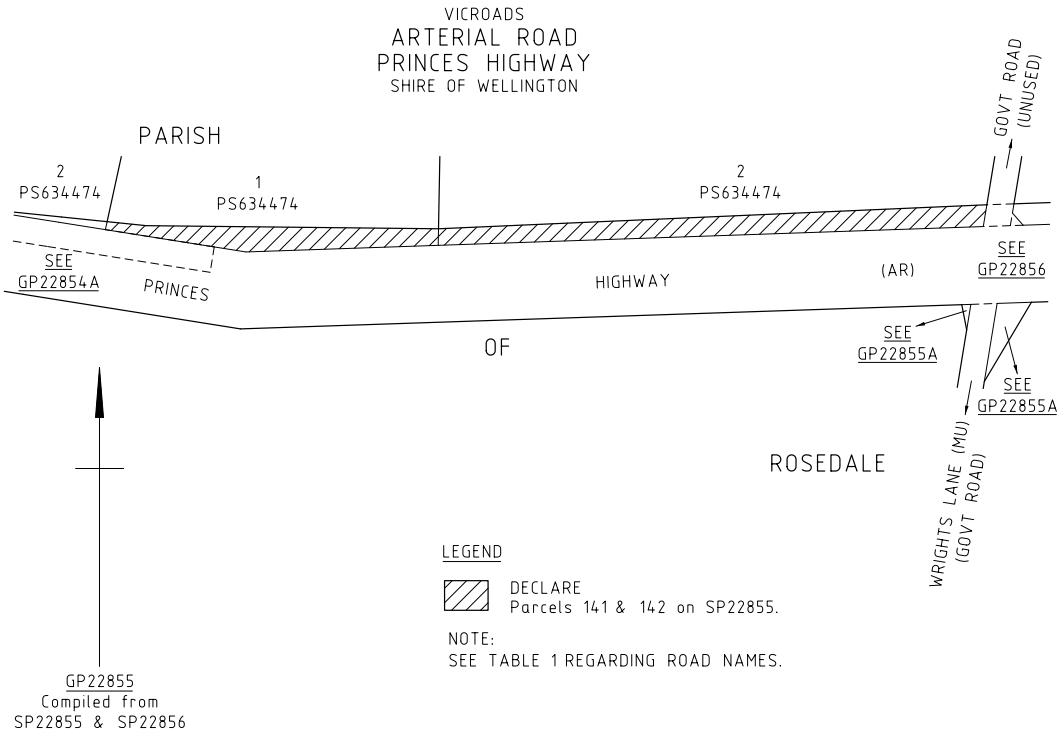

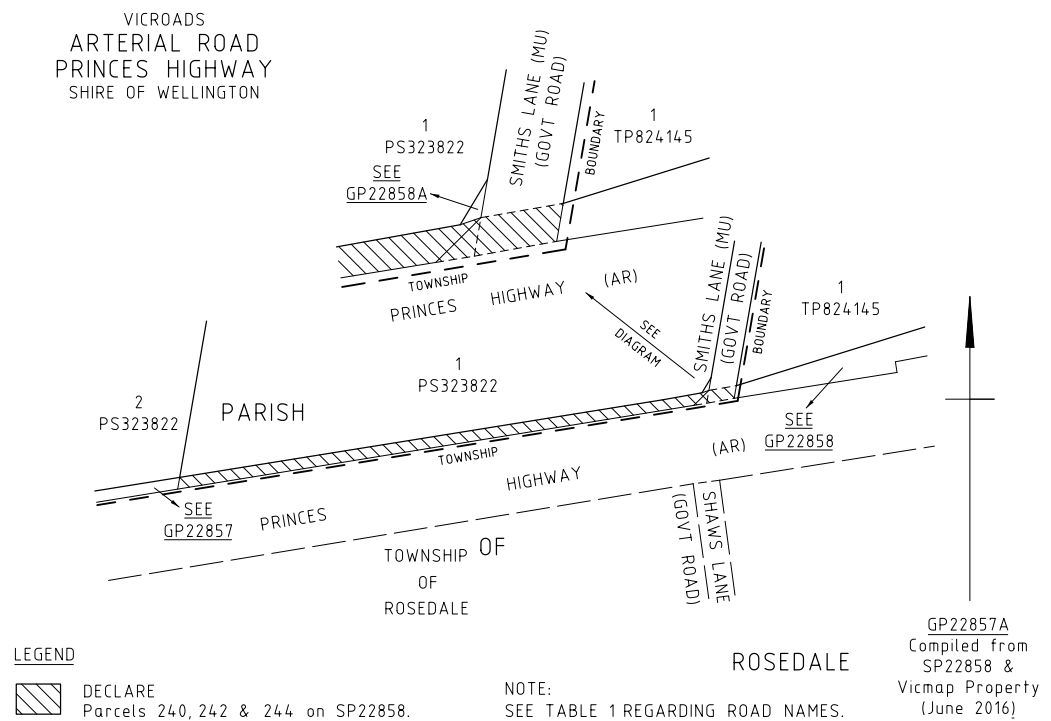
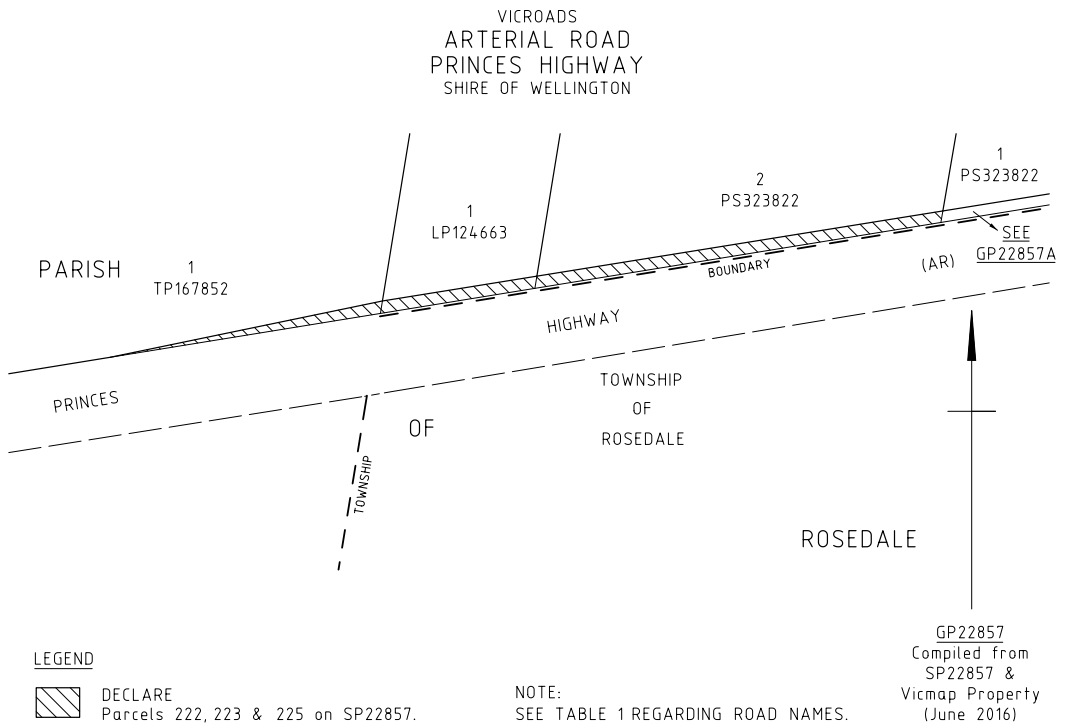

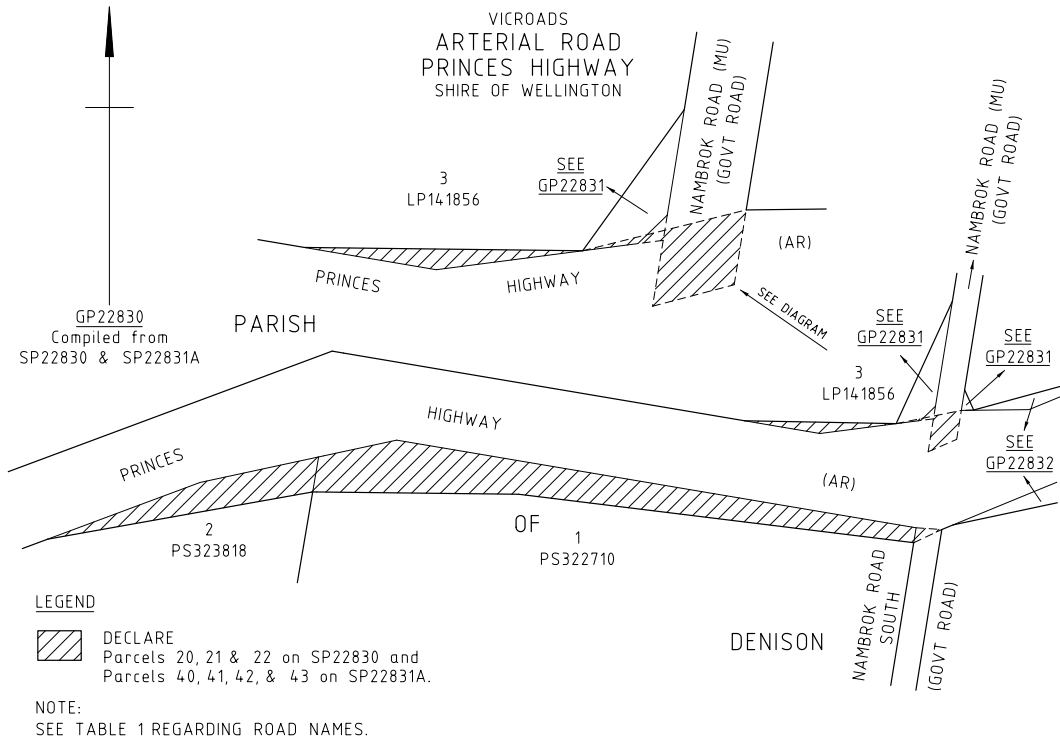
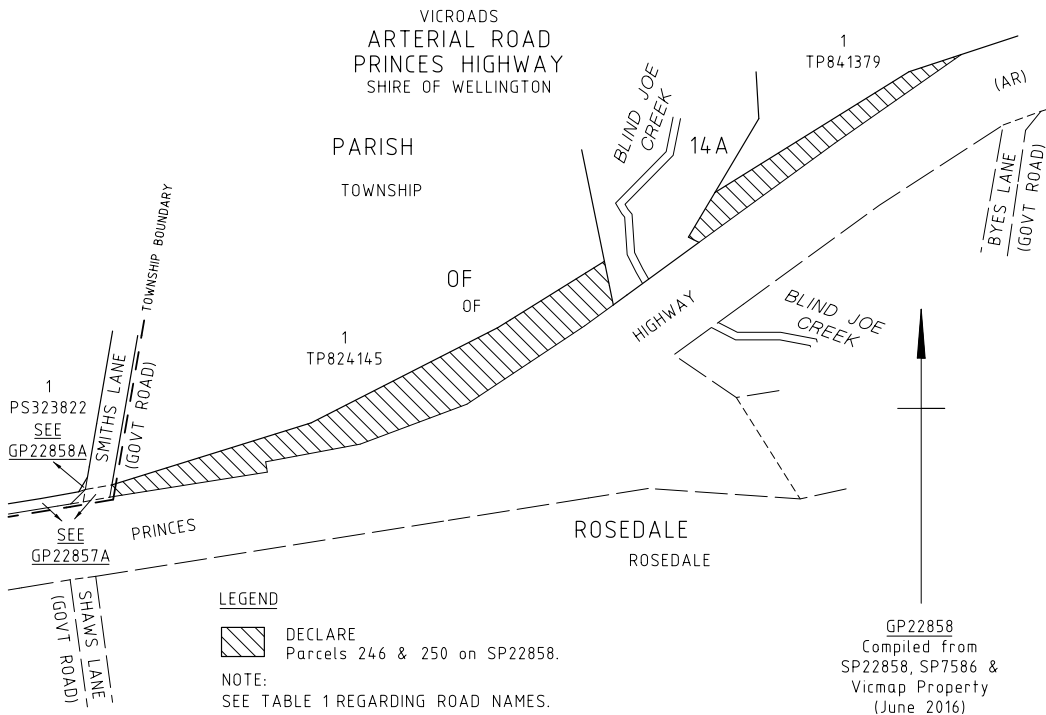

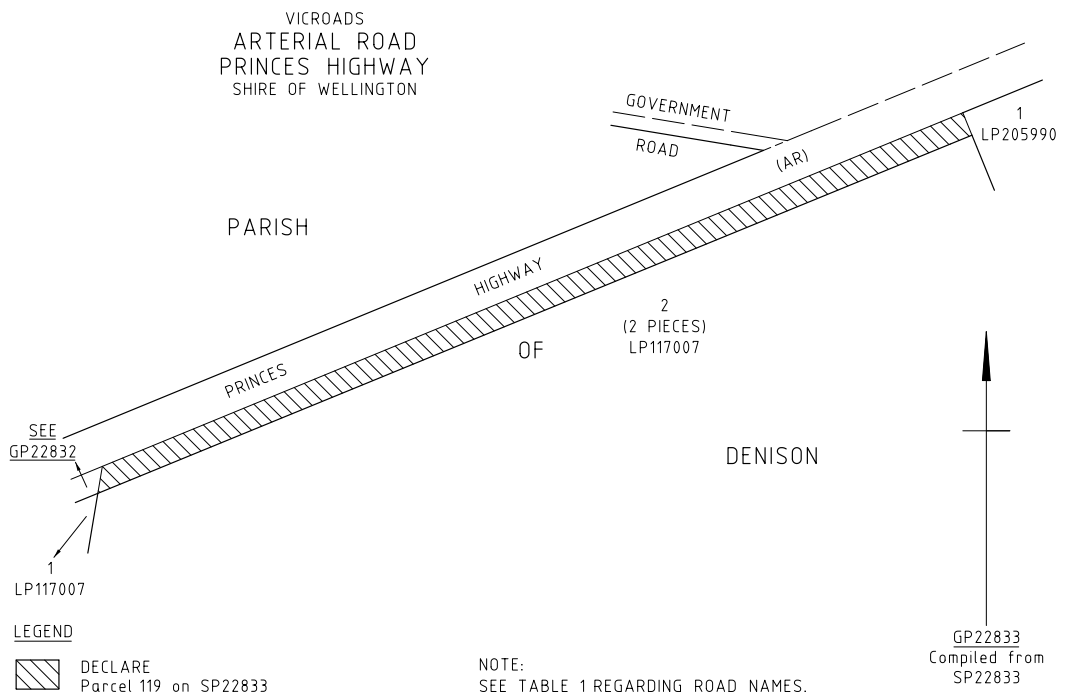
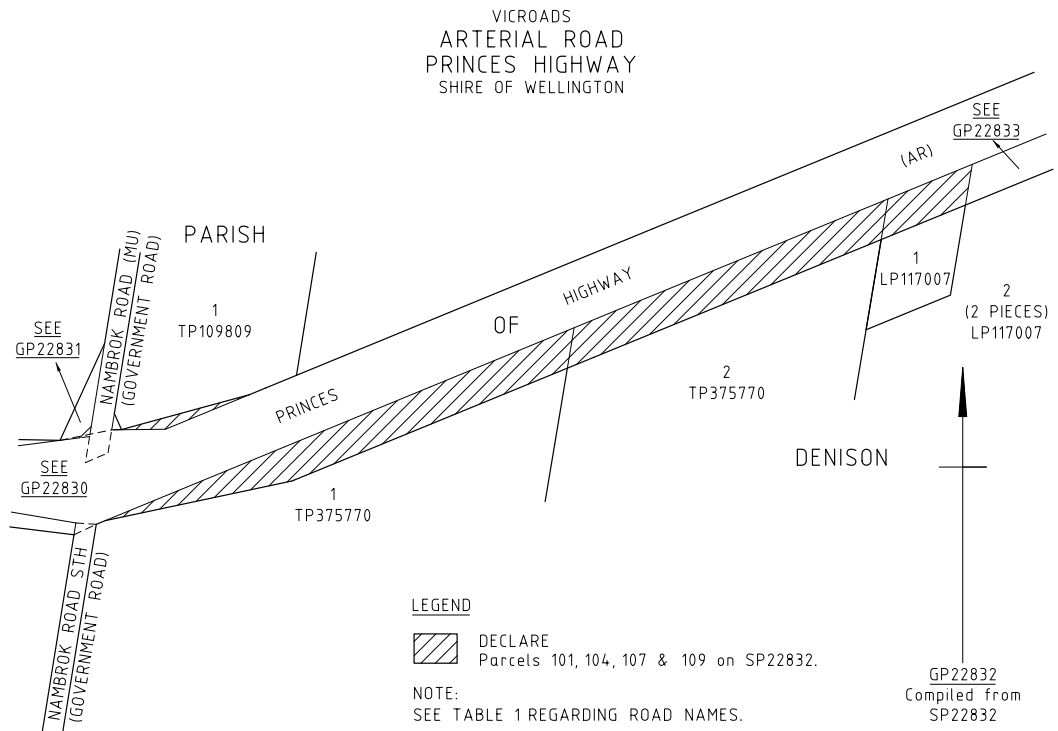

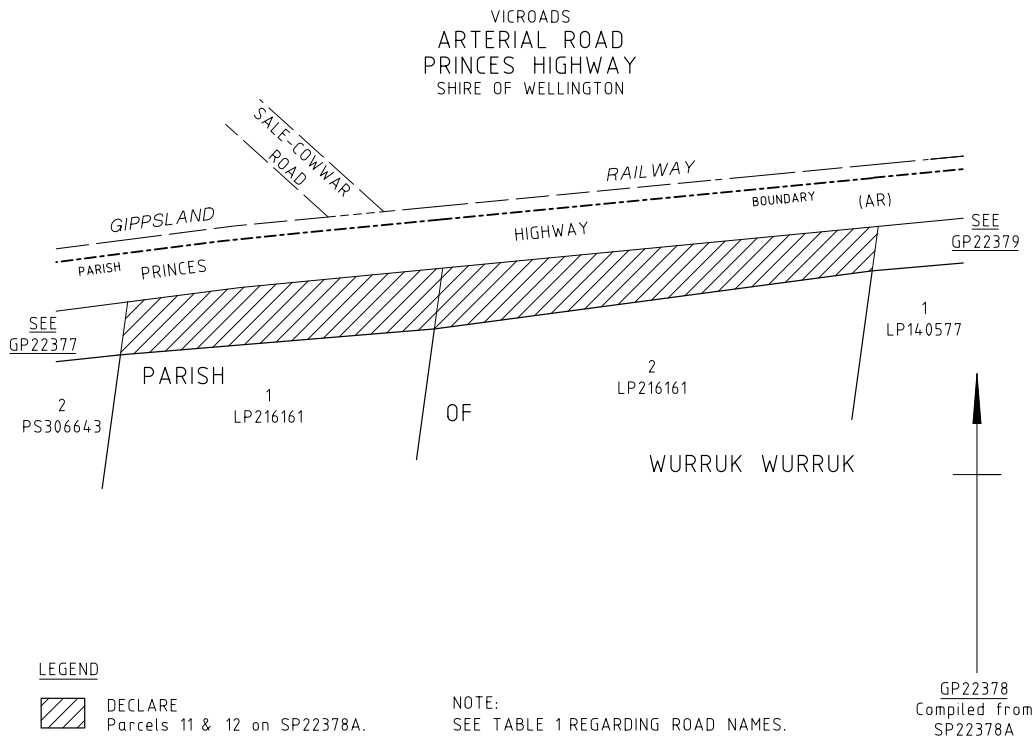
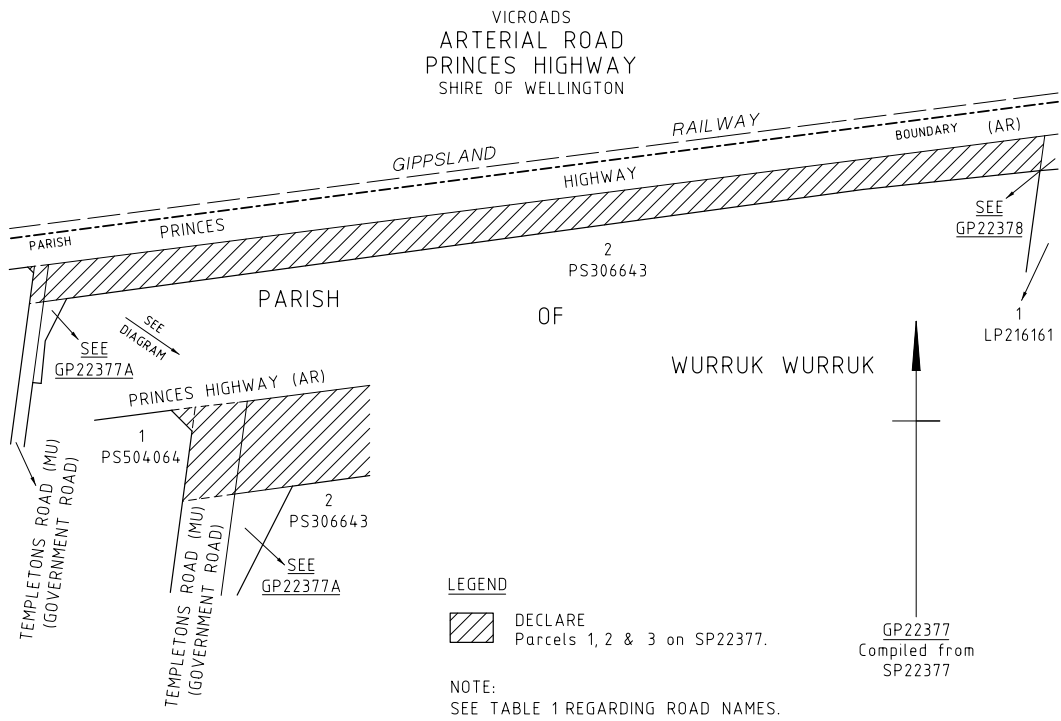

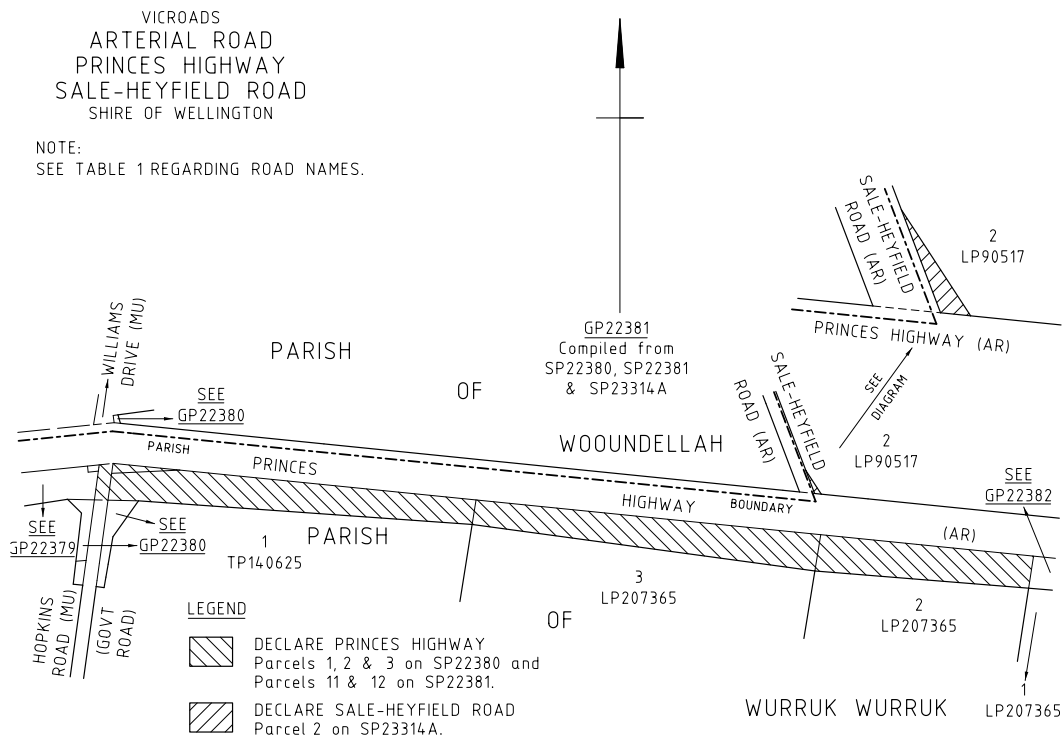
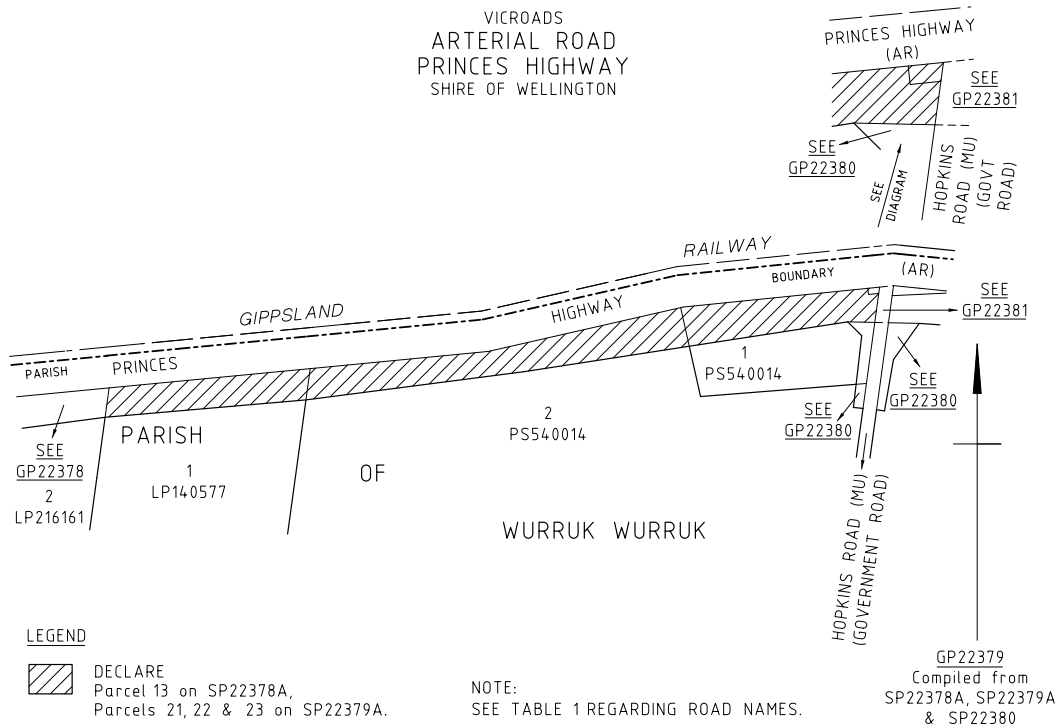

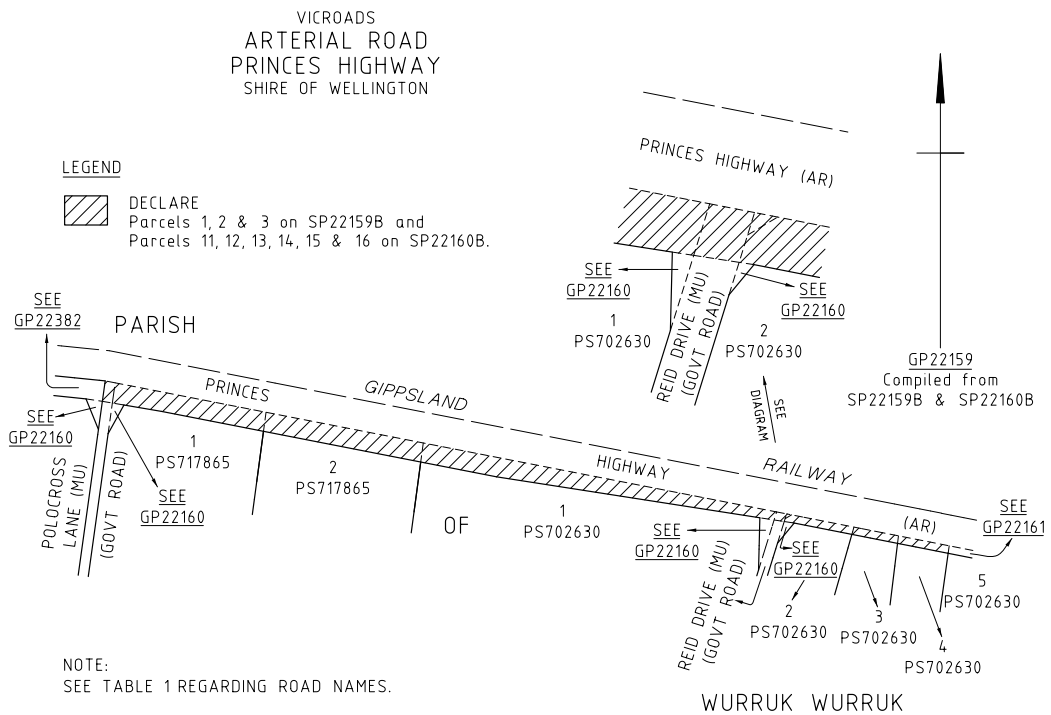
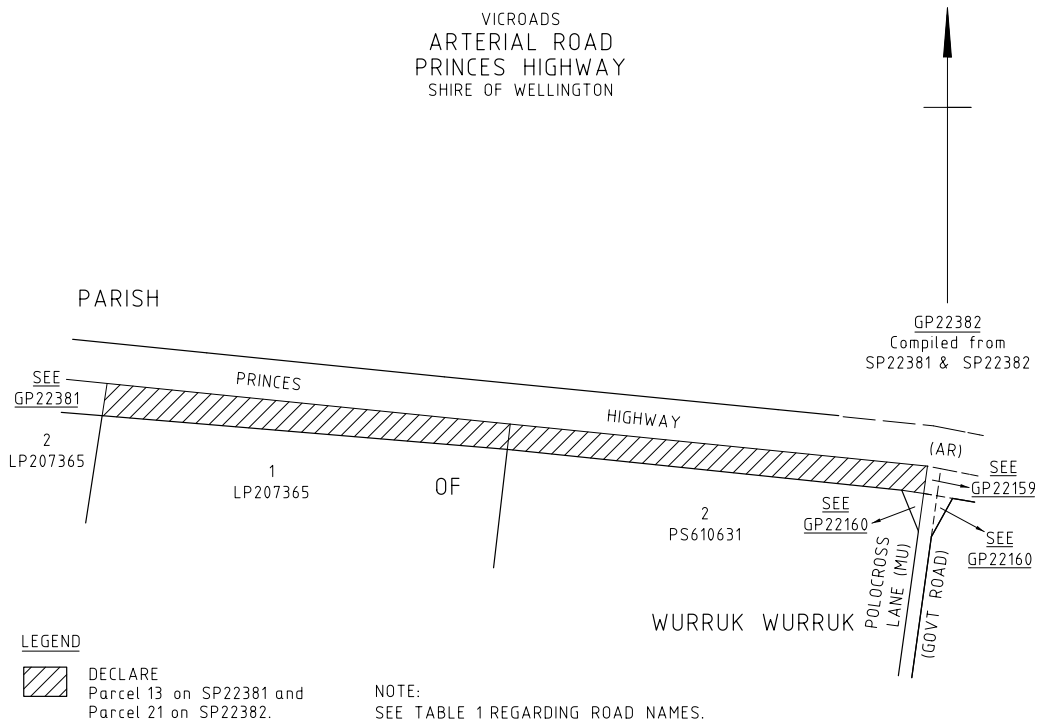

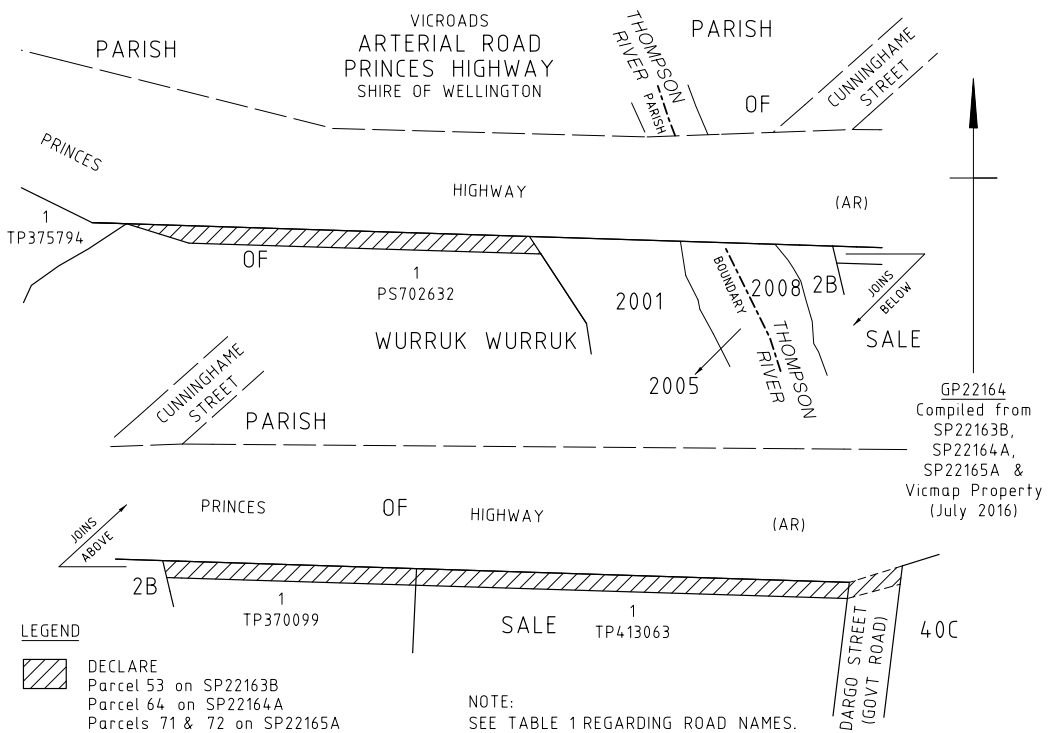
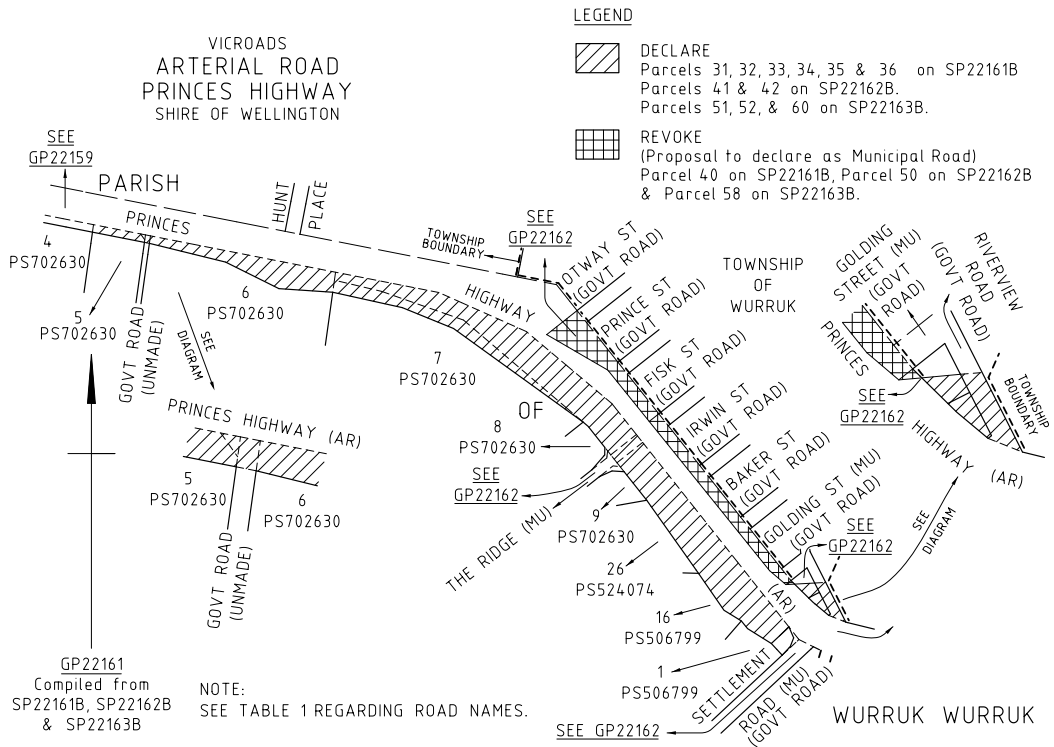

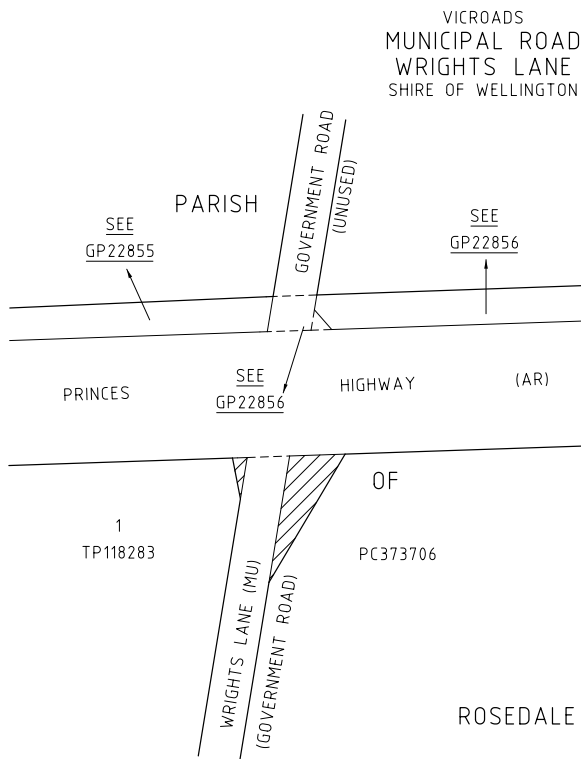

GP22855A
Compiled from
SP22855, SP22856
& Vicmap Property
(June 2016)

LEGEND

DECLARE
Parcel 143 on SP22855 and
Parcel 200 on SP22856.

NOTE:
SEE TABLE 1 REGARDING ROAD NAMES.

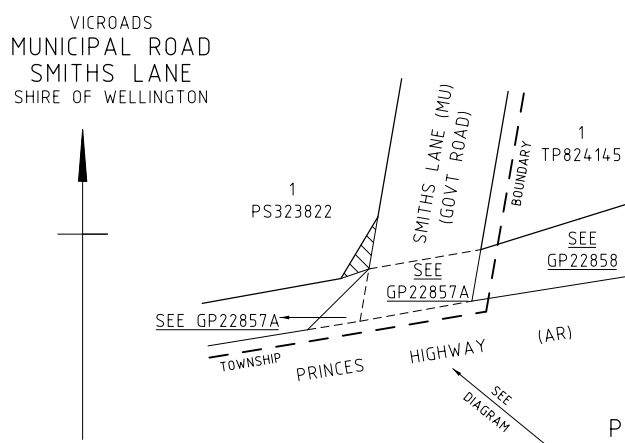

GP22858A
Compiled from
SP22858

LEGEND

DECLARE
Parcel 243 on SP22858.

NOTE:
SEE TABLE 1 REGARDING ROAD NAMES.

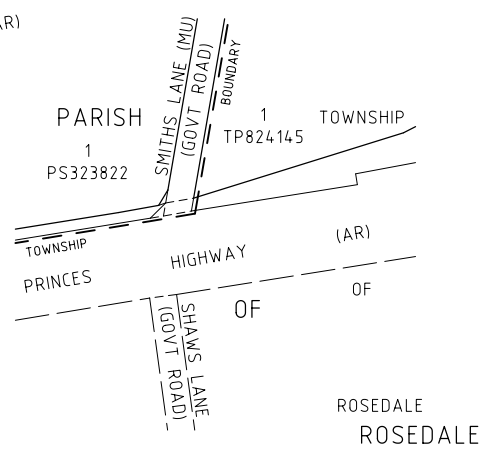

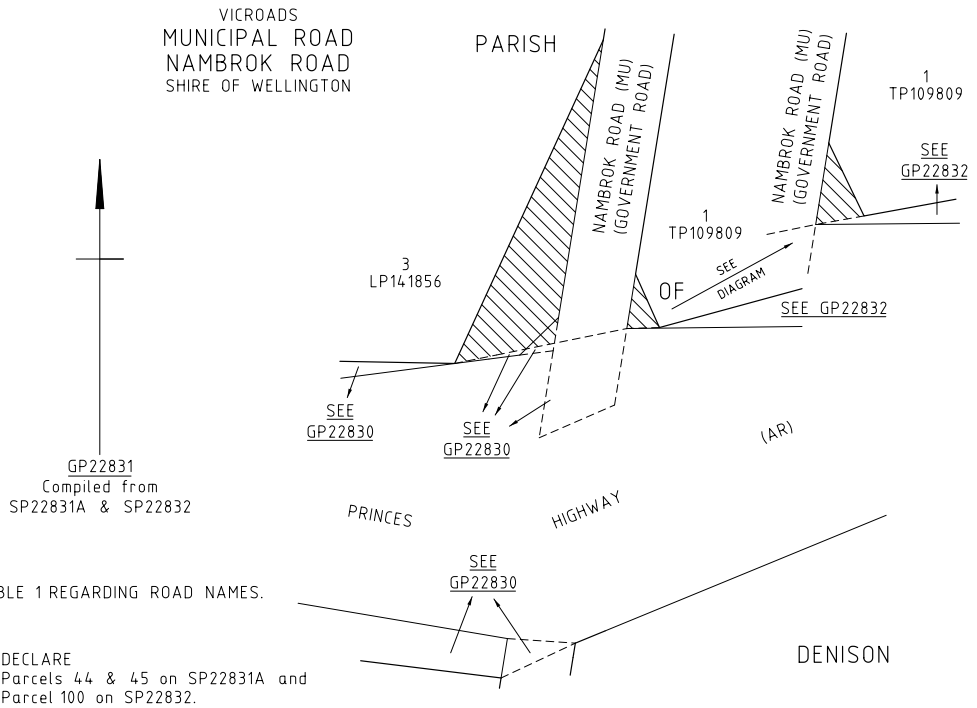

VICROADS
MUNICIPAL ROAD
TEMPLETONS ROAD
SHIRE OF WELLINGTON

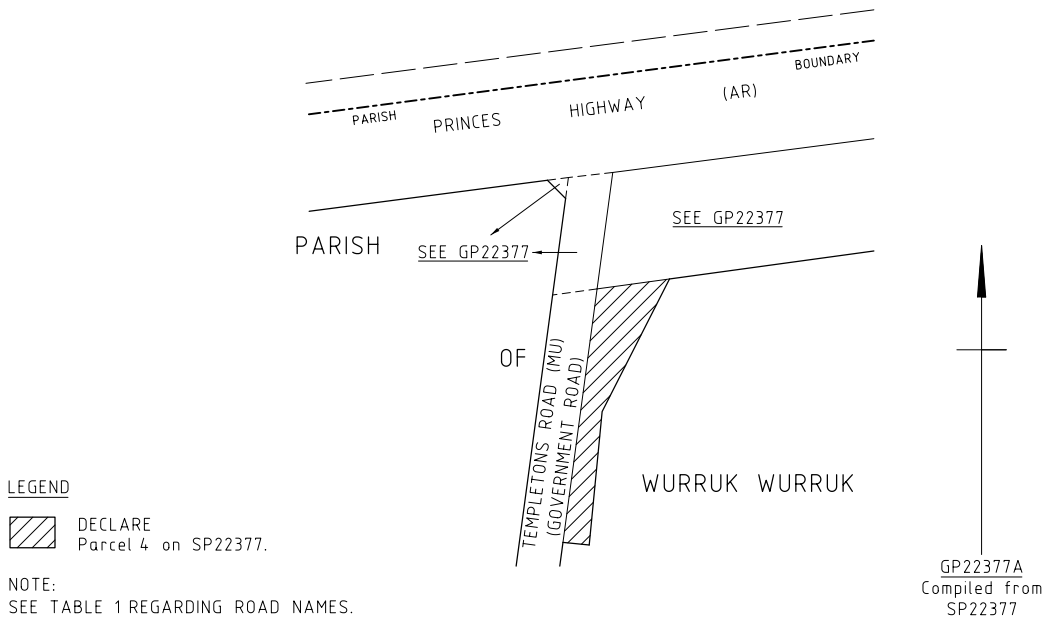

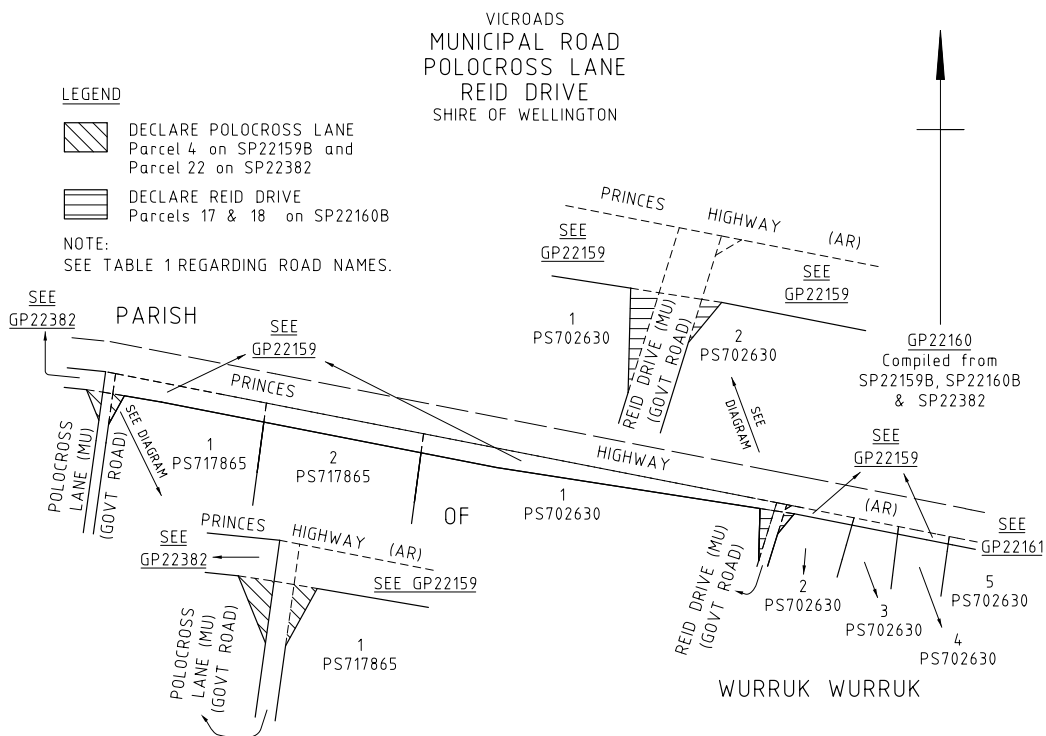
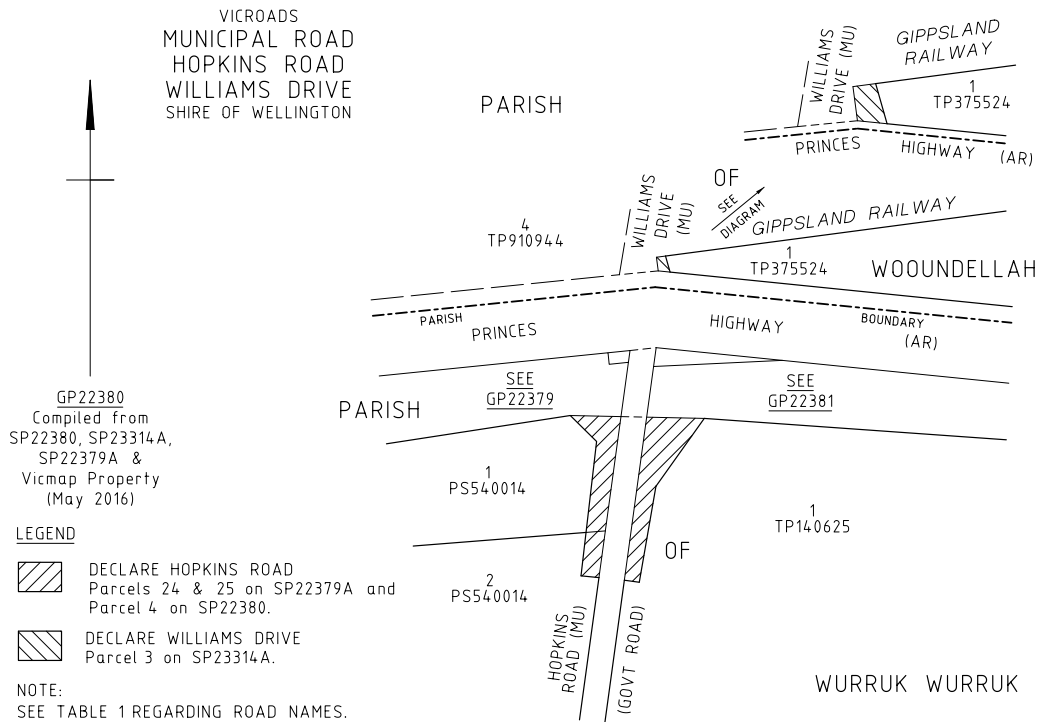

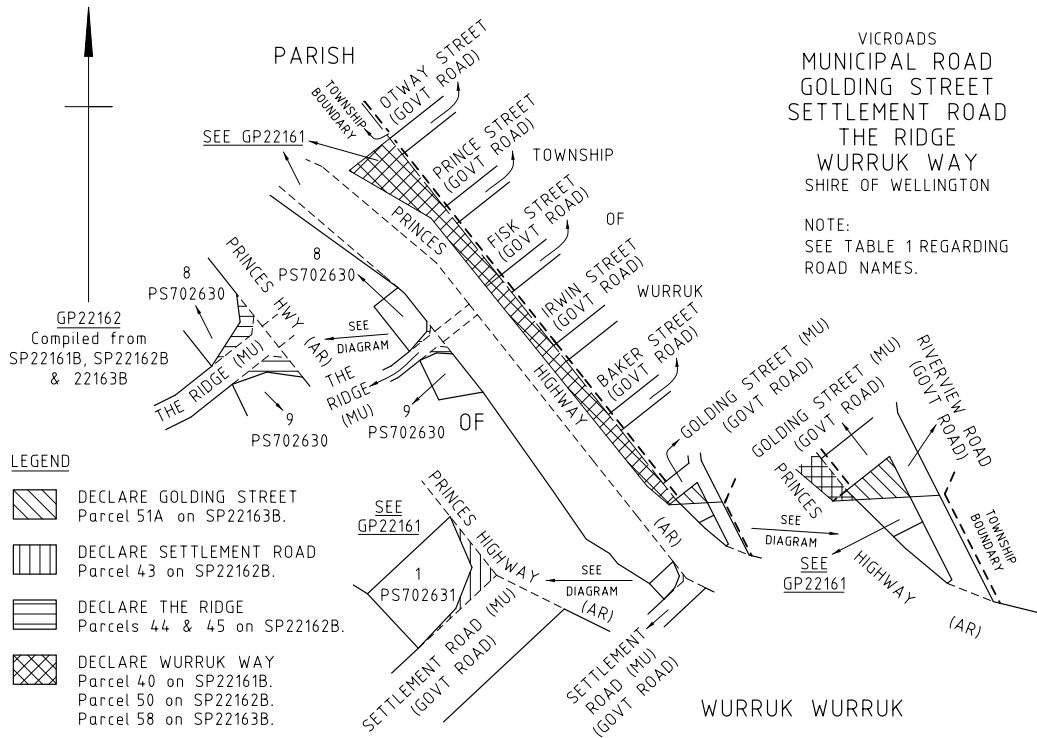

Dated 16 January 2017

PETER TODD
Deputy Chief Executive
VicRoads

This page was left blank intentionally

This page was left blank intentionally

bluestar * **PRINT**

The *Victoria Government Gazette* is published by Blue Star Print with the authority of the Government Printer for the State of Victoria

© State of Victoria 2017

This publication is copyright. No part may be reproduced by any process except in accordance with the provisions of the Copyright Act.

Address all enquiries to the Government Printer for the State of Victoria

Level 2, 1 Macarthur Street
Melbourne 3002
Victoria Australia

How To Order



**Retail &
Mail Sales**

Victoria Government Gazette

Level 5, 460 Bourke Street
Melbourne 3000
PO Box 1957 Melbourne 3001
DX 106 Melbourne



Telephone

(03) 8523 4601



Fax

(03) 9600 0478

email

gazette@bluestargroup.com.au

Price Code B