



Victoria Government Gazette

No. S 459 Wednesday 27 December 2017
By Authority of Victorian Government Printer

Road Management Act 2004

ROAD DECLARATIONS AND DISCONTINUANCES

ROAD DECLARATIONS

VicRoads, pursuant to sections 11 and 14 of the **Road Management Act 2004**, upon publication of this notice revokes or declares the roads described in Schedule A and on the plans attached.

ROAD DISCONTINUANCES

VicRoads, pursuant to section 12 of the **Road Management Act 2004**, upon publication of this notice discontinues the parts of the roads described in Schedule B and on the plans attached and approves the sale of the surplus land as provided in section 94 of the **Transport Integration Act 2010** and as delegated by the Minister for Roads under section 31 of the latter said Act.

The effects of these Road Declarations and Road Discontinuances on road names are described in Table 1.

SCHEDULE A

ARTERIAL ROAD

- a) Those parts of Burke Road identified by hatching on the plans numbered GP23533 and GP23534 are declared or revoked as described in the legend in the said plans.
- b) Those parts of Centre Road identified by hatching on the plan numbered GP23674 are revoked as described in the legend in the said plan.
- c) That part of North Road identified by hatching on the plan numbered GP23683 is revoked as described in the legend in the said plan.

SCHEDULE B

ARTERIAL ROAD

- a) Those parts of Burke Road identified by hatching on the plan numbered GP23533 are discontinued as described in the legend in the said plan.
- b) Those parts of Centre Road identified by hatching on the plan numbered GP23674 are discontinued as described in the legend in the said plan.
- c) That part of North Road identified by hatching on the plan numbered GP23683 is discontinued as described in the legend in the said plan.

MUNICIPAL ROAD

- d) That part of Milton Parade identified by hatching on the plan numbered GP23530 is discontinued as described in the legend in the said plan.
- e) Those parts of Carroll Crescent identified by hatching on the plans numbered GP23531, GP23531A and GP23532 are discontinued as described in the legend in the said plans.
- f) Those parts of Wills Street identified by hatching on the plan numbered GP23534A are discontinued as described in the legend in the said plan.
- g) Those parts of McKinnon Road and Nicholson Street identified by hatching on the plan numbered GP23671 are discontinued as described in the legend in the said plan.
- h) Those parts of Burgess Street identified by hatching on the plan numbered GP23675 are discontinued as described in the legend in the said plan.
- i) Those parts of Katandra Road identified by hatching on the plans numbered GP23682 and GP23683A are discontinued as described in the legend in the said plans.
- j) That part of Cadby Avenue identified by hatching on the plan numbered GP23684 is discontinued as described in the legend in the said plan.
- k) Those parts of Road identified by hatching on the plan numbered GP23673 are discontinued as described in the legend in the said plan.

SPECIAL

TABLE 1
EFFECTS ON ROAD NAMES

1. Names in Column 2 are existing Vicmap Address names, which are unaffected by this notice.
2. **Names in Column 1 are for VicRoads administrative purposes only and are independent of names in Column 2.**
3. Names in Column 2 may not apply to the whole length of the road and are for general information only.

ARTERIAL ROAD

Plan No.	VicRoads Administrative Road Name Column 1	Vicmap Address Road Name (for property addressing purposes) Column 2
GP23533 GP23534	Burke Road	Not detailed – Road boundary adjustments only
GP23674	Centre Road	Not detailed – Road boundary adjustments only
GP23683	North Road	Not detailed – Road boundary adjustments only

MUNICIPAL ROAD

Plan No.	VicRoads Administrative Road Name Column 1	Vicmap Address Road Name (for property addressing purposes) Column 2
GP23530 GP23531 GP23531A GP23532 GP23534A	Not applicable	Not detailed – Road boundary adjustments only
GP23671 GP23675 GP23682 GP23683A GP23684 GP23673	Not applicable	Not detailed – Road boundary adjustments only

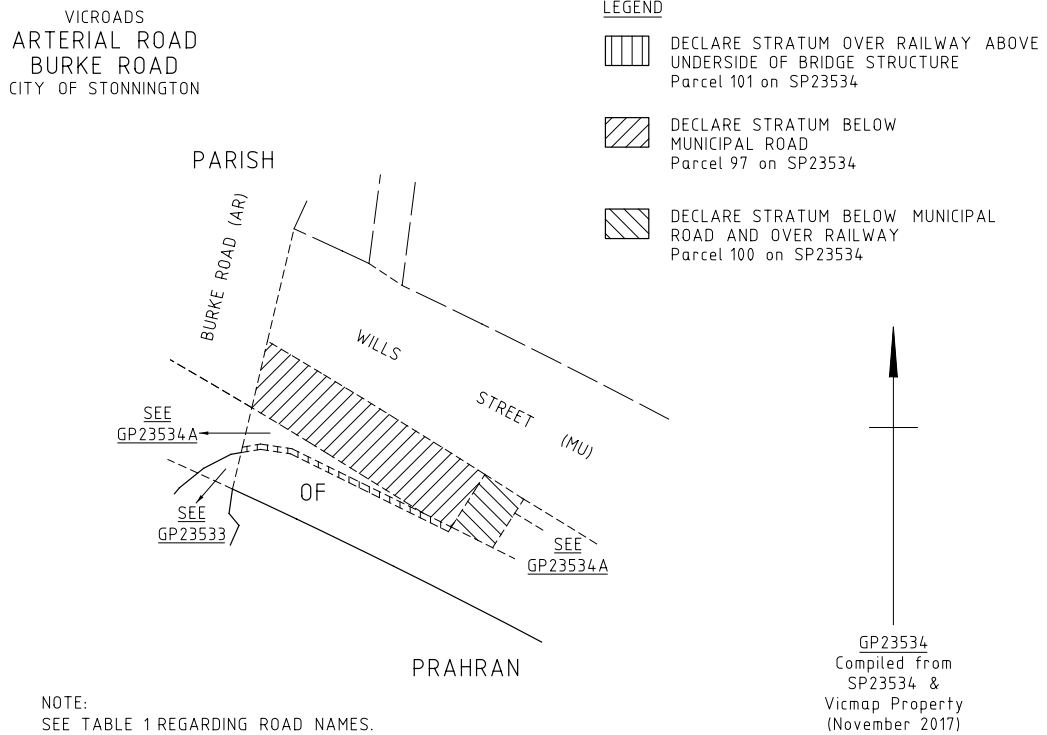
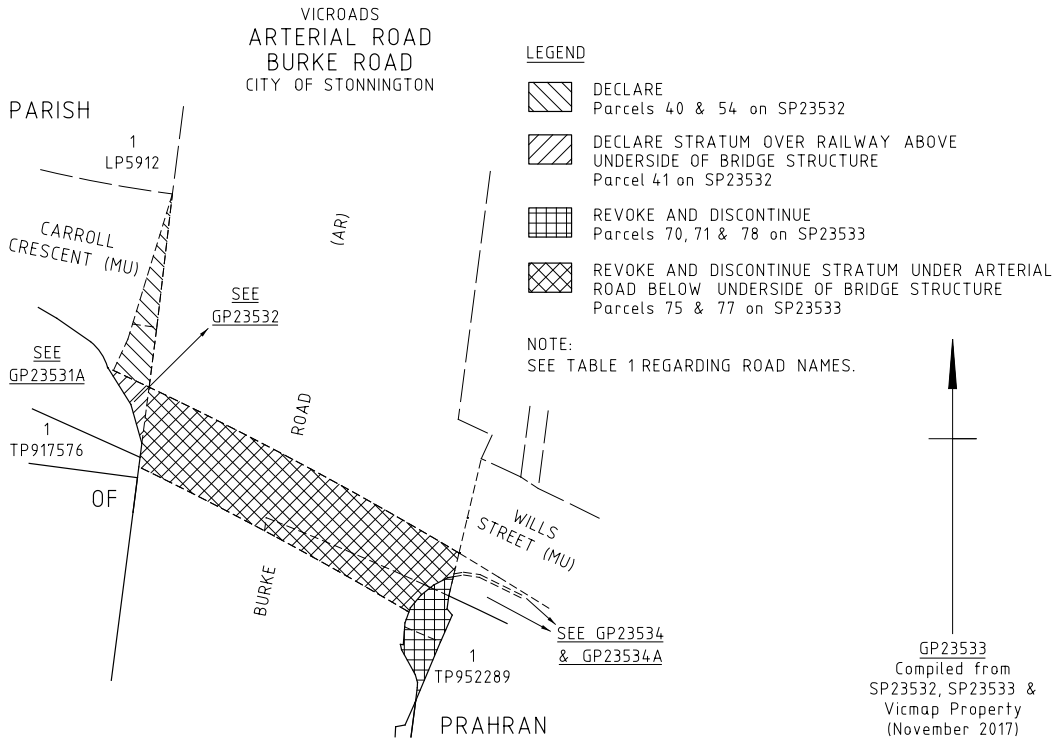

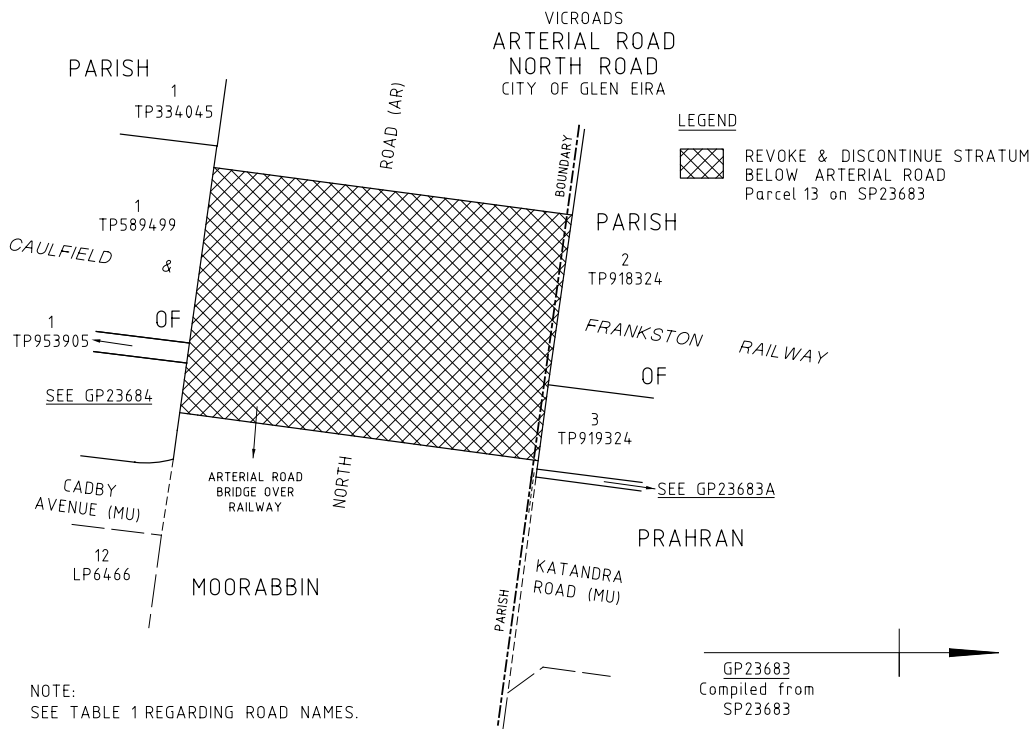
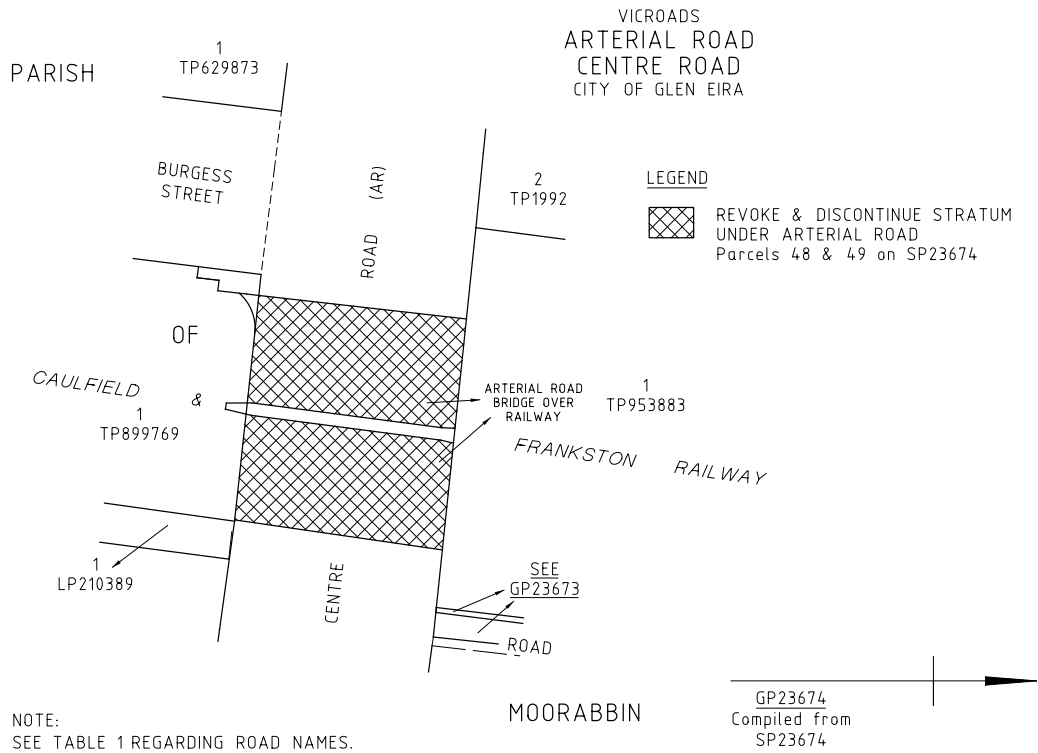

VICROADS
MUNICIPAL ROAD
MILTON PARADE
CITY OF STONNINGTON

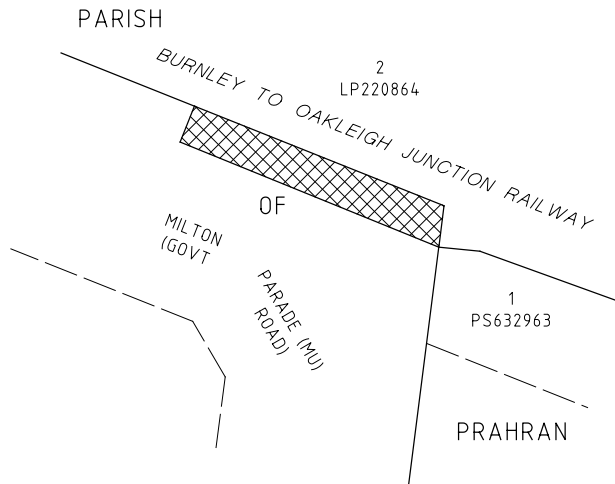

GP23530
Compiled from
SP23530 &
Vicmap Property
(November 2017)

LEGEND

 DISCONTINUE
Parcel 1 SP23530

NOTE:
SEE TABLE 1 REGARDING ROAD NAMES.

VICROADS
MUNICIPAL ROAD
CARROLL CRESCENT
CITY OF STONNINGTON

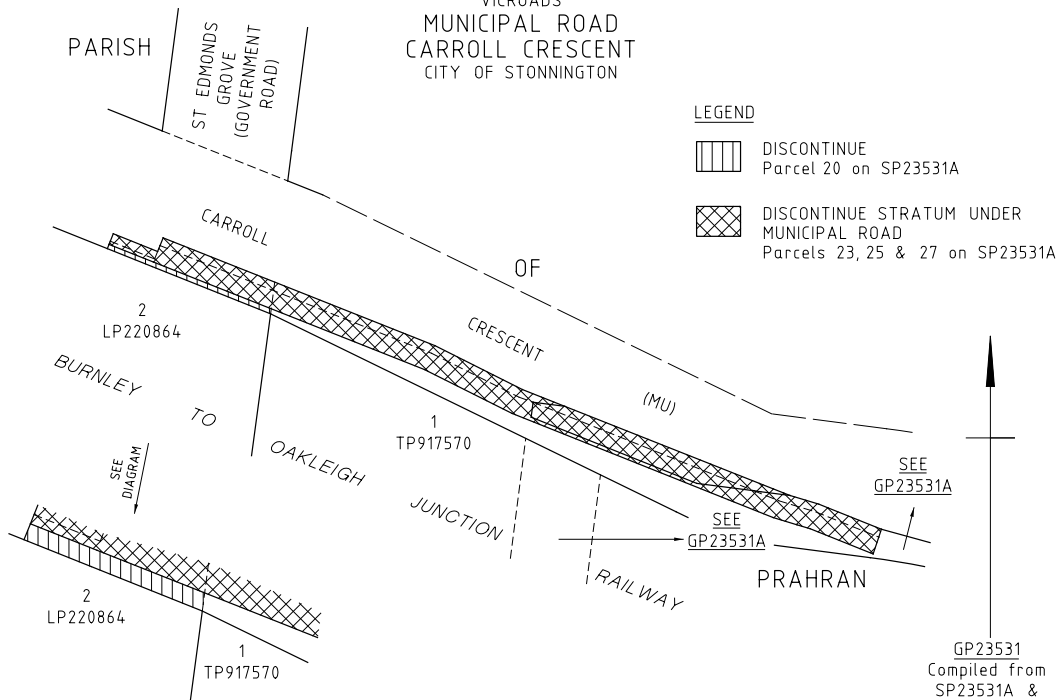

LEGEND

 DISCONTINUE
Parcel 20 on SP23531A

 DISCONTINUE STRATUM UNDER
MUNICIPAL ROAD
Parcels 23, 25 & 27 on SP23531A

GP23531
Compiled from
SP23531A &
Vicmap Property
(November 2017)

NOTE:
SEE TABLE 1 REGARDING ROAD NAMES.

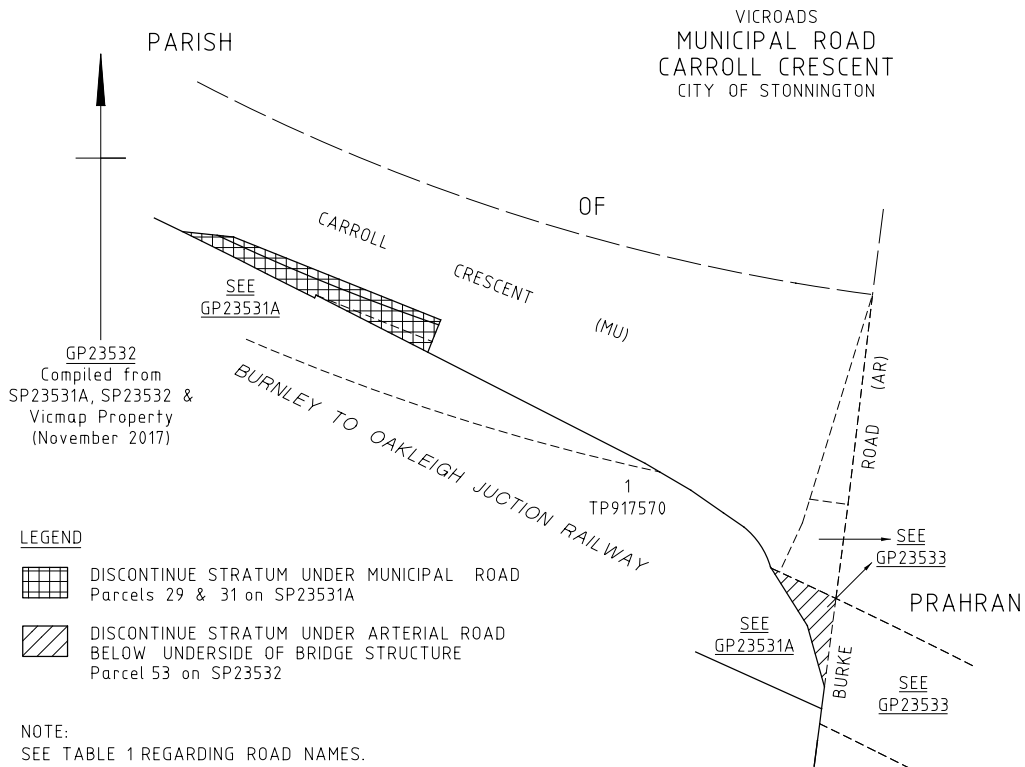
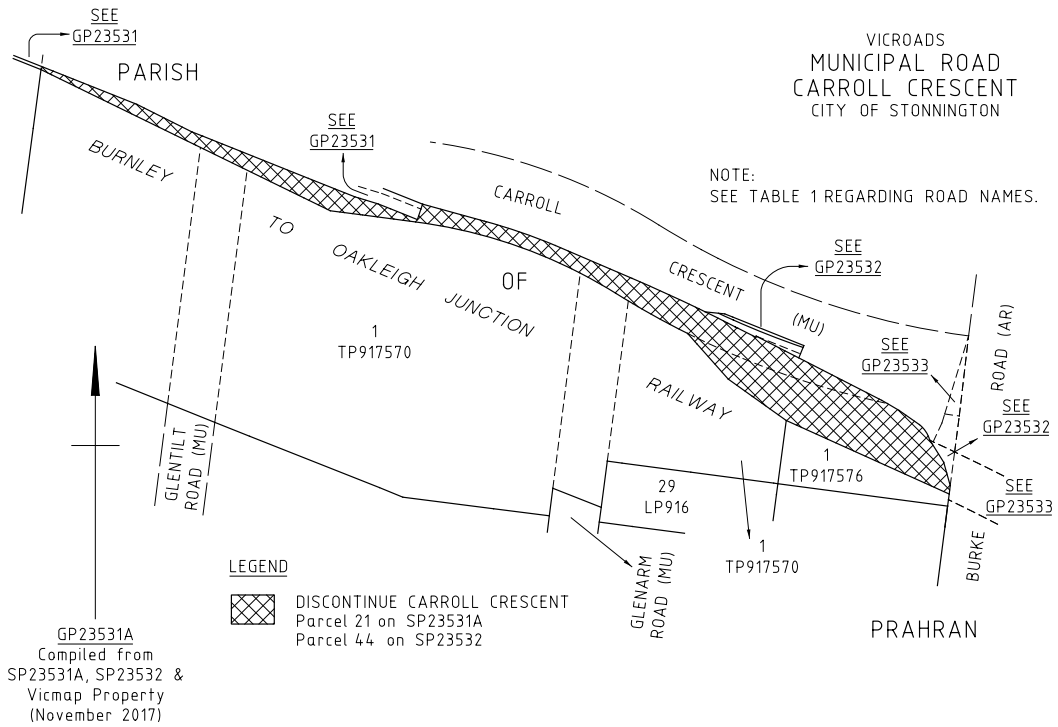

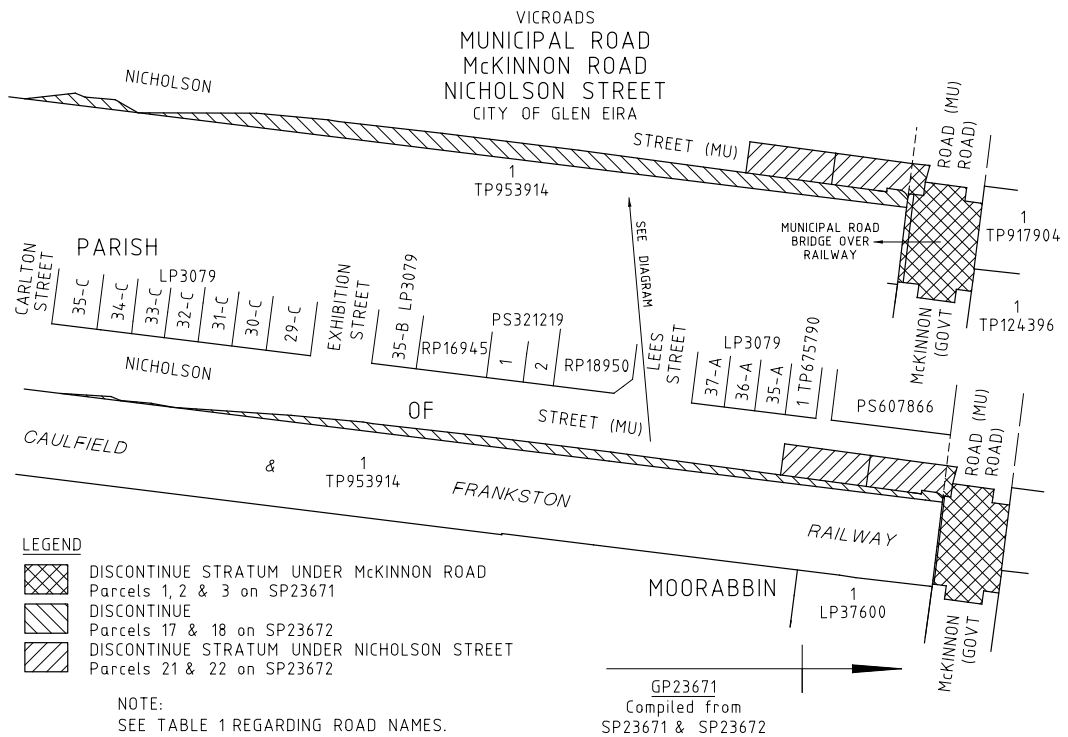
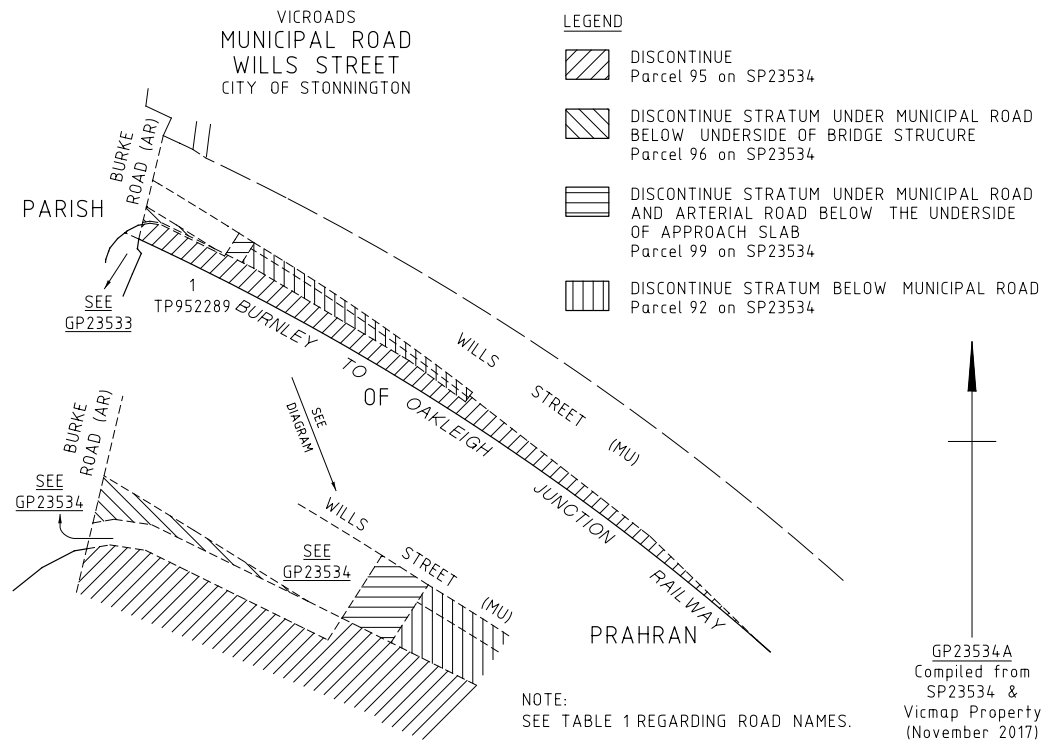

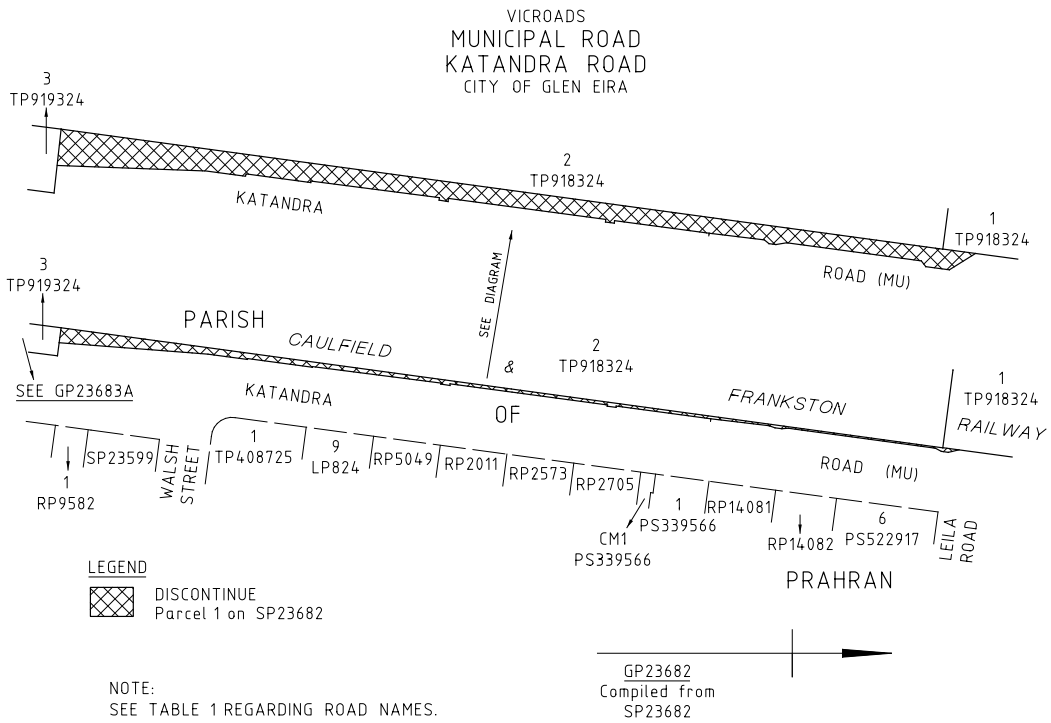
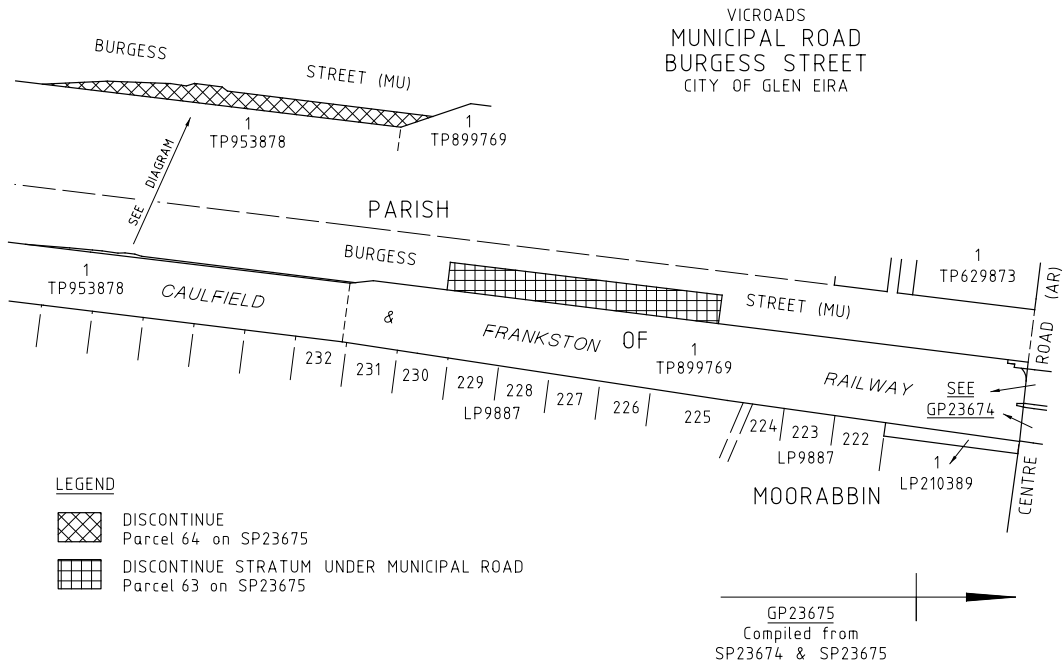

VICROADS
MUNICIPAL ROAD
KATANDRA ROAD
CITY OF GLEN EIRA

LEGEND

 DISCONTINUE
Parcels 11 & 12 on SP23683

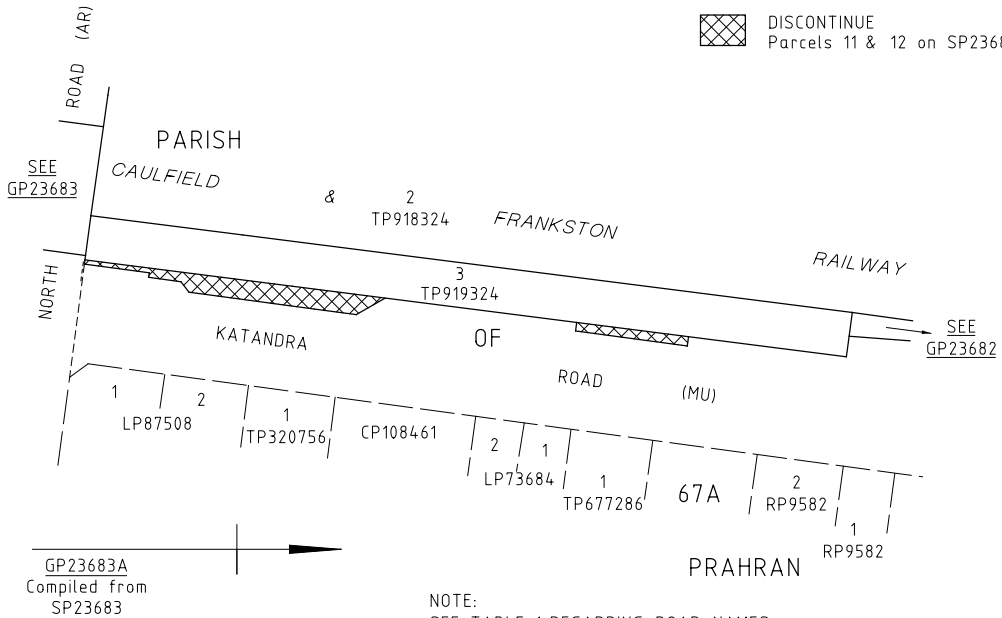

VICROADS
MUNICIPAL ROAD
CADBY AVENUE
CITY OF GLEN EIRA

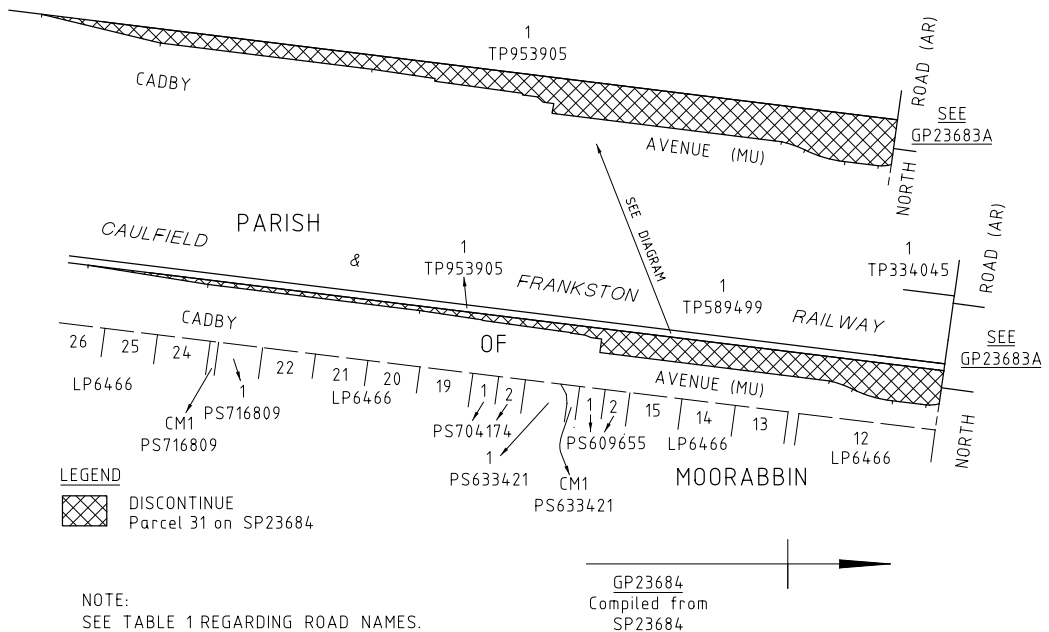

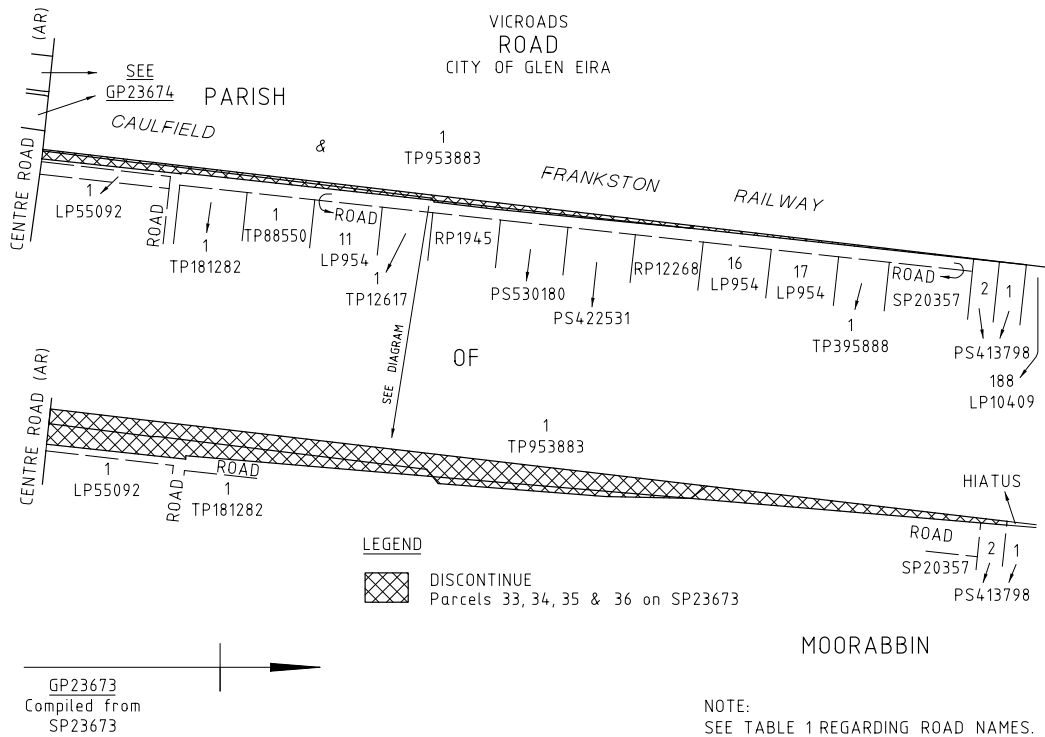

Dated 20 December 2017

JOHN MERRIT
Chief Executive
VicRoads

This page was left blank intentionally

bluestar **PRINT**

The *Victoria Government Gazette* is published by Blue Star Print with the authority of the Government Printer for the State of Victoria

© State of Victoria 2017

This publication is copyright. No part may be reproduced by any process except in accordance with the provisions of the Copyright Act.

Address all enquiries to the Government Printer for the State of Victoria

Level 2, 1 Macarthur Street
Melbourne 3002
Victoria Australia

How To Order



**Retail &
Mail Sales**

Victoria Government Gazette

Ground Floor, Building 8,
658 Church Street,
Richmond 3121

DX 106 Melbourne



Telephone

(03) 8523 4601



Fax

(03) 9600 0478

email

gazette@bluestargroup.com.au

Price Code A