



# Victoria Government Gazette

No. S 254 Wednesday 26 July 2017  
By Authority of Victorian Government Printer

## Road Management Act 2004

### ROAD DECLARATIONS AND DISCONTINUANCES

#### ROAD DECLARATIONS

VicRoads, pursuant to sections 11 and 14 of the **Road Management Act 2004**, upon publication of this notice declares, revokes or renames the roads described in Schedule A and on the plans attached.

VicRoads also authorises and withdraws the freeway access points described in Schedule B and on the plans attached.

#### ROAD DISCONTINUANCES

VicRoads, pursuant to section 12 of the **Road Management Act 2004**, upon publication of this notice:

- a) discontinues the parts of Hume Freeway described in Schedule C and on the plans attached, subject to the right, power and interest held by the Authority/Beneficiary over the Identified Land shown in Schedule D and on the plan attached, as provided for in section 207C of the **Local Government Act 1989**; and
- b) approves the sale of the surplus land as provided in section 94 of the **Transport Integration Act 2010** and as delegated by the Minister for Roads and Road Safety under section 31 of the latter said Act.
- c) discontinues the parts of South Gippsland Highway described in Schedule C and on the plan attached

The effects of these Road Declarations and Road Discontinuances on road names are described in Table 1.

### SCHEDULE A

#### FREEWAY

- a) Those parts of Hume Freeway identified by hatching on the plans numbered GP23483 and GP23483A are revoked as described in the legend in the said plans.
- b) Those parts of Western Freeway identified by hatching on the plans numbered GP22055, GP22056, GP22058, GP22060, GP22061 and GP22062 are declared as described in the legend in the said plans.

#### ARTERIAL ROAD

- c) Those parts of South Gippsland Highway identified by hatching on the plan numbered GP22391 are declared or revoked as described in the legend in the said plan.
- d) Those parts of Dandenong Bypass identified by hatching on the plans numbered GP21926, GP21927, GP21928, GP21929, GP21930, GP21931, GP21932, GP21933 and GP21934 are declared or renamed as described in the legend in the said plans.
- e) Those parts of State (Bell/Springvale) Highway identified by hatching on the plans numbered GP21926 and GP21927 are declared as described in the legend in the said plans.
- f) Those parts of State (Lower Dandenong/Cheltenham) Highway identified by hatching on the plans numbered GP21929, GP21930 and GP21934 are declared as described in the legend in the said plans.

#### MUNICIPAL ROAD

- g) Those parts of Jeetho Road identified by hatching on the plan numbered GP22391A are declared as described in the legend in the said plan.
- h) That part of Coomoora Road identified by hatching on the plan numbered GP21926A is declared as described in the legend in the said plan.

**SPECIAL**

- i) That part of Southpark Close identified by hatching on the plan numbered GP21927A is declared as described in the legend in the said plan.
- j) That part of Perry Road identified by hatching on the plan numbered GP21934A is declared as described in the legend in the said plan.

**SCHEDULE B**

<b>Plan No. (Identifier)</b>	<b>Purpose of Access Point</b>	<b>Authorised Users</b>
GP22055 (AA4)	Private Access Point	Parcel 10 on SP22054 Only
GP22055 (AA8)	Private Access Point	Parcel 23 on SP22055B Only
GP22055 (AA9)	Private Access Point	Parcel 24 on SP22055B Only
GP22055 (AAW)	Withdrawn	N/A
GP22056 (AA13)	Private Access Point	Parcel 47 on SP22056A Only
GP22056 (AA14)	Private Access Point	Parcel 45 on SP22056A Only
GP22056 (AA20)	Private Access Point	Parcel 63 on SP22057A Only
GP22056 (AAW)	Withdrawn	N/A
GP22060 (AA27) & (AA29)	Private Access Point	Parcel 124 on SP22060A Only
GP22060 (AA28)	Private Access Point	Parcel 125 on SP22060A Only
GP22060 (AAW)	Withdrawn	N/A
GP22061 (AA33)	Private Access Point	Parcel 146 on SP22061A Only
GP22061 (AAW)	Withdrawn	N/A
The access points are authorised for the time being only and VicRoads may withdraw the authorisation at any time it so desires.		

**SCHEDULE C****ROAD**

- a) Those parts of Hume Freeway identified by hatching on the plans numbered GP23483 and GP23483A are discontinued as described in the legend in the said plans.
- b) That part of South Gippsland Highway identified by hatching on the plan numbered GP22391 is discontinued as described in the legend in the said plan.

**SCHEDULE D**

<b>Plan No.</b>	<b>Identified Land</b>	<b>Authority/Beneficiary</b>
GP23483	E-1 on GP23483	APA Group

TABLE 1

**EFFECTS ON ROAD NAMES**

1. Names in Column 2 are existing Vicmap Address names, which are unaffected by this notice.
2. **Names in Column 1 are for VicRoads administrative purposes only and are independent of names in Column 2.**
3. Names in Column 2 may not apply to the whole length of the road and are for general information only.

**FREEWAY**

<b>Plan No.</b>	<b>VicRoads Administrative Road Name Column 1</b>	<b>Vicmap Address Road Name (for property addressing purposes) Column 2</b>
GP23483 GP23483A	Hume Freeway	Not Applicable
GP22055 GP22056 GP22058 GP22060 GP22061 GP22062	Western Freeway	Western Freeway

**ARTERIAL ROAD**

<b>Plan No.</b>	<b>VicRoads Administrative Road Name Column 1</b>	<b>Vicmap Address Road Name (for property addressing purposes) Column 2</b>
GP22391	South Gippsland Highway	South Gippsland Highway
GP21926 GP21927 GP21928 GP21929 GP21930 GP21931 GP21932 GP21933 GP21934	Dandenong Bypass	Not Applicable
GP21926 GP21927	State (Bell/Springvale) Highway	Springvale Road
GP21929 GP21930 GP21934	State (Lower Dandenong/Cheltenham) Highway  Note: Former administrative name State (Lower Dandenong/Cheltenham) Highway ceases where revoked	Cheltenham Road

**MUNICIPAL ROAD**

<b>Plan No.</b>	<b>VicRoads Administrative Road Name Column 1</b>	<b>Vicmap Address Road Name (for property addressing purposes) Column 2</b>
GP22391A	Not applicable	Not detailed – Road boundary adjustments only
GP21926A	Not applicable	Not detailed – Road boundary adjustments only
GP21927A	Not applicable	Not detailed – Road boundary adjustments only
GP21934A	Not applicable	Not detailed – Road boundary adjustments only

VICROADS  
FREEWAY  
HUME FREEWAY  
CITY OF WHITTLESEA

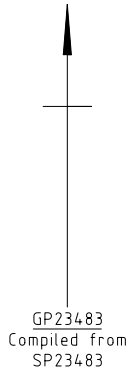

PARISH

OF

HUME

FREEWAY

(FW)

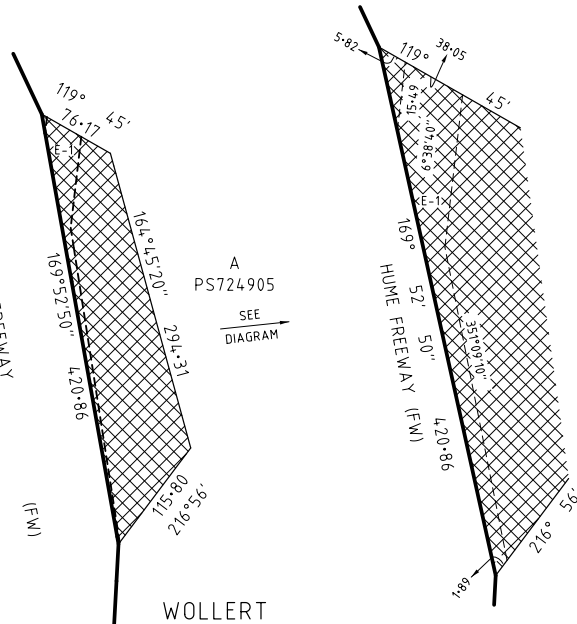

WOLLERT

LEGEND

REVOKE AND DISCONTINUE Parcel 1 on SP23483.

NOTES:

- SEE TABLE 1 REGARDING ROAD NAMES.  
THE HEAVIEST LINE INDICATES:  
1. A RESTRICTION OF ACCESS.  
2. THE LIMITS OF THE FREEWAY RESERVATION.

Easement Reference	Purpose	Width (Metres)	Origin	Land Benefited/ In Favour Of
E-1	Gas Supply	See Diag	This Plan	APA GROUP

VICROADS  
FREEWAY  
HUME FREEWAY  
CITY OF WHITTLESEA

LEGEND

REVOKE AND DISCONTINUE Parcel 2 on SP23483.

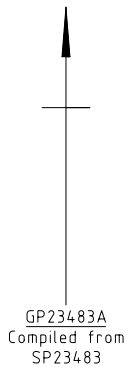

PARISH

OF

HUME

FREEWAY

(FW)

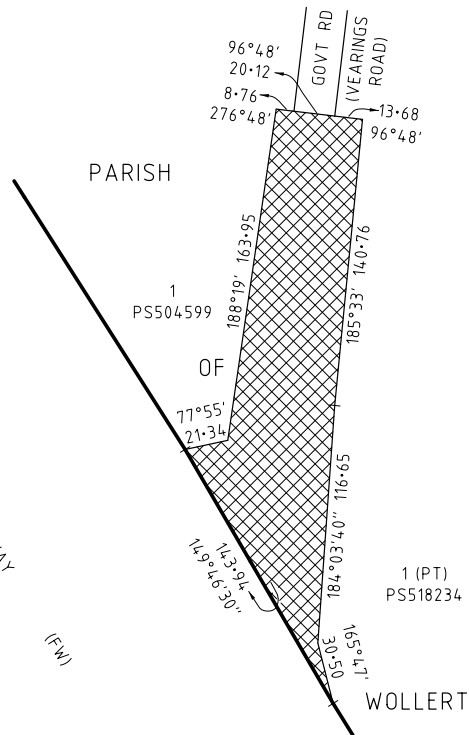

WOLLERT

NOTES:

- SEE TABLE 1 REGARDING ROAD NAMES.  
THE HEAVIEST LINE INDICATES:  
1. A RESTRICTION OF ACCESS.  
2. THE LIMITS OF THE FREEWAY RESERVATION.

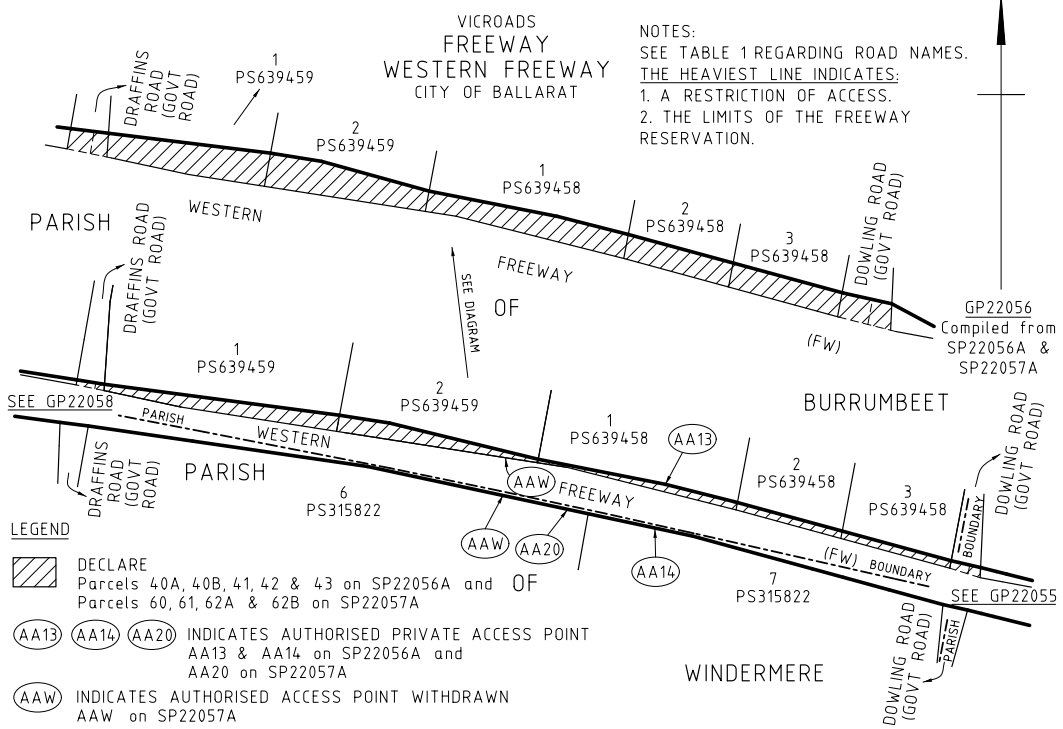
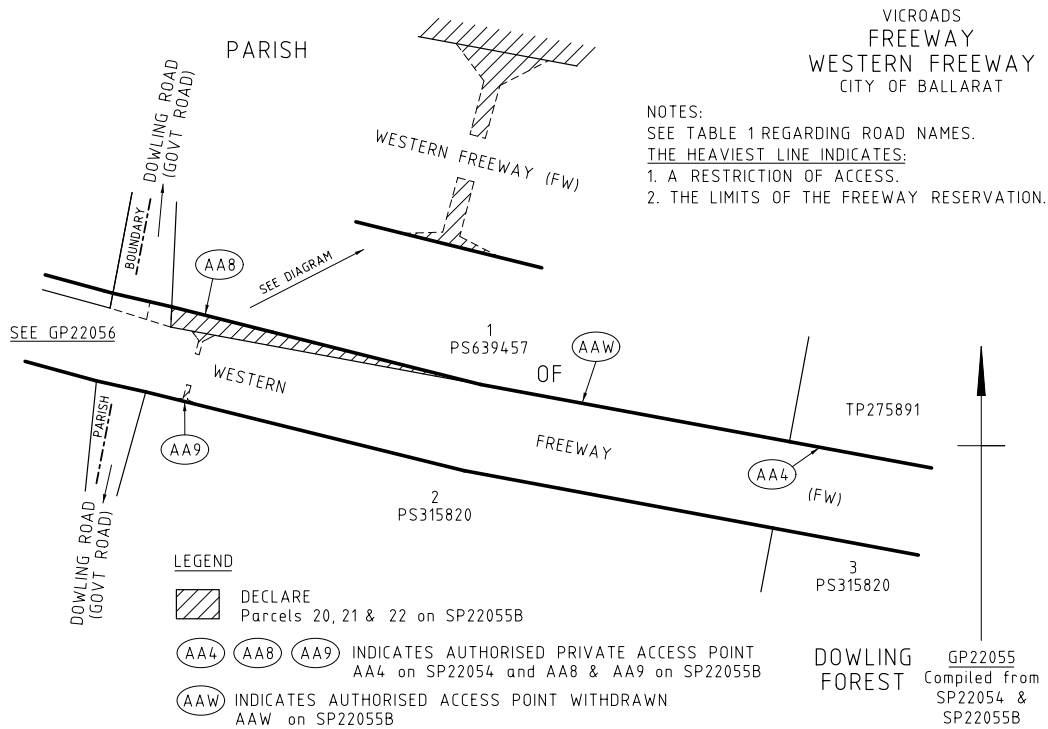

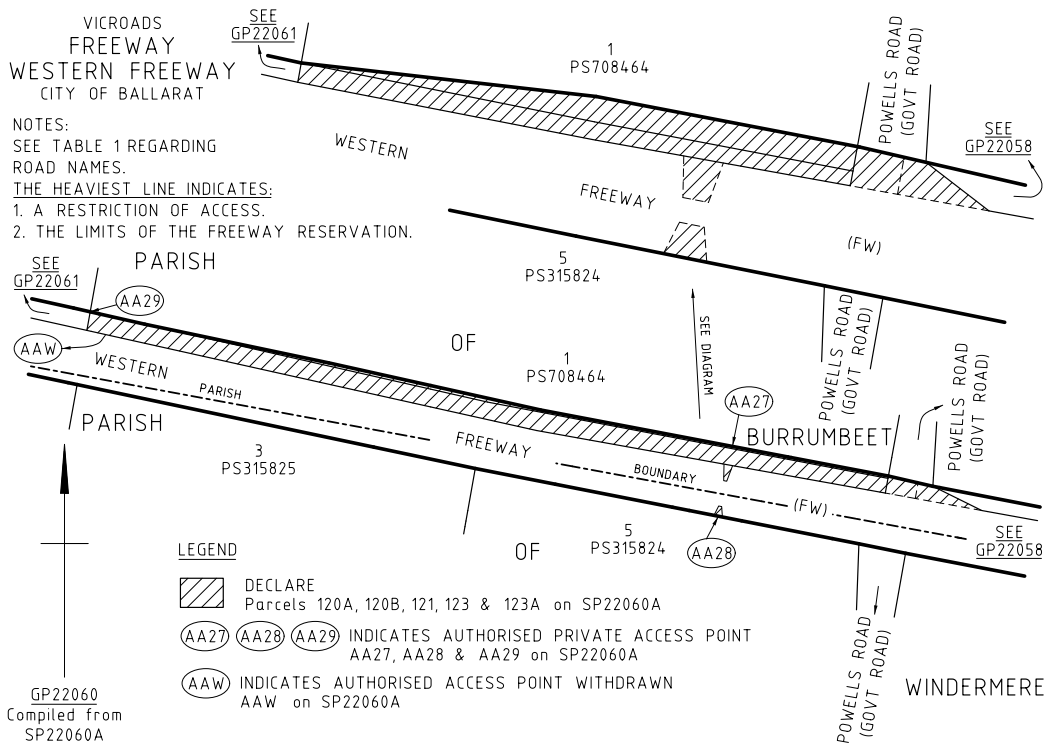
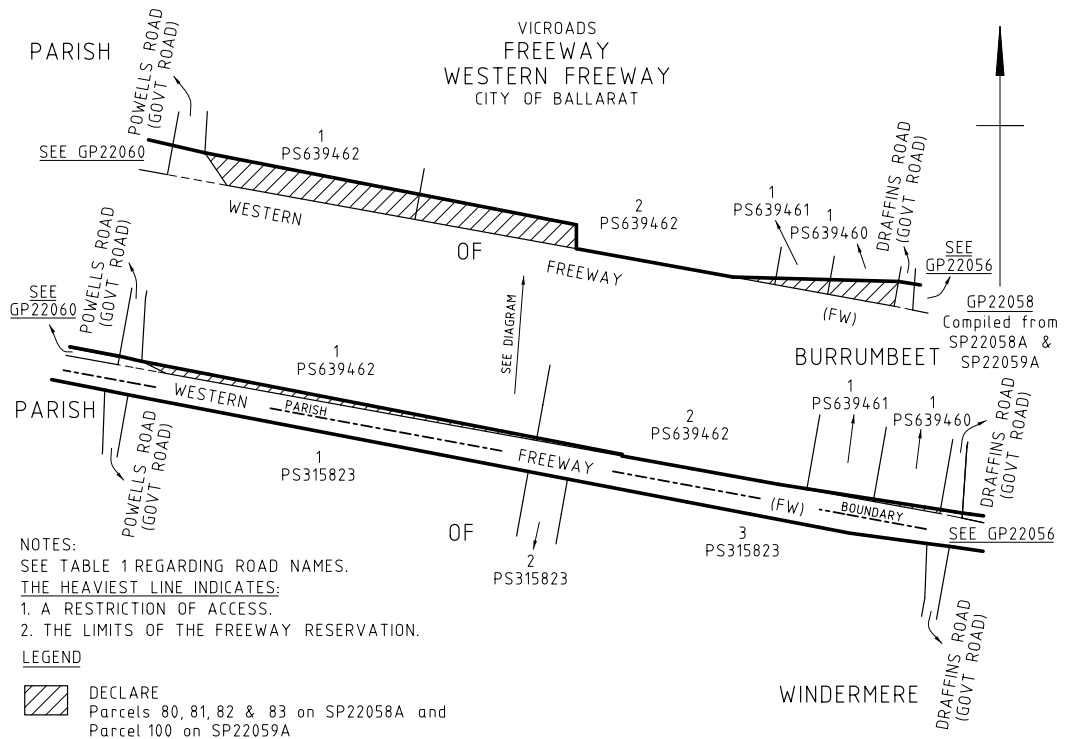

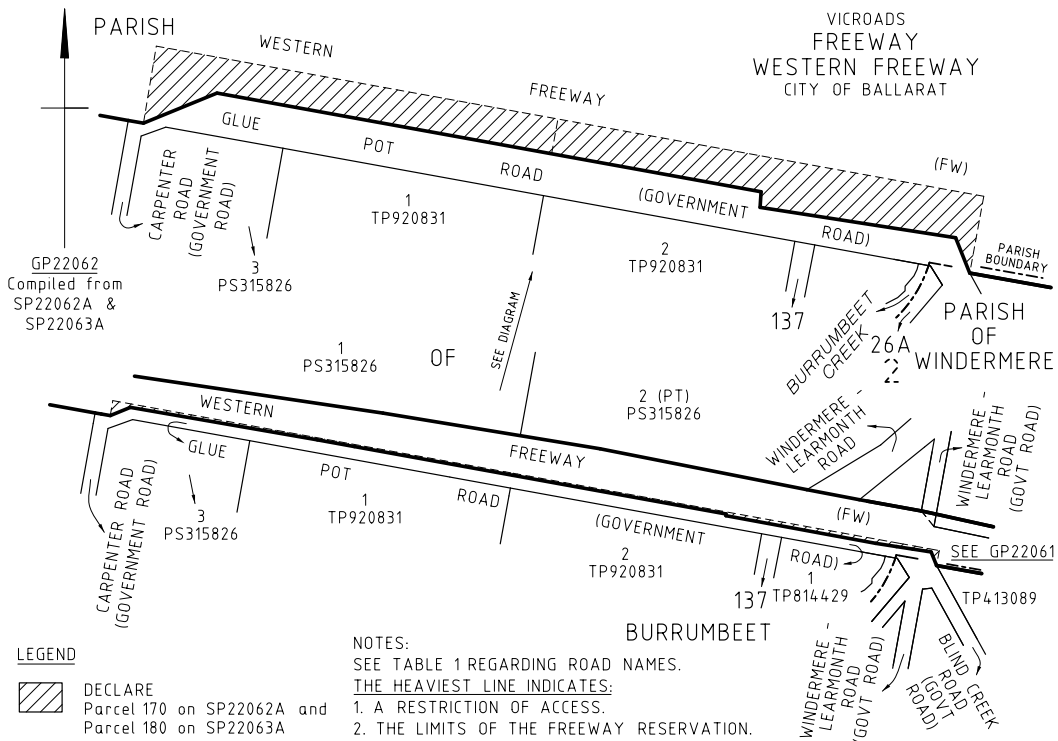
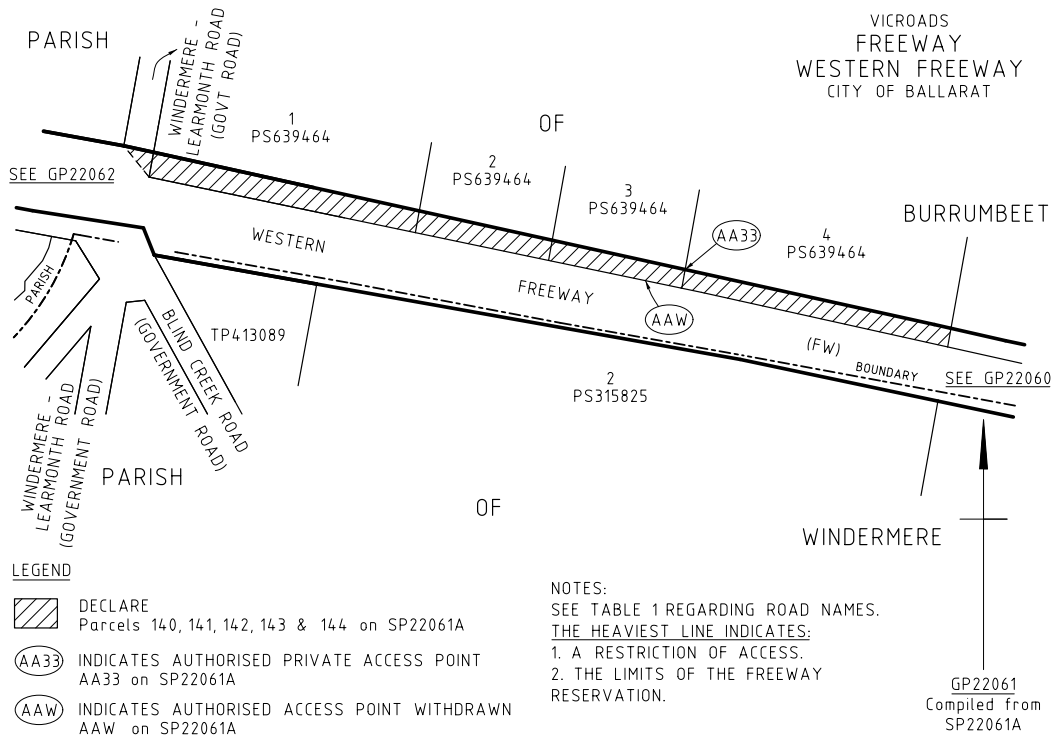





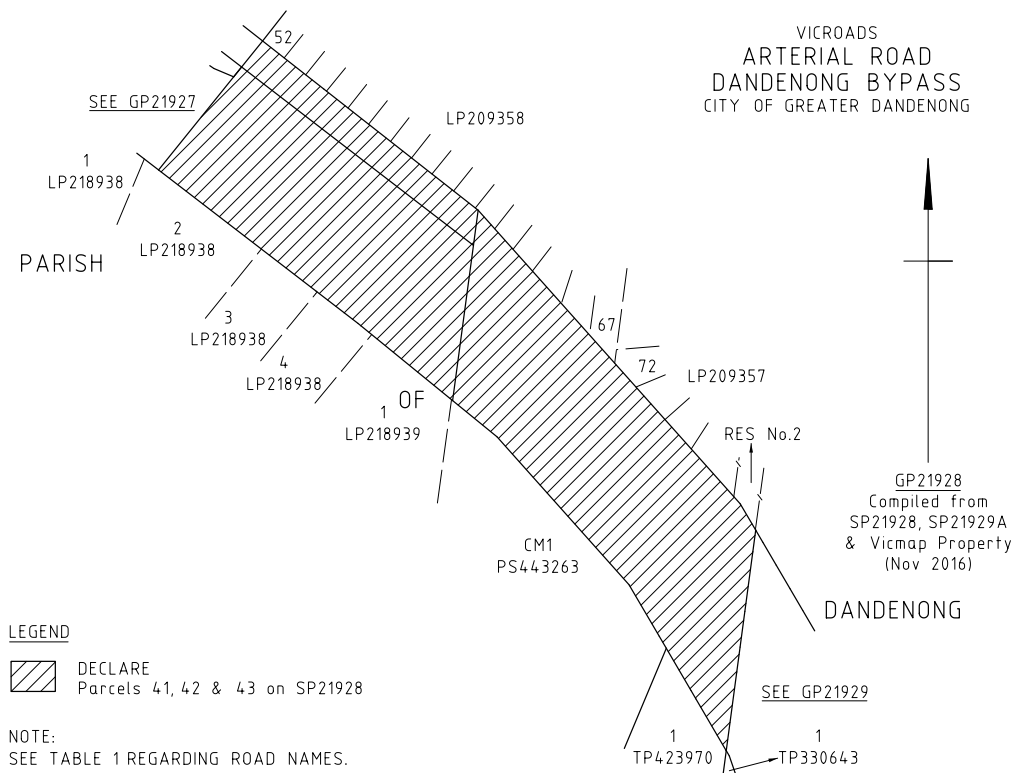
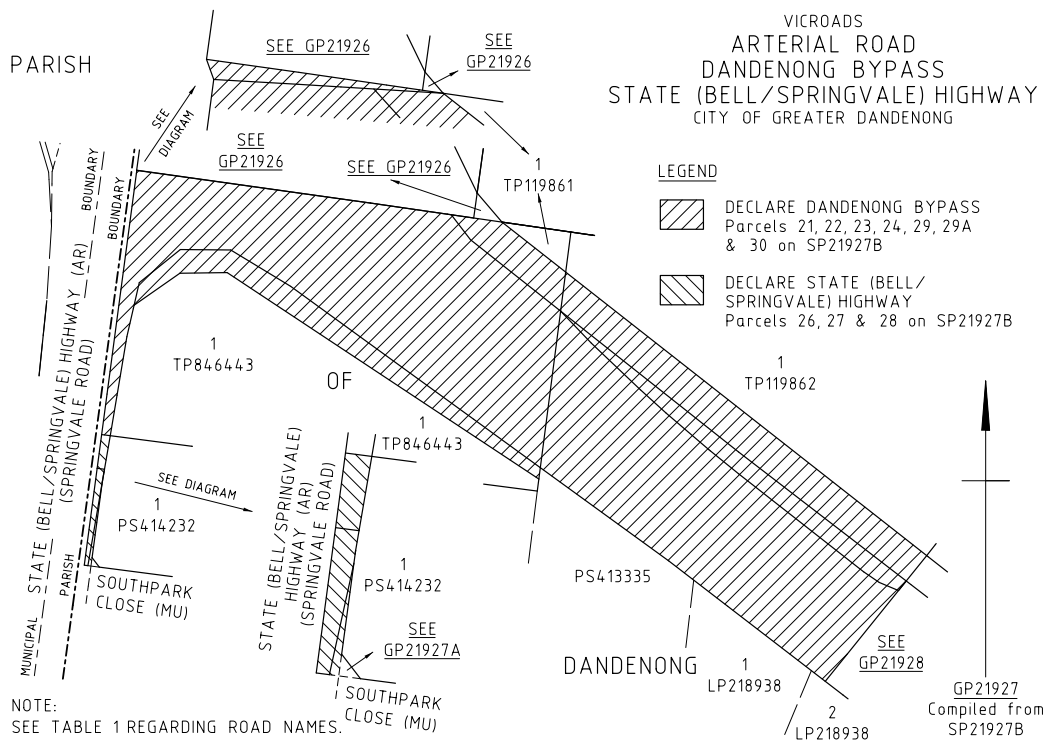

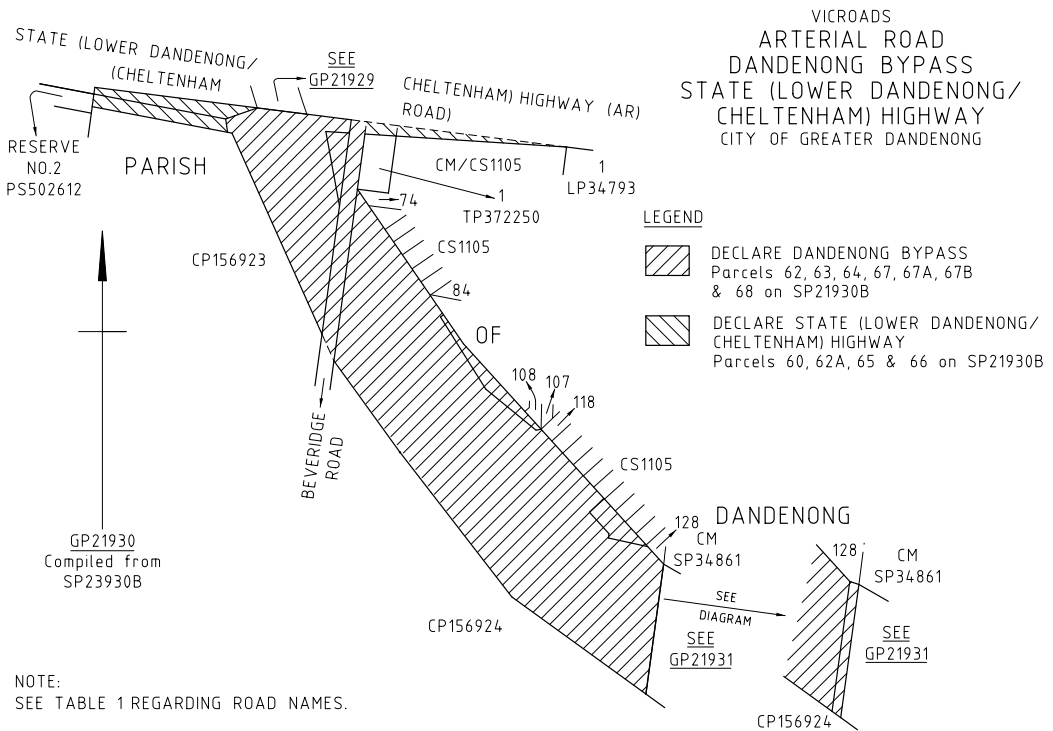
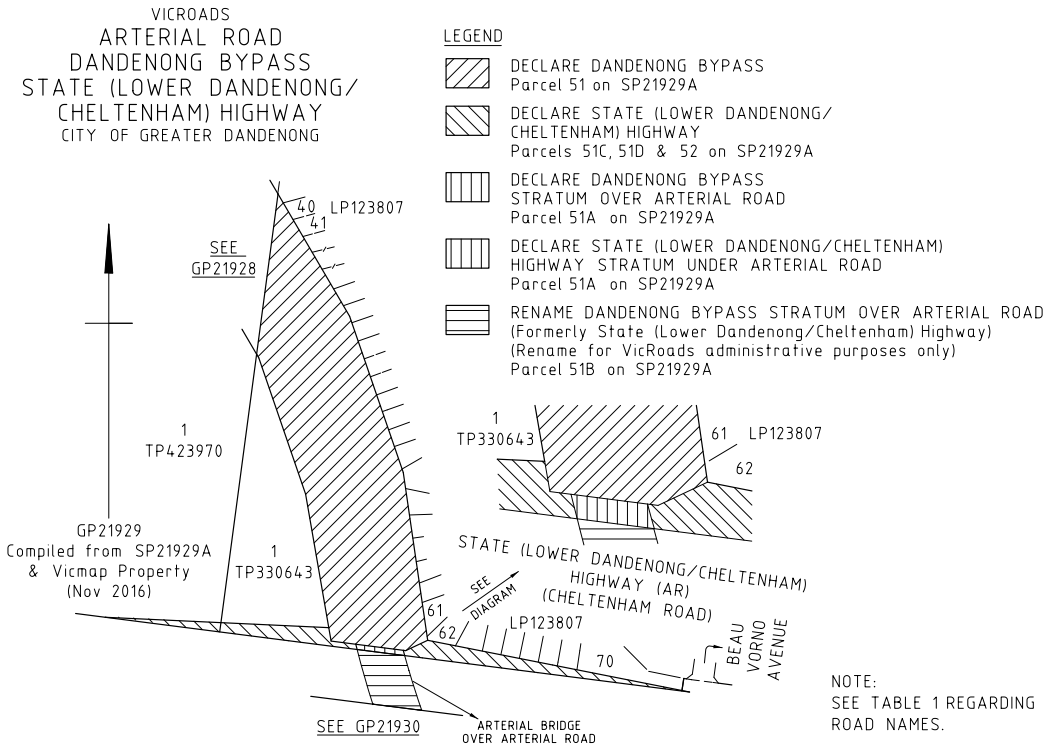

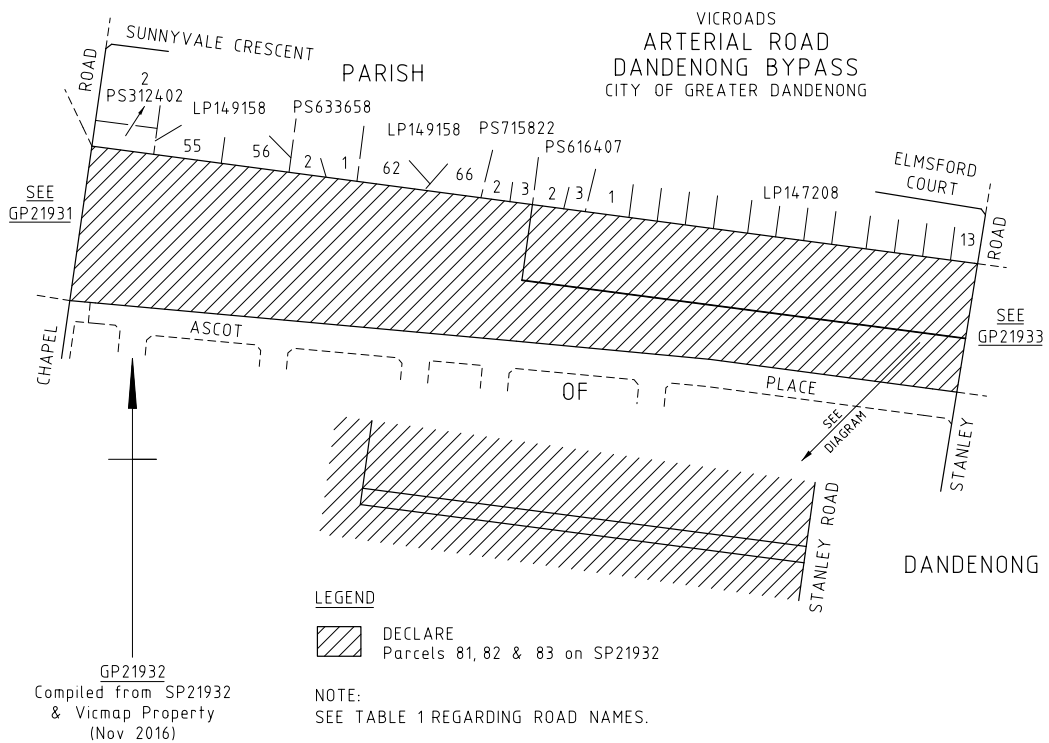
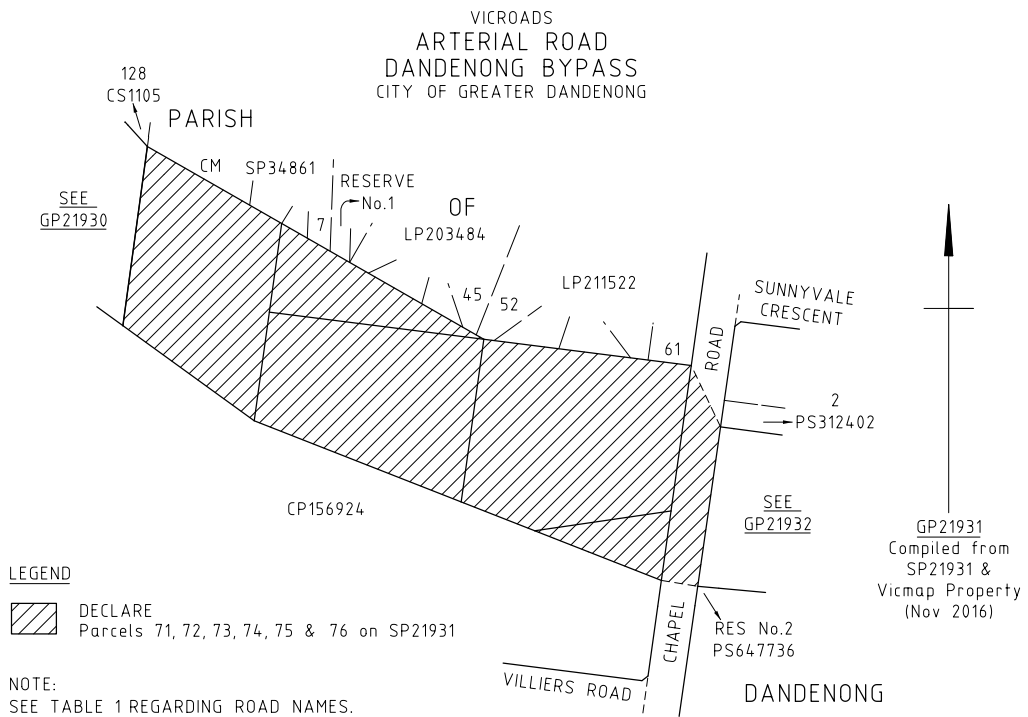

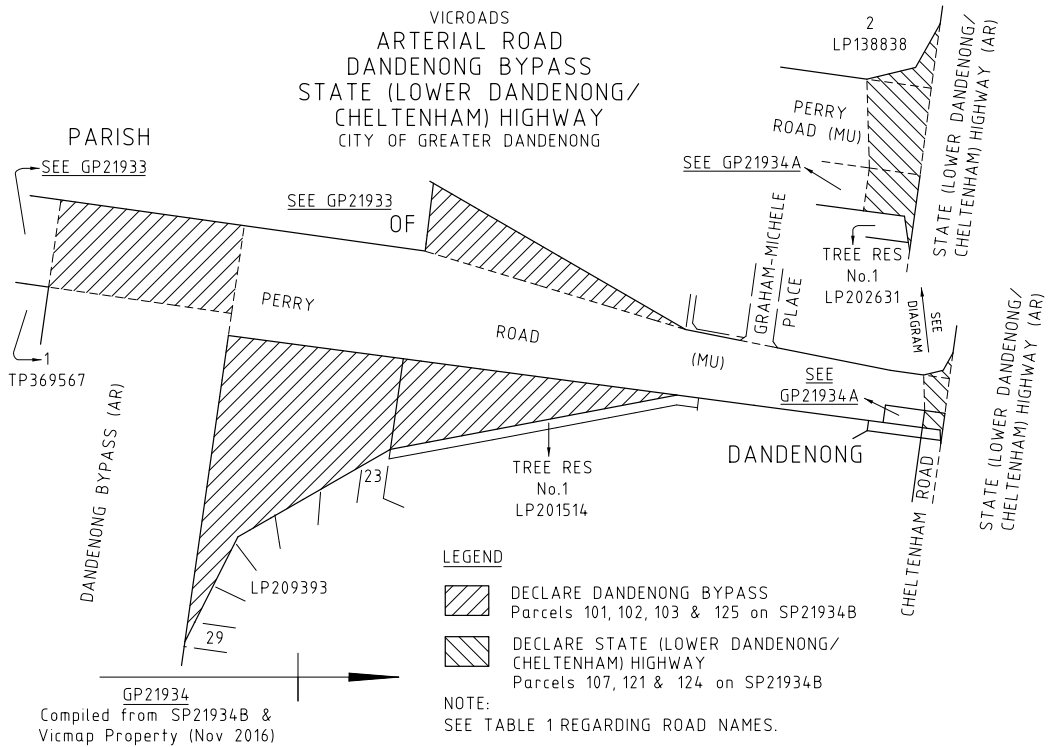
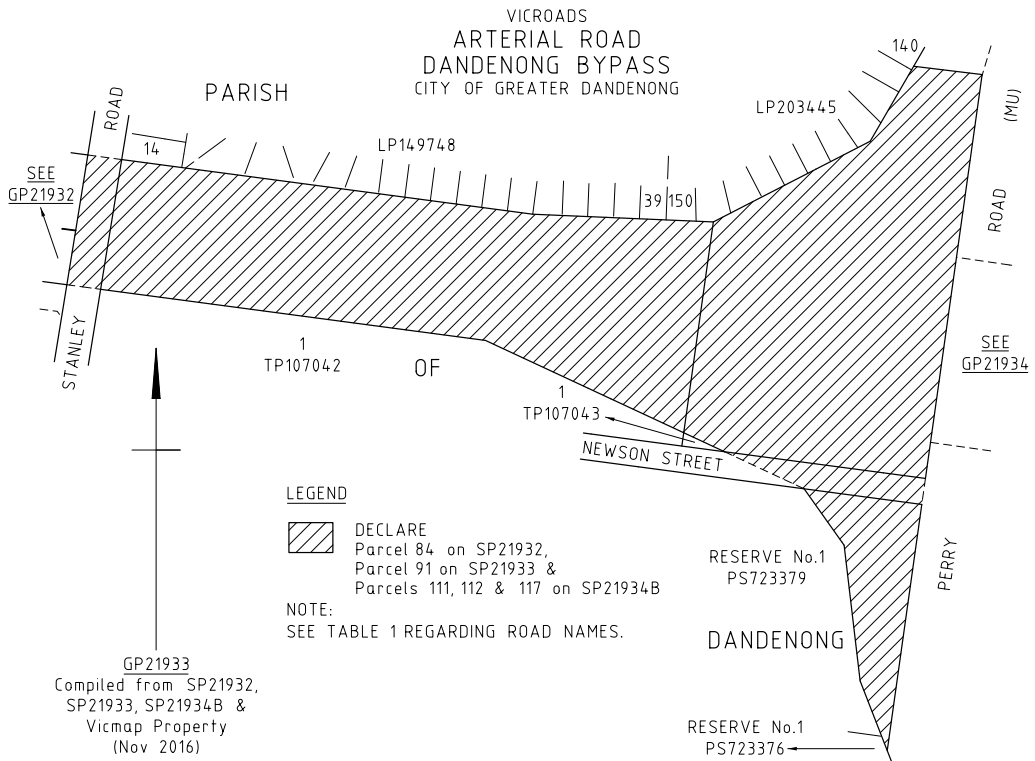

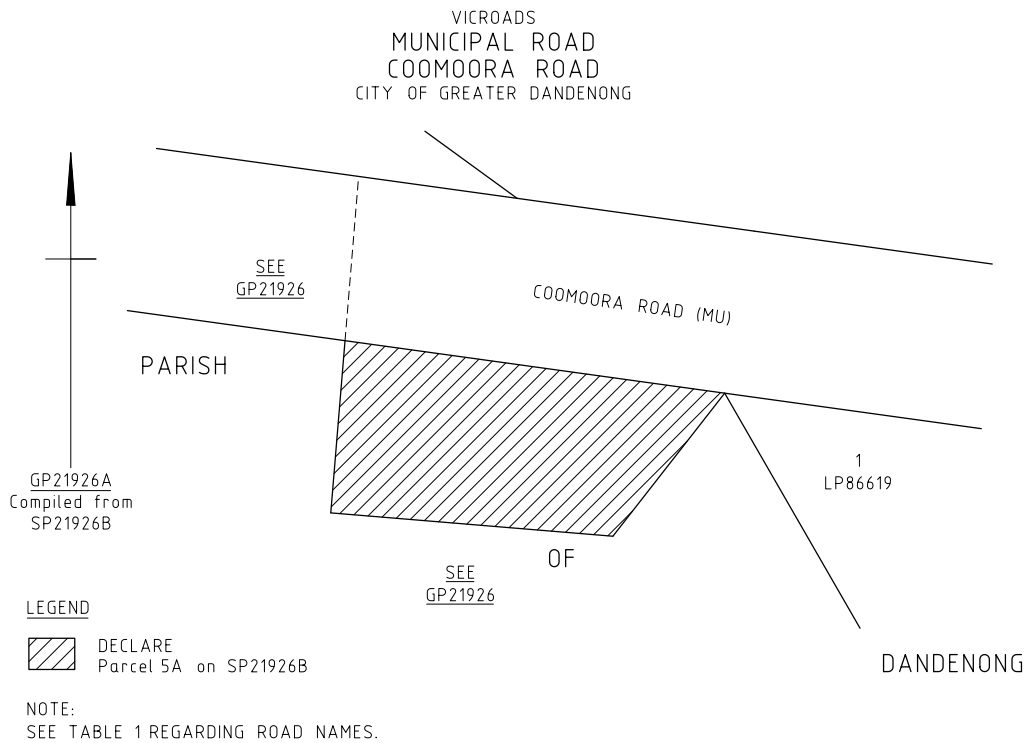
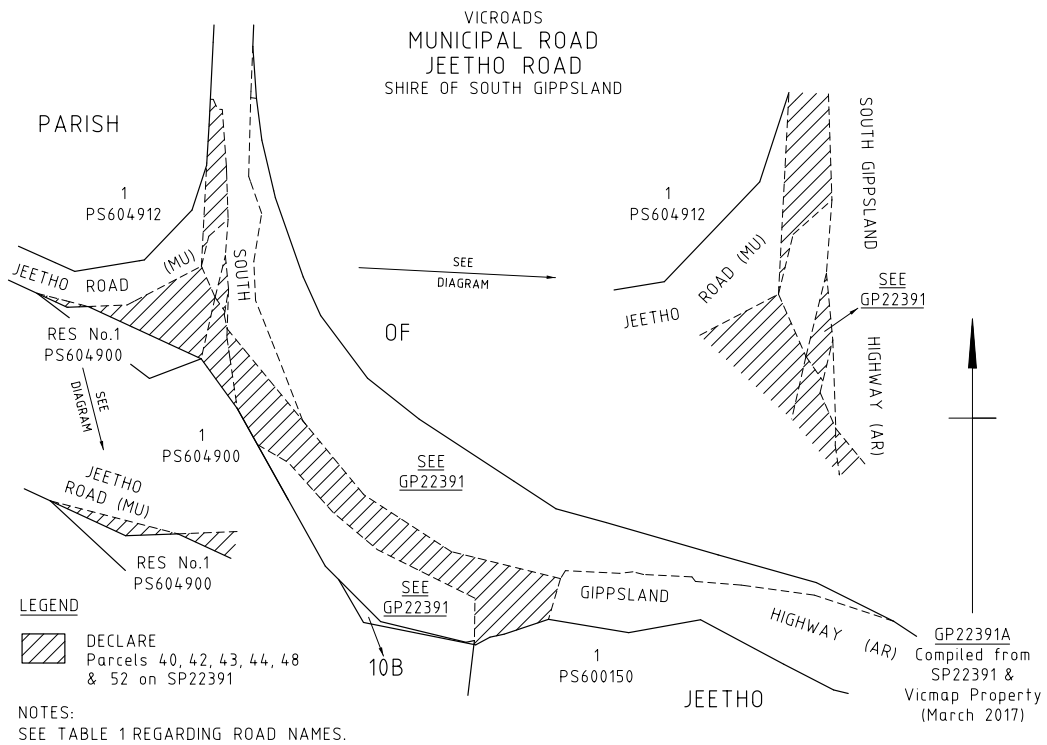



VICROADS  
MUNICIPAL ROAD  
SOUTHPARK CLOSE  
CITY OF GREATER DANDENONG

LEGEND

 DECLARE  
Parcel 33 on SP21927B

NOTE:  
SEE TABLE 1 REGARDING ROAD NAMES.

  
GP21927A  
Compiled from  
SP21927B

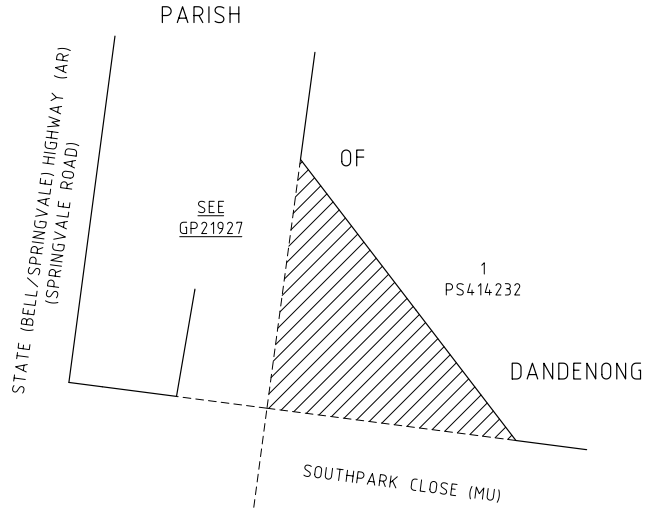

VICROADS  
MUNICIPAL ROAD  
PERRY ROAD  
CITY OF GREATER DANDENONG

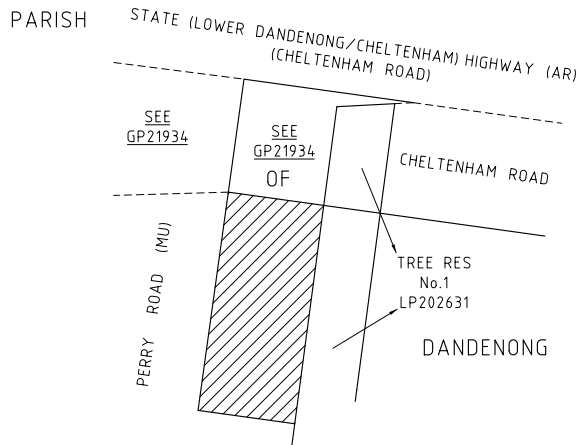

  
GP21934A  
Compiled from  
SP21934A

LEGEND

 DECLARE  
Parcel 106 on SP21934A

NOTE:  
SEE TABLE 1 REGARDING ROAD NAMES.

Dated 25 July 2017

JOHN MERRIT  
Chief Executive  
VicRoads

## **bluestar** \* **PRINT**

The *Victoria Government Gazette* is published by Blue Star Print with the authority of the Government Printer for the State of Victoria

© State of Victoria 2017

This publication is copyright. No part may be reproduced by any process except in accordance with the provisions of the Copyright Act.

Address all enquiries to the Government Printer for the State of Victoria

Level 2, 1 Macarthur Street  
Melbourne 3002  
Victoria Australia

### How To Order



**Retail &  
Mail Sales**

**Victoria Government Gazette**

Ground Floor, Building 8,  
658 Church Street,  
Richmond 3121  
DX 106 Melbourne



**Telephone**

(03) 8523 4601



**Fax**

(03) 9600 0478

**email**

[gazette@bluestargroup.com.au](mailto:gazette@bluestargroup.com.au)

**Price Code A**