



Victoria Government Gazette

No. S 580 Tuesday 31 December 2019
By Authority of Victorian Government Printer

Road Management Act 2004

ROAD DECLARATIONS AND DISCONTINUANCE

ROAD DECLARATIONS

VicRoads, pursuant to sections 11 and 14 of the **Road Management Act 2004**, upon publication of this notice declares, revokes and renames the roads described in Schedule A and on the plans attached.

ROAD DISCONTINUANCE

VicRoads, pursuant to section 12 of the **Road Management Act 2004**, upon publication of this notice discontinues the part of the road described in Schedule B and on the plan attached.

The effects of these Road Declarations and Road Discontinuance on road names are described in Table 1.

SCHEDULE A

ARTERIAL ROAD

- a) That part of Traralgon West Road identified by hatching on the plan numbered GP23397 is declared as described in the legend in the said plan.
- b) That part of Korumburra–Wonthaggi Road identified by hatching on the plan numbered GP23460 is declared as described in the legend in the said plan.
- c) Those parts of Pound Road identified by hatching on the plan numbered GP23234 are declared or renamed as described in the legend in the said plan.
- d) That part of Shrives Road identified by hatching on the plan numbered GP23234 is declared as described in the legend in the said plan.
- e) Those parts of Midland Highway identified by hatching on the plans numbered GP23695 and GP23696 are declared as described in the legend in the said plans.
- f) Those parts of Western Port Highway identified by hatching on the plan numbered GP23550 are declared as described in the legend in the said plan.

MUNICIPAL ROAD

- g) Those parts of Robinsons Road identified by hatching on the plan numbered GP23551 are declared as described in the legend in the said plan.
- h) Those parts of Bird Road, Glen Alvie Road and West Creek Road identified by hatching on the plan numbered GP23459 are revoked or declared as described in the legend in the said plan.

SCHEDULE B

ROAD

- a) That part of Bird Road identified by hatching on the plan numbered GP23459 is discontinued as described in the legend in the said plan.

SPECIAL

TABLE 1**EFFECTS ON ROAD NAMES**

1. Names in Column 2 are existing Vicmap Address names, which are unaffected by this notice.
2. **Names in Column 1 are for VicRoads administrative purposes only and are independent of names in Column 2.**
3. Names in Column 2 may not apply to the whole length of the road and are for general information only.

ARTERIAL ROAD

GP Number	VicRoads Administrative Road Name Column 1	Vicmap Address Road Name (for property addressing purposes) Column 2
GP23397	Traralgon West Road	Not detailed – Road boundary adjustments only
GP23460	Korumburra–Wonthaggi Road	Not detailed – Road boundary adjustments only
GP23234	Pound Road Shrives Road Note: Former administrative name (Shrives Road) ceases where renamed	Not detailed – Road boundary adjustments only
GP23695 GP23696	Midland Highway	Not detailed – Road boundary adjustments only
GP23550	Western Port Highway	Not detailed – Road boundary adjustments only

MUNICIPAL ROAD

GP Number	VicRoads Administrative Road Name Column 1	Vicmap Address Road Name (for property addressing purposes) Column 2
GP23551	Not applicable	Not detailed – Road boundary adjustments only
GP23459	Not applicable	Not detailed – Road boundary adjustments only

VICROADS
ARTERIAL ROAD
TRARALGON WEST ROAD
CITY OF LATROBE

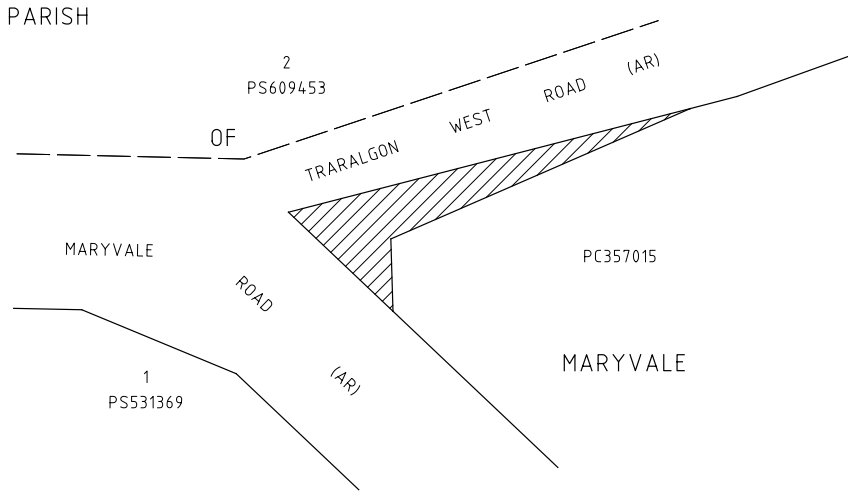

LEGEND

 DECLARE
Parcel 1 on SP23397

NOTE:
SEE TABLE 1 REGARDING ROAD NAMES.

GP23397
Compiled from
SP23397 &
Vicmap Property
(Feb 2019)

VICROADS
ARTERIAL ROAD
KORUMBURRA-WONTHAGGI ROAD
BASS COAST SHIRE

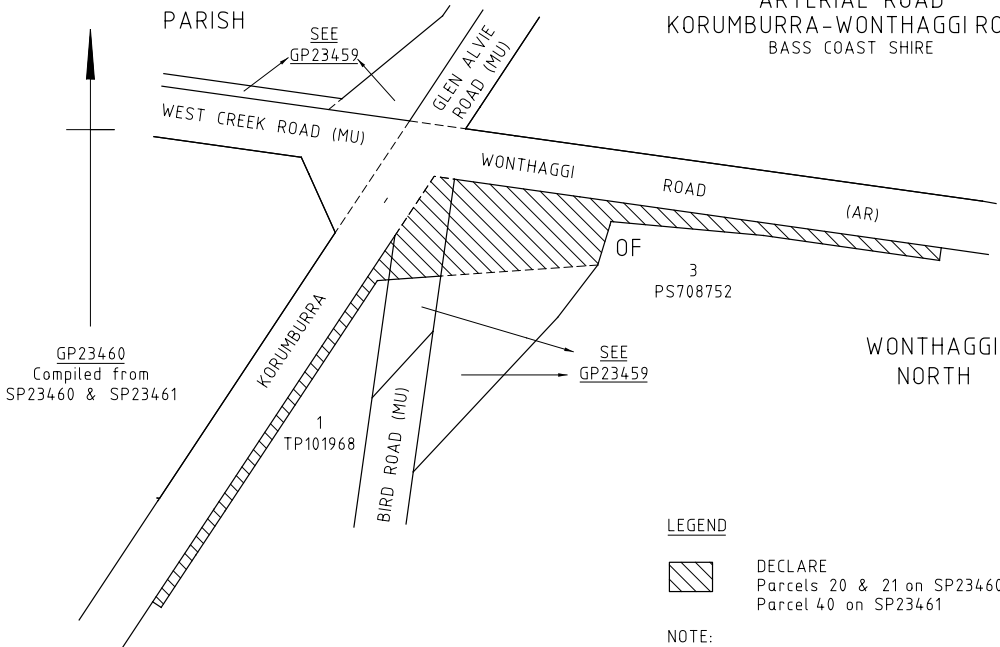

GP23460
Compiled from
SP23460 & SP23461

LEGEND

 DECLARE
Parcels 20 & 21 on SP23460
Parcel 40 on SP23461

NOTE:
SEE TABLE 1 REGARDING ROAD NAMES.

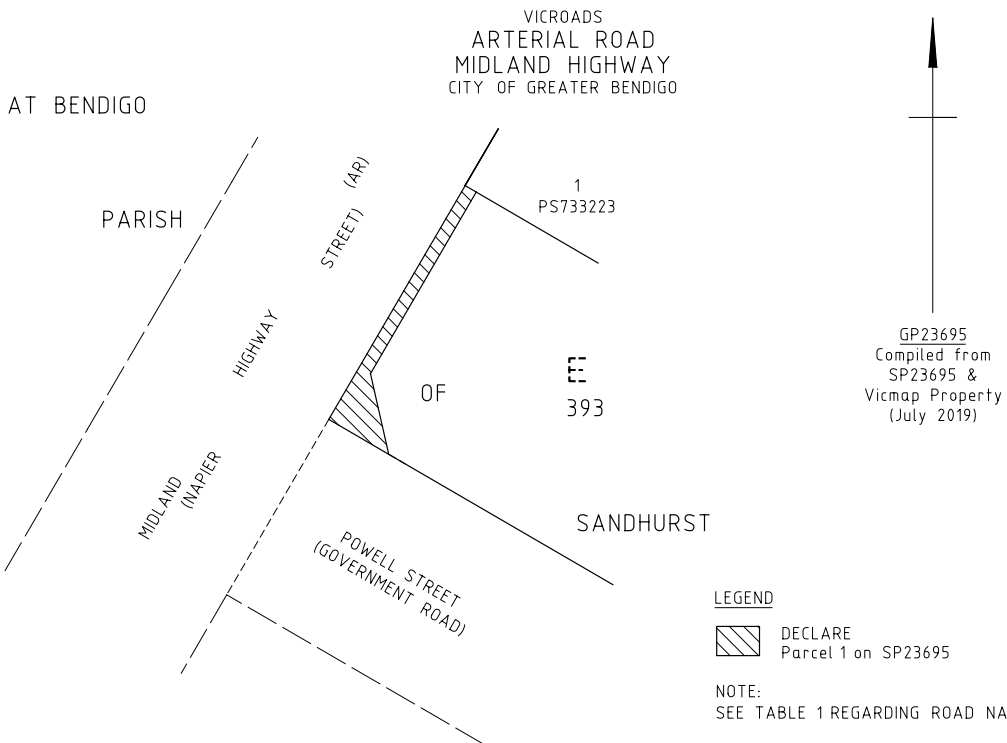
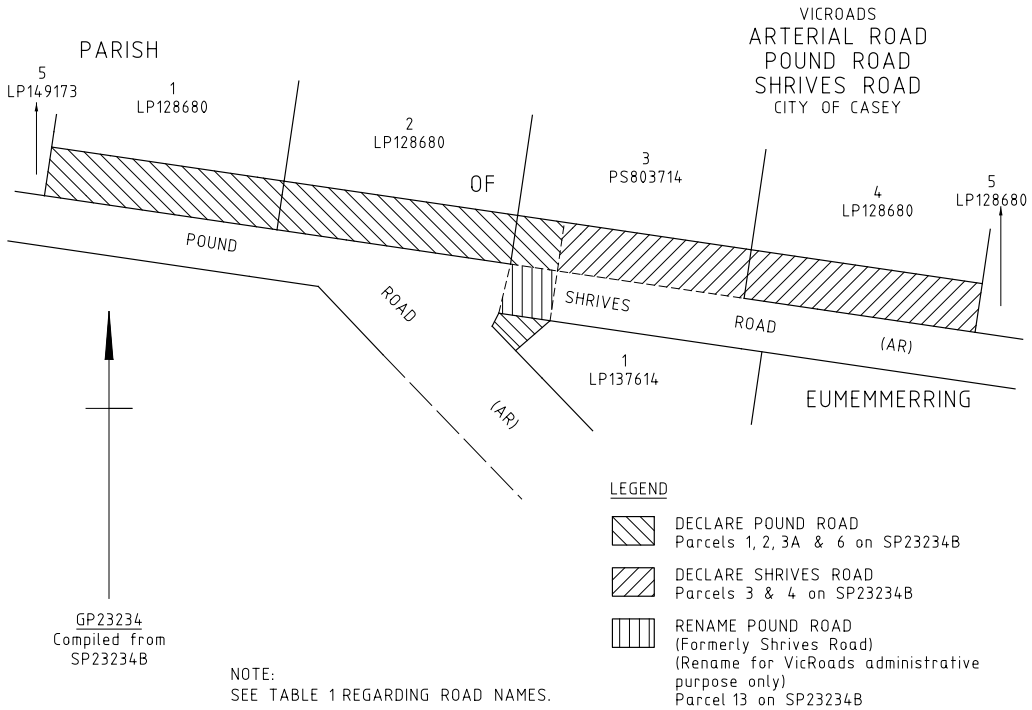

AT BENDIGO

VICROADS
ARTERIAL ROAD
MIDLAND HIGHWAY
CITY OF GREATER BENDIGO

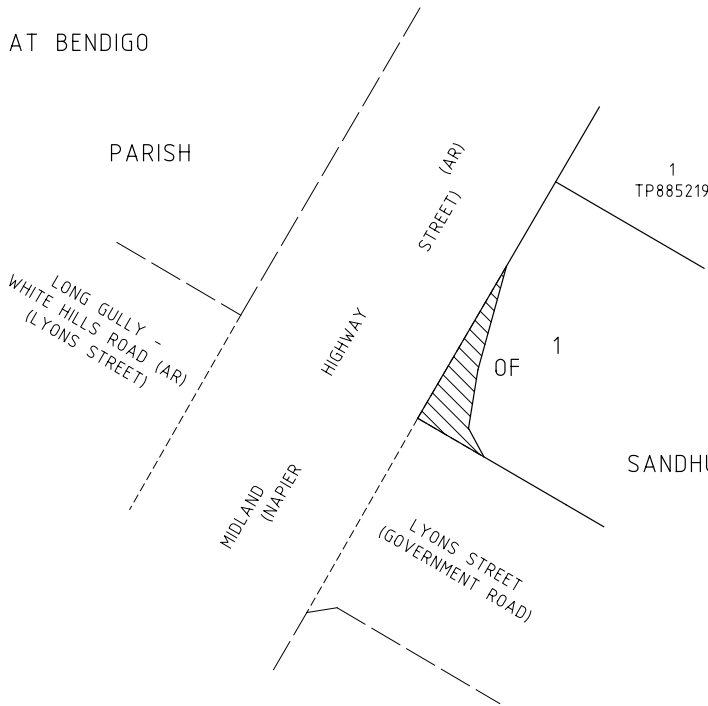

GP23696
Compiled from
SP23696 &
Vicmap Property
(July 2019)

LEGEND

 DECLARE
Parcel 1 on SP23696

NOTE:
SEE TABLE 1 REGARDING ROAD NAMES.

VICROADS
ARTERIAL ROAD
WESTERN PORT HIGHWAY
CITY OF CASEY
CITY OF FRANKSTON

LEGEND

 DECLARE
Parcels 1, 2, 3 & 4 on SP23550A
Parcels 11, 12, 16 & 17 on SP23551A

NOTE:
SEE TABLE 1 REGARDING ROAD NAMES.

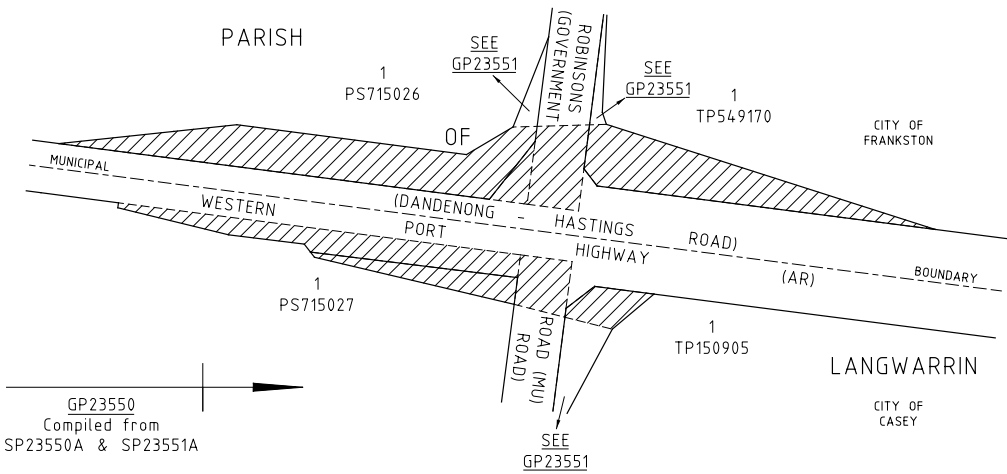

GP23550
Compiled from
SP23550A & SP23551A

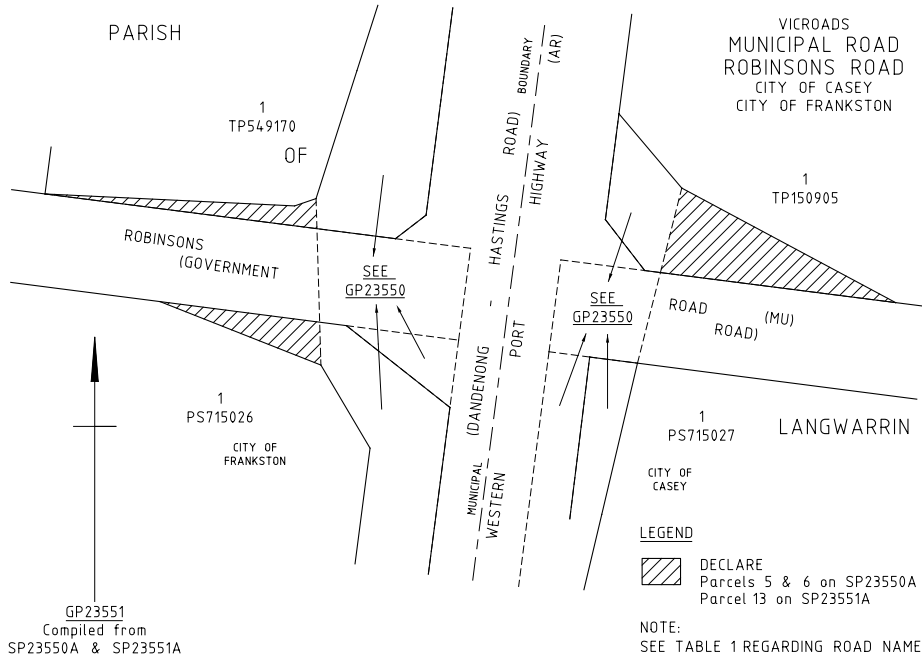

- LEGEND
- DECLARE BIRD ROAD
Parcel 41 on SP23461
 - DECLARE GLEN ALVIE ROAD
Parcel 1 on SP23459A
 - DECLARE WEST CREEK ROAD
Parcel 2 on SP23459A
 - REVOKE & DISCONTINUE BIRD ROAD
Parcel 22 on SP23460

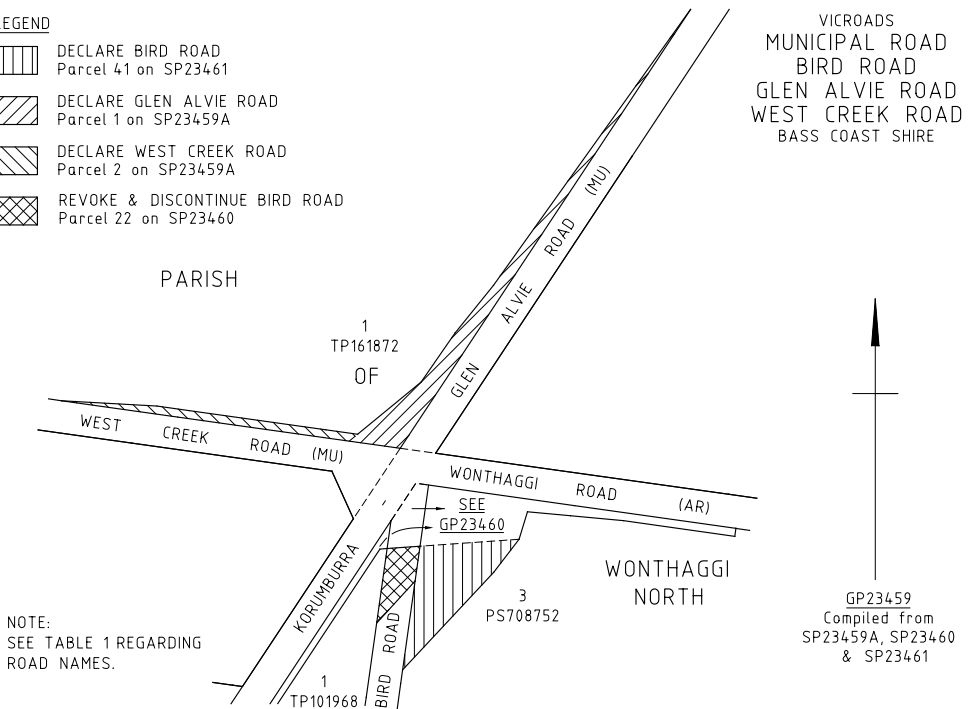

Dated 22 December 2019

ANDREW WALL
Acting Chief Engineering and
Road Management Officer
VicRoads

This page was left blank intentionally

ive

The *Victoria Government Gazette* is published by IVE Group Limited with the authority of the Government Printer for the State of Victoria

© State of Victoria 2019

This publication is copyright. No part may be reproduced by any process except in accordance with the provisions of the Copyright Act.

Address all enquiries to the Government Printer for the State of Victoria
Level 2, 1 Macarthur Street
Melbourne 3002
Victoria Australia

How To Order



**Retail &
Mail Sales**

Victoria Government Gazette

Ground Floor, Building 8,
658 Church Street,
Richmond 3121

DX 106 Melbourne



Telephone

(03) 8523 4601



Fax

(03) 9600 0478

email

gazette@ivegroup.com.au

Price Code A