



Victoria Government Gazette

No. S 89 Wednesday 13 March 2019
By Authority of Victorian Government Printer

Road Management Act 2004

ROAD DECLARATIONS AND DISCONTINUANCES

ROAD DECLARATIONS

VicRoads, pursuant to sections 11 and 14 of the **Road Management Act 2004**, upon publication of this notice revokes and declares the roads described in Schedule A and on the plans attached.

ROAD DISCONTINUANCES

VicRoads, pursuant to section 12 of the **Road Management Act 2004**, upon publication of this notice discontinues the parts of the roads described in Schedule B and on the plans attached.

The effects of these Road Declarations and Road Discontinuances on road names are described in Table 1.

SCHEDULE A

ARTERIAL ROAD

- a) Those parts of South Road identified by hatching on the plans numbered GP23542 and GP23542A are declared as described in the legend in the said plans.
- b) Those parts of Warrigal Highway identified by hatching on the plans numbered GP23542 and GP21565 are declared and renamed as described in the legend in the said plans.
- c) Those parts of Dingley Bypass identified by hatching on the plans numbered GP21565, GP21566, GP22689, GP22692, GP22695, GP22701, GP22702, GP22706, GP22709 and GP22712 are declared and renamed as described in the legend in the said plans.
- d) Those parts of Huntingdale Road identified by hatching on the plan numbered GP22689 are declared as described in the legend in the said plan.
- e) Those parts of Heatherton Road identified by hatching on the plans numbered GP22695, GP22701 and GP22576 are declared as described in the legend in the said plans.
- f) Those parts of Doncaster–Mordialloc Road identified by hatching on the plan numbered GP22702 are declared as described in the legend in the said plan.

MUNICIPAL ROAD

- g) Those parts of Kingsway identified by hatching on the plan numbered GP23541 are declared as described in the legend in the said plan.
- h) That part of Road identified by hatching on the plan numbered GP21567B is declared as described in the legend in the said plan.
- i) Those parts of Bourke Road and Cunningham Place identified by hatching on the plan numbered GP22690 are declared as described in the legend in the said plan.
- j) Those parts of Elder Street South identified by hatching on the plan numbered GP22693 are declared as described in the legend in the said plan.
- k) Those parts of Grange Road and Junction Road identified by hatching on the plan numbered GP22708 are declared as described in the legend in the said plan.
- l) Those parts of Tootal Road identified by hatching on the plan numbered GP22711A are declared as described in the legend in the said plan.
- m) Those parts of Glenarm Road and Glentilt Road identified by hatching on the plan numbered GP23531B are revoked as described in the legend in the said plan.
- n) That part of King Street identified by hatching on the plan numbered GP23535 is revoked as described in the legend in the said plan.
- o) That part of Katandra Road identified by hatching on the plan numbered GP23683B is revoked as described in the legend in the said plan.

SPECIAL

SCHEDULE B**ROAD**

- a) Those parts of Glenarm Road and Glentilt Road identified by hatching on the plan numbered GP23531B are discontinued as described in the legend in the said plan.
- b) That part of King Street identified by hatching on the plan numbered GP23535 is discontinued as described in the legend in the said plan.
- c) That part of Katandra Road identified by hatching on the plan numbered GP23683B is discontinued as described in the legend in the said plan.

TABLE 1**EFFECTS ON ROAD NAMES**

1. Names in Column 2 are existing Vicmap Address names, which are unaffected by this notice.
2. **Names in Column 1 are for VicRoads administrative purposes only and are independent of names in Column 2.**
3. Names in Column 2 may not apply to the whole length of the road and are for general information only.

ARTERIAL ROAD

GP Number	VicRoads Administrative Road Name Column 1	Vicmap Address Road Name (for property addressing purposes) Column 2
GP23542 GP23542A	South Road	South Road
GP23542 GP21565	Warrigal Highway Note: Former administrative name (South Road) ceases where renamed	Warrigal Road
GP21565 GP21566 GP22689 GP22692 GP22695 GP22701 GP22702 GP22706 GP22709 GP22712	Dingley Bypass Note: Former administrative name (Old Dandenong Road) ceases where renamed	Not Applicable
GP22689	Huntingdale Road	Clarinda Road
GP22695 GP22701 GP22576	Heatherton Road	Kingston Road Heatherton Road
GP22702	Doncaster–Mordialloc Road	Boundary Road

MUNICIPAL ROAD

GP Number	VicRoads Administrative Road Name Column 1	Vicmap Address Road Name (for property addressing purposes) Column 2
GP23541 GP22690 GP22693 GP22708 GP22711A	Not applicable	Not detailed – Road boundary adjustments only
GP21567B	Not applicable	Local road name pending.
GP23531B	Not applicable	Not detailed – Road boundary adjustments only
GP23535	Not applicable	Not detailed – Road boundary adjustments only
GP23683B	Not applicable	Not detailed – Road boundary adjustments only

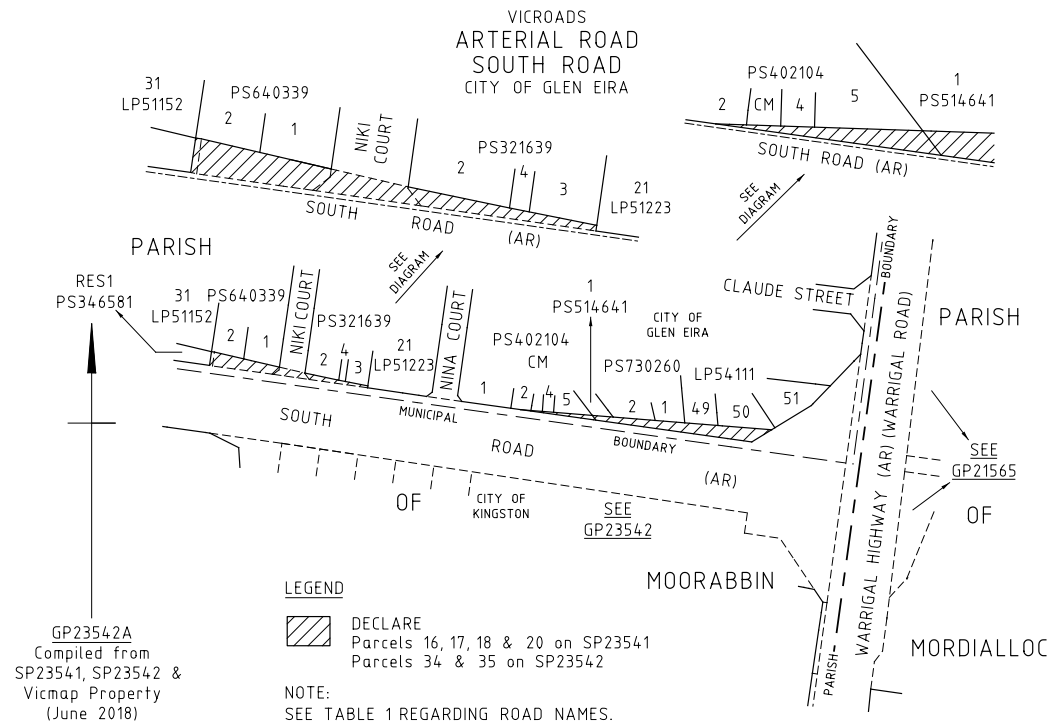
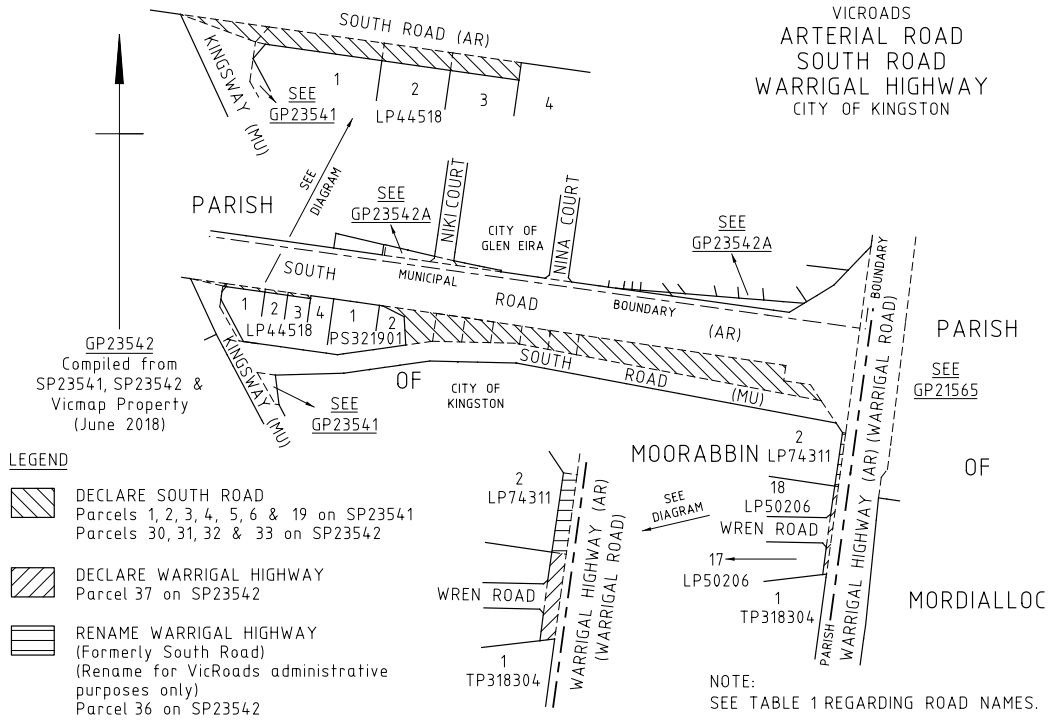

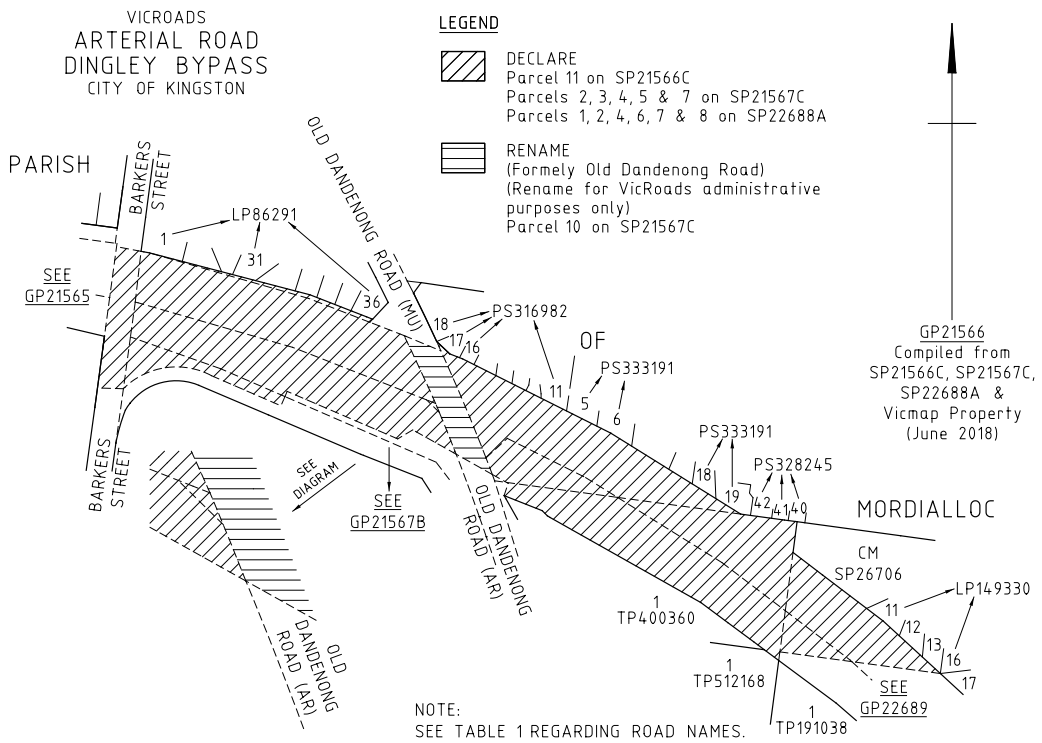
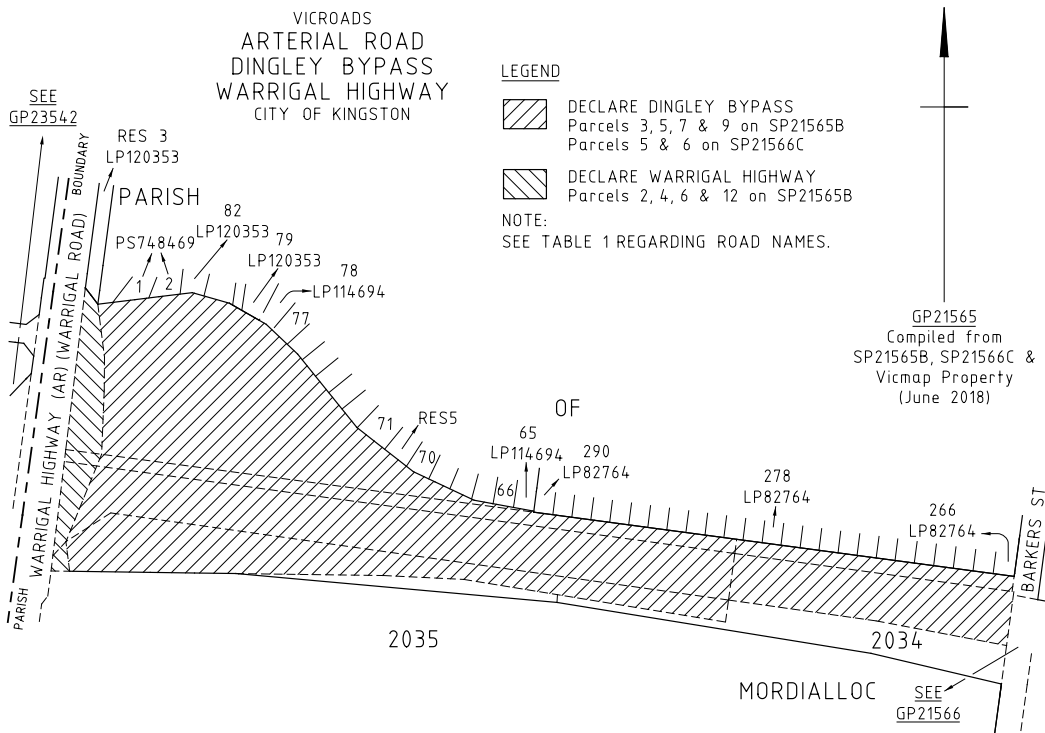

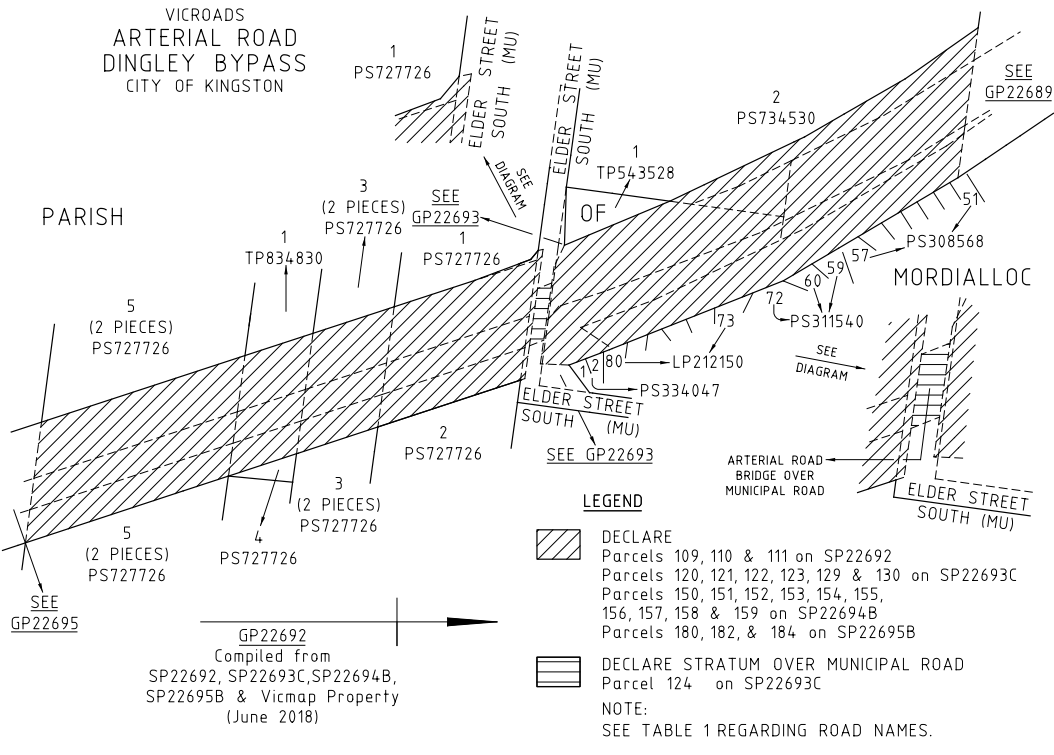
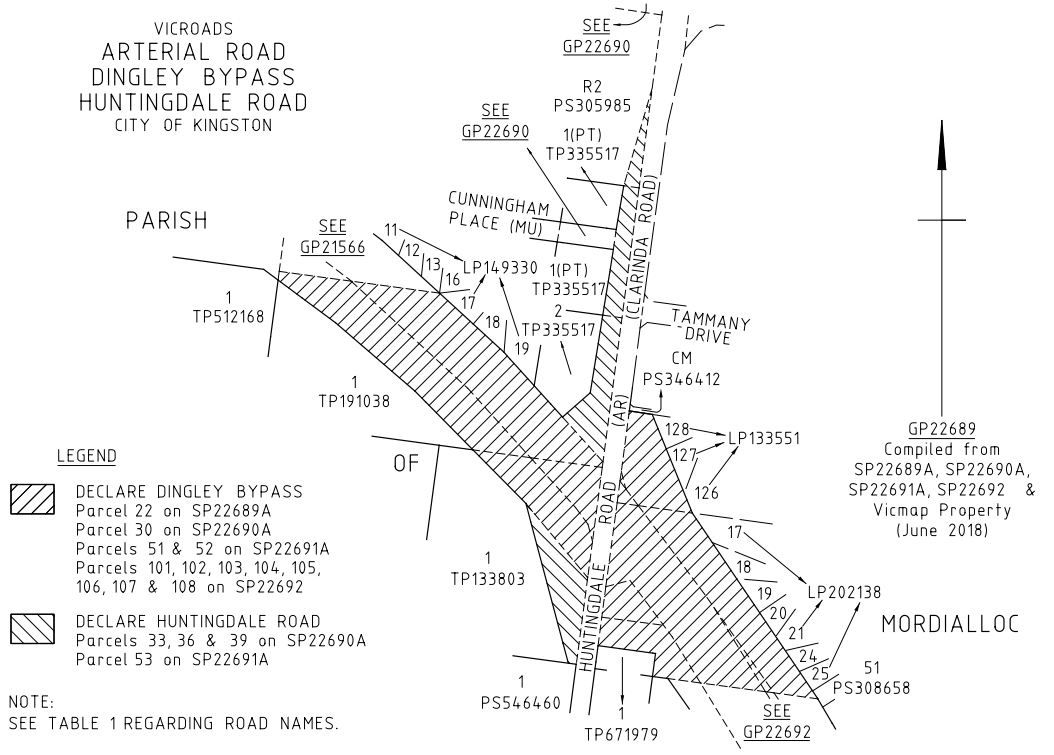

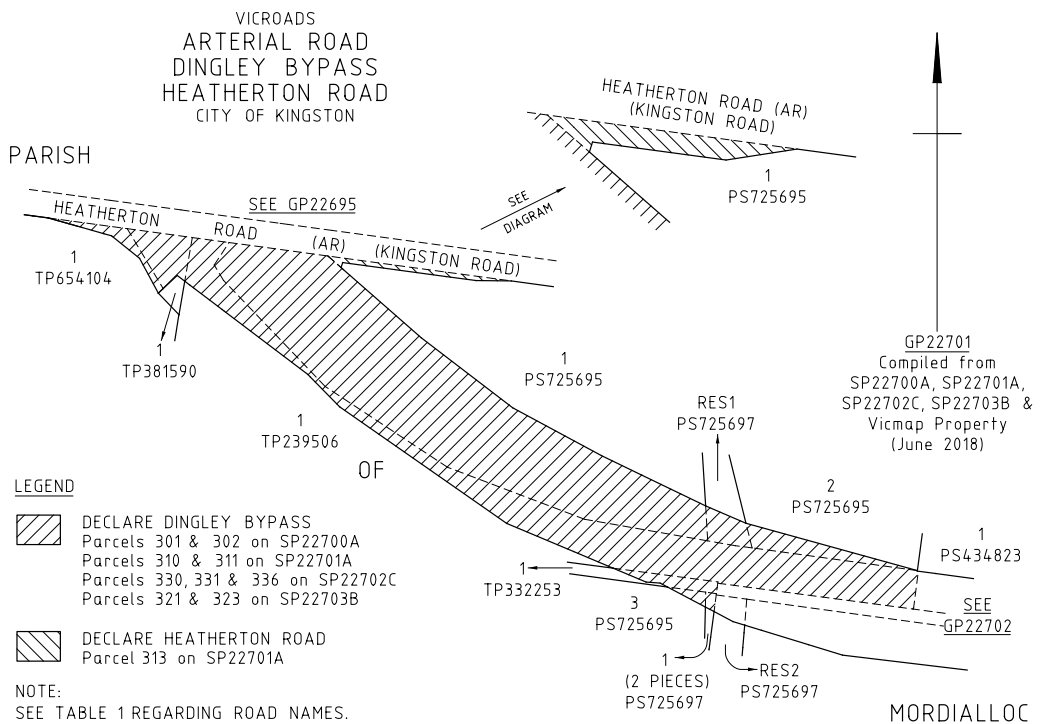
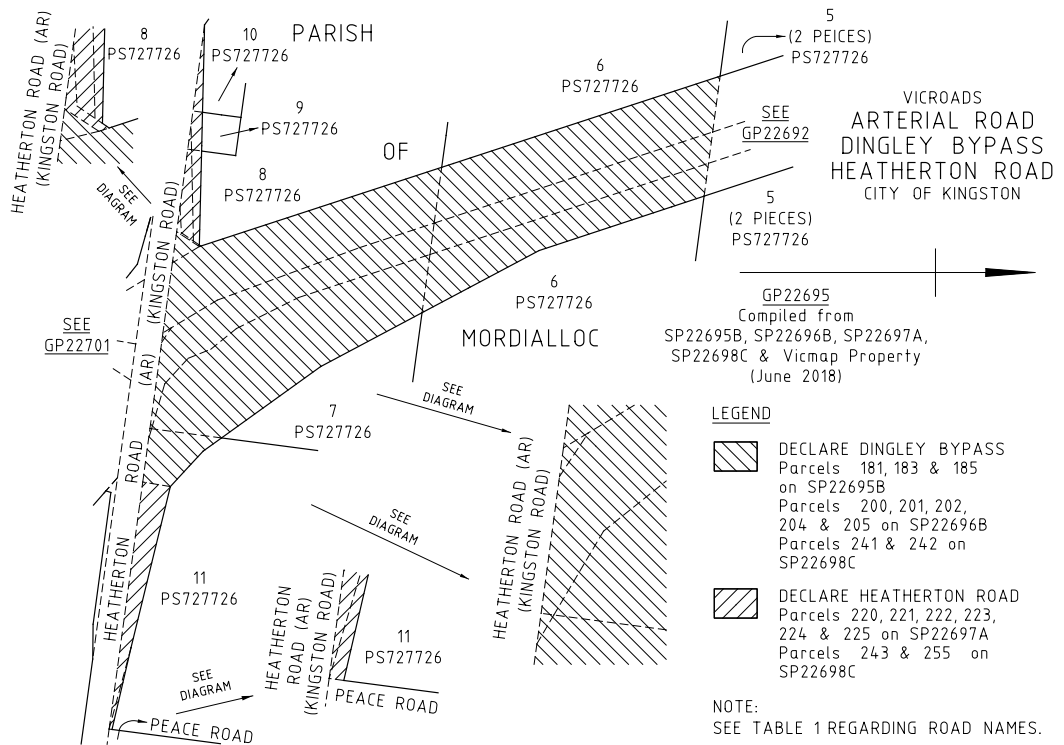

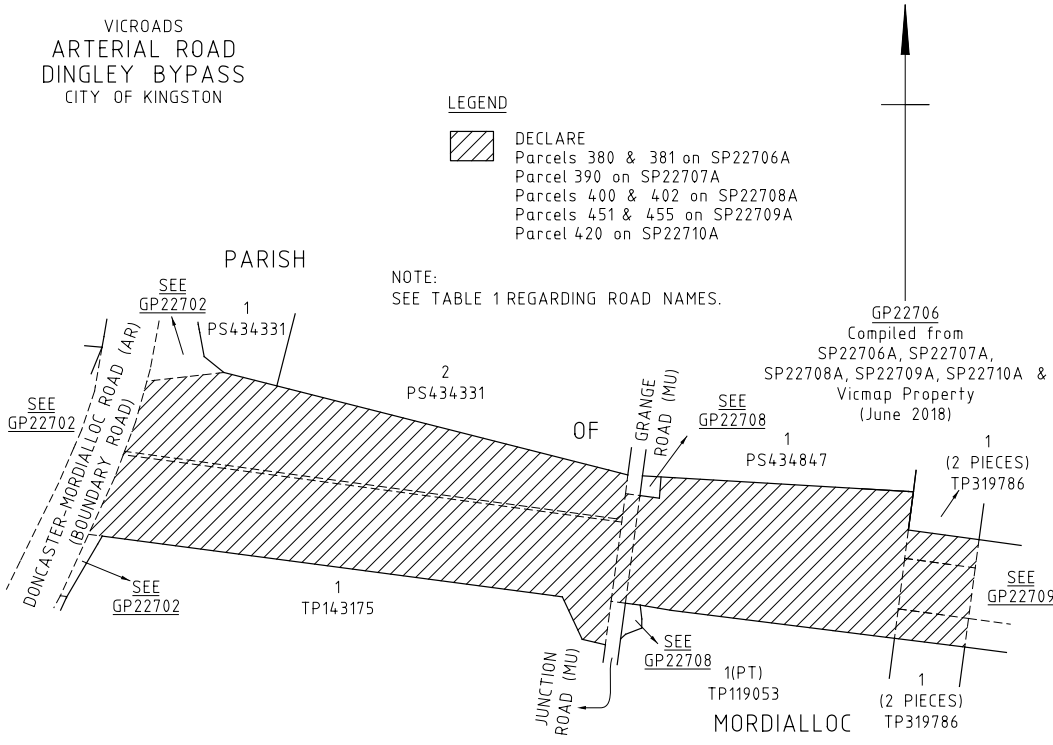
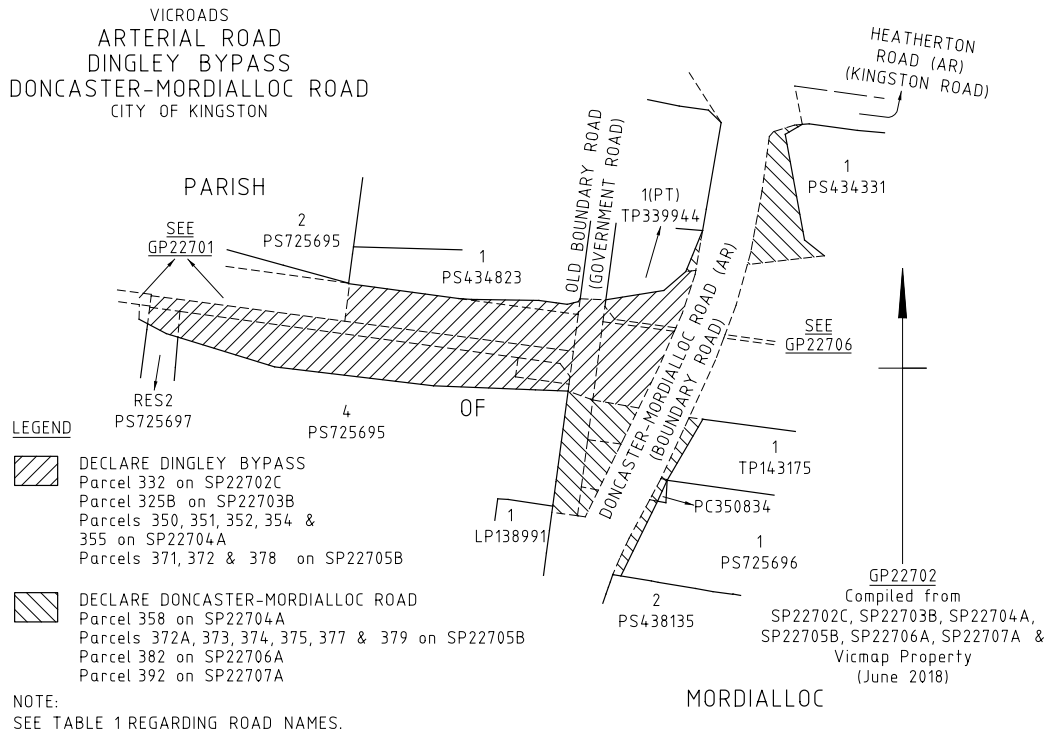

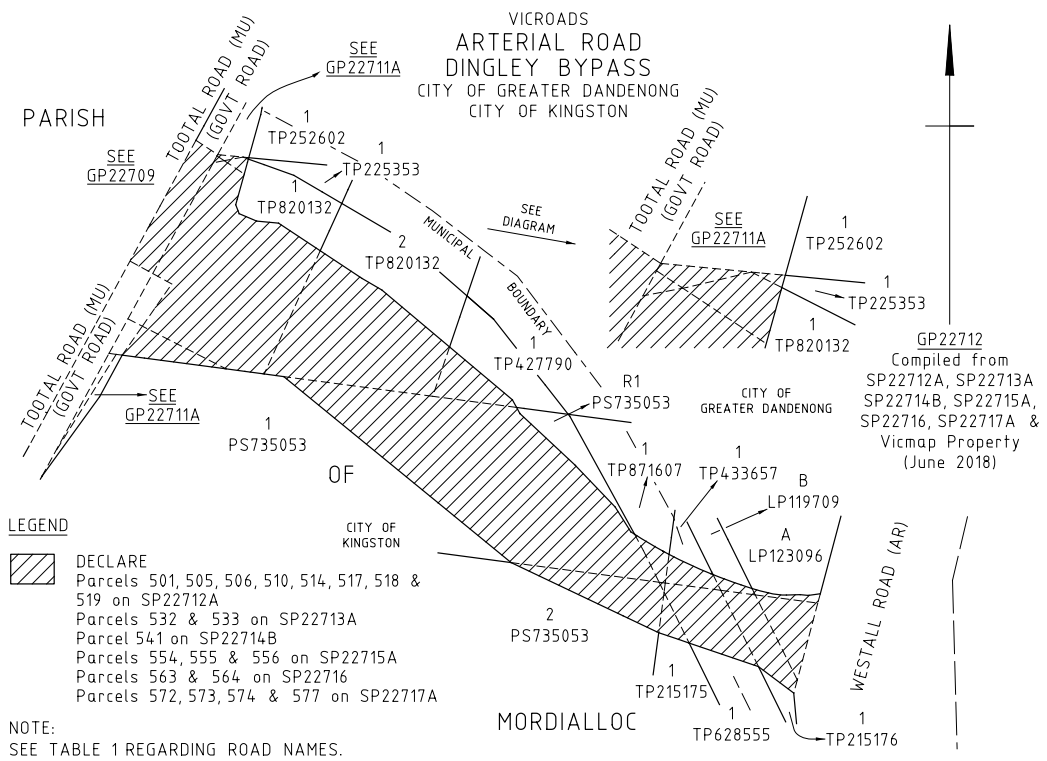
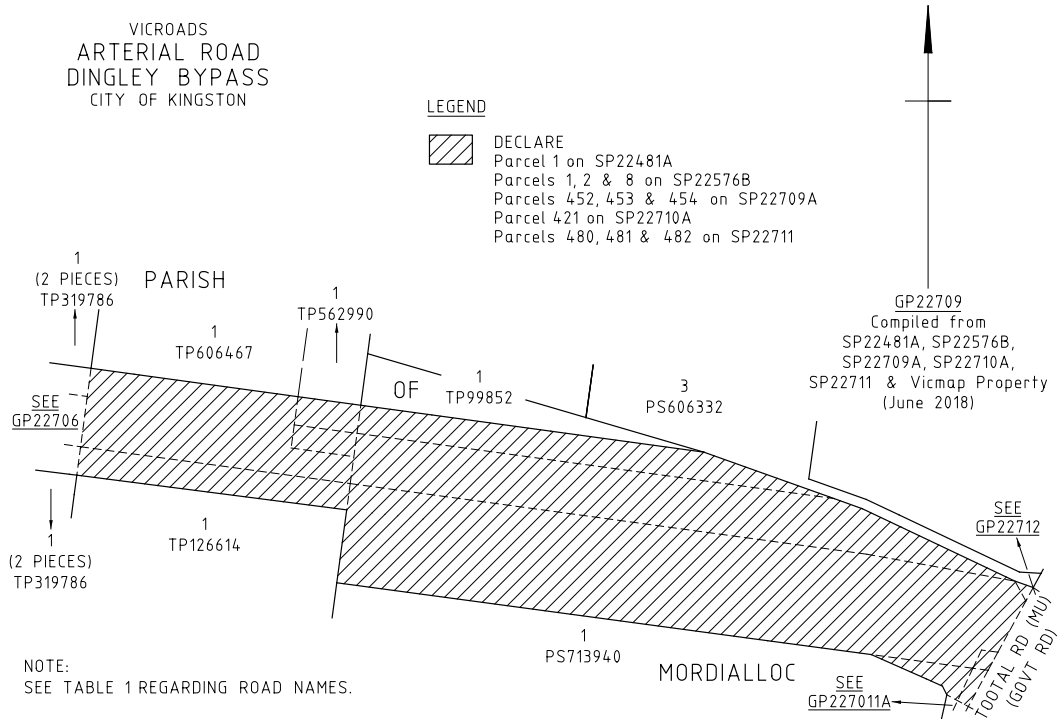



PARISH

VICROADS
ARTERIAL ROAD
HEATHERTON ROAD
CITY OF KINGSTON

LEGEND

 DECLARE
Parcel 9 on SP22576B
R1 on PS632444

NOTE:
SEE TABLE 1 REGARDING
ROAD NAMES.

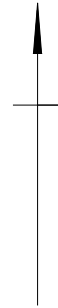

GP22576
Compiled from
SP22576B,
PS632444 & Vicmap
Property (July 2018)

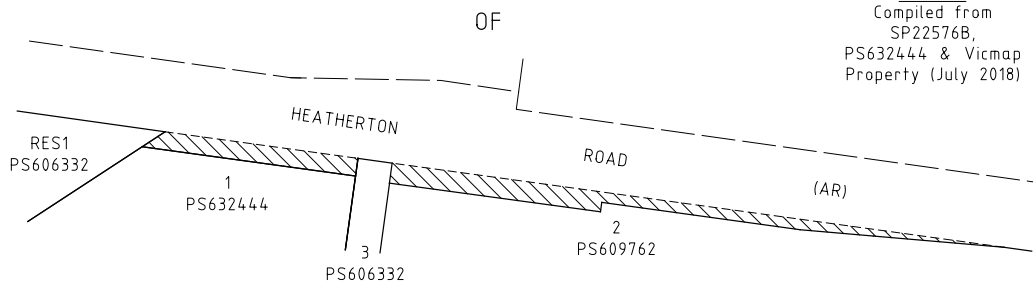

MORDIALLOC

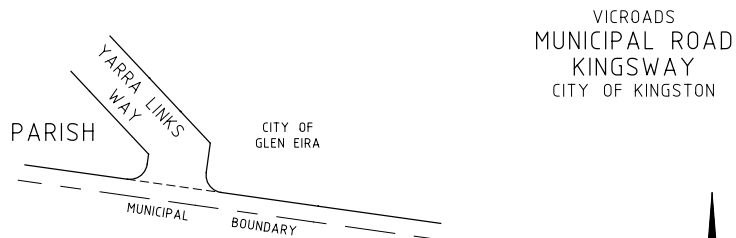

VICROADS
MUNICIPAL ROAD
KINGSWAY
CITY OF KINGSTON

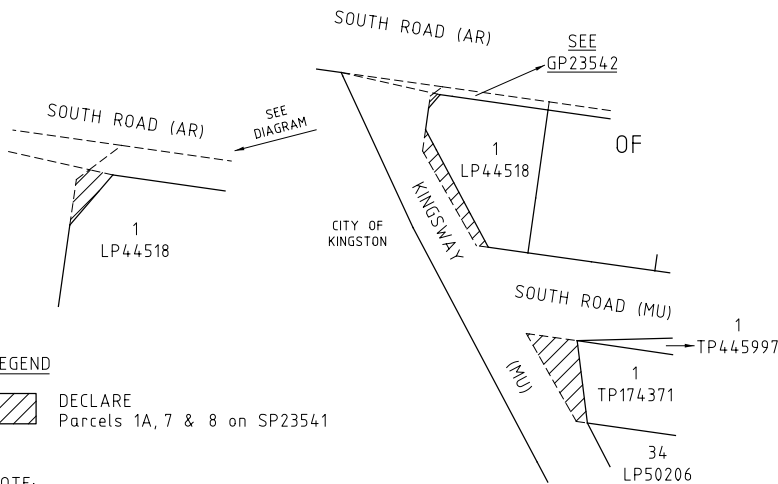

LEGEND

 DECLARE
Parcels 1A, 7 & 8 on SP23541

NOTE:
SEE TABLE 1 REGARDING ROAD NAMES.



GP23541
Compiled from
SP23541 &
Vicmap Property
(June 2018)

MOORABBIN

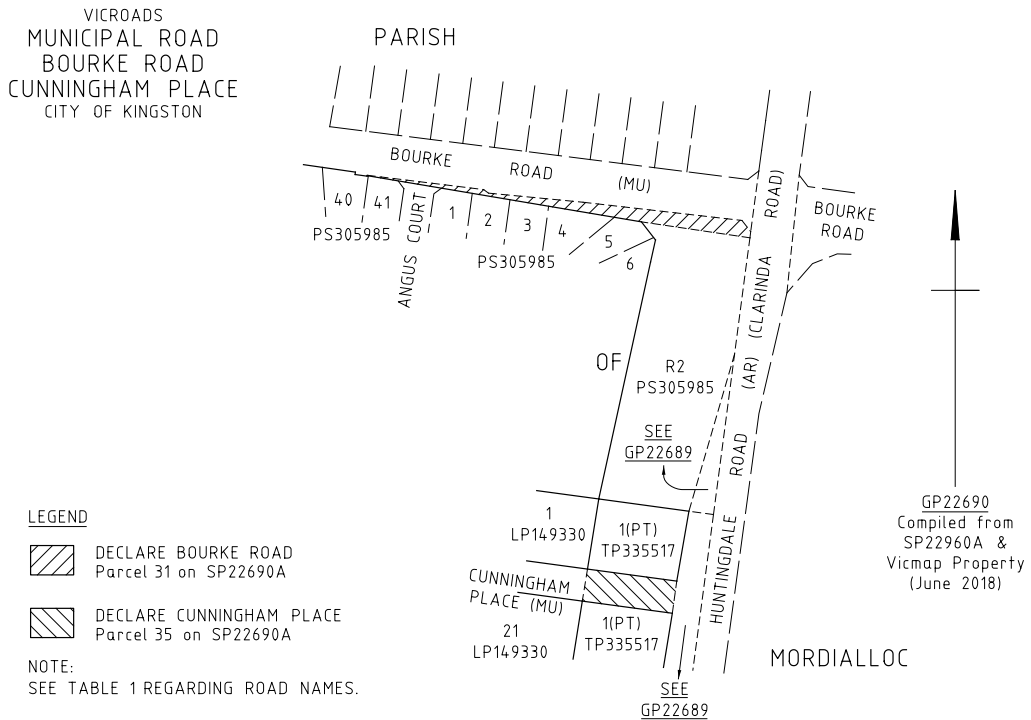
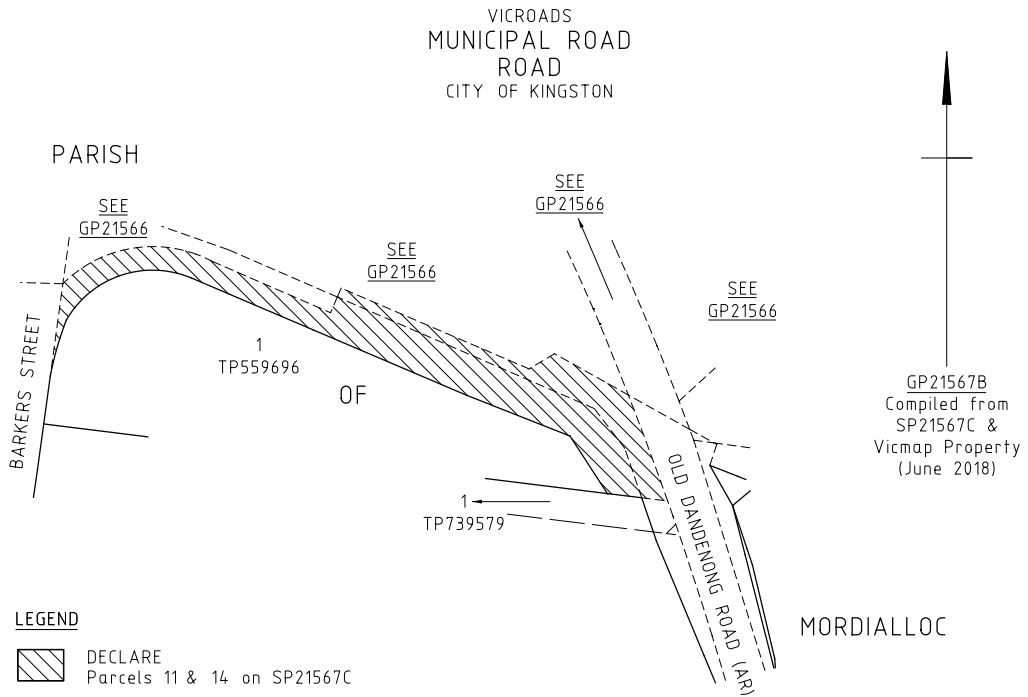

VICROADS
MUNICIPAL ROAD
ELDER STREET SOUTH
CITY OF KINGSTON

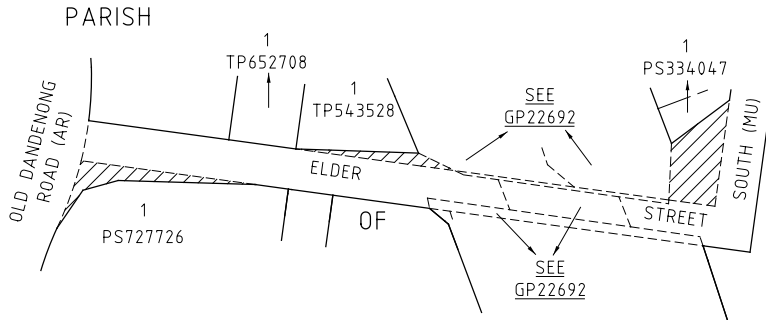

LEGEND

-  DECLARE
Parcels 128 & 131 on SP22693C
Parcel 168 on SP22694B

NOTE:
SEE TABLE 1 REGARDING ROAD NAMES.



MORDIALLOC

GP22693
Compiled from
SP22693C, SP22694B &
Vicmap Property
(June 2018)

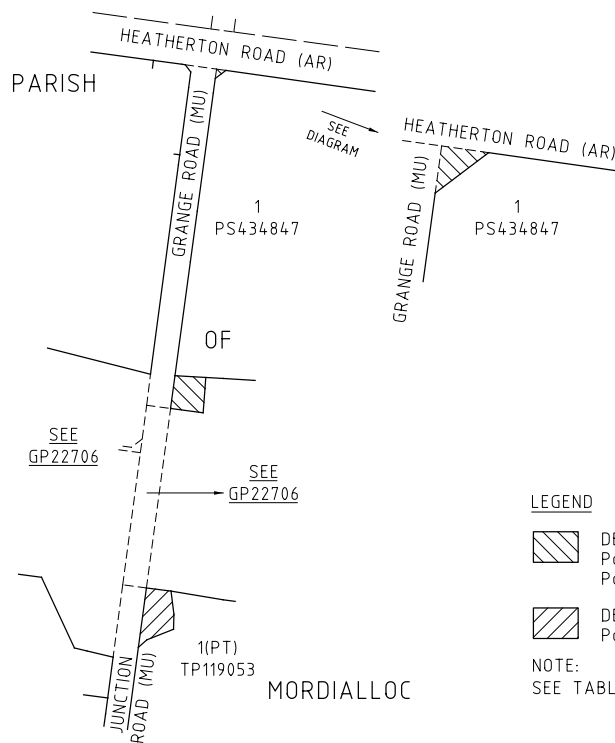
VICROADS
MUNICIPAL ROAD
GRANGE ROAD
JUNCTION ROAD
CITY OF KINGSTON



LEGEND

-  DECLARE GRANGE ROAD
Parcel 1 on SP19802
Parcel 403 on SP22708A
-  DECLARE JUNCTION ROAD
Parcel 404 on SP22708A

NOTE:
SEE TABLE 1 REGARDING ROAD NAMES.

MORDIALLOC

GP22708
Compiled from
SP19802, SP22708A, &
Vicmap Property
(June 2018)

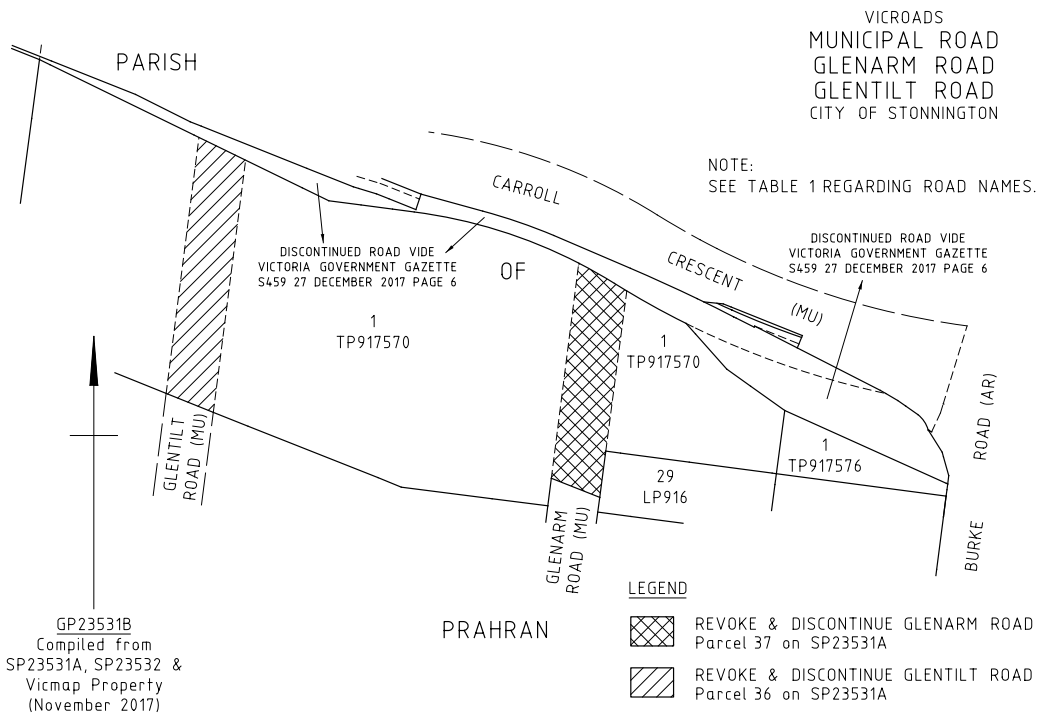
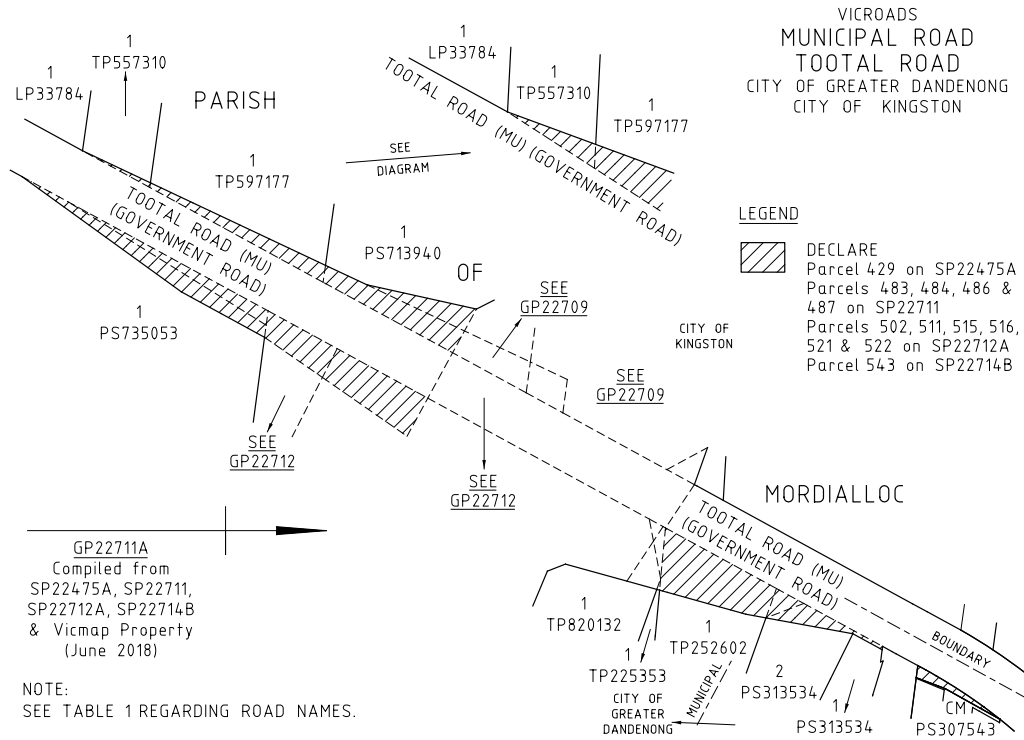

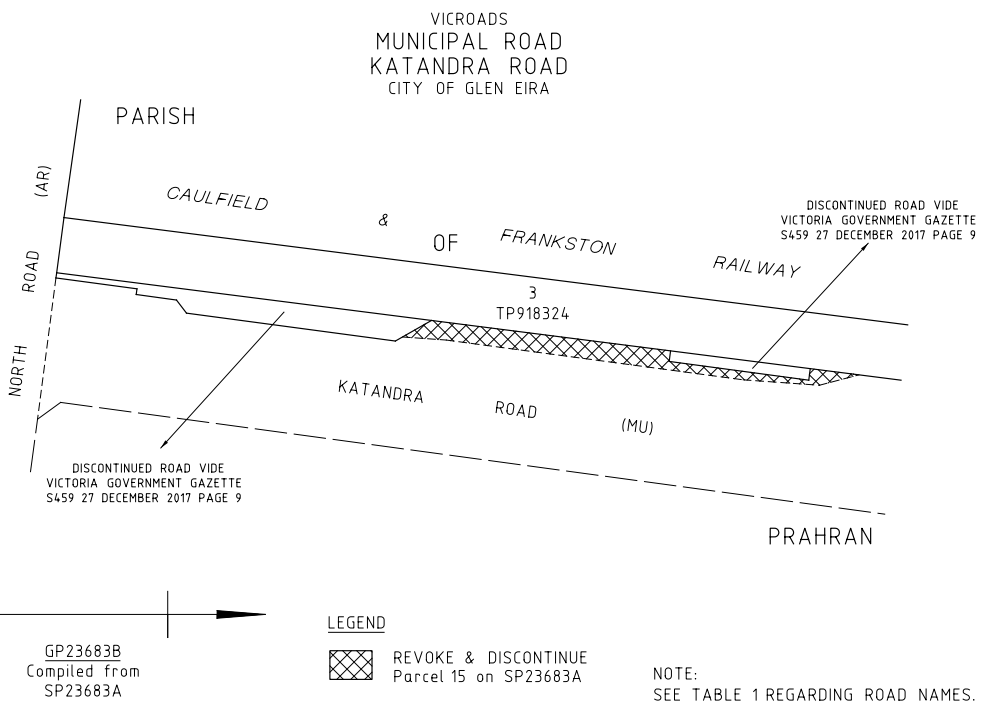
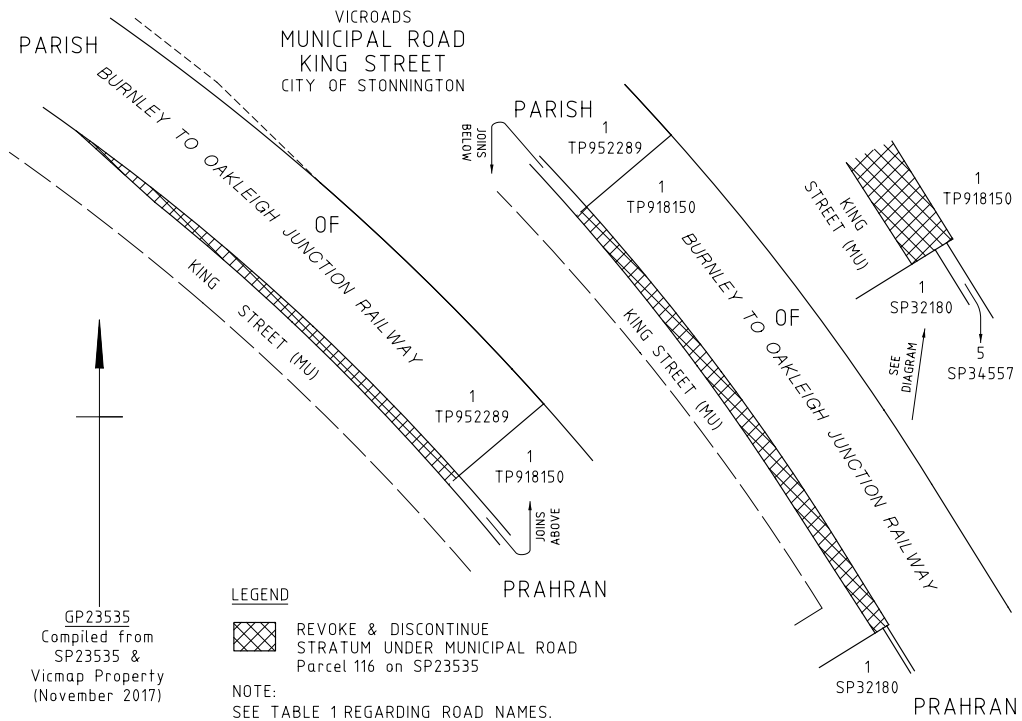

Dated 7 March 2019

ROBYN SEYMOUR
Acting Chief Executive
VicRoads

Road Management Act 2004

CORRIGENDUM

This notice corrects an error contained in a notice published in Victoria Government Gazette (S453) dated 21 December 2017.

All references to road name 'Hume Link Road' in that notice, including the gazette plan 'GP23595A' published in that notice, should be read as 'Hume Link Highway'.

Note: This notice only affects the VicRoads administrative road name and does not affect any other name for this road, including naming for property addressing purposes.

Dated 7 March 2019

ROBYN SEYMOUR
Acting Chief Executive
VicRoads

Road Management Act 2004

CORRIGENDUM

This notice corrects an error contained in a notice published in Victoria Government Gazette (S58) dated 20 February 2018.

The legend of gazette plan GP22749, published in that notice reads,

DECLARE

Parcels 5, 10 & 11 on SP22748C,
Parcels 20, 21 & 34 on SP22749C, and
Parcel 40 on SP22750C.

This should be read as,

DECLARE

Parcels 5 & 10 on SP22748C,
Parcel 21 on SP22749C, and
Parcel 40 on SP22750C.

Note: Parcel 11 on SP22748C and parcels 20 & 34 on SP22749C have not been declared as part of that gazette notice.

Dated 7 March 2019

ROBYN SEYMOUR
Acting Chief Executive
VicRoads

bluestar * **PRINT**

The *Victoria Government Gazette* is published by Blue Star Print with the authority of the Government Printer for the State of Victoria

© State of Victoria 2019

This publication is copyright. No part may be reproduced by any process except in accordance with the provisions of the Copyright Act.

Address all enquiries to the Government Printer for the State of Victoria

Level 2, 1 Macarthur Street
Melbourne 3002
Victoria Australia

How To Order



**Retail &
Mail Sales**

Victoria Government Gazette

Ground Floor, Building 8,
658 Church Street,
Richmond 3121

DX 106 Melbourne



Telephone

(03) 8523 4601



Fax

(03) 9600 0478

email

gazette@bluestargroup.com.au

Price Code A