



Victoria Government Gazette

By Authority of Victorian Government Printer

No. G 38 Thursday 19 September 2019

www.gazette.vic.gov.au

GENERAL

TABLE OF PROVISIONS

Private Advertisements		Sales by the Sheriff	
Dissolution of Partnership		Myles David Kummrow	1940
South Melbourne Market Nut Shop	1936	Viswanathan Murugesu	1940
Estates of Deceased Persons		Government and Outer Budget Sector	
Aitken Partners	1936	Agencies Notices	1941
Argent Law	1936	Orders in Council	1979
Australian Unity Trustees		Education and Training Reform;	
Legal Services	1936	Planning and Environment	
Ballards Solicitors Pty Ltd	1936	Obtainables	1986
Basile Pino & Co.	1937		
Daniel Lawyers & Associates	1937		
Davis Lawyers	1937		
Devenish	1937		
Equity Trustees Wealth			
Services Limited	1937		
Garden & Green Lawyers	1938		
Hicks Oakley Chessell Williams	1938		
Hutchinson Legal	1938		
Joliman Lawyers	1938		
MST Lawyers	1938		
Macpherson Kelley	1939		
Suzanne Lyttleton Lawyers	1939		
Verhoeven & Curtain Solicitors	1939		
Wills & Probate Victoria	1939		
Wisewould Mahony	1939		

Advertisers Please Note

As from 19 September 2019

The last Special Gazette was No. 376 dated 18 September 2019.

The last Periodical Gazette was No. 1 dated 29 May 2019.

How To Submit Copy

- See our webpage www.gazette.vic.gov.au
 - or contact our office on 8523 4601
between 8.30 am and 5.30 pm Monday to Friday
-

2019 AFL GRAND FINAL PUBLIC HOLIDAY

Grand Final Friday

The Friday before the Australian Football League (AFL) Grand Final was declared a public holiday and published in Special Gazette S229 dated 19 August 2015. The 2019 public holiday will fall on Friday 27 September 2019.

Please Note: this office will be closed on Friday 27 September 2019.

The Victoria Government Gazette (General) for GRAND FINAL FRIDAY week (G40/19) will be published on **Thursday 3 October 2019**.

Copy deadlines:

Private Advertisements **9.30 am on Monday 30 September 2019**

Government and Outer

Budget Sector Agencies Notices **9.30 am on Tuesday 1 October 2019**

Office Hours:

The Victoria Government Gazette Office is open normal office hours during that week, i.e. 8.30 am to 5.30 pm **Monday to Thursday**, excluding the public holiday.

Where urgent gazettal is required after hours, arrangements should be made with the Government Gazette Officer on 0419 327 321.

JENNY NOAKES
Government Gazette Officer

PRIVATE ADVERTISEMENTS

DISSOLUTION OF PARTNERSHIP

Take notice that the partnership formerly subsisting between Christos Ganatsios, also known as Chris Ganatsios, and Irene Ganatsios previously carrying on business under the business name South Melbourne Market Nut Shop, ABN 55 147 937 278, from the premises situated at Stall 1 of South Melbourne Market, was dissolved on 5 August 2019.

Creditors, next-of-kin and others having claims in respect of the estate of MAURICE ANTHONY O'KEEFE, deceased, late of 1 Julie Street, Blackburn North, Victoria, retired, who died on 4 July 2019, are requested to send particulars of their claims to the executor, Graeme Joseph O'Keefe (in the Will called Graeme O'Keefe), care of the undersigned solicitors, by 22 November 2019, after which date he will convey or distribute the assets, having regard only to the claims of which he then has notice.

AITKEN PARTNERS, solicitors,
Level 28, 140 William Street, Melbourne 3000.

JOYCLYN MAUD NOBLE, late of 2/9 Carrum Street, Malvern East, Victoria 3145, retired dressmaker, deceased.

Creditors, next-of-kin and others having claims in respect of the estate of the abovenamed deceased, who died on 3 June 2019, are required by the trustee, Melissa Louise Patterson, to send particulars of their claims to the undermentioned firm by 25 November 2019, after which date the said trustee may convey or distribute the estate, having regard only to the claims of which she then has notice. Probate was granted in Victoria on 4 September 2019.

Dated 10 September 2019

ARGENT LAW,
Ground Floor, 2 Stawell Street, Richmond,
Victoria 3121.
Ph: (03) 9571 7444, Fax: (03) 9571 1059.
HA:20192580. Contact: Helen Adoranti.

ROBERT JOHN GAWNE, late of 15 McAuley Drive, Rosanna, Victoria, retired, deceased.

Creditors, next-of-kin and others having claims in respect of the estate of the deceased, who died on 29 May 2019, are required by Australian Unity Trustees Limited, ACN 162 061 556, of 15/271 Spring Street, Melbourne, Victoria, the executor, to send particulars to it by 20 November 2019, after which date it may convey or distribute the assets, having regard only to the claims of which it then has notice.

AUSTRALIAN UNITY TRUSTEES
LEGAL SERVICES,
15/271 Spring Street, Melbourne, Victoria 3000.

YVONNE BARBARA PERRET, late of 29 Rennie Street, Seddon, Victoria, retired, deceased.

Creditors, next-of-kin and others having claims in respect of the estate of the deceased, who died on 1 May 2019, are required by Australian Unity Trustees Limited, ACN 162 061 556, of 15/271 Spring Street, Melbourne, Victoria, having been duly authorised by Sarah Collins nee Smith (in the Will called Sarah Smith) and Ian George Warren Smith, the executors appointed in the Will, to send particulars to it by 20 November 2019, after which date it may convey or distribute the assets, having regard only to the claims of which it then has notice.

AUSTRALIAN UNITY TRUSTEES
LEGAL SERVICES,
15/271 Spring Street, Melbourne, Victoria 3000.

JEAN FRANCES DAY, late of 526 Burwood Highway, Vermont South, Victoria 3133, retired, deceased.

Creditors, next-of-kin and others having claims in respect of the estate of the abovenamed deceased, who died on 13 March 2019, are required by the executors for Grant of Administration, Lynette Aird and Neville Robert Windebank, care of Suite 4, 426 Burwood Highway, Wantirna South, Victoria 3152, to send particulars of their claims to them by 30 November 2019, after which date the executors may convey or distribute the assets

of the estate, having regard only to the claims of which they then have notice. Probate was granted in Victoria on 30 May 2019.

Dated 10 September 2019

BALLARDS SOLICITORS PTY LTD,
Suite 4, 426 Burwood Highway, Wantirna South,
Victoria 3152.
PO Box 4118, Knox City Centre, Victoria 3152.
DX 18206 Knox City.
Ph: (03) 9800 7500, Fax: (03) 9800 7555.
MAG:MMM:190063.
Contact: Mandy Anne Greenlaw.

Re: LEO DENIS FITZGERALD, deceased.

Creditors, next-of-kin and others having claims in respect of the estate of the deceased, who died on 22 May 2019, are required by the trustee, Gerard Joseph Treuel, to send particulars to him, care of the undermentioned solicitors, within two months from the date of this publication, after which date the trustee may convey or distribute the assets, having regard only to the claims of which the trustee has notice.

BASILE PINO & CO., solicitors,
213 Campbell Street, Swan Hill 3585.

Re: HILDEGARDE MARTA KURTAJ, also known as 'Hilda', late of 15 Hospital Street, Daylesford, Victoria 3460.

Creditors, next-of-kin and others having claims in respect of the estate of the deceased, who died on 30 March 2019, are required by the executor, Roger Kurtaj, to send particulars of their claim to him, care of the undermentioned solicitors, by 12 November 2019, after which date the executor may convey or distribute the assets, having regard only to the claims of which he may then have notice.

DANIEL LAWYERS & ASSOCIATES,
Level 5, 12 Clarke Street, Sunshine 3020.

Re: STEPHEN JOSEPH McPOLIN, late of 410 Robinsons Road, Langwarrin South, Victoria, former mining engineer, deceased.

Creditors, next-of-kin and all others having claims in respect of the estate of the abovementioned deceased, who died on 25 November 2018, are required by the administrator, Debra Anne Davis, to send

particulars of such claims to her, care of the undermentioned solicitors, by 20 November 2019, after which date the administrator may convey or distribute the assets, having regard only to the claims of which she then has notice.

DAVIS LAWYERS,
Level 15, 200 Queen Street, Melbourne,
Victoria 3000.

Re: MARIA GIOVANNA ZORZANELLO, late of 33 Newmans Road, Templestowe, Victoria, home duties, deceased.

Creditors, next-of-kin and all others having claims in respect of the estate of the abovementioned deceased, who died on 24 January 2019, are required by the executors, Juliana Quinn, Vittorio Zorzanello and Davide Zorzanello, to send particulars of such claims to them, care of the undermentioned solicitors, by 20 November 2019, after which date the executors may convey or distribute the assets, having regard only to the claims of which they then have notice.

DAVIS LAWYERS,
Level 15, 200 Queen Street, Melbourne,
Victoria 3000.

GLADYS MATHER, late of Unit 1, 1A Hovea Street, Templestowe, Victoria, retired, deceased.

Creditors, next-of-kin and others having claims in respect of the estate of the deceased, who died on 2 July 2019, are required by the executor, Barbara Joy Andersson, to send particulars of their claims to the undermentioned solicitors within 60 days from the date of publication of this notice, after which date the executor may convey or distribute the assets, having regard only to the claims of which the executor then has notice.

DEVENISH, lawyers,
23 Ringwood Street, Ringwood, Victoria 3134.

ROBERT KEITH DUNN, late of 879 Plenty Road, South Morang, Victoria, retired salesman, deceased.

Creditors, next-of-kin and others having claims in respect of the estate of the deceased, who died on 26 April 2018, are required by

the trustees, Equity Trustees Wealth Services Limited, ACN 006 132 332, and Catherine Peta Dunn, both care of the address below, to send particulars to the trustee by 19 November 2019, after which date the trustee may convey or distribute the assets, having regard only to the claims of which the trustee then has notice.

EQUITY TRUSTEES WEALTH
SERVICES LIMITED,
Shop 12, Fountain Court, Bendigo, Victoria 3550.

KURT KUFFER, late of Quambatook, Victoria, deceased.

Creditors, next-of-kin and others having claims in respect of the estate of the deceased, who died on 13 July 2019, are required by Gayle Patricia Kuffer, the executor of the Will of the deceased, to send particulars of their claims to her, care of the undermentioned solicitor, within 60 days from the date of publication of this notice, after which date the executor may convey or distribute the assets, having regard only to the claims of which she then has notice.

GARDEN & GREEN LAWYERS,
35 Beveridge Street, Swan Hill, Victoria 3585.

Re: Estate of SUSAN ELIZABETH BLAIR.

Creditors, next-of-kin and others having claims against the estate of SUSAN ELIZABETH BLAIR, late of 123–127 Whalley Drive, Wheelers Hill, Victoria, business owner, deceased, who died on 25 June 2019, are requested to send particulars of their claims to the executor, care of the undermentioned lawyers, by 20 November 2019, after which date they will distribute the assets, having regard only to the claims of which they then have notice.

HICKS OAKLEY CHESSELL WILLIAMS,
lawyers,
PO Box 2165, Mount Waverley, Victoria 3149.

NICHOLAS ALAN RICHARD KENT, late of 1 Kimberley Avenue, Drysdale, Victoria, motor mechanic, deceased.

Creditors, next-of-kin and others having claims in respect of the estate of the deceased, who died on 12 January 2019, are required by the administrators, Thomas Richard Kent and Helen Frances Kent, to send particulars to them,

care of the undersigned, by 22 November 2019, after which date the administrators may convey or distribute the assets, having regard only to the claims of which they then have notice.

HUTCHINSON LEGAL,
38 New Street, Ringwood, Victoria 3134.

VALERIE JUNE SMITH, late of 18 Avon Avenue, Mitcham, Victoria, cook, deceased.

Creditors, next-of-kin and others having claims in respect of the estate of the deceased, who died on 2 July 2019, are required by the personal representatives, Karen Elizabeth Smith and Andrea Dahlstrom, to send particulars to them, care of the undersigned, by 18 November 2019, after which date the personal representatives may convey or distribute the assets, having regard only to the claims of which they then have notice.

HUTCHINSON LEGAL,
38 New Street, Ringwood, Victoria 3134.

Re: Estate of KUNIGUNDA KILEY.

Creditors, next-of-kin or others having claims in respect of the estate of KUNIGUNDA KILEY, also known as Gunda Kiley, late of Respect Aged Care, 2–14 Boree Drive, Swan Hill, in the State of Victoria, widow, deceased, who died on 17 June 2019, are to send particulars of their claim to the executor, care of the undermentioned legal practitioners, by 8 December 2019, after which the executor will distribute the assets, having regard only to the claims of which he then has notice.

JOLIMAN LAWYERS,
Beveridge Dome, 194–208 Beveridge Street,
Swan Hill 3585.

Re: Estate of MARY GRACE MANSON.

Creditors, next-of-kin or others having claims in respect of the estate of MARY GRACE MANSON, late of Respect Aged Care, 2–14 Boree Drive, Swan Hill in the State of Victoria, widow, deceased, who died on 10 August 2019, are to send particulars of their claim to the executors, care of the undermentioned legal practitioners, by 9 December 2019, after which the executors will distribute the assets, having regard only to the claims of which they then have notice.

JOLIMAN LAWYERS,
Beveridge Dome, 194–208 Beveridge Street,
Swan Hill 3585.

Re: GIOVANNA CHRISTA BUHAGIAR, also known as Joan Christa Buhagiar, deceased.

Creditors, next-of-kin and others having claims in respect of the estate of the deceased, who died on 21 May 2019, are required by the trustees, Oswald Paul Guido Buhagiar and Henry Paul Buhagiar, to send particulars to their solicitors at the address below, by 19 November 2019, after which date the trustees may convey or distribute the assets, having regard only to the claims of which the trustees have notice.

MST LAWYERS,
315 Ferntree Gully Road, Mount Waverley 3149.

Re: RAM SHARAN, deceased.

Creditors, next-of-kin and others having claims in respect of the estate of the deceased, who died on 27 June 2019, are required by the trustee, Pradeep Kumar Sharan, to send particulars to his solicitors at the address below, by 19 November 2019, after which date the trustee may convey or distribute the assets, having regard only to the claims of which the trustee has notice.

MST LAWYERS,
315 Ferntree Gully Road, Mount Waverley 3149.

GORDON GILL, late of 37 Langmore Lane, Berwick, Victoria, farmer, deceased.

Creditors, next-of-kin and others having claims in respect of the estate of the abovenamed deceased, who died 4 June 2019, are required by the executors, Frank Monacella of 61–63 Victoria Street, Warragul, Victoria, chartered accountant, James Alexander Sturgess of 40–42 Scott Street, Dandenong, Victoria, Australian legal practitioner, and Heather Ann Porter of 6 Mary Court, Berwick, Victoria, director, to send particulars of their claims to them, care of the undersigned, by 19 November 2019, after which date the executors will convey or distribute the assets, having regard only to the claims of which they then have notice.

MACPHERSON KELLEY,
Level 7, 600 Bourke Street, Melbourne 3000.

Re: ERNEST JAMES MARRIOTT, late of Villa Maria Aged Care, 89–93 Avebury Drive, Berwick, primary producer, deceased.

Creditors, next-of-kin and others having claims in respect of the estate of the deceased, who died on 5 June 2019, are required by the executor, Mary Elizabeth McCarthy, to send particulars to her, care of the undermentioned lawyer, by a date not later than two months from the date of publication hereof, after which date the executor will convey or distribute the assets, having regard only to the claims of which she then has notice.

SUZANNE LYTTLETON LAWYERS,
PO Box 2181, St Kilda West, Victoria 3182.
Telephone: 9646 4477.

RAYMOND WALTHAM, late of Unit 3, 2D Mitchells Road, Moe in the State of Victoria, retired, deceased.

Creditors, next-of-kin and others having claims in respect of the estate of the deceased, who died on 7 April 2019, are required by the personal representative, Mavis Joyce Dambrauskas of 46 Haigh Street, Moe, to send particulars to her, care of the undermentioned solicitors, by 18 November 2019, after which date the personal representative may convey or distribute the assets, having regard only to the claims of which they then have notice.

VERHOEVEN & CURTAIN SOLICITORS,
Suite 4, 46 Haigh Street, Moe 3825.

Re: GORDON VEREY JONES, late of 80B Napier Street, South Melbourne, Victoria.

Creditors, next-of-kin and others having claims in respect of the estate of the deceased, who died on 26 March 2019, are required to send particulars of their claims to the executor, care of GPO Box 1946, Melbourne, Victoria 3001, by 6 December 2019, after which date the executor may convey or distribute the assets, having regard only to the claims of which she may then have notice.

WILLS & PROBATE VICTORIA, lawyers,
Level 3, 20–22 McKillop Street, Melbourne 3000.

CHRISTOPHER RODNEY BISHOP, late of 32 St Johns Wood Road, Blairgowrie in the State of Victoria, company director, deceased.

Creditors, next-of-kin and others having claims in respect of the estate of the deceased,

who died on 27 August 2018, are required by the executrix of the Will of the deceased, Elizabeth Anne Bishop, care of Wisewould Mahony, Level 8, 419 Collins Street, Melbourne in the State of Victoria, to send particulars of their claims to the executrix by 24 November 2019, after which date the executrix may convey or distribute the assets, having regard only to the claims of which they then have notice.

Probate was granted in Victoria on 24 May 2019.

WISEWOULD MAHONY, solicitor,
Level 8, 419 Collins Street, Melbourne,
Victoria 3000.

ADVERTISEMENT OF AUCTION BY THE SHERIFF

On Thursday 24 October 2019 at 1.30 pm, at Level 6, 446 Collins Street, Melbourne (unless process is stayed or satisfied), all the estate and interest (if any) of the person(s) named below, in the land described below, will be auctioned by the Sheriff:

Myles David Kummrow of 1A Rupert Street, Mitcham, sole proprietor of an estate in fee simple in the land described on Certificate of Title Volume 08195 Folio 577, upon which is erected a single-storey house and known as 1A Rupert Street, Mitcham.

The following recordings in the Register affect or may affect the land as at 8 August 2019:

- Registered Caveat (Dealing Number AS010716V).

The Sheriff is unable to provide access to this property. Refer to the advertisement on realestate.com.au for further information.

Terms: 10% deposit on the fall of the hammer. Balance within 14 days unless as stated in particulars of sale in contract of sale. Payment is by cheque only.

Please visit the Sheriff's Office Victoria Real Estate Section website at www.justice.vic.gov.au/sheriffrealestate for an information sheet on Sheriff's Auctions, a contract of sale and further information. Alternately, you can contact the Sheriff's Office Victoria Real Estate Section at realestatediv@justice.vic.gov.au

SHERIFF OF VICTORIA

ADVERTISEMENT OF AUCTION BY THE SHERIFF

On Thursday 24 October 2019 at 1.30 pm, at Level 6, 446 Collins Street, Melbourne (unless process is stayed or satisfied), all the estate and interest (if any) of the person(s) named below, in the land described below, will be auctioned by the Sheriff:

Viswanathan Murugesu of 2 Wannon Place, Taylors Hill, Victoria, sole proprietor of an estate in fee simple in the land described on Certificate of Title Volume 10536 Folio 629, upon which is erected a double-storey dwelling and known as 2 Wannon Place, Taylors Hill, Victoria 3037.

The following recordings in the Register affect or may affect the land as at 4 September 2019:

- Registered Mortgage AD774277M,
- Registered Caveat (Dealing Number AE533988P),
- Covenant X212113G.

The Sheriff is unable to provide access to this property. Refer to the advertisement on realestate.com.au for further information.

Terms: 10% deposit on the fall of the hammer. Balance within 14 days unless as stated in particulars of sale in contract of sale. Payment is by cheque only.

Please visit the Sheriff's Office Victoria Real Estate Section website at www.justice.vic.gov.au/sheriffrealestate for an information sheet on Sheriff's Auctions, a contract of sale and further information. Alternately, you can contact the Sheriff's Office Victoria Real Estate Section at realestatediv@justice.vic.gov.au

SHERIFF OF VICTORIA

**GOVERNMENT AND OUTER BUDGET
SECTOR AGENCIES NOTICES**

MORELAND CITY COUNCIL

Road Discontinuance

Pursuant to section 206 and Schedule 10, Clause 3 of the **Local Government Act 1989**, the Moreland City Council, at its ordinary meeting held on 14 August 2019, resolved to discontinue the road adjoining 1 Essex Street, Brunswick, shown by hatching on the plan below and to sell the land from the road by private treaty to the owner of 1 Essex Street, Brunswick.

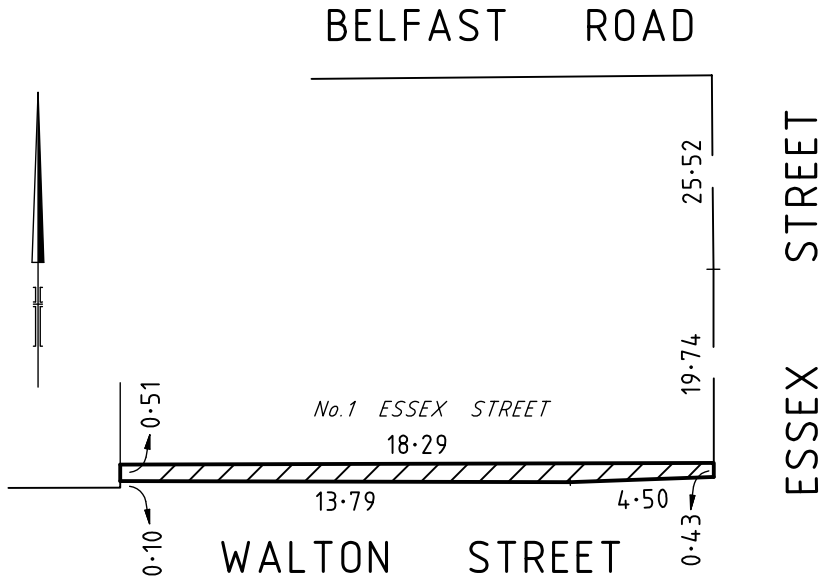

GRANT THORNE
Acting Chief Executive Officer



**MORNINGTON
PENINSULA**
Shire

**NOTICE OF INTENTION TO AMEND
General Purposes Local Law 2012**

Notice is hereby given pursuant to the provisions of section 119(2) of the **Local Government Act 1989** that at its meeting on 27 August 2019, Mornington Peninsula Shire Council resolved to amend General Purposes Local Law 2012 to incorporate clauses regulating smoking.

Purpose and General Purport of the Proposed Amendment of the Local Law

The purpose and general purport of the Local Law are to:

- amend the Local Law to incorporate clauses regulating smoking;
- provide a safe and healthy environment so that the community within the municipality can enjoy a quality of life that meets its expectations;
- protecting the community from the harmful effects of second-hand smoke;
- de-normalising smoking behaviours, which is particularly important for discouraging children from taking up smoking;
- providing residents and visitors with smoke-free public areas; and
- prescribe penalties for smoking offences under the Local Law.

Have Your Say

Any person affected by the proposed local law may make a submission to Council. All submissions received on or before 5.00 pm on Thursday 31 October 2019 will be considered by Council in accordance with section 223 of the **Local Government Act 1989**.

Any person making a submission is entitled to request (in the submission itself) to be heard at a Council meeting in support of the submission, either in person or by a person acting on his or her behalf. Notice of the meeting date and time will be given to each person who has lodged a submission.

Submissions should be marked ‘Draft Smoke-Free Policy’ and addressed to: Peter O’Brien, Mornington Peninsula Shire Council, Private Bag 1000, Rosebud, Victoria 3939. Submissions may also be hand delivered to any of the Civic Centres at either 90 Besgrove Street, Rosebud; or 2 Queen Street, Mornington; or 21 Marine Parade, Hastings; or complete the survey on the Shire’s webpage at or emailed to <https://www.mornpen.vic.gov.au/About-Us/Have-your-say/Have-Your-Say-Smoke-Free-Environment-Policy>

Submitters should note that Council is required to maintain a public register of submissions received during the previous 12 months. Unless a submitter requests to the contrary, copies of submissions (including the submitters’ names and addresses) may also be included in the Council meeting agenda and minutes, which are a permanent public record, and which are published on Council’s website.

Copies of the proposed Amendment of the Local Law, the Draft Smoke-Free Environment Policy and Background Paper – Development of the Shire’s Smoke-Free Environment Policy – can be inspected at or obtained from Council’s Civic Centres. Alternatively, copies can be viewed online at <https://www.mornpen.vic.gov.au/About-Us/Have-your-say/Have-Your-Say-Smoke-Free-Environment-Policy>

JOHN BAKER
Chief Executive Officer

MOONEE VALLEY CITY COUNCIL

Erratum – Notice of Road Discontinuance

On 30 September 1999, Moonee Valley City Council gave notice in edition G39 of the Victoria Government Gazette (Gazettal Notice) of its resolution to discontinue the road shown hatched on the plan below.

The original Gazettal Notice is amended as follows:

1. insert the words ‘and City West Water Corporation’ after the words ‘Melbourne Water Corporation’; and
2. delete the words ‘that authority’ and insert the words ‘those authorities’.

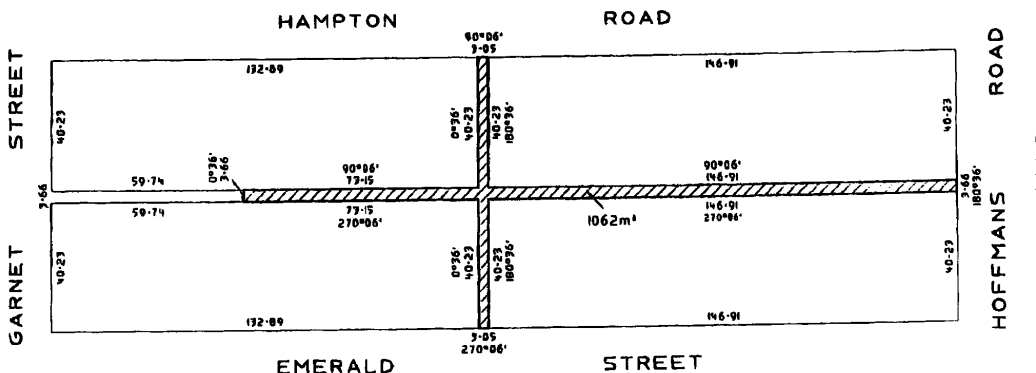

BRYAN LANCASTER
Chief Executive Officer
Moonee Valley City Council

Planning and Environment Act 1987**MORELAND PLANNING SCHEME**

Notice of the Preparation of an Amendment

Amendment C183

Moreland City Council has prepared Amendment C183 to the Moreland Planning Scheme. The Amendment affects land in the Brunswick, Coburg and Glenroy Activity Centres, Local and Neighbourhood Centres, and all other land in a Commercial 1 Zone and Mixed Use Zone.

The Amendment proposes to make changes to the Moreland Planning Scheme to implement the *Moreland Integrated Transport Strategy 2019* and *Moreland Parking Implementation Plan 2019*. It proposes to introduce Parking Overlays to remove minimum parking requirements, and introduce maximum parking rates, in the Brunswick, Coburg and Glenroy Activity Centres; reduce minimum parking requirements by 20 per cent in twelve Neighbourhood Centres; introduce new guidelines to encourage development to integrate sustainable transport into its design; and make consequential changes to local policies (Clauses 21.02, 21.04 and 22.03).

You may inspect the Amendment, any documents that support the Amendment and the explanatory report about the Amendment, free of charge, at the following locations: Moreland Citizens Service Centre, 90 Bell Street, Coburg; Brunswick Citizen Service Centre, 233 Sydney Road, Brunswick; Glenroy Citizen Service Centre, 796N Pascoe Vale Road, Glenroy; Coburg Library, corner Victoria and Louisa Streets, Coburg; Brunswick Library, 233 Sydney Road, Brunswick; Glenroy Library, 737 Pascoe Vale Road, Glenroy; Fawkner Library, 77 Jukes Road, Fawkner.

The Amendment can also be inspected on the Moreland City Council website at www.moreland.vic.gov.au/amendment-c183 and at the Department of Environment, Land, Water and Planning website, www.delwp.vic.gov.au/public-inspection

Any person who may be affected by the Amendment may make a submission to the planning authority about the Amendment. Submissions must be made in writing giving the submitter's name and contact address, clearly stating the grounds on which the Amendment is supported or opposed and indicating what changes (if any) the submitter wishes to make.

Name and contact details of submitters are required for Council to consider submissions and to notify such persons of the opportunity to attend Council meetings and any public hearing held to consider submissions. The closing date for submissions is Monday 11 November 2019. Submissions must be sent to: Strategic Planning, Submission to Amendment C183, Moreland City Council, Locked Bag 10, Moreland, Victoria 3058; or via email: strategicplanning@moreland.vic.gov.au

The planning authority must make a copy of every submission available at its office for any person to inspect, free of charge, for two months after the Amendment comes into operation or lapses.

KIRSTEN COSTER
Director City Futures

Planning and Environment Act 1987**YARRA PLANNING SCHEME**

Notice of the Preparation of an Amendment

Amendment C223

The Yarra City Council has prepared Amendment C223 to the Yarra Planning Scheme.

The land affected by the Amendment is 81–95 Burney Street and 26 Doonside Street, Richmond.

The Amendment proposes to rezone the site from Industrial 3 Zone to Mixed Use Zone and apply the Development Plan Overlay Schedule 15 and an Environmental Audit Overlay to the site.

You may inspect the Amendment, any documents that support the Amendment and the explanatory report about the Amendment, free of charge, at the following locations: during office hours, at the office of the planning authority, City of Yarra, Richmond Town Hall, Town Planning Counter, 333 Bridge Road, Richmond, Victoria 3121; and at the Department of Environment, Land, Water and Planning website, www.delwp.vic.gov.au/public-inspection

Any person who may be affected by the Amendment may make a submission to the planning authority about the Amendment. Submissions must be made in writing giving the submitter's name and contact address, clearly stating the grounds on which the Amendment is supported or opposed and indicating what changes (if any) the submitter wishes to make.

Name and contact details of submitters are required for council to consider submissions and to notify such persons of the opportunity to attend council meetings and any public hearing held to consider submissions. The closing date for submissions is Thursday 24 October 2019. A submission must be sent to the Yarra City Council, Strategic Planning Unit, PO Box 168, Richmond 3121; or by email to strategicplanning@yarracity.vic.gov.au with Amendment C223 in the subject line.

The planning authority must make a copy of every submission available at its office for any person to inspect, free of charge, for two months after the Amendment comes into operation or lapses.

DAVID WALMSLEY
Manager City Strategy

Creditors, next-of-kin and others having claims against the estate of any of the undermentioned deceased persons are required to send particulars of their claims to State Trustees Limited, ABN 68 064 593 148, of 1 McNab Avenue, Footscray, Victoria 3011, the personal representative, on or before 19 November 2019, after which date State Trustees Limited may convey or distribute the assets, having regard only to the claims of which State Trustees Limited then has notice.

BEYER, Norma Pauline, late of Eden Park Residential Care, 31 Thompson Street, Whittington, Victoria 3219, deceased, who died on 12 October 2017.

ERICSON, Colin John, late of 18 The Ridge, Kinglake, Victoria 3763, deceased, who died on 22 October 2018.

HOWARD, Joyce Rita, late of Arcadia Aged Care, 120 McCracken Street, Essendon, Victoria 3040, home duties, deceased, who died on 17 June 2019.

ISWORTH, Thelma Constance, late of Bupa Greensborough, 264 Diamond Creek Road, Greensborough, Victoria 3088, home duties, deceased, who died on 29 June 2019.

LAFRENZ, Erika, late of Tabulam and Templar Homes for the Aged, 31–41 Elizabeth Street, Bayswater, Victoria 3153, deceased, who died on 17 May 2019.

LESAR, Julie Ann, late of Spurway Community Nursing Home, 89–91 Murrumbeena Road, Murrumbeena, Victoria 3163, deceased, who died on 2 August 2017.

McNAMARA, John Francis, late of Unit 7, 41 Parkers Road, Parkdale, Victoria 3194, deceased, who died on 28 May 2019.

MILLER, Rodney Graeme, late of Unit 8, 54 Tennyson Street, Elwood, Victoria 3184, public servant, deceased, who died on 14 June 2019.

SCHUTT, Kevin, late of Hammond Care Namarra, 294 Kooyong Road, Caulfield, Victoria 3162, deceased, who died on 18 May 2019.

SMITH, James Suttie, late of Lyndoch Living, 10 Hopkins Road, Warrnambool, Victoria 3280, deceased, who died on 12 July 2019.

TAM, Rita Fong, late of Bapcare Westhaven, 50 Pickett Street, Footscray, Victoria 3011, deceased, who died on 25 May 2019.

VASSALLO, Anthony, late of St Bernadettes Aged Care Facility, 17 Park Drive, Sunshine, Victoria 3020, deceased, who died on 8 July 2019.

WAUGH, Robert Patrick, late of 62 Maher Road, Laverton, Victoria 3028, deceased, who died on 16 May 2019.

Dated 10 September 2019

Creditors, next-of-kin and others having claims against the estate of any of the undermentioned deceased persons are required to send particulars of their claims to State Trustees Limited, ABN 68 064 593 148, of 1 McNab Avenue, Footscray, Victoria 3011, the personal representative, on or before 21 November 2019, after which date State Trustees Limited may convey or distribute the assets, having regard only to the claims of which State Trustees Limited then has notice.

BISSETT, Raymond William Henry, late of Glenlyn Aged Care Facility, 34 Finchley Avenue, Glenroy, Victoria 3046, deceased, who died on 21 January 2019. Date of Grant 6 September 2019.

BURGESS, Alwyn Nellie, late of Scottvale Aged Care, 71 Scott Street, Dandenong, Victoria 3175, deceased, who died on 4 July 2019.

COLLINS, Ronald, late of Namarra Nursing Home, 260 Kooyong Road, Caulfield South, Victoria 3162, deceased, who died on 4 August 2019.

EASTON, Matthew James, late of 1209–1215 Nepean Highway, Highett, Victoria 3190, deceased, who died on 18 February 2019.

KERR, Ian Graham, late of 4 Sinclair Crescent, Seymour, Victoria 3660, deceased, who died on 22 June 2019.

TAYLOR, Campbell Robertson, late of Mayfair Lodge, 80 Stud Road, Dandenong, Victoria 3175, deceased, who died on 3 May 2019.

Dated 12 September 2019

Creditors, next-of-kin and others having claims against the estate of any of the undermentioned deceased persons are required to send particulars of their claims to State Trustees Limited, ABN 68 064 593 148, of 1 McNab Avenue, Footscray, Victoria 3011, the personal representative, on or before 25 November 2019, after which date State Trustees Limited may convey or distribute the assets, having regard only to the claims of which State Trustees Limited then has notice.

BAILEY, Stephen Vincent, late of Lyndoch Living Nursing Home, 10 Hopkins Road, Warrnambool, Victoria 3280, deceased, who died on 13 June 2019.

BARRANQUERO, Eugene, late of Twin Parks Aged Care, 33–47 Blake Street, Reservoir, Victoria 3073, deceased, who died on 21 February 2019.

HEATH, Howard Joseph, late of 374 National Park Road, Loch Sport, Victoria 3851, deceased, who died on 6 May 2019.

HENLEY, Imogene Dorothy, late of Nazareth House, 16 Cornell Street, Camberwell, Victoria 3124, deceased, who died on 23 April 2019.

HULL, Dorothy Florence, late of 118 Somers Avenue, Macleod, Victoria 3085, deceased, who died on 14 April 2019.

LUBCKE, Allan Jeffery, late of Kirralee Residential Aged Care Facility, 207 Richards Street, Ballarat Central, Victoria 3350, deceased, who died on 4 May 2019.

MAHONEY, Peter, late of Greenway Gardens, 27–29 The Greenway, Heathmont, Victoria 3135, deceased, who died on 9 April 2019.

NOONAN, Michael Nicholas, late of Unit 3, 306 Dorcas Street, South Melbourne, Victoria 3205, retired, deceased, who died on 12 April 2019.

SEALY, Robert George, late of Bupa Traralgon, 96 Park Lane, Traralgon, Victoria 3844, deceased, who died on 10 May 2019.

SMITH, Ellen Mary, late of Barwidgie Lodge, Myrtleford Hospital, 30 O'Donnell Street, Myrtleford, Victoria 3737, deceased, who died on 4 June 2018.

WILLIAMS, Maxwell, late of Jack Lonsdale Lodge Nursing Home, 232 Spencer Street, Sebastopol, Victoria 3356, deceased, who died on 6 May 2019.

Dated 16 September 2019

Associations Incorporation Reform Act 2012

SECTION 135

On 20 August 2019 I issued a notice under section 135(2) of the **Associations Incorporation Reform Act 2012** (the Act) to the incorporated associations listed below, requesting them to show cause as to why their incorporation should not be cancelled.

I am now satisfied that the incorporation of the below listed incorporated associations should be and are hereby cancelled in accordance with section 135(3) of the Act.

(Y.V.) Youth Of Victoria Inc.; Abyei Women Group Association for Establishment & Development in Victoria Inc.; Amateur Radio Australia Inc.; Ampersand Network Inc.; Associazione San Gabriele Dell'addolorata – Melbourne Inc.; Australasian Creative Craft Association Inc.; Australasian Specialty Tea Association Inc.; Australian Chinese Sports Association Inc.; Australian Goldpanning Association Inc.; Australian Islamic Education Fund Inc.; Australian Migrant Women Association Inc.; Australian Slot Car Drag Racing Association Inc.; Australian Somali Integration of Australia Inc.; Australian Somali Youth Association Inc.; Australian Turkish Poetry Volunteers Group Inc.; Ballarat Touch Association Inc.; Bayside Residents for Urban Protection Inc.; Bendigo Western Performance

and Horsemanship Club Inc.; Bengoma Inc.; Bent Boards Inc.; Black Glen Equine Services Inc.; Breakthrough Embassy Melbourne Inc.; Bula Pacific Rugby Sports Association Inc.; Byaduk Tennis Club Inc.; Casterton-Coleraine Hunt Club Inc.; Central America Pastoral House Inc.; Central District Golf Association Inc.; Chelsea & Peninsula Cycling Club Inc.; Chetwynd Ski Club Inc.; Chulipuram Victoria College Old Students Association Inc.; Circolo Sociale & Pensionati Italiani Bendigo & District Inc.; CLK Musical Theatre Inc.; Clunes Film and Amateur Theatre Society Inc.; Coburg Turkish Elderly & Pensioners Club Inc.; Collin Street Elite Club Inc.; Construction Industry Sub Contractors & Employees Association Inc.; Coptic Arts & Heritage Association Inc.; Cottles Bridge Landcare Group Inc.; Council of Sudanese Groups Inc.; Croatian Historical Society Inc.; Croxton Youth Cricket Club Inc.; Daylesford & District Action Group Inc.; Denison Public Hall Inc.; Donald Tourism Association Inc.; Eastern Razorbacks Inline Hockey Club Inc.; Everton Camp Draft Inc.; Federation of Homeworkers Worldwide Inc.; Fernleigh Calisthenics Club Inc.; Fidelity Social Tennis Club Inc.; Filipino-Australian Artists of Melbourne (FAME) Inc.; Focus 35+ Inc.; Friday Nite Live Inc.; Friends of Providence Ponds Inc.; Friends of The Nation Inc.; Friendship Table Tennis Association Inc.; Future Canvas Inc.; Gay Women's Cancer Support & Advocacy Group Inc.; Geelong Junior Moto Cross Club Inc.; Gift Hotel Social Club Inc.; Gippsland Rabbit Fanciers Association Inc.; Global Freedom Inc.; Global Trade Watch Inc.; God Rock Ministries Inc.; GV Ethnic Professionals' Association Inc.; Hepner Place Indoor Tennis Club Inc.; Institute for Kurdish Studies in Australia (I.K.S.A.) Inc.; International Fur Association Australia Inc.; Islamic Association of Australia Inc.; Islamic Family and Childcare Agency Inc.; Islamic Quran Radio Association (IQRA) Inc.; Jeparit River and Environment Committee Inc.; Jesus, Hope for All Nations Inc.; Jewish Inclusion Network Inc.; Kerang Woodcrafters Inc.; Kinglake Action Network & Development Organisation (KANDO) Inc.; Kladorrahi Social Club Inc.; Knox Early Parenting Centre Inc.; Korrine Tennis Club Inc.; Korweinguboorra Cricket Club Inc.; Krinkl Theatre Inc.; Kurdish Youth of Australia (KYA) Inc.; Lake Bolac Tennis Club Inc.; Legal Australian Sex Industry Inc.; Lillydale Lake Playgroup Inc.; Limbkids Support Association Victas Inc.; Lions Cricket Club of Victoria Inc.; Little Samaritan Mission Inc.; Lotus Aid Relief Inc.; Macedonian Social Club: Cento-Prilep – From Melbourne Inc.; Madda Walaabuu Sport Club Inc.; Ma'di Community Association in Victoria Australia (MACA) Inc.; Manihiki Sport and Multi Cultural Association Inc.; Maribyrnong Press Association Inc.; Meeniyah & District Historical Society Inc.; Melbourne Fujian Business Council Inc.; Melbourne Golf Group Inc.; Melbourne Stallions Cricket Club Inc.; Melbourne Toastmasters Inc.; Melbourne Unicorns Football Club Inc.; Metropolitan Fire & Emergency Services Board Ski Club Inc.; Metropolitan Fire & Emergency Services Board Tennis Club Inc.; Millenion Inc.; Mooroolbark Social Golf Club Inc.; Moreland Eagles Football Club Inc.; Moreland Residents Association Inc.; Mount Zion Spanish Christian Church Inc.; Move Youth Services Inc.; Movie Friends Inc.; Multiverse Inc.; National Liaison Committee for International Students in Australia Inc.; Newport Sports Club Inc.; North Glenroy Soccer Club Inc.; North Suburban Eight Ball Association Inc.; Northern Rivers Region BMX Inc.; Orient Travel Agents Consortium Inc.; Orthodox Church of Australia Inc.; P.A.S.E (Parents and Supporters of Elite) Gymnastics Inc.; Pathfinder Ministries Inc.; Paynesville Koala and Native Wildlife Shelter Inc.; Peninsula Conference Bureau Inc.; Petros Mission Inc.; Phat Quang Temple Inc.; Pinot Noir South Inc.; Playground Association of Mount Martha Inc.; Poco Loco Social Club Inc.; Point Orient Chinese School Inc.; Port Campbell Traders Association Inc.; Port Phillip Combined Cricket Club Inc.; Portland Potato Growers Association Inc.; Portland Woodturners Guild Inc.; Professional Clinical Myotherapists of Australia Inc.; Puffing Billy Country Tourism Inc.; Raglan Street Gallery Inc.; Rat and Mouse Association (Victoria) Inc.; Red Hill Basketball Club Inc.; Red Hill Social & Sporting Club Inc.; Relief Organization for Ethiopia In Australia Inc.; Renaissance Bookbinding Inc.; Revive Financial Recovery Institute Inc.; Ringdon Auxiliary Inc.; Ringwood Warhammer Club Inc.; Road Rebel Motorcycle Club Inc.; Roof Ministries Overseas Aid Inc.; Rosa Benedikt Centre Inc.; Rotaract Club of Central Melbourne Inc.; Rotary Club of Burwood Inc.; Rowville Heights Netball Club

Inc.; Royal Park Dogs Inc.; Russian Australian Senior Citizens Club in Prahran Inc.; Russian-Australian Orthodox Welfare Fund Inc.; Rutherglen Judo Club Inc.; Rutherglen Village Inc.; Saint Yacoub Boordono Syrian Orthodox Church Inc.; Samoan Catholic Community St. Peters Inc.; Save Sandringham Action Group Inc.; Scenar Therapy Association of Australasia Inc.; Sciencenow! Inc.; Scoliosis Association of Australia Inc.; Scrub Bashers Ute Club Inc.; Serbian Community TV Inc.; Sevens National Franchisees Association Inc.; Shelford Tennis Club Inc.; Shepparton FX & FJ Club Inc.; Shido-Kan Australia Inc.; Shipping Friends for Kids Inc.; Sikh Society of Australia Inc.; Sir Charles Darling Social and Recreation Club Inc.; Sky Lark Productions Inc.; Smart Movers Business & Breakfast Inc.; Smilevo 1903 Dame Gruev Social Club Inc.; Society for Ancient Hellenic Studies Inc.; Soldiers Hill Railway Society Inc.; Somali Community TV Network Inc.; Somali Council Care Inc.; Somalia Bantu Organisation Australia Inc.; Somaliland Community Association of Australia Inc.; South Asian Journalists Association of Australia Inc.; South Eastern Angels Softball Club Inc.; South West Ski Club Inc.; South Western Old Time Dance Association Inc.; South-Eastern Quarter Horse Association Inc.; Southern Peninsula Off Road Track and Race Track Inc.; Southwest Mini Moto Club Inc.; Springvale Tai-Chi and Qi-Gong Association Inc.; Sri Lanka Welfare Association for Whittlesea, Morland & Hume Region Inc.; Sri Lankan Humanitarian and Migration Association Inc.; St Mark's Anglican Parish of Mill Park Life Care Ministries Inc.; St. George Coptic Orthodox Youth's Association Inc.; Star and Sky Soccer Club Inc.; Stawell Pool Association Incorporated; Stevensville Netball Assoc Inc.; Sudan Liaison Organisation in Australia Inc.; Sudanese Women Group of Victoria Inc.; Sudanese Youth Group Inc.; Sunbury Indoor Soccer Association Inc.; Sunbury Street Safe Inc.; Sunraysia Irrigators Council Inc.; Sunshine Fruit & Nut Botanical Park Inc.; Sutton Grange Tennis Club Inc.; Taller Alerce Cultural Workshop Inc.; Tamil Coordinating Committee Australia Inc.; Tarrawingee Tennis Club Inc.; Team Adrenaline Inc.; Team Africa Inc.; Teke Langi O Nasaleti Inc.; Thai Restaurant Association of Victoria Inc.; That's Fishing Productions Inc.; The Australian And New Zealand Modapts Association Inc.; The Australian Hull Inc.; The Australian Lebanese Assoc. for the Disabled Inc.; The Birman And Semi-Longhair Cat Club

Inc.; The Bollies Community Business Awards Inc.; The Cat Judges Association of Victoria Inc.; The Centenary of Chinese Film Celebrations Committee Australia Inc.; The Centre for Awate for Studies and Information Services Inc.; The Combined Coastal Villages Group Inc.; The Corryong Junior Charity Rodeo Inc.; The Egyptian Federation of Victoria Inc.; The Festa Group Inc.; The Lhasa Apso Club of Victoria Inc.; The Mayone Bulluk Community Association Inc.; The Melbourne Elgar Festival Inc.; The Melbourne Shakespeare Festival Inc.; The Melbourne Wine Society Inc.; The Melton Attention Deficit Disorder Support Group Inc.; The Moonee Ponds Residents Association Inc.; The National Australian Lebanese Nomoor Al Harar Association – Australia – New Zealand Inc.; The Oasis Community Church Inc.; The Pam Pearling Lugger Restoration Project Inc.; The Polar Bears Women's Ice Hockey Team Inc.; The Rising Sun Assembly Incorporated; The Robe to Bendigo Golden Trail Inc.; The Tyabb Baseball Club Inc.; The Victorian Pronto User Group Inc.; The Vietnamese Health Sciences Students Association of Victoria Inc.; Thoroughbreds Cricket Club Inc.; Tongan Australian Association Inc.; Tyabb Playgroup Inc.; United Somali Organization in Australia Inc.; Victorian Cambodian Development Committee Inc.; Victorian Chinese Golf Association Inc.; Victorian Chinese Memorial Foundation Inc.; Victorian Downhill Mountain Bike Series Inc.; Victorian Fishing Charter Association Inc.; Victorian Missing Persons Committee Inc.; Victory Outreach Inc.; Vlach Association of Australia (Aromaneasca Sotsata) Inc.; WACD Working Against Culpable Driving Inc.; Warragul Rodeo Committee Inc.; Werribee River Recovery Inc.; Western Boomers Basketball Club Inc.; Western Metropolitan Fringe Association Inc.; Western Zone Wrasse Association Inc.; Wheelers Hill Cricket Club Inc.; Whiteline Riders Motorcycle Club Orbost Inc.; Whittlesea Business Link Inc.; Wildlife Protective Society Inc.; Wolakota Australia Inc.; Womens Ice Hockey Victoria Inc.; Wyndham City Netball Club; Young Dancers Inc.; Youth United Soccer Club Inc.

Dated 19 September 2019

DAVID JOYNER
Deputy Registrar of
Incorporated Associations
PO Box 4567
Melbourne, Victoria 3001

Co-operatives National Law (Victoria)

NARRE WARREN SOUTH P-12 COLLEGE
CO-OPERATIVE LTD

On application under section 601AA of the **Corporations Act 2001** (the Act), notice is hereby given under section 601AA(4A) of the Act, as applied by section 453(a) of the **Co-operatives National Law (Victoria)**, that, at the expiration of two months from the date of this notice, the name of the co-operative listed above will, unless cause is shown to the contrary, be removed from the register of co-operatives and its registration will be dissolved.

Dated at Melbourne 19 September 2019

DAVID JOYNER
Deputy Registrar of Cooperatives

Building Act 1993

Pursuant to Part 17 of the Building Regulations 2018, a Certificate of Accreditation (V18/01-A2) has been issued to Allstate Polystyrene Industries, 26-28 Elliot Road, Dandenong, Victoria 3175, for the Statewall External Wall Cladding System.

The Building Regulations Advisory Committee established under Division 4 of Part 12 of the **Building Act 1993**, after examination of an application for accreditation of the Statewall External Wall Cladding System as being suitable as an external wall system has determined that the Statewall External Wall Cladding System complies with the following Performance Requirements of the National Construction Code Volume Two – Building Code of Australia Class 1 and Class 10 buildings

Performance Requirements P2.1.1, P2.2.2 and P2.2.3

as adopted by the Building Regulations 2018, to the extent that those clauses refer to the structural performance of external walls, resistance to wind action and rainwater action, and weatherproofing, and damp-proofing of external wall systems.

Conditions for use of the product are provided on the Certificate.

JOHN SHAW
Secretary
Building Regulation Advisory Committee

Building Act 1993

Pursuant to Part 17 of the Building Regulations 2018, a Certificate of Accreditation for Bradford Cavity Wall Insulation number V07/05, issued 21 November 2007, has been revoked by the Building Regulations Advisory Committee. The Building Regulations Advisory Committee established under Division 4 of Part 12 of the **Building Act 1993**, revoked the Certificate on the request of the Certificate holder, CSR Bradford Insulation, pursuant to regulation 247 of the Building Regulations 2018. CSR Bradford Insulation sought the revocation due to the accredited product no longer being manufactured.

JOHN SHAW
Secretary
Building Regulations Advisory Committee

Building Act 1993

Pursuant to Part 17 of the Building Regulations 2018, four Certificates of Accreditation have been revoked. The Building Regulations Advisory Committee established under Division 4 of Part 12 of the **Building Act 1993** revoked the four Certificates on the request of the Certificate holder, RMAX Pty Ltd, pursuant to regulation 247 of the Building Regulations 2018. RMAX sought the revocation due to the accredited products no longer being manufactured. The revoked Certificates are:

RMAX Orangeboard External Polystyrene Insulated Cladding System – Certificate No. V10/03A issued 13 October 2010

RMAX ThermaWallplus External Insulated Cladding – Certificate No. V11/01 issued 24 January 2011

RMAX ThermaWall External Insulated Cladding – Certificate No. V11/07 issued 1 December 2011

RMAX ThermaWall Plus Silver, ThermaWall Silver and ThermaSilver Board External Insulated Cladding – Certificate No. V12/01 issued 6 June 2012.

JOHN SHAW
Secretary
Building Regulations Advisory Committee

Country Fire Authority Act 1958**DECLARATION OF FIRE DANGER PERIOD**

In pursuance of the powers conferred by section 4 of the **Country Fire Authority Act 1958**, I, Steven Warrington, Chief Officer of the Country Fire Authority, after consultation with

the Secretary to the Department of Environment, Land, Water and Planning, hereby declare the following periods to be the Fire Danger Period in the municipal districts of the municipalities or parts of municipalities specified, commencing on the dates shown and, unless varied by subsequent declaration, ending at 0100 hours on 1 May 2020.

To commence from 0100 hours on 23 September 2019:

- East Gippsland Shire Council.

STEVEN WARRINGTON AFSM
Chief Officer

Geographic Place Names Act 1998

NOTICE OF REGISTRATION OF GEOGRAPHIC NAMES

The Registrar of Geographic Names hereby gives notice of the registration of the undermentioned place names.

Road Naming:

Change Request Number	Road Name	Locality	Naming Authority and Location
125197	Blake Lane	Kew	Boroondara City Council The road traverses east from High Street South.
125197	Halfey Lane	Kew	Boroondara City Council The road traverses west from Denmark Street.

Feature Naming:

Change Request Number	Place Name	Naming Authority and Location
124003	Dooliebeal Reserve	Greater Geelong City Council (formerly known as Stewarts Reserve) Located at 105 Stewarts Road, Armstrong Creek. For further details see map at www.delwp.vic.gov.au/namingplaces

Geographic Names Victoria

Land Use Victoria

2 Lonsdale Street

Melbourne 3000

CRAIG L. SANDY
Registrar of Geographic Names

Crown Land (Reserves) Act 1978

ORDER GIVING APPROVAL TO GRANT A LICENCE UNDER SECTIONS 17B AND 17BA

Under section 17B and 17BA of the **Crown Land (Reserves) Act 1978**, I, the Hon. Lily D’Ambrosio MP, Minister for Energy, Environment and Climate Change, being satisfied that there are special reasons which make the granting of a licence reasonable and appropriate in the particular circumstances and to do this will not be substantially detrimental to the use and enjoyment of any adjacent land reserved under the **Crown Land (Reserves) Act 1978**, approve the granting of a licence by the Melbourne City Council as committee of management over the Lynch’s Bridge Historical Precinct Reserve described in the schedule below for the purpose of a communal food garden space including growing, cultivating and management of garden beds for the local community and associated activities and, in accordance with section 17B(3)(a) of the **Crown Land (Reserves) Act 1978**, state that:

- (a) there are special reasons which make granting of a licence reasonable and appropriate in the particular circumstances; and
- (b) to do this will not be substantially detrimental to the use and enjoyment of any adjacent land reserved under the **Crown Land (Reserves) Act 1978**.

SCHEDULE

The land shown hatched and bold black line on the attached plan, which is part of the Crown land temporarily reserved for the purposes of conservation of an area of historic interest by Order in Council of 5 July 1988 (vide Government Gazette 13 July 1988, page 2097).

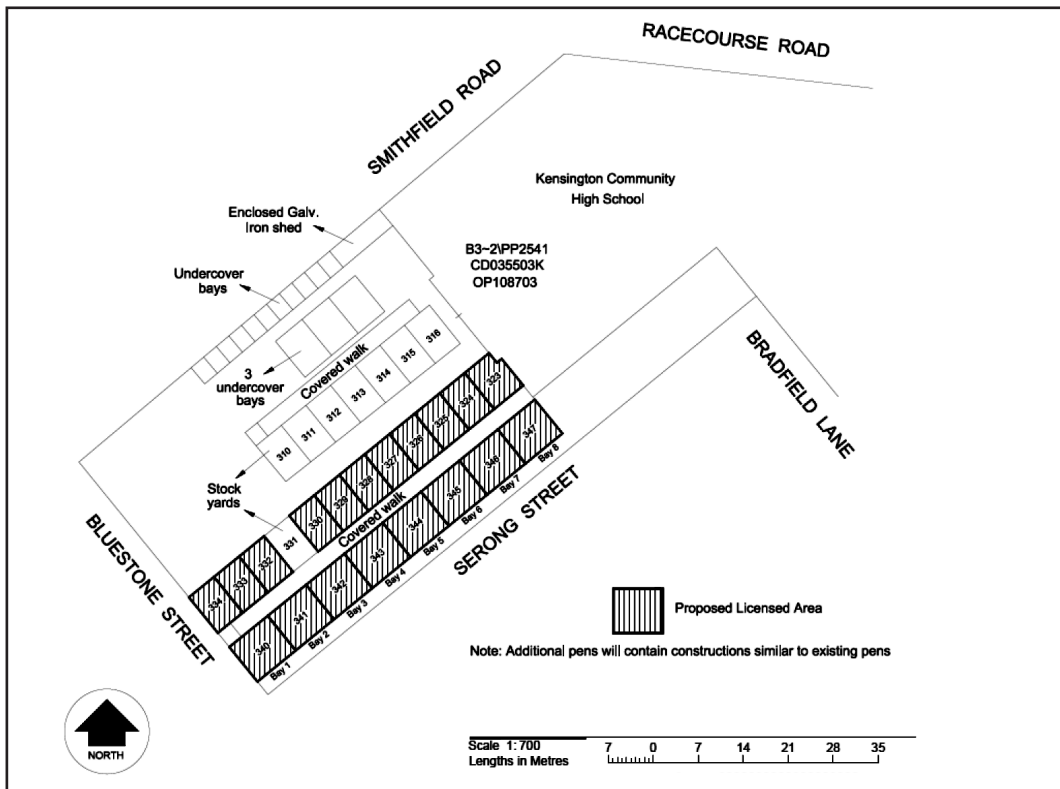

1204748

Dated 4 September 2019

LILY D’AMBROSIO MP
Minister for Energy, Environment and Climate Change

Food Act 1984**REVOCATION OF REGISTRATION OF A FOOD SAFETY PROGRAM TEMPLATE**

I, Dr Milena Canil, as delegate of the Secretary to the Department of Health and Human Services

- (a) noting that the **Pizza Capers Food Safety Program template Version 1** was registered under section 19DB of the **Food Act 1984** (the Act) in a notice published in the Government Gazette on 14 August 2014;
- (b) revoke the registration of that food safety program template under section 19DB of the Act.

This revocation takes effect on the date this notice is published in the Government Gazette.

DR MILENA CANIL
Senior Manager
Food Safety Unit

Health Services Act 1988**HEALTH PURCHASING VICTORIA****Notice of Purchasing Policy Exemptions**

Pursuant to section 134A of the **Health Services Act 1988**, Health Purchasing Victoria (HPV) now grants exemption from the requirements specified at subsections 2.4(a), 2.4(b) and 2.4(d) of the HPV Collective Purchasing Policy (Policy) for the public hospital or class of public hospital as specified in the table below, and only in relation to the named HPV collective agreement and category:

HPV collective agreement	Category	Public hospital or class of public hospital	Reason (Policy reference)	Exemption duration
Operating Room and Wound Drainage Consumables (HPVC2017-057)	18.01 – Embolectomy Catheters	Alfred Health	Clinical grounds (2.17(b))	12 months
Operating Room and Wound Drainage Consumables (HPVC2017-057)	18.01 – Embolectomy Catheters	Austin Health	Clinical grounds (2.17(b))	12 months

This exemption become effective from the date of publication in the Government Gazette and ceases as per the exemption duration specified above.



Marine Safety Act 2010
Section 208(2)

NOTICE OF BOATING ACTIVITY EXCLUSION ZONE

Loddon Shire Council as the declared waterway manager for the Loddon River at Bridgewater between Flour Mill Weir and Sweeneys Lane, hereby gives notice under section 208(2) of the **Marine Safety Act 2010** that the waters of the Loddon River, between the Calder Highway Bridge and the boat ramp at Sweeneys Lane, are prohibited to all persons and vessels not registered to take part in the 2019 Tournament Water Ski Victoria Junior Development Ski Clinic.

The exclusion zone will be in effect from 7.30 am to 5.00 pm between 30 September and 3 October 2019.

Dated 4 September 2019

BY ORDER OF LODDON SHIRE COUNCIL

Public Health and Wellbeing Act 2008

ORDER UNDER SECTION 33 OF THE
PUBLIC HEALTH AND WELLBEING ACT 2008

The Victorian Perioperative Consultative Council

I, Hon. Jenny Mikakos MP, Minister for Health, acting under section 33 of the **Public Health and Wellbeing Act 2008** (the Act), by Order:

Appoint in accordance with sections 33(3), 33(4)(a) and 33(5) of the Act the following person to the Victorian Perioperative Consultative Council (being the Council established by the Order of the Hon. Jenny Mikakos MP, Minister for Health, dated 6 June 2019):

Name	Title	Term of Appointment
Professor David A. Watters	Member and Chairperson	Date of publication until 31 July 2022

Remuneration of Professor Watters shall be in accordance with the Act and the Public Health and Wellbeing Regulations 2009 and the *Appointment and Remuneration Guidelines* issued by the Department of Premier and Cabinet.

JENNY MIKAKOS MP
Minister for Health

Public Holidays Act 1993

I, Adem Somyurek, Minister for Small Business, under section 8 of the **Public Holidays Act 1993**, declare –

- Tuesday 5 November 2019 is not a public holiday for the townships and surrounding localities of Clunes, Creswick, Smeaton and Newlyn in Hepburn Shire.
- Friday 8 November 2019 is appointed a full-day public holiday for the townships and surrounding localities of Clunes, Creswick, Smeaton and Newlyn in Hepburn Shire.

Dated 10 September 2019

HON. ADEM SOMYUREK MP
Minister for Small Business



Subordinate Legislation Act 1994

NOTICE OF AMENDMENTS TO
AUSTRALIAN RULES OF HARNESS RACING (ARHR)

Notice is hereby given under section 16A(2) of the **Subordinate Legislation Act 1994** of the making of amendments to the ARHR, made by Harness Racing Victoria under section 49 of the **Racing Act 1958**.

Details of the amendments to the ARHR may be obtained by contacting Harness Racing Victoria, Integrity Department: (in person) 400 Epsom Road, Flemington; or (by mail) PO Box 184, Moonee Ponds 3039.

Water Act 1989

GOULBURN–MURRAY WATER CONNECTIONS PROJECT

Notice of Adoption of a Reconfiguration Plan

LV16 RP01

TO32 RP16

On 4 September 2019, the Connections Reconfiguration Committee, being a committee established by Goulburn–Murray Water under the **Water Act 1989**, determined to adopt Reconfiguration Plan LV16 RP01 and Reconfiguration Plan TO32 RP16.

A copy of each Reconfiguration Plan map can be inspected, free of charge, at the Goulburn–Murray Water website at www.connectionsproject.com.au and free of charge, during office hours, at the offices of the Goulburn–Murray Water Connections Project, 55 Welsford Street, Shepparton.

FRANK FISSELER
Project Director
Connections Project
Goulburn–Murray Water

Water Act 1989

GOULBURN–MURRAY WATER CONNECTIONS PROJECT

Notice of Adoption of a Reconfiguration Plan

MV22 RP01

TO16 RP01

CG37 RP01

On 11 September 2019, the Connections Reconfiguration Committee, being a committee established by Goulburn–Murray Water under the **Water Act 1989**, determined to adopt Reconfiguration Plan MV22 RP01, Reconfiguration Plan TO16 RP01 and Reconfiguration Plan CG37 RP01.

A copy of each Reconfiguration Plan map can be inspected, free of charge, at the Goulburn–Murray Water website at www.connectionsproject.com.au and free of charge, during office hours, at the offices of the Goulburn–Murray Water Connections Project, 55 Welsford Street, Shepparton.

FRANK FISSELER
Project Director
Connections Project
Goulburn–Murray Water



Water Act 1989

GOULBURN-MURRAY RURAL WATER CORPORATION

Extension of Goulburn-Murray Irrigation District and East Loddon Piped District

Notice is hereby given that Goulburn-Murray Rural Water Corporation intends to extend the Goulburn-Murray Irrigation District and East Loddon Piped District by including the lands described below and shown on Plan Number GMW505, GMW506, GMW507 and GMW508.

DESCRIPTION OF LANDS TO BE INCLUDED IN THE GOULBURN-MURRAY IRRIGATION DISTRICT AND EAST LODDON PIPED DISTRICT

Volume	Folio	Lot No. / Crown Allotment	Plan No. / Section	Parish	Area (Ha)
10902	201	CA 5	18	Yarrayne	45.30
10902	201	CA 8	5	Salisbury	25.70
10902	202	1, 2 and 3	TP867537	Yarrayne	120.2
10902	202	CA 7	5	Salisbury	45.40
10122	965	CA 2	21	Yarrayne	44.30
10122	966	1	TP282	Yarrayne	47.30
10122	964	CA 5	21	Yarrayne	38.50
8706	215	CA 1A, 2A, 1B and 2B	12	Yarrayne	235.4
8706	215	CA 4, 5, 6 and 7	4	Salisbury	238.2
6615	902	CA 12B and CA 12C	C	Bael Bael	106.9
9503	585	CA 12A and CA 12D	C	Bael Bael	119.4
3039	609	CA 5	C	Bael Bael	129.70
3016	99	CA 6	C	Bael Bael	132.20
8035	958	CA 10A	1	Korrak Korrak	127.70
8045	384	CA 4	C	Bael Bael	159.50
10726	523	2	PS513241S	Bael Bael	210.50
10726	522	1	PS513241S	Korrak Korrak	321.30
5263	409	CA 4A	C	Bael Bael	44.50
8074	646	CA 8	1	Korrak Korrak	128.00
8074	647	CA 7A	C	Bael Bael	126.20
8074	645	CA 7	1	Korrak Korrak	129.90
8074	648	CA 7B	C	Bael Bael	128.90
7079	714	CA 31	1	Korrak Korrak	170.30
9425	211	CA 30	1	Korrak Korrak	144.70
4797	362	CA 1	1	Korrak Korrak	3.90

Volume	Folio	Lot No. / Crown Allotment	Plan No. / Section	Parish	Area (Ha)
3347	217	CA 2	1	Korrak Korrak	130.20
8593	884	CA 6A	1	Korrak Korrak	129.40
3347	218	CA 3	1	Korrak Korrak	129.20
8035	959	CA 11	1	Korrak Korrak	132.70
8035	960	CA 20A and CA 20	C	Bael Bael	248.40
3257	322	CA 4	A	Karramomus	81.80
3257	308	1	TP744968M	Karramomus	21.38
4038	594	1	TP392961L	Kinypanial	135.16
4038	595	1	TP247064G	Kinypanial	121.86
10472	168	2	PS430694N	Kinypanial	177.46

The Corporation invites submissions in respect to the proposal. Any submissions should set out the grounds on which the submission is made and may be received by the Corporation within one month of publication of this notice in the Victoria Government Gazette. A copy of the proposal may be inspected, free of charge, at the office of Goulburn Murray Rural Water Corporation, 40 Casey Street, Tatura, during business hours.

FABIAN McCLOY
Head of Customer and Community

AGREEMENT FOR THE MELBOURNE CITY LINK AND AGREEMENT FOR THE
EXHIBITION STREET EXTENSION PROJECT

Notice under Schedule 4 of the Agreement for Integrating and Facilitating the Project and the Exhibition Street Extension Project between the Crown in right of the State of Victoria, CityLink Melbourne Limited, Transurban Infrastructure Management Limited and City Link Extension Pty Limited (the 'IFA') (as substituted for (and as if incorporated in lieu of) Schedule 3 of the Agreement for the Melbourne City Link between the Crown in right of the State of Victoria, CityLink Melbourne Limited and Transurban Infrastructure Management Limited (the 'Concession Deed') and Schedule 1 of the Agreement for the Exhibition Street Extension Project between the Crown in right of the State of Victoria and City Link Extension Pty Limited ('the ESEP Deed')).

CityLink Melbourne Limited (ABN 65 070 810 678) (for itself and as agent of City Link Extension Pty Limited (ABN 40 082 058 615)) ('CityLink Melbourne') gives notice of the following Charge Tolls, Maximum Charge Tolls, Day Tolls, Taxi Tolls and Taxi Day Tolls for the Melbourne City Link and the Exhibition Street Extension:

Schedule of Charge Tolls and Maximum Charge Tolls

Category of Vehicle	Car	Light Commercial Vehicle	Heavy Commercial Vehicle – Day	Heavy Commercial Vehicle – Night	Motor Cycle
Tollable Section					
Tullamarine Freeway Upgrade, between Moreland Road and Brunswick Road	2.54	4.07	7.63	5.09	1.27
Western Link Section 1, between Racecourse Road and Dynon Road	2.54	4.07	7.63	5.09	1.27
Western Link Section 2, between Footscray Road and West Gate Freeway	3.18	5.09	9.55	6.37	1.59
Domain Tunnel and that part of the Southern Link leading into that Tunnel between the eastern portal of that Tunnel and Punt Road, other than that part of Southern Link Section 1:	3.18	5.09	9.55	6.37	1.59
(a) between Punt Road and the exit to Boulton Parade; and					
(b) comprising Boulton Parade					
Burnley Tunnel and that part of the Southern Link leading out of that Tunnel between the eastern portal of that Tunnel and Burnley Street	5.73	9.16	17.18	11.45	2.86
Southern Link Section 1, between Burnley Street and Punt Road and including that part of Southern Link Section 1:	2.54	4.07	7.63	5.09	1.27
(a) between Punt Road and the exit to Boulton Parade; and					
(b) comprising Boulton Parade					
Southern Link Section 5, between Punt Road and Burnley Street other than that part of the Southern Link leading out of the Burnley Tunnel between the eastern portal of that Tunnel and Burnley Street	2.54	4.07	7.63	5.09	1.27
Southern Link Section 1, between Glenferrie Road and Burnley Street	2.54	4.07	7.63	5.09	1.27
Southern Link Section 5, between Burnley Street and Glenferrie Road	2.54	4.07	7.63	5.09	1.27
Exhibition Street Extension	1.59	2.55	4.77	3.18	0.80

Southern Link Section 1, between Punt Road and Swan Street Intersection, other than: (a) that part of Southern Link Section 1: (i) between Punt Road and the exit to Boulton Parade; and (ii) comprising Boulton Parade; and (b) that part of the Southern Link leading into the Domain Tunnel between the eastern portal of that Tunnel and Punt Road	1.59	2.55	4.77	3.18	0.80
Southern Link Section 5, between Swan Street Intersection and Punt Road	1.59	2.55	4.77	3.18	0.80

Notes:

1. When travelling on Southern Link Section 1 between Burnley Street and Punt Road and then onto Batman Avenue, the Tollable Sections may be combined for the purposes of levying Tolls.
2. When travelling on Southern Link Section 1 and into the Domain Tunnel, the Tollable Sections may be combined for the purposes of levying Tolls.
3. A reference in the description of a Tollable Section to a part of the Southern Link between a particular street or road and Burnley Street, includes that part of the Southern Link between that particular street or road and where Burnley Street would cross the Southern Link if Burnley Street continued in a straight southerly direction from its southernmost extremity.
4. In this table:
 - ‘Heavy Commercial Vehicle – Day’ refers to where the passage of the Heavy Commercial Vehicle on the Tollable Section occurs between 6.00 am and 8.00 pm.
 - ‘Heavy Commercial Vehicle – Night’ refers to where the passage of the Heavy Commercial Vehicle on the Tollable Section occurs between 8.00 pm and 6.00 am.
 - ‘Boulton Parade’ includes the off-ramp connecting the rest of the Southern Link to Boulton Parade;
 - ‘Burnley Tunnel’ means the eastbound tunnel between Sturt Street and Burnley Street;
 - ‘Domain Tunnel’ means the westbound tunnel between Punt Road and Sturt Street; and
 - ‘Swan Street Intersection’ means the intersection between Swan Street and Batman Avenue.

Maximum Charge Tolls (\$/vehicle)

Category of Vehicle	Car	Light Commercial Vehicle	Heavy Commercial Vehicle	Motor Cycle
Trips where the passage of the Vehicle on the last Tollable Section comprising the Trip before exiting the Total Link occurs between 6.00 am and 8.00 pm	9.55	15.27	28.64	4.77
Trips where the passage of the Vehicle on the last Tollable Section comprising the Trip before exiting the Total Link occurs between 8.00 pm and 6.00 am	9.55	15.27	19.09	4.77

Day Tolls (\$/vehicle)

Category of Vehicle	Car	Light Commercial Vehicle	Heavy Commercial Vehicle	Motor Cycle
Day Toll	18.31	39.71	73.98	9.16

Taxi Tolls (\$/Taxi)

Trip	Taxi Toll
Trips involving use of any or all of the Tollable Sections which comprise the Western Link* and no other Tollable Sections	6.40
Trips involving use of any or all of the Tollable Sections which comprise the Southern Link** and/or Exhibition Street Extension*** and no other Tollable Sections	6.40
Trips involving use of Tollable Sections which comprise both the Western Link* and either or both of the Southern Link** and the Exhibition Street Extension***	8.45

* The Western Link comprises the following three Tollable Sections:

1. Tullamarine Freeway Upgrade, between Moreland Road and Brunswick Road.
2. Western Link Section 1, between Racecourse Road and Dynon Road.
3. Western Link Section 2, between Footscray Road and West Gate Freeway.

** The Southern Link comprises the following eight Tollable Sections:

1. Domain Tunnel and that part of the Southern Link leading into that Tunnel between the eastern portal of that Tunnel and Punt Road, other than that part of Southern Link Section 1:
 - (a) between Punt Road and the exit to Boulton Parade; and
 - (b) comprising Boulton Parade.

2. Southern Link Section 1, between Burnley Street and Punt Road and including that part of Southern Link Section 1:
 - (a) between Punt Road and the exit to Boulton Parade; and
 - (b) comprising Boulton Parade.
3. Southern Link Section 5, between Punt Road and Burnley Street other than that part of the Southern Link leading out of the Burnley Tunnel between the eastern portal of that Tunnel and Burnley Street.
4. Burnley Tunnel and that part of the Southern Link leading out of that Tunnel between the eastern portal of that Tunnel and Burnley Street.
5. Southern Link Section 1, between Glenferrie Road and Burnley Street.
6. Southern Link Section 5, between Burnley Street and Glenferrie Road.
7. Southern Link Section 1, between Punt Road and Swan Street Intersection, other than:
 - (a) that part of Southern Link Section 1:
 - (i) between Punt Road and the exit to Boulton Parade; and
 - (ii) comprising Boulton Parade; and
 - (b) that part of the Southern Link leading into the Domain Tunnel between the eastern portal of that Tunnel and Punt Road.
8. Southern Link Section 5, between Swan Street Intersection and Punt Road.

*** The Exhibition Street Extension comprises the following Tollable Section:

1. Exhibition Street Extension.

Taxi Day Tolls (\$/Taxi)

Taxi	Taxi Day toll
Metropolitan Taxi	18.31
A Taxi not being a Metropolitan Taxi	7.00

CityLink Melbourne intends that each Charge Toll, Maximum Charge Toll, Day Toll, Taxi Toll and Taxi Day Toll specified above will first apply in the quarter ending 31 December 2019.

Capitalised terms in this notice that are defined in:

- (a) the Concession Deed have, subject to paragraph (b), that meaning in this notice;
- (b) the ESEP Deed have that meaning in this notice, but only to the extent that the provision applies to the ESEP Deed, subject to the provisions of the IFA.

A. L. STREET
 Company Secretary
 CityLink Melbourne Limited
 (ABN 65 070 810 678)

W. D. BALLANTINE
 Director
 CityLink Melbourne Limited
 (ABN 65 070 810 678)

AGREEMENT FOR THE EXHIBITION STREET EXTENSION PROJECT

Notice under Schedule 1 of the Agreement for the Exhibition Street Extension Project between the Crown in right of the State of Victoria and City Link Extension Pty Limited (the 'ESEP Deed').

City Link Extension Pty Limited (ABN 40 082 058 615) ('Clepcó') gives notice of the following Charge Tolls for the Exhibition Street Extension:

Charge Tolls (\$/vehicle)

Category of Vehicle	Car	Light Commercial Vehicle	Heavy Commercial Vehicle – Day	Heavy Commercial Vehicle – Night	Motor Cycle
Tollable Section					
Exhibition Street Extension	1.59	2.55	4.77	3.18	0.80

Note:

In this table:

'Heavy Commercial Vehicle – Day' refers to where the passage of the Heavy Commercial Vehicle on the Tollable Section occurs between 6.00 am and 8.00 pm.

'Heavy Commercial Vehicle – Night' refers to where the passage of the Heavy Commercial Vehicle on the Tollable Section occurs between 8.00 pm and 6.00 am.

Clepcó intends that these Charge Tolls will first apply in the quarter ending 31 December 2019.

Capitalised terms in this notice that are defined in the ESEP Deed have the same meaning as given by the ESEP Deed.

A. L. STREET
 Company Secretary
 City Link Extension Pty Limited
 ABN 40 082 058 615

W. D. BALLANTINE
 Director
 City Link Extension Pty Limited
 ABN 40 082 058 615

AGREEMENT FOR THE MELBOURNE CITY LINK

Notice under Schedule 3 of the Agreement for the Melbourne City Link between the Crown in right of the State of Victoria, CityLink Melbourne Limited and Transurban Infrastructure Management Limited (the 'Concession Deed').

CityLink Melbourne Limited (ABN 65 070 810 678) ('CityLink Melbourne') gives notice of the following Charge Tolls, Maximum Charge Tolls, Day Tolls, Taxi Tolls and Taxi Day Tolls for the Melbourne City Link:

Charge Tolls (\$/vehicle)

Category of Vehicle	Car	Light Commercial Vehicle	Heavy Commercial Vehicle – Day	Heavy Commercial Vehicle – Night	Motor Cycle
Tollable Section					
Tullamarine Freeway Upgrade, between Moreland Road and Brunswick Road	2.54	4.07	7.63	5.09	1.27
Western Link Section 1, between Racecourse Road and Dynon Road	2.54	4.07	7.63	5.09	1.27
Western Link Section 2, between Footscray Road and West Gate Freeway	3.18	5.09	9.55	6.37	1.59
Domain Tunnel and that part of the Southern Link leading into that Tunnel between the eastern portal of that Tunnel and Punt Road, other than that part of Southern Link Section 1:	3.18	5.09	9.55	6.37	1.59
(a) between Punt Road and the exit to Boulton Parade; and					
(b) comprising Boulton Parade					
Burnley Tunnel and that part of the Southern Link leading out of that Tunnel between the eastern portal of that Tunnel and Burnley Street	5.73	9.16	17.18	11.45	2.86
Southern Link Section 1, between Burnley Street and Punt Road and including that part of Southern Link Section 1:	2.54	4.07	7.63	5.09	1.27
(a) between Punt Road and the exit to Boulton Parade; and					
(b) comprising Boulton Parade					

Southern Link Section 5, between Punt Road and Burnley Street other than that part of the Southern Link leading out of the Burnley Tunnel between the eastern portal of that Tunnel and Burnley Street	2.54	4.07	7.63	5.09	1.27
Southern Link Section 1, between Glenferrie Road and Burnley Street	2.54	4.07	7.63	5.09	1.27
Southern Link Section 5, between Burnley Street and Glenferrie Road	2.54	4.07	7.63	5.09	1.27
Southern Link Section 1, between Punt Road and Swan Street Intersection, other than:	1.59	2.55	4.77	3.18	0.80
(a) that part of Southern Link Section 1:					
(i) between Punt Road and the exit to Boulton Parade; and					
(ii) comprising Boulton Parade; and					
(b) that part of the Southern Link leading into the Domain Tunnel between the eastern portal of that Tunnel and Punt Road					
Southern Link Section 5, between Swan Street Intersection and Punt Road	1.59	2.55	4.77	3.18	0.80

Notes:

- When travelling on Southern Link Section 1 between Burnley Street and Punt Road and then onto Batman Avenue, the Tollable Sections may be combined for the purposes of levying Tolls.
- When travelling on Southern Link Section 1 and into the Domain Tunnel, the Tollable Sections may be combined for the purposes of levying Tolls.
- A reference in the description of a Tollable Section to a part of the Southern Link between a particular street or road and Burnley Street, includes that part of the Southern Link between that particular street or road and where Burnley Street would cross the Southern Link if Burnley Street continued in a straight southerly direction from its southernmost extremity.
- In this table:
 - ‘Heavy Commercial Vehicle – Day’ refers to where the passage of the Heavy Commercial Vehicle on the Tollable Section occurs between 6.00 am and 8.00 pm.
 - ‘Heavy Commercial Vehicle – Night’ refers to where the passage of the Heavy Commercial Vehicle on the Tollable Section occurs between 8.00 pm and 6.00 am.
 - ‘Boulton Parade’ includes the off-ramp connecting the rest of the Southern Link to Boulton Parade;
 - ‘Burnley Tunnel’ means the eastbound tunnel between Sturt Street and Burnley Street;
 - ‘Domain Tunnel’ means the westbound tunnel between Punt Road and Sturt Street; and
 - ‘Swan Street Intersection’ means the intersection between Swan Street and Batman Avenue.

Maximum Charge Tolls (\$/vehicle)

Category of Vehicle	Car	Light Commercial Vehicle	Heavy Commercial Vehicle	Motor Cycle
Trips where the passage of the Vehicle on the last Tollable Section comprising the Trip before exiting the Link occurs between 6.00 am and 8.00 pm	9.55	15.27	28.64	4.77
Trips where the passage of the Vehicle on the last Tollable Section comprising the Trip before exiting the Link occurs between 8.00 pm and 6.00 am	9.55	15.27	19.09	4.77

Day Tolls (\$/vehicle)

Category of Vehicle	Car	Light Commercial Vehicle	Heavy Commercial Vehicle	Motor Cycle
Day Toll	18.31	39.71	73.98	9.16

Taxi Tolls (\$/Taxi)

Trip	Taxi Toll
Trips involving use of any or all of the Tollable Sections which comprise the Western Link* and no other Tollable Sections	6.40
Trips involving use of any or all of the Tollable Sections which comprise the Southern Link** and no other Tollable Sections	6.40
Trips involving use of Tollable Sections which comprise both the Western Link* and the Southern Link**	8.45

* The Western Link comprises the following three Tollable Sections:

1. Tullamarine Freeway Upgrade, between Moreland Road and Brunswick Road.
2. Western Link Section 1, between Racecourse Road and Dynon Road.
3. Western Link Section 2, between Footscray Road and West Gate Freeway.

** The Southern Link comprises the following eight Tollable Sections:

1. Domain Tunnel and that part of the Southern Link leading into that Tunnel between the eastern portal of that Tunnel and Punt Road, other than that part of Southern Link Section 1:
 - (a) between Punt Road and the exit to Boulton Parade; and
 - (b) comprising Boulton Parade.
2. Southern Link Section 1, between Burnley Street and Punt Road and including that part of Southern Link Section 1:
 - (a) between Punt Road and the exit to Boulton Parade; and
 - (b) comprising Boulton Parade.

3. Southern Link Section 5, between Punt Road and Burnley Street other than that part of the Southern Link leading out of the Burnley Tunnel between the eastern portal of that Tunnel and Burnley Street.
4. Burnley Tunnel and that part of the Southern Link leading out of that Tunnel between the eastern portal of that Tunnel and Burnley Street.
5. Southern Link Section 1, between Glenferrie Road and Burnley Street.
6. Southern Link Section 5, between Burnley Street and Glenferrie Road.
7. Southern Link Section 1, between Punt Road and Swan Street Intersection, other than:
 - (a) that part of Southern Link Section 1:
 - (i) between Punt Road and the exit to Boulton Parade; and
 - (ii) comprising Boulton Parade; and
 - (b) that part of the Southern Link leading into the Domain Tunnel between the eastern portal of that Tunnel and Punt Road.
8. Southern Link Section 5, between Swan Street Intersection and Punt Road.

Taxi Day Tolls (\$/Taxi)

Taxi	Taxi Day toll
Metropolitan Taxi	18.31
A Taxi not being a Metropolitan Taxi	7.00

CityLink Melbourne intends that each Charge Toll, Maximum Charge Toll, Day Toll, Taxi Toll and Taxi Day Toll specified above will first apply in the quarter ending 31 December 2019.

Capitalised terms in this notice that are defined in the Concession Deed have the same meaning as given by the Concession Deed.

A. L. STREET
 Company Secretary
 CityLink Melbourne Limited
 (ABN 65 070 810 678)

W. D. BALLANTINE
 Director
 CityLink Melbourne Limited
 (ABN 65 070 810 678)

Melbourne City Link Act 1995

NOTICE UNDER SECTION 71(1)

Under section 71(1)(b) of the **Melbourne City Link Act 1995** ('the Act'), CityLink Melbourne Limited, ABN 65 070 810 678, (the relevant corporation in relation to the Link road) hereby fixes tolls which are payable in respect of the use of vehicles (as set out herein) on toll zones on the Link road.

For the purposes of this Notice, the following definitions apply:

Boulton Parade includes the off-ramp connecting the rest of the Link road to Boulton Parade;

Burnley Tunnel means the eastbound tunnel between Sturt Street and Burnley Street;

Bus is a Motor Vehicle having more than 12 seating positions (including that of the driver);

Car is a Motor Vehicle, other than:

- (a) a Motor Cycle;
- (b) a Light Commercial Vehicle;
- (c) a Heavy Commercial Vehicle; or
- (d) a Taxi;

even if such a Motor Vehicle is towing a trailer or caravan;

Domain Tunnel means the westbound tunnel between Punt Road and Sturt Street;

Full Link road is the road included within both the Link road and the Extension road;

Full Link Taxi Trip is a Trip by a Taxi on:

- (a) one or more of the toll zones described in this Notice as toll zones 1, 2 and 3; and
- (b) one or more of the toll zones described in this Notice as toll zones 4, 5, 6, 7, 8, 9, 10 and 11;

Half Link Taxi Trip is a Trip by a Taxi on:

- (a) one or more of the toll zones described in this Notice as toll zones 1, 2 and 3; or
- (b) one or more of the toll zones described in this Notice as toll zones 4, 5, 6, 7, 8, 9, 10 and 11, and no other toll zone;

HCV – Day refers to where the passage of the Heavy Commercial Vehicle on the Tollable Section occurs between 6.00 am and 8.00 pm;

HCV – Night refers to where the passage of the Heavy Commercial Vehicle on the Tollable Section occurs between 8.00 pm and 6.00 am;

Heavy Commercial Vehicle or **HCV** is a Motor Vehicle, other than a Taxi, which is:

- (a) a rigid Truck with three or more axles;
- (b) an articulated Truck;
- (c) a Bus; or
- (d) a two-axle rigid Truck having a gross vehicle mass which exceeds 4.5 tonnes;

Light Commercial Vehicle or **LCV** is a Motor Vehicle, other than a Taxi, which is a two-axle rigid Truck having a gross vehicle mass which exceeds 1.5 tonnes, but does not exceed 4.5 tonnes;

Motor Cycle is a two-wheeled Motor Vehicle (and includes such a Motor Vehicle even if it has a trailer, fore car or side car attached) other than a Taxi;

Motor Vehicle is a vehicle which is used or intended to be used on a highway or in a public place and which has its own motive power (other than human or animal power) but does not include:

- (a) a vehicle intended to be used on a railway or tramway; or
- (b) a motorised wheelchair capable of a speed of not more than 10 kilometres per hour which is used solely for the conveyance of an injured or disabled person;

Swan Street Intersection means the intersection between Swan Street and Batman Avenue;

Taxi is, at any particular time, a Motor Vehicle in relation to which a commercial passenger vehicle licence (issued under the **Transport Act 1983**) then subsists, being a licence allowing for the operation of the Motor Vehicle as a Taxi-Cab (within the meaning of the **Transport Act 1983**);

the Agreement has the same meaning as in the Act;

the Integration and Facilitation Agreement has the same meaning as in the Act;

Trip is the passage of a vehicle on one or more toll zones:

- (a) uninterrupted by exit and subsequent re-entry; or
- (b) if so interrupted, the interruption consists only of travel directly between:
 - (i) that part of the Link road between Bulla Road and the West Gate Freeway; and
 - (ii) that part of the Link road between Sturt Street and Glenferrie Road;

Truck is a Motor Vehicle other than a Bus which has a cab-chassis construction and a gross vehicle mass which exceeds 1.5 tonnes; and

vehicle has the same meaning as in the Act.

Under section 71(1)(b) of the Act and in accordance with the Agreement, the tolls listed in Table One are payable in respect of the use of vehicles on toll zones on the Link road, where those vehicles are a Car, a LCV, a HCV or a Motor Cycle:

Toll Zone	Toll				
	Car	LCV	HCV – Day	HCV – Night	Motor Cycle
1. That part of the Link road between Moreland Road and Brunswick Road.	\$2.54	\$4.07	\$7.63	\$5.09	\$1.27
2. That part of the Link road between Racecourse Road and Dynon Road.	\$2.54	\$4.07	\$7.63	\$5.09	\$1.27
3. That part of the Link road between Footscray Road and the West Gate Freeway.	\$3.18	\$5.09	\$9.55	\$6.37	\$1.59
4. That part of the Link road being the Domain Tunnel and that part of the Link road leading into that Tunnel between the eastern portal of that Tunnel and Punt Road, other than that part of the Link road – <ol style="list-style-type: none"> (a) being the eastbound carriageways of the Link road; (b) between Punt Road and the exit to Boulton Parade; and (c) comprising Boulton Parade. 	\$3.18	\$5.09	\$9.55	\$6.37	\$1.59
5. That part of the Link road being the Burnley Tunnel and that part of the Link road leading out of that Tunnel between the eastern portal of that Tunnel and Burnley Street.	\$5.73	\$9.16	\$17.18	\$11.45	\$2.86

6.	That part of the Link road being the eastbound carriageways between Punt Road and Burnley Street other than that part of the Link road being the Burnley Tunnel and that part of the Link road leading out of that Tunnel between the eastern portal of that Tunnel and Burnley Street.	\$2.54	\$4.07	\$7.63	\$5.09	\$1.27
7.	That part of the Link road between Burnley Street and Punt Road and including that part of the Link road – (a) between Punt Road and the exit to Boulton Parade, other than the eastbound carriageways; and (b) comprising Boulton Parade, other than: (i) the eastbound carriageways between Burnley Street and Punt Road; and (ii) that part of the Link road being the Burnley Tunnel and that part of the Link road leading out of that Tunnel between the eastern portal of that Tunnel and Burnley Street.	\$2.54	\$4.07	\$7.63	\$5.09	\$1.27
8.	That part of the Link road being the eastbound carriageways between Burnley Street and Glenferrie Road.	\$2.54	\$4.07	\$7.63	\$5.09	\$1.27
9.	That part of the Link road between Glenferrie Road and Burnley Street, other than the eastbound carriageways.	\$2.54	\$4.07	\$7.63	\$5.09	\$1.27
10.	That part of the Link road being the eastbound carriageways between Swan Street Intersection and Punt Road, other than – (a) that part of the Link road being the Burnley Tunnel; and (b) that part of the Link road comprising Boulton Parade.	\$1.59	\$2.55	\$4.77	\$3.18	\$0.80

11.	That part of the Link road between Punt Road and Swan Street Intersection, other than –	\$1.59	\$2.55	\$4.77	\$3.18	\$0.80
	(a) the eastbound carriageways;					
	(b) that part of the Link road being the Burnley Tunnel;					
	(c) that part of the Link road:					
	(1) between Punt Road and the exit to Boulton Parade; and					
	(2) comprising Boulton Parade; and					
	(d) that part of the Link road being the Domain Tunnel and that part of the Link road leading into that Tunnel between the eastern portal of that Tunnel and Punt Road.					

For the avoidance of doubt, a reference in this Notice to the specification of a toll zone by reference to Burnley Street refers to that point on the Link road where Burnley Street would cross the Link road if Burnley Street continued in a straight southerly direction from its southernmost extremity. For the avoidance of doubt, a reference in this Notice to ‘eastbound’ means in a general easterly direction from the eastern end of the West Gate Freeway towards Glenferrie Road.

Notwithstanding anything to the contrary in Table One, under section 71(1) (b) of the Act and in accordance with the Agreement, the maximum tolls payable in respect of the use of a vehicle on a toll zone on the Link road where that vehicle is a Car, a LCV, a HCV or a Motor Cycle for a Trip are as listed in Table Two:

Table Two					
Trip Cap		Toll			
		Car	LCV	HCV	Motor Cycle
1.	Where the passage of the vehicle on the last toll zone comprising the Trip before exiting the Full Link road occurs between 6 am and 8 pm on the same day.	\$9.55	\$15.27	\$28.64	\$4.77
2.	Where the passage of the vehicle on the last toll zone comprising the Trip before exiting the Full Link road occurs between 8 pm on the one day and 6 am on the next.	\$9.55	\$15.27	\$19.09	\$4.77

Under section 71(1)(b) of the Act, and in accordance with the Agreement, the tolls listed in Table Three are payable in respect of the use of vehicles on toll zones on the Link road where those vehicles are Taxis:

Table Three	
Taxis	Toll
Each Half Link Taxi Trip	\$6.40
Each Full Link Taxi Trip	\$8.45

For the avoidance of doubt, this Notice does not set Charge Tolls, Maximum Charge Tolls or Taxi Tolls for the purposes of Schedule 3 (the Toll Calculation Schedule) of the Agreement, or Schedule 4 (the Toll Calculation Schedule) of the Integration and Facilitation Agreement.

For the avoidance of doubt, this Notice also:

- (i) revokes or repeals; or, in the alternative
- (ii) amends –

the NOTICE UNDER SECTION 71(1) dated 12 June 2019 and published in the Victoria Government Gazette No. G25 (pages 1170 to 1174) dated 20 June 2019 and dated 28 June 2019 and published in the Victoria Government Gazette No. S267 (pages 6 to 8) (collectively ‘the Last Notice’).

This notice takes effect on 1 October 2019 and for the avoidance of doubt, the Last Notice ceases to have effect when this Notice takes effect, and the revocation, repeal, amendment or ceasing to have effect of the Last Notice shall not:

- (a) revive anything not in force or existing at the time at which the revocation, repeal, amendment or ceasing to have effect becomes operative;
- (b) affect the previous operation of the Last Notice or anything duly done or suffered under the Last Notice;
- (c) affect any right, privilege, obligation or liability acquired, accrued or incurred under the Last Notice;
- (d) affect any penalty, forfeiture or punishment incurred in respect of any offence committed relating (directly or indirectly) to or in respect of the Last Notice; or
- (e) affect any investigation, legal proceeding or remedy in respect of any such right, privilege, obligation, liability, penalty, forfeiture or punishment as is mentioned in paragraphs (c) and (d) –

and any such investigation, legal proceeding or remedy may be instituted, continued or enforced, and any such penalty, forfeiture or punishment may be imposed, as if the Last Notice had not been revoked or repealed or amended or had not expired, lapsed or otherwise ceased to have effect.

For the avoidance of doubt, the revocation, repeal, amendment or ceasing to have effect of the Last Notice does not in any way affect the direct amendments made in or by the Last Notice to, or the operation or effect of those amendments to, any NOTICE UNDER SECTION 71(1) published in the Victoria Government Gazette prior to the publication of the Last Notice.

Dated 11 September 2019

A. L. STREET
Company Secretary
CityLink Melbourne Limited
(ABN 65 070 810 678)

W. D. BALLANTINE
Director
CityLink Melbourne Limited
(ABN 65 070 810 678)

Melbourne City Link Act 1995
NOTICE UNDER SECTION 71(1)

Under section 71(1)(b) of the **Melbourne City Link Act 1995** ('the Act'), City Link Extension Pty Limited, ABN 40 082 058 615, (the relevant corporation in relation to the Extension road) hereby fixes tolls which are payable in respect of the use of vehicles (as set out herein) on the toll zone on the Extension road.

For the purposes of this Notice, the following definitions apply:

Bus is a Motor Vehicle having more than 12 seating positions (including that of the driver);

Car is a Motor Vehicle, other than:

- (a) a Motor Cycle;
- (b) a Light Commercial Vehicle;
- (c) a Heavy Commercial Vehicle; or
- (d) a Taxi;

even if such a Motor Vehicle is towing a trailer or caravan;

HCV – Day refers to where the passage of the Heavy Commercial Vehicle on the Tollable Section occurs between 6.00 am and 8.00 pm;

HCV – Night refers to where the passage of the Heavy Commercial Vehicle on the Tollable Section occurs between 8.00 pm and 6.00 am;

Heavy Commercial Vehicle or **HCV** is a Motor Vehicle, other than a Taxi, which is:

- (a) a rigid Truck with three or more axles;
- (b) an articulated Truck;
- (c) a Bus; or
- (d) a two-axle rigid Truck having a gross vehicle mass which exceeds 4.5 tonnes;

Light Commercial Vehicle or **LCV** is a Motor Vehicle, other than a Taxi, which is a two-axle rigid Truck having a gross vehicle mass which exceeds 1.5 tonnes, but does not exceed 4.5 tonnes;

Motor Cycle is a two-wheeled Motor Vehicle (and includes such a Motor Vehicle even if it has a trailer, fore car or side car attached) other than a Taxi;

Motor Vehicle is a vehicle which is used or intended to be used on a highway or in a public place and which has its own motive power (other than human or animal power) but does not include:

- (a) a vehicle intended to be used on a railway or tramway; or
- (b) a motorised wheelchair capable of a speed of not more than 10 kilometres per hour which is used solely for the conveyance of an injured or disabled person;

Taxi is, at any particular time, a Motor Vehicle in relation to which a commercial passenger vehicle licence (issued under the **Transport Act 1983**) then subsists, being a licence allowing for the operation of the Motor Vehicle as a Taxi-Cab (within the meaning of the **Transport Act 1983**);

the Extension Agreement has the same meaning as in the Act;

the Integration and Facilitation Agreement has the same meaning as in the Act;

Truck is a Motor Vehicle other than a Bus which has a cab-chassis construction and a gross vehicle mass which exceeds 1.5 tonnes; and

vehicle has the same meaning as in the Act.

Under section 71(1)(b) of the Act and in accordance with the Extension Agreement, the tolls listed in Table One are payable in respect of the use of vehicles on the toll zone on the Extension road, where those vehicles are a Car, a LCV, a HCV or a Motor Cycle:

Table One					
Toll Zone	Toll				
	Car	LCV	HCV – Day	HCV – Night	Motor Cycle
12. The Extension road	\$1.59	\$2.55	\$4.77	\$3.18	\$0.80

For the avoidance of doubt, this Notice does not set Charge Tolls for the purposes of Schedule 1 (the Toll Calculation Schedule) of the Extension Agreement, or Schedule 4 (the Toll Calculation Schedule) of the Integration and Facilitation Agreement.

For the avoidance of doubt, this Notice also:

- (i) revokes or repeals; or, in the alternative
- (ii) amends –

the NOTICE UNDER SECTION 71(1) dated 12 June 2019 and published in the Victoria Government Gazette No. G25 (pages 1175 to 1176) dated 20 June 2019 ('the Last Notice').

This notice takes effect on 1 October 2019 and for the avoidance of doubt, the Last Notice ceases to have effect when this Notice takes effect, and the revocation, repeal, amendment or ceasing to have effect of the Last Notice shall not:

- (a) revive anything not in force or existing at the time at which the revocation, repeal, amendment or ceasing to have effect becomes operative;
- (b) affect the previous operation of the Last Notice or anything duly done or suffered under the Last Notice;
- (c) affect any right, privilege, obligation or liability acquired, accrued or incurred under the Last Notice;
- (d) affect any penalty, forfeiture or punishment incurred in respect of any offence committed relating (directly or indirectly) to or in respect of the Last Notice; or
- (e) affect any investigation, legal proceeding or remedy in respect of any such right, privilege, obligation, liability, penalty, forfeiture or punishment as is mentioned in paragraphs (c) and (d) –

and any such investigation, legal proceeding or remedy may be instituted, continued or enforced, and any such penalty, forfeiture or punishment may be imposed, as if the Last Notice had not been revoked or repealed or amended or had not expired, lapsed or otherwise ceased to have effect.

For the avoidance of doubt, the revocation, repeal, amendment or ceasing to have effect of the Last Notice does not in any way affect the direct amendments made in or by the Last Notice to, or the operation or effect of those amendments to, any NOTICE UNDER SECTION 71(1) published in the Victoria Government Gazette prior to the publication of the Last Notice.

Dated 11 September 2019

A. L. STREET
Company Secretary
City Link Extension Pty Limited
(ABN 40 082 058 615)

W. D. BALLANTINE
Director
City Link Extension Pty Limited
(ABN 40 082 058 615)

Melbourne City Link Act 1995
NOTICE UNDER SECTION 71(1)

Under section 71(1)(b) of the **Melbourne City Link Act 1995** ('the Act'), CityLink Melbourne Limited, ABN 65 070 810 678, (the relevant corporation in relation to the Link road) ('CityLink Melbourne') hereby fixes tolls which are payable in respect of the use of vehicles on toll zones on the Link road where those vehicles are the subject of a CityLink Pass for that use.

For the purposes of this Notice, the following definitions apply:

Bus is a Motor Vehicle having more than 12 seating positions (including that of the driver);

Car is a Motor Vehicle, other than a Motor Cycle, a Light Commercial Vehicle, a Heavy Commercial Vehicle or a Taxi even if such a Motor Vehicle is towing a trailer or caravan;

CityLink Pass is a 24 Hour Pass, a Tulla Pass or a Weekend Pass;

Full Link road is the road included within both the Link road and the Extension road;

Heavy Commercial Vehicle or **HCV** is a Motor Vehicle, other than a Taxi, which is:

- (a) a rigid Truck with three or more axles;
- (b) an articulated Truck;
- (c) a Bus; or
- (d) a two-axle rigid Truck having a gross vehicle mass which exceeds 4.5 tonnes;

Light Commercial Vehicle or **LCV** is a Motor Vehicle, other than a Taxi, which is a two-axle rigid Truck having a gross vehicle mass which exceeds 1.5 tonnes, but does not exceed 4.5 tonnes;

Motor Cycle is a two-wheeled Motor Vehicle (and includes such a Motor Vehicle even if it has a trailer, fore car or side car attached) other than a Taxi;

Motor Vehicle is a vehicle which is used or intended to be used on a highway or in a public place and which has its own motive power (other than human or animal power) but does not include:

- (a) a vehicle intended to be used on a railway or tramway; or
- (b) a motorised wheelchair capable of a speed of not more than 10 kilometres per hour which is used solely for the conveyance of an injured or disabled person;

Taxi is, at any particular time, a Motor Vehicle in relation to which a commercial passenger vehicle licence (issued under the **Transport Act 1983**) then subsists, being a licence allowing for the operation of the Motor Vehicle as a Taxi-Cab (within the meaning of the **Transport Act 1983**);

the Agreement has the same meaning as in the Act;

the Integration and Facilitation Agreement has the same meaning as in the Act;

Trip is the passage of a vehicle on one or more toll zones:

- (a) uninterrupted by exit and subsequent re-entry; or
- (b) if so interrupted, consists only of travel directly between:
 - (i) that part of the Link road between Bulla Road and the West Gate Freeway; and
 - (ii) that part of the Link road between Sturt Street and Glenferrie Road;

Truck is a Motor Vehicle other than a Bus which has a cab-chassis construction and a gross vehicle mass which exceeds 1.5 tonnes;

Tulla Pass is an agreement with CityLink Melbourne for CityLink Melbourne to register a Car, Light Commercial Vehicle or Motor Cycle under Part 4 of the Act for use only on that part of the Link road being the Tullamarine Freeway Upgrade, between Bulla Road and Flemington Road including the toll zone between Moreland Road and Brunswick Road, for a fixed 24-hour period commencing at the time of the first Tulla Trip by that Car, Light Commercial Vehicle or Motor Cycle on a specified day;

Tulla Trip is the passage of a Car, Light Commercial Vehicle or Motor Cycle on that part of the Link road being the toll zone between Moreland Road and Brunswick Road;

24 Hour Pass is an agreement with CityLink Melbourne to register a vehicle (other than a Taxi) under Part 4 of the Act for use of any or all toll zones comprising the Full Link road for a fixed 24-hour period commencing at the time of the first Trip by the vehicle on a specified day;

vehicle has the same meaning as in the Act; and

Weekend Pass is an agreement with CityLink Melbourne to register a Car, Light Commercial Vehicle or Motor Cycle under Part 4 of the Act for use of any or all toll zones comprising the Full Link road for a fixed period commencing at 12.00 pm on the Friday immediately before a specified Saturday and ending at midnight on the Sunday immediately following that specified Saturday. The fact that CityLink Melbourne also registers a Car, Light Commercial Vehicle or Motor Cycle for an additional period at no extra charge does not prevent the agreement from being a Weekend Pass.

Under section 71(1)(b) of the Act and in accordance with the Agreement, the tolls listed in Table One are payable in respect of the use of vehicles on toll zones on the Link road where the vehicle is the subject of a 24 Hour Pass for that use.

Table One				
24 Hour Pass	Toll			
	Car	LCV	HCV	Motor Cycle
	\$18.31	\$39.71	\$73.98	\$9.16

Under section 71(1)(b) of the Act and in accordance with the Agreement, the tolls listed in Table Two are payable in respect of the use of vehicles on toll zones on the Link road where the vehicle is the subject of a Weekend Pass for that use.

Table Two			
Weekend Pass	Toll		
	Car	LCV	Motor Cycle
	\$18.31	\$39.71	\$9.16

Under section 71(1)(b) of the Act and in accordance with the Agreement, the tolls listed in Table Three are payable in respect of the use of Cars, Light Commercial Vehicles or Motor Cycles on the toll zone, consisting of that part of the Link road between Moreland Road and Brunswick Road, where the Car, Light Commercial Vehicle or Motor Cycle is the subject of a Tulla Pass for that use.

Table Three			
Tulla Pass	Toll		
	Car	LCV	Motor Cycle
	\$6.52	\$10.43	\$3.23

For the avoidance of doubt, this Notice does not set Charge Tolls or Day Tolls for the purpose of Schedule 3 (the Toll Calculation Schedule) of the Agreement or Schedule 4 (the Toll Calculation Schedule) of the Integration and Facilitation Agreement.

For the avoidance of doubt, this Notice also:

- (i) revokes or repeals; or, in the alternative
- (ii) amends –

the NOTICE UNDER SECTION 71(1) dated 12 June 2019 and published in the Victoria Government Gazette No. G25 (pages 1177 to 1179) dated 20 June 2019 ('the Last Notice').

This notice takes effect on 1 October 2019 and for the avoidance of doubt, the Last Notice ceases to have effect when this Notice takes effect, and the revocation, repeal, amendment or ceasing to have effect of the Last Notice shall not:

- (a) revive anything not in force or existing at the time at which the revocation, repeal, amendment or ceasing to have effect becomes operative;
- (b) affect the previous operation of the Last Notice or anything duly done or suffered under the Last Notice;
- (c) affect any right, privilege, obligation or liability acquired, accrued or incurred under the Last Notice;
- (d) affect any penalty, forfeiture or punishment incurred in respect of any offence committed relating (directly or indirectly) to or in respect of the Last Notice; or
- (e) affect any investigation, legal proceeding or remedy in respect of any such right, privilege, obligation, liability, penalty, forfeiture or punishment as is mentioned in paragraphs (c) and (d) –

and any such investigation, legal proceeding or remedy may be instituted, continued or enforced, and any such penalty, forfeiture or punishment may be imposed, as if the Last Notice had not been revoked or repealed or amended or had not expired, lapsed or otherwise ceased to have effect.

For the avoidance of doubt, the revocation, repeal, amendment or ceasing to have effect of the Last Notice does not in any way affect the direct amendments made in or by the Last Notice to, or the operation or effect of those amendments to, any NOTICE UNDER SECTION 71(1) published in the Victoria Government Gazette prior to the publication of the Last Notice.

Dated 11 September 2019

A. L. STREET
Company Secretary
CityLink Melbourne Limited
(ABN 65 070 810 678)

W. D. BALLANTINE
Director
CityLink Melbourne Limited
(ABN 65 070 810 678)

Melbourne City Link Act 1995

NOTICE UNDER SECTION 71(1)

Under section 71(1)(b) of the **Melbourne City Link Act 1995** ('the Act'), City Link Extension Pty Limited, ABN 40 082 058 615, (the relevant corporation in relation to the Extension road) hereby fixes tolls which are payable in respect of the use of vehicles on the toll zone on the Extension road where those vehicles are the subject of a CityLink Pass for that use.

For the purposes of this Notice, the following definitions apply:

Bus is a Motor Vehicle having more than 12 seating positions (including that of the driver);

Car is a Motor Vehicle, other than a Motor Cycle, a Light Commercial Vehicle, a Heavy Commercial Vehicle or a Taxi even if such a Motor Vehicle is towing a trailer or caravan;

CityLink is CityLink Melbourne Limited ABN 65 070 810 678, the relevant corporation for the purposes of section 73C of the Act;

CityLink Pass is a 24 Hour Pass or a Weekend Pass;

Full Link road is the road included within both the Link road and the Extension road;

Heavy Commercial Vehicle or **HCV** is a Motor Vehicle, other than a Taxi, which is:

- (a) a rigid Truck with three or more axles;
- (b) an articulated Truck;
- (c) a Bus; or
- (d) a two-axle rigid Truck having a gross vehicle mass which exceeds 4.5 tonnes;

Light Commercial Vehicle or **LCV** is a Motor Vehicle, other than a Taxi, which is a two-axle rigid Truck having a gross vehicle mass which exceeds 1.5 tonnes, but does not exceed 4.5 tonnes;

Motor Cycle is a two-wheeled Motor Vehicle (and includes such a Motor Vehicle even if it has a trailer, fore car or side car attached) other than a Taxi;

Motor Vehicle is a vehicle which is used or intended to be used on a highway or in a public place and which has its own motive power (other than human or animal power) but does not include:

- (a) a vehicle intended to be used on a railway or tramway; or
- (b) a motorised wheelchair capable of a speed of not more than 10 kilometres per hour which is used solely for the conveyance of an injured or disabled person;

Taxi is, at any particular time, a Motor Vehicle in relation to which a commercial passenger vehicle licence (issued under the **Transport Act 1983**) then subsists, being a licence allowing for the operation of the Motor Vehicle as a Taxi-Cab (within the meaning of the **Transport Act 1983**);

the Extension Agreement has the same meaning as in the Act;

the Integration and Facilitation Agreement has the same meaning as in the Act;

Trip is the passage of a vehicle on one or more toll zones:

- (a) uninterrupted by exit and subsequent re-entry; or
- (b) if so interrupted, consists only of travel directly between:
 - (i) that part of the Link road between Bulla Road and the West Gate Freeway; and
 - (ii) that part of the Link road between Sturt Street and Glenferrie Road;

Truck is a Motor Vehicle other than a Bus which has a cab-chassis construction and a gross vehicle mass which exceeds 1.5 tonnes;

24 Hour Pass is an agreement with CityLink to register a vehicle (other than a Taxi) under Part 4 of the Act for use of any or all toll zones comprising the Full Link road for a fixed 24-hour period commencing at the time of the first Trip by the vehicle on a specified day;

vehicle has the same meaning as in the Act; and

Weekend Pass is an agreement with CityLink to register a Car, Light Commercial Vehicle or Motor Cycle under Part 4 of the Act for use of any or all toll zones comprising the Full Link road for a fixed period commencing at 12.00 pm on the Friday immediately before a specified Saturday and ending at midnight on the Sunday immediately following that specified Saturday. The fact that CityLink also registers that Car, Light Commercial Vehicle or Motor Cycle for an additional period at no extra charge does not prevent the agreement from being a Weekend Pass.

Under section 71(1)(b) of the Act and in accordance with the Extension Agreement, the tolls listed in Table One are payable in respect of the use of vehicles on the toll zone on the Extension road where the vehicle is the subject of a 24 Hour Pass for that use.

Table One				
24 Hour Pass	Toll			
	Car	LCV	HCV	Motor Cycle
	\$18.31	\$39.71	\$73.98	\$9.16

Under section 71(1)(b) of the Act and in accordance with the Extension Agreement, the tolls listed in Table Two are payable in respect of the use of vehicles on the toll zone on the Extension road where the vehicle is the subject of a Weekend Pass for that use.

Table Two			
Weekend Pass	Toll		
	Car	LCV	Motor Cycle
	\$18.31	\$39.71	\$9.16

For the avoidance of doubt, this Notice does not set Charge Tolls or Day Tolls for the purpose of Schedule 1 (the Toll Calculation Schedule) of the Extension Agreement or Schedule 4 (the Toll Calculation Schedule) of the Integration and Facilitation Agreement.

For the avoidance of doubt, this Notice also:

- (i) revokes or repeals; or, in the alternative
- (ii) amends –

the NOTICE UNDER SECTION 71(1) dated 12 June 2019 and published in the Victoria Government Gazette No. G25 (pages 1180 to 1182) dated 20 June 2019 ('the Last Notice').

This notice takes effect on 1 October 2019 and for the avoidance of doubt, the Last Notice ceases to have effect when this Notice takes effect, and the revocation, repeal, amendment or ceasing to have effect of the Last Notice shall not:

- (a) revive anything not in force or existing at the time at which the revocation, repeal, amendment or ceasing to have effect becomes operative;
- (b) affect the previous operation of the Last Notice or anything duly done or suffered under the Last Notice;
- (c) affect any right, privilege, obligation or liability acquired, accrued or incurred under the Last Notice;
- (d) affect any penalty, forfeiture or punishment incurred in respect of any offence committed relating (directly or indirectly) to or in respect of the Last Notice; or
- (e) affect any investigation, legal proceeding or remedy in respect of any such right, privilege, obligation, liability, penalty, forfeiture or punishment as is mentioned in paragraphs (c) and (d) –

and any such investigation, legal proceeding or remedy may be instituted, continued or enforced, and any such penalty, forfeiture or punishment may be imposed, as if the Last Notice had not been revoked or repealed or amended or had not expired, lapsed or otherwise ceased to have effect.

For the avoidance of doubt, the revocation, repeal, amendment or ceasing to have effect of the Last Notice does not in any way affect the direct amendments made in or by the Last Notice to, or the operation or effect of those amendments to, any NOTICE UNDER SECTION 71(1) published in the Victoria Government Gazette prior to the publication of the Last Notice.

Dated 11 September 2019

A. L. STREET
Company Secretary
City Link Extension Pty Limited
(ABN 40 082 058 615)

W. D. BALLANTINE
Director
City Link Extension Pty Limited
(ABN 40 082 058 615)

ORDERS IN COUNCIL**Education and Training Reform Act 2006**APPOINTMENT OF MEMBERS TO THE
VICTORIAN CURRICULUM AND ASSESSMENT AUTHORITY

Order in Council

The Governor in Council, under section 2.5.6(1)(b) of the **Education and Training Reform Act 2006**, appoints Catharine Florence Hydon, Aayushi Khillan and Seir Cook Holley as members of the Victorian Curriculum and Assessment Authority from the date of the order until 16 September 2022 (both dates inclusive).

The terms and conditions of the appointments are contained in the attached Schedule.

Dated 17 September 2019

Responsible Minister:

THE HON. JAMES MERLINO MP

Minister for Education

PIETA TAVROU

Clerk of the Executive Council

Education and Training Reform Act 2006APPOINTMENT OF MEMBERS TO THE
VICTORIAN CURRICULUM AND ASSESSMENT AUTHORITY

SCHEDULE TO THE ORDER IN COUNCIL

1. Appointment Arrangements

Under section 2.5.6(4) of the **Education and Training Reform Act 2006** (the Act), a member is appointed on a part-time basis.

2. Period of Appointment

The appointment is from the date of the order to 16 September 2022.

3. Duties and Responsibilities of the Position

The functions of the Authority are contained in section 2.5.3 of the Act and are to develop policies, criteria and standards for curriculum, assessments and courses for learners and school students, including courses leading to recognised qualifications.

4. Termination Arrangements

Section 2.5.6(5) of the Act states that a member may resign from office by delivering to the Governor in Council a signed letter of resignation.

Section 2.5.6(6) of the Act states that the Governor in Council may at any time remove a member from office.

5. Payment Provisions

Schedule 2, Item 3(1) of the Act states that a member or acting member of an authority, other than a member who holds a full-time Government office, or a full-time position in the public service, teaching service or with a statutory authority (other than a university) is entitled to receive the remuneration and fees that are fixed in the member's instrument of appointment or are fixed from time to time by the Governor in Council for that member.

Ms Hydon and Ms Khillan are eligible to receive annual remuneration of \$11,422 per annum. Ms Holley is a full-time public sector employee and is not eligible to receive remuneration.

6. Superannuation Obligations

Superannuation will be paid in accordance with the **Superannuation Guarantee (Administration) Act 1992** (Cth).

7. Travel and Personal Expenses Arrangements

Schedule 2, Item 3(2) of the Act states that each member or acting member of an authority is entitled to receive the personal and travelling expenses that are fixed in the member's instrument of appointment or are fixed from time to time by the Governor in Council.

Reasonable personal and travelling expenses will be paid.

8. Leave Arrangements

There are no leave provisions for these part-time statutory positions.

9. Prior Service

Not applicable.

Planning and Environment Act 1987**DECLARATION OF THE SURF COAST AS A
DISTINCTIVE AREA AND LANDSCAPE****Order in Council**

The Governor in Council, under section 46AO(1) of the **Planning and Environment Act 1987** (Act), on the recommendation of the Minister, makes the following Order:

1. Preamble

In accordance with section 46AO(2)(d)(i) of the Act, the following statement sets out the significance of the area to the people of Victoria:

- (a) The Surf Coast has natural landscapes of outstanding beauty and environmental, economic and cultural heritage values of state and national significance.
- (b) Its diverse natural environment and impressive landforms, combined with visible layers of history, underscore its special significance to the people of Victoria and its important role in our social, cultural and economic development.
- (c) There are a number of nationally and state significant areas of biodiversity including the Point Addis Marine National Park, Point Danger Marine Sanctuary, Point Impossible, The Breamlea/Karaaf wetlands and associated estuaries. These areas provide important habitats to a variety of flora and fauna including endangered and threatened species like the Hooded Plover, Bellarine Yellow Gum and the critically endangered Orange-Bellied Parrot.
- (d) The Great Ocean Road, which begins in Torquay, is registered on the National Heritage list. The Road is a highly important destination for local and overseas visitors. The history and construction of the road was important for the development of the state and opening the region to tourism.
- (e) There are many high-quality surfing beaches within the area, including Bells Beach, which hosts international surfing events. The Surf Coast is synonymous with surfing, is an important aspect of the development of the area as a holiday destination and forms part of the cultural identity of the Surf Coast.

The following statement sets out the significance of Wadawurrung Country and the area to the Traditional Owners in traditional language, in accordance with section 46AO(2)(d)(ii) of the Act:

Comugeen budj-o thalikiyu kin kin bil beng-ordi-ngadak. Ngarrwabil, boron, guli, bagurrk. Comugeen budj-o bengadak ngarr-uk dja, ngubiyt, weagoon gobata gupma wurring-wurring baap beng-ordi-nganak, djarrima murrup-nhuk bengadak

Gobata Wadawurrung balug jumbuk didalbil murrup-nhuk bundjil monomeeth beek-o weagoon. Mutjak-ak noogie n'uder durrallully

Wa-ngarrak Wadawurrung balug bengadak mirriyu boron-dja gobata-k ying ying, ngarrimilli, wah-ak, karrung, kuy-a, nyanayit-yanunit, djilenawurr, baap willam beng-ordi-ngadak.

Nyurrinana-ngal beng-ordi-ngadak

Willam Barwon Yaluk baap Koaka-dorla ‘bass strait’ Wadawurrung Balug dja beng-ordi-ngadak, bullarto nerr-i-girr baap monomeeth worrowing warree, gelanyi bulboluk

Weagoon-o Modewarre-wa, Mode baap kiang-purt

Weagoon-o Koaka-Dorla-wa Dorla

Weeagoon-o Wurdiboluk, Gherang, Pawon Yaluk monomeeth-wa Yonbarra baap wirrapiyn, buniya, tark-a binyak-ngal.

Wa-weagoon nerr-i-gurr-o kit kit baap bullarto gurrin-gurrin-k wah-ak, karrung, yanikan-werrity. Corroborree bullarto wa-ik-ngitj balug-wa beng-ordi-ngadak

Mirr wurru-ngarra dja bengadak.

Mirr-i-tonton dja Wadawurrung balug, gobata be-ak yerra-ak murrup yani-mirriyu ngarrwa-uk beng-ordi-ngadak

The following statement sets out the significance of the Wadawurrung Country and the area to the Traditional Owners, in accordance with section 46AO(2)(d)(ii) of the Act:

We deeply respect our people of the past. Elders, children, men, women. We deeply respect their knowledge of country, water, life, their care of the traditions and of each other, we stand with their spirit.

Great spirit Bundjil told us to take care of the great life within the land. To only take what you need without selfishness

Wadawurrung shared their knowledge of singing, dance, trade, camps, fishing, hunting, paintings, and homes to us to protect for our future generations.

We all need to help.

Our Wadawurrung family group lived within Barwon River and Bass Strait, with a large land of forested areas and wonderful banks of the ocean, near many water bodies. Life in the Modewarre gave Musk duck and Bream. Life in the Anglesea gave mullet Wurdiboluk, Gherang, Barwon River all provide ideal life to birds and fish, eels. Reeds turned into our baskets.

Life in the forest gave resources like food and lots of tools to use for trade, building, journey

If there was lots to trade, we would share with our families and celebrate

We would name our country, by what we could see.

Our country is remembered by Wadawurrung, our proud spirit walks to tomorrow to teach others the care of our earth.

2. Declaration

In accordance with section 46AO of the Act, the Surf Coast is declared as a distinctive area and landscape.

3. Description of area

In accordance with section 46AO(2)(a) of the Act, the Surf Coast declared as a distinctive area and landscape is described in the plan numbered LEGL./19-163 lodged in the Central Plan Office.

4. Attributes and distinctive features of the declared area

In accordance with section 46AO(2)(b) of the Act, Table 1 provides the attributes described in section 46AP(1) that qualify the Surf Coast as an area to be declared as a distinctive area and landscape.

Table 1. Attributes qualifying declared area as a distinctive area and landscape

Item	Attribute	Distinctive Features
1.	Outstanding Environmental Significance	<p>(a) Creeks, wetlands, saltmarshes, woodlands and beaches in the area provide habitat for numerous state and national threatened species.</p> <p>(b) Areas of biodiversity significance include Point Addis Marine National Park, Point Danger Marine Sanctuary, Point Impossible, Karaaf Wetlands, Breamlea Flora and Fauna Reserve, Thompson Creek, Deep Creek, remnant vegetation west of Torquay-Jan Juc.</p>
2.	Significant Geographical Features, including Natural Landforms	<p>(a) Landscape includes areas of state and national significance, particularly along the coastline.</p> <p>(b) Bells Beach, the surrounding rugged coastline and hinterland offers scenic views from landmark cliffs, points and lookouts that define the character of the area.</p> <p>(c) Landscape character is highly visible from main road corridors.</p>
3.	Heritage and Cultural Significance	<p>(a) The region has extensive heritage and cultural value, ranging from areas of Aboriginal heritage significance, renowned surfing locations and shipwrecks along the coastline.</p> <p>(b) Coastal areas and waterways contain significant Aboriginal heritage value and are gathering places for the Wadawurrung people.</p> <p>(c) Bells Beach is an area of state heritage significance and included on the Victorian Heritage Register for its surfing, cultural and aesthetic heritage values.</p> <p>(d) The Great Ocean Road is included on the National Heritage List – it serves as a memorial to Australian servicemen in the First World War and enables access to spectacular natural scenery.</p>
4.	Natural Resources or Productive Land of Significance	<p>(a) Surf Coast is a major nature-based tourism destination of state significance, with tourism assets including Bells Beach, the Great Ocean Road and Torquay-Jan Juc</p> <p>(b) Extractive industries in the area are significant, particularly for their contribution to Victoria's supply of limestone</p>
5.	Strategic Infrastructure or Built Form of Significance	<p>(a) The Great Ocean Road is strategic infrastructure of national significance and is an important aspect of the tourism economy.</p> <p>(b) Surf Coast Highway and Anglesea Road also form part of the state transport network which is critical for the function of the Surf Coast</p>

5. Threats of significant land use change of the declared area

In accordance with section 46AO(2)(c) of the Act, the list below identifies the threats of significant or irreversible land use change, as described in section 46AP(2), that would affect the environmental, social or economic values of the declared area.

- (a) Threats to areas of significant biodiversity from land clearing and loss of habitat, urban development pressures including water run-off, human interference increased through tourism and introduced weeds and pests, climate change impacts and natural hazards such as change in water temperatures, sea level rise, storm surges and bushfire;
- (b) Threats to natural landscapes and landforms from urban development expansion, increased visitation pressures, climate change impacts including sea level rise and change in storm patterns expected to increase risk of erosion;
- (c) Threats to preservation of heritage and cultural attributes from township expansion, land use practices and increased tourism activity and recreation;
- (d) Threats to natural resources and productive land from land use conflicts between conservation, agricultural use, residential use and recreation activities; cumulative impacts of development; and natural hazards, including bushfire and flooding;
- (e) Threats to future effectiveness of strategic infrastructure due to increasing pressure from urban growth, tourism activity and cumulative urban development.

Dated 17 September 2019

Responsible Minister:

THE HON RICHARD WYNNE MP

Minister for Planning

PIETA TAVROU
Clerk of the Executive Council

This page was left blank intentionally

This page was left blank intentionally

**SUBORDINATE LEGISLATION ACT 1994
NOTICE THAT STATUTORY RULES ARE
OBTAINABLE**

Notice is hereby given under section 17(3) of the **Subordinate Legislation Act 1994** that the following Statutory Rules were first obtainable from TIMG Bookshop, Level 10, 575 Bourke Street, Melbourne 3000, on the date specified:

- | | | | |
|----------------------------|--|----------------------------|--|
| 81. <i>Statutory Rule:</i> | Magistrates' Court
(Miscellaneous
Civil Proceedings)
(Arbitration Costs
Amendment)
Rules 2019 | 84. <i>Statutory Rule:</i> | Parliamentary
Salaries,
Allowances and
Superannuation
Regulations 2019 |
| | <i>Authorising Act:</i> | | <i>Authorising Act:</i> |
| | Magistrates' Court
Act 1989 | | Parliamentary
Salaries,
Allowances and
Superannuation
Act 1968 |
| | <i>Date first obtainable:</i> | | <i>Date first obtainable:</i> |
| | 16 September 2019 | | 17 September 2019 |
| | <i>Code A</i> | | <i>Code A</i> |
| 82. <i>Statutory Rule:</i> | Magistrates' Court
Authentication
Amendment
Rules 2019 | 85. <i>Statutory Rule:</i> | Child Wellbeing
and Safety
Amendment
Regulations 2019 |
| | <i>Authorising Act:</i> | | <i>Authorising Act:</i> |
| | Magistrates' Court
Act 1989 | | Child Wellbeing
and Safety
Act 2005 |
| | <i>Date first obtainable:</i> | | <i>Date first obtainable:</i> |
| | 16 September 2019 | | 18 September 2019 |
| | <i>Code A</i> | | <i>Code A</i> |
| 83. <i>Statutory Rule:</i> | Victorian
Independent
Remuneration
Tribunal and
Improving
Parliamentary
Standards
Amendment
Regulations 2019 | 86. <i>Statutory Rule:</i> | Assisted
Reproductive
Treatment
Amendment
Regulations 2019 |
| | <i>Authorising Act:</i> | | <i>Authorising Act:</i> |
| | Victorian
Independent
Remuneration
Tribunal and
Improving
Parliamentary
Standards Act 2019 | | Assisted
Reproductive
Treatment
Act 2008 |
| | <i>Date first obtainable:</i> | | <i>Date first obtainable:</i> |
| | 17 September 2019 | | 18 September 2019 |
| | <i>Code A</i> | | <i>Code A</i> |
-

PRICING FOR SPECIAL GAZETTE, PERIODICAL GAZETTE AND VICTORIAN LEGISLATION

Retail price varies according to the number of pages in each Victoria Government Special Gazette, Victoria Government Periodical Gazette and Victorian legislation. The table below sets out the prices that apply.

<i>Price Code</i>	<i>No. of Pages (Including cover and blank pages)</i>	<i>Price*</i>
A	1–16	\$4.22
B	17–32	\$6.33
C	33–48	\$8.65
D	49–96	\$13.61
E	97–144	\$17.51
F	145–192	\$20.78
G	193–240	\$23.95
H	241–288	\$25.43
I	289–352	\$28.70
J	353–416	\$33.44
K	417–480	\$38.19
L	481–544	\$44.52
M	545–608	\$50.90
N	609–672	\$56.28
O	673–736	\$63.62
P	737–800	\$70.10
#Q	821–886	\$76.22
#R	887–950	\$81.29
#S	951–1016	\$86.83
#T	1017–1080	\$92.21
#U	1081–1146	\$97.75
#V	1147–1210	\$103.50
#W	1211–1276	\$108.88
#X	1277–1340	\$114.78
#Y	1341–1406	\$119.95

<i>Price Code</i>	<i>No. of Pages (Including cover and blank pages)</i>	<i>Price*</i>
#Z	1407–1470	\$125.60
#ZA	1471–1536	\$131.56
#ZB	1537–1610	\$136.57
#ZC	1611–1666	\$142.32
#ZD	1667–1730	\$147.70
#ZE	1731–1796	\$153.66
#ZF	1797–1860	\$159.20
#ZG	1861–1926	\$164.42
#ZH	1927–1990	\$170.38
#ZI	1991–2056	\$175.76

* All prices include GST
Printed as two volumes

bluestar **PRINT**

The *Victoria Government Gazette* is published by Blue Star Print with the authority of the Government Printer for the State of Victoria

© State of Victoria 2019

This publication is copyright. No part may be reproduced by any process except in accordance with the provisions of the Copyright Act.

Address all enquiries to the Government Printer for the State of Victoria

Level 2, 1 Macarthur Street

Melbourne 3002

Victoria Australia

How To Order



**Retail &
Mail Sales**

Victoria Government Gazette
Ground Floor, Building 8,
658 Church Street,
Richmond 3121

DX 106 Melbourne



Telephone

(03) 8523 4601



Fax

(03) 9600 0478

email

gazette@bluestargroup.com.au

Recommended Retail Price \$2.30 (includes GST)