



# Victoria Government Gazette

No. S 703 Friday 10 December 2021  
By Authority of Victorian Government Printer

## Road Management Act 2004

### ROAD DECLARATIONS

Head, Transport for Victoria, pursuant to sections 11 and 14 of the **Road Management Act 2004**, upon publication of this notice declares or renames the roads described in the Schedule and on the plans attached.

The effects of these Road Declarations on road names are described in Table 1.

### SCHEDULE

#### ARTERIAL ROAD

- a) Those parts of Thompson Road identified by hatching on the plans numbered GP23325, GP23328, GP23328A, GP23333, GP23336, GP23339, GP23353, GP23356 and GP23358 are declared as described in the legend in the said plans.
- b) That part of Dandenong Valley Highway identified by hatching on the plan numbered GP23325 is renamed as described in the said plan.
- c) Those parts of Western Port Highway identified by hatching on the plans numbered GP23328A, GP23333 are declared or renamed as described in the legend in the said plans.
- d) Those parts of Berwick – Cranbourne Road identified by hatching on the plan numbered GP23358 are declared or renamed as described in the legend in the said plan.

#### MUNICIPAL ROAD

- e) Those parts of McCormicks Road identified by hatching on the plan numbered GP23326 are declared as described in the legend in the said plan.
- f) Those parts of Roads identified by hatching on the plans numbered GP23334 and GP23339A are declared as described in the legend in the said plans.
- g) Those parts of Evans Road identified by hatching on the plan numbered GP23338 are declared as described in the legend in the said plan.
- h) That part of Merinda Park Boulevard identified by hatching on the plan numbered GP23339A is declared as described in the legend in the said plan.
- i) That part of Thompsons Road identified by hatching on the plan numbered GP24331 is declared as described in the legend in the said plan.

**SPECIAL**

**TABLE 1****EFFECTS ON ROAD NAMES**

1. Names in Column 2 are existing Vicmap Address names, which are unaffected by this notice.
2. **Names in Column 1 are for Department of Transport administrative purposes only and are independent of names in Column 2.**
3. Names in Column 2 may not apply to the whole length of the road and are for general information only.

**ARTERIAL ROAD**

| <b>GP Number</b>   | <b>Department of Transport<br/>Administrative Road Name<br/>Column 1</b> | <b>Vicmap Address Road Name<br/>(for property addressing purposes)<br/>Column 2</b> |
|--|--|---|
| GP23325<br>GP23328<br>GP23328A<br>GP23333<br>GP23336<br>GP23339<br>GP23353<br>GP23356<br>GP23358 | Thompson Road  | Not detailed – Road boundary adjustments only                                       |
| GP23325  | Dandenong Valley Highway   | Not detailed – Road boundary adjustments only                                       |
| GP23328A<br>GP23333  | Western Port Highway   |   |
| GP23358  | Berwick-Cranbourne Road  |   |

**MUNICIPAL ROAD**

| <b>GP Number</b>                          | <b>Department of Transport<br/>Administrative Road Name<br/>Column 1</b> | <b>Vicmap Address Road Name<br/>(for property addressing purposes)<br/>Column 2</b> |
|---|--|---|
| GP23326<br>GP23338<br>GP23339A<br>GP24331 | Not applicable   | Not detailed – Road boundary adjustments only                                       |
| GP23334<br>GP23339A                       | Not applicable   | Road names are not yet available  |

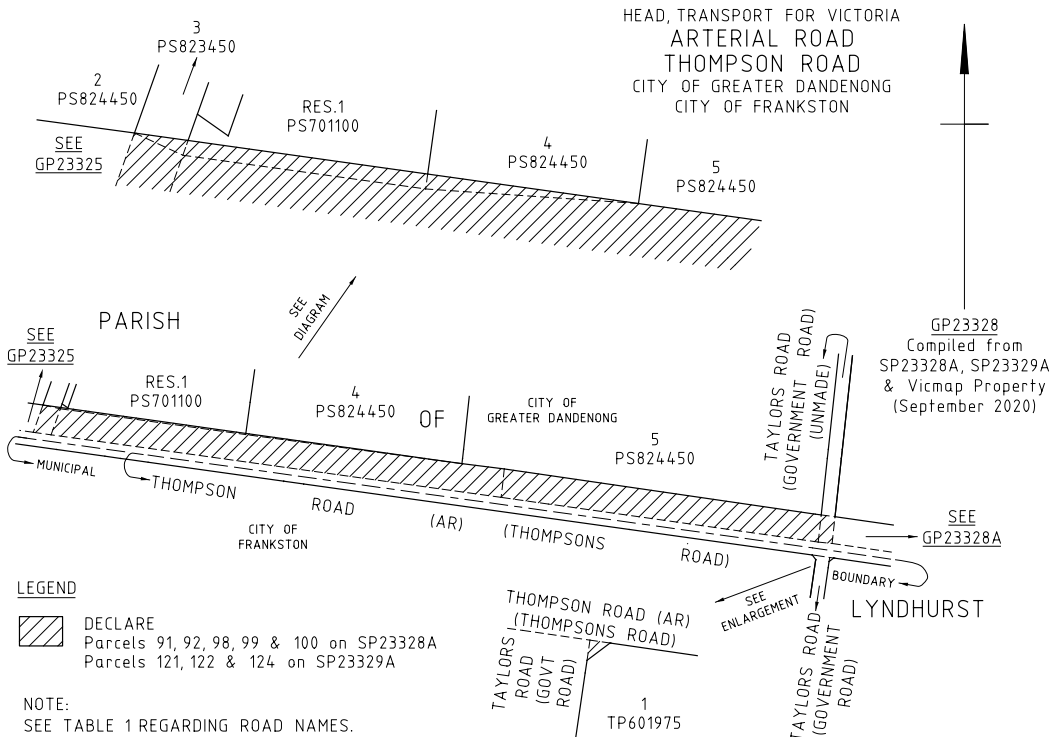
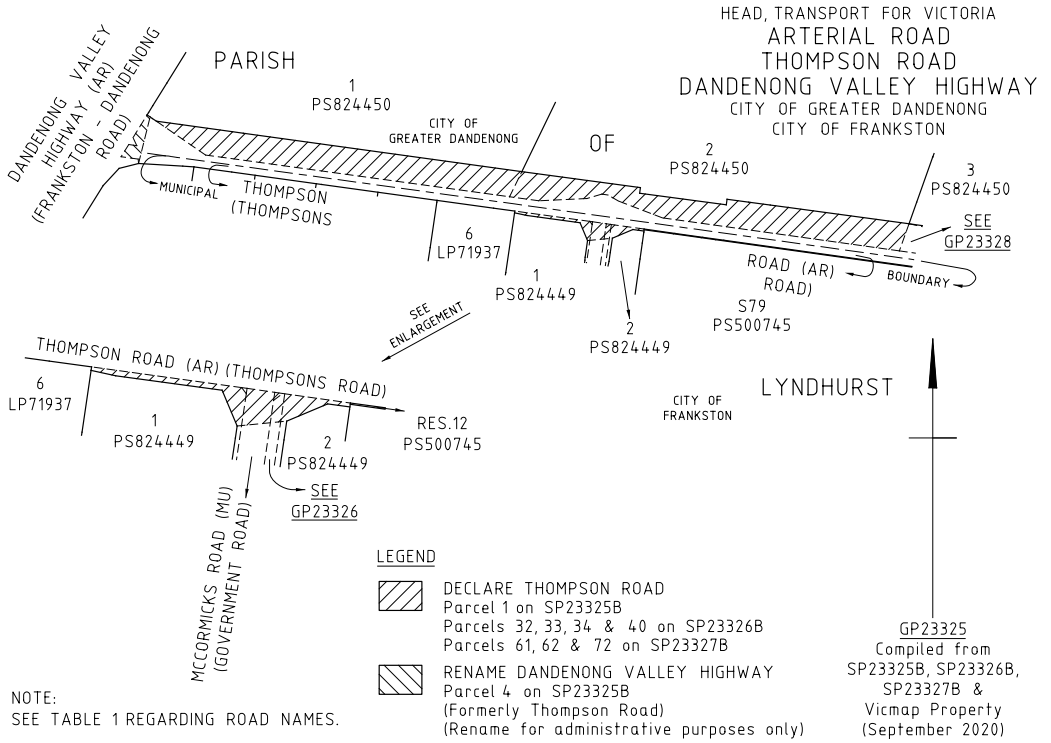

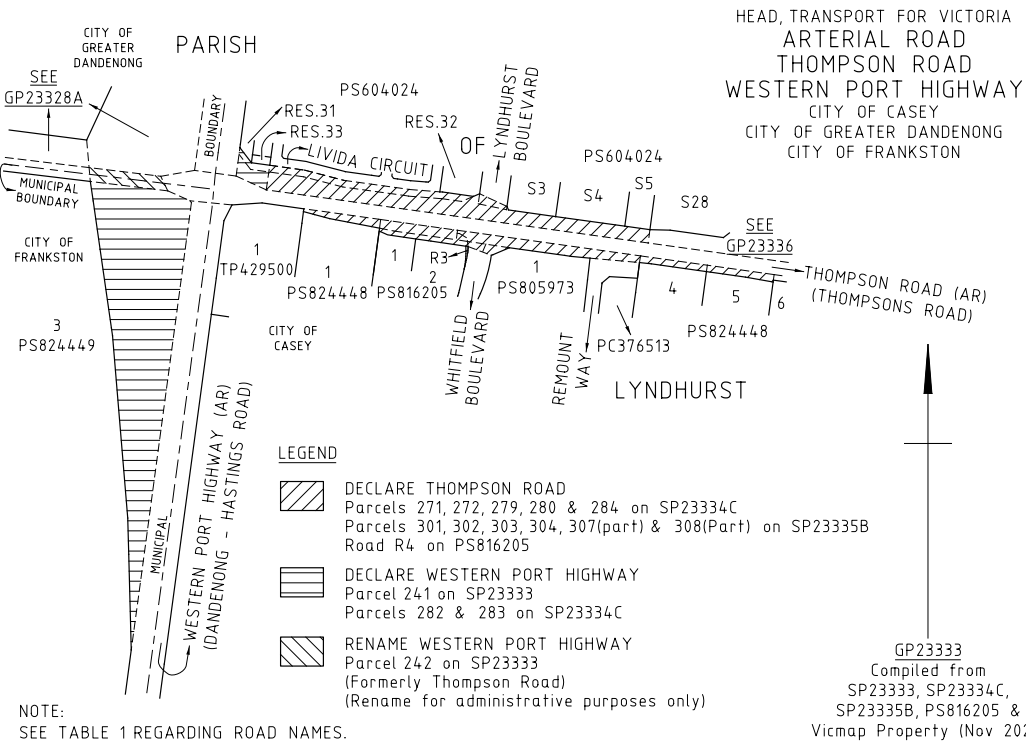
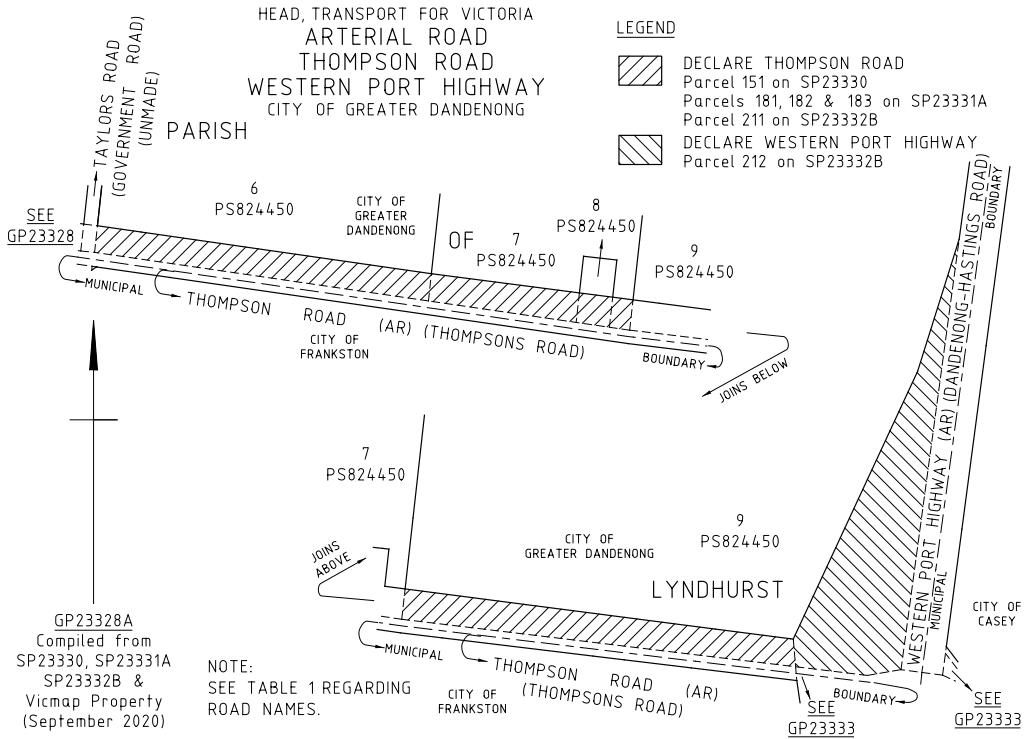

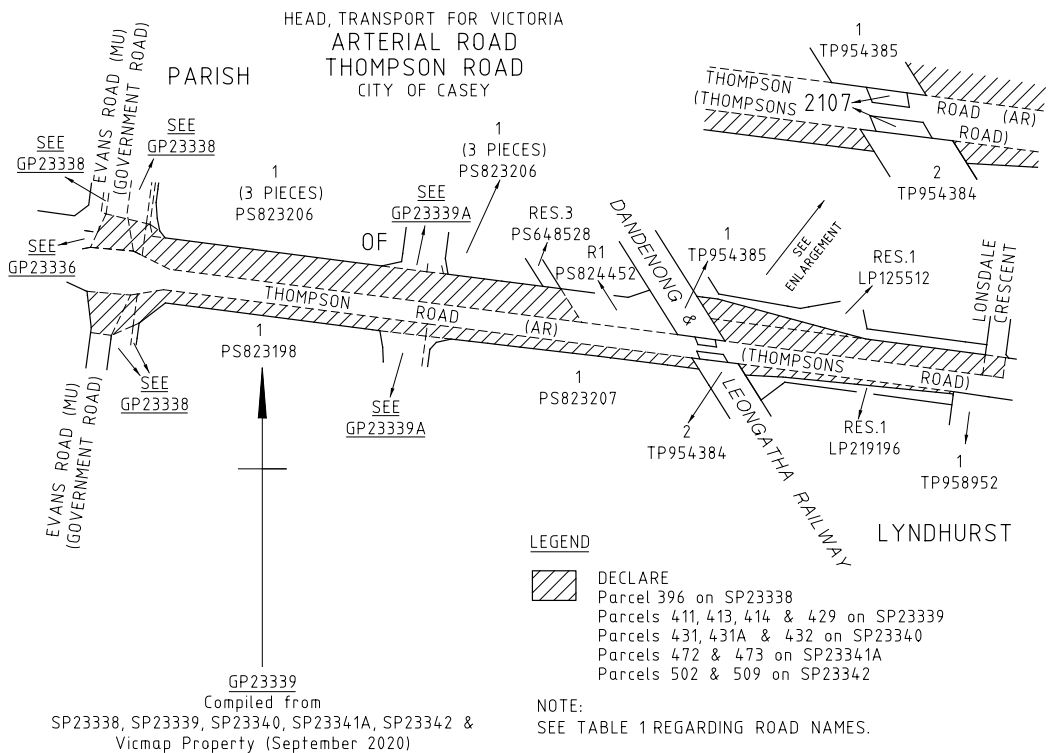
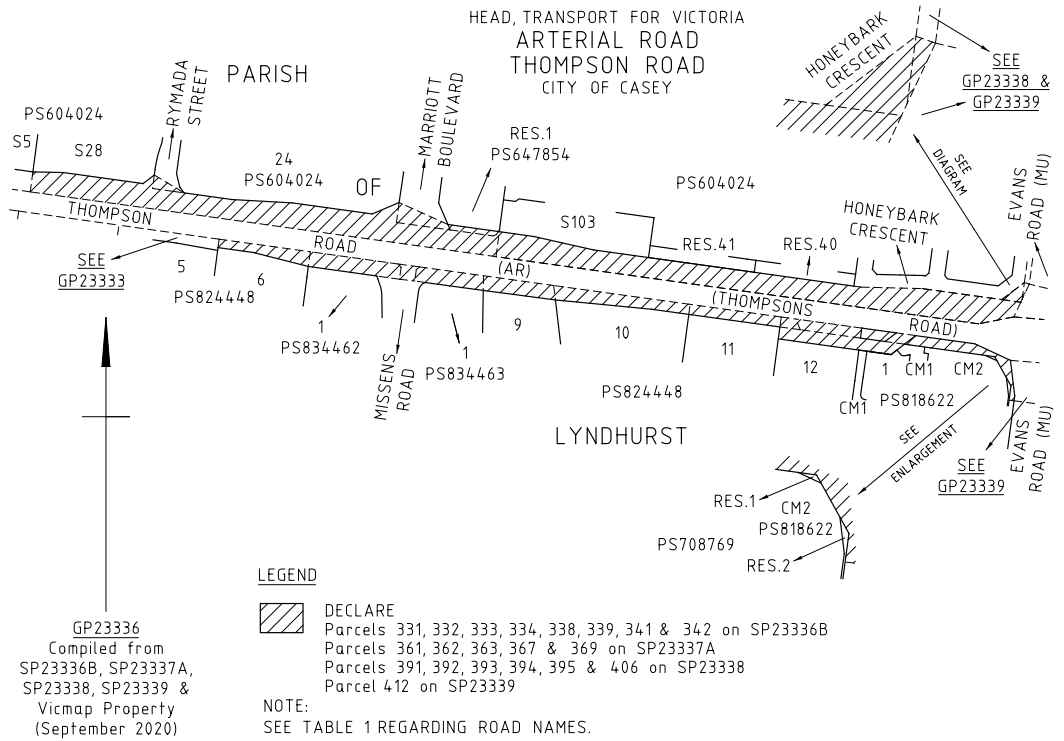

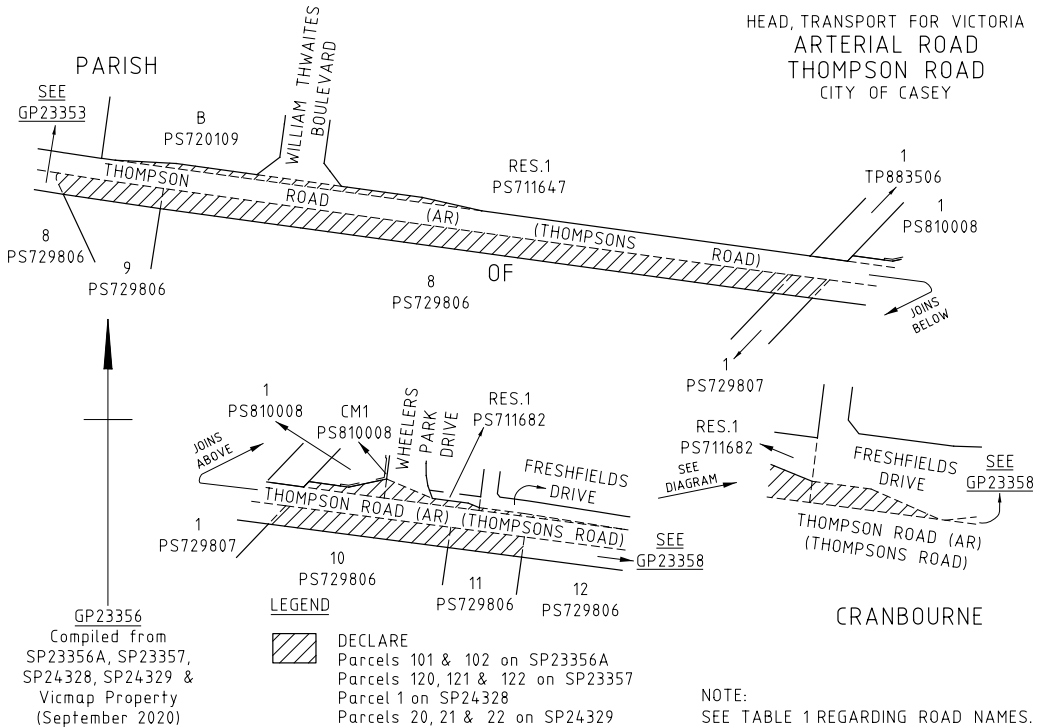
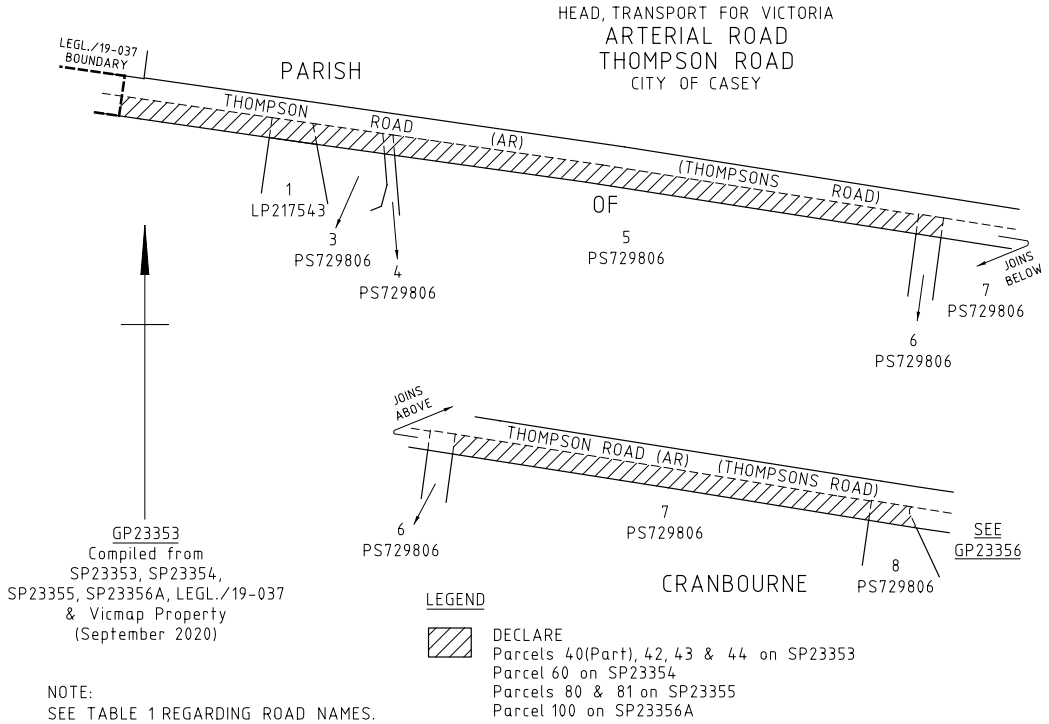

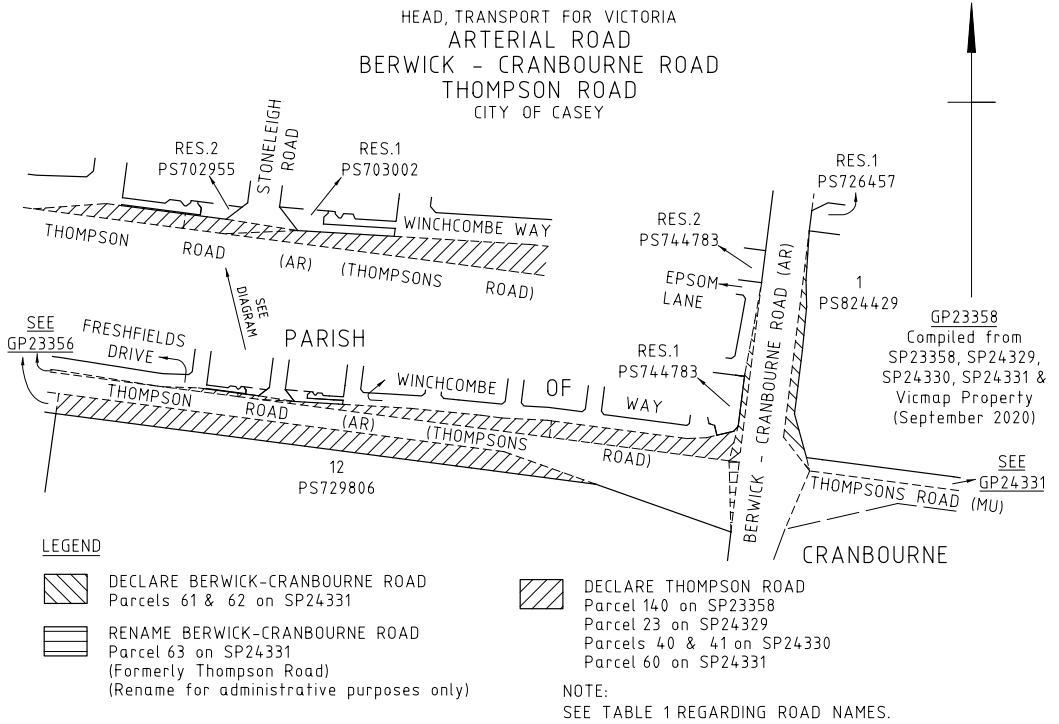

HEAD, TRANSPORT FOR VICTORIA  
MUNICIPAL ROAD  
MCCORMICKS ROAD  
CITY OF FRANKSTON

PARISH

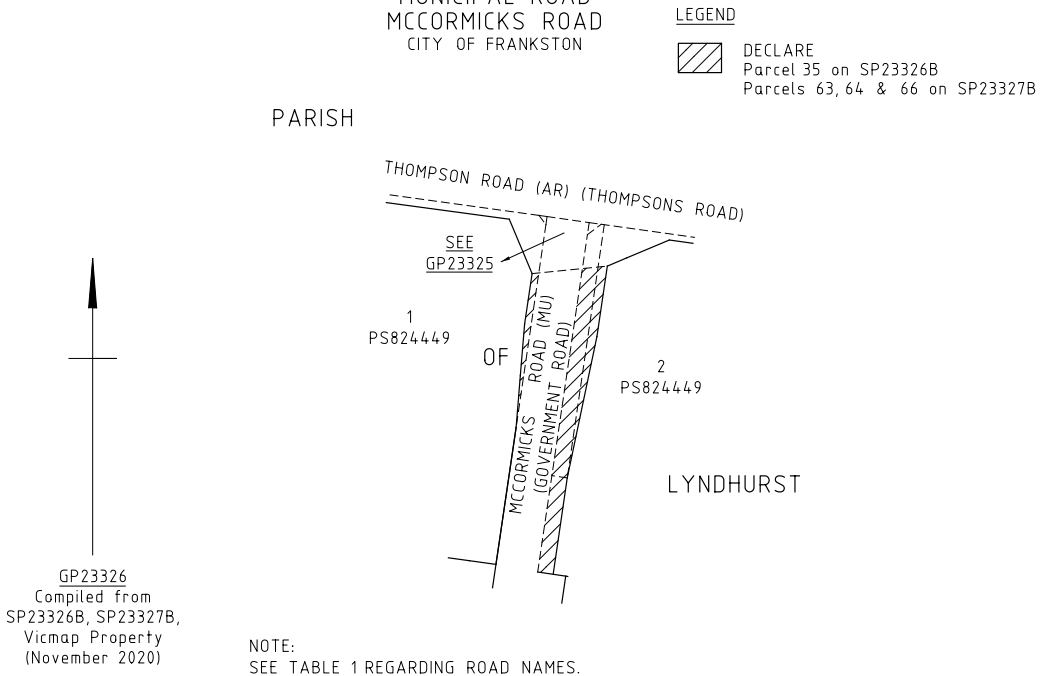

HEAD, TRANSPORT FOR VICTORIA  
MUNICIPAL ROAD  
ROAD  
CITY OF CASEY

LEGEND



DECLARE  
Parcels 273 & 274 on SP23334C  
Parcel 312 on SP23335B

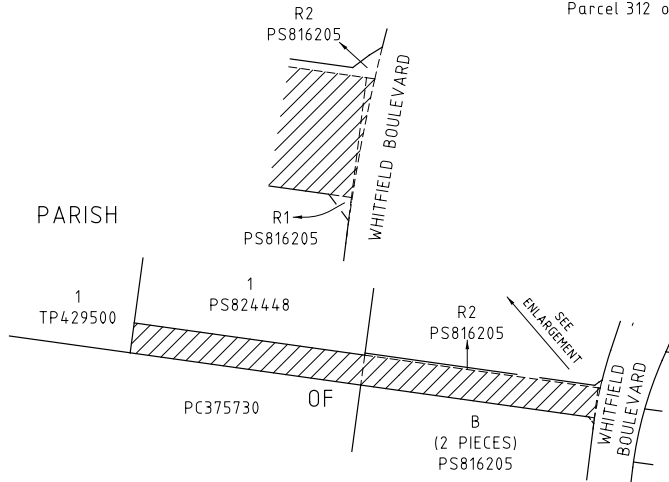
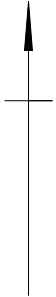

GP23334  
Compiled from  
SP23334C & SP23335B  
Vicmap Property  
(November 2020)

NOTE:  
SEE TABLE 1 REGARDING ROAD NAMES.

HEAD, TRANSPORT FOR VICTORIA  
MUNICIPAL ROAD  
EVANS ROAD  
CITY OF CASEY

PARISH

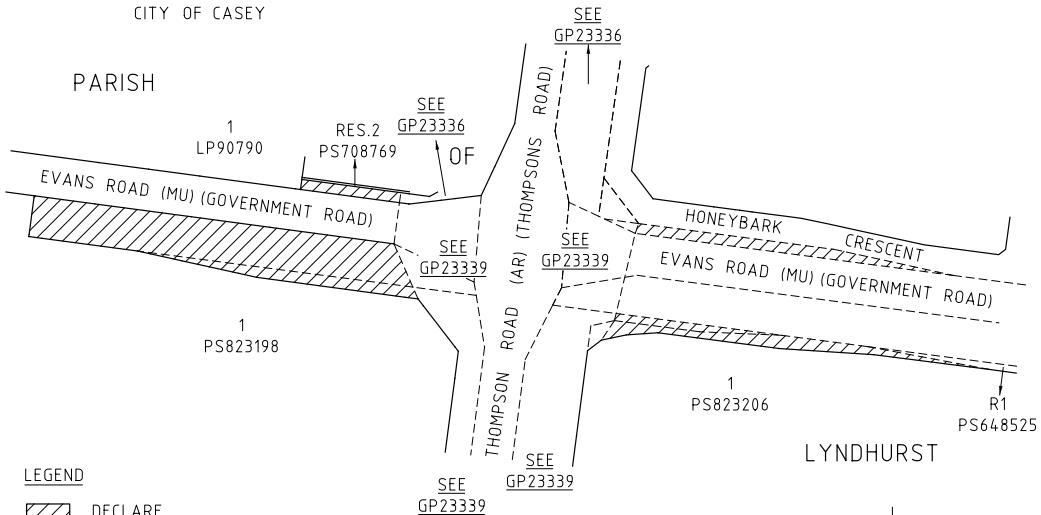

LEGEND



DECLARE  
Parcel 397 on SP23338  
Parcels 415, 423 & 426 on SP23339  
Parcels 433 & 433A on SP23340

NOTE:  
SEE TABLE 1 REGARDING ROAD NAMES.

GP23338  
Compiled from  
SP23338, SP23339, SP23340 &  
Vicmap Property (September 2020)

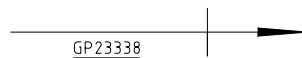



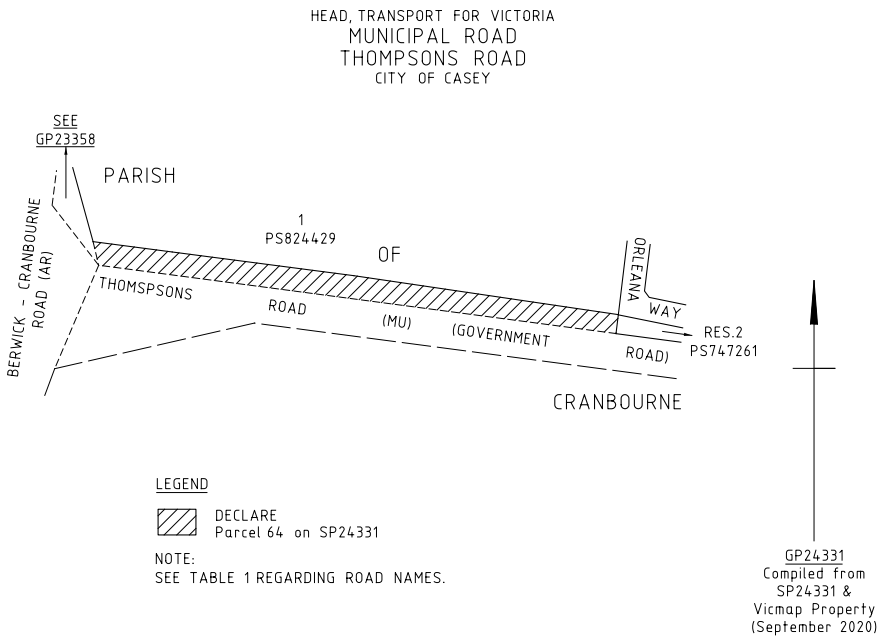
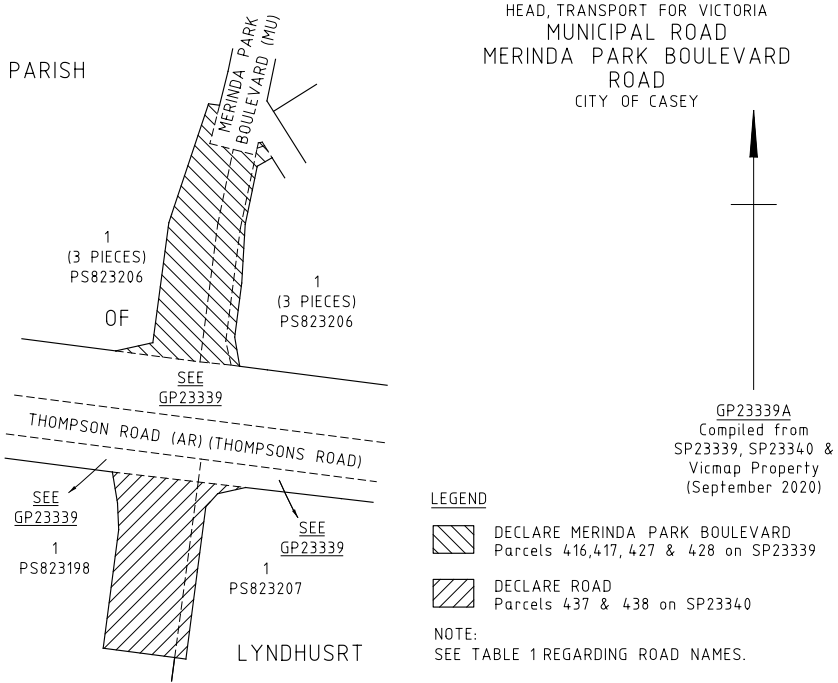

Dated 9 December 2021

ROBERT MURPHY  
Executive Director Transport Assets  
Department of Transport

This page was left blank intentionally

This page was left blank intentionally

# ive

The *Victoria Government Gazette* is published by IVE Group Limited with the authority of the Government Printer for the State of Victoria

© State of Victoria 2021

This publication is copyright. No part may be reproduced by any process except in accordance with the provisions of the Copyright Act.

Address all enquiries to the Government Printer for the State of Victoria  
Level 2, 1 Macarthur Street  
Melbourne 3002  
Victoria Australia

## How To Order



**Retail &  
Mail Sales**

**Victoria Government Gazette**

Ground Floor, Building 8,  
658 Church Street,  
Richmond 3121

DX 106 Melbourne



**Telephone**

(03) 8523 4601

**email**

[gazette@ivegroup.com.au](mailto:gazette@ivegroup.com.au)

**Price Code A**