



Victoria Government Gazette

No. S 371 Tuesday 6 July 2021
By Authority of Victorian Government Printer

Major Transport Projects Facilitation Act 2009

(Sections 96(3)(a) and 96(3)(b))

VARIATION OF THE DESIGNATED PROJECT AREA

Cranbourne Line Duplication Project

I, Richard Wynne, Minister for Planning, pursuant to section 96(3)(a) of the **Major Transport Projects Facilitation Act 2009** (the Act), increase the project area for the Cranbourne Line Duplication Project by designating land in the vicinity of the project area to be part of the project area, and pursuant to section 96(3)(b) of the Act, designate land as not being part of the project area, as shown on the plans signed by the Surveyor General with reference LEGL./20-046 Sheets 1 to 4 (inclusive) and lodged at the Central Plan Office on 20 October 2020, and as generally indicated on the map in the schedule, to be part of the project area for the Cranbourne Line Duplication Project, declared by the Premier to be a declared project pursuant to section 10(1)(b) of the Act and published in the Government Gazette on 7 November 2019.

This order comes into effect from the date it is published in the Government Gazette.

Dated 30 June 2021

THE HON. RICHARD WYNNE MP
Minister for Planning

SPECIAL

SCHEDULE

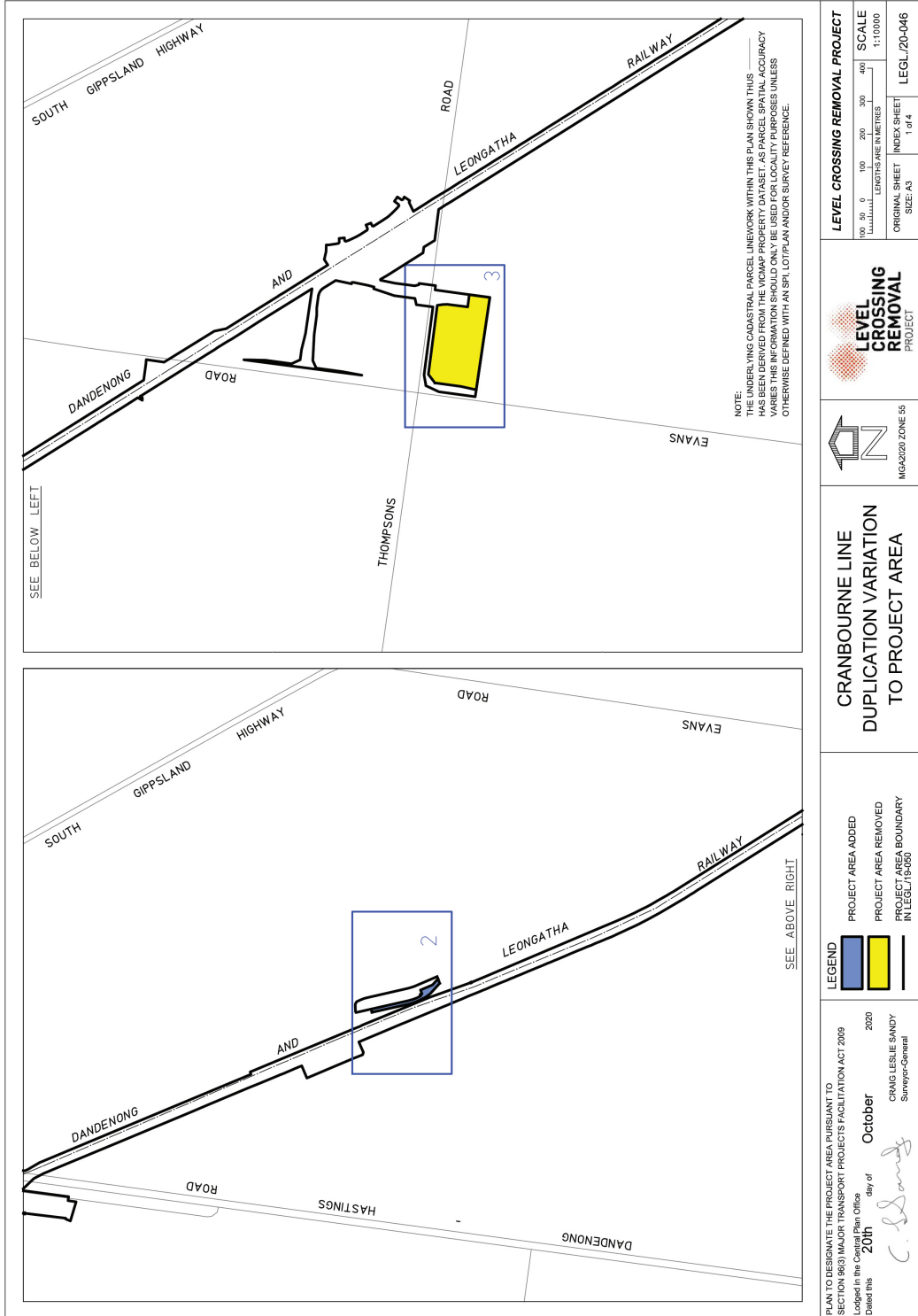

PLAN TO DESIGNATE THE PROJECT AREA PURSUANT TO SECTION 86(3) MAJOR TRANSPORT PROJECTS FACILITATION ACT 2009
 Lodged in the Central Plan Office
 Dated this **20th** day of **October** 2020
C. Sandry
 CRAIG LESLIE SANDY
 Surveyor-General

LEGEND

- PROJECT AREA ADDED
- PROJECT AREA REMOVED
- PROJECT AREA BOUNDARY IN LEGL/19-050

CRANBOURNE LINE
 DUPLICATION VARIATION
 TO PROJECT AREA

MC6200 ZONE 56

LEVEL CROSSING REMOVAL PROJECT

LEVEL CROSSING REMOVAL PROJECT

SCALE 1:10000
 LENGTHS ARE IN METRES
 ORIGINAL SHEET INDEX SHEET 1 of 4
 SIZE: A3
 LEGL/20-046

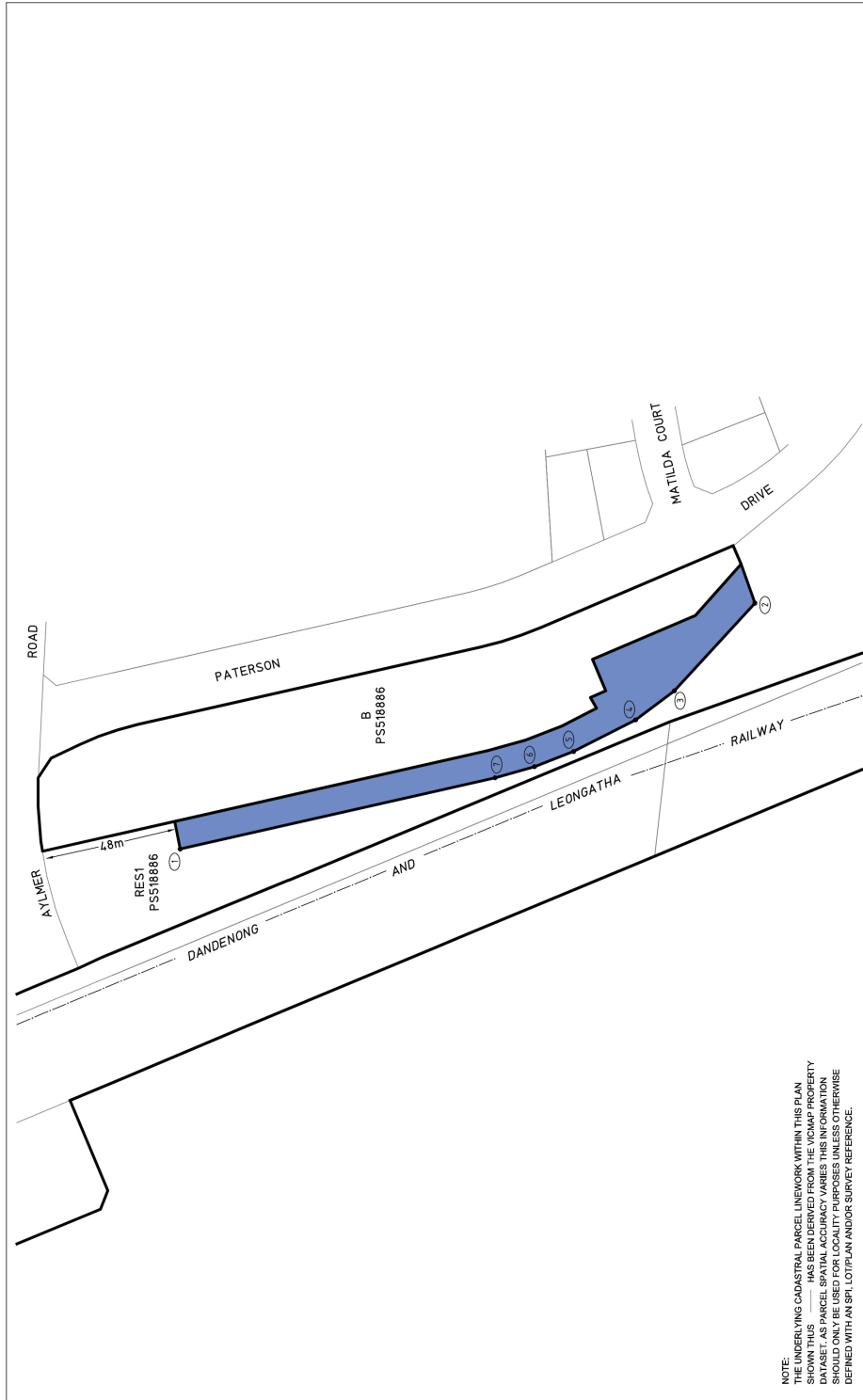

NOTE:
 THE UNDERLYING CADASTRAL PARCEL LINEWORK WITHIN THIS PLAN SHOWN THIS ——— HAS BEEN DERIVED FROM THE VICMAP PROPERTY DATASET. AS PARCEL SPATIAL ACCURACY VARIES THIS INFORMATION SHOULD ONLY BE USED FOR LOCALITY PURPOSES UNLESS OTHERWISE DERIVED WITH AN SPL, LOT/PLAN AND/OR SURVEY REFERENCE.

POINTS SHOWN THIS • (T) ARE COORDINATED.
 SEE SHEET 4 FOR SCHEDULE OF COORDINATES.
 LINES SHOWN THIS ——— ARE THE VICMAP PARCELS WHICH ARE THE APPROXIMATE LOCATION ONLY OF TITLE BOUNDARIES.

LEGEND

 PROJECT AREA ADDED
 PROJECT AREA BOUNDARY IN LEGL/19-050

CRANBOURNE LINE
 DUPLICATION VARIATION
 TO PROJECT AREA



LEVEL CROSSING REMOVAL PROJECT	
2.5 6.25 0 12.5 25 37.5 50	SCALE 1:1250
LENGTHS ARE IN METRES	
ORIGINAL SHEET SIZE: A3	SHEET 2 OF 4
LEGL/20-046	

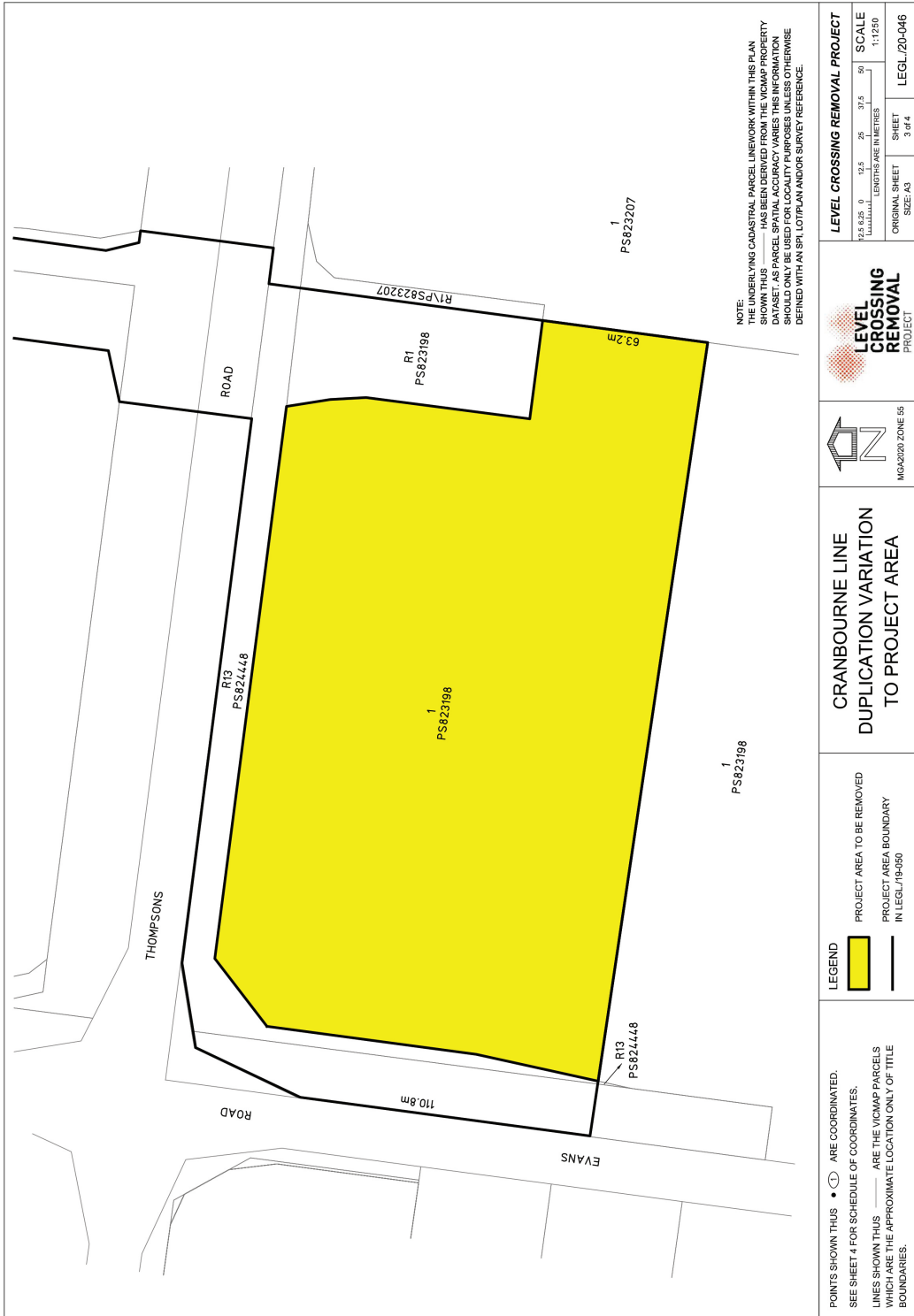

MGA2020 ZONE 55 CO-ORDINATES (METRES)
 COORDINATES ROUNDED TO THE NEAREST METRE, ADD 2 DECIMAL PLACES FOR FULL PRECISION

POINT	EAST	NORTH
1	346515	5786237
2	346603	5786032
3	346571	5786061
4	346561	5786075
5	346550	5786097
6	346544	5786111
7	346540	5786125

COORDINATE
 SCHEDULE

CRANBOURNE LINE
 DUPLICATION VARIATION
 TO PROJECT AREA



LEVEL CROSSING REMOVAL PROJECT

ORIGINAL SHEET SIZE: A3	SHEET 4 OF 4	LEGL./20-046
----------------------------	-----------------	--------------

This page was left blank intentionally

This page was left blank intentionally

ive

The *Victoria Government Gazette* is published by IVE Group Limited with the authority of the Government Printer for the State of Victoria

© State of Victoria 2021

This publication is copyright. No part may be reproduced by any process except in accordance with the provisions of the Copyright Act.

Address all enquiries to the Government Printer for the State of Victoria
Level 2, 1 Macarthur Street
Melbourne 3002
Victoria Australia

How To Order



**Retail &
Mail Sales**

Victoria Government Gazette

Ground Floor, Building 8,
658 Church Street,
Richmond 3121

DX 106 Melbourne



Telephone

(03) 8523 4601

email

gazette@ivegroup.com.au

Price Code A